

JOINT PUBLIC NOTICE

November 23, 2015

United States Army
Corps of Engineers
New Orleans District
Regulatory Branch
Post Office Box 60267
New Orleans, Louisiana 70160-0267

State of Louisiana
Department of Environmental Quality
Water Quality Certifications Section
Post Office Box 4313
Baton Rouge, Louisiana 70821-4313

(504) 862-2272
Project Manager
Amy Oestringer
Amy.L.Oestringer@usace.army.mil
MVN 2015-01659-WQQ

(225) 219-3225
Project Manager
Ms. Elizabeth Hill
WQC Application Number
WQC 15116-02

Interested parties are hereby notified that a permit application has been received by the New Orleans District of the U.S. Army Corps of Engineers pursuant to: [] Section 10 of the Rivers and Harbors Act of March 3, 1899 (30 Stat. 1151; 33 USC 403); and/or [X] Section 404 of the Clean Water Act (86 Stat. 816; 33 USC 1344).

Application has also been made to the Louisiana Department of Environmental Quality, Office of Environmental Services, for a Water Quality Certification (WQC) in accordance with statutory authority contained in LRS30:2074 A(3), and provisions of Section 401 of the Clean Water Act (P.L.95-17).

EXCAVATE AND FILL FOR DRAINAGE IMPROVEMENTS IN BUXTON CREEK IN DEQUINCY, LOUISIANA IN CALCASIEU PARISH

NAME OF APPLICANT: City of DeQuincy, c/o Arabie Environmental Solutions, Attn: Blaine Johnson, Post Office Box 928, Lake Charles, Louisiana 70602.

LOCATION OF WORK: Located within Buxton Creek, in Section 13, Township 7 South, Range 11 West, in DeQuincy, Louisiana, in Calcasieu Parish, as shown on the enclosed drawings (Latitude 30.4567 N Longitude -93.44184 W). This project is located in USGS Hydrologic Unit Code (HUC) 08080205-Lower Mississippi HUC.

CHARACTER OF WORK: The applicant is proposing to improve the alignment and install and maintain concrete pavement for drainage improvements. The proposed work section is an unpaved gap between upstream and downstream paved sections. Approximately 10,000 cubic yards of earthen material will be excavated from the channel banks. In addition to this material approximately 1,500 cubic yards of concrete and stone bedding will be deposited for the realignment of the channel. All work will be performed from the adjacent banks of the channel and will impact approximately 1.3 acres of jurisdictional waters of the US. No wetland impacts are proposed and therefore no compensatory mitigation is proposed. Best management practices will be implemented during construction activities to reduce runoff and potential water quality impacts as shown on the attached permit drawings.

The comment period for the Department of the Army Permit and the Louisiana Department of Environmental Quality WQC will close **20 days** from the date of this joint public notice. Written comments, including suggestions for modifications or objections to the proposed work, stating reasons thereof, are being solicited from anyone having interest in this

permit and/or this WQC request and must be mailed so as to be received before or by the last day of the comment period. Letters concerning the Corps of Engineers permit application must reference the applicant's name and the Permit Application Number, and be mailed to the Corps of Engineers at the address above, ATTENTION: **REGULATORY BRANCH**. Individuals or parties may request an extension of time in which to comment on the proposed work by writing to the project manager or clicking on the project manager's name on the public notice grid on the web page. Any request must be specific and substantively supportive of the requested extension, and received by this office prior to the end of the initial comment period. The Section Chief will review the request and the requestor will be promptly notified of the decision to grant or deny the request. If granted, the time extension will be continuous to the initial comment period and, inclusive of the initial comment period, will not exceed a total of 30 calendar days. Letters concerning the Water Quality Certification must reference the applicant's name and the WQC Application number and be mailed to the Louisiana Department of Environmental Quality at the address above.

The application for this proposed project is on file with the Louisiana Department of Environmental Quality and may be examined during weekdays between 8:00 a.m. and 4:30 p.m. Copies may be obtained upon payment of costs of reproduction.

Corps of Engineers Permit Criteria

The decision whether to issue a permit will be based on an evaluation of the probable impacts, including cumulative impacts of the proposed activity on the public interest. That decision will reflect the national concern for both protection and utilization of important resources. The benefit which reasonably may be expected to accrue from the proposal must be balanced against its reasonably foreseeable detriments. All factors which may be relevant to the proposal will be considered including the cumulative effects thereof; among those are conservation, economics, aesthetics, general environmental concerns, wetlands, historic properties, fish and wildlife values, flood hazards, floodplain values, land use, navigation, shoreline erosion and accretion, recreation, water supply and conservation, water quality, energy needs, safety, food and fiber production, mineral needs, considerations of property ownership and, in general, the needs and welfare of the people.

The U.S. Army Corps of Engineers is soliciting comments from the public, federal, state, and local agencies and officials, Indian Tribes, and other interested parties in order to consider and evaluate the impacts of this proposed activity. Any comments received will be considered by the U.S. Army Corps of Engineers to determine whether to make, modify, condition, or deny a permit for this proposal. To make this decision, comments are used to assess impacts on endangered species, historic properties, water quality, general environmental effects, and other public interest factors listed above. Comments are used in the preparation of an Environmental Assessment and/or an Environmental Impact Statement pursuant to the National Environmental Policy Act. Comments are also used to determine the need for a public hearing and to determine the overall public interest of the proposed activity.

The New Orleans District is unaware of properties listed on the National Register of Historic Places near the proposed work. The possibility exists that the proposed work may damage or destroy presently unknown archeological, scientific, prehistorical, historical sites, or data. Issuance of this public notice solicits input from the State Archeologist and State Historic Preservation Officer regarding potential impacts to cultural resources.

Our initial finding is that the proposed work would neither affect any species listed as endangered by the U.S. Departments of Interior or Commerce, nor affect any habitat designated as critical to the survival and recovery of any endangered species. Utilizing Standard Local Operating Procedure for Endangered Species in Louisiana (SLOPES), dated

October 22, 2014, between the U.S. Army Corps of Engineers, New Orleans and U.S. Fish and Wildlife Service, Ecological Services Office, the Corps has determined that the proposed activity would have no effect on any listed species.

This notice initiates the Essential Fish Habitat (EFH) consultation requirements of the Magnuson-Stevens Fishery Conservation and Management Act. The applicant's proposal would result in the destruction or alteration of NA acres of EFH utilized by various life stages of red drum and penaeid shrimp. Our initial determination is that the proposed action would not have a substantial adverse impact on EFH or federally managed fisheries in the Gulf of Mexico. Our final determination relative to project impacts and the need for mitigation measures is subject to review by and coordination with the National Marine Fisheries Service.

If the proposed work involves deposits of dredged or fill material into navigable waters, the evaluation of the probable impacts will include the application of guidelines established by the Administrator of the Environmental Protection Agency. Also, a certification that the proposed activity will not violate applicable water quality standards will be required from the Department of Environmental Quality, Office of Environmental Services, before a permit is issued.

Any person may request, in writing, within the comment period specified in this notice, that a public hearing be held to consider this application. Requests for public hearings shall state, with particularity, the reasons for holding a public hearing.

You are requested to communicate the information contained in this notice to any other parties whom you deem likely to have interest in the matter.

Darrell S. Barbara
Chief, Western Evaluation Section
Regulatory Branch

Enclosure

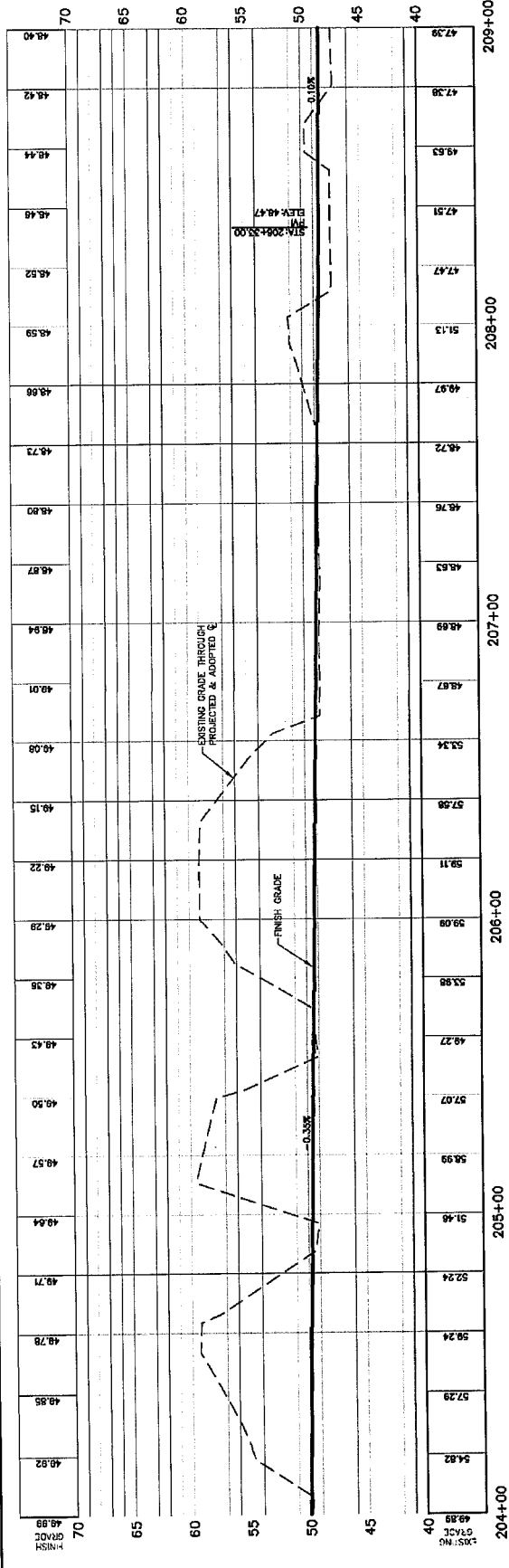
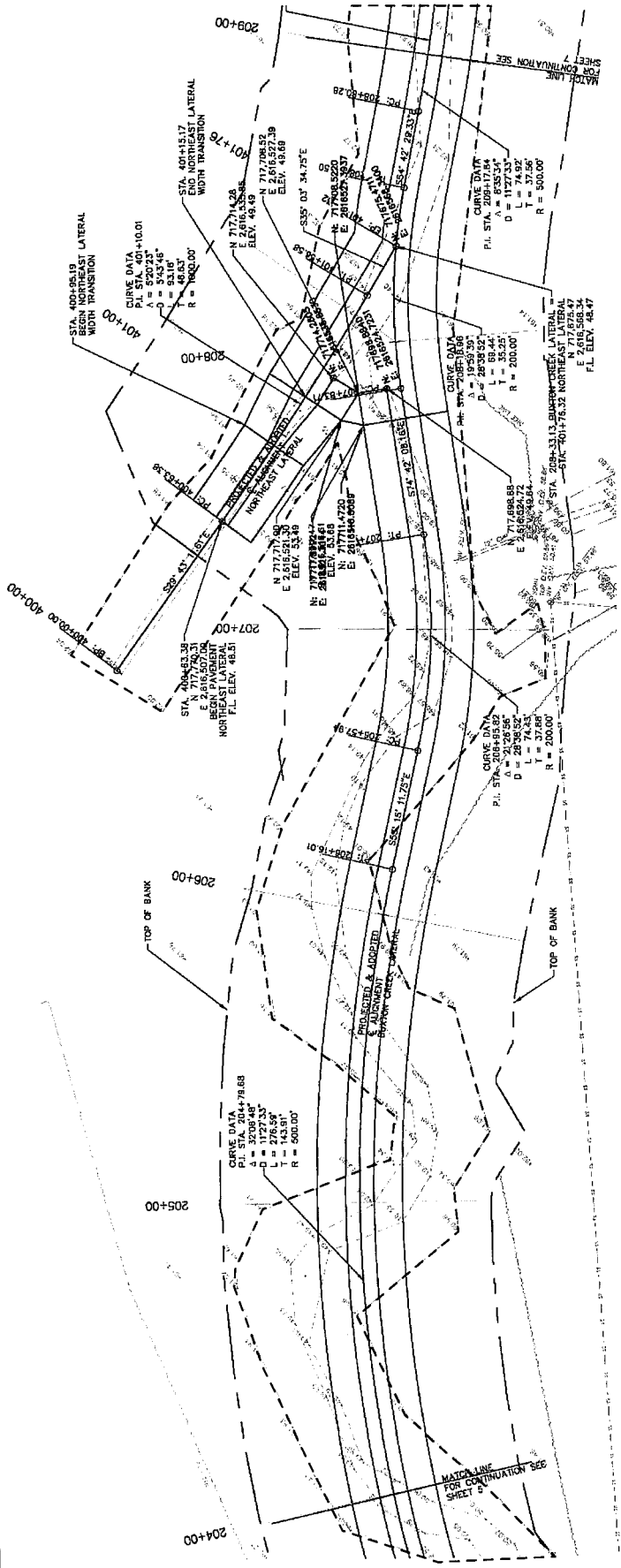
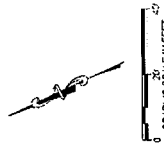

ARABEE ENVIRONMENTAL SOLUTIONS
 COURSE OF ACTION
 PLAN AND PROFILE
 PERMIT APPLICATION
 CITY OF BOCA RATON
 BOCA RATON PARKWAY
 CALOUSED PARK, LOUISIANA
 Drawn By: [Blank] Checked By: [Blank]
 Date: 10-2-2014 AES Project No: 11237
 Revised: 11-2-15

APPROXIMATE LIMIT OF SEC 404 WATERS
 Not to scale dimensions as noted
 Drawings provided by Meyer & Associates

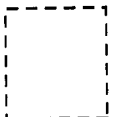

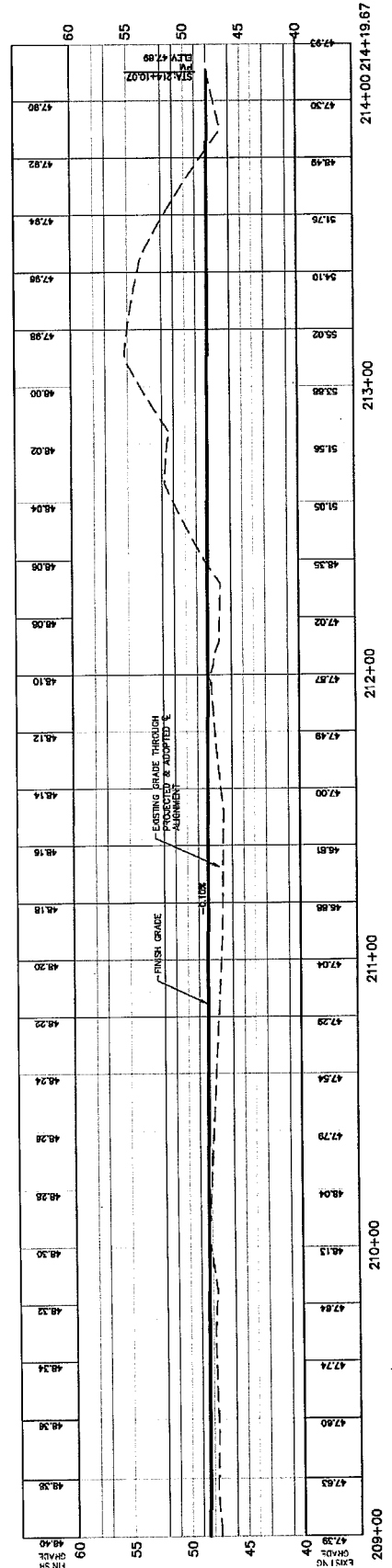
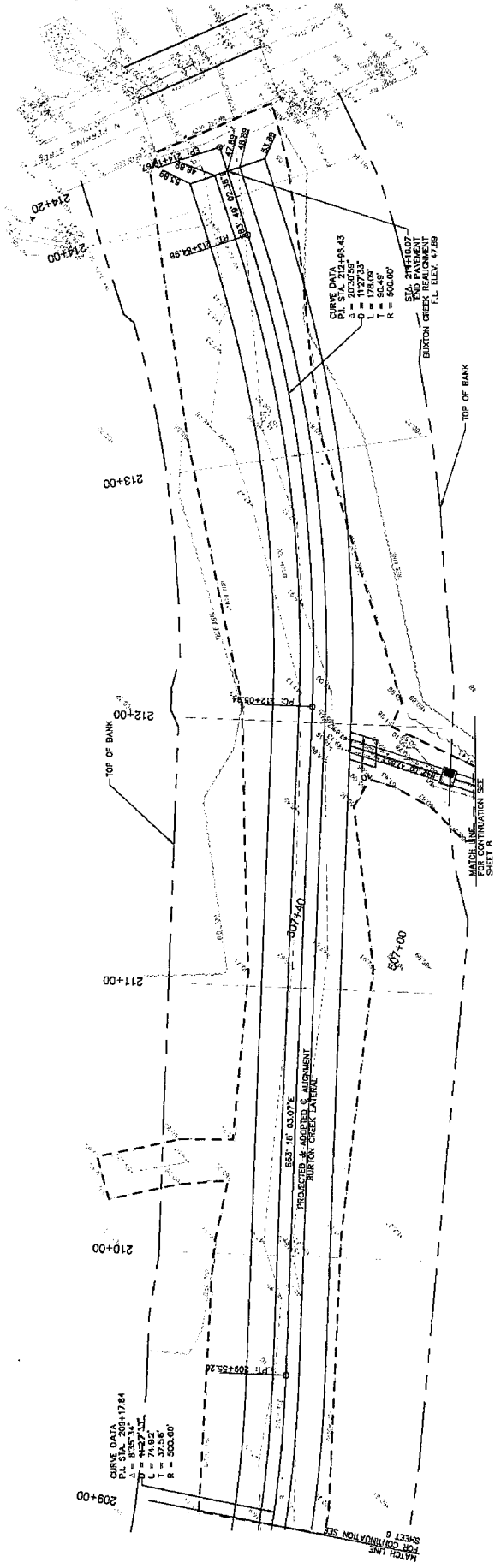
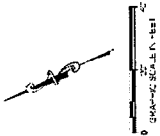

ARABIE ENVIRONMENTAL SOLUTIONS
 FIGURE 5 OF 10
 PLAN AND PROFILE
 PERMIT APPLICATION
 CITY OF BOCA RATON
 BOYCAUSE DRAINAGE
 BOCA RATON PARISH, LOUISIANA

Drawn By: 10-2-2014
 Date: 10-2-2014
 Checked By: ALES Project No: 11297

Revised: 11-2-15

APPROXIMATE LIMITS OF SEC. 404 WATERS

Not to scale dimensions as noted
 Drawings provided by Meyer & Associates

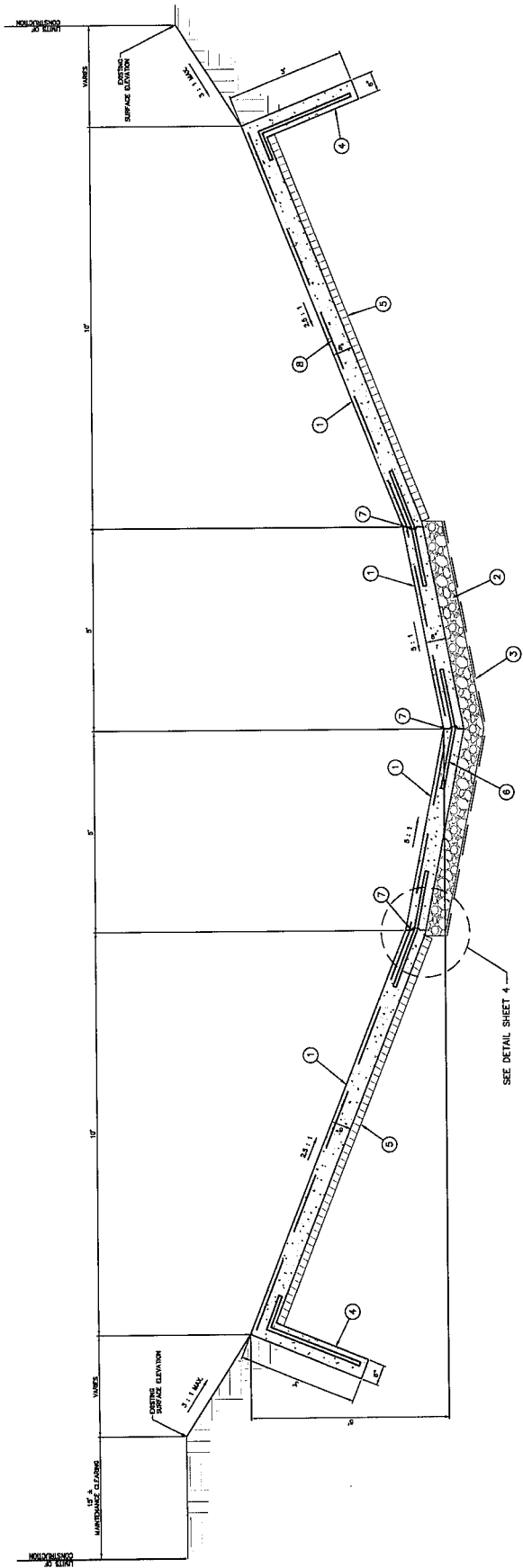

TYPICAL CHANNEL REVETMENT

APPLIES TO: STA. 200+00 TO STA. 214+10
 STA. 301+46 TO STA. 302+23
 STA. 401+16 TO STA. 401+76

KEYED NOTES

- ① REQ'D. 6" THICK CONCRETE REVETMENT (PAY ITEM 712-01-C)
- ② REQ'D. 6" THICK BEDDING (STONE) (PAY ITEM 726-01)
- ③ REQ'D. NON-WOVEN GEOTEXTILE FILTER FABRIC (INCLUDED UNDER PAY ITEM 726-01)
- ④ REQ'D. CONCRETE REVETMENT FOOTING (INCLUDED UNDER PAY ITEM S-001)
- ⑤ REQ'D. GEOTEXTILE COMPOSITE (INCLUDED UNDER PAY ITEM 712-01-C)
- ⑥ REQ'D. #4 DEF. DOWEL @ 2' CENTERS.
- ⑦ REQ'D. CONSTRUCTION JOINT. SEE SHEET 4 FOR DETAILS.
- ⑧ REQ'D. 6"X6" W4X24 WELDED WIRE FABRIC

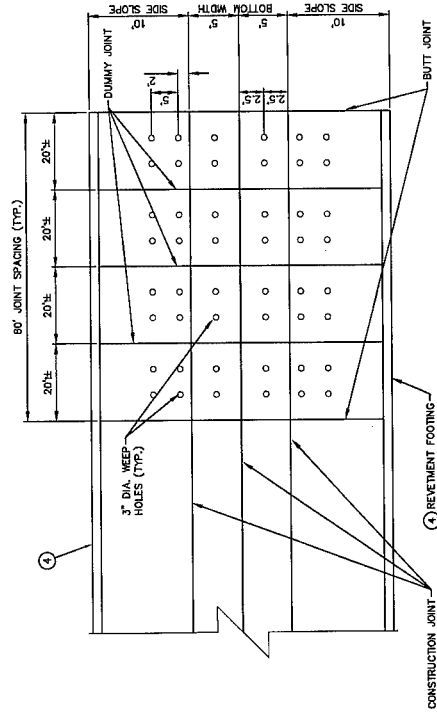

TYPICAL PLAN OF PAVED DITCH
 NO SCALE

Revised: 11-2-15

ARABIE ENVIRONMENTAL SOLUTIONS
 FIGURE 2 OF 10
 TYPICAL SECTION (MAIN LATERAL)
 PENNSYLVANIA
 CITY OF DEQUIN
 BOTTOM CREEK IMPROVEMENTS
 CALCULATED BY: [Name]

Drawn By: [Name] Checked By: [Name]
 Date: 10-8-2014 AES Project No: 11297

**Not to scale dimensions as noted
 Drawings provided by Meyer & Associates**

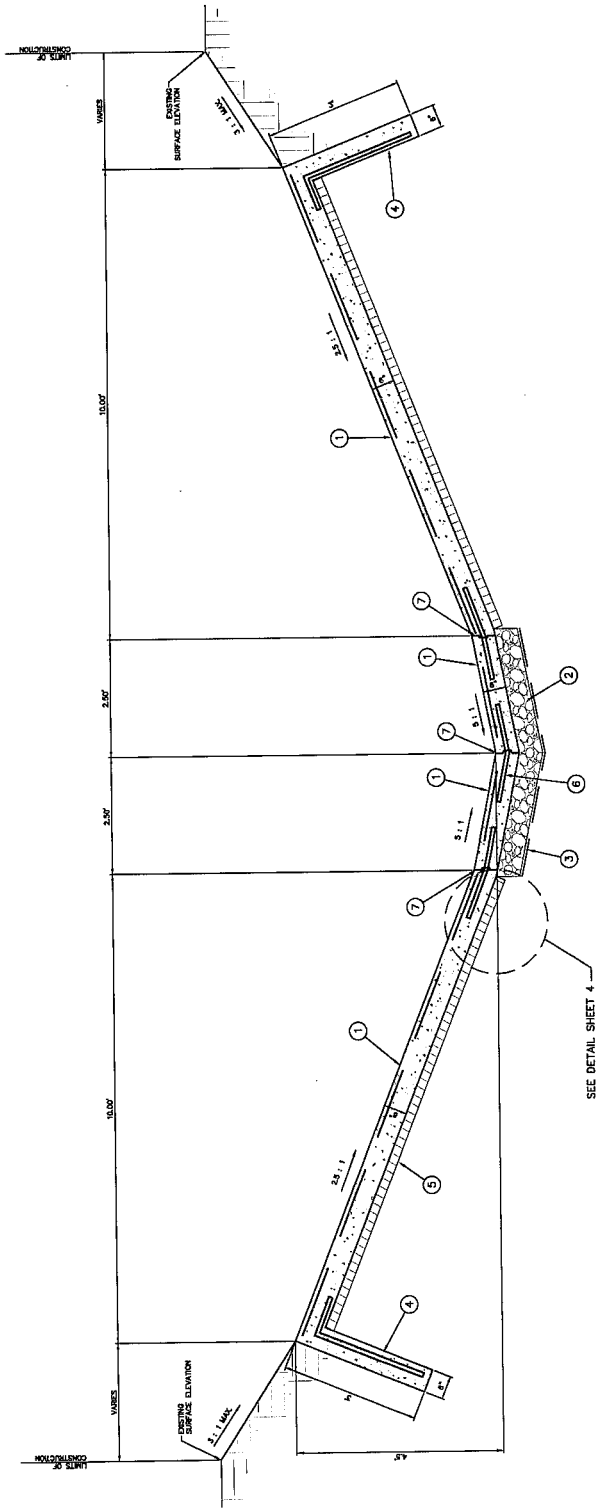

TYPICAL CHANNEL REVEMENT

APPLIES TO: STA. 300+45 TO STA. 301+26
STA. 400+63 TO STA. 400+96

KEYED NOTES

- ① REQ'D. 6" THICK CONCRETE REVEMENT (PAY ITEM 712-01-C)
- ② REQ'D. 6" THICK BEDDING (STONE) (PAY ITEM 726-01)
- ③ REQ'D. NON-WOVEN GEOTEXTILE FILTER FABRIC (INCLUDED UNDER PAY ITEM 726-01)
- ④ REQ'D. CONCRETE REVEMENT FOOTING (INCLUDED UNDER PAY ITEM S-001)
- ⑤ REQ'D. GEOTEXTILE COMPOSITE (INCLUDED UNDER PAY ITEM 712-01-C)
- ⑥ REQ'D. #4 DEF. DOWEL @ 2' CENTERS.
- ⑦ REQ'D. CONSTRUCTION JOINT. SEE SHEET 4 FOR DETAILS.
- ⑧ REQ'D. 6"x6" W4X24 WELDED WIRE FABRIC

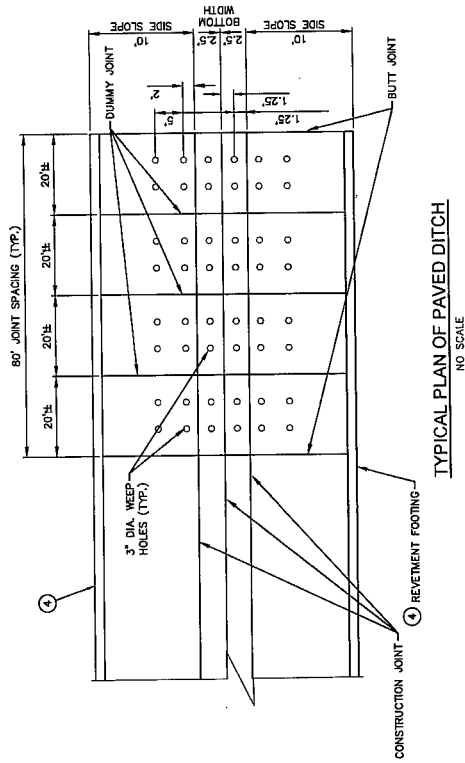

TYPICAL PLAN OF PAVED DITCH
NO SCALE

**Not to scale dimensions as noted
 Drawings provided by Meyer & Associates**

206+00.00

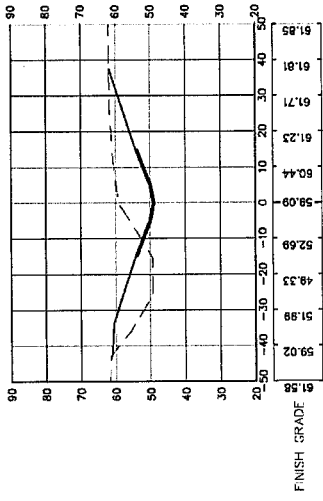

207+00.00

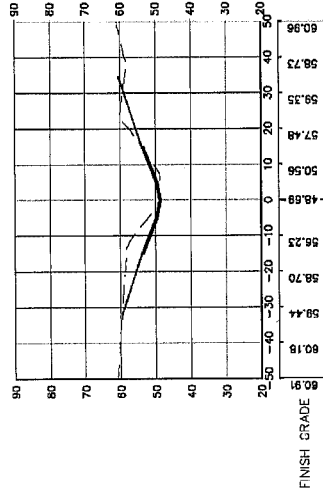

208+00.00

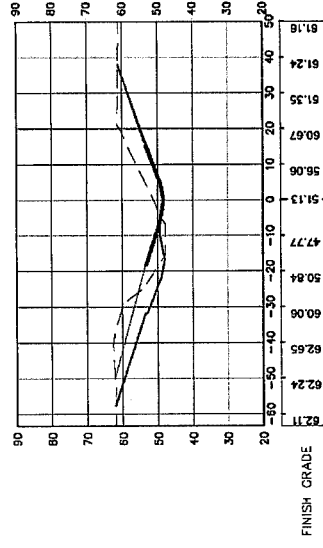

203+00.00

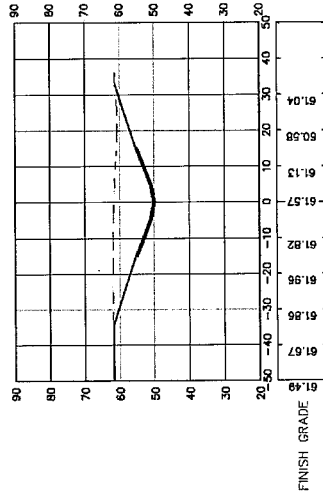

204+00.00

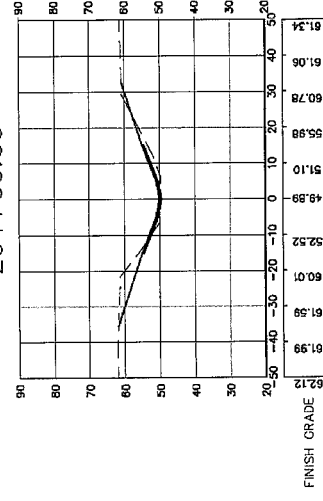

205+00.00

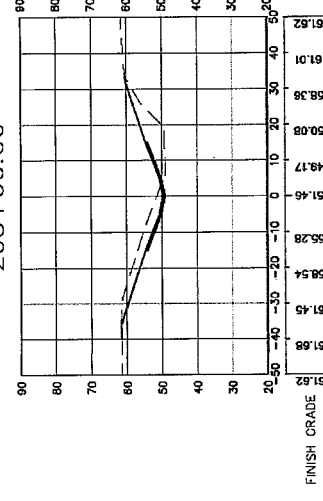

200+00.00

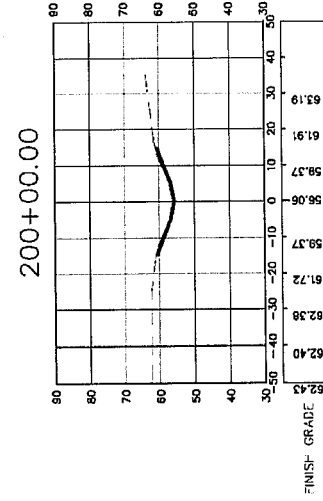

201+00.00

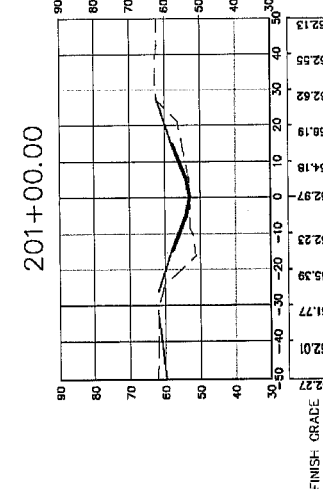

202+00.00

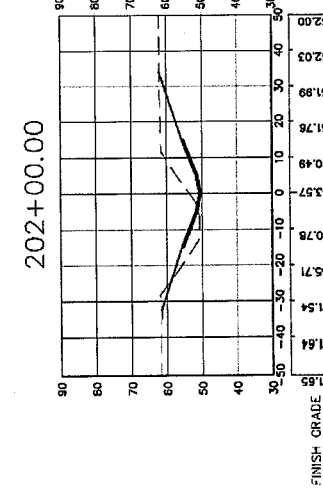

Not to scale dimensions as noted
Drawings provided by Meyer & Associates

Revised: 11-2-16

ARABIE ENVIRONMENTAL SOLUTIONS

FIGURE 7 OF 10
CROSS SECTIONS
PART OF RESUBMITTAL
AUTOMATIC FURNISHING PLAN
FOR THE CITY OF PRESIDENT JOHN F. KENNEDY
EXPANSION OF THE AIRPORT

Drawn By: [Signature] Checked By: [Signature]

Date: 10-2-2014 A/E/S Project No: 11297

209+00.00

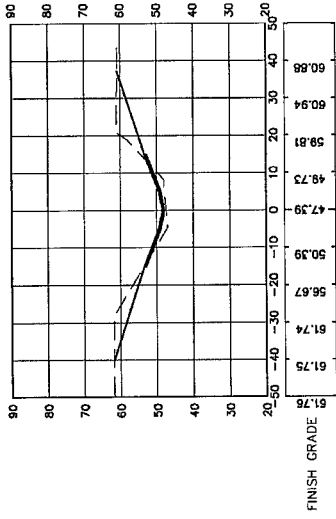

212+00.00

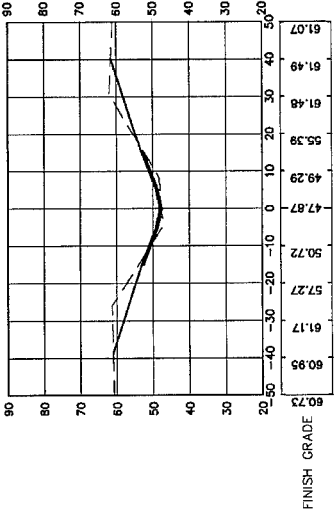

210+00.00

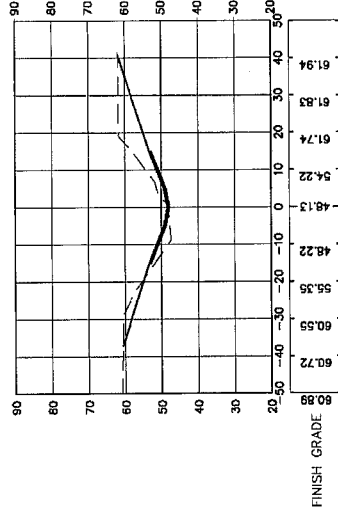

213+00.00

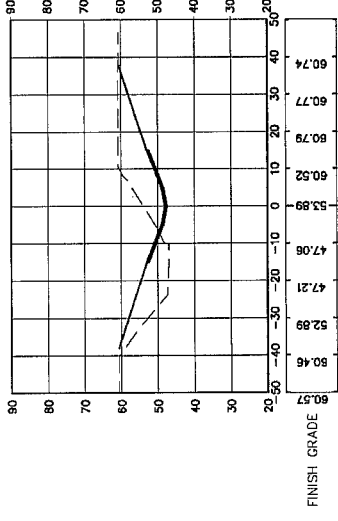

211+00.00

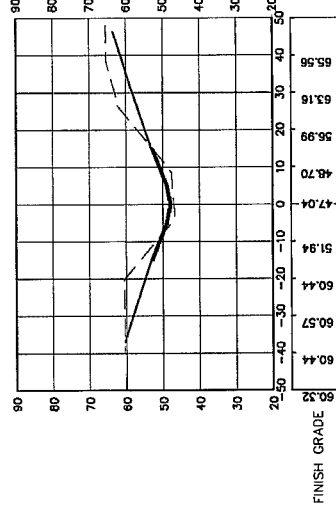

214+00.00

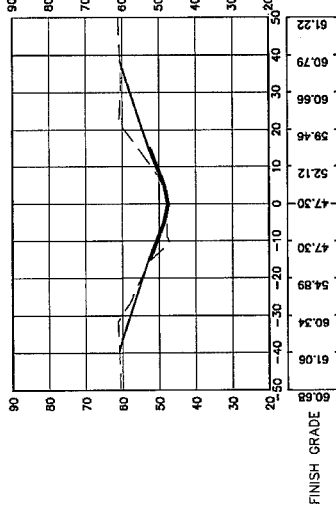

Not to scale dimensions as noted
Drawings provided by Meyer & Associates

Revised: 11-2-15

ARABIE ENVIRONMENTAL SOLUTIONS
 FIGURE 8 OF 10
 CROSS SECTIONS
 100' WIDE SIDEWALKS
 CITY OF BOULDER
 BOULDER COUNTY, COLORADO
 CALCULATED FOR: BOULDER, COLORADO

Drawn By: 10-3-2014
 Date: 10-3-2014
 Checked By: AES Project No: 11237

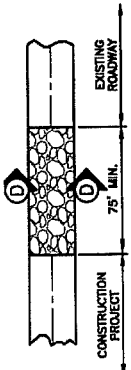

PLAN VIEW

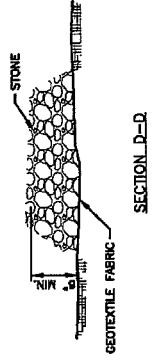

SECTION D-D

TEMPORARY STONE CONSTRUCTION ENTRANCE

NOTES:

TEMPORARY STONE CONSTRUCTION ENTRANCE AND/OR WASH RACK

A STONE STABILIZED PAD LOCATED AT POINT OF VEHICULAR INGRESS AND EGRESS ON THE CONSTRUCTION SITE TO REDUCE THE AMOUNT OF SEDIMENT AND MUD CARRIED OFF SITE BY THE ACTION OF THE VEHICLE TRAVELING OVER THE GRAVEL PAD IS NOT SUFFICIENT TO REMOVE THE MAJORITY OF THE MUD. THEN THE TIRES MUST BE WASHED BEFORE THE VEHICLE ENTERS A PUBLIC ROAD. A FEW BASIC DESIGN GUIDELINES FOR THE USE OF A STONE CONSTRUCTION ENTRANCE AND/OR WASH RACK ARE:

1. THE STONE LAYER MUST BE AT LEAST 6 INCHES THICK;
2. THE STONE SHALL CONFORM TO SECTION 711(02)(CLASS 2LB) OF THE LA DOTD STANDARD SPECIFICATION;
3. THE LENGTH OF THE PAD MUST BE AT LEAST 75 FEET AND IT MUST EXTEND THE FULL WIDTH OF THE VEHICULAR INGRESS AND EGRESS;
4. A GEOTEXTILE FABRIC UNDERLAYER IS REQUIRED. THE GEOTEXTILE FABRIC SHALL BE IN ACCORDANCE WITH SECTION 1019 (TYPE D) OF THE LA DOTD STANDARD SPECIFICATIONS;
5. IF A WASH RACK IS NECESSARY, PROVISIONS MUST BE MADE TO INTERCEPT THE WASH WATER AND TRAP THE SEDIMENT BEFORE IT IS CARRIED OFF SITE.

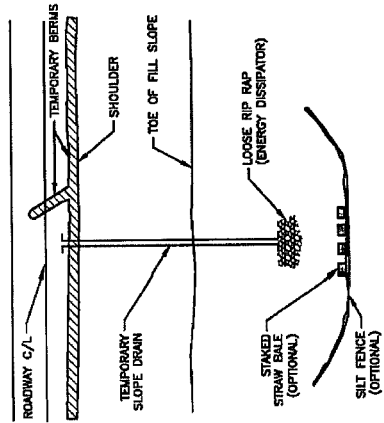

PLAN VIEW

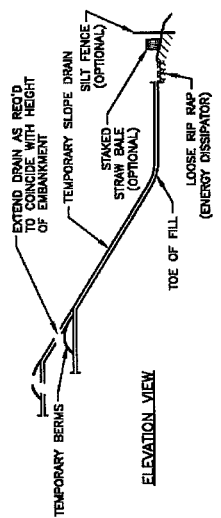

ELEVATION VIEW

TEMPORARY SLOPE DRAIN

NOTES:

A TEMPORARY SLOPE DRAIN IS A DEVICE USED TO CARRY WATER FROM THE CONSTRUCTION WORK AREA TO A LOWER ELEVATION. SLOPE DRAINS MAY BE PLASTIC SHEETS, METAL OR PLASTIC PIPE, STONE GUTTERS, FIBER MATS OR CONCRETE OR ASPHALT DITCHES. A FEW BASIC DESIGN GUIDELINES FOR THE USE OF A TEMPORARY SLOPE DRAIN ARE:

1. THE SPACING OF THE SLOPE DRAINS VARIES WITH THE ROAD GRADE.

FOR GRADES:	0.0% - 2.0%	USE 500' SPACING
	2.1% - 5.0%	USE 200' SPACING
	GREATER THAN 5.0%	USE 100' SPACING
2. SLOPE DRAIN MATERIAL:	SMOOTH PIPE	- 8" MINIMUM
	CORRUGATED PIPE	- 12" MINIMUM
	PLASTIC SHEETING	- 4" WIDE MINIMUM
	PLASTIC SHEETING	- 3 MILS THICK MINIMUM

3. PLASTIC SHEETING CAN BE STAKED DOWN OR WEIGHTED WITH ROCKS OR LOGS. THE AREA UNDER THE SHEETING SHOULD BE SHAPED TO PROVIDE AN ADEQUATE CHANNEL.
4. THE OUTLET END SHOULD BE PROTECTED OR HAVE SOME MEANS OF DISSIPATING ENERGY. THE FLOW SHOULD BE DIRECTED THROUGH A SEDIMENT TRAP SUCH AS A SILT FENCE OR HAY BALES.
5. TO INSURE PROPER OPERATION, TEMPORARY SLOPE DRAINS SHOULD BE INSPECTED REGULARLY AND AFTER EACH STORM. FUR CLOGGING OR DISPLACEMENT. EROSION AT THE OUTLET SHOULD BE CHECKED AND THE SILT TRAPS CLEANED IF NECESSARY.

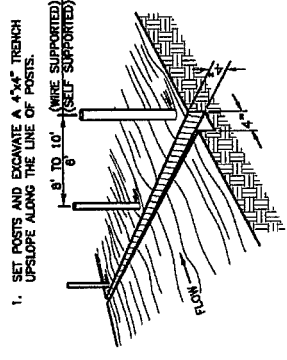

1. SET POSTS AND EXCAVATE A 4"x4" TRENCH UPSLOPE ALONG THE LINE OF POSTS.

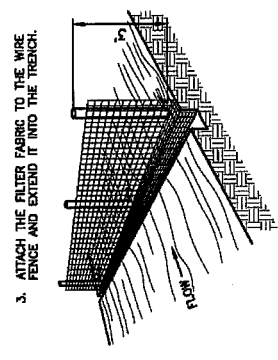

2. ATTACH THE FILTER FABRIC TO THE WIRE FENCE AND EXTEND IT INTO THE TRENCH.

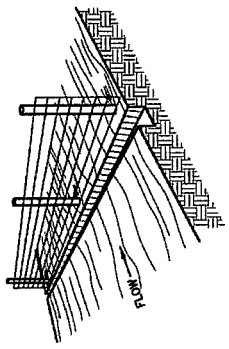

3. STAPLE WIRE FENCING TO THE POSTS.

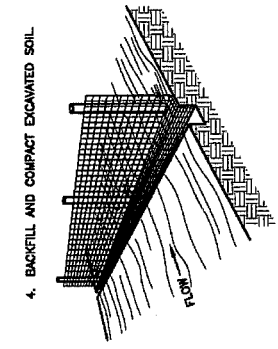

4. BACKFILL AND COMPACT EXCAVATED SOIL.

EXTENSION OF FABRIC INTO THE TRENCH

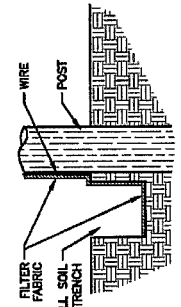

CONSTRUCTION OF TEMPORARY SILT FENCING

(WIRE SUPPORTED SILT FENCE IS SHOWN, SELF SUPPORTED SILT FENCE WILL BE CONSTRUCTED ACCORDING TO MANUFACTURERS SPECIFICATIONS.)

NOTES:

SILT FENCING IS A TEMPORARY BARRIER CONSISTING OF A FILTER FABRIC SUPPORTED BY POSTS AND STRETCHED ACROSS AN AREA TO INTERCEPT AND DETAIN SMALL AMOUNTS OF SEDIMENT. THE SILT FENCING SHALL BE IN ACCORDANCE WITH SECTION 204 OF THE LA DOTD STANDARD SPECIFICATIONS. A FEW BASIC GUIDELINES FOR THE USE OF SILT FENCING ARE:

1. USE WHERE EROSION WOULD OCCUR IN THE FORM OF SHEET AND RILL EROSION;
2. USE WHERE THE MAXIMUM DRAINAGE AREA BEHIND THE SILT FENCE IS 1/4 ACRE PER 100 FEET OF SILT FENCE LENGTH;
3. USE WHERE THE MAXIMUM SLOPE LENGTH BEHIND THE BARRIER IS 100 FEET;
4. USE WHERE THE MAXIMUM GRADIENT BEHIND THE BARRIER IS 2:1;
5. DO NOT USE SILT FENCES IN LIVE STREAMS OR IN DITCHES OR SWALES WHERE FLOWS EXCEED ONE CUBIC FOOT PER SECOND.

ARABIE ENVIRONMENTAL SOLUTIONS
 FIGURES OF 10 TYPICAL BMP'S
 PERMIT APPLICATION
 FOR THE IMPROVEMENTS
 BLUANT CREEK IMPROVEMENTS
 CALCAHOU PARISH, LOUISIANA

Revised: 11-2-15

Drawn By: 10-9-2014
 Checked By: AES Project No: 11237
 Date:

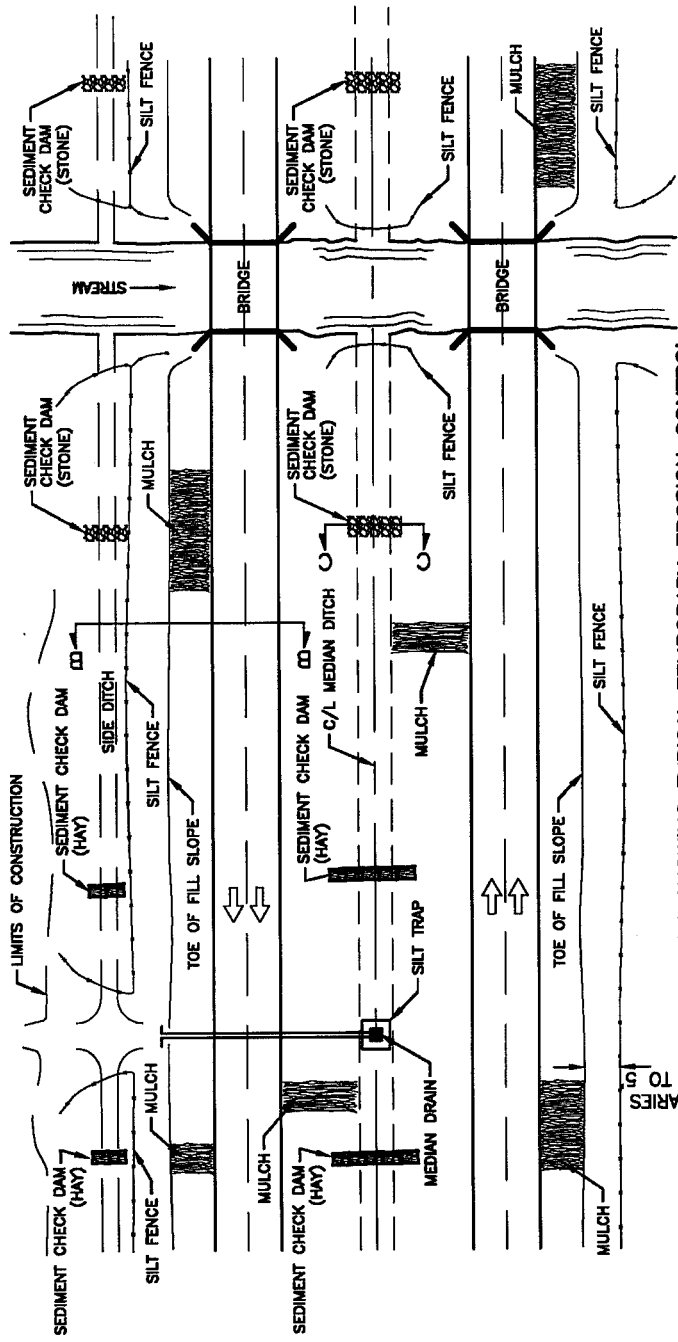

PLAN SHOWING TYPICAL TEMPORARY EROSION CONTROL

MULCHES

MULCHES ARE THE APPLICATION OF MATS OF MATERIAL PLACED ON THE SOIL SURFACE TO PREVENT EROSION BY PROTECTING THE SOIL SURFACE FROM RAINDROP IMPACT AND TO REDUCE THE VELOCITY OF OVERLAND FLOW. MULCHES CAN BE ORGANIC OR SYNTHETIC. MULCHES SHALL BE IN ACCORDANCE WITH SUBSECTION 1018.19 OF THE LA DOTD STANDARD SPECIFICATIONS. A FEW GUIDELINES THE USE OF MULCHES ARE:

1. USE ON CUT AND EMBANKMENT SLOPES WHICH HAVE NOT BEEN COMPLETED TO PLAN GRADE OR WHERE THE WEATHER OR SOIL CONDITIONS WILL NOT PERMIT COMPETING THEN WITHIN A REASONABLE TIME;
2. USE ON CLEARED, GRUBBED AND SCALPED AREAS WHERE SOIL EROSION IS LIKELY TO OCCUR;
3. USE WITH TEMPORARY SEEDING.

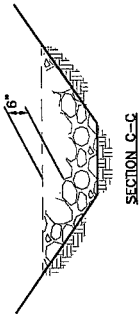

TEMPORARY SEDIMENT CHECK DAM (STONE)

NOTES:

1. A STONE CHECK DAM IS A SMALL TEMPORARY DAM CONSTRUCTED ACROSS A SWALE OR DRAINAGE DITCH. THE PURPOSE OF THIS MEASURE IS TO REDUCE THE VELOCITY OF OVERLAND FLOW, PREVENT RAINDROP IMPACT, AND TRAP SMALL AMOUNTS OF SEDIMENTS GENERATED IN THE DITCH ITSELF. HOWEVER IT SHOULD NOT BE USED AS A SEDIMENT TRAPPING DEVICE. A FEW BASIC DESIGN GUIDELINES FOR THE USE OF STONE CHECK DAMS ARE:
1. USE IN SMALL OPEN CHANNELS THAT DRAIN 10 ACRES OR LESS;
2. DO NOT USE IN A LIVE STREAM;
3. USE IN A TEMPORARY DITCH OR SWALE WHICH, BECAUSE OF THEIR SHORT LENGTH OF SERVICE, CANNOT RECEIVE A NON-ERODIBLE LINING;
4. USE IN PERMANENT DITCHES OR SWALES WHICH WILL NOT RECEIVE A PERMANENT LINING FOR AN EXTENDED PERIOD OF TIME;
5. USE IN TEMPORARY OR PERMANENT DITCHES OR SWALES WHICH NEED PROTECTION DURING THE ESTABLISHMENT OF GRASS LININGS;
6. FOR STONE SPECIFICATIONS SEE SUBSECTION 711.02(A)(CLASS 2LB.) OF THE LA DOTD STANDARD SPECIFICATIONS.

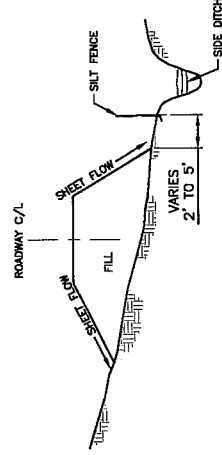

TEMPORARY SILT FENCE APPLICATION

(FOR CONSTRUCTION DETAILS AND SPECIFICATIONS SEE DETAILS)