



DEPARTMENT OF THE ARMY
U.S. ARMY CORPS OF ENGINEERS, NEW ORLEANS DISTRICT
7400 LEAKE AVE
NEW ORLEANS, LA 70118-3651

April 10, 2023

Regulatory Division
Eastern Evaluation Branch

Project Manager:
Angelle Greer
(504) 862-2279
angelle.v.greer@usace.army.mil

Application #: MVN-2014-02293-EG

PUBLIC NOTICE

Interested parties are hereby notified that a permit application has been received by the New Orleans District of the U.S. Army Corps of Engineers pursuant to: [X] Section 10 of the Rivers and Harbors Act of March 3, 1899 (30 Stat. 1151; 33 USC 403); and [X] Section 404 of the Clean Water Act (86 Stat. 816; 33 USC 1344).

DREDGING WITHIN THE MISSISSIPPI RIVER FOR MARSH RESTORATION IN PLAQUEMINES PARISH

NAME OF APPLICANT: Coastal Protection and Restoration Authority (CPRA), Attn: Sydney Dobson, P.O. Box 44027, Baton Rouge, LA 70804 (sydney.dobson@la.gov)

LOCATION OF WORK: At approximately Latitude: 29.542261, Longitude: -89.806953, and within the Mississippi River, mile 46 AHP, near Magnolia, Louisiana, in Plaquemines Parish, as shown on the enclosed drawings.

Hydrologic Unit Code: 08090301 (Lower Mississippi- East Central Louisiana Coastal)

CHARACTER OF WORK: Excavation of approximately 6,900,000-cubic yards of sediment material from within the Mississippi River, and placement of dredged material within an approximate 672-acre area to the west to create/restore marsh habitat and a forested coastal ridge. Temporary impacts to approximately 929-acres of existing wetlands and waters may occur during excavation and fill placement activities, however, the project proposes to create approximately 440-acres of marsh wetlands upon completion.

The comment period on the requested Department of the Army Permit will close **30 days** from the date of this public notice. Written comments, including suggestions for modifications or objections to the proposed work, stating reasons thereof, are being solicited from anyone having interest in this permit request, and must be submitted so as to be received before or by the last day of the comment period. Letters and/or comments concerning the subject permit application must reference the Applicant's Name and the Permit Application Number and can be preferably emailed to angelle.v.greer@usace.army.mil or forwarded to the Corps of Engineers at the address above, ATTENTION: REGULATORY DIVISION (RGE, Angelle Greer). This public notice is also available for review online at <https://go.usa.gov/xennJ>.

Corps of Engineers Permit Criteria

The decision whether to issue a Section 10/404 permit will be based on an evaluation of the probable impacts, including cumulative impacts of the proposed activity on the public interest. That decision will reflect the national concern for both protection and utilization of important resources. The benefit which reasonably may be expected to accrue from the proposal must be balanced against its reasonably foreseeable detriments. All factors which may be relevant to the proposal will be considered including the cumulative effects thereof; among those are conservation, economics, aesthetics, general environmental concerns, wetlands, historic properties, fish and wildlife values, flood hazards, floodplain values, land use, navigation, shoreline erosion and accretion, recreation, water supply and conservation, water quality, energy needs, safety, food and fiber production, mineral needs, considerations of property ownership and, in general, the needs and welfare of the people.

The U.S. Army Corps of Engineers is soliciting comments from the public, federal, state, and local agencies and officials, Indian Tribes, and other interested parties in order to consider and evaluate the impacts of this proposed activity. Any comments received will be considered by the U.S. Army Corps of Engineers to determine whether to make, modify, condition, or deny a permit for this proposal. To make this decision, comments are used to assess impacts on endangered species, historic properties, water quality, general environmental effects, and other public interest factors listed above. Comments are used in the preparation of an Environmental Assessment and/or an Environmental Impact Statement pursuant to the National Environmental Policy Act. Comments are also used to determine the need for a public hearing and to determine the overall public interest of the proposed activity. Further, all factors that may be relevant to the proposal will be considered, including the potential cumulative effects associated with the proposed project.

The New Orleans District is unaware of any properties listed on the National Register of Historic Places near the proposed work. The possibility exists that the proposed work may damage or destroy presently unknown archeological, scientific, prehistorical, historical sites, or data. As deemed necessary, copies of this public notice will be sent to the State Archeologist, State Historic Preservation Officer and federally listed tribes regarding potential impacts to cultural resources.

Our initial finding is that the proposed work would neither affect any species listed as endangered by the U.S. Departments of Interior or Commerce, nor affect any habitat designated as critical to the survival and recovery of any endangered species. Based on the Information Planning and Consultation (IPaC) tool for Endangered Species in Louisiana, as signed on January 27, 2020, between the U.S. Army Corps of Engineers, New Orleans and the U.S. Fish and Wildlife Service (USFWS), it has been determined that the proposed project may affect the Eastern Black Rail (*Laterallus jamaicensis* ssp. *jamaicensis*), and is not likely to adversely affect the Pallid Sturgeon (*Scaphirhynchus albus*) or the West Indian Manatee (*Trichechus manatus*). Consultation with USFWS regarding potential project-related effects to the Eastern Black Rail is in progress. Standard Manatee Conditions for In-Water Activities will be added to the permit, if authorized.

This notice initiates the Essential Fish Habitat (EFH) consultation requirements of the Magnuson-Stevens Fishery Conservation and Management Act. The applicant's proposal may result in the destruction or alteration of approximately 732-acres of EFH utilized by various life stages of red drum and penaeid shrimp. Our initial determination is that the proposed action would not have a substantial adverse impact on EFH or federally managed fisheries in the Gulf of Mexico. Our final determination relative to project impacts and the need for mitigation measures is subject to review by and coordination with the National Marine Fisheries Service.

If the proposed work involves deposits of dredged or fill material into navigable waters, the evaluation of the probable impacts will include the application of guidelines established by the Administrator of the Environmental Protection Agency. Also, a certification that the proposed activity will not violate applicable water quality standards will be required from the Department of Environmental Quality, Water Quality Certifications, before a permit is issued.

Any person may request, in writing, within the comment period specified in this notice, that a public hearing be held to consider this application. Requests for public hearings shall state, with particularity, the reasons for holding a public hearing.

The applicant has certified that the proposed activity described in the application complies with and will be conducted in a manner that is consistent with the Louisiana Coastal Resources Program (Louisiana Coastal Zone Application P20221102). The Department of the Army permit will not be issued unless the applicant received approval or a waiver of the Coastal Use Permit by the Department of Natural Resources.

You are requested to communicate the information contained in this notice to any other parties whom you deem likely to have interest in the matter.

Brad P. LaBorde
Chief, Eastern Evaluation Branch
Regulatory Division

INDEX TO SHEETS

SHEET NO.	DESCRIPTION
1	TITLE SHEET
2 - 3	EQUIPMENT ACCESS CORRIDOR
4	PREVIOUSLY PERMITTED BORROW AREA LAYOUT
5 - 6	DREDGE PIPELINE CORRIDOR LAYOUT
7	MARSH CREATION AREA 1 PLAN VIEW
8	MARSH CREATION AREAS 2 AND 3 PLAN VIEW
9	EQUIPMENT ACCESS TYPICAL SECTION
10	PREVIOUSLY PERMITTED TYPICAL BORROW AREA SECTION
11	TYPICAL MARSH CREATION AREA SECTIONS
12	EARTHEN RIDGE DETAIL
13	MISSISSIPPI RIVER LEVEE TYPICAL SECTION
14	MISSISSIPPI RIVER AND NOV LEVEE CROSSING DETAILS
15 - 16	LIMESTONE ROAD CROSSING DETAILS
17	HIGHWAY CROSSING SECTION
18	TEMPORARY WARNING SIGN DETAIL
19	NAVIGATIONAL CROSSING AND TEMPORARY DREDGE PIPELINE MARKER DETAIL
20	TEMPORARY CANAL CROSSING DETAIL

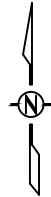

STATE OF LOUISIANA COASTAL PROTECTION AND RESTORATION AUTHORITY

GRAND BAYOU RIDGE AND MARSH RESTORATION PROJECT NO. BA-0217 PLAQUEMINES PARISH, LOUISIANA

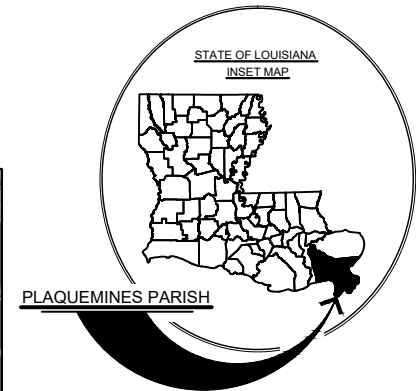
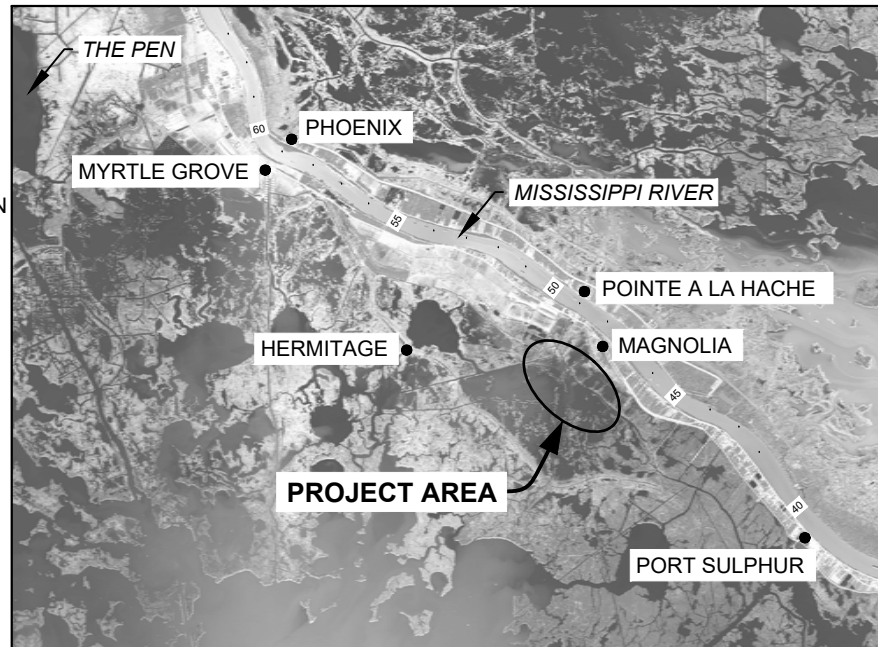

NOT FOR CONSTRUCTION
DOCUMENTS ARE NOT TO BE USED FOR
CONSTRUCTION, BIDDING,
RECORDATION, CONVEYANCE, OR SALES.

<p>APPLICATION BY: CPRA P.O. BOX 44027 BATON ROUGE, LA 70804</p>	<p>COASTAL PROTECTION AND RESTORATION AUTHORITY 150 TERRACE AVENUE BATON ROUGE, LOUISIANA 70802</p>	<p>GRAND BAYOU RIDGE AND MARSH RESTORATION</p>	<p>TITLE SHEET</p>
		<p>STATE PROJECT NUMBER: BA-0217</p>	<p>DATE: NOV. 2022</p>
<p>DRAWN BY: K. CANTU</p>	<p>DESIGNED BY: A. LINSON, P.E. 44730</p>	<p>APPROVED BY: M. MELTON, P.E. 36787</p>	<p>FEDERAL PROJECT NUMBER: SHEET 1 OF 20</p>

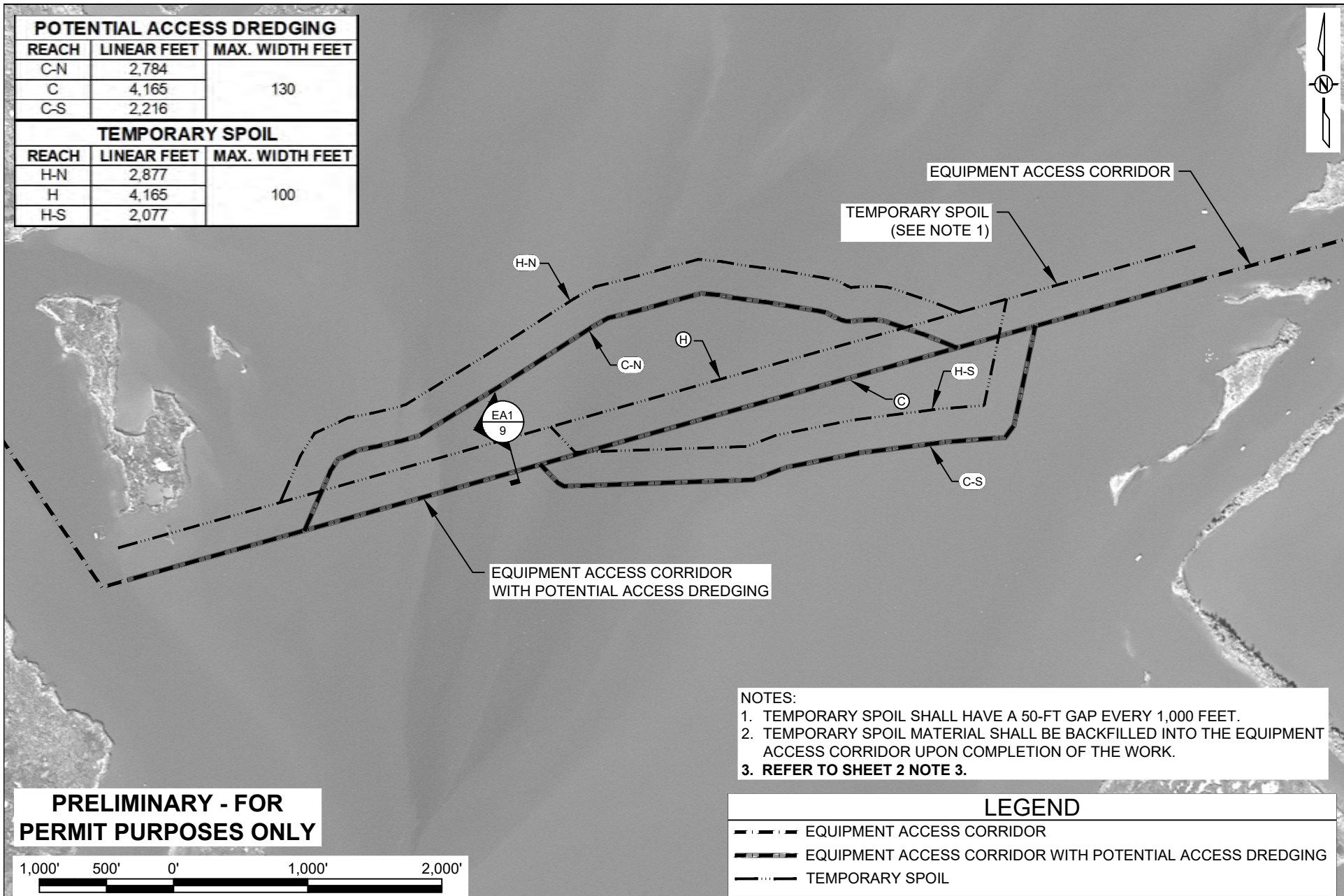

APPLICATION BY: CPRA P.O. BOX 44027 BATON ROUGE, LA 70804	COASTAL PROTECTION AND RESTORATION AUTHORITY 150 TERRACE AVENUE BATON ROUGE, LOUISIANA 70802		GRAND BAYOU RIDGE AND MARSH RESTORATION	EQUIPMENT ACCESS CORRIDOR
			STATE PROJECT NUMBER: BA-0217	DATE: NOV. 2022
DRAWN BY: K. CANTU	DESIGNED BY: A. LINSON, P.E.	APPROVED BY: M. MELTON, P.E. 36787	FEDERAL PROJECT NUMBER:	SHEET 3 OF 20

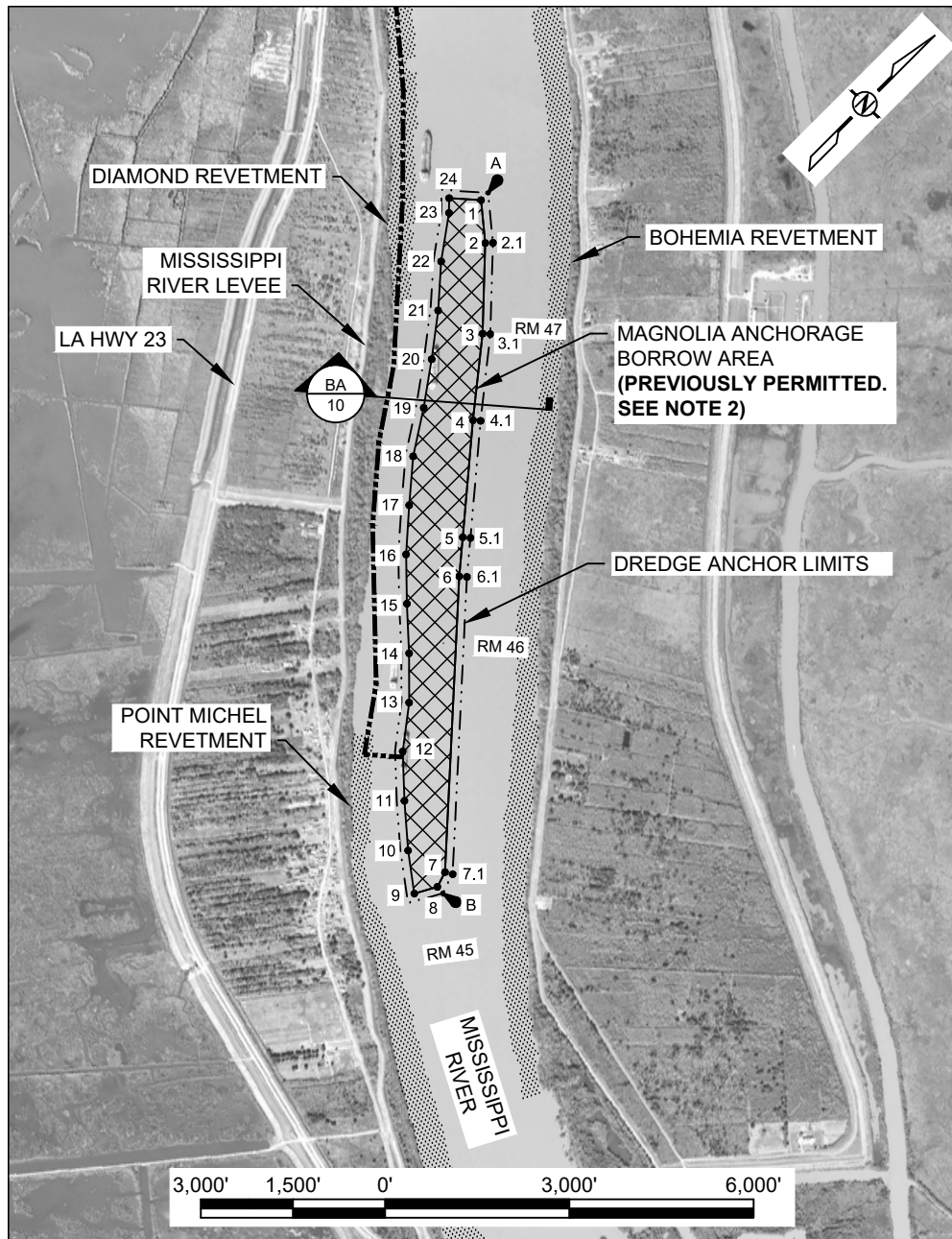

BORROW AREA QUANTITIES

VOLUME (MCY)	AREA (ACRES)
6.9	197

PRELIMINARY - FOR PERMIT PURPOSES ONLY

NOTES:

1. THE CONTRACTOR SHALL NOT DREDGE OUTSIDE THE BORROW AREA LIMITS, WHICH IS THE TOP OF CUT.
2. REFER TO SHEET 2 NOTE 3.

MAGNOLIA ANCHORAGE BORROW AREA

	LATITUDE	LONGITUDE
1	29° 33' 40.58"	89° 46' 46.11"
2	29° 33' 36.10"	89° 46' 40.04"
3	29° 33' 25.34"	89° 46' 28.74"
4	29° 33' 14.26"	89° 46' 18.89"
5	29° 32' 59.59"	89° 46' 05.19"
6	29° 32' 54.67"	89° 46' 00.62"
7	29° 32' 18.90"	89° 45' 24.48"
8	29° 32' 16.34"	89° 45' 23.59"
9	29° 32' 12.98"	89° 45' 25.78"
10	29° 32' 17.25"	89° 45' 32.13"
11	29° 32' 22.57"	89° 45' 39.01"
12	29° 32' 28.10"	89° 45' 45.59"
13	29° 32' 34.45"	89° 45' 51.01"
14	29° 32' 40.15"	89° 45' 57.36"
15	29° 32' 45.62"	89° 46' 04.02"
16	29° 32' 51.24"	89° 46' 10.48"
17	29° 32' 57.25"	89° 46' 16.38"
18	29° 33' 03.35"	89° 46' 22.15"
19	29° 33' 10.13"	89° 46' 26.97"
20	29° 33' 16.64"	89° 46' 32.18"
21	29° 33' 23.00"	89° 46' 37.58"
22	29° 33' 29.01"	89° 46' 43.49"
23	29° 33' 35.51"	89° 46' 48.71"
24	29° 33' 37.21"	89° 46' 50.59"

DREDGE ANCHOR LIMITS COORDINATES

	LATITUDE	LONGITUDE
A	29° 33' 42.21"	89° 46' 46.12"
2.1	29° 33' 36.99"	89° 46' 39.06"
3.1	29° 33' 26.14"	89° 46' 27.66"
4.4	29° 33' 15.03"	89° 46' 17.79"
5.1	29° 33' 00.37"	89° 46' 04.09"
6.1	29° 32' 55.47"	89° 45' 59.54"
7.1	29° 32' 19.52"	89° 45' 23.21"
B	29° 32' 16.19"	89° 45' 22.06"

BUOYS MARKING DREDGE ANCHOR LIMITS

	LATITUDE	LONGITUDE
A	29° 33' 42.21"	89° 46' 46.12"
B	29° 32' 16.19"	89° 45' 22.06"

LEGEND

	BORROW AREA (PREVIOUSLY PERMITTED)
	REVETMENT
	DREDGE ANCHOR LIMITS
	DREDGE PIPELINE CORRIDOR
	BOUY
RM 50	MISSISSIPPI RIVER MILE

APPLICATION BY:

CPRA
P.O. BOX 44027
BATON ROUGE, LA 70804

COASTAL PROTECTION AND RESTORATION AUTHORITY

150 TERRACE AVENUE
BATON ROUGE, LOUISIANA 70802

GRAND BAYOU RIDGE AND MARSH RESTORATION

PREVIOUSLY PERMITTED BORROW AREA LAYOUT

STATE PROJECT NUMBER: BA-0217

DATE: NOV. 2022

DRAWN BY: K. CANTU

DESIGNED BY: A. LINSON, P.E. 44730

APPROVED BY: M. MELTON, P.E. 36787

FEDERAL PROJECT NUMBER:

SHEET 4 OF 20

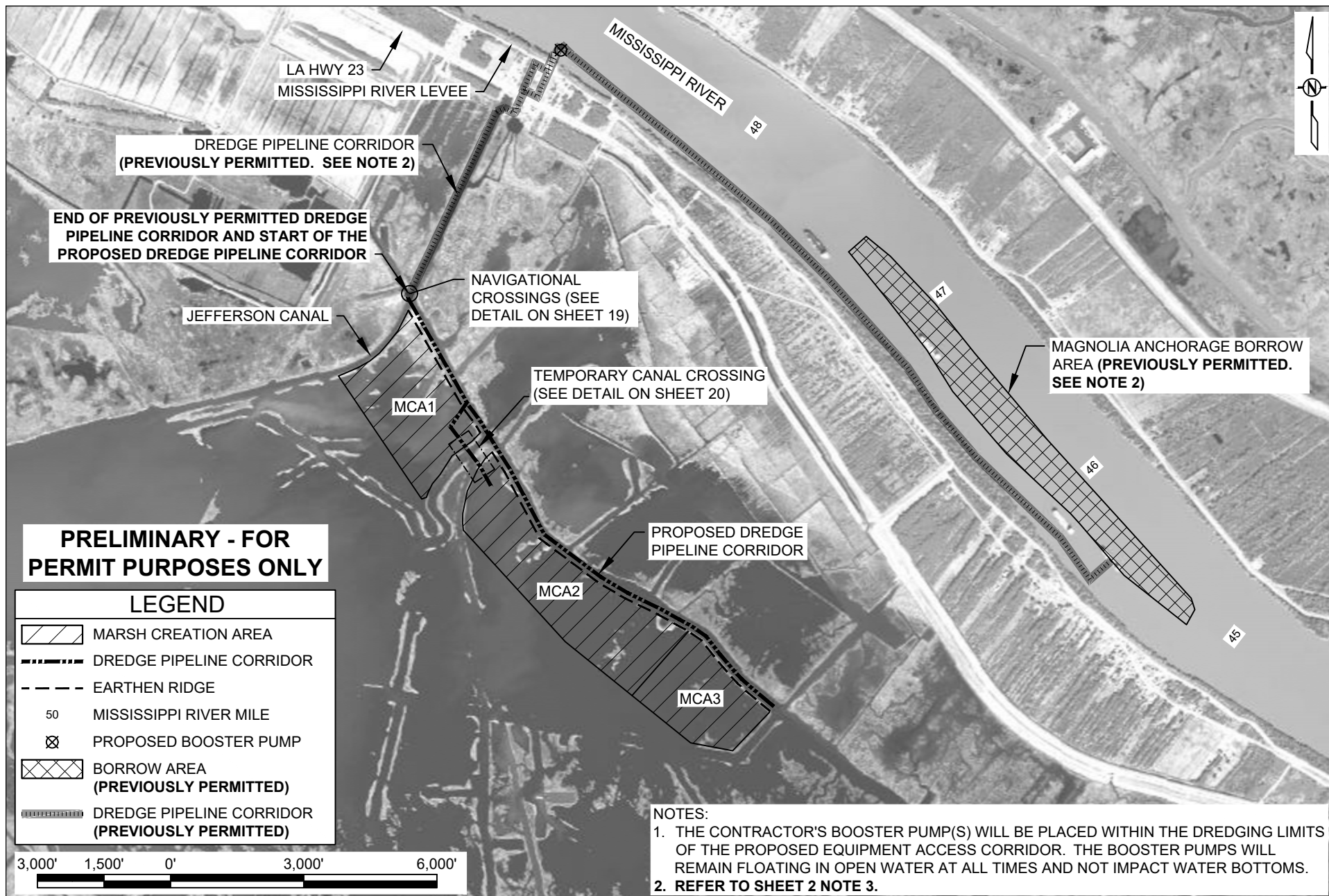

APPLICATION BY: CPRA P.O. BOX 44027 BATON ROUGE, LA 70804	COASTAL PROTECTION AND RESTORATION AUTHORITY 150 TERRACE AVENUE BATON ROUGE, LOUISIANA 70802		GRAND BAYOU RIDGE AND MARSH RESTORATION STATE PROJECT NUMBER: BA-0217	DREDGE PIPELINE COORIDOR LAYOUT DATE: NOV. 2022
DRAWN BY: K. CANTU	DESIGNED BY: A. LINSON, P.E. 44730	APPROVED BY: M. MELTON, P.E. 36787	FEDERAL PROJECT NUMBER:	SHEET 5 OF 20

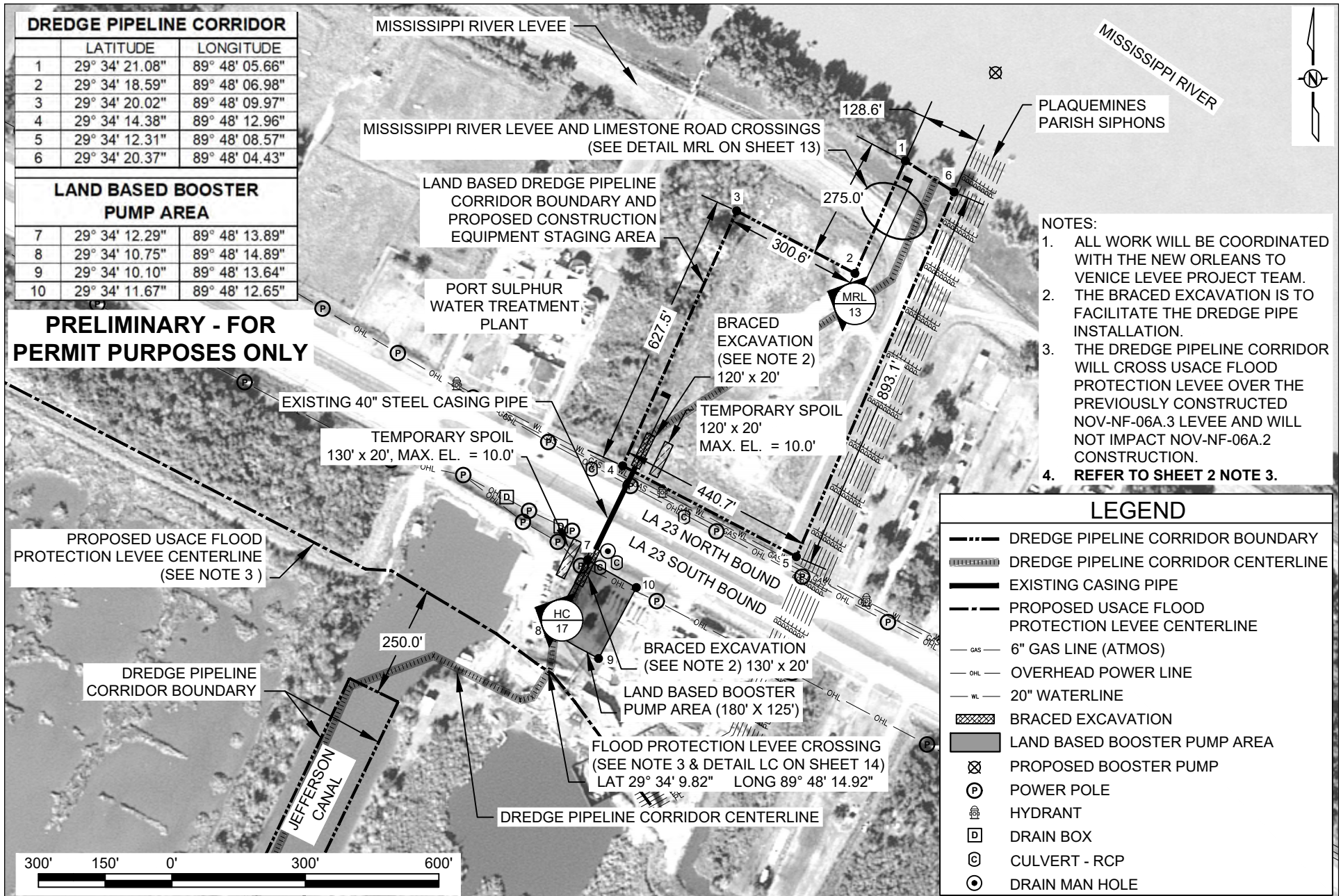

APPLICATION BY: CPRA P.O. BOX 44027 BATON ROUGE, LA 70804	COASTAL PROTECTION AND RESTORATION AUTHORITY 150 TERRACE AVENUE BATON ROUGE, LOUISIANA 70802	GRAND BAYOU RIDGE AND MARSH RESTORATION		DREDGE PIPELINE CORRIDOR LAYOUT
		STATE PROJECT NUMBER: BA-0217		DATE: NOV. 2022
DRAWN BY: K. CANTU	DESIGNED BY: A. LINSON, P.E. 44730	APPROVED BY: M. MELTON, P.E. 36787	FEDERAL PROJECT NUMBER:	SHEET 6 OF 20

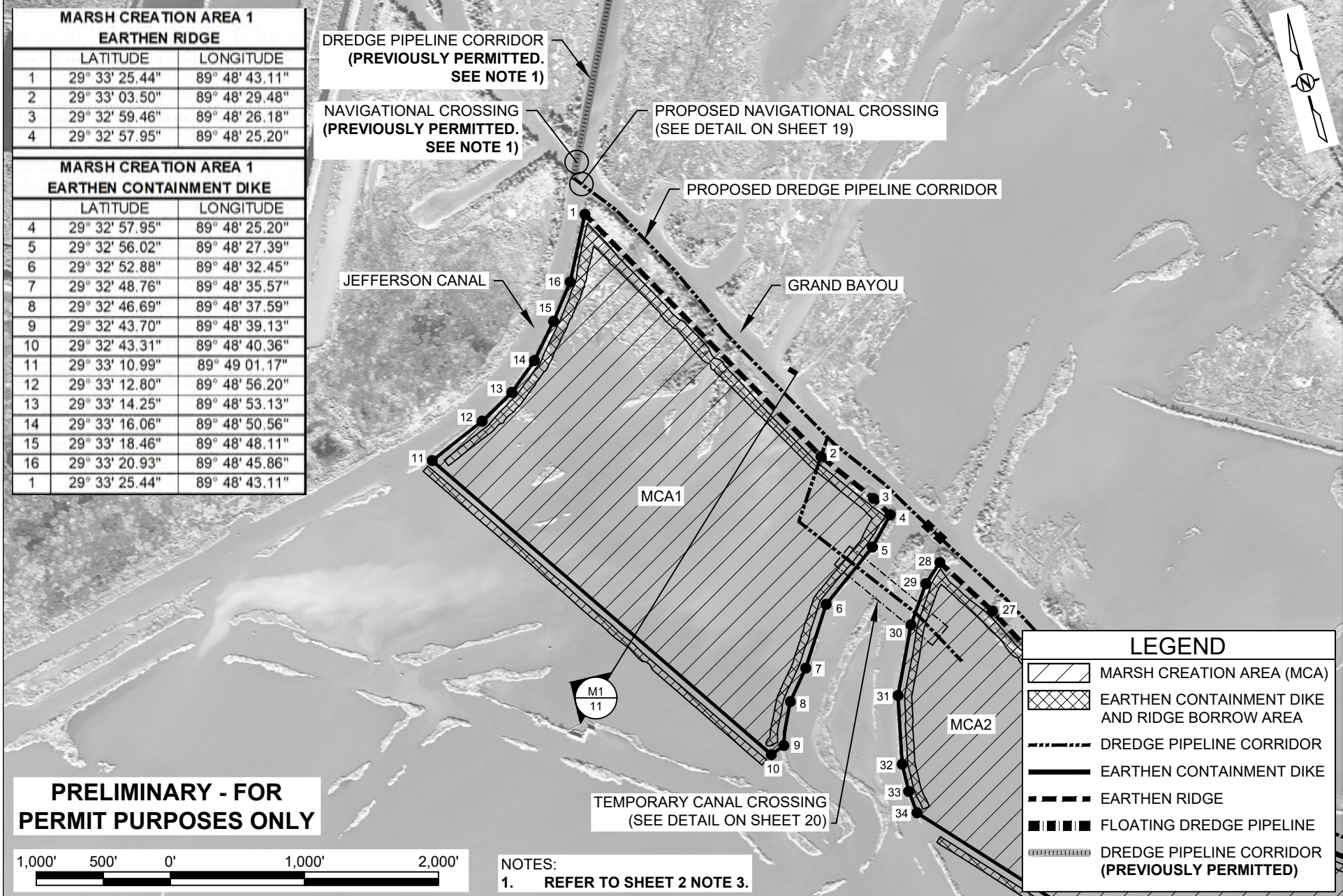

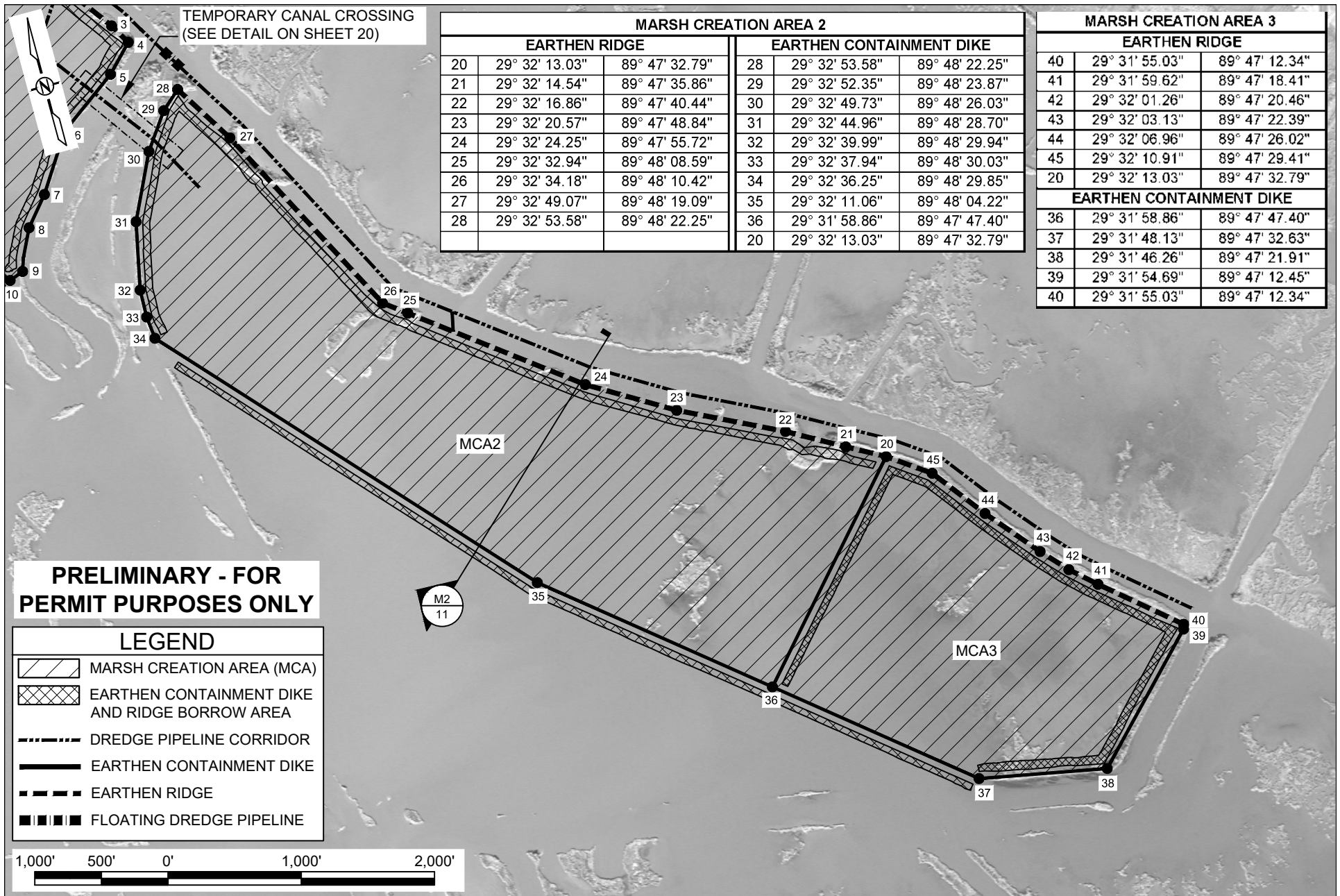

APPLICATION BY: CPRA P.O. BOX 44027 BATON ROUGE, LA 70804	COASTAL PROTECTION AND RESTORATION AUTHORITY 150 TERRACE AVENUE BATON ROUGE, LOUISIANA 70802		GRAND BAYOU RIDGE AND MARSH RESTORATION	MARSH CREATION AREA 2 AND 3 PLAN VIEW
DRAWN BY: K. CANTU	DESIGNED BY: A. LINSON, P.E. 44730	APPROVED BY: M. MELTON, P.E. 36787	STATE PROJECT NUMBER: BA-0217 FEDERAL PROJECT NUMBER:	DATE: NOV. 2022 SHEET 8 OF 20

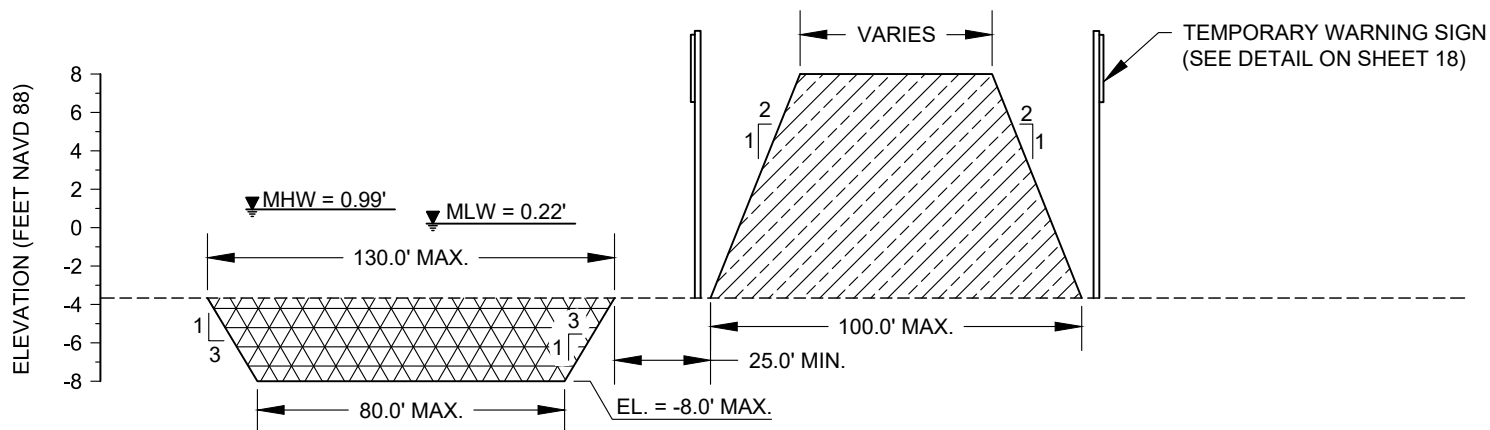

EA1
2.3 **POTENTIAL EQUIPMENT ACCESS DREDGING SECTION**

PRELIMINARY - FOR PERMIT PURPOSES ONLY

NOTES:

1. ALL VESSELS WILL REMAIN WITHIN THE EQUIPMENT ACCESS DREDGING LIMITS, FLOATING IN OPEN WATER, AND NOT IMPACT WATER BOTTOMS BEYOND WHAT IS SHOWN IN THE SECTIONS.

2. REFER TO SHEET 2 NOTE 3.

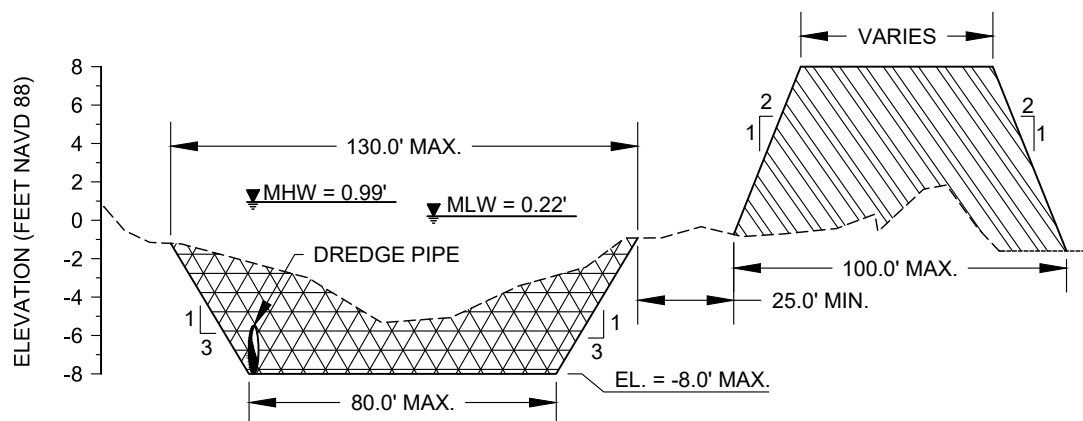

EA2
2 **POTENTIAL EQUIPMENT ACCESS DREDGING SECTION**

LEGEND	
	POTENTIAL EQUIPMENT ACCESS DREDGING
	PERMANENT SPOIL
	TEMPORARY SPOIL
	EXISTING WATER BOTTOM

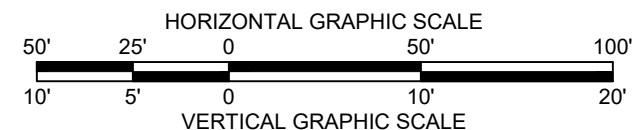

APPLICATION BY: CPRA P.O. BOX 44027 BATON ROUGE, LA 70804	COASTAL PROTECTION AND RESTORATION AUTHORITY 150 TERRACE AVENUE BATON ROUGE, LOUISIANA 70802	GRAND BAYOU RIDGE AND MARSH RESTORATION		EQUIPMENT ACCESS TYPICAL SECTION
		STATE PROJECT NUMBER: BA-0240		DATE: NOV. 2022
DRAWN BY: K. CANTU	DESIGNED BY: A. LINSON, P.E.	APPROVED BY: M. MELTON, P.E. 36787	FEDERAL PROJECT NUMBER:	SHEET 9 OF 20

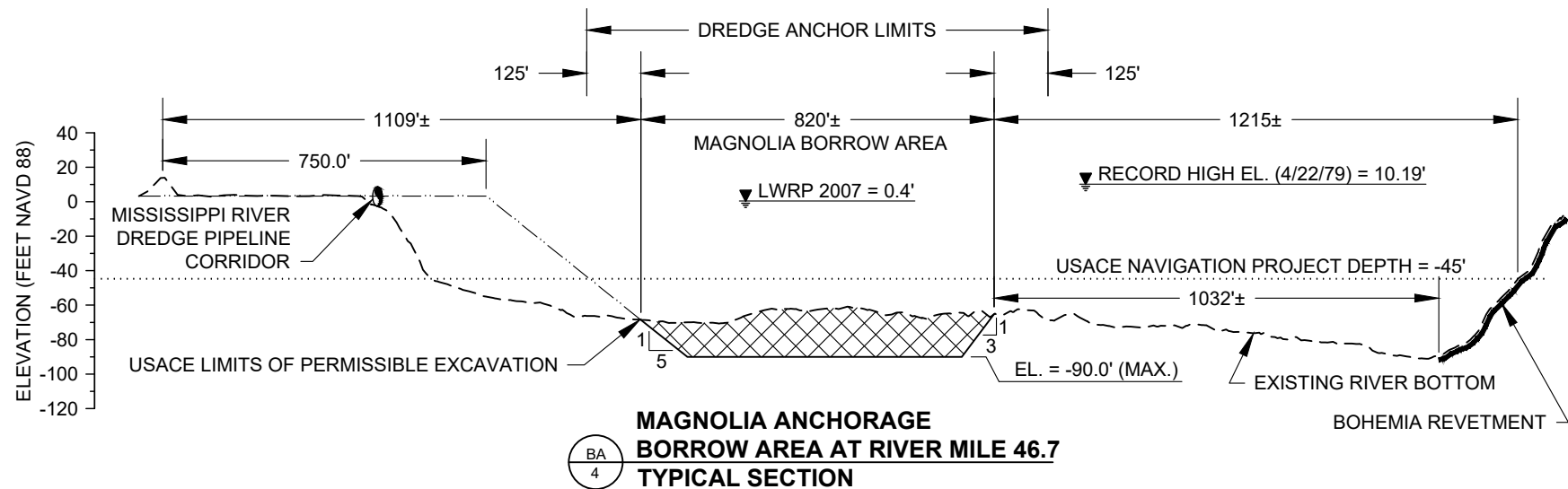

PRELIMINARY - FOR PERMIT PURPOSES ONLY

LEGEND	
	BORROW AREA
	NOVEMBER - DECEMBER 2019 SURVEY
	APPROXIMATE EXISTING GRADE
	EXISTING REVETMENT

NOTES:
1. REFER TO SHEET 2 NOTE 3.

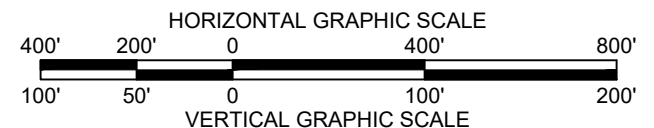

APPLICATION BY: CPRA P.O. BOX 44027 BATON ROUGE, LA 70804	COASTAL PROTECTION AND RESTORATION AUTHORITY 150 TERRACE AVENUE BATON ROUGE, LOUISIANA 70802		GRAND BAYOU RIDGE AND MARSH RESTORATION	PREVIOUSLY PERMITTED TYPICAL BORROW AREA SECTION
			STATE PROJECT NUMBER: BA-0217	DATE: NOV. 2022
DRAWN BY: K. CANTU	DESIGNED BY: A. LINSON, P.E. 44730	APPROVED BY: M. MELTON, P.E. 36787	FEDERAL PROJECT NUMBER:	SHEET 10 OF 20

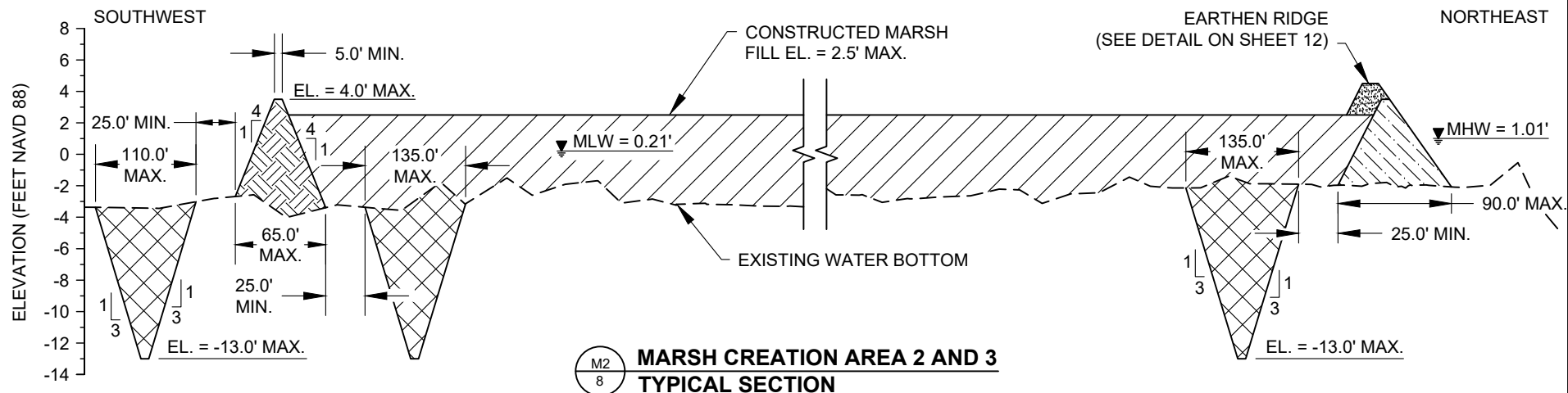
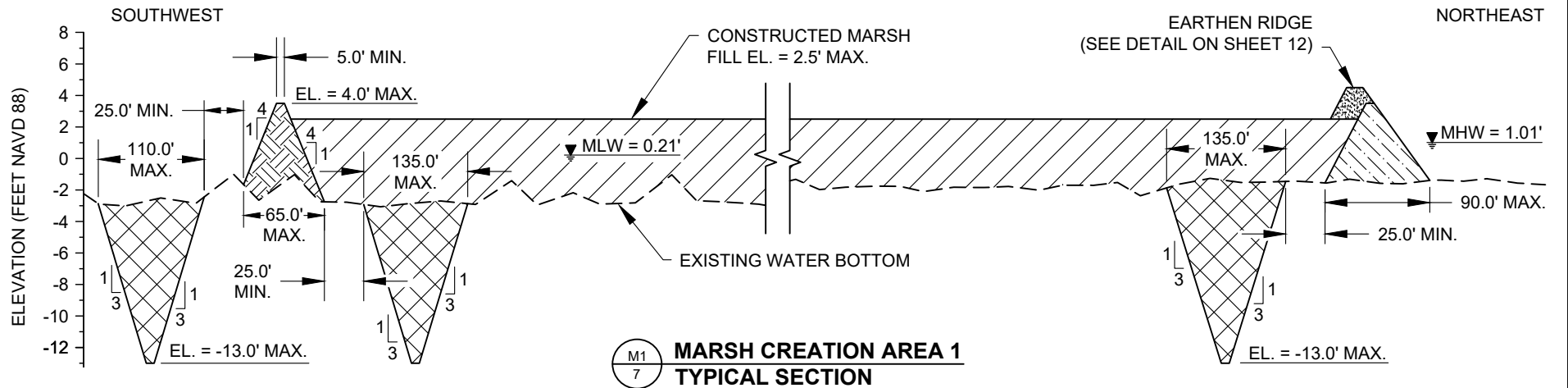

LEGEND

	BORROW AREA		EARTHEN RIDGE - 2ND LIFT (SAND CAP)
	EARTHEN CONTAINMENT DIKE		MARSH CREATION FILL
	EARTHEN RIDGE - 1ST LIFT (IN-SITU)		EXISTING WATER BOTTOM

PRELIMINARY - FOR PERMIT PURPOSES ONLY

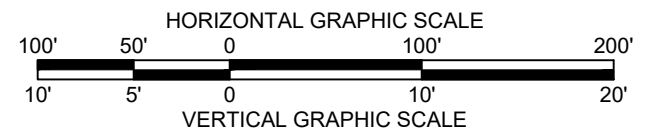

APPLICATION BY:
CPRA
P.O. BOX 44027
BATON ROUGE, LA 70804

**COASTAL PROTECTION AND
RESTORATION AUTHORITY**
150 TERRACE AVENUE
BATON ROUGE, LOUISIANA 70802

GRAND BAYOU RIDGE AND
MARSH RESTORATION

TYPICAL MARSH CREATION
AREA SECTIONS

STATE PROJECT NUMBER: BA-0217

DATE: NOV. 2022

DRAWN BY: K. CANTU

DESIGNED BY: A. LINSON, P.E. 44730

APPROVED BY: M. MELTON, P.E. 36787

FEDERAL PROJECT NUMBER:

SHEET 11 OF 20

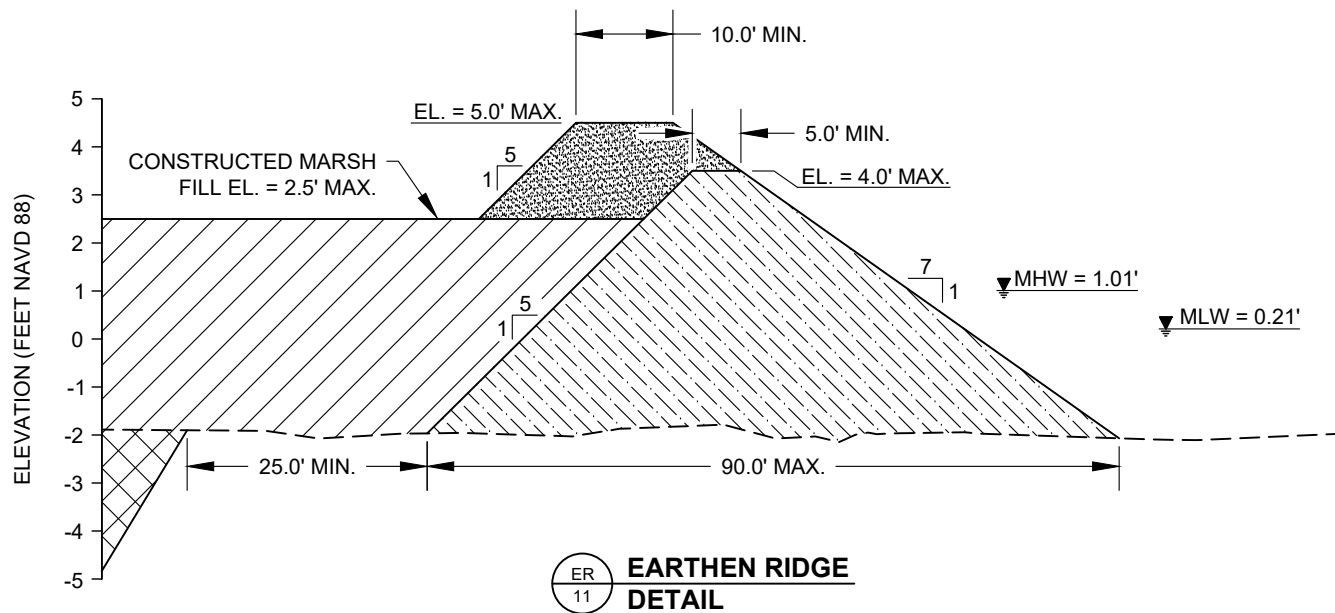

**EARTHEN RIDGE
DETAIL**

LEGEND	
	BORROW AREA
	EARTHEN RIDGE - 1ST LIFT (IN-SITU)
	EARTHEN RIDGE - 2ND LIFT (SAND CAP)
	MARSH CREATION FILL
	EXISTING WATER BOTTOM

**PRELIMINARY - FOR
PERMIT PURPOSES ONLY**

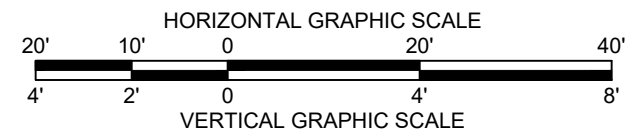

APPLICATION BY: CPRA P.O. BOX 44027 BATON ROUGE, LA 70804	COASTAL PROTECTION AND RESTORATION AUTHORITY 150 TERRACE AVENUE BATON ROUGE, LOUISIANA 70802		GRAND BAYOU RIDGE AND MARSH RESTORATION	EARTHEN RIDGE DETAIL
			STATE PROJECT NUMBER: BA-0217	DATE: NOV. 2022
DRAWN BY: K. CANTU	DESIGNED BY: A. LINSON, P.E. 44730	APPROVED BY: M . MELTON, P.E. 36787	FEDERAL PROJECT NUMBER:	SHEET 12 OF 20

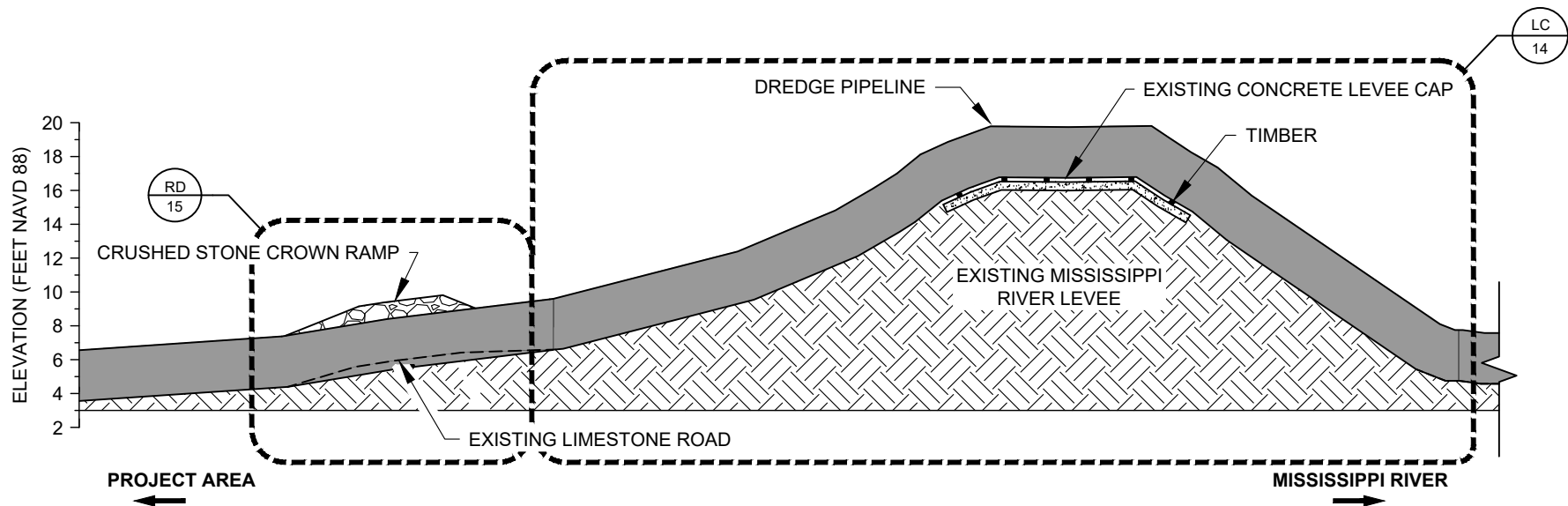

MRL
6
**MISSISSIPPI RIVER LEVEE AND ADJACENT
LIMESTONE ROAD CROSSING SECTION**

LEGEND

	MISSISSIPPI RIVER LEVEE
	DREDGE PIPELINE
	LIMESTONE ROAD
	EXISTING GROUND
	CONCRETE LEVEE CAP
	EXISTING MISSISSIPPI RIVER LEVEE
	EXISTING CONCRETE LEVEE CAP
	TIMBER

NOTES:
1. REFER TO SHEET 2 NOTE 3.

**PRELIMINARY - FOR
PERMIT PURPOSES ONLY**

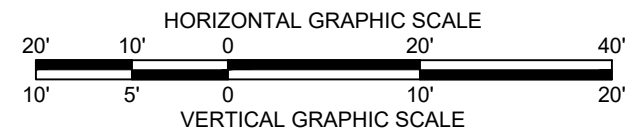

APPLICATION BY: CPRA P.O. BOX 44027 BATON ROUGE, LA 70804	COASTAL PROTECTION AND RESTORATION AUTHORITY 150 TERRACE AVENUE BATON ROUGE, LOUISIANA 70802		GRAND BAYOU RIDGE AND MARSH RESTORATION	MISSISSIPPI RIVER LEVEE TYPICAL SECTION
			STATE PROJECT NUMBER: BA-0217	DATE: NOV. 2022
DRAWN BY: K. CANTU	DESIGNED BY: A. LINSON, P.E. 44730	APPROVED BY: M. MELTON, P.E. 36787	FEDERAL PROJECT NUMBER:	SHEET 13 OF 20

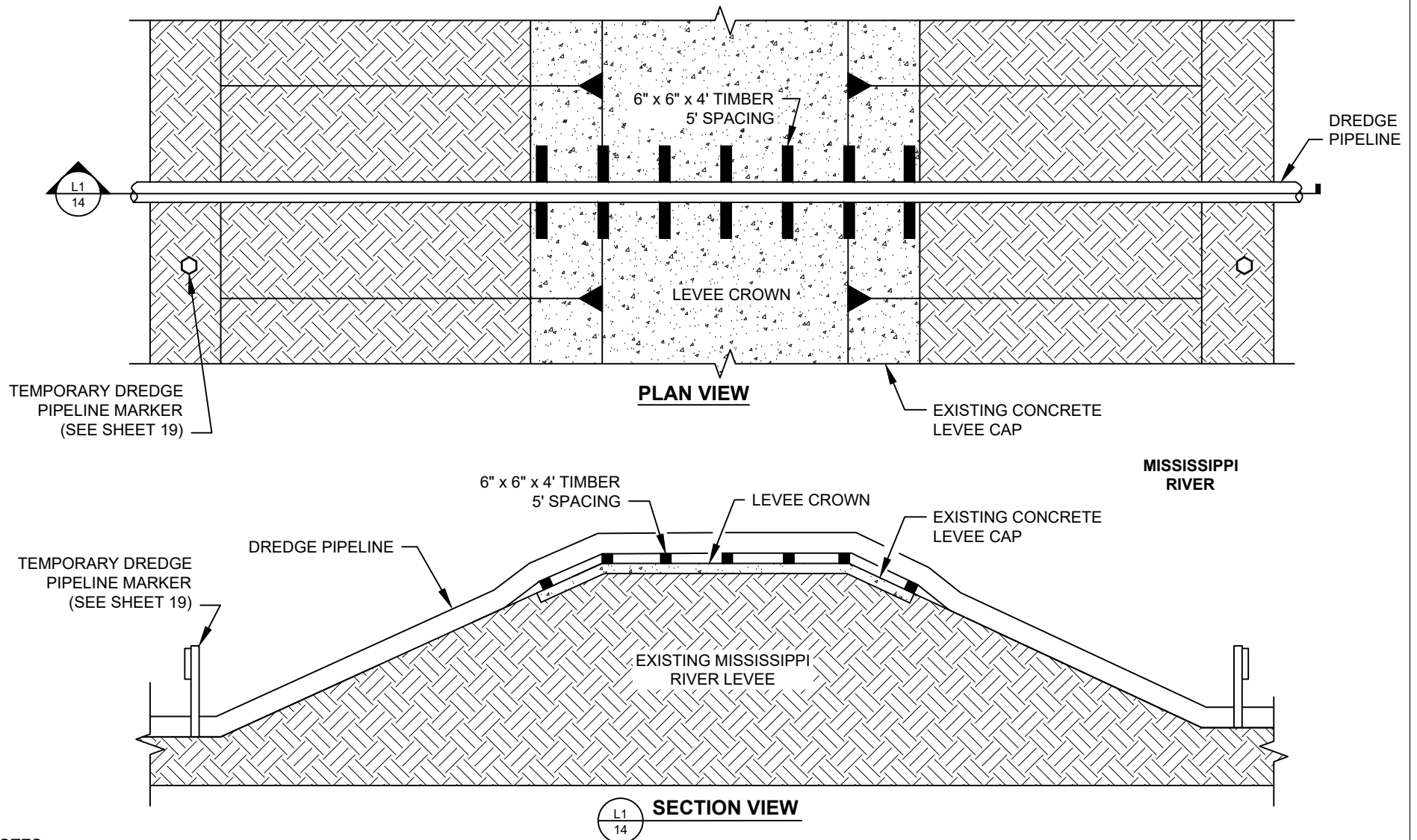

NOTES:

1. TEMPORARY PIPELINE MARKERS INDICATING CONTRACTOR, CONTENTS, AND ADDRESS FOR CONTACTING CONTRACTOR SHALL BE PLACED AND MAINTAINED AT EACH TOE OF THE LEVEE NEAR THE DREDGE PIPELINE.
2. REFER TO SHEET 2 NOTE 3.

**MISSISSIPPI RIVER LEVEE
AND NOV LEVEE CROSSING**
NOT TO SCALE

**PRELIMINARY - FOR
PERMIT PURPOSES ONLY**

APPLICATION BY: CPRA P.O. BOX 44027 BATON ROUGE, LA 70804	COASTAL PROTECTION AND RESTORATION AUTHORITY 150 TERRACE AVENUE BATON ROUGE, LOUISIANA 70802		GRAND BAYOU RIDGE AND MARSH RESTORATION	MISSISSIPPI RIVER AND NOV LEVEE CROSSING DETAILS
DRAWN BY: K. CANTU	DESIGNED BY: A. LINSON, P.E. 44730	APPROVED BY: M. MELTON, P.E. 36787	STATE PROJECT NUMBER: BA-0217 FEDERAL PROJECT NUMBER:	DATE: NOV. 2022 SHEET 14 OF 20

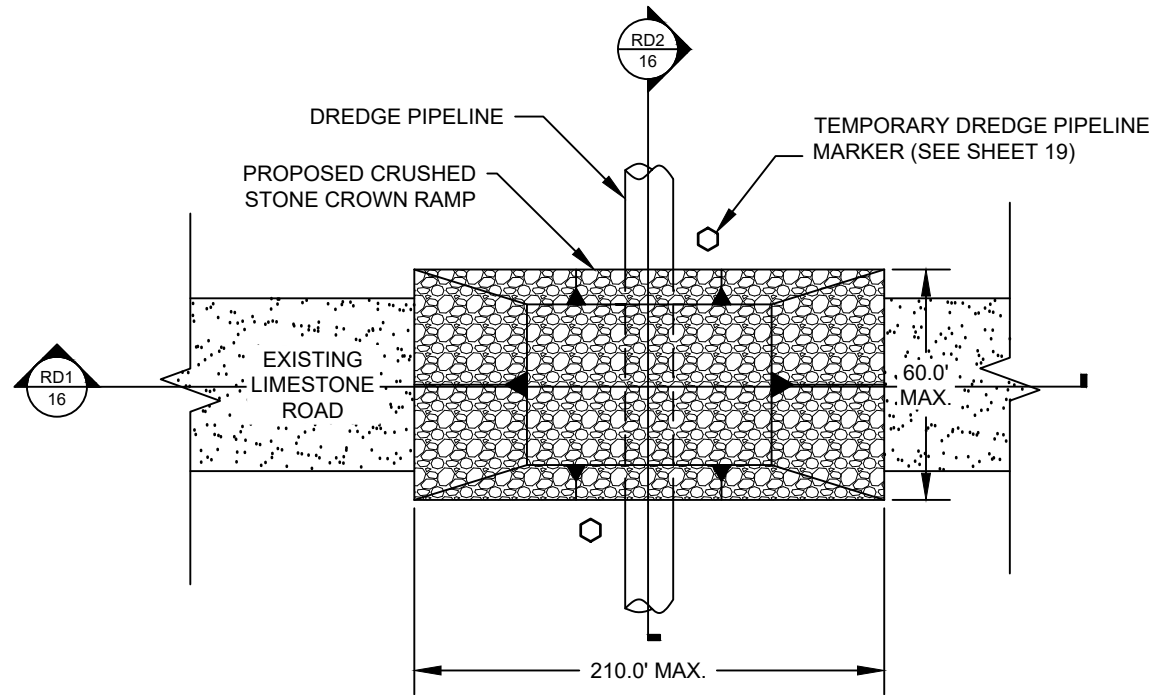

PLAN VIEW

LIMESTONE ROAD CROSSING
NOT TO SCALE

NOTES:

1. THE EXISTING LIMESTONE ROAD SHALL BE REMOVED FOR EASE OF CONSTRUCTION. AFTER THE REMOVAL OF DREDGE PIPE, THE ROAD SHALL BE REBUILT TO PRIOR CONDITION.
2. THE CROWN RAMP OVER THE DREDGE PIPELINE CROSSINGS SHALL CONSIST OF CRUSHED STONE FOR FULL WIDTH (10' MINIMUM) AND LENGTH OF RAMP. THE CRUSHED STONE MATERIAL SHALL CONFORM TO LADOTD 2016 STANDARD SPECIFICATION 1003.04 (a).
3. TEMPORARY PIPELINE MARKERS INDICATING CONTRACTOR, CONTENTS, AND ADDRESS FOR CONTACTING CONTRACTOR SHALL BE PLACED AND MAINTAINED AT EACH TOE OF THE LEVEE NEAR DREDGE PIPELINE.
4. **REFER TO SHEET 2 NOTE 3.**

**PRELIMINARY - FOR
PERMIT PURPOSES ONLY**

APPLICATION BY: CPRA P.O. BOX 44027 BATON ROUGE, LA 70804	COASTAL PROTECTION AND RESTORATION AUTHORITY 150 TERRACE AVENUE BATON ROUGE, LOUISIANA 70802		GRAND BAYOU RIDGE AND MARSH RESTORATION STATE PROJECT NUMBER: BA-0217	LIMESTONE ROAD CROSSING DETAILS DATE: NOV. 2022
DRAWN BY: K. CANTU	DESIGNED BY: A. LINSON, P.E. 44730	APPROVED BY: M. MELTON, P.E. 36787	FEDERAL PROJECT NUMBER:	SHEET 15 OF 20

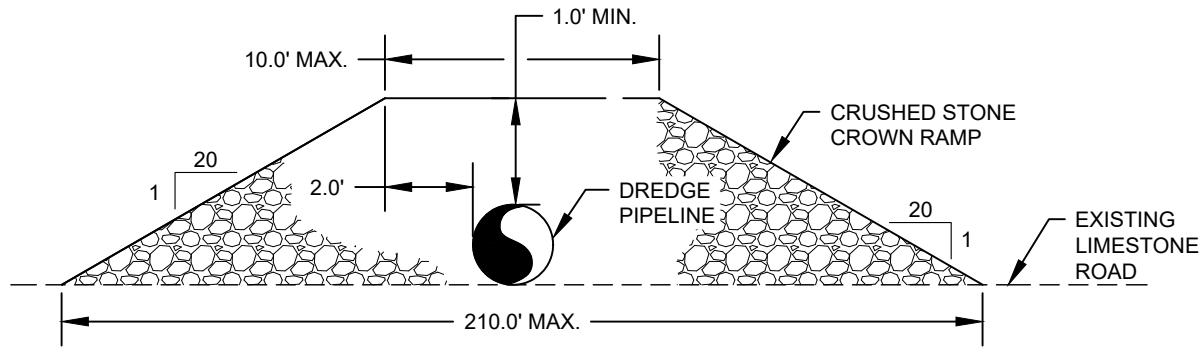

RD1
15 **LIMESTONE ROAD CROSSING SECTION**
NOT TO SCALE

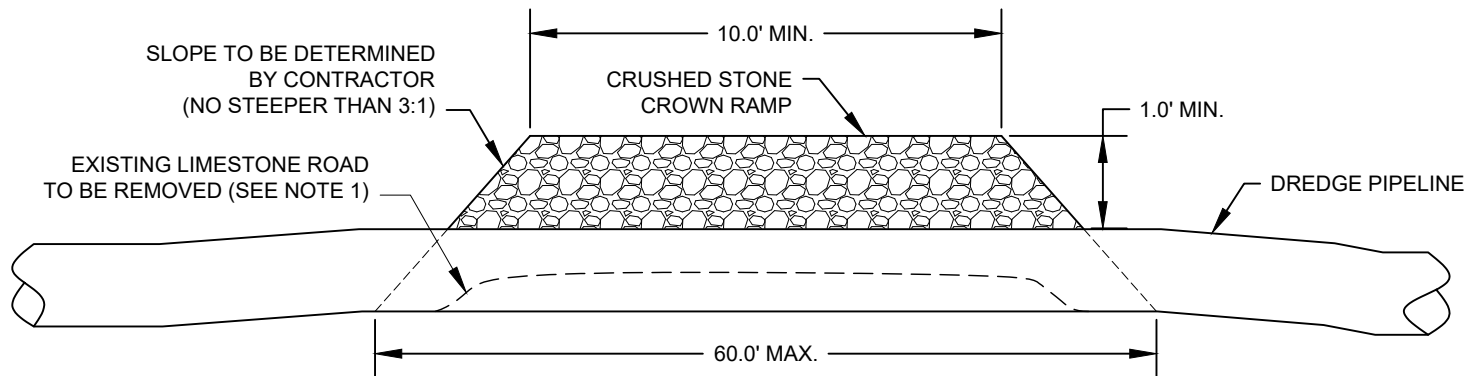

RD2
15 **LIMESTONE ROAD CROSSING PROFILE**
NOT TO SCALE

NOTES:

1. THE EXISTING LIMESTONE ROAD SHALL BE REMOVED FOR EASE OF CONSTRUCTION. AFTER THE REMOVAL OF DREDGE PIPE, THE ROAD SHALL BE REBUILT TO PRIOR CONDITION.
2. THE CROWN RAMP OVER THE DREDGE PIPELINE CROSSINGS SHALL CONSIST OF CRUSHED STONE FOR FULL WIDTH (10' MINIMUM) AND LENGTH OF RAMP. THE CRUSHED STONE MATERIAL SHALL CONFORM TO LADOTD 2016 STANDARD SPECIFICATION 1003.04 (a).
3. TEMPORARY PIPELINE MARKERS INDICATING CONTRACTOR, CONTENTS, AND ADDRESS FOR CONTACTING CONTRACTOR SHALL BE PLACED AND MAINTAINED AT EACH TOE OF THE LEVEE NEAR DREDGE PIPELINE.
4. REFER TO SHEET 2 NOTE 3.

**PRELIMINARY - FOR
PERMIT PURPOSES ONLY**

APPLICATION BY: CPRA P.O. BOX 44027 BATON ROUGE, LA 70804	COASTAL PROTECTION AND RESTORATION AUTHORITY 150 TERRACE AVENUE BATON ROUGE, LOUISIANA 70802		GRAND BAYOU RIDGE AND MARSH RESTORATION STATE PROJECT NUMBER: BA-0217	LIMESTONE ROAD CROSSING DETAILS DATE: NOV. 2022
DRAWN BY: K. CANTU	DESIGNED BY: A. LINSON, P.E. 44730	APPROVED BY: M. MELTON, P.E. 36787	FEDERAL PROJECT NUMBER:	SHEET 16 OF 20

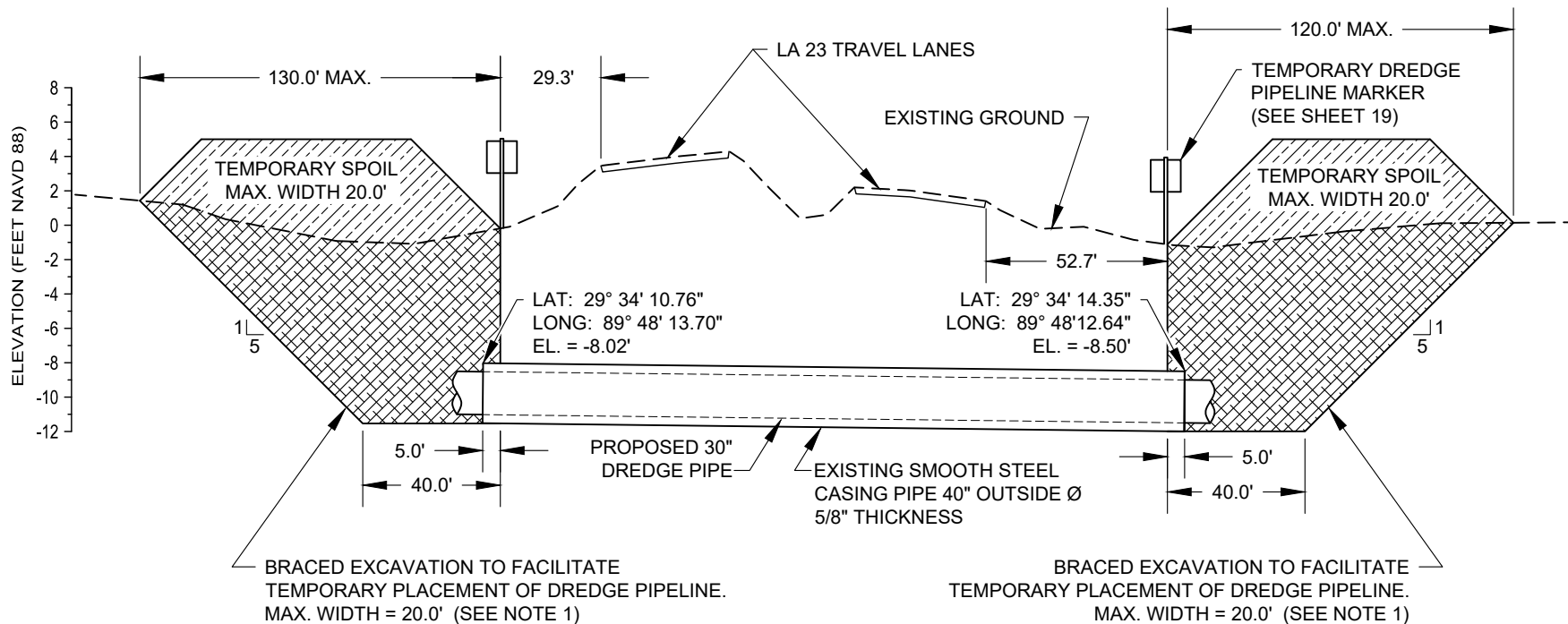

HIGHWAY CROSSING TYPICAL SECTION

PRELIMINARY - FOR PERMIT PURPOSES ONLY

LEGEND	
	EXCAVATION
	TEMPORARY SPOIL
	EXISTING GROUND

NOTES:

1. TEMPORARY SPOIL SHALL BE PLACED ADJACENT TO THE BRACED EXCAVATION ON BOTH SIDES.
2. THE TEMPORARY SPOIL SHALL BE BACKFILLED INTO THE EXCAVATION.
3. REFER TO SHEET 2 NOTE 3.

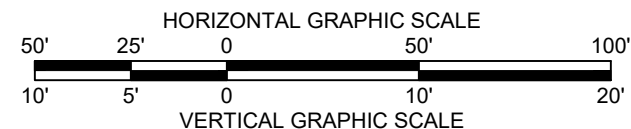

APPLICATION BY: CPRA P.O. BOX 44027 BATON ROUGE, LA 70804	COASTAL PROTECTION AND RESTORATION AUTHORITY 150 TERRACE AVENUE BATON ROUGE, LOUISIANA 70802	GRAND BAYOU RIDGE AND MARSH RESTORATION	HIGHWAY CROSSING SECTION
			STATE PROJECT NUMBER: BA-0217 DATE: NOV. 2022
DRAWN BY: K. CANTU	DESIGNED BY: A. LINSON, P.E. 44730	APPROVED BY: M. MELTON, P.E. 36787	FEDERAL PROJECT NUMBER: SHEET 17 OF 20

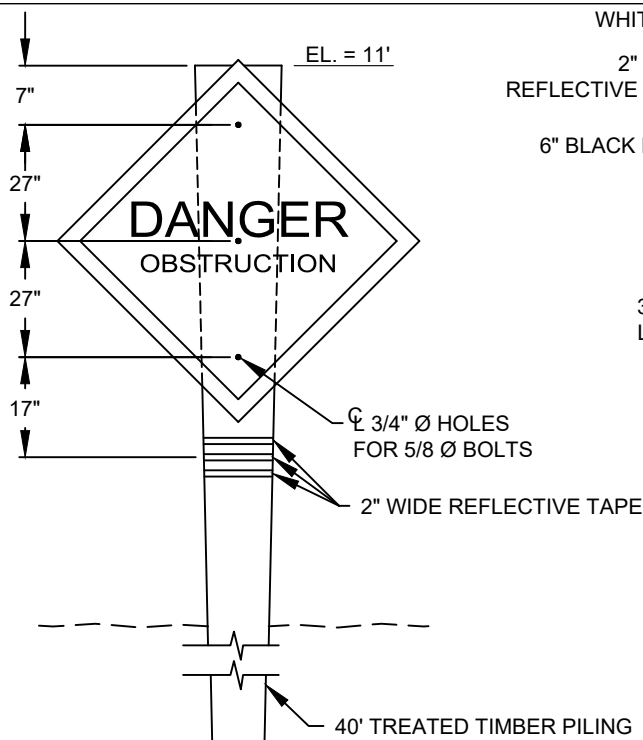

WARNING SIGN ELEVATION

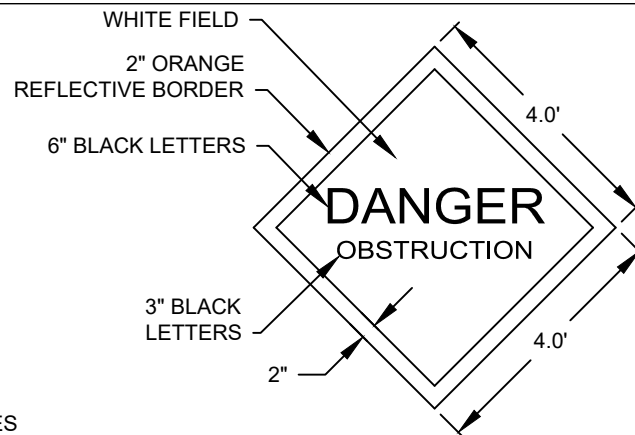

SIGN DETAIL

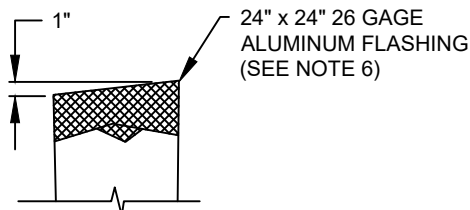

TYPICAL TIMBER PILE CAP

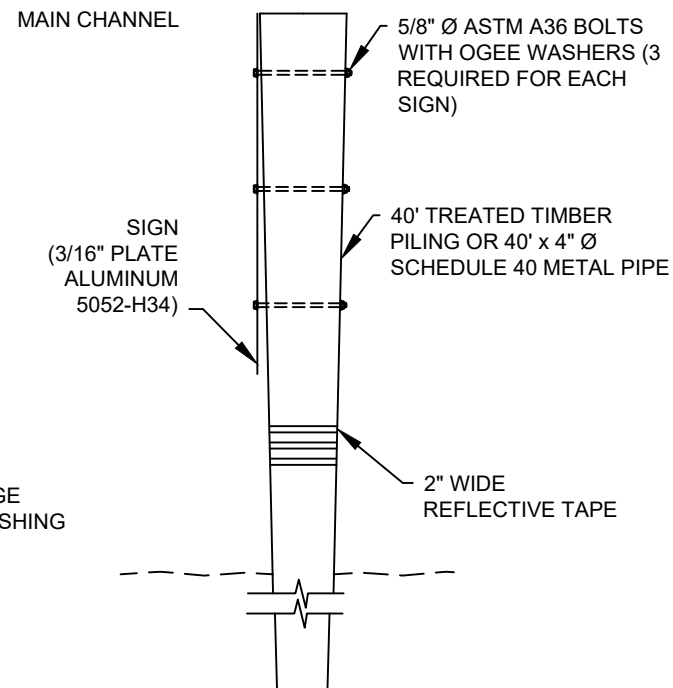

WARNING SIGN ELEVATION

TEMPORARY WARNING SIGN DETAIL

NOT TO SCALE

NOTES:

1. TEMPORARY WARNING SIGNS, INCLUDING TIMBER PILES, SHALL BE INSTALLED AT LOCATIONS SHOWN ON THE PLANS. THE 2" BORDER ON THE WARNING SIGN WILL BE REFLECTIVE MATERIAL OF ORANGE COLOR. THE LETTERING FIELD WILL BE A REFLECTIVE MATERIAL OF WHITE COLOR. THE LETTERING FOR THE WARNING SIGNS WILL BE BLACK. ALL SIGNS MUST MEET U.S. COAST GUARD STANDARDS AND BE IN ACCORDANCE WITH 33 CFR §66--PRIVATE AIDS TO NAVIGATION.
2. NEOPRENE WASHERS SHALL BE PLACED BETWEEN THE SIGN AND THE PILING AT ALL POINTS OF CONTACT.
3. HARDWARE FOR TIMBER CONNECTIONS SHALL BE HOT DIP GALVANIZED IN ACCORDANCE WITH SECTION 811.5 OF THE LOUISIANA STANDARD SPECIFICATIONS FOR ROADS AND BRIDGES, AS PUBLISHED BY THE LOUISIANA DEPARTMENT OF TRANSPORTATION AND DEVELOPMENT, LATEST EDITION.
4. TIMBER PILES SHALL CONFORM TO SECTIONS 804 AND 1014 OF THE LOUISIANA STANDARD SPECIFICATIONS FOR ROADS AND BRIDGES, AS PUBLISHED BY THE LOUISIANA DEPARTMENT OF TRANSPORTATION AND DEVELOPMENT, LATEST EDITION. PILES SHALL BE TREATED WITH A CREOSOTE SOLUTION CONFORMING TO AWPA P2 TO A MINIMUM RETENTION OF 20 PCF AND CAPPED ACCORDING TO LA DOTD SPECIFICATION 812.06.
5. TIMBER PILING SHALL BE 40' IN LENGTH WITH A NOMINAL 12" DIAMETER BUTT AND 7" MINIMUM DIAMETER AT THE TIP.
6. THE TOP OF THE PILES SHALL BE COATED WITH COAL TAR EPOXY PAINT PRIOR TO PLACING CAP. THE PILE CAP SHALL BE ATTACHED USING ALUMINUM OR STAINLESS STEEL NAILS.
7. THE TEMPORARY WARNING SIGNS ARE TO BE REMOVED PRIOR TO DEMOBILIZATION.
8. REFER TO SHEET 2 NOTE 3.

**PRELIMINARY - FOR
PERMIT PURPOSES ONLY**

APPLICATION BY: CPRA P.O. BOX 44027 BATON ROUGE, LA 70804	COASTAL PROTECTION AND RESTORATION AUTHORITY 150 TERRACE AVENUE BATON ROUGE, LOUISIANA 70802		GRAND BAYOU RIDGE AND MARSH RESTORATION	TEMPORARY WARNING SIGN DETAIL
DRAWN BY: K. CANTU	DESIGNED BY: A. LINSON, P.E. 44730	APPROVED BY: M. MELTON, P.E. 36787	STATE PROJECT NUMBER: BA-0217 FEDERAL PROJECT NUMBER:	DATE: NOV. 2022 SHEET 18 OF 20

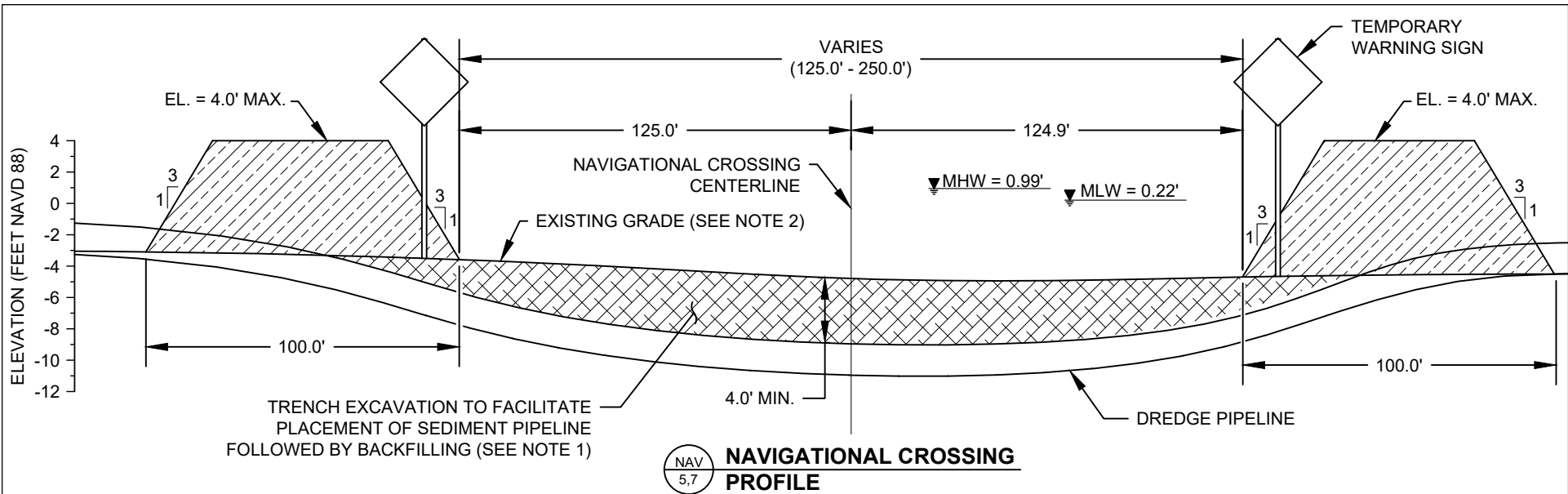

NAVIGATIONAL CROSSING NOTES:

1. EXCAVATED MATERIAL SHALL BE PLACED IN THE CONFINES OF THE TEMPORARY SIDECAST DISPOSAL AREAS, THERE SHALL BE NO SIDECASTING WITHIN CROSSING LIMITS.
2. IF EQUIPMENT ACCESS DREDGING IS PERFORMED IN THIS LOCATION, THE EXISTING GRADE SHALL BE THE DREDGED ELEVATION.

**PRELIMINARY - FOR
PERMIT PURPOSES ONLY**

TEMPORARY DREDGE PIPELINE MARKER NOTES:

1. MARKERS SHALL BE CONSTRUCTED AND INSTALLED IN ACCORDANCE WITH SECTION 729 OF THE LOUISIANA STANDARD SPECIFICATIONS FOR ROADS AND BRIDGES, AS PUBLISHED BY THE LADOTD, LATEST EDITION.
2. A SHOP DRAWING SHALL BE SUBMITTED TO THE ENGINEER FOR APPROVAL PRIOR TO FABRICATION OF THE MARKERS.
3. MARKERS SHALL BE INSTALLED PRIOR TO INSTALLATION OF THE DREDGE PIPELINE AND REMOVED AFTER THE REMOVAL OF THE DREDGE PIPELINE.
4. MARKERS SHALL BE INSTALLED ON BOTH SIDES OF THE CROSSING.
5. **REFER TO SHEET 2 NOTE 3.**

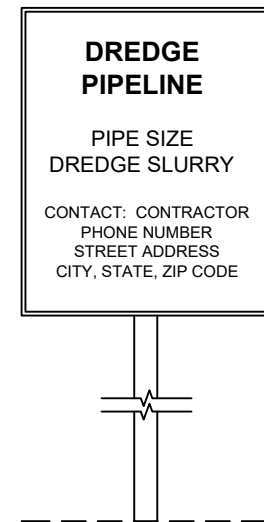

**TEMPORARY DREDGE PIPELINE
MARKER TYPICAL DETAIL**
NOT TO SCALE

APPLICATION BY: CPRA P.O. BOX 44027 BATON ROUGE, LA 70804	COASTAL PROTECTION AND RESTORATION AUTHORITY 150 TERRACE AVENUE BATON ROUGE, LOUISIANA 70802	GRAND BAYOU RIDGE AND MARSH RESTORATION STATE PROJECT NUMBER: BA-0217	NAVIGATIONAL CROSSING AND TEMPORARY DREDGE PIPELINE MARKER DETAIL DATE: NOV. 2022
DRAWN BY: K. CANTU	DESIGNED BY: A. LINSON, P.E. 44730	APPROVED BY: M. MELTON, P.E. 36787	FEDERAL PROJECT NUMBER: SHEET 19 OF 20

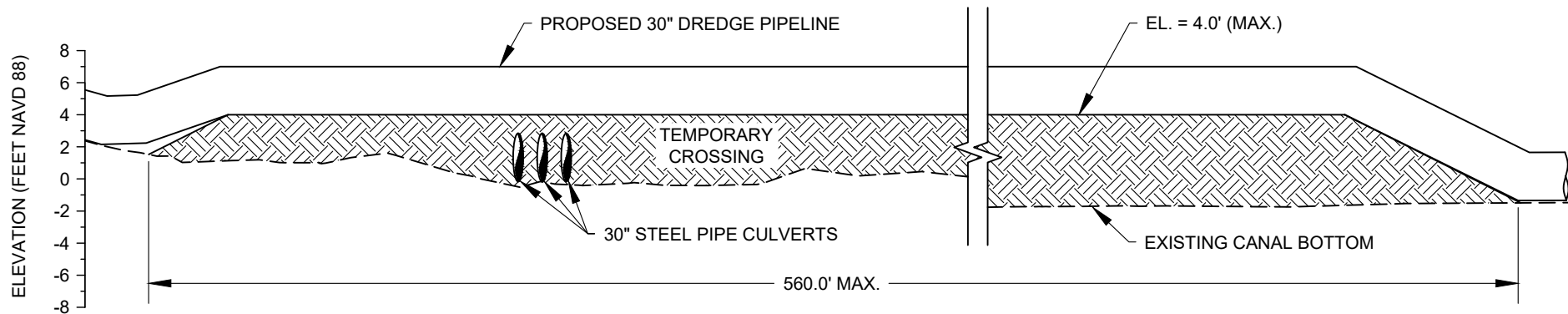

PROFILE VIEW

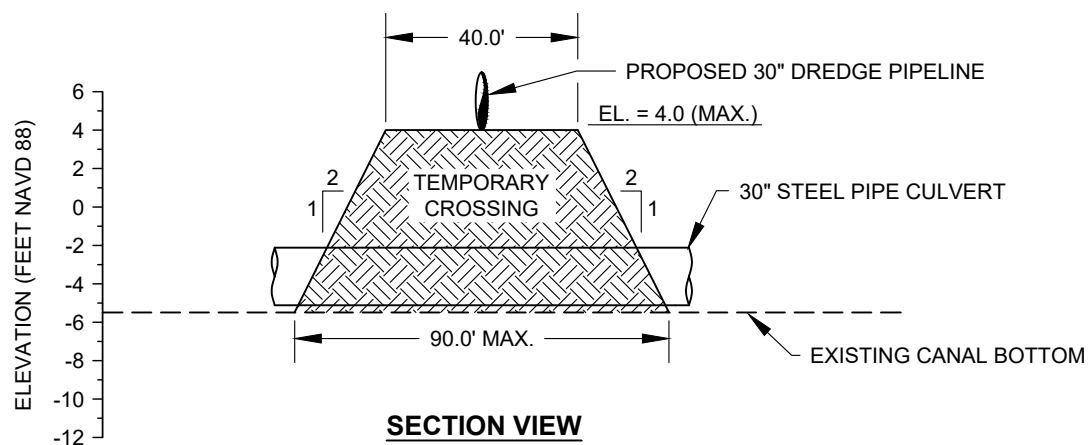

SECTION VIEW

NOTES:

1. THE TEMPORARY CANAL CROSSINGS SHALL BE CONSTRUCTED USING MATERIAL HYDRAULICALLY DREDGED FROM THE BORROW AREA IN THE MISSISSIPPI RIVER.
2. TEMPORARY CROSSINGS SHALL BE REMOVED PRIOR TO DEMOBILIZATION.



TEMPORARY CANAL CROSSING

**PRELIMINARY - FOR
PERMIT PURPOSES ONLY**

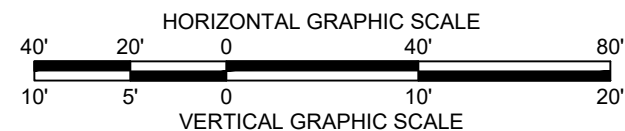

APPLICATION BY: CPRA P.O. BOX 44027 BATON ROUGE, LA 70804	COASTAL PROTECTION AND RESTORATION AUTHORITY 150 TERRACE AVENUE BATON ROUGE, LOUISIANA 70802		GRAND BAYOU RIDGE AND MARSH RESTORATION	TEMPORARY CANAL CROSSING DETAIL
DRAWN BY: K. CANTU	DESIGNED BY: A. LINSON, P.E. 44730	APPROVED BY: M. MELTON, P.E. 36787	STATE PROJECT NUMBER: BA-0217 FEDERAL PROJECT NUMBER:	DATE: JAN. 2023 SHEET 20 OF 20