



DEPARTMENT OF THE ARMY
U.S. ARMY CORPS OF ENGINEERS, NEW ORLEANS DISTRICT
7400 LEAKE AVENUE
NEW ORLEANS, LA 70118-3651

Regulatory Division
Eastern Branch- RGE

Project Manager:
Angelle Greer
(504) 862-2279
angelle.v.greer@usace.army.mil

Application #: MVN-2010-01024-EG

PUBLIC NOTICE

27 December 2022

Interested parties are hereby notified that a permit application has been received by the New Orleans District of the U.S. Army Corps of Engineers pursuant to: [X] Section 10 of the Rivers and Harbors Act of March 3, 1899 (30 Stat. 1151; 33 USC 403); and/or [] Section 404 of the Clean Water Act (86 Stat. 816; 33 USC 1344).

BARGE FLEET EXPANSION ON THE MISSISSIPPI RIVER **IN ST. CHARLES PARISH**

NAME OF APPLICANT: Turn Services, c/o Lanier and Associates Engineers, Attention: John Maurin, 4101 Magazine St., New Orleans, LA 70115, or jmaurin@lanier-engineers.com.

LOCATION OF WORK: At approximately Latitude: 29.965278, Longitude: -90.398333, on the Mississippi River at mile 124 AHP, right-descending bank, in Venice, Louisiana, in St. Charles Parish, as shown on the enclosed drawings.

Hydrologic Unit Code: 08090100 (Lower Mississippi-New Orleans)

CHARACTER OF WORK: Install and maintain 3 new barge mooring monopiles to extend an existing barge fleet upstream by 2 tiers long x 8 barges wide to accommodate growing demand in the immediate vicinity. No impacts to jurisdictional wetlands are anticipated as a result of the project, therefore no compensatory mitigation is proposed.

The comment period for the Department of the Army Permit will close **30 days** from the date of this public notice. Written comments, including suggestions for modifications or objections to the

proposed work, stating reasons thereof, are being solicited from anyone having interest in this permit and must be mailed so as to be received before or by the last day of the comment period. Letters concerning the Corps of Engineers permit application must reference the applicant's name and the Permit Application Number, and be mailed to the Corps of Engineers at the address above, **ATTENTION: REGULATORY DIVISION (RGE, Angelle Greer)**, or may be preferably emailed to angelle.v.greer@usace.army.mil.

Corps of Engineers Permit Criteria

The decision whether to issue a permit will be based on an evaluation of the probable impacts, including cumulative impacts of the proposed activity on the public interest. That decision will reflect the national concern for both protection and utilization of important resources. The benefit which reasonably may be expected to accrue from the proposal must be balanced against its reasonably foreseeable detriments. All factors which may be relevant to the proposal will be considered including the cumulative effects thereof; among those are conservation, economics, aesthetics, general environmental concerns, wetlands, historic properties, fish and wildlife values, flood hazards, floodplain values, land use, navigation, shoreline erosion and accretion, recreation, water supply and conservation, water quality, energy needs, safety, food and fiber production, mineral needs, considerations of property ownership and, in general, the needs and welfare of the people.

The U.S. Army Corps of Engineers is soliciting comments from the public, federal, state, and local agencies and officials, Indian Tribes, and other interested parties in order to consider and evaluate the impacts of this proposed activity. Any comments received will be considered by the U.S. Army Corps of Engineers to determine whether to make, modify, condition, or deny a permit for this proposal. To make this decision, comments are used to assess impacts on endangered species, historic properties, water quality, general environmental effects, and other public interest factors listed above. Comments are used in the preparation of an Environmental Assessment and/or an Environmental Impact Statement pursuant to the National Environmental Policy Act. Comments are also used to determine the need for a public hearing and to determine the overall public interest of the proposed activity.

The New Orleans District is unaware of any properties listed on the National Register of Historic Places near the proposed work. The possibility exists that the proposed work may damage or destroy presently unknown archeological, scientific, prehistorical, historical sites, or data. Issuance of this public notice solicits input from the State Archeologist and State Historic Preservation Officer regarding potential impacts to cultural resources.

Based on the Information & Planning Consultation for Endangered Species in Louisiana (IPaC), dated January 27, 2020 between the U.S. Army Corps of Engineers, New Orleans and U.S. Fish and Wildlife Service, Ecological Services Office, it has been determined that the activity is not likely to adversely affect the West Indian Manatee and may affect the Pallid Sturgeon. Consultation with USFWS for potential project-related effects to the Pallid Sturgeon has been initiated. Standard

Manatee Conditions for In-Water Activities will be added to the permit, if authorized.

Our initial finding is that the proposed work is Not Likely to Adversely Affect any species listed as endangered by the U.S. Departments of Commerce, nor affect any habitat designated as critical to the survival and recovery of such species.

This notice initiates the Essential Fish Habitat (EFH) consultation requirements of the Magnuson-Stevens Fishery Conservation and Management Act. The applicant's proposal is not expected to result in the destruction or alteration of EFH utilized by various life stages of red drum and penaeid shrimp. Our initial determination is that the proposed action would have no adverse impact on EFH or federally managed fisheries in the Gulf of Mexico. Our final determination relative to project impacts and the need for mitigation measures is subject to review by and coordination with the National Marine Fisheries Service.

The applicant has certified that the proposed activity described in the application complies with and will be conducted in a manner that is consistent with the Louisiana Coastal Resources Program. The Department of the Army permit will not be issued unless the applicant received approval or a waiver of the Coastal Use Permit by the Department of Natural Resources.

Any person may request, in writing, within the comment period specified in this notice, that a public hearing be held to consider this application. Requests for public hearings shall state, with particularity, the reasons for holding a public hearing. You are requested to communicate the information contained in this notice to any other parties whom you deem likely to have interest in the matter.

Brad P. LaBorde
Chief, Eastern Evaluation Branch

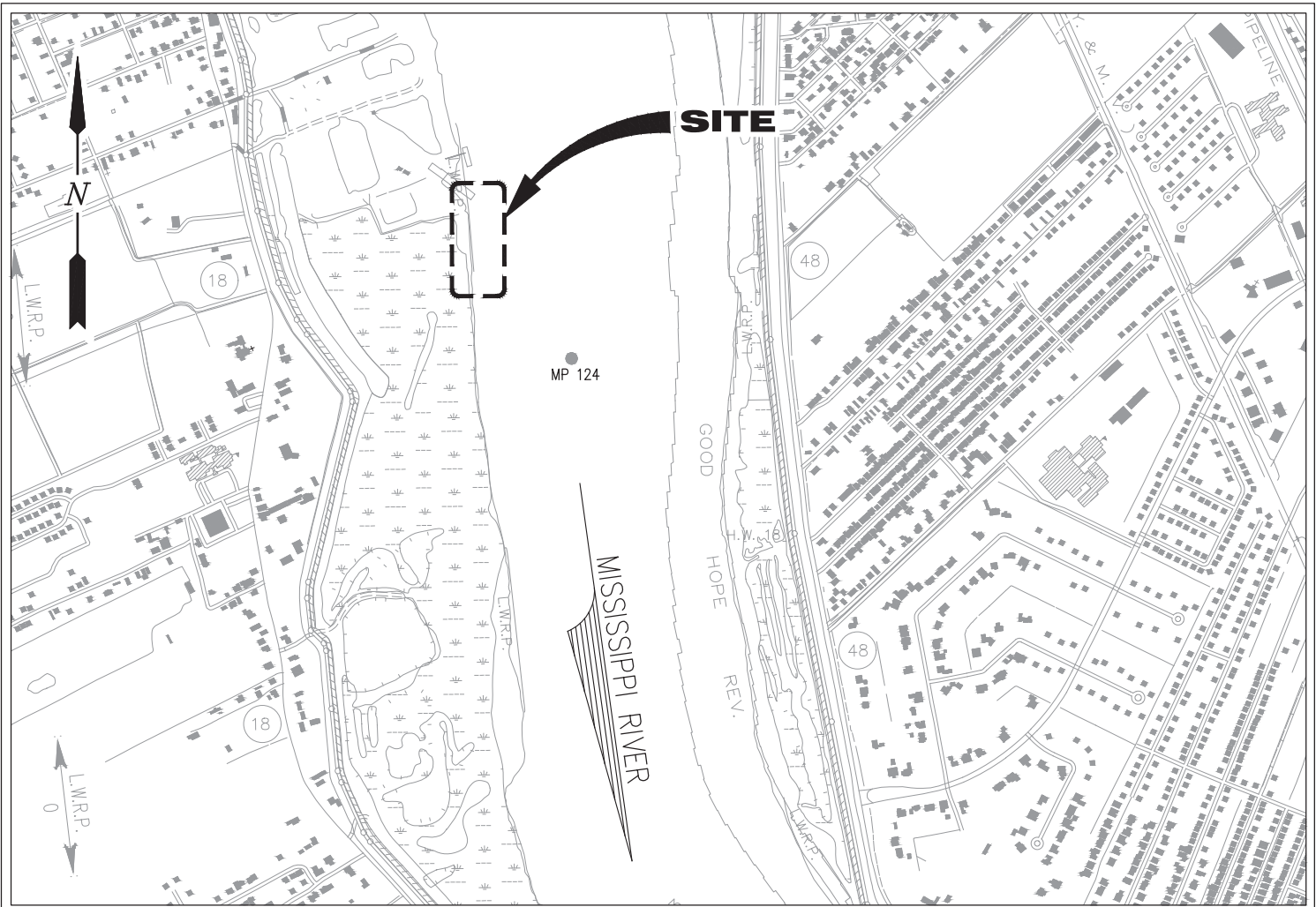

VICINITY MAP

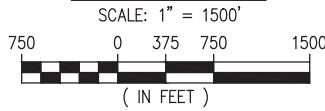

ST. CHARLES PARISH
 LAT. 29° 58' 15" N
 LONG. 90° 23' 56" W

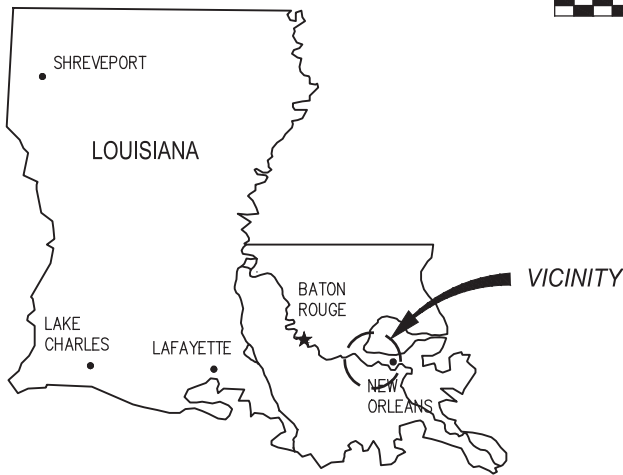

AREA MAP

NOTES

1. AS-BUILT DRAWINGS AND/OR PLANS SHALL HAVE WRITTEN ON THEM THE DATE OF COMPLETION OF SAID ACTIVITIES AND SHALL BE SUBMITTED TO THE LOUISIANA DEPARTMENT OF NATURAL RESOURCES, OFFICE OF COASTAL MANAGEMENT, P.O. BOX 44487, BATON ROUGE, LA 70804-4487 WITHIN 30 DAYS FOLLOWING PROJECT COMPLETION.
2. ALL STRUCTURES, FACILITIES, WELL AND PIPELINES/FLOWLINES OCCURRING IN OPEN WATER AREAS OR IN OILFIELD CANALS OR SLIPS SHALL BE REMOVED WITHIN 120 DAYS OF ABANDONMENT OF THE FACILITIES FOR THE HEREIN PERMITTED USE UNLESS PRIOR WRITTEN APPROVAL TO LEAVE SUCH STRUCTURES IN PLACE IS RECEIVED FROM THE COASTAL MANAGEMENT DIVISION. THIS CONDITION DOES NOT PRECLUDE THE NECESSITY FOR REVISING THE CURRENT PERMIT OR OBTAINING A SEPARATE COASTAL USE PERMIT, SHOULD ONE BE REQUIRED.
3. STRUCTURES MUST ALSO BE MARKED/LIGHTED IN ACCORDANCE WITH U.S. COAST GUARD REGULATIONS.
4. IN ORDER TO ENSURE THE SAFETY OF ALL PARTIES, THE PERMITTEE SHALL CONTACT THE LOUISIANA ONE CALL SYSTEM (1-800-272-3020) A MINIMUM OF 48 HOURS PRIOR TO THE COMMENCEMENT OF ANY EXCAVATION (DIGGING, DREDGING, JETTING, ETC.) OR DEMOLITION ACTIVITY.
5. ALL ELEVATIONS REFER TO NAVD 88 UNLESS NOTED OTHERWISE.

JOSEPH E. JACQUET P.E.
 LA PE #21953

PRELIMINARY - FOR PERMIT PURPOSES ONLY

REV A



LANIER & ASSOCIATES
 CONSULTING ENGINEERS
 INCORPORATED

LA: EF-1120 TX: F-2981
 NEW ORLEANS • BEAUMONT • CORPUS CHRISTI • HOUSTON

TURN SERVICES
 HAHNVILLE LOUISIANA

**PROPOSED BARGE FLEET EXTENSION
 VICINITY MAP, AREA MAP & NOTES**

DATE JUN. '22
 DESIGN JDM
 DRAWN ADG
 CHECK JDM
 JOB NO 12201
 SHEET No.

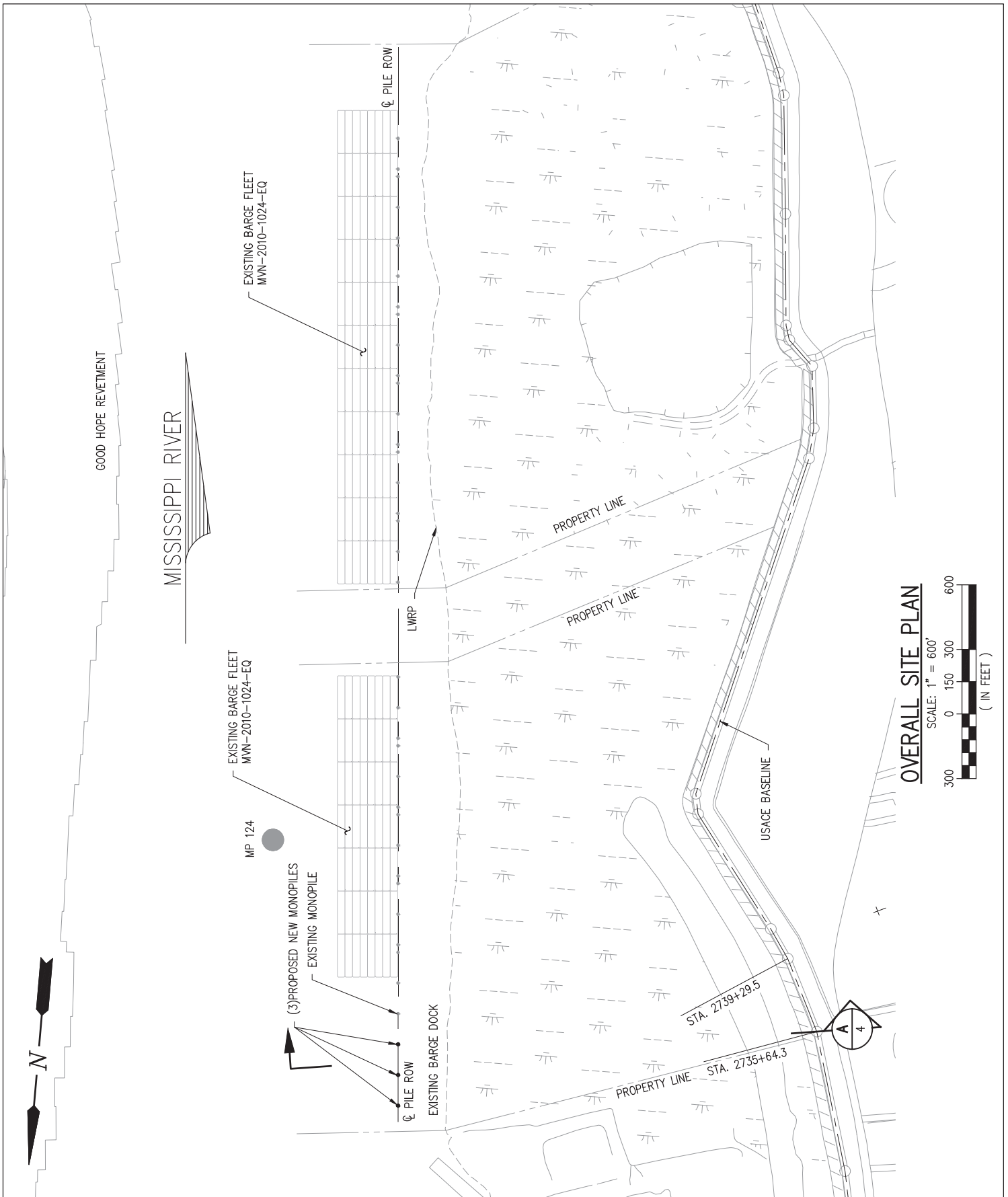

JOSEPH E. JACQUET P.E.
LA PE #21953

PRELIMINARY - FOR PERMIT PURPOSES ONLY

REV A



LANIER & ASSOCIATES
CONSULTING ENGINEERS
INCORPORATED

LA: EF-1120 TX: F-2981
NEW ORLEANS • BEAUMONT • CORPUS CHRISTI • HOUSTON

HAHNVILLE

TURN SERVICES

LOUISIANA

**PROPOSED BARGE FLEET EXTENSION
OVERALL SITE PLAN**

DATE JUN. '22
DESIGN JDM
DRAWN ADG
CHECK JDM
JOB NO 12201
SHEET No.

2 OF 5

MISSISSIPPI RIVER



MP 124.2

PROPOSED NEW BARGE FLEET EXTENSION
(2 TIERS LONG AND 8 TIERS WIDE)

(3) PROPOSED NEW MONOPILES

☉ PILE ROW

120'-0" 142'-6" 142'-6" 142'-6"

EXISTING MONOPILE

LWRP

NOTE:

WILDLIFE DIVERSITY PROGRAM: NO IMPACTS TO RARE, THREATENED OR ENDANGERED SPECIES OR CRITICAL HABITATS ARE ANTICIPATED FROM THE PROPOSED PROJECT. NO STATE OR FEDERAL PARKS, WILDLIFE REFUGES, WILDLIFE MANAGEMENT AREAS OR SCENIC RIVERS ARE KNOWN AT THE SPECIFIED SITE OR WITHIN ¼ MILE OF THE PROPOSED PROJECT. THE WILDLIFE DIVERSITY PROGRAM (WDP) REPORTS SUMMARIZE THE EXISTING INFORMATION KNOWN AT THE TIME OF THE REQUEST REGARDING THE LOCATION IN QUESTION. WDP REPORTS SHOULD NOT BE CONSIDERED FINAL STATEMENTS ON THE BIOLOGICAL ELEMENTS OR AREAS BEING CONSIDERED, NOR SHOULD THEY BE SUBSTITUTED FOR ON-SITE SURVEYS REQUIRED FOR ENVIRONMENTAL ASSESSMENTS. IF AT ANY TIME WDP TRACKED SPECIES ARE ENCOUNTERED WITHIN THE PROJECT AREA, PLEASE CONTACT OUR BIOLOGIST AT 225-763-3554.

ENLARGED SITE PLAN

SCALE: 1" = 150'



PROPERTY LINE

JOSEPH E. JACQUET P.E.
LA PE #21953

PRELIMINARY - FOR PERMIT PURPOSES ONLY

REV A



LANIER & ASSOCIATES
CONSULTING ENGINEERS
INCORPORATED

LA: EF-1120 TX: F-2981
NEW ORLEANS • BEAUMONT • CORPUS CHRISTI • HOUSTON

HAHNVILLE

TURN SERVICES

LOUISIANA

**PROPOSED BARGE FLEET EXTENSION
ENLARGED SITE PLAN**

DATE JUN. '22
DESIGN JDM
DRAWN ADG
CHECK JDM
JOB NO 12201
SHEET No.

3 OF 5

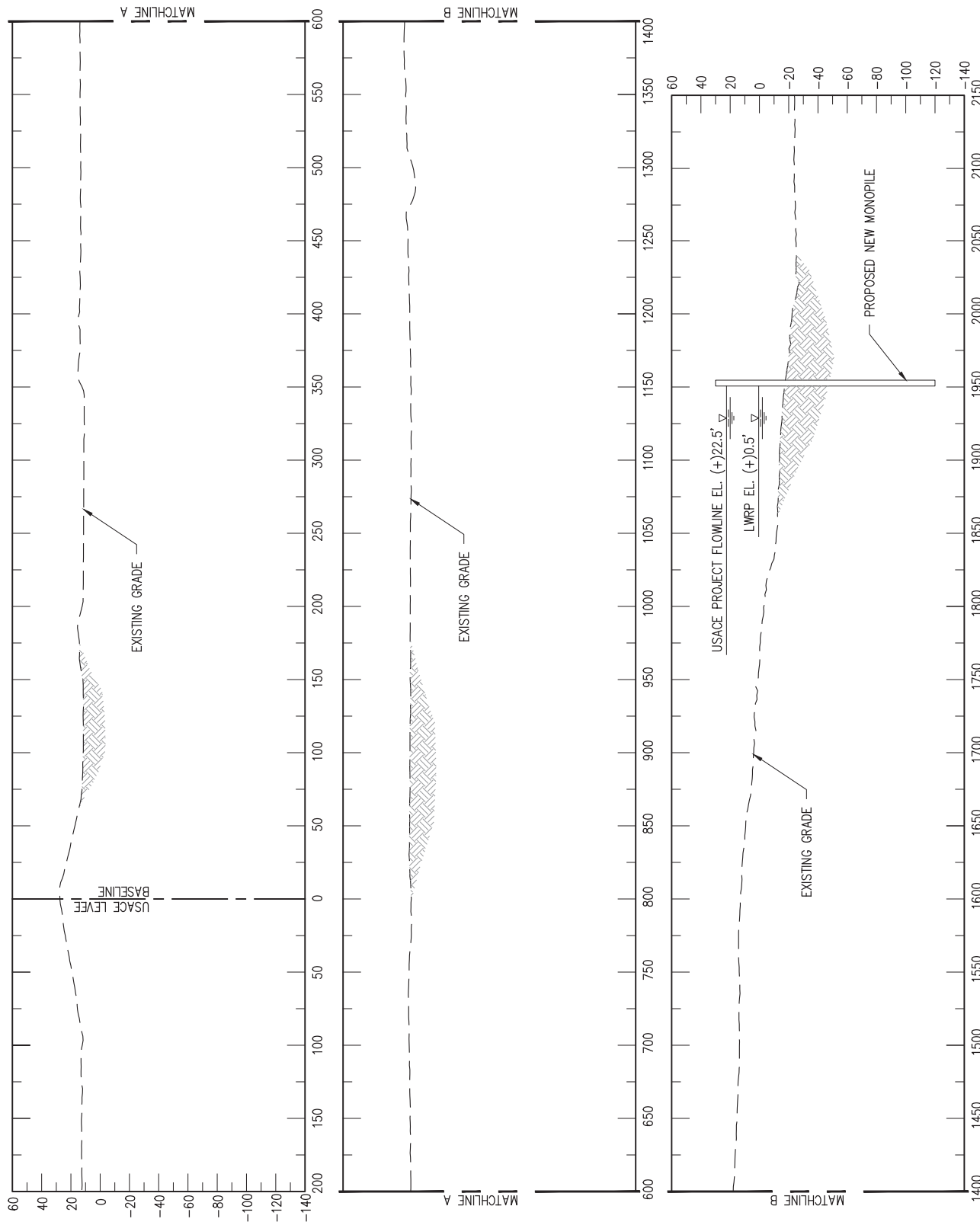

SECTION A
SCALE: 1" = 100'
P2

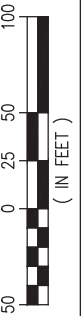

JOSEPH E. JACQUET P.E.
LA PE #21953

PRELIMINARY - FOR PERMIT PURPOSES ONLY

REV A



LANIER & ASSOCIATES
CONSULTING ENGINEERS
INCORPORATED

LA: EF-1120 TX: F-2981
NEW ORLEANS • BEAUMONT • CORPUS CHRISTI • HOUSTON

HAHNVILLE

TURN SERVICES

LOUISIANA

**PROPOSED BARGE FLEET EXTENSION
TYPICAL CROSS SECTION**

DATE JUN. '22
DESIGN JDM
DRAWN ADG
CHECK JDM
JOB NO 12201
SHEET No.

4 OF 5

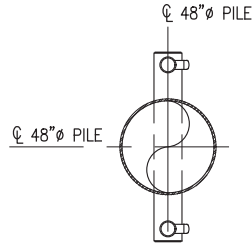

BARGE MONOPILE PLAN

SCALE: 1/8" = 1'-0"
(3 REQUIRED)

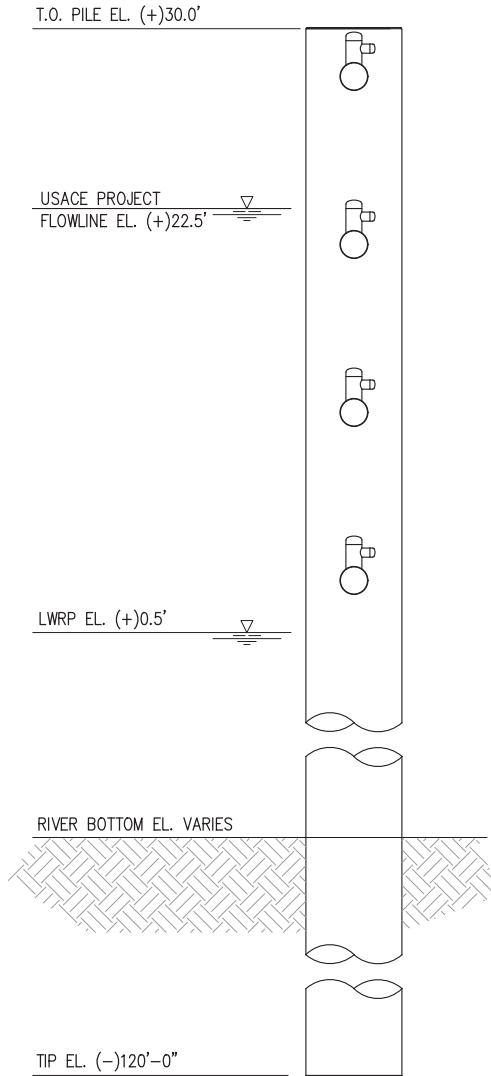

BARGE MONOPILE ELEVATION

SCALE: 1/8" = 1'-0"
(3 REQUIRED)

JOSEPH E. JACQUET P.E.
LA PE #21953

PRELIMINARY - FOR PERMIT PURPOSES ONLY

REV
A



LANIER & ASSOCIATES
CONSULTING ENGINEERS
INCORPORATED

LA: EF-1120 TX: F-2981
NEW ORLEANS • BEAUMONT • CORPUS CHRISTI • HOUSTON

TURN SERVICES
HAHNVILLE LOUISIANA

**PROPOSED BARGE FLEET EXTENSION
BARGE MONOPILE PLAN AND ELEVATION**

DATE JUN. '22
DESIGN JDM
DRAWN ADG
CHECK JDM
JOB NO 12201
SHEET No.
5 OF 5