

# JOINT PUBLIC NOTICE

**December 9, 2019**

United States Army  
Corps of Engineers  
New Orleans District  
Regulatory Branch, ODR-E  
Room 280  
7400 Leake Avenue  
New Orleans, Louisiana 70118

(504) 862-1564

[Stephanie.L.Castaing@usace.army.mil](mailto:Stephanie.L.Castaing@usace.army.mil)

Project Manager  
Stephanie Castaing  
Permit Application Number  
MVN-2018-0721-EPP

State of Louisiana  
Department of Environmental Quality  
ATTN: Water Quality Certifications

Post Office Box 4313  
Baton Rouge, Louisiana 70821-4313

(225) 219-3225

Project Manager  
Elizabeth Hill  
WQC Application Number  
WQC 190828-03

Interested parties are hereby notified that a permit application has been received by the New Orleans District of the U.S. Army Corps of Engineers pursuant to: [ ] Section 10 of the Rivers and Harbors Act of March 3, 1899 (30 Stat. 1151; 33 USC 403); and/or [X] Section 404 of the Clean Water Act (86 Stat. 816; 33 USC 1344).

Application has also been made to the Louisiana Department of Environmental Quality, Water Quality Certifications, for a Water Quality Certification (WQC) in accordance with statutory authority contained in LRS30:2047 A(3), and provisions of Section 401 of the Clean Water Act (P.L.95-17).

## **BIKE PATH IN JEFFERSON PARISH.**

**NAME OF APPLICANT:** Jefferson Parish, Department of Engineering, c/o AECOM, Attention: Jonathan Martinez, 1515 Poydras Street, Suite 2700, New Orleans, Louisiana 70112.

**LOCATION OF WORK:** Project site is located along Leo Kerner Parkway, extending from Barataria Boulevard south to the entrance of Parc des Families, in Estelle, Louisiana, in Jefferson Parish, as shown on the attached drawings.

Latitude: 29.851986 Longitude: -90.104778

Hydrologic Unit Codes: 08090301, East Central Louisiana Coastal

**CHARACTER OF WORK:** Clear, grade, excavate and fill for a 12' wide bike path along Leo Kerner Parkway. Project implementation will directly impact 6.09 acres of jurisdictional wetlands. The applicant proposed to contract with an approved mitigation bank in order to offset the adverse impact to jurisdictional wetlands.

The comment period for the Department of the Army Permit and the Louisiana Department of Environmental Quality WQC will close **20 days** from the date of this joint public notice. Written comments, including suggestions for modifications or objections to the proposed work, stating reasons thereof, are being solicited from anyone having interest in this permit and/or this WQC request and must be mailed so as to be received before or by the last day of the comment period. Letters concerning the Corps of Engineers permit application must reference the applicant's name and the Permit Application Number, and be mailed to the Corps of Engineers at the address above, **ATTENTION: REGULATORY BRANCH**. Similar letters concerning the Water Quality Certification must reference the applicant's name and the WQC Application number and be mailed to the Louisiana Department of Environmental Quality at the address above. Individuals or parties may request an extension of time in which to comment on the proposed work by writing or e-mailing the Corps of Engineers Project Manager listed above. Any request must be specific and substantively supportive of the requested extension, and received by this office prior to the end of the initial comment period. The Section Chief will review the request and the requestor will be promptly notified of the decision to grant or deny the request. If granted, the time extension will be continuous to the initial comment period and, inclusive of the initial comment period, will not exceed a total of 30 calendar days.

The application for this proposed project is on file with the Louisiana Department of Environmental Quality and may be examined during weekdays between 8:00 a.m. and 4:30 p.m. Copies may be obtained upon payment of costs of reproduction.

### **Corps of Engineers Permit Criteria**

The decision whether to issue a permit will be based on an evaluation of the probable impacts, including cumulative impacts of the proposed activity on the public interest. That decision will reflect the national concern for both protection and utilization of important resources. The benefit which reasonably may be expected to accrue from the proposal must be balanced against its reasonably foreseeable detriments. All factors which may be relevant to the proposal will be considered including the cumulative effects thereof; among those are conservation, economics, aesthetics, general environmental concerns, wetlands, historic properties, fish and wildlife values, flood hazards, floodplain values, land use, navigation, shoreline erosion and accretion, recreation, water supply and conservation, water quality, energy needs, safety, food and fiber production, mineral needs, considerations of property ownership and, in general, the needs and welfare of the people.

The U.S. Army Corps of Engineers is soliciting comments from the public, federal, state, and local agencies and officials, Indian Tribes, and other interested parties in order to consider and evaluate the impacts of this proposed activity. Any comments received will be considered by the U.S. Army Corps of Engineers to determine whether to make, modify, condition, or deny a permit for this proposal. To make this decision, comments are used to assess impacts on endangered species, historic properties, water quality, general environmental effects, and other public interest factors listed above. Comments are used in the preparation of an Environmental Assessment and/or an Environmental Impact Statement pursuant to the National Environmental Policy Act. Comments are also used to determine the need for a public hearing and to determine the overall public interest of the proposed activity.

The New Orleans District is unaware of properties listed on the National Register of Historic Places near the proposed work. The possibility exists that the proposed work may damage or destroy presently unknown archeological, scientific, prehistorical, historical sites, or data. Issuance of this public notice solicits input from the State Archeologist and State Historic Preservation Officer regarding potential impacts to cultural resources.

The New Orleans District has determined that the proposed project will have no effect on any listed species based on the Standard Local Operating Procedure for Endangered Species of Louisiana (SLOPES), dated October 22, 2014, between the U.S. Army Corps of Engineers and U.S. Fish and Wildlife Service, Ecological Services Office.

Our initial finding is that the proposed work would not affect any species, nor affect any habitat designated as critical to the survival and recovery of such species, listed as endangered by the U.S. Department of Commerce.

This notice initiates the Essential Fish Habitat (EFH) consultation requirements of the Magnuson-Stevens Fishery Conservation and Management Act. The applicant's proposal would result in the destruction or alteration of 6.09 acres of EFH utilized by various life stages of red drum and penaeid shrimp. Our initial determination is that the proposed action would not have a substantial adverse impact on EFH or federally managed fisheries in the Gulf of Mexico. Our final determination relative to project impacts and the need for mitigation measures is subject to review by and coordination with the National Marine Fisheries Service.

If the proposed work involves deposits of dredged or fill material into navigable waters, the evaluation of the probable impacts will include the application of guidelines established by the Administrator of the Environmental Protection Agency. Also, a certification that the proposed activity will not violate applicable water quality standards will be required from the Department of Environmental Quality, Water Quality Certifications, before a permit is issued.

Any person may request, in writing, within the comment period specified in this notice, that a public hearing be held to consider this application. Requests for public hearings shall state, with particularity, the reasons for holding a public hearing.

The applicant has certified that the proposed activity described in the application complies with and will be conducted in a manner that is consistent with the Louisiana Coastal Resources Program. The Department of the Army permit will not be issued unless the applicant received approval or a waiver of the Coastal Use Permit by the Department of Natural Resources.

You are requested to communicate the information contained in this notice to any other parties whom you deem likely to have interest in the matter.

Michael V. Farabee  
Chief, Eastern Evaluation Section

Enclosure

G:\11177\CORP PERMITS\PERMIT SECTION.dwg [PERMIT OVERALL] Dec 18, 2018 - 7:57am by ron



### LOCATION MAP

JEFFERSON PARISH DEPT. OF PUBLIC WORKS  
LEO KERNER BIKE PATH  
CORPS OF ENGINEERS PERMIT APPLICATION

JEFFERSON PARISH,  
LOUISIANA

OWNER

SCALE:  
1" = 1200'

DATE:  
DECEMBER 2018

 **PEC** PROFESSIONAL ENGINEERING  
CONSULTANTS CORPORATION  
7600 Innovation Park Dr. | Baton Rouge, LA 70820 | 225.769.2810

PROJECT NO. <b>11177</b>
SHEET NO. <b>EXHIBIT A</b>

C:\11177\CORP PERMITS\PERMIT SECTION.dwg [PERMIT SECTION] Sep 02, 2019 - 5:28pm by ron

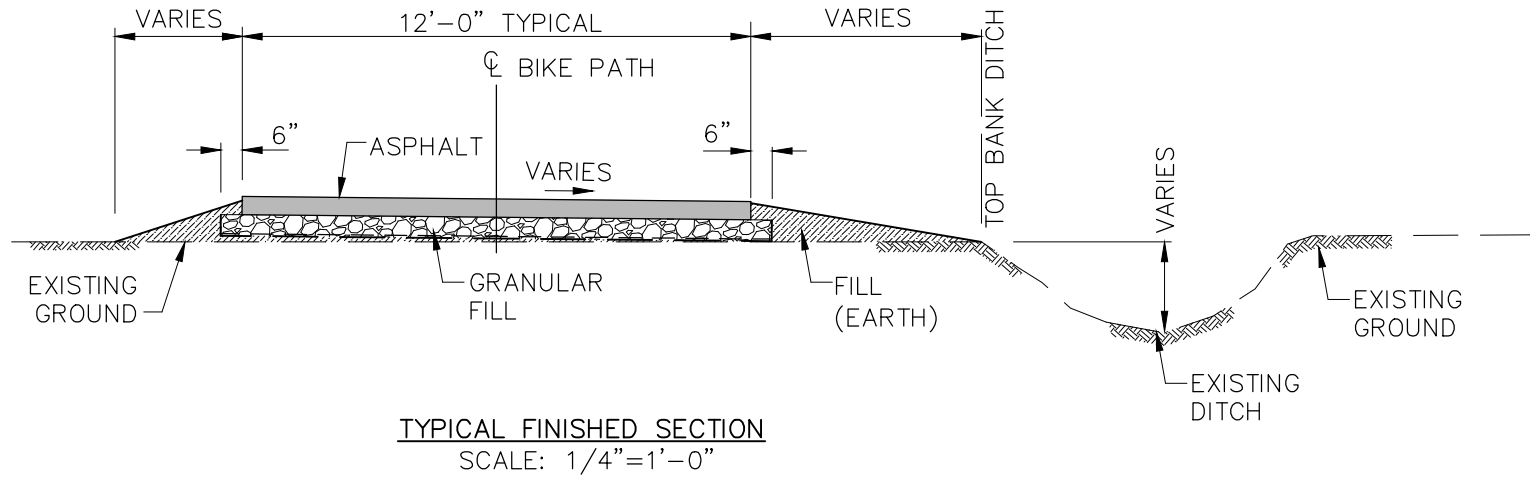

ITEM	UNIT	AREA 1 QUANTITY	AREA 2 QUANTITY	AREA 3 QUANTITY	TOTAL QUANTITY
LENGTH OF BIKE PATH	L.F.	920	1,180	3,422	5,534
LENGTH OF DITCH	L.F.	918	1,180	3,415	5,525
TREE REMOVAL	AC.	1.014	1.278	2.821	5.113
EXCAVATION	C.Y.	168.2	91.3	659.1	918.6
FILL (EARTH)	C.Y.	707.2	350.9	355.4	1,413.5
ASPHALT PAVEMENT	S.Y.	1,243	1,573	4,563	7,379
GRANULAR FILL	C.Y.	224.4	284.1	823.8	1,332.3

JEFFERSON PARISH,  
LOUISIANA

OWNER

JEFFERSON PARISH DEPT. OF PUBLIC WORKS  
LEO KERNER BIKE PATH  
CORPS OF ENGINEERS PERMIT APPLICATION

TITLE

SCALE:  
NOTED

DATE:  
DECEMBER 2018



**PEC** PROFESSIONAL ENGINEERING  
CONSULTANTS CORPORATION  
7600 Innovation Park Dr. | Baton Rouge, LA 70820 | 225.769.2610

PROJECT NO.

11177

SHEET NO.

EXHIBIT B



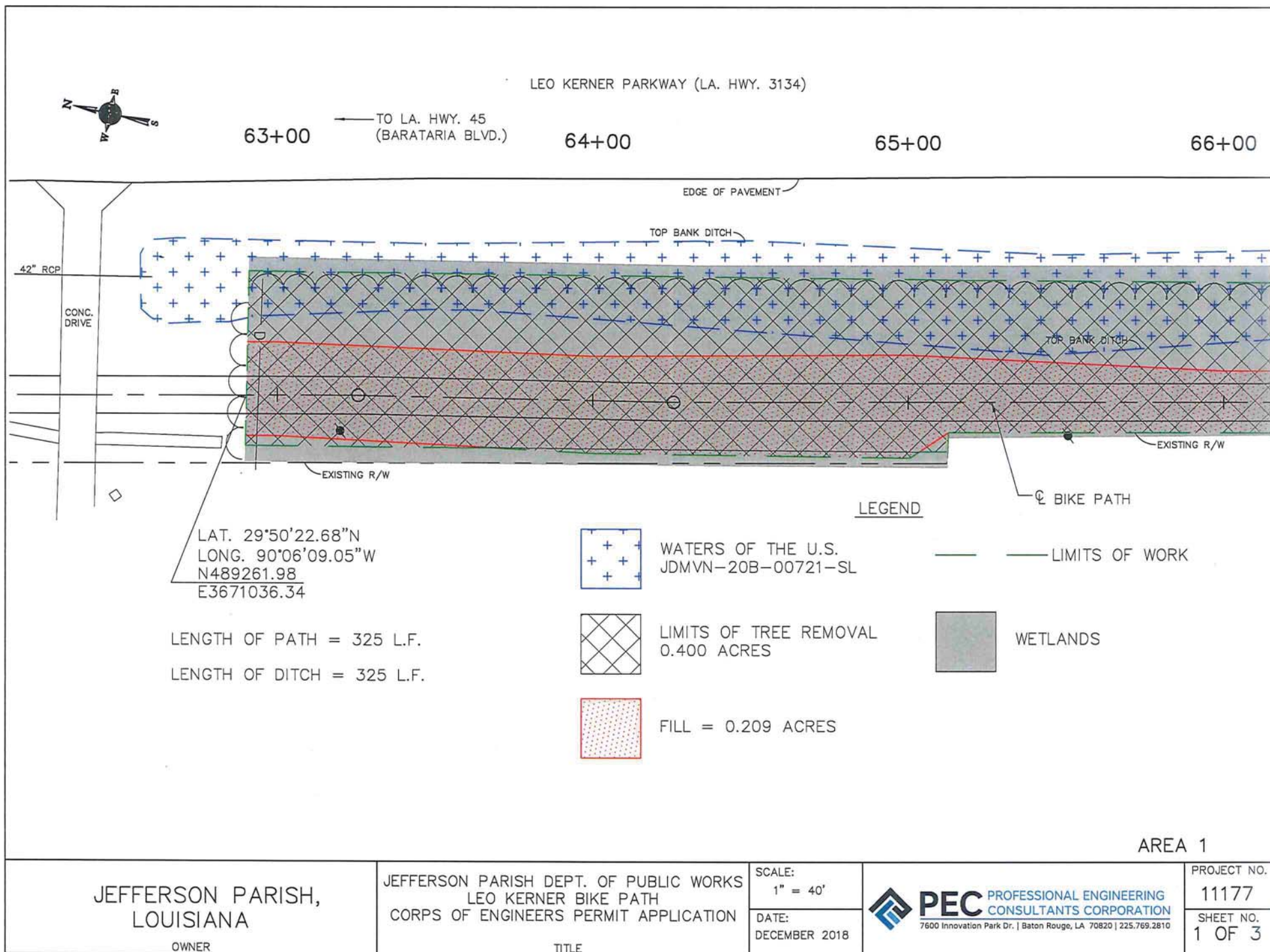



LEO KERNER PARKWAY (LA. HWY. 3134)

67+00

← TO LA. HWY. 45  
(BARATARIA BLVD.)

68+00

69+00

70+00

EDGE OF PAVEMENT

TOP BANK DITCH

EXISTING R/W

CL BIKE PATH

LEGEND

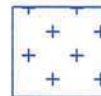

WATERS OF THE U.S.  
JDMVN-20B-00721-SL

— LIMITS OF WORK

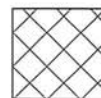

LIMITS OF TREE REMOVAL  
0.423 ACRES



WETLANDS



FILL = 0.180 ACRES

LENGTH OF PATH = 400 L.F.

LENGTH OF DITCH = 400 L.F.

AREA 1

JEFFERSON PARISH,  
LOUISIANA

OWNER

JEFFERSON PARISH DEPT. OF PUBLIC WORKS  
LEO KERNER BIKE PATH  
CORPS OF ENGINEERS PERMIT APPLICATION

TITLE

SCALE:  
1" = 40'

DATE:  
DECEMBER 2018



**PEC** PROFESSIONAL ENGINEERING  
CONSULTANTS CORPORATION  
7600 Innovation Park Dr. | Baton Rouge, LA 70820 | 225.769.2810

PROJECT NO.

11177

SHEET NO.  
2 OF 3



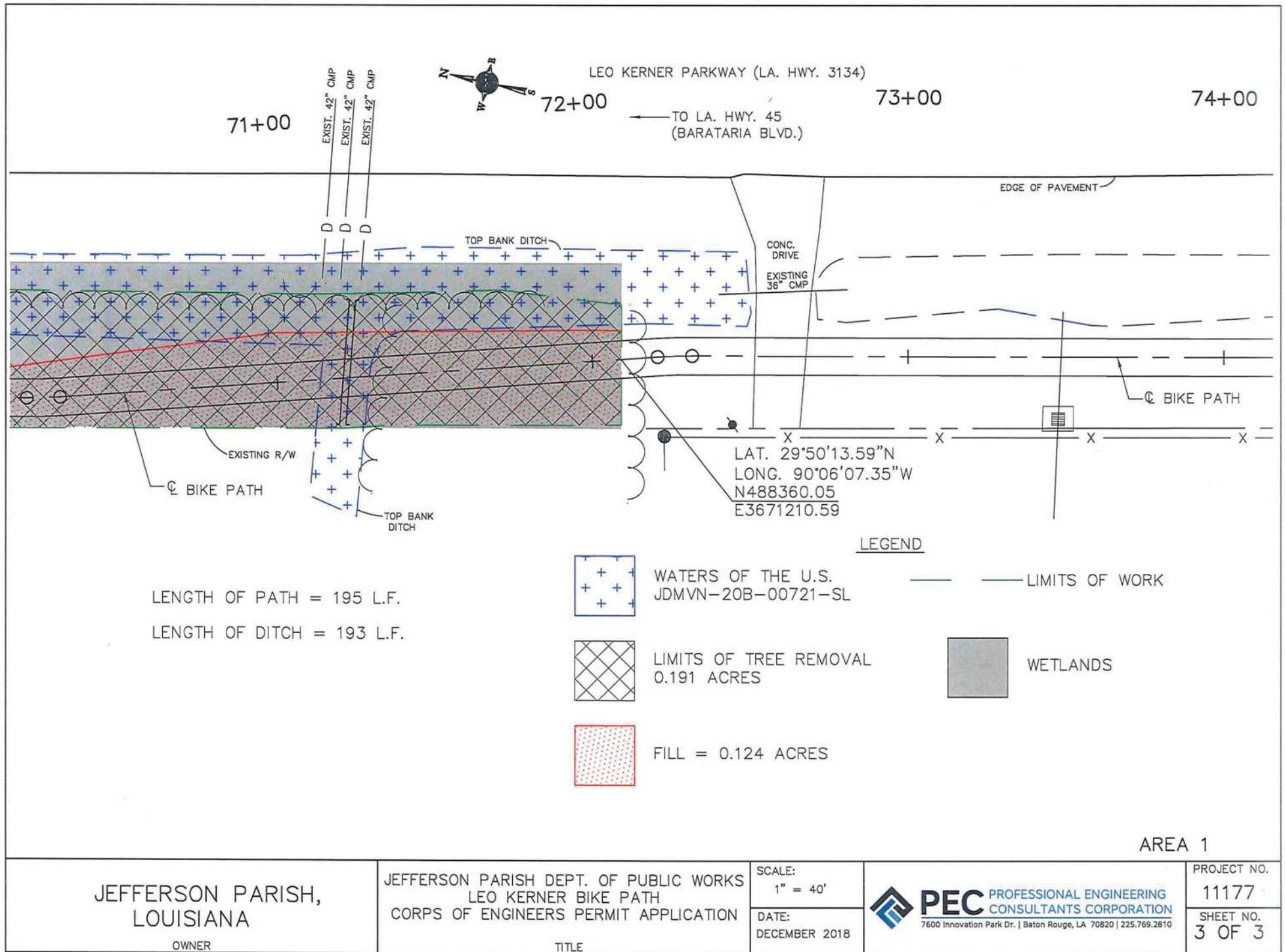



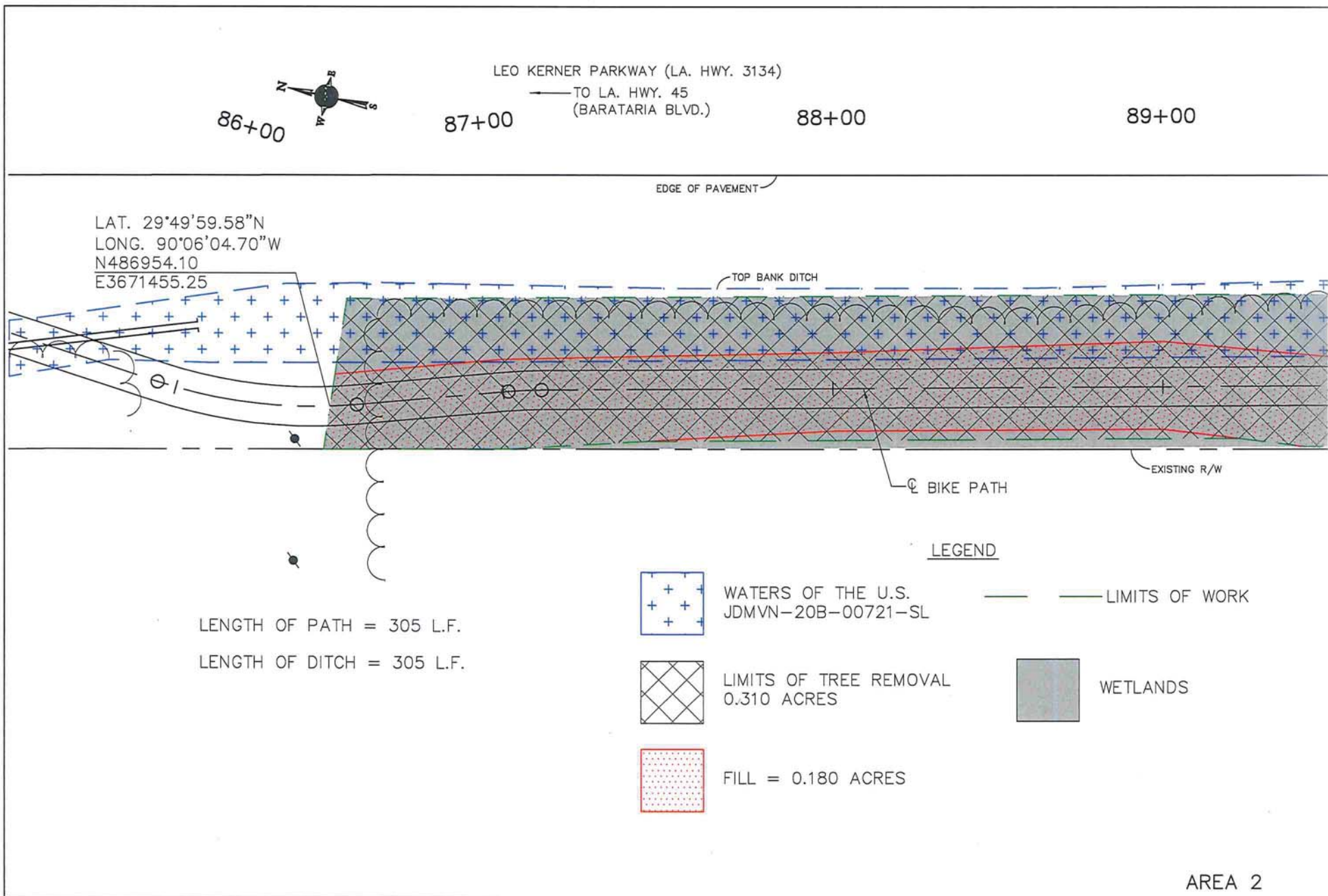

AREA 2

JEFFERSON PARISH,  
 LOUISIANA

OWNER

JEFFERSON PARISH DEPT. OF PUBLIC WORKS  
 LEO KERNER BIKE PATH  
 CORPS OF ENGINEERS PERMIT APPLICATION

TITLE

SCALE:  
 1" = 40'

DATE:  
 DECEMBER 2018



**PEC** PROFESSIONAL ENGINEERING  
 CONSULTANTS CORPORATION  
 7600 Innovation Park Dr. | Baton Rouge, LA 70820 | 225.769.2810

PROJECT NO.

11177

SHEET NO.  
 1 OF 4

LEO KERNER PARKWAY (LA. HWY. 3134)

90+00



91+00

TO LA. HWY. 45  
(BARATARIA BLVD.)

92+00

93+00

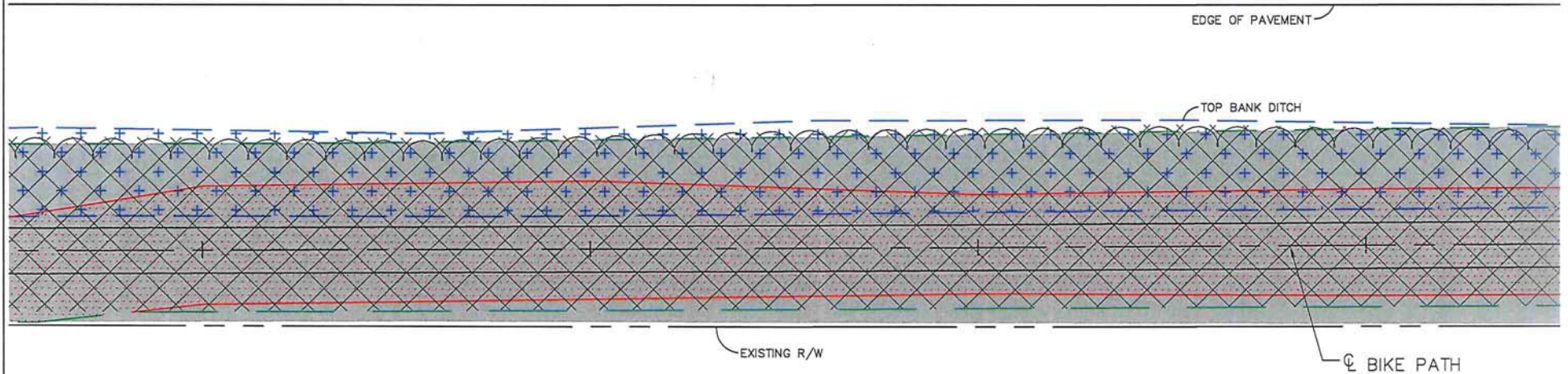

LEGEND



WATERS OF THE U.S.  
JDMVN-20B-00721-SL



LIMITS OF TREE REMOVAL  
0.453 ACRES



FILL = 0.265 ACRES

— LIMITS OF WORK



WETLANDS

LENGTH OF PATH = 400 L.F.

LENGTH OF DITCH = 400 L.F.

AREA 2

JEFFERSON PARISH,  
LOUISIANA

OWNER

JEFFERSON PARISH DEPT. OF PUBLIC WORKS  
LEO KERNER BIKE PATH  
CORPS OF ENGINEERS PERMIT APPLICATION

TITLE

SCALE:

1" = 40'

DATE:

DECEMBER 2018

**PEC** PROFESSIONAL ENGINEERING  
CONSULTANTS CORPORATION  
7600 Innovation Park Dr. | Baton Rouge, LA 70820 | 225.769.2810

PROJECT NO.

11177

SHEET NO.

2 OF 4



94+00



95+00

LEO KERNER PARKWAY (LA. HWY. 3134)

 TO LA. HWY. 45  
(BARATARIA BLVD.)

96+00

97+00

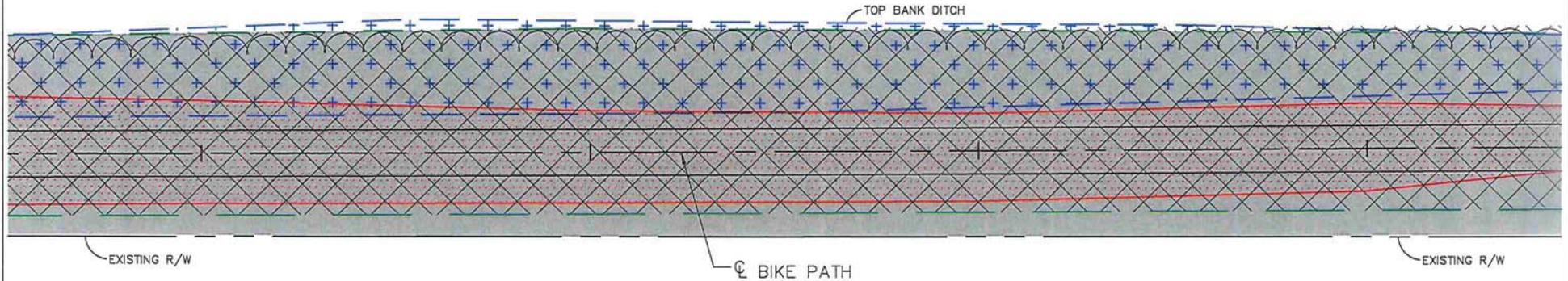

LENGTH OF PATH = 400 L.F.

LENGTH OF DITCH = 400 L.F.

LEGEND
 WATERS OF THE U.S.  
JDMVN-20B-00721-SL

— LIMITS OF WORK

 LIMITS OF TREE REMOVAL  
0.438 ACRES

WETLANDS



FILL = 0.219 ACRES

AREA 2

 JEFFERSON PARISH,  
LOUISIANA

OWNER

 JEFFERSON PARISH DEPT. OF PUBLIC WORKS  
LEO KERNER BIKE PATH  
CORPS OF ENGINEERS PERMIT APPLICATION

TITLE

 SCALE:  
1" = 40'

 DATE:  
DECEMBER 2018

**PEC** PROFESSIONAL ENGINEERING  
CONSULTANTS CORPORATION  
7600 Innovation Park Dr. | Baton Rouge, LA 70820 | 225.769.2810

PROJECT NO.

11177

 SHEET NO.  
3 OF 4



98+00



LEO KERNER PARKWAY (LA. HWY. 3134)  
 99+00 — TO LA. HWY. 45  
 (BARATARIA BLVD.) 100+00

101+00

EDGE OF PAVEMENT

LAT. 29°49'48.16"N  
 LONG. 90°06'02.53"W  
 N485799.30  
 E3671675.44

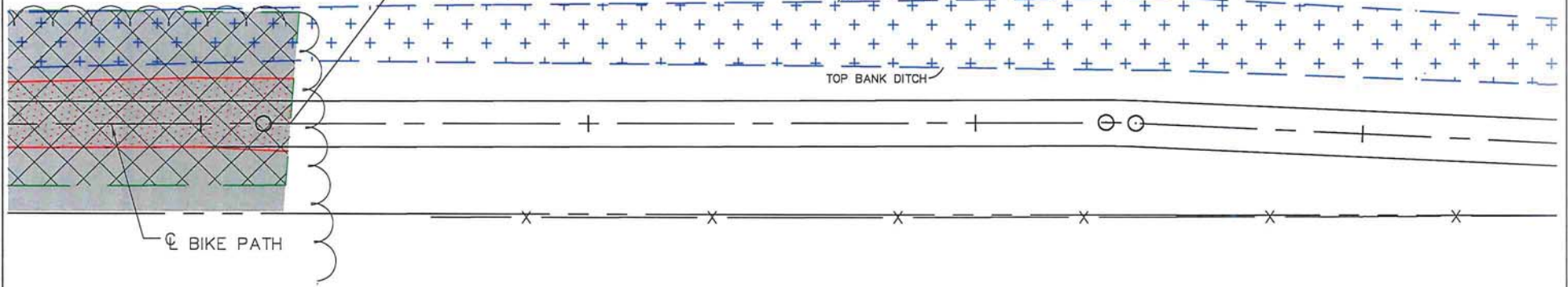

CL BIKE PATH

LENGTH OF PATH = 75 L.F.

LENGTH OF DITCH = 75 L.F.

# LEGEND

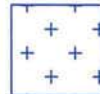

WATERS OF THE U.S.  
 JDMVN-20B-00721-SL

— LIMITS OF WORK



LIMITS OF TREE REMOVAL  
 0.077 ACRES



WETLANDS



FILL = .030 ACRES

AREA 2

JEFFERSON PARISH,  
 LOUISIANA

OWNER

JEFFERSON PARISH DEPT. OF PUBLIC WORKS  
 LEO KERNER BIKE PATH  
 CORPS OF ENGINEERS PERMIT APPLICATION

TITLE

SCALE:  
 1" = 40'

DATE:  
 DECEMBER 2018

**PEC** PROFESSIONAL ENGINEERING  
 CONSULTANTS CORPORATION  
 7600 Innovation Park Dr. | Baton Rouge, LA 70820 | 225.769.2810

PROJECT NO.

11177

SHEET NO.

4 OF 4



LEO KERNER PARKWAY (LA. HWY. 3134)

TO LA. HWY. 45  
(BARATARIA BLVD.)

166+00

167+00

168+00

169+00

EDGE OF PAVEMENT

LAT. 29°48'40.85"N  
LONG. 90°05'54.79"W  
N478954.53  
E3672409.62

TOP BANK DITCH

EXISTING R/W

CL BIKE PATH

EXISTING R/W

LENGTH OF PATH = 215 L.F.

LENGTH OF DITCH = 215 L.F.

### LEGEND

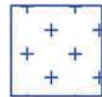

WATERS OF THE U.S.  
JDMVN-20B-00721-SL

— LIMITS OF WORK

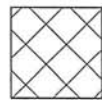

LIMITS OF TREE REMOVAL  
0.251 ACRES



WETLANDS

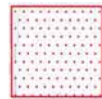

FILL = 0.088 ACRES

AREA 3

JEFFERSON PARISH,  
LOUISIANA

OWNER

JEFFERSON PARISH DEPT. OF PUBLIC WORKS  
LEO KERNER BIKE PATH  
CORPS OF ENGINEERS PERMIT APPLICATION

TITLE

SCALE:  
1" = 40'

DATE:  
DECEMBER 2018



**PEC** PROFESSIONAL ENGINEERING  
CONSULTANTS CORPORATION  
7600 Innovation Park Dr. | Baton Rouge, LA 70820 | 225.769.2810

PROJECT NO.

11177

SHEET NO.  
1 OF 9





LEO KERNER PARKWAY (LA. HWY. 3134)

← TO LA. HWY. 45  
(BARATARIA BLVD.)

172+00

173+00

170+00

EDGE OF PAVEMENT

TOP BANK DITCH

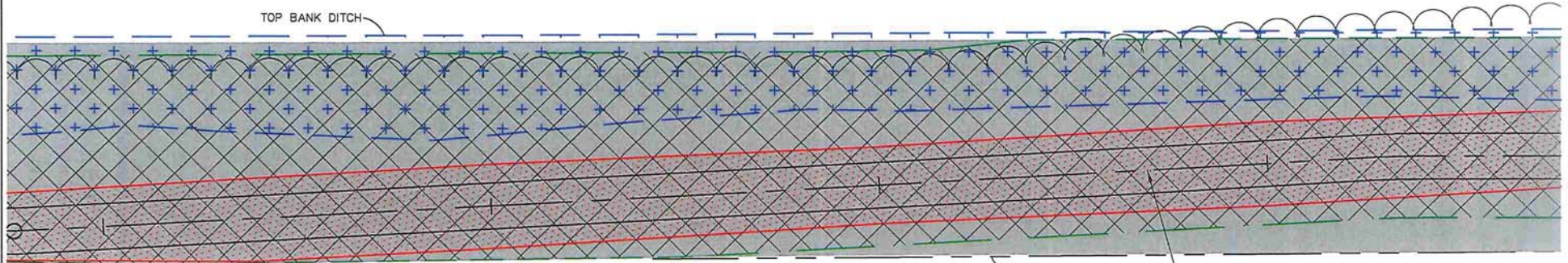

EXISTING R/W

CL BIKE PATH

### LEGEND

LENGTH OF PATH = 400 L.F.

LENGTH OF DITCH = 400 L.F.



WATERS OF THE U.S.  
JDMVN-20B-00721-SL



LIMITS OF TREE REMOVAL  
0.474 ACRES



FILL = 0.192 ACRES

— — LIMITS OF WORK



WETLANDS

AREA 3

JEFFERSON PARISH,  
LOUISIANA

OWNER

JEFFERSON PARISH DEPT. OF PUBLIC WORKS  
LEO KERNER BIKE PATH  
CORPS OF ENGINEERS PERMIT APPLICATION

TITLE

SCALE:  
1" = 40'

DATE:  
DECEMBER 2018

 **PEC** PROFESSIONAL ENGINEERING  
CONSULTANTS CORPORATION  
7600 Innovation Park Dr. | Baton Rouge, LA 70820 | 225.769.2810

PROJECT NO.

11177

SHEET NO.

2 OF 9



174+00



LEO KERNER PARKWAY (LA. HWY. 3134)

175+00

 TO LA. HWY. 45  
(BARATARIA BLVD.)

176+00

177+00

EXIST. 36"x59" CMP

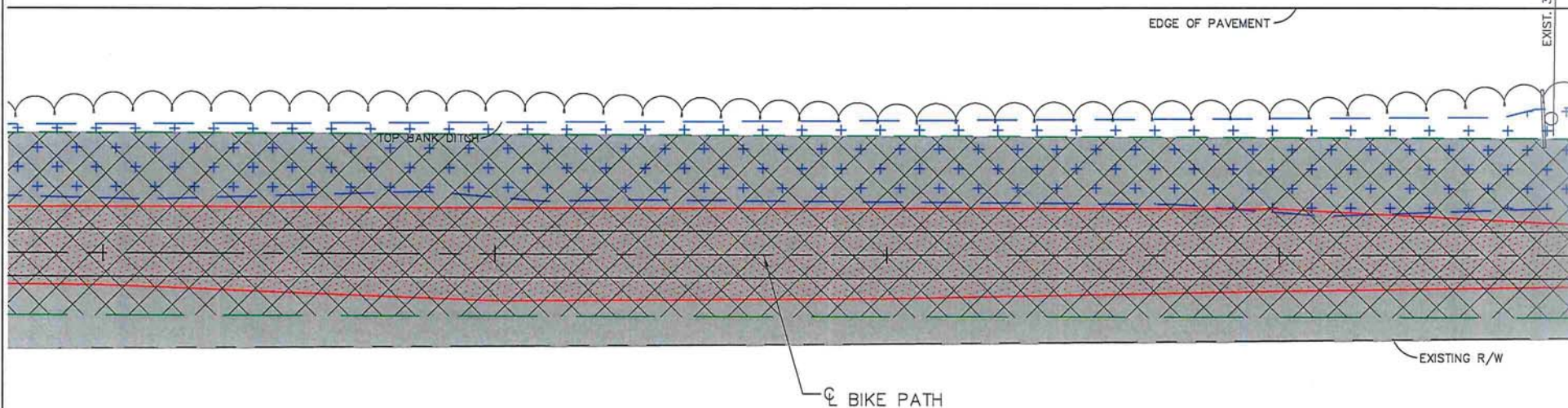

LENGTH OF PATH = 400 L.F.

LENGTH OF DITCH = 400 L.F.

## LEGEND

 WATERS OF THE U.S.  
JDMVN-20B-00721-SL

LIMITS OF WORK

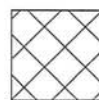
 LIMITS OF TREE REMOVAL  
0.428 ACRES

FILL = 0.200 ACRES



WETLANDS

AREA 3

 JEFFERSON PARISH,  
LOUISIANA

OWNER

 JEFFERSON PARISH DEPT. OF PUBLIC WORKS  
LEO KERNER BIKE PATH  
CORPS OF ENGINEERS PERMIT APPLICATION

TITLE

 SCALE:  
1" = 40'

 DATE:  
DECEMBER 2018

**PEC** PROFESSIONAL ENGINEERING  
CONSULTANTS CORPORATION  
7600 Innovation Park Dr. | Baton Rouge, LA 70820 | 225.769.2810

PROJECT NO.

11177

SHEET NO.

3 OF 9

← TO LA. HWY. 45  
(BARATARIA BLVD.)

181+00

EDGE OF PAVEMENT —

TOP BANK DITCH

- EXISTING R/W

-C BIKE PATH

LENGTH OF PATH = 400 L.F.

LENGTH OF DITCH = 400 L.F.



WATERS OF THE U.S.  
JDMVN-20B-00721-SL



LIMITS OF TREE REMOVAL  
0.418 ACRES



FILL = 0.177 ACRES

## LIMITS OF WORK

WETLANDS

AREA 3

JEFFERSON PARISH,  
LOUISIANA

OWNER

JEFFERSON PARISH DEPT. OF PUBLIC WORKS  
LEO KERNER BIKE PATH  
CORPS OF ENGINEERS PERMIT APPLICATION

TITLE

SCALE:  
1" = 40'

DATE:  
DECEMBER 2018



PROJECT NO.	
-------------	--

11177

SHEET NO.  
4 OF 9



182+00



LEO KERNER PARKWAY (LA. HWY. 3134)

183+00

 TO LA. HWY. 45  
(BARATARIA BLVD.)

184+00

185+00

EDGE OF PAVEMENT

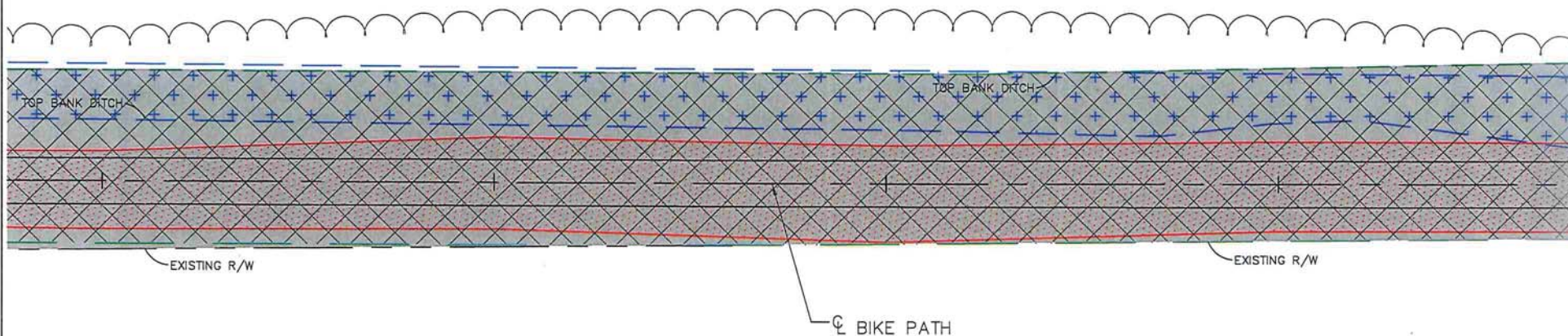

LENGTH OF PATH = 400 L.F.

LENGTH OF DITCH = 400 L.F.

## LEGEND

 WATERS OF THE U.S.  
JDMVN-20B-00721-SL

 LIMITS OF TREE REMOVAL  
0.410 ACRES

FILL = 0.214 ACRES

 LIMITS OF WORK

WETLANDS

AREA 3

 JEFFERSON PARISH,  
LOUISIANA

OWNER

 JEFFERSON PARISH DEPT. OF PUBLIC WORKS  
LEO KERNER BIKE PATH  
CORPS OF ENGINEERS PERMIT APPLICATION

TITLE

 SCALE:  
1" = 40'

 DATE:  
DECEMBER 2018

**PEC** PROFESSIONAL ENGINEERING  
CONSULTANTS CORPORATION  
7600 Innovation Park Dr. | Baton Rouge, LA 70820 | 225.769.2810

PROJECT NO.

11177

SHEET NO.

5 OF 9



