

JOINT PUBLIC NOTICE

June 19, 2017

United States Army
Corps of Engineers
New Orleans District
Regulatory Branch
Post Office Box 60267
New Orleans, Louisiana 70160-0267

(504) 862-1564
Stephanie.L.Castaing@usace.army.mil
Project Manager
Stephanie Castaing
Permit Application Number
MVN 2009-2142-EPP

State of Louisiana
Department of Environmental Quality
ATTN: Water Quality Certifications
Post Office Box 4313
Baton Rouge, Louisiana 70821-4313

(225) 219-3225

Project Manager
Elizabeth Hill
WQC Application Number
WQC 170615-01

Interested parties are hereby notified that a permit application has been received by the New Orleans District of the U.S. Army Corps of Engineers pursuant to: [X] Section 10 of the Rivers and Harbors Act of March 3, 1899 (30 Stat. 1151; 33 USC 403); and/or [X] Section 404 of the Clean Water Act (86 Stat. 816; 33 USC 1344).

Application has also been made to the Louisiana Department of Environmental Quality, Water Quality Certifications, for a Water Quality Certification (WQC) in accordance with statutory authority contained in LRS30:2047 A(3), and provisions of Section 401 of the Clean Water Act (P.L.95-17).

TIME EXTENSION TO DREDGE AND STOCKPILE SAND WITHIN AND ALONG THE MISSISSIPPI RIVER AT AN EXISTING FACILITY IN PLAQUEMINES PARISH

NAME OF APPLICANT: Woodland Borrow Pits, LLC, c/o Paul Hogan, Post Office Box 250, Des Allemands, Louisiana 70030.

LOCATION OF WORK: Project site is located on the right descending bank of the Mississippi River, at about 50 miles above Head of Passes, at 22442 LA Highway 23, in Port Sulphur, Louisiana, in Plaquemines Parish, as shown on the attached drawings.

Latitude: 29.58278/Longitude: -89.81306 Hydrologic Unit Codes: 08090100 Lower Mississippi-New Orleans.

CHARACTER OF WORK: Dredge and stockpile sand for commercial sales. Project implementation will require the excavation and deposition of 4,500,000 cubic yards of native material. The applicant has stated that no jurisdictional wetlands will be impacted; therefore, compensatory mitigation has not been proposed.

The comment period for the Department of the Army Permit and the Louisiana Department of Environmental Quality WQC will close **30 days** from the date of this joint public notice. Written comments, including suggestions for modifications or objections to the proposed work, stating reasons thereof, are being solicited from anyone having interest in this permit and/or this WQC request and must be mailed so as to be received before or by the last day of the comment period. Letters concerning the Corps of Engineers permit application must reference the applicant's name and the Permit Application Number, and be mailed to the Corps of Engineers at the address above, **ATTENTION: REGULATORY BRANCH**. Similar letters concerning the Water Quality Certification must reference the applicant's name and the WQC Application number and be mailed to the Louisiana Department of Environmental Quality at the address above.

The application for this proposed project is on file with the Louisiana Department of Environmental Quality and may be examined during weekdays between 8:00 a.m. and 4:30 p.m. Copies may be obtained upon payment of costs of reproduction.

Corps of Engineers Permit Criteria

The decision whether to issue a permit will be based on an evaluation of the probable impacts, including cumulative impacts of the proposed activity on the public interest. That decision will reflect the national concern for both protection and utilization of important resources. The benefit which reasonably may be expected to accrue from the proposal must be balanced against its reasonably foreseeable detriments. All factors which may be relevant to the proposal will be considered including the cumulative effects thereof; among those are conservation, economics, aesthetics, general environmental concerns, wetlands, historic properties, fish and wildlife values, flood hazards, floodplain values, land use, navigation, shoreline erosion and accretion, recreation, water supply and conservation, water quality, energy needs, safety, food and fiber production, mineral needs, considerations of property ownership and, in general, the needs and welfare of the people.

The U.S. Army Corps of Engineers is soliciting comments from the public, federal, state, and local agencies and officials, Indian Tribes, and other interested parties in order to consider and evaluate the impacts of this proposed activity. Any comments received will be considered by the U.S. Army Corps of Engineers to determine whether to make, modify, condition, or deny a permit for this proposal. To make this decision, comments are used to assess impacts on endangered species, historic properties, water quality, general environmental effects, and other public interest factors listed above. Comments are used in the preparation of an Environmental Assessment and/or an Environmental Impact Statement pursuant to the National Environmental Policy Act. Comments are also used to determine the need for a public hearing and to determine the overall public interest of the proposed activity.

The New Orleans District is unaware of properties listed on the National Register of Historic Places near the proposed work. The possibility exists that the proposed work may damage or destroy presently unknown archeological, scientific, prehistorical, historical sites, or data. Issuance of this public notice solicits input from the State Archeologist and State Historic Preservation Officer regarding potential impacts to cultural resources.

The New Orleans District has determined that the proposed project is located in waters known to be utilized by the pallid sturgeon (*Scaphirhynchus albus*) and determined that the proposed activity is not likely to adversely affect the species based on the Standard Local Operating Procedure for Endangered Species of Louisiana (SLOPES), dated October 22, 2014, between the U.S. Army Corps of Engineers and U.S. Fish and Wildlife Service, Ecological Services Office.

Our initial finding is that the proposed work would not affect any species, nor affect any habitat designated as critical to the survival and recovery of such species, listed as endangered by the U.S. Department of Commerce.

This notice initiates the Essential Fish Habitat (EFH) consultation requirements of the Magnuson-Stevens Fishery Conservation and Management Act. The applicant's proposal would result in the destruction or alteration of 69.0 acres of EFH utilized by various life stages of red drum and penaeid shrimp. Our initial determination is that the proposed action would not have a substantial adverse impact on EFH or federally managed fisheries in the Gulf of Mexico. Our final determination relative to project impacts and the need for mitigation measures is subject to review by and coordination with the National Marine Fisheries Service.

If the proposed work involves deposits of dredged or fill material into navigable waters, the evaluation of the probable impacts will include the application of guidelines established by the Administrator of the Environmental Protection Agency. Also, a certification that the proposed activity will not violate applicable water quality standards will be required from the Department of Environmental Quality, Water Quality Certifications, before a permit is issued.

Any person may request, in writing, within the comment period specified in this notice, that a public hearing be held to consider this application. Requests for public hearings shall state, with particularity, the reasons for holding a public hearing.

The applicant has certified that the proposed activity described in the application complies with and will be conducted in a manner that is consistent with the Louisiana Coastal Resources Program. The Department of the Army permit will not be issued unless the applicant received approval or a waiver of the Coastal Use Permit by the Department of Natural Resources.

You are requested to communicate the information contained in this notice to any other parties whom you deem likely to have interest in the matter.

for
Michael V. Farabee
Chief, Eastern Evaluation Section

Enclosure

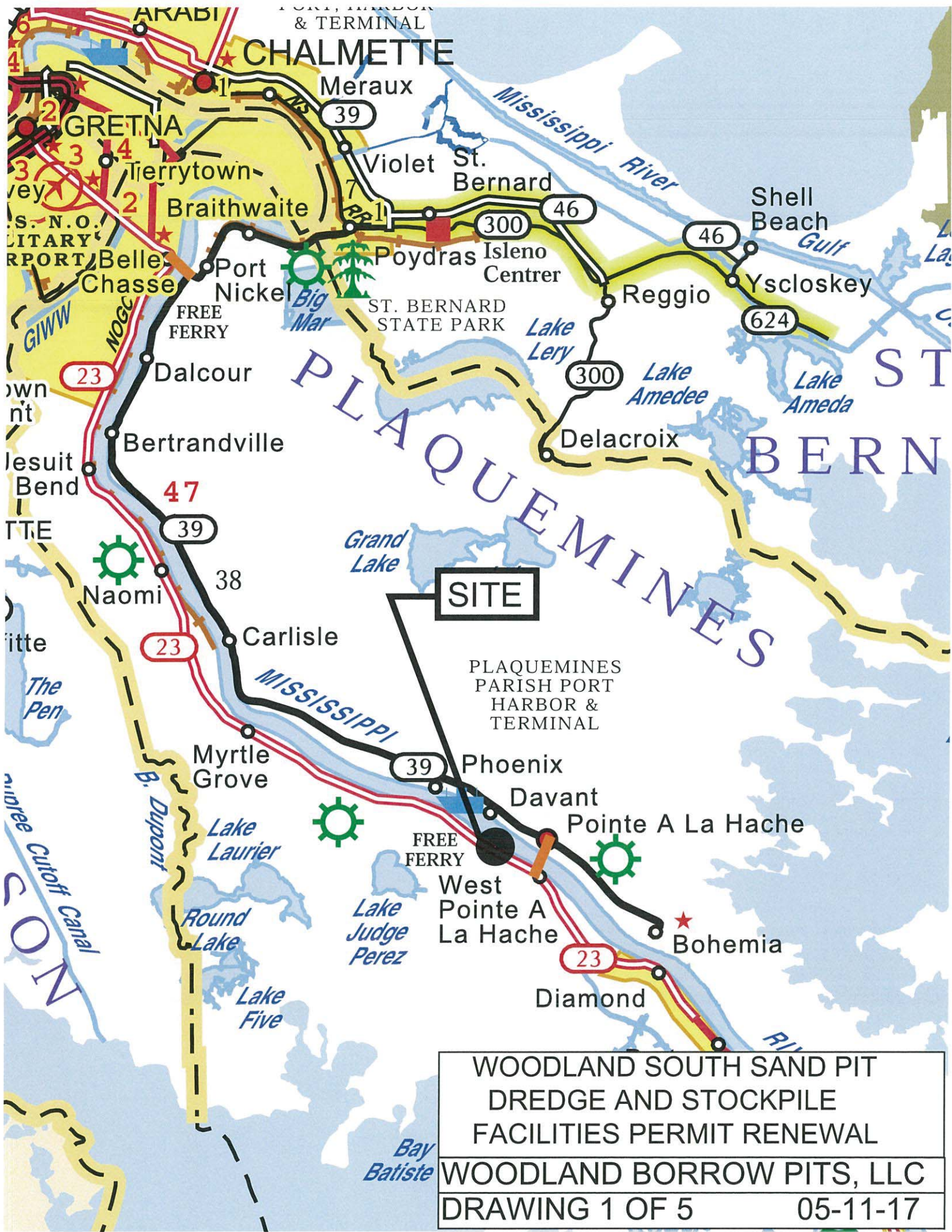

SITE

PLAQUEMINES
PARISH PORT
HARBOR &
TERMINAL

WOODLAND SOUTH SAND PIT
DREDGE AND STOCKPILE
FACILITIES PERMIT RENEWAL

WOODLAND BORROW PITS, LLC
DRAWING 1 OF 5 05-11-17

0' 2000'

SCALE

STOCKPILE AREA

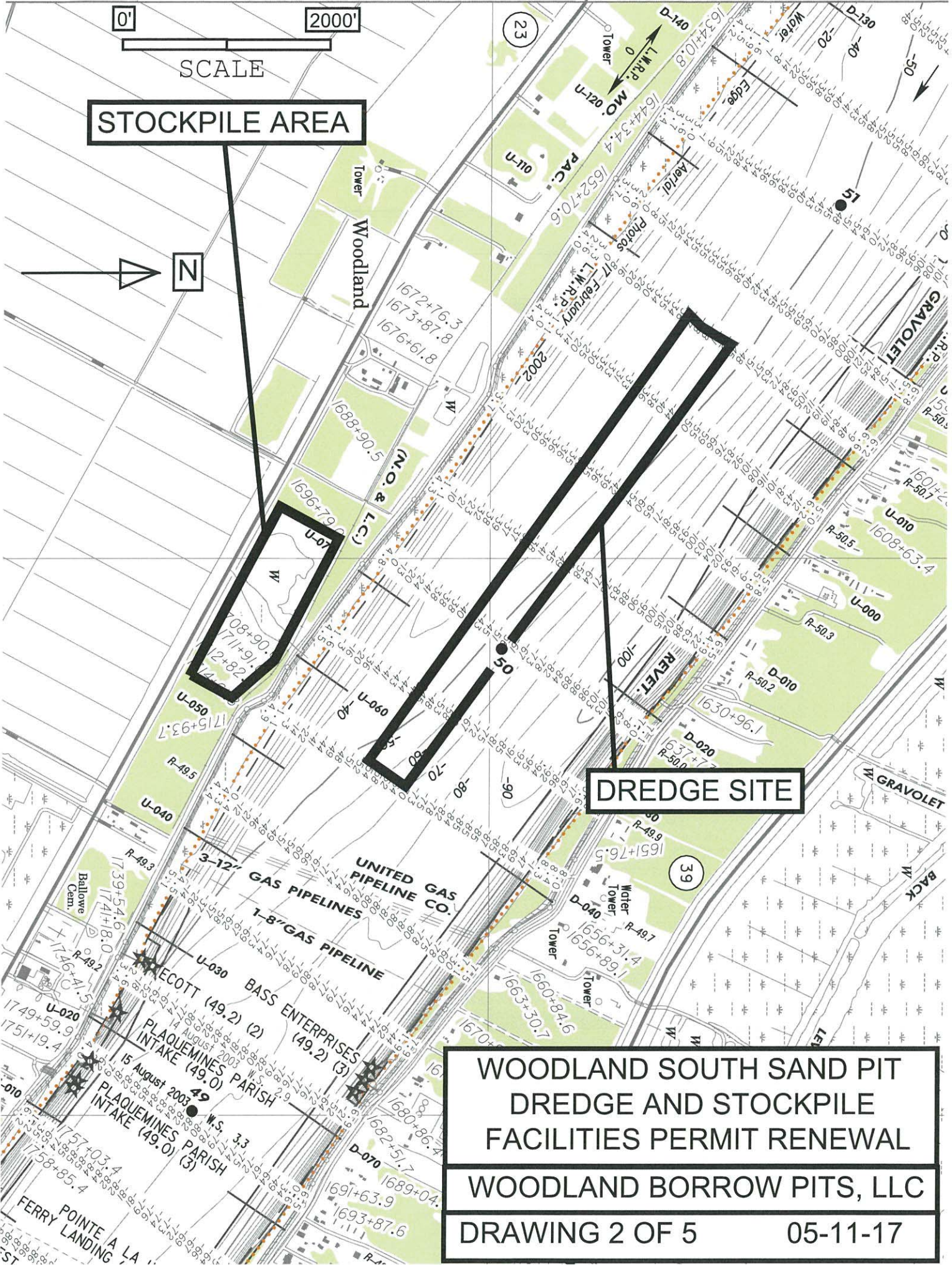

DREDGE SITE

WOODLAND SOUTH SAND PIT
 DREDGE AND STOCKPILE
 FACILITIES PERMIT RENEWAL

WOODLAND BORROW PITS, LLC

DRAWING 2 OF 5 05-11-17

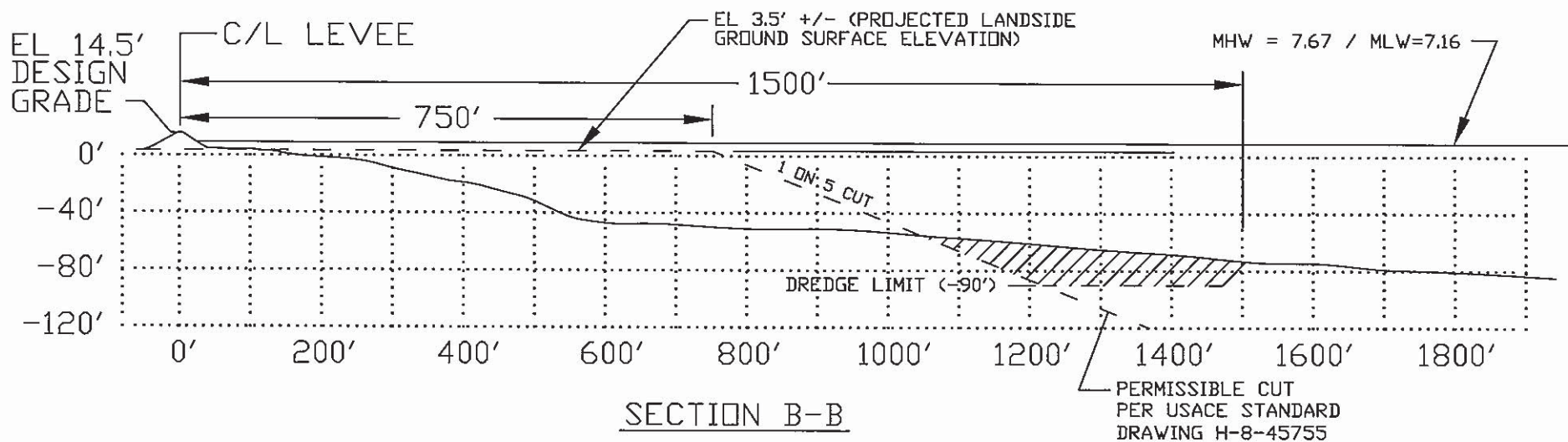
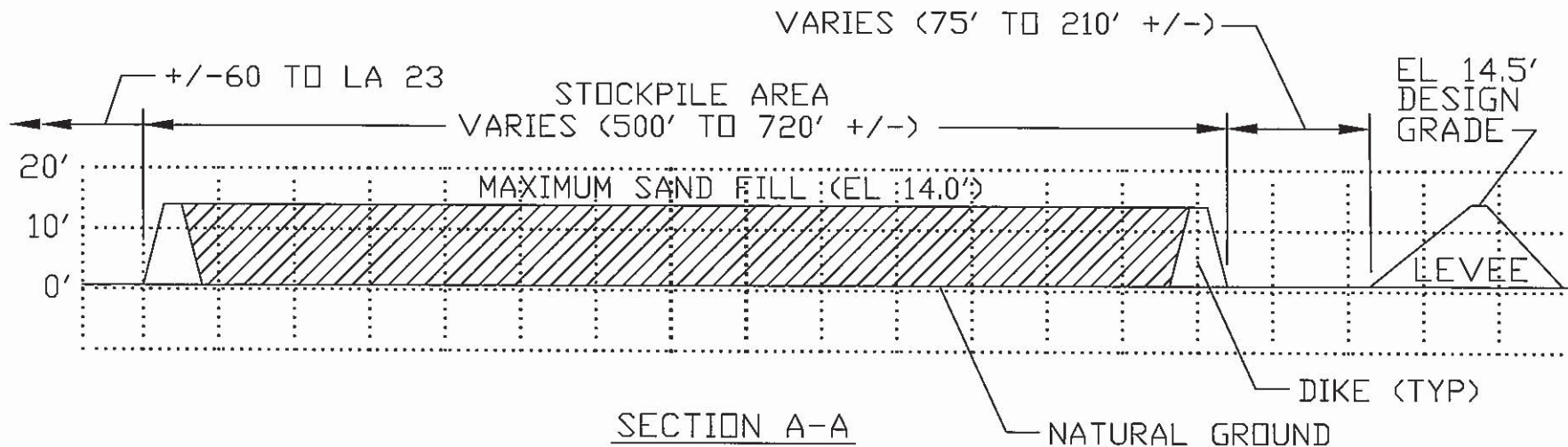

WOODLAND SOUTH SAND PIT
DREDGE AND STOCKPILE

FACILITIES PERMIT RENEWAL

WOODLAND BORROW PITS, LLC

DRAWING 4 OF 5

05-11-17

MISSISSIPPI RIVER

NOTE: THE TEMPORARY DREDGE PIPELINE CROSSING MATERIAL SHALL BE 610 LIMESTONE OR EQUAL. THE MATERIAL IS TO BE REMOVED AND PLACED ON THE EXISTING RAMP OR REMOVED FROM THE SITE UPON COMPLETION OF THE DREDGING OPERATION.

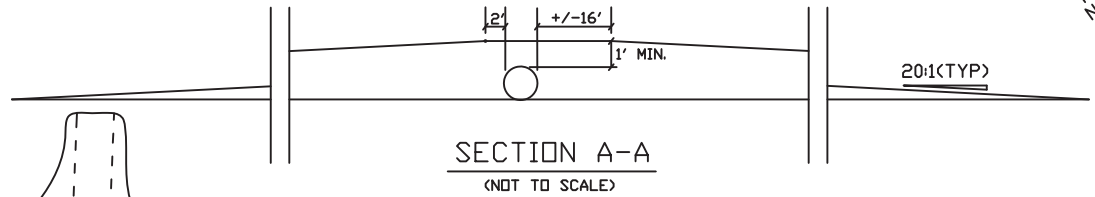

TEMOPRARY DREDGE PIPELINE TO BE ROUTED TO RIVER TO FLOATING DREDGE PIPELINE

BATTURE

BATTURE

RIVER BANK

EXISTING CROSSING

TOE

1705+80(+/-)

20:1 SLOPE (MAX)

1708+91

CROWN

A

A

3:1 SLOPE (MAX)

TOE

10:1 SLOPE (MAX)

TO WOODLAND SOUTH SAND PIT

PROPOSED TEMPORARY DREDGE PIPELINE
MISSISSISSI LEVEE CROSSING
STATION 1705+80 (+/-)

PORT SULPHUR, LOUISIANA

DRAWING 4A OF 5

DATE: 05-19-17

As-Built drawings will be submitted within 10 days of completion of this project to the Louisiana Department of Natural Resources, Office of Conservation, Pipeline Division, P.O. Box 94275, Baton Rouge, LA 70804, and to the Louisiana Department of Natural Resources, Coastal Management Division, P.O. Box 44487, Baton Rouge, LA 70804-4487.

All structures, facilities, well and pipe lines / flowlines occurring in open water areas or in oilfield canal. or slips shall be removed within 120 days of abandonment or the facilities for the herein permitted use unless prior written approval to leave such structures in place is received from the Coastal Management Division. This condition does not preclude the necessity for revising the current permit or obtaining a separate Coastal Use Permit, should one be required.

Structures must also be marked / lighted in accordance with U.S. Coast Guard regulations.

In order to ensure the safety of all parties, the permitted shall contact the Louisiana One Call System (1-800-272-3020) a minimum of 48 hours prior to the commencement of any excavation (digging, dredging, jetting, etc.) or demolition activity.

The pallid sturgeon (*Scaphirhynchus albus*) may occur in water bodies near this proposed project. The pallid sturgeon is listed as endangered under the Endangered Species Act (16 U.S.C. 1531-1544) and occur in the Mississippi and Atchafalaya rivers in southern Louisiana, and the Red River. This species requires large, turbid, free-flowing riverine habitat and is adapted to living close to the bottom of large rivers with sand and gravel bars. Pallid sturgeon typically spawn from May-August, but successful reproduction has been severely reduced due to habitat modification. This includes the loss of habitat through the construction of dams that have modified flows, reduced turbidity and lowered water temperatures. It is advised that one takes the necessary measures to avoid the breeding season and any degradation of water quality in the Mississippi and Atchafalaya rivers. Contact Beau Gregory at 337-491-2576 regarding questions.

The Louisiana Natural Heritage Program (LNHP) reports summarize the existing information known at the time of the permitting request regarding the location in question. LNHP reports should not be considered final statements on the biological elements or areas being considered, nor should they be substituted for on-site surveys required for environmental assessments. If at any time LNHP tracked species are encountered within the project area, contact a LDWF biologist at 225-765-2643.

The long-tailed weasel is considered rare in La. The species is found in habitats usually near water. Habitats include brush land, open woodlands, field edges, riparian grassland, swamps & marshes. Dens are in abandoned burrows of other mammals, rock crevices, brush piles, stump hollows or spaces among tree roots. Research indicates that the weasel may be sensitive to agriculturally induced fragmentation of habitat, showing the importance of maintaining landscape connectivity for the conservation of this species.

The area where the project is located is all part of the aboriginal homelands of the Chitimacha Tribe of Louisiana. As such, large villages, burial sites, and sacred sites were in place in that entire area. If at any time during the course of the work, any traditional cultural properties are discovered, Permittee shall immediately contact Kimberly S. Walden (Cultural Director) or Melanie Aymond (Research Coordinator) at (337) 923-9923 or (337) 923-4395. Office hours are Monday through Thursday from 7:30 A.M. - 5:00 P.M. and on Friday between 7:30 A.M. - 11:30 A.M. If traditional cultural properties are discovered on the weekend or after business hours, the notification shall be made the next business morning. This information is being requested pursuant to LAC, Title 43, Part I, Chapter 7, §701.

Dredging operations may not commence if there is another dredge operating in the area. Additionally, any dredging operations must be suspended if another dredge begins dredging in the area. All dredging operations shall be for short periods of time to deposit material on the bank.

**WOODLAND SOUTH SAND PIT
DREDGE AND STOCKPILE
FACILITIES PERMIT RENEWAL**

WOODLAND BORROW PITS, LLC

DRAWING 5 OF 5

05-11-17