



DEPARTMENT OF THE ARMY  
U.S. ARMY CORPS OF ENGINEERS, NEW ORLEANS DISTRICT  
7400 LEAKE AVE  
NEW ORLEANS, LA 70118-3651

February 12, 2024

Regulatory Division

Eastern Evaluation Branch

Project Manager:  
Scott Kennedy  
(504) 862-2259  
[Scott.N.Kennedy@usace.army.mil](mailto:Scott.N.Kennedy@usace.army.mil)

Application #: MVN 2023-00931 EMM

## **PUBLIC NOTICE**

Interested parties are hereby notified that a permit application has been received by the New Orleans District of the U.S. Army Corps of Engineers pursuant to: ☒ Section 10 of the Rivers and Harbors Act of March 3, 1899 (30 Stat. 1151; 33 USC 403); and/or ☒ Section 404 of the Clean Water Act (86 Stat. 816; 33 USC 1344), and/or ☐ Section 14 of the Rivers and Harbors Act of 1899 (33 U.S.C. Section 408).

### **INSTALL AND MAINTAIN A NEW BARGE DOCK AND APPURTENANT STRUCTURES IN THE MISSISSIPPI RIVER, PLAQUEMINES PARISH**

**NAME OF APPLICANT:** Florida Marine Transporters, LLC, c/o Lanier & Associates, 4101 Magazine Street, New Orleans, Louisiana 70115.

**LOCATION OF WORK:** Mississippi River, left descending bank, Mile Marker 44.4. Section 15, Township 15 South, Range 17 East, in Bohemia, Louisiana, in Plaquemines Parish, as shown on the attached drawings.

Hydrologic Unit Code: 08090100: Lower Mississippi – New Orleans  
Latitude: 29.533859 Longitude: -89.740499

**CHARACTER OF WORK:** The proposed project is to construct a new barge dock. The proposed work will be accomplished by installing and maintaining new barge monopiles, a fixed barge dock platform, an elevated approachway and piperack, and pipe supports to transfer product to an existing facility. The installation requires crossing the levee and Highway 15. The site is approximately 12.27 acres. Impacts include approximately 9.23 acres of jurisdictional wetlands and 1.83 acres of Other Waters of the U.S. Approximately 3.88 acres of impacted jurisdictional wetlands would be a habitat conversion (forested to an emergent wetland for the piperack right-of-way) and approximately 5.35 acres of jurisdictional wetlands would be temporarily impacted during construction of the proposed structure.

**MITIGATION:** The applicant states that the proposed project has been designed to avoid and minimize direct and secondary adverse impacts to the maximum extent practicable. The applicant has proposed to compensate for any unavoidable impacts to jurisdictional wetlands by utilizing a Corps approved mitigation bank within the watershed.

The comment period for the Department of the Army Permit will close **30 days** from the date of this public notice. Written comments, including suggestions for modifications or objections to the proposed work, stating reasons thereof, are being solicited from anyone having interest in this permit request, and must be submitted so as to be received before or by the last day of the comment period. Letters and/or comments concerning the subject permit application must reference the Applicant's Name and the Permit Application Number, and can preferably emailed to the Corps of Engineers project manager listed above or forwarded to the Corps of Engineers at the address above, **ATTENTION: REGULATORY DIVISION, RGE, Mr. Scott Kennedy**. This public notice is also available for review online at <https://go.usa.gov/xennJ>.

### **Corps of Engineers Permit Criteria**

The decision whether to issue a permit will be based on an evaluation of the probable impacts, including cumulative impacts of the proposed activity on the public interest. That decision will reflect the national concern for both protection and utilization of important resources. The benefit which reasonably may be expected to accrue from the proposal must be balanced against its reasonably foreseeable detriments. All factors which may be relevant to the proposal will be considered including the cumulative effects thereof; among those are conservation, economics, aesthetics, general environmental concerns, wetlands, historic properties, fish and wildlife values, flood hazards, floodplain values, land use, navigation, shoreline erosion and accretion, recreation, water supply and conservation, water quality, energy needs, safety, food and fiber production, mineral needs, considerations of property ownership and, in general, the needs and welfare of the people.

The U.S. Army Corps of Engineers is soliciting comments from the public, federal, state, and local agencies and officials, Indian Tribes, and other interested parties in order to consider and evaluate the impacts of this proposed activity. Any comments received will be considered by the U.S. Army Corps of Engineers to determine whether to make, modify, condition, or deny a permit for this proposal. To make this decision, comments are used to assess impacts on endangered species, historic properties, water quality, general environmental effects, and other public interest factors listed above. Comments are used in the preparation of an Environmental Assessment and/or an Environmental Impact Statement pursuant to the National Environmental Policy Act. Comments are also used to determine the need for a public hearing and to determine the overall public interest of the proposed activity. Further, all factors that may be relevant to the proposal will be considered, including the potential cumulative effects associated with the proposed project.

The New Orleans District is unaware of properties listed on the National Register of Historic Places near the proposed work. The possibility exists that the proposed work may damage or destroy presently unknown archeological, scientific, prehistorical, historical sites, or data. Issuance of this public notice solicits input from the State Archeologist and State Historic Preservation Officer regarding potential impacts to cultural resources.

The New Orleans District has determined that the project footprint is located in waters known to be utilized by the Pallid Sturgeon (*Scaphirhynchus albus*) and the West Indian Manatee (*Trichechus manatus*) and determined that the proposed activities are Not Likely to Adversely Affect the species based on the Information & Planning Consultation for Endangered Species in Louisiana (IPaC), dated January 27, 2020 between the U.S. Army Corps of Engineers, New Orleans and U.S. Fish and Wildlife Service, Ecological Services Office.

Our initial finding is that the proposed work is Not Likely to Adversely Affect any species listed as endangered by the U.S. Departments of Commerce, nor affect any habitat designated as critical to the survival and recovery of such species.

This notice initiates the Essential Fish Habitat (EFH) consultation requirements of the Magnuson-Stevens Fishery Conservation and Management Act. The applicant's proposal is not expected to result in the destruction, alteration, and/or disturbance of **0.0 acres** of EFH utilized by various life stages of red drum and penaeid shrimp. Our initial determination is that the proposed action would have no adverse impact on EFH or federally managed fisheries in the Gulf of Mexico. Our final determination relative to project impacts and the need for mitigation measures is subject to review by and coordination with the National Marine Fisheries Service.

If the proposed work involves deposits of dredged or fill material into navigable waters, the evaluation of the probable impacts will include the application of guidelines established by the Administrator of the Environmental Protection Agency. Also, a certification that the proposed activity will not violate applicable water quality standards will be required from the Department of Environmental Quality, Water Quality Certifications, before a permit is issued.

Any person may request, in writing, within the comment period specified in this notice, that a public hearing be held to consider this application. Requests for public hearings shall state, with particularity, the reasons for holding a public hearing.

The applicant has certified that the proposed activity described in the application complies with and will be conducted in a manner that is consistent with the Louisiana Coastal Resources Program (Louisiana Coastal Zone Application P20230700). The Department of the Army permit will not be issued unless the applicant received approval or a waiver of the Coastal Use Permit by the Department of Natural Resources.

You are invited to communicate the information contained in this notice to any other parties whom you deem likely to have interest in the matter.

Brad P. LaBorde  
Chief, Eastern Evaluation Branch  
Regulatory Division

Enclosure

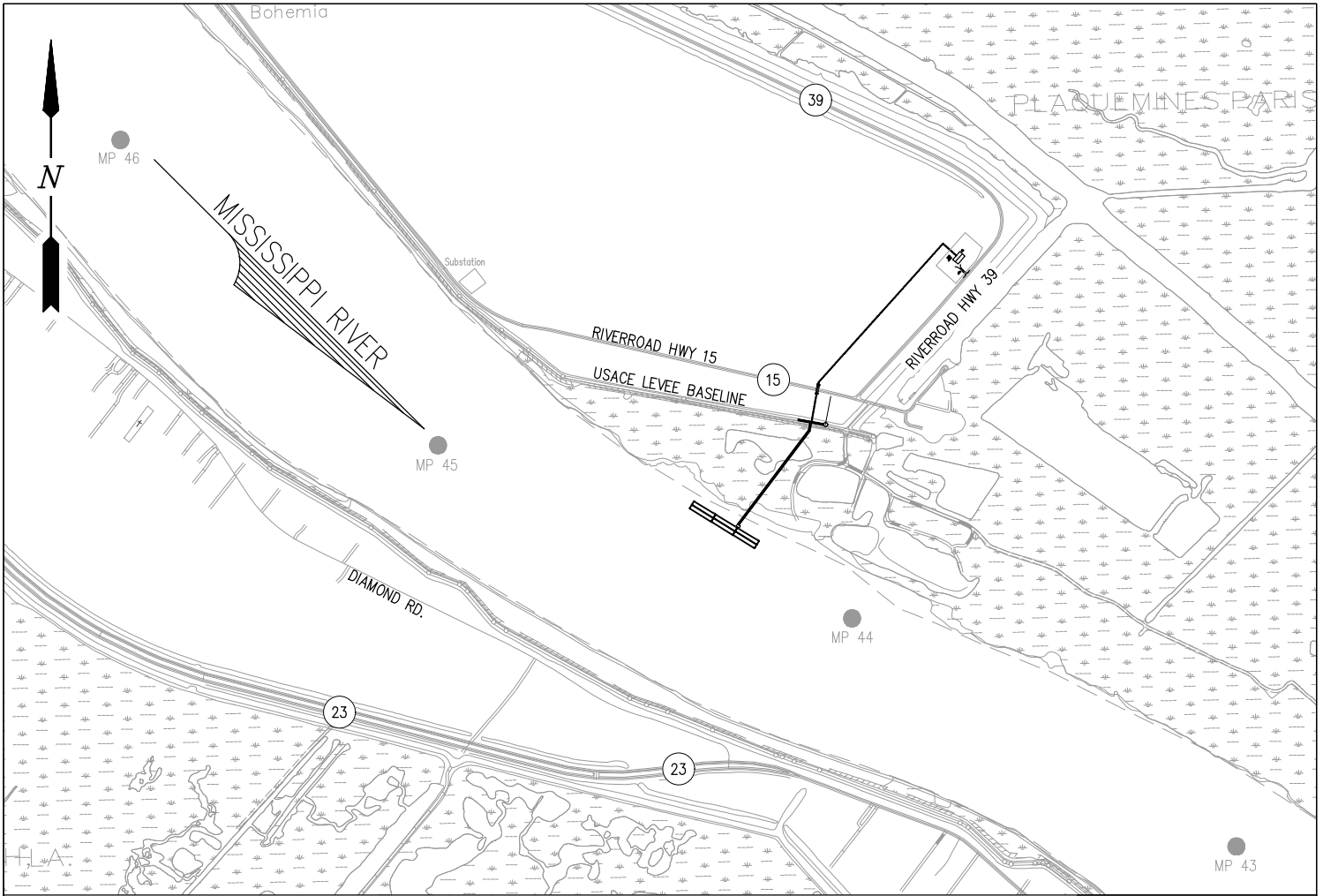

### VICINITY MAP

SCALE: 1" = 2000'

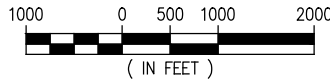

PLAQUEMINES PARISH  
LAT: 29° 31' 58" N  
LONG: 89° 44' 28" W

### NOTES:

1. AS-BUILT DRAWINGS AND/OR PLATS SHALL HAVE WRITTEN ON THEM THE DATE OF COMPLETION OF SAID ACTIVITIES AND SHALL BE SUBMITTED TO THE LOUISIANA DEPARTMENT OF NATURAL RESOURCES, OFFICE OF COASTAL MANAGEMENT, P. O. BOX 44487, BATON ROUGE, LA 70804-4487 WITHIN 30 DAYS FOLLOWING PROJECT COMPLETION.
2. ALL STRUCTURES BUILT UNDER THE AUTHORIZATION AND CONDITIONS OF THIS PERMIT SHALL BE REMOVED FROM THE SITE WITHIN 120 DAYS OF ABANDONMENT OF THE FACILITIES FOR THE HEREIN PERMITTED USE, OR WHEN THESE STRUCTURES FALL INTO A STATE OF DISREPAIR SUCH THAT THEY CAN NO LONGER FUNCTION AS INTENDED. THIS CONDITION DOES NOT PRECLUDE THE NECESSITY FOR REVISING THE CURRENT PERMIT OR OBTAINING A SEPARATE COASTAL USE PERMIT, SHOULD ONE BE REQUIRED, FOR SUCH REMOVAL ACTIVITIES.
3. STRUCTURES MUST ALSO BE MARKED/LIGHTED IN ACCORDANCE WITH U. S. COAST GUARD REGULATIONS.
4. IN ORDER TO ENSURE THE SAFETY OF ALL PARTIES, THE PERMITTEE SHALL CONTACT THE LOUISIANA ONE CALL SYSTEM (1-800-272-3020) A MINIMUM OF 48 HOURS PRIOR TO THE COMMENCEMENT OF ANY EXCAVATION (DIGGING, DREDGING, JETTING, ETC.) OR DEMOLITION ACTIVITY.
5. LOUISIANA NATURAL HERITAGE PROGRAM: NO IMPACTS TO RARE, THREATENED OR ENDANGERED SPECIES OR CRITICAL HABITATS ARE ANTICIPATED FROM THE PROPOSED PROJECT. NO STATE OR FEDERAL PARKS, WILDLIFE REFUGES, WILDLIFE MANAGEMENT AREAS OR SCENIC RIVERS ARE KNOWN AT THE SPECIFIED SITE OR WITHIN ¼ MILE OF THE PROPOSED PROJECT. THE LOUISIANA NATURAL HERITAGE PROGRAM (LNHP) REPORTS SUMMARIZE THE EXISTING INFORMATION KNOWN AT THE TIME OF THE REQUEST REGARDING THE LOCATION IN QUESTION. LNHP REPORTS SHOULD NOT BE CONSIDERED FINAL STATEMENTS ON THE BIOLOGICAL ELEMENTS OR AREAS BEING CONSIDERED, NOR SHOULD THEY BE SUBSTITUTED FOR ON-SITE SURVEYS REQUIRED FOR ENVIRONMENTAL ASSESSMENTS. IF AT ANY TIME LNHP TRACKED SPECIES ARE ENCOUNTERED WITHIN THE PROJECT AREA, PLEASE CONTACT OUR BIOLOGIST AT 225-765-2643.

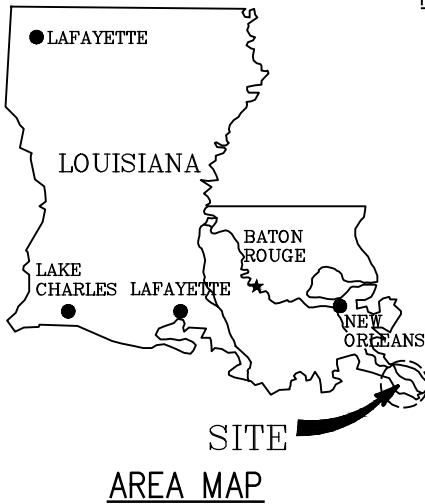

### AREA MAP

JAMES C. POTTER P.E.  
LA PE #29668

PRELIMINARY - FOR PERMITTING PURPOSES ONLY, NOT FOR CONSTRUCTION

REV  
A

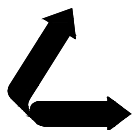

**LANIER & ASSOCIATES**  
**CONSULTING ENGINEERS**  
INCORPORATED

LA: EF-1120 TX: F-2981  
NEW ORLEANS • BEAUMONT • CORPUS CHRISTI • HOUSTON

FLORIDA MARINE TRANSPORTERS  
BOHEMIA LOUISIANA

**PROPOSED NEW BARGE DOCK FACILITY**  
**VICINITY MAP, AREA MAP & NOTES**

DATE JUNE '23  
DESIGN JDM  
DRAWN MEW  
CHECK JCP  
JOB NO 12585  
SHEET No.  
**1 OF 14**



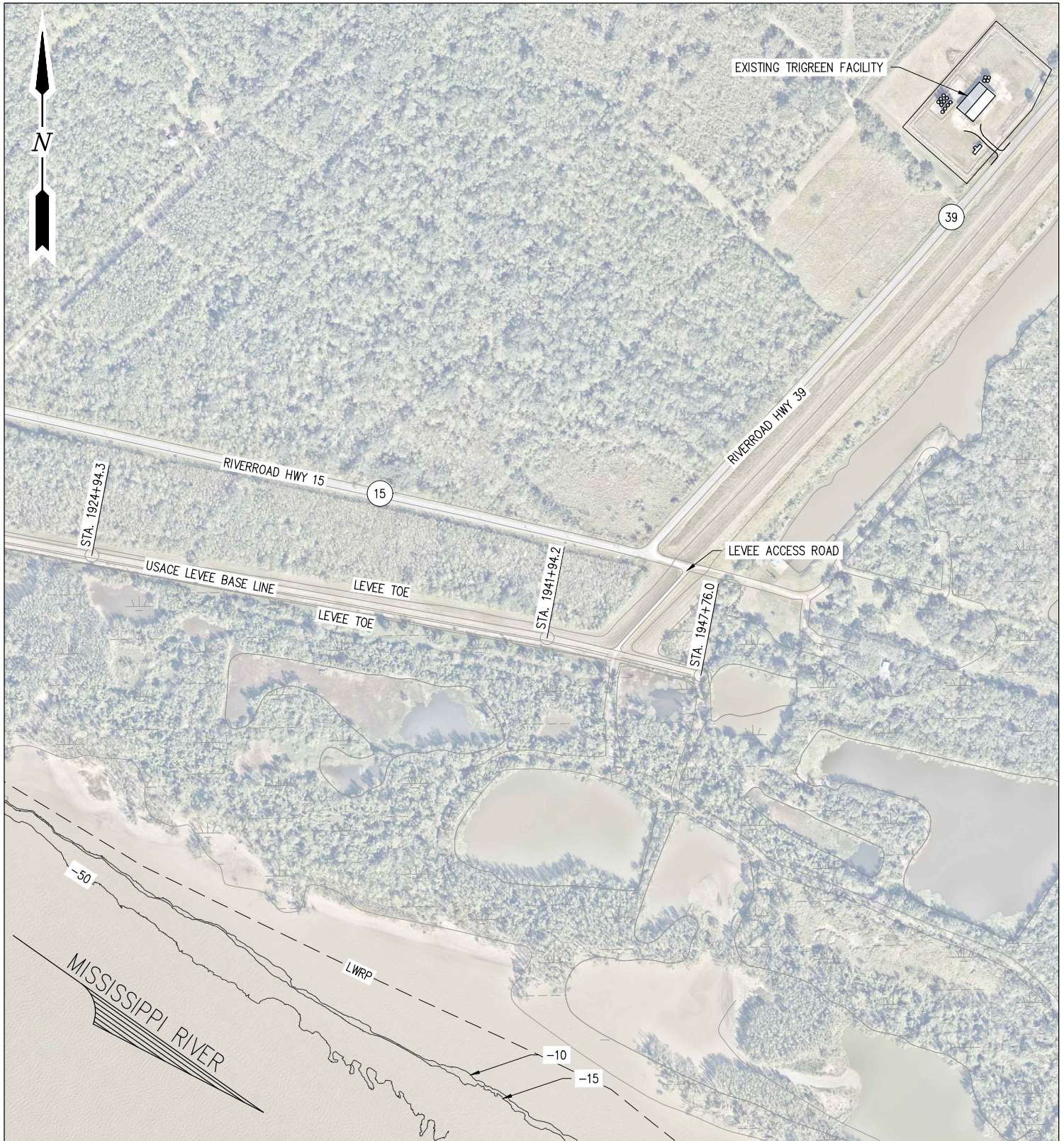

**EXISTING SITE PLAN**

SCALE: 1" = 500

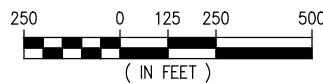

JAMES C. POTTER P.E.  
LA PE #29668

**PRELIMINARY - FOR PERMITTING PURPOSES ONLY, NOT FOR CONSTRUCTION**

REV  
A



**LANIER & ASSOCIATES  
CONSULTING ENGINEERS  
INCORPORATED**

LA: EF-1120 TX: F-2981  
NEW ORLEANS • BEAUMONT • CORPUS CHRISTI • HOUSTON

FLORIDA MARINE TRANSPORTERS  
BOHEMIA LOUISIANA

**PROPOSED NEW BARGE DOCK FACILITY  
EXISTING SITE PLAN**

DATE JUNE '23  
DESIGN JDM  
DRAWN MEW  
CHECK JCP  
JOB NO 12585  
SHEET No.  
**2 OF 14**



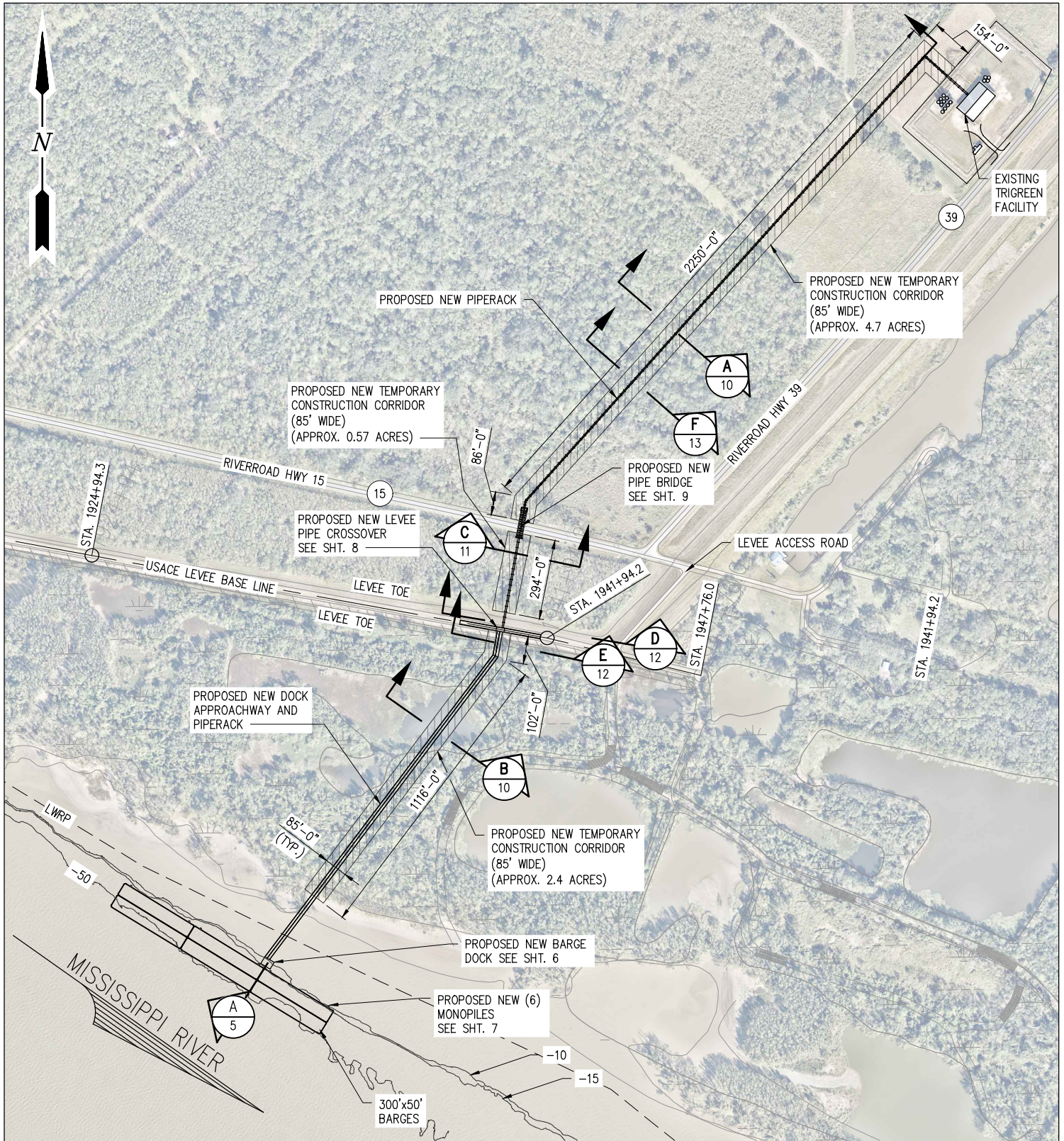

**PROPOSED NEW SITE PLAN**

SCALE: 1" = 500'

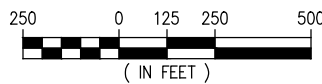

JAMES C. POTTER P.E.  
LA PE #29668

**PRELIMINARY - FOR PERMITTING PURPOSES ONLY, NOT FOR CONSTRUCTION**

REV  
B



**LANIER & ASSOCIATES  
CONSULTING ENGINEERS  
INCORPORATED**

LA: EF-1120 TX: F-2981  
NEW ORLEANS • BEAUMONT • CORPUS CHRISTI • HOUSTON

FLORIDA MARINE TRANSPORTERS  
BOHEMIA LOUISIANA

**PROPOSED NEW BARGE DOCK FACILITY  
PROPOSED NEW SITE PLAN**

DATE JUNE '23  
DESIGN JDM  
DRAWN MEW  
CHECK JCP  
JOB NO 12585  
SHEET No.  
**3 OF 14**



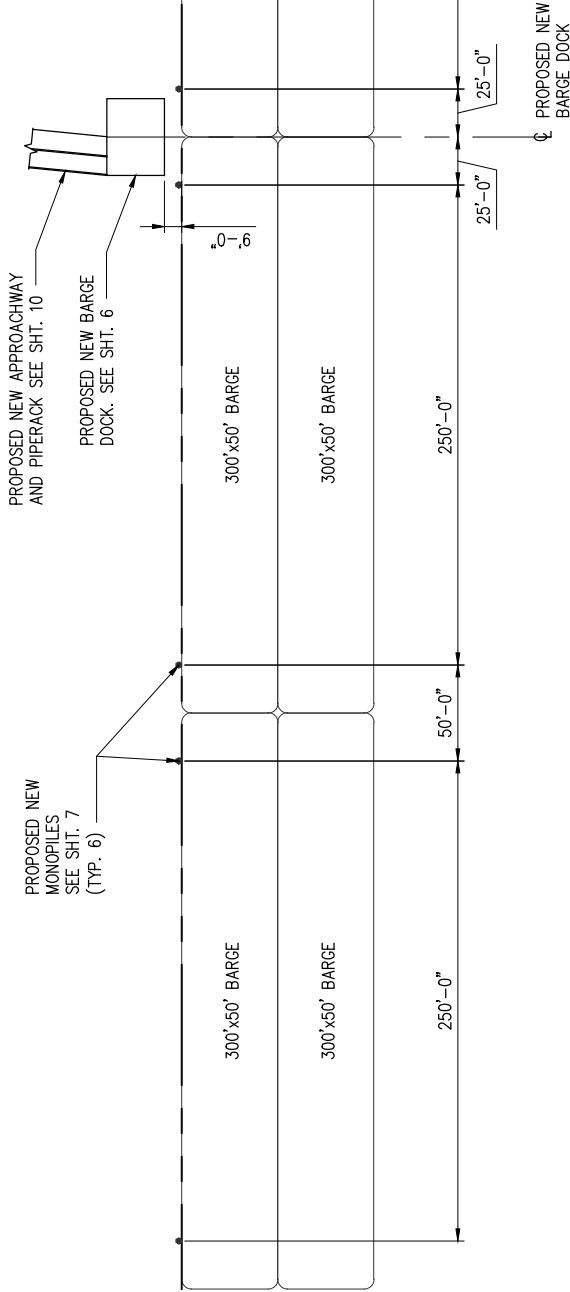
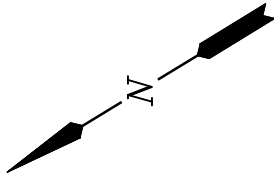

MISSISSIPPI RIVER

**PROPOSED NEW BARGE DOCK ENLARGED PLAN**

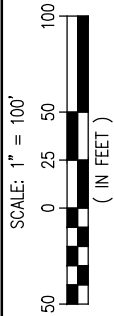

JAMES C. POTTER P.E.  
LA PE #29668

PRELIMINARY - FOR PERMITTING PURPOSES ONLY, NOT FOR CONSTRUCTION

REV  
A



**LANIER & ASSOCIATES**  
**CONSULTING ENGINEERS**  
INCORPORATED

LA: EF-1120 TX: F-2981  
NEW ORLEANS • BEAUMONT • CORPUS CHRISTI • HOUSTON

FLORIDA MARINE TRANSPORTERS  
BOHEMIA LOUISIANA

**PROPOSED NEW BARGE DOCK FACILITY**  
**PROPOSED NEW BARGE**  
**ENLARGED DOCK PLAN**

DATE JUNE '23  
DESIGN JDM  
DRAWN MEW  
CHECK JCP  
JOB NO 12585  
SHEET No.  
**4 OF 14**



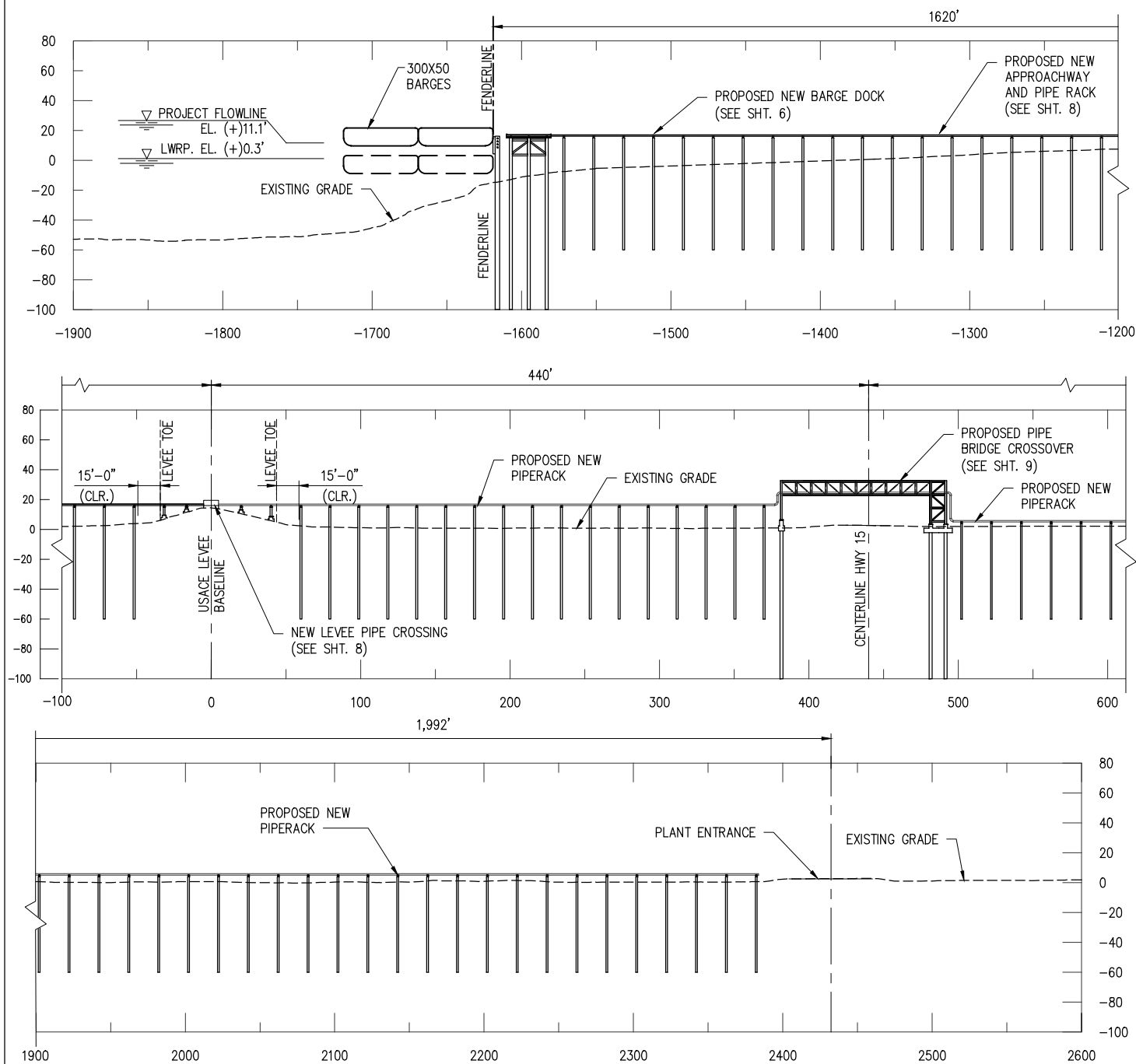

### PROFILE SECTION

SCALE: 1" = 100'

A  
3

### NOTES:

- HYDROGRAPHIC SURVEY PERFORMED BY LANIER & ASSOCIATES ON JUNE 30, 2023.
- HYDROGRAPHIC SURVEY WAS PERFORMED UTILIZING ELECTRONIC POSITIONING AND DEPTH EQUIPMENT.
- TOPOGRAPHIC / LIDAR SURVEY WAS PERFORMED BY LANIER AND ASSOCIATES ON JUNE 27, 2023.
- DATUM FOR THE WATER SURFACE AT THE TIME OF THE SURVEY IS RELATIVE TO THE INTERPOLATED ELEVATIONS FROM
- U.S.A.C.E. RIVER GAUGE LOCATED AT WEST POINT A LA HACHE MP 48.7
- U.S.A.C.E. RIVER GAUGE LOCATED AT EMPIRE - M.P. 29.5.
- HORIZONTAL DATUM REFERENCE TO NAD 83 ZONE 1702 LOUISIANA SOUTH, FEET.
- ALL ELEVATIONS ARE EXPRESSED IN FEET AND TENTHS AND REFERENCED TO NAVD 88.
- THE AREA SHOWN ON THIS DRAWING IS SUBJECT TO SILTING. THE ACTUAL ELEVATIONS FOLLOWING THE DATE OF THE SURVEY MAY DIFFER FROM THE ELEVATIONS SHOWN.

JAMES C. POTTER P.E.  
LA PE #29668

PRELIMINARY - FOR PERMITTING PURPOSES ONLY, NOT FOR CONSTRUCTION

REV  
A



**LANIER & ASSOCIATES**  
**CONSULTING ENGINEERS**  
INCORPORATED

LA: EF-1120 TX: F-2981  
NEW ORLEANS • BEAUMONT • CORPUS CHRISTI • HOUSTON

FLORIDA MARINE TRANSPORTERS  
BOHEMIA LOUISIANA

**PROPOSED NEW BARGE DOCK FACILITY**  
**PROPOSED PROFILE SECTION**

DATE JUNE '23  
DESIGN JDM  
DRAWN MEW  
CHECK JCP  
JOB NO 12585  
SHEET No.  
**5 OF 14**

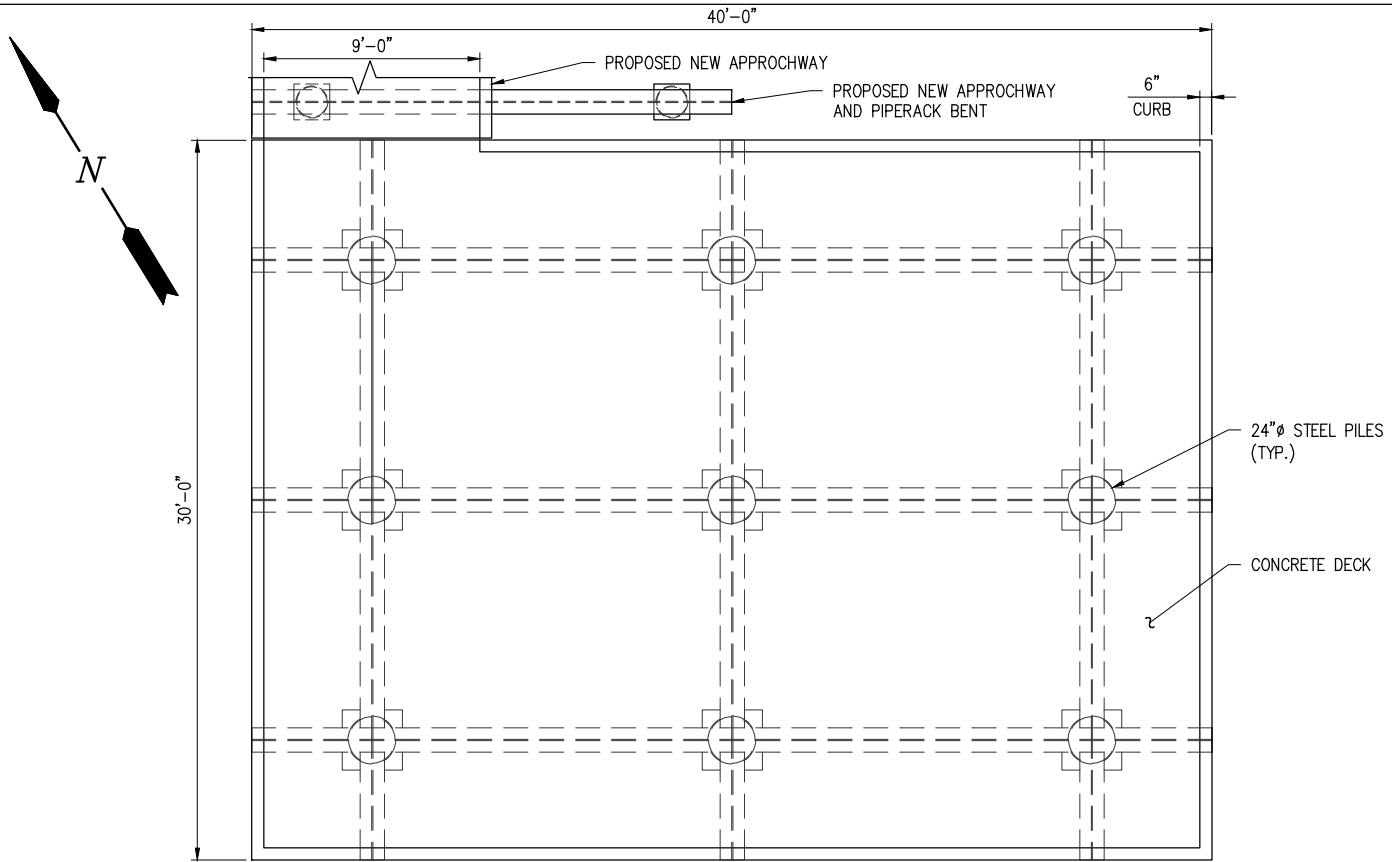

### PROPOSED NEW BARGE DOCK PLAN

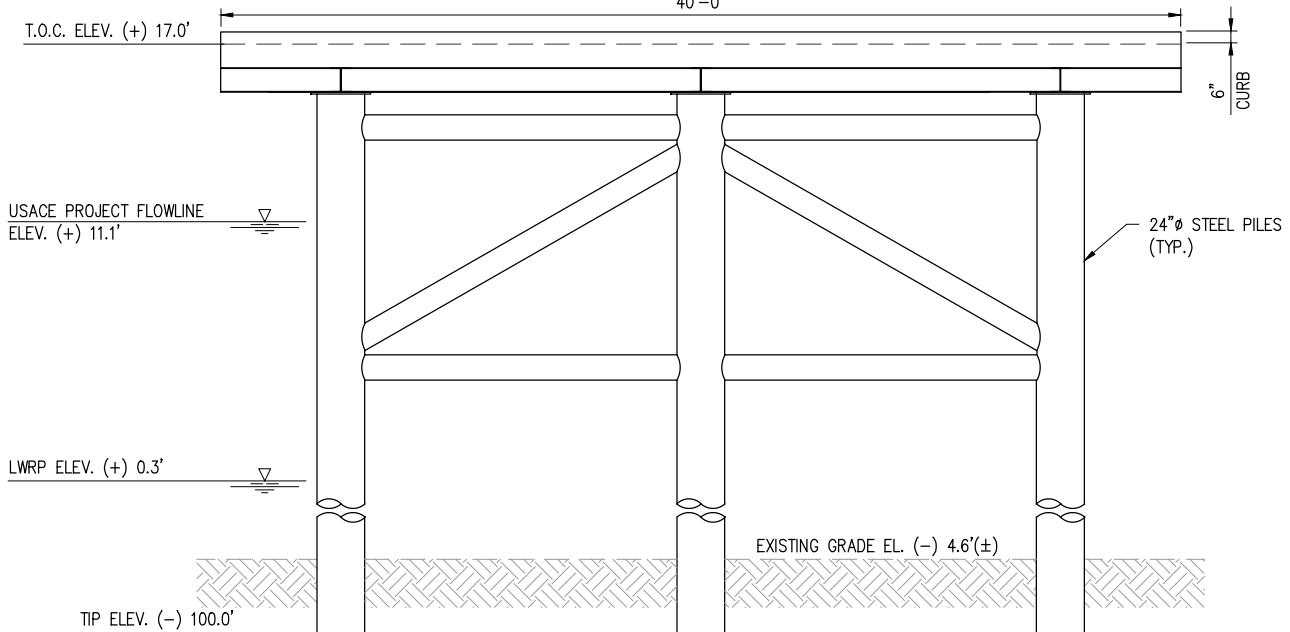
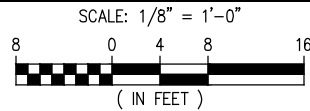

### PROPOSED NEW BARGE DOCK ELEVATION

SCALE: 1/8" = 1'-0"

JAMES C. POTTER P.E.  
LA PE #29668

PRELIMINARY - FOR PERMITTING PURPOSES ONLY, NOT FOR CONSTRUCTION

REV  
A



**LANIER & ASSOCIATES**  
**CONSULTING ENGINEERS**  
INCORPORATED

LA: EF-1120 TX: F-2981  
NEW ORLEANS • BEAUMONT • CORPUS CHRISTI • HOUSTON

FLORIDA MARINE TRANSPORTERS  
BOHEMIA LOUISIANA

**PROPOSED NEW BARGE DOCK FACILITY**  
**PROPOSED NEW BARGE DOCK PLAN**  
**AND ELEVATION**

DATE JUNE '23  
DESIGN JDM  
DRAWN MEW  
CHECK JCP  
JOB NO 12585  
SHEET No.  
**6 OF 14**

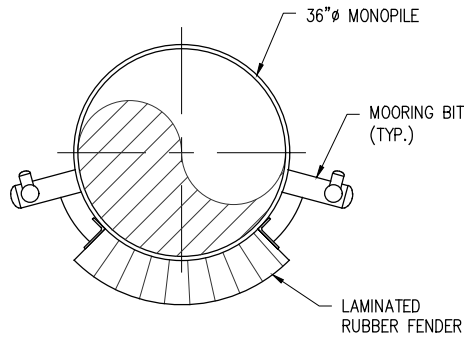
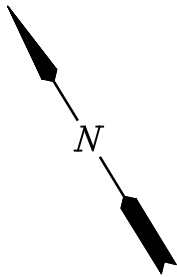

## PROPOSED NEW MONOPILE PLAN

SCALE:  $\frac{3}{8}" = 1'-0"$

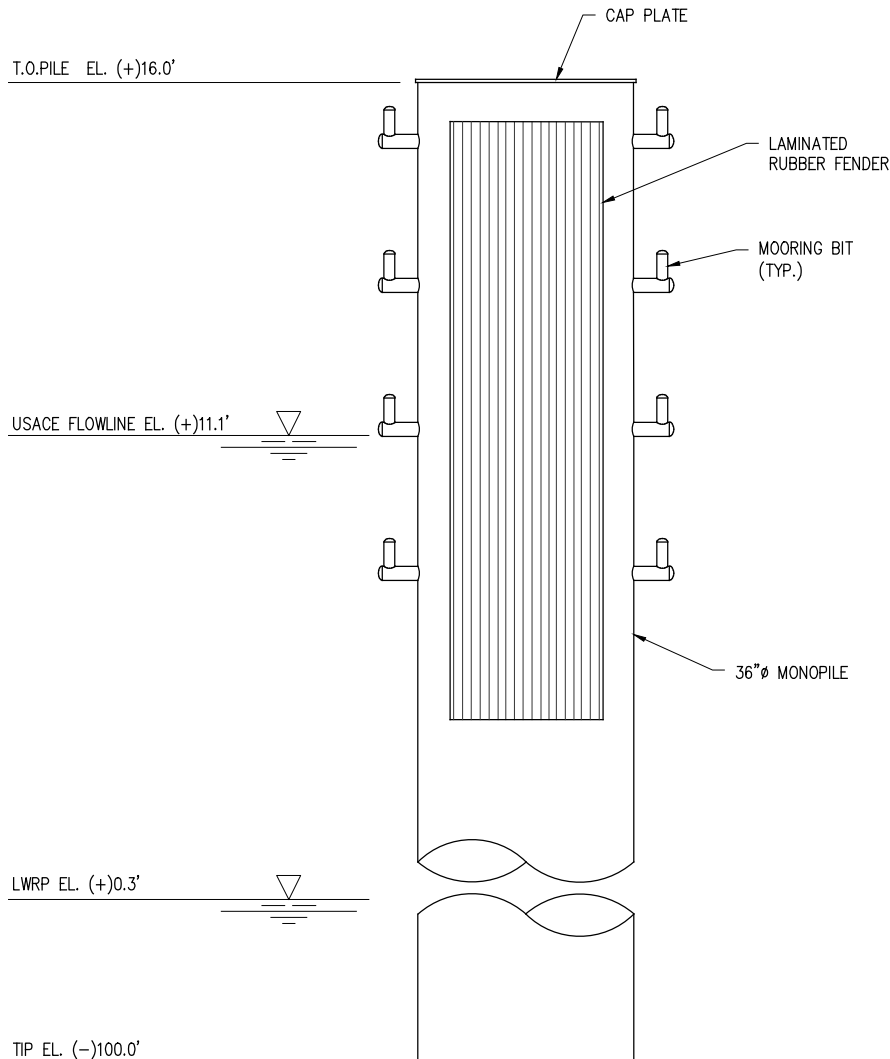

## PROPOSED NEW MONOPILE ELEVATION

SCALE:  $\frac{3}{8}" = 1'-0"$   
(6 REQUIRED)

JAMES C. POTTER P.E.  
LA PE #29668

PRELIMINARY - FOR PERMITTING PURPOSES ONLY, NOT FOR CONSTRUCTION

REV  
A



**LANIER & ASSOCIATES**  
**CONSULTING ENGINEERS**  
INCORPORATED

LA: EF-1120 TX: F-2981  
NEW ORLEANS • BEAUMONT • CORPUS CHRISTI • HOUSTON

FLORIDA MARINE TRANSPORTERS  
BOHEMIA LOUISIANA

PROPOSED NEW BARGE DOCK FACILITY  
PROPOSED NEW MONOPILES

DATE JUNE '23  
DESIGN JDM  
DRAWN MEW  
CHECK JCP  
JOB NO 12585  
SHEET No.

7 OF 14



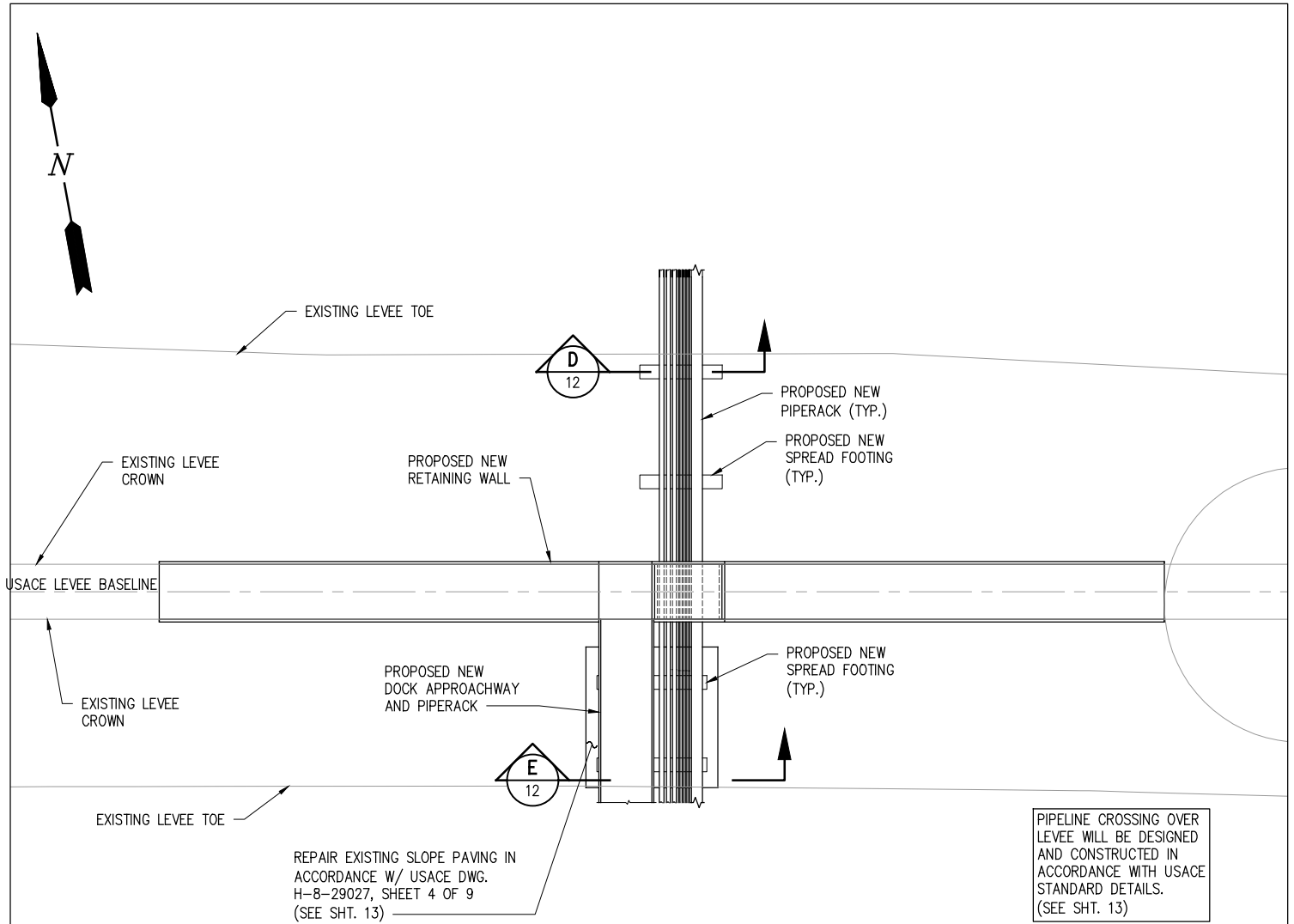

## PROPOSED NEW LEVEE PIPE CROSSING – PLAN

SCALE: 1" = 30'

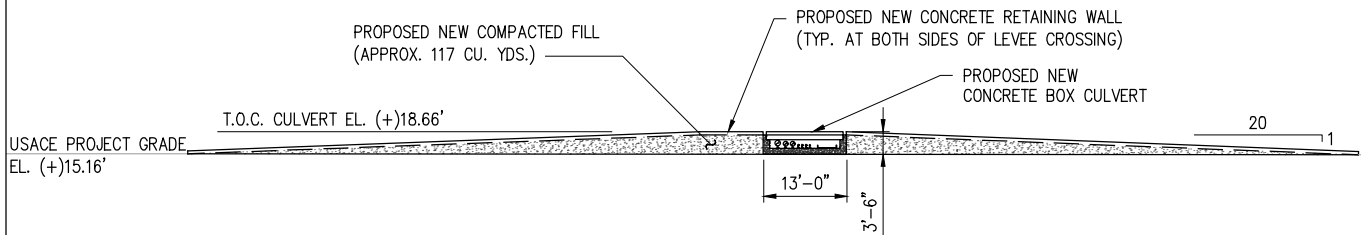

## PROPOSED NEW LEVEE PIPE CROSSING – ELEVATION

SCALE: 1" = 30'

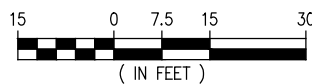

JAMES C. POTTER P.E.  
LA PE #29668

PRELIMINARY - FOR PERMITTING PURPOSES ONLY, NOT FOR CONSTRUCTION

REV  
B



**LANIER & ASSOCIATES**  
**CONSULTING ENGINEERS**  
INCORPORATED

LA: EF-1120 TX: F-2981  
NEW ORLEANS • BEAUMONT • CORPUS CHRISTI • HOUSTON

FLORIDA MARINE TRANSPORTERS  
BOHEMIA LOUISIANA

PROPOSED NEW BARGE DOCK FACILITY  
PROPOSED NEW LEVEE PIPE CROSSING

DATE JUNE '23  
DESIGN JDM  
DRAWN ADG  
CHECK JCP  
JOB NO 12585  
SHEET No.  
8 OF 14

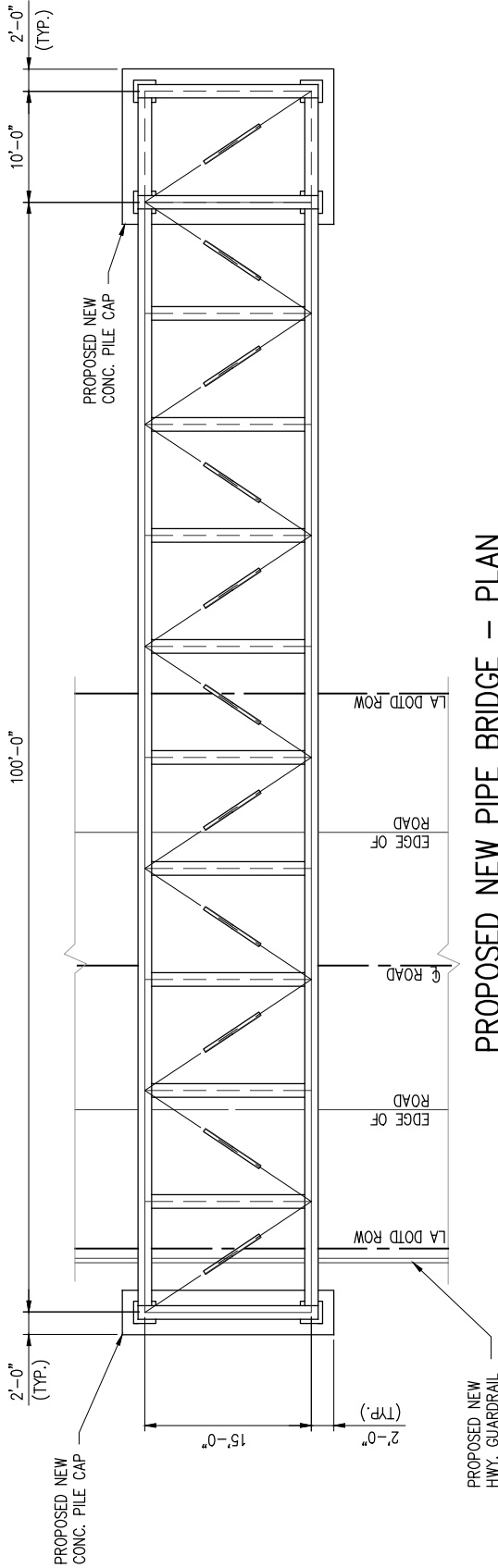
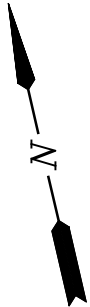

PROPOSED NEW PIPE BRIDGE - PLAN

SCALE: 1/16" = 1'-0"

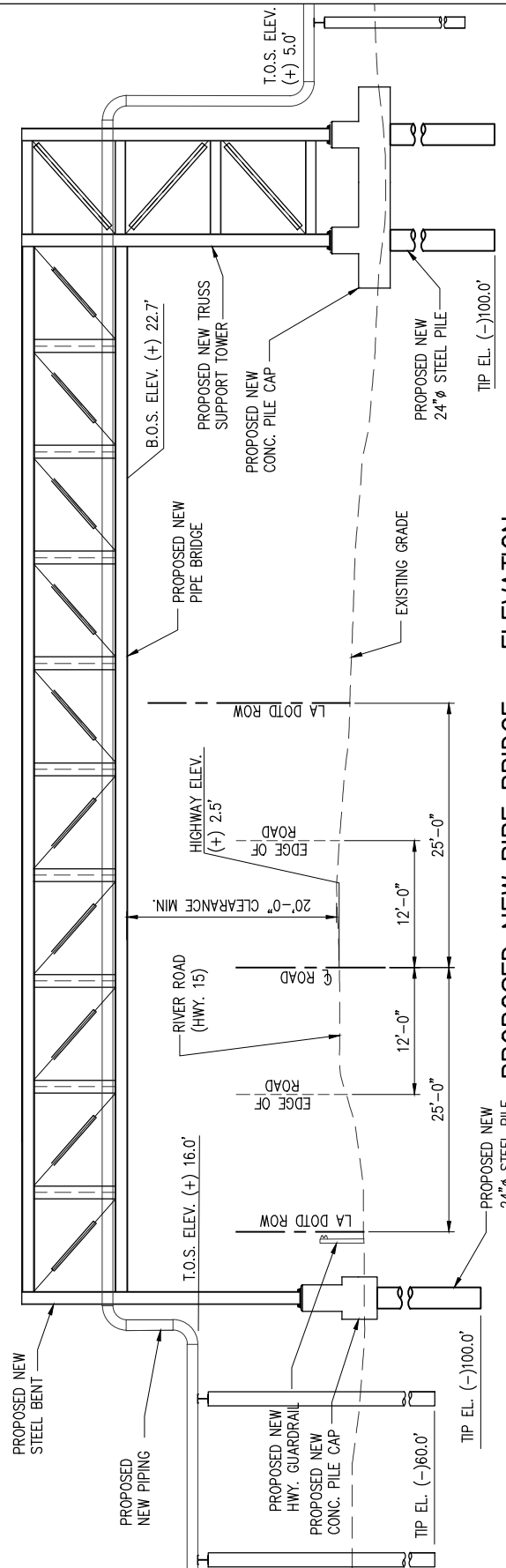

PROPOSED NEW PIPE BRIDGE - ELEVATION

SCALE: 1/16" = 1'-0"

JAMES C. POTTER P.E.  
LA PE #29668

PRELIMINARY - FOR PERMITTING PURPOSES ONLY, NOT FOR CONSTRUCTION

REV  
A

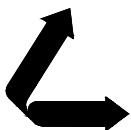

**LANIER & ASSOCIATES**  
**CONSULTING ENGINEERS**  
INCORPORATED

LA: EF-1120 TX: F-2981  
NEW ORLEANS • BEAUMONT • CORPUS CHRISTI • HOUSTON

FLORIDA MARINE TRANSPORTERS  
BOHEMIA LOUISIANA

PROPOSED NEW BARGE DOCK FACILITY  
PROPOSED NEW PIPE BRIDGE  
PLAN AND ELEVATION

DATE JUNE '23  
DESIGN JDM  
DRAWN MEW  
CHECK JCP  
JOB NO 12585  
SHEET No. 9 OF 14

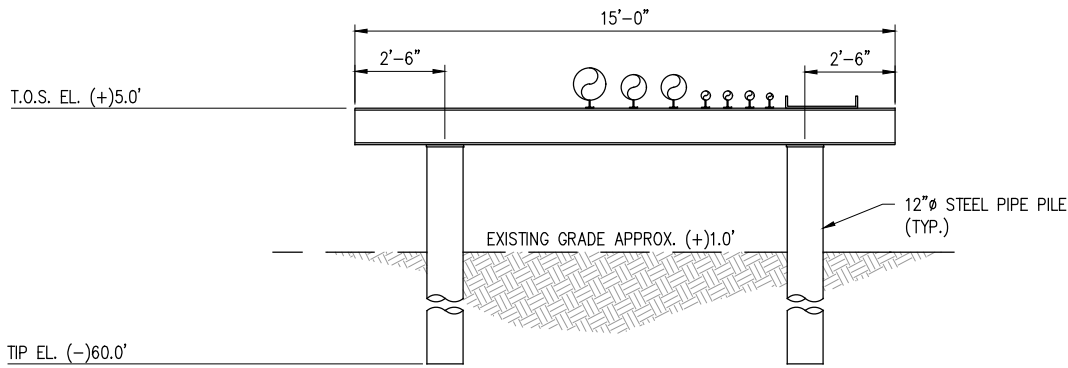

### PROPOSED TYPICAL NEW PIPERACK SECTION

SCALE: 3/16" = 1'-0"

A  
3

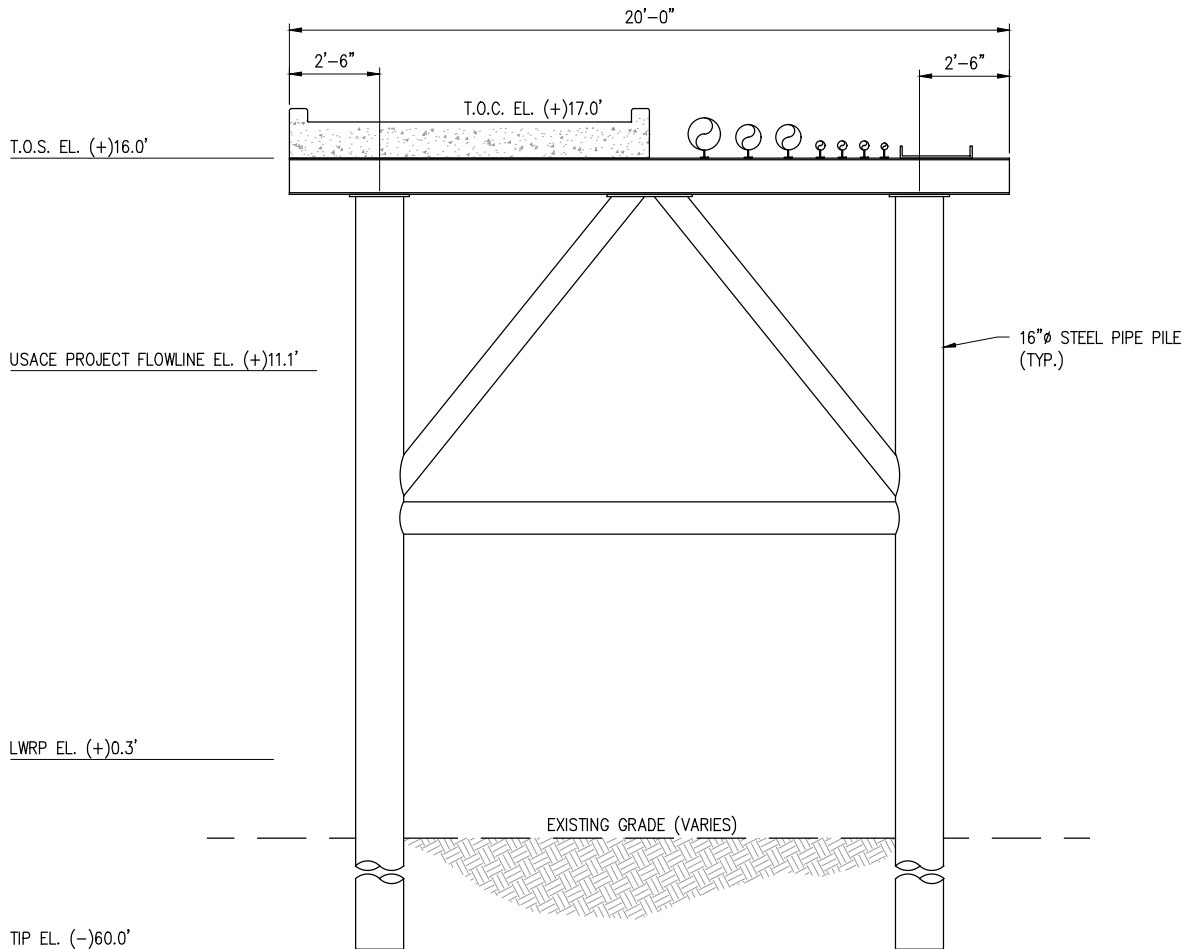

### PROPOSED TYPICAL NEW APPROACHWAY AND PIPERACK SECTION

SCALE: 3/16" = 1'-0"

B  
3

JAMES C. POTTER P.E.  
LA PE #29668

PRELIMINARY - FOR PERMITTING PURPOSES ONLY, NOT FOR CONSTRUCTION

REV  
A



**LANIER & ASSOCIATES**  
**CONSULTING ENGINEERS**  
INCORPORATED

LA: EF-1120 TX: F-2981  
NEW ORLEANS • BEAUMONT • CORPUS CHRISTI • HOUSTON

FLORIDA MARINE TRANSPORTERS  
BOHEMIA LOUISIANA

**PROPOSED NEW BARGE DOCK FACILITY**  
**PROPOSED NEW APPROACHWAY**  
**AND PIPE SUPPORT SECTIONS**

DATE JUNE '23  
DESIGN JDM  
DRAWN MEW  
CHECK JCP  
JOB NO 12585  
SHEET No.  
**10 OF 14**



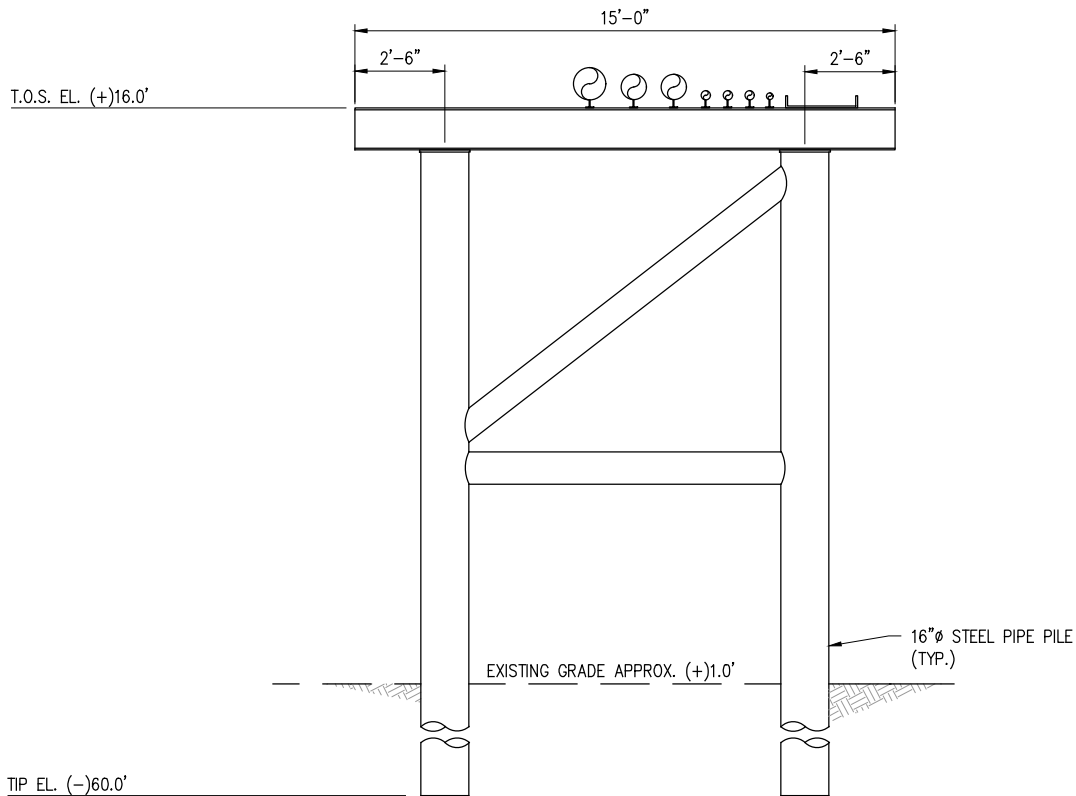

PROPOSED TYPICAL NEW LEVEE PIPE CROSSING SECTION

SCALE: 3/16" = 1'-0"

C  
3

JAMES C. POTTER P.E.  
LA PE #29668

PRELIMINARY - FOR PERMITTING PURPOSES ONLY, NOT FOR CONSTRUCTION

REV  
A



**LANIER & ASSOCIATES**  
**CONSULTING ENGINEERS**  
INCORPORATED

LA: EF-1120 TX: F-2981  
NEW ORLEANS • BEAUMONT • CORPUS CHRISTI • HOUSTON

FLORIDA MARINE TRANSPORTERS  
BOHEMIA LOUISIANA

PROPOSED NEW BARGE DOCK FACILITY  
PROPOSED NEW PIPE SUPPORT SECTIONS

DATE JUNE '23  
DESIGN JDM  
DRAWN MEW  
CHECK JCP  
JOB NO 12585  
SHEET No.  
11 OF 14

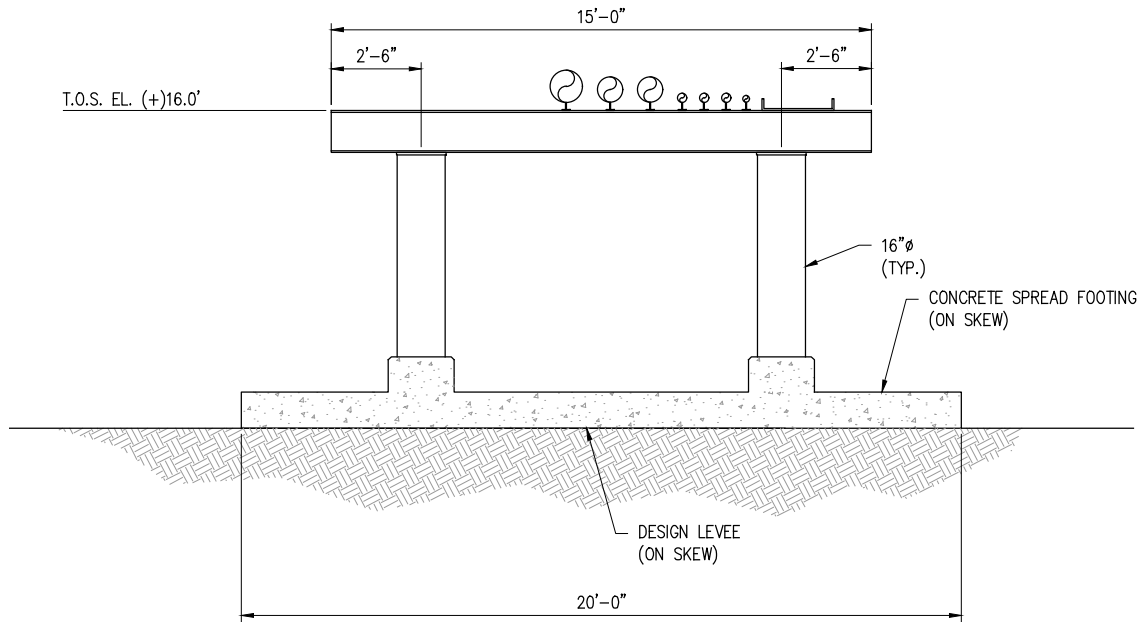

PROPOSED TYPICAL NEW LEVEE PIPE CROSSING SECTION

SCALE: 3/16" = 1'-0"

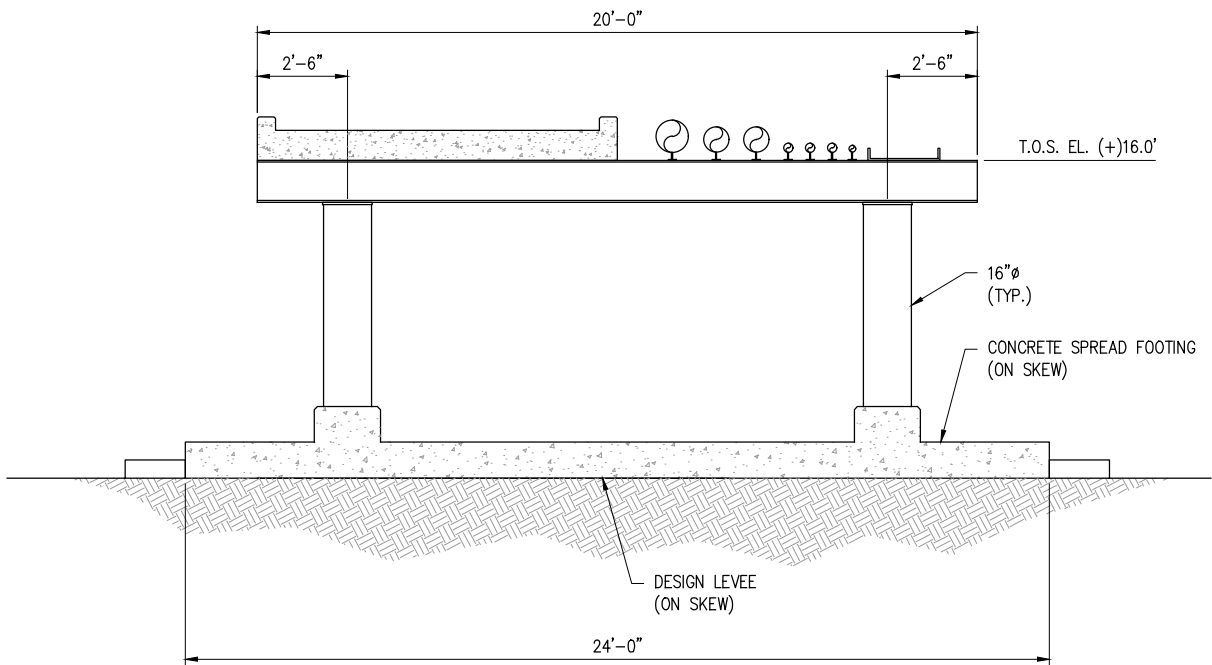
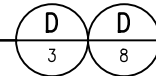

PROPOSED TYPICAL NEW LEVEE PIPE CROSSING SECTION

SCALE: 3/16" = 1'-0"

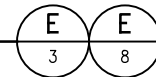

JAMES C. POTTER P.E.  
LA PE #29668

PRELIMINARY - FOR PERMITTING PURPOSES ONLY, NOT FOR CONSTRUCTION

REV  
A



**LANIER & ASSOCIATES**  
**CONSULTING ENGINEERS**  
INCORPORATED

LA: EF-1120 TX: F-2981  
NEW ORLEANS • BEAUMONT • CORPUS CHRISTI • HOUSTON

FLORIDA MARINE TRANSPORTERS  
BOHEMIA LOUISIANA

PROPOSED NEW BARGE DOCK FACILITY  
PROPOSED NEW LEVEE PIPE  
CROSSING SECTIONS

DATE JUNE '23  
DESIGN JDM  
DRAWN MEW  
CHECK JCP  
JOB NO 12585  
SHEET No.  
**12 OF 14**

NOTE:

1. EXISTING TREES AND VEGETATION TO BE REMOVED FOR CONSTRUCTION
2. EQUIPMENT TO BE USED: CHAINSAWS, BULLDOZERS AND FORESTRY MULCHER.
3. TREES AND VEGETATION REMOVED WILL BE DISPOSED OF AT A STATE-APPROVED FACILITY.

EXISTING VEGETATION  
(TO BE CUT AND REMOVED)

EXISTING GRADE

85'-0"

F  
3

PROPOSED TYPICAL CONSTRUCTION CORRIDOR SECTION

SCALE: 1" = 20'

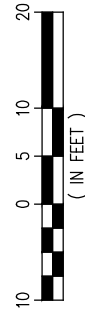

JAMES C. POTTER P.E.  
LA PE #29668

PRELIMINARY - FOR PERMITTING PURPOSES ONLY, NOT FOR CONSTRUCTION

REV  
A

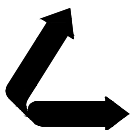

**LANIER & ASSOCIATES**  
**CONSULTING ENGINEERS**  
INCORPORATED

LA: EF-1120 TX: F-2981  
NEW ORLEANS • BEAUMONT • CORPUS CHRISTI • HOUSTON

FLORIDA MARINE TRANSPORTERS  
BOHEMIA LOUISIANA

PROPOSED NEW BARGE DOCK FACILITY  
TYPICAL CONSTRUCTION CORRIDOR SECTION

DATE JUNE '23  
DESIGN JDM  
DRAWN ADG  
CHECK JCP  
JOB NO 12585  
SHEET No.  
**13** OF **14**



JAMES C. POTTER P.E.  
LA PE #29668

PRELIMINARY - FOR PERMITTING PURPOSES ONLY, NOT FOR CONSTRUCTION

REV  
A

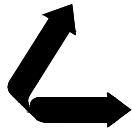

**LANIER & ASSOCIATES**  
**CONSULTING ENGINEERS**  
INCORPORATED  
LA: EF-1120 TX: F-2981  
NEW ORLEANS • BEAUMONT • CORPUS CHRISTI • HOUSTON

FLORIDA MARINE TRANSPORTERS  
BOHEMIA LOUISIANA

**PROPOSED NEW BARGE DOCK FACILITY**  
**PIPELINE CROSSINGS OVER LEVEES**  
**AND FLOODWALLS**

DATE JUNE '23  
DESIGN JDM  
DRAWN MEW  
CHECK JCP  
JOB NO 12585  
SHEET No.  
**14 OF 14**

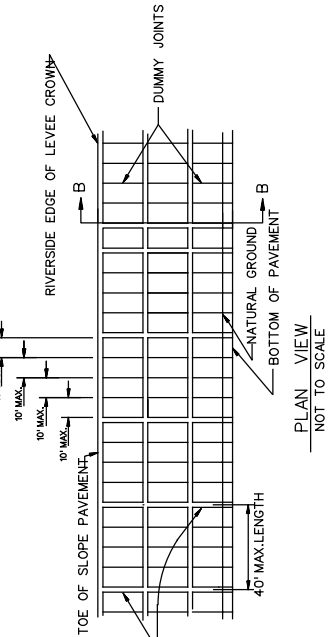

PLAN VIEW  
NOT TO SCALE

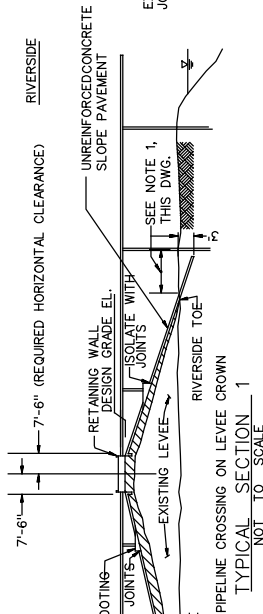

TYPICAL SECTION 1  
NOT TO SCALE

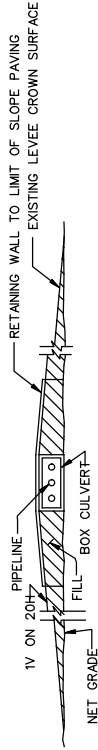

SECTION A - A  
NOT TO SCALE

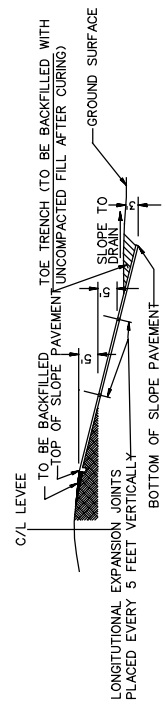

HORIZONTAL EXPANSION JOINT  
SECTION B - B  
NOT TO SCALE

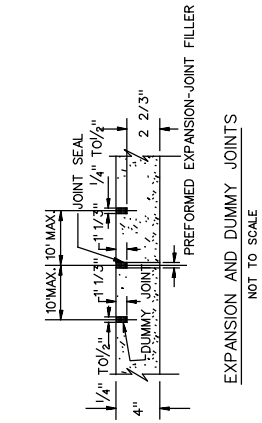

EXPANSION AND DUMMY JOINTS  
NOT TO SCALE

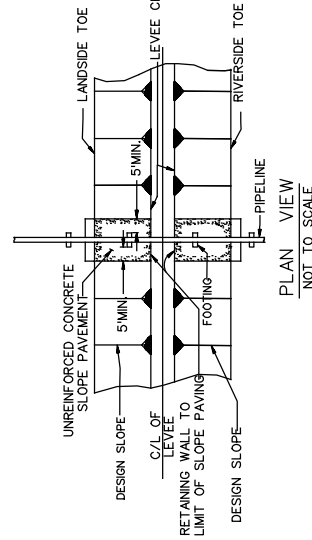

PLAN VIEW  
NOT TO SCALE

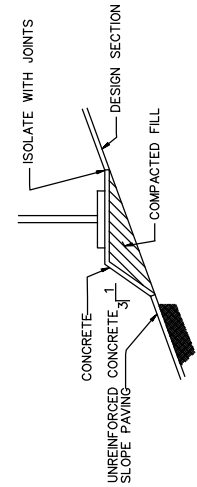

DETAIL  
NOT TO SCALE

**EMBANKMENT REQUIREMENTS**

COMPACTED FILL: (LEVEE ACCESS ROADS AND FOOTINGS)  
THE MATERIAL FOR COMPACTED FILL SHALL BE PLACED IN LAYERS, THE FIRST LAYER NOT MORE THAN 4 INCHES IN THICKNESS AND THE SUCCEEDING LAYERS NOT MORE THAN 8 INCHES IN THICKNESS PRIOR TO COMPACTION. EACH LAYER SHALL BE COMPACTED TO A MINIMUM OF 95 PERCENT RELATIVE COMPACTION. THE FILL SHALL BE PLACED AT A RATE OF NOT LESS THAN 20,000 POUNDS AND EXERTING A UNIT TREAD PRESSURE OF NOT LESS THAN 6 POUNDS PER SQUARE INCH. THE TRACTOR SHALL BE OPERATED AT SPEEDS NOT TO EXCEED 3.5 MILES PER HOUR. IF AN ALTERNATE TYPE COMPACTION MACHINE IS USED, TYPE SHOULD BE STATED ON APPLICANT'S DRAWING FOR REVIEW AND APPROVAL.

SEMCOMPACTED FILL: (LEVEE)  
THE MATERIAL FOR SEMCOMPACTED FILL SHALL BE PLACED OR SPREAD IN LAYERS, THE FIRST LAYER NOT MORE THAN 4 INCHES IN THICKNESS AND THE SUCCEEDING LAYERS NOT MORE THAN 8 INCHES IN THICKNESS PRIOR TO COMPACTION. EACH LAYER SHALL BE COMPACTED BY THREE COMPLETE PASSES OF A CRAWLER-TYPE TRACTOR WEIGHING NOT LESS THAN 20,000 POUNDS AND EXERTING A UNIT TREAD PRESSURE OF NOT LESS THAN 6 POUNDS PER SQUARE INCH. THE TRACTOR SHALL BE OPERATED AT SPEEDS NOT TO EXCEED 3.5 MILES PER HOUR. IF AN ALTERNATE TYPE COMPACTION MACHINE IS USED, TYPE SHOULD BE STATED ON APPLICANT'S DRAWING FOR REVIEW AND APPROVAL.

UNCOMPACTED FILL: (BERMS AND BACKFILL)  
THE MATERIAL FOR UNCOMPACTED FILL SHALL BE PLACED IN APPROXIMATELY HORIZONTAL LAYERS NOT EXCEEDING 3 FEET IN THICKNESS. THE LAYERS SHALL BE UNIFORMLY SPREAD, DISTRIBUTED, AND OTHERWISE MANIPULATED DURING PLACEMENT TO PREVENT THE FORMATION OF LUNGS OR OTHER DEFECTS. THE FILL SHALL NOT REMAIN INTACT, AND LARGE, OPEN Voids IN THE FILL WILL BE ELIMINATED.

**SLOPE PAVEMENT DETAILS**

**NOTES:**

1. 10' MIN. OR AS REQUIRED TO AVOID PENETRATION OF CONCRETE SLOPE PAVEMENT.
2. CONCRETE SLOPE PAVEMENT IS REQUIRED WHEN FOOTING REST ON LEVEE SLOPE PAVEMENT MUST EXTEND 5' EACH SIDE OF FOOTINGS.
3. IN THE ABSENCE OF FOOTING ON LEVEE LANDSIDE SLOPE PAVING WILL NOT BE REQUIRED. RIVERSIDE SLOPING WILL BE REQUIRED WHEN NECESSARY FOR EROSION CONTROL.
4. SMOOTH TRANSITIONS SHALL BE CONSTRUCTED BETWEEN THE LEVEE ENLARGEMENT AND EXISTING LEVEE.
5. ALL FRESH FILL SHALL BE SODDED OR FERTILIZED AND SEEDED, AND SHALL BE MAINTAINED UNTIL A HEALTHY GROWTH IS OBTAINED.
6. THE CROWN OF THE ENLARGED LEVEE SHALL BE SURFACED WITH UNCOMPACTED FILL TO A MINIMUM OF NINE INCHES IN THICKNESS AND A LENGTH OF RAMP.
7. FILL MATERIAL USED IN CONSTRUCTION OF THE LEVEE ENLARGEMENT, RAMP, PIPE COVER, AND BACKFILL OF EXCAVATION SHALL BE IMPERVIOUS EARTH FILL.
8. PIPELINE MARKERS SHALL BE PLACED AND MAINTAINED AT EACH TOE OF LEVEE IN LINE WITH PIPE CROSSING AND INDICATING NUMBER AND NUMBER OF LINES, PRODUCT AND ADDRESS FOR CONTACTING OWNER.