



DEPARTMENT OF THE ARMY
U.S. ARMY CORPS OF ENGINEERS, NEW ORLEANS DISTRICT
7400 LEAKE AVE
NEW ORLEANS, LA 70118-3651

JULY 18, 2022

Regulatory Division
Central Evaluation Branch

Project Manager:
Zachary Steinkoenig
(504) 862-1288
Zachary.j.steinkoenig@usace.army.mil
Application #: MVN-2022-00310-CF

PUBLIC NOTICE

Interested parties are hereby notified that a permit application has been received by the New Orleans District of the US Army Corps of Engineers pursuant to: [X] Section 10 of the Rivers and Harbors Act of March 3, 1899 (30 Stat. 1151; 33 USC 403), [X] Section 404 of the Clean Water Act (86 Stat. 816; 33 USC 1344).

PROPOSED BULKHEAD, BOAT SLIPS, and FILL ALONG THE TICKFAW RIVER

NAME OF APPLICANT: DALE POLITZ, c/o PTB Properties, LLC, 21375 Waterfront East Drive, Maurepas, LA 70449, ATTN: Tom Bhramayana.

LOCATION OF WORK: 20500 Lyndra Drive, Springfield, LA, Tickfaw River, Livingston Parish, Latitude 30.367583, Longitude -90.573250, within the Lake Pontchartrain Basin in hydrologic unit (HUC 08070203), as shown on the attached drawings.

CHARACTER OF WORK: The applicant has requested a Department of the Army authorization to construct and maintain a 410 linear foot bulkhead, dredge 124 cubic yards for the construction of two boat slips, construct boardwalk and decks, and place 2480 cubic yards of fill for the development and construction of a residential house along the Tickfaw River. The existing bulkhead has deteriorated and the applicant proposes a new bulkhead for a replacement and to additionally recapture land lost due to localized erosion. Impacts to wetlands are expected to be minimal as the property has historically been developed

The applicant states that the impact to wetlands/waterbottoms will be minimal since the property was already occupied and historically developed.

The comment period for the Department of Army Permit will close in **20 days** from the date of this public notice. This public notice is also available for review online at <https://go.usa.gov/xennJ>. Written comments, including suggestions for modifications or objections to the proposed work, stating reasons thereof, are being solicited from

anyone having interest in this permit and must be mailed so as to be received before or by the last day of the comment period. Letters and/or comments concerning the subject permit application must reference the applicant's name and the Permit Application Number and preferably emailed to the Corps of Engineers project manager listed above or forwarded to the Corps of Engineers at the address above, **ATTENTION: REGULATORY DIVISION, RGC, Zachary Steinkoenig**. Individuals or parties may request an extension of time in which to comment on the proposed work by writing or e-mailing the Corps of Engineers Project Manager listed above. Any request must be specific and substantively supportive of the requested extension and received by this office prior to the end of the initial comment period. The Branch Chief will review the request and the requestor will be promptly notified of the decision to grant or deny the request. If granted, the time extension will be continuous to the initial comment period and, inclusive of the initial comment period, will not exceed a total of 30 calendar days.

Corps of Engineers Permit Criteria

The decision whether to issue a permit will be based on an evaluation of the probable impacts, including cumulative impacts of the proposed activity on the public interest. That decision will reflect the national concern for both protection and utilization of important resources. The benefit which reasonably may be expected to accrue from the proposal must be balanced against its reasonably foreseeable detriments. All factors which may be relevant to the proposal will be considered including the cumulative effects thereof; among those are conservation, economics, aesthetics, general environmental concerns, wetlands, historic properties, fish and wildlife values, flood hazards, floodplain values, land use, navigation, shoreline erosion and accretion, recreation, water supply and conservation, water quality, energy needs, safety, food and fiber production, mineral needs, considerations of property ownership and, in general, the needs and welfare of the people.

The U.S. Army Corps of Engineers is soliciting comments from the public, federal, state, and local agencies and officials, Indian Tribes, and other interested parties in order to consider and evaluate the impacts of this proposed activity. Any comments received will be considered by the U.S. Army Corps of Engineers to determine whether to make, modify, condition, or deny a permit for this proposal. To make this decision, comments are used to assess impacts on endangered species, historic properties, water quality, general environmental effects, and other public interest factors listed above. Comments are used in the preparation of an Environmental Assessment and/or an Environmental Impact Statement pursuant to the National Environmental Policy Act. Comments are also used to determine the need for a public hearing and to determine the overall public interest of the proposed activity.

The New Orleans District is unaware of properties listed on the National Register of Historic Places near the proposed work. The possibility exists that the proposed work may damage or destroy presently unknown archeological, scientific, prehistorical,

historical sites, or data. Copies of this notice are being sent to the State Archeologist and State Historic Preservation Officer regarding potential impacts to cultural resources.

The New Orleans District has determined that the proposed project is located in waters known to be utilized by the West Indian Manatee and it was determined that the proposed activity is not likely to adversely affect the species with the inclusion of special manatee conditions based on the Information & Planning Consultation for Endangered Species (IPaC) procedure, as signed on January 27, 2020, between the U.S. Army Corps of Engineers and U.S. Fish and Wildlife Service.

This notice initiates the Essential Fish Habitat (EFH) consultation requirements of the Magnuson-Stevens Fishery Conservation and Management Act. The applicant's proposal may result in the destruction, alteration and/or disturbance of **N/A** acres of EFH utilized by various life stages of red drum and penaeid shrimp. Our initial determination is that the proposed action would not have a substantial adverse impact on EFH or federally managed fisheries in the Gulf of Mexico. Our final determination relative to project impacts and the need for mitigation measures is subject to review by and coordination with the National Marine Fisheries Service.

If the proposed work involves deposits of dredged or fill material into navigable waters, the evaluation of the probable impacts will include the application of guidelines established by the Administrator of the Environmental Protection Agency. Also, a certification that the proposed activity will not violate water quality standards will be required from the Louisiana Department of Environmental Quality, Office of Environmental Services before a Department of the Army permit can be issued.

Any person may request, in writing, within the comment period specified in this notice, that a public hearing be held to consider this application. Requests for public hearings shall state, with particularity, the reasons for holding a public hearing. You are requested to communicate the information contained in this notice to any other parties whom you deem likely to have interest in the matter.

JOHN M. HERMAN
Chief, Central Evaluation Branch
Regulatory Division

Enclosure

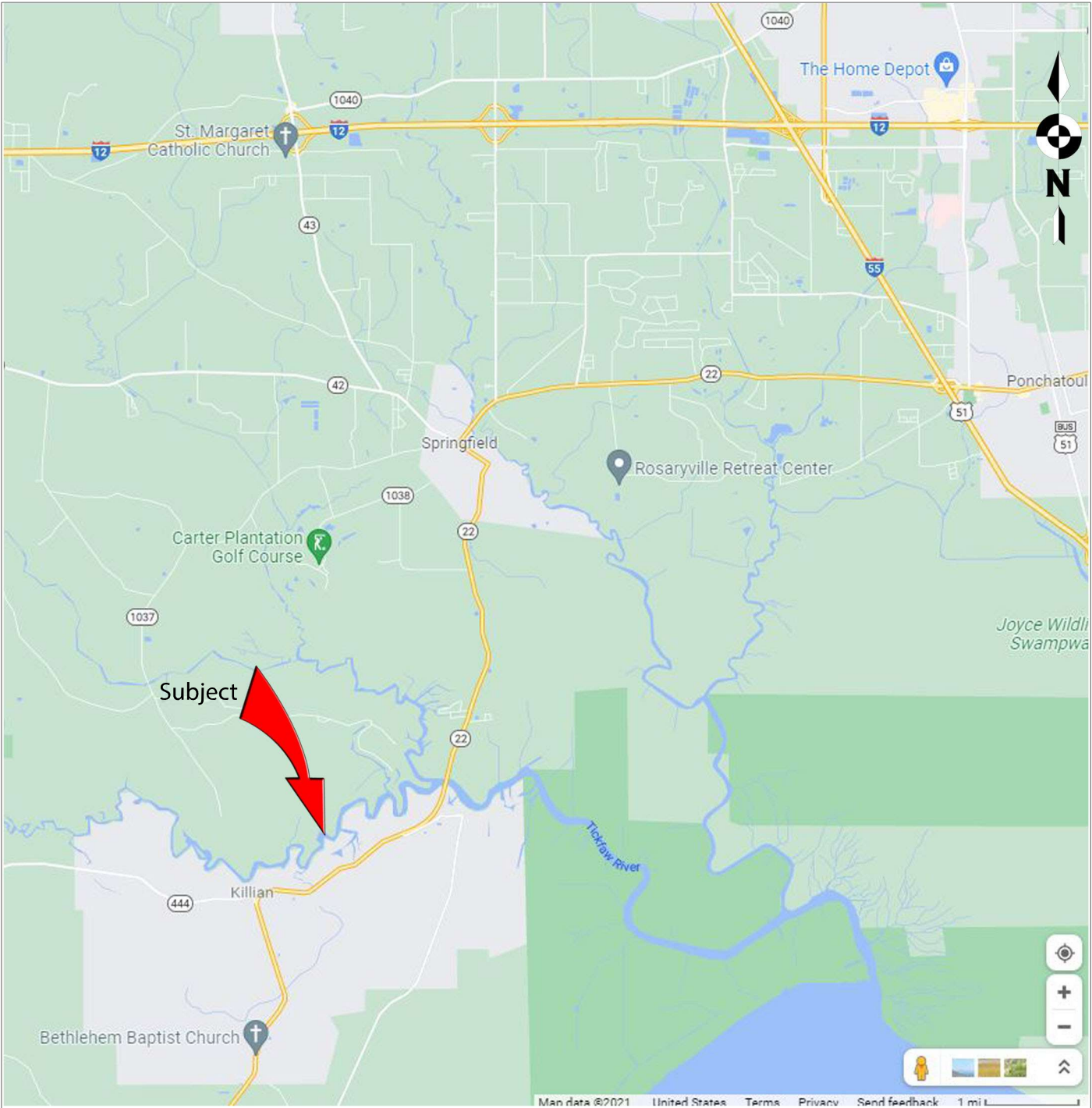

Lot Size: 0.41 Acres

LONG: 30.367612° LAT: -90.573210°
SEC 15 - TOWNSHIP 8S - RANGE 6E

VACINITY MAP WIDE SHOT
DALE POLITZ
20500 LINDA DR. SPRINGFIELD, LA 70462
LOT 3 BLOCK B OF SHELLY O'NEAL ESTATES NO. 2
LIVINGSTON PARISH

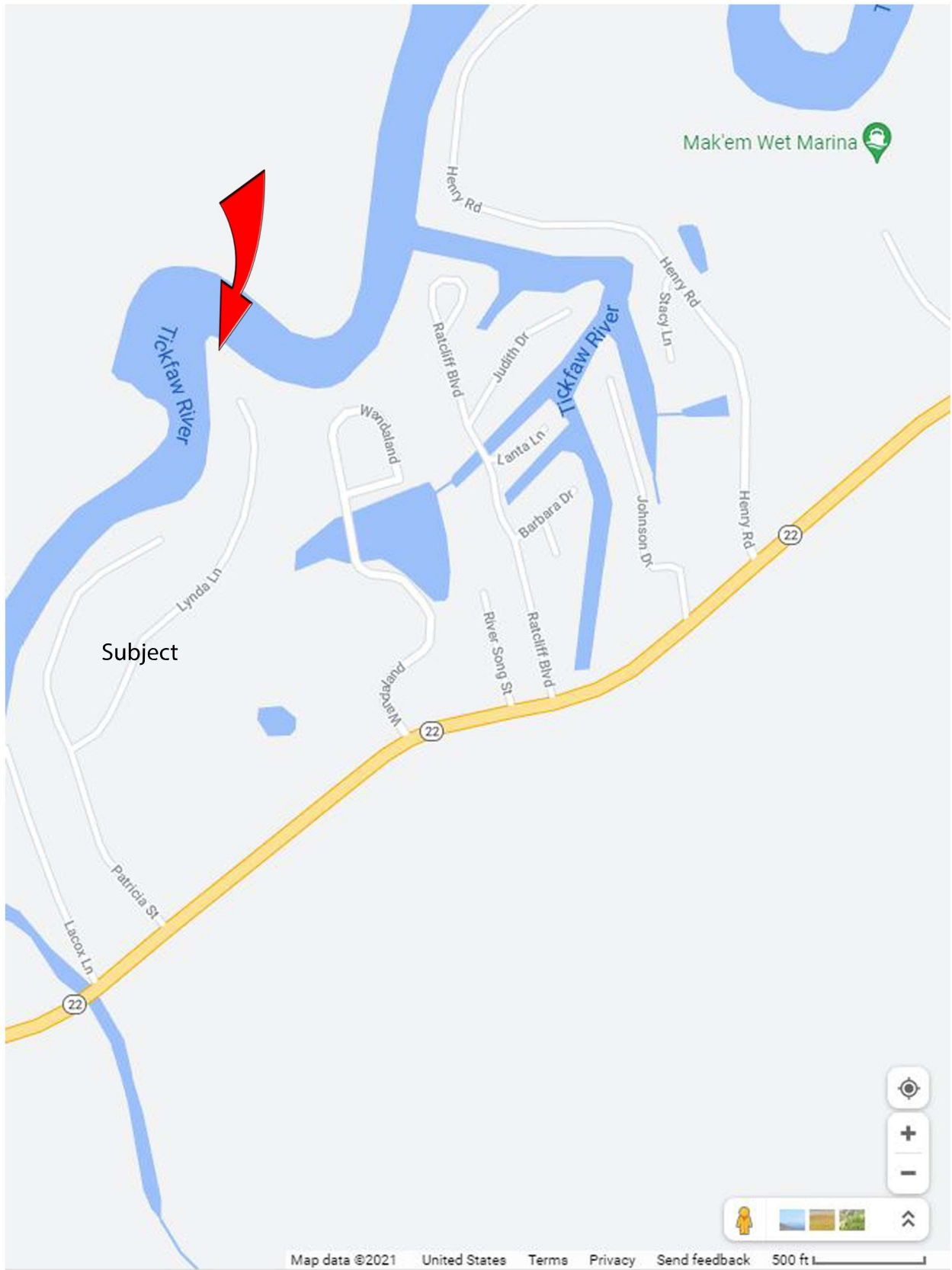

Lot Size: 0.41 Acres

LONG: 30.367612° LAT: -90.573210°
SEC 15 - TOWNSHIP 8S - RANGE 6E

VACINITY MAP WIDE SHOT
DALE POLITZ
20500 LINDA DR. SPRINGFIELD, LA 70462
LOT 3 BLOCK B OF SHELLY O'NEAL ESTATES NO. 2
LIVINGSTON PARISH

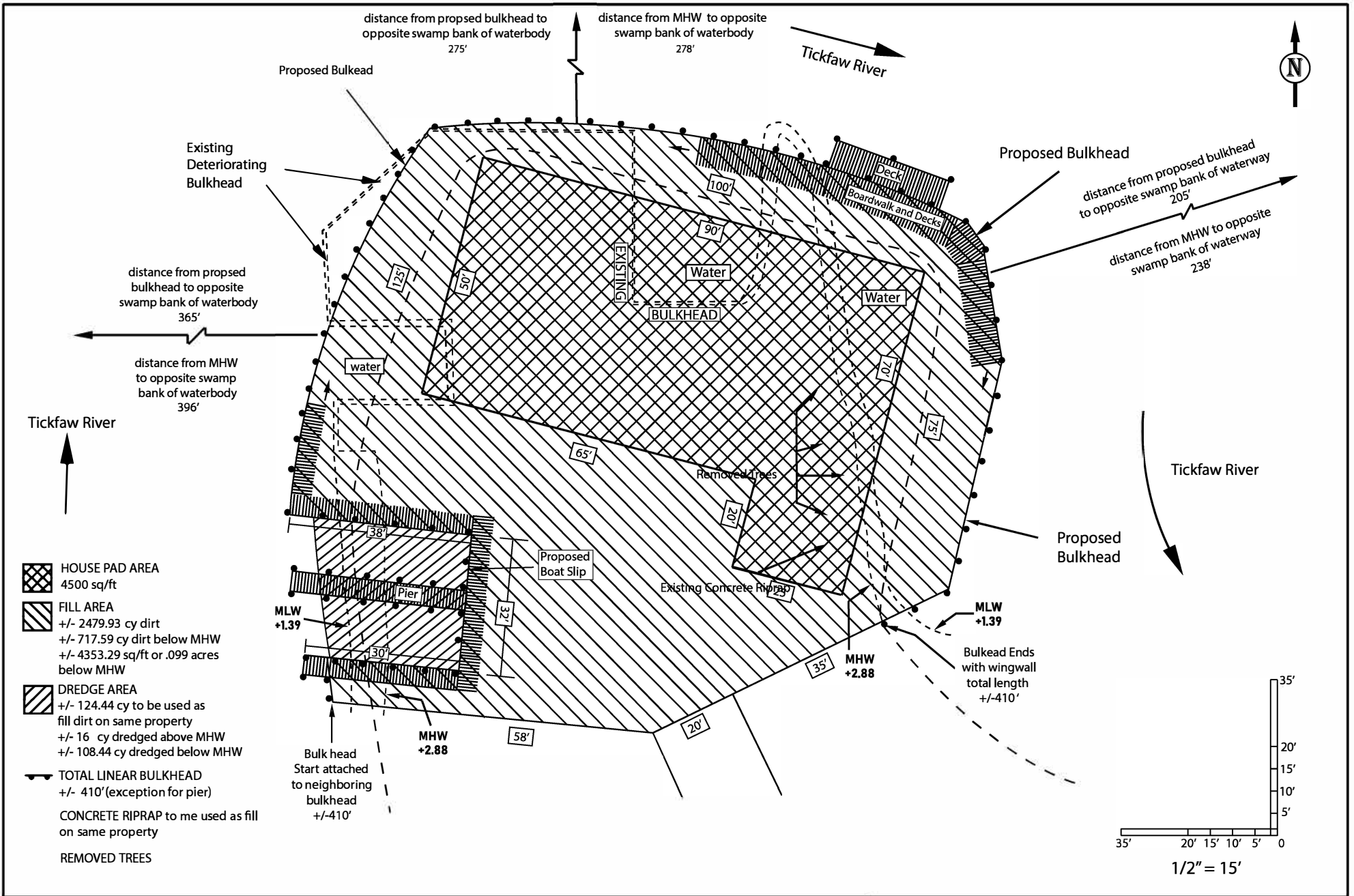

LOT SIZE: .41 ACRES
 LONG: 30.367612° LAT: -90.573210°
 SEC 15 - TOWNSHIP 8S - RANGE 6E

AERIAL PROPOSED DREDGE AND FILL
 DALE POLITZ
 20500 LINDA DR. SPRINGFIELD, LA 70462
 LOT 3 BLOCK B OF SHELLY O'NEAL ESTATES NO. 2
 LIVINGSTON PARISH

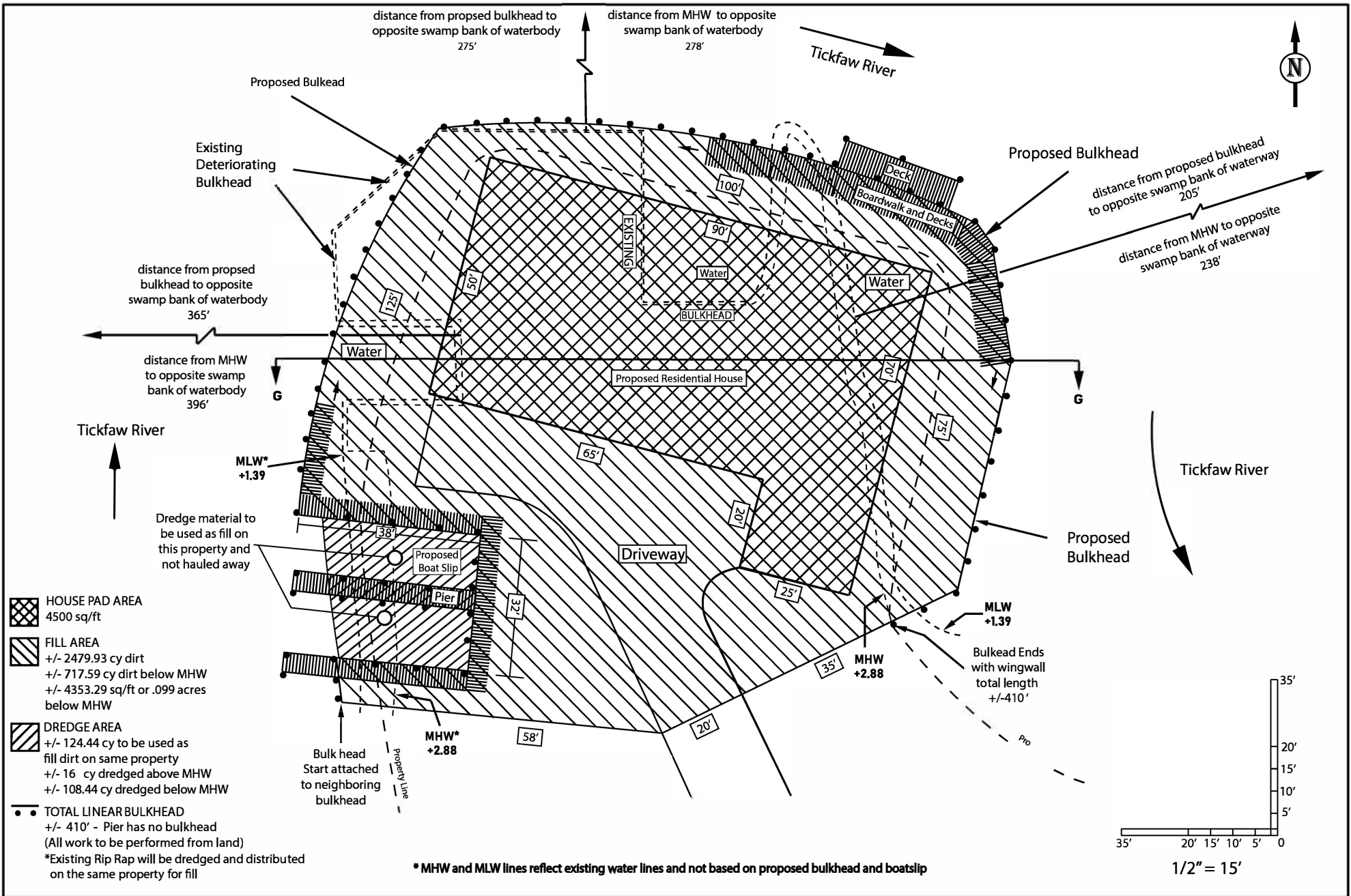

LOT SIZE: .41 ACRES
 LONG: 30.367612° LAT: -90.573210°
 SEC 15 - TOWNSHIP 8S - RANGE 6E

AERIAL "G" FULL CROSS SECTION MAP
 DALE POLITZ
 20500 LINDA DR. SPRINGFIELD, LA 70462
 LOT 3 BLOCK B OF SHELLY O'NEAL ESTATES NO. 2
 LIVINGSTON PARISH

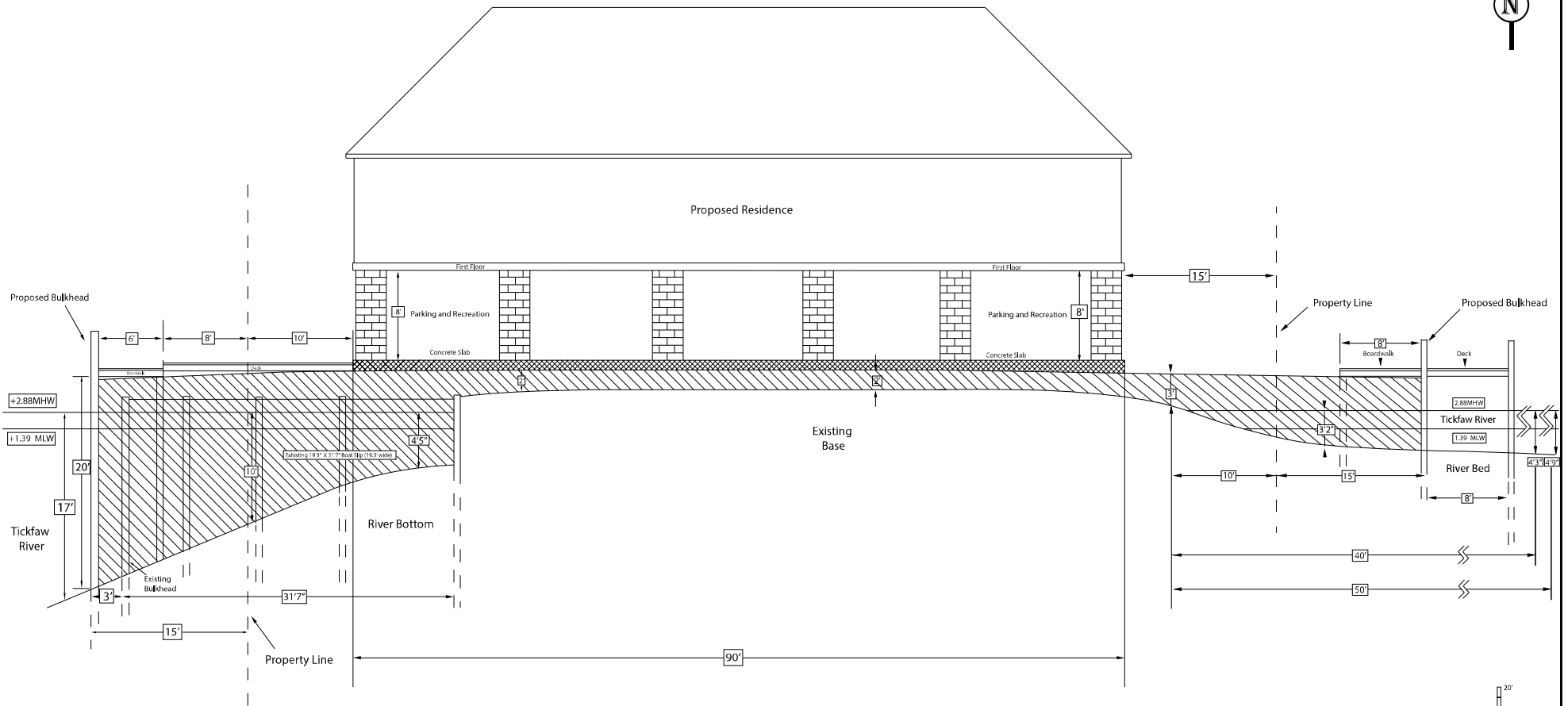

 HOUSE PAD AREA
4500 sq/ft

 FILL AREA
+/- 2479.93 cy dirt
+/- 717.59 cy dirt below MHW
+/- 4353.29 sq/ft or .099 acres
below MHW

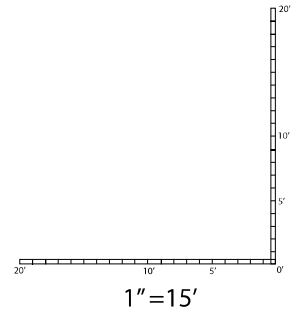

LOT SIZE: .41 ACRES
LONG: 30.367612° LAT: -90.573210°
SEC 15 - TOWNSHIP 8S - RANGE 6E

EXHIBIT "G" FULL WIDTH COSS SECTION
DALE POLITZ
20500 LINDA DR. SPRINGFIELD, LA 70462
LOT 3 BLOCK B OF SHELLY O'NEAL ESTATES NO. 2
LIVINGSTON PARISH

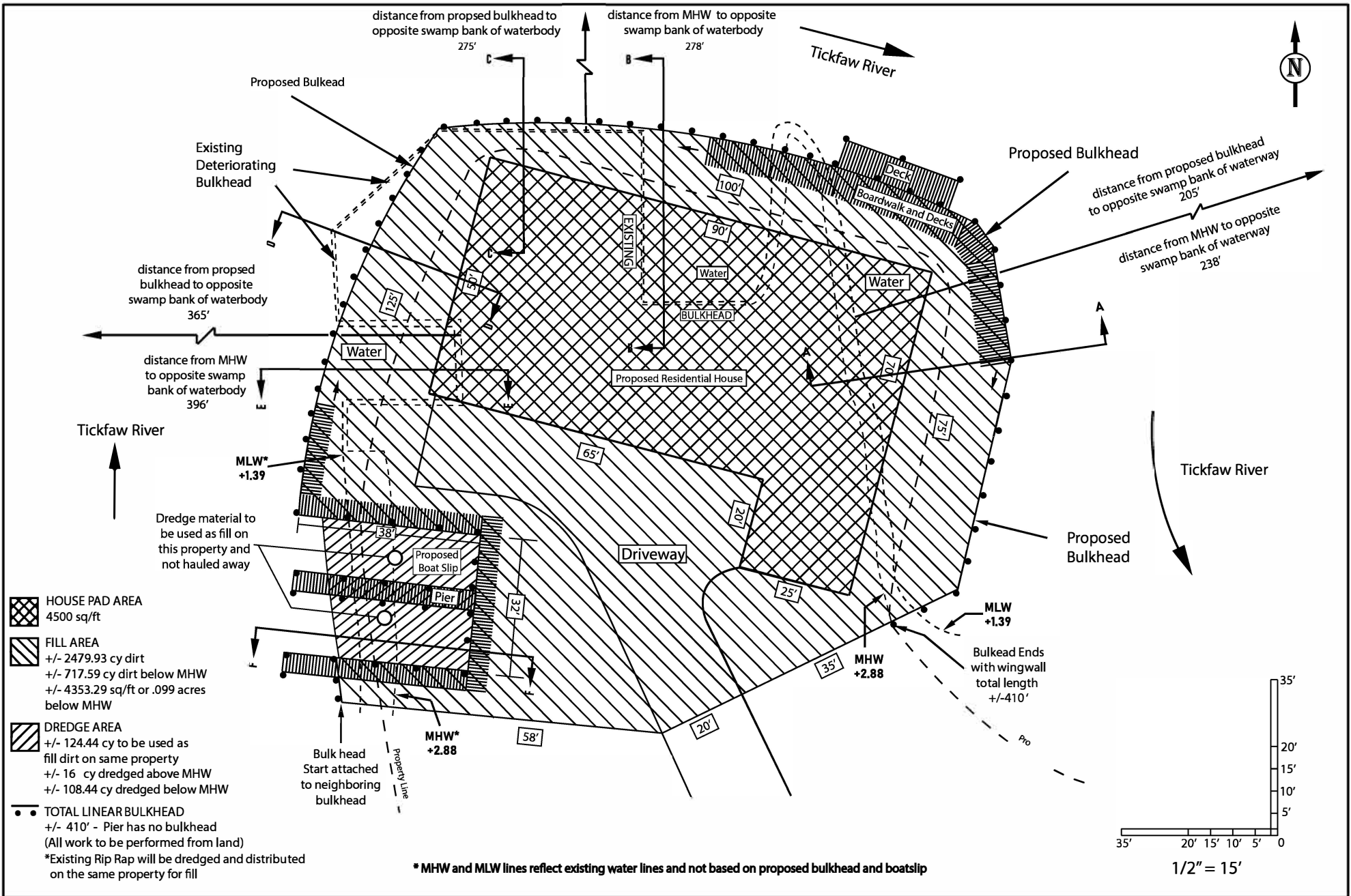

LOT SIZE: .41 ACRES
 LONG: 30.367612° LAT: -90.573210°
 SEC 15 - TOWNSHIP 8S - RANGE 6E

AERIAL A-F CROSS SECTIONS
 DALE POLITZ
 20500 LINDA DR. SPRINGFIELD, LA 70462
 LOT 3 BLOCK B OF SHELLY O'NEAL ESTATES NO. 2
 LIVINGSTON PARISH

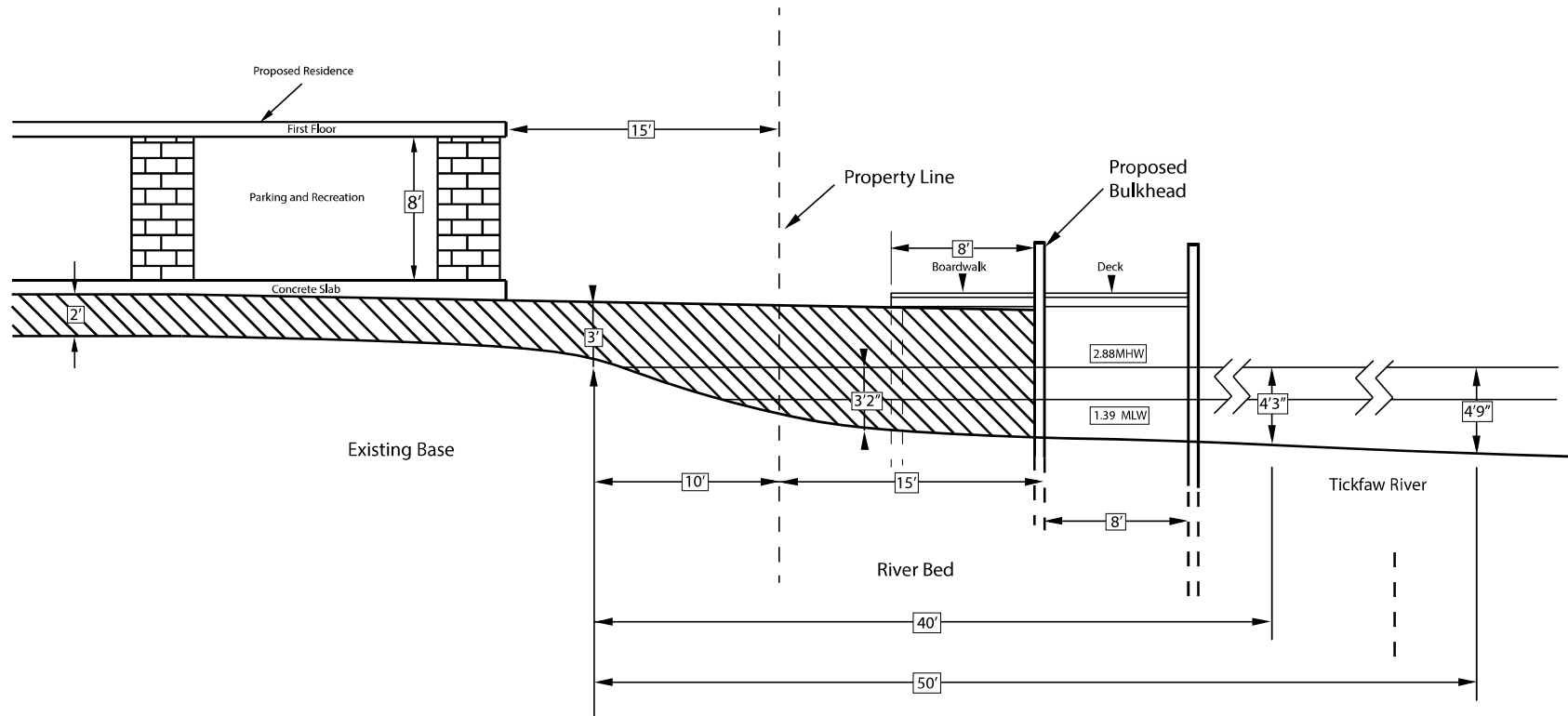

 FILL AREA
+/- 298.23 cy dirt

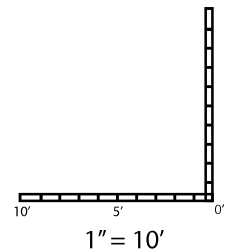

LOT SIZE: .41 ACRES
LONG: 30.367612° LAT: -90.573210°
SEC 15 - TOWNSHIP 8S - RANGE 6E

EXHIBIT "A" EAST CROSS SECTION
DALE POLITZ
20500 LINDA DR. SPRINGFIELD, LA 70462
LOT 3 BLOCK B OF SHELLY O'NEAL ESTATES NO. 2
LIVINGSTON PARISH

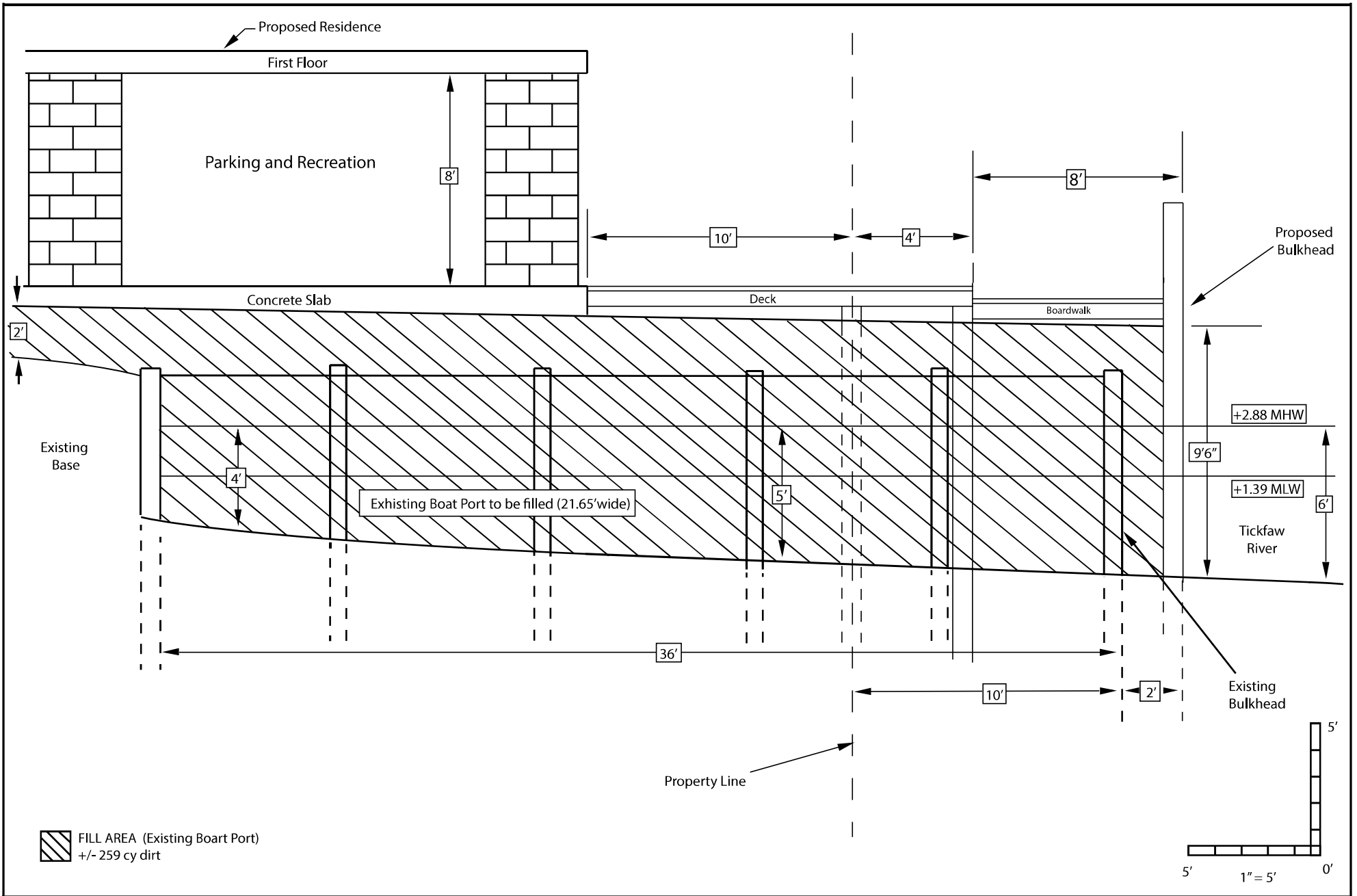

LOT SIZE: .41 ACRES
 LONG: 30.367612° LAT: -90.573210°
 SEC 15 - TOWNSHIP 8S - RANGE 6E

EXHIBIT "B" NORTH BOAT PORT CROSS SECTION
 DALE POLITZ
 20500 LINDA DR. SPRINGFIELD, LA 70462
 LOT 3 BLOCK B OF SHELLY O'NEAL ESTATES NO. 2
 LIVINGSTON PARISH

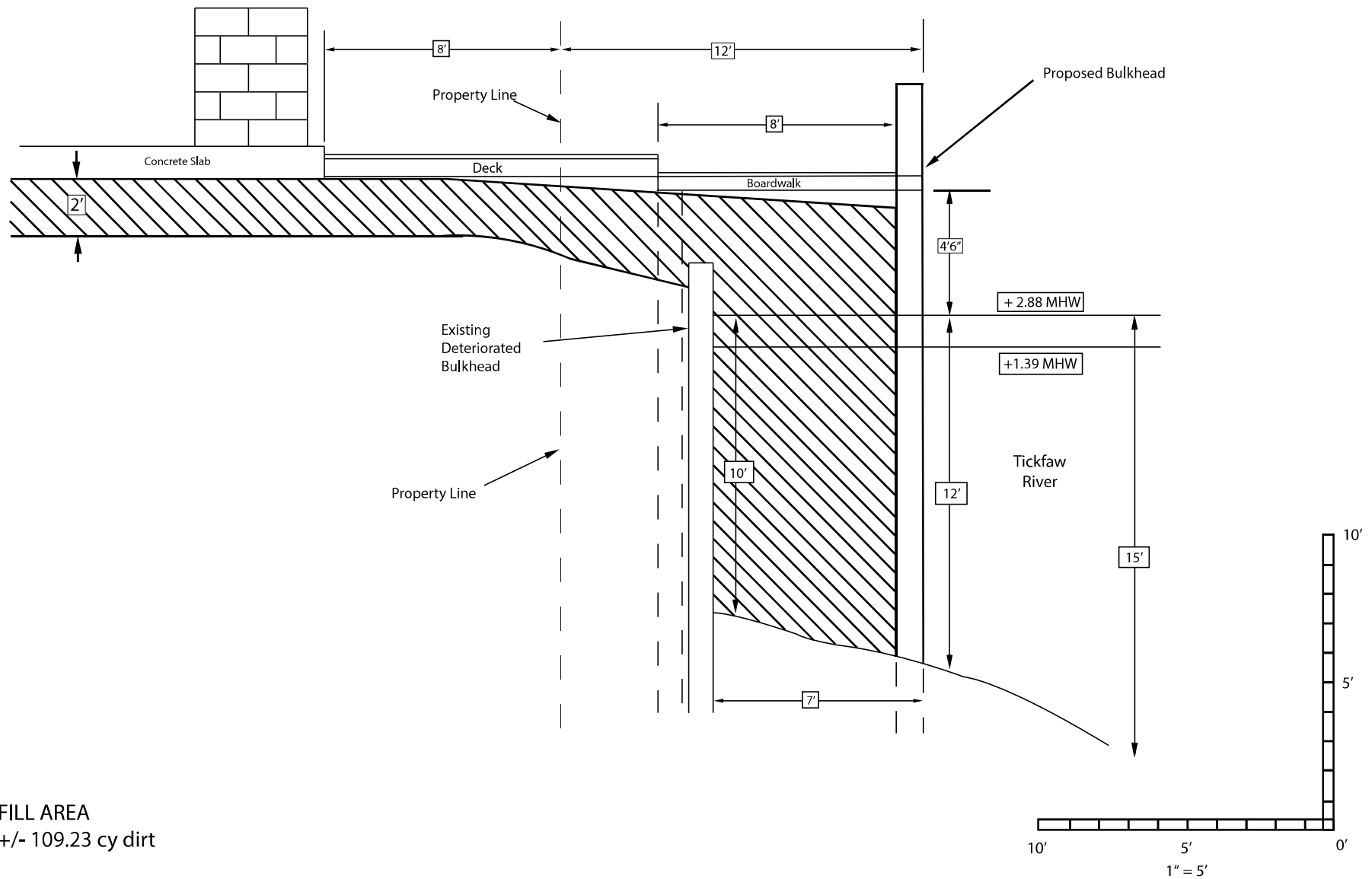

LOT SIZE: .41 ACRES
 LONG: 30.367612° LAT: -90.573210°
 SEC 15 - TOWNSHIP 8S - RANGE 6E

EXHIBIT "C" NORTH CROSS SECTION
 DALE POLITZ
 20500 LINDA DR. SPRINGFIELD, LA 70462
 LOT 3 BLOCK B OF SHELLY O'NEAL ESTATES NO. 2
 LIVINGSTON PARISH

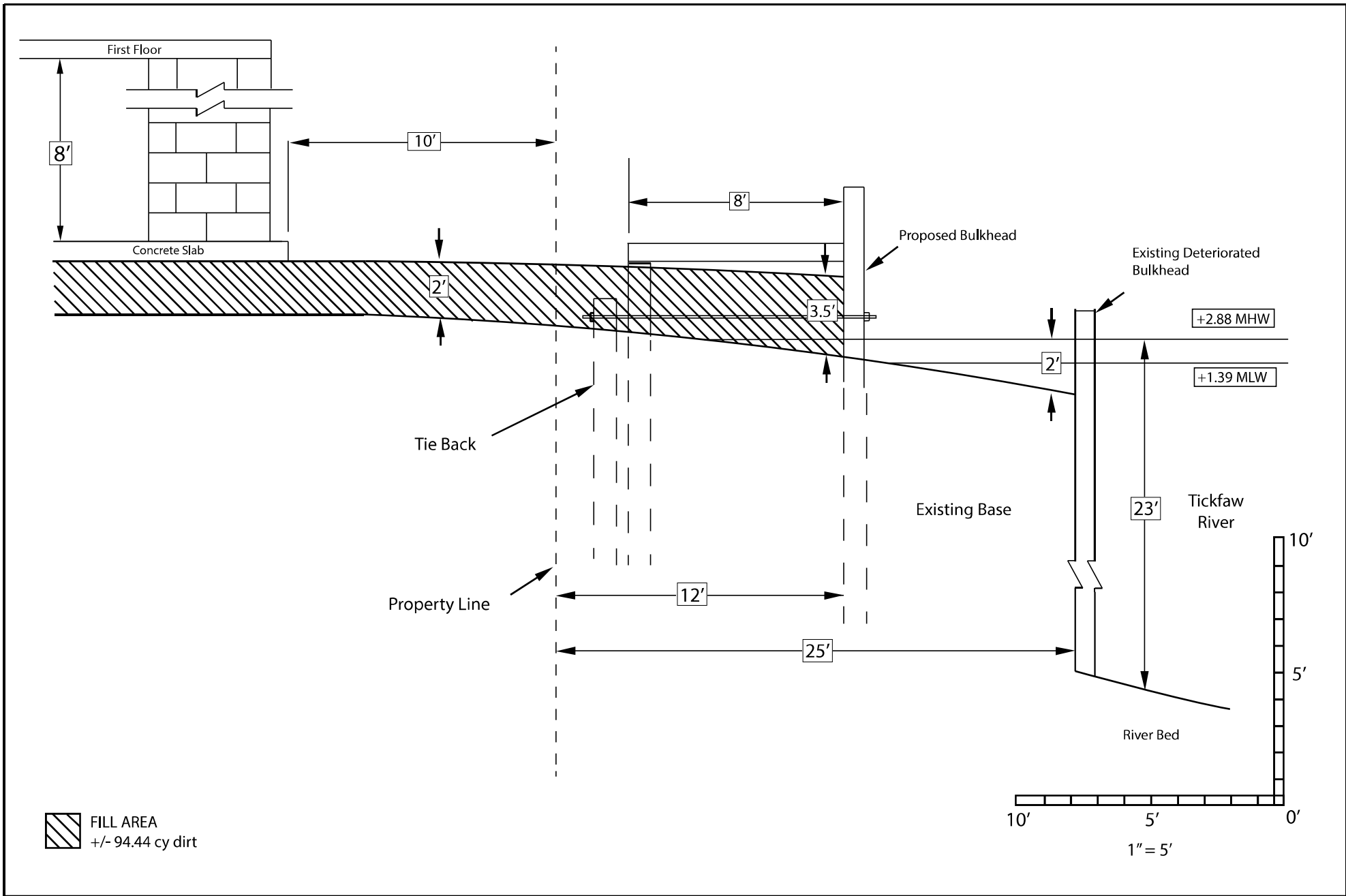

LOT SIZE: .41 ACRES
 LONG: 30.367612° LAT: -90.573210°
 SEC 15 - TOWNSHIP 8S - RANGE 6E

EXHIBIT "D" NORTH WEST CROSS SECTION
 DALE POLITZ
 20500 LINDA DR. SPRINGFIELD, LA 70462
 LOT 3 BLOCK B OF SHELLY O'NEAL ESTATES NO. 2
 LIVINGSTON PARISH

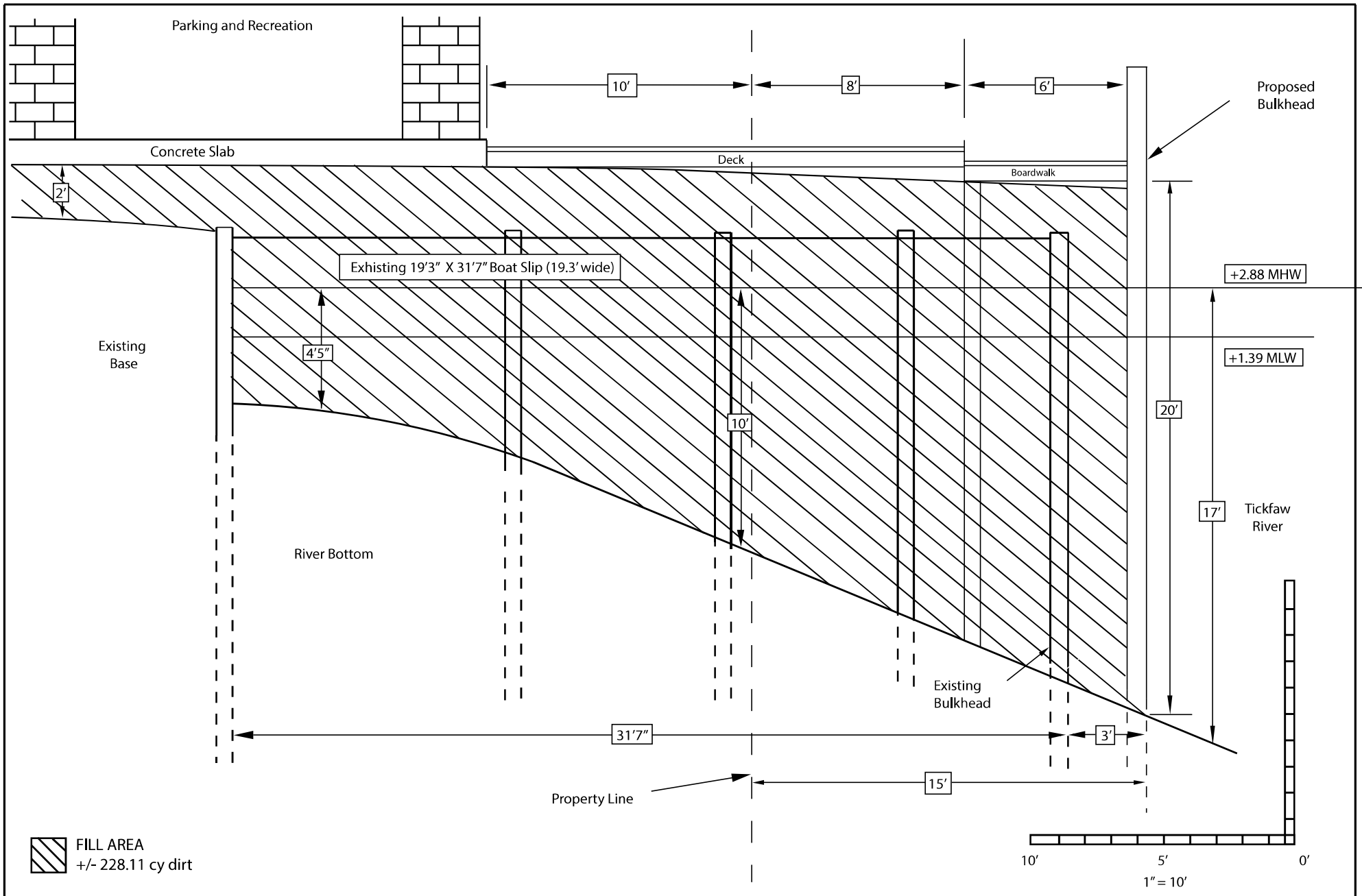



 FILL AREA
 +/- 228.11 cy dirt

LOT SIZE: .41 ACRES
 LONG: 30.367612° LAT: -90.573210°
 SEC 15 - TOWNSHIP 8S - RANGE 6E

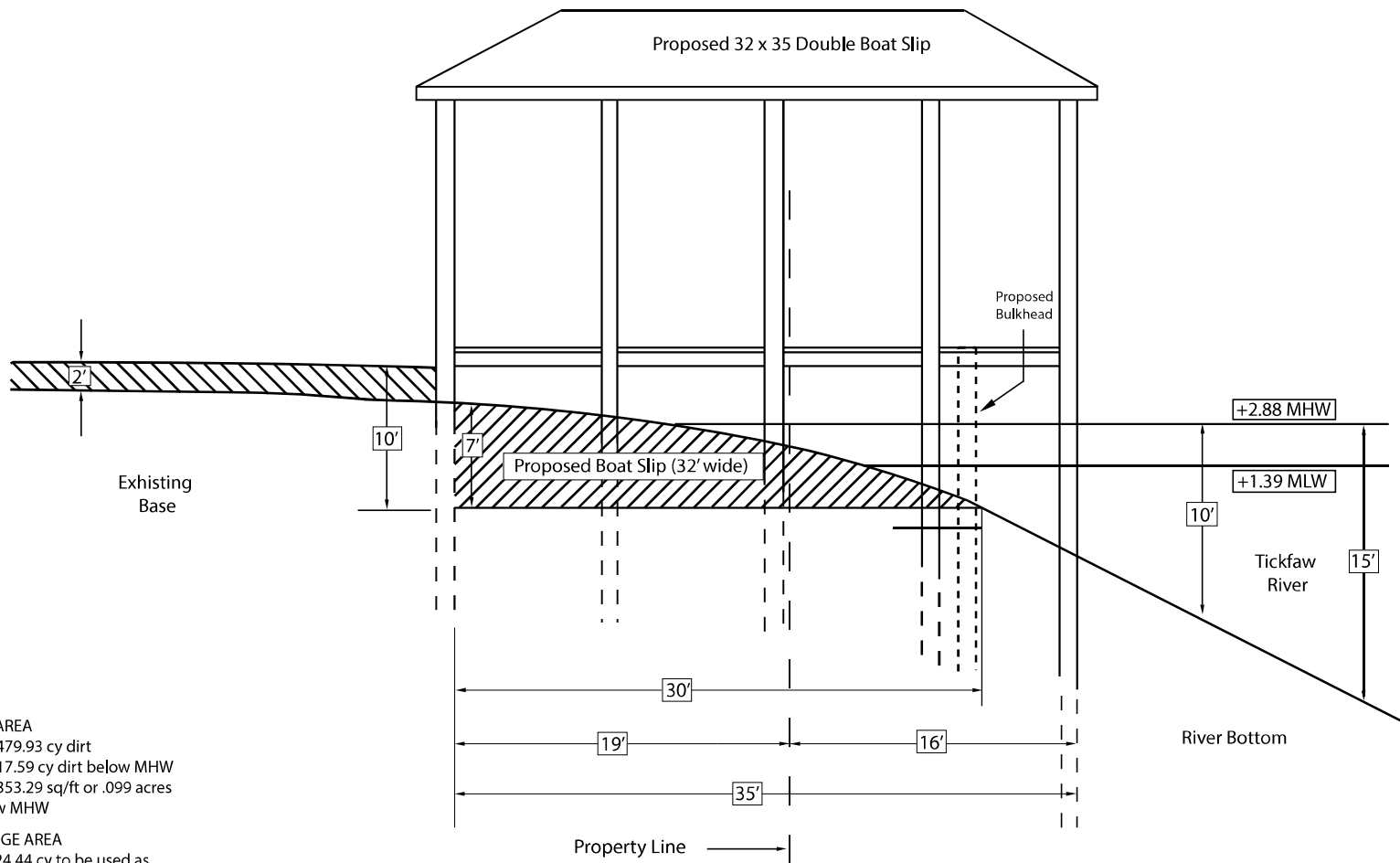
EXHIBIT "E" OLD BOAT PORT CROSS SECTION
 DALE POLITZ
 20500 LINDA DR. SPRINGFIELD, LA 70462
 LOT 3 BLOCK B OF SHELLY O'NEAL ESTATES NO. 2
 LIVINGSTON PARISH



- 
FILL AREA
 +/- 2479.93 cy dirt
 +/- 717.59 cy dirt below MHW
 +/- 4353.29 sq/ft or .099 acres
 below MHW
- 
DREDGE AREA
 +/- 124.44 cy to be used as
 fill dirt on same property
 +/- 16 cy dredged above MHW
 +/- 108.44 cy dredged below MHW

Existing Rip Rap will be dredged and distributed on the same property for fill

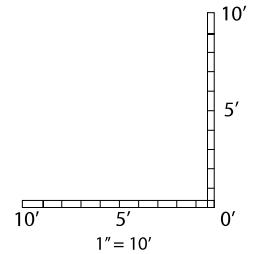

LOT SIZE: .41 ACRES
 LONG: 30.367612° LAT: -90.573210°
 SEC 15 - TOWNSHIP 8S - RANGE 6E

EXHIBIT "F" WEST PROPOSED BOAT SLIP CROSS SECTION
 DALE POLITZ
 20500 LINDA DR. SPRINGFIELD, LA 70462
 LOT 3 BLOCK B OF SHELLY O'NEAL ESTATES NO. 2
 LIVINGSTON PARISH

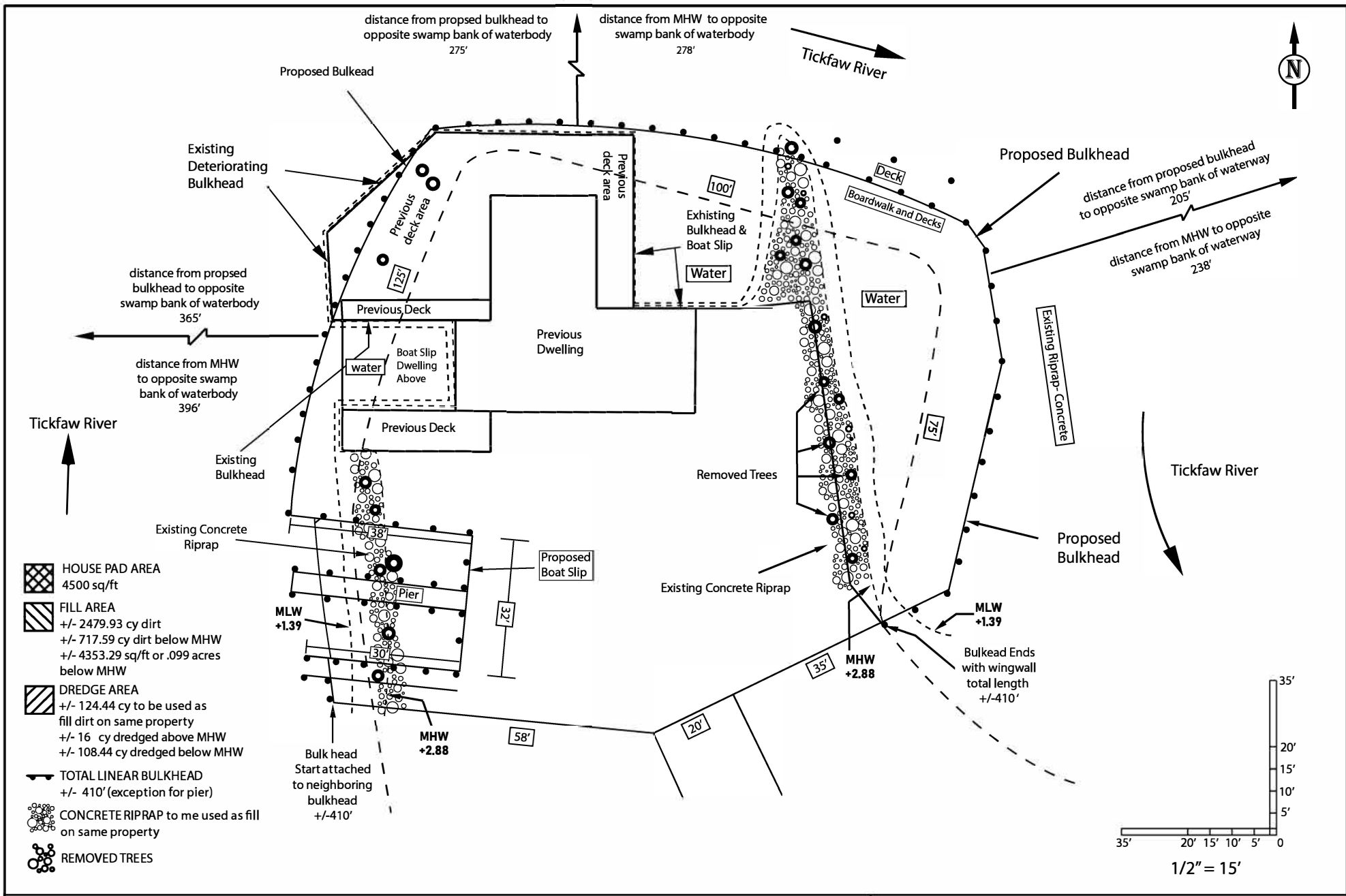

LOT SIZE: .41 ACRES
 LONG: 30.367612° LAT: -90.573210°
 SEC 15 - TOWNSHIP 8S - RANGE 6E

PREVIOUS DWELLING AND EXISTING BULKHEAD
 DALE POLITZ
 20500 LINDA DR. SPRINGFIELD, LA 70462
 LOT 3 BLOCK B OF SHELLY O'NEAL ESTATES NO. 2
 LIVINGSTON PARISH