



DEPARTMENT OF THE ARMY
U.S. ARMY CORPS OF ENGINEERS, NEW ORLEANS DISTRICT
7400 LEAKE AVENUE
NEW ORLEANS LA 70118-3651

December 19, 2022

Regulatory Division
Eastern Evaluation Branch

Project Manager:
Jennifer Burkett
(504) 862-2045
jennifer.e.burkett@usace.army.mil

Application #: MVN-2022-01298-EBB

PUBLIC NOTICE

Interested parties are hereby notified that a permit application has been received by the New Orleans District of the U.S. Army Corps of Engineers pursuant to: [X] Section 10 of the Rivers and Harbors Act of March 3, 1899 (30 Stat. 1151; 33 USC 403); and/or [X] Section 404 of the Clean Water Act (86 Stat. 816; 33 USC 1344), and/or [] Section 14 of the Rivers and Harbors Act of 1899 (33 U.S.C. Section 408).

BARGE TOW HOLDING AREA ON THE MISSISSIPPI RIVER IN ORLEANS PARISH

NAME OF APPLICANT: Turn Services c/o Lanier & Associates Engineers, Attention: John Maurin, 4101 Magazine Street, New Orleans, Louisiana 70115.

LOCATION OF WORK: Located on the right descending bank of the Mississippi River, approximately 87.4 miles above Head of Passes, in Orleans Parish, Louisiana, (lat. 29.920278, long. -89.9525), as shown on the attached drawings. (Hydrologic Unit Code: 08090100; Lower Mississippi – New Orleans).

CHARACTER OF WORK: The proposed project is to install and maintain twenty-four 48"Ø monopiles to create a mooring area for barge tows waiting to be dispatched to the Algiers Locks. No barge fleeting will be allowed at the proposed barge holding area. The purpose of the project is to keep the barge tows tucked closer to the bank and parallel with the river to enhance safe navigation of vessels in the area while reducing fuel waste and emissions during the holding period. The project as proposed will extend 270 feet into the river which is approximately 2200 feet wide at this location. Fill consisting of 150 cubic yards of rock rip rap will be used around monopiles which penetrate the revetment.

MITIGATION: The applicant proposes to avoid direct impacts and minimize secondary impacts to the maximum extent practicable. No permanent adverse impacts to special aquatic sites are proposed; no compensatory mitigation is anticipated at this time.

The comment period on the requested Department of the Army Permit will close **30 days** from the date of this public notice. Written comments, including suggestions for modifications or objections to the proposed work, stating reasons thereof, are being solicited from anyone having interest in this permit request, and must be submitted so as to be received before or by the last day of the comment period. Letters and/or comments concerning the subject permit application must reference the Applicant's Name and the Permit Application Number and can be preferably emailed to the Corps of Engineer's project manager listed above or forwarded to the Corps of Engineers at the address above, **ATTENTION: REGULATORY DIVISION, RGE, Jennifer Burkett**. This public notice is also available for review online at <https://go.usa.gov/xennJ>

Corps of Engineers Permit Criteria

The decision whether to issue a permit will be based on an evaluation of the probable impacts, including cumulative impacts of the proposed activity on the public interest. That decision will reflect the national concern for both protection and utilization of important resources. The benefit which reasonably may be expected to accrue from the proposal must be balanced against its reasonably foreseeable detriments. All factors which may be relevant to the proposal will be considered including the cumulative effects thereof; among those are conservation, economics, aesthetics, general environmental concerns, wetlands, historic properties, fish and wildlife values, flood hazards, floodplain values, land use, navigation, shoreline erosion and accretion, recreation, water supply and conservation, water quality, energy needs, safety, food and fiber production, mineral needs, considerations of property ownership and, in general, the needs and welfare of the people.

The U.S. Army Corps of Engineers is soliciting comments from the public, federal, state, and local agencies and officials, Indian Tribes, and other interested parties in order to consider and evaluate the impacts of this proposed activity. Any comments received will be considered by the U.S. Army Corps of Engineers to determine whether to make, modify, condition, or deny a permit for this proposal. To make this decision, comments are used to assess impacts on endangered species, historic properties, water quality, general environmental effects, and other public interest factors listed above. Comments are used in the preparation of an Environmental Assessment and/or an Environmental Impact Statement pursuant to the National Environmental Policy Act. Comments are also used to determine the need for a public hearing and to determine the overall public interest of the proposed activity. Further, all factors that may be relevant to the proposal will be considered, including the potential cumulative effects associated with the proposed project

The New Orleans District is presently unaware of properties listed on the National Register of Historic Places at or near the proposed work but is pending further review in accordance with the National Historic Preservation Act. The possibility exists that the proposed work may damage or destroy presently unknown archeological, scientific, prehistorical, historical sites, or data. As deemed necessary, copies of this public notice will be sent to the State Archeologist, State Historic Preservation Officer, and federally listed tribes regarding potential impacts to cultural resources.

Our initial finding is that the proposed work would have no effect on any species listed as endangered by the U.S. Department of Commerce, nor affect any habitat designated as critical to the survival and recovery of any such species.

The New Orleans District has determined that the work is located in waters known to be utilized by the pallid sturgeon (*Scaphirhynchus albus*) and concluded the activity is not likely to adversely affect this species based on the Information Planning and Consultation (IPaC) tool for Endangered Species in Louisiana, as signed on January 27, 2020, between the U.S. Army Corps of Engineers, New Orleans and the U.S. Fish and Wildlife Service.

This notice initiates the Essential Fish Habitat (EFH) consultation requirements of the Magnuson-Stevens Fishery Conservation and Management Act. The applicant's proposal may result in the destruction, alteration, and/or disturbance of N/A acres of EFH utilized by various life stages of red drum and penaeid shrimp. Our initial determination is that the proposed action would not have a substantial adverse impact on EFH or federally managed fisheries in the Gulf of Mexico. Our final determination relative to project impacts and the need for mitigation measures is subject to review by and coordination with the National Marine Fisheries Service.

If the proposed work involves deposits of dredged or fill material into navigable waters, the evaluation of the probable impacts will include the application of guidelines established by the Administrator of the Environmental Protection Agency. Also, a certification that the proposed activity will not violate applicable water quality standards will be required from the LA Department of Environmental Quality before a Department of the Army permit is issued.

Any person may request, (preferably by email to the project manager, or in writing), within the comment period specified in this notice, that a public hearing be held to consider this application. Requests for public hearings shall state, with particularity, the reasons for holding a public hearing.

The applicant has certified that the proposed activity described in the application complies with and will be conducted in a manner that is consistent with the Louisiana Coastal Resources Program (Louisiana Coastal Zone Application P20220838). The Department of the Army permit will not be issued unless the applicant received approval or a waiver of the Coastal Use Permit by the Department of Natural Resources.

You are invited to communicate the information contained in this notice to any other parties whom you deem likely to have interest in the matter.

Brad P. Laborde
Chief, Eastern Evaluation Branch
Regulatory Division

Enclosures

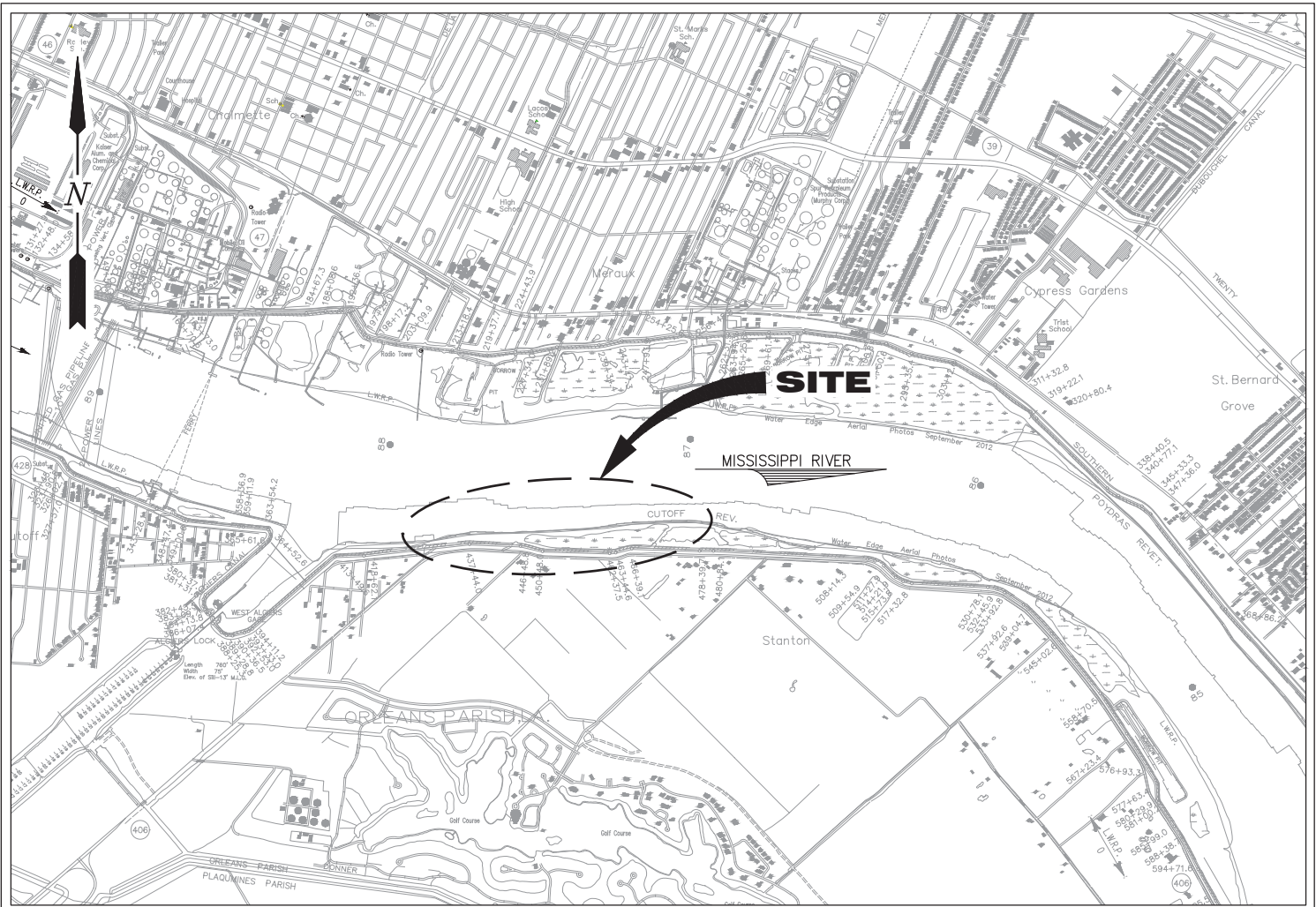

VICINITY MAP

SCALE: 1" = 3000'

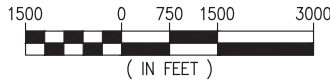

ORLEANS PARISH
LAT. 29° 55' 13" N
LONG. 89° 57' 09" W



AREA MAP

NOTES

1. AS-BUILT DRAWINGS AND/OR PLANS SHALL HAVE WRITTEN ON THEM THE DATE OF COMPLETION OF SAID ACTIVITIES AND SHALL BE SUBMITTED TO THE LOUISIANA DEPARTMENT OF NATURAL RESOURCES, OFFICE OF COASTAL MANAGEMENT, P.O. BOX 44487, BATON ROUGE, LA 70804-4487 WITHIN 30 DAYS FOLLOWING PROJECT COMPLETION.
2. ALL STRUCTURES, FACILITIES, WELL AND PIPELINES/FLOWLINES OCCURRING IN OPEN WATER AREAS OR IN OILFIELD CANALS OR SLIPS SHALL BE REMOVED WITHIN 120 DAYS OF ABANDONMENT OF THE FACILITIES FOR THE HEREIN PERMITTED USE UNLESS PRIOR WRITTEN APPROVAL TO LEAVE SUCH STRUCTURES IN PLACE IS RECEIVED FROM THE COASTAL MANAGEMENT DIVISION. THIS CONDITION DOES NOT PRECLUDE THE NECESSITY FOR REVISING THE CURRENT PERMIT OR OBTAINING A SEPARATE COASTAL USE PERMIT, SHOULD ONE BE REQUIRED.
3. STRUCTURES MUST ALSO BE MARKED/LIGHTED IN ACCORDANCE WITH U.S. COAST GUARD REGULATIONS.
4. IN ORDER TO ENSURE THE SAFETY OF ALL PARTIES, THE PERMITTEE SHALL CONTACT THE LOUISIANA ONE CALL SYSTEM (1-800-272-3020) A MINIMUM OF 48 HOURS PRIOR TO THE COMMENCEMENT OF ANY EXCAVATION (DIGGING, DREDGING, JETTING, ETC.) OR DEMOLITION ACTIVITY.
5. ALL ELEVATIONS REFER TO NAVD 88 UNLESS NOTED OTHERWISE.

JOSEPH E. JACQUAT
LA PE #21953

PRELIMINARY - FOR PERMIT PURPOSES ONLY

REV A

LANIER & ASSOCIATES
CONSULTING ENGINEERS
INCORPORATED

LA: EF-1120 TX: F-2981
NEW ORLEANS • BEAUMONT • CORPUS CHRISTI • HOUSTON

ALGIERS TURN SERVICES LOUISIANA

PROPOSED NEW BARGE HOLDING AREA

VICINITY MAP, AREA MAP & NOTES

DATE AUG. '21
DESIGN NPL
DRAWN ADG
CHECK JDM
JOB NO 10828
SHEET No.
1 OF 6

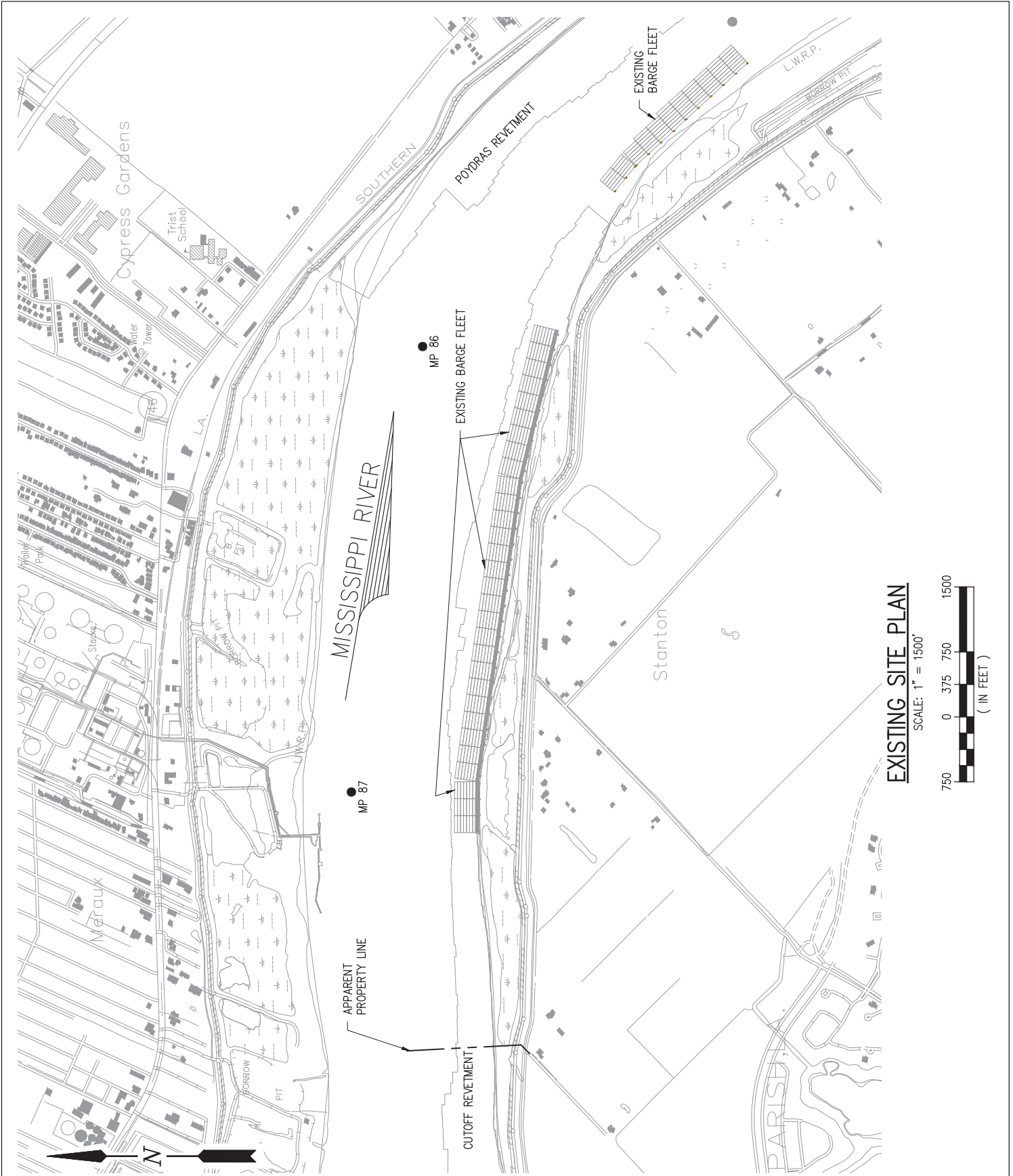

EXISTING SITE PLAN

SCALE: 1" = 1500'



JOSEPH E. JACQUAT
LA PE #21953

PRELIMINARY - FOR PERMIT PURPOSES ONLY

REV
A



LANIER & ASSOCIATES
CONSULTING ENGINEERS
INCORPORATED

LA: EF-1120 TX: F-2981
NEW ORLEANS • BEAUMONT • CORPUS CHRISTI • HOUSTON

ALGIERS

TURN SERVICES

LOUISIANA

PROPOSED NEW BARGE HOLDING AREA

EXISTING SITE PLAN

DATE AUG. '21
DESIGN NPL
DRAWN ADG
CHECK JDM
JOB NO 10828
SHEET No.

2 OF 6

MP 87

MISSISSIPPI RIVER

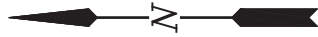

NO FLEETING TO BE ALLOWED WITHIN
PROPOSED BARGE HOLDING AREA.
BARGE HOLDING AREA WILL BE LIMITED
TO A WIDTH OF 220'.

PROPOSED NEW BARGE
HOLDING AREA

EXISTING BARGE FLEET

PROPOSED NEW MONOPILE
(24 TYP.)

CUTOFF REVEITEMENT

APPARENT LEASE LIMIT

USACE MON. 478+39.7

PROPOSED NEW SITE PLAN

SCALE: 1" = 400'



JOSEPH E. JACQUAT
LA PE #21953

PRELIMINARY - FOR PERMIT PURPOSES ONLY

REV
A



LANIER & ASSOCIATES
CONSULTING ENGINEERS
INCORPORATED

LA: EF-1120 TX: F-2981
NEW ORLEANS • BEAUMONT • CORPUS CHRISTI • HOUSTON

ALGIERS

TURN SERVICES

LOUISIANA

PROPOSED NEW BARGE HOLDING AREA
PROPOSED NEW SITE PLAN

DATE AUG. '21
DESIGN NPL
DRAWN ADG
CHECK JDM
JOB NO 10828
SHEET No.

3 OF 6

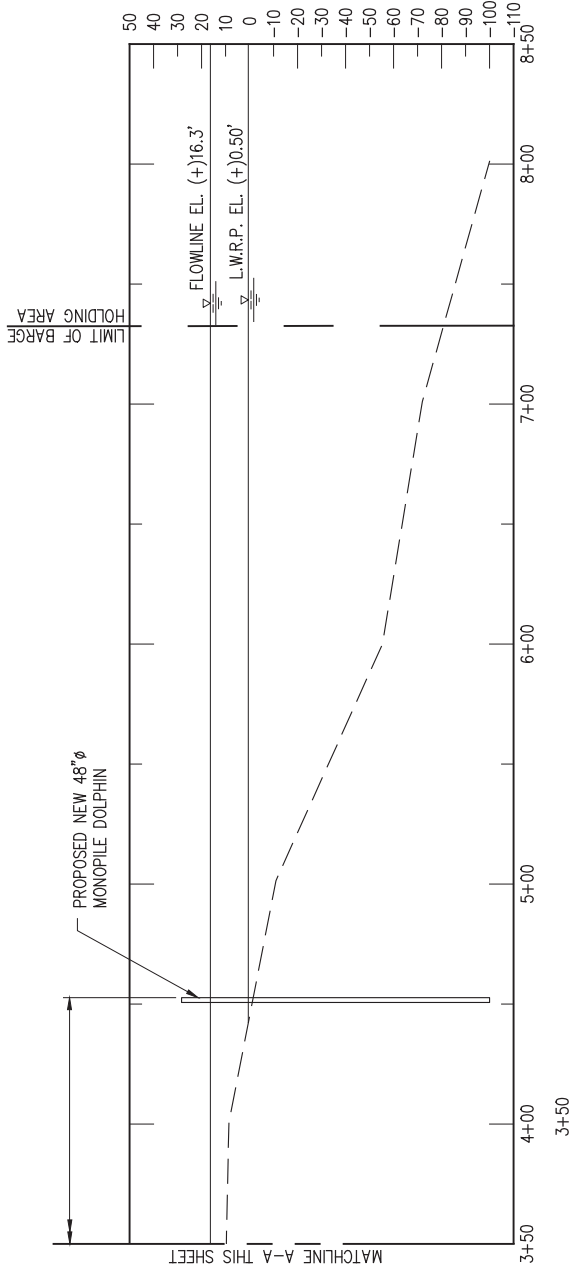
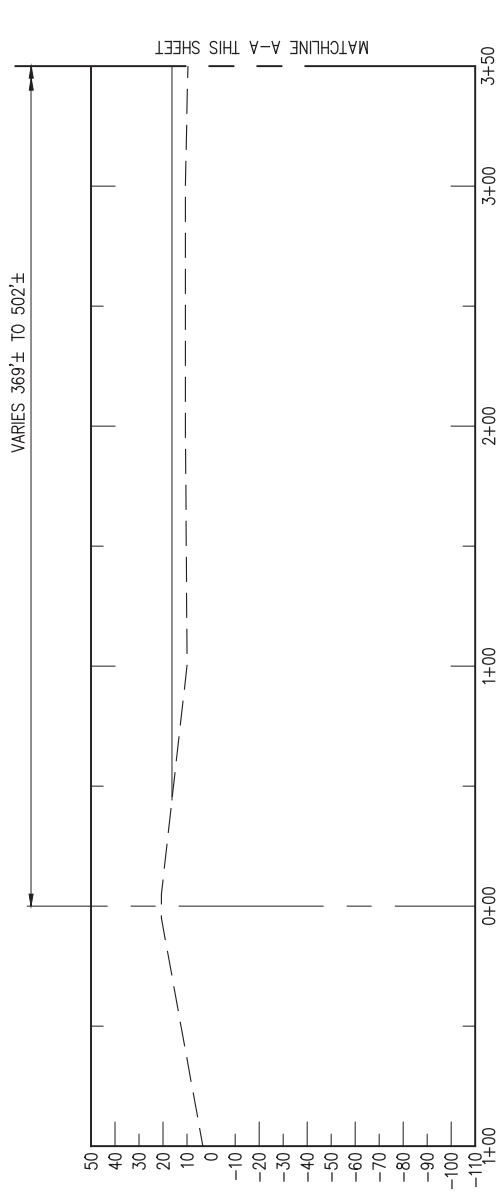

SECTION AT USACE MONUMENT 462+37.5

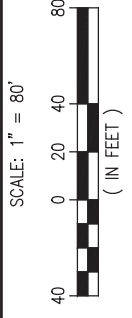

JOSEPH E. JACQUAT
LA PE #21953

PRELIMINARY - FOR PERMIT PURPOSES ONLY

REV
A



LANIER & ASSOCIATES
CONSULTING ENGINEERS
INCORPORATED
LA: EF-1120 TX: F-2981
NEW ORLEANS • BEAUMONT • CORPUS CHRISTI • HOUSTON

ALGIERS TURN SERVICES LOUISIANA

PROPOSED NEW BARGE HOLDING AREA
SECTION AT USACE MONUMENT 462+37.5

DATE AUG. '21
DESIGN NPL
DRAWN ADG
CHECK JDM
JOB NO 10828
SHEET No.
4 OF 6

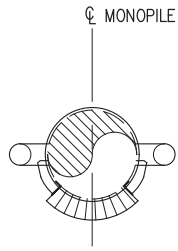

MONOPILE - PLAN

SCALE: 1/8" = 1'-0"

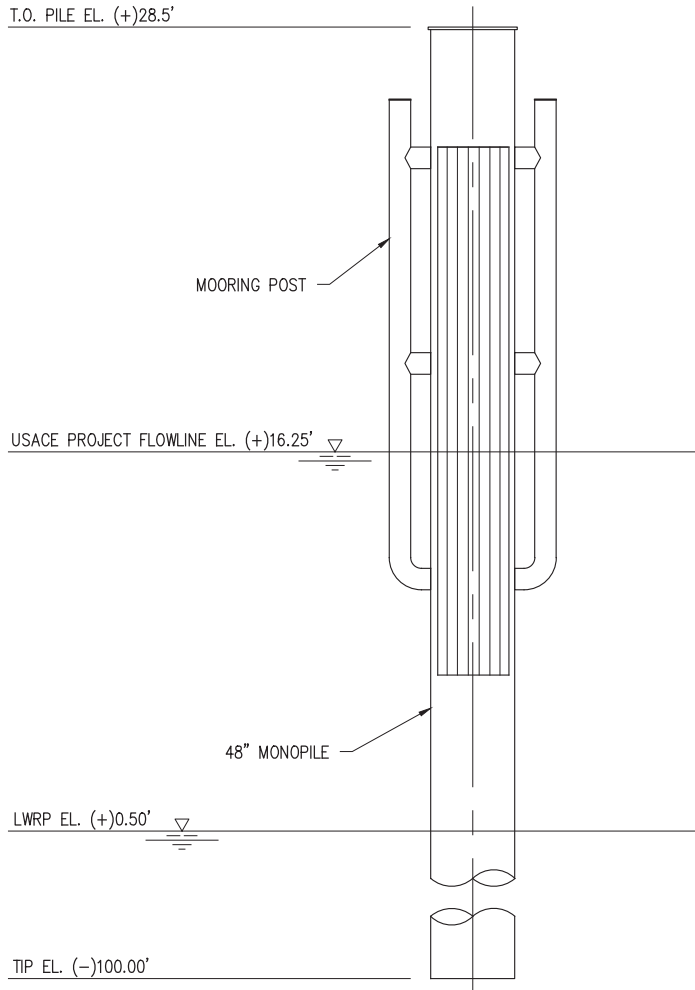

MONOPILE - ELEVATION

SCALE: 1/8" = 1'-0"

J:\100005\10828 TURN SERVICES BARGE FLEET EXPANSION\DRAWINGS\02-STANTON PLANTATION\10828-02-P5.DWG

JOSEPH E. JACQUAT
LA PE #21953

PRELIMINARY - FOR PERMIT PURPOSES ONLY

REV
A



LANIER & ASSOCIATES
CONSULTING ENGINEERS
INCORPORATED

LA: EF-1120 TX: F-2981
NEW ORLEANS • BEAUMONT • CORPUS CHRISTI • HOUSTON

ALGIERS TURN SERVICES LOUISIANA

PROPOSED NEW BARGE HOLDING AREA
PROPOSED NEW MONOPILE
PLAN AND ELEVATION

DATE AUG. '21
DESIGN NPL
DRAWN ADG
CHECK JDM
JOB NO 10828
SHEET No.

5 OF 6

PILE

CAISSON

SPUD PILE (BUOY AND ANCHOR CHAIN)

PILE CLUSTER

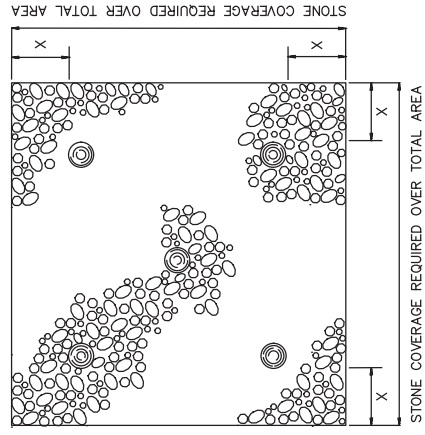
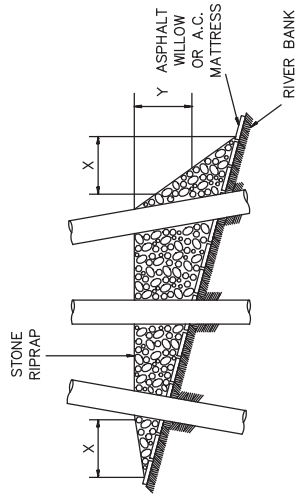
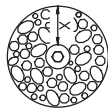
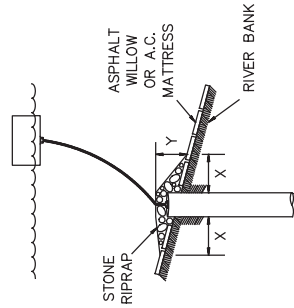
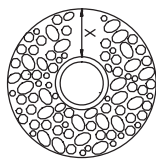
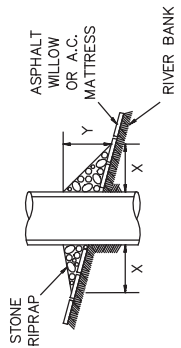
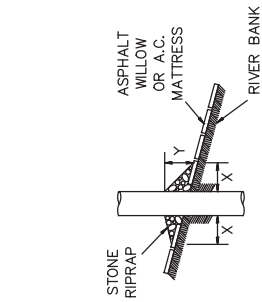

NOTES:

1. SIZE OF RIPRAP TO VARY BETWEEN 6 POUNDS AND 125 POUNDS WITH 40 PERCENT TO 60 PERCENT OF THE STONE WITHIN THE RANGE OF 25 POUNDS TO 75 POUNDS.
2. WHEN PENETRATING THE UPPER BANK PAVING IN A REVETMENT AREA WITH PILES, CAISSONS AND/OR PILE CLUSTERS, A 10 INCH THICK RIPRAP STONE LAYER SHALL BE PLACED OVER ALL AREAS WHERE THE BANK PAVING IS DISTURBED BY DRIVING OPERATIONS.
3. WHEN USING AN ANCHOR CHAIN AND BUOY SYSTEM, THE ANCHOR CHAIN MUST BE ATTACHED AT THE TOP OF THE PILE TO MINIMIZE REVETMENT DAMAGE.

DEPTH OF WATER IN FEET AT POINT OF PENETRATION AT TIME OF STONE PLACEMENT	DIMENSIONS IN FEET FOR PROTECTION AREA REQUIRED									
	PILE		CAISSON			SPUD PILE (BUOY AND ANCHOR CHAIN)			PILE CLUSTER	
	X	Y	X	Y	X	Y	X	Y	X	Y
1' - 10'	3	1.5	5	2					3	1
11' - 40'	5	2	8	3	7	3	6	2		
41' - 60'	8	3	12	4	12	4	10	3		

JOSEPH E. JACQUAT
LA PE #21953

PRELIMINARY - FOR PERMIT PURPOSES ONLY

REV A



LANIER & ASSOCIATES
CONSULTING ENGINEERS
INCORPORATED
LA: EF-1120 TX: F-2981
NEW ORLEANS • BEAUMONT • CORPUS CHRISTI • HOUSTON

ALGIERS TURN SERVICES LOUISIANA

PROPOSED NEW BARGE HOLDING AREA
USACE REVETMENT REPAIR DETAILS

DATE AUG. '21
DESIGN NPL
DRAWN ADG
CHECK JDM
JOB NO 10828
SHEET No.
6 OF 6