

PUBLIC NOTICE

January 10, 2022

United States Army
Corps of Engineers
New Orleans District
Attn: Regulatory Division
7400 Leake Avenue
New Orleans, Louisiana 70118

State of Louisiana
Department of Environmental Quality
Attn: Office of Environmental Services
Post Office Box 4313
Baton Rouge, Louisiana 70821-4313

(504) 862-2301
Project Manager: Dirreen Arnold
dirreen.s.arnold@usace.army.mil
Permit Application Number:
MVN-2021-01162-CA

(225) 219-3225
Project Manager: Elizabeth Hill
WQC Application Number:
WQC-211228-01

Interested parties are hereby notified that a permit application has been received by the New Orleans District of the US Army Corps of Engineers pursuant to: **[X]** Section 10 of the Rivers and Harbors Act of March 3, 1899 (30 Stat. 1151; 33 USC 403), **[X]** Section 404 of the Clean Water Act (86 Stat. 816; 33 USC 1344).

PROPOSED BULKHEAD AND COVERED BOAT HOUSE ALONG THE OLD AMITE RIVER ASCENSION PARISH

NAME OF APPLICANT: JEFF BRAUD, c/o Jerry Hanna, Kingfisher Construction, 11744 River Highlands Drive, Saint Amant, Louisiana 70774.

LOCATION OF WORK: Old Amite River, left descending bank, located at 13822 Calle Sevario Street, Prairieville, Louisiana, (30.338291, -90.859005), in Ascension Parish, as shown on the enclosed drawings, within Hydrologic Unit Code 08070202, Lower Mississippi – Lake Maurepas Watershed.

CHARACTER OF WORK: The applicant has requested Department of the Army authorization to excavate approximately 12.7 cubic yards of waterbottom material, and to install and maintain approximately 114 linear feet of bulkhead and place the excavated material along with approximately 38 cubic yards of hauled in topsoil behind the bulkhead for stabilization. In addition, the applicant has requested to install and maintain a 33-ft x 18-ft (594-ft²) covered boat house along the left descending bank of the Amite River, all for private recreational purposes. The proposed structures will extend approximately 18 feet channelward where the waterway's width is approximately 125 feet wide. Approximately 38 cubic yards of hauled in topsoil along with the excavated material will be placed behind the bulkhead for stabilization. No direct impacts to vegetated wetlands are expected and no mitigation is anticipated.

The comment period for the Department of the Army Permit will close **20 days** from the date of this public notice. Written comments, including suggestions for modifications or objections to the proposed work, stating reasons thereof, are being solicited from anyone having interest in this permit must be mailed so as to be received before or by the last day of the

comment period. Letters concerning the Corps of Engineers permit -application must reference the applicant's name and the Permit Application Number, and be mailed to the Corps of Engineers at the address above, **ATTENTION: REGULATORY DIVISION, RG-C, Dirreen Arnold**. Individuals or parties may request an extension of time in which to comment on the proposed work by writing or e-mailing the Corps of Engineers Project Manager listed above. Any request must be specific and substantively supportive of the requested extension, and received by this office prior to the end of the initial comment period. The Branch Chief will review the request and the requestor will be promptly notified of the decision to grant or deny the request. If granted, the time extension will be continuous to the initial comment period and inclusive of the initial comment period, will not exceed a total of 30 calendar days.

Corps of Engineers Permit Criteria

The decision whether to issue a permit will be based on an evaluation of the probable impacts, including cumulative impacts of the proposed activity on the public interest. That decision will reflect the national concern for both protection and utilization of important resources. The benefit which reasonably may be expected to accrue from the proposal must be balanced against its reasonably foreseeable detriments. All factors which may be relevant to the proposal will be considered including the cumulative effects thereof; among those are conservation, economics, aesthetics, general environmental concerns, wetlands, historic properties, fish and wildlife values, flood hazards, floodplain values, land use, navigation, shoreline erosion and accretion, recreation, water supply and conservation, water quality, energy needs, safety, food and fiber production, mineral needs, considerations of property ownership and, in general, the needs and welfare of the people.

The U.S. Army Corps of Engineers is soliciting comments from the public, federal, state, and local agencies and officials, Indian Tribes, and other interested parties in order to consider and evaluate the impacts of this proposed activity. Any comments received will be considered by the U.S. Army Corps of Engineers to determine whether to make, modify, condition, or deny a permit for this proposal. To make this decision, comments are used to assess impacts on endangered species, historic properties, water quality, general environmental effects, and other public interest factors listed above. Comments are used in the preparation of an Environmental Assessment and/or an Environmental Impact Statement pursuant to the National Environmental Policy Act. Comments are also used to determine the need for a public hearing and to determine the overall public interest of the proposed activity.

The New Orleans District is unaware of properties listed on the National Register of Historic Places near the proposed work. The possibility exists that the proposed work may damage or destroy presently unknown archeological, scientific, pre-historical, historical sites, or data. Issuance of this public notice solicits input from the State Archeologist and State Historic Preservation Officer regarding potential impacts to cultural resources.

Utilizing the Information & Planning Consultation for Endangered Species in Louisiana (IPaC), dated January 27, 2020, between the U.S. Army Corps of Engineers, New Orleans and U.S. Fish and Wildlife Service, Ecological Services Office, the Corps has determined that the proposed action is consistent with a determination of “no effect” or “may affect, but not likely to adversely affect (NLAA)” the threatened West Indian Manatee (*Trichechus manatus*) along with a “no effect” to the endangered Red-cockaded woodpecker (*Picoides borealis*).

This notice initiates the Essential Fish Habitat (EFH) consultation requirements of the Magnuson-Stevens Fishery Conservation and Management Act. The applicant's proposal may result in the destruction or alteration of 0.014 acres of EFH utilized by various life stages of red drum and penaeid shrimp. Our initial determination is that the proposed action would not have a substantial adverse impact on EFH or federally managed fisheries in the Gulf of Mexico. Our final determination relative to project impacts and the need for mitigation measures is subject to review by and coordination with the National Marine Fisheries Service.

Any person may request, in writing, within the comment period specified in this notice, that a public hearing be held to consider this application. Requests for public hearings shall state, with particularity, the reasons for holding a public hearing.

The applicant has certified that the proposed activity described in the application complies with and will be conducted in a manner that is consistent with the Louisiana Coastal Resources Program. The Department of the Army permit will not be issued unless the applicant received approval or a waiver of the Coastal Use Permit by the Department of Natural Resources.

You are requested to communicate the information contained in this notice to any other parties whom you deem likely to have interest in the matter.

JOHN M. HERMAN
Chief, Central Evaluation Branch



13822 Calle Sevario St

Jeff Braud 13822 Callie Sevario Rd. Lot 17A

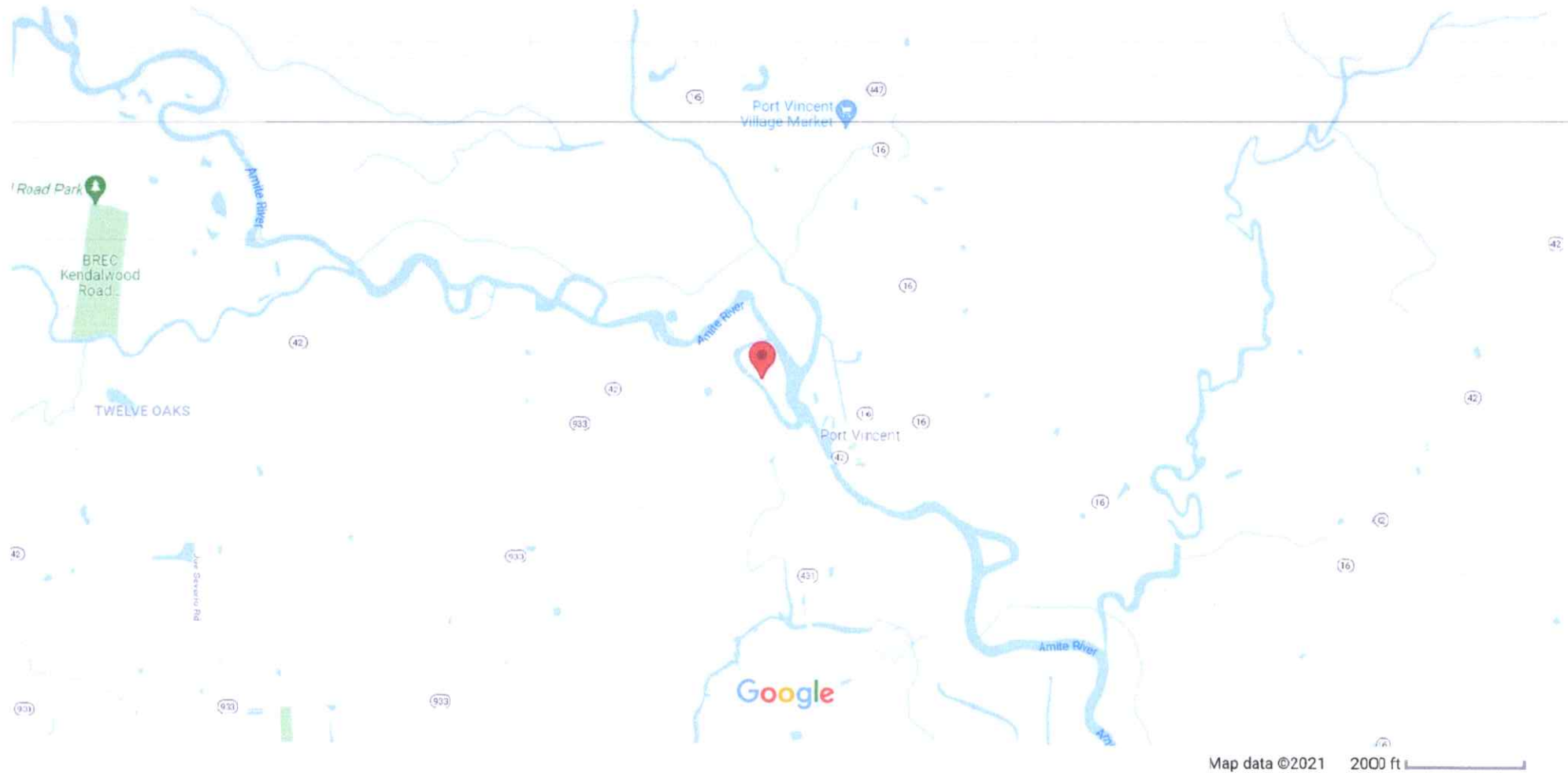

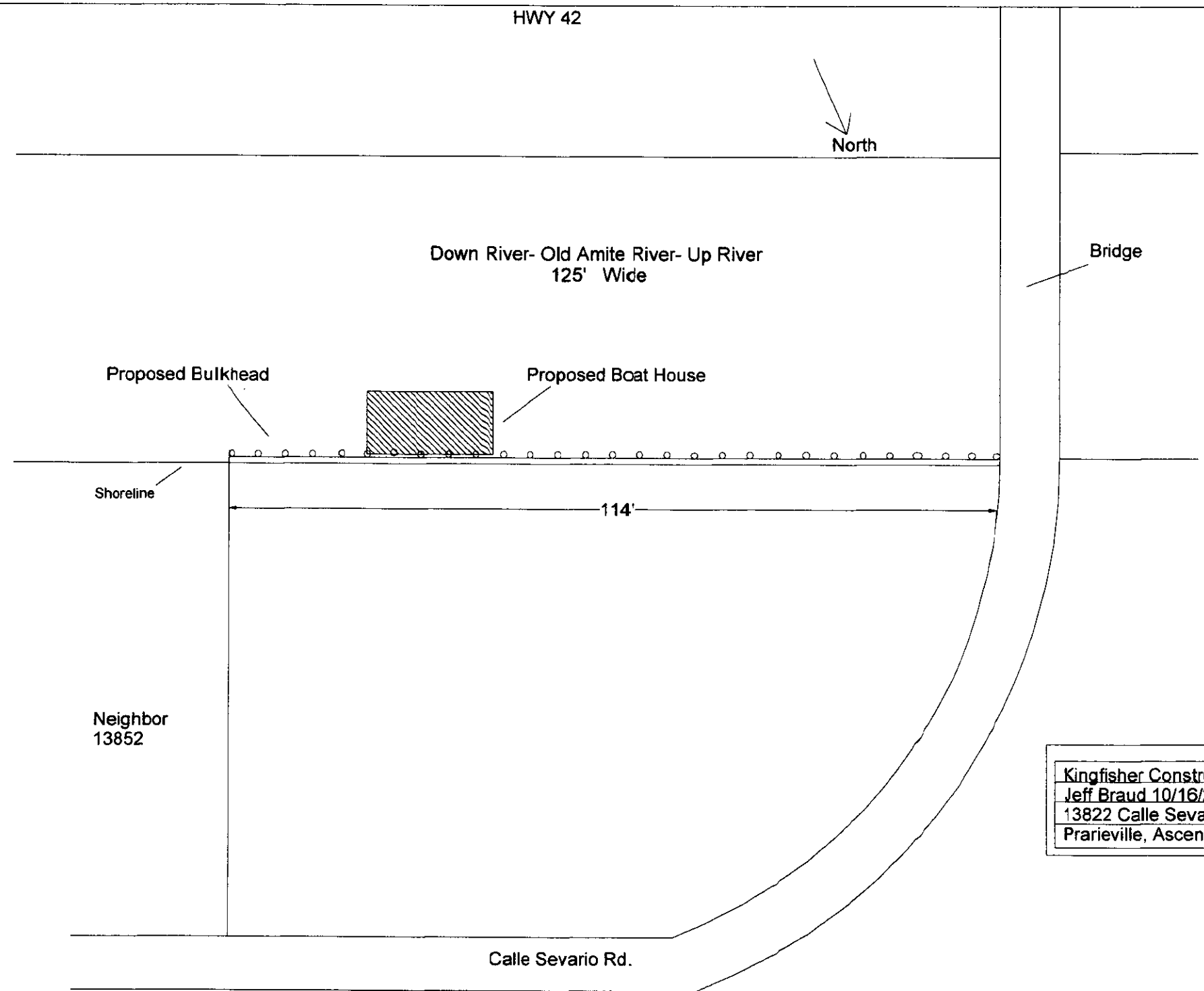

Kingfisher Construction LLC
Jeff Braud 10/16/21
13822 Calle Sevario St. Lot 17 A.
Prarieville, Ascension Parish

Down River- Old Amite River - Up River
125' to opposite bank

All treated wood materials

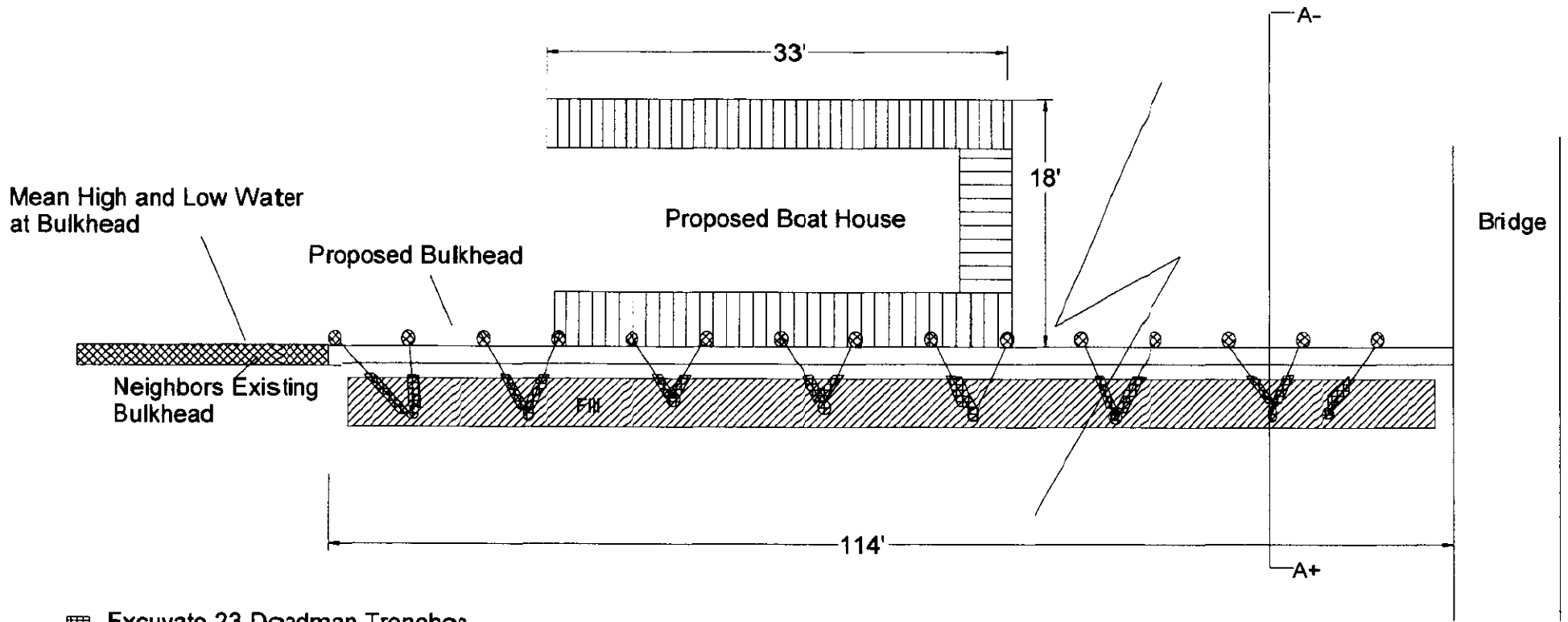

Mean High and Low Water
at Bulkhead

Proposed Bulkhead

Proposed Boat House

Bridge

Neighbors Existing
Bulkhead

Fill

114'

A+

- Excavate 23 Deadman Trenches
 1'D, x1'W, x15'L = 12.7 Cu Yards
- Bulkhead back fill Area = 38 Cu Yards of Hauled In Dirt.
 114 'L x 3'D next to bulkhead, 6' W at
 Surface, x 0' W at Bottom
 Plus the trenches will be refilled with their 12.7 Cu Yd of excavation.
 Total = 50.7 Cu Yds of Fill

Kingfisher Construction LLC
Jeff Braud 10/16/21
13822 Calle Sevario St. Lot 17A
Prairieville, Ascension Parish

Note: Construction Barge and Boat are less than 1' Draft

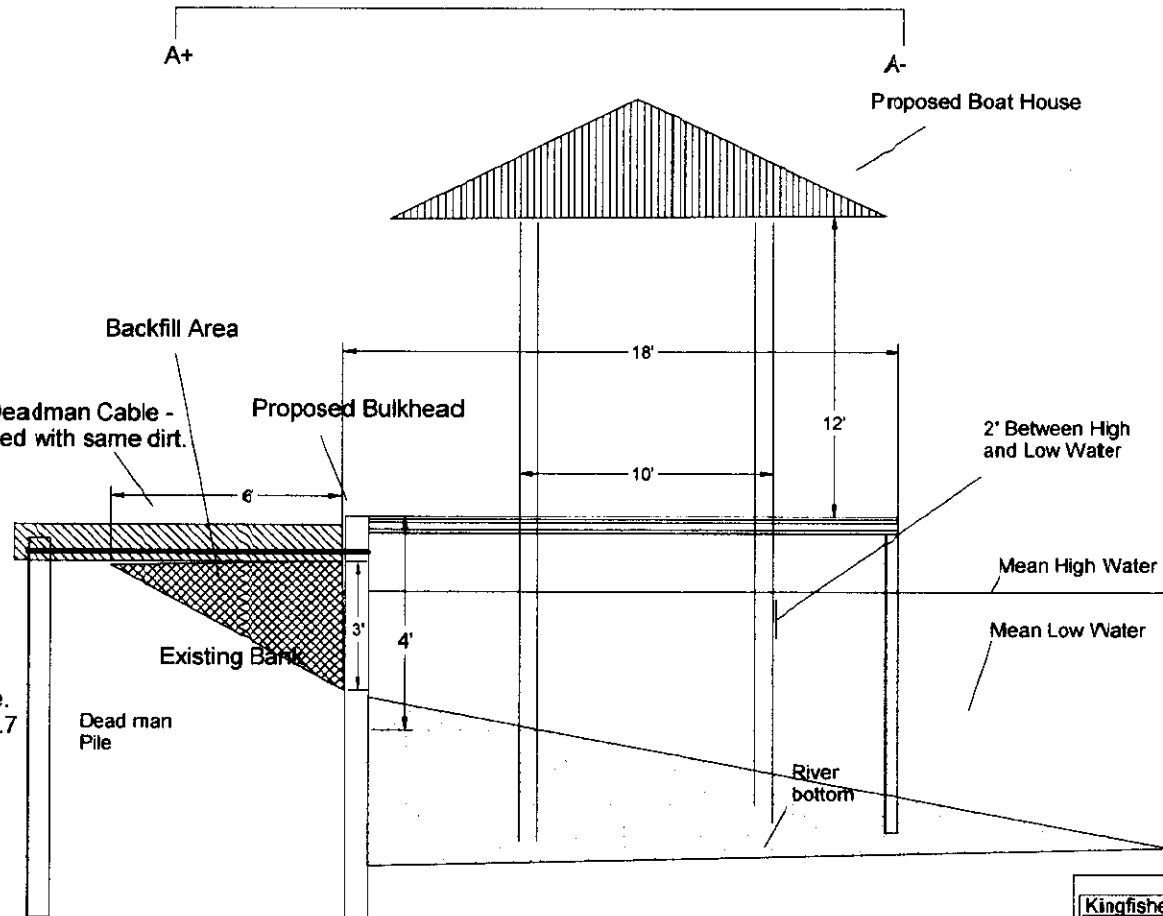

Excavate 23 Deadmen Trenches
1' Deep x 1'Wide x 15' Long =12.7 Cu Yds.

Bulkhead Backfill Area =38 Cu Yards
of Hauled in Dirt 114'L x 3'D x 6'W at surface.
Plus the trenches will be refilled with their 12.7
of excavation Total =50.7 Cu Yds of Fill

Kingfisher Construction LLC
Jeff Braud 10/16/21
13822 Calle Sevario St. L of 17 A
Prarieville, Ascension Parish

Permit Plat Notes

1. As built drawings and/or plats shall have written on them the date of completion of said activities and shall be submitted to the Louisiana Department of Natural Resources, Office of Coastal Management, P.O. Box 44487, Baton Rouge, La 70804-4487 within 30 days following project completion.
2. All structures built under the authorization and conditions of this permit shall be removed from the site within 120 days of abandonment of the facilities for the herein permitted use, or when these structures fall into state of disrepair such that they can no longer function as intended. This condition does not preclude the necessity for revising the current permit or obtaining a separate Coastal Use Permit, should one be required, for such removal activities.
3. Structures must also be marked/lighted in accordance with U.S. Coast Guard regulations.
4. In order to ensure the safety of all parties, the permittee shall contact the Louisiana One Call System (1-800-272-3020) a minimum of 48 hours prior to the commencement of any excavation (digging, dredging, jetting, etc.) or demolition activity.

Kingfisher Construction LLC
Jeff Braud 10/16/21
13822 Calie Sevario St. Lot 17A
Prarieville, Ascension Parish