

PUBLIC NOTICE

November 8, 2021

United States Army
Corps of Engineers
New Orleans District
Attn: Regulatory Division
7400 Leake Avenue
New Orleans, Louisiana 70118

(504) 862-2301
Project Manager: Dirreen Arnold
dirreen.s.arnold@usace.army.mil
Permit Application Number: MVN-2021-01069-CA

Interested parties are hereby notified that a permit application has been received by the New Orleans District of the US Army Corps of Engineers pursuant to: **[X]** Section 10 of the Rivers and Harbors Act of March 3, 1899 (30 Stat. 1151; 33 USC 403), **[X]** Section 404 of the Clean Water Act (86 Stat. 816; 33 USC 1344).

PROPOSED 2-BOAT CAPACITY BOAT HOUSE AND BULKHEAD **AMITE RIVER, LIVINGSTON PARISH**

NAME OF APPLICANT: ROBERT IGLESIAS, 14056 Mill Settlement Trace, Denham Springs, Louisiana 70726.

LOCATION OF WORK: Amite River, left descending bank, Lot #32 Old Mill Settlement, located at 14065 Mill Settlement Trace, Port Vincent, Louisiana, (30.318969, -90.836338), in Livingston Parish, as shown on the enclosed drawings, within Hydrologic Unit Code 08070202, Lower Mississippi – Lake Maurepas Watershed.

CHARACTER OF WORK: The applicant has requested Department of the Army authorization to excavate approximately 277 cubic yards of water bottom material in order to create two (2) boat slips; install and maintain approximately 100 linear feet of wooden bulkhead, a 35-ft x 22-ft deck and two (2) 35-ft x 8-ft piers, in order to create a 35-ft x 60-ft covered boat house within the Amite River, all for private recreational purposes. The structures will extend approximately 35 feet channelward where the Amite River's width is approximately 276 feet wide. Approximately 0.05 acre of unvegetated waterbottoms will be impacted with the proposed project. No direct impacts to vegetated wetlands are expected and no mitigation is anticipated.

The comment period for the Department of the Army Permit will close in **15 days** from the date of this public notice. Written comments, including suggestions for modifications or objections to the proposed work, stating reasons thereof, are being solicited from anyone having interest in this permit and must be mailed so as to be received before or by the last day of the comment period. Letters concerning the Corps of Engineers permit application must reference the applicant's name and the Permit Application Number, and be mailed to the Corps of Engineers at the address above, **ATTENTION: REGULATORY DIVISION**. Individuals or parties may request an extension of time in which to comment on the proposed work by writing or e-mailing the Corps of Engineers Project Manager listed above. Any request must be specific and substantively supportive of the requested extension and received by this office prior to the end of the initial comment period. The Section Chief will review the request and the requestor will be promptly notified of the decision to grant or deny the request. If granted, the time extension will be continuous to the initial comment period and, inclusive of the initial comment period, will not exceed a total of 30 calendar days.

Corps of Engineers Permit Criteria

The decision whether to issue a permit will be based on an evaluation of the probable impacts, including cumulative impacts of the proposed activity on the public interest. That decision will reflect the national concern for both protection and utilization of important resources. The benefit which reasonably may be expected to accrue from the proposal must be balanced against its reasonably foreseeable detriments. All factors which may be relevant to the proposal will be considered including the cumulative effects thereof; among those are conservation, economics, aesthetics, general environmental concerns, wetlands, historic properties, fish and wildlife values, flood hazards, floodplain values, land use, navigation, shoreline erosion and accretion, recreation, water supply and conservation, water quality, energy needs, safety, food and fiber production, mineral needs, considerations of property ownership and, in general, the needs and welfare of the people.

The U.S. Army Corps of Engineers is soliciting comments from the public, federal, state, and local agencies and officials, Indian Tribes, and other interested parties in order to consider and evaluate the impacts of this proposed activity. Any comments received will be considered by the U.S. Army Corps of Engineers to determine whether to make, modify, condition, or deny a permit for this proposal. To make this decision, comments are used to assess impacts on endangered species, historic properties, water quality, general environmental effects, and other public interest factors listed above. Comments are used in the preparation of an Environmental Assessment and/or an Environmental Impact Statement pursuant to the National Environmental Policy Act. Comments are also used to determine the need for a public hearing and to determine the overall public interest of the proposed activity.

The New Orleans District is unaware of properties listed on the National Register of Historic Places near the proposed work. The possibility exists that the proposed work may damage or destroy presently unknown archeological, scientific, pre-historical, historical sites, or data. Issuance of this public notice solicits input from the State Archeologist and State Historic Preservation Officer regarding potential impacts to cultural resources.

Our initial finding is that the proposed work would not affect any species listed as endangered by the U.S. Department of Interior, nor affect any habitat designated as critical to the survival and recovery of any endangered species.

Utilizing the Information & Planning Consultation for Endangered Species in Louisiana (IPaC), dated January 27, 2020, between the U.S. Army Corps of Engineers, New Orleans and U.S. Fish and Wildlife Service, Ecological Services Office, the Corps has determined that the proposed action is consistent with a determination of “no effect” or “may affect, but not likely to adversely affect (NLAA)” the threatened West Indian Manatee (*Trichechus manatus*) along with a “no effect” to the endangered Red-cockaded woodpecker (*Picoides borealis*).

This notice initiates the Essential Fish Habitat (EFH) consultation requirements of the Magnuson-Stevens Fishery Conservation and Management Act. The applicant's proposal may result in the destruction or alteration of 0.05 acres of EFH utilized by various life stages of red drum and penaeid shrimp. Our initial determination is that the proposed action would not have a substantial adverse impact on EFH or federally managed fisheries in the Gulf of Mexico. Our final determination relative to project impacts and the need for mitigation measures is subject to review by and coordination with the National Marine Fisheries Service.

Any person may request, in writing, within the comment period specified in this notice, that a public hearing be held to consider this application. Requests for public hearings shall state, with particularity, the reasons for holding a public hearing.

The applicant has certified that the proposed activity described in the application complies with and will be conducted in a manner that is consistent with the Louisiana Coastal Resources Program. The Department of the Army permit will not be issued unless the applicant received approval or a waiver of the Coastal Use Permit by the Department of Natural Resources.

You are requested to communicate the information contained in this notice to any other parties whom you deem likely to have interest in the matter.

JOHN M. HERMAN
Chief, Central Evaluation Branch
Regulatory Division

VICINITY MAP

0 250 500 ft

1" = 500'

Cove Ln

Old Mill Settlement Rd

1

6

4



3D



5

Project Site
Lat 30° 19' 8.29"
Long -90° 50' 10.82"

Mill Settlement

Mill Settlement Trace

4

X

1

AMITE RIVER

3

Summerfield Rd S

4

S

Bulkhead of Boat Slip/Dredgeat Fill

③ = Dredge Dimensions

P# P20210868

Cross Section
A-A'

①

Boathouse Roof will be Metal 39'x62'
Bulkhead Material will be Wood.

Wharf of Boat Slud with dredge

③ = Structure dimensions
⑩ = Existing + Proposed water depths

Dredge Area

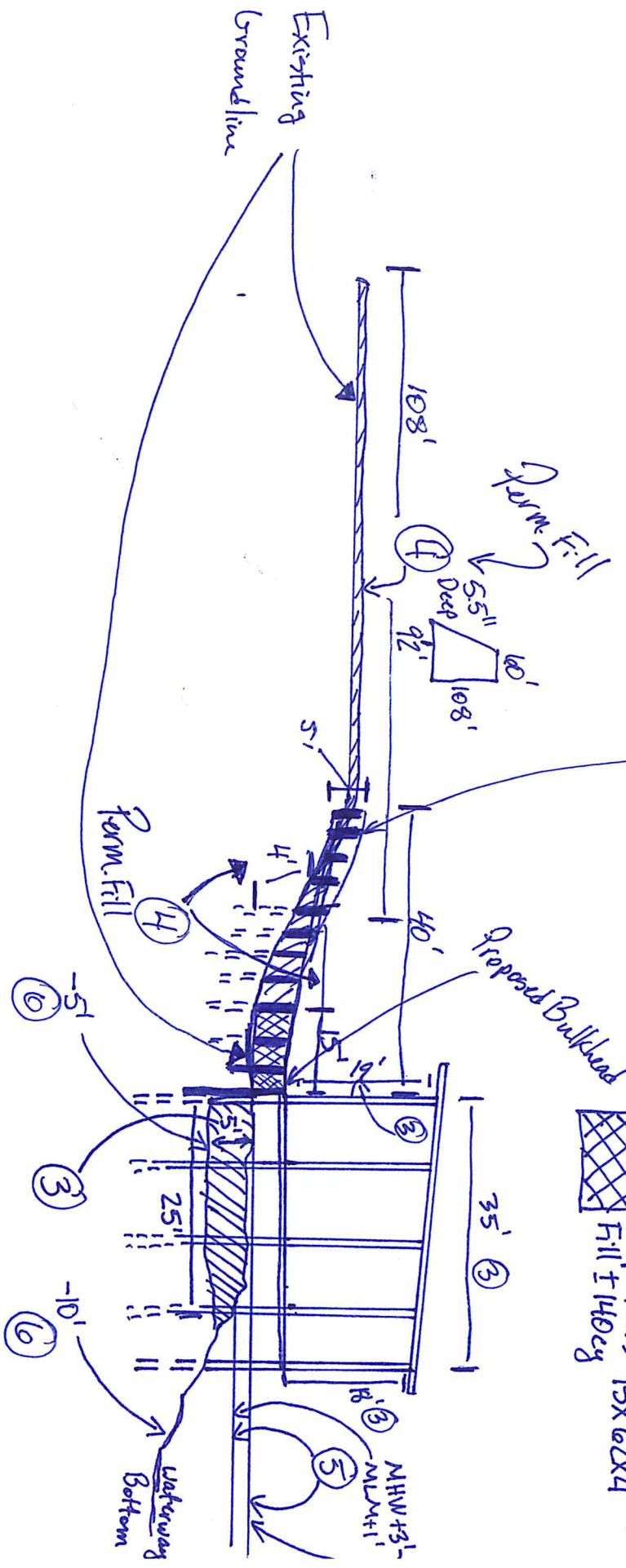
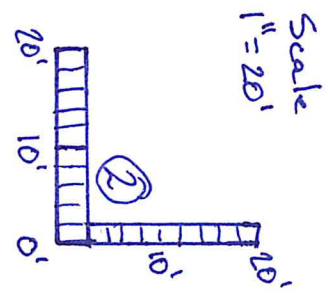
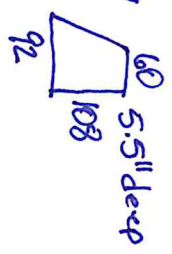
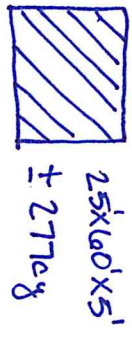

Plan View P#20210868

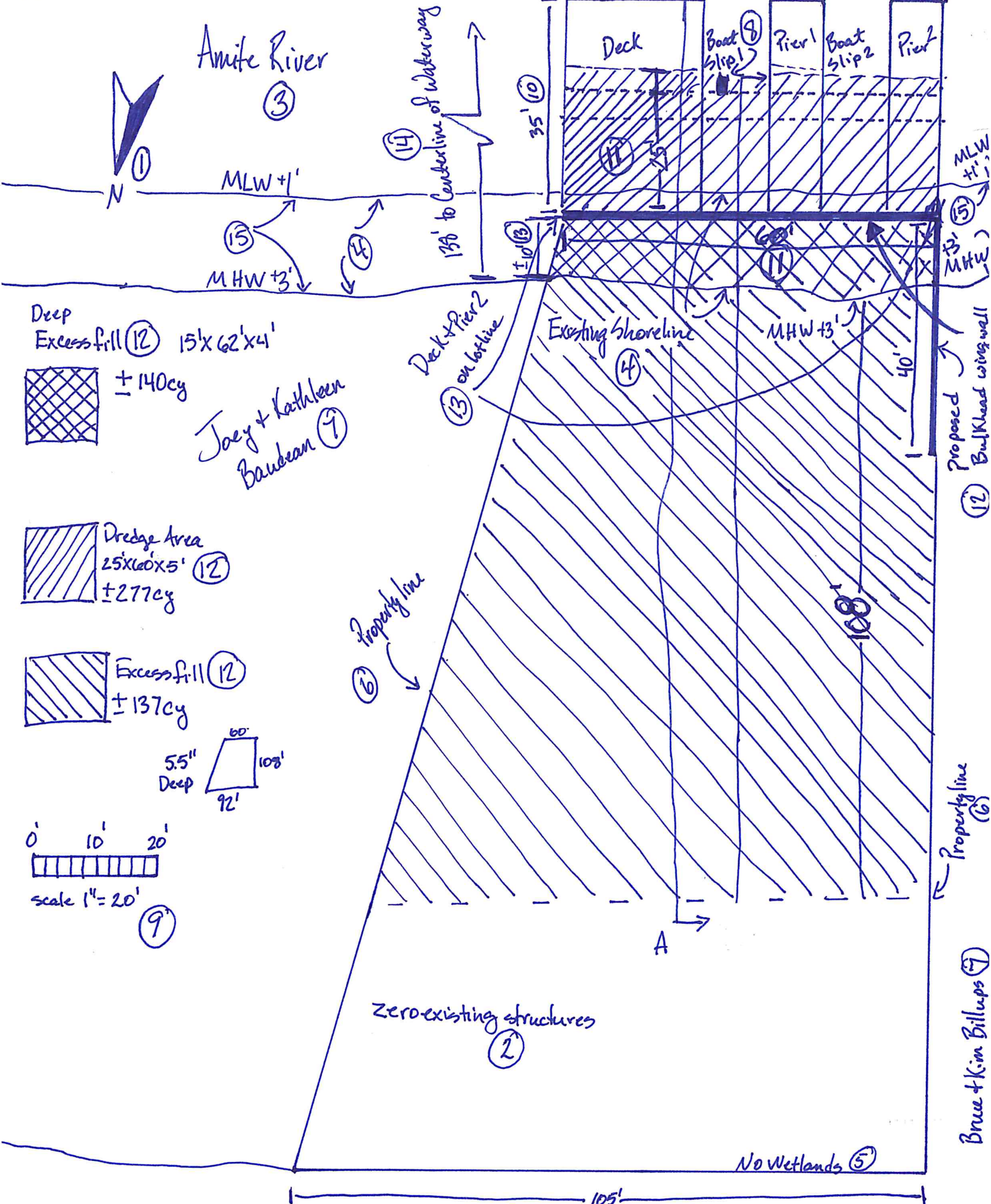

Amite River (3)

N (1)

MLW +1'

MHW +3'

130' to Centerline of Waterway (14)

Deep Excess fill (12) 15' x 62' x 4'

± 140cy

Joey + Kathleen Baudreau (7)

Dredge Area 25' x 60' x 5' (12)

± 277cy

Excess fill (12) ± 137cy

5.5" Deep

60' 103' 92'

0' 10' 20'

scale 1" = 20'

(9)

Property line (6)

Zero-existing structures (2)

No Wetlands (5)

22' (10) 11' (10) 3' (10) 11' (10) 3' (10)

35' (10)

Deck

Boat Slip 1 (9)

Pier 1

Boat Slip 2

Pier 2

11' (10)

13' MHW

15' (10)

MLW +1'

Deck + Pier 2 on lot line (13)

Existing shoreline (4)

MHW +3'

Proposed Bulkhead wing wall (12)

Property line (6)

Bruce + Kim Billups (7)