



DEPARTMENT OF THE ARMY
U.S. ARMY CORPS OF ENGINEERS, NEW ORLEANS DISTRICT
7400 LEAKE AVE
NEW ORLEANS, LOUISIANA 70118-3651

January 17, 2023

Regulatory Division
Central Evaluation Branch

Project Manager
S. Gail Gainey
(504) 862-1545
Sandra.G.Gainey@usace.army.mil

Application #: MVN-2021-00678-CG

PUBLIC NOTICE

Interested parties are hereby notified that an application has been received by the District engineer for a Department of the Army permit to authorize the following pursuant to (X) Section 10 of the Rivers and Harbors Act of March 3, 1899 (30 Stat. 1151; 33 USC 403); and/or (X) section 404 of the Clean Water Act (86 Stat. 816; 33 USC 1344); and (X) Section 14 of the Rivers and Harbors Act of 1899 (33 U.S.C. Section 408).

PROPOSED LOW CARBON INTENSITY RENEWABLE FUELS PLANT ALONG THE GULF INTRACOASTAL WATERWAY IN WEST BATON ROUGE PARISH

NAME OF APPLICANT: Gron Fuels, LLC. c/o Elliot Boudreaux of CSRS, Inc., 8555 United Plaza Blvd., Baton Rouge, LA 70809.

LOCATION OF WORK: At mile marker 62 on the GIWW, in Sections 12, 28, 94, 95, 96, 98, and 99, Township 7 South, Range 12 East, along North Line Road in Port Allen, Louisiana, in West Baton Rouge Parish, within the Terrebonne Basin in hydrologic unit (HUC 08070300), as shown on the attached drawings (Latitude 30.438961 N, Longitude -91.234305 W).

CHARACTER OF WORK: The applicant has requested Department of the Army authorization to clear, grade, excavate, dredge, and deposit fill and/or aggregate material to construct and maintain a renewable fuels manufacturing facility to include a renewable feedstock pretreatment unit, hydrogen plant, hydroprocessing unit, feedstock and finished product tank farms, loading/unloading facilities, substation, retention pond, wastewater treatment facility, supporting utility systems, and administration building. In addition to the facility, the project includes installation of an approx. 2.5-mile pipeline corridor, three onsite water wells to be drilled into the Mississippi Alluvial Aquifer, and construction of a marine terminal along the GIWW. Approximately 115,000 cubic yards of material would be dredged from the GIWW and redeposited to an onsite placement area. Approx. 1,930 cubic yards of stone and approx. 3,575 cubic yards of limestone and earthen fill will be hauled in and deposited to construct structures and achieve required grade elevation requirements. The proposed project would impact approx. 2.48 acres of jurisdictional wetlands, 8.67 acres of traditionally navigable waters, and 953 linear feet of non-wetland waters of the U.S. This project proposes a tie-in

with the West Baton Rouge Parish Treatment Facility which is being evaluated for a separate authorization (MVN-2021-00382-CQ) and abuts the proposed Port of Greater Baton Rouge Rail Chambering Yard also under separate evaluation (MVN-2022-00593-CG).

The applicant proposes to avoid additional direct impacts and minimize secondary impacts to the maximum extent practicable by avoiding jurisdictional wetlands in the design of the main facility, limiting the construction activity to the designated construction areas onsite, utilizing rip rap and silt fencing utilize during construction as temporary erosion control measures and including sheet piles, armored cut slope, and rip rap as permanent erosion and scour control measures along the GIWW, sharing a wastewater effluent corridor with West Baton Rouge Parish to further reduce impacts and disposing of all cleared vegetation onsite within upland project areas. If authorized, the project will receive approval from all appropriate local drainage authorities. As compensation for unavoidable wetland impacts, the applicant proposes to use a Corps approved mitigation bank within the watershed of impact

The comment period for the Department of Army will close in **20 days** from the date of this public notice. Written comments, including suggestions for modifications or objections to the proposed work, stating reasons thereof, are being solicited from anyone having interest in this permit must be mailed so as to be received before or by the last day of the comment period. Letters and/or comments concerning the subject permit application must reference the applicant's name and the Permit Application Number and preferably emailed to the Corps of Engineers project manager listed above or forwarded to the Corps of Engineers at the address above, **ATTENTION: REGULATORY DIVISION, RGC, S. Gail Gainey**. Individuals or parties may request an extension of time in which to comment on the proposed work by writing or e-mailing the Corps of Engineers Project Manager listed above. Any request must be specific and substantively supportive of the requested extension, and received by this office prior to the end of the initial comment period. The Branch Chief will review the request and the requestor will be promptly notified of the decision to grant or deny the request. If granted, the time extension will be continuous to the initial comment period and inclusive of the initial comment period, will not exceed a total of 30 calendar days. This public notice is also available for review online at <https://go.usa.gov/xennJ>.

Corps of Engineers Permit Criteria

The decision whether to issue a Section 10/404 permit will be based on an evaluation of the probable impacts, including cumulative impacts of the proposed activity on the public interest. That decision will reflect the national concern for both protection and utilization of important resources. The benefit which reasonably may be expected to accrue from the proposal must be balanced against its reasonably foreseeable detriments. All factors which may be relevant to the proposal will be considered including the cumulative effects thereof; among those are conservation, economics, aesthetics, general environmental concerns, wetlands, historic properties, fish and wildlife values, flood hazards, floodplain values, land use, navigation, shoreline erosion and accretion, recreation, water supply and conservation, water quality, energy needs, safety, food and fiber production, mineral needs, considerations of property ownership and, in general, the needs and welfare of the people.

This request will also be reviewed pursuant to Section 408 and USACE Engineering Circular

(EC) 1165-2-220, which provides policy and procedural guidance for processing requests to alter USACE civil works projects. The decision whether to grant permission for the requested alteration will be based on several factors. The benefits that reasonably may be expected to accrue from the proposal will be balanced against its reasonably foreseeable detriments. Review of the requests for modification will be evaluated by a USACE technical review team considering the following factors:

1) Potential to Impair the Usefulness of the Project. Proposed alterations will be reviewed to determine whether the alteration would limit the ability of the USACE project to function as authorized, or would compromise or change any authorized project conditions, purposes or outputs. If USACE determines that the usefulness of the authorized project would be impaired, the request will be denied.

2) Potential to be Injurious to the Public Interest. Proposed alterations will be reviewed to determine the probable impacts, including cumulative impacts, on the public interest. Factors that may be relevant to the public interest depend upon the type of USACE project being altered and may include, but are not limited to, such things as conservation, economic development, historic properties, cultural resources, environmental impacts, water supply, water quality, flood hazards, floodplains, residual risk, induced damages, navigation, shore erosion or accretion, and recreation. This evaluation will consider information received from the interested parties, including tribes, agencies, and the public. The decision whether to approve an alteration will be determined by the consideration of whether benefits are commensurate with risks. If the potential detriments are found to outweigh the potential benefits, then it may be determined that the proposed alteration is injurious to the public interest.

The U.S. Army Corps of Engineers is soliciting comments from the public, federal, state, and local agencies and officials, Indian Tribes, and other interested parties in order to consider and evaluate the impacts of this proposed activity. Any comments received will be considered by the U.S. Army Corps of Engineers to determine whether to make, modify, condition, or deny a permit for this proposal. To make this decision, comments are used to assess impacts on endangered species, historic properties, water quality, general environmental effects, and other public interest factors listed above. Comments are used in the preparation of an Environmental Assessment and/or an Environmental Impact Statement pursuant to the National Environmental Policy Act. Comments are also used to determine the need for a public hearing and to determine the overall public interest of the proposed activity. Further, all factors that may be relevant to the proposal will be considered, including the potential cumulative effects associated with the proposed project. The Section 408 review will consider the potential impact to the usefulness of the Federal project and whether the proposed alteration would be injurious to the public interest. Policy and legal compliance will also be considered.

The New Orleans District utilizes the National Register of Historic Places to identify properties listed on or near the proposed work. The possibility exists that the proposed work may damage or destroy presently unknown archeological, scientific, prehistorical, historical sites, or data. However, extent of coverage and impacts is undetermined at this time pending a National Historic Preservation Act compliance determination. Copies of this notice are made available to the State Archeologist and the State Historic Preservation Officer.

Our initial finding is that the proposed work would neither affect any species listed as endangered by the U.S. Departments of Interior or Commerce, nor affect any habitat designated as critical to the survival and recovery of any endangered species. Utilizing the Information & Planning Consultation for Endangered Species in Louisiana protocol, dated January 27, 2020 between the U.S. Army Corps of Engineers, New Orleans and U.S. Fish and Wildlife Service, Ecological Services Office, the Corps has determined there are no threatened or endangered species, nor any designated or proposed critical habitat that may occur within the boundary of the proposed project.

This notice initiates the Essential Fish Habitat (EFH) consultation requirements of the Magnuson-Stevens Fishery Conservation and Management Act. The applicant's proposal would result in the destruction or alteration of NA acres of EFH utilized by various life stages of red drum and penaeid shrimp. Our initial determination is that the proposed action would not have a substantial adverse impact on EFH or federally managed fisheries in the Gulf of Mexico. Our final determination relative to project impacts and the need for mitigation measures is subject to review by and coordination with the National Marine Fisheries Service.

If the proposed work involves deposits of dredged or fill material into navigable waters, the evaluation of the probable impacts will include the application of guidelines established by the Administrator of the Environmental Protection Agency. Also, a certification that the proposed activity will not violate applicable water quality standards will be required from the Department of Environmental Quality, Office of Environmental Services, before a permit is issued.

Any person may request, in writing, within the comment period specified in this notice, that a public hearing be held to consider this application. Requests for public hearings shall state, with particularity, the reasons for holding a public hearing. You are requested to communicate the information contained in this notice to any other parties whom you deem likely to have interest in the matter.

John M. Herman
Chief, Central Evaluation Branch
Regulatory Division

Enclosures

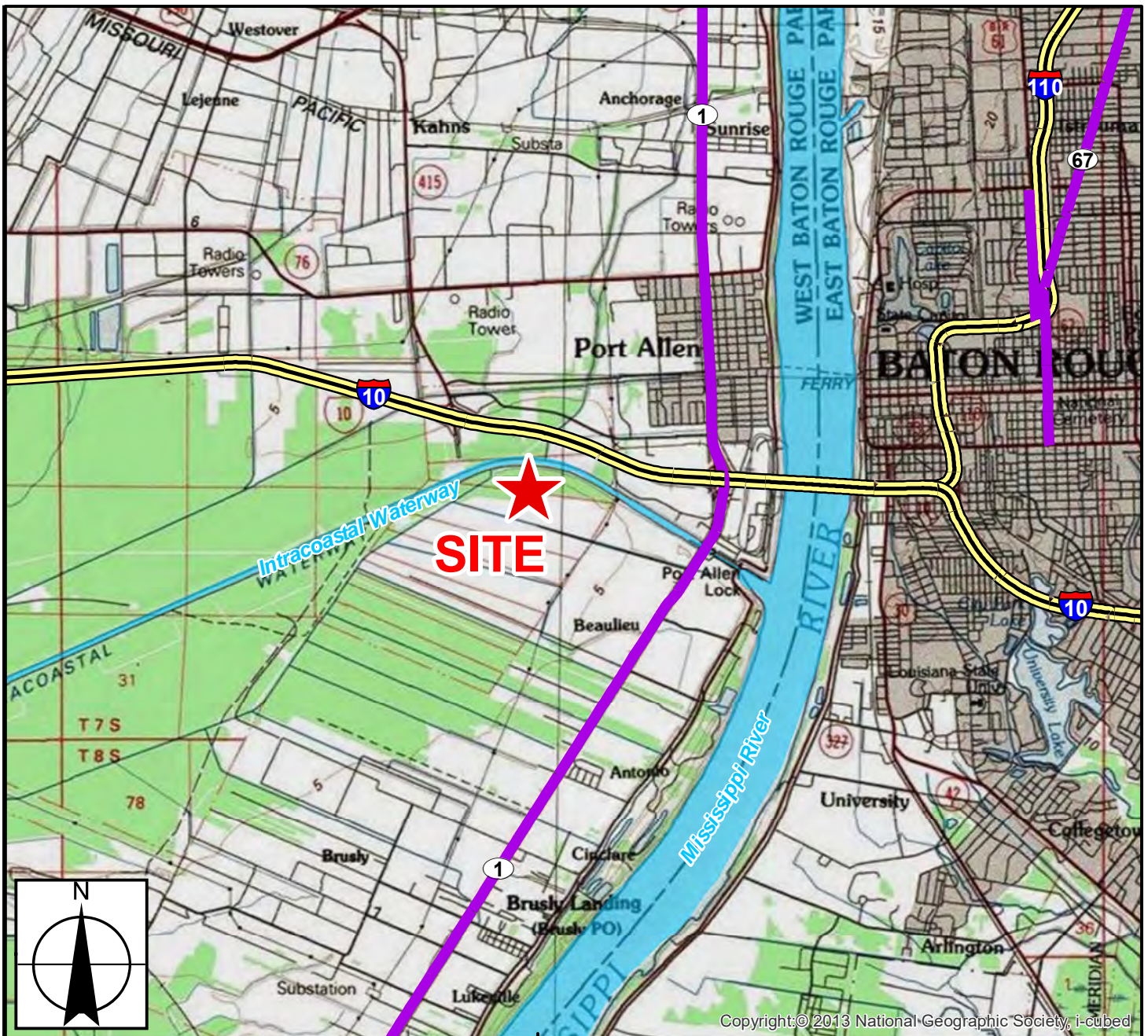



Copyright: © 2013 National Geographic Society, i-cubed

Legend

 Gron Fuels LLC Site Location

Major Roads

-  Interstate
-  2-Lane State Highway
-  Waterbody





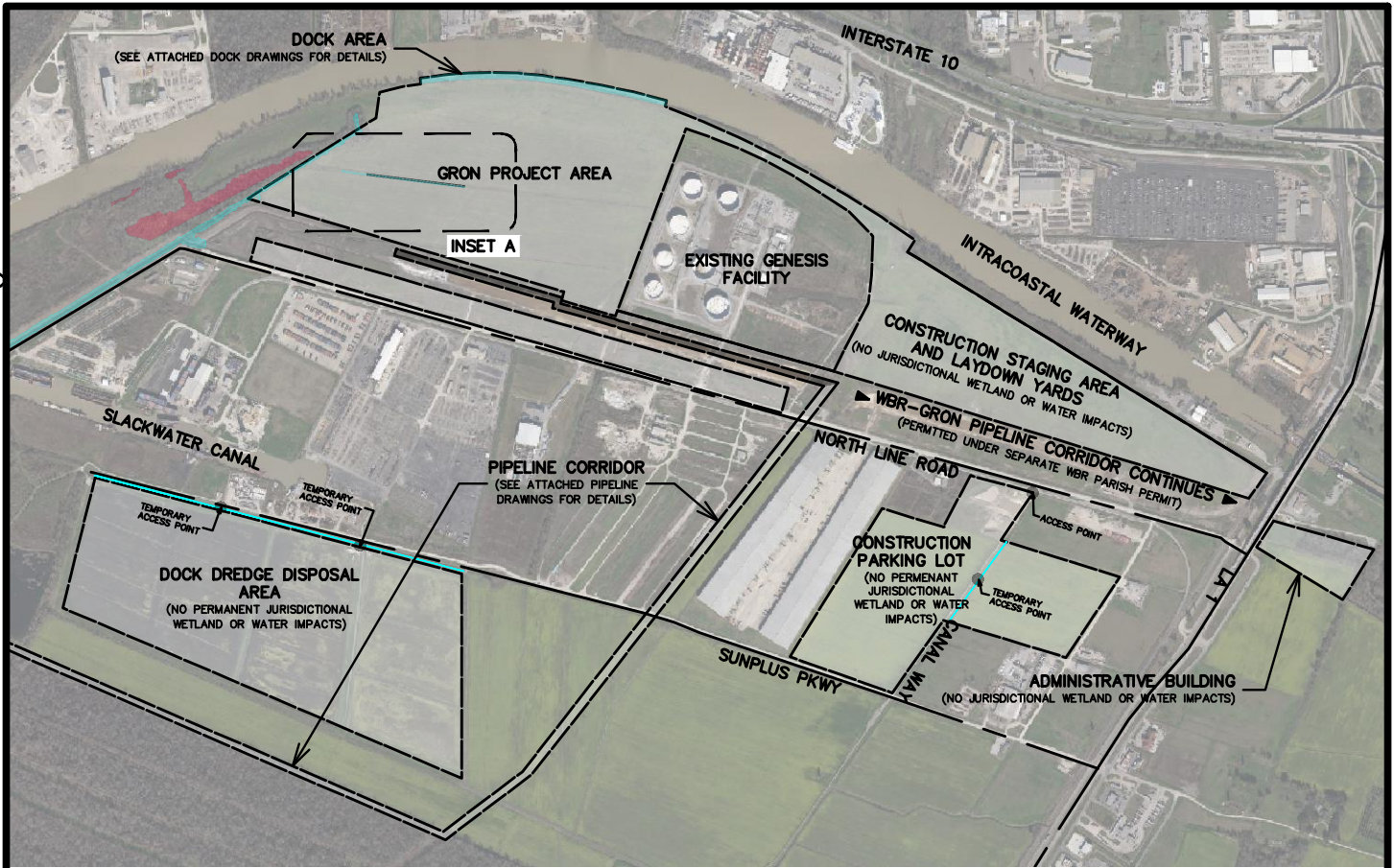

Gron Fuels LLC
Low Carbon Intensity
Renewable Fuels Plant

Sheet 1 - Vicinity Map





LEGEND:

-  PROJECT AREA LIMITS (TOTAL AREA: 436 AC)
-  JURISDICTIONAL WETLANDS
-  JURISDICTIONAL (404) WATERS (TOTAL IMPACTED LENGTH: 953 LF)
-  IMPACTED AREAS

LAND INFORMATION:

PROJECT LIMITS: 436 AC
 IMPACTED JURISDICTIONAL WATERS: 953 LF

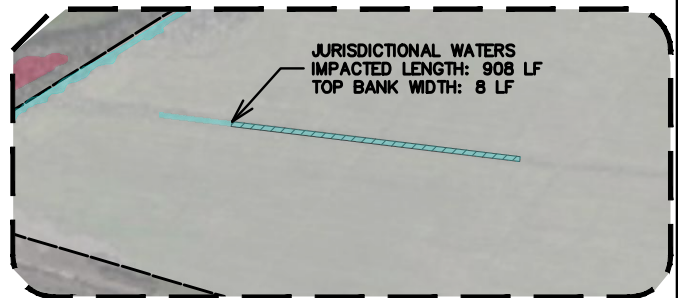

INSET A
 SCALE: 1"=600'

ACCESS TO ALL STAGING/WORK AREAS, LAYDOWN YARDS, TEMPORARY CONSTRUCTION AREAS AND PERMANENT PROJECT ARE ACCESSED FROM THE EXISTING PUBLIC ROADWAYS IDENTIFIED ABOVE.

ISSUED FOR
 PERMITTING ONLY
 April 25, 2022



8555 United Plaza Blvd Baton Rouge, LA 70808
 Telephone: 225 769-0546 Fax: 225 767-0060
 www.csrsinc.com

EXISTING CONDITIONS

SCALE: 1"=1700'

Date: _____ APRIL 2022
 Project Number: _____ 220090

Project:
 GRON FUELS RENEWABLE DIESEL
 MANUFACTURING FACILITY
 GRON FUELS, LLC.

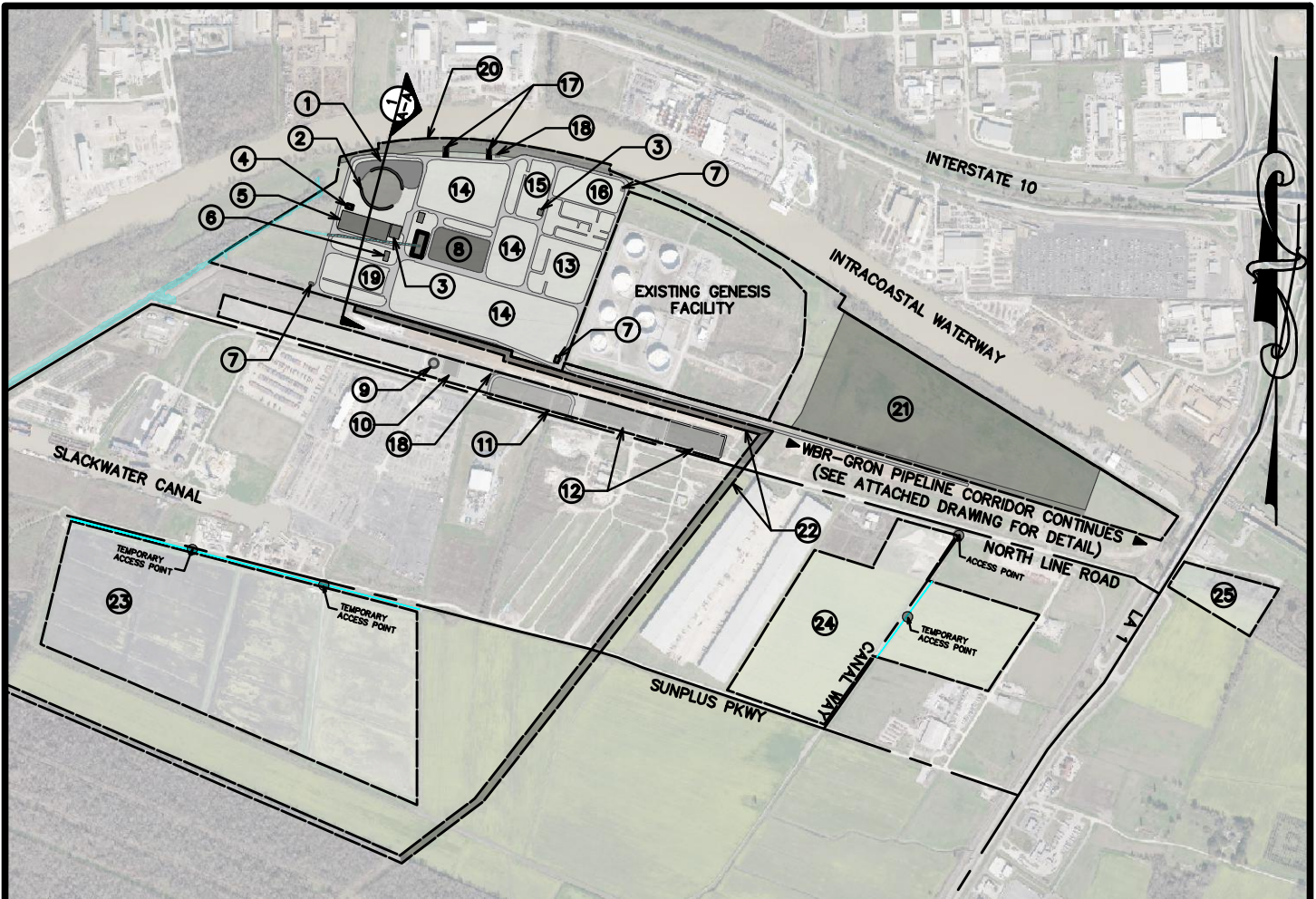

LEGEND:

- | | | | |
|--|--------------------------|--|--------------------------------------|
| | ROAD | | WATER STRIPPER |
| | PROJECT AREA LIMITS | | HYDROGEN PLANT |
| | RETENTION POND | | MAINTENANCE/ACCESS |
| | FLARE | | BREAK ROOM/ RESTROOM |
| | CONTROL ROOM | | WASTEWATER TREATMENT |
| | SANITARY SEWER TREATMENT | | DOCK |
| | MAINTENANCE COMPLEX | | LAYDOWN AREA |
| | LAB | | GRON/COMBINED PIPE CORRIDOR |
| | GUARDHOUSE | | DOCK DREDGE DISPOSAL AREA |
| | PRE TREATMENT | | CONSTRUCTION PARKING LOT |
| | WATER TOWER | | ADMINISTRATION BUILDING |
| | NITROGEN PLANT | | IMPACTED JURISDICTIONAL (404) WATERS |
| | LOADING RACK | | |
| | SUBSTATION | | |
| | CARBON CAPTURE | | |
| | TANK FARM | | |

CALCULATIONS: CRUSHED STONE

TOTAL FILL FOR JURISDICTIONAL WATER FEATURE: APPROX. 2,335 CY

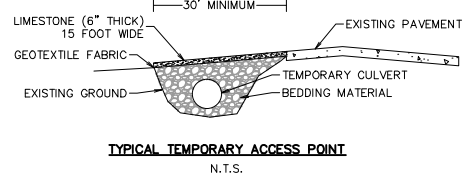

TYPICAL TEMPORARY ACCESS POINT
N.T.S.

ISSUED FOR
PERMITTING ONLY
April 25, 2022

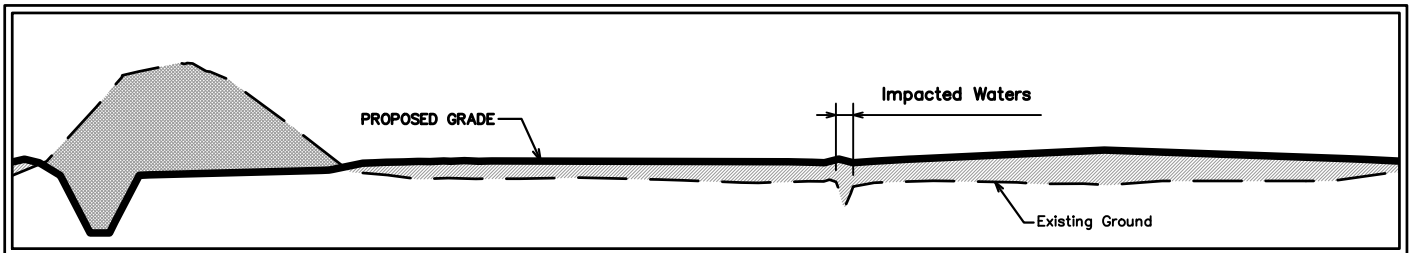

1 TYPICAL SECTION A-A
N.T.S.

CALCULATIONS:

TOTAL FILL FOR JURISDICTIONAL
WATER FEATURE: APPROX. 1930 CY
CRUSHED STONE

ISSUED FOR
PERMITTING ONLY
April 25, 2022

Sheet 4

CSRS

8555 United Plaza Blvd Baton Rouge, LA 70808
Telephone: 225 769-0546 Fax: 225 767-0060
www.csrsinc.com

**PROPOSED
DEVELOPMENT**

SCALE: 1"=1700'

Date:

APRIL 2022

Project Number:

220090

Project:

**GRON FUELS, LLC. -
Low Carbon Intensity
Renewable Fuels Plant**

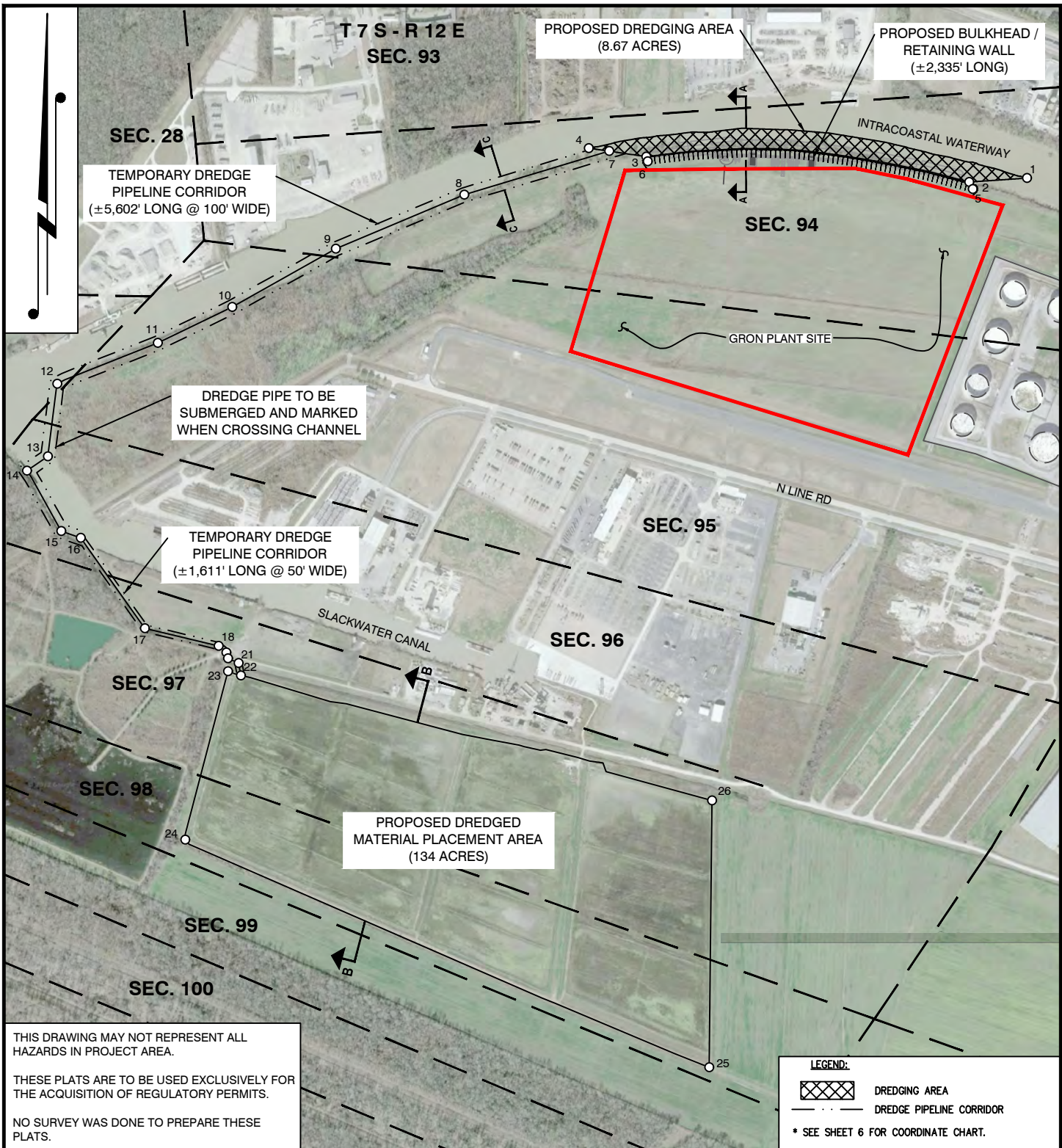

THIS DRAWING MAY NOT REPRESENT ALL HAZARDS IN PROJECT AREA.

THESE PLATS ARE TO BE USED EXCLUSIVELY FOR THE ACQUISITION OF REGULATORY PERMITS.

NO SURVEY WAS DONE TO PREPARE THESE PLATS.

LEGEND:

DREDGING AREA

DREDGE PIPELINE CORRIDOR

* SEE SHEET 6 FOR COORDINATE CHART.

DRAWN BY:	AZB	APPROVED BY:	ADM
DATE:	03/24/22	JOB NO:	2022.0028
DRAWING NAME:	220028_COE_AREA_REV4.DWG		
SHEET NO:	5		
PROJECTION:	LOUISIANA SOUTH ZONE		
GEO. DATUM:	HARN VERT. DATUM: NAVD88		
GRID UNITS:	US SURVEY FEET		

AREA MAP

GRON FUELS, LLC
 PROPOSED DREDGING, BULKHEAD, BARGE DOCK,
 DREDGE PIPELINE CORRIDOR
 AND DREDGE MATERIAL PLACEMENT AREA
 SECTIONS 94 - 98, T7S-R12E
 WEST BATON ROUGE PARISH, LOUISIANA

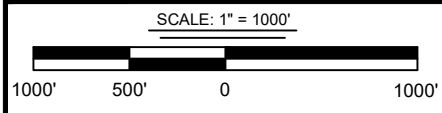

T. BAKER SMITH
 A CENTURY OF SOLUTIONS
 107 Global Circle, Lafayette, LA 70503
 (337)735-2800 - tbsmith.com

REV. NO:	4	REV. DATE:	04/21/2022	REV. BY:	RBT
REVISION DESCRIPTION: REVISED PER EMAIL REQUEST					

4/22/2022 - P:\X-2022\2022.0028\DWG\COE PLATS\REV4\220028_COE_AREA_REV4.DWG

PROJECT PLANT SITE

CHANNEL CENTERLINE:
 PC X: 3,309,588.5270' Y: 705,865.0152'
 PT X: 3,314,876.7435' Y: 705,503.8346'
 PI X: 3,312,328.9712' Y: 707,094.9247'
 RADIUS: 5,630.86' DELTA: 56.1554 (D)

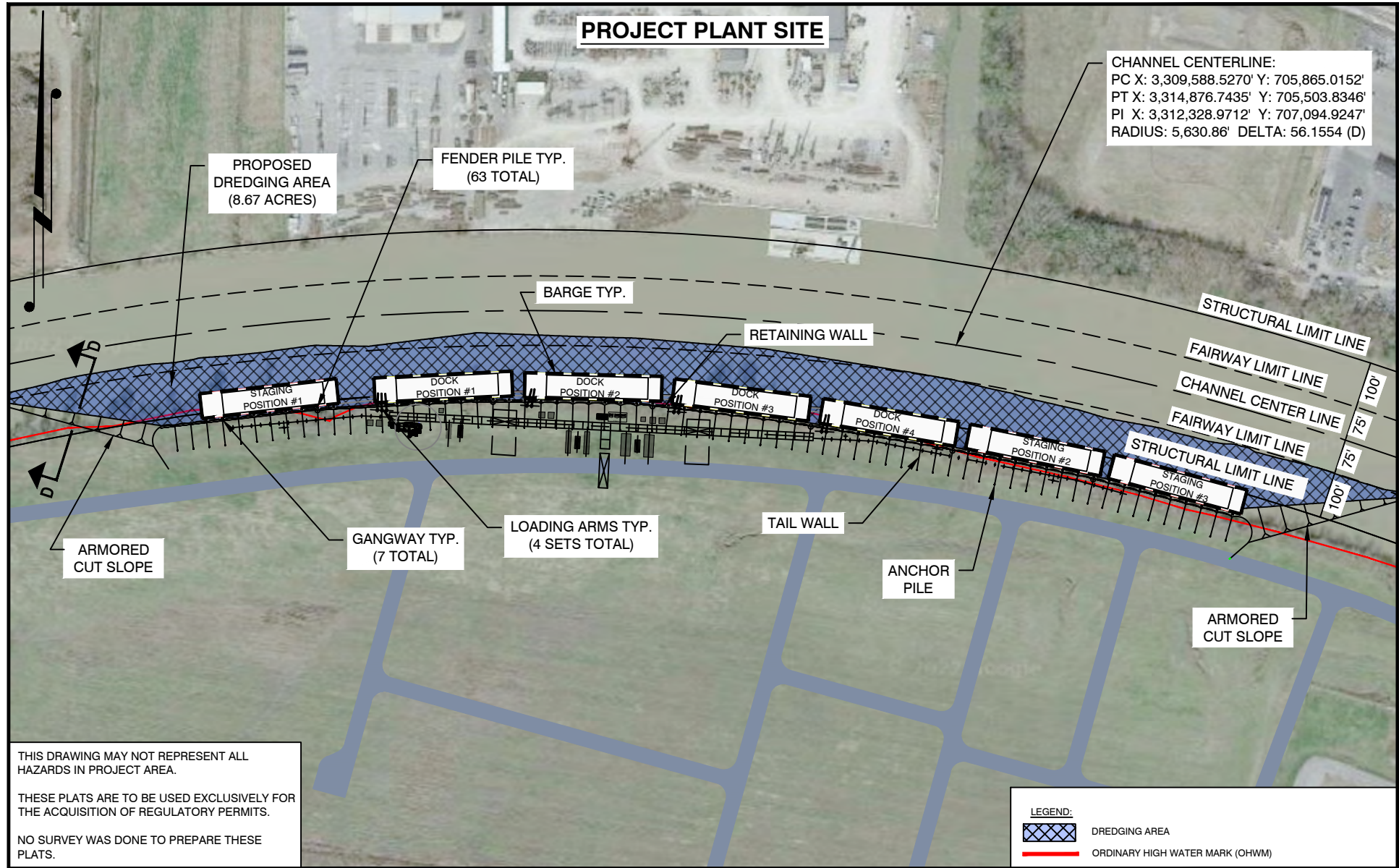

THIS DRAWING MAY NOT REPRESENT ALL HAZARDS IN PROJECT AREA.

THESE PLATS ARE TO BE USED EXCLUSIVELY FOR THE ACQUISITION OF REGULATORY PERMITS.

NO SURVEY WAS DONE TO PREPARE THESE PLATS.

LEGEND:

- DREDGING AREA
- ORDINARY HIGH WATER MARK (OHWM)

SCALE: 1" = 300'

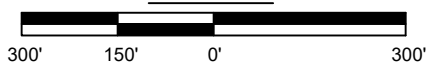

DRAWN BY: AZB	APPROVED BY: ADM
DATE: 03/24/22	JOB NO: 2022.0028
DRAWING NAME: 220028_COE_PLAN_REV4.DWG	

SHEET NO: **6**

PROJECTION: LOUISIANA SOUTH ZONE
 GEO. DATUM: HARN | VERT. DATUM: NAVD88
 GRID UNITS: US SURVEY FEET

T. BAKER SMITH
 A CENTURY OF SOLUTIONS
 107 Global Circle, Lafayette, LA 70503
 (337)735-2800 - tbsmith.com

REV. NO: 4	REV. DATE: 04/21/2022	REV. BY: RBT
------------	-----------------------	--------------

REVISION DESCRIPTION:
 REVISED PER EMAIL REQUEST

PLAN VIEW

GRON FUELS, LLC
 PROPOSED DREDGING, BULKHEAD, BARGE DOCK,
 DREDGE PIPELINE CORRIDOR
 AND DREDGE MATERIAL PLACEMENT AREA
 SECTIONS 94-98, T7S-R12E
 WEST BATON ROUGE PARISH, LOUISIANA

4/21/2022 - P:\Y-2022\2022.0028\DWG\COE PLATS\REV4\220028_COE_PLAN_REV4.DWG

TIE	COORDINATE CHART - NAD 83 (2011)				
	X	Y	LATITUDE	LONGITUDE	DESCRIPTION
1	3,313,795'	705,957'	30° 26' 28.271"N	91° 13' 43.458"W	DREDGE EXTENTS / CORNER
2	3,313,386'	705,929'	30° 26' 27.995"N	91° 13' 48.130"W	DREDGE EXTENTS / CORNER
3	3,311,094'	706,109'	30° 26' 29.803"N	91° 14' 14.305"W	DREDGE EXTENTS / CORNER
4	3,310,686'	706,169'	30° 26' 30.401"N	91° 14' 18.965"W	DREDGE EXTENTS / CORNER
5	3,313,410'	705,878'	30° 26' 27.495"N	91° 13' 47.853"W	END OF BULKHEAD
6	3,311,104'	706,076'	30° 26' 29.471"N	91° 14' 14.191"W	END OF BULKHEAD
7	3,310,831'	706,148'	30° 26' 30.188"N	91° 14' 17.309"W	DREDGE PIPE P.O.B.
8	3,309,803'	705,838'	30° 26' 27.133"N	91° 14' 29.055"W	DREDGE PIPE P.I.
9	3,308,891'	705,455'	30° 26' 23.343"N	91° 14' 39.476"W	DREDGE PIPE P.I.
10	3,308,157'	705,043'	30° 26' 19.268"N	91° 14' 47.873"W	DREDGE PIPE P.I.
11	3,307,629'	704,787'	30° 26' 16.739"N	91° 14' 53.905"W	DREDGE PIPE P.I.
12	3,306,915'	704,498'	30° 26' 13.889"N	91° 15' 02.058"W	DREDGE PIPE P.I.
13	3,306,848'	703,983'	30° 26' 08.788"N	91° 15' 02.830"W	DREDGE PIPE P.I.
14	3,306,700'	703,881'	30° 26' 07.777"N	91° 15' 04.527"W	DREDGE PIPE P.I.
15	3,306,944'	703,453'	30° 26' 03.543"N	91° 15' 01.742"W	DREDGE PIPE P.I.
16	3,307,082'	703,404'	30° 26' 03.054"N	91° 15' 00.163"W	DREDGE PIPE P.I.
17	3,307,537'	702,763'	30° 25' 56.705"N	91° 14' 54.973"W	DREDGE PIPE P.I.
18	3,308,060'	702,638'	30° 25' 55.467"N	91° 14' 48.997"W	DREDGE PIPE P.I.
19	3,308,115'	702,592'	30° 25' 55.012"N	91° 14' 48.372"W	DREDGE PIPE P.I.
20	3,308,126'	702,550'	30° 25' 54.595"N	91° 14' 48.249"W	DREDGE PIPE P.I.
21	3,308,200'	702,517'	30° 25' 54.265"N	91° 14' 47.393"W	DREDGE PIPE P.I.
22	3,308,218'	702,428'	30° 25' 53.388"N	91° 14' 47.188"W	DREDGE PIPE P.O.E.
23	3,308,127'	702,458'	30° 25' 53.683"N	91° 14' 48.234"W	DREDGE MATERIAL PLACEMENT EXTENTS / CORNER
24	3,307,823'	701,264'	30° 25' 41.864"N	91° 14' 51.719"W	DREDGE MATERIAL PLACEMENT EXTENTS / CORNER
25	3,311,540'	699,649'	30° 25' 25.850"N	91° 14' 09.274"W	DREDGE MATERIAL PLACEMENT EXTENTS / CORNER
26	3,311,561'	701,541'	30° 25' 44.579"N	91° 14' 09.014"W	DREDGE MATERIAL PLACEMENT EXTENTS / CORNER

THIS DRAWING MAY NOT REPRESENT ALL HAZARDS IN PROJECT AREA.

THESE PLATS ARE TO BE USED EXCLUSIVELY FOR THE ACQUISITION OF REGULATORY PERMITS.

NO SURVEY WAS DONE TO PREPARE THESE PLATS.

DRAWN BY: AZB	APPROVED BY: ADM
DATE: 03/24/22	JOB NO: 2022.0028
DRAWING NAME: 220028_COE_AREA_REV4.DWG	
SHEET NO: 7	
PROJECTION: LOUISIANA SOUTH ZONE GEO. DATUM: HARN VERT. DATUM: NAVD88 GRID UNITS: US SURVEY FEET	

COORDINATE CHART

GRON FUELS, LLC
 PROPOSED DREDGING, BULKHEAD, BARGE DOCK,
 DREDGE PIPELINE CORRIDOR
 AND DREDGE MATERIAL PLACEMENT AREA
 SECTIONS 94 - 98, T7S-R12E
 WEST BATON ROUGE PARISH, LOUISIANA

NOT TO SCALE



REV. NO: 4	REV. DATE: 04/21/2022	REV. BY: RBT
REVISION DESCRIPTION: REVISED PER EMAIL REQUEST		

4/21/2022 - P:\Y-2022\2022.0028\DWG\COE PLATS\REV4\220028_COE_AREA_REV4.DWG

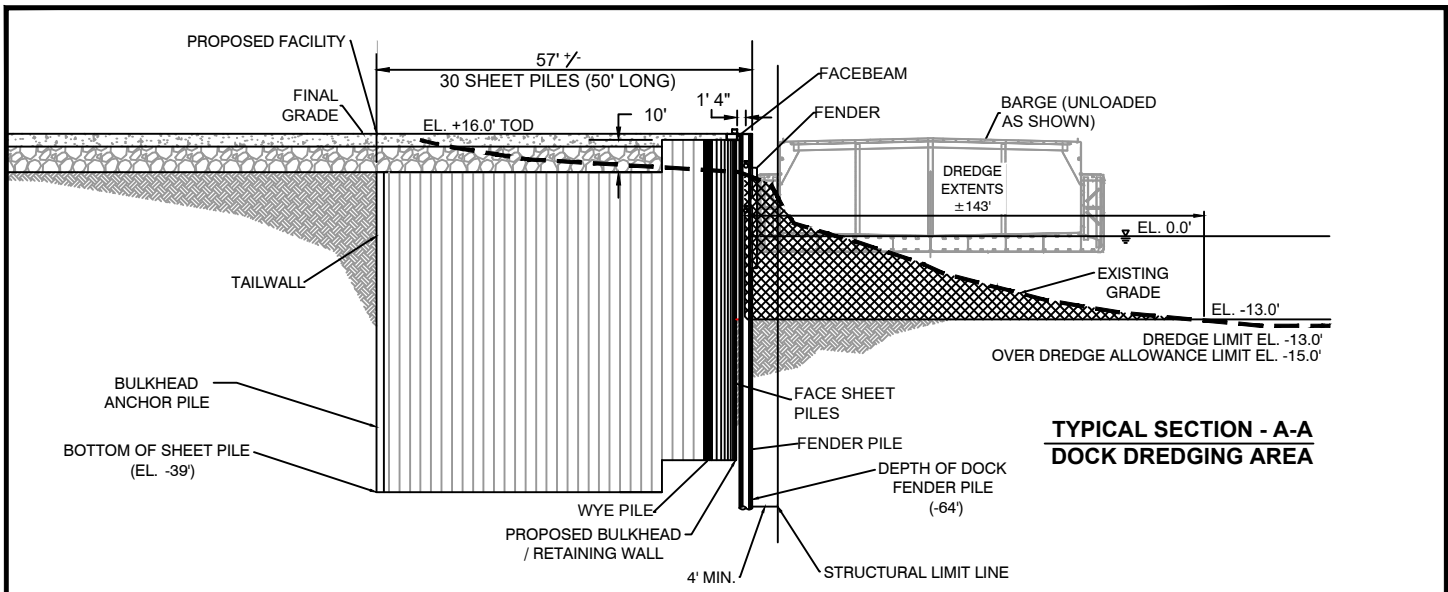

**TYPICAL SECTION - A-A
DOCK DREDGING AREA**

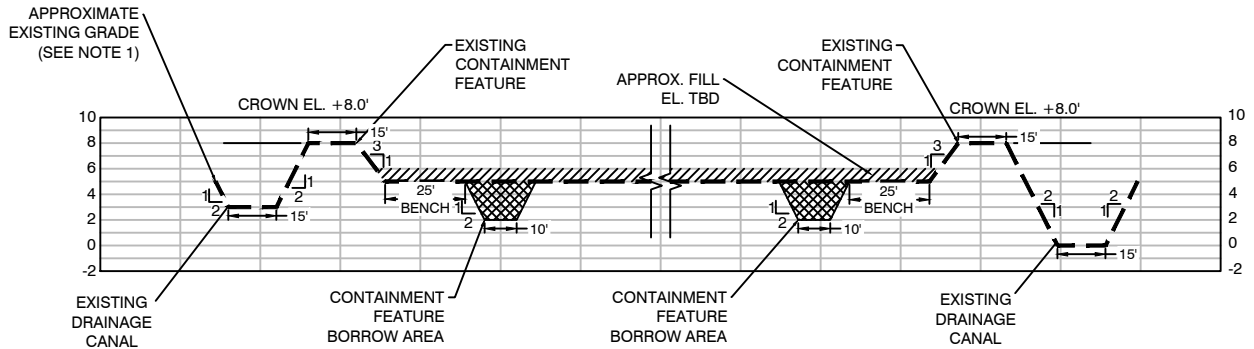

**TYPICAL SECTION - B-B
DREDGED MATERIAL PLACEMENT AREA**

CALCULATION:
APPROXIMATELY 115,000 CU. YDS.
DISPLACED BY DREDGING.

LEGEND:	
	DREDGED MATERIAL FILL
	BORROW AREA
	EXISTING GROUND

THIS DRAWING MAY NOT REPRESENT ALL HAZARDS IN PROJECT AREA.

THESE PLATS ARE TO BE USED EXCLUSIVELY FOR THE ACQUISITION OF REGULATORY PERMITS.

NO SURVEY WAS DONE TO PREPARE THESE PLATS.

- NOTES:**
- DREDGED MATERIAL PLACEMENT AREA TO BE SURVEYED IN SUBSEQUENT DESIGN PHASE.

DRAWN BY: AZB	APPROVED BY: ADM
DATE: 03/24/22	JOB NO: 2022.0028
DRAWING NAME: 220028_COE_PROFILES_REV4.DWG	
SHEET NO: 8	
PROJECTION: LOUISIANA SOUTH ZONE GEO. DATUM: HARN VERT. DATUM: NAVD88 GRID UNITS: US SURVEY FEET	

PROFILE VIEW

GRON FUELS, LLC
PROPOSED DREDGING, BULKHEAD, BARGE DOCK,
DREDGE PIPELINE CORRIDOR
AND DREDGE MATERIAL PLACEMENT AREA
SECTIONS 94 - 98, T7S-R12E
WEST BATON ROUGE PARISH, LOUISIANA

NOT TO SCALE

T. BAKER SMITH
A CENTURY OF SOLUTIONS
107 Global Circle, Lafayette, LA 70503
(337)735-2800 - tbsmith.com

REV. NO: 4	REV. DATE: 04/21/2022	REV. BY: RBT
REVISION DESCRIPTION: REVISED PER EMAIL REQUEST		

4/21/2022 - P:\Y-2022\2022.0028\DWG\COE PLATS\REV4\220028_COE_PROFILES_REV4.DWG

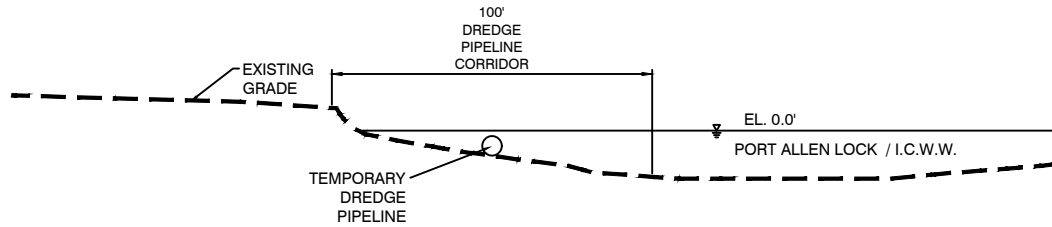

**TYPICAL SECTION - C-C
DREDGE PIPELINE CORRIDOR**

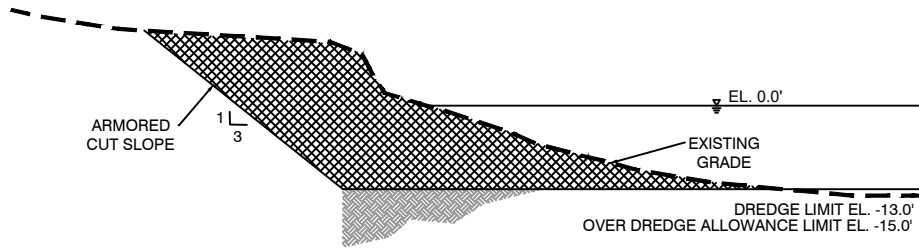

**TYPICAL SECTION - D-D
ARMORED CUT SLOPE**

CALCULATION:
APPROXIMATELY 115,000 CU. YDS.
DISPLACED BY DREDGING.

LEGEND:	
	DREDGED MATERIAL FILL
	BORROW AREA
	EXISTING GROUND

THIS DRAWING MAY NOT REPRESENT ALL HAZARDS IN PROJECT AREA.

THESE PLATS ARE TO BE USED EXCLUSIVELY FOR THE ACQUISITION OF REGULATORY PERMITS.

NO SURVEY WAS DONE TO PREPARE THESE PLATS.

NOTES:

1. DREDGED MATERIAL PLACEMENT AREA TO BE SURVEYED IN SUBSEQUENT DESIGN PHASE.

DRAWN BY: AZB		APPROVED BY: ADM		PROFILE VIEW GRON FUELS, LLC PROPOSED DREDGING, BULKHEAD, BARGE DOCK, DREDGE PIPELINE CORRIDOR AND DREDGE MATERIAL PLACEMENT AREA SECTIONS 94 - 98, T7S-R12E WEST BATON ROUGE PARISH, LOUISIANA	
DATE: 03/24/22		JOB NO: 2022.0028			
DRAWING NAME: 220028_COE_PROFILES_REV4.DWG					
SHEET NO: 9					
PROJECTION: LOUISIANA SOUTH ZONE GEO. DATUM: HARN VERT. DATUM: NAVD88 GRID UNITS: US SURVEY FEET				REV. NO: 4 REV. DATE: 04/21/2022 REV. BY: RBT	
NOT TO SCALE		T. BAKER SMITH A CENTURY OF SOLUTIONS 107 Global Circle, Lafayette, LA 70503 (337)735-2800 - tbsmith.com		REVISION DESCRIPTION: REVISED PER EMAIL REQUEST	

4/21/2022 - P:\X-2022\2022.0028\DWG\COE PLATS\REV4\220028_COE_PROFILES_REV4.DWG

C:\Users\nebert\Box\220090\90\Owners Engineer\Working Drawings\USACE Waters & Wetlands\Gron - Pipeline Permitting.dwg Sep 01, 2022 - 8:11am



8555 United Plaza Blvd Baton Rouge, LA 70808
Telephone: 225 769-0546 Fax: 225 767-0060
www.csrsinc.com

SHEET 10

SCALE: NONE

REFERENCE DRAWING(S)-SHTS 11,12 & 13

Date:

August, 2022

Project Number:

220090

Grön Fuels, LLC
Low Carbon Intensity
Renewable Fuels Plant
West Baton Rouge Parish, LA

C:\Users\hebert\Box\220090\90\Owners Engineer\Working Drawings\USACE Waters & Wetlands\Gron - Pipeline Permitting.dwg Sep 01, 2022 - 8:14am

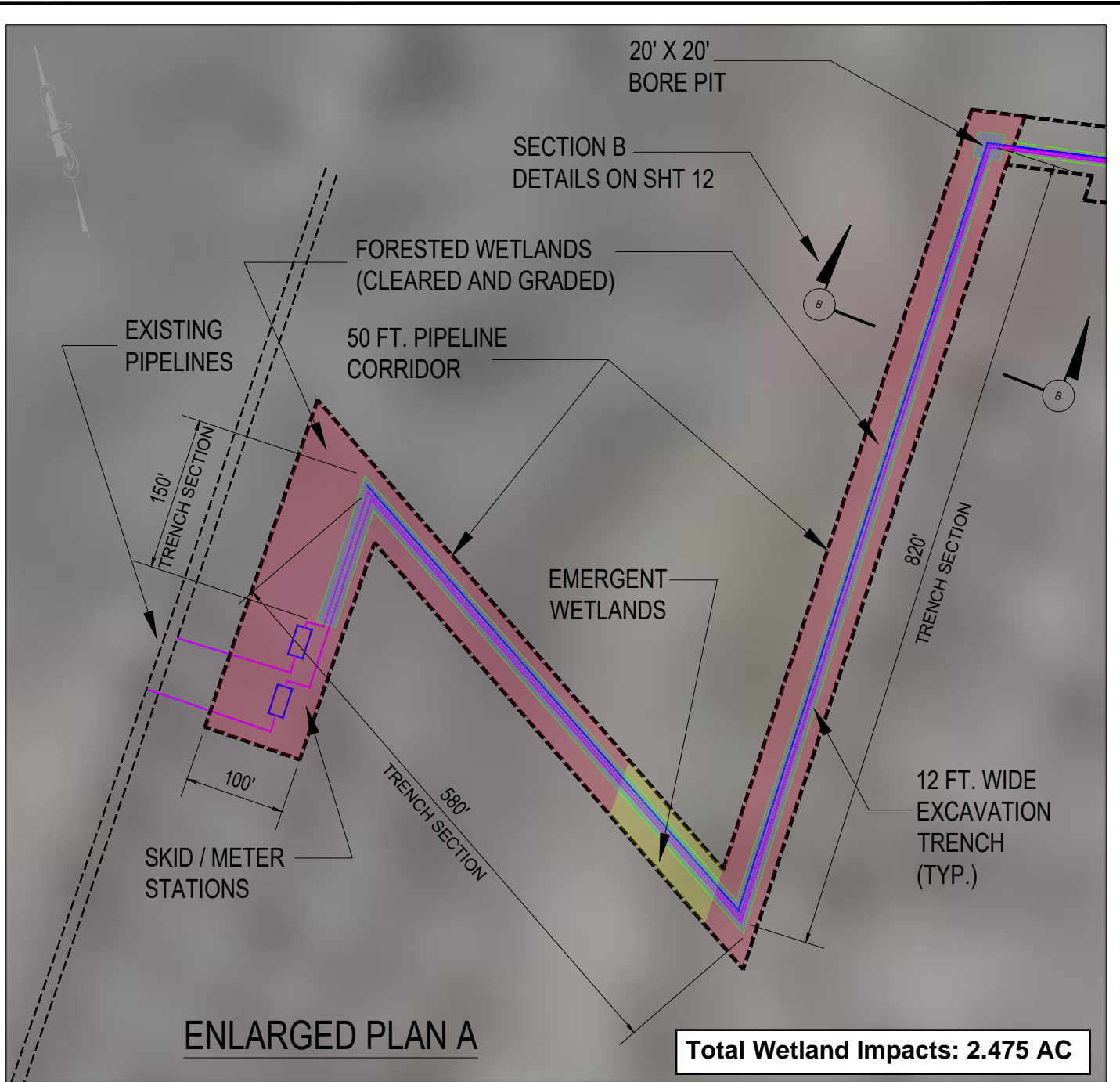

- CLEARED & GRADED - FORESTED WETLANDS (2.31 AC.) - NO PLACEMENT OF DREDGE OR FILL MATERIAL
- IMPACTED EMERGENT WETLANDS (.165 AC.)
- TOTAL EXCAVATED WETLANDS (.56 AC.) (3,575 CU YDS.) - TO BE BACKFILLED TO NATURAL ELEVATIONS WITH ONSITE PREVIOUSLY EXCAVATED SOILS.



8555 United Plaza Blvd Baton Rouge, LA 70808
 Telephone: 225 769-0546 Fax: 225 767-0060
 www.csrsinc.com

SHEET 11

SCALE: NONE
 REFERENCE DRAWING(S)-SHTS 10,12 & 13
 Date: August, 2022
 Project Number: 220090

Grön Fuels, LLC
Low Carbon Intensity
Renewable Fuels Plant
West Baton Rouge Parish, LA

C:\Users\nebert\Box\220090\90\Owners Engineer\Working Drawings\USACE Waters & Wetlands\Gron - Pipeline Permitting.dwg Sep 07, 2022 - 12:39pm

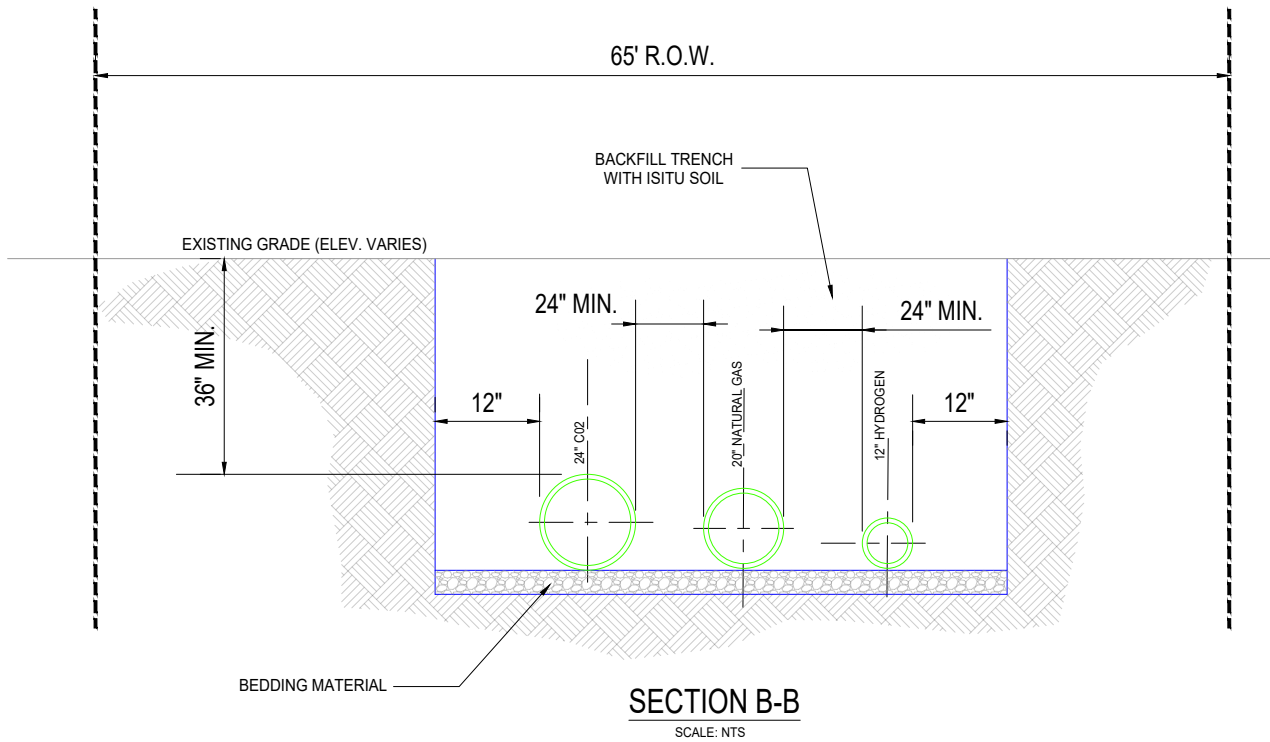

8555 United Plaza Blvd Baton Rouge, LA 70808
Telephone: 225 769-0546 Fax: 225 767-0060
www.csrsinc.com

SHEET 12

SCALE: NONE

REFERENCE DRAWING(S)-SHTS 10, 11, & 13

Date:

August, 2022

Project Number:

220090

Grön Fuels, LLC
Low Carbon Intensity
Renewable Fuels Plant
West Baton Rouge Parish, LA

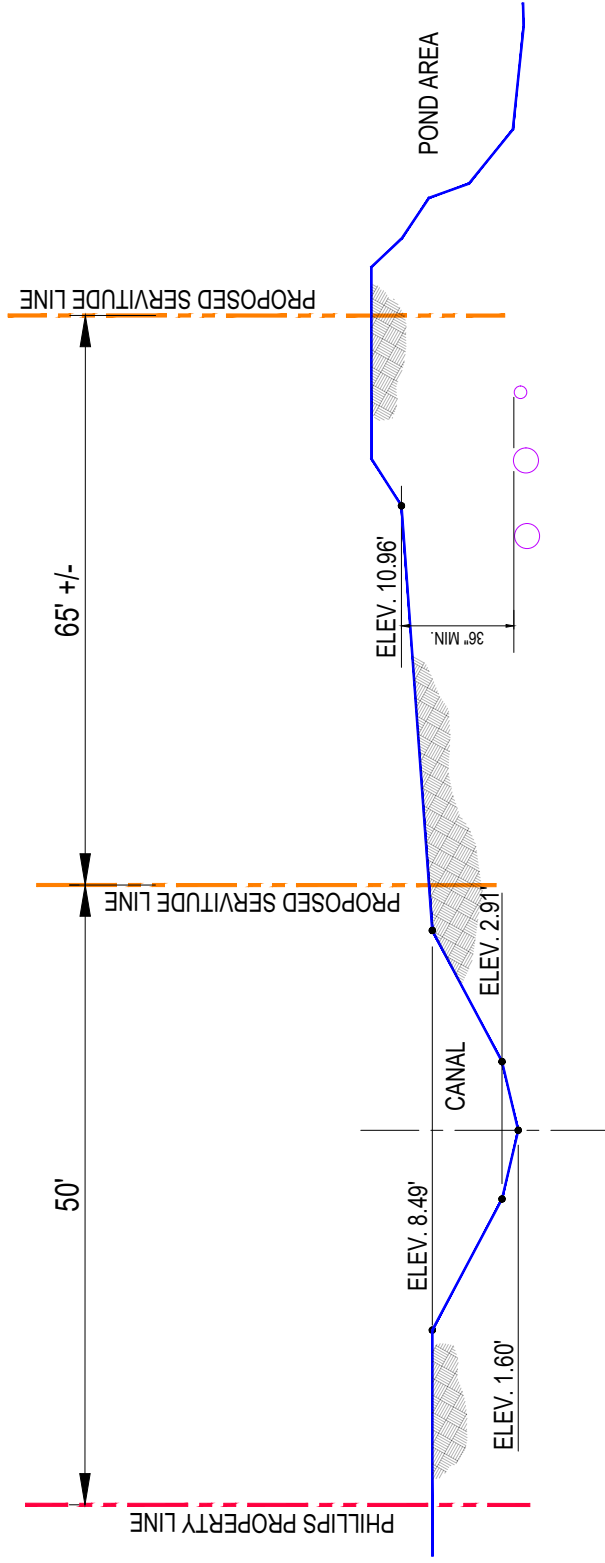

SECTION C - C



ENGINEERING LLC

Coastal Design & Infrastructure
197 Elysian Drive
Houma, LA 70363
O: (985) 219-1000 | F: (985) 475-7014

ENGINEERING • PLANNING • ENVIRONMENTAL CONSULTING

REVISIONS

No.	Description	Date

FOR PERMIT APPLICATION ONLY

ENGINEER'S NAME
LA. LICENSE NO. 00000

WEST BATON ROUGE PARISH
WEST BATON ROUGE
WASTEWATER TREATMENT FACILITY
DISCHARGE PIPELINE LAYOUT

PLAN VIEW

Project number	49145-5444
Date	MARCH 2022
Designed by	BH
Drawn by	SDP
Checked by	MM
Approved by	MM
Plot Date	April 14, 2022

Sheet 14

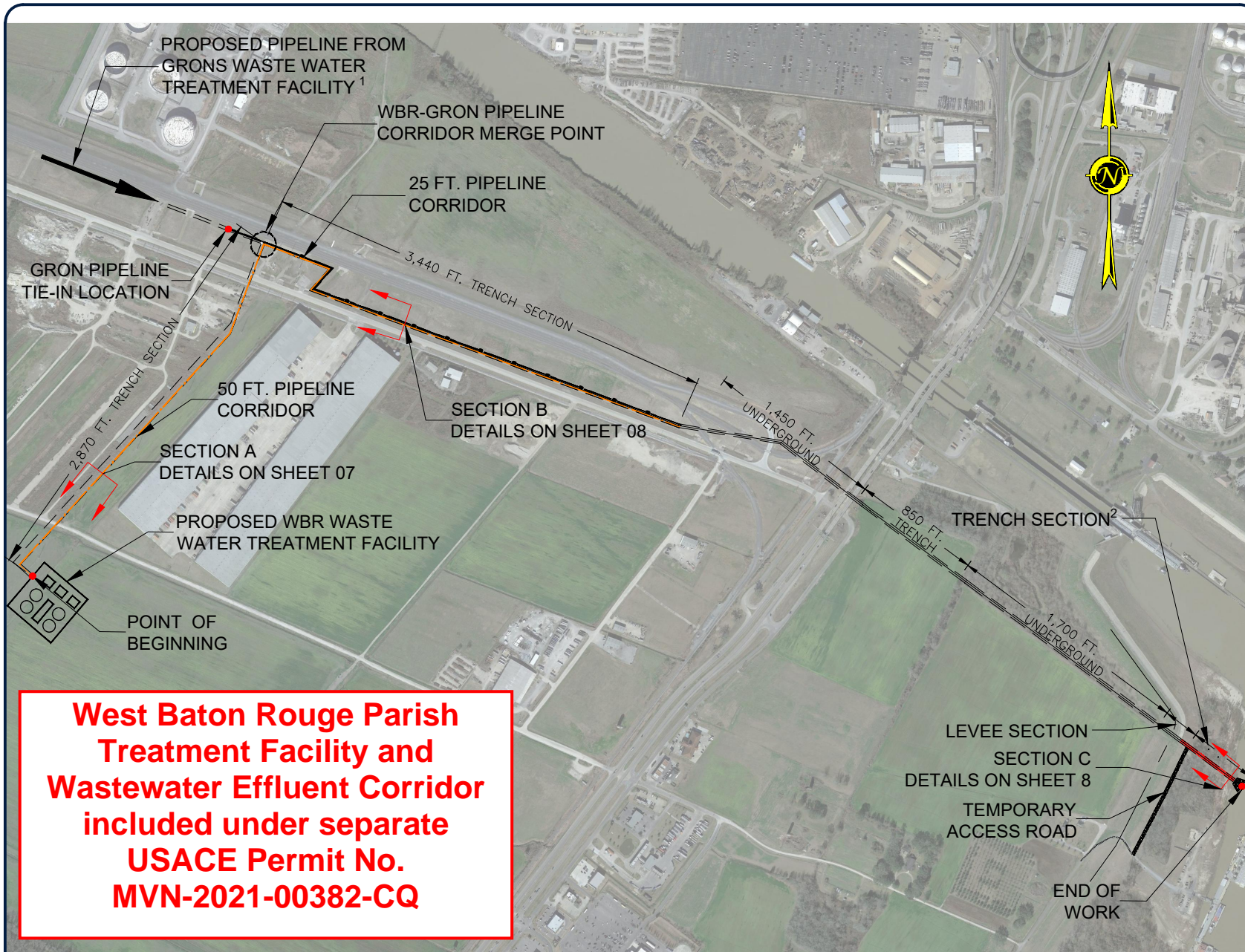

**West Baton Rouge Parish
Treatment Facility and
Wastewater Effluent Corridor
included under separate
USACE Permit No.
MVN-2021-00382-CQ**

NOTE: THE IMAGE ABOVE IS A GENERAL REPRESENTATION OF THE WORK AREA, ACTUAL FIELD CONDITIONS MAY DIFFER.

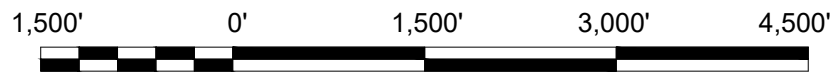

SCALE: 1:1500

NOTES:

- GRON FACILITY LOCATION AND CONSTRUCTION ACTIVITIES UP TO THE TIE-IN POINT WITH THE WBR CORRIDOR WILL BE PERMITTED BY GRON UNDER A SEPARATE PERMIT APPLICATION.
- THE PIPELINES IN THE TRENCH SECTION SHOULD HAVE A BURY DEPTH OF MINIMUM 3.0 FT.



ENGINEERING LLC

Coastal Design & Infrastructure
 197 Elysian Drive
 Houma, LA 70363
 O: (985) 219-1000 | F: (985) 475-7014

ENGINEERING • PLANNING • ENVIRONMENTAL CONSULTING

REVISIONS		
No.	Description	Date

FOR PERMIT APPLICATION ONLY

ENGINEER'S NAME
LA. LICENSE NO. 00000

WEST BATON ROUGE PARISH
 WEST BATON ROUGE
 WASTEWATER TREATMENT FACILITY
 DISCHARGE PIPELINE LAYOUT

**DETAILED
 PLAN VIEW**

Project number	49145-5444
Date	MARCH 2022
Designed by	BH
Drawn by	SDP
Checked by	MM
Approved by	MM
Plot Date	April 14, 2022

Sheet 15

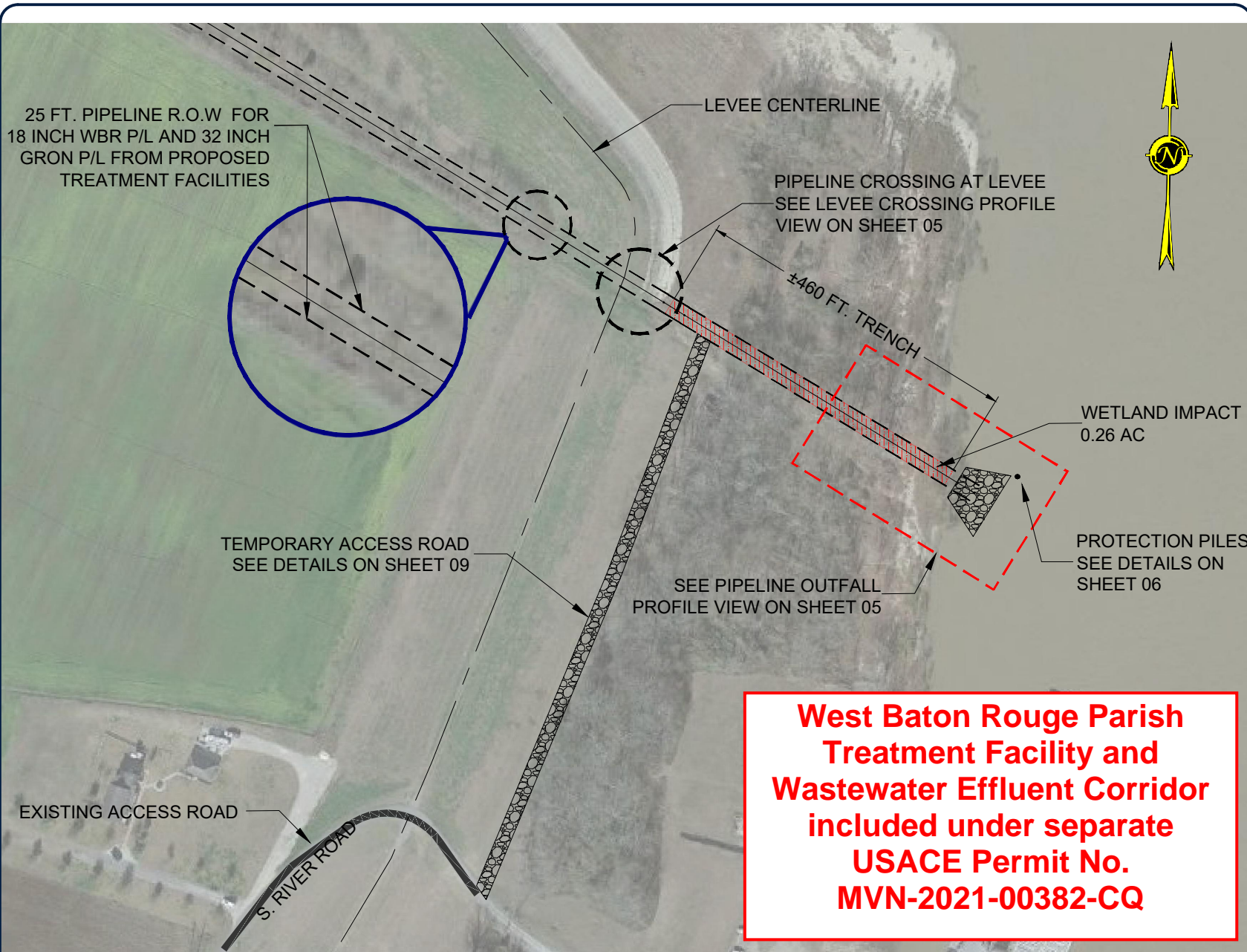

**West Baton Rouge Parish
 Treatment Facility and
 Wastewater Effluent Corridor
 included under separate
 USACE Permit No.
 MVN-2021-00382-CQ**

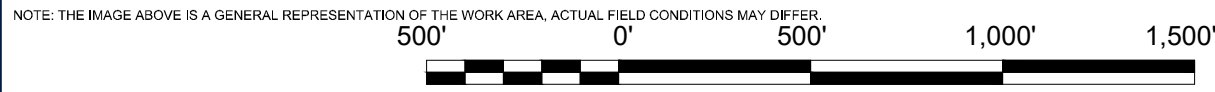

WETLAND IMPACT 0.26 AC

SCALE: 1:500

NOTES:
 VOLUME OF MATERIAL EXCAVATED = 830 CY.
 MATERIAL EXCAVATED WILL BE BACKFILLED

M:\Department_39\Client\00Permit\Status Report\Projects and other Data\39145-0000-1111- Grn Ww Pipeline\CAD\01_VGINITY_MP2.dwg

West Baton Rouge Parish Treatment Facility and Wastewater Effluent Corridor included under separate USACE Permit No. MVN-2021-00382-CQ



ENGINEERING LLC

Coastal Design & Infrastructure
197 Elysian Drive
Houma, LA 70363
O: (985) 219-1000 | F: (985) 475-7014

ENGINEERING • PLANNING • ENVIRONMENTAL CONSULTING

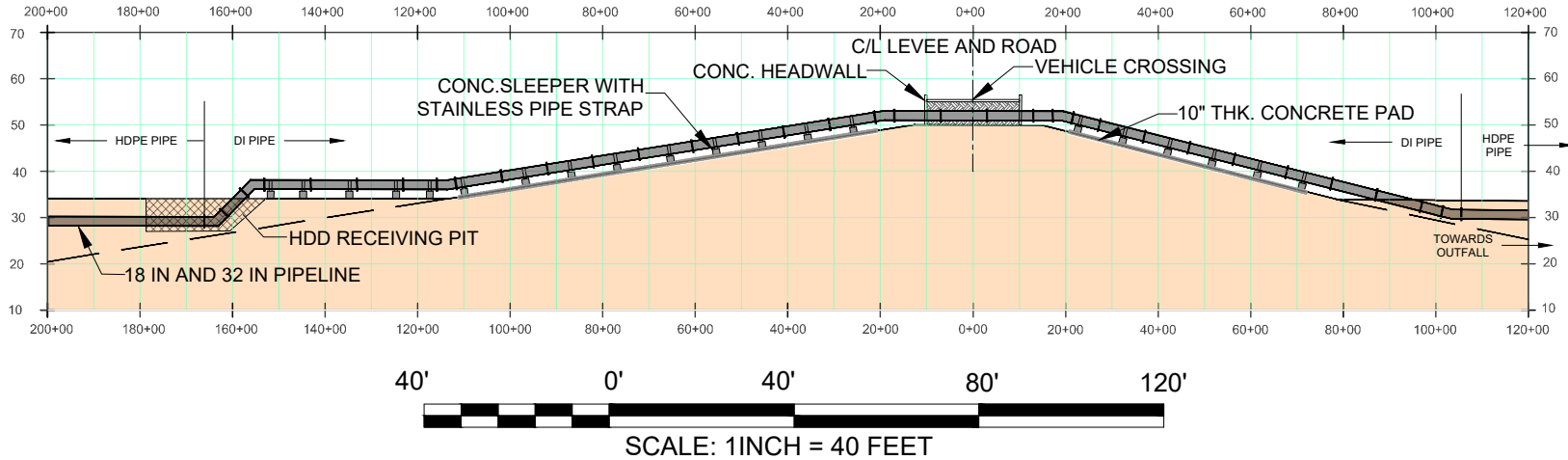

LEVEE CROSSING PROFILE VIEW

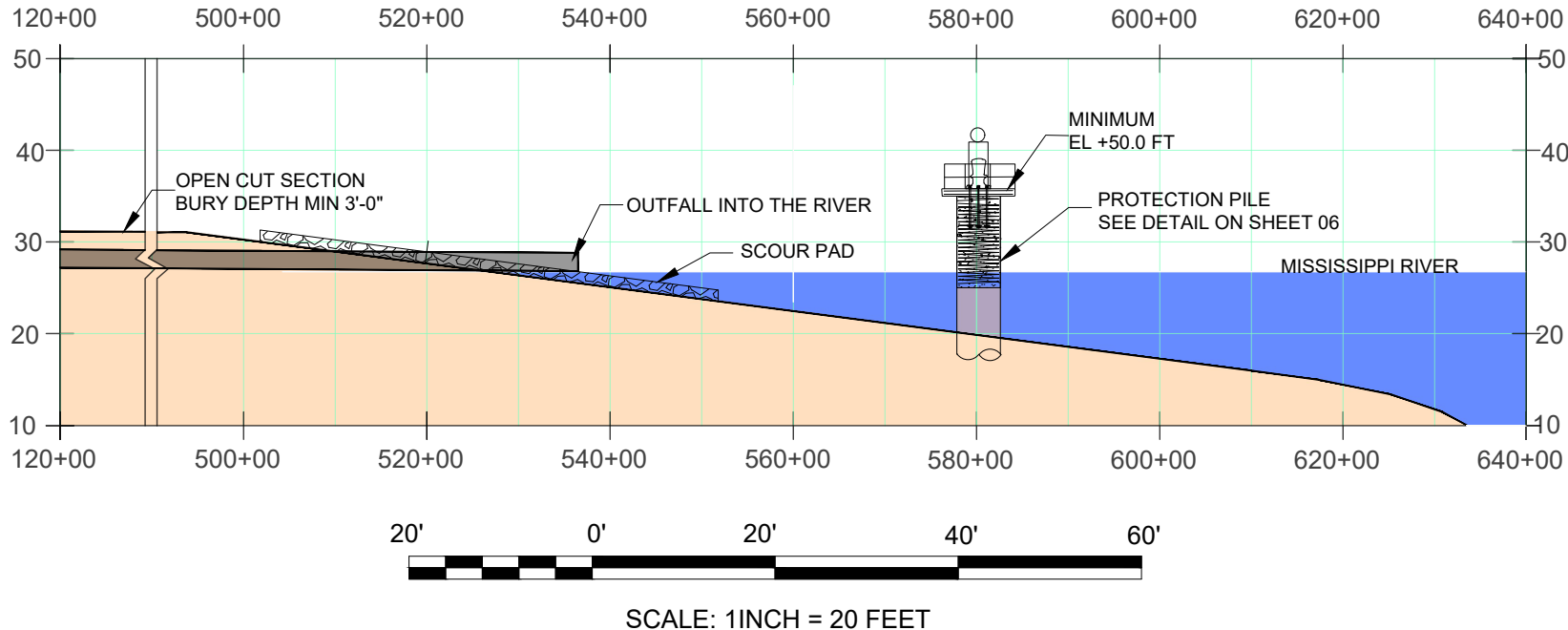

PIPELINE OUTFALL PROFILE VIEW

REVISIONS

No.	Description	Date

FOR PERMIT APPLICATION ONLY

ENGINEER'S NAME
LA LICENSE NO. 00000

WEST BATON ROUGE PARISH
WEST BATON ROUGE
WASTEWATER TREATMENT FACILITY
DISCHARGE PIPELINE LAYOUT

PROFILE VIEW

Project number	49145-5444
Date	MARCH 2022
Designed by	BH
Drawn by	SDP
Checked by	MM
Approved by	MM
Plot Date	April 14, 2022

Sheet 16

M:\Department_39\Clients\00Permit_Status Report\Projects and other Data\39145-0000-1111-Grow Ww Pipeline\CAD\01_VICINITY_MAP.dwg