



DEPARTMENT OF THE ARMY
U.S. ARMY CORPS OF ENGINEERS, NEW ORLEANS DISTRICT
7400 LEAKE AVE
NEW ORLEANS, LA 70118-3651

December 11, 2023

Regulatory Division
Central Evaluation Branch

Project Manager:
Dirreen Arnold
(504) 862-2301
dirreen.s.arnold@usace.army.mil

Application #: MVN-2021-00485-1-CA
408 Application #: 2021-0013-1

PUBLIC NOTICE

Interested parties are hereby notified that a permit application has been received by the New Orleans District of the U.S. Army Corps of Engineers pursuant to: [X] Section 10 of the Rivers and Harbors Act of March 3, 1899 (30 Stat. 1151; 33 USC 403); and/or [X] Section 404 of the Clean Water Act (86 Stat. 816; 33 USC 1344), and/or [X] Section 14 of the Rivers and Harbors Act of 1899 (33 U.S.C. Section 408).

PROPOSED BARGE FLEET EXPANSION, MISSISSIPPI RIVER, LDB, MM 191 IBERVILLE PARISH

NAME OF APPLICANT: SHAMROCK MARINE, LLC, c/o Lanier and Associates Consulting Engineers, Incorporated, Attn: Celeste Bergeron, 4101 Magazine Street, New Orleans, Louisiana, 70115.

LOCATION OF WORK: Mississippi River, left descending bank, Mile Marker 191, near Carville, Louisiana, (30.196111, -91.122777), in Iberville Parish, within the Mississippi River Basin in hydrologic unit (HUC 08070100), as shown on the attached drawings.

CHARACTER OF WORK: The applicant has requested Department of the Army authorization to install and maintain twenty (20) monopiles, eleven (11) shore anchor piles and two (2) anchor piles with buoys, all to expand an existing barge fleet, consisting of 10 tiers, each 8 barges wide. Approximately 220 cubic yards of rip-rap material will be installed around the monopoles.

MITIGATION: The applicant states that the proposed project has been designed to avoid and minimize direct and secondary adverse impacts to the maximum amount practicable. No permanent impacts to vegetated wetlands are expected, and no mitigation is anticipated.

The comment period for the Department of the Army Permit will close **30 days** from the date of this public notice. Written comments, including suggestions for modifications or objections to the proposed work, stating reasons thereof, are being solicited from anyone having interest in this permit must be mailed so as to be received before or by the last day of the comment period. Letters concerning the Corps of Engineers permit application must reference the applicant's name and the Permit Application Number and be preferably emailed to the Corps of Engineers project manager listed above or mailed to the Corps of Engineers at the address above, **ATTENTION: REGULATORY DIVISION, RGC, Dirreen Arnold**. This public notice is also available for review online at <https://go.usa.gov/xennJ>

Corps of Engineers Permit Criteria

The decision whether to issue a permit will be based on an evaluation of the probable impacts, including cumulative impacts of the proposed activity on the public interest. That decision will reflect the national concern for both protection and utilization of important resources. The benefit which reasonably may be expected to accrue from the proposal must be balanced against its reasonably foreseeable detriments. All factors which may be relevant to the proposal will be considered including the cumulative effects thereof; among those are conservation, economics, aesthetics, general environmental concerns, wetlands, historic properties, fish and wildlife values, flood hazards, floodplain values, land use, navigation, shoreline erosion and accretion, recreation, water supply and conservation, water quality, energy needs, safety, food and fiber production, mineral needs, considerations of property ownership and, in general, the needs and welfare of the people.

This request will also be reviewed pursuant to Section 408 and USACE Engineering Circular (EC) 1165-2-220, which provides policy and procedural guidance for processing requests to alter USACE civil works projects.

The decision whether to grant permission for the requested alteration will be based on several factors. The benefits that reasonably may be expected to accrue from the proposal will be balanced against its reasonably foreseeable detriments. Review of the requests for modification will be reviewed by a USACE technical review team considering the following factors:

1) Potential to Impair the Usefulness of the Project. Proposed alterations will be reviewed to determine whether the alteration would limit the ability of the USACE project to function as authorized, or would compromise or change any authorized project conditions, purposes or outputs. If USACE determines that the usefulness of the authorized project would be impaired, the request will be denied.

2) Potential to be Injurious to the Public Interest. Proposed alterations will be reviewed to determine the probable impacts, including cumulative impacts, on the public interest. Factors that may be relevant to the public interest depend upon the type of USACE project being altered and may include, but are not limited to, such things as conservation,

economic development, historic properties, cultural resources, environmental impacts, water supply, water quality, flood hazards, floodplains, residual risk, induced damages, navigation, shore erosion or accretion, and recreation. This evaluation will consider information received from the interested parties, including tribes, agencies, and the public. The decision whether to approve an alteration will be determined by the consideration of whether benefits are commensurate with risks. If the potential detriments are found to outweigh the potential benefits, then it may be determined that the proposed alteration is injurious to the public interest.

The U.S. Army Corps of Engineers is soliciting comments from the public, federal, state, and local agencies and officials, Indian Tribes, and other interested parties in order to consider and evaluate the impacts of this proposed activity. Any comments received will be considered by the U.S. Army Corps of Engineers to determine whether to make, modify, condition, or deny a permit for this proposal. To make this decision, comments are used to assess impacts on endangered species, historic properties, water quality, general environmental effects, and other public interest factors listed above. Comments are used in the preparation of an Environmental Assessment and/or an Environmental Impact Statement pursuant to the National Environmental Policy Act. Comments are also used to determine the need for a public hearing and to determine the overall public interest of the proposed activity. Further, all factors that may be relevant to the proposal will be considered, including the potential cumulative effects associated with the proposed project. The Section 408 review will consider the potential impact to the usefulness of the Federal project and whether the proposed alteration would be injurious to the public interest. Policy and legal compliance will also be considered.

The New Orleans District is presently unaware of properties listed on the National Register of Historic Places near the proposed work. The possibility exists that the proposed work may damage or destroy presently unknown archeological, scientific, pre-historical, historical sites, or data. As deemed necessary, copies of this public notice will be sent to the State Archeologist, State Historic Preservation Officer, and federally listed tribes regarding potential impacts to cultural resources.

Our initial finding is that the proposed work is Not Likely to Adversely Affect any species as endangered by the U.S. Department of Commerce, nor affect any habitat designated as critical to the survival and recovery of any endangered species.

The New Orleans District has determined that the proposed project is located in waters known to be utilized by the pallid sturgeon (*Scaphirhynchus albus*) and determined that the proposed activity is not likely to adversely affect the species based on the Information Planning and Consultation (IPaC) procedure for Endangered Species in Louisiana, as signed on January 27, 2020, between the U.S. Army Corps of Engineers, New Orleans, and the U.S. Fish and Wildlife Service.

This notice initiates the Essential Fish Habitat (EFH) consultation requirements of the Magnuson-Stevens Fishery Conservation and Management Act. The applicant's proposal may result in the destruction or alteration of 0.0 acres of EFH utilized by

various life stages of red drum and penaeid shrimp. Our initial determination is that the proposed action would not have a substantial adverse impact on EFH or federally managed fisheries in the Gulf of Mexico. Our final determination relative to project impacts and the need for mitigation measures is subject to review by and coordination with the National Marine Fisheries Service.

If the proposed work involves deposits of dredged or fill material into navigable waters, the evaluation of the probable impacts will include the application of guidelines established by the Administrator of the Environmental Protection Agency. Also, a certification that the proposed activity will not violate applicable water quality standards will be required from the Louisiana Department of Environmental Quality, Office of Environmental Services, before a permit is issued.

Any person may request, (preferably by email to the project manager, or in writing), within the comment period specified in this notice, that a public hearing be held to consider this application. Requests for public hearings shall state, with particularity, the reasons for holding a public hearing.

You are invited to communicate the information contained in this notice to any other parties whom you deem likely to have interest in the matter.

John M. Herman
Chief, Central Evaluation Branch
Regulatory Division

Enclosures

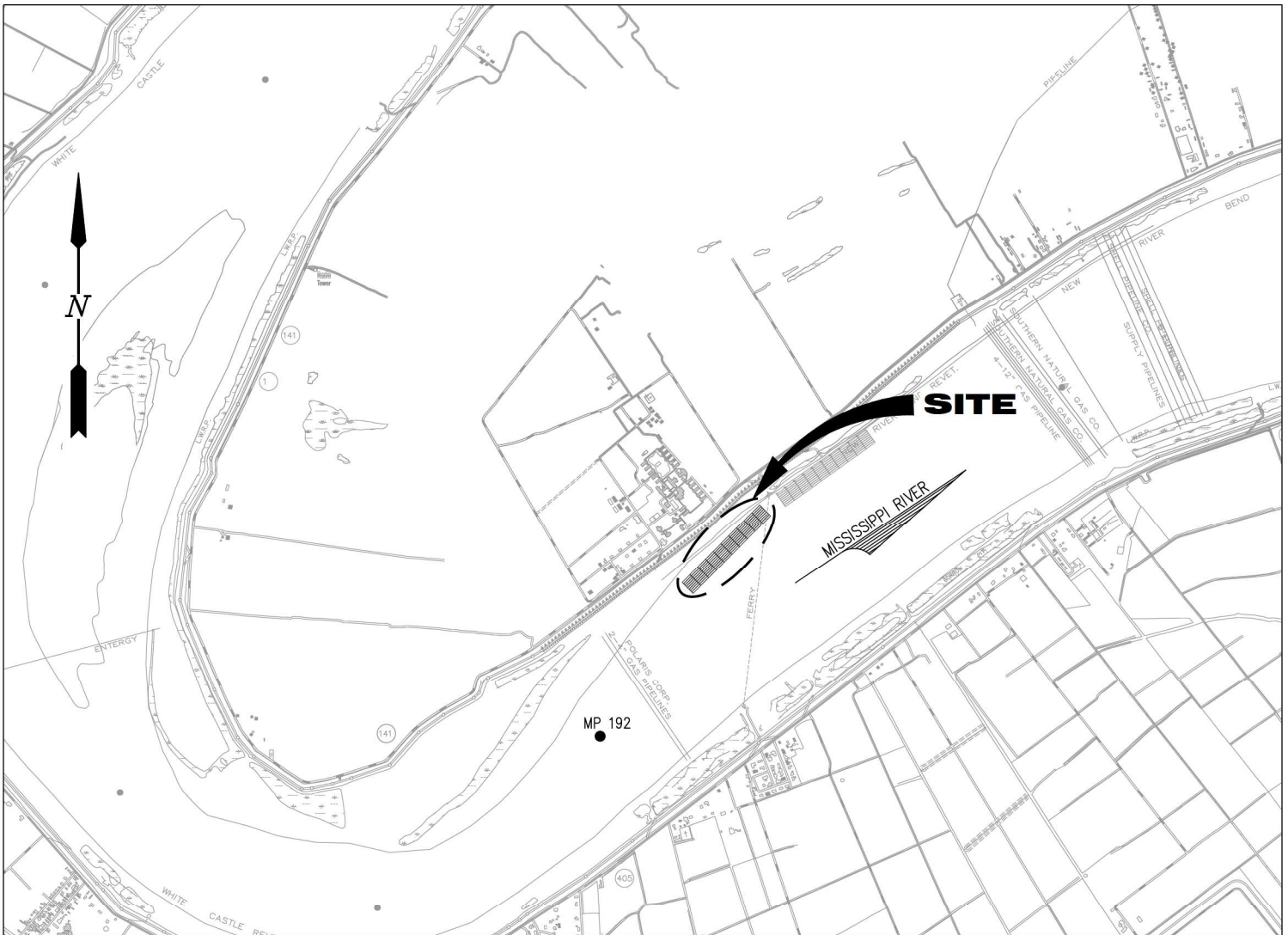

VICINITY MAP

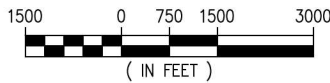

IBERVILLE PARISH
 LAT. 30° 11' 46" N
 LONG. 91° 07' 22" W

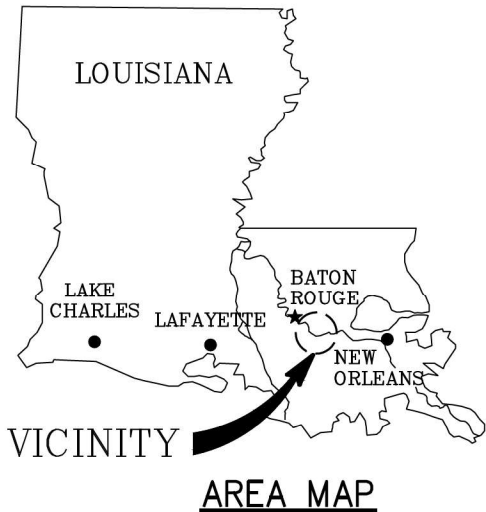

NOTES:

1. AS-BUILT DRAWINGS WILL BE SUBMITTED WITHIN 30 DAYS OF COMPLETION OF THIS PROJECT TO THE LOUISIANA DEPARTMENT OF NATURAL RESOURCES, OFFICE OF CONSERVATION, PIPELINE DIVISION, P. O. BOX 94275 BATON ROUGE, LA 70804, AND TO THE LOUISIANA DEPARTMENT OF NATURAL RESOURCES, COASTAL MANAGEMENT DIVISION, P. O. BOX 44487, BATON ROUGE, LA 70804-4487.
2. ALL STRUCTURES, FACILITIES, WELL AND PIPELINES/FLOWLINES OCCURRING IN OPEN WATER AREAS OR IN OILFIELD CANALS OR SLIPS SHALL BE REMOVED WITHIN 120 DAYS OF ABANDONMENT OR THE FACILITIES FOR THE HEREIN PERMITTED USE UNLESS PRIOR WRITTEN APPROVAL TO LEAVE SUCH STRUCTURES IN PLACE IS RECEIVED FROM THE COASTAL MANAGEMENT DIVISION. THIS CONDITION DOES NOT PRECLUDE THE NECESSITY FOR REVISING THE CURRENT PERMIT OR OBTAINING A SEPARATE COASTAL USE PERMIT, SHOULD ONE BE REQUIRED.
3. STRUCTURES MUST ALSO BE MARKED / LIGHTED IN ACCORDANCE WITH U. S. COAST GUARD REGULATIONS.
4. IN ORDER TO ENSURE THE SAFETY OF ALL PARTIES, THE PERMITTEE SHALL CONTACT THE LOUISIANA ONE CALL SYSTEM (1-800-272-3020) A MINIMUM OF 48 HOURS PRIOR TO THE COMMENCEMENT OF ANY EXCAVATION (DIGGING, DREDGING, JETTING, ETC.) OR DEMOLITION ACTIVITY.

CHAD B. SHAW P.E.
 LA PE #47340

PRELIMINARY - FOR PERMITTING PURPOSES ONLY, NOT FOR CONSTRUCTION

REV
 A



LANIER & ASSOCIATES
 CONSULTING ENGINEERS, INC.

LA: EF-1120 TX: F-2981
 VF-185 LSF-10194817

NEW ORLEANS • BEAUMONT • CORPUS CHRISTI • HOUSTON • MANDEVILLE

CARVILLE

SHAMROCK MARINE

LOUISIANA

**PROPOSED BARGE FLEET EXTENSION
 VICINITY MAP, AREA MAP & NOTES**

DATE	OCT. '23
DESIGN	CBS
DRAWN	SWF
CHECK	JDM
JOB NO.	12640
SHEET No.	1 OF 6

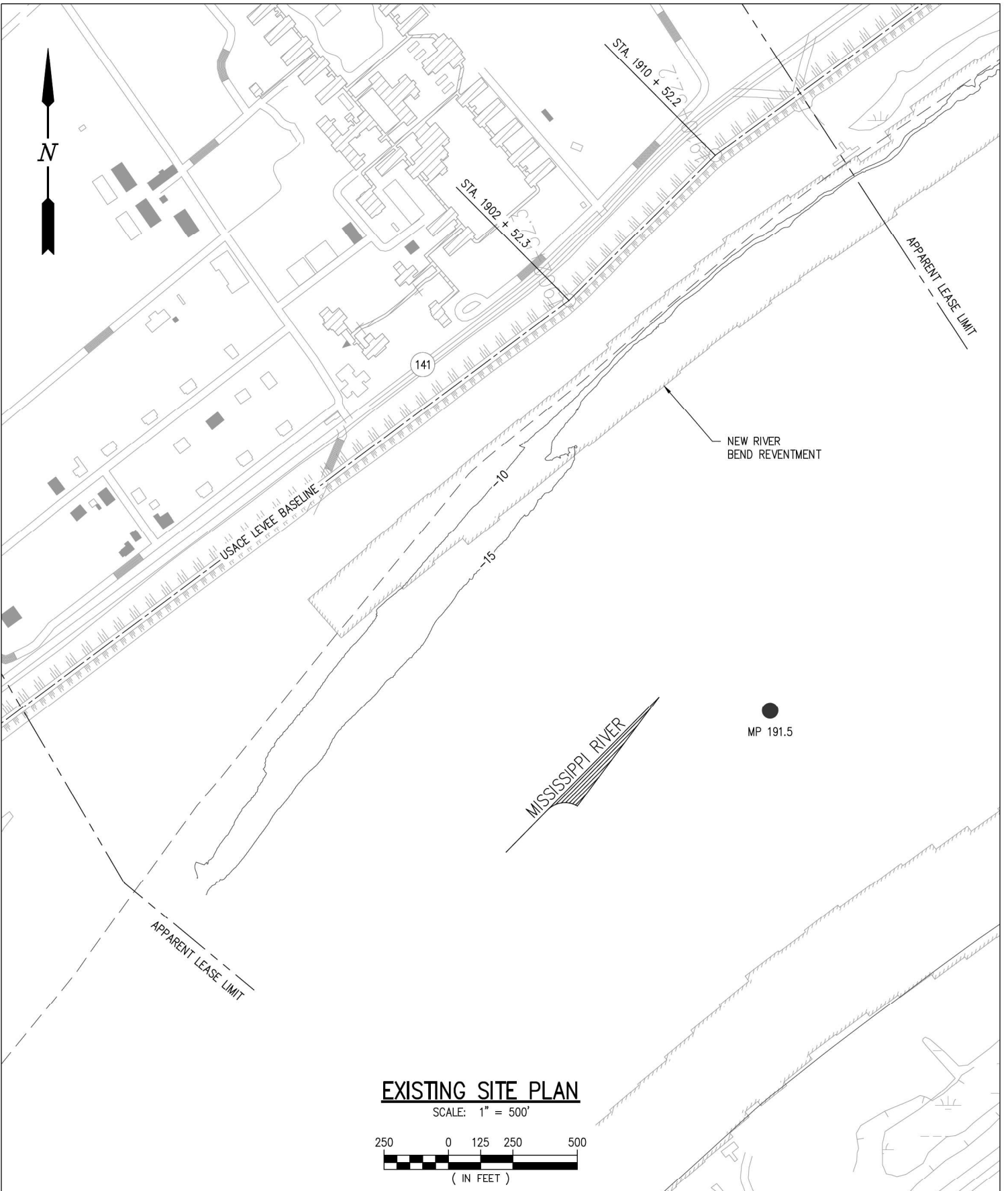

EXISTING SITE PLAN

SCALE: 1" = 500'

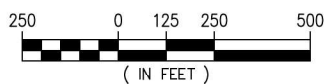

CHAD B. SHAW P.E.
LA PE #47340

PRELIMINARY - FOR PERMITTING PURPOSES ONLY, NOT FOR CONSTRUCTION

REV
A



LANIER & ASSOCIATES
CONSULTING ENGINEERS, INC.

LA: EF-1120 TX: F-2981
VF-185 LSF-10194817

NEW ORLEANS • BEAUMONT • CORPUS CHRISTI • HOUSTON • MANDEVILLE

CARVILLE

SHAMROCK MARINE

LOUISIANA

**PROPOSED BARGE FLEET EXTENSION
EXISTING SITE PLAN**

DATE	OCT. '23
DESIGN	CBS
DRAWN	SWF
CHECK	JDM
JOB NO.	12640
SHEET No.	2 OF 6

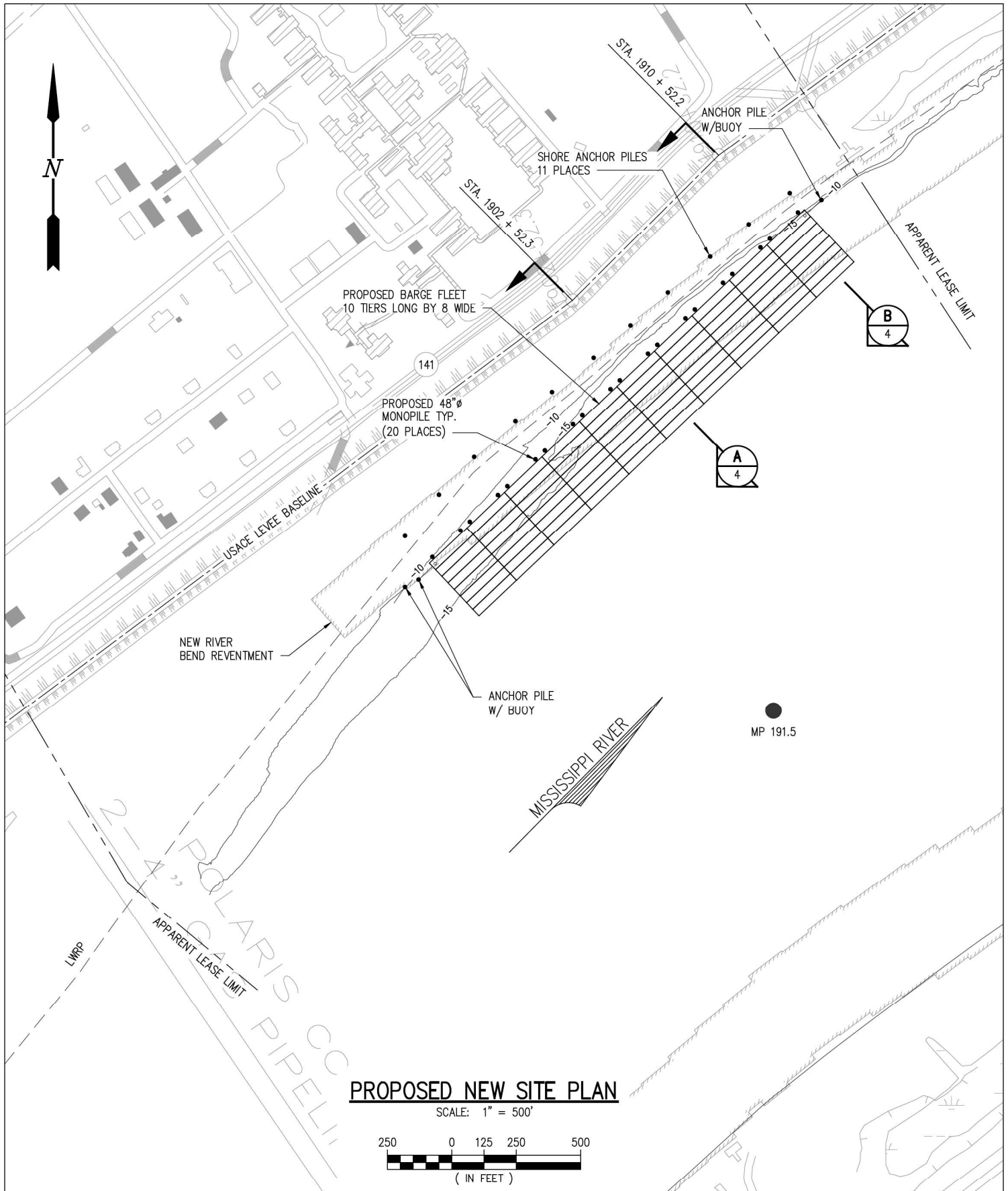

PROPOSED NEW SITE PLAN

SCALE: 1" = 500'

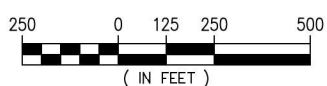

CHAD B. SHAW P.E.
LA PE #47340

PRELIMINARY - FOR PERMITTING PURPOSES ONLY, NOT FOR CONSTRUCTION

REV
A

LANIER & ASSOCIATES
CONSULTING ENGINEERS, INC.

LA: EF-1120 TX: F-2981
VF-185 LSF-10194817

NEW ORLEANS • BEAUMONT • CORPUS CHRISTI • HOUSTON • MANDEVILLE

SHAMROCK MARINE
CARVILLE LOUISIANA

PROPOSED BARGE FLEET EXTENSION
PROPOSED NEW SITE PLAN

DATE	OCT. '23
DESIGN	CBS
DRAWN	SWF
CHECK	JDM
JOB NO.	12640
SHEET No.	3 OF 6

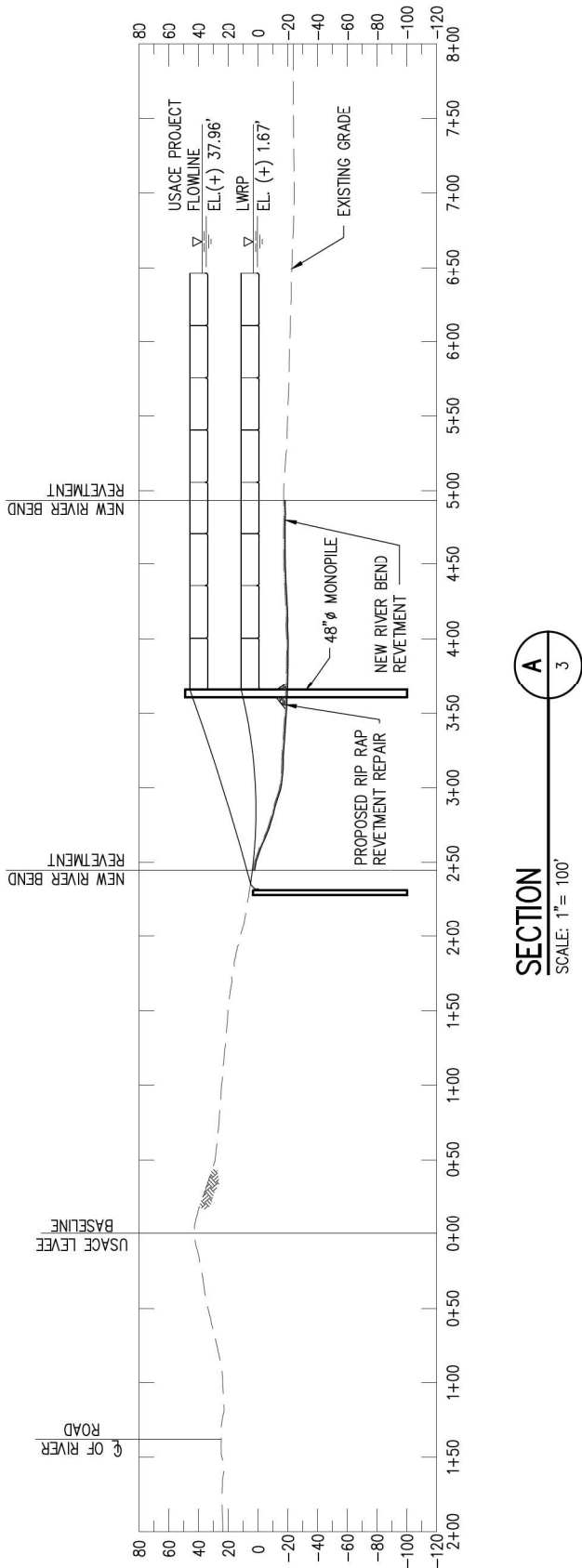

SECTION A 3
SCALE: 1" = 100'

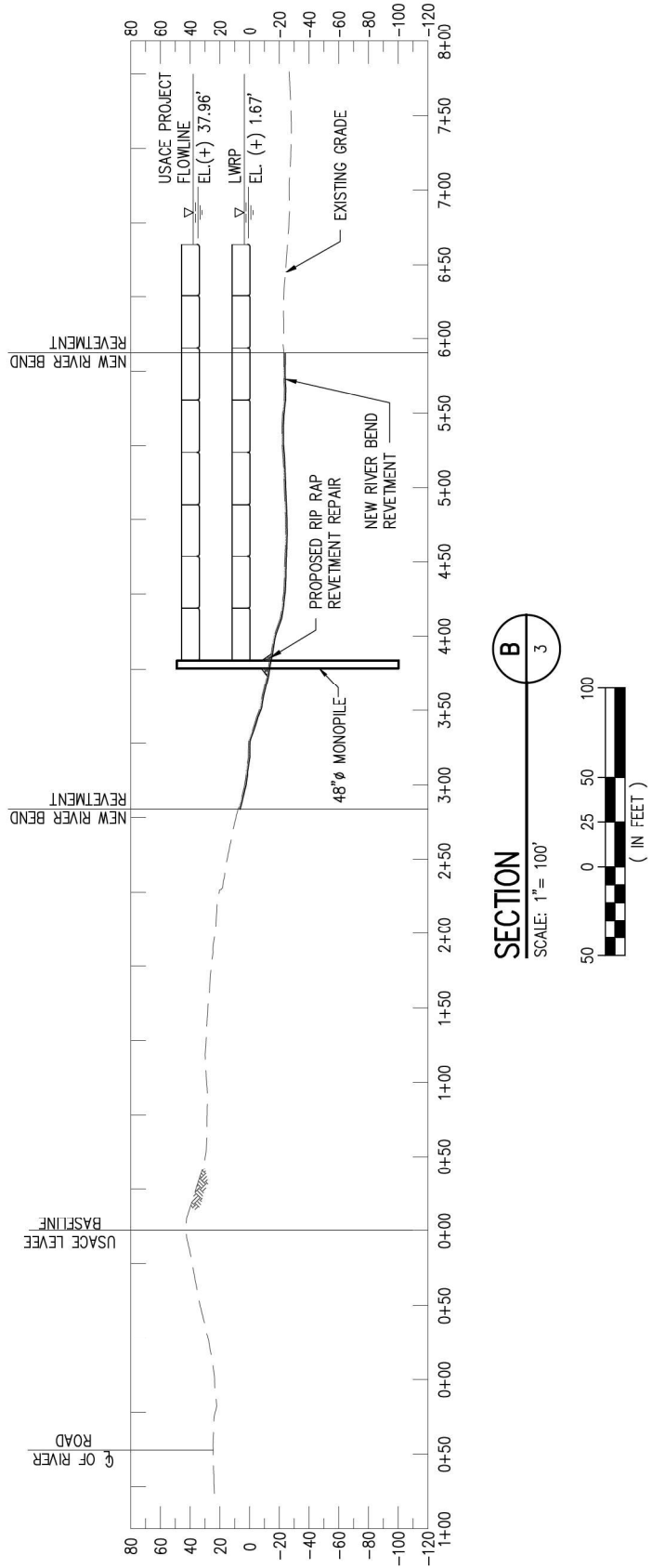

SECTION B 3
SCALE: 1" = 100'

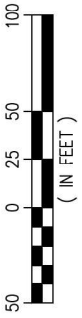

CHAD B. SHAW P.E.
LA PE #47340

PRELIMINARY - FOR PERMITTING PURPOSES ONLY, NOT FOR CONSTRUCTION

REV
A



LANIER & ASSOCIATES
CONSULTING ENGINEERS, INC.

LA: EF-1120 TX: F-2981
VF-185 LSF-10194817

NEW ORLEANS • BEAUMONT • CORPUS CHRISTI • HOUSTON • MANDEVILLE

CARVILLE

SHAMROCK MARINE

LOUISIANA

**PROPOSED BARGE FLEET EXTENSION
SECTIONS**

DATE OCT. '23
DESIGN CBS
DRAWN SWF
CHECK JDM
JOB NO 12640
SHEET No.

4 OF 6

T.O.P. EL. (+) 48.0'

USACE PROJECT FLOWLINE
EL. (+) 37.96'

LWRP EL. 1.67'

RIVER BOTTOM EL. -10.0' (±)

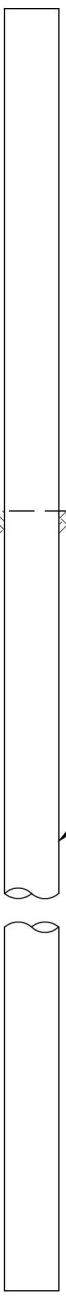

48"Ø STEEL PIPE PILE

TIP. EL. (-) 100.0'

PROPOSED BARGE MONOPILE

SCALE: 1/16" = 1'-0"
(30 REQ'D)

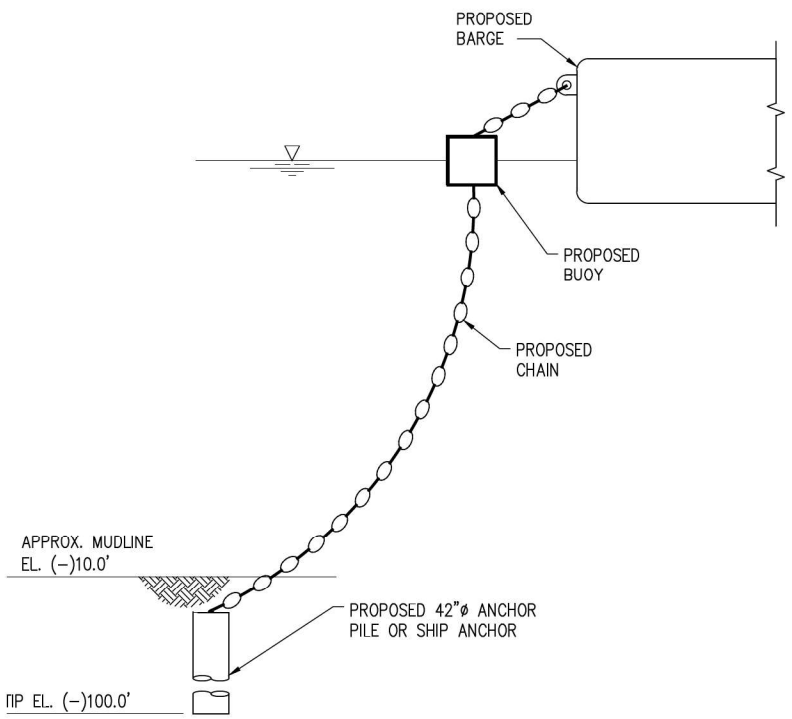

PROPOSED BARGE FLEET ANCHOR PILE

SCALE: 1/16" = 1'-0"
(4 REQ'D)

APPROX. MUDLINE
EL. (-)10.0'

PROPOSED 42"Ø ANCHOR
PILE OR SHIP ANCHOR

TIP EL. (-)100.0'

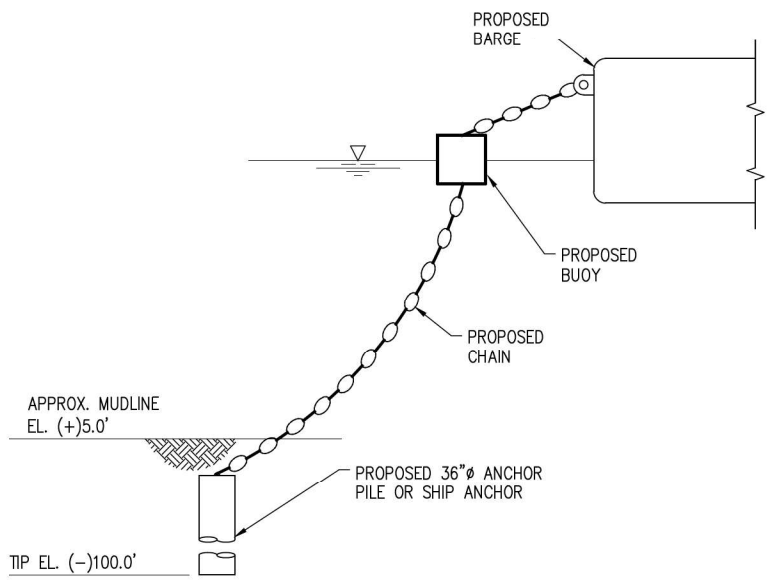

PROPOSED SHORE ANCHOR PILE

SCALE: 1/16" = 1'-0"
(17 REQ'D)

APPROX. MUDLINE
EL. (+)5.0'

PROPOSED 36"Ø ANCHOR
PILE OR SHIP ANCHOR

TIP EL. (-)100.0'

CHAD B. SHAW P.E.
LA PE #47340

PRELIMINARY - FOR PERMITTING PURPOSES ONLY, NOT FOR CONSTRUCTION

REV
A



LANIER & ASSOCIATES
CONSULTING ENGINEERS, INC.

LA: EF-1120 TX: F-2981
VF-185 LSF-10194817

NEW ORLEANS • BEAUMONT • CORPUS CHRISTI • HOUSTON • MANDEVILLE

CARVILLE

SHAMROCK MARINE

LOUISIANA

**PROPOSED BARGE FLEET EXTENSION
PROPOSED PILING ELEVATIONS**

DATE	OCT. '23
DESIGN	CBS
DRAWN	SWF
CHECK	JDM
JOB NO.	12640
SHEET No.	
	5 OF 6

PILE CLUSTER

SPUD PILE (BUOY AND ANCHOR CHAIN)

CAISSON

PILE

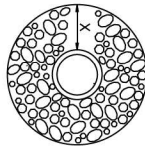
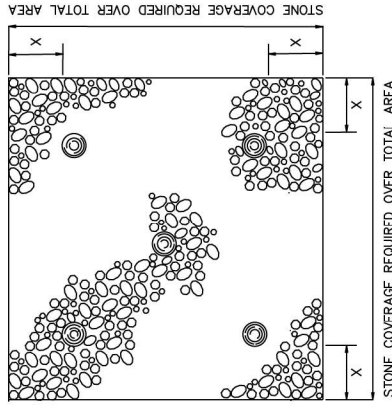
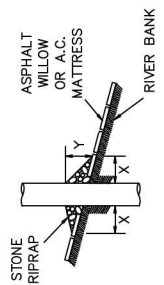
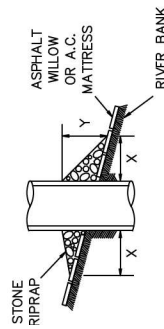
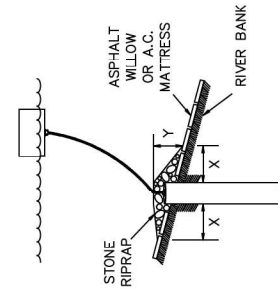
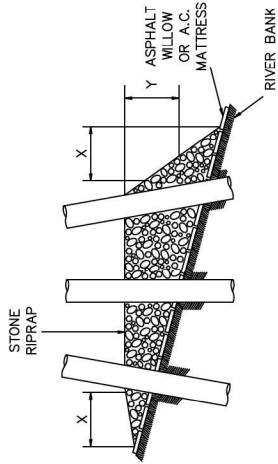

NOTES:

1. SIZE OF RIPRAP TO VARY BETWEEN 6 POUNDS AND 125 POUNDS WITH 40 PERCENT TO 60 PERCENT OF THE STONE WITHIN THE RANGE OF 25 POUNDS TO 75 POUNDS.
2. WHEN PENETRATING THE UPPER BANK PAVING IN A REVETMENT AREA WITH PILES, CAISSONS AND/OR PILE CLUSTERS, A 10 INCH THICK RIPRAP STONE LAYER SHALL BE PLACED OVER ALL AREAS WHERE THE BANK PAVING IS DISTURBED BY DRIVING OPERATIONS.
3. WHEN USING AN ANCHOR CHAIN AND BUOY SYSTEM, THE ANCHOR CHAIN MUST BE ATTACHED AT THE TOP OF THE PILE TO MINIMIZE REVETMENT DAMAGE.

DEPTH OF WATER IN FEET AT POINT OF PENETRATION AT TIME OF STONE PLACEMENT	DIMENSIONS IN FEET FOR PROTECTION AREA REQUIRED								
	PILE		CAISSON			SPUD PILE (BUOY AND ANCHOR CHAIN)			PILE CLUSTER
	X	Y	X	Y	X	Y	X	Y	Y
1' - 10'	3	1.5	5	2	2	3	3	1	1
11' - 40'	5	2	8	3	7	3	6	2	2
41' - 60'	8	3	12	4	12	4	10	3	3

CHAD B. SHAW P.E.
LA PE #47340

PRELIMINARY - FOR PERMITTING PURPOSES ONLY, NOT FOR CONSTRUCTION

REV
A



LANIER & ASSOCIATES
CONSULTING ENGINEERS, INC.

LA: EF-1120 TX: F-2981
VF-185 LSF-10194817

NEW ORLEANS • BEAUMONT • CORPUS CHRISTI • HOUSTON • MANDEVILLE

CARRVILLE

SHAMROCK MARINE

LOUISIANA

**PROPOSED BARGE FLEET EXTENSION
USACE REVETMENT REPAIR DETAIL**

DATE OCT. '23
DESIGN JDM
DRAWN PJC
CHECK CAP
JOB NO 12640
SHEET No.
6 OF 6

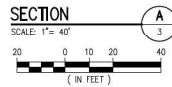
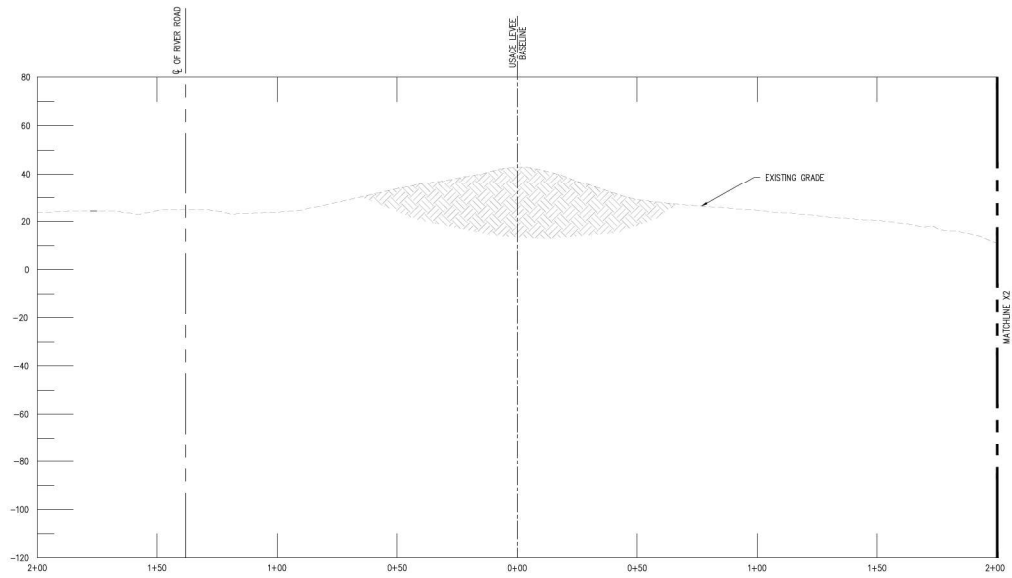

LANIER & ASSOCIATES
 CONSULTING ENGINEERS, INC.
 LA: EF-1120 TX: F-2981
 VF-185 LSF-10194817
 NEW ORLEANS • BEAUMONT • CORPUS CHRISTI • HOUSTON • MANDEVILLE

REV	DATE	BY	DESCRIPTION	REV	DATE	BY	DESCRIPTION

THIS DOCUMENT IS RELEASED FOR THE PURPOSE OF REVIEW UNDER THE AUTHORITY OF CHAD B. SHAW, P.E. #1240 ON 11/08/23. IT IS NOT TO BE USED FOR BIDDING OR CONSTRUCTION PURPOSES.

CHAD B. SHAW P.E.
 LA P.E. #47340

DATE: OCT. 23
 SHEET SIZE: 11x17
 DESIGN: CBS
 DRAWN: ADC
 CHECK: JDM
 APPR'D: CBS
 JOB NO. 12840

PRELIMINARY - FOR PERMITTING PURPOSES ONLY, NOT FOR CONSTRUCTION

SHAMROCK MARINE
 CARVILLE LOUISIANA

PROPOSED BARGE FLEET EXTENSION
SECTION A
SHEET 1 OF 2

SHEET NO. **X1**

11/8/2023 12:54 PM

A:\20005\12840 SHAMROCK BARGE FLEET EXT\DRAWINGS\PERMIT\944_11167.DWG

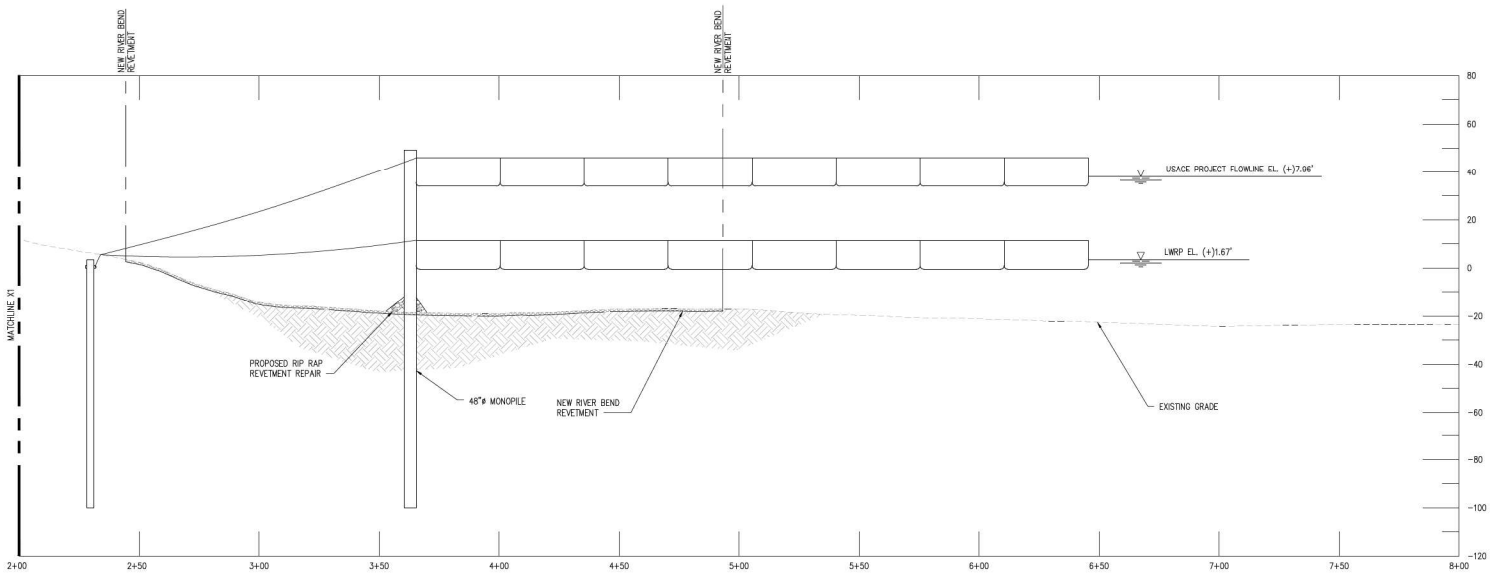

LANIER & ASSOCIATES
 CONSULTING ENGINEERS, INC.
 LA: EF-1120 TX: F-2981
 VF-185 LSF-10194817
 NEW ORLEANS • BEAUMONT • CORPUS CHRISTI • HOUSTON • MANDEVILLE

REV	DATE	BY	DESCRIPTION	REV	DATE	BY	DESCRIPTION

THIS DOCUMENT IS RELEASED FOR THE PURPOSE OF REVIEW UNDER THE AUTHORITY OF CHAD B. SHAW, P.E. #1240 ON 11/08/23. IT IS NOT TO BE USED FOR BIDDING OR CONSTRUCTION PURPOSES.

CHAD B. SHAW P.E.
 LA P.E. #47340
 DATE: OCT. 23
 SHEET NO.: 11167
 DESIGN: CBS
 DRAWN: ADC
 CHECK: JDM
 APPR'D: CBS
 JOB NO.: 12840

PRELIMINARY - FOR PERMITTING PURPOSES ONLY, NOT FOR CONSTRUCTION

SHAMROCK MARINE
 CARVILLE LOUISIANA

PROPOSED BARGE FLEET EXTENSION
SECTION A
SHEET 2 OF 2

SHEET NO. **X2**

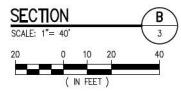
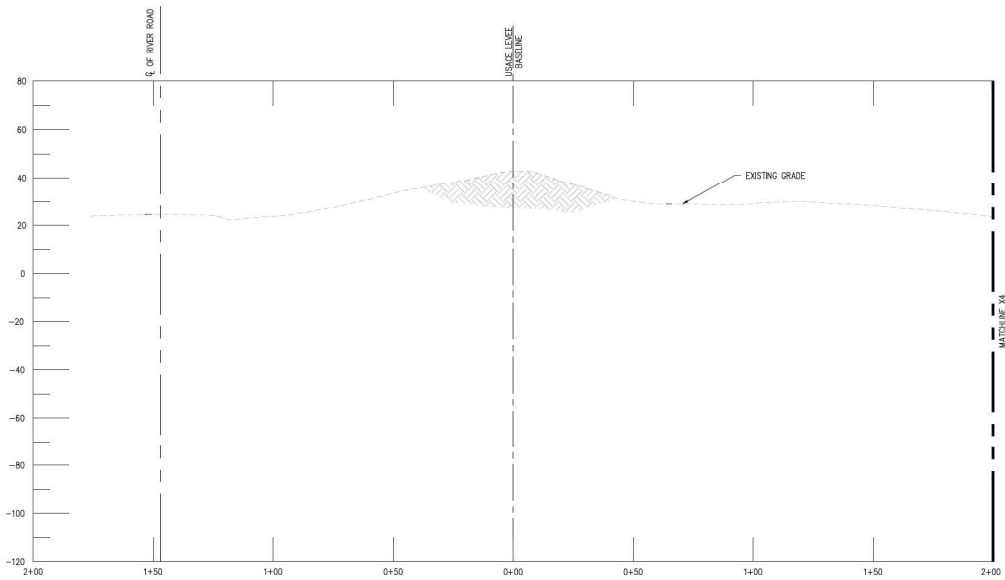

LANIER & ASSOCIATES
 CONSULTING ENGINEERS, INC.
 LA: EF-1120 TX: F-2981
 VF-185 LSF-10194817
 NEW ORLEANS • BEAUMONT • CORPUS CHRISTI • HOUSTON • MANDEVILLE

REV	DATE	BY	DESCRIPTION	REV	DATE	BY	DESCRIPTION

THIS DOCUMENT IS RELEASED FOR THE PURPOSE OF REVIEW UNDER THE AUTHORITY OF CHAD B. SHAW, P.E. #1240 ON 11/08/23. IT IS NOT TO BE USED FOR BIDDING OR CONSTRUCTION PURPOSES.

CHAD B. SHAW P.E.
 LA P.E. #47340

PRELIMINARY - FOR PERMITTING PURPOSES ONLY, NOT FOR CONSTRUCTION

SHAMROCK MARINE
 CARVILLE LOUISIANA
PROPOSED BARGE FLEET EXTENSION
SECTION B
SHEET 1 OF 2

SHEET NO.
X3

11/8/2023 12:54 PM

A:\20005\12840 SHAMROCK BARGE FLEET EXT\DRAWINGS\PERMIT\94-11167.DWG

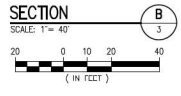
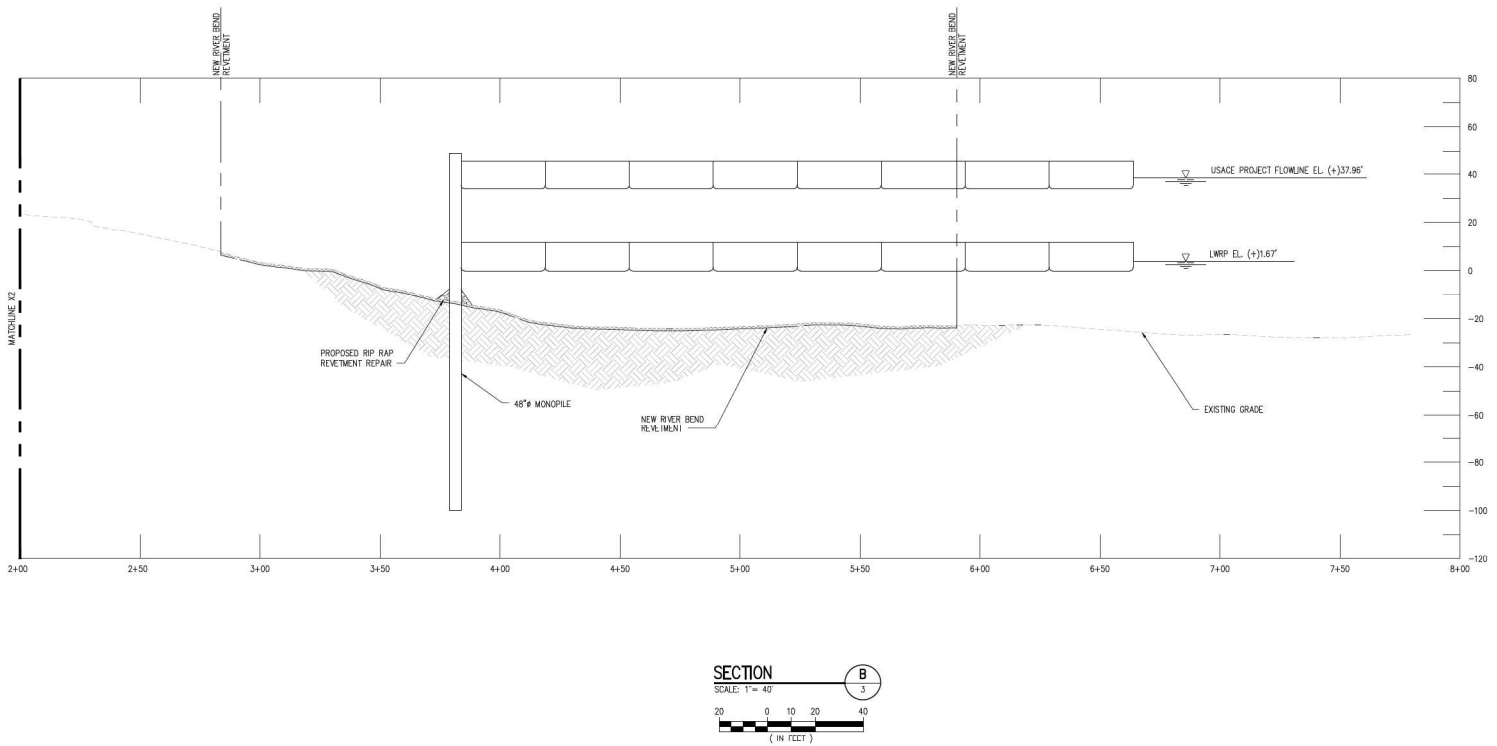

LANIER & ASSOCIATES
 CONSULTING ENGINEERS, INC.
 LA: EF-1120 TX: F-2981
 VF-185 LSF-10194817
 NEW ORLEANS • BEAUMONT • CORPUS CHRISTI • HOUSTON • MANDEVILLE

REV	DATE	BY	DESCRIPTION	REV	DATE	BY	DESCRIPTION

THIS DOCUMENT IS RELEASED FOR THE PURPOSE OF REVIEW UNDER THE AUTHORITY OF CHAD B. SHAW, P.E. #1240 ON 11/08/23. IT IS NOT TO BE USED FOR BIDDING OR CONSTRUCTION PURPOSES.

CHAD B. SHAW P.E. LA P.E. #47340
 PRELIMINARY - FOR PERMITTING PURPOSES ONLY, NOT FOR CONSTRUCTION

DATE: OCT. 23
 SHEET SIZE: 11x17
 DESIGN: CBS
 DRAWN: ADC
 CHECK: JDM
 APPR'D: CBS
 JOB NO. 12840

SHAMROCK MARINE
 CARVILLE LOUISIANA

PROPOSED BARGE FLEET EXTENSION
SECTION B
SHEET 2 OF 2

SHEET NO. **X4**