

JOINT PUBLIC NOTICE

December 2, 2019

United States Army Corps of Engineers
New Orleans District
Regulatory Branch
7400 Leake Avenue
New Orleans, Louisiana 70118

(504) 862-1288
Project Manager
Zach Steinkoenig
Zachary.j.steinkoenig@usace.army.mil
MVN 2019-01215-CF

State of Louisiana
Department of Environmental Quality
Water Permits Division
Post Office Box 4313
Baton Rouge, Louisiana 70821-4313

(225) 219-3225
Project Manager
Elizabeth Hill
WQC Application Number
WQC #191122-01

Interested parties are hereby notified that a permit application has been received by the New Orleans District of the US Army Corps of Engineers pursuant to: [X] Section 10 of the Rivers and Harbors Act of March 3, 1899 (30 Stat. 1151; 33 USC 403) and [X] Section 404 of the Clean Water Act (86 Stat. 816; 33 USC 1344).

Application has also been made to the Louisiana Department of Environmental Quality for a Water Quality Certification (WQC) in accordance with statutory authority contained in LRS 30:2074 A(3) and provisions of Section 401 of the Clean Water Act.

PROPOSED BARGE DOCK STRUCTURE IN MISSISSIPPI RIVER

NAME OF APPLICANT: Ingram Barge Company, c/o Lanier & Associates Consulting Engineers Inc., 4101 Magazine Street, New Orleans, Louisiana, 70115. ATTENTION: Price Lanier.

LOCATION OF WORK: In Mississippi River, left descending bank, mile point 234, Baton Rouge, Louisiana, in East Baton Rouge Parish, within the Mississippi River Basin in hydrologic unit (HUC 08070100), as shown on the attached drawings.

CHARACTER OF WORK: The applicant has requested a Department of the Army authorization to install and maintain a new barge dock at mile point 234 of the Mississippi River on the left descending bank. Approximately 500 cubic yards of concrete material would be hauled in and deposited to install and maintain 2 new reinforced concrete ramps. Pilings will be driven for the proposed dock structure. It is anticipated that the proposed action would have no impact on wetlands.

A preliminary analysis has determined there are no wetlands at the project site.

The comment period for the Department of Army will close in **30 days** from the date of this public notice. Written comments, including suggestions for modifications or objections to the proposed work, stating reasons thereof, are being solicited from anyone having interest in this permit and must be mailed so as to be received before or by the last day of the comment period. Letters concerning the Corps of Engineers permit application must

reference the applicant's name and the Permit Application Number, and be mailed to the Corps of Engineers at the address above. **ATTENTION: REGULATORY BRANCH** Similar letters concerning the Water Quality Certification must reference the applicant's name and the WQC application number and be mailed to the Louisiana Department of Environmental Quality at the address above.

The application for this proposed project is on file with the Louisiana Department of Environmental Quality and may be examined during weekdays between 8:00 a.m. and 4:30 p.m. Copies may be obtained upon payment of costs of reproduction.

Corps of Engineers Permit Criteria

The decision whether to issue a permit will be based on an evaluation of the probable impacts, including cumulative impacts of the proposed activity on the public interest. That decision will reflect the national concern for both protection and utilization of important resources. The benefit which reasonably may be expected to accrue from the proposal must be balanced against its reasonably foreseeable detriments. All factors which may be relevant to the proposal will be considered including the cumulative effects thereof; among those are conservation, economics, aesthetics, general environmental concerns, wetlands, historic properties, fish and wildlife values, flood hazards, floodplain values, land use, navigation, shoreline erosion and accretion, recreation, water supply and conservation, water quality, energy needs, safety, food and fiber production, mineral needs, considerations of property ownership and, in general, the needs and welfare of the people.

The U.S. Army Corps of Engineers is soliciting comments from the public, federal, state, and local agencies and officials, Indian Tribes, and other interested parties in order to consider and evaluate the impacts of this proposed activity. Any comments received will be considered by the U.S. Army Corps of Engineers to determine whether to make, modify, condition, or deny a permit for this proposal. To make this decision, comments are used to assess impacts on endangered species, historic properties, water quality, general environmental effects, and other public interest factors listed above. Comments are used in the preparation of an Environmental Assessment and/or an Environmental Impact Statement pursuant to the National Environmental Policy Act. Comments are also used to determine the need for a public hearing and to determine the overall public interest of the proposed activity.

The New Orleans District is unaware of properties listed on the National Register of Historic Places near the proposed work. The possibility exists that the proposed work may damage or destroy presently unknown archeological, scientific, prehistorical, historical sites, or data. Copies of this notice are being sent to the State Archeologist and State Historic Preservation Officer.

The New Orleans District has determined that the proposed project is located in waters known to be utilized by the pallid sturgeon (*Scaphirhynchus albus*) and determined that the proposed activity is not likely to adversely affect the species based on the Standard Local Operating Procedure for Endangered Species of Louisiana (SLOPES), dated October 22, 2014, between the U.S. Army Corps of Engineers and U.S. Fish and Wildlife Service, Ecological Services Office.

This notice initiates the Essential Fish Habitat (EFH) consultation requirements of the Magnuson-Stevens Fishery Conservation and Management Act. The applicant's proposal would result in the destruction or alteration of up to 0 acre of EFH utilized by various life stages of red drum and penaeid shrimp. Our initial determination is that the proposed action would not have a substantial adverse impact on EFH or federally managed fisheries in the Gulf of Mexico. Our final determination relative to project impacts and the need for mitigation measures is subject to review by and coordination with the National Marine Fisheries Service.

If the proposed work involves deposits of dredged or fill material into navigable waters, the evaluation of the probable impacts will include the application of guidelines established by the Administrator of the Environmental Protection Agency. Also, a certification that the proposed activity will not violate water quality standards will be required from the Department of Environmental Quality, Office of Environmental Services before a permit is issued.

Any person may request, in writing, within the comment period specified in this notice, that a public hearing be held to consider this application. Requests for public hearings shall state, with particularity, the reasons for holding a public hearing. You are requested to communicate the information contained in this notice to any other parties whom you deem likely to have interest in the matter.

JOHN M. HERMAN
Chief, Central Evaluation Section
Regulatory Branch

Enclosures

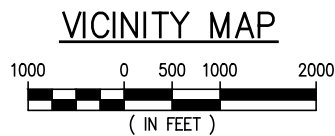
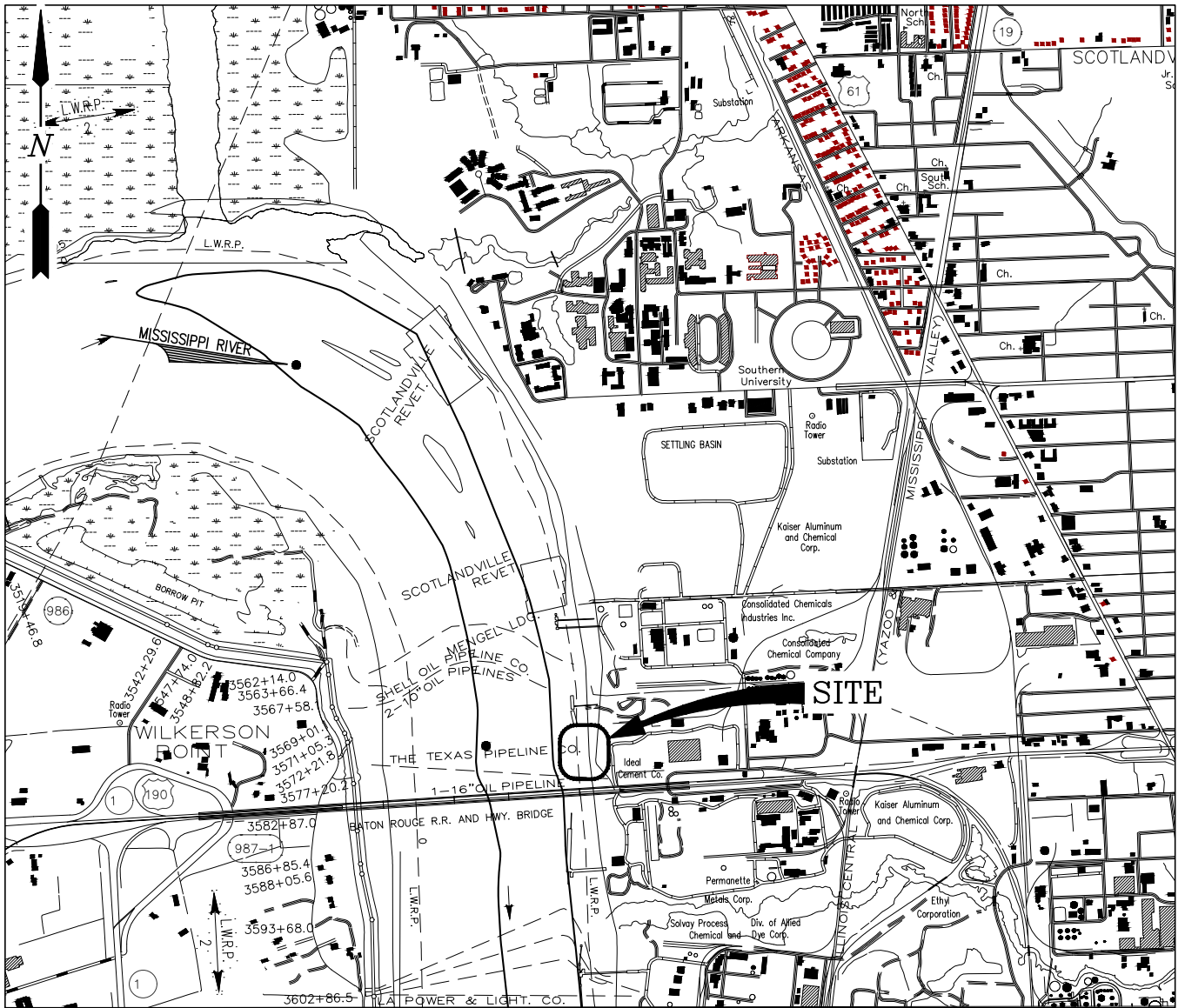

PARISH: EAST BATON ROUGE
 LATITUDE: 30°30'31"
 LONGITUDE: 91°11'40"

FOR PERMIT
 OCTOBER 30, 2019

RICHARD R. MESTAYER
 LA PE #34732

PRELIMINARY - FOR PERMIT PURPOSES ONLY

REV
 0

LANIER & ASSOCIATES
 CONSULTING ENGINEERS
 INCORPORATED

LA: C-1120 TX: F-2981
 NEW ORLEANS, LA • BEAUMONT, TX

INGRAM BARGE COMPANY
 BATON ROUGE LOUISIANA

**PROPOSED NEW BARGE DOCK
 VICINITY MAP**

DATE OCT '19
 DESIGN RRM
 DRAWN JDM
 CHECK NPL
 JOB NO 11209
 SHEET No.
 1 OF 5

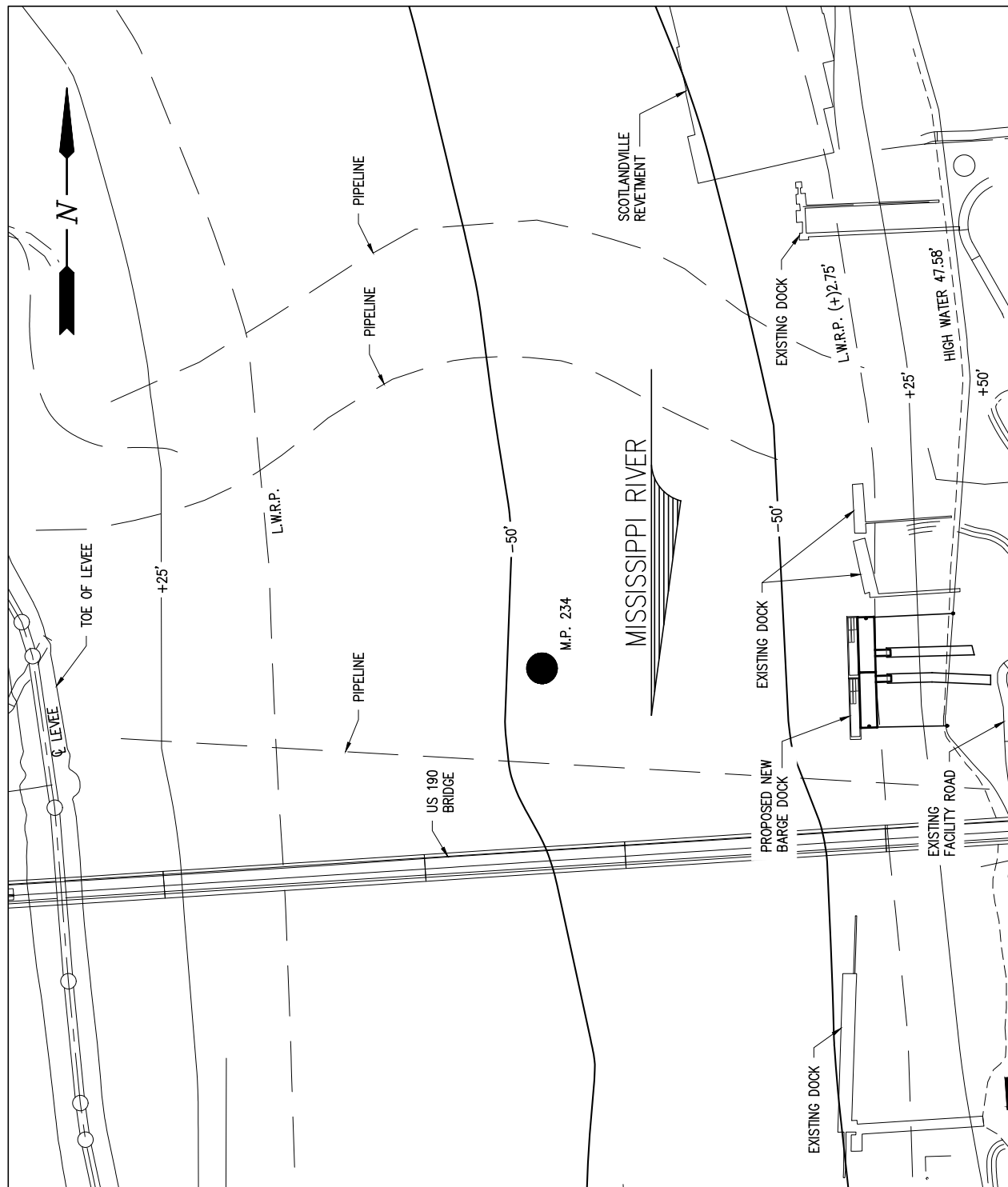

PROPOSED OVERALL SITE PLAN

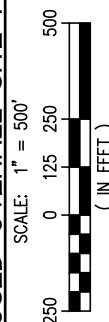

FOR PERMIT
NOVEMBER 19, 2019

RICHARD R. MESTAYER
LA PE #34732

PRELIMINARY - FOR PERMIT PURPOSES ONLY

REV
1



LANIER & ASSOCIATES
CONSULTING ENGINEERS
INCORPORATED

LA: C-1120 TX: F-2981
NEW ORLEANS, LA • BEAUMONT, TX

INGRAM BARGE COMPANY
BATON ROUGE LOUISIANA

PROPOSED NEW BARGE DOCK
PROPOSED OVERALL SITE PLAN

DATE OCT '19
DESIGN RRM
DRAWN JDM
CHECK NPL
JOB NO 11209
SHEET No.
2 OF 5

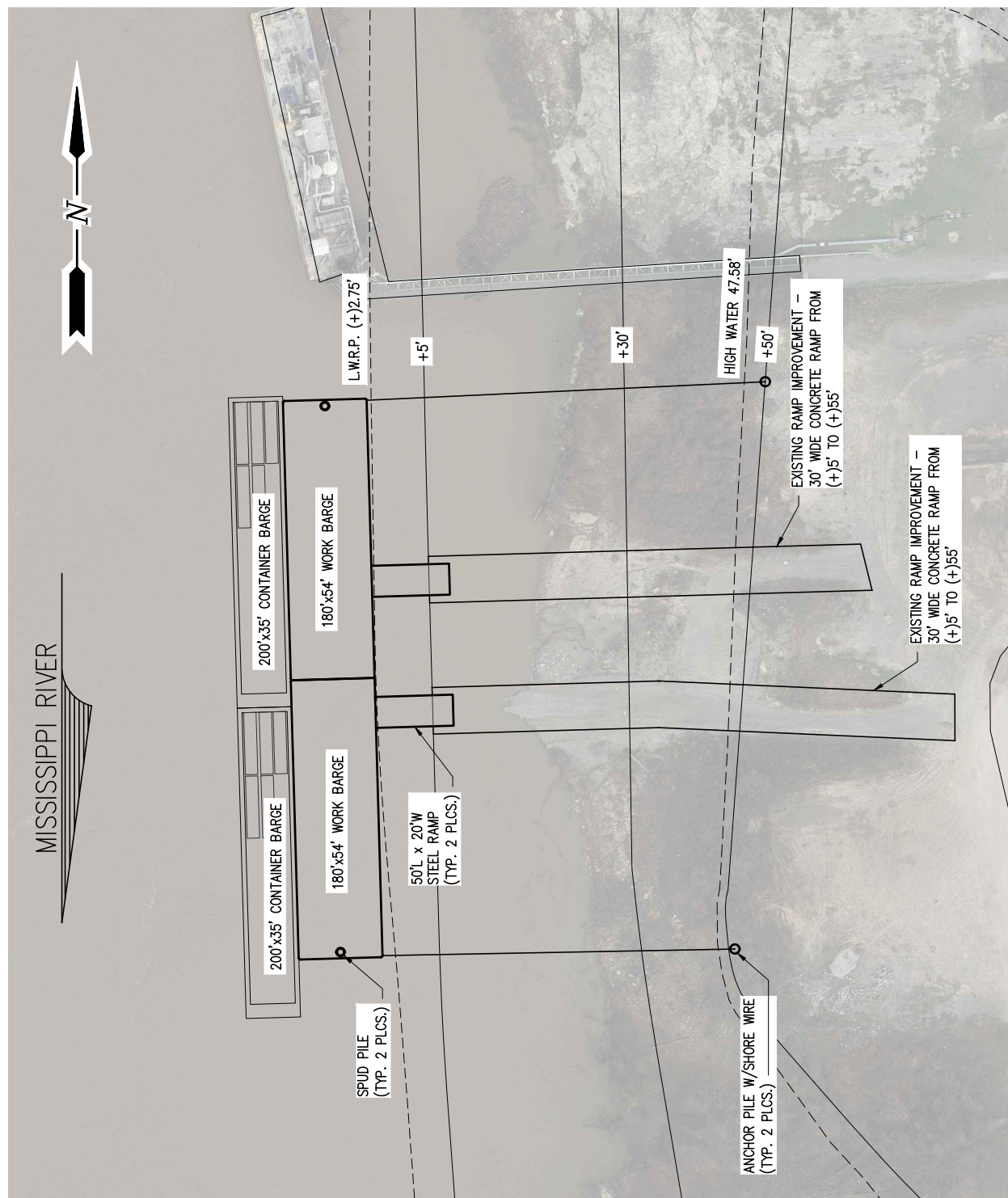

PROPOSED ENLARGED SITE PLAN @ (+)5.00'

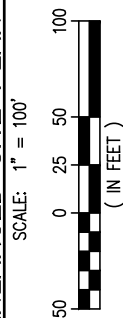

FOR PERMIT
NOVEMBER 19, 2019

RICHARD R. MESTAYER
LA PE #34732

PRELIMINARY - FOR PERMIT PURPOSES ONLY

REV
1



LANIER & ASSOCIATES
CONSULTING ENGINEERS
INCORPORATED

LA: C-1120 TX: F-2981
NEW ORLEANS, LA • BEAUMONT, TX

INGRAM BARGE COMPANY
BATON ROUGE LOUISIANA

PROPOSED NEW BARGE DOCK
PROPOSED ENLARGED SITE PLAN @ (+)5'

DATE	OCT '19
DESIGN	RRM
DRAWN	JDM
CHECK	NPL
JOB NO	11209
SHEET No.	
3	OF 5

J:\110005\11209 INGRAM BATON ROUGE UNLOADING PERMIT\DRAWINGS\PERMIT\11209-P04.DWG

MISSISSIPPI RIVER

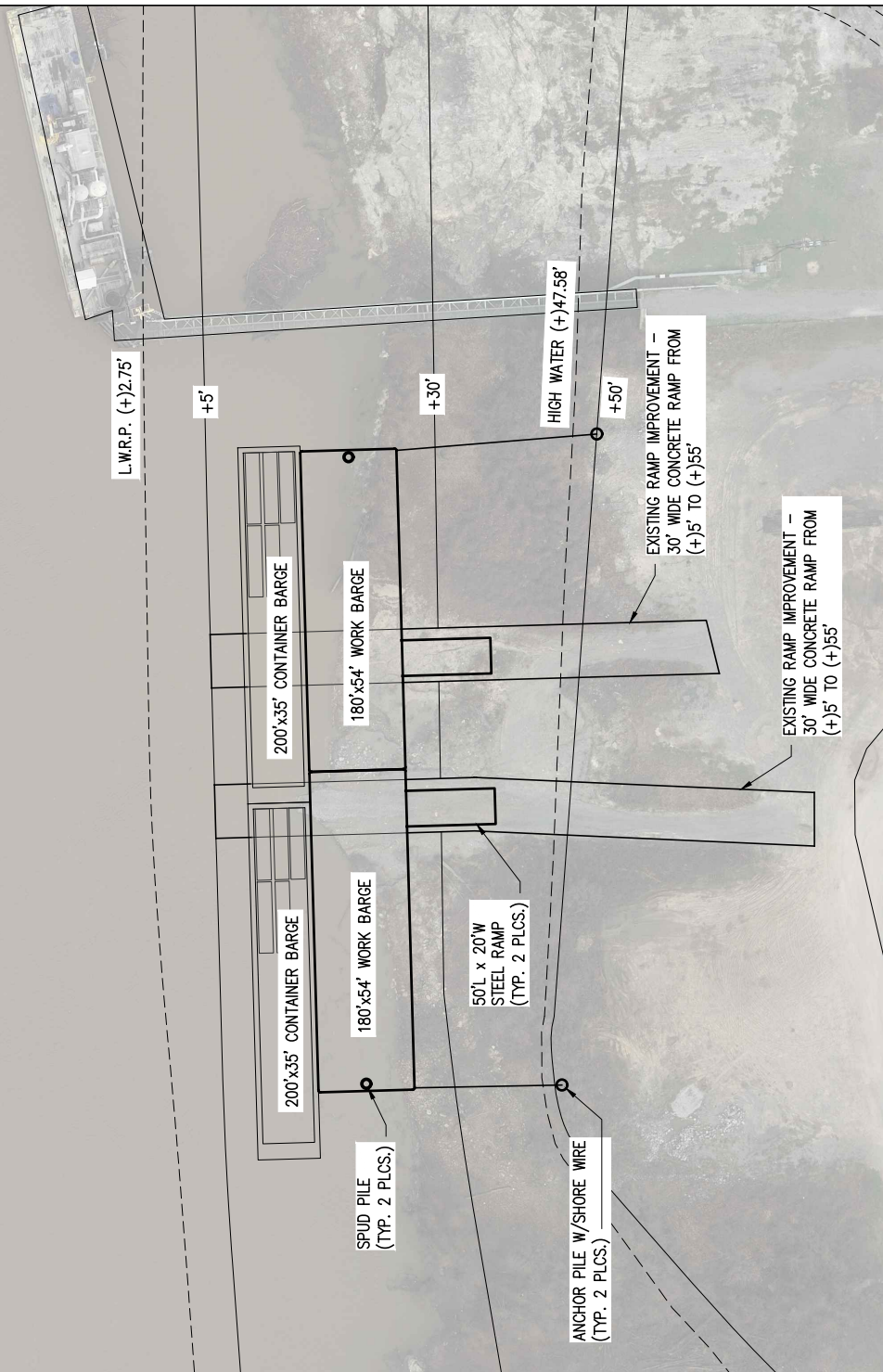

PROPOSED ENLARGED SITE PLAN @ (+)30.00'

SCALE: 1" = 100'

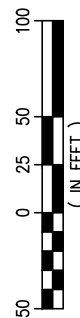

FOR PERMIT
NOVEMBER 19, 2019

RICHARD R. MESTAYER
LA PE #34732

PRELIMINARY - FOR PERMIT PURPOSES ONLY

REV
1

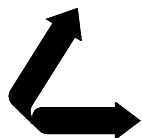

LANIER & ASSOCIATES
CONSULTING ENGINEERS
INCORPORATED

LA: C-1120 TX: F-2981
NEW ORLEANS, LA • BEAUMONT, TX

INGRAM BARGE COMPANY
BATON ROUGE LOUISIANA

PROPOSED NEW BARGE DOCK
PROPOSED ENLARGED SITE PLAN @ (+)30'

DATE	OCT '19
DESIGN	RRM
DRAWN	JDM
CHECK	NPL
JOB NO	11209
SHEET No.	
4	OF 5

J:\110005\11209 INGRAM BATON ROUGE UNLOADING PERMIT\DRAWINGS\PERMIT\11209-P05.DWG

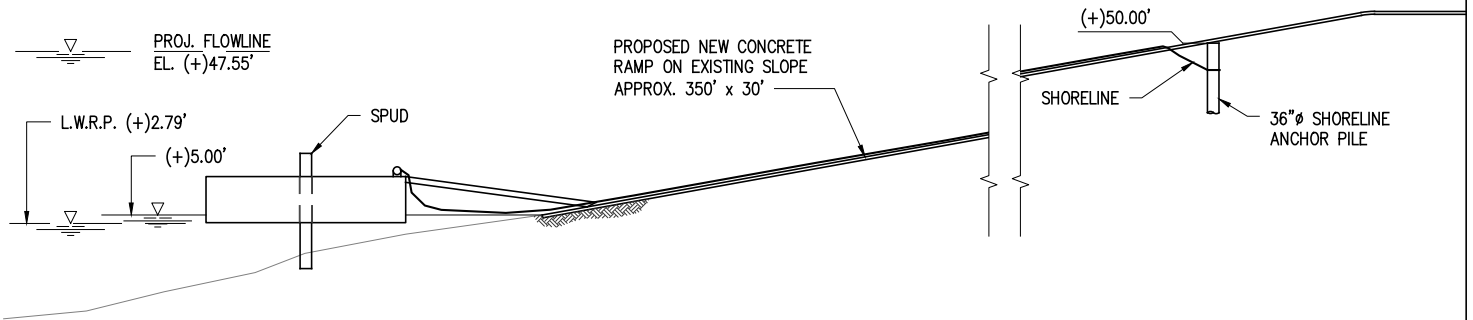

PROPOSED BARGE DOCK ELEVATION @ (+)5.00'

SCALE: 1" = 50'

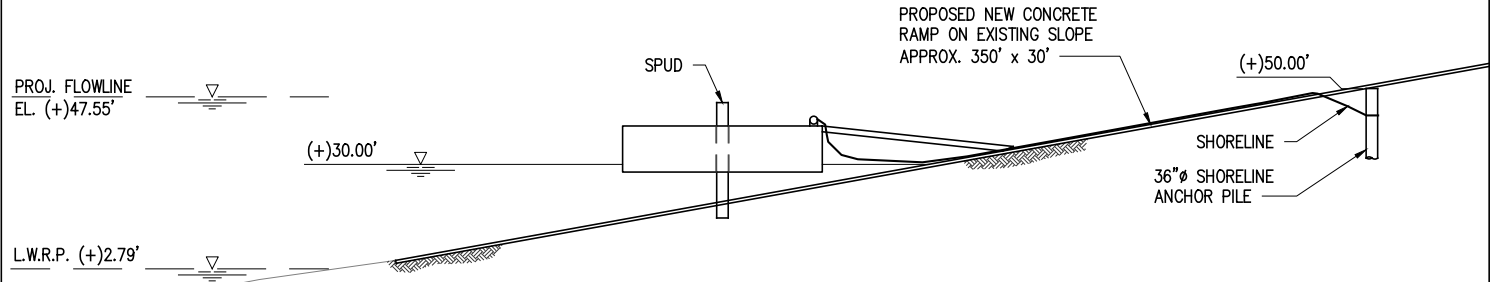
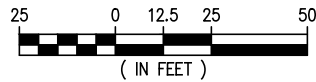

PROPOSED BARGE DOCK ELEVATION @ (+)30.00'

SCALE: 1" = 50'

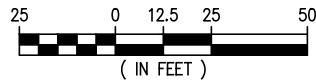

FOR PERMIT
OCTOBER 30, 2019

RICHARD R. MESTAYER
LA PE #34732

PRELIMINARY - FOR PERMIT PURPOSES ONLY

REV
0

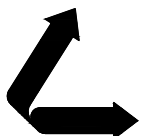

LANIER & ASSOCIATES
CONSULTING ENGINEERS
INCORPORATED

LA: C-1120 TX: F-2981
NEW ORLEANS, LA • BEAUMONT, TX

BATON ROUGE

INGRAM BARGE COMPANY

LOUISIANA

**PROPOSED NEW BARGE DOCK
PROPOSED ELEVATIONS**

DATE	OCT '19
DESIGN	RRM
DRAWN	JDM
CHECK	NPL
JOB NO	11209
SHEET No.	
5	OF 5