

# JOINT PUBLIC NOTICE

September 2, 2019

United States Army  
Corps of Engineers  
New Orleans District  
Regulatory Branch  
7400 Leake Avenue  
New Orleans, Louisiana 70118

State of Louisiana  
Department of Environmental Quality  
ATTN: Water Quality Certifications  
Post Office Box 4313  
Baton Rouge, Louisiana 70821-4313

(504) 862-1280 / FAX (504) 862-1697  
Brandon.D.Gaspard@usace.army.mil  
Project Manager  
Brandon Gaspard  
Permit Application Number  
MVN 2018-01327-MG

(225) 219-3225 / FAX (225) 325-8250  
Elizabeth.Hill@la.gov  
Project Manager  
Elizabeth Hill  
WQC Application Number  
WQC 190820-01

Interested parties are hereby notified that a permit application has been received by the New Orleans District of the U.S. Army Corps of Engineers pursuant to: [ ] Section 10 of the Rivers and Harbors Act of March 3, 1899 (30 Stat. 1151; 33 USC 403); and/or [X] Section 404 of the Clean Water Act (86 Stat. 816; 33 USC 1344).

Application has also been made to the Louisiana Department of Environmental Quality, Water Quality Certifications, for a Water Quality Certification (WQC) in accordance with statutory authority contained in LRS30:2047 A(3), and provisions of Section 401 of the Clean Water Act (P.L.95-17).

## **LOUISIANA AVENUE REGIONAL DETENTION BASIN** **IN CALCASIEU PARISH**

**NAME OF APPLICANT:** AECOM, on behalf of Calcasieu Parish Police Jury, ATTN: Mr. Roy Knowles, 19219 Katy Freeway, Suite 100, Houston, Texas.

**LOCATION OF WORK:** Located on and along Louisiana Avenue in Section 20, Township 10 South, Range 8 West, in Lake Charles, Louisiana, within Calcasieu Parish, as shown on the enclosed drawings.

Location: Latitude: 30.179 /Longitude: -93.205  
Hydrologic Unit Code: 08080206 – Lower Calcasieu. LA.

**CHARACTER OF WORK:** Calcasieu Parish Police Jury is proposing to construct a regional wet-bottom detention basin on an approximate 18.6 acre tract of land located southeast of the intersection of Louisiana Avenue and Contraband Bayou in Lake Charles, Louisiana. The purpose of the project is to provide flood risk reduction in the mid portion of the Contraband Bayou watershed. Project construction will include impacts to a total of 2.33 acres of wetlands and 0.92 acres of non-wetland waters. To mitigate unavoidable permanent wetland impacts of 0.81 acres of herbaceous wetlands, unavoidable permanent wetland impacts of 1.40 acres of bottomland hardwoods, and conversion of 0.02 acres of bottomland hardwoods to herbaceous wetlands, the applicant has agreed to contract with a CEMVN approved mitigation bank, should a DA permit be warranted.

The comment period for the Department of the Army Permit and the Louisiana Department of Environmental Quality WQC will close **20 days** from the date of this joint public notice. Written comments, including suggestions for modifications or objections to the proposed work, stating reasons thereof, are being solicited from anyone having interest in this permit and/or this WQC request and must be mailed so as to be received before or by the last day of the comment period. Letters concerning the Corps of Engineers permit application must reference the applicant's name and the Permit Application Number, and be mailed to the Corps of Engineers at the address above, **ATTENTION: REGULATORY BRANCH**. Similar letters concerning the Water Quality Certification must reference the applicant's name and the WQC Application number and be mailed to the Louisiana Department of Environmental Quality at the address above. **Individuals or parties may request an extension of time in which to comment on the proposed work by writing or e-mailing the Corps of Engineers Project Manager listed above. Any request must be specific and substantively supportive of the requested extension, and received by this office prior to the end of the initial comment period. The Section Chief will review the request and the requestor will be promptly notified of the decision to grant or deny the request. If granted, the time extension will be continuous to the initial comment period and, inclusive of the initial comment period, will not exceed a total of 30 calendar days.**

The application for this proposed project is on file with the Louisiana Department of Environmental Quality and may be examined during weekdays between 8:00 a.m. and 4:30 p.m. Copies may be obtained upon payment of costs of reproduction.

### **Corps of Engineers Permit Criteria**

The decision whether to issue a permit will be based on an evaluation of the probable impacts, including cumulative impacts of the proposed activity on the public interest. That decision will reflect the national concern for both protection and utilization of important resources. The benefit which reasonably may be expected to accrue from the proposal must be balanced against its reasonably foreseeable detriments. All factors which may be relevant to the proposal will be considered including the cumulative effects thereof; among those are conservation, economics, aesthetics, general

environmental concerns, wetlands, historic properties, fish and wildlife values, flood hazards, floodplain values, land use, navigation, shoreline erosion and accretion, recreation, water supply and conservation, water quality, energy needs, safety, food and fiber production, mineral needs, considerations of property ownership and, in general, the needs and welfare of the people.

The U.S. Army Corps of Engineers is soliciting comments from the public, federal, state, and local agencies and officials, Indian Tribes, and other interested parties in order to consider and evaluate the impacts of this proposed activity. Any comments received will be considered by the U.S. Army Corps of Engineers to determine whether to make, modify, condition, or deny a permit for this proposal. To make this decision, comments are used to assess impacts on endangered species, historic properties, water quality, general environmental effects, and other public interest factors listed above. Comments are used in the preparation of an Environmental Assessment and/or an Environmental Impact Statement pursuant to the National Environmental Policy Act. Comments are also used to determine the need for a public hearing and to determine the overall public interest of the proposed activity.

The New Orleans District is unaware of properties listed on the National Register of Historic Places near the proposed work. The possibility exists that the proposed work may damage or destroy presently unknown archeological, scientific, prehistorical, historical sites, or data. Copies of this public notice will be forwarded to the State Archeologist and State Historic Preservation Officer regarding potential impacts to cultural resources.

Our initial finding is that the proposed work would neither affect any species listed as endangered by the U.S. Departments of Interior or Commerce, nor affect any habitat designated as critical to the survival and recovery of any endangered species. Based on the South Louisiana **Standard Local Operating Procedure for Endangered Species (SLOPES)**, as signed on October 22, 2014, between the U.S. Army Corps of Engineers, New Orleans and the U.S. Fish and Wildlife Service, it has been determined that the project would have no effect to any listed species.

This notice initiates the Essential Fish Habitat (EFH) consultation requirements of the Magnuson-Stevens Fishery Conservation and Management Act. The applicant's proposal would result in the destruction or alteration of 0 acres of EFH utilized by various life stages of red drum and penaeid shrimp. Our initial determination is that the proposed action would not have a substantial adverse impact on EFH or federally managed fisheries in the Gulf of Mexico. Our final determination relative to project impacts and the need for mitigation measures is subject to review by and coordination with the National Marine Fisheries Service.

If the proposed work involves deposits of dredged or fill material into navigable waters, the evaluation of the probable impacts will include the application of guidelines established by the Administrator of the Environmental Protection Agency.

Also, a certification that the proposed activity will not violate applicable water quality standards will be required from the Department of Environmental Quality, Water Quality Certifications, before a permit is issued.

Any person may request, in writing, within the comment period specified in this notice, that a public hearing be held to consider this application. Requests for public hearings shall state, with particularity, the reasons for holding a public hearing.

You are requested to communicate the information contained in this notice to any other parties whom you deem likely to have interest in the matter.

BARBARA.DARR  
ELL.SAM.12308  
46096  
Darrell S. Barbara  
Chief, Western Evaluation Section  
Regulatory Branch

Digitally signed by  
BARBARA.DARRELL.SAM.1  
230846096  
Date: 2019.08.29 11:38:14  
-05'00'

Enclosures

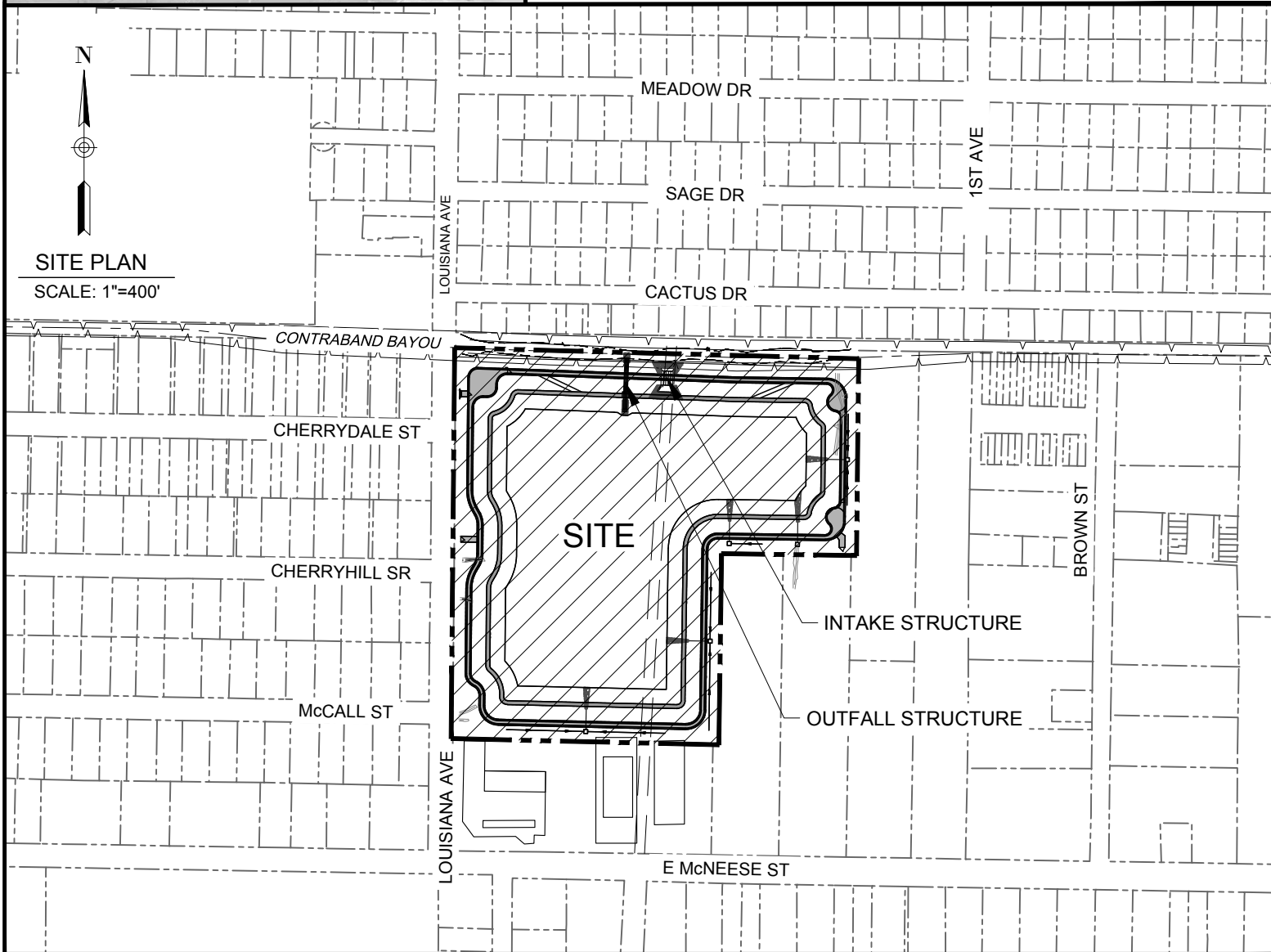
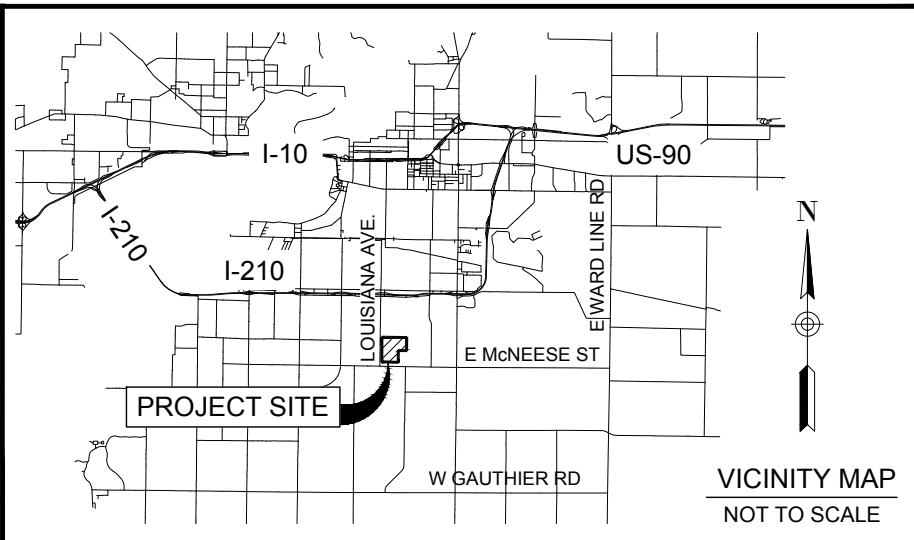
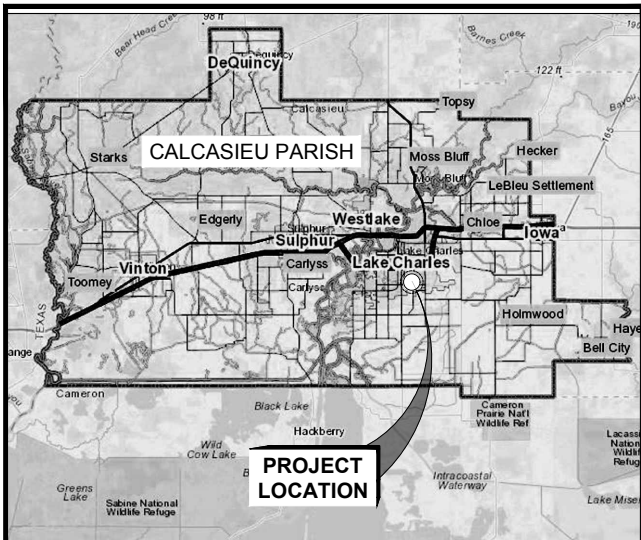

## LEGEND

- SITE BOUNDARY
- DETENTION BASIN SITE

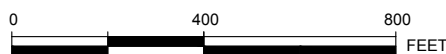

**DEPARTMENT OF THE ARMY  
PERMIT APPLICATION  
LOUISIANA AVENUE  
REGIONAL DETENTION BASIN**

## LOCATION MAP AND SITE PLAN

PARISH: CALCASIEU

STATE: LOUISIANA

APPLICANT BY: CALCASIEU PARISH POLICE JURY

SHEET 1 OF 7

MARCH 2019

Filename: P:\PWP\CALCASIEU\_PARISH\_LA\_AVE\_DET1900\_CADD\_GIS\901\_CADD20-SHEETS\ARMY CORPS ENGINEERS PACKAGE

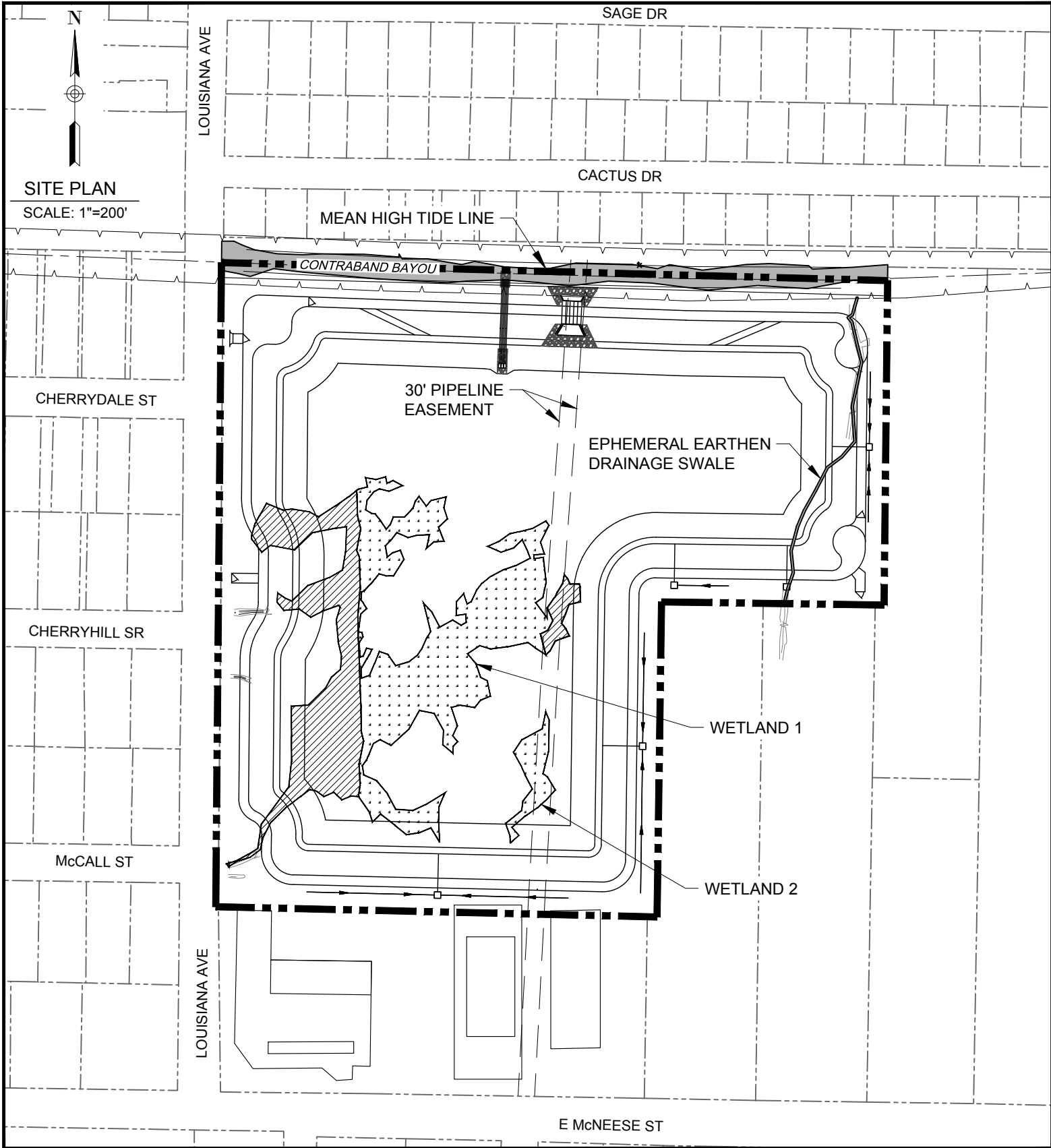

**LEGEND**

- SITE BOUNDARY
- JURISDICTIONAL WATERS OF THE UNITED STATES
- WETLAND 1 - HERBACEOUS (0.91 AC.)
- WETLAND 1 - FORESTED (1.30 AC.)
- WETLAND 2 - FORESTED (0.12 AC.)

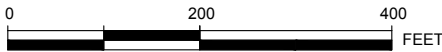

**DEPARTMENT OF THE ARMY  
PERMIT APPLICATION  
LOUISIANA AVENUE  
REGIONAL DETENTION BASIN  
JURISDICTIONAL  
WATERS / WETLANDS**

PARISH: CALCASIEU STATE: LOUISIANA  
APPLICANT BY: CALCASIEU PARISH POLICE JURY  
SHEET 2 OF 7  
MARCH 2019

Filename: P:\PWP\CALCASIEU PARISH LA\_AVE\_DET1900\_CADD\20-SHEETS\ARMY CORPS ENGINEERS PACKAGE

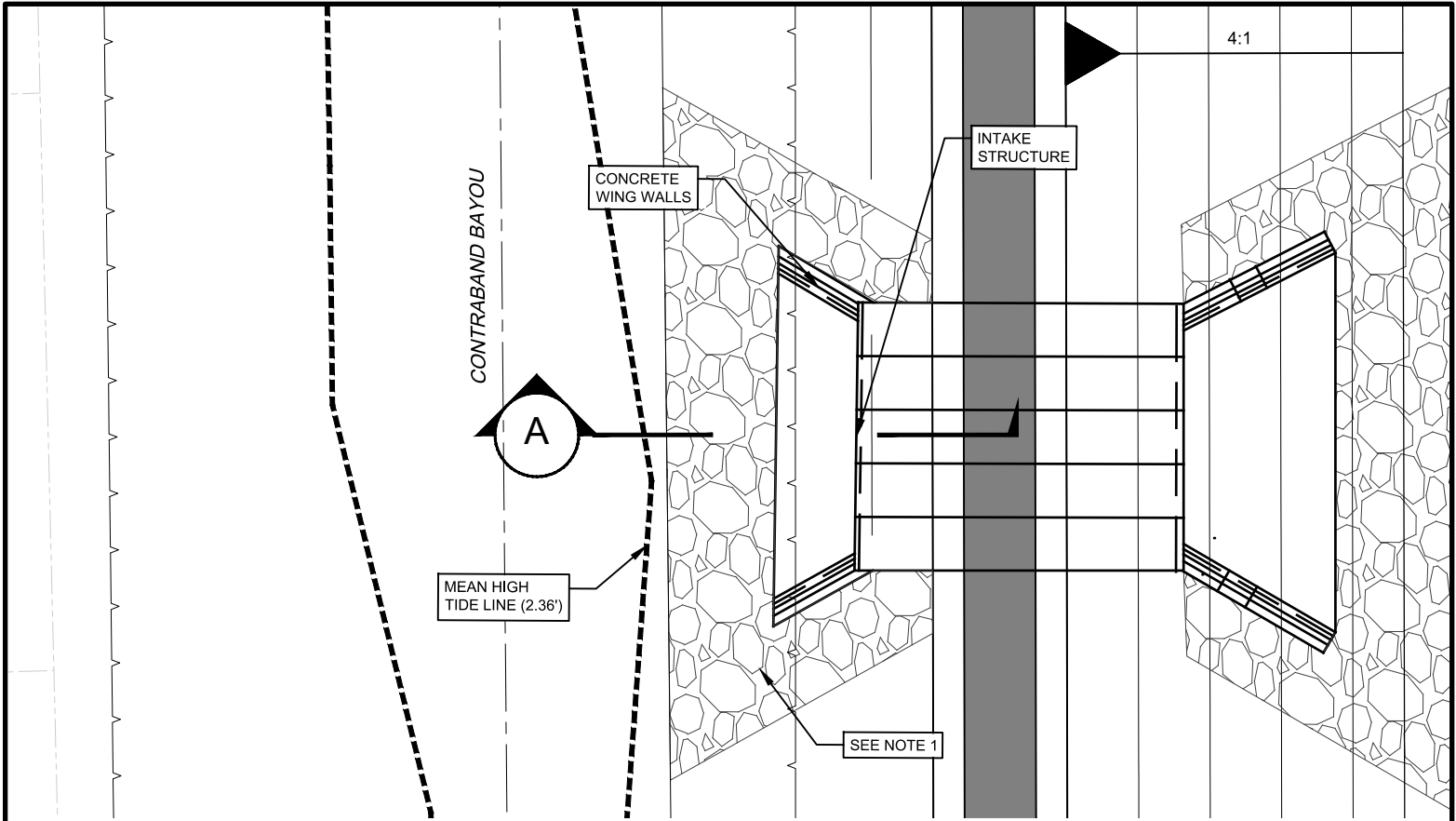

NOTES:

1. TOTAL RIP-RAP AREA AT CHANNEL INTAKE IS 1,212 SQUARE FEET.  
NO ANTICIPATED IMPACT BELOW THE MEAN HIGH TIDE LINE.
2. TOTAL RIP-RAP VOLUME AT CHANNEL INTAKE IS 70.5 CUBIC YARDS.  
NO ANTICIPATED IMPACT BELOW THE MEAN HIGH TIDE LINE.

INTAKE PLAN

SCALE: 1"=20'

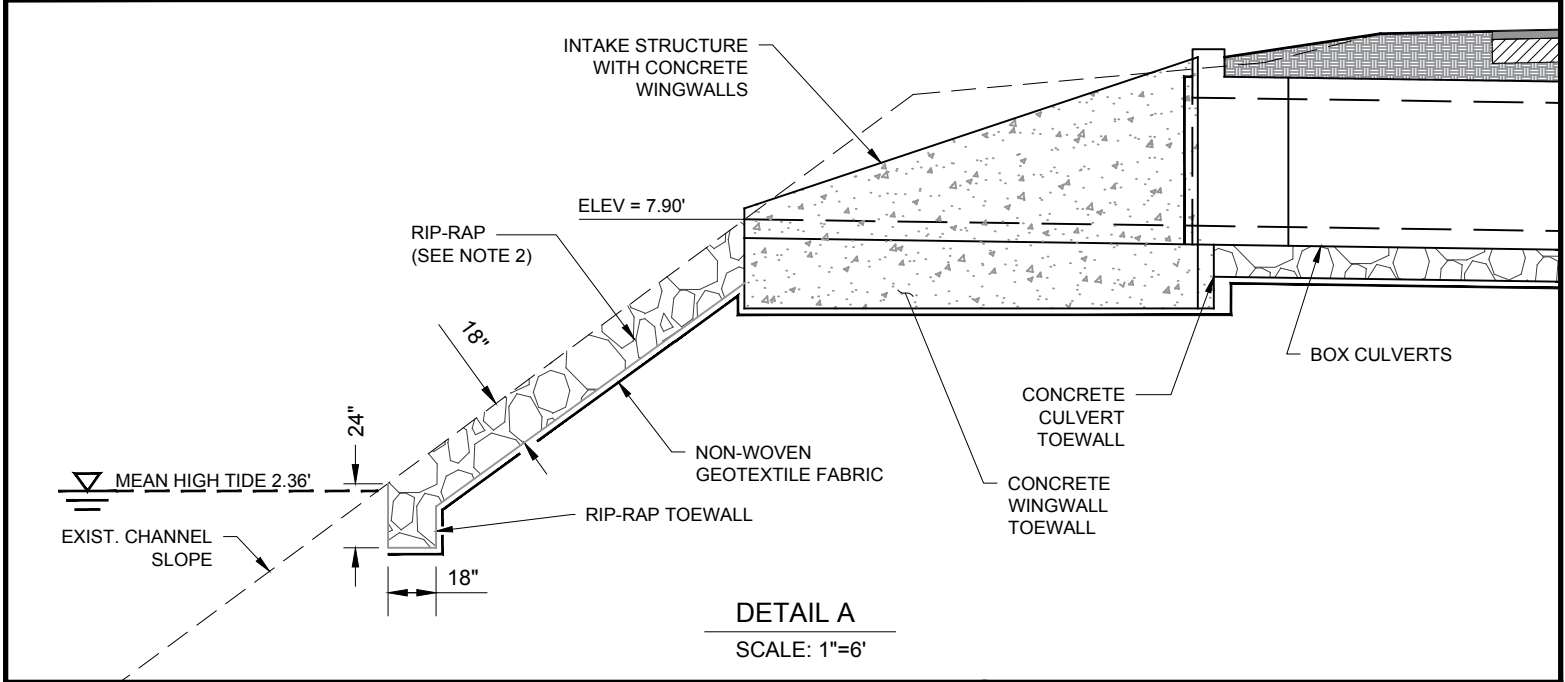
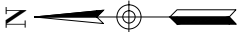

DETAIL A

SCALE: 1"=6'

LEGEND

PROPOSED BOX CULVERTS



PROPOSED RIP-RAP

EXISTING CHANNEL FLOW LINE



PROPOSED CONCRETE

EXISTING TOP OF BANK

MEAN HIGH TIDE LINE

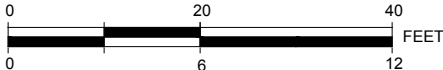

DEPARTMENT OF THE ARMY  
PERMIT APPLICATION  
LOUISIANA AVENUE  
REGIONAL DETENTION BASIN

INTAKE PLAN AND DETAIL

PARISH: CALCASIEU

STATE: LOUISIANA

APPLICANT BY: CALCASIEU PARISH POLICE JURY

SHEET 3 OF 7

MARCH 2019

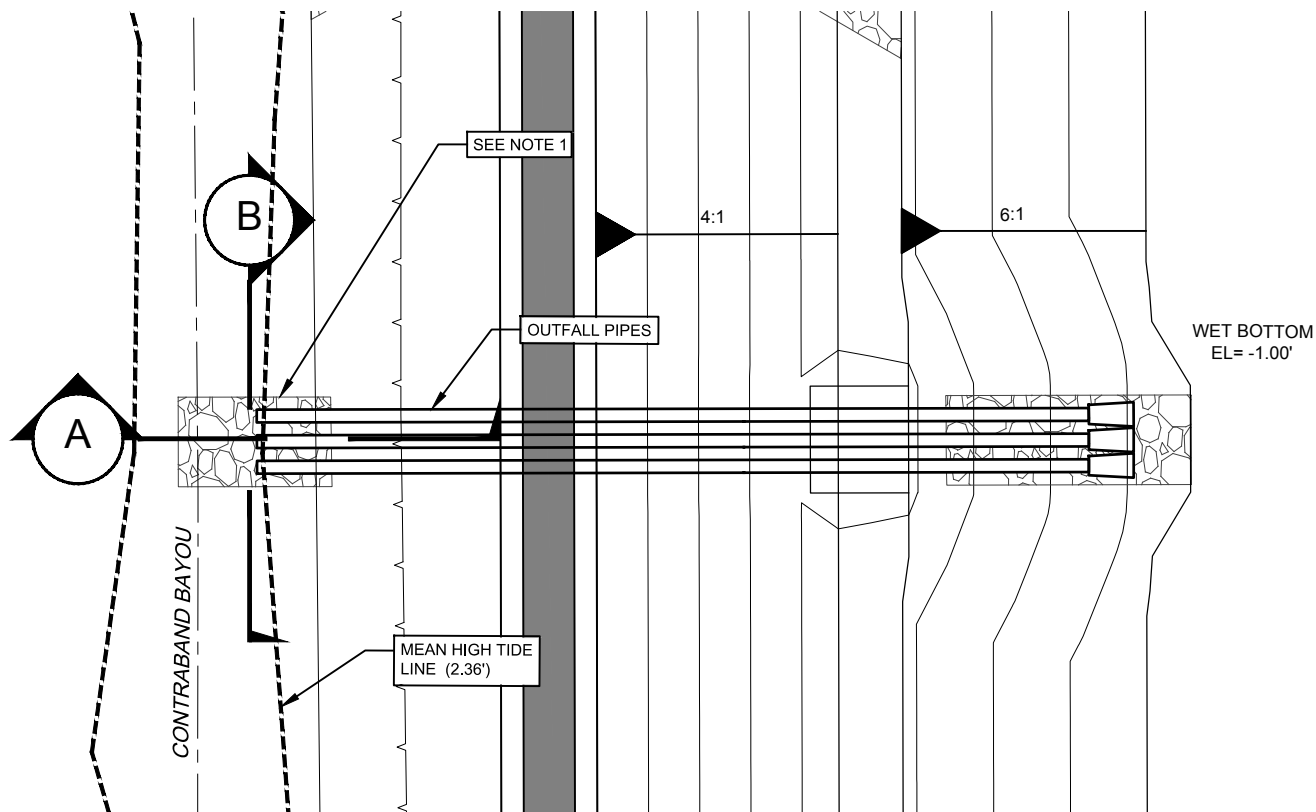

#### NOTES:

1. TOTAL RIP-RAP AREA AT CHANNEL OUTFALL IS 265 SQUARE FEET OF WHICH 189 SQUARE FEET IS BELOW THE MEAN HIGH TIDE LINE.
2. TOTAL RIP-RAP VOLUME AT CHANNEL OUTFALL IS 18.7 CUBIC YARDS OF WHICH 10.5 CUBIC YARDS IS BELOW THE MEAN HIGH TIDE LINE.

#### OUTFALL PLAN

SCALE: 1"=30'

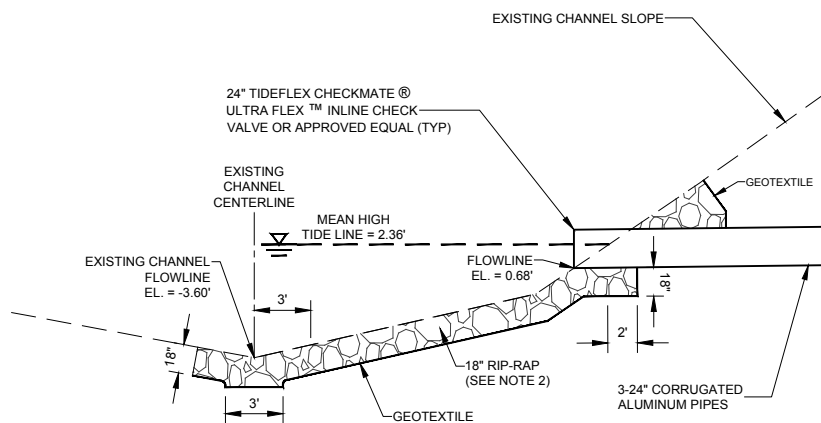

#### DETAIL A

SCALE: 1"=10'

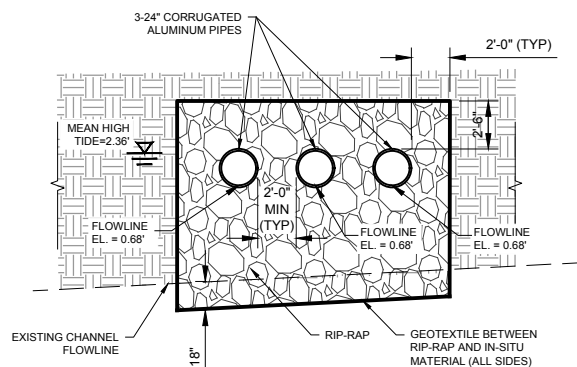

#### DETAIL B

SCALE: 1"=10'

#### LEGEND

- PROPOSED OUTFALL PIPES
- EXISTING CHANNEL FLOW LINE
- EXISTING TOP OF BANK
- MEAN HIGH TIDE LINE



PROPOSED RIP-RAP

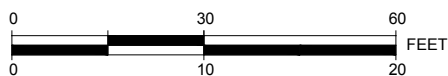

#### DEPARTMENT OF THE ARMY PERMIT APPLICATION LOUISIANA AVENUE REGIONAL DETENTION BASIN

#### OUTFALL PLAN AND DETAILS

PARISH: CALCASIEU

STATE: LOUISIANA

APPLICANT BY: CALCASIEU PARISH POLICE JURY

SHEET 4 OF 7

MARCH 2019



Filename: P:\PWP\CALCASIEU PARISH LA AVE DET1900\_CADD\_GIS\901\_CADD20-SHEETS\ARMY CORPS ENGINEERS PACKAGE

PROPOSED TEMPORARY  
SHEET PILE COFFER DAM

CONTRABAND BAYOU

OUTFALL PIPES

MEAN HIGH TIDE  
LINE (2.36')

4:1

6:1



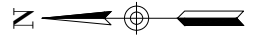

WET BOTTOM  
EL = -1.00'

## OUTFALL PLAN

SCALE: 1"=30'



## LEGEND

-  PROPOSED OUTFALL PIPES
-  EXISTING CHANNEL FLOW LINE
-  EXISTING TOP OF BANK
-  MEAN HIGH TIDE LINE

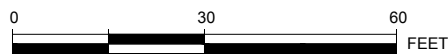

## DEPARTMENT OF THE ARMY PERMIT APPLICATION LOUISIANA AVENUE REGIONAL DETENTION BASIN TEMPORARY COFFER DAM

PARISH: CALCASIEU

STATE: LOUISIANA

APPLICANT BY: CALCASIEU PARISH POLICE JURY

SHEET 5 OF 7

MARCH 2019

Last saved by: BOCANEGRAN/2019-08-27) Last Plotter: 2019-08-27  
Filename: P:\PWP\CALCASIEU PARISH LA AVE DET900 CADD GIS\901 CADD\20-SHEETS\ARMY CORPS ENGINEERS PACKAGE\CPJ-USACE LANDSCAPING-60555334.DWG

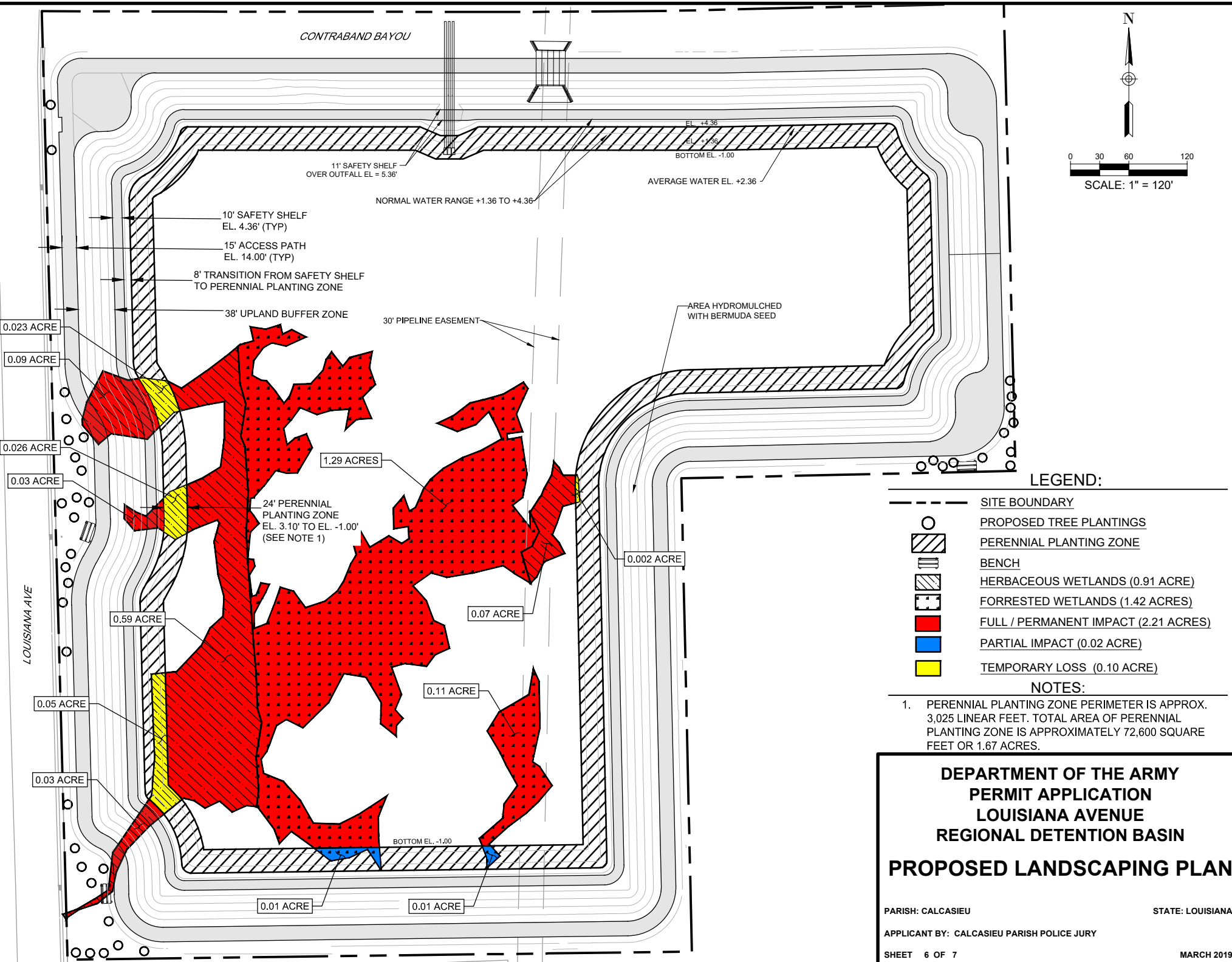

Last saved by: BOCANEGRAA(2019-08-27) Last Plotted: 2019-08-27  
Filename: P:\PWP\CALCASIEU PARISH LA AVE DET900 CADD GIS\901 CADD\20-SHEETS\ARMY CORPS ENGINEERS PACKAGE\CPJ-USACE LANDSCAPING-60555334.DWG

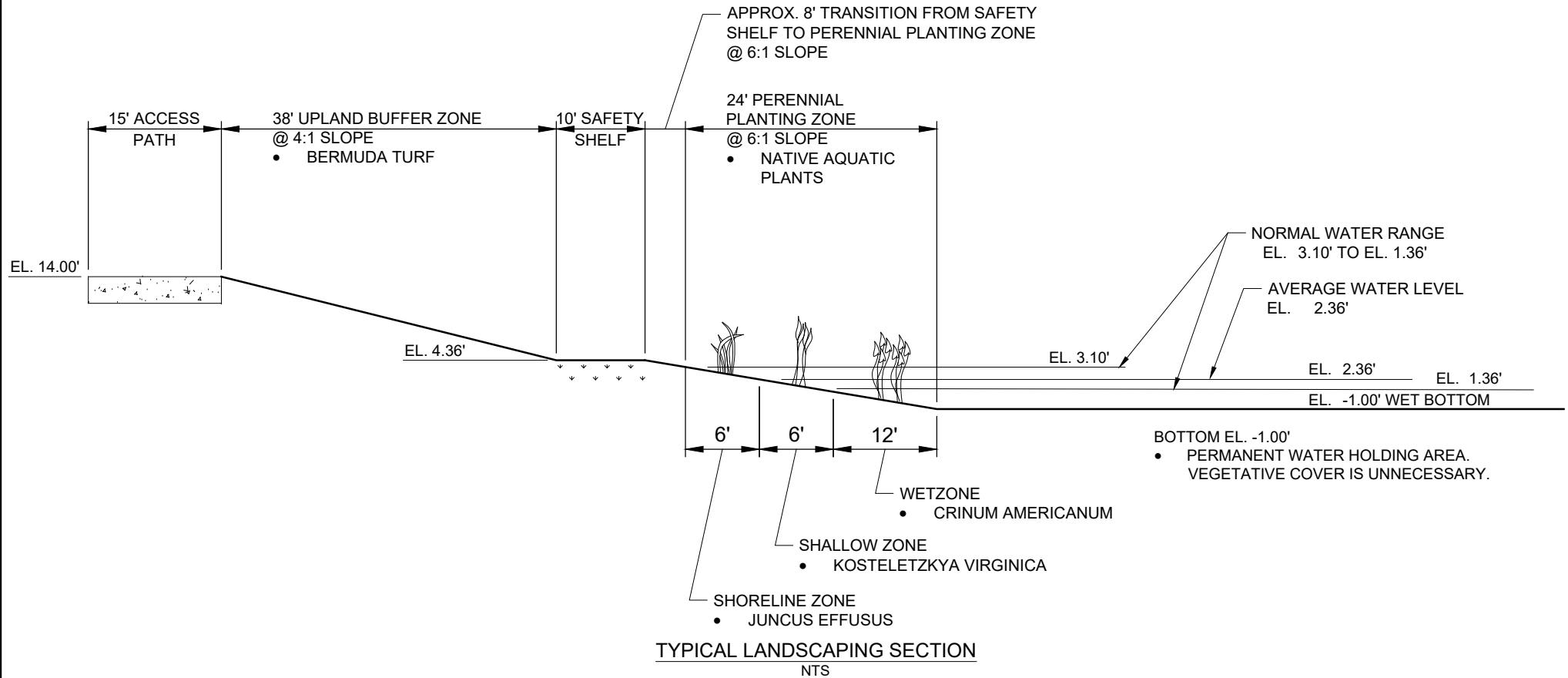

TOTAL IMPACTS TO JURISDICTIONAL WATERS OF THE U.S.	FULL/ PERMANENT	PARTIAL	TEMPORARY LOSS	TOTAL IMPACT
NON-WETLAND WATERS OF THE U.S.	0.044 ACRE			0.044 ACRE
WETLANDS ( HERBACEOUS AND BOTTOMLAND HARDWOOD)	2.21 ACRES	0.02 ACRE	0.10 ACRE	2.33 ACRES
DETAILED IMPACTS TO JURISDICTIONAL WETLANDS				
WETLAND 1 (HERBACEOUS)	0.81 ACRE		0.10 ACRE	0.91 ACRE
WETLAND 1 ( BOTTOMLAND HARDWOOD)	1.29 ACRES	0.01 ACRE		1.30 ACRES
WETLAND 2 ( BOTTOMLAND HARDWOOD)	0.11 ACRE	0.01 ACRE		0.12 ACRE

FULL/ PERMANENT IMPACT = LOSS OF AQUATIC RESOURCE (CONVERSION TO UPLANDS)  
PARTIAL IMPACT = CONVERSION FROM HIGHER QUALITY HABITAT TO A LOWER QUALITY HABITAT  
(BOTTOMLAND HARDWOOD TO HERBACEOUS)  
TEMPORARY LOSS = TEMPORAL; DEGRADED HERBACEOUS TO REPLANTED HERBACEOUS (MAY NOT BE ASSESSED)

DEPARTMENT OF THE ARMY  
PERMIT APPLICATION  
LOUISIANA AVENUE  
REGIONAL DETENTION BASIN  
**PROPOSED LANDSCAPING SECTION**

PARISH: CALCASIEU

STATE: LOUISIANA

APPLICANT BY: CALCASIEU PARISH POLICE JURY

SHEET 7 OF 7

MARCH 2019