

JOINT PUBLIC NOTICE

April 30, 2018

United States Army Corps of Engineers
New Orleans District
Regulatory Branch
7400 Leake Avenue
New Orleans, Louisiana 70118

State of Louisiana
Department of Environmental Quality
Water Permits Division
Post Office Box 4313
Baton Rouge, Louisiana 70821-4313

(504) 862-1577
Project Manager
Patricia Clune
Patricia.R.Clune@usace.army.mil
MVN 2018-00305-CE

(225) 219-3225
Project Manager
Elizabeth Hill
WQC Application Number
WQC # 180322-01

Interested parties are hereby notified that a permit application has been received by the New Orleans District of the US Army Corps of Engineers pursuant to: [X] Section 10 of the Rivers and Harbors Act of March 3, 1899 (30 Stat. 1151; 33 USC 403); and/or [X] Section 404 of the Clean Water Act (86 Stat. 816; 33 USC 1344).

Application has also been made to the Louisiana Department of Environmental Quality, Water Permits Division, for a Water Quality Certification (WQC) in accordance with statutory authority contained in LRS 30:2074 A(3) and provisions of Section 401 of the Clean Water Act.

NEW BARGE FLEETING OPERATION IN THE MISSISSIPPI RIVER WITHIN EAST BATON ROUGE PARISH

NAME OF APPLICANT: Ingram Barge Company, c/o Lanier & Associates Consulting Engineers Inc., 4101 Magazine Street, New Orleans, Louisiana 70115.

LOCATION OF WORK: In the Mississippi River, left descending bank, at MP 226, in East Baton Rouge Parish, Louisiana, within the Mississippi River Basin in hydrologic unit (HUC 08070100), as shown on the attached drawings (Latitude 30.381389 N, Longitude - 91.223611 W).

CHARACTER OF WORK: The applicant has requested Department of the Army authorization to install a new barge fleeting operation to include the placement of 800 cubic yards of rip rap for revetment repair. The operation will be broken into 4 separate fleets. From downriver going up, the first fleet will have 10 tiers of barges. The second fleet will have 7 tiers of barges. The third fleet will have 6 tiers of barges and the fourth fleet will have 7 tiers of barges. The barges will be secured using steel monopiles and a string of spar barges. During normal river stage conditions (+16' and above on the Baton Rouge gauge) each tier will be 9 barges wide which includes the spar barges. During low water river stage conditions (below +16' at the Baton Rouge gauge) each tier will be reduced down to 5 barges wide, which includes the spar barges, in order to allow for additional channel space for deep draft vessel traffic.

The applicant stated that the proposed project has been designed to avoid and minimize direct and secondary adverse impacts to the maximum extent practicable which are limited to the placement of 800 cubic yards of rip rap to stabilize the bank.

The comment period for the Department of Army will close in **30 days** from the date of this public notice. Written comments, including suggestions for modifications or objections to the proposed work, stating reasons thereof, are being solicited from anyone having interest in this permit and must be mailed so as to be received before or by the last day of the comment period. Letters concerning the Corps of Engineers permit application must reference the applicant's name and the Permit Application Number, and be mailed to the Corps of Engineers at the address above **ATTENTION: REGULATORY BRANCH**. Similar letters concerning the Water Quality Certification must reference the applicant's name and the WQC application number and be mailed to the Louisiana Department of Environmental Quality at the address above.

The application for this proposed project is on file with the Louisiana Department of Environmental Quality and may be examined during weekdays between 8:00 a.m. and 4:30 p.m. Copies may be obtained upon payment of costs of reproduction.

Corps of Engineers Permit Criteria

The decision whether to issue a permit will be based on an evaluation of the probable impacts, including cumulative impacts of the proposed activity on the public interest. That decision will reflect the national concern for both protection and utilization of important resources. The benefit which reasonably may be expected to accrue from the proposal must be balanced against its reasonably foreseeable detriments. All factors which may be relevant to the proposal will be considered including the cumulative effects thereof; among those are conservation, economics, aesthetics, general environmental concerns, wetlands, historic properties, fish and wildlife values, flood hazards, floodplain values, land use, navigation, shoreline erosion and accretion, recreation, water supply and conservation, water quality, energy needs, safety, food and fiber production, mineral needs, considerations of property ownership and, in general, the needs and welfare of the people.

The US Army Corps of Engineers is soliciting comments from the public, federal, state, and local agencies and officials, Indian Tribes, and other interested parties in order to consider and evaluate the impacts of this proposed activity. Any comments received will be considered by the US Army Corps of Engineers to determine whether to make, modify, condition, or deny a permit for this proposal. To make this decision, comments are used to assess impacts on endangered species, historic properties, water quality, general environmental effects, and other public interest factors listed above. Comments are used in the preparation of an Environmental Assessment and/or an Environmental Impact Statement pursuant to the National Environmental Policy Act. Comments are also used to determine the need for a public hearing and to determine the overall public interest of the proposed activity.

The New Orleans District is unaware of properties listed on the National Register of

Historic Places near the proposed work. The possibility exists that the proposed work may damage or destroy presently unknown archeological, scientific, prehistorical, historical sites, or data. Copies of this notice are being sent to the State Archeologist and the State Historic Preservation Officer.

Our initial finding is that the proposed work would neither affect any species listed as endangered by the U.S. Departments of Interior or Commerce, nor affect any habitat designated as critical to the survival and recovery of any endangered species.

The New Orleans District has determined that the proposed project is located in waters known to be utilized by the Pallid Sturgeon (*Scaphirhynchus albus*). Utilizing Standard Local Operating Procedure for Endangered Species in Louisiana (SLOPES), dated October 22, 2014, between the U.S. Army Corps of Engineers, New Orleans and U.S. Fish and Wildlife Service, Ecological Services Office, the Corps has determined that the proposed work is not likely to adversely affect the Pallid Sturgeon as there will be no dredging activities associated with this project.

This notice initiates the Essential Fish Habitat (EFH) consultation requirements of the Magnuson-Stevens Fishery Conservation and Management Act. The applicant's proposal will not result in the destruction or alteration of EFH utilized by various life stages of red drum and penaeid shrimp. Our initial determination is that the proposed action would not have a substantial adverse impact on EFH or federally managed fisheries in the Gulf of Mexico. Our final determination relative to project impacts and the need for mitigation measures is subject to review by and coordination with the National Marine Fisheries Service.

If the proposed work involves deposits of dredged or fill material into navigable waters, the evaluation of the probable impacts will include the application of guidelines established by the Administrator of the Environmental Protection Agency. Also, a certification that the proposed activity will not violate water quality standards will be required from the Department of Environmental Quality, Water Quality Certifications Section before a permit is issued.

Any person may request, in writing, within the comment period specified in this notice, that a public hearing be held to consider this application. Requests for public hearings shall state, with particularity, the reasons for holding a public hearing. You are requested to communicate the information contained in this notice to any other parties whom you deem likely to have interest in the matter.

JOHN M. HERMAN
Chief, Central Evaluation Section
Regulatory Branch

Enclosures

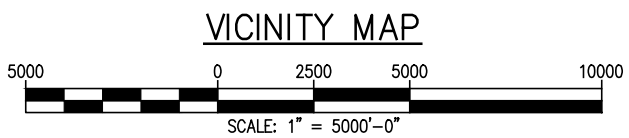

PARISH: EAST BATON ROUGE
 LATITUDE: 30°22'53"
 LONGITUDE: 91°13'25"

BRADFORD N. FRISCHERTZ
 LANIER & ASSOCIATES
 LA P.E. # 32628

PRELIMINARY - FOR PERMIT PURPOSES ONLY

10577-P1

LANIER & ASSOCIATES
 CONSULTING ENGINEERS
 INCORPORATED
 LA: C-1120 F-2981
 NEW ORLEANS, LA • BEAUMONT, TX

INGRAM BARGE COMPANY
 BATON ROUGE LOUISIANA
PROPOSED NEW BARGE FLEETING
VICINITY MAP

DATE	OCT 2017
DESIGN	NPL
DRAWN	JDM
CHECK	NPL
CONTRACT	10577
SHEET No.	
	1 OF 9

J:\1000S\10577 INGRAM BARGE PERMITTING\DRAWINGS\10577-P1.DWG

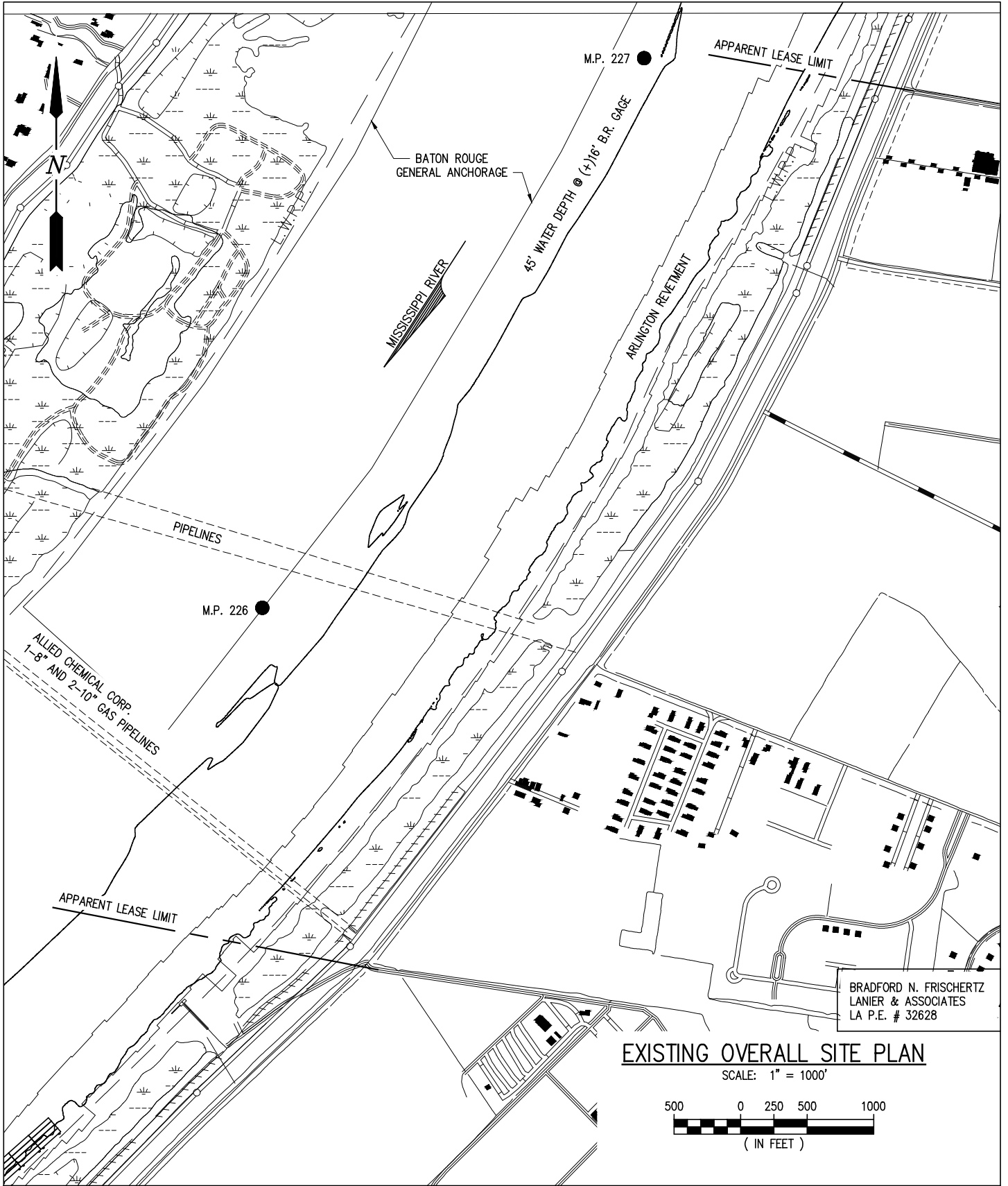

BRADFORD N. FRISCHERTZ
 LANIER & ASSOCIATES
 LA P.E. # 32628

EXISTING OVERALL SITE PLAN

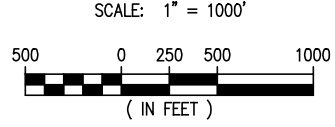

PRELIMINARY - FOR PERMIT PURPOSES ONLY

10577-P2

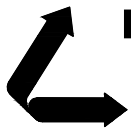

LANIER & ASSOCIATES
 CONSULTING ENGINEERS
 INCORPORATED
 LA: C-1120 F-2981
 NEW ORLEANS, LA • BEAUMONT, TX

INGRAM BARGE COMPANY
 BATON ROUGE LOUISIANA

PROPOSED NEW BARGE FLEETING
EXISTING OVERALL SITE PLAN

DATE FEB 2018
 DESIGN NPL
 DRAWN JDM
 CHECK NPL
 CONTRACT 10577
 SHEET No.
2 OF 9

J:\100005\10577 INGRAM BARGE PERMITTING\DRAWINGS\10577-P2.DWG

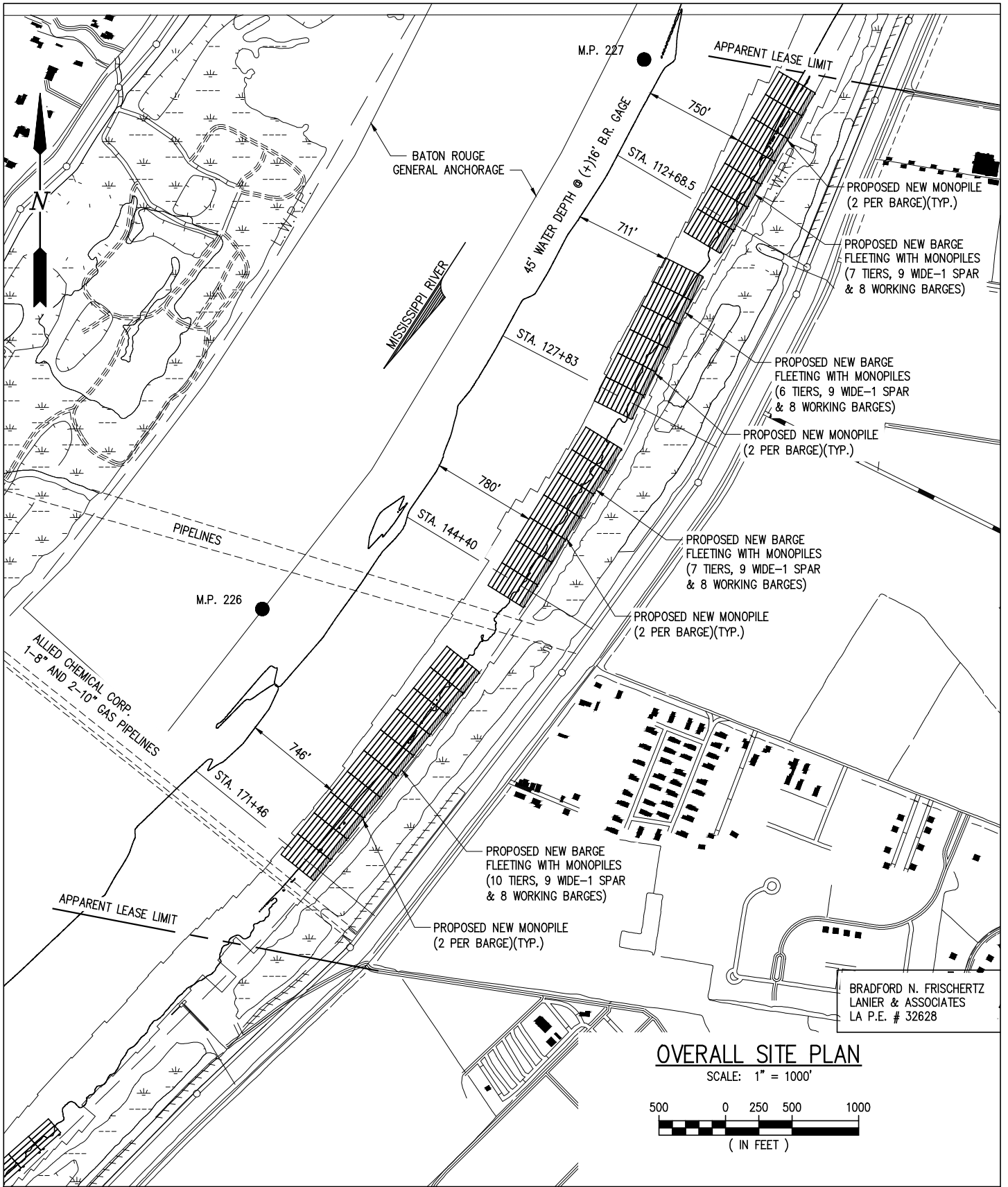

OVERALL SITE PLAN

SCALE: 1" = 1000'

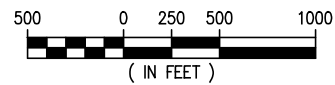

BRADFORD N. FRISCHERTZ
LANIER & ASSOCIATES
LA P.E. # 32628

PRELIMINARY - FOR PERMIT PURPOSES ONLY

10577-P3

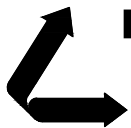

LANIER & ASSOCIATES
CONSULTING ENGINEERS
INCORPORATED
LA: C-1120 F-2981
NEW ORLEANS, LA • BEAUMONT, TX

INGRAM BARGE COMPANY
BATON ROUGE LOUISIANA

**PROPOSED NEW BARGE FLEETING
OVERALL SITE PLAN
AT RIVER STAGE 16.0' OR GREATER**

DATE FEB 2018
DESIGN NPL
DRAWN JDM
CHECK NPL
CONTRACT 10577
SHEET No.

3 OF 9

J:\100005\10577 INGRAM BARGE PERMITTING\DRAWINGS\10577-P3.DWG

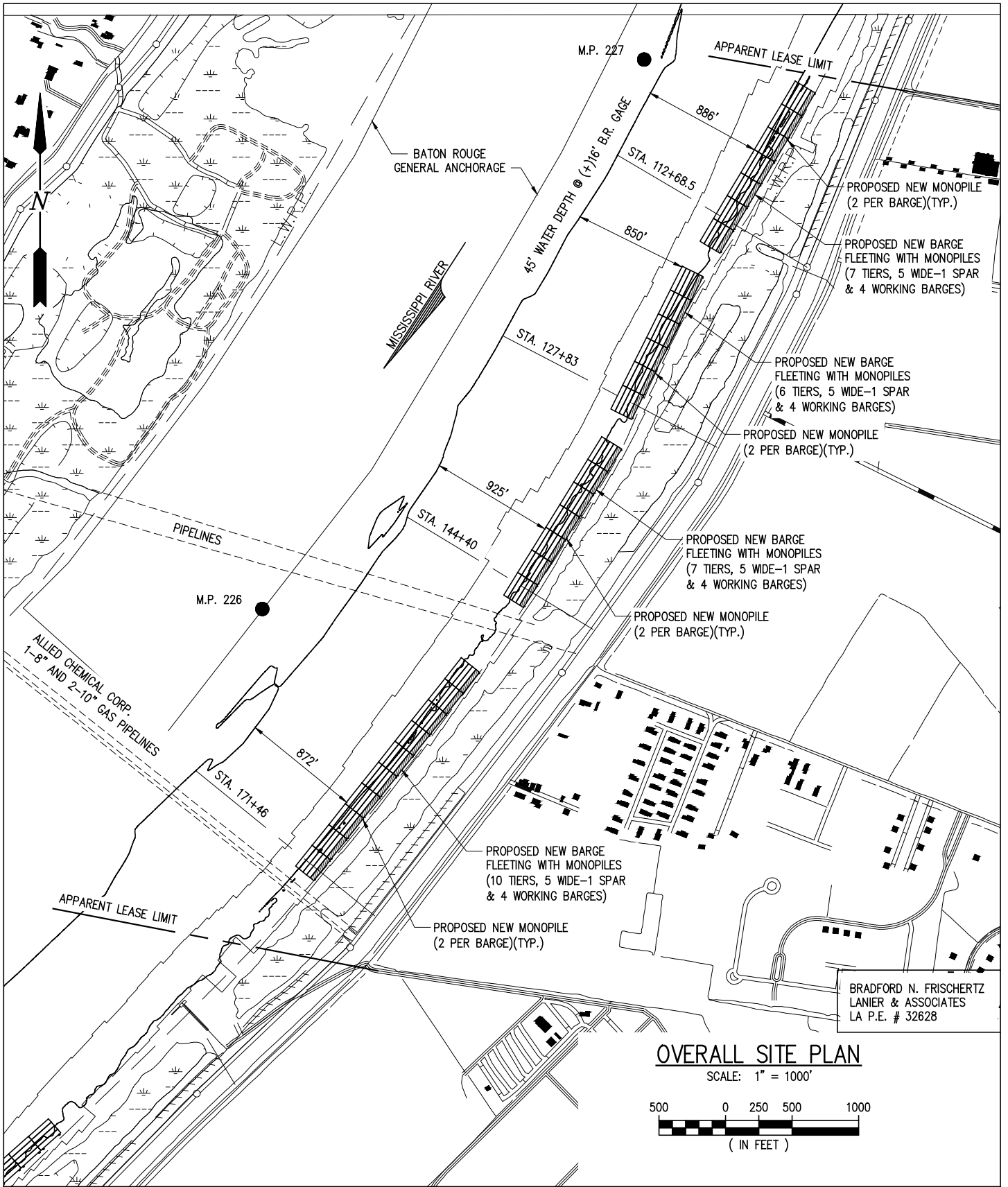

OVERALL SITE PLAN

SCALE: 1" = 1000'

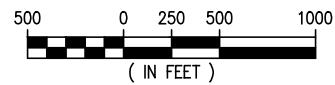

PRELIMINARY - FOR PERMIT PURPOSES ONLY

10577-P4

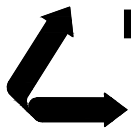

LANIER & ASSOCIATES
CONSULTING ENGINEERS
INCORPORATED
LA: C-1120 F-2981
NEW ORLEANS, LA • BEAUMONT, TX

INGRAM BARGE COMPANY
BATON ROUGE LOUISIANA

**PROPOSED NEW BARGE FLEETING
OVERALL SITE PLAN
BELOW RIVER STAGE 16.0'**

DATE FEB 2018
DESIGN NPL
DRAWN JDM
CHECK NPL
CONTRACT 10577
SHEET No.

4 OF 9

J:\100005\10577 INGRAM BARGE PERMITTING\DRAWINGS\10577-P4.DWG

☉ LEVEE

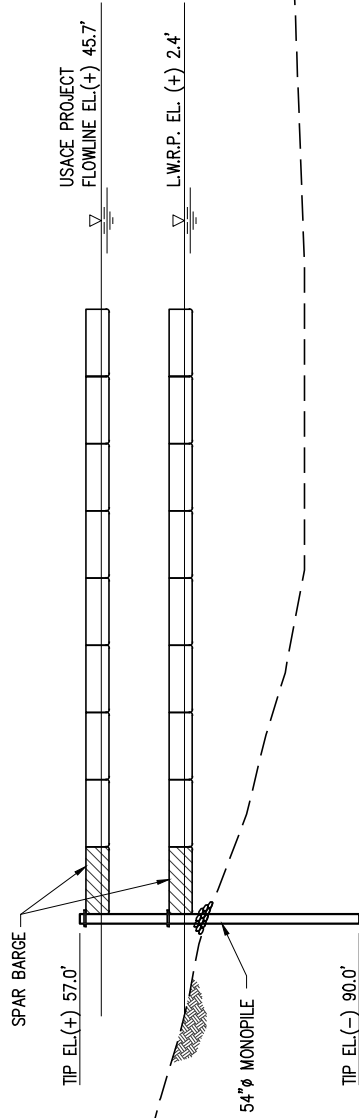

SECTION AT STA. 112+68.5

SCALE: 1" = 100'

☉ LEVEE

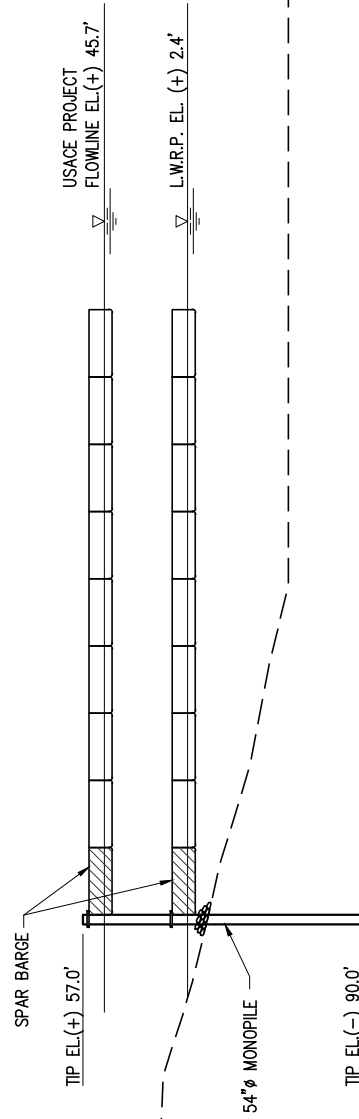

SECTION AT STA. 127+83

SCALE: 1" = 100'

BRADFORD N. FRISCHERTZ
LANIER & ASSOCIATES
LA P.E. # 32628

PRELIMINARY - FOR PERMIT PURPOSES ONLY

10577-P5

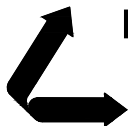

LANIER & ASSOCIATES
CONSULTING ENGINEERS
INCORPORATED
LA: C-1120 F-2981
NEW ORLEANS, LA • BEAUMONT, TX

INGRAM BARGE COMPANY
BATON ROUGE LOUISIANA

**PROPOSED NEW BARGE FLEETING
CROSS SECTIONS
STA. 112+68.5 AND STA. 127+83**

DATE FEB 2018
DESIGN NPL
DRAWN JDM
CHECK NPL
CONTRACT 10577
SHEET No.

5 OF 9

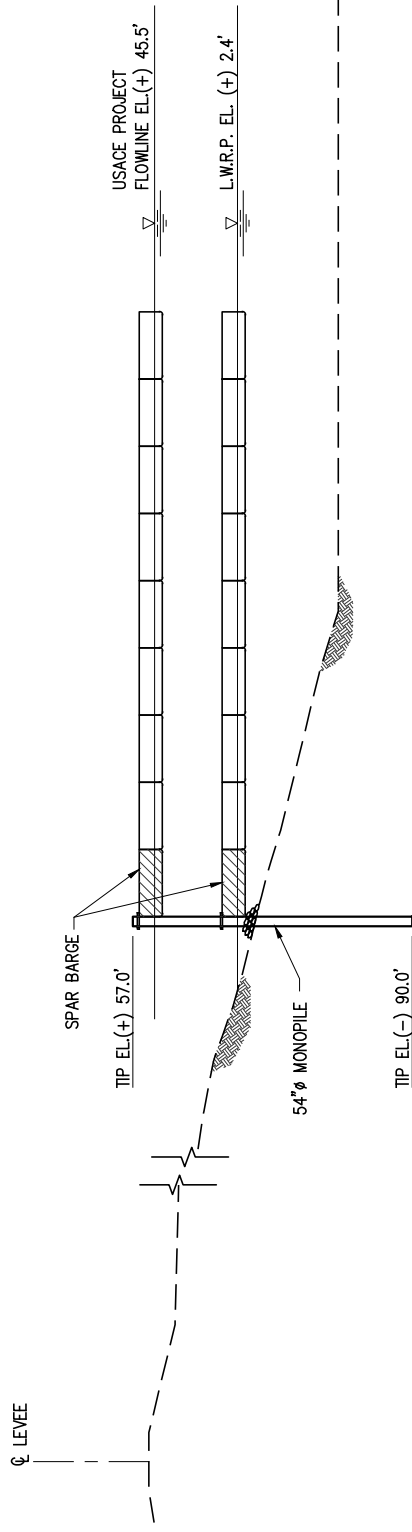

SECTION AT STA. 144+40
SCALE: 1" = 100'

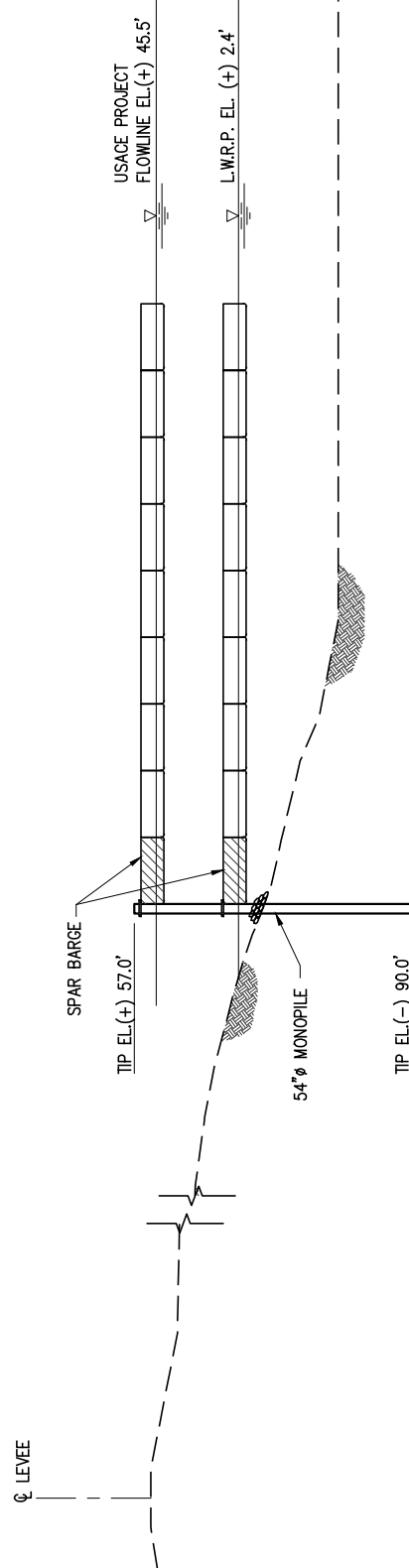

SECTION AT STA. 171+46
SCALE: 1" = 100'

BRADFORD N. FRISCHERTZ
LANIER & ASSOCIATES
LA P.E. # 32628

PRELIMINARY - FOR PERMIT PURPOSES ONLY

10577-P6

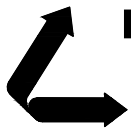

LANIER & ASSOCIATES
CONSULTING ENGINEERS
INCORPORATED
LA: C-1120 F-2981
NEW ORLEANS, LA • BEAUMONT, TX

INGRAM BARGE COMPANY
BATON ROUGE LOUISIANA

**PROPOSED NEW BARGE FLEETING
CROSS SECTIONS
STA. 144+40 AND STA. 171+46**

DATE FEB 2018
DESIGN NPL
DRAWN JDM
CHECK NPL
CONTRACT 10577
SHEET No.

6 OF 9

J:\1000S\10577 INGRAM BARGE PERMITTING\DRAWINGS\10577-P7.DWG

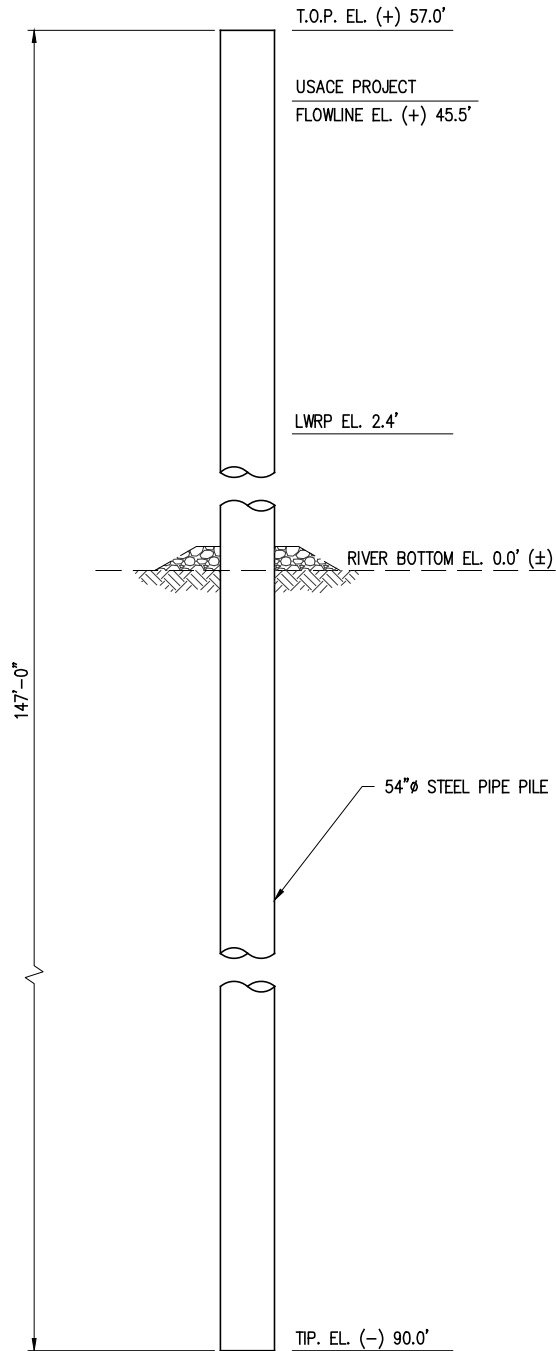

BARGE MONOPILE

SCALE: 1/16" = 1'-0"
(60 REQ'D)

BRADFORD N. FRISCHERTZ
LANIER & ASSOCIATES
LA P.E. # 32628

PRELIMINARY - FOR PERMIT PURPOSES ONLY

10577-P7

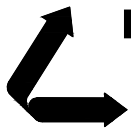

LANIER & ASSOCIATES
CONSULTING ENGINEERS
INCORPORATED
LA: C-1120 F-2981
NEW ORLEANS, LA • BEAUMONT, TX

INGRAM BARGE COMPANY
BATON ROUGE LOUISIANA

**PROPOSED NEW BARGE FLEETING
BARGE MONOPILE**

DATE FEB 2018
DESIGN NPL
DRAWN JDM
CHECK NPL
CONTRACT 10577
SHEET No.

7 OF 9

PILE

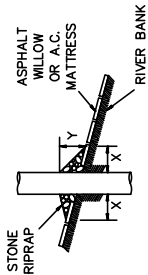

CAISSON

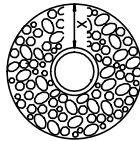
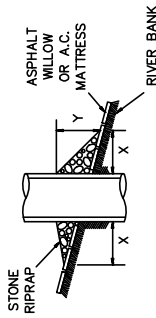

SPUD PILE
(BUOY AND ANCHOR CHAIN)

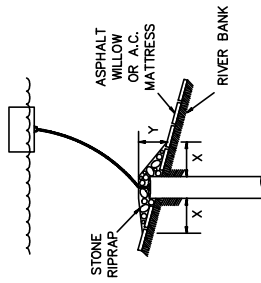

PILE CLUSTER

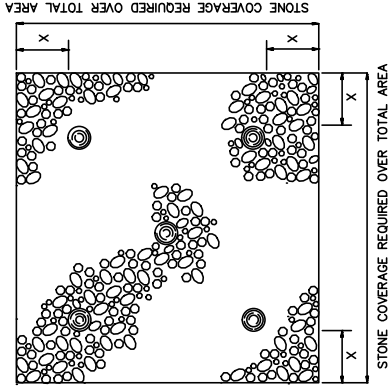
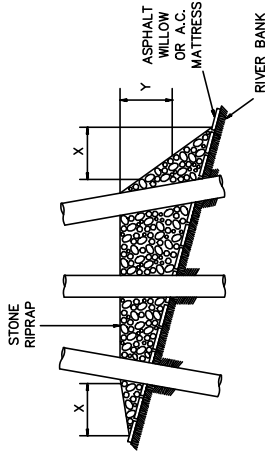

NOTES:

1. SIZE OF RIPRAP TO VARY BETWEEN 6 POUNDS AND 125 POUNDS WITH 40 PERCENT TO 60 PERCENT OF THE STONE WITHIN THE RANGE OF 25 POUNDS TO 75 POUNDS.
2. WHEN PENETRATING THE UPPER BANK PAVING IN A RETEVMENT AREA WITH PILES, CAISSONS AND/OR PILE CLUSTERS, A 10 INCH THICK RIPRAP STONE LAYER SHALL BE PLACED OVER ALL AREAS WHERE THE BANK PAVING IS DISTURBED BY DRIVING OPERATIONS.
3. WHEN USING AN ANCHOR CHAIN AND BUOY SYSTEM, THE ANCHOR CHAIN MUST BE ATTACHED AT THE TOP OF THE PILE TO MINIMIZE RETEVMENT DAMAGE.

DEPTH OF WATER IN FEET AT POINT OF PENETRATION AT TIME OF STONE PLACEMENT	DIMENSIONS IN FEET FOR PROTECTION AREA REQUIRED											
	PILE			CAISSON			SPUD PILE (BUOY AND ANCHOR CHAIN)			PILE CLUSTER		
	X	Y		X	Y		X	Y		X	Y	
1' - 10'	3	1.5	5	2	2	3	3	3	3	3	1	
11' - 40'	5	2	8	3	3	7	3	6	6	2	2	
41' - 60'	8	3	12	4	4	12	4	10	10	3	3	

BRADFORD N. FRISCHERTZ
LANIER & ASSOCIATES
LA P.E. # 32628

PRELIMINARY - FOR PERMIT PURPOSES ONLY

10577-P8

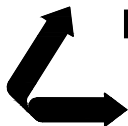

LANIER & ASSOCIATES
CONSULTING ENGINEERS
INCORPORATED
LA: C-1120 F-2981
NEW ORLEANS, LA • BEAUMONT, TX

INGRAM BARGE COMPANY
BATON ROUGE LOUISIANA
PROPOSED NEW BARGE FLEETING
USACE RETEVMENT REPAIR

DATE FEB 2018
DESIGN NPL
DRAWN JDM
CHECK NPL
CONTRACT 10577
SHEET No.
8 OF **9**

J:\100005\10577 INGRAM BARGE PERMITTING\DRAWINGS\10577-P9.DWG

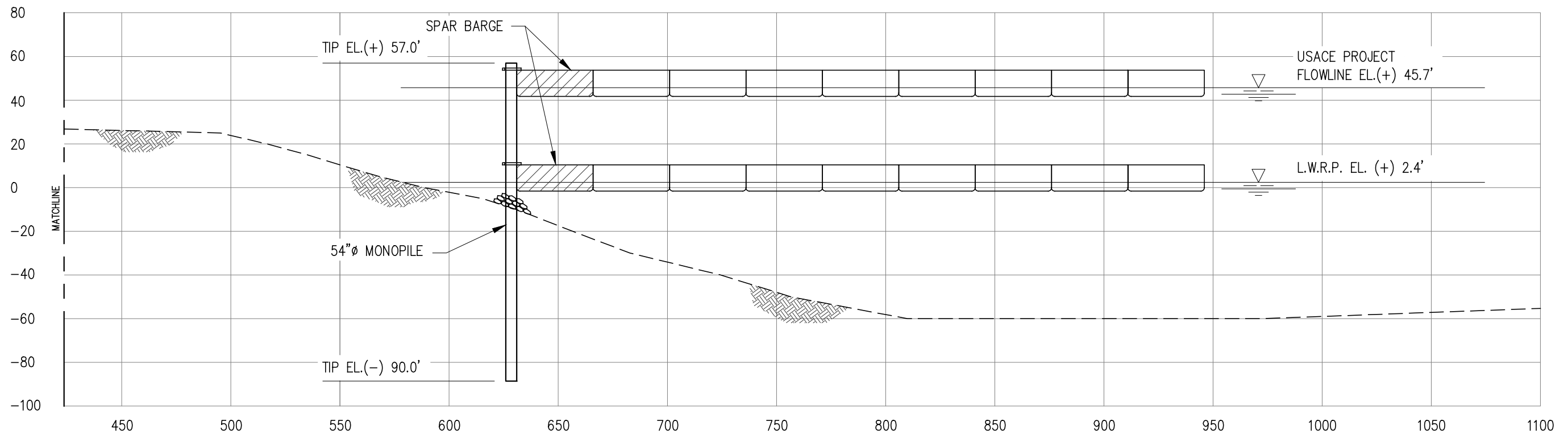
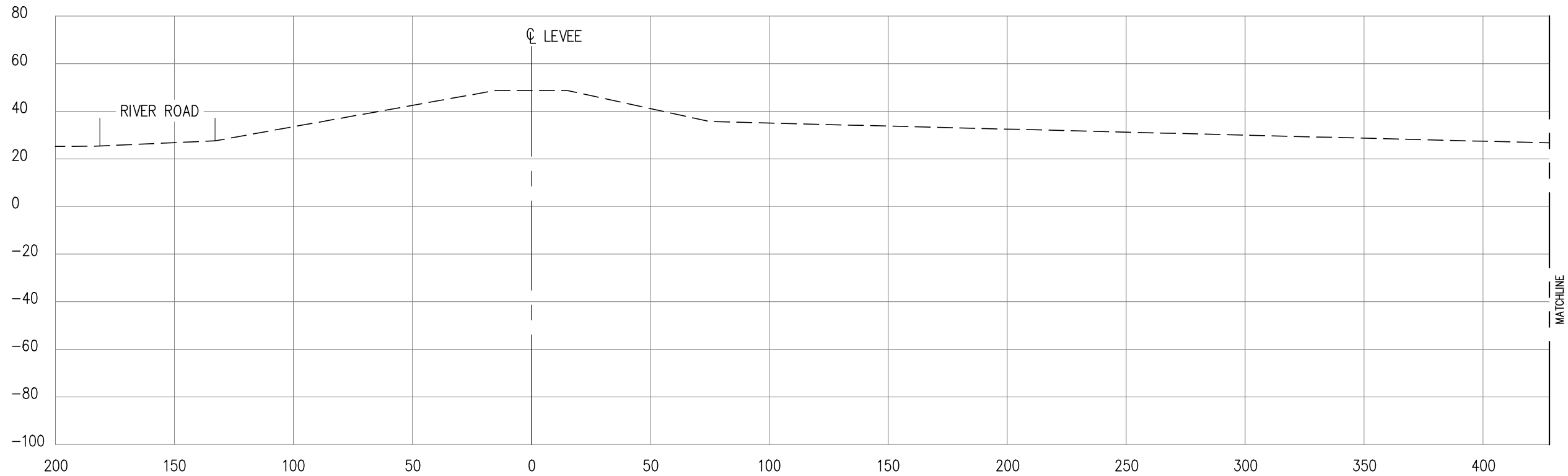

SECTION AT STA. 112+68.5

SCALE: 1" = 50'

BRADFORD N. FRISCHERTZ
LANIER & ASSOCIATES
LA P.E. # 32628

PRELIMINARY - FOR PERMIT PURPOSES ONLY



LANIER & ASSOCIATES
CONSULTING ENGINEERS
INCORPORATED
LA: C-1120 F-2981
NEW ORLEANS, LA • BEAUMONT, TX

REV	DATE	BY	DESCRIPTION	REV	DATE	BY	DESCRIPTION

DATE FEB '18
SCALE NOTED
DESIGN NPL
DRAWN JDM
CHECK BNF
APPR'D *
CAD NO 10577-P9

INGRAM BARGE COMPANY
BATON ROUGE LOUISIANA

PROPOSED NEW BARGE FLEETING

CROSS SECTION @ STA. 112+68.5

10577-18
SHEET NO.

P9