



REPLY TO
ATTENTION OF:

DEPARTMENT OF THE ARMY
CORPS OF ENGINEERS, NEW ORLEANS DISTRICT
7400 LEAKE AVENUE
NEW ORLEANS, LOUISIANA 70118

December 11, 2017

Operations Division
Central Evaluation Section

Project Manager
Dirreen Arnold
(504) 862-2301
Dirreen.S.Arnold@usace.army.mil

SUBJECT: MVN 2017-01481 CA

PUBLIC NOTICE

Interested parties are hereby notified that a permit application has been received by the New Orleans District of the US Army Corps of Engineers pursuant to: [X] Section 10 of the Rivers and Harbors Act of March 3, 1899 (30 Stat. 1151; 33 USC 403).

SHIP SHOAL 94 ARTIFICIAL REEF CREATION
OUTER CONTINENTAL SHELF, GULF OF MEXICO

NAME OF APPLICANT: LOUISIANA DEPARTMENT OF WILDLIFE AND FISHERIES,
Attn: Artificial Reef Coordinator, Michael McDonough, Post Office Box 98000, Baton Rouge, Louisiana 70808

LOCATION OF WORK: Gulf of Mexico, Outer Continental Shelf, Ship Shoal 94, approximately 25 nautical miles southwest of Cocodrie, Louisiana, off the coast of Terrebonne Parish, Louisiana, as shown on the enclosed drawings.

CHARACTER OF WORK: The applicant has requested Department of the Army authorization to deposit 15,000 tons of concrete or limestone rubble and 800 constructed reef modules over a 100 acre area to create the Ship Shoal 94 Artificial Reef, all to enhance and maintain fishing opportunities off the coast of Louisiana. The reef site is located more than 2 nautical miles from any safety fairway and the charted clearance of 18 feet at the reef site will be maintained. No special aquatic sites will be affected by this project and no mitigation is anticipated. This request is pursuant to Act 100, 1986 Louisiana Legislature and National Fishing Enhancement Act of 1984.

The comment period for the Department of the Army Permit will close **15 days** from the date of this public notice. Written comments, including suggestions for modifications or objections to the proposed work, stating reasons thereof, are being solicited from anyone having interest in this permit must be mailed so as to be received before or by the last day of the comment period. Letters concerning the Corps of Engineers permit application must reference the applicant's name and the Permit Application Number,

and be mailed to the Corps of Engineers at the address above, **ATTENTION: REGULATORY BRANCH**. Individuals or parties may request an extension of time in which to comment on the proposed work by writing or e-mailing the Corps of Engineers Project Manager listed above. Any request must be specific and substantively supportive of the requested extension, and received by this office prior to the end of the initial comment period. The Section Chief will review the request and the requestor will be promptly notified of the decision to grant or deny the request. If granted, the time extension will be continuous to the initial comment period and, inclusive of the initial comment period, will not exceed a total of 30 calendar days.

Corps of Engineers Permit Criteria

The decision as to whether a permit will be issued will be based on an evaluation of the impact of the proposed work on navigation and national security.

The U.S. Army Corps of Engineers is soliciting comments from the public, federal, state, and local agencies and officials, Indian Tribes, and other interested parties in order to consider and evaluate the impacts of this proposed activity. Any comments received will be considered by the U.S. Army Corps of Engineers to determine whether to make, modify, condition, or deny a permit for this proposal. To make this decision, comments are used to assess impacts on endangered species, historic properties, water quality, general environmental effects, and other public interest factors listed above. Comments are used in the preparation of an Environmental Assessment and/or an Environmental Impact Statement pursuant to the National Environmental Policy Act. Comments are also used to determine the need for a public hearing and to determine the overall public interest of the proposed activity.

The New Orleans District is unaware of properties listed on the National Register of Historic Places near the proposed work. The possibility exists that the proposed work may damage or destroy presently unknown archeological, scientific, pre-historical, historical sites, or data. Issuance of this public notice solicits input from the State Archeologist and State Historic Preservation Officer regarding potential impacts to cultural resources.

Our initial finding is that the proposed work would not affect any species, nor affect any habitat designated as critical to the survival and recovery of such species, listed as endangered by the U.S. Department of Commerce.

This notice initiates the Essential Fish Habitat (EFH) consultation requirements of the Magnuson-Stevens Fishery Conservation and Management Act. The applicant's proposal may result in the destruction or alteration of 100 acres of EFH utilized by various life stages of red drum and penaeid shrimp. Our initial determination is that the

proposed action would not have a substantial adverse impact on EFH or federally managed fisheries in the Gulf of Mexico. Our final determination relative to project impacts and the need for mitigation measures is subject to review by and coordination with the National Marine Fisheries Service.

If the proposed work involves deposits of dredged or fill material into navigable waters, the evaluation of the probable impacts will include the application of guidelines established by the Administrator of the Environmental Protection Agency. Also, a certification that the proposed activity will not violate applicable water quality standards will be required from the Department of Environmental Quality, before a permit is issued.

The applicant has certified that the proposed activity described in the application complies with and will be conducted in a manner that is consistent with the Louisiana Coastal Resources Program. The Department of the Army permit will not be issued unless the applicant received approval or a waiver of the Coastal Use Permit by the Department of Natural Resources.

Any person may request, in writing, within the comment period specified in this notice, that a public hearing be held to consider this application. Requests for public hearings shall state, with particularity, the reasons for holding a public hearing.

You are requested to communicate the information contained in this notice to any other parties whom you deem likely to have interest in the matter.

JOHN M. HERMAN
Chief, Central Evaluation Section
Regulatory Branch

Enclosure



REPLY TO
ATTENTION OF:

DEPARTMENT OF THE ARMY
CORPS OF ENGINEERS, NEW ORLEANS DISTRICT
7400 LEAKE AVENUE
NEW ORLEANS, LOUISIANA 70118

December 11, 2017

Operations Division
Central Evaluation Section

Project Manager
Dirreen Arnold
(504) 862-2301
Dirreen.S.Arnold@usace.army.mil

SUBJECT: MVN 2017-01481 CA

PUBLIC NOTICE

Interested parties are hereby notified that a permit application has been received by the New Orleans District of the US Army Corps of Engineers pursuant to: [X] Section 10 of the Rivers and Harbors Act of March 3, 1899 (30 Stat. 1151; 33 USC 403).

SHIP SHOAL 94 ARTIFICIAL REEF CREATION
OUTER CONTINENTAL SHELF, GULF OF MEXICO

NAME OF APPLICANT: LOUISIANA DEPARTMENT OF WILDLIFE AND FISHERIES,
Attn: Artificial Reef Coordinator, Michael McDonough, Post Office Box 98000, Baton Rouge, Louisiana 70808

LOCATION OF WORK: Gulf of Mexico, Outer Continental Shelf, Ship Shoal 94, approximately 25 nautical miles southwest of Cocodrie, Louisiana, off the coast of Terrebonne Parish, Louisiana, as shown on the enclosed drawings.

CHARACTER OF WORK: The applicant has requested Department of the Army authorization to deposit 15,000 tons of concrete or limestone rubble and 800 constructed reef modules over a 100 acre area to create the Ship Shoal 94 Artificial Reef, all to enhance and maintain fishing opportunities off the coast of Louisiana. The reef site is located more than 2 nautical miles from any safety fairway and the charted clearance of 18 feet at the reef site will be maintained. No special aquatic sites will be affected by this project and no mitigation is anticipated. This request is pursuant to Act 100, 1986 Louisiana Legislature and National Fishing Enhancement Act of 1984.

The comment period for the Department of the Army Permit will close **15 days** from the date of this public notice. Written comments, including suggestions for modifications or objections to the proposed work, stating reasons thereof, are being solicited from anyone having interest in this permit must be mailed so as to be received before or by the last day of the comment period. Letters concerning the Corps of Engineers permit application must reference the applicant's name and the Permit Application Number,

and be mailed to the Corps of Engineers at the address above, **ATTENTION: REGULATORY BRANCH**. Individuals or parties may request an extension of time in which to comment on the proposed work by writing or e-mailing the Corps of Engineers Project Manager listed above. Any request must be specific and substantively supportive of the requested extension, and received by this office prior to the end of the initial comment period. The Section Chief will review the request and the requestor will be promptly notified of the decision to grant or deny the request. If granted, the time extension will be continuous to the initial comment period and, inclusive of the initial comment period, will not exceed a total of 30 calendar days.

Corps of Engineers Permit Criteria

The decision as to whether a permit will be issued will be based on an evaluation of the impact of the proposed work on navigation and national security.

The U.S. Army Corps of Engineers is soliciting comments from the public, federal, state, and local agencies and officials, Indian Tribes, and other interested parties in order to consider and evaluate the impacts of this proposed activity. Any comments received will be considered by the U.S. Army Corps of Engineers to determine whether to make, modify, condition, or deny a permit for this proposal. To make this decision, comments are used to assess impacts on endangered species, historic properties, water quality, general environmental effects, and other public interest factors listed above. Comments are used in the preparation of an Environmental Assessment and/or an Environmental Impact Statement pursuant to the National Environmental Policy Act. Comments are also used to determine the need for a public hearing and to determine the overall public interest of the proposed activity.

The New Orleans District is unaware of properties listed on the National Register of Historic Places near the proposed work. The possibility exists that the proposed work may damage or destroy presently unknown archeological, scientific, pre-historical, historical sites, or data. Issuance of this public notice solicits input from the State Archeologist and State Historic Preservation Officer regarding potential impacts to cultural resources.

Our initial finding is that the proposed work would not affect any species, nor affect any habitat designated as critical to the survival and recovery of such species, listed as endangered by the U.S. Department of Commerce.

This notice initiates the Essential Fish Habitat (EFH) consultation requirements of the Magnuson-Stevens Fishery Conservation and Management Act. The applicant's proposal may result in the destruction or alteration of 100 acres of EFH utilized by various life stages of red drum and penaeid shrimp. Our initial determination is that the

proposed action would not have a substantial adverse impact on EFH or federally managed fisheries in the Gulf of Mexico. Our final determination relative to project impacts and the need for mitigation measures is subject to review by and coordination with the National Marine Fisheries Service.

If the proposed work involves deposits of dredged or fill material into navigable waters, the evaluation of the probable impacts will include the application of guidelines established by the Administrator of the Environmental Protection Agency. Also, a certification that the proposed activity will not violate applicable water quality standards will be required from the Department of Environmental Quality, before a permit is issued.

The applicant has certified that the proposed activity described in the application complies with and will be conducted in a manner that is consistent with the Louisiana Coastal Resources Program. The Department of the Army permit will not be issued unless the applicant received approval or a waiver of the Coastal Use Permit by the Department of Natural Resources.

Any person may request, in writing, within the comment period specified in this notice, that a public hearing be held to consider this application. Requests for public hearings shall state, with particularity, the reasons for holding a public hearing.

You are requested to communicate the information contained in this notice to any other parties whom you deem likely to have interest in the matter.

JOHN M. HERMAN
Chief, Central Evaluation Section
Regulatory Branch

Enclosure

Louisiana Nearshore Artificial Reef Planning Areas

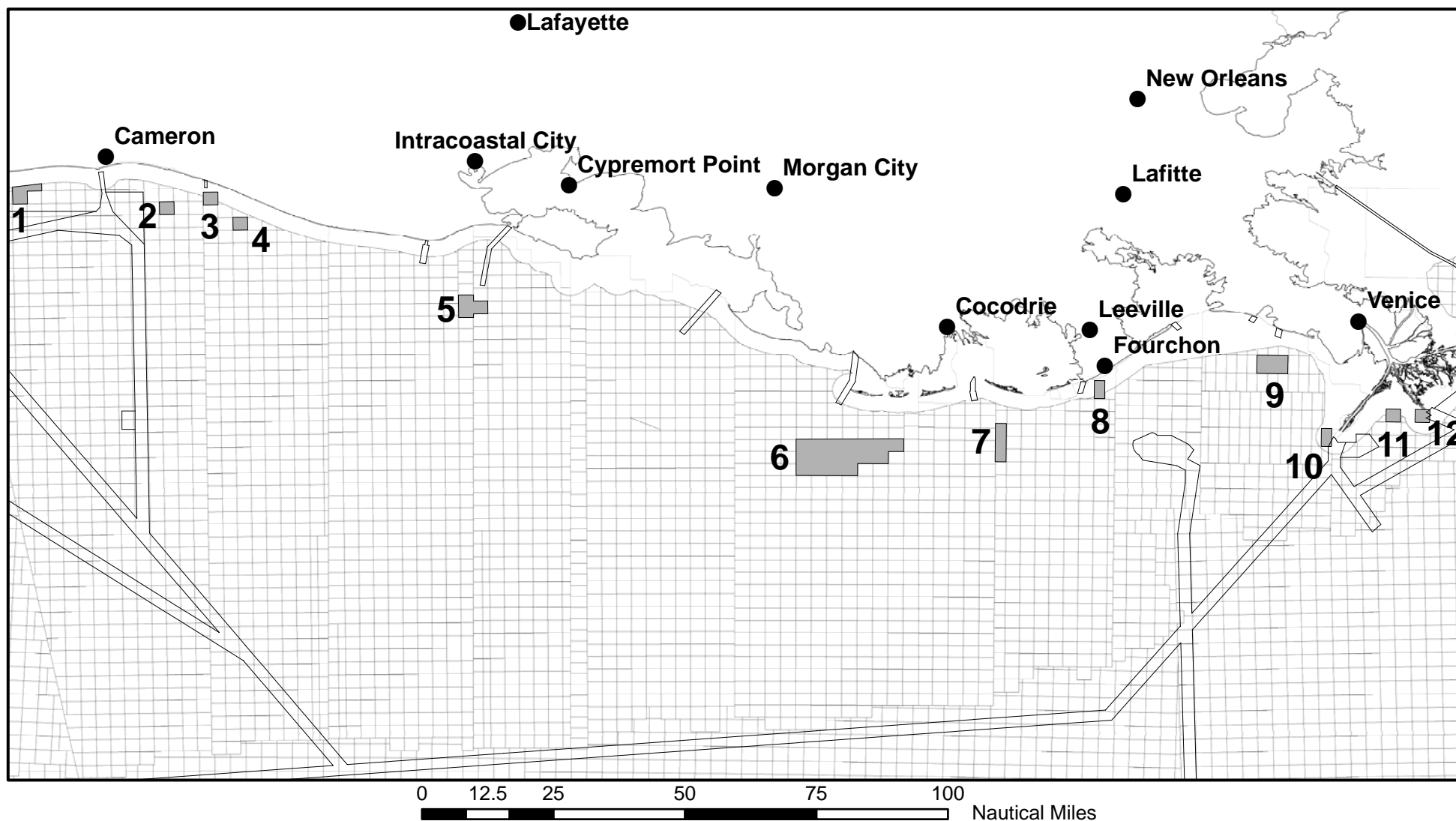

-  Reef Planning Area
-  Fairways
-  OCS Blocks

Planning Areas

- | | |
|-------------------------------------|----------------------------------|
| 1. Johnson Bayou Planning Area | 7. South Timbalier Planning Area |
| 2. West Cameron Planning Area | 8. Bay Marchand Planning Area |
| 3. East Cameron (2) Planning Area | 9. West Delta Planning Area |
| 4. East Cameron (14) Planning Area | 10. Southwest Pass Planning Area |
| 5. South Marsh Island Planning Area | 11. East Bay Planning Area |
| 6. Ship Shoal Planning Area | 12. South Pass Planning Area |

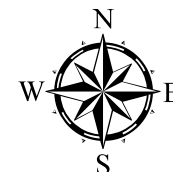

Louisiana Artificial Reef Program

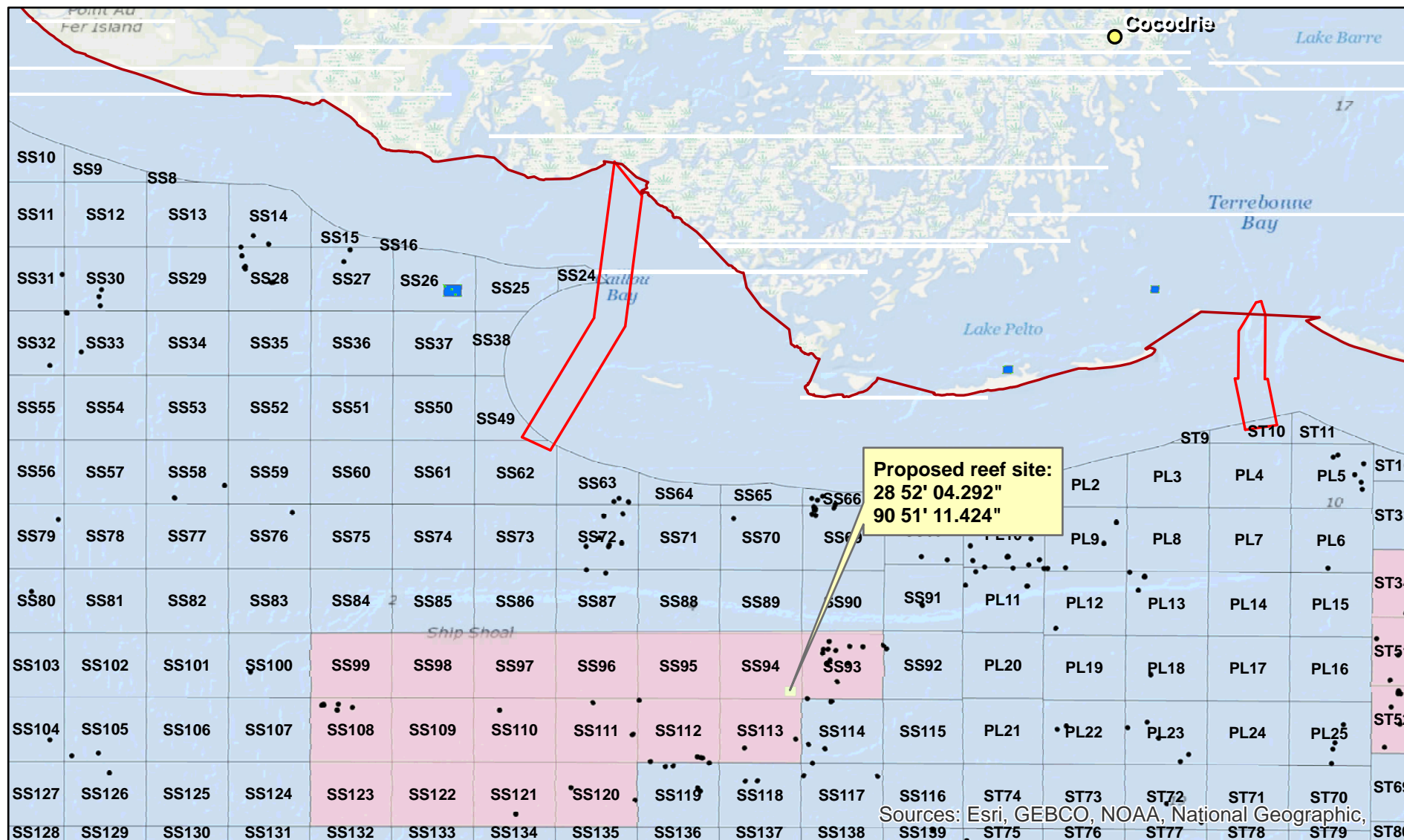

Plan View: Proposed Ship Shoal 99 Reef

Legend

- Standing Platforms
- Existing LA Reefs
- Nearshore Planning Areas

November 9, 2017

0 5 10 20 Miles



Not to be used for navigation.

Louisiana Artificial Reef Program

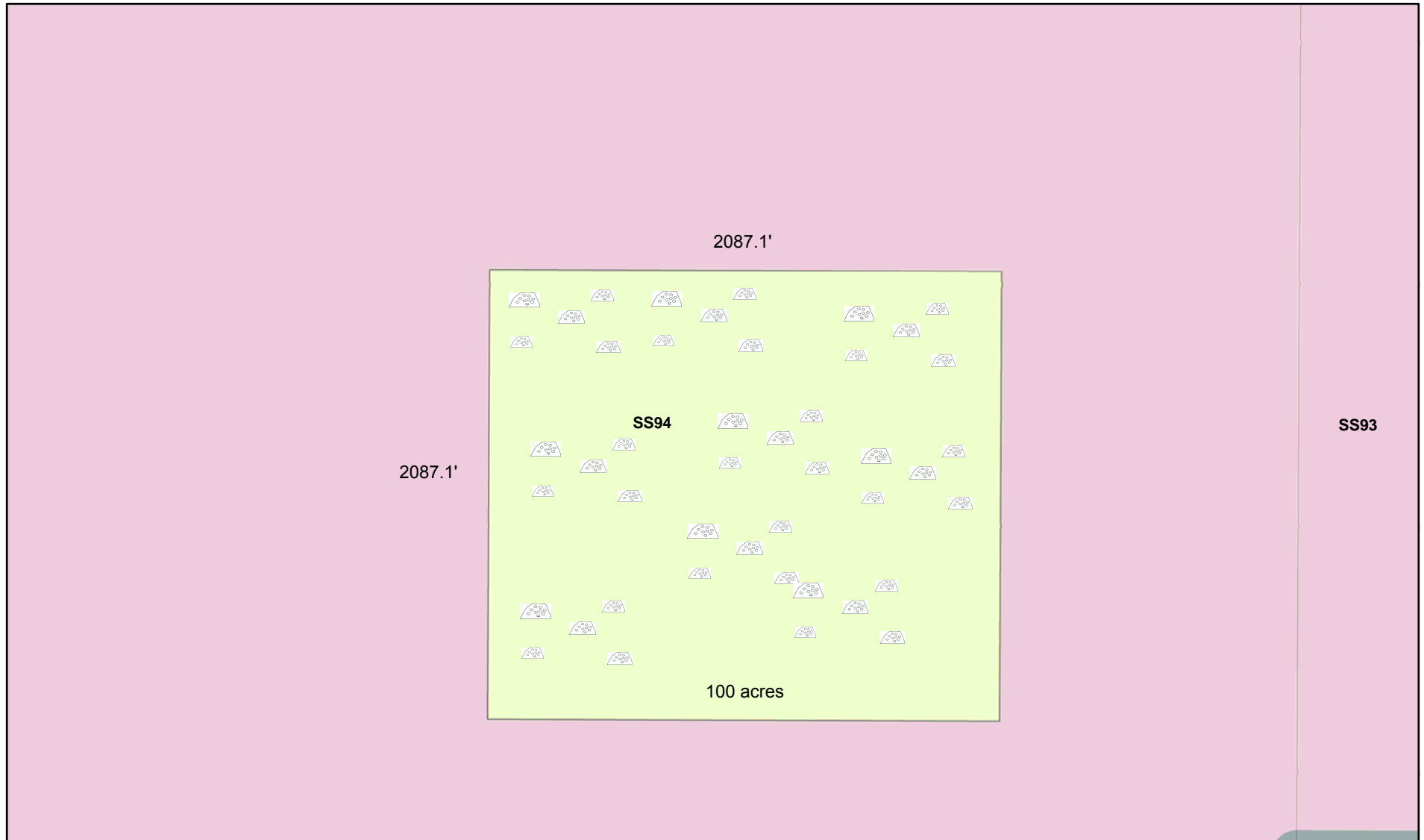

Plan View: Proposed Ship Shoal 94 Reef

November 9, 2017

Legend

 Nearshore Planning Areas

0 0.125 0.25 0.5
Miles



Not to be used for navigation.

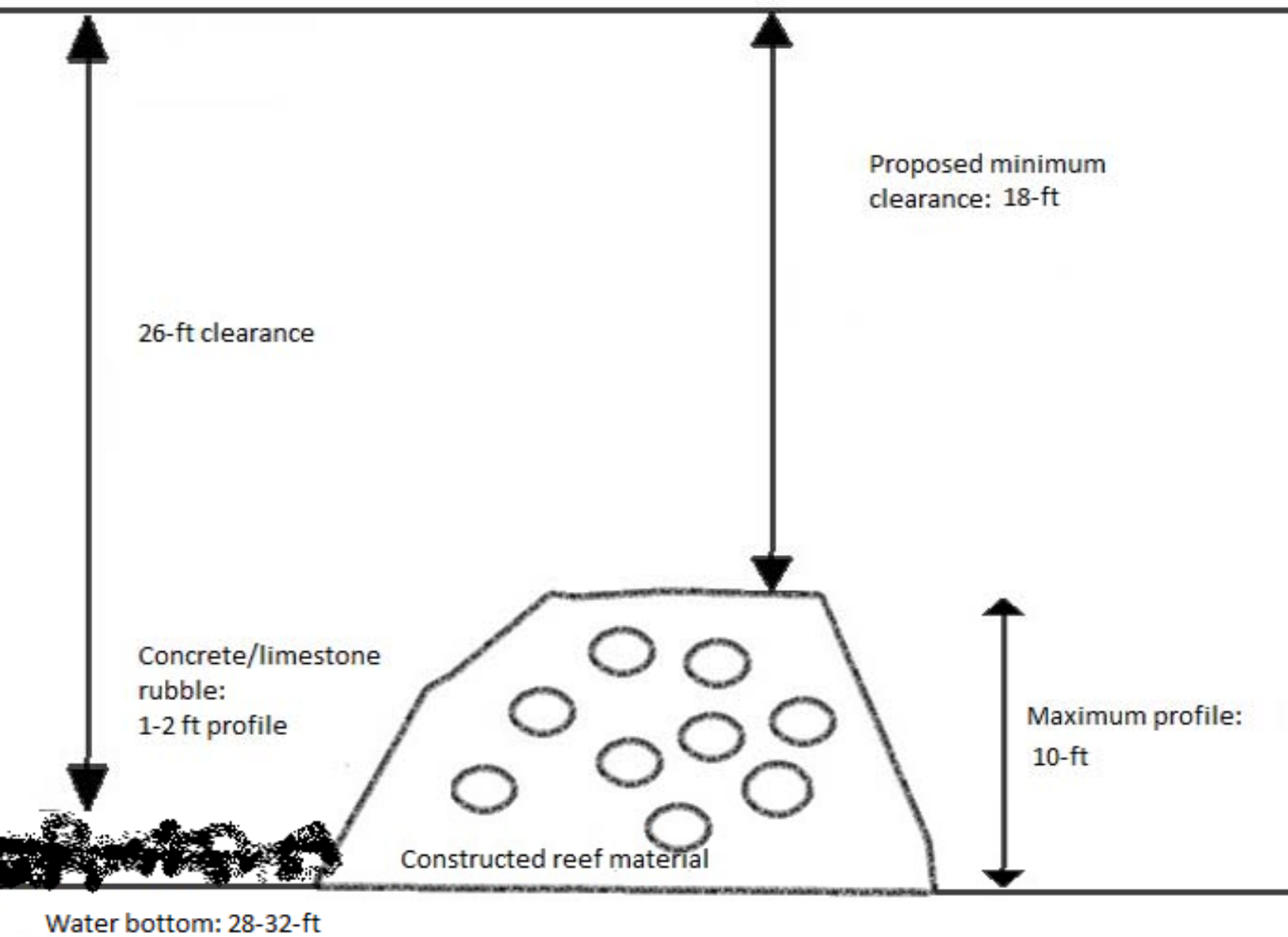

**Cross Section View of
Proposed SS-94 Reef**
November 9, 2017

Proposed Nearshore Reef Boundaries

NAD83

Ship Shoal 94 Reef

		Latitude			Longitude	
Center	28°	52'	04.292"	90°	51'	11.424"
NW Corner	28°	52'	14.666"	90°	51'	23.110"
NE Corner	28°	52'	14.580"	90°	50'	59.640"
SE Corner	28°	51'	53.919"	90°	50'	59.738"
SW Corner	28°	51'	54.005"	90°	51'	23.208"

Water Depth = 28-32 feet

Clearance = 18 feet