

JOINT PUBLIC NOTICE

October 16, 2017

United States Army
Corps of Engineers
New Orleans District
Attn: Regulatory Branch
7400 Leake Avenue
New Orleans, Louisiana 70118

State of Louisiana
Department of Environmental Quality
Attn: Office of Environmental Services
Post Office Box 4313
Baton Rouge, Louisiana 70821-4313

Project Manager: Dirreen Arnold
(504) 862-2301 / fax: (504) 862-2574
dirreen.s.arnold@usace.army.mil
Permit Application Number:
MVN-2017-01238-CA

Project Manager:
Elizabeth Hill
(225) 219-3225 / fax: (225) 219-3156
WQC Application Number:
WQC-171009-01

Interested parties are hereby notified that a permit application has been received by the New Orleans District of the US Army Corps of Engineers pursuant to: [X] Section 10 of the Rivers and Harbors Act of March 3, 1899 (30 Stat. 1151; 33 USC 403); and/or [X] Section 404 of the Clean Water Act (86 Stat. 816; 33 USC 1344).

Application has also been made to the Louisiana Department of Environmental Quality, Office of Environmental Services, for a Water Quality Certification (WQC) in accordance with statutory authority contained in LRS 30:2074 A(3) and provisions of Section 401 of the Clean Water Act.

PERSONNEL, BARGE AND EQUIPMENT DOCK INSTALLATIONS **FOURCHON TERMINAL, LAFOURCHE PARISH**

NAME OF APPLICANT: CHEVRON PIPE LINE COMPANY, c/o T. Baker Smith, Attn: Jeffrey Hargis, Post Office Box 2266, Houma, Louisiana 70361

LOCATION OF WORK: California Canal and Pass Fourchon at the Fourchon Terminal, located in Section 24, Township 23 South, Range 22 East, Port Fourchon, Louisiana, (29.106077, -90.193469), in Lafourche Parish, as shown on the enclosed drawings, within Hydrologic Unit Code 08090301 East Central Louisiana Coastal.

CHARACTER OF WORK: The applicant has requested Department of the Army authorization to install and maintain a 6.5-ft wide by 70-ft long steel personnel boat dock and walkway in the California Canal (29.106077, -90.193469), and to install and maintain a 3.5-ft wide by 39-ft long steel barge dock walkway, and a 14-ft wide by 40-ft long steel loading ramp with timber and steel piles in Pass Fourchon (29.104880, -90.190625), all to ensure continuity of safe operations at Fourchon Terminal since a bridge along Louisiana Highway 3090 that serves as the only means of access to the site, will be removed by the Lafourche Parish Government. Three (3) 8-ft by 20-ft articulated concrete mats will be placed under the steel loading ramp for erosion control. A proposed winch mounted on a 30" steel piling will be installed on the existing gravel parking lot. All construction activities will be conducted from the water on barges. No dredging or wheel washing is required. The site is an industrial facility and there are no jurisdictional wetlands that will be impacted by this project.

The comment period for the Department of the Army Permit and the Louisiana Department of Environmental Quality WQC will close **20 days** from the date of this joint public notice. Written comments, including suggestions for modifications or objections to the proposed work, stating reasons thereof, are being solicited from anyone having interest in this permit and/or this WQC request and must be submitted so as to be received before or by the last day of the comment period. Letters concerning the Corps of Engineers permit application must reference the applicant's name and the Permit Application Number, and be forwarded to the Corps of Engineers at the address above, **ATTENTION: REGULATORY BRANCH**. Similar letters concerning the Water Quality Certification must reference the applicant's name and the WQC application number and be mailed to the Louisiana Department of Environmental Quality at the address above. Individuals or parties may request an extension of time in which to comment on the proposed work by writing, faxing, or e-mailing the Corps of Engineers Project Manager listed above. Any request must be specific and substantively supportive of the requested extension, and received by this office prior to the end of the initial comment period. The Section Chief will review the request and the requestor will be promptly notified of the decision to grant or deny the request. If granted, the time extension will be continuous to the initial comment period and, inclusive of the initial comment period, will not exceed a total of 30 calendar days.

The application for this proposed project is on file with the Louisiana Department of Environmental Quality and may be examined during weekdays between 8:00 a.m. and 4:30 p.m. Copies may be obtained upon payment of costs of reproduction.

Corps of Engineers Permit Criteria

The decision whether to issue a permit will be based on an evaluation of the probable impacts, including cumulative impacts of the proposed activity on the public interest. That decision will reflect the national concern for both protection and utilization of important resources. The benefit which reasonably may be expected to accrue from the proposal must be balanced against its reasonably foreseeable detriments. All factors which may be relevant to the proposal will be considered including the cumulative effects thereof; among those are conservation, economics, aesthetics, general environmental concerns, wetlands, historic properties, fish and wildlife values, flood hazards, floodplain values, land use, navigation, shoreline erosion and accretion, recreation, water supply and conservation, water quality, energy needs, safety, food and fiber production, mineral needs, considerations of property ownership and, in general, the needs and welfare of the people.

The U.S. Army Corps of Engineers is soliciting comments from the public, federal, state, and local agencies and officials, Indian Tribes, and other interested parties in order to consider and evaluate the impacts of this proposed activity. Any comments received will be considered by the U.S. Army Corps of Engineers to determine whether to make, modify, condition, or deny a permit for this proposal. To make this decision, comments are used to assess impacts on endangered species, historic properties, water quality, general environmental effects, and other public interest factors listed above. Comments are used in the preparation of an Environmental Assessment and/or an Environmental Impact Statement pursuant to the National Environmental Policy Act. Comments are also used to determine the need for a public hearing and to determine the overall public interest of the proposed activity.

The New Orleans District is unaware of properties listed on the National Register of Historic Places near the proposed work. The possibility exists that the proposed work may damage or destroy presently unknown archeological, scientific, pre-historical, historical sites, or data. Issuance of this public notice solicits input from the State Archeologist and State Historic Preservation Officer regarding potential impacts to cultural resources.

The New Orleans District has determined that the proposed project is located within waters known to be occupied by the endangered West Indian Manatee (*Trichechus manatus*) and determined with the inclusion of the Standard Manatee Conditions for In-Water Activities the proposed activity is not likely to adversely affect the species based on the Standard Local Operating Procedure for Endangered Species in Louisiana (SLOPES), dated October 22, 2014, between the U.S. Army Corps of Engineers, New Orleans and U.S. Fish and Wildlife Service, Ecological Services Office.

This notice initiates the Essential Fish Habitat (EFH) consultation requirements of the Magnuson-Stevens Fishery Conservation and Management Act. The applicant's proposal may result in the destruction or alteration of 0.0 acres of EFH utilized by various life stages of red drum and penaeid shrimp. Our initial determination is that the proposed action would not have a substantial adverse impact on EFH or federally managed fisheries in the Gulf of Mexico. Our final determination relative to project impacts and the need for mitigation measures is subject to review by and coordination with the National Marine Fisheries Service.

If the proposed work involves deposits of dredged or fill material into navigable waters, the evaluation of the probable impacts will include the application of guidelines established by the Administrator of the Environmental Protection Agency. Also, a certification that the proposed activity will not violate applicable water quality standards will be required from the Department of Environmental Quality, before a permit is issued.

Any person may request, in writing, within the comment period specified in this notice, that a public hearing be held to consider this application. Requests for public hearings shall state, with particularity, the reasons for holding a public hearing. You are requested to communicate the information contained in this notice to any other parties whom you deem likely to have interest in the matter.

The applicant has certified that the proposed activity described in the application complies with and will be conducted in a manner that is consistent with the Louisiana Coastal Resources Program. The Department of the Army permit will not be issued unless the applicant received approval or a waiver of the Coastal Use Permit by the Department of Natural Resources.

JOHN M. HERMAN
Chief, Central Evaluation Section
Regulatory Branch

Enclosure

LAFOURCH PARISH, LOUISIANA
20 MILES SOUTH OF GOLDEN MEADOW

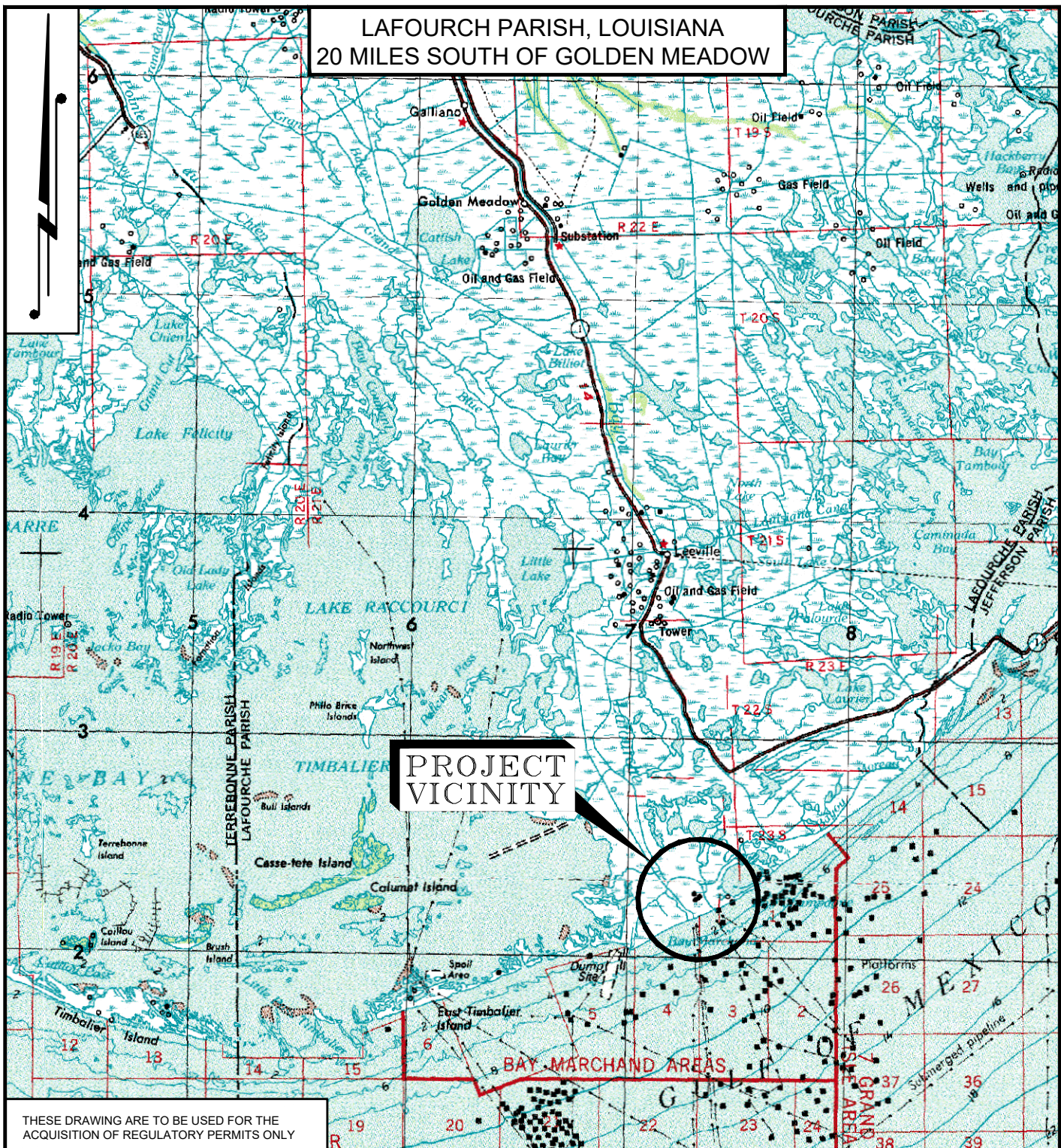

PROJECT VICINITY

THESE DRAWING ARE TO BE USED FOR THE ACQUISITION OF REGULATORY PERMITS ONLY

DRAWN BY: SJK APPROVED BY: JMH

DATE: 09/13/17 JOB NO: 2017.0812

DRAWING NAME: 170812P01-02.DWG

SHEET NO: 1 OF 12

PROJECTION: LA SOUTH
GEO. DATUM: NAD83 | VERT. DATUM: NAVD88
GRID UNITS: US SURVEY FEET

SCALE: 1" = 4 Miles



PROJECT VICINITY

CHEVRON PIPE LINE COMPANY
PROPOSED INSTALLATION OF
A PERSONNEL DOCK & EQUIPMENT DOCK
FOURCHON TERMINAL
SECTION 24, T23S-R22E
LAFOURCHE PARISH, LOUISIANA



REV. NO: 00 REV. DATE: --/-- REV. BY: --

REVISION DESCRIPTION:

--

LAFOURCH PARISH, LOUISIANA
SECTION 24, T23S-R22E

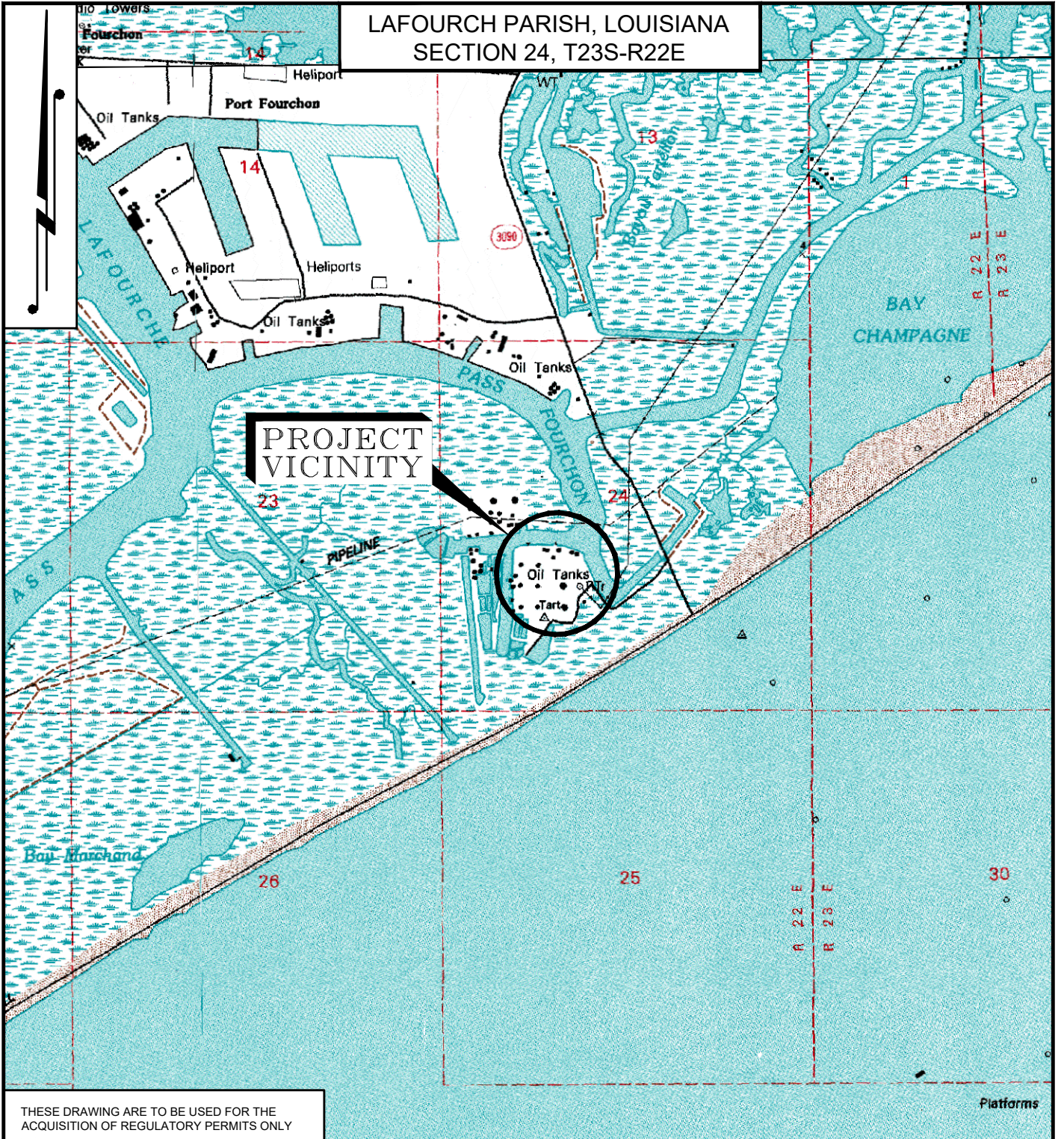

THESE DRAWING ARE TO BE USED FOR THE ACQUISITION OF REGULATORY PERMITS ONLY

DRAWN BY: SJK APPROVED BY: JMH

DATE: 09/13/17 JOB NO: 2017.0812

DRAWING NAME: 170812P01-02.DWG

SHEET NO: 2 OF 12

PROJECTION: LA SOUTH
GEO. DATUM: NAD83 | VERT. DATUM: NAVD88
GRID UNITS: US SURVEY FEET

SCALE: 1" = 2000'

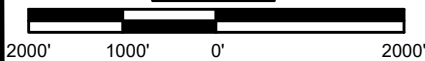

PROJECT VICINITY

CHEVRON PIPE LINE COMPANY
PROPOSED INSTALLATION OF
A PERSONNEL DOCK & EQUIPMENT DOCK
FOURCHON TERMINAL
SECTION 24, T23S-R22E
LAFOURCHE PARISH, LOUISIANA



REV. NO: 00 REV. DATE: --/-- REV. BY: --

REVISION DESCRIPTION:

--

Platforms

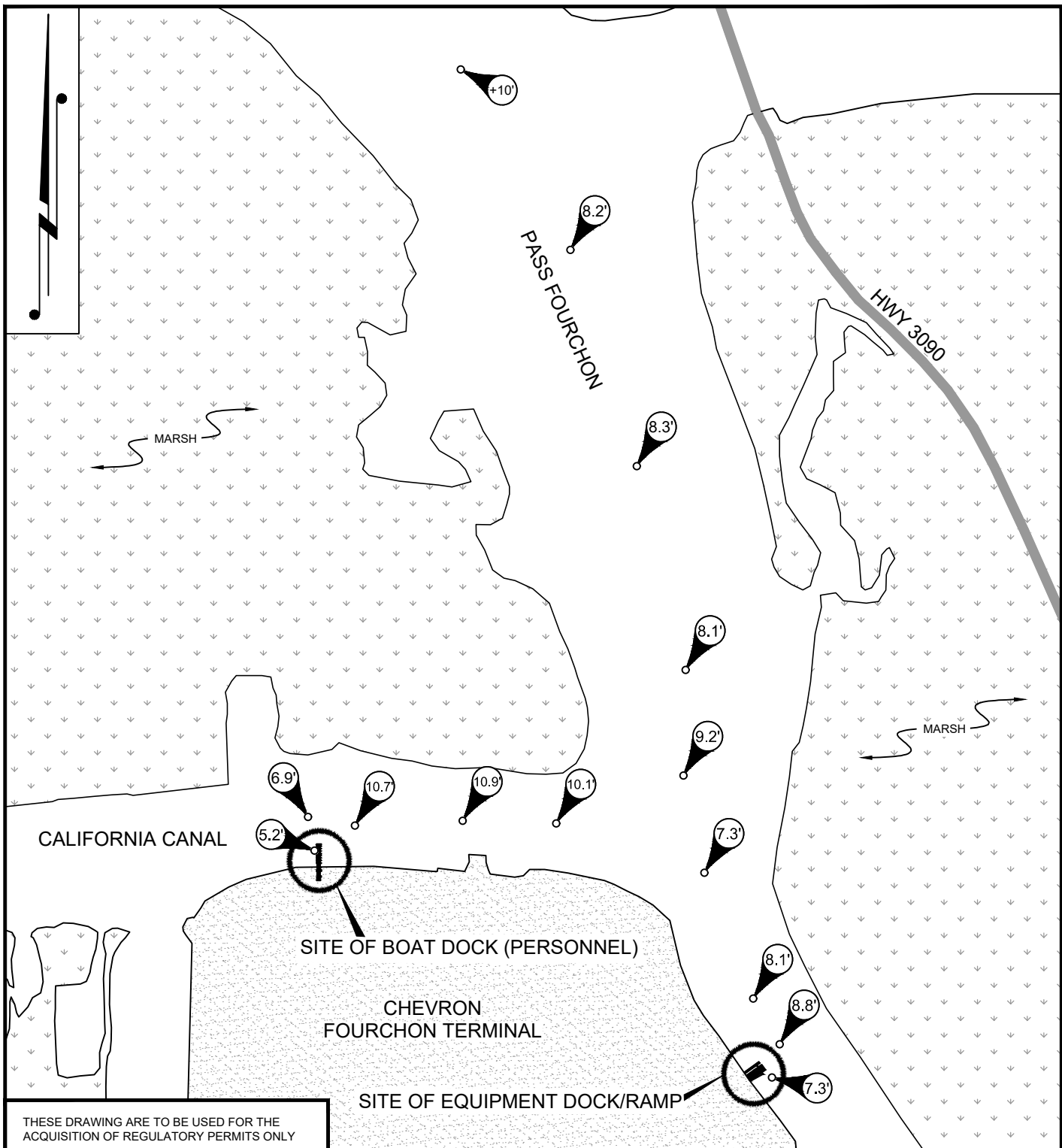

THESE DRAWING ARE TO BE USED FOR THE ACQUISITION OF REGULATORY PERMITS ONLY

DRAWN BY: SJK APPROVED BY: JMH

DATE: 09/13/17 JOB NO: 2017.0812

DRAWING NAME: 170812P01-02.DWG

SHEET NO: 3 OF 12

PROJECTION: LA SOUTH
 GEO. DATUM: NAD83 | VERT. DATUM: NAVD88
 GRID UNITS: US SURVEY FEET

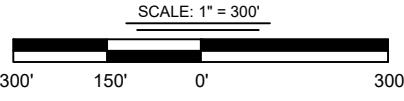

ACCESS

CHEVRON PIPE LINE COMPANY
 PROPOSED INSTALLATION OF
 A PERSONNEL DOCK & EQUIPMENT DOCK
 FOURCHON TERMINAL
 SECTION 24, T23S-R22E
 LAFOURCHE PARISH, LOUISIANA

T. BAKER SMITH
 A CENTURY OF SOLUTIONS
 412 South Van Ave, Houma, LA 70063
 (905)908-1000 - tbsmith.com

REV. NO: 00 REV. DATE: --/--/-- REV. BY: --

REVISION DESCRIPTION:
 --

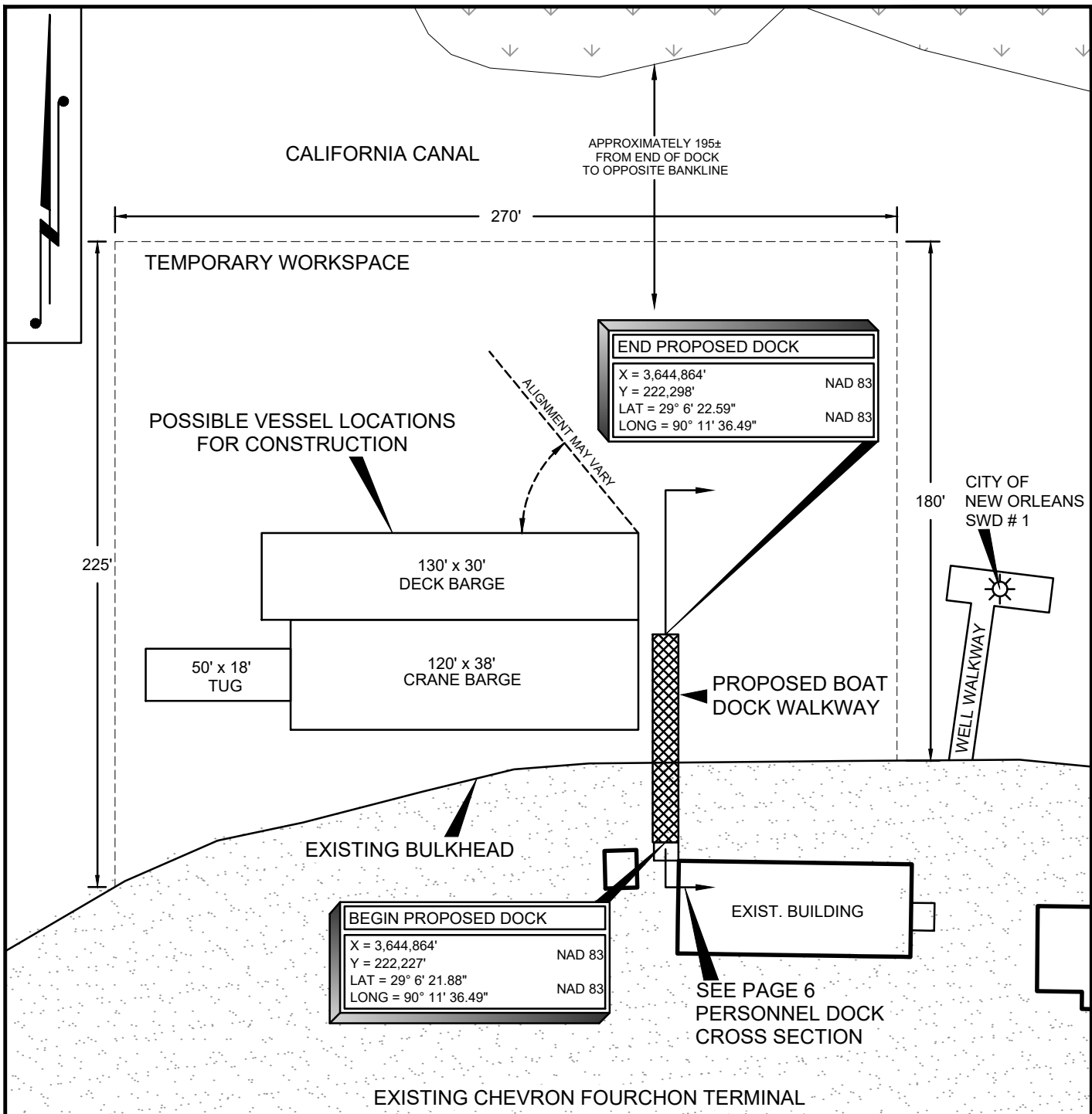

| | |
|---|-------------------|
| THESE DRAWING ARE TO BE USED FOR THE ACQUISITION OF REGULATORY PERMITS ONLY | |
| DRAWN BY: SJK | APPROVED BY: JMH |
| DATE: 09/13/17 | JOB NO: 2017.0812 |
| DRAWING NAME: 170812P01-02.DWG | |
| SHEET NO: 4 | OF 12 |
| PROJECTION: LA SOUTH GEO. DATUM: NAD83 VERT. DATUM: NAVD88 GRID UNITS: US SURVEY FEET | |
| SCALE: 1" = 50' | |
| | |

BOAT DOCK (PERSONNEL) WORKSPACE

CHEVRON PIPE LINE COMPANY
PROPOSED INSTALLATION OF
A PERSONNEL DOCK & EQUIPMENT DOCK
FOURCHON TERMINAL
SECTION 24, T23S-R22E
LAFOURCHE PARISH, LOUISIANA

| | | |
|-----------------------------|------------------|-------------|
| REV. NO: 00 | REV. DATE: --/-- | REV. BY: -- |
| REVISION DESCRIPTION: -- | | |

T. BAKER SMITH
A CENTURY OF SOLUTIONS
412 South Van Ave, Houma, LA 70063
(905)908-1000 - tbsmith.com

IMPACTS:

12" TIMBER PILES: QTY. 6
 6 TO BE INSTALLED IN WATER: 6 sqft.

0 CUBIC YARDS OF MATERIAL REMOVED

PASS FOURCHON

END PROPOSED DOCK

X = 3,645,808' NAD 83
 Y = 221,825' NAD 83
 LAT = 29° 6' 17.81"
 LONG = 90° 11' 25.90"

BEGIN PROPOSED DOCK

X = 3,645,777' NAD 83
 Y = 221,801' NAD 83
 LAT = 29° 6' 17.57"
 LONG = 90° 11' 26.25"

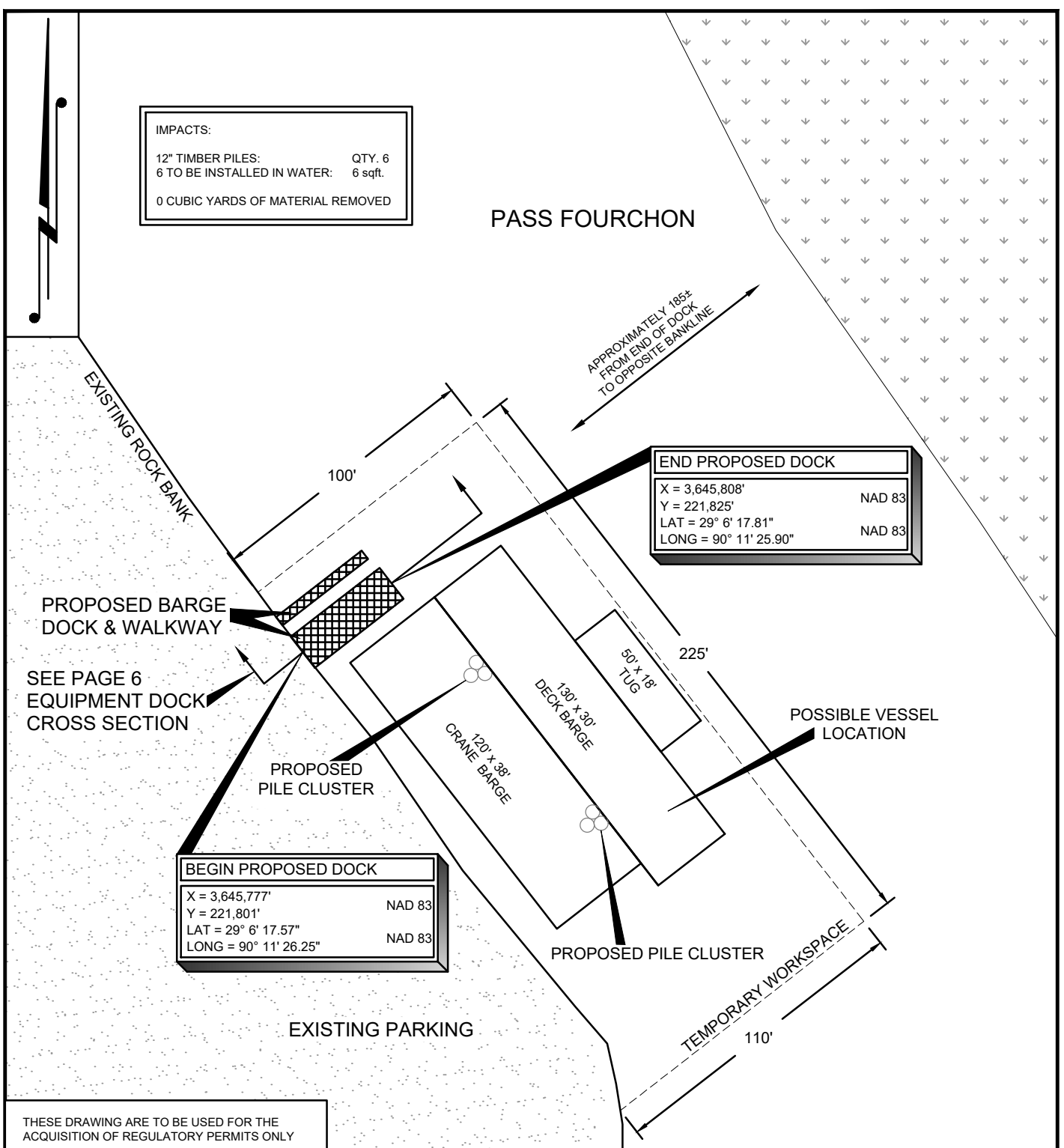

| | |
|---|-------------------|
| THESE DRAWING ARE TO BE USED FOR THE ACQUISITION OF REGULATORY PERMITS ONLY | |
| DRAWN BY: SJK | APPROVED BY: JMH |
| DATE: 09/13/17 | JOB NO: 2017.0812 |
| DRAWING NAME: 170812P01-02.DWG | |
| SHEET NO: 5 OF 12 | |
| PROJECTION: LA SOUTH GEO. DATUM: NAD83 VERT. DATUM: NAVD88 GRID UNITS: US SURVEY FEET | |
| SCALE: 1" = 50' | |
| | |

EQUIPMENT DOCK/RAMP WORKSPACE

CHEVRON PIPE LINE COMPANY
 PROPOSED INSTALLATION OF
 A PERSONNEL DOCK & EQUIPMENT DOCK
 FOURCHON TERMINAL
 SECTION 24, T23S-R22E
 LAFORCHE PARISH, LOUISIANA

| | | |
|-----------------------|------------------|-------------|
| REV. NO: 00 | REV. DATE: --/-- | REV. BY: -- |
| REVISION DESCRIPTION: | | |
| -- | | |

T. BAKER SMITH
 A CENTURY OF SOLUTIONS
 412 South Van Ave, Houma, LA 70063
 (905) 908-1000 - tbsmith.com

CROSS SECTION "PERSONNEL DOCK "

LOOKING EAST

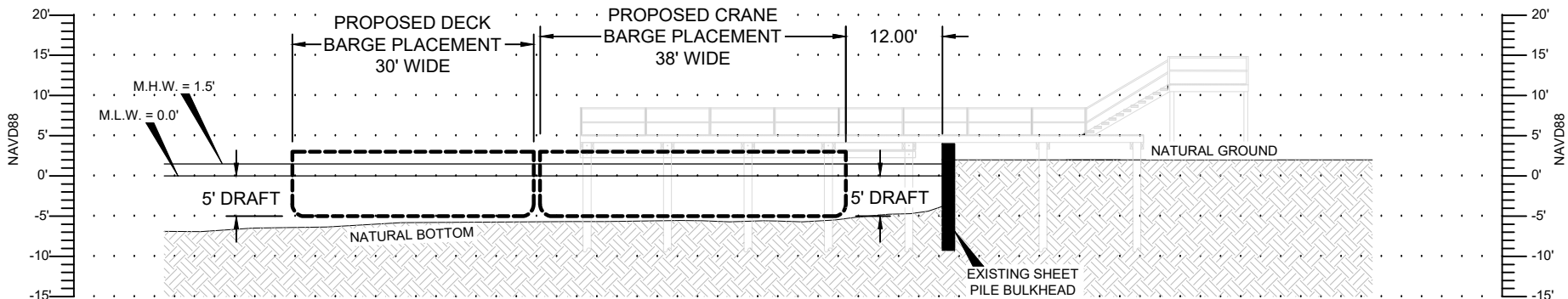

CROSS SECTION "EQUIPMENT DOCK"

LOOKING NORTHWEST

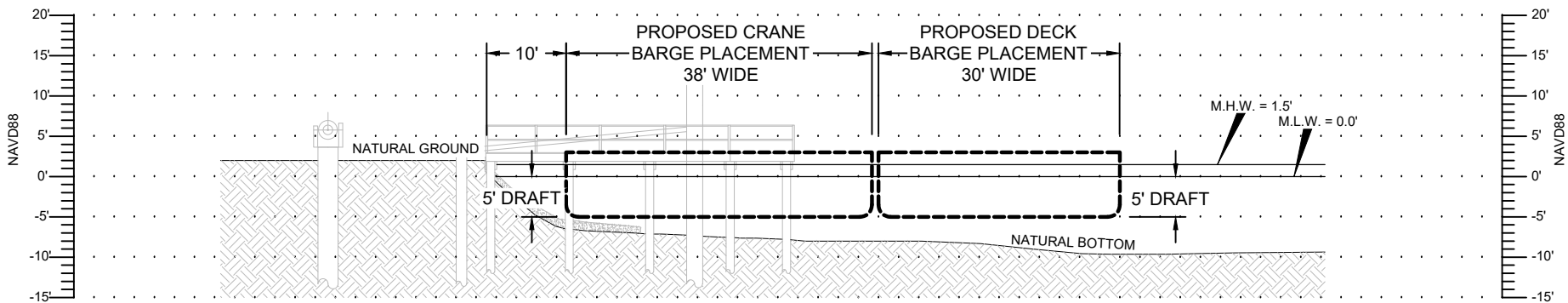

THESE DRAWING ARE TO BE USED FOR THE ACQUISITION OF REGULATORY PERMITS ONLY

SCALE: 1" = 20'

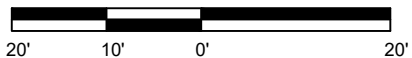

| | | | |
|---------------|------------------|--------------|-----------|
| DRAWN BY: | SJK | APPROVED BY: | JMH |
| DATE: | 09/13/17 | JOB NO: | 2017.0812 |
| DRAWING NAME: | 170812P01-02.DWG | | |

SHEET NO: **6** OF **12**

PROJECTION: LA SOUTH
 GEO. DATUM: NAD83 | VERT. DATUM: NAVD88
 GRID UNITS: US SURVEY FEET

REVISION DESCRIPTION:

| | | | | | |
|----------|----|------------|-------|----------|-----|
| REV. NO: | 00 | REV. DATE: | --/-- | REV. BY: | --- |
|----------|----|------------|-------|----------|-----|

EQUIPMENT ACCESS PROFILE
CHEVRON PIPE LINE COMPANY
 PROPOSED INSTALLATION OF
 A PERSONNEL DOCK & EQUIPMENT DOCK
 FOURCHON TERMINAL
 SECTION 24, T23S-R22E
 LAFORCHE PARISH, LOUISIANA



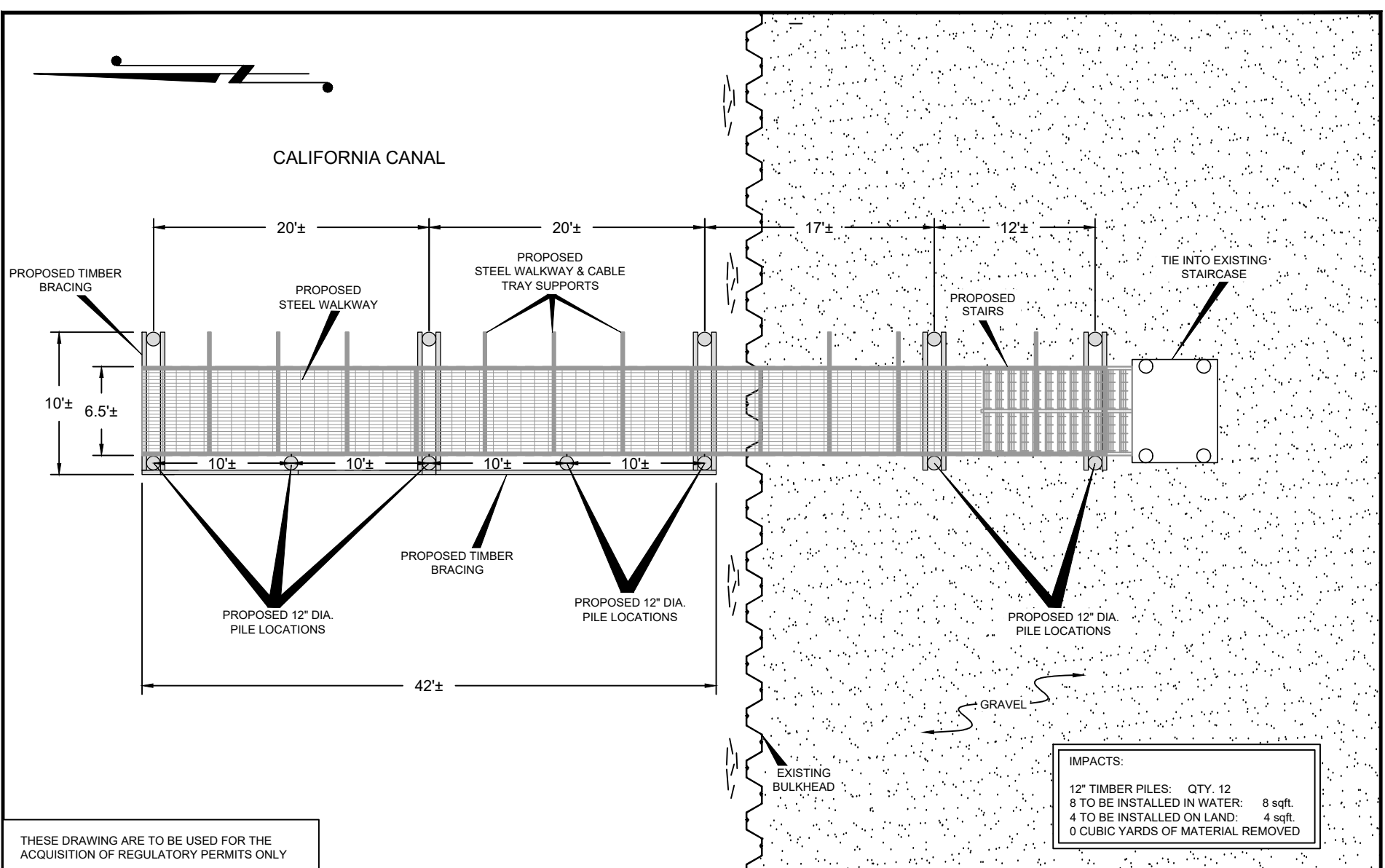

IMPACTS:
 12" TIMBER PILES: QTY. 12
 8 TO BE INSTALLED IN WATER: 8 sqft.
 4 TO BE INSTALLED ON LAND: 4 sqft.
 0 CUBIC YARDS OF MATERIAL REMOVED

THESE DRAWING ARE TO BE USED FOR THE ACQUISITION OF REGULATORY PERMITS ONLY

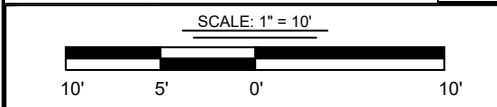

| | |
|---|-------------------|
| DRAWN BY: SJK | APPROVED BY: JMH |
| DATE: 09/13/17 | JOB NO: 2017.0812 |
| DRAWING NAME: 170812P01-02.DWG | |
| SHEET NO: 7 | OF 12 |
| PROJECTION: LA SOUTH GEO. DATUM: NAD83 VERT. DATUM: NAVD88 GRID UNITS: US SURVEY FEET | |
| REVISION DESCRIPTION: | |

TBS T. BAKER SMITH
 A CENTURY OF SOLUTIONS
 412 South Van Ave, Houma, LA 70363
 (905) 808-1000 - tbsmith.com

| | | |
|-------------|------------------|-------------|
| REV. NO: 00 | REV. DATE: --/-- | REV. BY: -- |
|-------------|------------------|-------------|

BOAT DOCK (PERSONNEL) DETAIL

CHEVRON PIPE LINE COMPANY
 PROPOSED INSTALLATION OF
 A PERSONNEL DOCK & EQUIPMENT DOCK
 FOURCHON TERMINAL
 SECTION 24, T23S-R22E
 LAFORCHE PARISH, LOUISIANA

PROPOSED DOCK INSTALLATION LOOKING EAST

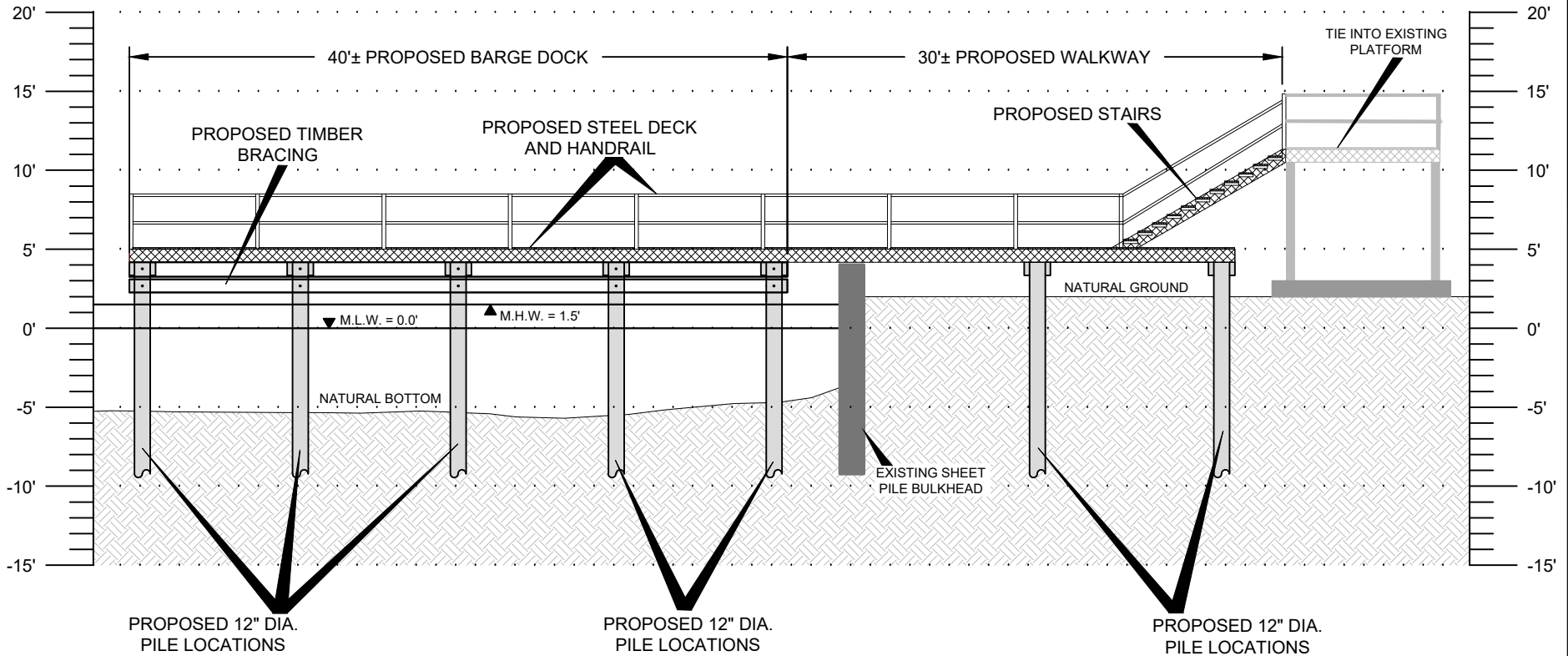

THESE DRAWING ARE TO BE USED FOR THE ACQUISITION OF REGULATORY PERMITS ONLY

SCALE: 1" = 10'

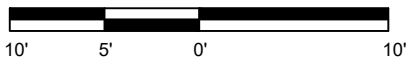

DRAWN BY: SJK APPROVED BY: JMH

DATE: 09/13/17 JOB NO: 2017.0812

DRAWING NAME: 170812P01-02.DWG

SHEET NO: 8 OF 12

PROJECTION: LA SOUTH
GEO. DATUM: NAD83 | VERT. DATUM: NAVD88
GRID UNITS: US SURVEY FEET

REVISION DESCRIPTION:

BOAT DOCK (PERSONNEL) PROFILE

CHEVRON PIPE LINE COMPANY
PROPOSED INSTALLATION OF
A PERSONNEL DOCK & EQUIPMENT DOCK
FOURCHON TERMINAL
SECTION 24, T23S-R22E
LAFOURCHE PARISH, LOUISIANA

REV. NO: 00 REV. DATE: --/-- REV. BY: ---



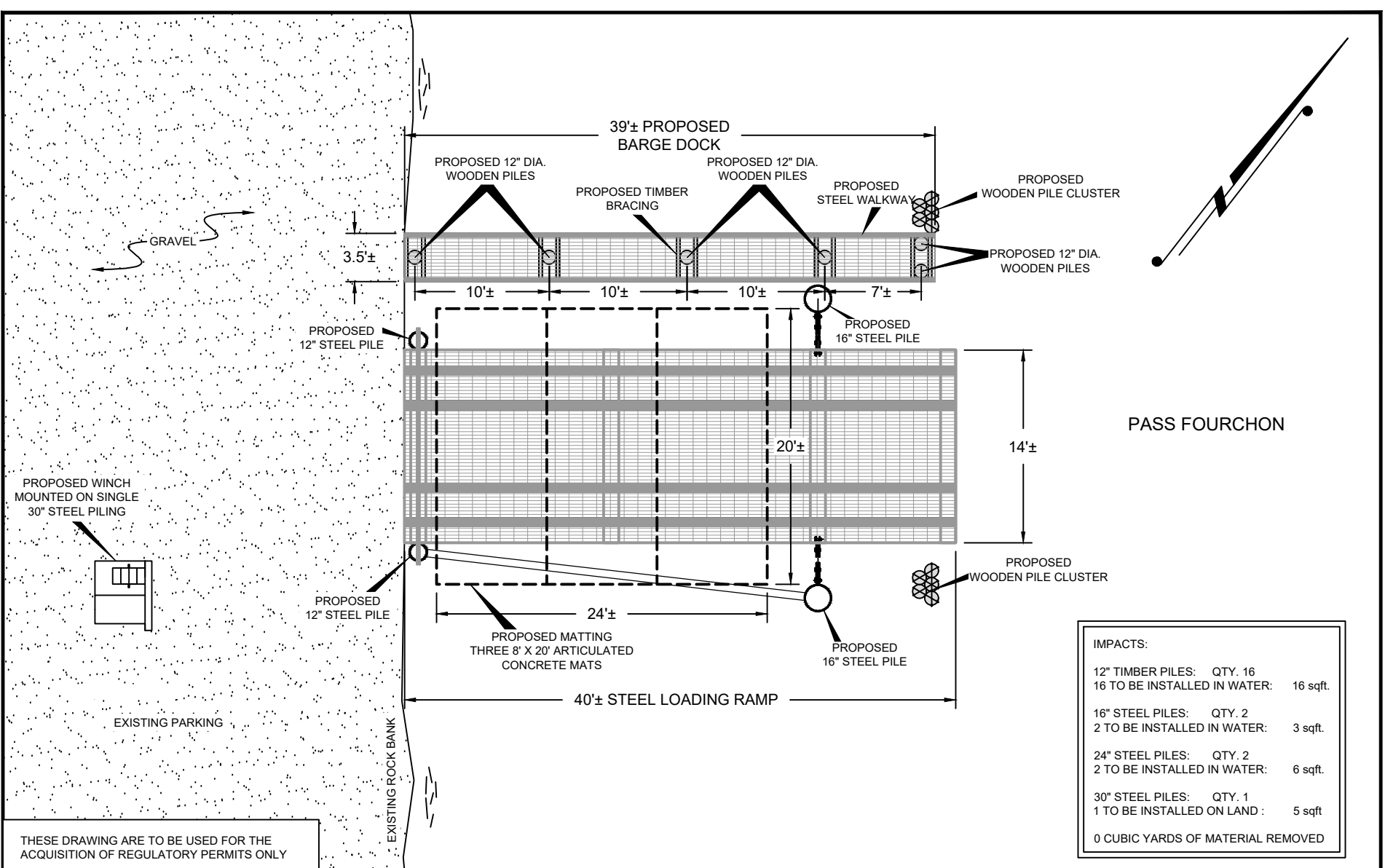

| IMPACTS: | |
|-----------------------------------|----------|
| 12" TIMBER PILES: QTY. 16 | |
| 16 TO BE INSTALLED IN WATER: | 16 sqft. |
| 16" STEEL PILES: QTY. 2 | |
| 2 TO BE INSTALLED IN WATER: | 3 sqft. |
| 24" STEEL PILES: QTY. 2 | |
| 2 TO BE INSTALLED IN WATER: | 6 sqft. |
| 30" STEEL PILES: QTY. 1 | |
| 1 TO BE INSTALLED ON LAND: | 5 sqft. |
| 0 CUBIC YARDS OF MATERIAL REMOVED | |

THESE DRAWING ARE TO BE USED FOR THE ACQUISITION OF REGULATORY PERMITS ONLY

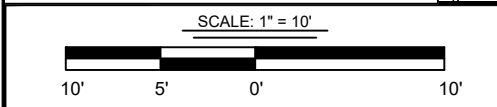

| | |
|---|-------------------|
| DRAWN BY: SJK | APPROVED BY: JMH |
| DATE: 09/13/17 | JOB NO: 2017.0812 |
| DRAWING NAME: 170812P01-02.DWG | |
| SHEET NO: 9 | OF 12 |
| PROJECTION: LA SOUTH GEO. DATUM: NAD83 VERT. DATUM: NAVD88 GRID UNITS: US SURVEY FEET | |
| REVISION DESCRIPTION: | |

TBS T. BAKER SMITH
 A CENTURY OF SOLUTIONS
 412 South Van Ave, Houma, LA 70363
 (855) 828-1656 - tbsmith.com

| | | |
|-------------|------------------|-------------|
| REV. NO: 00 | REV. DATE: --/-- | REV. BY: -- |
|-------------|------------------|-------------|

EQUIPMENT DOCK/RAMP DETAIL
CHEVRON PIPE LINE COMPANY
 PROPOSED INSTALLATION OF
 A PERSONNEL DOCK & EQUIPMENT DOCK
 FOURCHON TERMINAL
 SECTION 24, T23S-R22E
 LAFORCHE PARISH, LOUISIANA

PROPOSED DOCK INSTALLATION LOOKING NORTHWEST

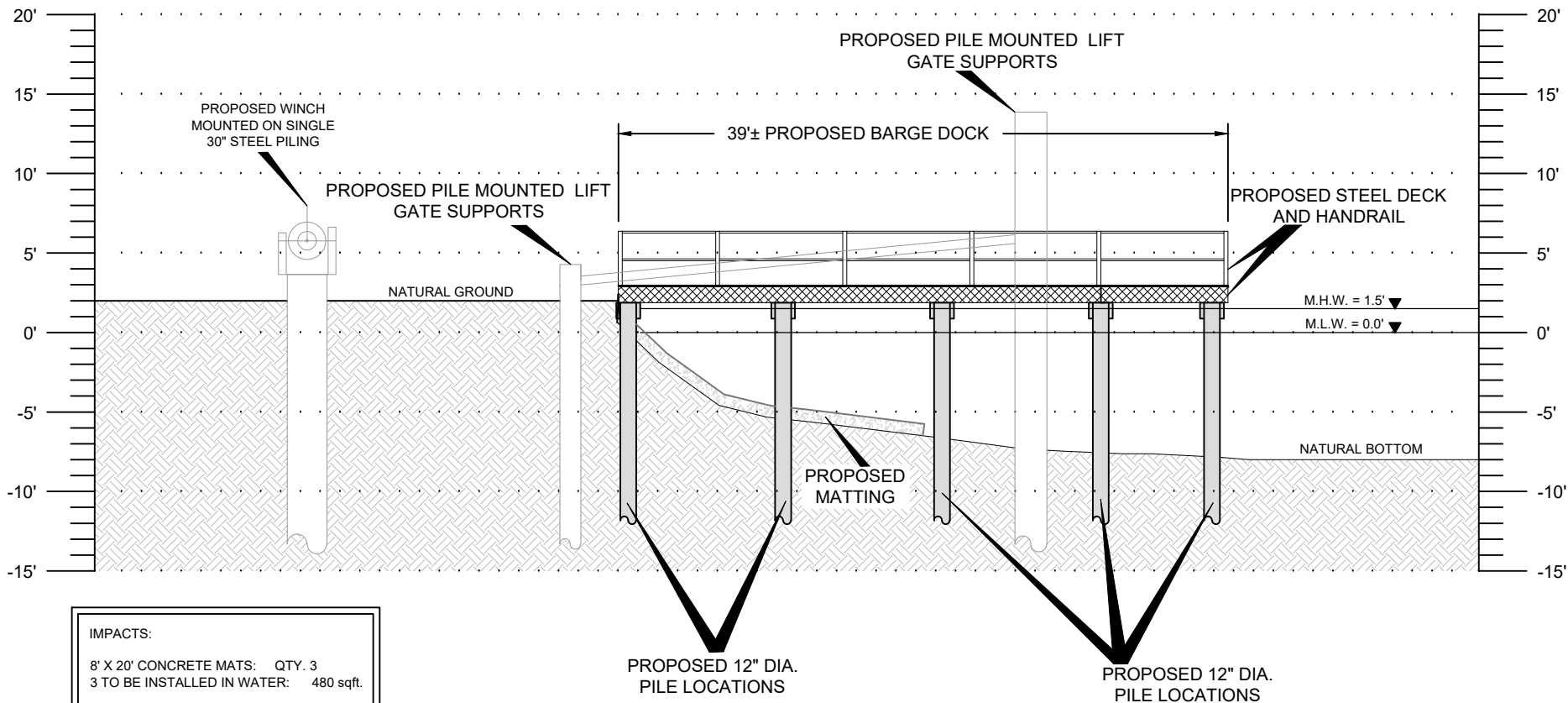

IMPACTS:
 8' X 20' CONCRETE MATS: QTY. 3
 3 TO BE INSTALLED IN WATER: 480 sqft.
 0 CUBIC YARDS OF MATERIAL REMOVED

THESE DRAWING ARE TO BE USED FOR THE ACQUISITION OF REGULATORY PERMITS ONLY

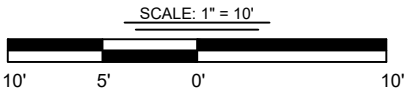

TBS T. BAKER SMITH
 A CENTURY OF SOLUTIONS
 412 South Van Ave, Houma, LA 70363
 (905) 828-1696 - tbsmith.com

| | | | |
|-----------------------|-----------------------------|--------------|-----------|
| DRAWN BY: | SJK | APPROVED BY: | JMH |
| DATE: | 09/13/17 | JOB NO.: | 2017.0812 |
| DRAWING NAME: | 170812P01-02.DWG | | |
| SHEET NO.: | 10 | OF | 12 |
| PROJECTION: | LA SOUTH | | |
| GEO. DATUM: | NAD83 VERT. DATUM: NAVD88 | | |
| GRID UNITS: | US SURVEY FEET | | |
| REVISION DESCRIPTION: | --- | | |

| | | | | | |
|-----------|----|------------|-------|----------|-----|
| REV. NO.: | 00 | REV. DATE: | --/-- | REV. BY: | --- |
|-----------|----|------------|-------|----------|-----|

EQUIPMENT DOCK/RAMP PROFILE

CHEVRON PIPE LINE COMPANY
 PROPOSED INSTALLATION OF
 A PERSONNEL DOCK & EQUIPMENT DOCK
 FOURCHON TERMINAL
 SECTION 24, T23S-R22E
 LAFORCHE PARISH, LOUISIANA

**PROPOSED MAT INSTALLATION
OBLIQUE VIEW**

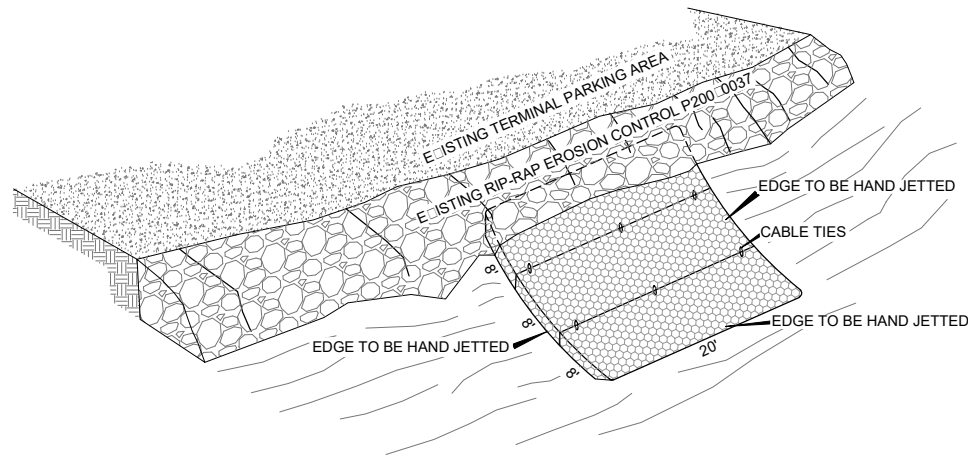

**PROPOSED MAT INSTALLATION
LOOKING NORTHWEST**

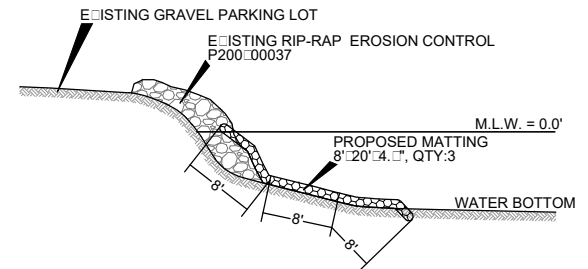

EXISTING RIP-RAP WILL BE REGRADED TO ALLOW FOR MAT PLACEMENT WITH EDGES EMBEDDED IN THE BOTTOM 1.0'. EDGE BURIAL WILL TAKE PLACE BY HAND JETTING.

8'x20' MATS, QTY: 3
 8' LINEAR FEET OF MAT EDGES TO BE JETTED
 8' OF MATS x 1/2' WIDE x 1' BURIAL DEPTH = 34 CUBIC FT. = 1.2 CU. YDS. OF JETTING
 8' OF MATS x 1/2' WIDE = 34 SQFT. = 0.0007 ACRES OF JETTING

TYPICAL MAT IDENTIFICATION TAG

CHEVRON PIPE LINE COMPANY
 100 NORTH PARK BLVD
 COVINGTON, LA 70433
 CUP P20170913
 MAT NO. 1 OF 3

THESE DRAWING ARE TO BE USED FOR THE ACQUISITION OF REGULATORY PERMITS ONLY

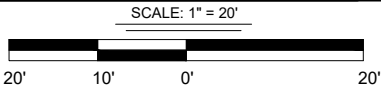

DRAWN BY: SJK APPROVED BY: JMH
 DATE: 09/13/17 JOB NO: 2017.0812
 DRAWING NAME: 170812P01-02.DWG

SHEET NO: 11 OF 12

PROJECTION: LA SOUTH
 GEO. DATUM: NAD83 | VERT. DATUM: NAVD88
 GRID UNITS: US SURVEY FEET

REVISION DESCRIPTION:
 --

| | | |
|-------------|------------------|-------------|
| REV. NO: 00 | REV. DATE: --/-- | REV. BY: -- |
|-------------|------------------|-------------|

MATTIN DETAIL
CHEVRON PIPE LINE COMPANY
 PROPOSED INSTALLATION OF
 A PERSONNEL DOCK & EQUIPMENT DOCK
 FOURCHON TERMINAL
 SECTION 24, T23S-R22E
 LAFOURCHE PARISH, LOUISIANA

TYPICAL SHALLOW DRAFT TUG, BARGE, AND CRANE
NOT TO SCALE

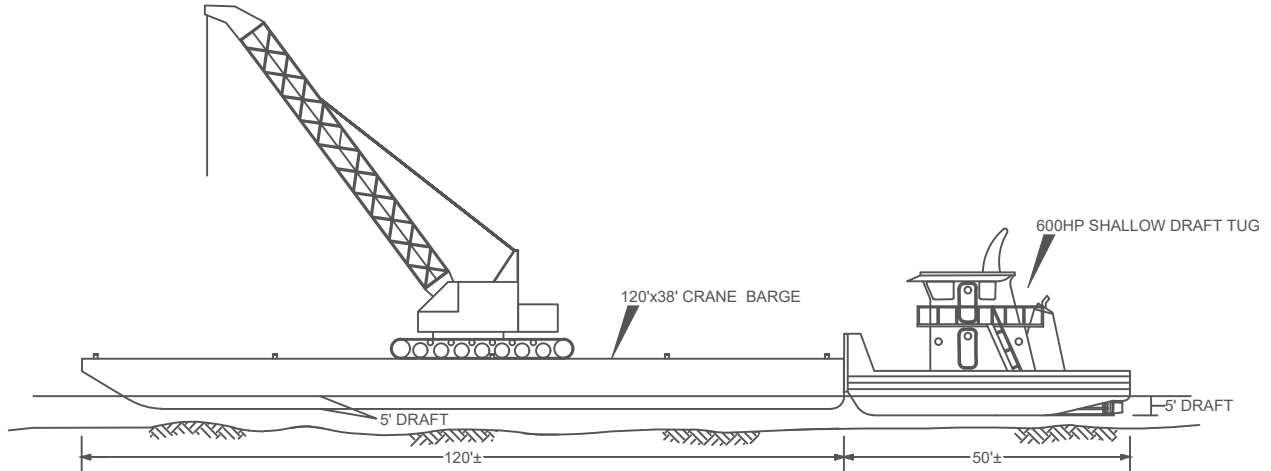

EQUIPMENT LIST:

- 600 HP TUG 50' X 18' X 5' DRAFT
- 38' X 120' X 5' DRAFT CRANE/QUARTERS BARGE
- 30' X 130' X 3'-5' DRAFT DECK BARGE
- ALUMINUM WORK SKIFF

CALCULATIONS:

- APPROXIMATELY 9 SQUARE FEET OF THE FOURCHON TERMINAL GROUNDS MAY BE AFFECTED BY PILINGS USED IN THE PROPOSED DOCK CONSTRUCTION
- APPROXIMATELY 33 SQUARE FEET OF WATER BOTTOMS MAY BE AFFECTED BY PILINGS USED IN THE PROPOSED DOCK CONSTRUCTION.
- APPROXIMATELY 480 SQ FT (0.01 ACRES) MAY BE AFFECTED BY THE PLACEMENT OF 4.5" ARTICULATED CONCRETE MATTING FOR EROSION CONTROL (6.67 CUBIC YARDS).
- APPROXIMATELY 34 SQFT. (0.0007 ACRES) MAY BE AFFECTED BY HAND JETTING
- APPROXIMATELY 1.26 CU. YDS. OF NATIVE MATERIAL MAY BE DISPLACED BY HAND JETTING
- NO DREDGING OR WHEEL WASHING IS ANTICIPATED

NOTES:

- AS-BUILT DRAWINGS AND/OR PLATS SHALL HAVE WRITTEN ON THEM THE DATE OF COMPLETION OF SAID ACTIVITIES AND SHALL BE SUBMITTED TO THE LOUISIANA DEPARTMENT OF NATURAL RESOURCES, OFFICE OF COASTAL MANAGEMENT, P. O. BOX 44487, BATON ROUGE, LA 70804-4487 WITHIN 30 DAYS FOLLOWING PROJECT COMPLETION.
- ALL STRUCTURES BUILT UNDER THE AUTHORIZATION AND CONDITIONS OF THIS PERMIT SHALL BE REMOVED FROM THE SITE WITHIN 120 DAYS OF ABANDONMENT OF THE FACILITIES FOR THE HEREIN PERMITTED USE, OR WHEN THESE STRUCTURES FALL INTO A STATE OF DISREPAIR SUCH THAT THEY CAN NO LONGER FUNCTION AS INTENDED. THIS CONDITION DOES NOT PRECLUDE THE NECESSITY FOR REVISING THE CURRENT PERMIT OR OBTAINING A SEPARATE COASTAL USE PERMIT, SHOULD ONE BE REQUIRED, FOR SUCH REMOVAL ACTIVITIES.
- STRUCTURES MUST ALSO BE MARKED/LIGHTED IN ACCORDANCE WITH U. S. COAST GUARD REGULATIONS.
- IN ORDER TO ENSURE THE SAFETY OF ALL PARTIES, THE PERMITEE SHALL CONTACT THE LOUISIANA ONE CALL SYSTEM (1-800-272-3020) A MINIMUM OF 48 HOURS PRIOR TO THE COMMENCEMENT OF ANY EXCAVATION (DIGGING, DREDGING, JETTING, ETC.) OR DEMOLITION ACTIVITY.

| | |
|---|-------------------|
| THESE DRAWING ARE TO BE USED FOR THE ACQUISITION OF REGULATORY PERMITS ONLY | |
| DRAWN BY: SJK | APPROVED BY: JMH |
| DATE: 09/13/17 | JOB NO: 2017.0812 |
| DRAWING NAME: 170812P01-02.DWG | |
| SHEET NO: 12 OF 12 | |
| PROJECTION: LA SOUTH GEO. DATUM: NAD83 VERT. DATUM: NAVD88 GRID UNITS: US SURVEY FEET | |

| | | |
|-----------------------------------|------------------|--------------|
| EQUIPMENT/NOTES | | |
| CHEVRON PIPE LINE COMPANY | | |
| PROPOSED INSTALLATION OF | | |
| A PERSONNEL DOCK & EQUIPMENT DOCK | | |
| FOURCHON TERMINAL | | |
| SECTION 24, T23S-R22E | | |
| LAFORCHE PARISH, LOUISIANA | | |
| REV. NO: 00 | REV. DATE: --/-- | REV. BY: --- |
| REVISION DESCRIPTION: -- | | |

T. BAKER SMITH
A CENTURY OF SOLUTIONS
412 South Van Ave, Houma, LA 70963
(905)908-1000 - tbsmith.com