

JOINT PUBLIC NOTICE

24 July 2017

United States Army Corps of Engineers
New Orleans District
Regulatory Branch
7400 Leake Avenue
New Orleans, Louisiana 70118

State of Louisiana
Department of Environmental Quality
Office of Environmental Services
Post Office Box 4313
Baton Rouge, Louisiana 70821-4313

(504) 862-1588
Project Manager
Glenn E. Dobson Jr.
glenn.e.dobson@usace.army.mil
MVN-2017-00843-CC

(225) 219-3225
Project Manager
Elizabeth Hill
WQC Application Number
WQC # 170713-03

Interested parties are hereby notified that a permit application has been received by the New Orleans District of the US Army Corps of Engineers pursuant to: [X] Section 10 of the Rivers and Harbors Act of March 3, 1899 (30 Stat. 1151; 33 USC 403); and/or [X] Section 404 of the Clean Water Act (86 Stat. 816; 33 USC 1344).

Application has also been made to the Louisiana Department of Environmental Quality, Office of Environmental Services, for a Water Quality Certification (WQC) in accordance with statutory authority contained in LRS 30:2074 A(3) and provisions of Section 401 of the Clean Water Act.

PROPOSED PUMPING STATION, ACCESS ROAD, AND TIE-IN LEVEES ALONG HANSON CANAL NEAR BAYOU BLACK IN TERREBONNE PARISH

NAME OF APPLICANT: Terrebonne Parish Consolidated Government, c/o GIS Engineering, LLC, 2503 Petroleum Drive, Suite 110, Houma, Louisiana 70363.

LOCATION OF WORK: Hanson Canal, near Bayou Black in Section 34, T17S-R16E, near Houma, Louisiana, in Terrebonne Parish, within the Terrebonne Basin in hydrologic unit (HUC 08090302), as shown on the attached drawings (Latitude 29.602094 N, Longitude -90.860436 W).

CHARACTER OF WORK: The applicant has requested Department of the Army authorization to construct and maintain a pumping station, a swing gate and tie-in levees in and adjacent to the Hanson Canal to pump the water from Bayou Black which is one of the drainage channels for Chacahoula-Gibson watershed area. The project also includes the removal of an old tainter gate along with dredging of the existing drainage canal. An access road from the east side of the pump station is also proposed in the project. Approximately 24,000 cubic yards of material will be excavated and used on site as fill. Additionally, 1,180 cubic yards of concrete, crushed stone and rock will be hauled in for the construction of the access roads and tie-in levees. It is anticipated that the proposed action will impact approximately 5.8 acres of wetlands due to the construction of the access roads and tie-in levees.

It is presumed that the applicant has designed the project to avoid and minimize direct and secondary adverse impacts to the maximum extent practicable. The alternative of selecting of Hanson Canal for the construction of a pump station is the most feasible as it is the only canal that can connect the water flowing into Bayou Black to Intracoastal Waterway which flows into the Gulf of Mexico. Also, the area between Bayou Black and Intracoastal Waterway are freshwater marshlands. Construction of a canal would lead to additional wetland impacts over a large area which would not be economically feasible. The applicant will compensate for unavoidable wetland impacts by purchasing credits from an approved mitigation bank.

The comment period for the Department of Army will close in **20 days** from the date of this joint public notice. Written comments, including suggestions for modifications or objections to the proposed work, stating reasons thereof, are being solicited from anyone having interest in this permit and/or this WQC request and must be mailed so as to be received before or by the last day of the comment period. Letters concerning the Corps of Engineers permit application must reference the applicant's name and the Permit Application Number, and be mailed to the Corps of Engineers at the address above, **ATTENTION: REGULATORY BRANCH**. Similar letters concerning the Water Quality Certification must reference the applicant's name and the WQC application number and be mailed to the Louisiana Department of Environmental Quality at the address above. Individuals or parties may request an extension of time in which to comment on the proposed work by writing or e-mailing the Corps of Engineers Project Manager listed above. Any request must be specific and substantively supportive of the requested extension, and received by this office prior to the end of the initial comment period. The Section Chief will review the request and the requestor will be promptly notified of the decision to grant or deny the request. If granted, the time extension will be continuous to the initial comment period and, inclusive of the initial comment period, will not exceed a total of 30 calendar days.

The application for this proposed project is on file with the Louisiana Department of Environmental Quality and may be examined during weekdays between 8:00 a.m. and 4:30 p.m. Copies may be obtained upon payment of costs of reproduction.

Corps of Engineers Permit Criteria

The decision whether to issue a permit will be based on an evaluation of the probable impacts, including cumulative impacts of the proposed activity on the public interest. That decision will reflect the national concern for both protection and utilization of important resources. The benefit which reasonably may be expected to accrue from the proposal must be balanced against its reasonably foreseeable detriments. All factors which may be relevant to the proposal will be considered including the cumulative effects thereof; among those are conservation, economics, aesthetics, general environmental concerns, wetlands, historic properties, fish and wildlife values, flood hazards, floodplain values, land use, navigation, shoreline erosion and accretion, recreation, water supply and conservation, water quality, energy needs, safety, food and fiber production, mineral needs, considerations of property ownership and, in general, the needs and welfare of the people.

The US Army Corps of Engineers is soliciting comments from the public, federal, state, and local agencies and officials, Indian Tribes, and other interested parties in order to consider and evaluate the impacts of this proposed activity. Any comments received will be considered by the US Army Corps of Engineers to determine whether to make, modify, condition, or deny a permit for this proposal. To make this decision, comments are used to assess impacts on endangered species, historic properties, water quality, general environmental effects, and other public interest factors listed above. Comments are used in the preparation of an Environmental Assessment and/or an Environmental Impact Statement pursuant to the National Environmental Policy Act. Comments are also used to determine the need for a public hearing and to determine the overall public interest of the proposed activity.

The New Orleans District is unaware of properties listed on the National Register of Historic Places near the proposed work. The possibility exists that the proposed work may damage or destroy presently unknown archeological, scientific, prehistorical, historical sites, or data. Copies of this notice are being sent to the State Archeologist and the State Historic Preservation Officer.

The New Orleans District has determined that the proposed project is located in waters known to be utilized by the West Indian Manatee (*Trichechus manatus*). Utilizing Standard Local Operating Procedure for Endangered Species in Louisiana (SLOPES), dated October 22, 2014, between the U.S. Army Corps of Engineers, New Orleans and U.S. Fish and Wildlife Service, Ecological Services Office, the Corps has determined that with the inclusion of the Standard Manatee Conditions for In-Water Activities, proposed work is not likely to adversely affect the West Indian Manatee.

This notice initiates the Essential Fish Habitat (EFH) consultation requirements of the Magnuson-Stevens Fishery Conservation and Management Act. The applicant's proposal would result in the destruction or alteration of 0 acres of EFH. Our initial determination is that the proposed action would not have a substantial adverse impact on EFH or federally managed fisheries in the Gulf of Mexico. Our final determination relative to project impacts and the need for mitigation measures is subject to review by and coordination with the National Marine Fisheries Service.

If the proposed work involves deposits of dredged or fill material into navigable waters, the evaluation of the probable impacts will include the application of guidelines established by the Administrator of the Environmental Protection Agency. Also, a certification that the proposed activity will not violate water quality standards will be required from the Department of Environmental Quality, Office of Environmental Services before a permit is issued.

Any person may request, in writing, within the comment period specified in this notice, that a public hearing be held to consider this application. Requests for public hearings shall state, with particularity, the reasons for holding a public hearing. You are requested to communicate the information contained in this notice to any other parties whom you deem likely to have interest in the matter.

The applicant has certified that the proposed activity described in the application complies with and will be conducted in a manner that is consistent with the Louisiana Coastal Resources Program. The Department of the Army permit will not be issued unless the applicant received approval or a waiver of the Coastal Use Permit by the Department of Natural Resources.

JOHN M. HERMAN
Chief, Central Evaluation Section
Regulatory Branch

Enclosures

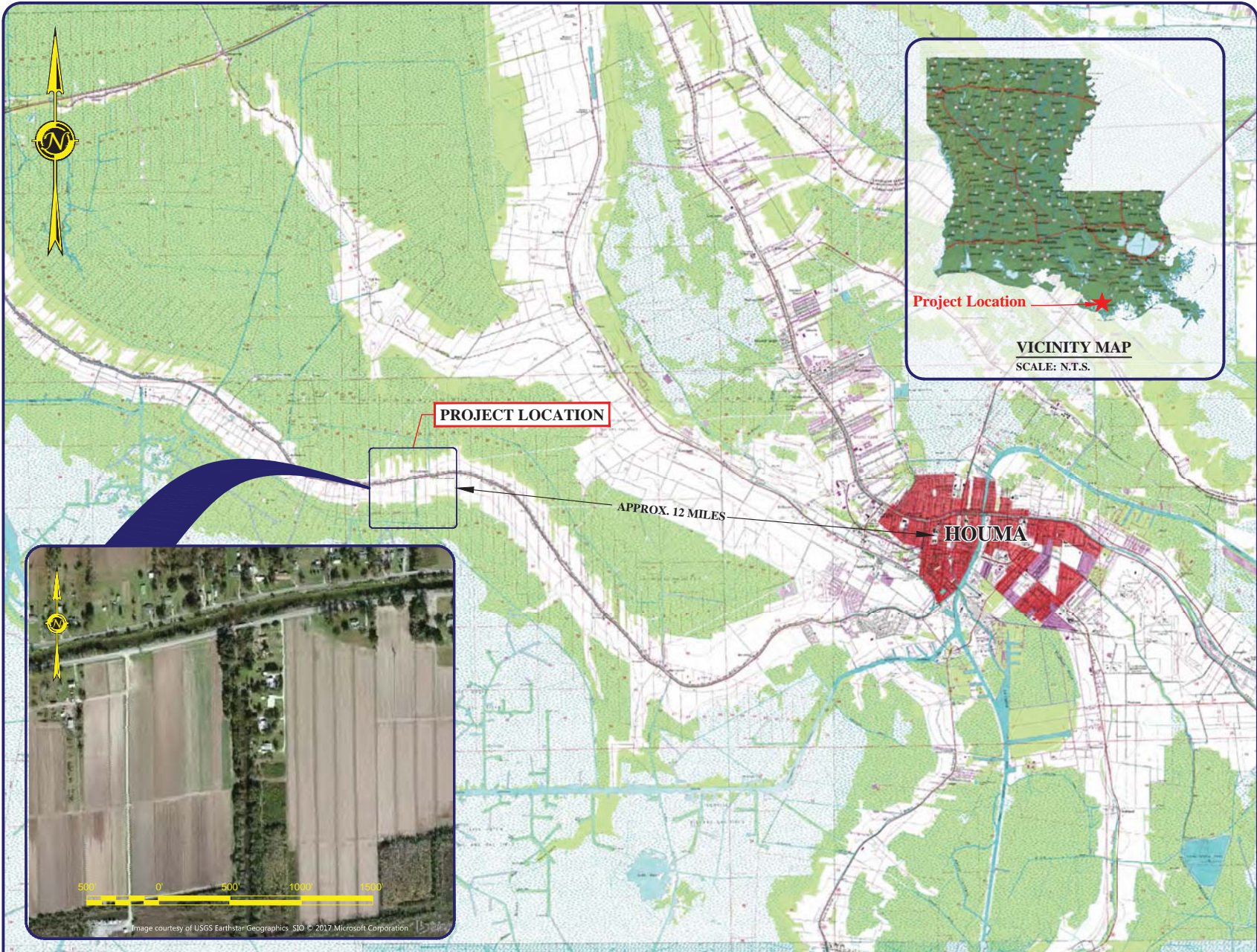

ENGINEERING LLC

Coastal Design & Infrastructure
 2503 Petroleum Dr. | Suite 110
 Houma, LA 70363
 O: (985) 219-1000 | F: (985) 475-7014

ENGINEERING • PLANNING • ENVIRONMENTAL CONSULTING

REVISIONS		
No.	Description	Date



TERREBONNE PARISH
 CONSOLIDATED GOVERNMENT
 CHACHAHOULA-GIBSON BASIN
 DRAINAGE PROJECT

VICINITY MAP

Project number	39130-1020
Date	MAY 2017
Designed by	DMM
Drawn by	MAC,JJS
Checked by	DMM
Checked by	MAC
Plot Date	June 23, 2017

NOTE: THE IMAGE ABOVE IS A GENERAL REPRESENTATION OF THE WORK AREA, ACTUAL FIELD CONDITIONS MAY DIFFER.



01



ENGINEERING LLC

Coastal Design & Infrastructure
 2503 Petroleum Dr. | Suite 110
 Houma, LA 70363
 O: (985) 219-1000 | F: (985) 475-7014

ENGINEERING • PLANNING • ENVIRONMENTAL CONSULTING

REVISIONS

No.	Description	Date

TERREBONNE PARISH
 CONSOLIDATED GOVERNMENT
 CHACHAHOULA-GIBSON BASIN
 DRAINAGE PROJECT

PROPOSED SITE PLAN

Project number	39130-1020
Date	MAY 2017
Designed by	DMM
Drawn by	MAC, JJS
Checked by	DMM
Checked by	MAC
Plot Date	June 23, 2017

02

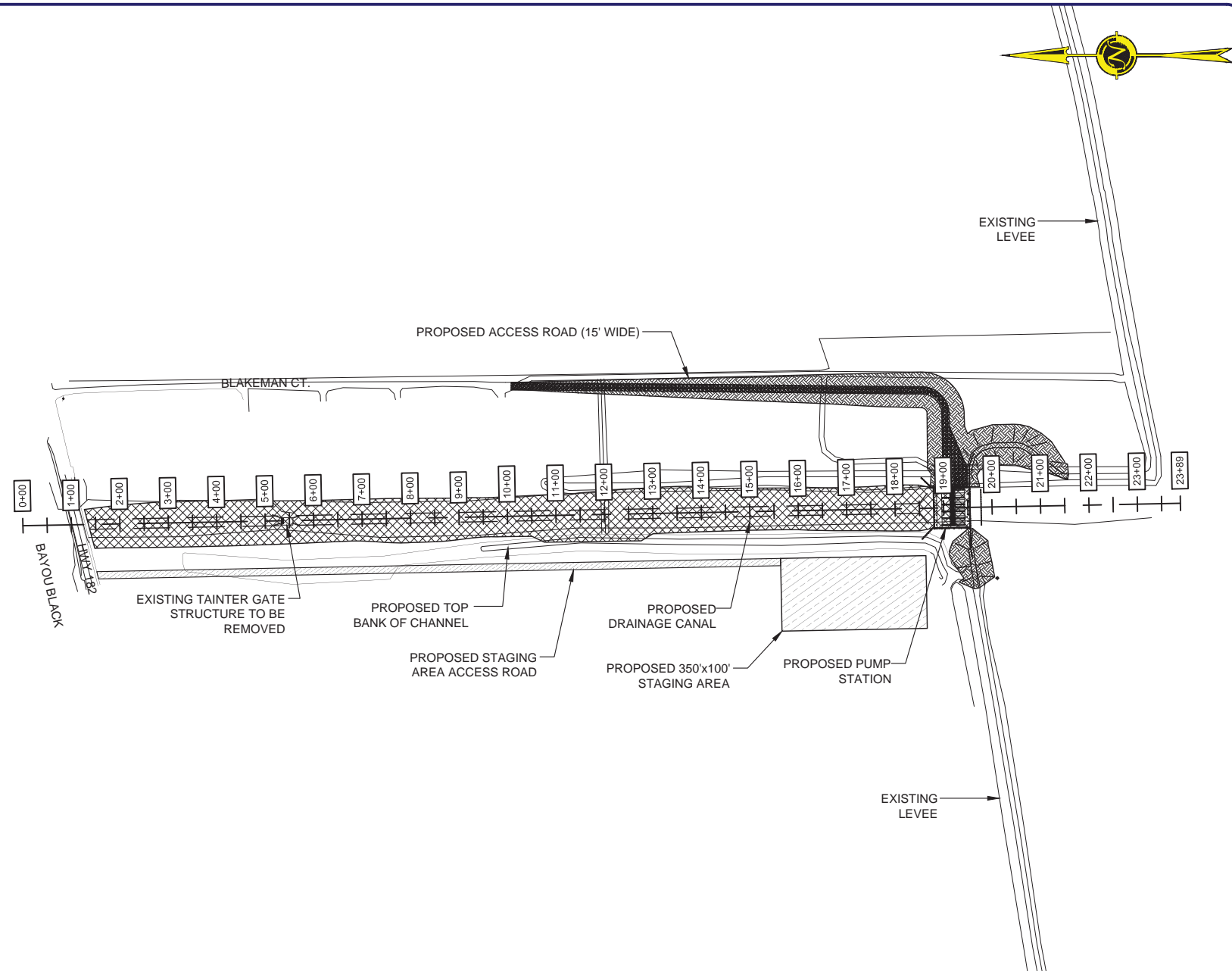

NOTE: THE IMAGE ABOVE IS A GENERAL REPRESENTATION OF THE WORK AREA, ACTUAL FIELD CONDITIONS MAY DIFFER.

- LEGEND**
- PROPOSED ACCESS ROAD (1.023')
 - DREDGING AND GRADING (4.8 ACRES)
 - LEVEE AND ACCESS ROAD EMBANKMENT (1.9 ACRES)
 - STAGING AREA







M:\Department - 39\client\1703 - Terrebonne Parish - Chachahoula-Gibson Basin Drainage Project\Drafting\CAD\DWG\1 Permit\PROPOSED SITE PLAN.dwg



NOTE: THE IMAGE ABOVE IS A GENERAL REPRESENTATION OF THE WORK AREA, ACTUAL FIELD CONDITIONS MAY DIFFER.

LEGEND

-  PROPOSED ACCESS ROAD
-  DREDGING AND GRADING
-  LEVEE AND ACCESS ROAD EMBANKMENT
-  STAGING AREA

PROPOSED SITE PLAN



Coastal Design & Infrastructure
 2503 Petroleum Dr. | Suite 110
 Houma, LA 70363
 O: (985) 219-1000 | F: (985) 475-7014
 ENGINEERING • PLANNING • ENVIRONMENTAL CONSULTING

REVISIONS		
No.	Description	Date



TERREBONNE PARISH
 CONSOLIDATED GOVERNMENT
 CHACHOULA-GIBSON BASIN
 DRAINAGE PROJECT

ENLARGED SITE PLAN

Project number	39130-1020
Date	MAY 2017
Designed by	DMM
Drawn by	MAC, JJS
Checked by	DMM
Checked by	MAC
Plot Date	June 23, 2017

03



ENGINEERING LLC

Coastal Design & Infrastructure
 2503 Petroleum Dr. | Suite 110
 Houma, LA 70363
 O: (985) 219-1000 | F: (985) 475-7014

ENGINEERING • PLANNING • ENVIRONMENTAL CONSULTING

REVISIONS

No.	Description	Date

TERREBONNE PARISH
 CONSOLIDATED GOVERNMENT
 CHACHAHOULA-GIBSON BASIN
 DRAINAGE PROJECT





ENLARGED SITE PLAN

Project number	39130-1020
Date	MAY 2017
Designed by	DMM
Drawn by	MAC, JJS
Checked by	DMM
Checked by	MAC
Plot Date	June 23, 2017

04



NOTE: THE IMAGE ABOVE IS A GENERAL REPRESENTATION OF THE WORK AREA, ACTUAL FIELD CONDITIONS MAY DIFFER.

- LEGEND**
-  PROPOSED ACCESS ROAD
 -  DREDGING AND GRADING
 -  LEVEE
 -  STAGING AREA



M:\Department_39\client\PCG - Terrebonne Parish - Chachoula-Gibson Basin Drainage Project\Drafting\CAD\DWG\1 Permit\PROPOSED SITE PLAN.dwg

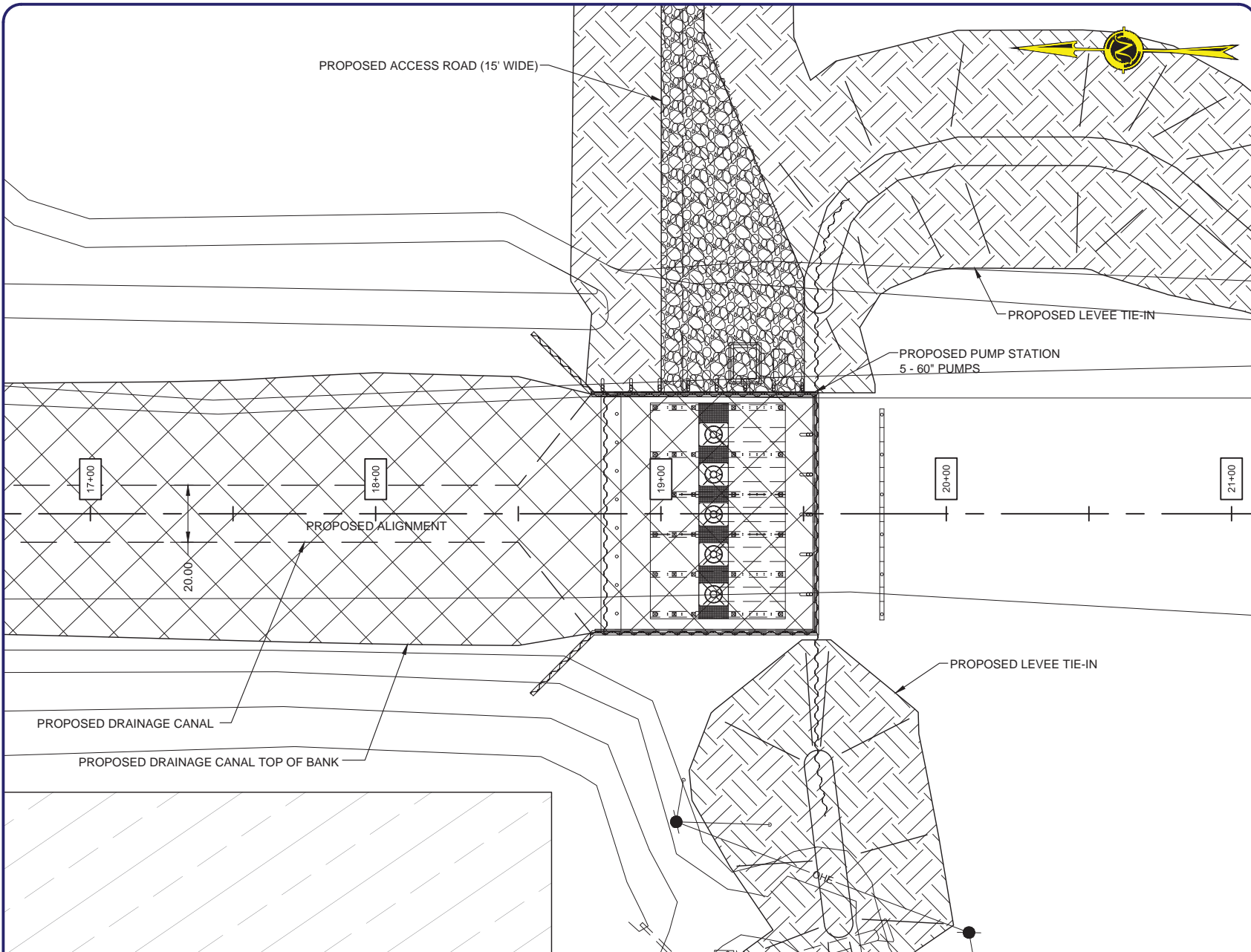

PROPOSED ACCESS ROAD (15' WIDE)

PROPOSED LEVEE TIE-IN

PROPOSED PUMP STATION
5 - 60" PUMPS

PROPOSED ALIGNMENT



PROPOSED LEVEE TIE-IN

PROPOSED DRAINAGE CANAL

PROPOSED DRAINAGE CANAL TOP OF BANK

NOTE: THE IMAGE ABOVE IS A GENERAL REPRESENTATION OF THE WORK AREA, ACTUAL FIELD CONDITIONS MAY DIFFER.

LEGEND

-  PROPOSED ACCESS ROAD
-  DREDGING AND GRADING
-  LEVEE

ENLARGED SITE PLAN



ENGINEERING LLC
 Coastal Design & Infrastructure
 2503 Petroleum Dr. | Suite 110
 Houma, LA 70363
 O: (985) 219-1000 | F: (985) 475-7014
 ENGINEERING • PLANNING • ENVIRONMENTAL CONSULTING

REVISIONS		
No.	Description	Date

PRELIMINARY
THIS DOCUMENT IS NOT TO BE USED FOR CONSTRUCTION, BIDDING, RECORDATION, CONVEYANCE, SALES OR AS THE BASIS FOR THE ISSUANCE OF A PERMIT.
 DUSTIN M. MALBROUGH
 LA LICENSE NO. 36779

TERREBONNE PARISH
 CONSOLIDATED GOVERNMENT
 CHACHAHOULA-GIBSON BASIN
 DRAINAGE PROJECT

**PUMP STATION
 SITE PLAN**

Project number	39130-1020
Date	MAY 2017
Designed by	DMM
Drawn by	MAC, JJS
Checked by	DMM
Checked by	MAC
Plot Date	June 23, 2017

M:\Department_39\client\1703 - Terrebonne Parish - Terrebonne Parish\1020-1021 Chachahoula-Gibson Basin Drainage Project\Drafting\CAD\DWG\1 Permit\PUMP STATION SITE PLAN.dwg

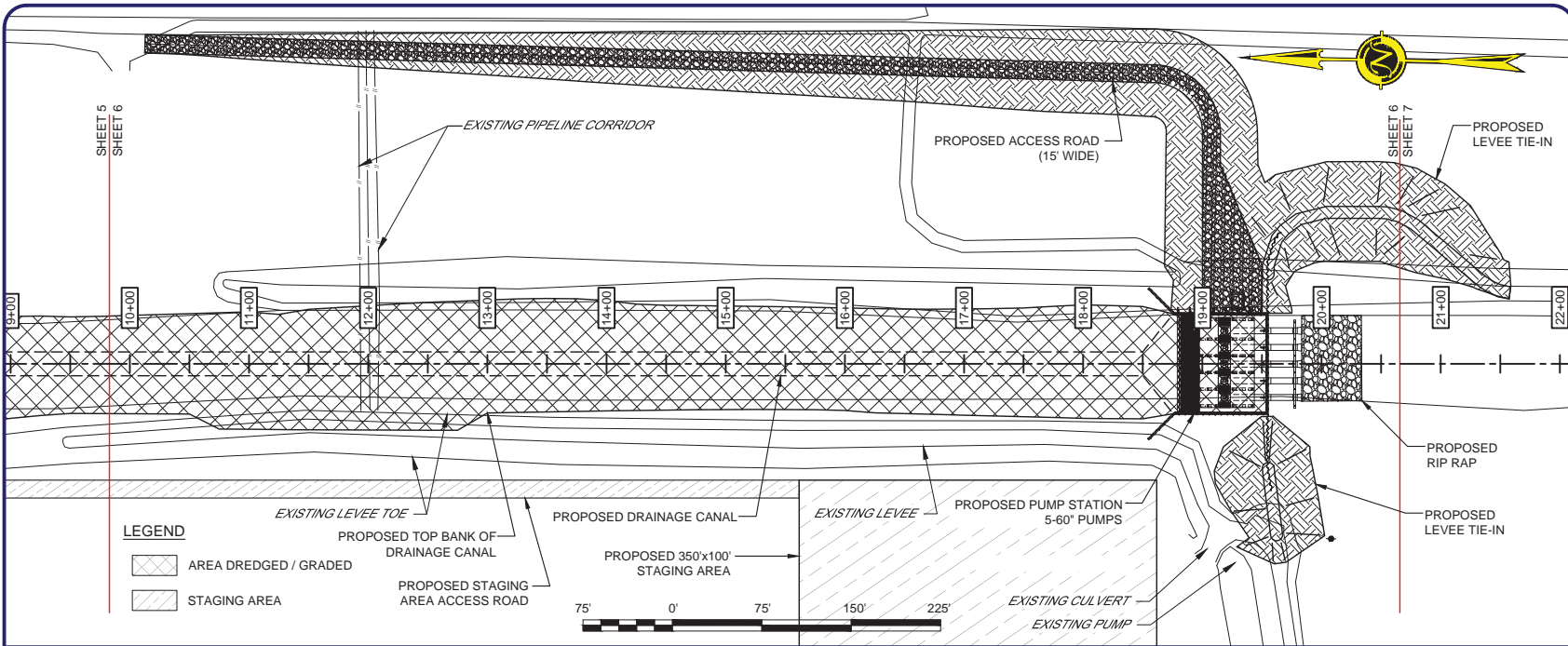

NOTE: THE IMAGE ABOVE IS A GENERAL REPRESENTATION OF THE WORK AREA, ACTUAL FIELD CONDITIONS MAY DIFFER.

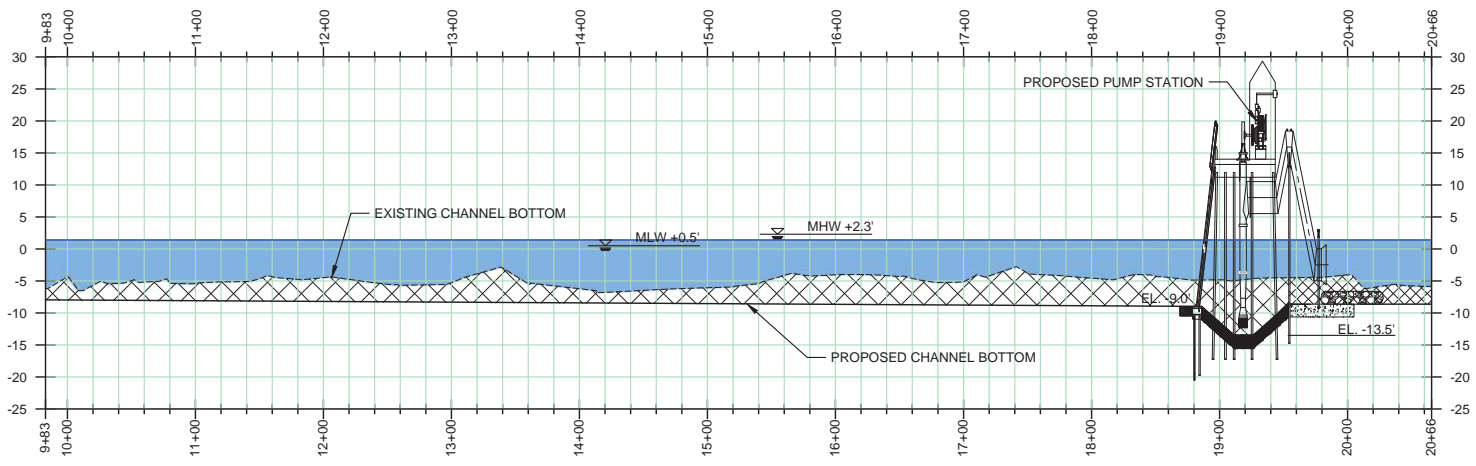

LEGEND
 MATERIAL DREDGED

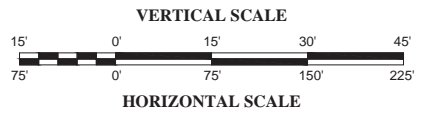

Coastal Design & Infrastructure
 2503 Petroleum Dr. | Suite 110
 Houma, LA 70363
 O: (985) 219-1000 | F: (985) 475-7014
 ENGINEERING • PLANNING • ENVIRONMENTAL CONSULTING

REVISIONS		
No.	Description	Date



TERREBONNE PARISH
 CONSOLIDATED GOVERNMENT
 CHACHAHOULA-GIBSON BASIN
 DRAINAGE PROJECT

PLAN AND PROFILE

Project number	39130-1020
Date	MAY 2017
Designed by	DMM
Drawn by	MAC,JJS
Checked by	DMM
Checked by	MAC
Plot Date	June 23, 2017

07

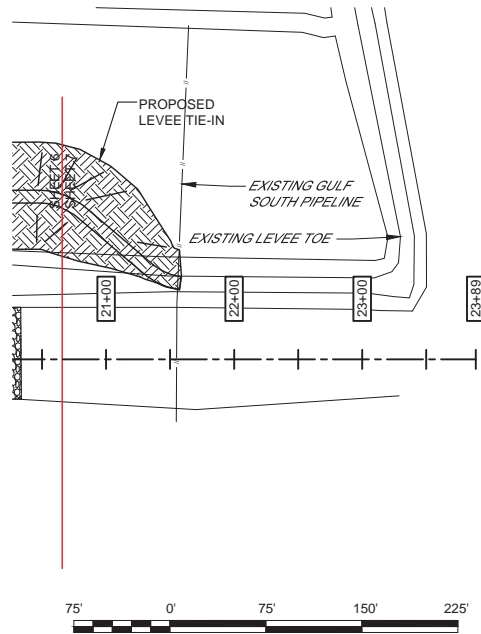

NOTE: THE IMAGE ABOVE IS A GENERAL REPRESENTATION OF THE WORK AREA, ACTUAL FIELD CONDITIONS MAY DIFFER.

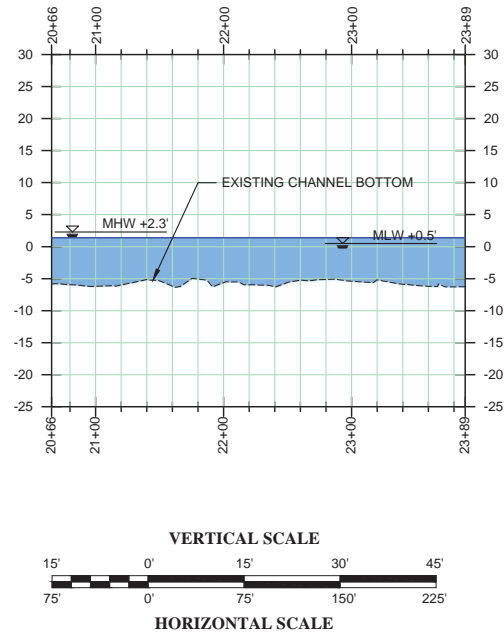

Coastal Design & Infrastructure
 2503 Petroleum Dr. | Suite 110
 Houma, LA 70363
 O: (985) 219-1000 | F: (985) 475-7014
 ENGINEERING • PLANNING • ENVIRONMENTAL CONSULTING

REVISIONS		
No.	Description	Date



TERREBONNE PARISH
 CONSOLIDATED GOVERNMENT
 CHACHOULA-GIBSON BASIN
 DRAINAGE PROJECT

PLAN AND PROFILE

Project number	39130-1020
Date	MAY 2017
Designed by	DMM
Drawn by	MAC,JJS
Checked by	DMM
Checked by	MAC
Plot Date	June 23, 2017

08

M:\Department_39\Client\PCG - Terrebonne Parish - Terrebonne Parish - Chachoula-Gibson Basin Drainage Project\Drafting\CAD\DWG\1 Permits\PLAN AND PROFILE.dwg



ENGINEERING LLC

Coastal Design & Infrastructure
2503 Petroleum Dr. | Suite 110
Houma, LA 70363
O: (985) 219-1000 | F: (985) 475-7014
ENGINEERING • PLANNING • ENVIRONMENTAL CONSULTING

REVISIONS

No.	Description	Date

TERREBONNE PARISH
CONSOLIDATED GOVERNMENT
CHACHAHOULA-GIBSON BASIN
DRAINAGE PROJECT

CROSS SECTIONS

Project number	39130-1020
Date	MAY 2017
Designed by	DMM
Drawn by	MAC,JJS
Checked by	DMM
Checked by	MAC
Plot Date	June 23, 2017

09

1+00.00

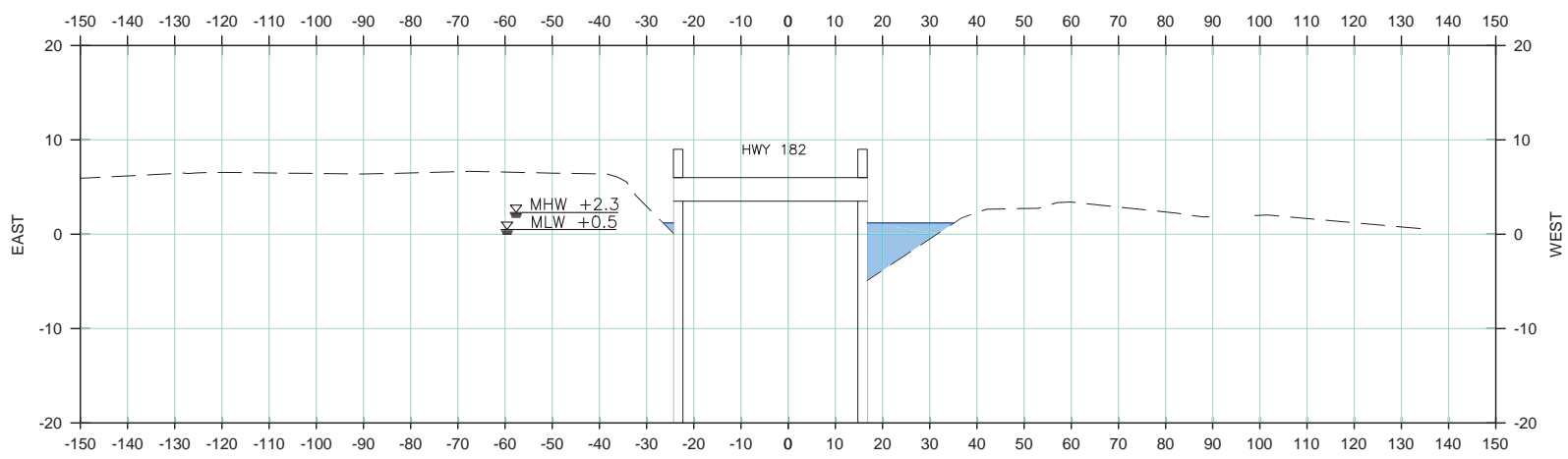

0+00.00

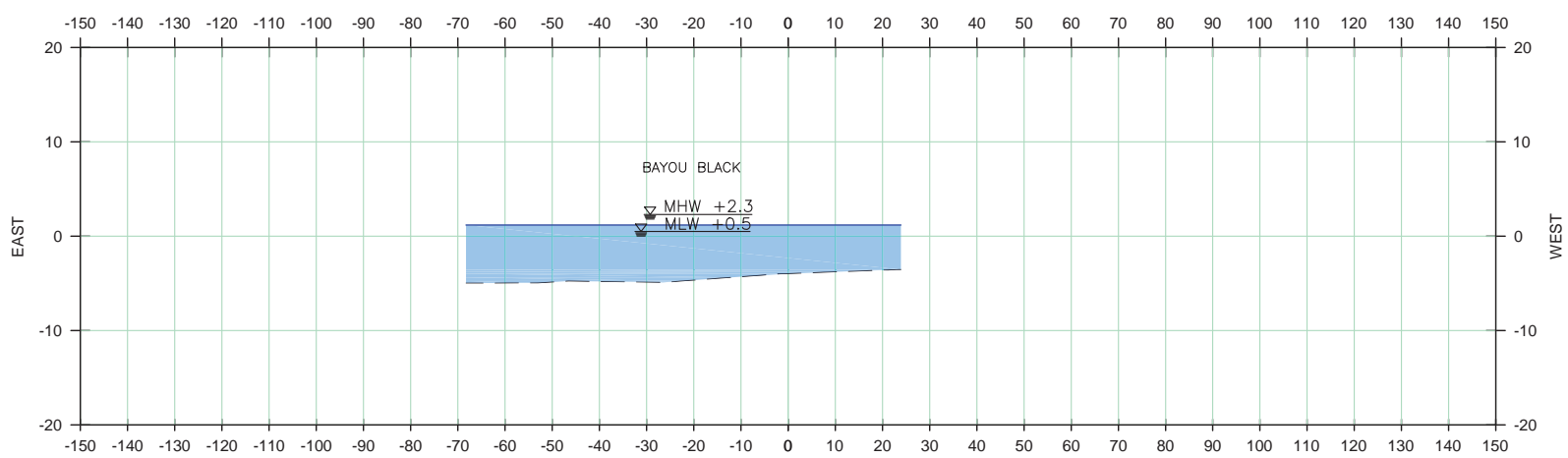

- LEGEND**
- - - - - EXISTING GROUND
 - WATER
 - AREA DREGED

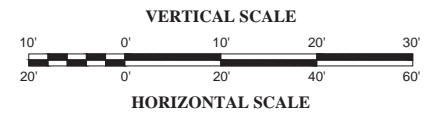

M:\Department_39\Client\PCG - Terrebonne Parish - Chachoula-Gibson Basin Drainage Project\Drafting\CAD\DWG\1 Permitt\CROSS SECTIONS.dwg



ENGINEERING LLC

Coastal Design & Infrastructure
 2503 Petroleum Dr. | Suite 110
 Houma, LA 70363
 O: (985) 219-1000 | F: (985) 475-7014

ENGINEERING • PLANNING • ENVIRONMENTAL CONSULTING

REVISIONS

No.	Description	Date

TERREBONNE PARISH
 CONSOLIDATED GOVERNMENT
 CHACHAHOULA-GIBSON BASIN
 DRAINAGE PROJECT

CROSS SECTIONS

Project number	39130-1020
Date	MAY 2017
Designed by	DMM
Drawn by	MAC,JJS
Checked by	DMM
Checked by	MAC
Plot Date	June 23, 2017

10

3+00.00

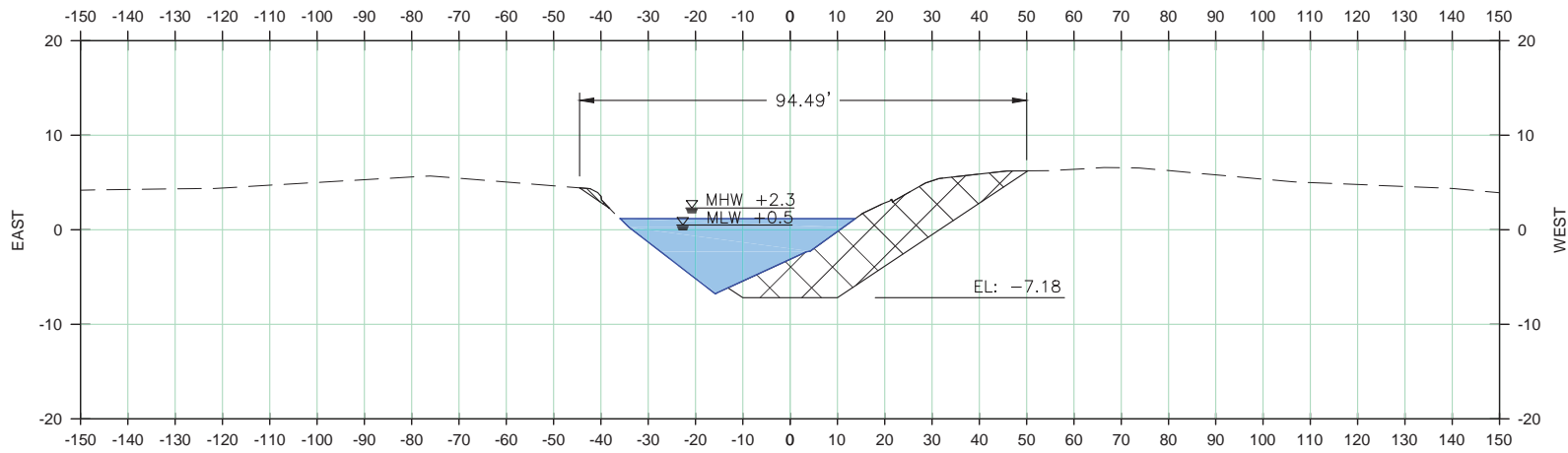

2+00.00

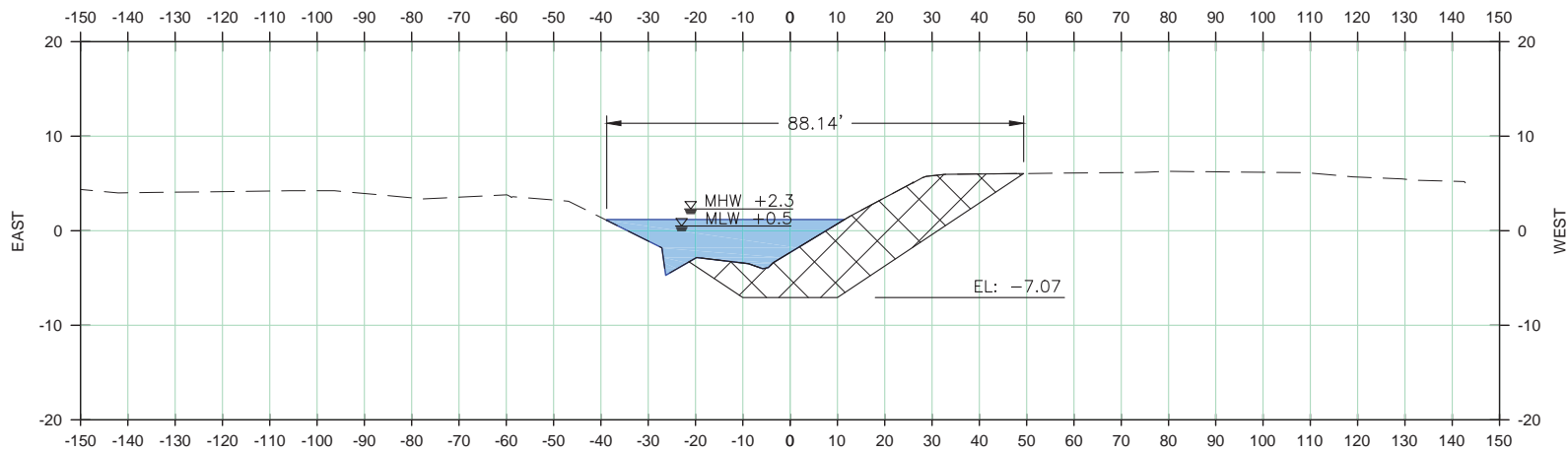

LEGEND

- - EXISTING GROUND
- - WATER
- ▨ - AREA DREDGED

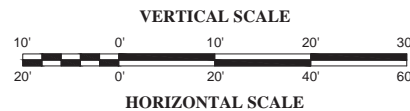

M:\Department_39\Client\PCG - Terrebonne Parish - Chachoula-Gibson Basin Drainage Project\Drafting\CAD\DWG\1 Permit\CROSS SECTIONS.dwg



ENGINEERING LLC

Coastal Design & Infrastructure
 2503 Petroleum Dr. | Suite 110
 Houma, LA 70363
 O: (985) 219-1000 | F: (985) 475-7014

ENGINEERING • PLANNING • ENVIRONMENTAL CONSULTING

REVISIONS

No.	Description	Date

**TERREBONNE PARISH
 CONSOLIDATED GOVERNMENT
 CHACHAHOULA-GIBSON BASIN
 DRAINAGE PROJECT**

CROSS SECTIONS

Project number	39130-1020
Date	MAY 2017
Designed by	DMM
Drawn by	MAC,JJS
Checked by	DMM
Checked by	MAC
Plot Date	June 23, 2017

5+00.00

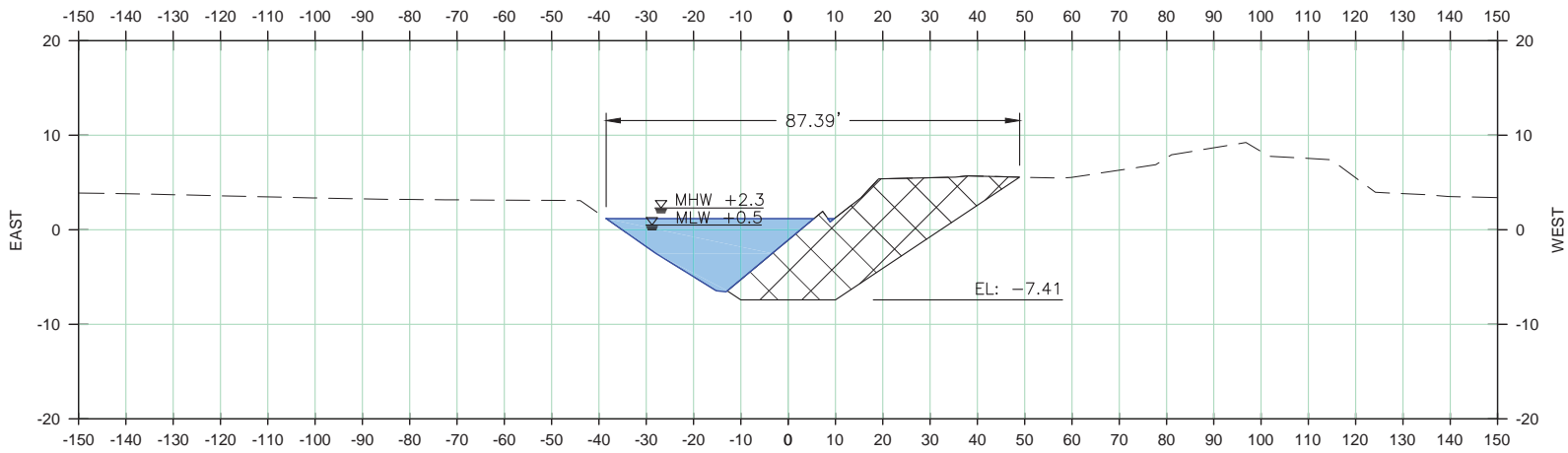

4+00.00

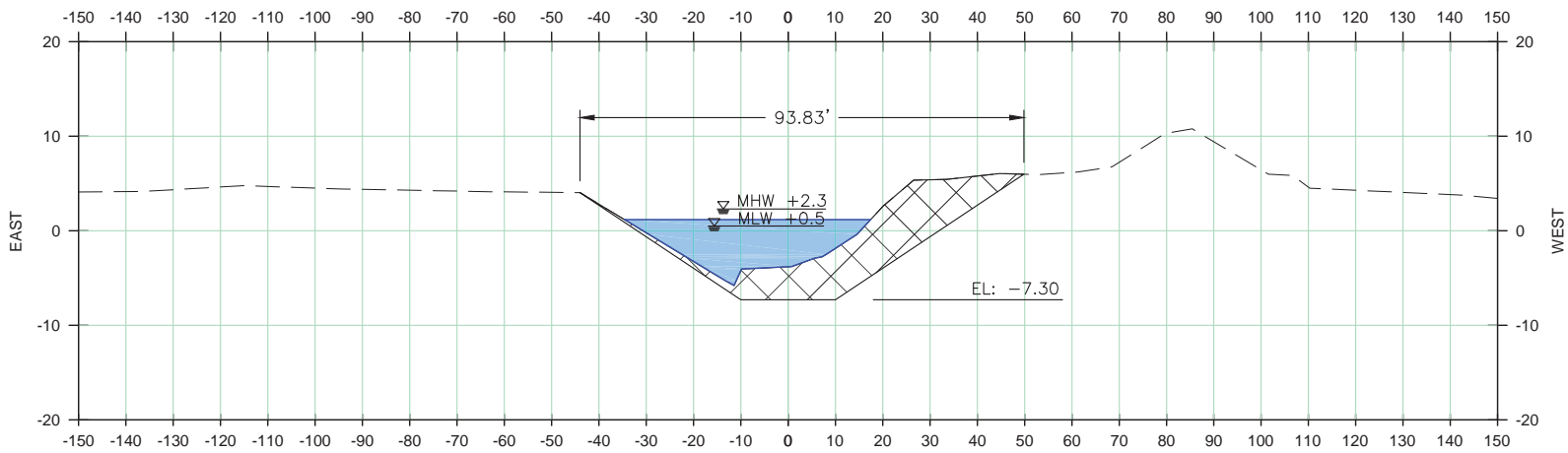

LEGEND

- - EXISTING GROUND
- - WATER
- ▩ - AREA DREDGED

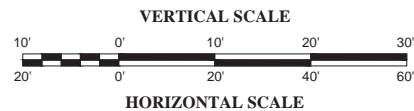



ENGINEERING LLC

Coastal Design & Infrastructure
 2503 Petroleum Dr. | Suite 110
 Houma, LA 70363
 O: (985) 219-1000 | F: (985) 475-7014

ENGINEERING • PLANNING • ENVIRONMENTAL CONSULTING

REVISIONS

No.	Description	Date

TERREBONNE PARISH
 CONSOLIDATED GOVERNMENT
 CHACHAHOULA-GIBSON BASIN
 DRAINAGE PROJECT

CROSS SECTIONS

Project number	39130-1020
Date	MAY 2017
Designed by	DMM
Drawn by	MAC,JJS
Checked by	DMM
Checked by	MAC
Plot Date	June 23, 2017

7+00.00

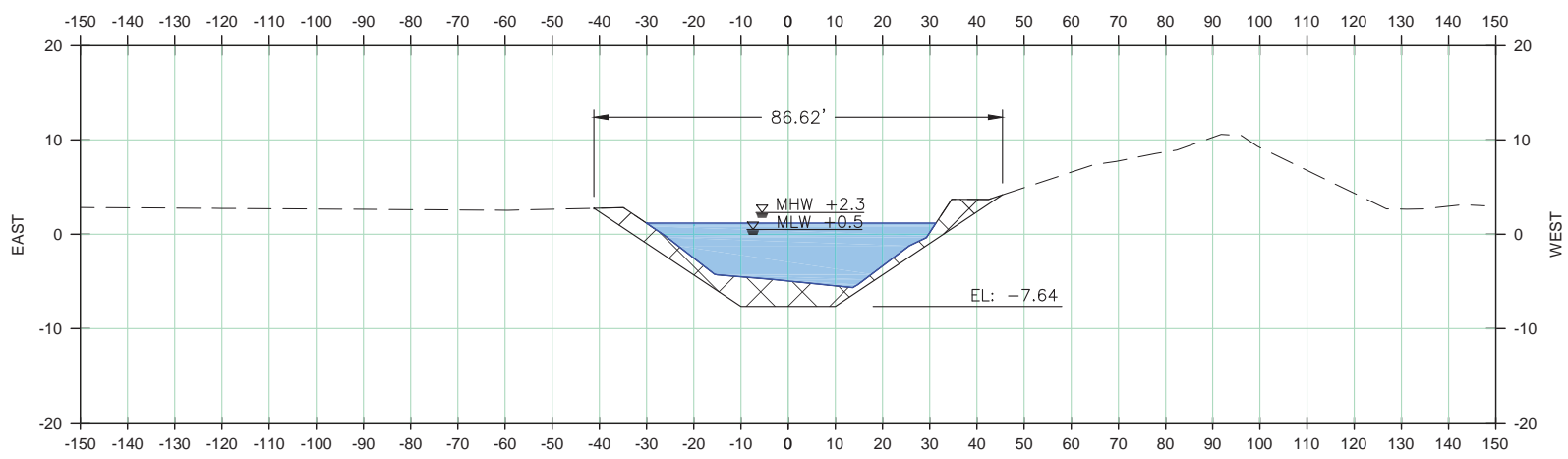

6+00.00

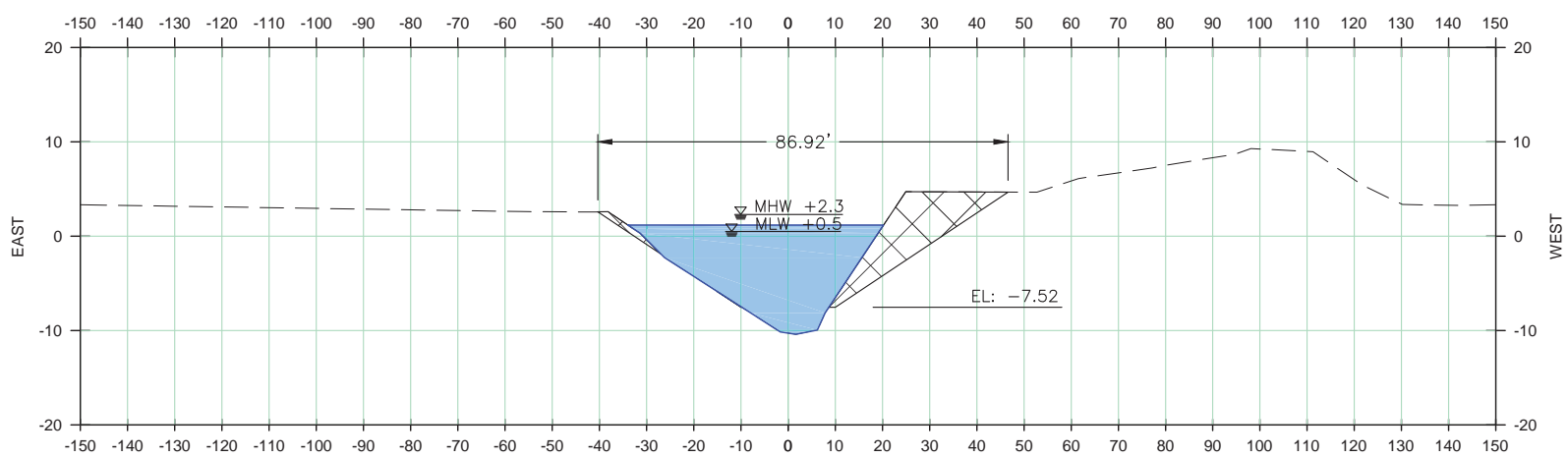

LEGEND

- - EXISTING GROUND
- WATER
- AREA DREDGED

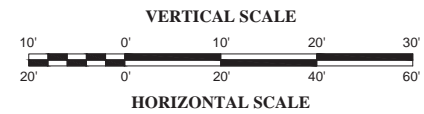



ENGINEERING LLC

Coastal Design & Infrastructure
 2503 Petroleum Dr. | Suite 110
 Houma, LA 70363
 O: (985) 219-1000 | F: (985) 475-7014

ENGINEERING • PLANNING • ENVIRONMENTAL CONSULTING

REVISIONS

No.	Description	Date

TERREBONNE PARISH
 CONSOLIDATED GOVERNMENT
 CHACHAHOULA-GIBSON BASIN
 DRAINAGE PROJECT

CROSS SECTIONS

Project number	39130-1020
Date	MAY 2017
Designed by	DMM
Drawn by	MAC,JJS
Checked by	DMM
Checked by	MAC
Plot Date	June 23, 2017

9+00.00

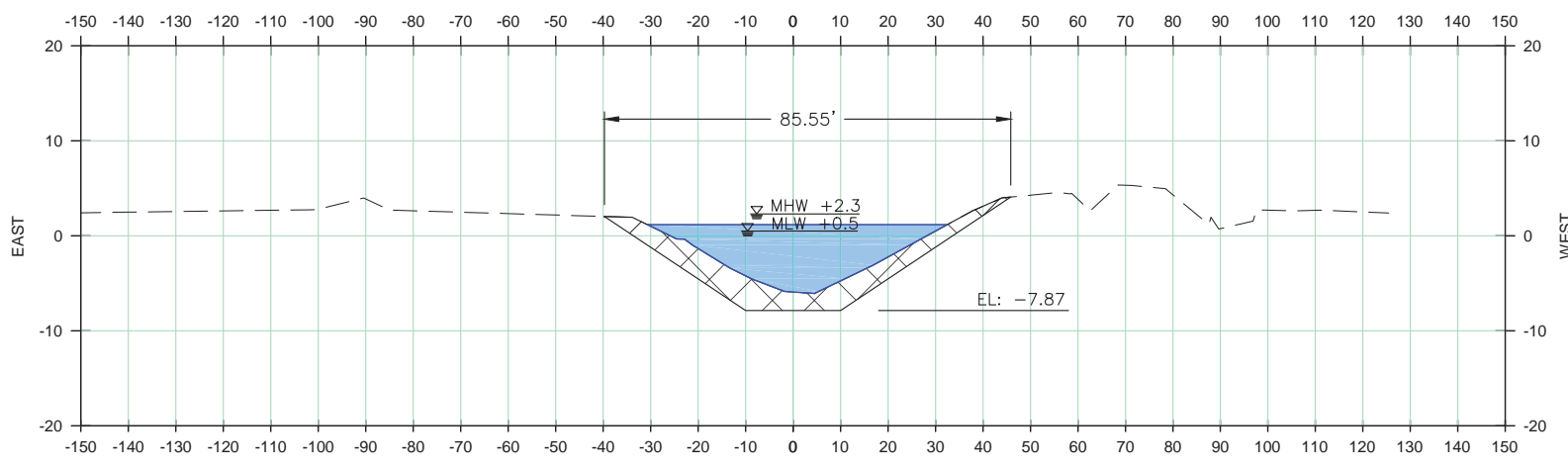

8+00.00

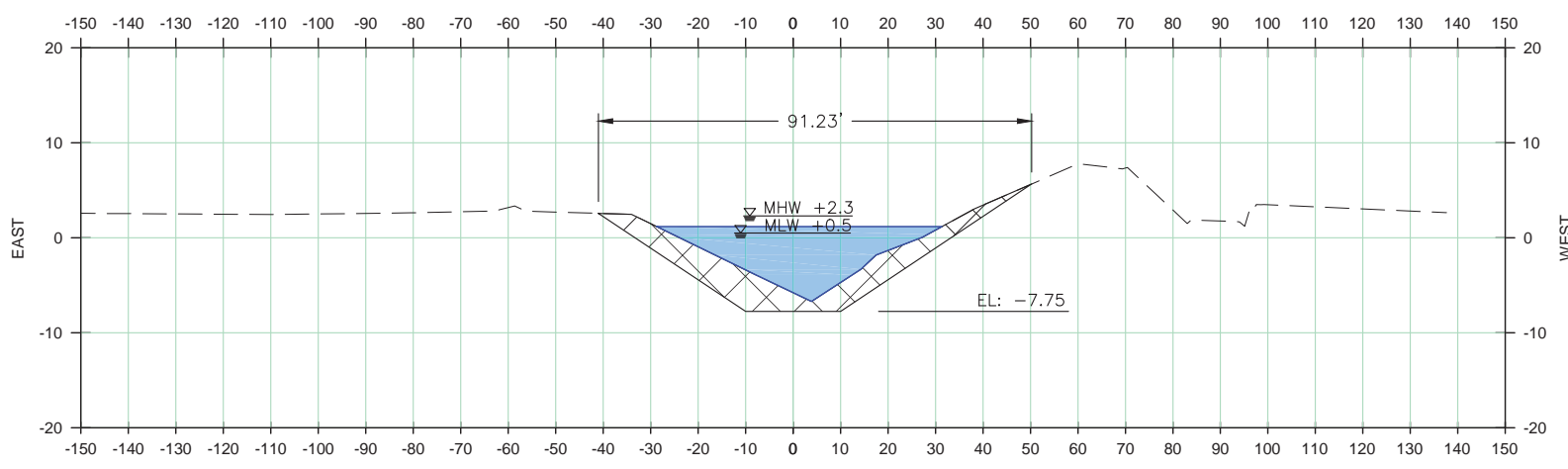

- LEGEND**
- - - - - EXISTING GROUND
 - █ - WATER
 - ▩ - AREA DREDGED

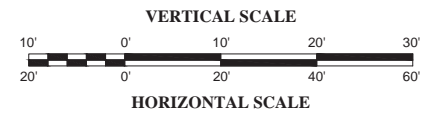

M:\Department_39\client\1703 - Terrebonne Parish - Chachahoula-Gibson Basin Drainage Project\Drafting\CAD\DWG\1 Permit\CROSS SECTIONS.dwg



ENGINEERING LLC

Coastal Design & Infrastructure
 2503 Petroleum Dr. | Suite 110
 Houma, LA 70363
 O: (985) 219-1000 | F: (985) 475-7014

ENGINEERING • PLANNING • ENVIRONMENTAL CONSULTING

REVISIONS

No.	Description	Date



TERREBONNE PARISH
 CONSOLIDATED GOVERNMENT
 CHACHAHOULA-GIBSON BASIN
 DRAINAGE PROJECT

CROSS SECTIONS

Project number	39130-1020
Date	MAY 2017
Designed by	DMM
Drawn by	MAC,JJS
Checked by	DMM
Checked by	MAC
Plot Date	June 23, 2017

11+00.00

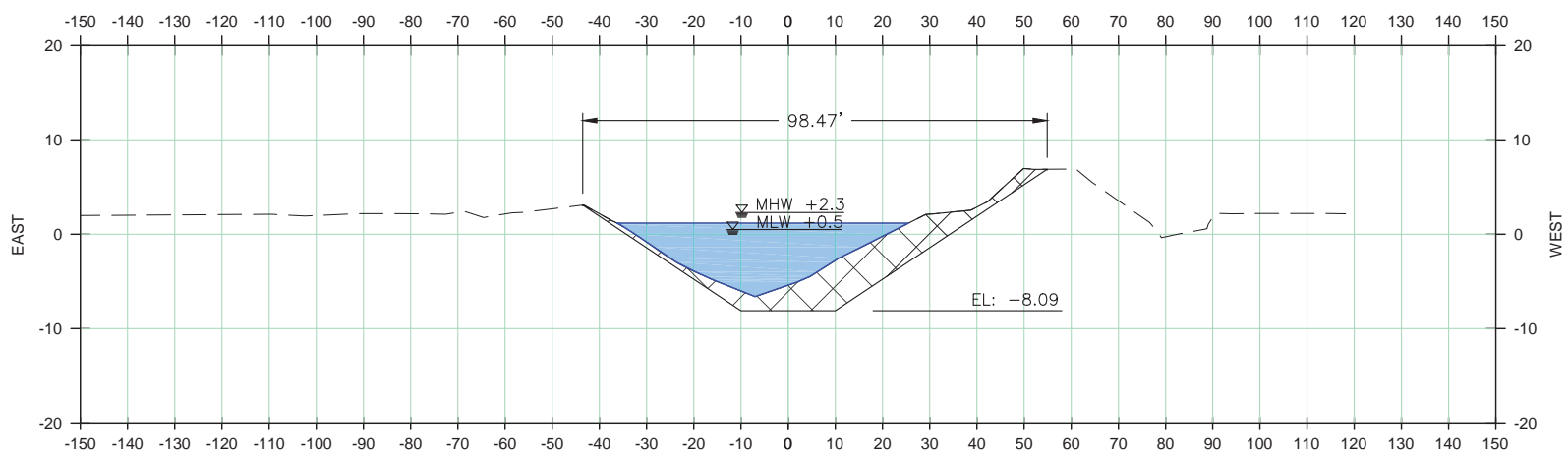

10+00.00

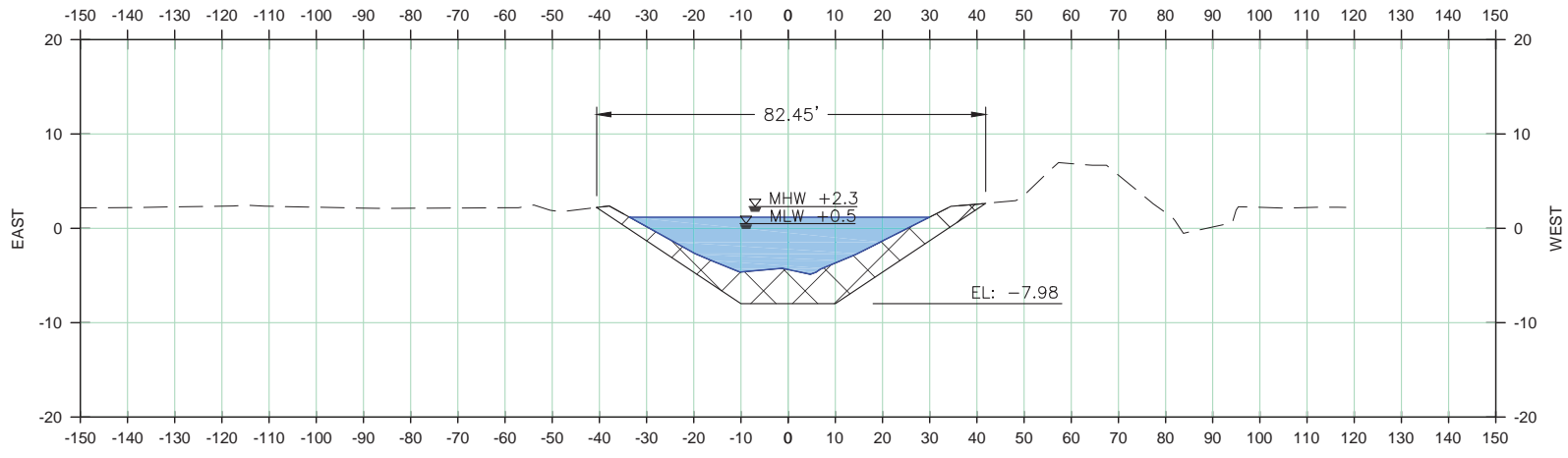

LEGEND

- - - - EXISTING GROUND
- - WATER
- ▩ - AREA DREDGED

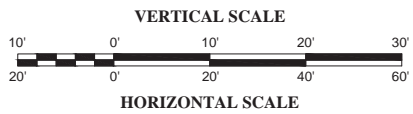



ENGINEERING LLC

Coastal Design & Infrastructure
 2503 Petroleum Dr. | Suite 110
 Houma, LA 70363
 O: (985) 219-1000 | F: (985) 475-7014

ENGINEERING • PLANNING • ENVIRONMENTAL CONSULTING

REVISIONS

No.	Description	Date

TERREBONNE PARISH
 CONSOLIDATED GOVERNMENT
 CHACHAHOULA-GIBSON BASIN
 DRAINAGE PROJECT

CROSS SECTIONS

Project number	39130-1020
Date	MAY 2017
Designed by	DMM
Drawn by	MAC,JJS
Checked by	DMM
Checked by	MAC
Plot Date	June 23, 2017

M:\Department_39\client\1703 - Terrebonne Parish - Chachoula-Gibson Basin Drainage Project\Drafting\CAD\DWG\1 Permitt\CROSS SECTIONS.dwg

13+00.00

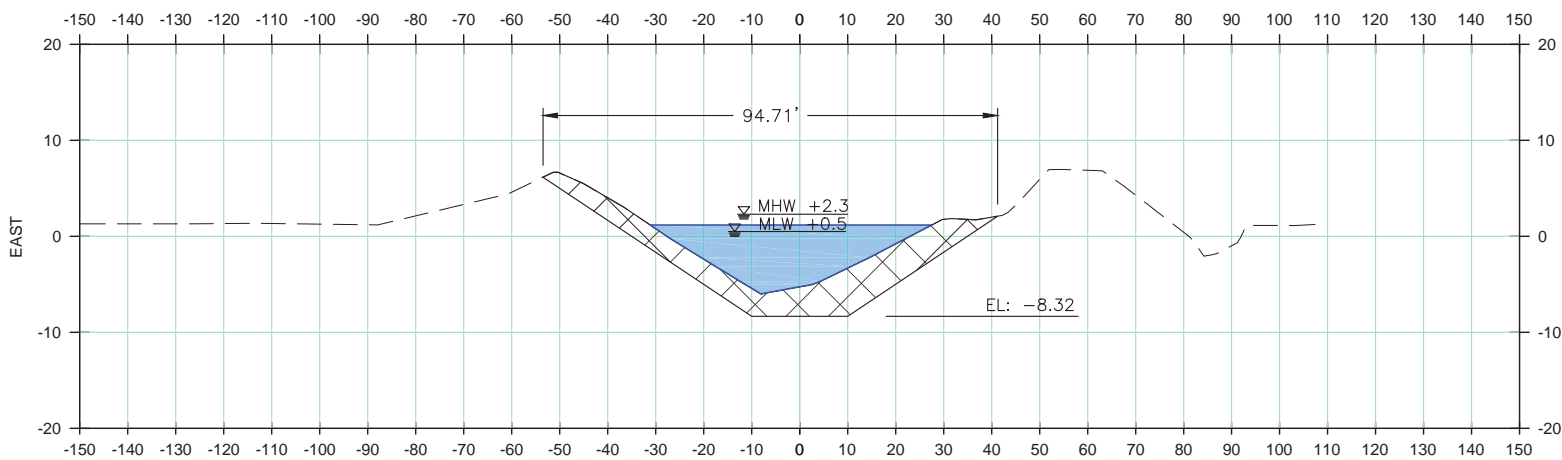

12+00.00

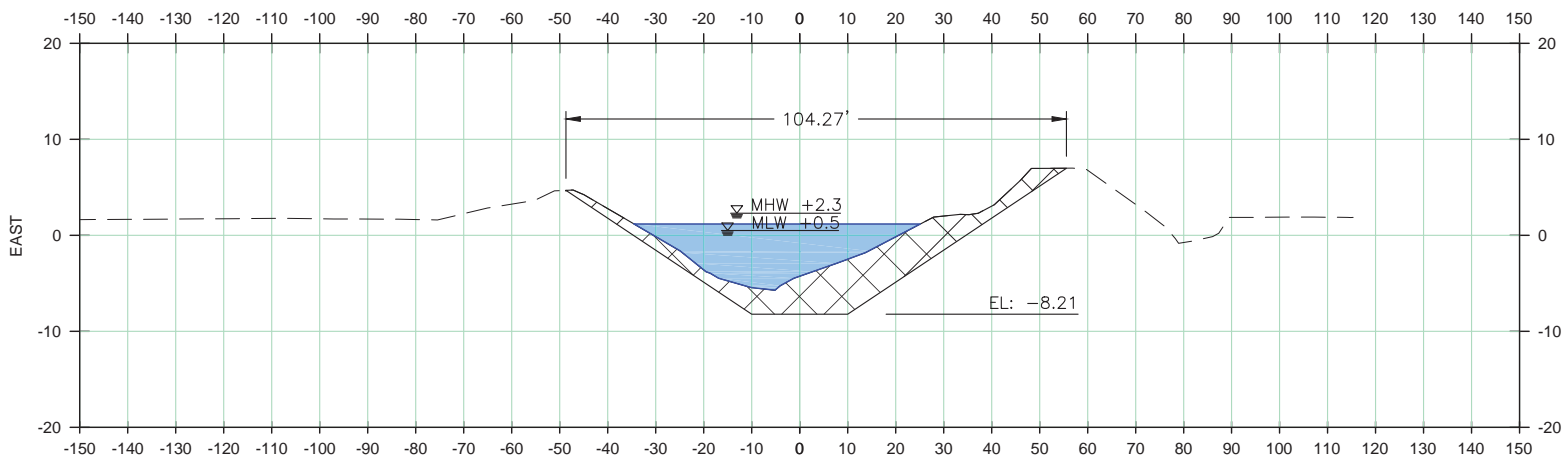

LEGEND

- EXISTING GROUND
- WATER
- ▣ AREA DREDGED

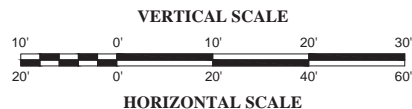



ENGINEERING LLC

Coastal Design & Infrastructure
 2503 Petroleum Dr. | Suite 110
 Houma, LA 70363
 O: (985) 219-1000 | F: (985) 475-7014

ENGINEERING • PLANNING • ENVIRONMENTAL CONSULTING

REVISIONS

No.	Description	Date

TERREBONNE PARISH
 CONSOLIDATED GOVERNMENT
 CHACHAHOULA-GIBSON BASIN
 DRAINAGE PROJECT

CROSS SECTIONS

Project number	39130-1020
Date	MAY 2017
Designed by	DMM
Drawn by	MAC,JJS
Checked by	DMM
Checked by	MAC
Plot Date	June 23, 2017

17

17+00.00

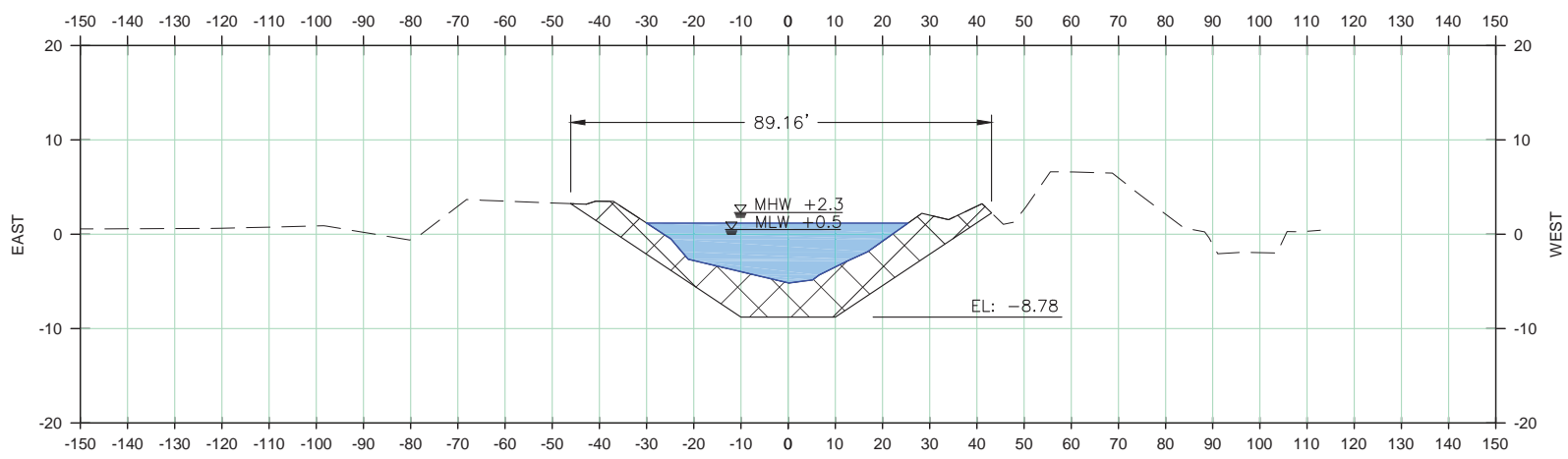

16+00.00

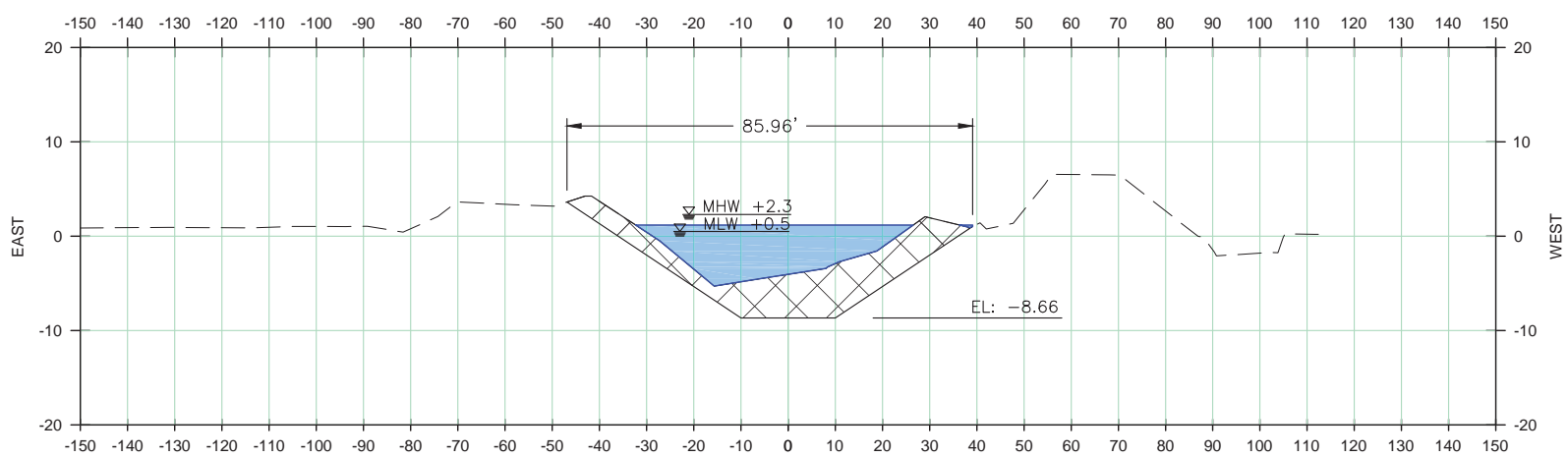

- LEGEND**
- - EXISTING GROUND
 - - WATER
 - ▨ - AREA DREDGED

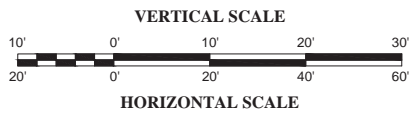



ENGINEERING LLC

Coastal Design & Infrastructure
 2503 Petroleum Dr. | Suite 110
 Houma, LA 70363
 O: (985) 219-1000 | F: (985) 475-7014

ENGINEERING • PLANNING • ENVIRONMENTAL CONSULTING

REVISIONS

No.	Description	Date

TERREBONNE PARISH
 CONSOLIDATED GOVERNMENT
 CHACHAHOULA-GIBSON BASIN
 DRAINAGE PROJECT

CROSS SECTIONS

Project number	39130-1020
Date	MAY 2017
Designed by	DMM
Drawn by	MAC,JJS
Checked by	DMM
Checked by	MAC
Plot Date	June 23, 2017

19+00.00

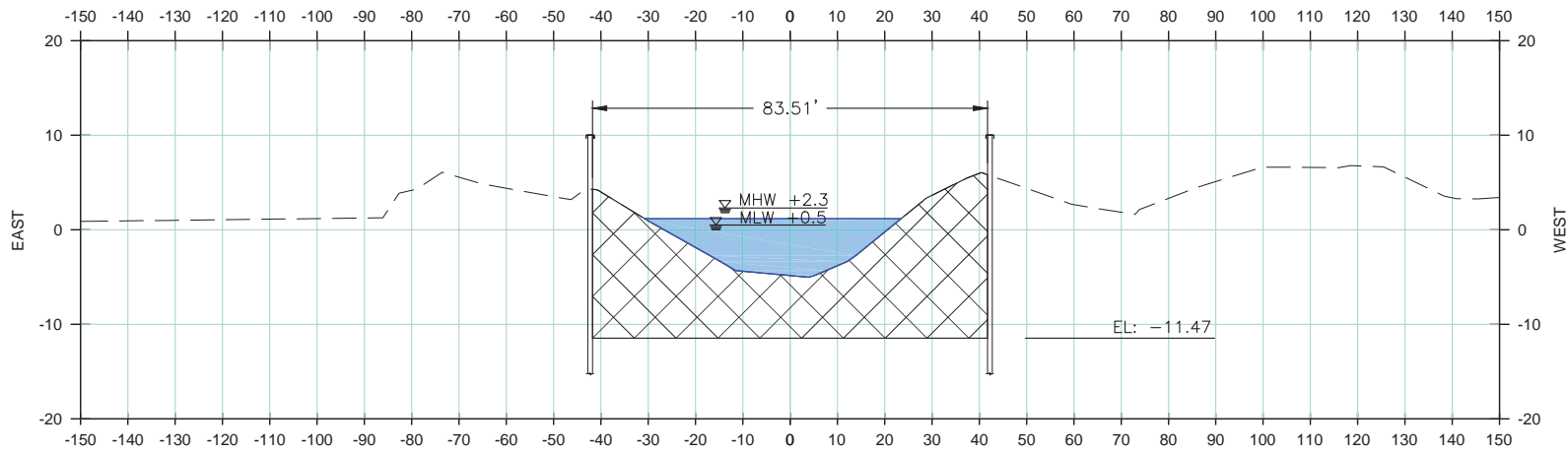

18+00.00

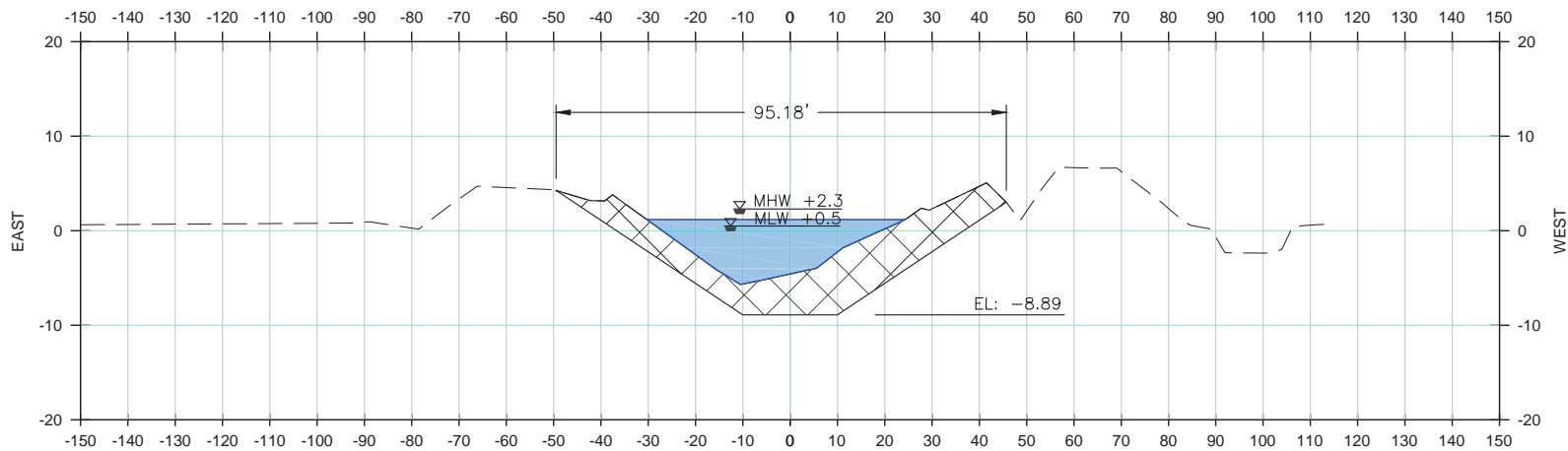

LEGEND

- - EXISTING GROUND
- - WATER
- ▨ - AREA DREDGED

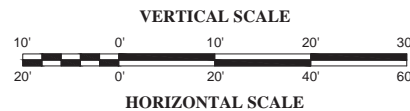



ENGINEERING LLC

Coastal Design & Infrastructure
 2503 Petroleum Dr. | Suite 110
 Houma, LA 70363

O: (985) 219-1000 | F: (985) 475-7014

ENGINEERING • PLANNING • ENVIRONMENTAL CONSULTING

REVISIONS

No.	Description	Date

TERREBONNE PARISH
 CONSOLIDATED GOVERNMENT
 CHACHAHOULA-GIBSON BASIN
 DRAINAGE PROJECT

CROSS SECTIONS

Project number	39130-1020
Date	MAY 2017
Designed by	DMM
Drawn by	MAC,JJS
Checked by	DMM
Checked by	MAC
Plot Date	June 23, 2017

21+00.00

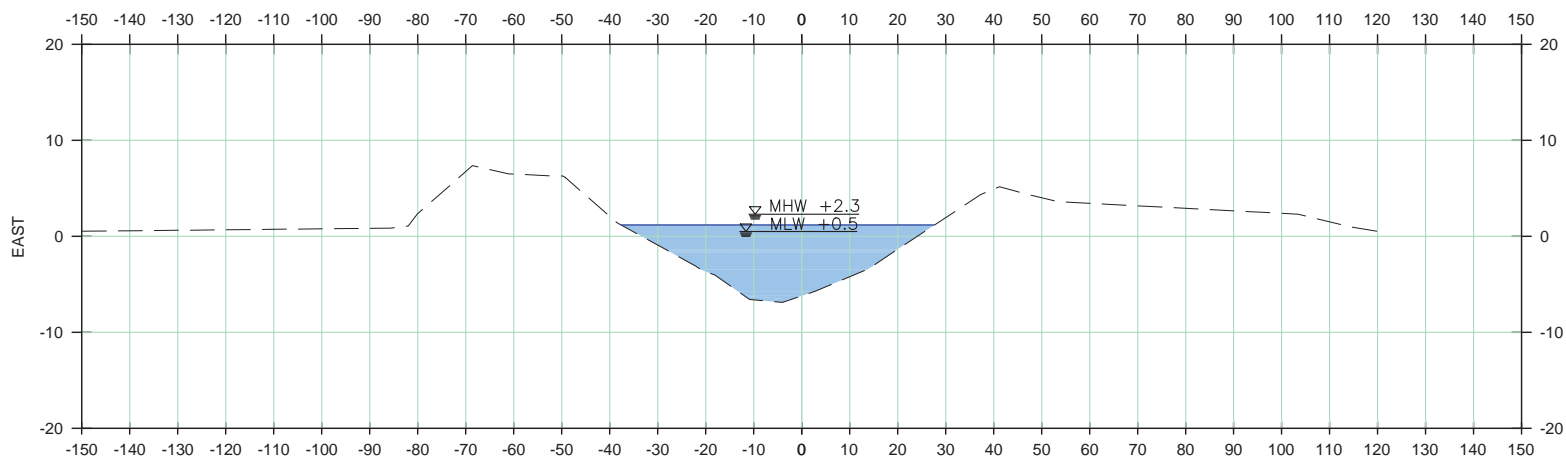

20+00.00

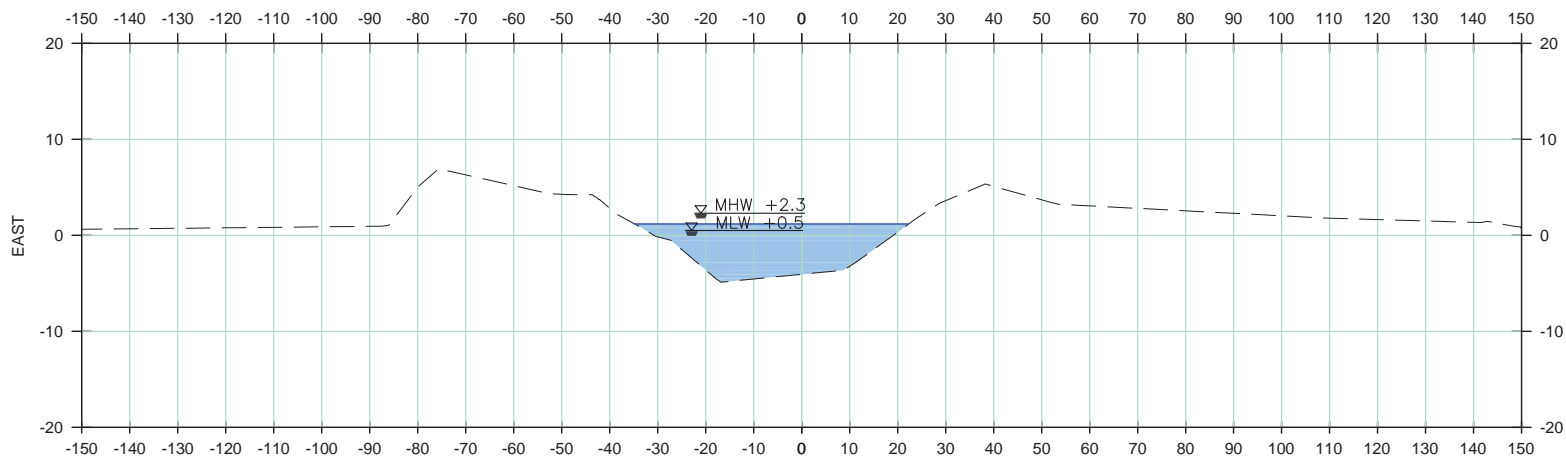

LEGEND

- - EXISTING GROUND
- - WATER
- ▨ - AREA DREDGED

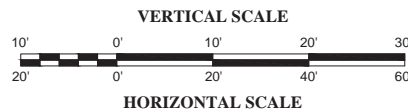

M:\Department_39\client\1703 - Terrebonne Parish - Chachahoula-Gibson Basin Drainage Project\Drafting\CAD\DWG\1 Permit\CROSS SECTIONS.dwg



ENGINEERING LLC

Coastal Design & Infrastructure
 2503 Petroleum Dr. | Suite 110
 Houma, LA 70363
 O: (985) 219-1000 | F: (985) 475-7014

ENGINEERING • PLANNING • ENVIRONMENTAL CONSULTING

REVISIONS

No.	Description	Date

TERREBONNE PARISH
 CONSOLIDATED GOVERNMENT
 CHACHAHOULA-GIBSON BASIN
 DRAINAGE PROJECT

CROSS SECTIONS

Project number	39130-1020
Date	MAY 2017
Designed by	DMM
Drawn by	MAC,JJS
Checked by	DMM
Checked by	MAC
Plot Date	June 23, 2017

20

23+00.00

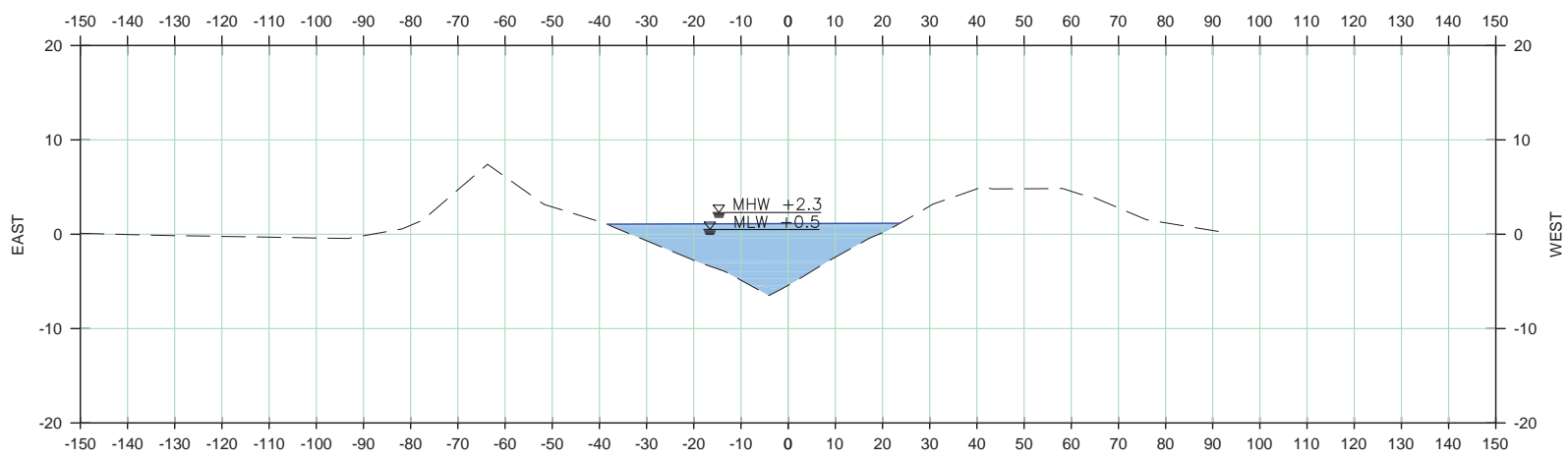

22+00.00

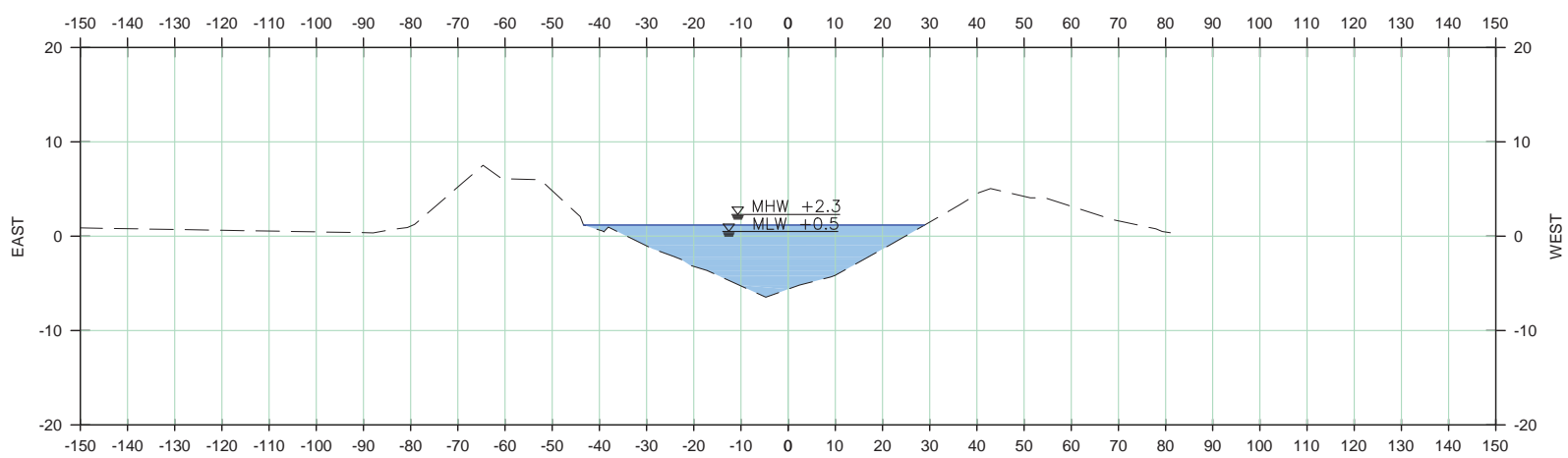

LEGEND

- - EXISTING GROUND
- [Blue Area] - WATER
- [Cross-hatch Area] - AREA DREDGED

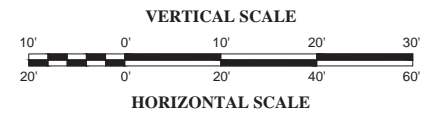



ENGINEERING LLC

Coastal Design & Infrastructure
 2503 Petroleum Dr. | Suite 110
 Houma, LA 70363
 O: (985) 219-1000 | F: (985) 475-7014

ENGINEERING • PLANNING • ENVIRONMENTAL CONSULTING

REVISIONS

No.	Description	Date



TERREBONNE PARISH
 CONSOLIDATED GOVERNMENT
 CHACHAHOULA-GIBSON BASIN
 DRAINAGE PROJECT

CROSS SECTIONS

Project number	39130-1020
Date	MAY 2017
Designed by	DMM
Drawn by	MAC,JJS
Checked by	DMM
Checked by	MAC
Plot Date	June 23, 2017

23+25.00

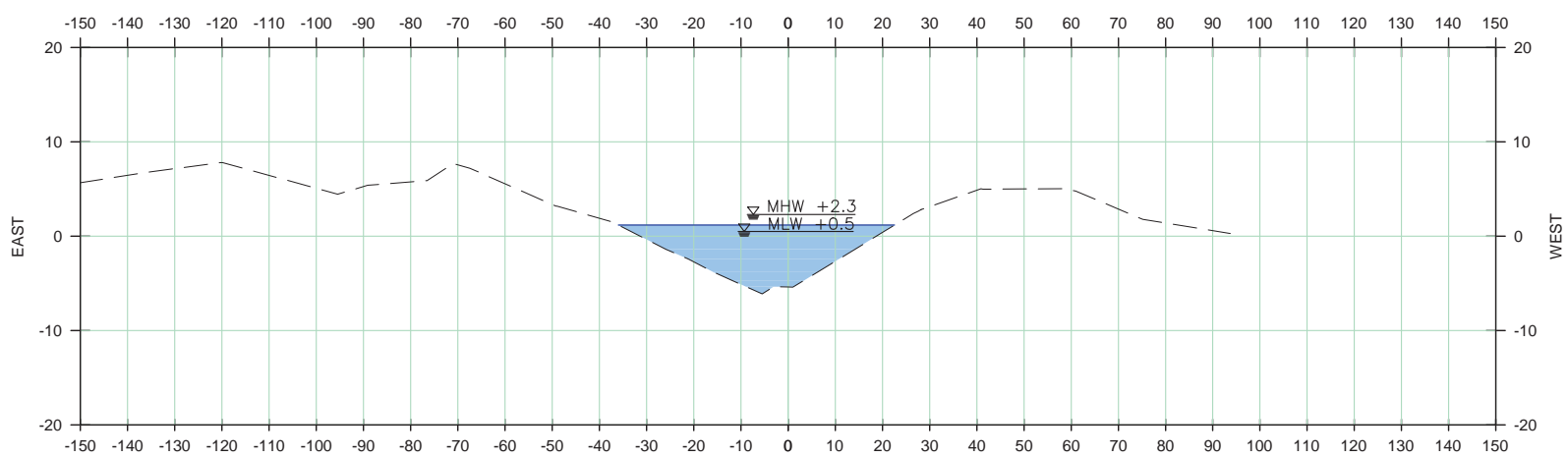

- LEGEND**
- - EXISTING GROUND
 - - WATER
 - ▨ - AREA DREDGED

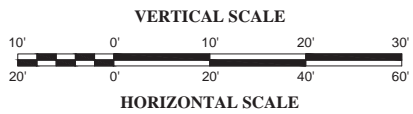

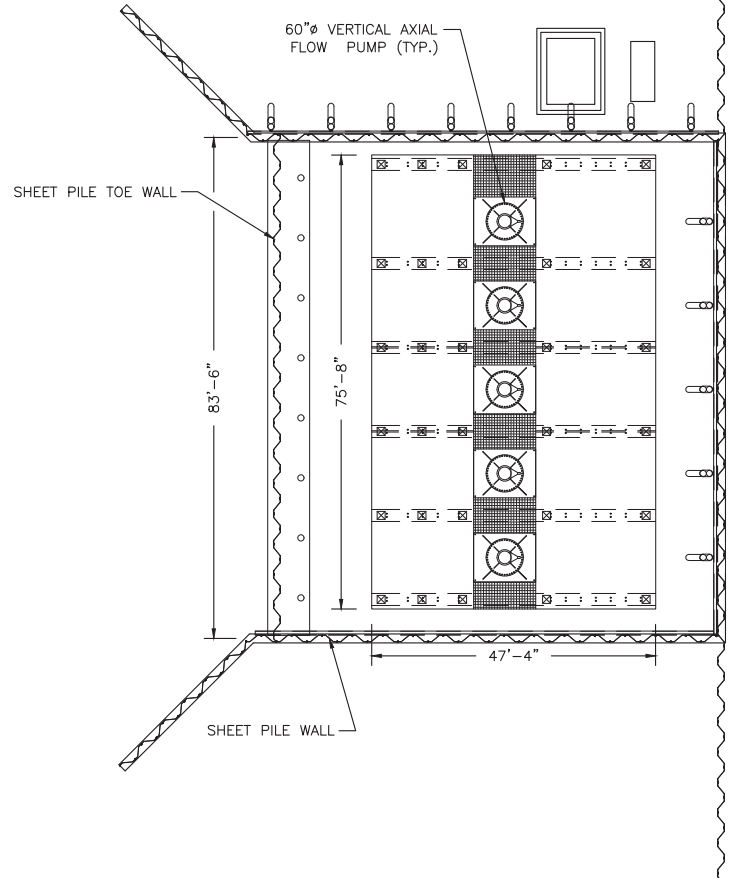

PUMP STATION PLAN
SCALE: 1/32" = 1'-0"



ENGINEERING LLC

Coastal Design & Infrastructure
2503 Petroleum Dr. | Suite 110
Houma, LA 70363
O: (985) 219-1000 | F: (985) 475-7014

ENGINEERING • PLANNING • ENVIRONMENTAL CONSULTING

REVISIONS

No.	Description	Date

TERREBONNE PARISH
CONSOLIDATED GOVERNMENT
CHACHOULA-GIBSON BASIN
DRAINAGE PROJECT

**PUMP STATION PLAN
AND ELEVATION**

Project number	39130-1020
Date	MAY 2017
Designed by	DMM
Drawn by	MAC,JJS
Checked by	DMM
Checked by	MAC
Plot Date	June 23, 2017

M:\Department_39\client\1703 - Terrebonne Parish - Terrebonne Parish\1020-1021 Chachoula-Gibson Basin Drainage Project\Drafting\CAD\DWG\1 Permit\PUMP STATION PLAN AND ELEVATION.dwg



ENGINEERING LLC

Coastal Design & Infrastructure
 2503 Petroleum Dr. | Suite 110
 Houma, LA 70363
 O: (985) 219-1000 | F: (985) 475-7014

ENGINEERING • PLANNING • ENVIRONMENTAL CONSULTING

REVISIONS

No.	Description	Date

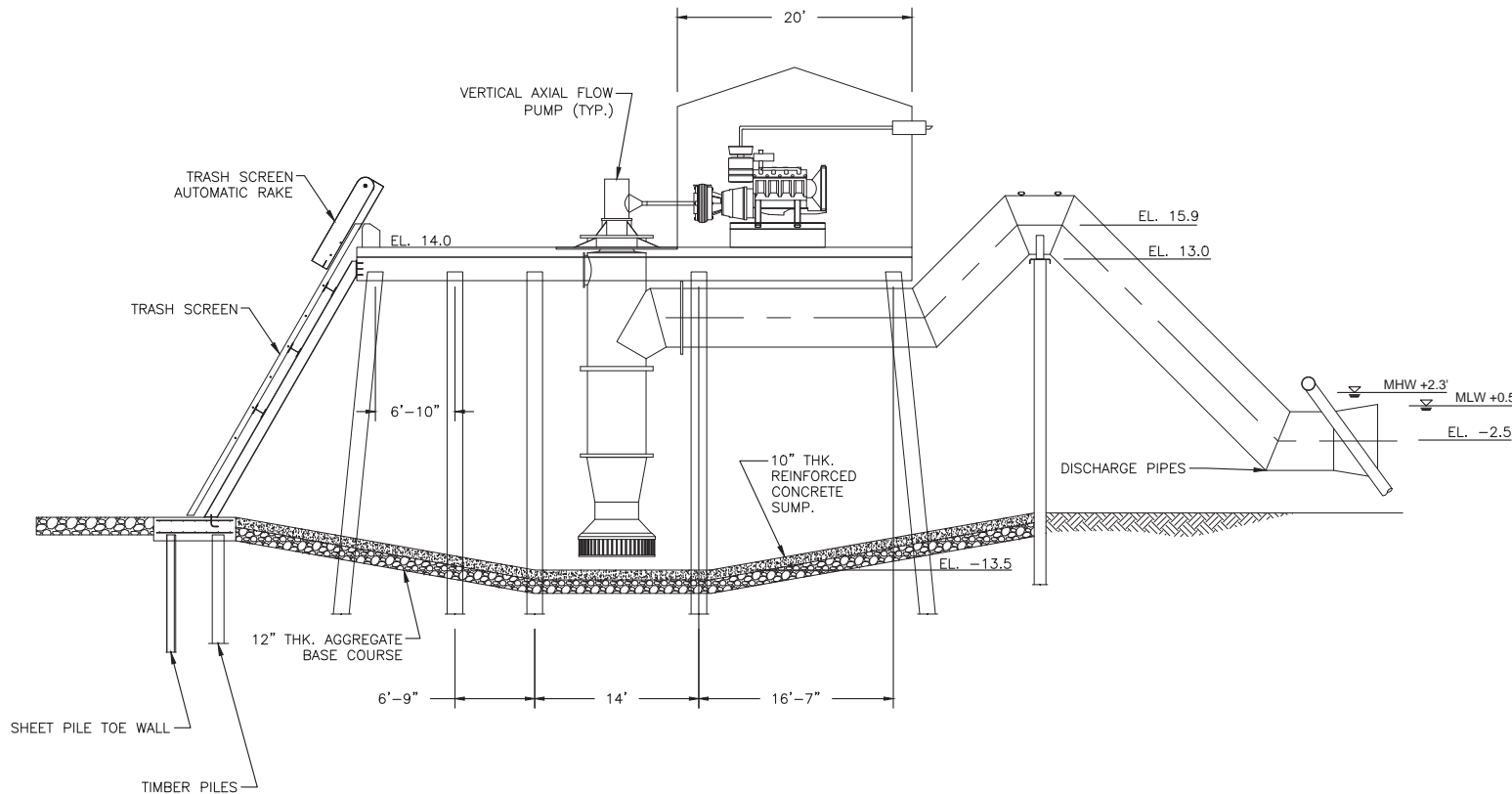

PUMP STATION ELEV.
 SCALE: 1/16" = 1'-0"

TERREBONNE PARISH
 CONSOLIDATED GOVERNMENT
 CHACHAHOULA-GIBSON BASIN
 DRAINAGE PROJECT

**PUMP STATION PLAN
 AND ELEVATION**

Project number	39130-1020
Date	MAY 2017
Designed by	DMM
Drawn by	MAC,JJS
Checked by	DMM
Checked by	MAC
Plot Date	June 23, 2017

M:\Department - 39\Client\TPG3 - Terrebonne Parish - Terrebonne Parish\1020-1021 Chachoula-Gibson Basin Drainage Project\Drafting\CAD\DWG\1 Permit\PUMP STATION PLAN AND ELEVATION.dwg



ENGINEERING LLC

Coastal Design & Infrastructure
 2503 Petroleum Dr. | Suite 110
 Houma, LA 70363
 O: (985) 219-1000 | F: (985) 475-7014

ENGINEERING • PLANNING • ENVIRONMENTAL CONSULTING

REVISIONS

No.	Description	Date

TERREBONNE PARISH
 CONSOLIDATED GOVERNMENT
 CHACHAHOULA-GIBSON BASIN
 DRAINAGE PROJECT

**ACCESS ROAD
 PLAN AND
 SECTION**

Project number	39130-1020
Date	MAY 2017
Designed by	DMM
Drawn by	MAC,JJS
Checked by	DMM
Checked by	MAC
Plot Date	June 23, 2017

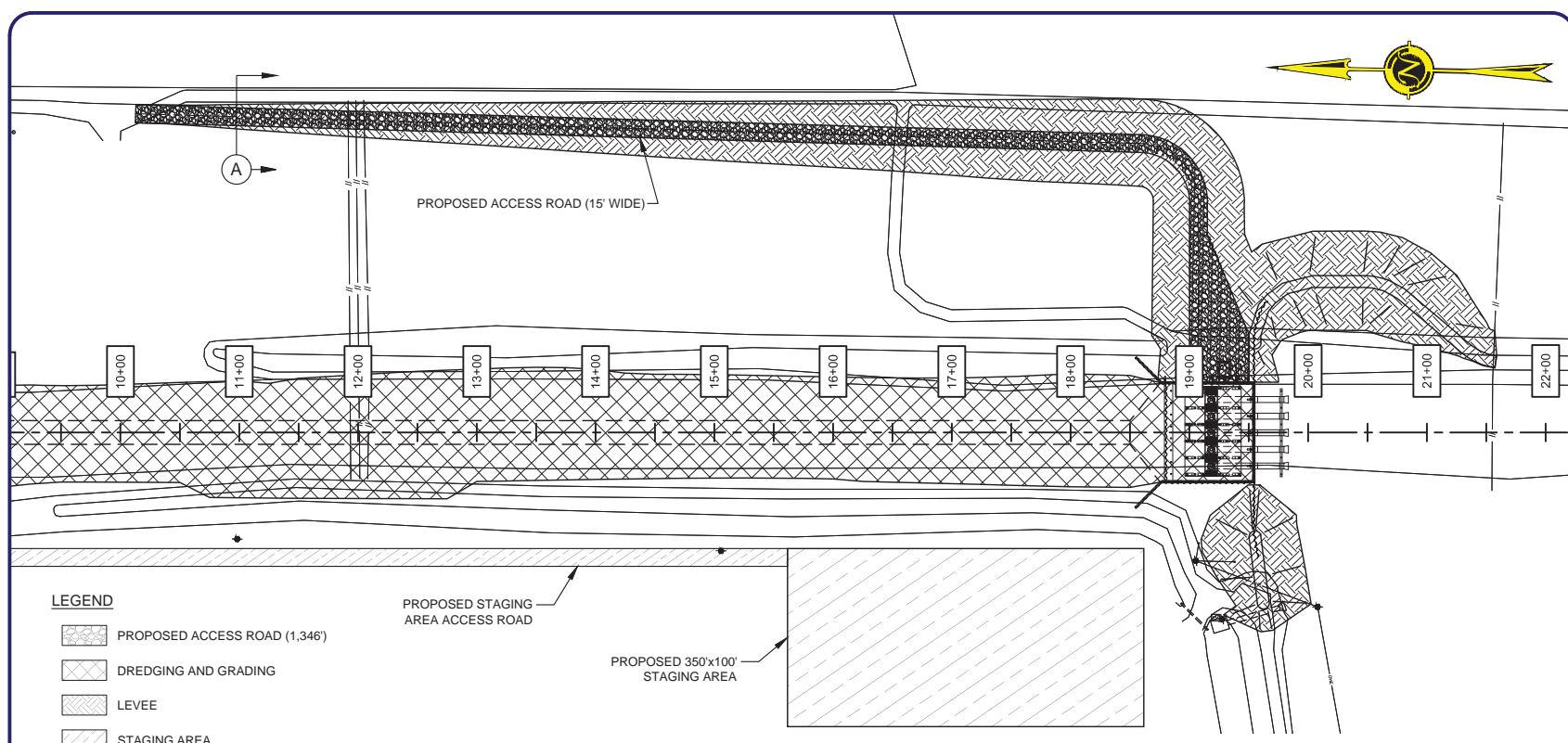

- LEGEND**
- PROPOSED ACCESS ROAD (1,346')
 - DREDGING AND GRADING
 - LEVEE
 - STAGING AREA

PROPOSED STAGING AREA ACCESS ROAD

PROPOSED 350'x100' STAGING AREA

LEVEE ACCESS ROAD PLAN

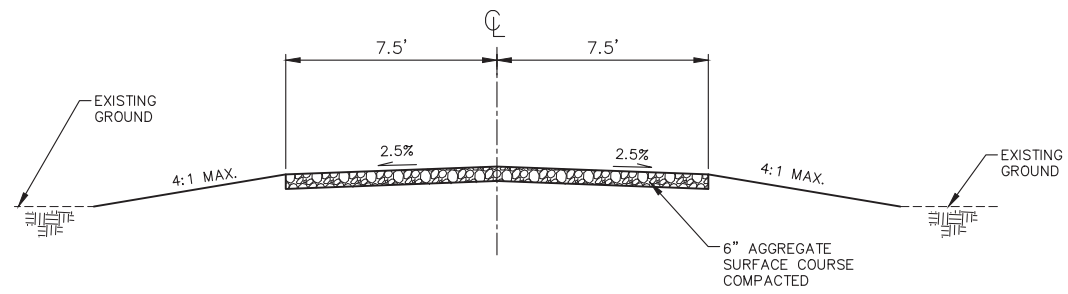

(A) ACCESS ROAD TYPICAL SECTION
 SCALE: N.T.S.

M:\Department - 39\client\1703 - Terrebonne Parish - Chachahoula-Gibson Basin Drainage Project\Drafting\CAD\DWG\1 Permits\ACCESS ROAD PLAN AND SECTION.dwg



ENGINEERING LLC

Coastal Design & Infrastructure
 2503 Petroleum Dr. | Suite 110
 Houma, LA 70363
 O: (985) 219-1000 | F: (985) 475-7014

ENGINEERING • PLANNING • ENVIRONMENTAL CONSULTING

REVISIONS

No.	Description	Date



TERREBONNE PARISH
 CONSOLIDATED GOVERNMENT
 CHACHAHOULA-GIBSON BASIN
 DRAINAGE PROJECT

**EXISTING LEVEE
 TYPICAL SECTION**

Project number	39130-1020
Date	MAY 2017
Designed by	DMM
Drawn by	MAC,JJS
Checked by	DMM
Checked by	MAC
Plot Date	June 23, 2017

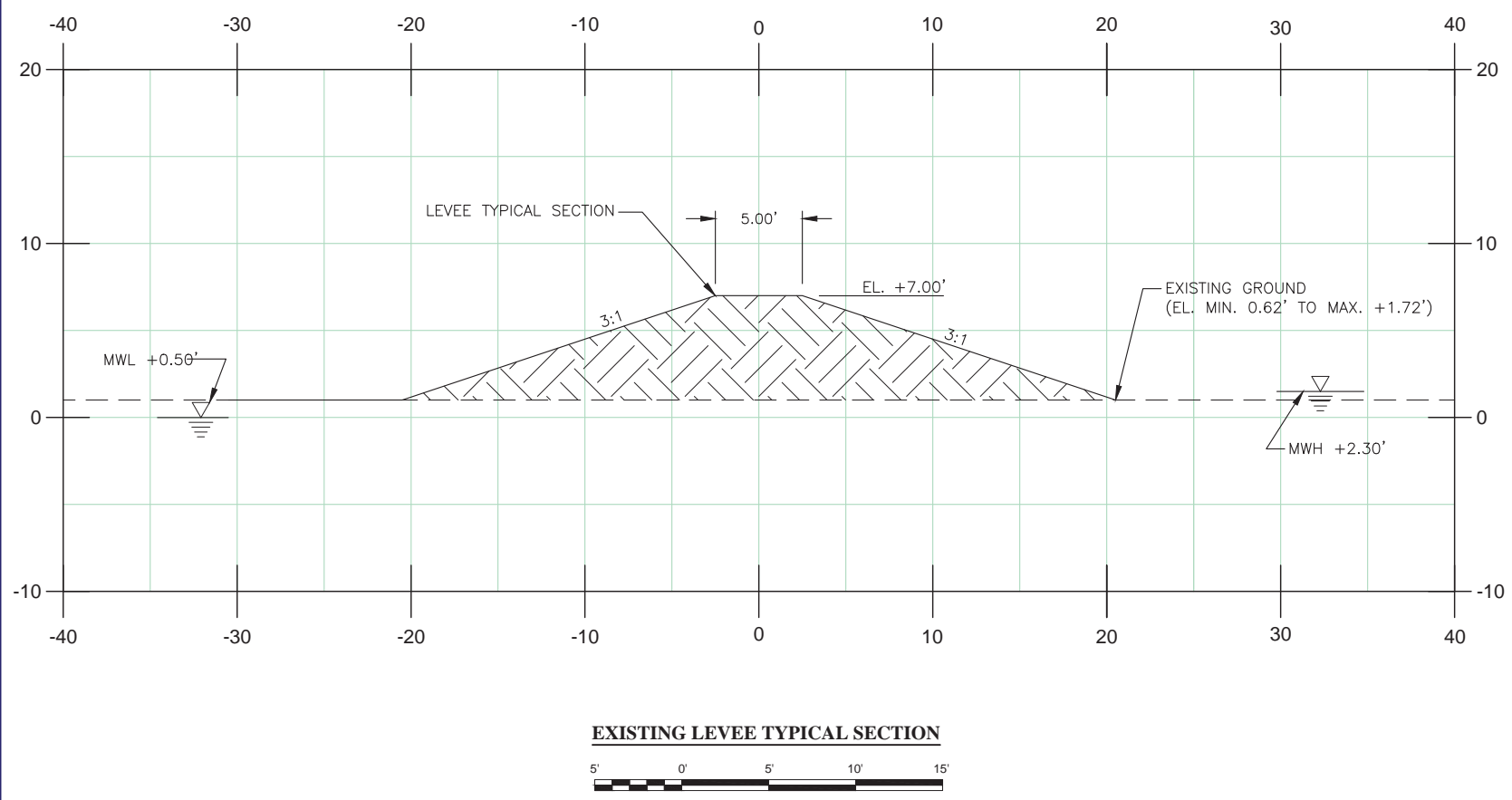

EXISTING LEVEE TYPICAL SECTION



M:\Department_39\client\1703 - Terrebonne Parish - Chachoula-Gibson Basin Drainage Project\Drafting\CAD\DWG\1 Permit\EXISTING LEVEE TYPICAL SECTION.dwg