

# JOINT PUBLIC NOTICE

31 July 2017

United States Army Corps of Engineers  
New Orleans District  
Regulatory Branch  
7400 Leake Avenue  
New Orleans, Louisiana 70118

State of Louisiana  
Department of Environmental Quality  
Office of Environmental Services  
Post Office Box 4313  
Baton Rouge, Louisiana 70821-4313

(504) 862-1588  
Project Manager  
Glenn E. Dobson Jr.  
[glenn.e.dobson@usace.army.mil](mailto:glenn.e.dobson@usace.army.mil)  
MVN-2017-00828-CC

(225) 219-3225  
Project Manager  
Elizabeth Hill  
WQC Application Number  
WQC # 170725-02

Interested parties are hereby notified that a permit application has been received by the New Orleans District of the US Army Corps of Engineers pursuant to: [X] Section 10 of the Rivers and Harbors Act of March 3, 1899 (30 Stat. 1151; 33 USC 403); and/or [X] Section 404 of the Clean Water Act (86 Stat. 816; 33 USC 1344).

Application has also been made to the Louisiana Department of Environmental Quality, Office of Environmental Services, for a Water Quality Certification (WQC) in accordance with statutory authority contained in LRS 30:2074 A(3) and provisions of Section 401 of the Clean Water Act.

## **PROPOSED BULKHEAD REPLACEMENT, WHARVES AND BOAT SHED ALONG THE AMITE RIVER IN LIVINGSTON PARISH**

**NAME OF APPLICANT:** Dennis Howze, c/o Sharp Bros Construction 27132 Hwy 22 Springfield, Louisiana 70394.

**LOCATION OF WORK:** Amite River, left descending bank, in Section 11, T9S-R4E, at 18417 La Trace Road French Settlement, Louisiana, in Livingston Parish, within the Lake Pontchartrain Basin in hydrologic unit (HUC 08070204), as shown on the attached drawings (Latitude 30.276397 N, Longitude -90.943967 W).

**CHARACTER OF WORK:** The applicant has requested Department of the Army authorization to replace an existing bulkhead and to construct a new bulkhead, two wharves and a covered boat shed. The new section of bulkhead will be approximately 50 feet long. Approximately 96.5 cubic yards of material will be dredged from beneath the boat shed area and be used as backfill behind the new bulkhead. The boat shed and piers will be constructed by driving piles using a dragline excavator and will extend channel ward approximately 30 feet. A preliminary analysis has determined that wetlands may be present at the project site; however, extent of coverage and impacts is undetermined at this time pending wetland delineation. It is anticipated that impacts to special aquatic sites will be negligible.

It is presumed that the applicant has designed the project to avoid and minimize direct and secondary adverse impacts to the maximum extent practicable. Any further reduction would limit usage of the property and, therefore function deeming the project impracticable.

The comment period for the Department of Army will close in **20 days** from the date of this joint public notice. Written comments, including suggestions for modifications or objections to the proposed work, stating reasons thereof, are being solicited from anyone having interest in this permit and/or this WQC request and must be mailed so as to be received before or by the last day of the comment period. Letters concerning the Corps of Engineers permit application must reference the applicant's name and the Permit Application Number, and be mailed to the Corps of Engineers at the address above, **ATTENTION: REGULATORY BRANCH**. Similar letters concerning the Water Quality Certification must reference the applicant's name and the WQC application number and be mailed to the Louisiana Department of Environmental Quality at the address above. Individuals or parties may request an extension of time in which to comment on the proposed work by writing or e-mailing the Corps of Engineers Project Manager listed above. Any request must be specific and substantively supportive of the requested extension, and received by this office prior to the end of the initial comment period. The Section Chief will review the request and the requestor will be promptly notified of the decision to grant or deny the request. If granted, the time extension will be continuous to the initial comment period and, inclusive of the initial comment period, will not exceed a total of 30 calendar days.

The application for this proposed project is on file with the Louisiana Department of Environmental Quality and may be examined during weekdays between 8:00 a.m. and 4:30 p.m. Copies may be obtained upon payment of costs of reproduction.

### **Corps of Engineers Permit Criteria**

The decision whether to issue a permit will be based on an evaluation of the probable impacts, including cumulative impacts of the proposed activity on the public interest. That decision will reflect the national concern for both protection and utilization of important resources. The benefit which reasonably may be expected to accrue from the proposal must be balanced against its reasonably foreseeable detriments. All factors which may be relevant to the proposal will be considered including the cumulative effects thereof; among those are conservation, economics, aesthetics, general environmental concerns, wetlands, historic properties, fish and wildlife values, flood hazards, floodplain values, land use, navigation, shoreline erosion and accretion, recreation, water supply and conservation, water quality, energy needs, safety, food and fiber production, mineral needs, considerations of property ownership and, in general, the needs and welfare of the people.

The US Army Corps of Engineers is soliciting comments from the public, federal, state, and local agencies and officials, Indian Tribes, and other interested parties in order to consider and evaluate the impacts of this proposed activity. Any comments received will be considered by the US Army Corps of Engineers to determine whether to make, modify, condition, or deny a permit for this proposal. To make this decision, comments are used to assess impacts on endangered species, historic properties, water quality, general environmental effects, and other public interest factors listed above. Comments are used in the preparation of an Environmental Assessment and/or an Environmental Impact Statement pursuant to the National Environmental Policy Act. Comments are also used to determine the need for a public hearing and to determine the overall public interest of the proposed activity.

The New Orleans District is unaware of properties listed on the National Register of Historic Places near the proposed work. The possibility exists that the proposed work may damage or destroy presently unknown archeological, scientific, prehistorical, historical sites, or data. Copies of this notice are being sent to the State Archeologist and the State Historic Preservation Officer.

The New Orleans District has determined that the proposed project is located in waters known to be utilized by the West Indian Manatee (*Trichechus manatus*). Utilizing Standard Local Operating Procedure for Endangered Species in Louisiana (SLOPES), dated October 22, 2014, between the U.S. Army Corps of Engineers, New Orleans and U.S. Fish and Wildlife Service, Ecological Services Office, the Corps has determined that with the inclusion of the Standard Manatee Conditions for In-Water Activities, proposed work is not likely to adversely affect the West Indian Manatee.

This notice initiates the Essential Fish Habitat (EFH) consultation requirements of the Magnuson-Stevens Fishery Conservation and Management Act. The applicant's proposal would result in the destruction or alteration of **0.03** acres of EFH. Our initial determination is that the proposed action would not have a substantial adverse impact on EFH or federally managed fisheries in the Gulf of Mexico. Our final determination relative to project impacts and the need for mitigation measures is subject to review by and coordination with the National Marine Fisheries Service.

If the proposed work involves deposits of dredged or fill material into navigable waters, the evaluation of the probable impacts will include the application of guidelines established by the Administrator of the Environmental Protection Agency. Also, a certification that the proposed activity will not violate water quality standards will be required from the Department of Environmental Quality, Office of Environmental Services before a permit is issued.

Any person may request, in writing, within the comment period specified in this notice, that a public hearing be held to consider this application. Requests for public hearings shall state, with particularity, the reasons for holding a public hearing. You are requested to communicate the information contained in this notice to any other parties whom you deem likely to have interest in the matter.

The applicant has certified that the proposed activity described in the application complies with and will be conducted in a manner that is consistent with the Louisiana Coastal Resources Program. The Department of the Army permit will not be issued unless the applicant received approval or a waiver of the Coastal Use Permit by the Department of Natural Resources.

JOHN M. HERMAN  
Chief, Central Evaluation Section  
Regulatory Branch

Enclosures

**Vicinity Map**  
Ron Harris  
18417 La Trace Rd  
French Settlement, LA 70733  
Livingston Parish



Sect 12 T9S R4E  
Ward 003  
Lot 95, LA Trace Phase III  
Livingston Parish  
30°16'35.0184"N 90°46'28.4376"W  
30.276397,-90.774565  
NAD83

# EXISTING BULKHEAD (To Be Replaced)

<Down River - Amite River - Up River>  
225 Feet to Opposite Bank

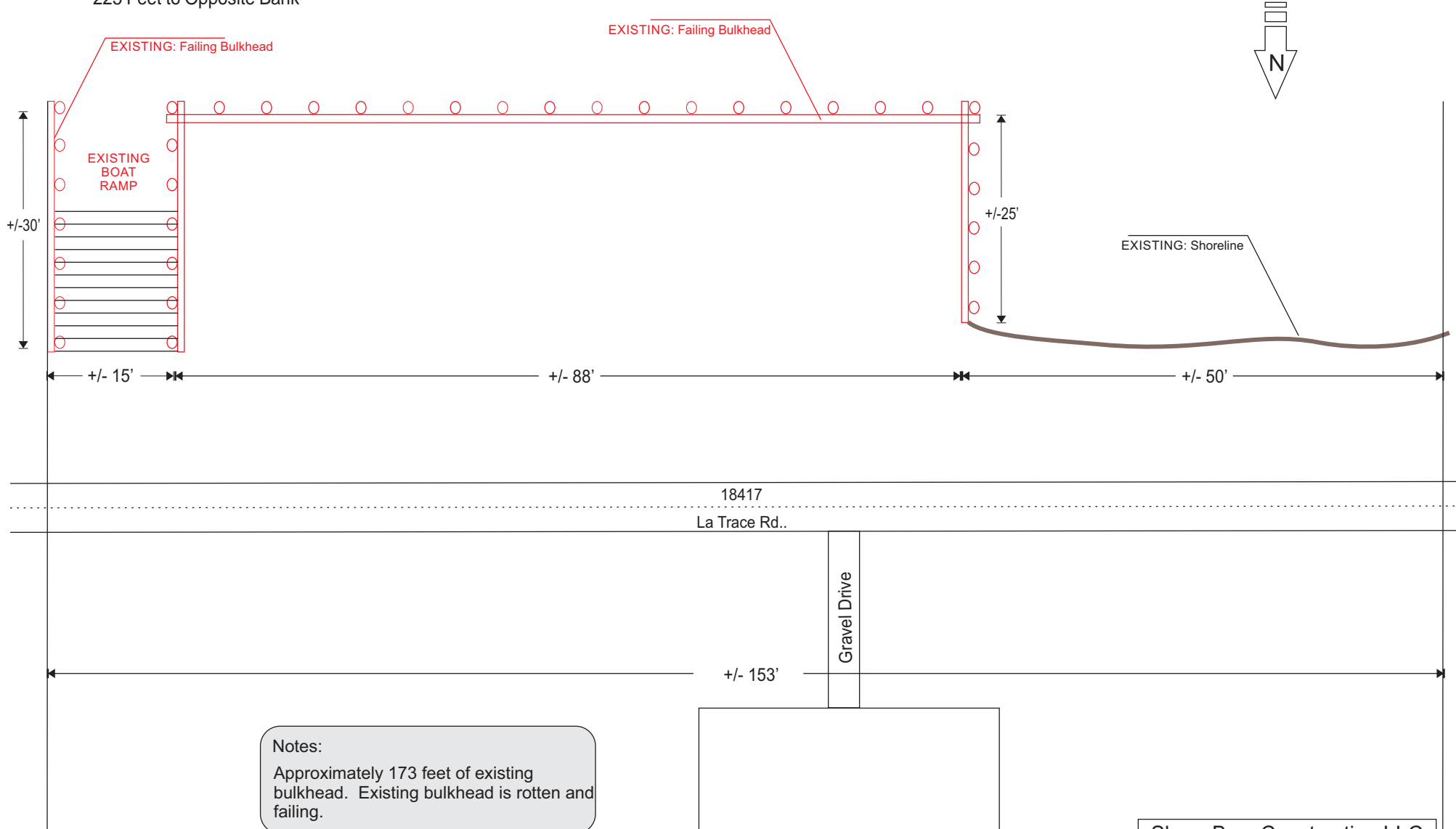

Notes:  
Approximately 173 feet of existing bulkhead. Existing bulkhead is rotten and failing.

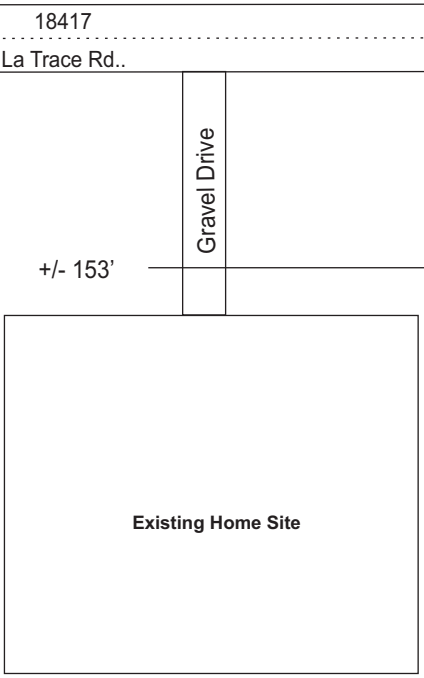

Sharp Bros Construction LLC  
Dennis Howze  
18417 La Trace Rd  
French Settlement, LA 70733  
Livingston Parish



# EXISTING BULKHEAD (Site Photos)



East Side:  
Existing Boat Ramp



Bulkhead Along River



West Side:  
Corner & Existing Shoreline



South Side:  
Existing Lot with Bulkhead

# EXISTING BULKHEAD (Water Depth)

<Down River - Amite River - Up River>  
225 Feet to Opposite Bank

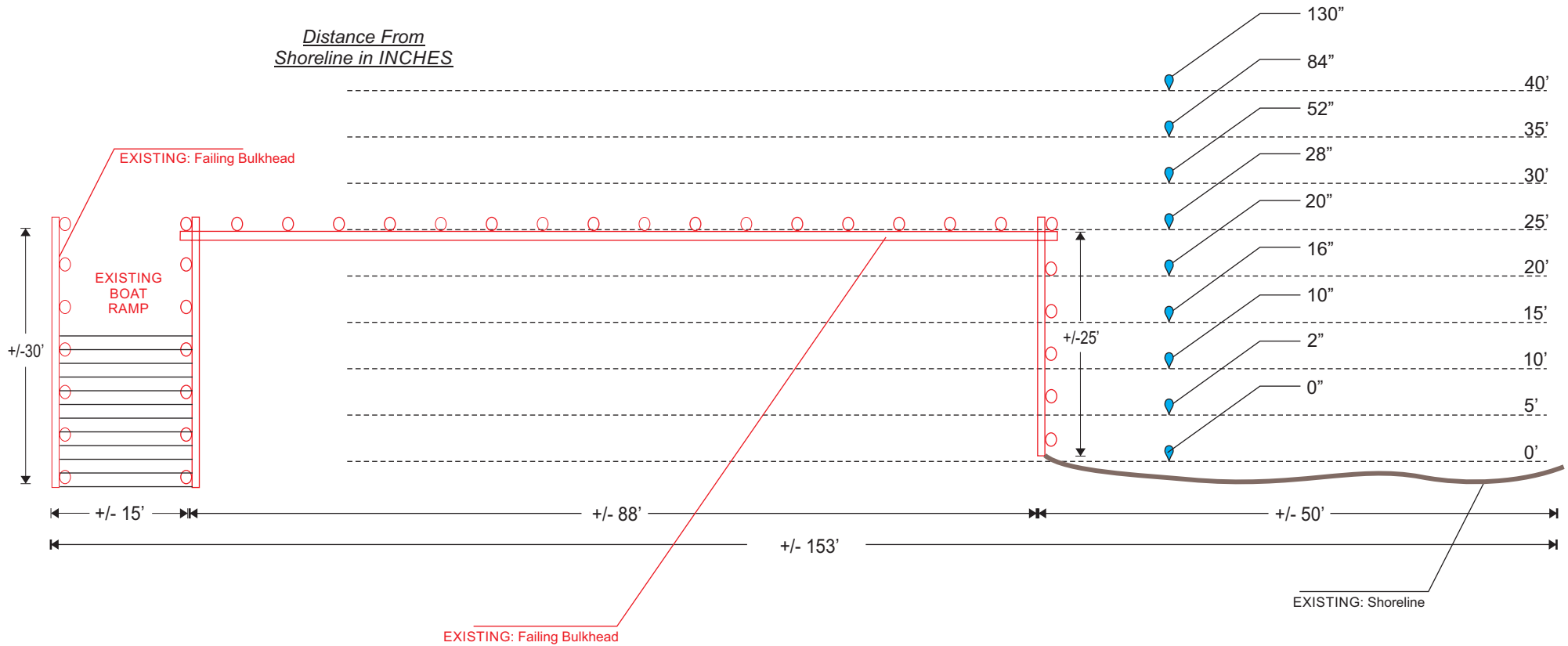



# Proposed Development - VIEW 01

<Down River - Amite River - Up River>  
225 Feet to Opposite Bank

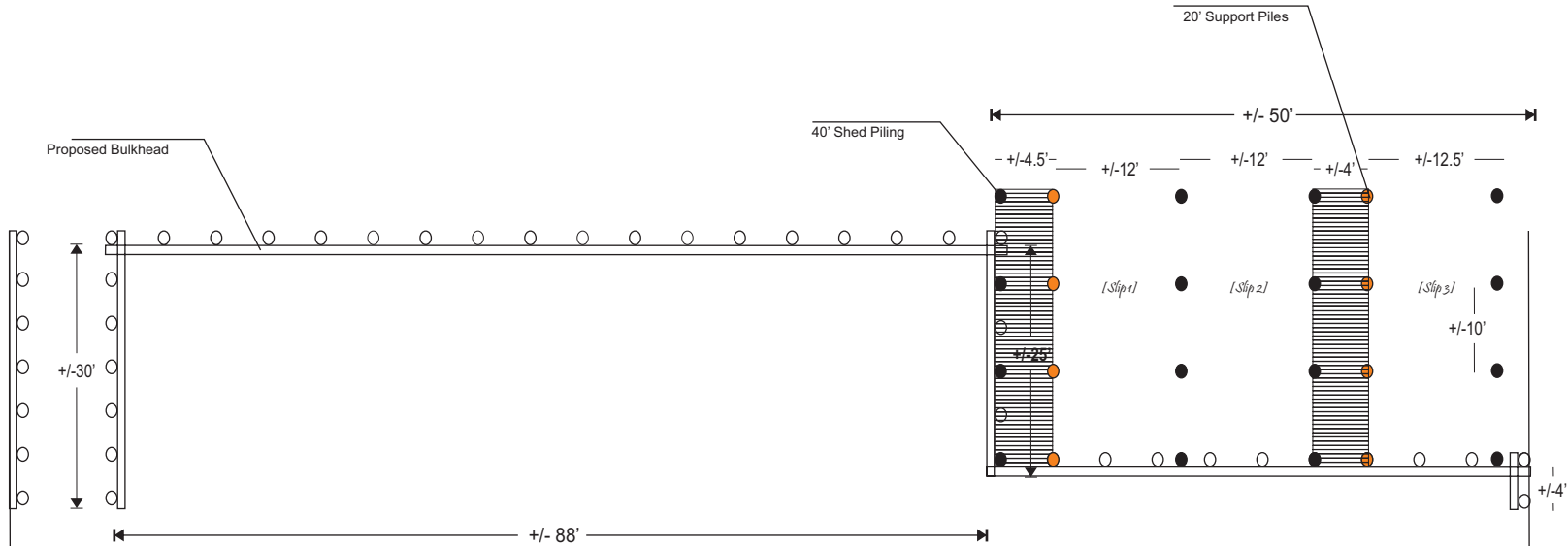

18417  
La Trace Rd..

+/- 153'

Gravel Drive

Mary Guillory  
18421 La Trace

Michael Corona  
18387 La Trace

Notes:  
New bulkhead wall to be installed adjacent to existing wall.



Sharp Bros Construction LLC  
Dennis Howze  
18417 La Trace Rd  
French Settlement, LA 70733  
Livingston Parish

# Proposed Development - VIEW 02 (Dredge & Fill)

<Down River - Amite River - Up River>  
225 Feet to Opposite Bank

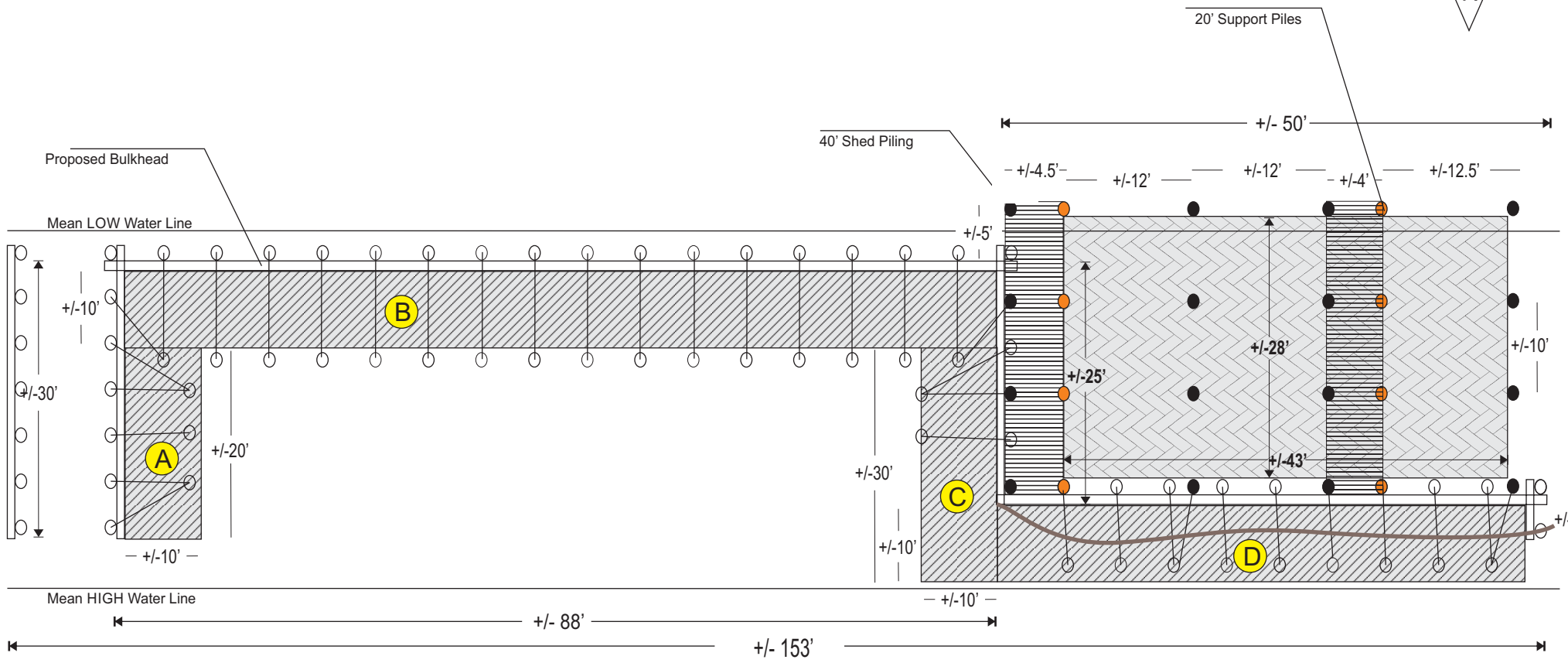

1. Wall to be tied back to installed foundation piling approximately 10' behind proposed bulkhead wall.
2. Slip Excavation = 96.5 Cubic Yards (43' x 28' x 52") divided by 2 = decline in grade from bulkhead outwards.
3. Total Backfill = 87.5 Cubic Yards  
87.5 Cubic Yards excavated onsite from slip; 9 Cubic Yards hauled offsite or spread onsite around home site.  
A: 7.5 Cubic Yards (10' x 20' x 12")  
B: 32 Cubic Yards (10' x 88' x 12")  
C: 11 Cubic Yards (10' x 30' x 12")  
D: 37 Cubic Yards (10' x 50' x 24")
4. All treated wood material.

Sharp Bros Construction LLC  
Dennis Howze  
18417 La Trace Rd  
French Settlement, LA 70733  
Livingston Parish

# Proposed Development - View 3 (Cross Section)

225 Feet to Opposite Bank

