

JOINT PUBLIC NOTICE

2 December 2019

United States Army
Corps of Engineers
New Orleans District
Regulatory Branch
7400 Leake Avenue
New Orleans, Louisiana 70118

(504) 862-2045
jennifer.e.burkett@usace.army.mil
Project Manager
Jennifer Burkett
Permit Application Number
MVN 2015-0887 EBB

State of Louisiana
Department of Environmental Quality
ATTN: Water Quality Certifications
Post Office Box 4313
Baton Rouge, Louisiana 70821-4313

(225) 219-3225
Project Manager
Elizabeth Hill
WQC Application Number
WQC 191127-02

Interested parties are hereby notified that a permit application has been received by the New Orleans District of the U.S. Army Corps of Engineers pursuant to: [X] Section 10 of the Rivers and Harbors Act of March 3, 1899 (30 Stat. 1151; 33 USC 403); and/or [X] Section 404 of the Clean Water Act (86 Stat. 816; 33 USC 1344).

Application has also been made to the Louisiana Department of Environmental Quality for a Water Quality Certification (WQC) in accordance with statutory authority contained in LRS30:2047 A(3), and provisions of Section 401 of the Clean Water Act (P.L.95-17).

LOADING DOCK ON MISSISSIPPI RIVER IN PLAQUEMINES PARISH

NAME OF APPLICANT: Plaquemines Holdings, LLC c/o Cali & LaPlace Engineers, LLC, Attention: Stephen P. Cali, at Post Office Box 7158, Metairie, Louisiana 70158.

LOCATION OF WORK: Right descending bank of the Mississippi River, approximately 61.9 miles above the Head of Passes, Belle Chasse, in Plaquemines Parish, Louisiana, as shown on the attached drawings.

Hydrologic Unit Code: 08090100; Lower Mississippi River – New Orleans
Latitude: 29.678889, Longitude: -89.966389

CHARACTER OF WORK: To install and maintain a 22' x 70' loading dock, four barge dolphins, a raised road, and piperack with 12" pipeline, all to serve an existing motor oil refining plant. A barge-mounted crane will be used for all work beyond the low water reference plane, and a land-based crane will be utilized for all other work. Project implementation will require fill of 0.01 acre of non-vegetated water bottom for riprap around pilings which penetrate the revetment, temporary impacts to 0.39 acres of wetlands for work areas, and permanent impacts to 0.21 acres of wetlands for road and pipeline right-of-ways. This permit was issued to CHS, Inc. on 20 June 2016, and compensatory mitigation requirements were fulfilled at that time. The current request is for a time extension to the permit as well as transfer to Plaquemines Holdings, LLC. No changes to the work are proposed; no additional mitigation is anticipated at this time.

The comment period for the Department of the Army Permit and the Louisiana Department of Environmental Quality WQC will close **30 days** from the date of this joint public notice. Written comments, including suggestions for modifications or objections to the proposed work, stating reasons thereof, are being solicited from anyone having interest in this permit and/or this WQC request and must be mailed so as to be received before or by the last day of the comment period. Letters concerning the Corps of Engineers permit application must reference the applicant's name and the Permit Application Number, and be mailed to the Corps of Engineers at the address above, **ATTENTION: REGULATORY BRANCH**. Similar letters concerning the Water Quality Certification must reference the applicant's name and the WQC Application number and be mailed to the Louisiana Department of Environmental Quality at the address above.

The application for this proposed project is on file with the Louisiana Department of Environmental Quality and may be examined during weekdays between 8:00 a.m. and 4:30 p.m. Copies may be obtained upon payment of costs of reproduction.

Corps of Engineers Permit Criteria

The decision whether to issue a permit will be based on an evaluation of the probable impacts, including cumulative impacts of the proposed activity on the public interest. That decision will reflect the national concern for both protection and utilization of important resources. The benefit which reasonably may be expected to accrue from the proposal must be balanced against its reasonably foreseeable detriments. All factors which may be relevant to the proposal will be considered including the cumulative effects thereof; among those are conservation, economics, aesthetics, general environmental concerns, wetlands, historic properties, fish and wildlife values, flood hazards, floodplain values, land use, navigation, shoreline erosion and accretion, recreation, water supply and conservation, water quality, energy needs, safety, food and fiber production, mineral needs, considerations of property ownership and, in general, the needs and welfare of the people.

The U.S. Army Corps of Engineers is soliciting comments from the public, federal, state, and local agencies and officials, Indian Tribes, and other interested parties in order to consider and evaluate the impacts of this proposed activity. Any comments received will be considered by the U.S. Army Corps of Engineers to determine whether to make, modify, condition, or deny a permit for this proposal. To make this decision, comments are used to assess impacts on endangered species, historic properties, water quality, general environmental effects, and other public interest factors listed above. Comments are used in the preparation of an Environmental Assessment and/or an Environmental Impact Statement pursuant to the National Environmental Policy Act. Comments are also used to determine the need for a public hearing and to determine the overall public interest of the proposed activity.

The New Orleans District is unaware of properties listed on the National Register of Historic Places near the proposed work. The possibility exists that the proposed work may damage or destroy presently unknown archeological, scientific, prehistorical, historical sites, or data. Issuance of this public notice solicits input from the State Archeologist and State Historic Preservation Officer regarding potential impacts to cultural resources.

Our initial finding is that the proposed work would neither affect any species listed as endangered by the U.S. Department of Commerce, nor affect any habitat designated as critical to the survival and recovery of such species.

The New Orleans District has determined that the 0.76 acre work footprint is located in waters known to be utilized by the pallid sturgeon (*Scaphirhynchus albus*) and concluded the activity is "not likely to adversely affect" this species based on the Standard Local Operating Procedure for Endangered Species in Louisiana (SLOPES), dated October 22, 2014, between the U.S. Army Corps of Engineers, New Orleans and U.S. Fish and Wildlife Service, Ecological Services Office.

This notice initiates the Essential Fish Habitat (EFH) consultation requirements of the Magnuson-Stevens Fishery Conservation and Management Act. The applicant's proposal would result in the destruction or alteration of **N/A** acre of **EFH** utilized by various life stages of red drum and penaeid shrimp. Our initial determination is that the proposed action would not have a substantial adverse impact on EFH or federally managed fisheries in the Gulf of Mexico. Our final determination relative to project impacts and the need for mitigation measures is subject to review by and coordination with the National Marine Fisheries Service.

-

If the proposed work involves deposits of dredged or fill material into navigable waters, the evaluation of the probable impacts will include the application of guidelines established by the Administrator of the Environmental Protection Agency. Also, a certification that the proposed activity will not violate applicable water quality standards will be required from the Department of Environmental Quality before a permit is issued.

The applicant has certified that the proposed activity described in the application complies with and will be conducted in a manner that is consistent with the Louisiana Coastal Resources Program. The Department of the Army permit will not be issued unless the applicant received approval or a waiver of the Coastal Use Permit by the Department of Natural Resources.

Any person may request, in writing, within the comment period specified in this notice, that a public hearing be held to consider this application. Requests for public hearings shall state, with particularity, the reasons for holding a public hearing.

You are requested to communicate the information contained in this notice to any other parties whom you deem likely to have interest in the matter.

Michael V. Farabee
Chief, Eastern Evaluation Section

Attachments

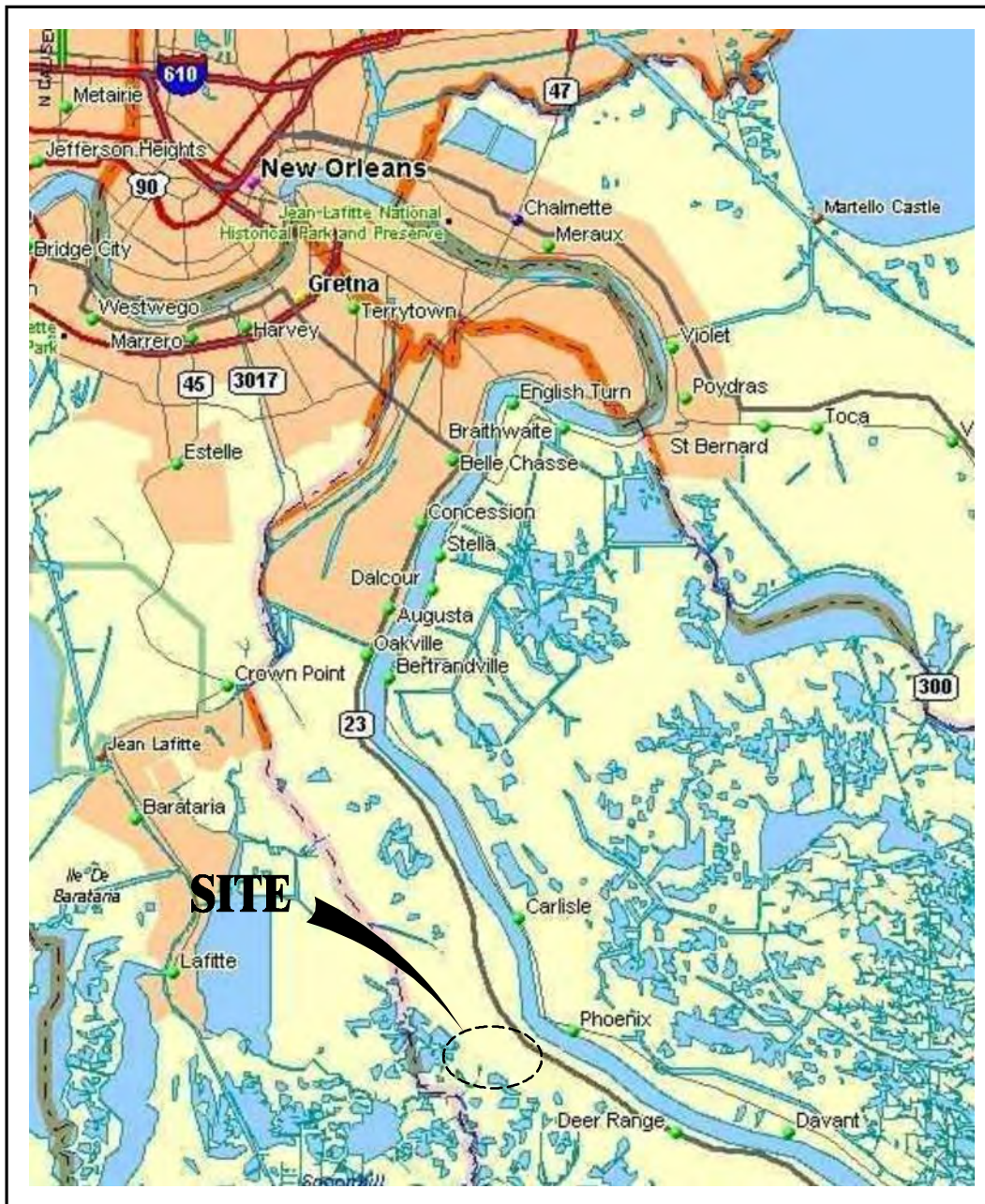

PARISH: PLAQUEMINES
 LATITUDE: 29°40'44" N
 LONGITUDE: 89°57'59" W

VICINITY MAP

SCALE: 1" = 5 MILES

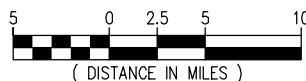

NOTES:

1. ALL STRUCTURES BUILT UNDER THE AUTHORIZATION AND CONDITIONS OF THIS PERMIT SHALL BE REMOVED FROM THE SITE WITHIN 120 DAYS OF ABANDONMENT OF THE FACILITIES FOR THE HEREIN PERMITTED USE, OR WHEN THESE STRUCTURES FALL INTO A STATE OF DISREPAIR SUCH THAT THEY CAN NO LONGER FUNCTION AS INTENDED. THIS CONDITION DOES NOT PRECLUDE THE NECESSITY FOR REVISING THE CURRENT PERMIT OF OBTAINING A SEPARATE COASTAL USE PERMIT, SHOULD ONE BE REQUIRED, FOR SUCH REMOVAL ACTIVITIES.
2. STRUCTURES MUST ALSO BE MARKED/LIGHTED IN ACCORDANCE WITH U.S. COAST GUARD REGULATIONS.
3. IN ORDER TO ENSURE THE SAFETY OF ALL PARTIES, THE PERMITTEE SHALL CONTACT THE LOUISIANA ONE CALL SYSTEM (1-800-272-3020) A MINIMUM OF 48 HOURS PRIOR TO THE COMMENCEMENT OF ANY EXCAVATION (DIGGING, DREDGING, JETTING, ETC.) OR DEMOLITION ACTIVITY.

9742-P01

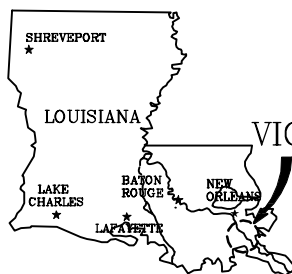

VICINITY

AREA MAP

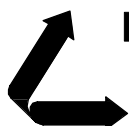

LANIER & ASSOCIATES

CONSULTING ENGINEERS
 INCORPORATED

NEW ORLEANS, LA · BEAUMONT, TX

MYRTLE GROVE

CHS, INC.

LOUISIANA

PROPOSED NEW BARGE DOCK

VICINITY MAP & AREA MAP

DATE MARCH '15
 DESIGN BNF
 DRAWN WGL
 CHECK CDF
 CONTRACT 9742
 SHEET No.

1 OF 13



OVERALL EXISTING SITE PLAN

SCALE: 1"=500'
GRAPHIC SCALE IN FEET

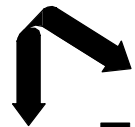
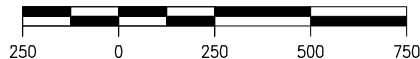

LANIER & ASSOCIATES
CONSULTING ENGINEERS
INCORPORATED

NEW ORLEANS, LA · BEAUMONT, TX

MORTLE GROVE

CHS, INC.

LOUISIANA

PROPOSED NEW BARGE DOCK
OVERALL EXISTING SITE PLAN

9742-P02

DATE: MARCH '15
DESIGN: BNF
DRAWN: WGL
CHECK: CDE
CONTRACT: 9742
SHEET NO. 2 OF 13

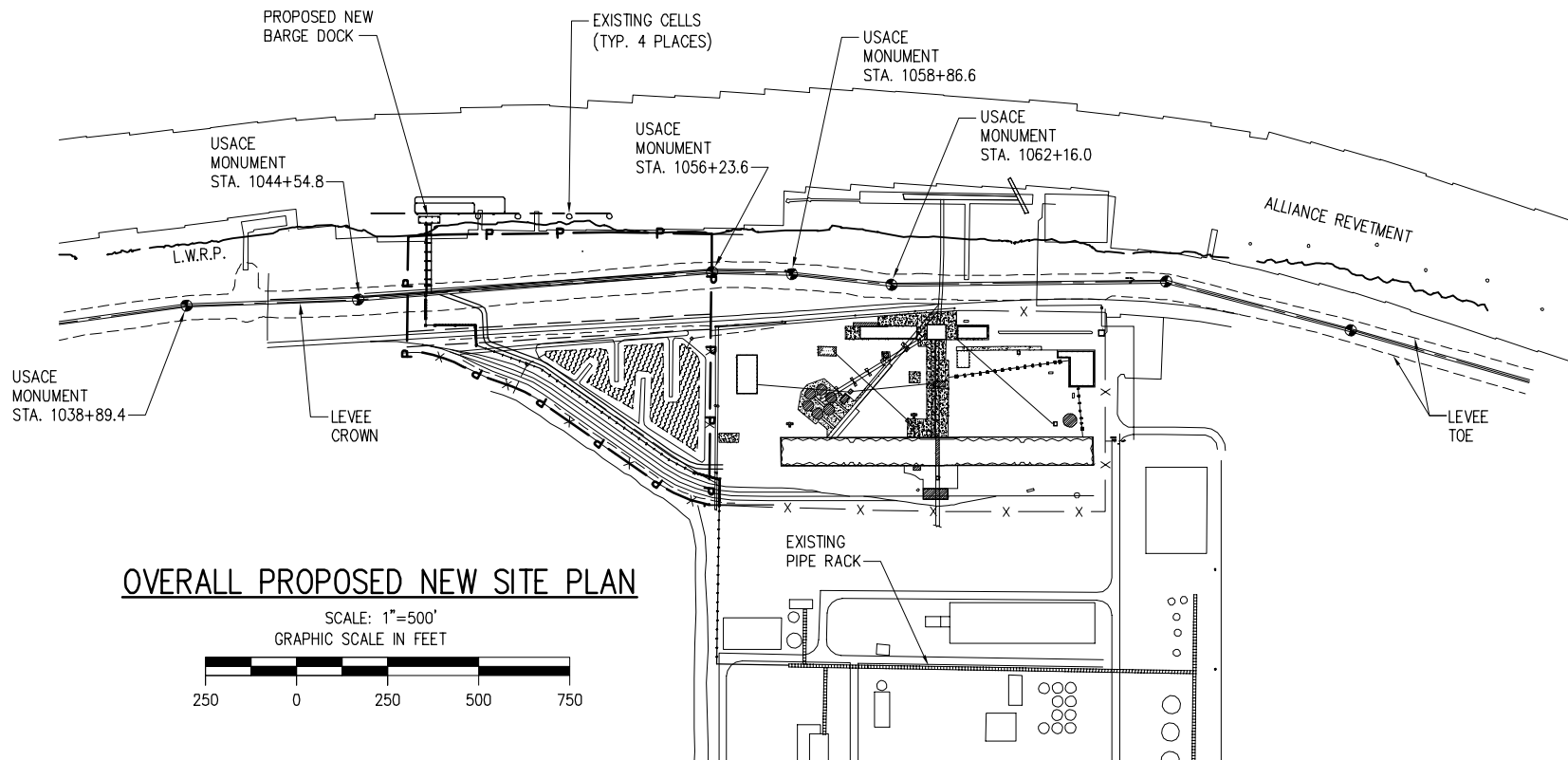

OVERALL PROPOSED NEW SITE PLAN

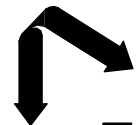
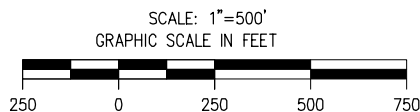

LANIER & ASSOCIATES
CONSULTING ENGINEERS
INCORPORATED

NEW ORLEANS, LA · BEAUMONT, TX

MRTLE GROVE

CHS, INC.

LOUISIANA

PROPOSED NEW BARGE DOCK

OVERALL PROPOSED NEW SITE PLAN

9742-P03

DATE MARCH '15
DESIGN BNF
DRAW WGL
CHECK CDE
CONTRACT 9742
SHEET NO.
3 OF **13**

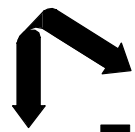

LANIER & ASSOCIATES
CONSULTING ENGINEERS
INCORPORATED

NEW ORLEANS, LA · BEAUMONT, TX

MRTLE GROVE

CHS, INC.

LOUISIANA

PROPOSED NEW BARGE DOCK

PROPOSED NEW MARINE SITE PLAN

9742-P04

DATE: MARCH '15

DESIGN: BNF

DRAWN: WGL

CHECK: CDE

CONTRACT: 9742

SHEET NO.

4 OF 13

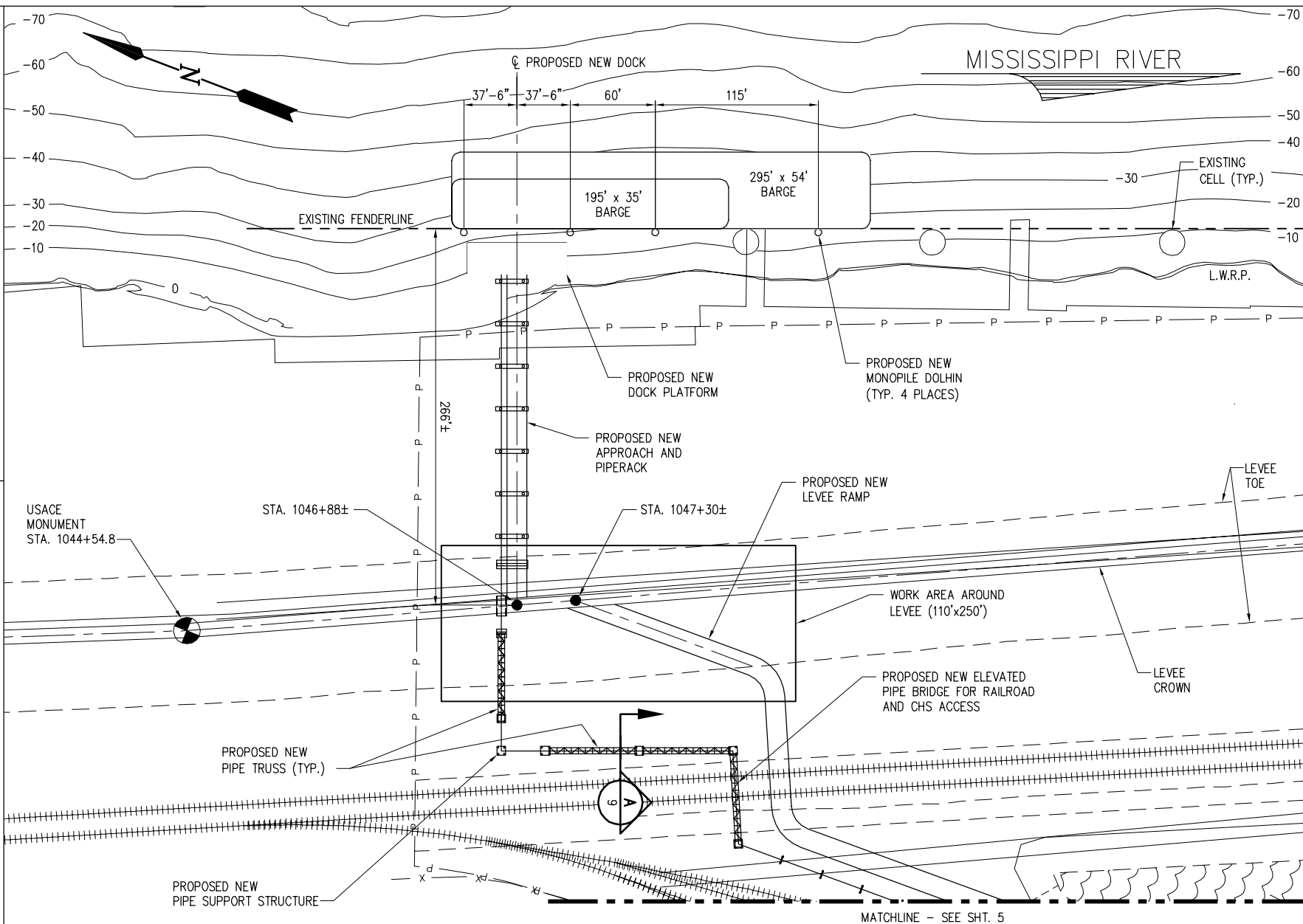

PROPOSED NEW MARINE SITE PLAN

SCALE: 1"=100'
GRAPHIC SCALE IN FEET

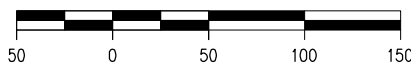

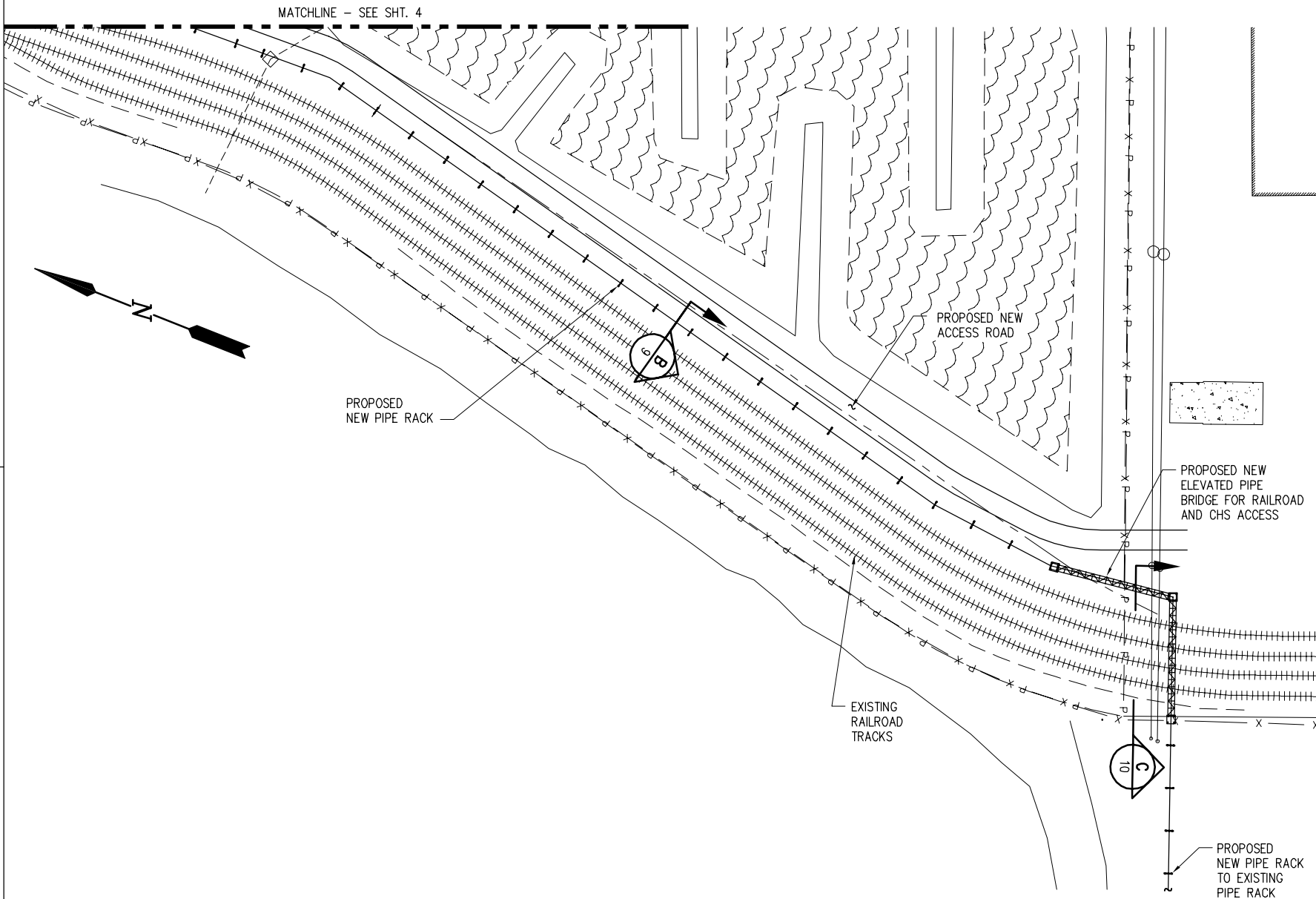

PROPOSED NEW PARTIAL LANDSIDE SITE PLAN

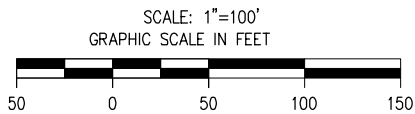

LANIER & ASSOCIATES
CONSULTING ENGINEERS
INCORPORATED
NEW ORLEANS, LA · BEAUMONT, TX

CHS, INC.
LOUISIANA
PROPOSED NEW BARGE DOCK
PROPOSED NEW PARTIAL LANDSIDE SITE PLAN

DATE: MARCH '15
DESIGN: BNF
DRAWN: WGL
CHECK: CDE
CONTRACT: 9742
SHEET NO. 5 OF 13

9742-P05

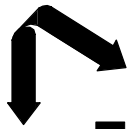

LANIER & ASSOCIATES
CONSULTING ENGINEERS
INCORPORATED
NEW ORLEANS, LA · BEAUMONT, TX

MRTLE GROVE

CHS, INC.

LOUISIANA

PROPOSED NEW BARGE DOCK

CROSS SECTION

DATE: MARCH '15
DESIGN: BNF
DRAWN: WGL
CHECK: CDE
CONTRACT: 9742
SHEET NO.
6 OF **12**

9742-P06

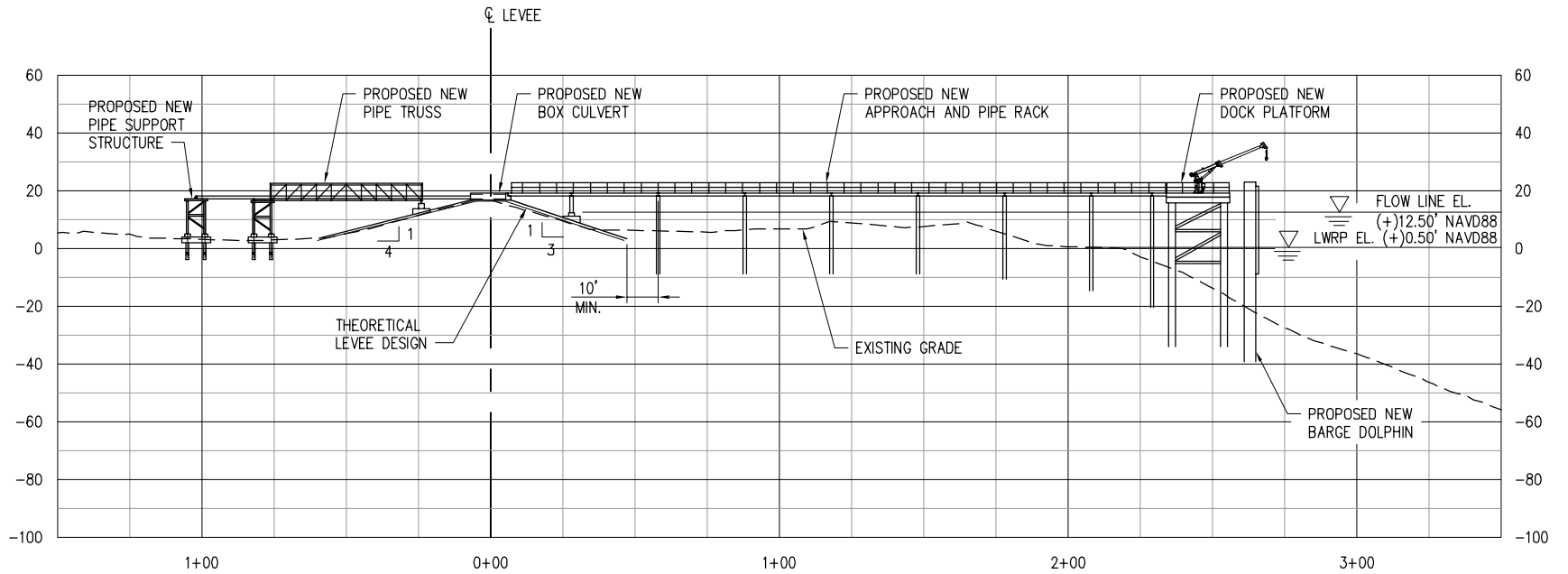

SECTION AT STA. 1046+88±

SCALE: 1" = 60"

GRAPHIC SCALE IN FEET

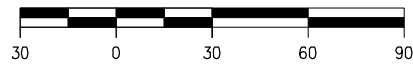

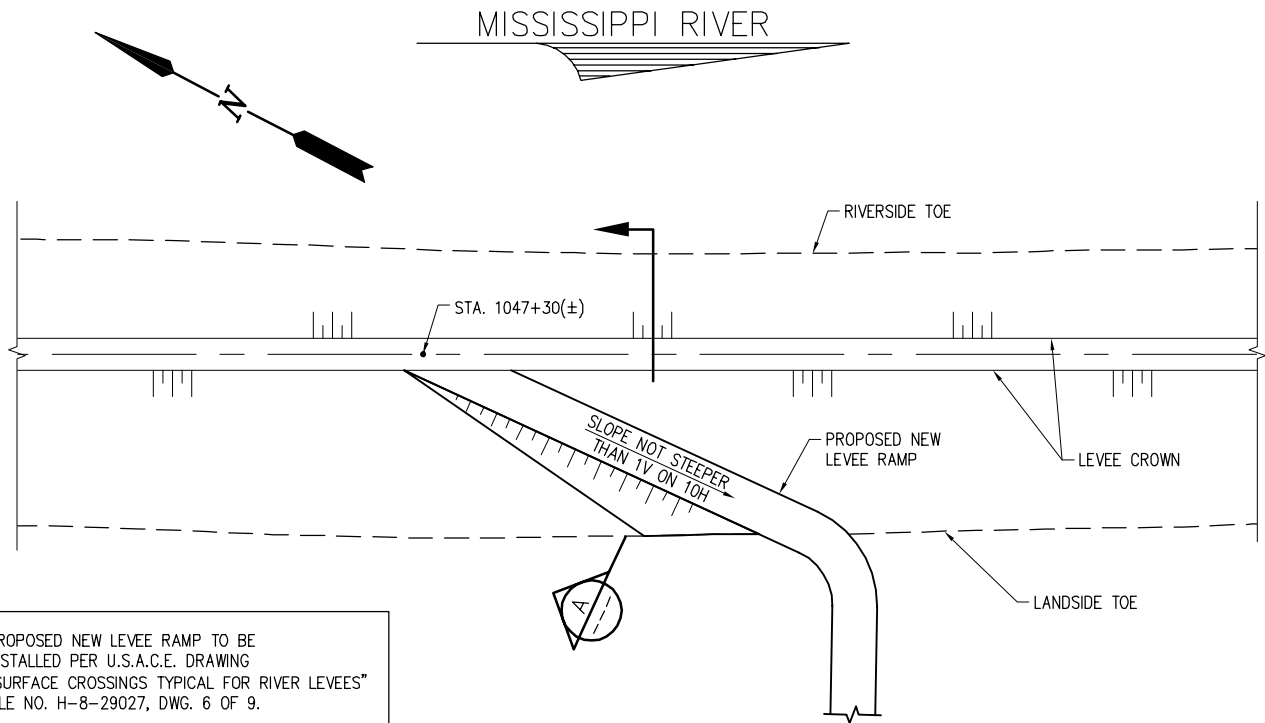

PROPOSED NEW LEVEE RAMP - PLAN

SCALE: 1"=60'

GRAPHIC SCALE IN FEET

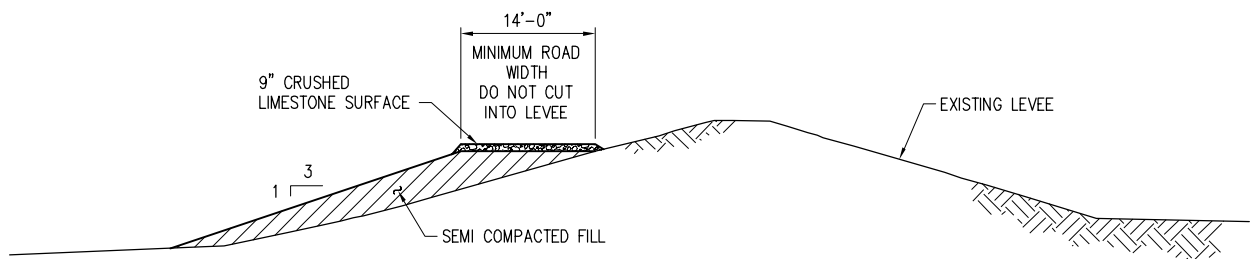
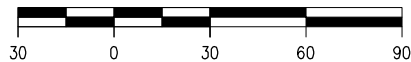

SECTION

SCALE: 1"=20'

GRAPHIC SCALE IN FEET

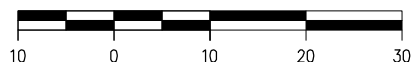

9742-P07

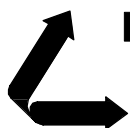

LANIER & ASSOCIATES

CONSULTING ENGINEERS
INCORPORATED

NEW ORLEANS, LA · BEAUMONT, TX

MYRTLE GROVE

CHS, INC.

LOUISIANA

**PROPOSED NEW BARGE DOCK
PROPOSED NEW LEVEE RAMP
@ STA. 1047+30 (±)**

DATE MARCH '15
DESIGN BNF
DRAWN WGL
CHECK CDE
CONTRACT 9742
SHEET No.

7 OF **13**

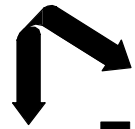

LANIER & ASSOCIATES
CONSULTING ENGINEERS
INCORPORATED
NEW ORLEANS, LA · BEAUMONT, TX

NEW ORLEANS

CHS, INC.

LOUISIANA

PROPOSED NEW BARGE DOCK
PROPOSED NEW BOX CULVERT

DATE: MARCH '15
DESIGN: BNF
DRAWN: CAP
CHECK: CDE
CONTRACT: 9742
SHEET NO. 8 OF 13

9742-P08

PROPOSED NEW CONCRETE BOX CULVERT
TO BE INSTALLED PER U.S.A.C.E. DRAWING
"SURFACE CROSSINGS TYPICAL FOR RIVER LEVEES"
FILE NO. H-8-29027, DWG. 4 OF 9.

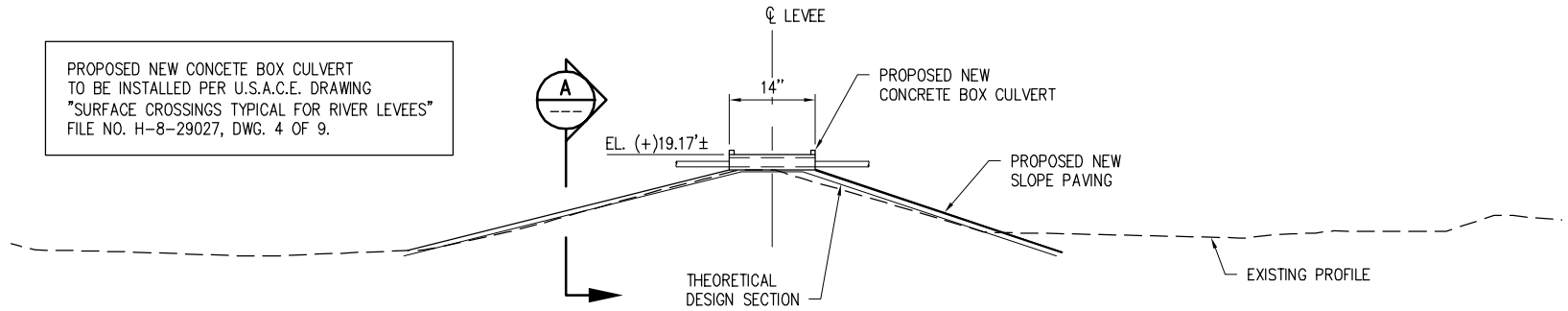

SECTION AT BOX CULVERT

SCALE: 1" = 30"

GRAPHIC SCALE IN FEET

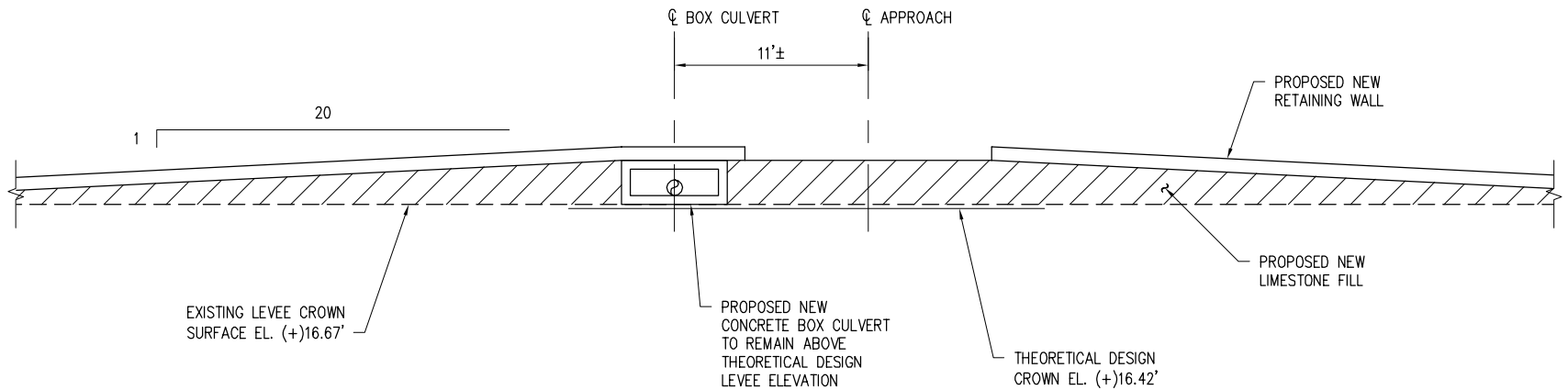
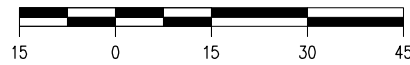

SECTION

SCALE: 1" = 10'

GRAPHIC SCALE IN FEET

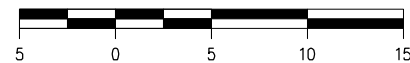

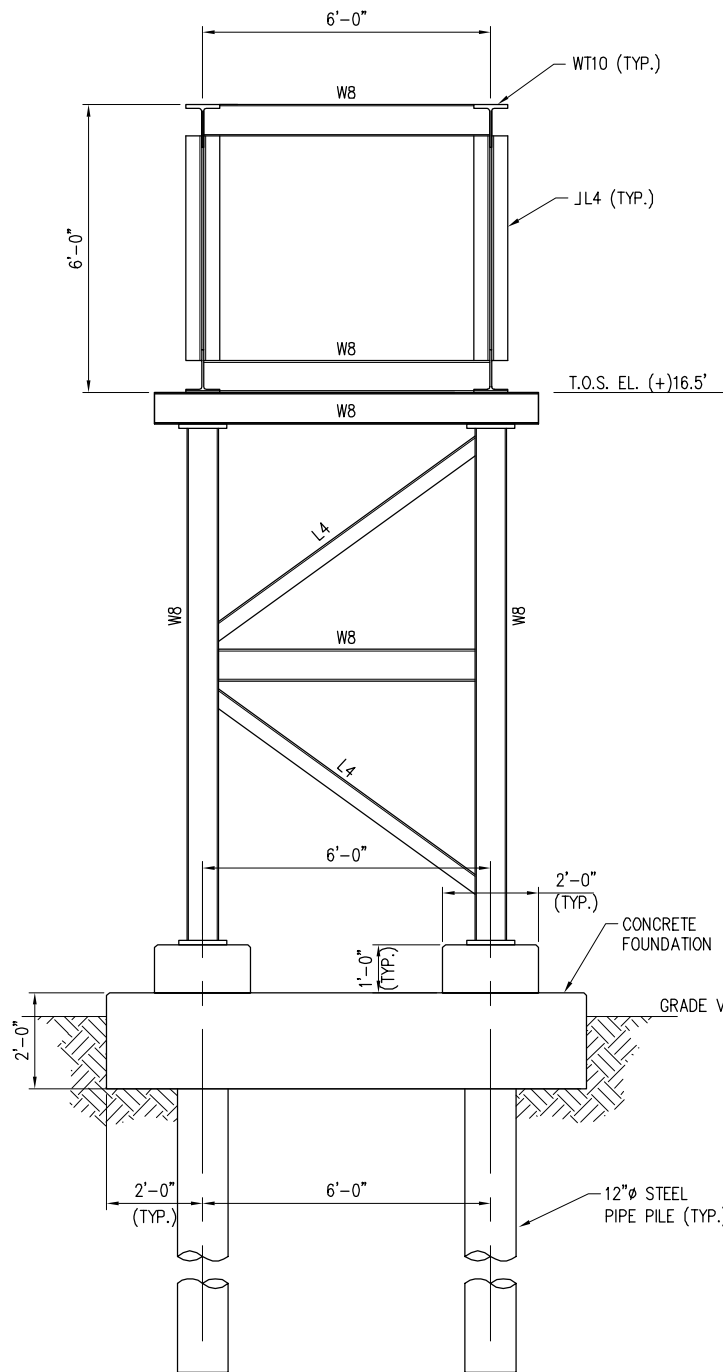

SECTION **A**
SCALE: 1/4"=1'-0"

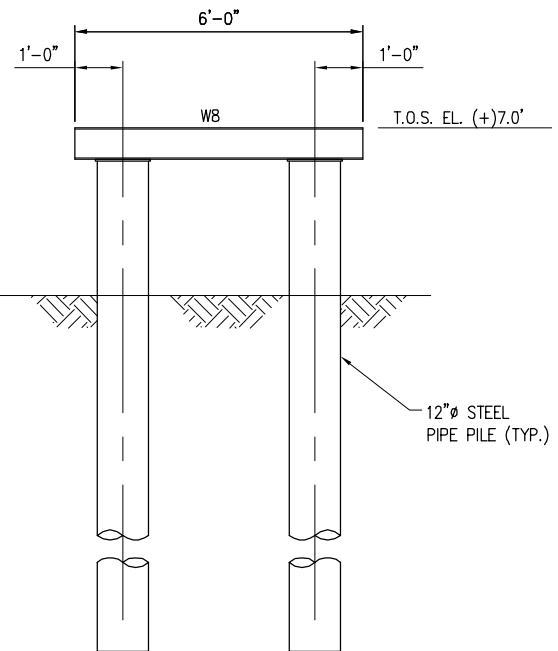

TYPICAL SECTION **B**
SCALE: 1/4"=1'-0"

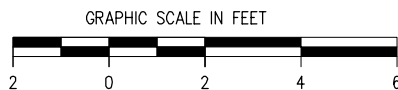

9742-P09

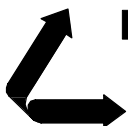

LANIER & ASSOCIATES
CONSULTING ENGINEERS
INCORPORATED
NEW ORLEANS, LA · BEAUMONT, TX

MYRTLE GROVE

CHS, INC.

LOUISIANA

PROPOSED NEW BARGE DOCK

SECTIONS

DATE MARCH '15
DESIGN BNF
DRAWN WGL
CHECK CDE
CONTRACT 9742
SHEET No.
9 OF **13**

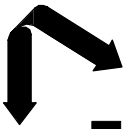

LANIER & ASSOCIATES
CONSULTING ENGINEERS
INCORPORATED

NEW ORLEANS, LA · BEAUMONT, TX

MYRTLE GROVE

CHS, INC.

LOUISIANA

PROPOSED NEW BARGE DOCK

TRUSS CROSSING AT RAIL ROAD

DATE: MARCH '15

DESIGN: BNF

DRAWN: WGL

CHECK: CDE

CONTRACT: 9742

SHEET NO.

10 OF 13

9742-P10

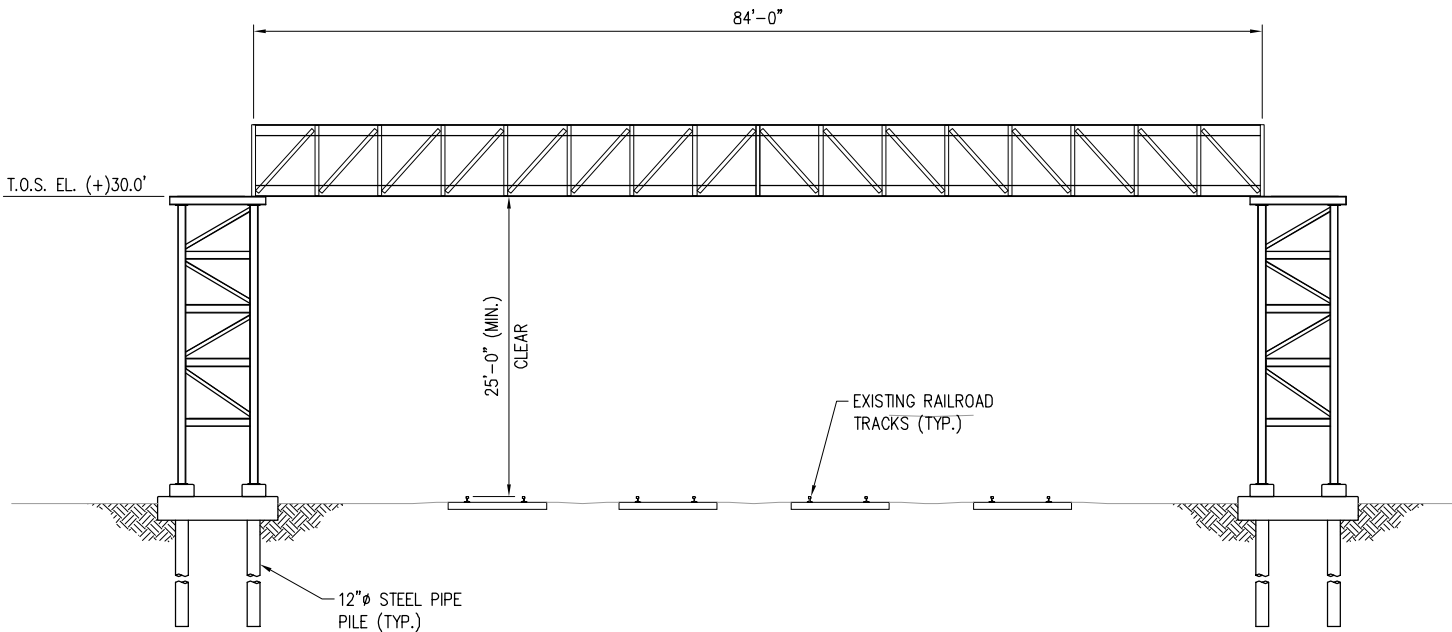

SECTION

SCALE: 1/16"=1'-0"



GRAPHIC SCALE IN FEET



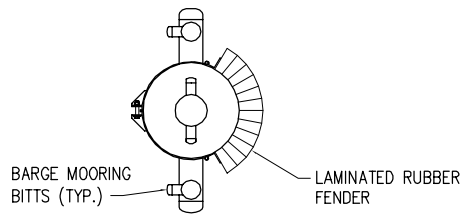

BARGE DOLPHIN PLAN

N.T.S.

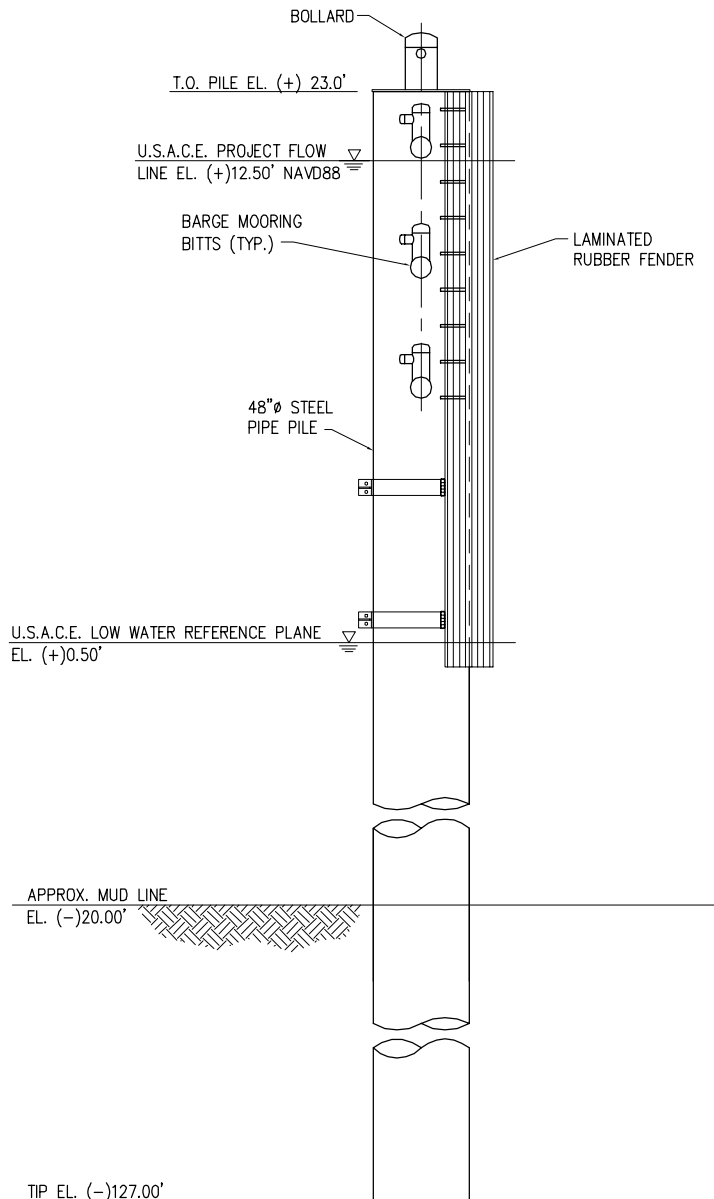

BARGE DOLPHIN ELEVATION

N.T.S.
(4 REQ'D)

9742-P11

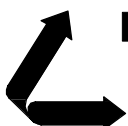

LANIER & ASSOCIATES

CONSULTING ENGINEERS
INCORPORATED

NEW ORLEANS, LA · BEAUMONT, TX

MYRTLE GROVE

CHS, INC.

LOUISIANA

PROPOSED NEW BARGE DOCK

PROPOSED NEW BARGE DOLPHIN

DATE MARCH '15
DESIGN BNF
DRAWN WGL
CHECK CDE
CONTRACT 9742
SHEET No.

11 OF 13

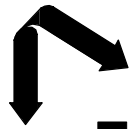

LANIER & ASSOCIATES
CONSULTING ENGINEERS
INCORPORATED

NEW ORLEANS, LA · BEAUMONT, TX

MRTLE GROVE

CHS, INC.

LOUISIANA

PROPOSED NEW BARGE DOCK
REVELMENT REPAIR PROCEDURES

DATE: MARCH '15
DESIGN: BNF
DRAWN: WGL
CHECK: CDE
CONTRACT: 9742
SHEET NO. 12 OF 13

9742-P12

PILE

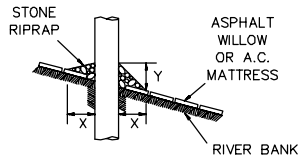

CAISSON

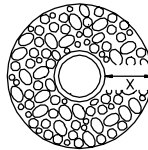
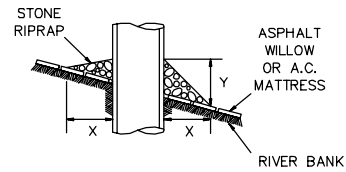

SPUD PILE (BUOY AND ANCHOR CHAIN)

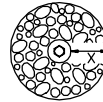
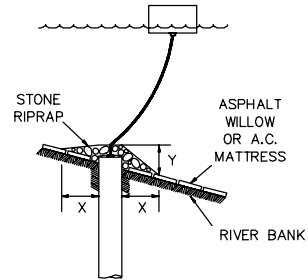

PILE CLUSTER

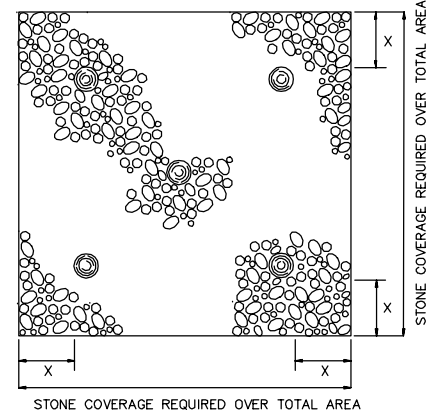
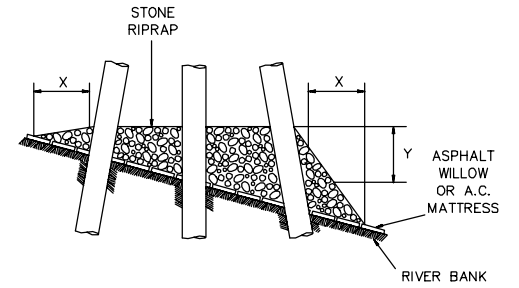

NOTES:

1. SIZE OF RIPRAP TO VARY BETWEEN 6 POUNDS AND 125 POUNDS WITH 40 PERCENT TO 60 PERCENT OF THE STONE WITHIN THE RANGE OF 25 POUNDS TO 75 POUNDS.
2. WHEN PENETRATING THE UPPER BANK PAVING IN A REVELMENT AREA WITH PILES, CAISSONS AND/OR PILE CLUSTERS, A 10 INCH THICK RIPRAP STONE LAYER SHALL BE PLACED OVER ALL AREAS WHERE THE BANK PAVING IS DISTURBED BY DRIVING OPERATIONS.
3. WHEN USING AN ANCHOR CHAIN AND BUOY SYSTEM, THE ANCHOR CHAIN MUST BE ATTACHED AT THE TOP OF THE PILE TO MINIMIZE REVELMENT DAMAGE.

DEPTH OF WATER IN FEET AT POINT OF PENETRATION AT TIME OF STONE PLACEMENT	DIMENSIONS IN FEET FOR PROTECTION AREA REQUIRED							
	PILE		CAISSON		SPUD PILE (BUOY AND ANCHOR CHAIN)		PILE CLUSTER	
	X	Y	X	Y	X	Y	X	Y
1' - 10'	3	1.5	5	2			3	1
11' - 40'	5	2	8	3	7	3	6	2
41' - 60'	8	3	12	4	12	4	10	3

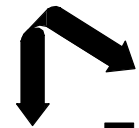

LANIER & ASSOCIATES
CONSULTING ENGINEERS
INCORPORATED
NEW ORLEANS, LA · BEAUMONT, TX

MRTLE GROVE

CHS, INC.

LOUISIANA

PROPOSED NEW BARGE DOCK
PROPOSED WETLANDS IMPACTS
STA. 1046+88 - MP 62, RDB

DATE: MARCH '15
DESIGN: BNF
DRAWN: WGL
CHECK: CDE
CONTRACT: 9742
SHEET NO. 13 OF 13

9742-P13

