



DEPARTMENT OF THE ARMY
U.S. ARMY CORPS OF ENGINEERS, NEW ORLEANS DISTRICT
7400 LEAKE AVENUE
NEW ORLEANS, LOUISIANA 70118-3651

August 29, 2022

Project Manager:
Stephanie Castaing
(504) 862-1564
Stephanie.L.Castaing@usace.army.mil
Permit Application Number: MVN-2015-1154-EPP

PUBLIC NOTICE

Interested parties are hereby notified that a permit application has been received by the New Orleans District of the U.S. Army Corps of Engineers pursuant to: [X] Section 10 of the Rivers and Harbors Act of March 3, 1899 (30 Stat. 1151; 33 USC 403); and/or [X] Section 404 of the Clean Water Act (86 Stat. 816; 33 USC 1344).

AFTER-THE-FACT FOR MAINTENANCE DREDGING OF EXISTING SLIPS AND INSTALL AND MAINTAIN BREAKWATERS AND PILES IN JEFFERSON PARISH

NAME OF APPLICANT: Amaris Isle Homeowners Association, c/o Picciola & Associates, Inc., Attn: Joseph Picciola, Post Office Box 687, Cut Off, Louisiana 70345 or joe@picciola.com

LOCATION OF WORK: At approximately Latitude: 29.263522, Longitude: -89.959806, at Amaris Isle Plantation Subdivision, in Grand Isle, Louisiana, in Jefferson Parish, as shown on the enclosed drawings.

Hydrologic Unit Code: 08090301 (East Central Louisiana Coastal)

The work described below was partially completed prior to obtaining a Department of the Army permit and was in violation of Section 301 of the Clean Water Act. All legal issues concerning the unauthorized work have since been deferred.

CHARACTER OF WORK: Maintenance dredge existing slips within the Amaris Isle Plantation Waterfront Development and deposit fill at Mud Island/Isle of Pelicans and install and maintain stone breakwaters, timber piles, and timber barrier. The project as proposed would directly impact 15.81 acres of wetlands and/or waterbottoms. Unauthorized activities consist of approximately 0.24 acre of dredged material, 0.65 acre of spoil placement, 0.25 acre of stone breakwater, 17 single piles, 1 (3) pile, and 42 feet of timber barrier. The applicant proposed to contract with an approved mitigation bank to offset the adverse impact to jurisdictional wetlands.

The applicant may be required to restore the site fully or partially to pre-project conditions if issuance of a permit is determined to be contrary to the public interest.

The comment period for the Department of the Army Permit will close 20 days from the date of this public notice. Written comments, including suggestions for modifications or objections to the proposed work, stating reasons thereof, are being solicited from anyone having interest in this permit and must be mailed so as to be received before or by the last day of the comment period. Letters and/or comments concerning the subject permit application must reference the Applicant's Name and the Permit Application Number and can be preferably emailed to the Corps of Engineers project manager listed above or forwarded to the Corps of Engineers at the address above, ATTENTION: REGULATORY DIVISION, RGE, Stephanie Castaing.

Individuals or parties may request an extension of time in which to comment on the proposed work by writing or e-mailing the Corps of Engineers Project Manager listed above. Any request must be specific and substantively supportive of the requested extension and received by this office prior to the end of the initial comment period. The Branch Chief will review the request and the requestor will be promptly notified of the decision to grant or deny the request. If granted, the time extension will be continuous to the initial comment period and inclusive of the initial comment period, will not exceed a total of 30 calendar days.

Corps of Engineers Permit Criteria

The decision whether to issue a permit will be based on an evaluation of the probable impacts, including cumulative impacts of the proposed activity on the public interest. That decision will reflect the national concern for both protection and utilization of important resources. The benefit which reasonably may be expected to accrue from the proposal must be balanced against its reasonably foreseeable detriments. All factors which may be relevant to the proposal will be considered including the cumulative effects thereof; among those are conservation, economics, aesthetics, general environmental concerns, wetlands, historic properties, fish and wildlife values, flood hazards, floodplain values, land use, navigation, shoreline erosion and accretion, recreation, water supply and conservation, water quality, energy needs, safety, food and fiber production, mineral needs, considerations of property ownership and, in general, the needs and welfare of the people.

The U.S. Army Corps of Engineers is soliciting comments from the public, federal, state, and local agencies and officials, Indian Tribes, and other interested parties to consider and evaluate the impacts of this proposed activity. Any comments received will be considered by the U.S. Army Corps of Engineers to determine whether to make, modify, condition, or deny a permit for this proposal. To make this decision, comments are used to assess impacts on endangered species, historic properties, water quality, general environmental effects, and other public interest factors listed above. Comments are used in the preparation of an Environmental Assessment and/or an Environmental Impact Statement pursuant to the National Environmental Policy Act. Comments are also used to determine the need for a public hearing and to determine the overall public interest of the proposed activity.

The New Orleans District is unaware of any properties listed on the National Register of Historic Places near the proposed work. The possibility exists that the proposed work may damage or destroy presently unknown archeological, scientific, prehistorical, historical sites, or data. Issuance of this public notice solicits input from the State Archeologist and State Historic Preservation Officer regarding potential impacts to cultural resources.

The New Orleans District has determined that the activity is not likely to adversely affect the Eastern Black Rail and the West Indian Manatee based on the Information & Planning Consultation for Endangered Species in Louisiana (IPaC), dated January 27, 2020, between the U.S. Army Corps of Engineers, New Orleans and U.S. Fish and Wildlife Service, Ecological Services Office.

Our initial finding is that the proposed work is Not Likely to Adversely Affect any species listed as endangered by the U.S. Departments of Commerce, nor affect any habitat designated as critical to the survival and recovery of such species.

This notice initiates the Essential Fish Habitat (EFH) consultation requirements of the Magnuson-Stevens Fishery Conservation and Management Act. The applicant's proposal would result in the destruction or alteration of 15.8 acres of EFH utilized by various life stages of red drum and penaeid shrimp. Our initial determination is that the proposed action would have no adverse impact on EFH or federally managed fisheries in the Gulf of Mexico. Our final determination relative to project impacts and the need for mitigation measures is subject to review by and coordination with the National Marine Fisheries Service.

If the proposed work involves deposits of dredged or fill material into navigable waters, the evaluation of the probable impacts will include the application of guidelines established by the Administrator of the Environmental Protection Agency. Also, a certification that the proposed activity will not violate applicable water quality standards will be required from the Department of Environmental Quality, Water Quality Certifications, before a permit is issued.

Any person may request, in writing, within the comment period specified in this notice, that a public hearing be held to consider this application. Requests for public hearings shall state, with particularity, the reasons for holding a public hearing.

The applicant has certified that the proposed activity described in the application complies with and will be conducted in a manner that is consistent with the Louisiana Coastal Resources Program. The Department of the Army permit will not be issued unless the applicant received approval or a waiver of the Coastal Use Permit by the Department of Natural Resources.

You are requested to communicate the information contained in this notice to any other parties whom you deem likely to have interest in the matter.

Brad P. LaBorde
Chief, Eastern Evaluation Branch

E:\21-DIR\08132101 Catering Cajun LLC - Permit on Grand Isle\ACAD\CURRENT\Permit_Rev2_01-27-2021\01_TITLE.dwg, 01-SHT, 1/27/2022 9:18:33 AM, leeg

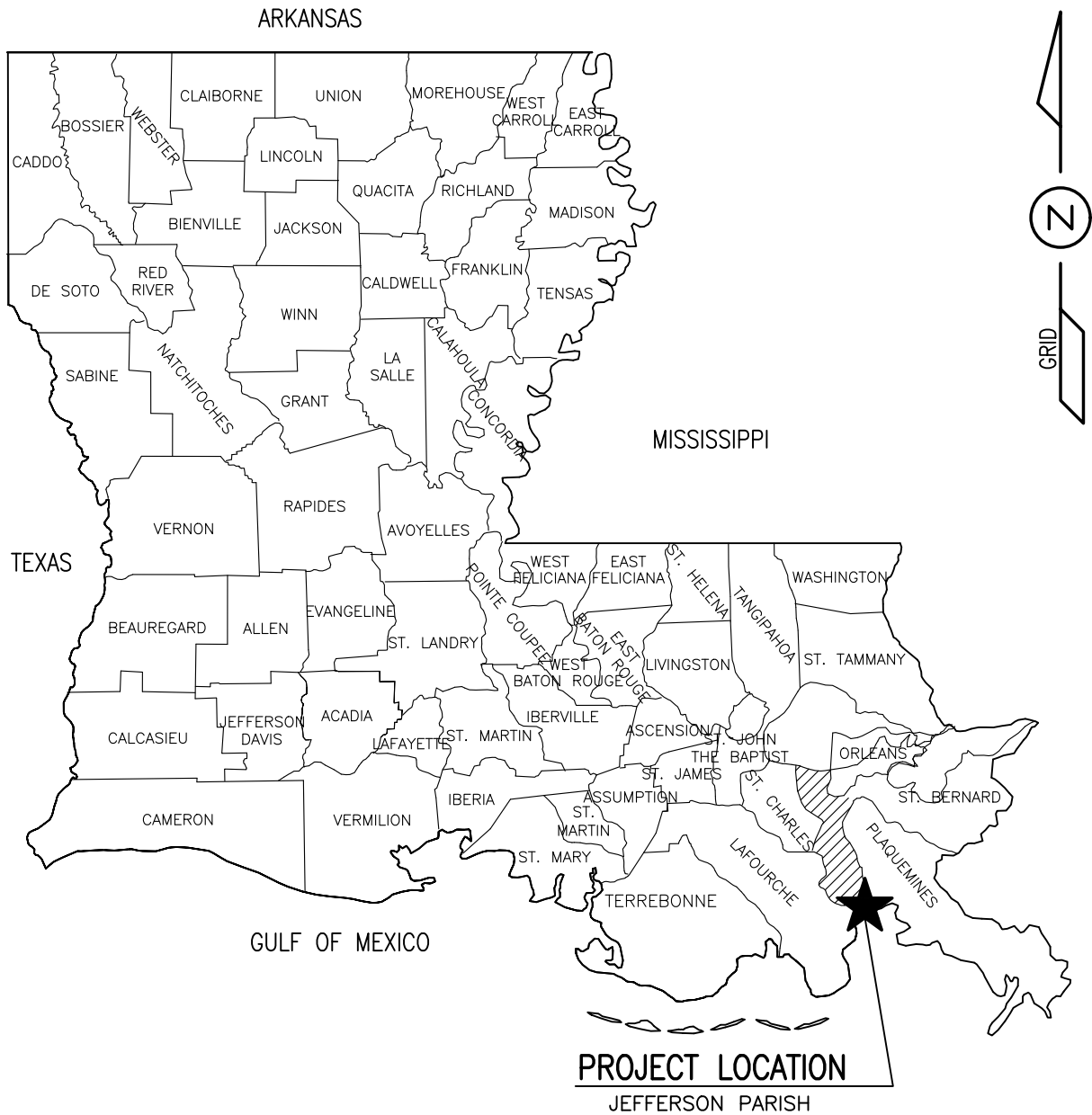

STATE VICINITY MAP
NOT TO SCALE

MAINTENANCE DREDGE PERMIT

WORK TO BE PERFORMED: MAINTENANCE DREDGING OF AMARIS ISLE PLANTATION WATERFRONT DEVELOPMENT
APPLIED BY: AMARIS ISLE HOMEOWNERS ASSOCIATION
AREA: EAST END OF GRAND ISLE, JEFFERSON PARISH, LOUISIANA



PICCIOLA & ASSOCIATES, INC.

CIVIL ENGINEERS NAVAL ARCHITECTS
LAND SURVEYORS MARINE ENGINEERS

P.O. BOX 687
CUT OFF, LOUISIANA 70345
(866) 632-5786

JN: 0813-2101

REV3: 01/27/2022
DATE: 12/22/2021

SHEET 1 OF 8



BARATARIA PASS QUAD. MAP

LOCAL VICINITY MAP

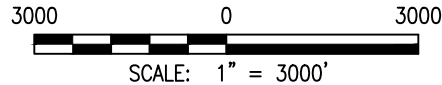

WORK TO BE PERFORMED: MAINTENANCE DREDGING OF AMARIS ISLE PLANTATION WATERFRONT DEVELOPMENT

APPLIED BY: AMARIS ISLE HOMEOWNERS ASSOCIATION

AREA: EAST END OF GRAND ISLE, JEFFERSON PARISH, LOUISIANA

PROJECT IS LOCATED IN SECTION 5, T-18-S, R-21-E

LATITUDE = 29° 15' 49.014" N
 LONGITUDE = 89° 57' 35.744" W
 LAT. & LON. IS LOCATED AT THE C/L INTERSECTION OF FORT LIVINGSTON INLET & BAYOU RIGAUD.



PICCIOLA & ASSOCIATES, INC.

CIVIL ENGINEERS NAVAL ARCHITECTS
 LAND SURVEYORS MARINE ENGINEERS

P.O. BOX 687
 CUT OFF, LOUISIANA 70345
 (866) 632-5786

JN: 0813-2101

REV1: 01/13/2022
 DATE: 12/22/2021

SHEET 2 OF 8

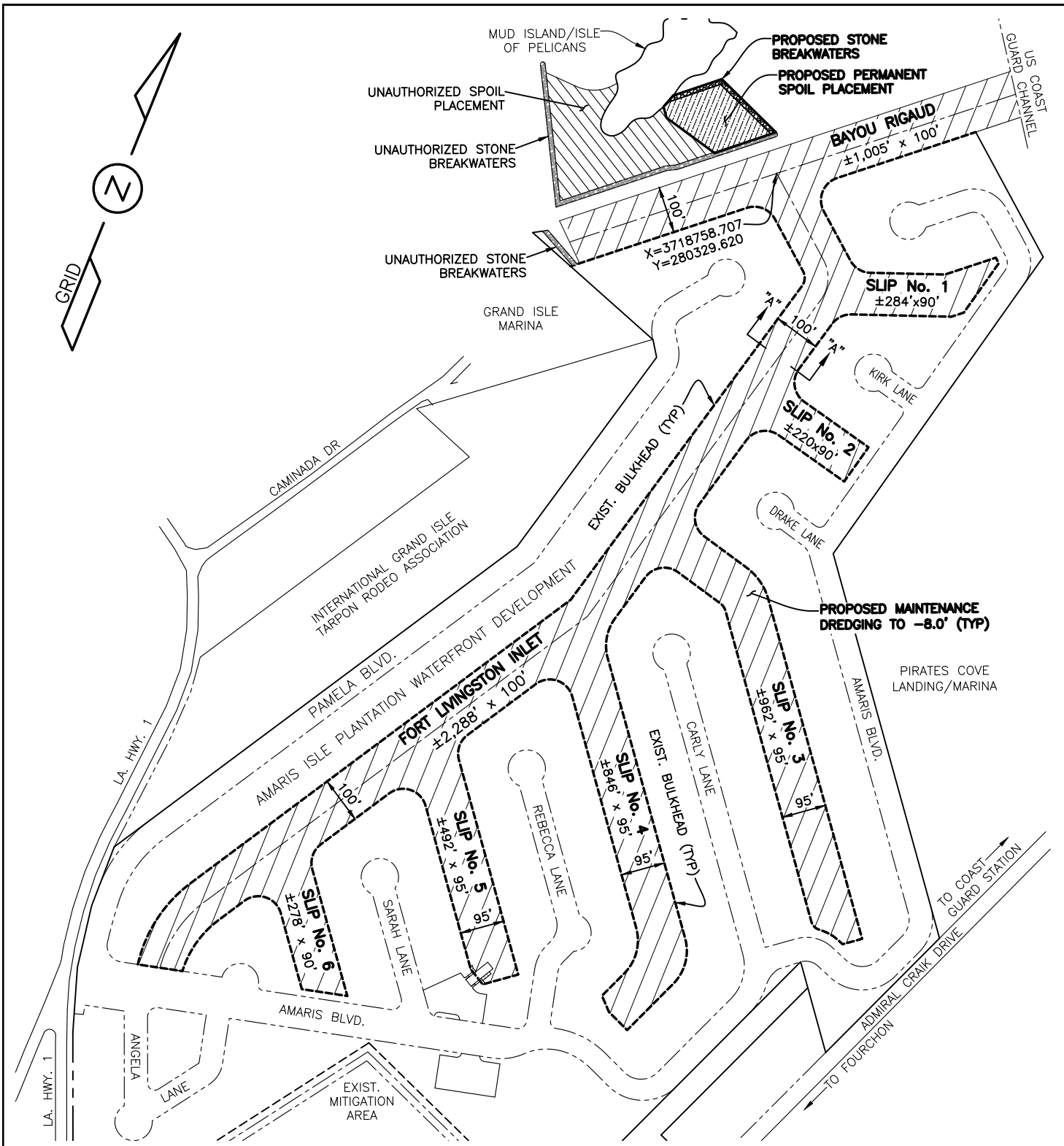

E:\21-DIR\08132101 Catering Cajun LLC - Permit on Grand Isle\ACAD\CURRENT\Permit_Rev1_01-13-2021\03_OVERALL SITE PLAN.dwg, 03_OVERALL SITE PLAN, 1/13/2022 11:38:11 AM, leeg



OVERALL SITE PLAN

NOTES:

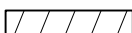
1. MATERIAL GENERATED FROM MAINTENANCE DREDGING SHALL BE DEPOSITED AND USED AS PERMANENT SPOIL PLACEMENT.
2. SEE SHEETS 4 THRU 8 FOR MORE INFORMATION ON PROPOSED AND UNAUTHORIZED ITEMS.

TOTAL LENGTH OF PROPOSED MAINTENANCE DREDGING: ±6,375'	
	PROPOSED MAINTENANCE DREDGING TO EL. -8.0' ±14.44 AC., ±23,300 CU YD OVER 10 YEARS
	PROPOSED SPOIL PLACEMENT: ±0.43 AC.
	PROPOSED STONE BREAKWATERS: ±0.06 AC.



PICCIOLA & ASSOCIATES, INC.

CIVIL ENGINEERS NAVAL ARCHITECTS
LAND SURVEYORS MARINE ENGINEERS

P.O. BOX 687
CUT OFF, LOUISIANA 70345
(866) 632-9786

JN: 0813-2101

REV1: 01/13/2022
DATE: 12/22/2021

SHEET 3 OF 8



PICCIOLA & ASSOCIATES, INC.

CIVIL ENGINEERS
LAND SURVEYORS

NAVAL ARCHITECTS
MARINE ENGINEERS

P.O. BOX 887
CUT OFF, LOUISIANA 70345
(885) 632-7786

JN: 0813-2101

REV3: 01/27/2022

DATE: 12/22/2021

SHEET 4 OF 8

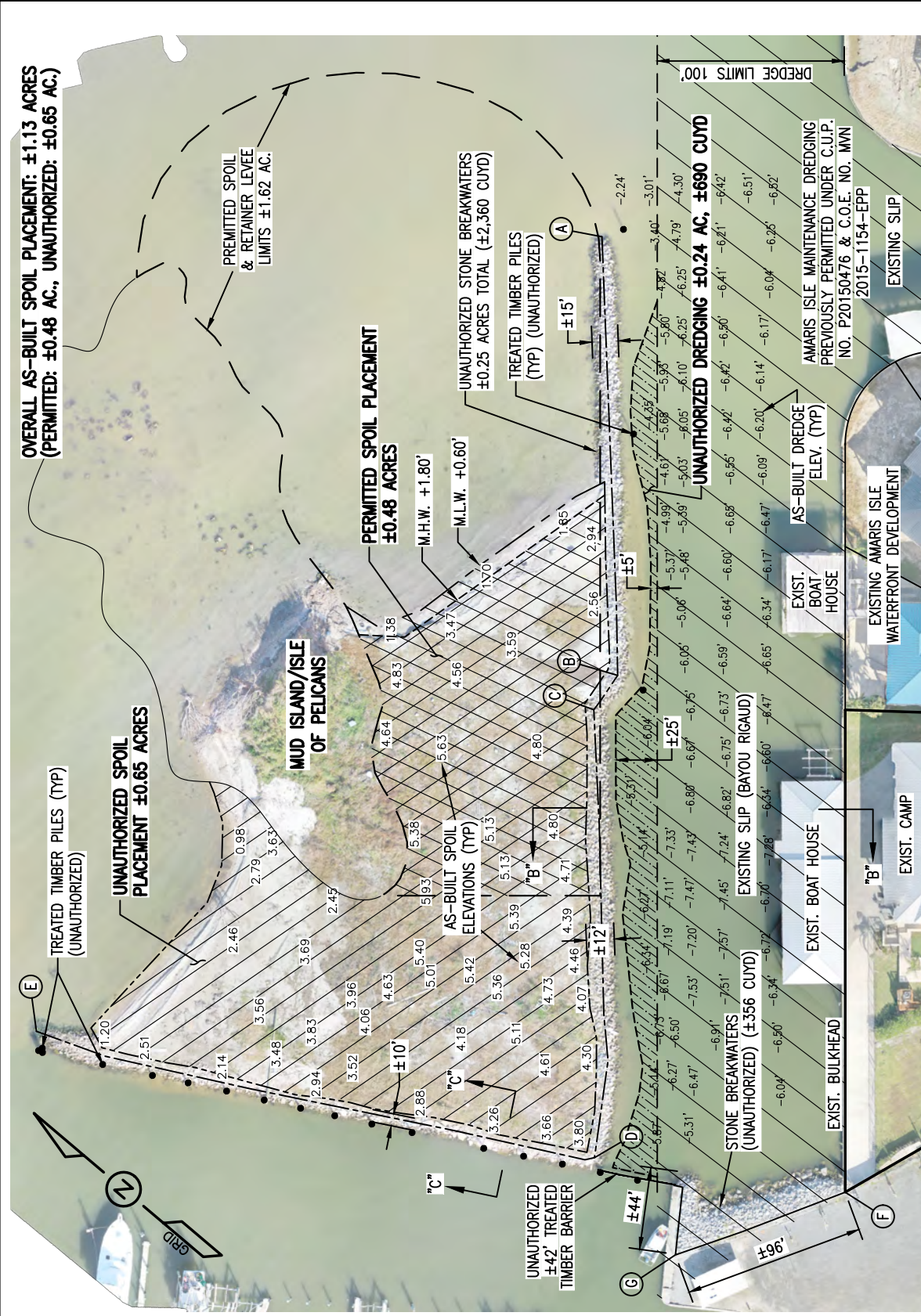

AS-BUILT SITE PLAN



NOTES:

1. AS-BUILT ELEVATIONS DERIVED FROM TOPOGRAPHIC AND HYDROGRAPHIC SURVEYS CONDUCTED BY PICCIOLA & ASSOCIATES, INC. ON DECEMBER 1, 2021.
2. SITE IMAGE DERIVED FROM DRONE AERIAL IMAGERY TAKEN BY PICCIOLA & ASSOCIATES, INC. ON DECEMBER 1, 2021.
3. SURVEY HORIZ. CONTROL: LOUISIANA STATE PLANE, 1702 LOUISIANA SOUTH ZONE, NAD 83 (2011) EPOCH 2010.00). U.S. SURVEY FEET, VRS PROVIDER IS C4G. VERTICAL CONTROL: NAVD 88 (GEOID 18, REV. 11/26/19).
4. REFERENCE SHEETS 6 THRU 8 FOR MORE INFORMATION ON PROPOSED & UNAUTHORIZED ITEMS.

UNAUTHORIZED STONE BREAKWATERS

A	X = 3718725.731, Y = 280409.536	LAT: 29°15'49.81" N, LONG: 89°57'36.11" W
B	X = 3718553.176, Y = 280252.043	LAT: 29°15'48.27" N, LONG: 89°57'38.08" W
C	X = 3718531.023, Y = 280249.903	LAT: 29°15'48.25" N, LONG: 89°57'38.33" W
D	X = 3718347.472, Y = 280096.866	LAT: 29°15'46.76" N, LONG: 89°57'40.42" W
E	X = 3718208.621, Y = 280365.138	LAT: 29°15'49.43" N, LONG: 89°57'41.95" W
F	X = 3718421.865, Y = 279981.724	LAT: 29°15'45.61" N, LONG: 89°57'39.59" W
G	X = 3718337.962, Y = 280028.987	LAT: 29°15'46.09" N, LONG: 89°57'40.53" W



PICCIOLA & ASSOCIATES, INC.

CIVIL ENGINEERS
LAND SURVEYORS

NAVAL ARCHITECTS
MARINE ENGINEERS

P.O. BOX 687
CUT OFF, LOUISIANA 70345
(885) 632-9786

JN: 0813-2101

REV1: 01/13/2022
DATE: 12/22/2021

SHEET 5 OF 8

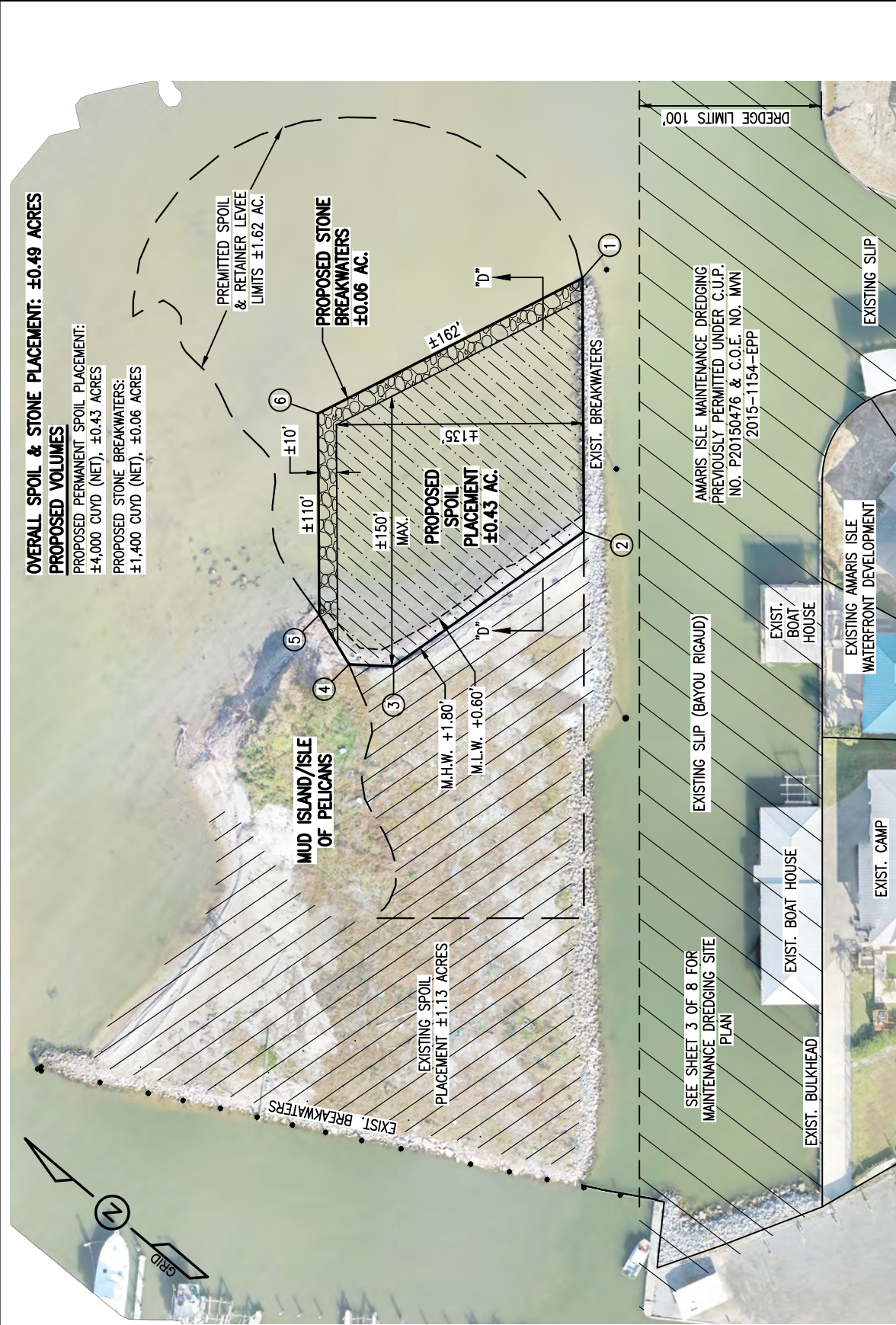

PROPOSED SPOIL PLACEMENT & STONE BREAKWATERS

	X	Y	LONG	N	LONG	W
1	3718724.019	280410.433	29°15'49.82"	89°57'36.12"	W	
2	3718618.995	280320.130	29°15'48.94"	89°57'37.32"	W	
3	3718495.321	280351.646	29°15'49.26"	89°57'38.71"	W	
4	3718480.499	280371.035	29°15'49.46"	89°57'38.88"	W	
5	3718490.606	280400.967	29°15'49.75"	89°57'38.76"	W	
6	3718574.013	280472.684	29°15'50.45"	89°57'37.81"	W	

NOTES:

- SITE IMAGE DERIVED FROM DRONE AERIAL IMAGERY TAKEN BY PICCIOLA & ASSOCIATES, INC. ON DECEMBER 1, 2021.
- SURVEY HORZ. CONTROL: LOUISIANA STATE PLANE, 1702 LOUISIANA SOUTH ZONE, NAD 83 (2011) EPOCH 2010.00); U.S. SURVEY FEET, VRS PROVIDER IS C4G. VERTICAL CONTROL: NAVD 88 (GEOID 18, REV. 11/26/19)
- SEE SHEETS 6 THRU 8 FOR MORE INFORMATION ON PROPOSED & UNAUTHORIZED ITEMS.



PICCIOLA & ASSOCIATES, INC.

CIVIL ENGINEERS
LAND SURVEYORS
NAVAL ARCHITECTS
MARINE ENGINEERS

P.O. BOX 687
CUT OFF, LOUISIANA 70345
(985) 652-9786

JN: 0813-2101

REV2: 01/25/2022

DATE: 12/22/2021

SHEET 6 OF 8

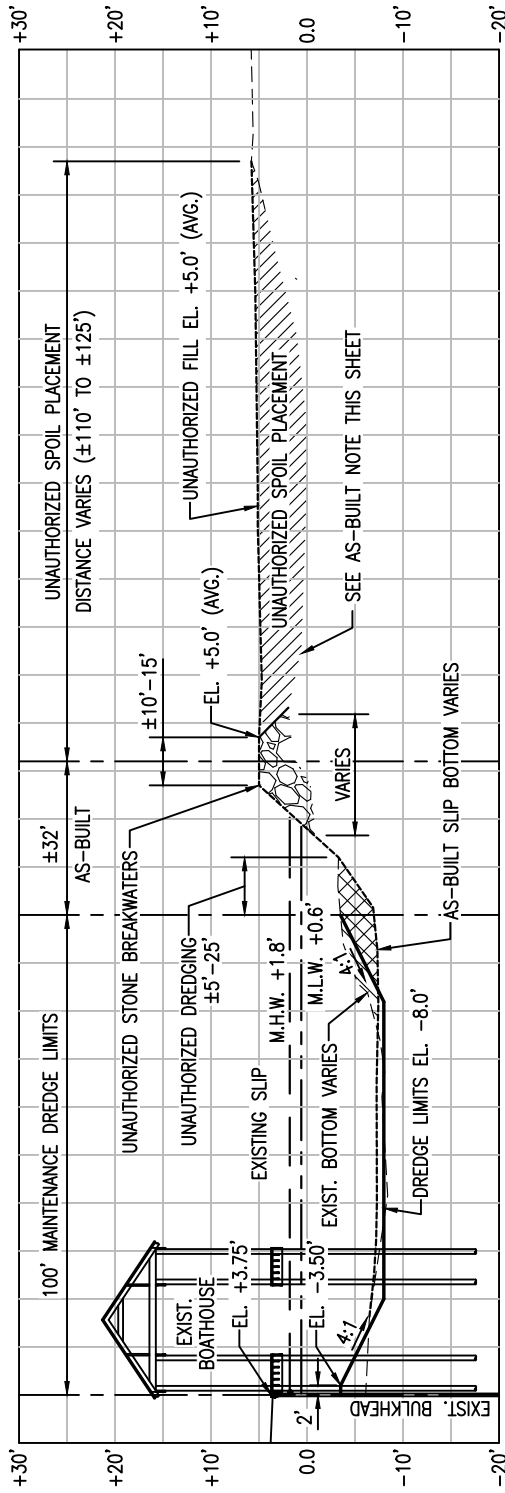

SECTION "B" - "B" (AS-BUILT)

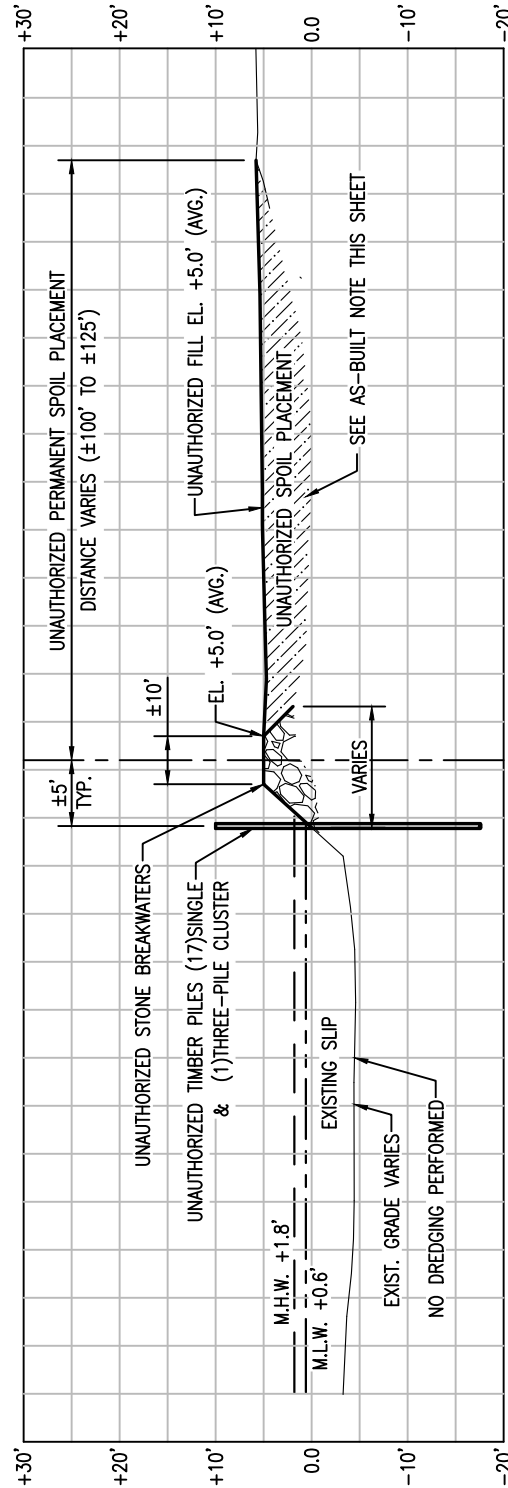

SECTION "C" - "C" (AS-BUILT)

ESTIMATED AREAS

- OVERALL AS-BUILT MAINTENANCE DREDGING: ±14.68 AC.
- (PERMITTED: ±14.44 AC., UNAUTHORIZED: ±0.24 AC.)
- OVERALL AS-BUILT SPOIL PLACEMENT: ±1.13 AC.
- (PERMITTED: ±0.48 AC., UNAUTHORIZED: ±0.65 AC.)
- UNAUTHORIZED STONE BREAKWATERS: ±0.25 ACRES
- UNAUTHORIZED TREATED TIMBER PILES: ±17 SINGLE, (1)3 PILE CLUSTER
- UNAUTHORIZED ±42' TREATED TIMBER BARRIER

NOTE:

1. DUE TO CONTINUALLY CHANGING SITE CONDITIONS AND DAMAGE FROM HURRICANE IDA, IT IS IMPOSSIBLE TO QUANTIFY AS-BUILT MATERIAL VOLUMES. ONLY APPROXIMATE AS-BUILT AREAS ARE PROVIDED.

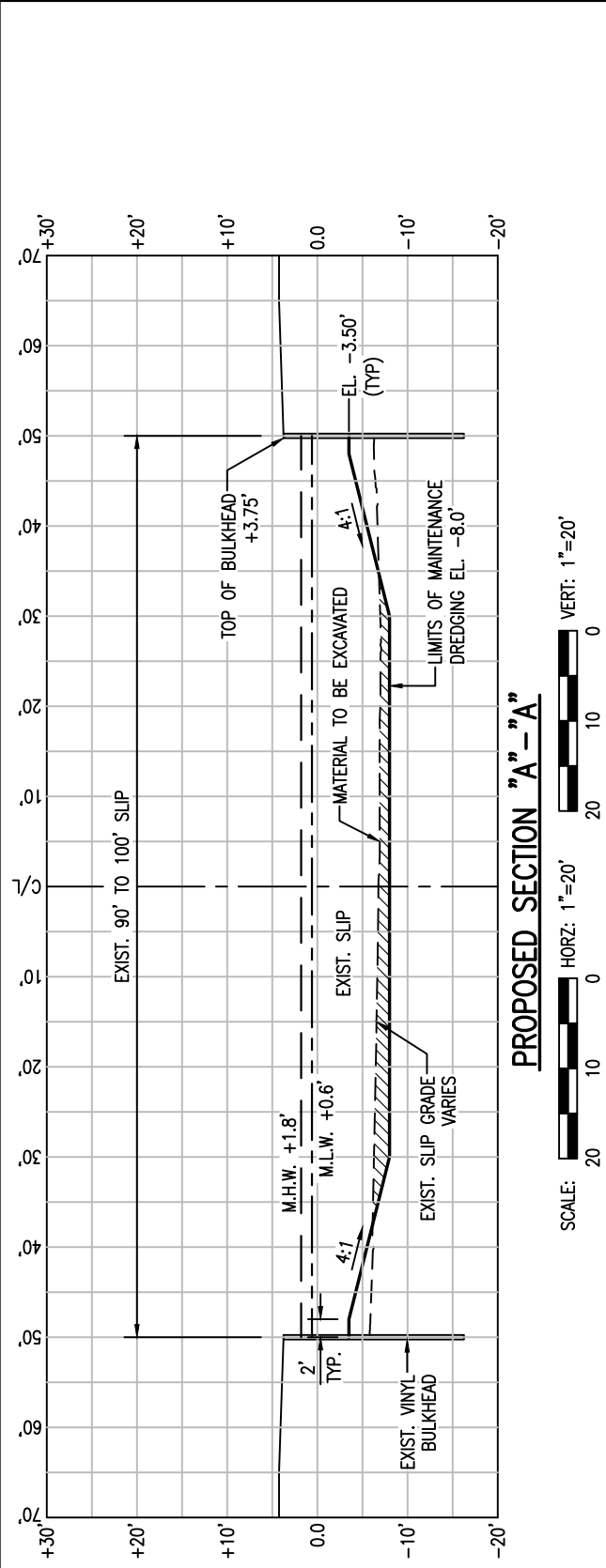

PROPOSED SECTION "A-A"

SCALE: HORIZ: 1"=20' VERT: 1"=20'

TOTAL LENGTH OF MAINTENANCE DREDGING: ±6,375 LF, ±23,300 CUYD OVER 10 YEARS, ±14.44 ACRES
 MAINTENANCE DREDGING PREVIOUSLY PERMITTED UNDER: C.U.P. NO. P20150476
 C.O.E. NO. MN 2015-1154-EPP

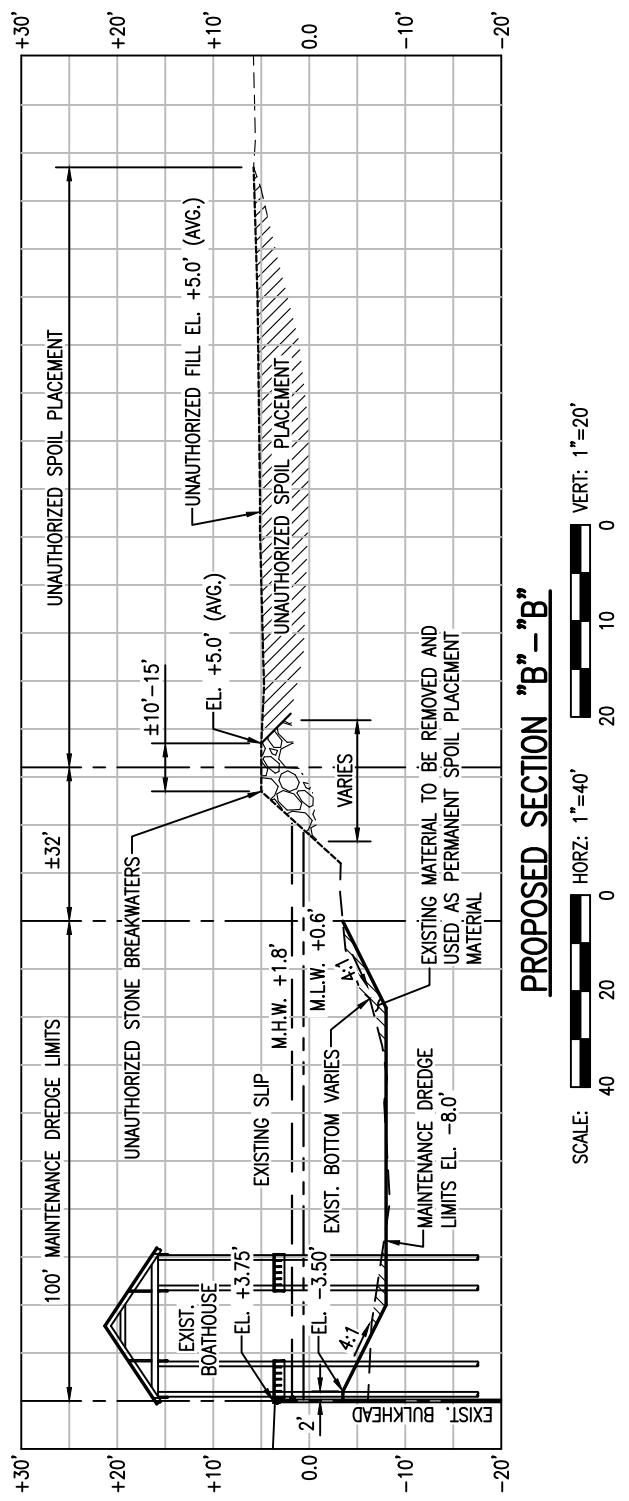

PROPOSED SECTION "B-B"

SCALE: HORIZ: 1"=40' VERT: 1"=20'



PICCIOLA & ASSOCIATES, INC.
 CIVIL ENGINEERS LAND SURVEYORS NAVAL ARCHITECTS MARINE ENGINEERS

P.O. BOX 687
 CUT OFF, LOUISIANA 70345
 (865) 632-9786

JN: 0813-2101

REV1: 01/13/2022
 DATE: 12/22/2021

SHEET 7 OF 8



PICCIOLA & ASSOCIATES, INC.

CIVIL ENGINEERS
LAND SURVEYORS

NAVAL ARCHITECTS
MARINE ENGINEERS

P.O. BOX 687
CUT OFF, LOUISIANA 70345
(985) 652-9786

JN: 0813-2101

REV1: 01/13/2022

DATE: 12/22/2021

SHEET 8 OF 8

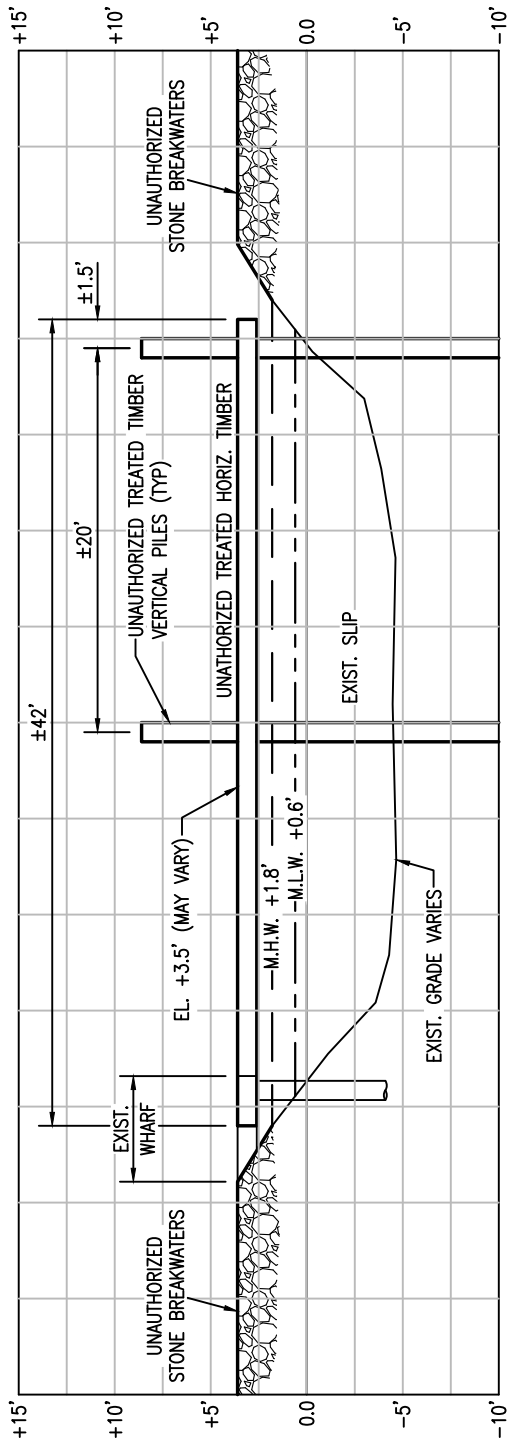

TREATED TIMBER BARRIER (UNAUTHORIZED)

NOT TO SCALE

ESTIMATED AREAS
UNAUTHORIZED STONE BREAKWATERS: ±0.25 ACRES
UNAUTHORIZED TREATED TIMBER PILES: ±17 SINGLE, (1)3 PILE CLUSTER
UNAUTHORIZED ±42' TREATED TIMBER BARRIER

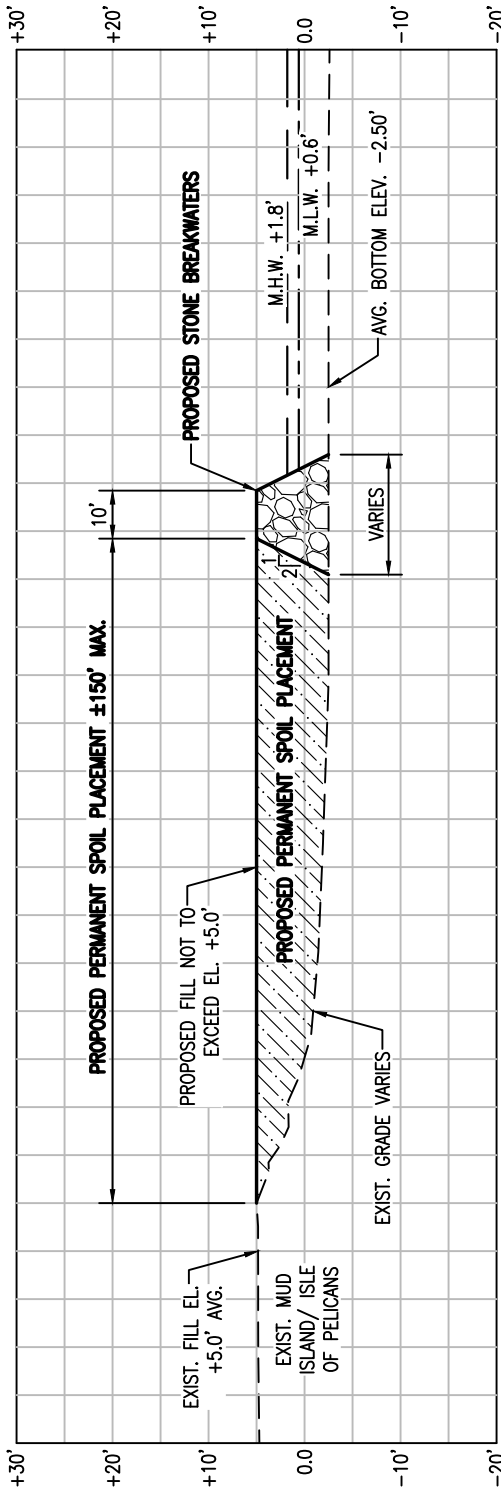

PROPOSED SECTION "D-D"

PROPOSED VOLUMES

PROPOSED PERMANENT SPOIL PLACEMENT:
±4,000 CU YD (NET), ±0.43 ACRES

PROPOSED STONE BREAKWATERS:
±1,400 CU YD (NET), ±0.06 ACRES

SCALE: 1"=40'



SCALE: 1"=20'



NOTES:

1. ALL MATERIAL GENERATED FROM MAINTENANCE DREDGING SHALL BE DEPOSITED AND USED AS PERMANENT SPOIL PLACEMENT ALONG EXISTING MUD ISLAND/ISLE OF PELICANS.