

JOINT PUBLIC NOTICE

May 14, 2018

United States Army Corps of Engineers
New Orleans District
Regulatory Branch
7400 Leake Avenue
New Orleans, Louisiana 70118 -3651

State of Louisiana
Department of Environmental Quality
Water Permits Division
Post Office Box 4313
Baton Rouge, Louisiana 70821-4313

(504) 862-2675
Project Manager
Jamie Crowe
Jamie.M.Crowe@usace.army.mil
Permit Application Number
MVN 2015-00351 CO

(225) 219-3225
Project Manager
Elizabeth Hill

WQC Application Number
WQC 180504-02

Interested parties are hereby notified that a permit application has been received by the New Orleans District of the U.S. Army Corps of Engineers pursuant to:
[] Section 10 of the Rivers and Harbors Act of March 3, 1899 (30 Stat. 1151; 33 USC 403); and/or [X] Section 404 of the Clean Water Act (86 Stat. 816; 33 USC 1344).

Application has also been made to the Louisiana Department of Environmental Quality, Office of Environmental Services, for a Water Quality Certification (WQC) in accordance with statutory authority contained in LRS30:2047 A(3), and provisions of Section 401 of the Clean Water Act (P.L.95-17).

MAINTENANCE CORRIDOR AND DITCH CLEANOUT IN LIVINGSTON PARISH

NAME OF APPLICANT: Livingston Parish Gravity Drainage District No. 2, c/o D&S Environmental Services, Post Office Box 510, French Settlement, Louisiana, 70733.

LOCATION OF WORK: Within the Lake Pontchartrain Basin, in the Amite River hydrologic unit (HUC 08070202); within a tributary to Middle Colyell Creek located in T5S-R3E, Sections 25 and 36; beginning at a point south of Tack Covington Road and extending approximately 1,042 feet downstream, near Watson, Louisiana, in Livingston Parish.

CHARACTER OF WORK: The applicant proposes to clear impeding vegetation along a 15-foot corridor adjacent to an unnamed tributary of Middle Colyell Creek. The upper 6 inches will be excavated and crushed concrete placed at natural grade in wetlands to create a permanent access route. Additionally, the unnamed tributary will be cleared of any obstructions, de-silted and re-shaped to the original shape. Two laterals that intersect the tributary will also be de-silted, re-shaped, and lined with crushed concrete to prevent future erosion. Excavated material will be distributed in non-wetlands on site with any excess material being placed in Livingston Parish Gravity Drainage District No.

2 maintenance yard. Approximately 0.2 acre of forested jurisdictional wetlands will be impacted by the maintenance corridor, while approximately 0.24 acre of jurisdictional waters will be impacted by ditch cleanout and re-shaping.

The applicant has minimized the impacts as much as practicable. Additionally, appropriate erosion control methods, including silt fencing, hay bales, seeding, etc., will be utilized during and after the construction to prevent impacts to adjacent property. Crushed concrete will also be placed in lateral ditches will help to contain the sediment load and prevent excessive runoff. As compensation for unavoidable wetland impacts the applicant proposes to purchase wetland credits from a Corps approved mitigation bank located in the watershed.

The comment period for the Department of the Army Permit and the Louisiana Department of Environmental Quality WQC will close **20 days** from the date of this joint public notice. Written comments, including suggestions for modifications or objections to the proposed work, stating reasons thereof, are being solicited from anyone having interest in this permit and/or this WQC request and must be mailed, so as to be received before or by the last day of the comment period. Letters concerning the Corps of Engineers permit application must reference the applicant's name and the Permit Application Number, and be mailed to the Corps of Engineers at the address above, **ATTENTION: REGULATORY BRANCH**. The application for this proposed project is on file with the Louisiana Department of Environmental Quality and may be examined weekdays between 8:00 a.m. and 4:30 p.m. Copies may be obtained upon payment of costs of reproduction. Individuals or parties may request an extension of time in which to comment on the proposed work by writing or e-mailing the Corps of Engineers Project Manager listed above. Any request must be specific and substantively supportive of the requested extension, and received by this office prior to the end of the initial comment period. The Section Chief will review the request and the requestor will be promptly notified of the decision to grant or deny the request. If granted, the time extension will be continuous to the initial comment period and, inclusive of the initial comment period, will not exceed a total of 30 calendar days. Letters concerning the Water Quality Certification must reference the applicant's name and the WQC Application number and be mailed to the Louisiana Department of Environmental Quality at the address above.

Corps of Engineers Permit Criteria

The decision whether to issue a permit will be based on an evaluation of the probable impacts, including cumulative impacts of the proposed activity on the public interest. That decision will reflect the national concern for both protection and utilization of important resources. The benefit which reasonably may be expected to accrue from the proposal must be balanced against its reasonably foreseeable detriments. All factors which may be relevant to the proposal will be considered including the cumulative effects thereof; among those are conservation, economics, aesthetics, general environmental concerns, wetlands, historic properties, fish and wildlife values, flood hazards, floodplain values, land use, navigation, shoreline erosion and accretion,

recreation, water supply and conservation, water quality, energy needs, safety, food and fiber production, mineral needs, considerations of property ownership and, in general, the needs and welfare of the people.

The U.S. Army Corps of Engineers is soliciting comments from the public, federal, state, and local agencies and officials, Indian Tribes, and other interested parties in order to consider and evaluate the impacts of this proposed activity. Any comments received will be considered by the U.S. Army Corps of Engineers to determine whether to make, modify, condition, or deny a permit for this proposal. To make this decision, comments are used to assess impacts on endangered species, historic properties, water quality, general environmental effects, and other public interest factors listed above. Comments are used in the preparation of an Environmental Assessment and/or an Environmental Impact Statement pursuant to the National Environmental Policy Act. Comments are also used to determine the need for a public hearing and to determine the overall public interest of the proposed activity.

The New Orleans District is unaware of properties listed on the National Register of Historic Places near the proposed work. The possibility exists that the proposed work may damage or destroy presently unknown archeological, scientific, prehistorical, historical sites, or data. Copies of this notice are being sent to the State Archeologist and State Historic Preservation Officer.

Our initial finding is that the proposed work would not affect any species, nor affect any habitat designated as critical to the survival and recovery of such species, listed as endangered by the U.S. Department of Commerce.

The New Orleans District has determined that the proposed project is located in waters known to be utilized by the west Indian manatee (*Trichechus manatus*) and determined that the proposed activity is not likely to adversely affect the species. This determination is based on the Standard Local Operating Procedure for Endangered Species of Louisiana (SLOPES), dated October 22, 2014, between the U.S. Army Corps of Engineers and U.S. Fish and Wildlife Service, Ecological Services Office.

This notice initiates the Essential Fish Habitat (EFH) consultation requirements of the Magnuson-Stevens Fishery Conservation and Management Act. The applicant's proposal would result in the destruction or alteration of **n/a acres** of EFH utilized by various life stages of red drum and penaeid shrimp. Our initial determination is that the proposed action would not have a substantial adverse impact on EFH or federally managed fisheries in the Gulf of Mexico. Our final determination relative to project impacts and the need for mitigation measures is subject to review by and coordination with the National Marine Fisheries Service.

If the proposed work involves deposits of dredged or fill material into navigable waters, the evaluation of the probable impacts will include the application of guidelines established by the Administrator of the Environmental Protection Agency. Also, a certification that the proposed activity will not violate applicable water quality standards will be required from the Department of Environmental Quality, Office of Environmental

Services, before a permit is issued.

Any person may request, in writing, within the comment period specified in this notice, that a public hearing be held to consider this application. Requests for public hearings shall state, with particularity, the reasons for holding a public hearing. You are requested to communicate the information contained in this notice to any other parties whom you deem likely to have interest in the matter.

You are requested to communicate the information contained in this notice to any other parties whom you deem likely to have interest in the matter.

John M. Herman
Chief, Central Evaluation Section
Regulatory Branch

Enclosure

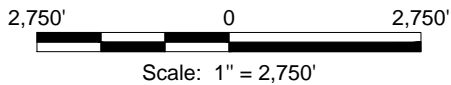
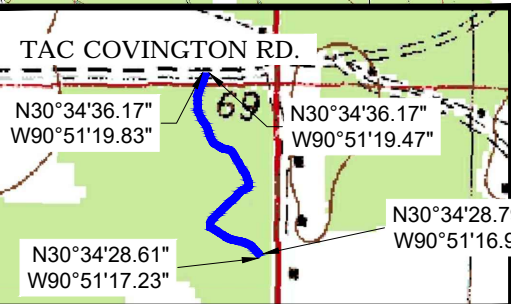
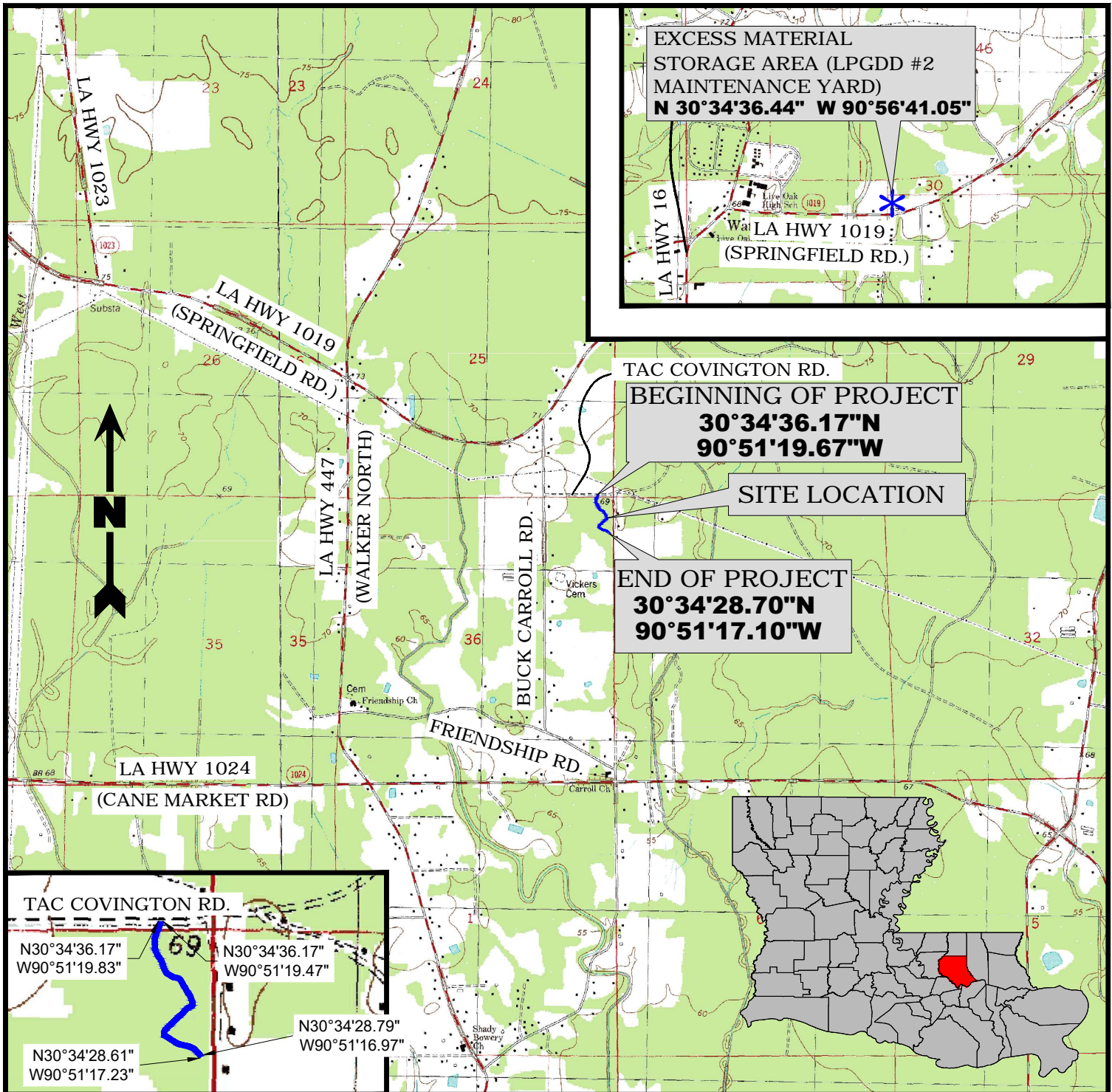

Notes

Property is located in Sections 25 & 36 T5S-R3E

Beginning of Project: Latitude: 30°34'36.17"N Longitude: 90°51'19.67"W
 End of Project: Latitude: 30°34'28.70"N Longitude: 90°51'17.10"W

Reference

Base map comprised of U.S.G.S. 7.5 minute topographic maps "Watson, LA" and "Satsuma, LA".

Livingston Parish Gravity Drainage District No. 2

Tac Covington Maintenance Project

Vicinity Map

Livingston Parish, Louisiana



D & S ENVIRONMENTAL SERVICES, INC.



Project No.: 27-2017-DOA

Date: 07-23-2017

Figure No.: 1

Livingston Parish Gravity Drainage District No. 2

Tac Covington Maintenance Project Proposed Plan View

Livingston Parish, Louisiana



D & S
ENVIRONMENTAL SERVICES, INC.



Project No.: 27-2017-DOA

Date: 07-23-2017

Figure No.: 2

Legend

- Property Boundary (0.720 Acres)
- Non-Wetlands (0.230 Acres)
- Total Jurisdictional Wetlands (0.240 Acres)
- Jurisdictional Wetlands To Be Excavated / Filled (0.194 Acres)
- Jurisdictional Wetlands Not To Be Impacted (0.046 Acres)
- Total Other Waters Of The US (0.250 Acres)
- Other Waters Of The US To Be Excavated (0.239 Acres)
- Other Waters Of The US To Be Excavated/Filled (0.006 Acres)
- Other Waters Of The US Not To Be Impacted (0.005 Acres)

Notes

1. The Proposed layout was provided by Livingston Parish Gravity Drainage District No. 2.
2. Jurisdictional Wetlands & Other Waters Of The U.S. obtained from U.S. Army CORPS of Engineers Jurisdictional Determination Account Number MVN-2015-00351-SY.
3. Wetland impacts by habitat type:
>Bottomland Hardwood =0.24 Acres
5. Excavated material will be redistributed in non-wetlands on-site. Any excess excavated material will be transported off-site to the maintenance yard for Livingston Parish Gravity Drainage District #2 located off LA Hwy 1019 (Springfield Road)(see Vicinity Map).
6. Wetland impacts shall consist of mechanized clearing of impeding vegetation, excavating (mucking out) the upper 6" and refilling with crushed concrete to a correlating elevation, which will ensure hydrological flow and connectivity to adjacent wetlands thereof.

Total Proposed Fill

Approximately 152.71 Cubic Yards of Crushed Concrete.

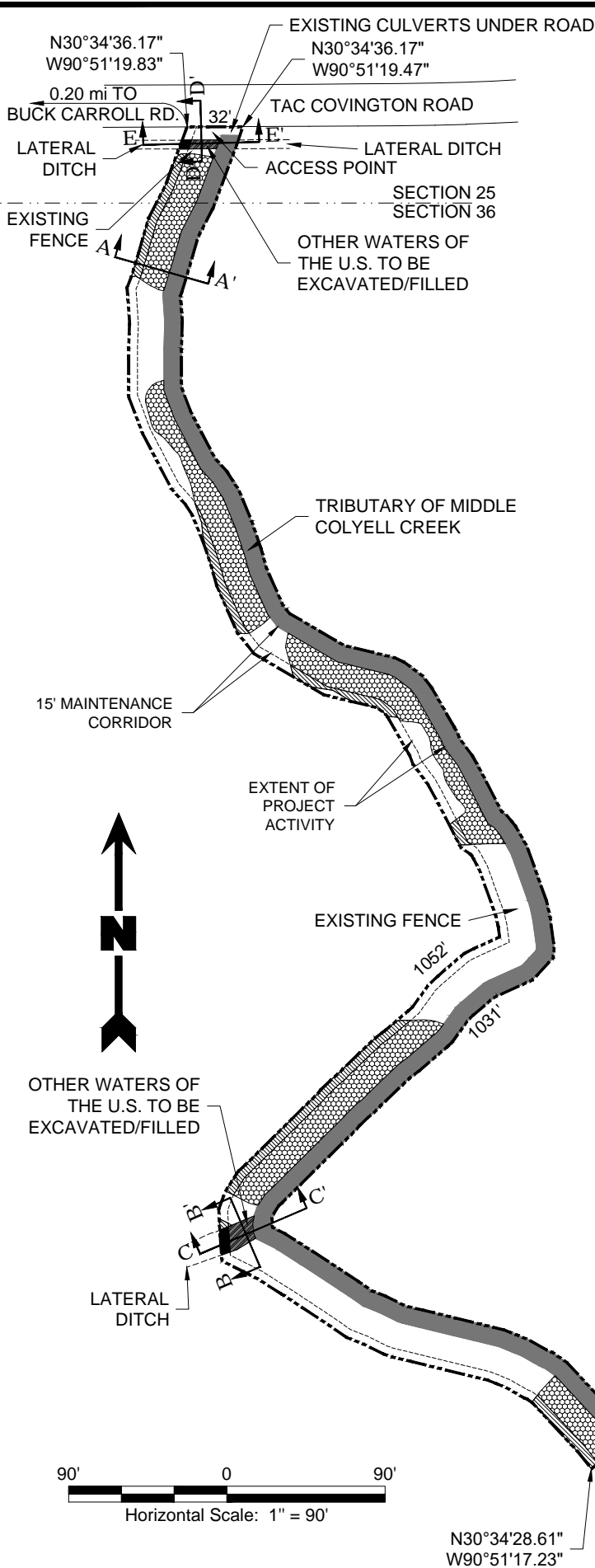

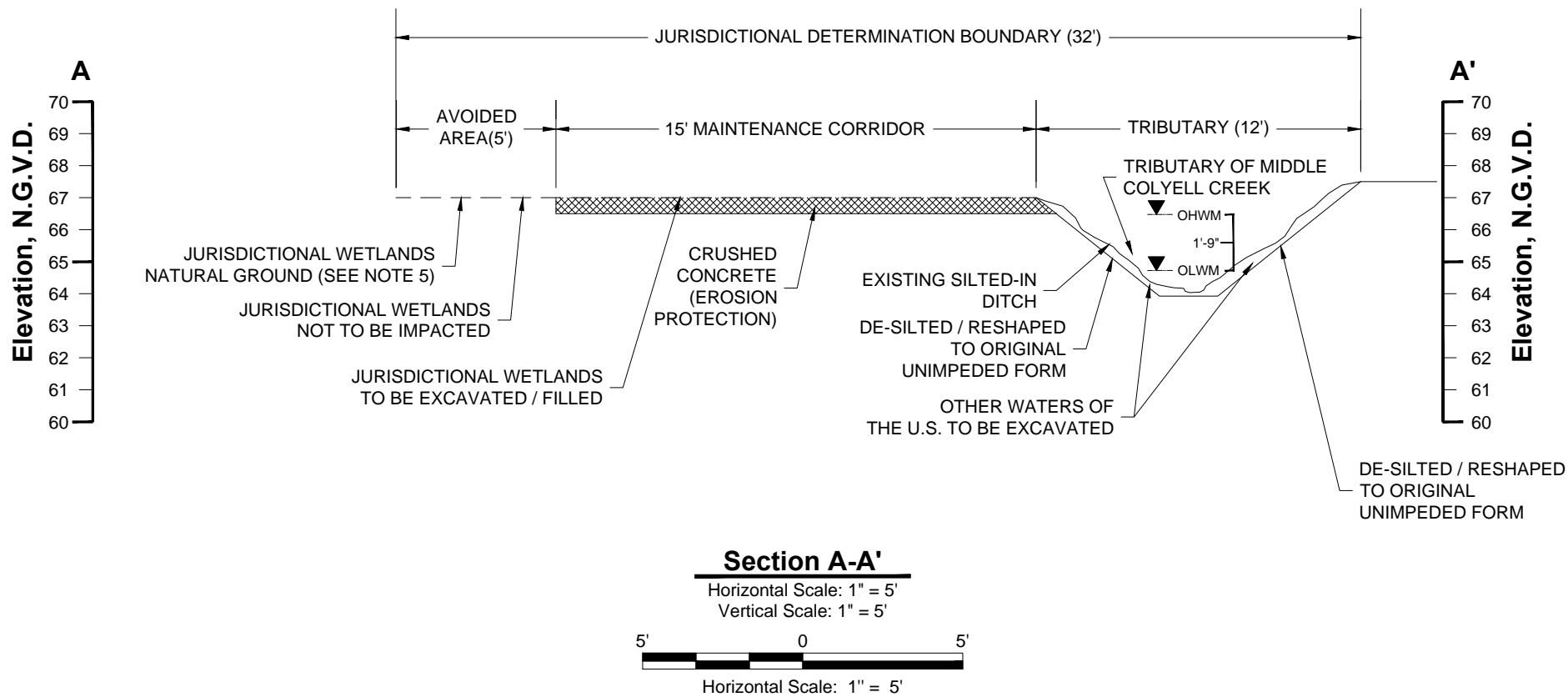

Notes

1. The Proposed layout was provided by Livingston Parish Gravity Drainage District No. 2.
2. Jurisdictional Wetlands & Other Waters Of The U.S. obtained from U.S. Army CORPS of Engineers Jurisdictional Determination Account Number MVN-2015-00351-SY.
3. Non-wetland ground elevations vary from 86' to 63' N.G.V.D. Elevation data was obtained from USGS Quad Maps.
4. Natural ground elevations in existing Jurisdictional Wetlands are approximately 6" lower than non-wetland ground elevations.

Legend

-  Crushed Concrete
- OHWM Ordinary High Water Mark
- OLWM Ordinary Low Water Mark

Livingston Parish Gravity Drainage District No. 2

**Tac Covington Maintenance Project
 Section View A-A'**

Livingston Parish, Louisiana



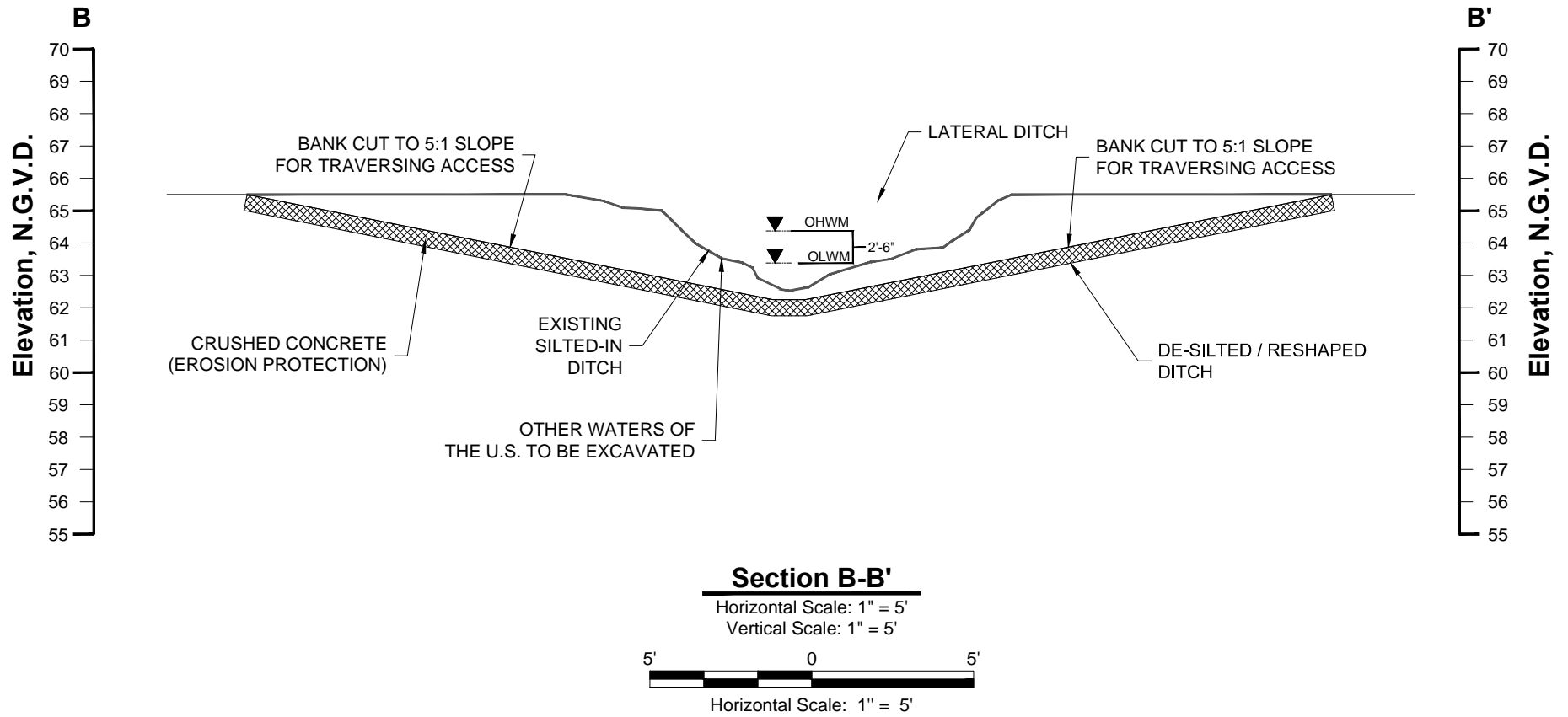



Notes

1. The Proposed layout was provided by Livingston Parish Gravity Drainage District No. 2.
2. Jurisdictional Wetlands & Other Waters Of The U.S. obtained from U.S. Army CORPS of Engineers Jurisdictional Determination Account Number MVN-2015-00351-SY.
3. Non-wetland ground elevations vary from 86' to 63' N.G.V.D. Elevation data was obtained from USGS Quad Maps.
4. Natural ground elevations in existing Jurisdictional Wetlands are approximately 6" lower than non-wetland ground elevations.

Legend

-  Crushed Concrete
-  OHWM Ordinary High Water Mark
-  OLWM Ordinary Low Water Mark

Livingston Parish Gravity Drainage District No. 2

Tac Covington Maintenance Project

Section View B-B'

Livingston Parish, Louisiana



D & S ENVIRONMENTAL SERVICES, INC.



Project No.: 27-2017-DOA

Date: 07-23-2017

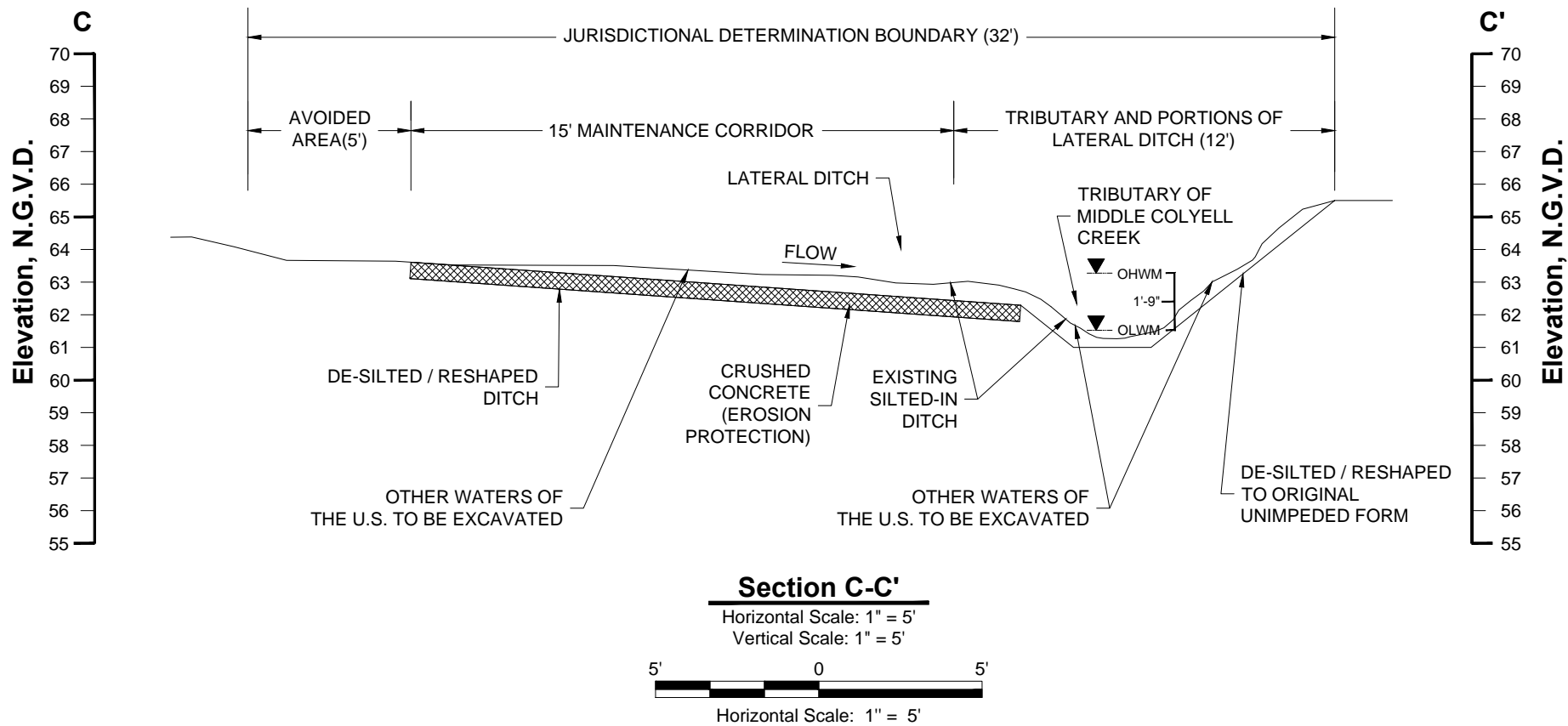

Figure No.: 4



Notes

1. The Proposed layout was provided by Livingston Parish Gravity Drainage District No. 2.
2. Jurisdictional Wetlands & Other Waters Of The U.S. obtained from U.S. Army CORPS of Engineers Jurisdictional Determination Account Number MVN-2015-00351-SY.
3. Non-wetland ground elevations vary from 86' to 63' N.G.V.D. Elevation data was obtained from USGS Quad Maps.
4. Natural ground elevations in existing Jurisdictional Wetlands are approximately 6" lower than non-wetland ground elevations.

Legend

-  Crushed Concrete
-  Ordinary High Water Mark
-  Ordinary Low Water Mark

Livingston Parish Gravity Drainage District No. 2

**Tac Covington Maintenance Project
 Section View C-C'**

Livingston Parish, Louisiana



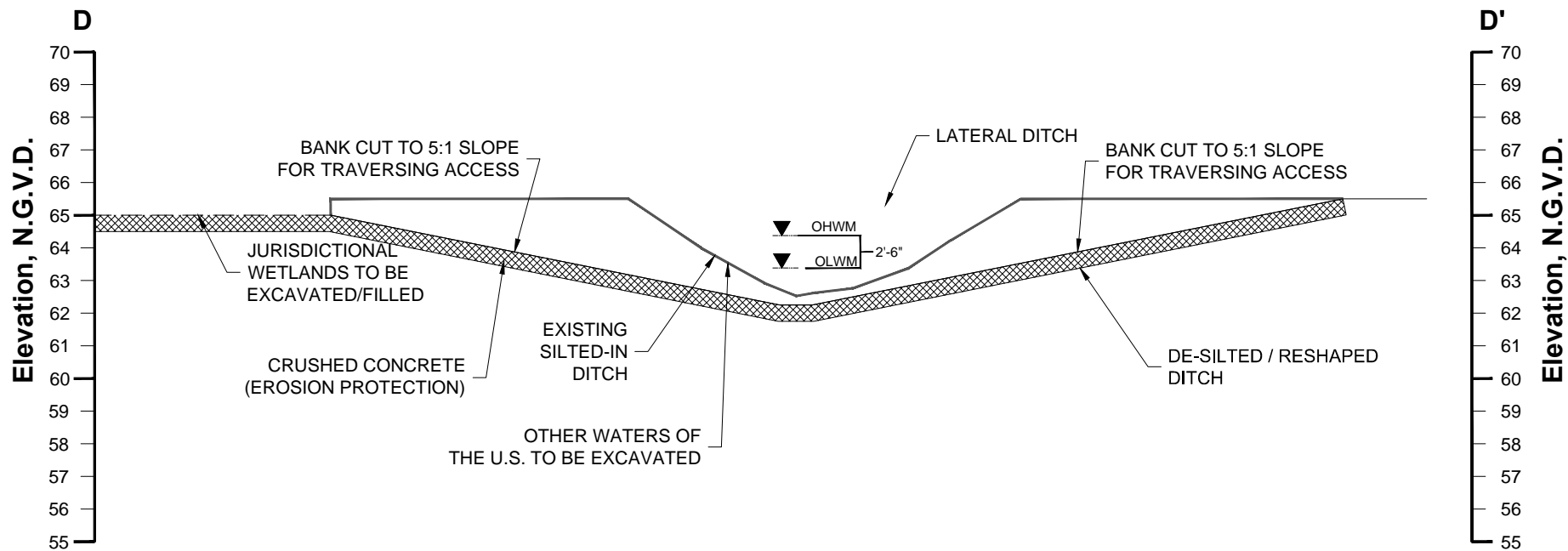

Section D-D'

Horizontal Scale: 1" = 5'
Vertical Scale: 1" = 5'

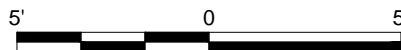



Horizontal Scale: 1" = 5'

Notes

1. The Proposed layout was provided by Livingston Parish Gravity Drainage District No. 2.
2. Jurisdictional Wetlands & Other Waters Of The U.S. obtained from U.S. Army CORPS of Engineers Jurisdictional Determination Account Number MVN-2015-00351-SY.
3. Non-wetland ground elevations vary from 86' to 63' N.G.V.D. Elevation data was obtained from USGS Quad Maps.
4. Natural ground elevations in existing Jurisdictional Wetlands are approximately 6" lower than non-wetland ground elevations.

Legend

-  Crushed Concrete
-  OHWM Ordinary High Water Mark
-  OLWM Ordinary Low Water Mark

Livingston Parish Gravity Drainage District No. 2

Tac Covington Maintenance Project

Section View D-D'

Livingston Parish, Louisiana



D & S
ENVIRONMENTAL SERVICES, INC.



Project No.: 27-2017-DOA

Date: 07-23-2017

Figure No.: 6

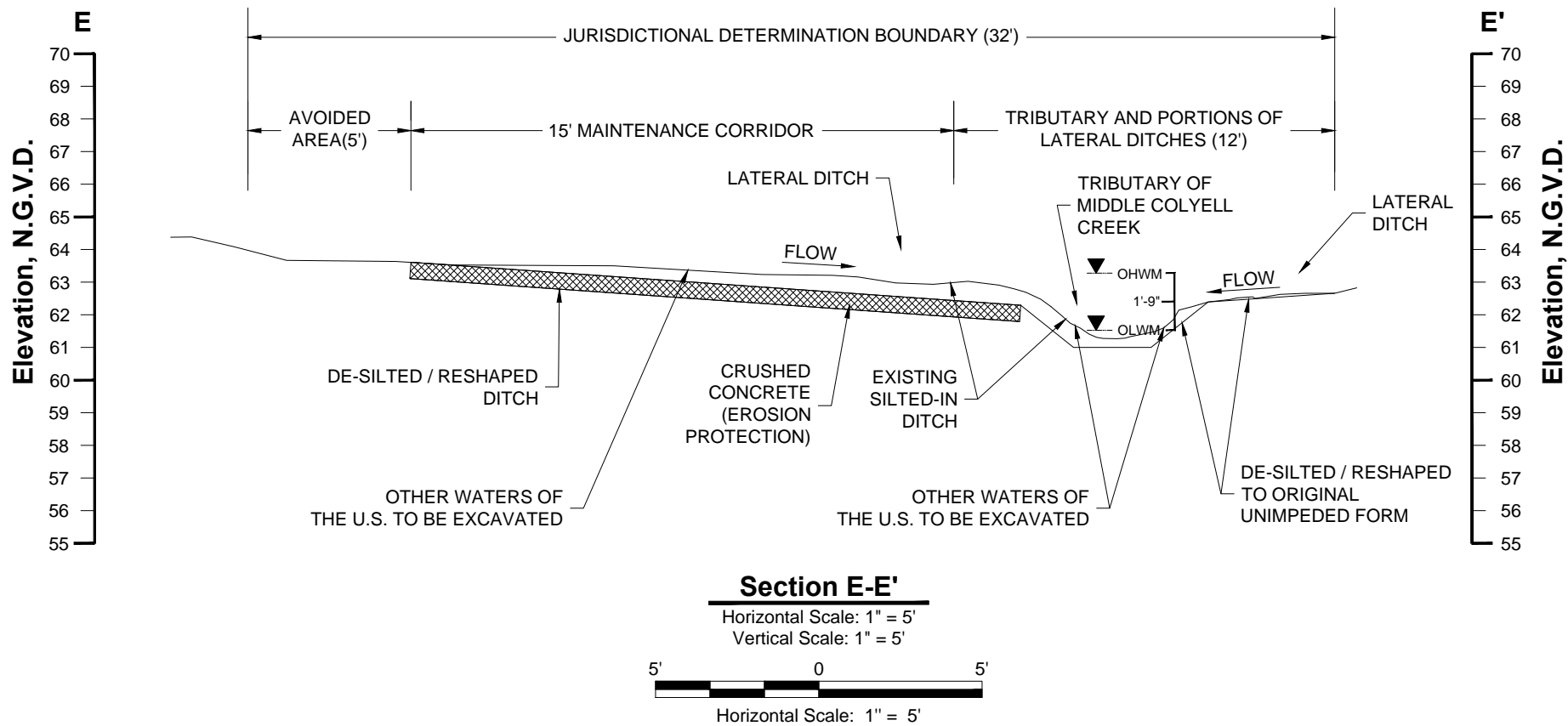

Notes

1. The Proposed layout was provided by Livingston Parish Gravity Drainage District No. 2.
2. Jurisdictional Wetlands & Other Waters Of The U.S. obtained from U.S. Army CORPS of Engineers Jurisdictional Determination Account Number MVN-2015-00351-SY.
3. Non-wetland ground elevations vary from 86' to 63' N.G.V.D. Elevation data was obtained from USGS Quad Maps.
4. Natural ground elevations in existing Jurisdictional Wetlands are approximately 6" lower than non-wetland ground elevations.

Legend

-  Crushed Concrete
- OHWM Ordinary High Water Mark
- OLWM Ordinary Low Water Mark

Livingston Parish Gravity Drainage District No. 2

**Tac Covington Maintenance Project
 Section View E-E'**

Livingston Parish, Louisiana

