



REPLY TO  
ATTENTION OF

DEPARTMENT OF THE ARMY  
CORPS OF ENGINEERS, NEW ORLEANS DISTRICT  
P.O. BOX 60267  
NEW ORLEANS LA 70160-0267

January 20, 2015

Operations Division  
Eastern Evaluation Section

Project Manager  
Jennifer Burkett  
(504) 862-2045  
jennifer.e.burkett@usace.army.mil  
SUBJECT: MVN 2014-2389 EBB

### **PUBLIC NOTICE**

Interested parties are hereby notified that a permit application has been received by the New Orleans District of the U.S. Army Corps of Engineers pursuant to: [X] Section 10 of the Rivers and Harbors Act of March 3, 1899 (30 Stat. 1151; 33 USC 403); and/or [ ] Section 404 of the Clean Water Act (86 Stat. 816; 33 USC 1344).

### **BOATHOUSE ON THE BOGUE FALAYA RIVER IN ST. TAMMANY PARISH**

**NAME OF APPLICANT:** John M. Taylor c/o Lamulle Construction, LLC at 4978 Pontchartrain Drive, Slidell, Louisiana 70458.

**LOCATION OF WORK:** On the Bogue Falaya River, at 18149 Three Rivers Road, Covington, in St. Tammany Parish, Louisiana, as shown on the attached drawings.

**HUC:** 080090201; Liberty Bayou – Tchefuncte River

**CHARACTER OF WORK:** To install and maintain a 24' x 30' boathouse adjacent to an existing bulkhead. The structure will extend 65' into the river, which is approximately 175' wide at this location. No fill is required. No special aquatic sites will be affected by this project; no mitigation is anticipated.

The comment period for the Department of the Army Permit will close **15 days** from the date of this public notice. Written comments, including suggestions for modifications or objections to the proposed work, stating reasons thereof, are being solicited from anyone having interest in this permit must be mailed so as to be received before or by the last day of the comment period. Letters concerning the Corps of Engineers permit application must reference the applicant's name and the Permit Application Number, and be mailed to the Corps of Engineers at the address above, **ATTENTION: REGULATORY BRANCH**. **Individuals or parties may request an extension of time in which to comment on the proposed work by writing or e-mailing the Corps of Engineers Project Manager listed above. Any request must be specific and substantively supportive of the requested extension, and**

**received by this office prior to the end of the initial comment period. The Section Chief will review the request and the requestor will be promptly notified of the decision to grant or deny the request. If granted, the time extension will be continuous to the initial comment period and, inclusive of the initial comment period, will not exceed a total of 30 calendar days.**

The decision whether to issue a permit will be based on an evaluation of the probable impacts, including cumulative impacts of the proposed activity on the public interest. That decision will reflect the national concern for both protection and utilization of important resources. The benefit which reasonably may be expected to accrue from the proposal must be balanced against its reasonably foreseeable detriments. All factors which may be relevant to the proposal will be considered including the cumulative effects thereof; among those are conservation, economics, aesthetics, general environmental concerns, wetlands, historic properties, fish and wildlife values, flood hazards, floodplain values, land use, navigation, shoreline erosion and accretion, recreation, water supply and conservation, water quality, energy needs, safety, food and fiber production, mineral needs, considerations of property ownership and, in general, the needs and welfare of the people.

The U.S. Army Corps of Engineers is soliciting comments from the public, federal, state, and local agencies and officials, Indian Tribes, and other interested parties in order to consider and evaluate the impacts of this proposed activity. Any comments received will be considered by the U.S. Army Corps of Engineers to determine whether to make, modify, condition, or deny a permit for this proposal. To make this decision, comments are used to assess impacts on endangered species, historic properties, water quality, general environmental effects, and other public interest factors listed above. Comments are used in the preparation of an Environmental Assessment and/or an Environmental Impact Statement pursuant to the National Environmental Policy Act. Comments are also used to determine the need for a public hearing and to determine the overall public interest of the proposed activity.

The New Orleans District is unaware of properties listed on the National Register of Historic Places near the proposed work. The possibility exists that the proposed work may damage or destroy presently unknown archeological, scientific, prehistorical, historical sites, or data. Issuance of this public notice solicits input from the State Archeologist and State Historic Preservation Officer regarding potential impacts to cultural resources.

Our initial finding is that the proposed work would neither affect any species listed as endangered by the U.S. Departments of Interior or Commerce, nor affect any habitat designated as critical to the survival and recovery of any endangered species.

This notice initiates the Essential Fish Habitat (EFH) consultation requirements of the Magnuson-Stevens Fishery Conservation and Management Act. The applicant's proposal would result in the destruction or alteration of N/A acres of EFH utilized by various life stages of red drum and penaeid shrimp. Our initial determination is that the proposed action would not have a substantial adverse impact on EFH or federally managed fisheries in the Gulf of Mexico. Our final determination relative to project impacts and the need for mitigation measures is subject to review by and coordination with the National Marine Fisheries Service.

If the proposed work involves deposits of dredged or fill material into navigable waters, the evaluation of the probable impacts will include the application of guidelines established by the Administrator of the Environmental Protection Agency. Also, a certification that the proposed activity will not violate applicable water quality standards will be required from the Department of Environmental Quality before a permit is issued.

Any person may request, in writing, within the comment period specified in this notice, that a public hearing be held to consider this application. Requests for public hearings shall state, with particularity, the reasons for holding a public hearing.

You are requested to communicate the information contained in this notice to any other parties whom you deem likely to have interest in the matter.

Michael V. Farabee  
Chief, Eastern Evaluation Section

Enclosures

TAYLOR MVN 2014 02389

18149 3 Rivers Rd, Covington, LA 70433

Street View · Search nearby

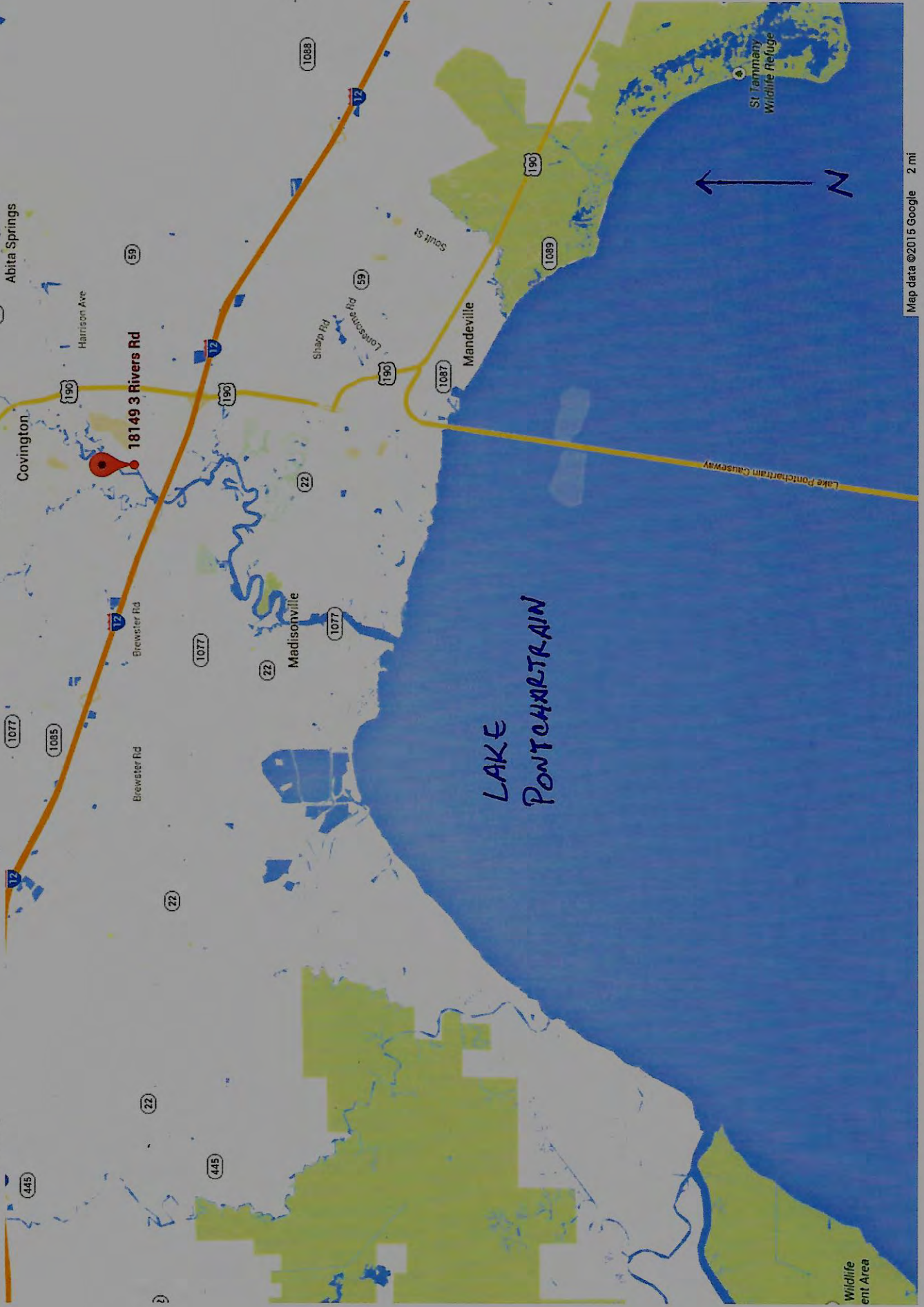



JOHN TAYLOR  
VICINITY MAP



500 ft

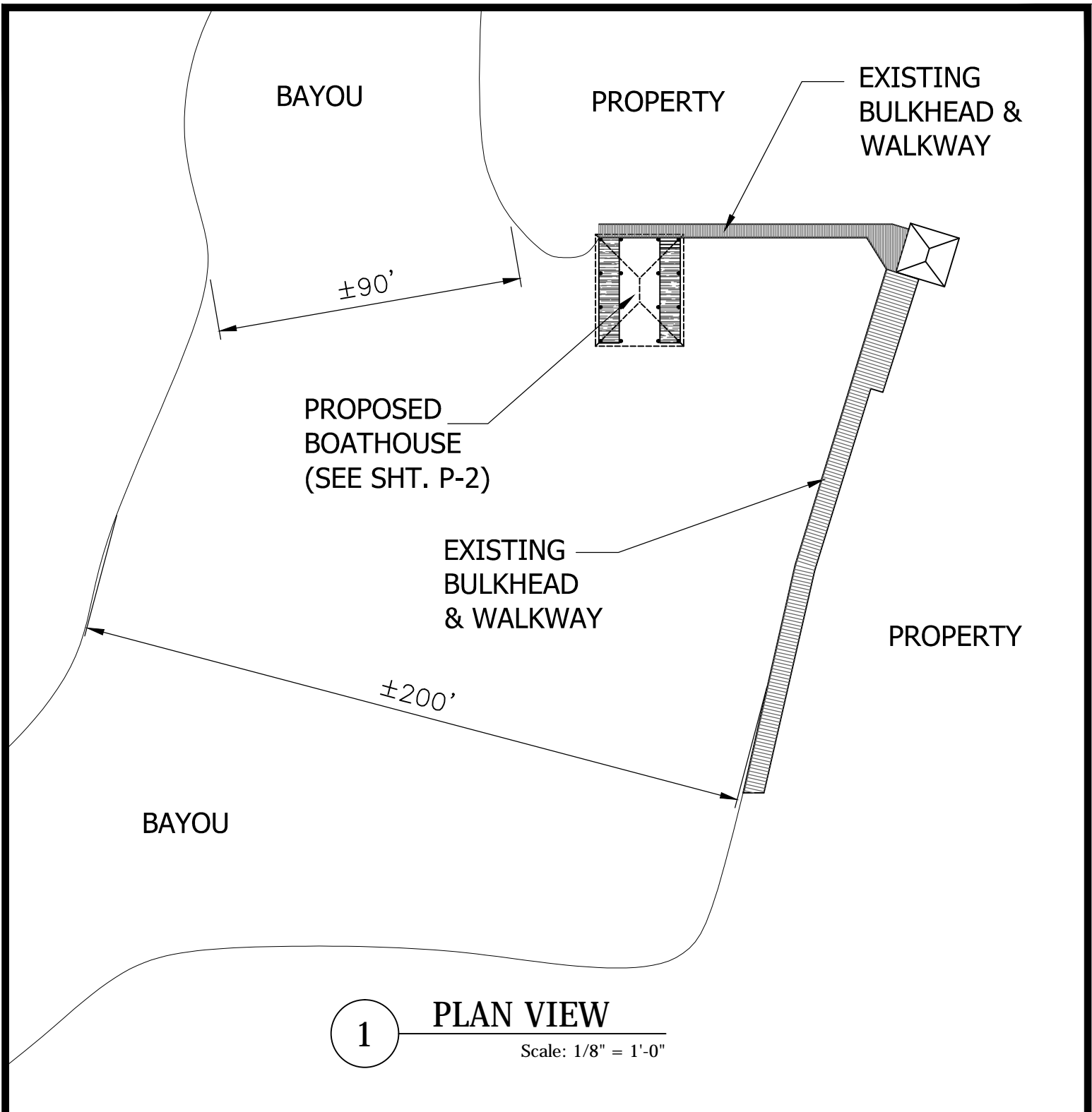

Client:  
LAMULLE CONSTRUCTION, INC.

Project:  
BOATHOUSE & DOCK FOR JAMES TAYLOR, 18149 THREE RIVERS ROAD, BEING 1.06 ACRES IN SECTION 9, T-7-S, R-11-E, ST. TAMMANY PARISH, LOUISIANA.

Project NO.	No.	Revision/Issue	Date
14-3			
Date			
10.20.2014			
Scale			
AS SHOWN			

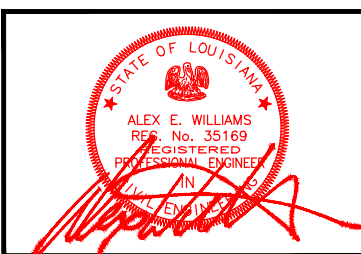

**DEEP SOUTH DESIGN GROUP**  
Civil/Environmental Engineering Firm

80400 Hwy. 21  
Bush, LA 70431  
PH: 985-705-4696

Sheet  
P-1

This drawing and design are the property of DEEP SOUTH DESIGN GROUP. They are submitted on the condition that they are not to be used, reproduced or copied in whole or part or used for furnishing information to others, without the prior written consent of DEEP SOUTH DESIGN GROUP. All common law rights of copyright and otherwise are hereby specifically reserved.

PROPERTY

EXISTING BULKHEAD & WALKWAY

BAYOU

CLASS B 40'  
LONG PILLING  
(16 PLACES)

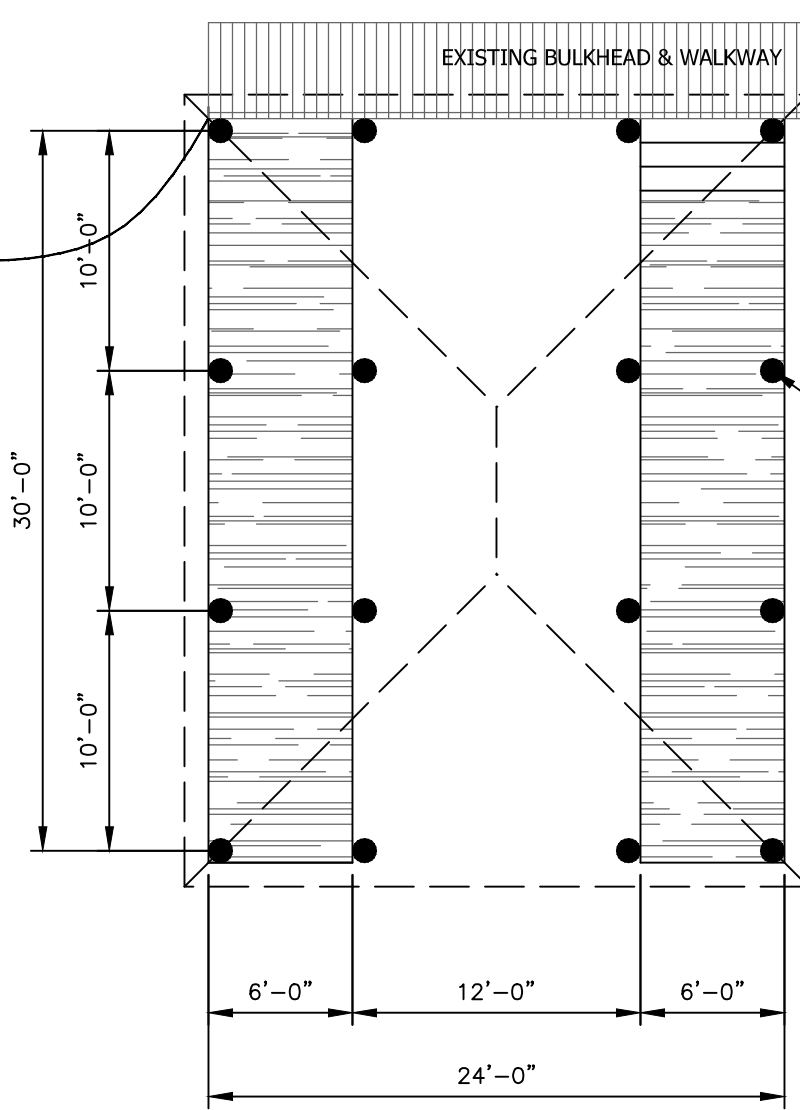

BAYOU

1

### ENLARGED PLAN VIEW

Scale: 1/8" = 1'-0"

Client:  
LAMULLE CONSTRUCTION, INC.

Project:  
BOATHOUSE & DOCK FOR JAMES TAYLOR, 18149 THREE RIVERS ROAD,  
BEING 1.06 ACRES IN SECTION 9, T-7-S, R-11-E, ST. TAMMANY PARISH,  
LOUISIANA.

Project NO.	No.	Revision/Issue	Date
14-3			
Date			
10.20.2014			
Scale			
AS SHOWN			

Sheet  
**P-2**

This drawing and design are the property of DEEP SOUTH DESIGN GROUP. They are submitted on the condition that they are not to be used, reproduced or copied in whole or part or used for furnishing information to others, without the prior written consent of DEEP SOUTH DESIGN GROUP. All common law rights of copyright and otherwise are hereby specifically reserved.

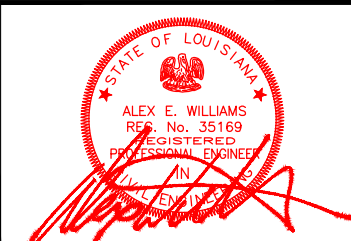

**DEEP SOUTH DESIGN GROUP**  
Civil/Environmental Engineering Firm

80400 Hwy. 21  
Bush, LA 70431  
PH: 985-705-4696

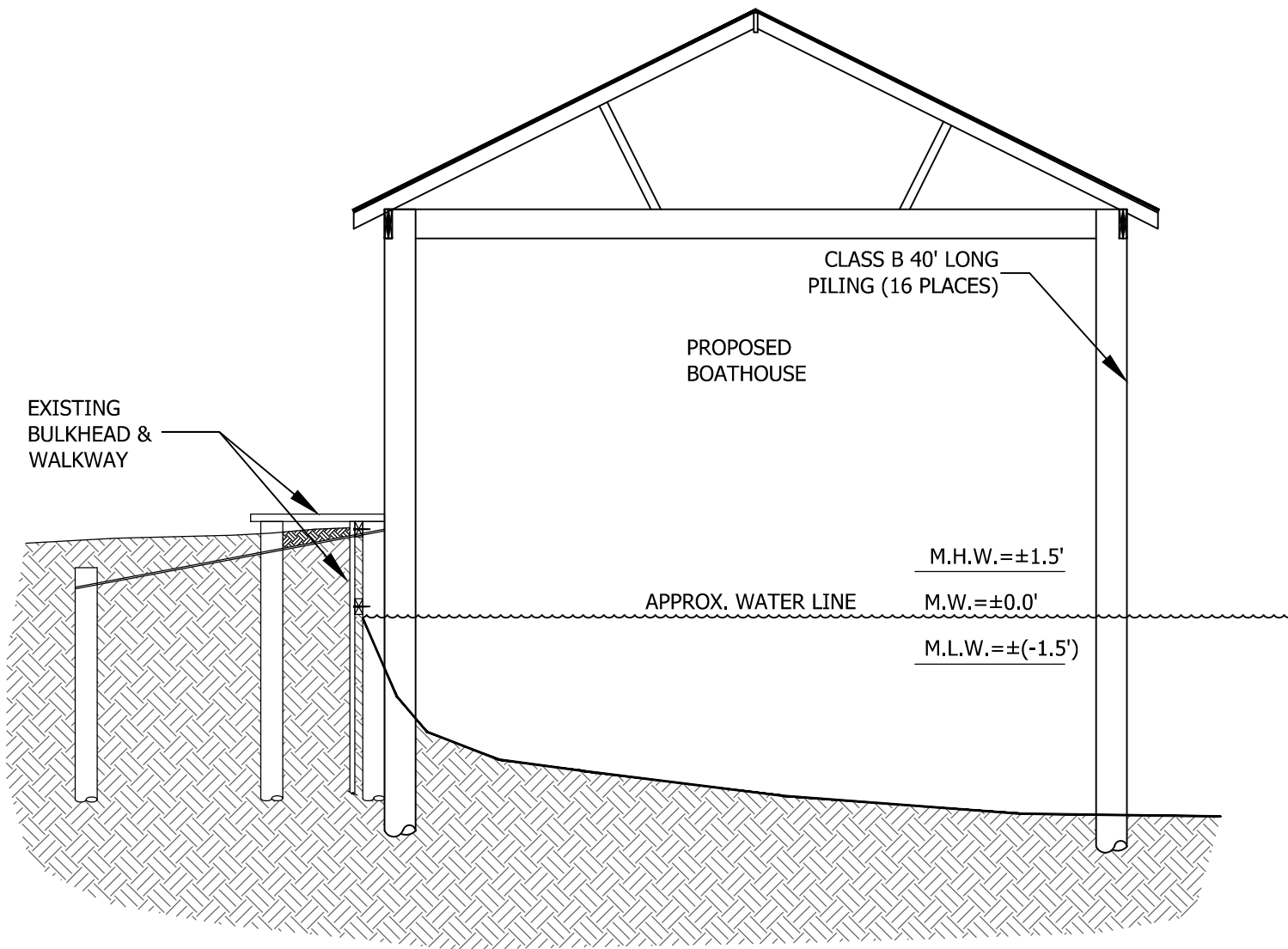

1
TYPICAL SECTION VIEW  
 Scale: 3/16" = 1'-0"

Client:  
LAMULLE CONSTRUCTION, INC.

Project:  
BOATHOUSE & DOCK FOR JAMES TAYLOR, 18149 THREE RIVERS ROAD,  
BEING 1.06 ACRES IN SECTION 9, T-7-S, R-11-E, ST. TAMMANY PARISH,  
LOUISIANA.

Project No.	No.	Revision/Issue	Date
14-3			
Date			
10.20.2014			
Scale			
AS SHOWN			



**DEEP SOUTH DESIGN GROUP**  
Civil/Environmental Engineering Firm

80400 Hwy. 21  
 Bush, LA 70431  
 PH: 985-705-4696

Sheet  
**P-3**

This drawing and design are the property of DEEP SOUTH DESIGN GROUP. They are submitted on the condition that they are not to be used, reproduced or copied in whole or part or used for furnishing information to others, without the prior written consent of DEEP SOUTH DESIGN GROUP. All common law rights of copyright and otherwise are hereby specifically reserved.



GENERAL NOTES:

1. ALL PILING TO CLASS B, 40' LONG w/MIN. 2.5 CCA AND DRIVEN TO 2 TON BEARING RESISTANCE.
2. ALL SILLS TO BE DOUBLE 2"x14"s NOTCHED AND BOLTED TO PILING WITH (2) 5/8" DIAMETER HOT DIPPED GALVANIZED BOLTS.
3. ALL COLLARS FOR DECKS TO BE 2"x8" NOMINAL 24" ON CENTER TREATED 0.40 ACQ.
4. ALL JOISTS FOR DECKS TO BE 2"x6" NOMINAL 24" ON CENTER TREATED 0.40 ACQ.
5. ALL DECKING SHALL BE 2"x6" TREATED 0.40 ACQ. OR FIBERGLASS PANELS.
6. RAFTERS TO BE 2"x6" #2 SYP AS REQUIRED BY LOCAL CODES w/ SIMPSON H2.5A HURRICANE TIES AT EACH RAFTER.
7. ROOF SHEATHING TO BE 5/8" OSB MINIMUM NAILING PATTERN 4" ON CENTER AT EDGES AND FIELD.
8. ROOFING SHALL BE 30 YR. SHINGLES AS PER OWNERS INSTRUCTIONS.
9. STRUCTURE IS RATED FOR 140 MPH WIND LOADS.

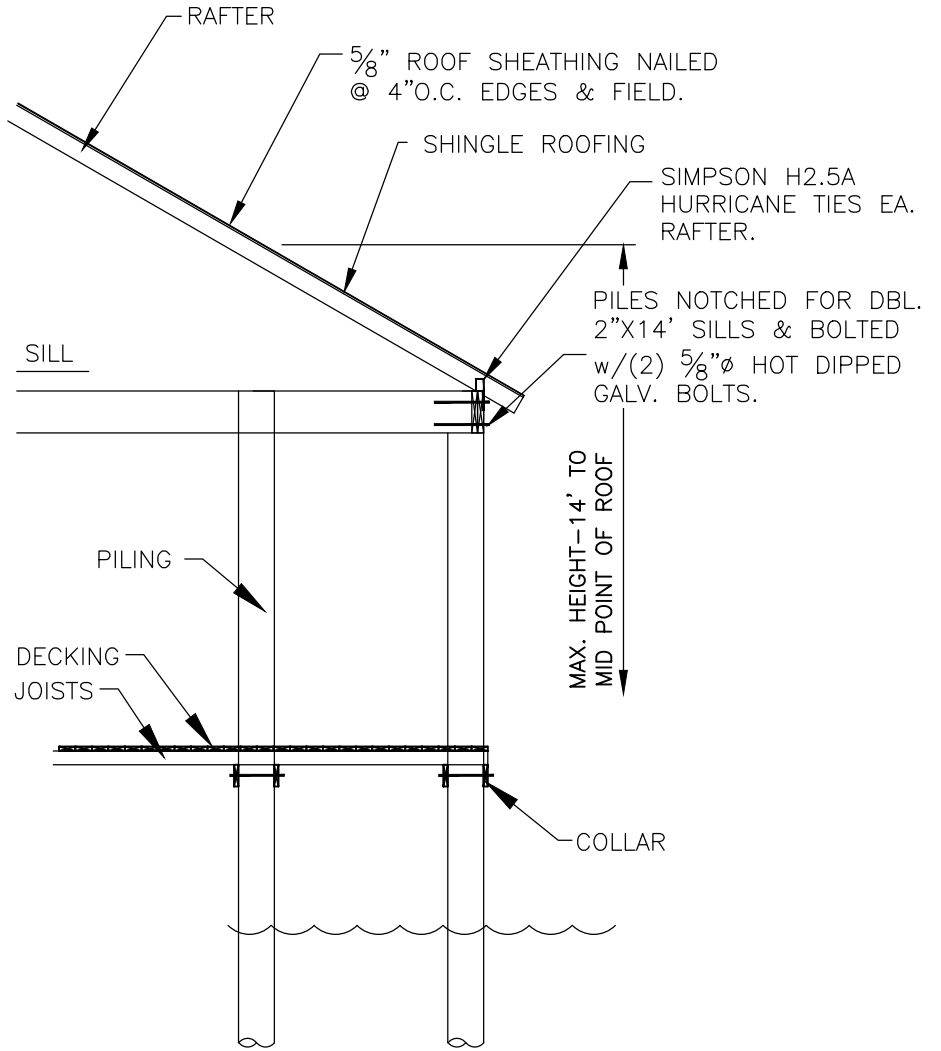

1 **TYPICAL SECTION VIEW**

Scale: N.T.S.

**Client:**  
LAMULLE CONSTRUCTION, INC.

**Project:**  
BOATHOUSE & DOCK FOR JAMES TAYLOR, 18149 THREE RIVERS ROAD, BEING 1.06 ACRES IN SECTION 9, T-7-S, R-11-E, ST. TAMMANY PARISH, LOUISIANA.

Project No.	No.	Revision/Issue	Date
14-3			
Date			
10.20.2014			
Scale			
N.T.S.			

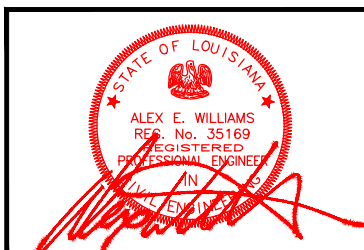



**DEEP SOUTH DESIGN GROUP**  
Civil/Environmental Engineering Firm

80400 Hwy. 21  
Bush, LA 70431  
PH: 985-705-4696

This drawing and design are the property of DEEP SOUTH DESIGN GROUP. They are submitted on the condition that they are not to be used, reproduced or copied in whole or part or used for furnishing information to others, without the prior written consent of DEEP SOUTH DESIGN GROUP. All common law rights of copyright and otherwise are hereby specifically reserved.

**P-4**