

JOINT PUBLIC NOTICE

February 12, 2018

United States Army Corps of Engineers
New Orleans District
Regulatory Branch
7400 Leake Avenue
New Orleans, Louisiana 70118

State of Louisiana
Department of Environmental Quality
Office of Environmental Services
Post Office Box 4313
Baton Rouge, Louisiana 70821-4313

(504) 862-1301
Project Manager
Neil T. Gauthier
Neil.T.Gauthier@usace.army.mil
MVN 2014-00763-CM

(225) 219-3225
Project Manager
Elizabeth Hill
WQC Application Number
WQC 180207-02

Interested parties are hereby notified that a permit application has been received by the New Orleans District of the US Army Corps of Engineers pursuant to: [] Section 10 of the Rivers and Harbors Act of March 3, 1899 (30 Stat. 1151; 33 USC 403); and/or [X] Section 404 of the Clean Water Act (86 Stat. 816; 33 USC 1344).

Application has also been made to the Louisiana Department of Environmental Quality, Office of Environmental Services, for a Water Quality Certification (WQC) in accordance with statutory authority contained in LRS 30:2074 A(3) and provisions of Section 401 of the Clean Water Act.

CLEAR, EXCAVATE, AND FILL FOR ACCESS TO AND MAINTENANCE OF WEST COLYELL CREEK IN LIVINGSTON PARISH

NAME OF APPLICANT: Livingston Parish Gravity Drainage District No. 2, c/o D & S Environmental Services, Inc., Attn: David Templet, P.O. Box 510, French Settlement, Louisiana 70733.

LOCATION OF WORK: On West Colyell Creek beginning on LA Hwy 1023 approximately 0.8 miles south of Weiss Rd. and continuing southward and ending at LA Hwy 1024 approximately 1.6 miles north of Arnold Rd. in Denham Springs, Louisiana, in Livingston Parish, within the Lake Pontchartrain Basin in hydrologic unit (HUC 08070202), as shown on the attached drawings.

CHARACTER OF WORK: The applicant has requested Department of the Army authorization to clear, excavate native material, and deposit crushed concrete to create a 15' wide access/permanent maintenance corridor and to clean out and re-shape West Colyell Creek to improve area drainage. The excavated native material will be distributed into non-wetland areas onsite. Approximately 1,412 cubic yards of crushed concrete will be placed to fill and stabilize parts of the maintenance corridor and areas of the creek for erosion protection and creek bottom stabilization. A Preliminary analysis has determined that the proposed project would permanently impact approximately 1.6 acres of forested wetlands within the project site and temporarily impact approximately 22.7 acres of "other

waters of the US”.

The applicant stated that they have designed the project to avoid and minimize direct and secondary adverse impacts to the maximum extent practicable. Any further reduction would limit their ability to provide proper access drainage maintenance and, therefore deem the project impracticable. As compensation for unavoidable wetland impacts, the applicant proposes to mitigate in-kind wetland credits from a Corps approved mitigation bank located in the watershed.

The comment period for the Department of Army will close in **20 days** from the date of this joint public notice. Written comments, including suggestions for modifications or objections to the proposed work, stating reasons thereof, are being solicited from anyone having interest in this permit and/or this WQC request and must be mailed so as to be received before or by the last day of the comment period. Letters concerning the Corps of Engineers permit application must reference the applicant's name and the Permit Application Number, and be mailed to the Corps of Engineers at the address above, **ATTENTION: REGULATORY BRANCH**. Similar letters concerning the Water Quality Certification must reference the applicant's name and the WQC application number and be mailed to the Louisiana Department of Environmental Quality at the address above. Individuals or parties may request an extension of time in which to comment on the proposed work by writing or e-mailing the Corps of Engineers Project Manager listed above. Any request must be specific and substantively supportive of the requested extension, and received by this office prior to the end of the initial comment period. The Section Chief will review the request and the requestor will be promptly notified of the decision to grant or deny the request. If granted, the time extension will be continuous to the initial comment period and, inclusive of the initial comment period, will not exceed a total of 30 calendar days.

The application for this proposed project is on file with the Louisiana Department of Environmental Quality and may be examined during weekdays between 8:00 a.m. and 4:30 p.m. Copies may be obtained upon payment of costs of reproduction.

Corps of Engineers Permit Criteria

The decision whether to issue a permit will be based on an evaluation of the probable impacts, including cumulative impacts of the proposed activity on the public interest. That decision will reflect the national concern for both protection and utilization of important resources. The benefit which reasonably may be expected to accrue from the proposal must be balanced against its reasonably foreseeable detriments. All factors which may be relevant to the proposal will be considered including the cumulative effects thereof; among those are conservation, economics, aesthetics, general environmental concerns, wetlands, historic properties, fish and wildlife values, flood hazards, floodplain values, land use, navigation, shoreline erosion and accretion, recreation, water supply and conservation, water quality, energy needs, safety, food and fiber production, mineral needs, considerations of property ownership and, in general, the needs and welfare of the people.

The US Army Corps of Engineers is soliciting comments from the public, federal, state, and local agencies and officials, Indian Tribes, and other interested parties in order to

consider and evaluate the impacts of this proposed activity. Any comments received will be considered by the US Army Corps of Engineers to determine whether to make, modify, condition, or deny a permit for this proposal. To make this decision, comments are used to assess impacts on endangered species, historic properties, water quality, general environmental effects, and other public interest factors listed above. Comments are used in the preparation of an Environmental Assessment and/or an Environmental Impact Statement pursuant to the National Environmental Policy Act. Comments are also used to determine the need for a public hearing and to determine the overall public interest of the proposed activity.

The New Orleans District is unaware of properties listed on the National Register of Historic Places near the proposed work. The possibility exists that the proposed work may damage or destroy presently unknown archeological, scientific, prehistorical, historical sites, or data. Copies of this notice are being sent to the State Archeologist and State Historic Preservation Officer.

Our initial finding is that the proposed work would not affect any species, nor affect any habitat designated as critical to the survival and recovery of such species, listed as endangered by the U.S. Department of Commerce.

Our initial finding is that the proposed work would not affect any species, nor affect any habitat designated as critical to the survival and recovery of such species, listed as endangered by the U.S. Department of Interior. Utilizing Standard Local Operating Procedure for Endangered Species in Louisiana (SLOPES), dated October 22, 2014, between the U.S. Army Corps of Engineers, New Orleans and U.S. Fish and Wildlife Service, Ecological Services Office, the Corps has determined that the proposed activity would have no effect on any listed species.

This notice initiates the Essential Fish Habitat (EFH) consultation requirements of the Magnuson-Stevens Fishery Conservation and Management Act. The applicant's proposal would result in the destruction or alteration of up to 0 acres of EFH utilized by various life stages of red drum and penaeid shrimp. Our initial determination is that the proposed action would not have a substantial adverse impact on EFH or federally managed fisheries in the Gulf of Mexico. Our final determination relative to project impacts and the need for mitigation measures is subject to review by and coordination with the National Marine Fisheries Service.

If the proposed work involves deposits of dredged or fill material into navigable waters, the evaluation of the probable impacts will include the application of guidelines established by the Administrator of the Environmental Protection Agency. Also, a certification that the proposed activity will not violate water quality standards will be required from the Department of Environmental Quality, Office of Environmental Services before a permit is issued.

Any person may request, in writing, within the comment period specified in this notice, that a public hearing be held to consider this application. Requests for public hearings shall state, with particularity, the reasons for holding a public hearing. You are requested to communicate the information contained in this notice to any other parties whom you deem likely to have interest in the matter.

JOHN M. HERMAN
Chief, Central Evaluation Section
Regulatory Branch

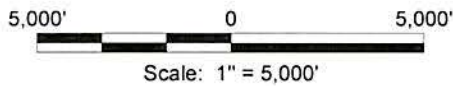
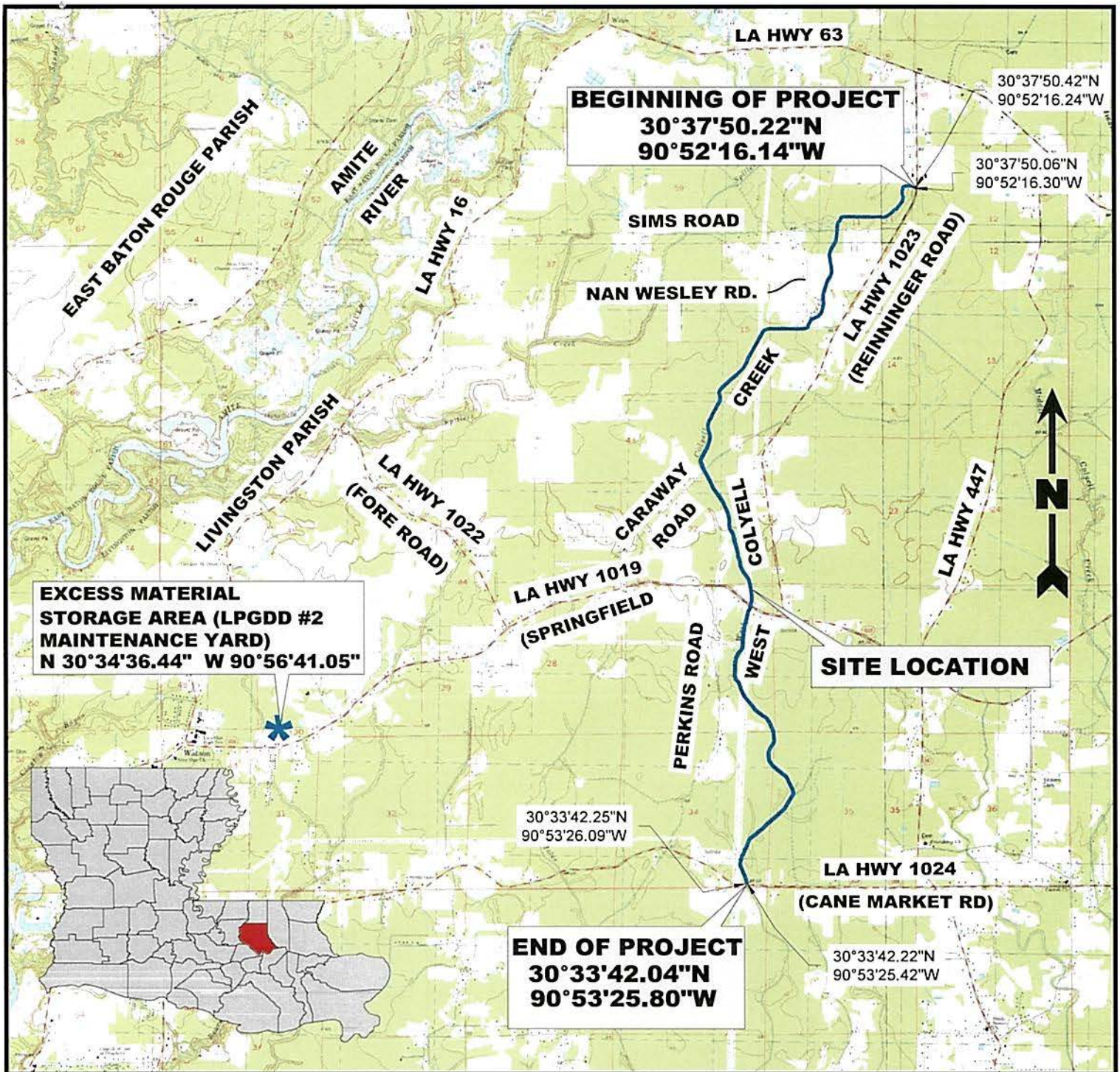

Notes

Property is located in Sections 11, 14, 15, 22, 27, 34, 35, 39 and 43 T-5-S, R-3-E

Beginning of Project Latitude: 30°37'50.22"N Longitude: 90°52'16.14"W
 End of Project Latitude: 30°33'42.04"N Longitude: 90°53'25.80"W

Reference

Base map comprised of U.S.G.S. 7.5 minute topographic maps "Watson, LA", "Satsuma, LA", "Pride, LA" and "Pine Grove, LA".

Livingston Parish Gravity Drainage
 District No. 2

West Colyell Creek Maintenance Project

Vicinity Map

Livingston Parish, Louisiana



D & S
 ENVIRONMENTAL SERVICES, INC.



Project No.: 26-2017-DOA

Date: 07-20-2017

Figure No.: 1

Total Proposed Fill

Approximately 1,411.67 Cubic Yards of Crushed Concrete.

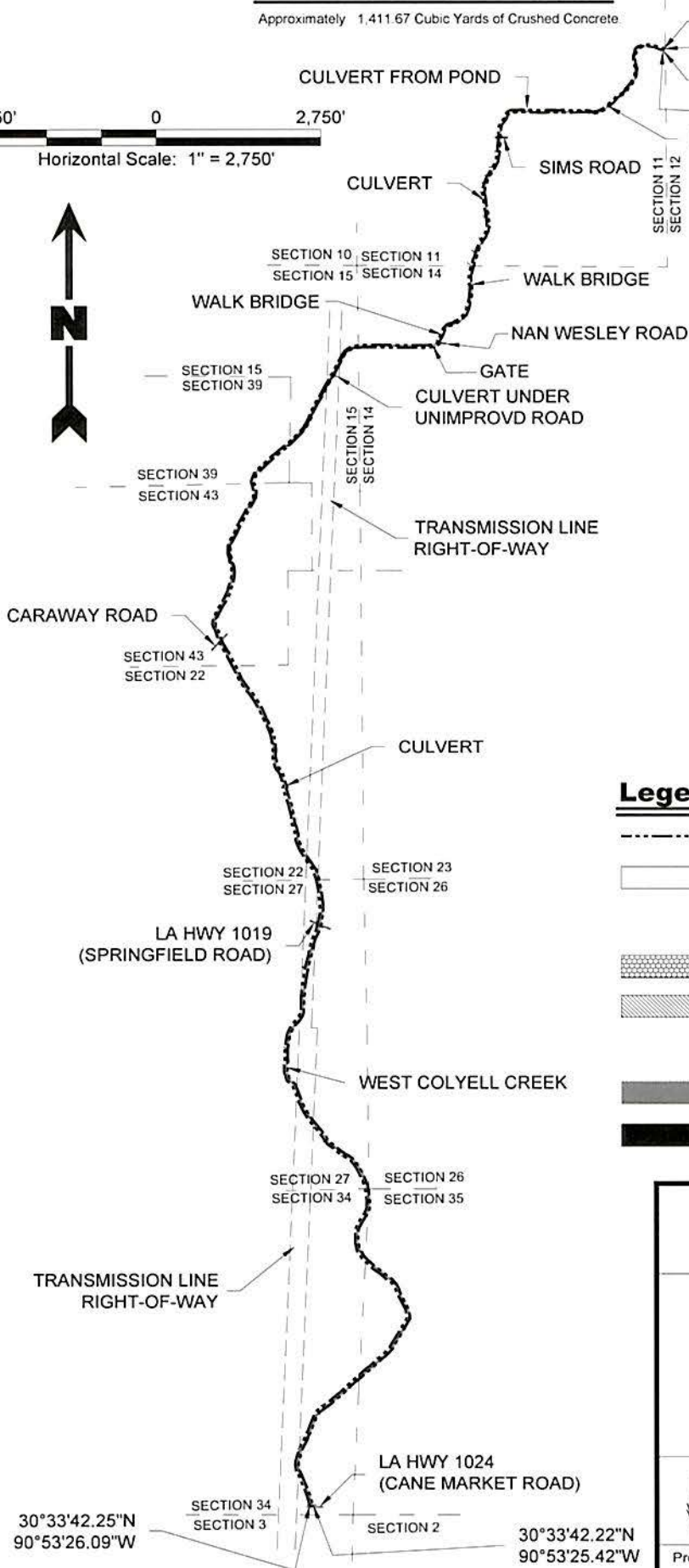

Notes

1. The Proposed layout was provided by Livingston Parish Gravity Drainage District No. 2.
2. Jurisdictional Wetlands & Other Waters Of The U.S. obtained from U.S. Army CORPS of Engineers Jurisdictional Determination Account Number MVN-2014-00763-SY.
3. Wetland impacts by habitat type:
 >Bottomland Hardwood =0.87 Acres
 >Herbaceous =0.56 Acres
 >Scrub/Shrub =0.16 Acres
5. Excavated material will be redistributed in non-wetlands on-site. Any excess excavated material will be transported off-site to the maintenance yard for Livingston Parish Gravity Drainage District #2 located off LA Hwy 1019 (Springfield Road)(see Vicinity Map).
6. Wetland impacts shall consist of mechanized clearing of impeding vegetation, excavating (mucking out) the upper 6" and refilling with crushed concrete to a correlating elevation, which will ensure hydrological flow and connectivity to adjacent wetlands thereof.

Legend

- Property Boundary (37.46 Acres)
- Non-Wetlands (12.44 Acres)
- Total Jurisdictional Wetlands (2.16 Acres)
- ▨ Jurisdictional Wetlands To Be Excavated / Filled (1.59 Acres)
- ▩ Jurisdictional Wetlands Not To Be Impacted (0.57 Acres)
- Total Other Waters Of The US (22.86 Acres)
- Other Waters Of The US To Be Excavated (22.76 Acres)
- Other Waters Of The US Not To Be Impacted (0.10 Acres)

Livingston Parish Gravity Drainage District No. 2

West Colyell Creek Maintenance Project

Overall Proposed Plan View

Livingston Parish, Louisiana

D & S
ENVIRONMENTAL SERVICES, INC.

Project. No.: 26-2017-DOA Date: 07-20-2017 Figure No.: 2

30°33'42.25"N
 90°53'26.09"W

30°33'42.22"N
 90°53'25.42"W

100' 0 100'

Horizontal Scale: 1" = 100'



15' MAINTENANCE CORRIDOR

EXTENT OF PROJECT ACTIVITY

30°37'50.42"N
90°52'16.24"W

30°37'50.06"N
90°52'16.30"W

LA HWY 1023
(REINNINGER ROAD)

CULVERT

SECTION 11
SECTION 12

WEST COLYELL CREEK

7,757'

7,694'

DILAPIDATED BRIDGE

MATCH LINE - SEE FIGURE 4

Legend

- Property Boundary (37.46 Acres)
- Non-Wetlands (12.44 Acres)
- Total Jurisdictional Wetlands (2.16 Acres)
- ▨ Jurisdictional Wetlands To Be Excavated / Filled (1.59 Acres)
- ▨ Jurisdictional Wetlands Not To Be Impacted (0.57 Acres)
- Total Other Waters Of The US (22.86 Acres)
- Other Waters Of The US To Be Excavated (22.76 Acres)
- Other Waters Of The US Not To Be Impacted (0.10 Acres)

Notes

See Figure 2

Total Proposed Fill

See Figure 2

Livingston Parish Gravity Drainage District No. 2

West Colyell Creek Maintenance Project

Proposed Plan View

Livingston Parish, Louisiana



D & S
ENVIRONMENTAL SERVICES, INC.



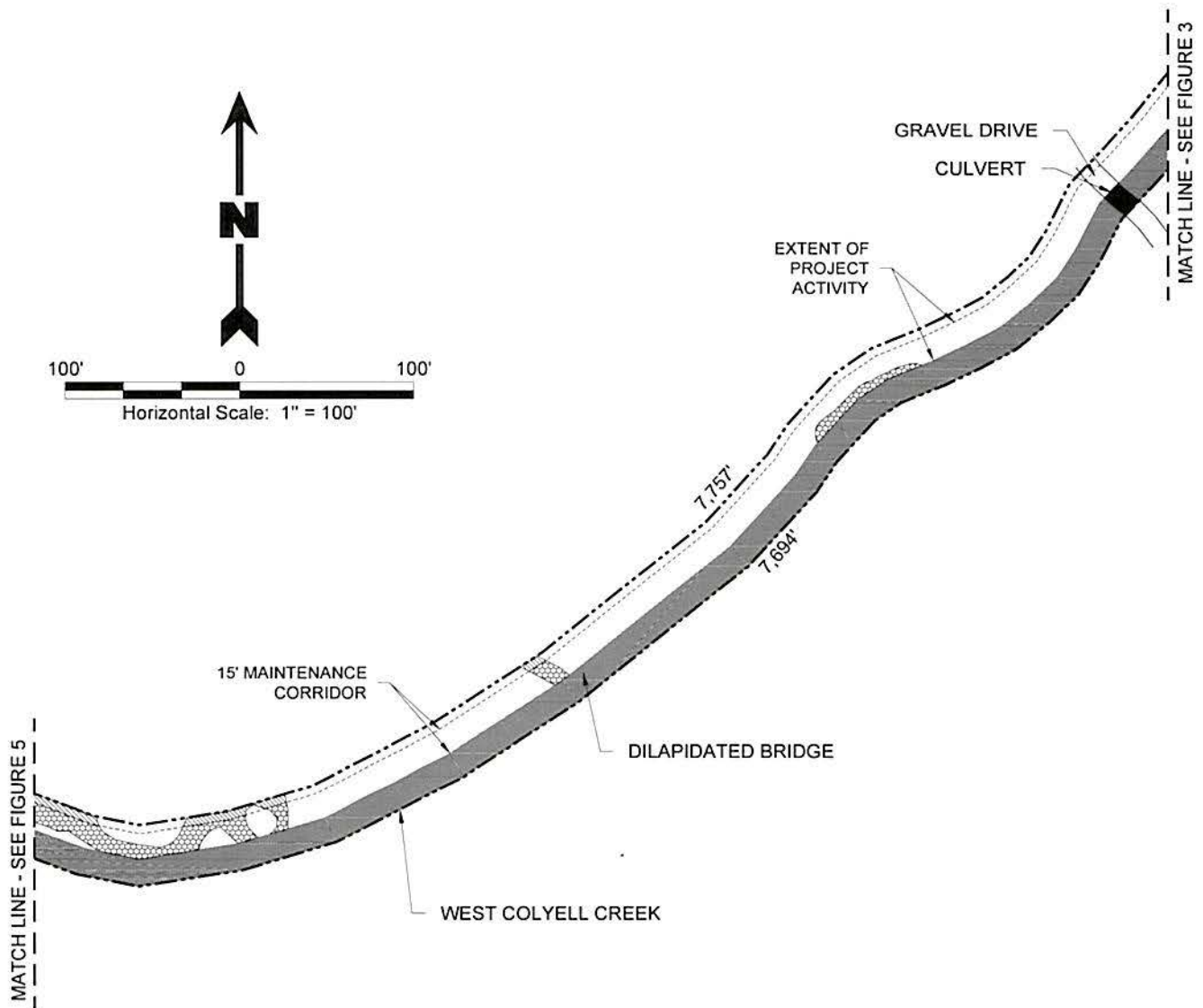

Notes

See Figure 2

Total Proposed Fill

See Figure 2

Legend

- Property Boundary (37.46 Acres)
- Non-Wetlands (12.44 Acres)
- Total Jurisdictional Wetlands (2.16 Acres)
- ▨ Jurisdictional Wetlands To Be Excavated / Filled (1.59 Acres)
- ▨ Jurisdictional Wetlands Not To Be Impacted (0.57 Acres)
- Total Other Waters Of The US (22.86 Acres)
- Other Waters Of The US To Be Excavated (22.76 Acres)
- Other Waters Of The US Not To Be Impacted (0.10 Acres)

Livingston Parish Gravity Drainage District No. 2

West Colyell Creek Maintenance Project

Proposed Plan View

Livingston Parish, Louisiana



D & S
ENVIRONMENTAL SERVICES, INC.



Project No.: 26-2017-DOA

Date: 07-20-2017

Figure No.: 4

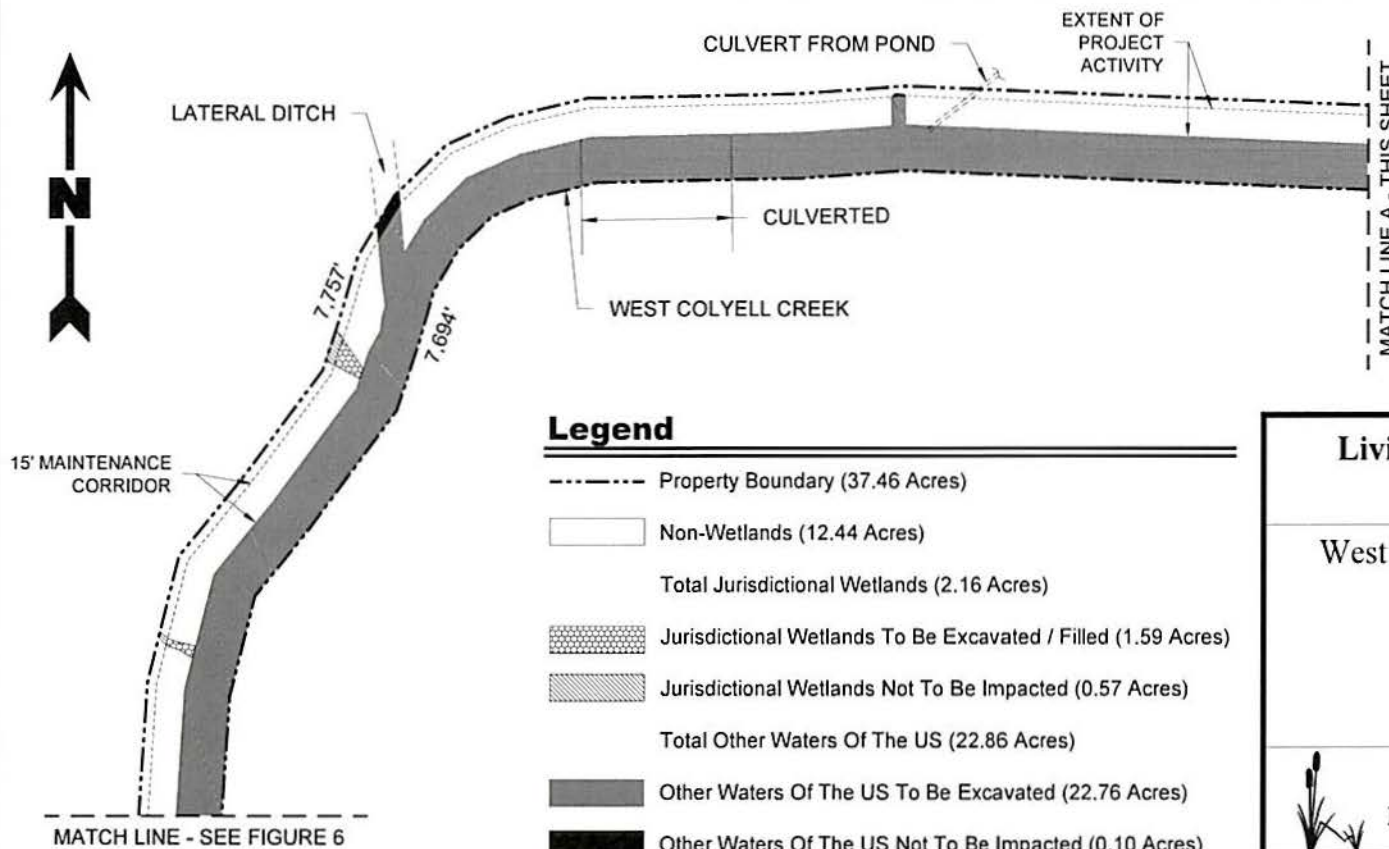
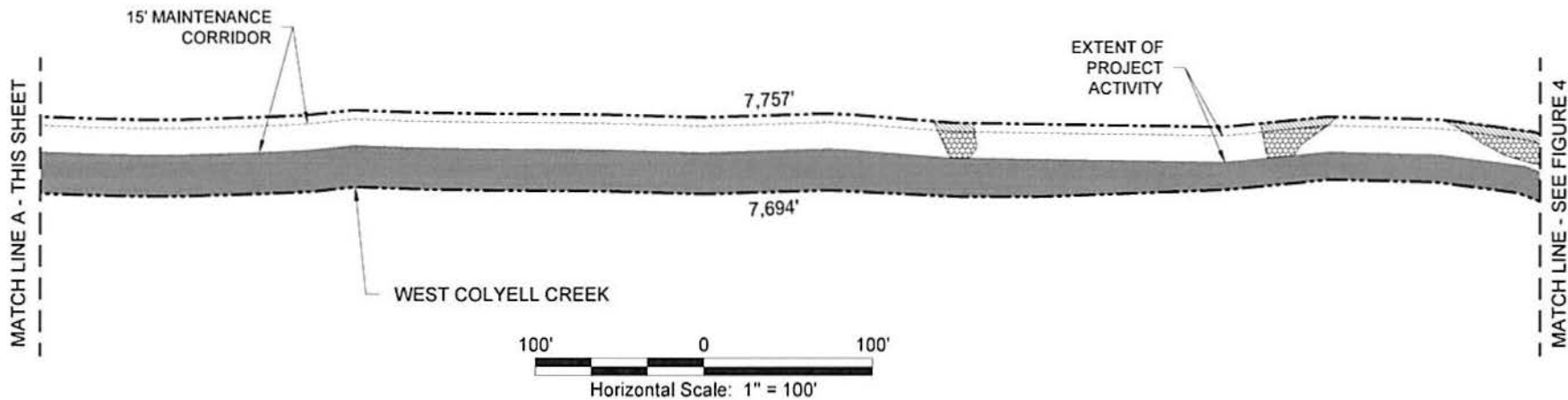

Legend

- Property Boundary (37.46 Acres)
- Non-Wetlands (12.44 Acres)
- Total Jurisdictional Wetlands (2.16 Acres)
 - ▨ Jurisdictional Wetlands To Be Excavated / Filled (1.59 Acres)
 - ▨ Jurisdictional Wetlands Not To Be Impacted (0.57 Acres)
- Total Other Waters Of The US (22.86 Acres)
 - Other Waters Of The US To Be Excavated (22.76 Acres)
 - Other Waters Of The US Not To Be Impacted (0.10 Acres)

Notes

See Figure 2

Total Proposed Fill

See Figure 2

Livingston Parish Gravity Drainage District No. 2

West Colyell Creek Maintenance Project

Proposed Plan View

Livingston Parish, Louisiana



D & S
ENVIRONMENTAL SERVICES, INC.





Notes

See Figure 2

Total Proposed Fill

See Figure 2

MATCH LINE - SEE FIGURE 5

CULVERT

LATERAL DITCH

CULVERT

SIMS ROAD

LATERAL DITCH

CULVERT

WEST COLYELL CREEK

LATERAL DITCH

EXTENT OF PROJECT ACTIVITY

7,757'

7,694'

Legend

- Property Boundary (37.46 Acres)
- Non-Wetlands (12.44 Acres)
- Total Jurisdictional Wetlands (2.16 Acres)
- ▨ Jurisdictional Wetlands To Be Excavated / Filled (1.59 Acres)
- ▨ Jurisdictional Wetlands Not To Be Impacted (0.57 Acres)
- Total Other Waters Of The US (22.86 Acres)
- Other Waters Of The US To Be Excavated (22.76 Acres)
- Other Waters Of The US Not To Be Impacted (0.10 Acres)

15' MAINTENANCE CORRIDOR

LATERAL DITCH

LATERAL DITCH

LATERAL DITCH

MATCH LINE - SEE FIGURE 7

Livingston Parish Gravity Drainage District No. 2

West Colyell Creek Maintenance Project

Proposed Plan View

Livingston Parish, Louisiana



D & S ENVIRONMENTAL SERVICES, INC.



MATCH LINE - SEE FIGURE 6

EXTENT OF PROJECT ACTIVITY

LATERAL DITCH

LATERAL DITCH

CULVERT

Notes

See Figure 2

Total Proposed Fill

See Figure 2

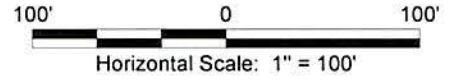

WEST COLYELL CREEK

LATERAL DITCHES

7,757'

7,694'

15' MAINTENANCE CORRIDOR

MATCH LINE - SEE FIGURE 8

Legend

- Property Boundary (37.46 Acres)
- Non-Wetlands (12.44 Acres)
- Total Jurisdictional Wetlands (2.16 Acres)
- ▨ Jurisdictional Wetlands To Be Excavated / Filled (1.59 Acres)
- ▨ Jurisdictional Wetlands Not To Be Impacted (0.57 Acres)
- Total Other Waters Of The US (22.86 Acres)
- Other Waters Of The US To Be Excavated (22.76 Acres)
- Other Waters Of The US Not To Be Impacted (0.10 Acres)

Livingston Parish Gravity Drainage District No. 2

West Colyell Creek Maintenance Project

Proposed Plan View

Livingston Parish, Louisiana



D & S
ENVIRONMENTAL SERVICES, INC.



Project No.:	26-2017-DOA	Date:	07-20-2017	Figure No.:	7
--------------	-------------	-------	------------	-------------	---

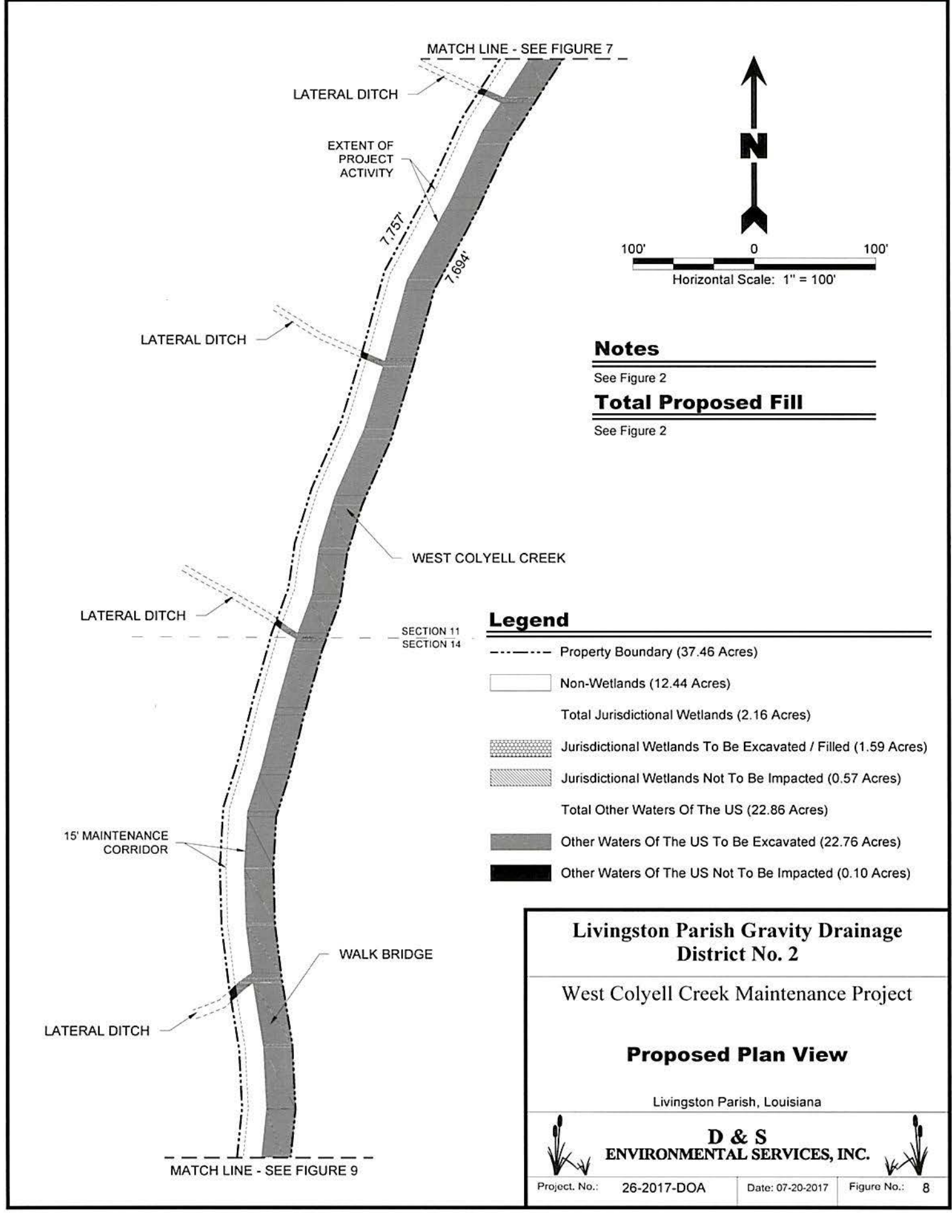

MATCH LINE - SEE FIGURE 7

LATERAL DITCH

EXTENT OF PROJECT ACTIVITY

7,757'

7,694'

LATERAL DITCH

LATERAL DITCH

WEST COLYELL CREEK

SECTION 11
SECTION 14

15' MAINTENANCE CORRIDOR

WALK BRIDGE

LATERAL DITCH

MATCH LINE - SEE FIGURE 9

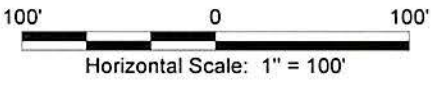

Notes

See Figure 2

Total Proposed Fill

See Figure 2

Legend

- Property Boundary (37.46 Acres)
- Non-Wetlands (12.44 Acres)
- Total Jurisdictional Wetlands (2.16 Acres)
- ▨ Jurisdictional Wetlands To Be Excavated / Filled (1.59 Acres)
- ▨ Jurisdictional Wetlands Not To Be Impacted (0.57 Acres)
- Total Other Waters Of The US (22.86 Acres)
- Other Waters Of The US To Be Excavated (22.76 Acres)
- Other Waters Of The US Not To Be Impacted (0.10 Acres)

Livingston Parish Gravity Drainage District No. 2

West Colyell Creek Maintenance Project

Proposed Plan View

Livingston Parish, Louisiana

D & S ENVIRONMENTAL SERVICES, INC.

Project No.: 26-2017-DOA	Date: 07-20-2017	Figure No.: 8
--------------------------	------------------	---------------

MATCH LINE - SEE FIGURE 8

15' MAINTENANCE CORRIDOR

LATERAL DITCH

EXTENT OF PROJECT ACTIVITY

WEST COLYELL CREEK

7,757

7,694

MATCH LINE - SEE FIGURE 10

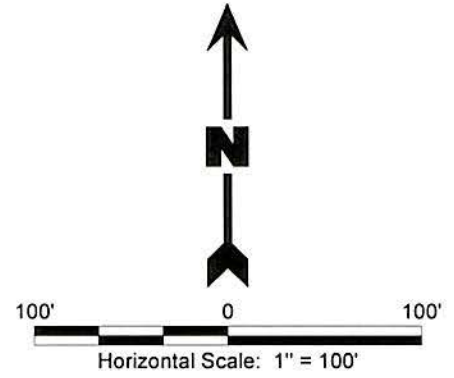

Notes

See Figure 2

Total Proposed Fill

See Figure 2

Legend

- Property Boundary (37.46 Acres)
- Non-Wetlands (12.44 Acres)
- Total Jurisdictional Wetlands (2.16 Acres)
- ▨ Jurisdictional Wetlands To Be Excavated / Filled (1.59 Acres)
- ▩ Jurisdictional Wetlands Not To Be Impacted (0.57 Acres)
- Total Other Waters Of The US (22.86 Acres)
- Other Waters Of The US To Be Excavated (22.76 Acres)
- Other Waters Of The US Not To Be Impacted (0.10 Acres)

Livingston Parish Gravity Drainage District No. 2

West Colyell Creek Maintenance Project

Proposed Plan View

Livingston Parish, Louisiana



D & S ENVIRONMENTAL SERVICES, INC.



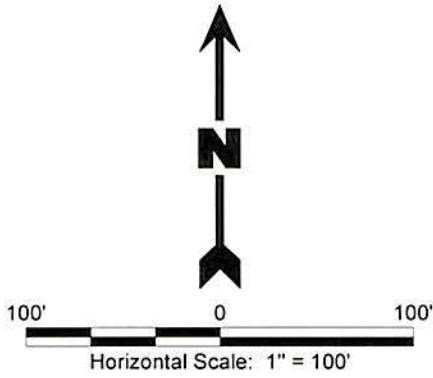

Notes

See Figure 2

Total Proposed Fill

See Figure 2

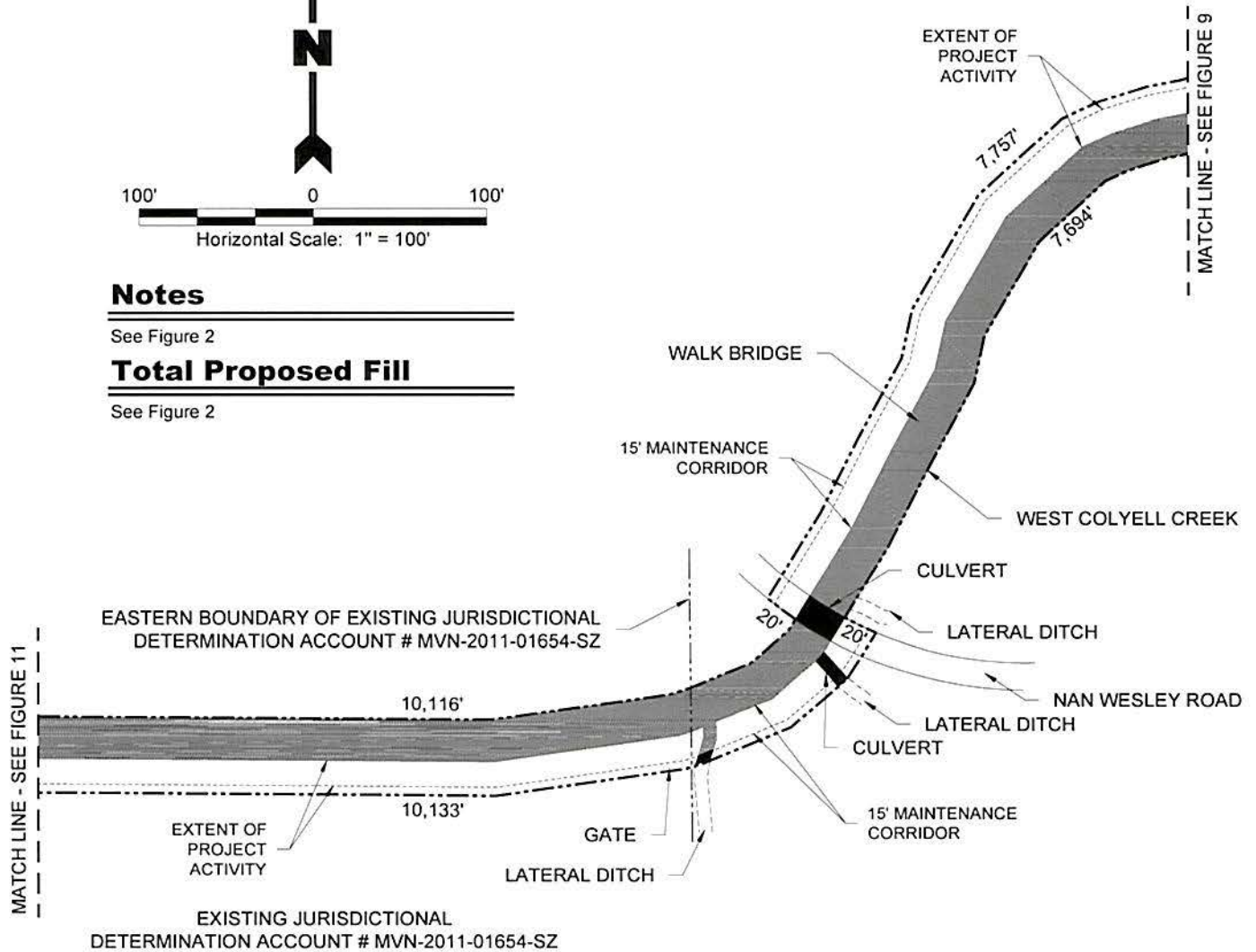

Legend

- Property Boundary (37.46 Acres)
- Non-Wetlands (12.44 Acres)
- Total Jurisdictional Wetlands (2.16 Acres)
- ▨ Jurisdictional Wetlands To Be Excavated / Filled (1.59 Acres)
- ▨ Jurisdictional Wetlands Not To Be Impacted (0.57 Acres)
- Total Other Waters Of The US (22.86 Acres)
- Other Waters Of The US To Be Excavated (22.76 Acres)
- Other Waters Of The US Not To Be Impacted (0.10 Acres)

Livingston Parish Gravity Drainage District No. 2

West Colyell Creek Maintenance Project

Proposed Plan View

Livingston Parish, Louisiana



D & S ENVIRONMENTAL SERVICES, INC.



Notes

See Figure 2

Total Proposed Fill

See Figure 2

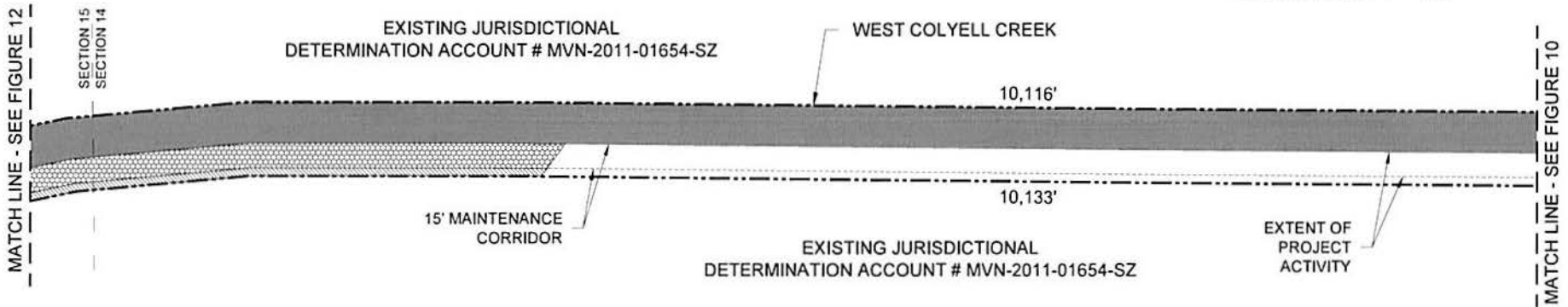
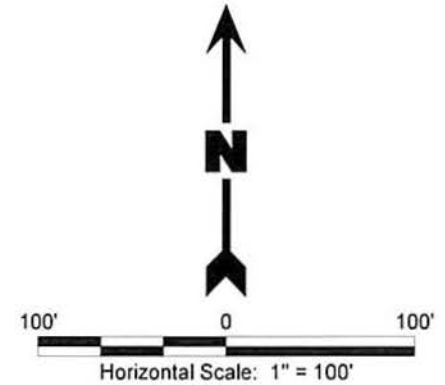

Legend

- Property Boundary (37.46 Acres)
- Non-Wetlands (12.44 Acres)
- Total Jurisdictional Wetlands (2.16 Acres)
- ▨ Jurisdictional Wetlands To Be Excavated / Filled (1.59 Acres)
- ▩ Jurisdictional Wetlands Not To Be Impacted (0.57 Acres)
- Total Other Waters Of The US (22.86 Acres)
- Other Waters Of The US To Be Excavated (22.76 Acres)
- Other Waters Of The US Not To Be Impacted (0.10 Acres)

Livingston Parish Gravity Drainage District No. 2

West Colyell Creek Maintenance Project

Proposed Plan View

Livingston Parish, Louisiana

D & S ENVIRONMENTAL SERVICES, INC.

Project No.: 26-2017-DOA	Date: 07-20-2017	Figure No.: 11
--------------------------	------------------	----------------

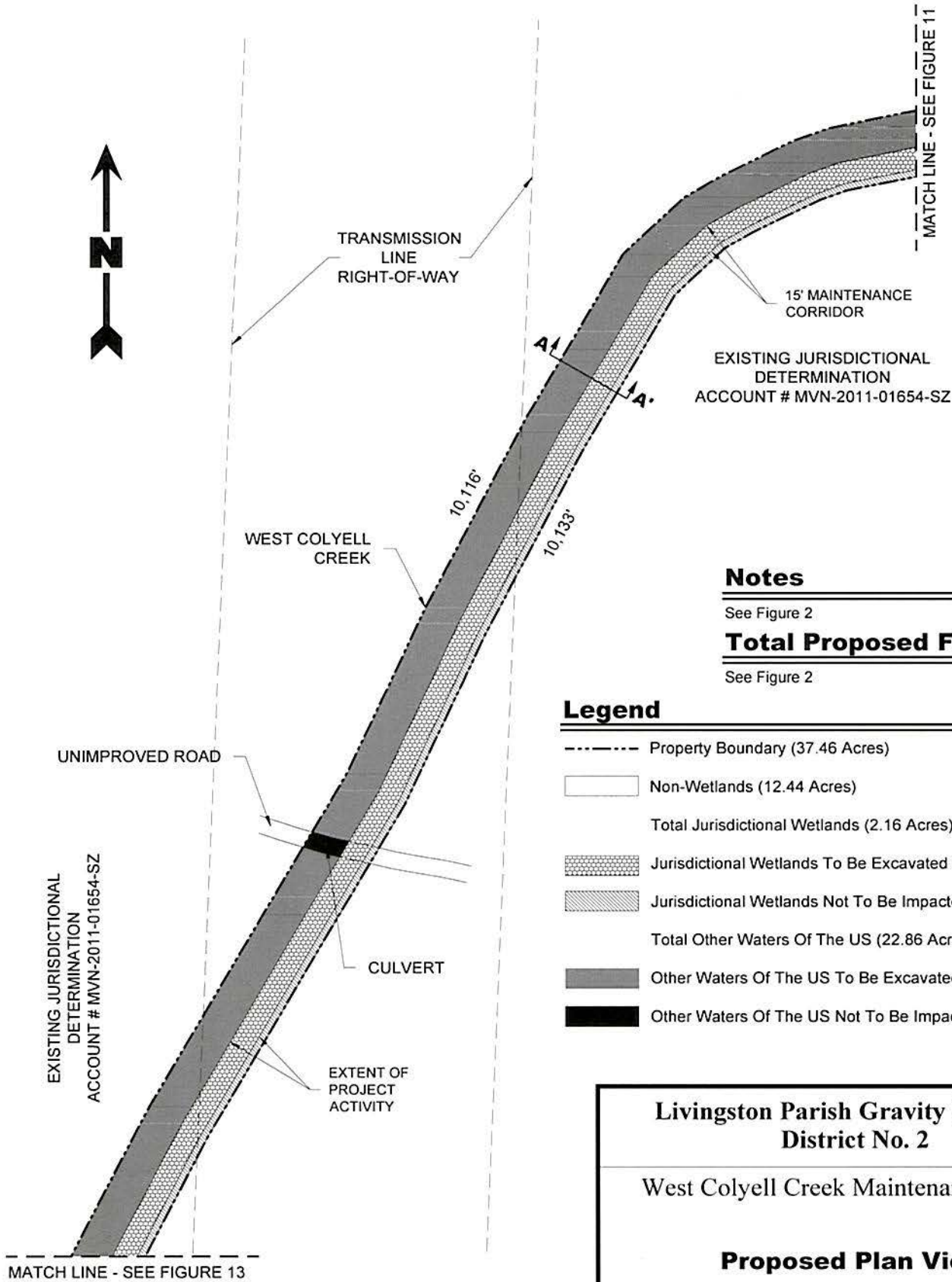

Notes

See Figure 2

Total Proposed Fill

See Figure 2

Legend

- Property Boundary (37.46 Acres)
- Non-Wetlands (12.44 Acres)
- Total Jurisdictional Wetlands (2.16 Acres)
- ▨ Jurisdictional Wetlands To Be Excavated / Filled (1.59 Acres)
- ▨ Jurisdictional Wetlands Not To Be Impacted (0.57 Acres)
- Total Other Waters Of The US (22.86 Acres)
- Other Waters Of The US To Be Excavated (22.76 Acres)
- Other Waters Of The US Not To Be Impacted (0.10 Acres)



Livingston Parish Gravity Drainage District No. 2

West Colyell Creek Maintenance Project

Proposed Plan View

Livingston Parish, Louisiana

D & S ENVIRONMENTAL SERVICES, INC.

Project. No.: 26-2017-DOA	Date: 07-20-2017	Figure No.: 12
---------------------------	------------------	----------------



EXISTING JURISDICTIONAL DETERMINATION ACCOUNT # MVN-2011-01654-SZ

MATCH LINE - SEE FIGURE 12

EXTENT OF PROJECT ACTIVITY

10,116'

10,133'

15' MAINTENANCE CORRIDOR

WEST COLYELL CREEK

Notes

See Figure 2

Total Proposed Fill

See Figure 2

Legend

- Property Boundary (37.46 Acres)
- Non-Wetlands (12.44 Acres)
- Total Jurisdictional Wetlands (2.16 Acres)
- ▨ Jurisdictional Wetlands To Be Excavated / Filled (1.59 Acres)
- ▨ Jurisdictional Wetlands Not To Be Impacted (0.57 Acres)
- Total Other Waters Of The US (22.86 Acres)
- Other Waters Of The US To Be Excavated (22.76 Acres)
- Other Waters Of The US Not To Be Impacted (0.10 Acres)

EXISTING JURISDICTIONAL DETERMINATION ACCOUNT # MVN-2011-01654-SZ

SECTION 39
SECTION 15

MATCH LINE - SEE FIGURE 14

WESTERN BOUNDARY OF EXISTING JURISDICTIONAL DETERMINATION ACCOUNT # MVN-2011-01654-SZ

Livingston Parish Gravity Drainage District No. 2

West Colyell Creek Maintenance Project

Proposed Plan View

Livingston Parish, Louisiana

D & S ENVIRONMENTAL SERVICES, INC.

Project. No.: 26-2017-DOA	Date: 07-20-2017	Figure No.: 13
---------------------------	------------------	----------------

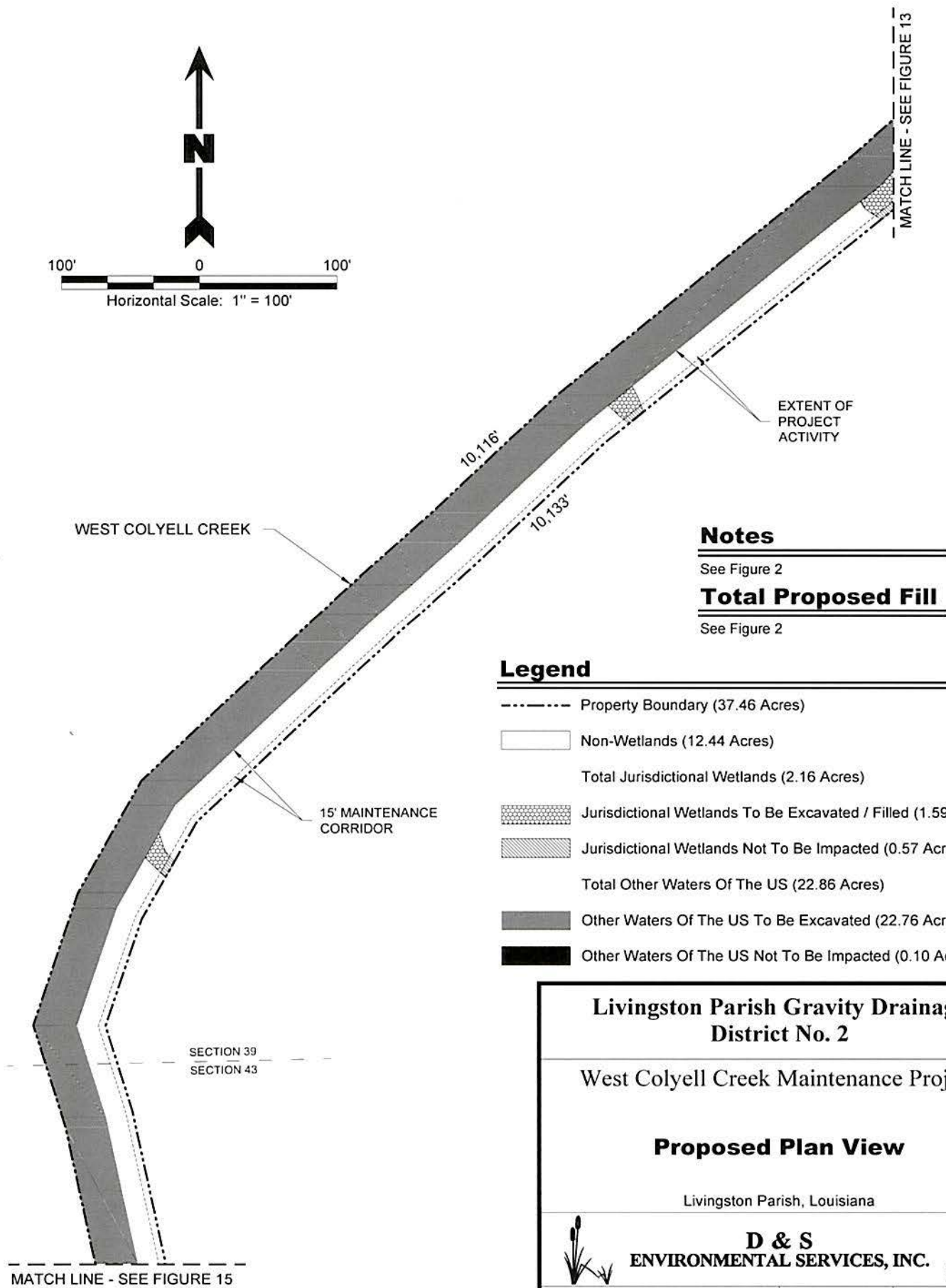
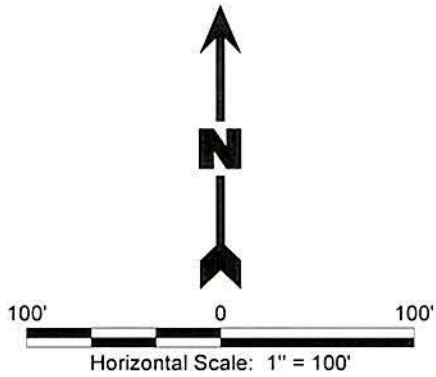

Notes

See Figure 2

Total Proposed Fill

See Figure 2

Legend

- Property Boundary (37.46 Acres)
- Non-Wetlands (12.44 Acres)
- Total Jurisdictional Wetlands (2.16 Acres)
- ▨ Jurisdictional Wetlands To Be Excavated / Filled (1.59 Acres)
- ▩ Jurisdictional Wetlands Not To Be Impacted (0.57 Acres)
- Total Other Waters Of The US (22.86 Acres)
- Other Waters Of The US To Be Excavated (22.76 Acres)
- Other Waters Of The US Not To Be Impacted (0.10 Acres)

**Livingston Parish Gravity Drainage
District No. 2**

West Colyell Creek Maintenance Project

Proposed Plan View

Livingston Parish, Louisiana

**D & S
ENVIRONMENTAL SERVICES, INC.**

Project No.: 26-2017-DOA	Date: 07-20-2017	Figure No.: 14
--------------------------	------------------	----------------



MATCH LINE - SEE FIGURE 14

WEST COLYELL CREEK

10,116'

10,733'

EXTENT OF PROJECT ACTIVITY

Notes

See Figure 2

Total Proposed Fill

See Figure 2

Legend

- Property Boundary (37.46 Acres)
- Non-Wetlands (12.44 Acres)
- Total Jurisdictional Wetlands (2.16 Acres)
- ▨ Jurisdictional Wetlands To Be Excavated / Filled (1.59 Acres)
- ▩ Jurisdictional Wetlands Not To Be Impacted (0.57 Acres)
- Total Other Waters Of The US (22.86 Acres)
- Other Waters Of The US To Be Excavated (22.76 Acres)
- Other Waters Of The US Not To Be Impacted (0.10 Acres)

15' MAINTENANCE CORRIDOR

MATCH LINE - SEE FIGURE 16

Livingston Parish Gravity Drainage District No. 2

West Colyell Creek Maintenance Project

Proposed Plan View

Livingston Parish, Louisiana



D & S ENVIRONMENTAL SERVICES, INC.



Project No.: 26-2017-DOA

Date: 07-20-2017

Figure No.: 15

MATCH LINE - SEE FIGURE 15

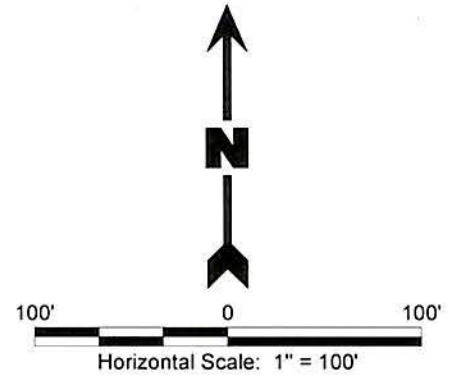
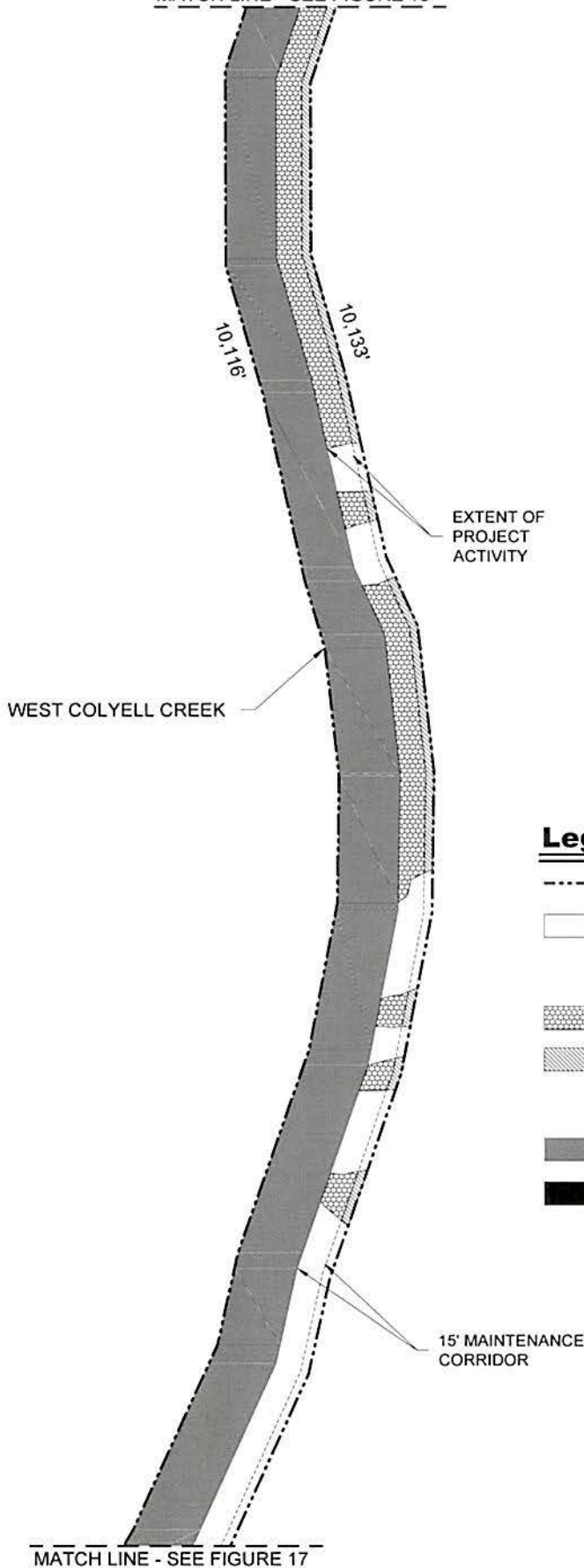

Notes

See Figure 2

Total Proposed Fill

See Figure 2

Legend

- Property Boundary (37.46 Acres)
- Non-Wetlands (12.44 Acres)
- Total Jurisdictional Wetlands (2.16 Acres)
- ▨ Jurisdictional Wetlands To Be Excavated / Filled (1.59 Acres)
- ▧ Jurisdictional Wetlands Not To Be Impacted (0.57 Acres)
- Total Other Waters Of The US (22.86 Acres)
- Other Waters Of The US To Be Excavated (22.76 Acres)
- Other Waters Of The US Not To Be Impacted (0.10 Acres)

Livingston Parish Gravity Drainage District No. 2

West Colyell Creek Maintenance Project

Proposed Plan View

Livingston Parish, Louisiana



D & S ENVIRONMENTAL SERVICES, INC.



MATCH LINE - SEE FIGURE 16

WEST COLYELL CREEK

EXTENT OF PROJECT ACTIVITY

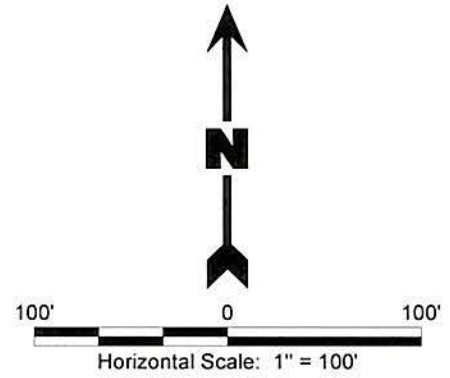

Notes

See Figure 2

Total Proposed Fill

See Figure 2

Legend

- Property Boundary (37.46 Acres)
- Non-Wetlands (12.44 Acres)
- Total Jurisdictional Wetlands (2.16 Acres)
- ▨ Jurisdictional Wetlands To Be Excavated / Filled (1.59 Acres)
- ▩ Jurisdictional Wetlands Not To Be Impacted (0.57 Acres)
- Total Other Waters Of The US (22.86 Acres)
- Other Waters Of The US To Be Excavated (22.76 Acres)
- Other Waters Of The US Not To Be Impacted (0.10 Acres)

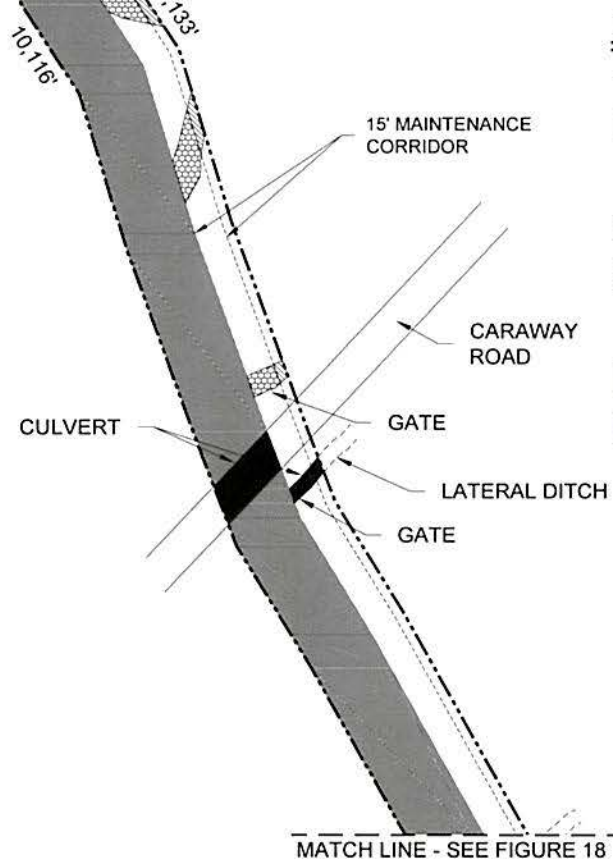

Livingston Parish Gravity Drainage District No. 2

West Colyell Creek Maintenance Project

Proposed Plan View

Livingston Parish, Louisiana



D & S
ENVIRONMENTAL SERVICES, INC.



MATCH LINE - SEE FIGURE 17

LATERAL DITCH

SECTION 43
SECTION 22

Legend

- Property Boundary (37.46 Acres)
- Non-Wetlands (12.44 Acres)
- Total Jurisdictional Wetlands (2.16 Acres)
 - ▨ Jurisdictional Wetlands To Be Excavated / Filled (1.59 Acres)
 - ▨ Jurisdictional Wetlands Not To Be Impacted (0.57 Acres)
- Total Other Waters Of The US (22.86 Acres)
 - Other Waters Of The US To Be Excavated (22.76 Acres)
 - Other Waters Of The US Not To Be Impacted (0.10 Acres)

Notes

See Figure 2

Total Proposed Fill

See Figure 2

EXTENT OF PROJECT ACTIVITY

WEST COLYELL CREEK

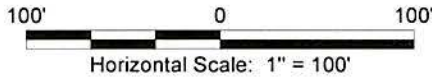

10.116'
10.133'

15' MAINTENANCE CORRIDOR

MATCH LINE - SEE FIGURE 19

Livingston Parish Gravity Drainage District No. 2

West Colyell Creek Maintenance Project

Proposed Plan View

Livingston Parish, Louisiana



D & S
ENVIRONMENTAL SERVICES, INC.



MATCH LINE - SEE FIGURE 18

WEST COLYELL CREEK

EXTENT OF PROJECT ACTIVITY

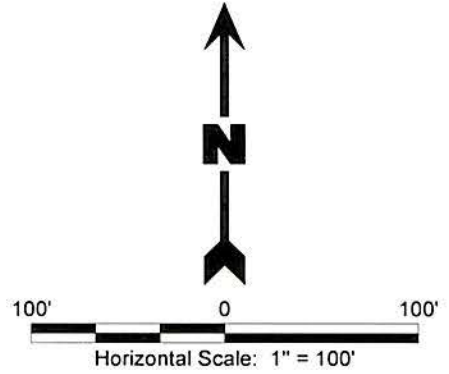

Notes

See Figure 2

Total Proposed Fill

See Figure 2

Legend

- Property Boundary (37.46 Acres)
- Non-Wetlands (12.44 Acres)
- Total Jurisdictional Wetlands (2.16 Acres)
- ▨ Jurisdictional Wetlands To Be Excavated / Filled (1.59 Acres)
- ▩ Jurisdictional Wetlands Not To Be Impacted (0.57 Acres)
- Total Other Waters Of The US (22.86 Acres)
- Other Waters Of The US To Be Excavated (22.76 Acres)
- Other Waters Of The US Not To Be Impacted (0.10 Acres)

WALK BRIDGE

15' MAINTENANCE CORRIDOR

10.116

10.133

Livingston Parish Gravity Drainage District No. 2

West Colyell Creek Maintenance Project

Proposed Plan View

Livingston Parish, Louisiana



D & S
ENVIRONMENTAL SERVICES, INC.



MATCH LINE - SEE FIGURE 20

MATCH LINE - SEE FIGURE 19

EXTENT OF PROJECT ACTIVITY

15' MAINTENANCE CORRIDOR

LATERAL DITCH

CULVERT

WEST COLYELL CREEK

EXTENT OF PROJECT ACTIVITY

15' MAINTENANCE CORRIDOR

LATERAL DITCH

MATCH LINE - SEE FIGURE 21



Notes

See Figure 2

Total Proposed Fill

See Figure 2

Legend

- Property Boundary (37.46 Acres)
- Non-Wetlands (12.44 Acres)
- Total Jurisdictional Wetlands (2.16 Acres)
 - ▨ Jurisdictional Wetlands To Be Excavated / Filled (1.59 Acres)
 - ▩ Jurisdictional Wetlands Not To Be Impacted (0.57 Acres)
- Total Other Waters Of The US (22.86 Acres)
 - Other Waters Of The US To Be Excavated (22.76 Acres)
 - Other Waters Of The US Not To Be Impacted (0.10 Acres)

Livingston Parish Gravity Drainage District No. 2

West Colyell Creek Maintenance Project

Proposed Plan View

Livingston Parish, Louisiana



D & S ENVIRONMENTAL SERVICES, INC.



MATCH LINE - SEE FIGURE 20

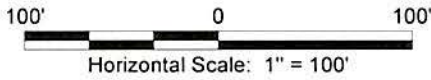

Notes

See Figure 2

Total Proposed Fill

See Figure 2

EXTENT OF PROJECT ACTIVITY

WEST COLYELL CREEK

Legend

- Property Boundary (37.46 Acres)
- Non-Wetlands (12.44 Acres)
- Total Jurisdictional Wetlands (2.16 Acres)
 - ▨ Jurisdictional Wetlands To Be Excavated / Filled (1.59 Acres)
 - ▨ Jurisdictional Wetlands Not To Be Impacted (0.57 Acres)
- Total Other Waters Of The US (22.86 Acres)
 - Other Waters Of The US To Be Excavated (22.76 Acres)
 - Other Waters Of The US Not To Be Impacted (0.10 Acres)

TRANSMISSION LINE RIGHT-OF-WAY

14,212
14,186

15' MAINTENANCE CORRIDOR

MATCH LINE - SEE FIGURE 22

Livingston Parish Gravity Drainage District No. 2

West Colyell Creek Maintenance Project

Proposed Plan View

Livingston Parish, Louisiana



D & S ENVIRONMENTAL SERVICES, INC.



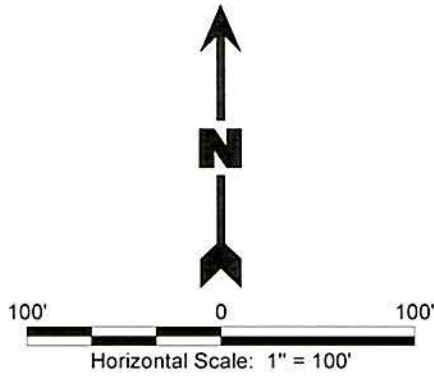

Notes

See Figure 2

Total Proposed Fill

See Figure 2

Legend

- Property Boundary (37.46 Acres)
- Non-Wetlands (12.44 Acres)
- Total Jurisdictional Wetlands (2.16 Acres)
- ▨ Jurisdictional Wetlands To Be Excavated / Filled (1.59 Acres)
- ▨ Jurisdictional Wetlands Not To Be Impacted (0.57 Acres)
- Total Other Waters Of The US (22.86 Acres)
- Other Waters Of The US To Be Excavated (22.76 Acres)
- Other Waters Of The US Not To Be Impacted (0.10 Acres)

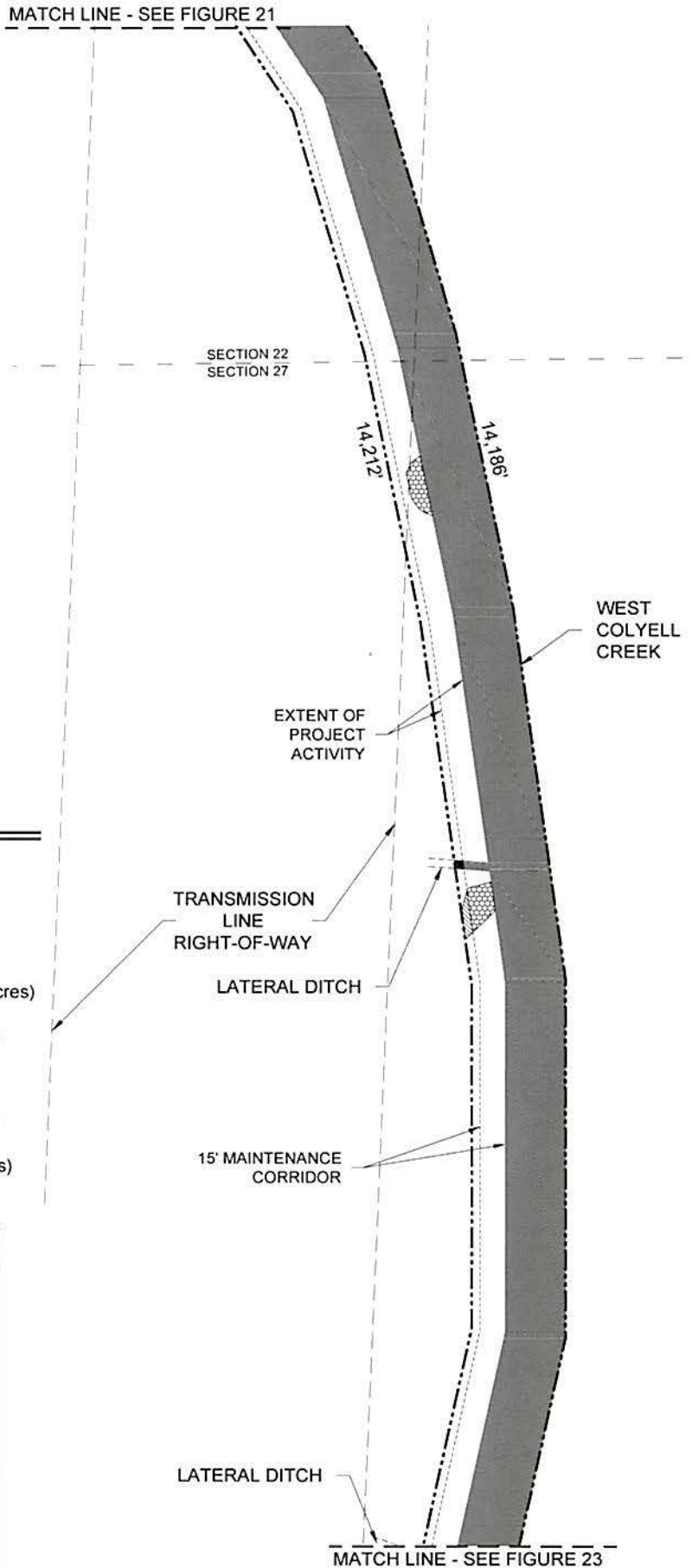

Livingston Parish Gravity Drainage District No. 2

West Colyell Creek Maintenance Project

Proposed Plan View

Livingston Parish, Louisiana



D & S ENVIRONMENTAL SERVICES, INC.



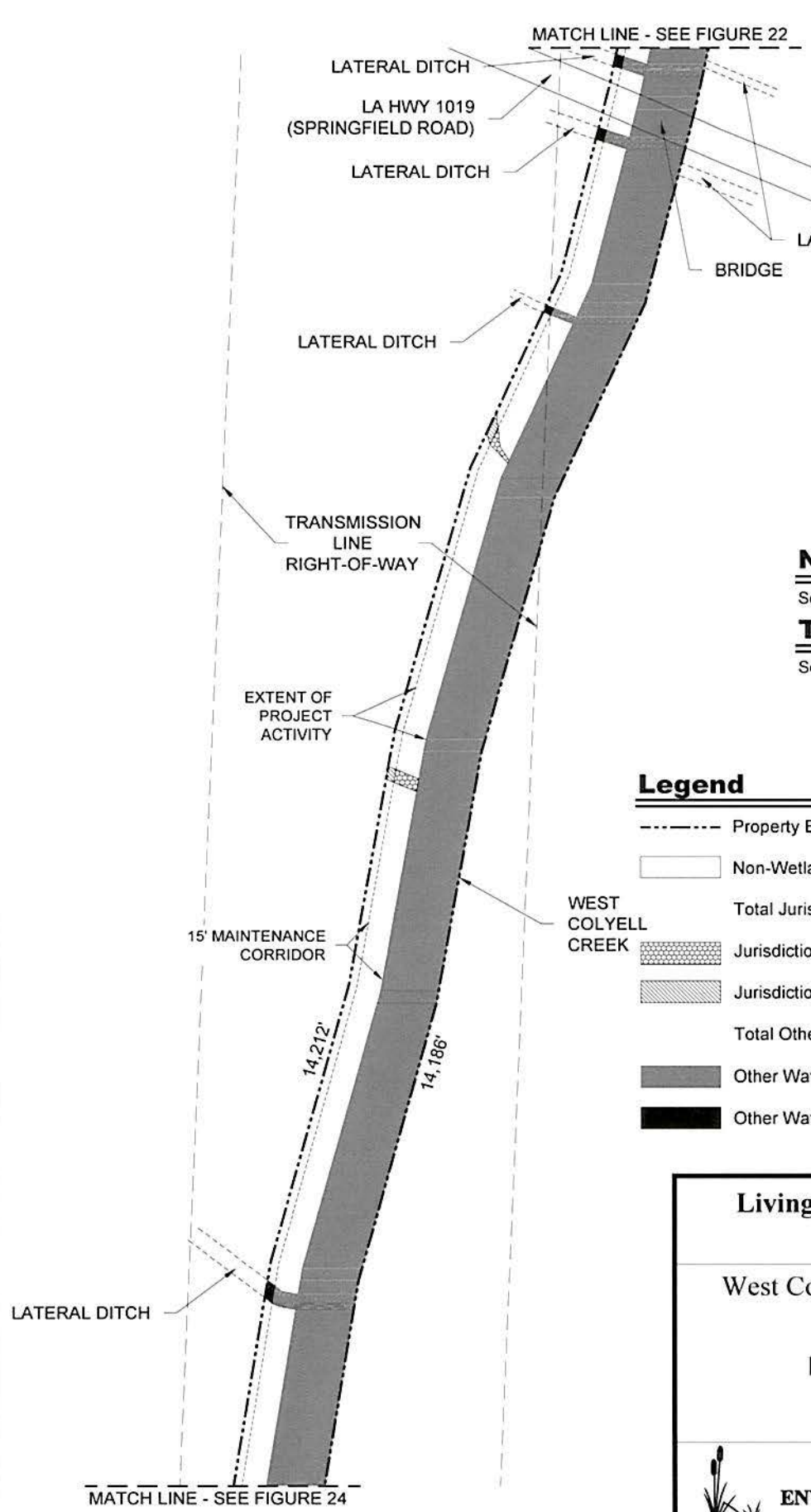

Notes

See Figure 2

Total Proposed Fill

See Figure 2

Legend

- Property Boundary (37.46 Acres)
- Non-Wetlands (12.44 Acres)
- ▨ Total Jurisdictional Wetlands (2.16 Acres)
 - ▨ Jurisdictional Wetlands To Be Excavated / Filled (1.59 Acres)
 - ▨ Jurisdictional Wetlands Not To Be Impacted (0.57 Acres)
- ▨ Total Other Waters Of The US (22.86 Acres)
 - ▨ Other Waters Of The US To Be Excavated (22.76 Acres)
 - ▨ Other Waters Of The US Not To Be Impacted (0.10 Acres)

Livingston Parish Gravity Drainage District No. 2

West Colyell Creek Maintenance Project

Proposed Plan View

Livingston Parish, Louisiana

D & S ENVIRONMENTAL SERVICES, INC.

Project No.: 26-2017-DOA	Date: 07-20-2017	Figure No.: 23
--------------------------	------------------	----------------

MATCH LINE - SEE FIGURE 23

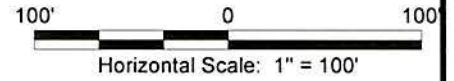

Notes

See Figure 2

Total Proposed Fill

See Figure 2

Legend

- Property Boundary (37.46 Acres)
- Non-Wetlands (12.44 Acres)
- Total Jurisdictional Wetlands (2.16 Acres)
- ▨ Jurisdictional Wetlands To Be Excavated / Filled (1.59 Acres)
- ▨ Jurisdictional Wetlands Not To Be Impacted (0.57 Acres)
- Total Other Waters Of The US (22.86 Acres)
- Other Waters Of The US To Be Excavated (22.76 Acres)
- Other Waters Of The US Not To Be Impacted (0.10 Acres)

LATERAL DITCH

WEST COLYELL CREEK

TRANSMISSION LINE RIGHT-OF-WAY

EXTENT OF PROJECT ACTIVITY

14,212'

14,186'

15' MAINTENANCE CORRIDOR

LATERAL DITCH

MATCH LINE - SEE FIGURE 25

Livingston Parish Gravity Drainage District No. 2

West Colyell Creek Maintenance Project

Proposed Plan View

Livingston Parish, Louisiana



D & S ENVIRONMENTAL SERVICES, INC.



MATCH LINE - SEE FIGURE 24

LATERAL DITCH

LATERAL DITCH

WEST COLYELL CREEK

14,212'

14,186'

EXTENT OF PROJECT ACTIVITY

WALK BRIDGE

15' MAINTENANCE CORRIDOR

MATCH LINE - SEE FIGURE 26



100' 0 100'
Horizontal Scale: 1" = 100'

Notes

See Figure 2

Total Proposed Fill

See Figure 2

Legend

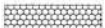
-  Property Boundary (37.46 Acres)
-  Non-Wetlands (12.44 Acres)
- Total Jurisdictional Wetlands (2.16 Acres)
 -  Jurisdictional Wetlands To Be Excavated / Filled (1.59 Acres)
 -  Jurisdictional Wetlands Not To Be Impacted (0.57 Acres)
- Total Other Waters Of The US (22.86 Acres)
 -  Other Waters Of The US To Be Excavated (22.76 Acres)
 -  Other Waters Of The US Not To Be Impacted (0.10 Acres)

Livingston Parish Gravity Drainage District No. 2

West Colyell Creek Maintenance Project

Proposed Plan View

Livingston Parish, Louisiana



D & S
ENVIRONMENTAL SERVICES, INC.



MATCH LINE - SEE FIGURE 25

Legend

- Property Boundary (37.46 Acres)
- Non-Wetlands (12.44 Acres)
- Total Jurisdictional Wetlands (2.16 Acres)
 - ▨ Jurisdictional Wetlands To Be Excavated / Filled (1.59 Acres)
 - ▨ Jurisdictional Wetlands Not To Be Impacted (0.57 Acres)
- Total Other Waters Of The US (22.86 Acres)
 - Other Waters Of The US To Be Excavated (22.76 Acres)
 - Other Waters Of The US Not To Be Impacted (0.10 Acres)

EXTENT OF PROJECT ACTIVITY

Notes

See Figure 2
Total Proposed Fill
 See Figure 2

TRANSMISSION LINE RIGHT-OF-WAY

15' MAINTENANCE CORRIDOR

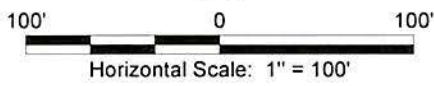

14,186'
 14,212'

WEST COLYELL CREEK

LATERAL DITCH

MATCH LINE - SEE FIGURE 27

**Livingston Parish Gravity Drainage
 District No. 2**

West Colyell Creek Maintenance Project

Proposed Plan View

Livingston Parish, Louisiana



**D & S
 ENVIRONMENTAL SERVICES, INC.**



MATCH LINE - SEE FIGURE 26

LATERAL DITCH

EXTENT OF PROJECT ACTIVITY

14,186'

14,212'



WEST COLYELL CREEK

LATERAL DITCH

15' MAINTENANCE CORRIDOR

MATCH LINE - SEE FIGURE 28

Notes

See Figure 2

Total Proposed Fill

See Figure 2

Livingston Parish Gravity Drainage District No. 2

West Colyell Creek Maintenance Project

Proposed Plan View

Livingston Parish, Louisiana



D & S
ENVIRONMENTAL SERVICES, INC.



Legend

- Property Boundary (37.46 Acres)
- Non-Wetlands (12.44 Acres)
- Total Jurisdictional Wetlands (2.16 Acres)
- ▨ Jurisdictional Wetlands To Be Excavated / Filled (1.59 Acres)
- ▩ Jurisdictional Wetlands Not To Be Impacted (0.57 Acres)
- Total Other Waters Of The US (22.86 Acres)
- Other Waters Of The US To Be Excavated (22.76 Acres)
- Other Waters Of The US Not To Be Impacted (0.10 Acres)

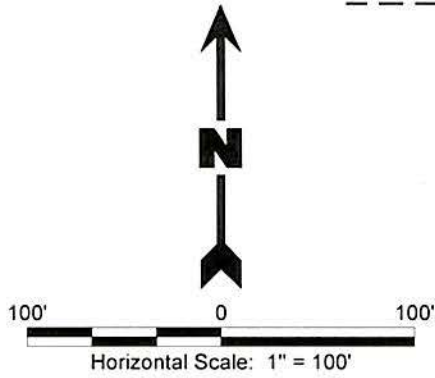

MATCH LINE - SEE FIGURE 27

EXTENT OF PROJECT ACTIVITY

SECTION 27
SECTION 34

SECTION 26
SECTION 35

14,212'

14,186'

15' MAINTENANCE CORRIDOR

WEST COLYELL CREEK

MATCH LINE - SEE FIGURE 29

Notes

See Figure 2

Total Proposed Fill

See Figure 2

Legend

- Property Boundary (37.46 Acres)
- Non-Wetlands (12.44 Acres)
- Total Jurisdictional Wetlands (2.16 Acres)
- ▨ Jurisdictional Wetlands To Be Excavated / Filled (1.59 Acres)
- ▨ Jurisdictional Wetlands Not To Be Impacted (0.57 Acres)
- Total Other Waters Of The US (22.86 Acres)
- Other Waters Of The US To Be Excavated (22.76 Acres)
- Other Waters Of The US Not To Be Impacted (0.10 Acres)

Livingston Parish Gravity Drainage District No. 2

West Colyell Creek Maintenance Project

Proposed Plan View

Livingston Parish, Louisiana



D & S
ENVIRONMENTAL SERVICES, INC.



MATCH LINE - SEE FIGURE 28

Legend

- Property Boundary (37.46 Acres)
- Non-Wetlands (12.44 Acres)
- Total Jurisdictional Wetlands (2.16 Acres)
 - ▨ Jurisdictional Wetlands To Be Excavated / Filled (1.59 Acres)
 - ▨ Jurisdictional Wetlands Not To Be Impacted (0.57 Acres)
- Total Other Waters Of The US (22.86 Acres)
 - Other Waters Of The US To Be Excavated (22.76 Acres)
 - Other Waters Of The US Not To Be Impacted (0.10 Acres)

LATERAL DITCH

EXTENT OF PROJECT ACTIVITY

14,212'

14,186'

15' MAINTENANCE CORRIDOR

LATERAL DITCH

WEST COLYELL CREEK

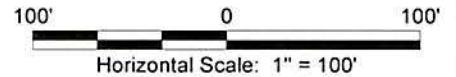

MATCH LINE - SEE FIGURE 30

Livingston Parish Gravity Drainage District No. 2

West Colyell Creek Maintenance Project

Proposed Plan View

Livingston Parish, Louisiana



D & S
ENVIRONMENTAL SERVICES, INC.



Legend

- Property Boundary (37.46 Acres)
- Non-Wetlands (12.44 Acres)
- Total Jurisdictional Wetlands (2.16 Acres)
 - ▨ Jurisdictional Wetlands To Be Excavated / Filled (1.59 Acres)
 - ▨ Jurisdictional Wetlands Not To Be Impacted (0.57 Acres)
- Total Other Waters Of The US (22.86 Acres)
 - Other Waters Of The US To Be Excavated (22.76 Acres)
 - Other Waters Of The US Not To Be Impacted (0.10 Acres)

Notes

See Figure 2

Total Proposed Fill

See Figure 2

MATCH LINE - SEE FIGURE 29

EXTENT OF PROJECT ACTIVITY

14,212'

14,186'

15' MAINTENANCE CORRIDOR

WEST COLYELL CREEK

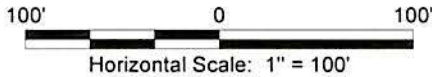

Livingston Parish Gravity Drainage District No. 2

West Colyell Creek Maintenance Project

Proposed Plan View

Livingston Parish, Louisiana



D & S ENVIRONMENTAL SERVICES, INC.



MATCH LINE - SEE FIGURE 31

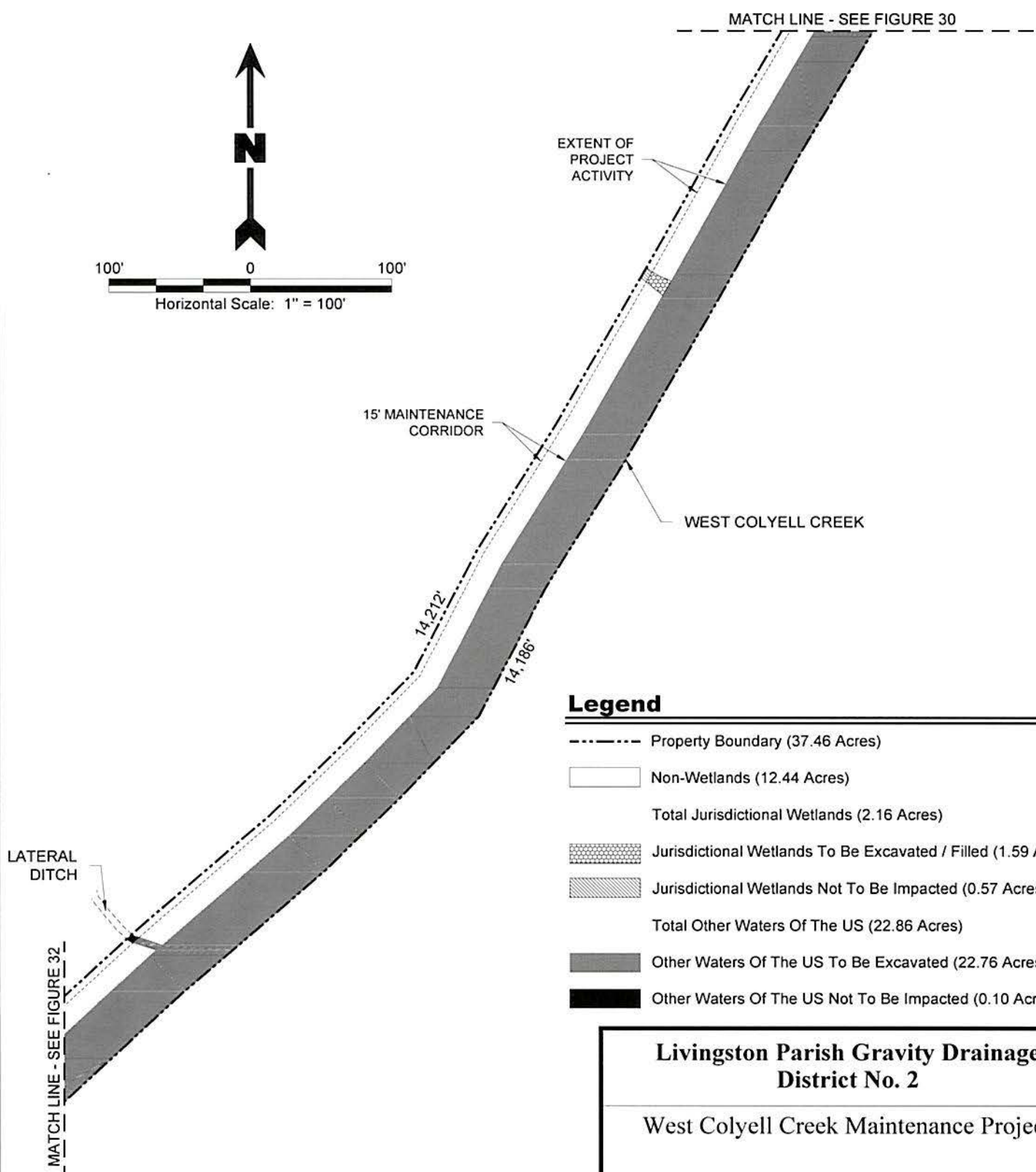
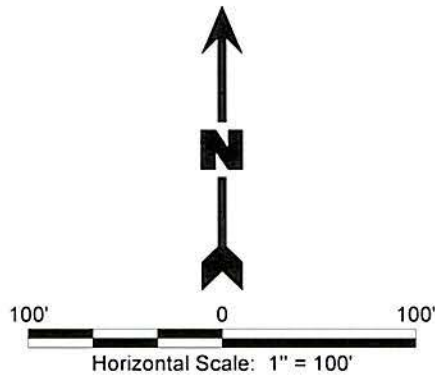

Legend

- Property Boundary (37.46 Acres)
- Non-Wetlands (12.44 Acres)
- Total Jurisdictional Wetlands (2.16 Acres)
- ▨ Jurisdictional Wetlands To Be Excavated / Filled (1.59 Acres)
- ▨ Jurisdictional Wetlands Not To Be Impacted (0.57 Acres)
- Total Other Waters Of The US (22.86 Acres)
- Other Waters Of The US To Be Excavated (22.76 Acres)
- Other Waters Of The US Not To Be Impacted (0.10 Acres)

Notes

See Figure 2
Total Proposed Fill
 See Figure 2

Livingston Parish Gravity Drainage District No. 2

West Colyell Creek Maintenance Project

Proposed Plan View

Livingston Parish, Louisiana

D & S ENVIRONMENTAL SERVICES, INC.

Project No.: 26-2017-DOA	Date: 07-20-2017	Figure No.: 31
--------------------------	------------------	----------------

Legend

- Property Boundary (37.46 Acres)
- Non-Wetlands (12.44 Acres)
- Total Jurisdictional Wetlands (2.16 Acres)
- ▨ Jurisdictional Wetlands To Be Excavated / Filled (1.59 Acres)
- ▨ Jurisdictional Wetlands Not To Be Impacted (0.57 Acres)
- Total Other Waters Of The US (22.86 Acres)
- Other Waters Of The US To Be Excavated (22.76 Acres)
- Other Waters Of The US Not To Be Impacted (0.10 Acres)

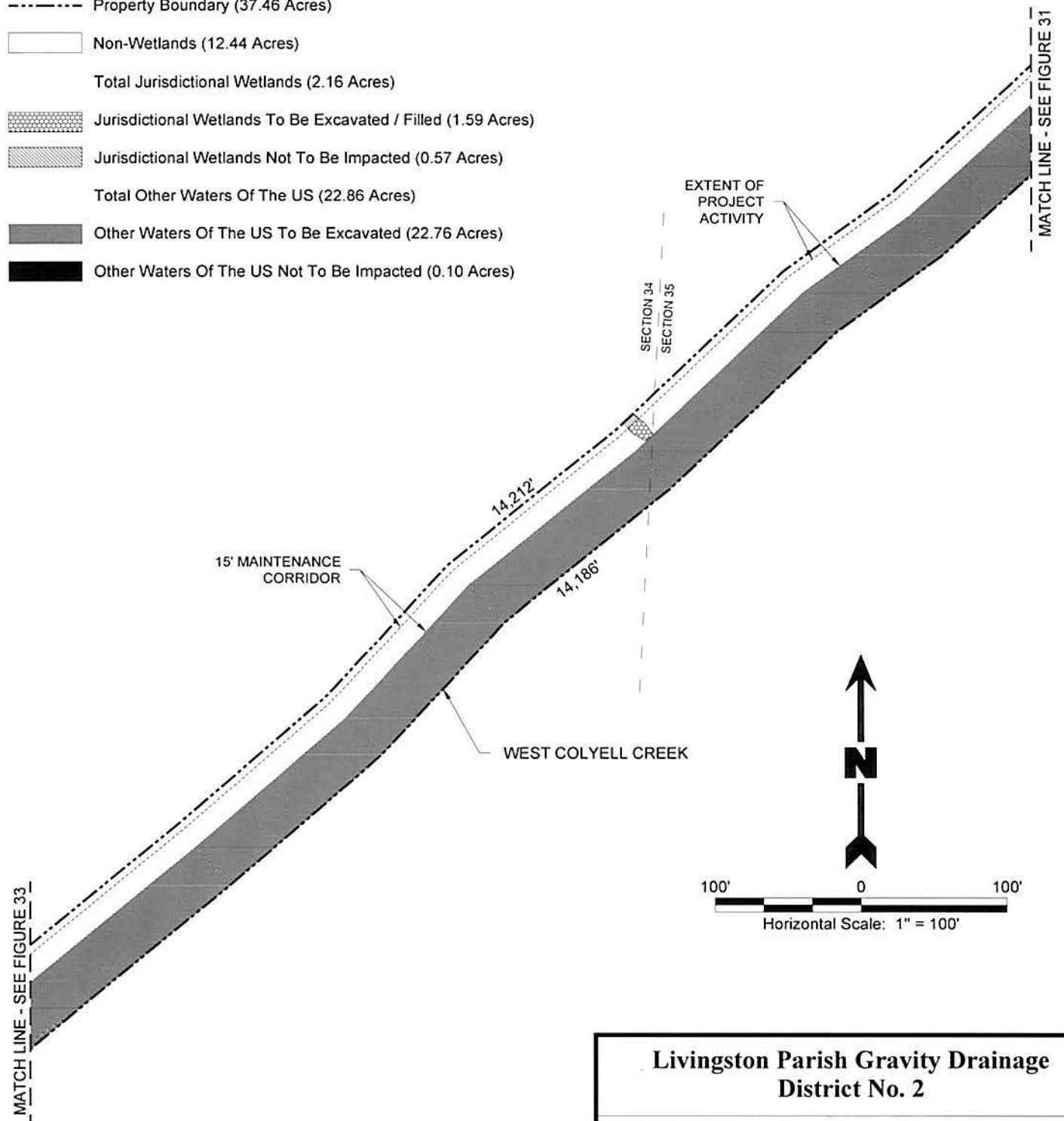

Notes

See Figure 2

Total Proposed Fill

See Figure 2

Livingston Parish Gravity Drainage District No. 2		
West Colyell Creek Maintenance Project		
Proposed Plan View		
Livingston Parish, Louisiana		
 D & S ENVIRONMENTAL SERVICES, INC. 		
Project No.:	26-2017-DOA	Date: 07-20-2017
		Figure No.: 32

Legend

- Property Boundary (37.46 Acres)
- Non-Wetlands (12.44 Acres)
- Total Jurisdictional Wetlands (2.16 Acres)
 - ▨ Jurisdictional Wetlands To Be Excavated / Filled (1.59 Acres)
 - ▨ Jurisdictional Wetlands Not To Be Impacted (0.57 Acres)
- Total Other Waters Of The US (22.86 Acres)
 - Other Waters Of The US To Be Excavated (22.76 Acres)
 - Other Waters Of The US Not To Be Impacted (0.10 Acres)

Notes

See Figure 2

Total Proposed Fill

See Figure 2

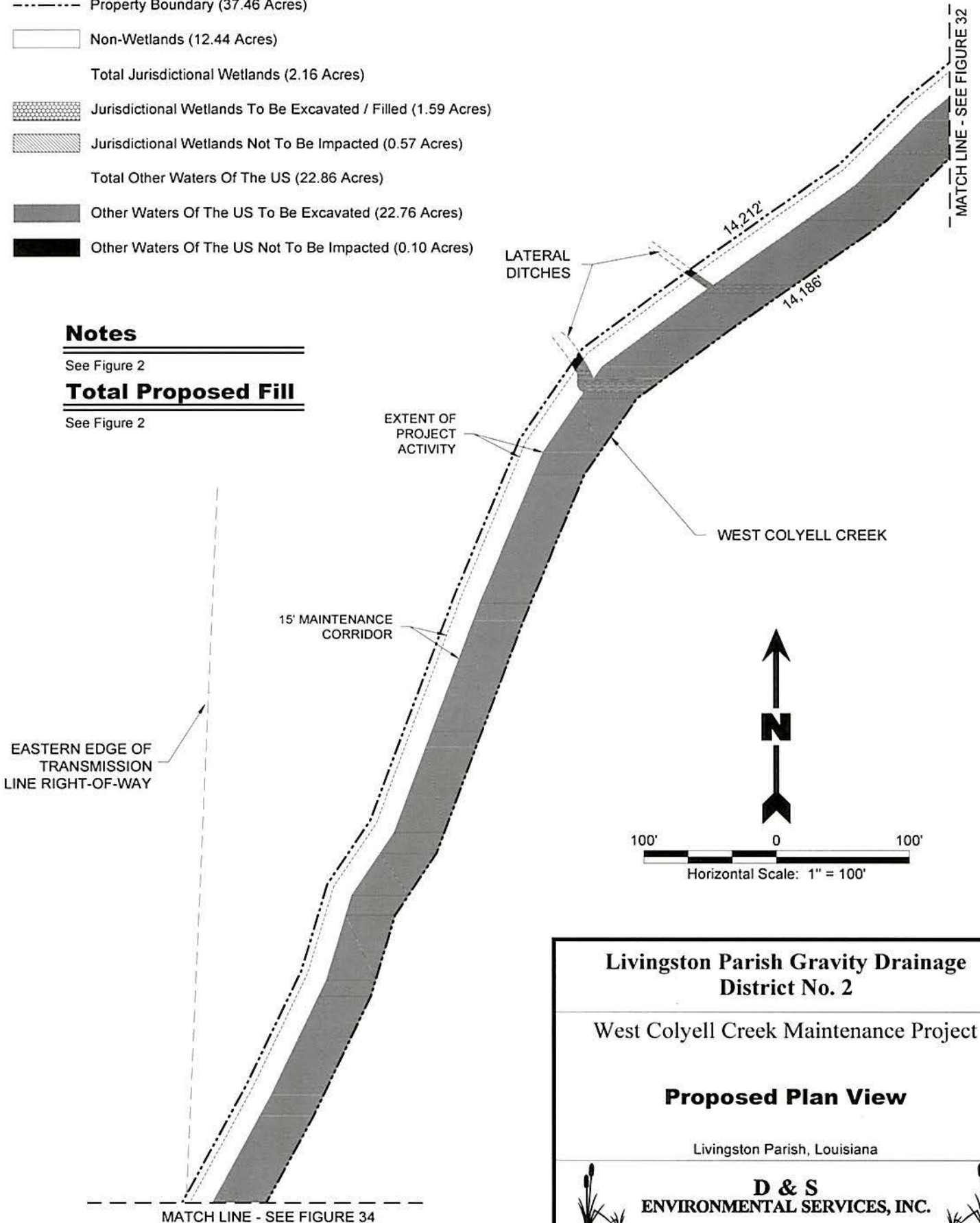

Livingston Parish Gravity Drainage District No. 2		
West Colyell Creek Maintenance Project		
Proposed Plan View		
Livingston Parish, Louisiana		
D & S ENVIRONMENTAL SERVICES, INC.		
Project No.: 26-2017-DOA	Date: 07-20-2017	Figure No.: 33

Legend

- Property Boundary (37.46 Acres)
- Non-Wetlands (12.44 Acres)
- Total Jurisdictional Wetlands (2.16 Acres)
 - ▨ Jurisdictional Wetlands To Be Excavated / Filled (1.59 Acres)
 - ▨ Jurisdictional Wetlands Not To Be Impacted (0.57 Acres)
- Total Other Waters Of The US (22.86 Acres)
 - Other Waters Of The US To Be Excavated (22.76 Acres)
 - Other Waters Of The US Not To Be Impacted (0.10 Acres)

Notes

See Figure 2

Total Proposed Fill

See Figure 2

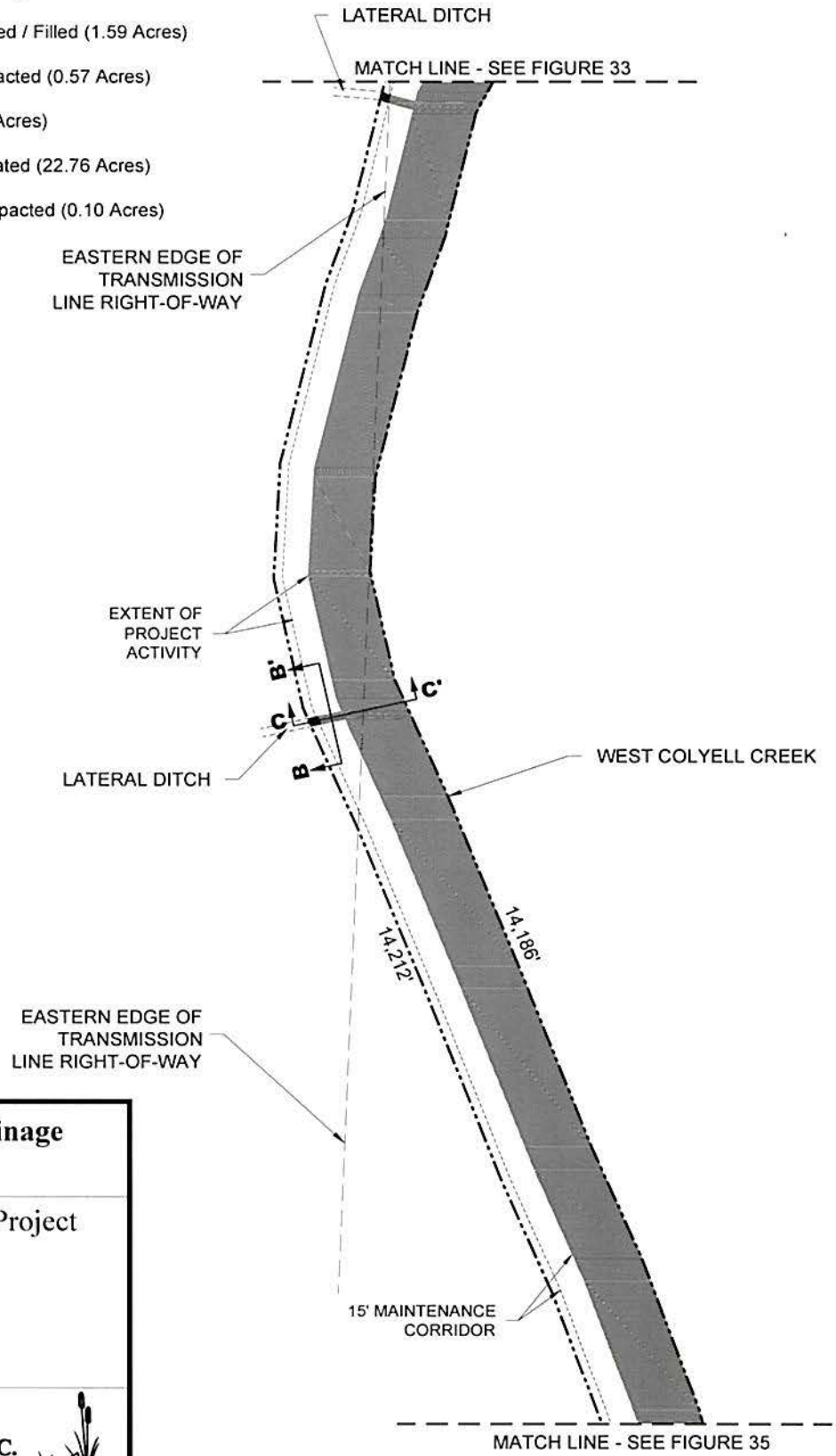
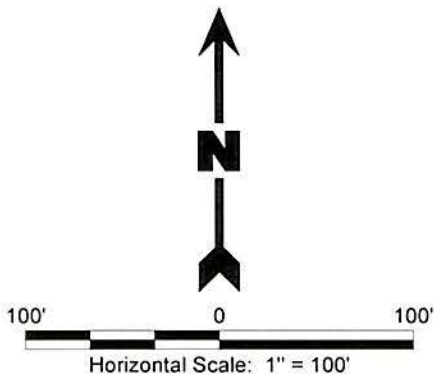

**Livingston Parish Gravity Drainage
District No. 2**

West Colyell Creek Maintenance Project

Proposed Plan View

Livingston Parish, Louisiana

D & S
ENVIRONMENTAL SERVICES, INC.

Project. No.: 26-2017-DOA	Date: 07-20-2017	Figure No.: 34
---------------------------	------------------	----------------

Notes

See Figure 2

Total Proposed Fill

See Figure 2

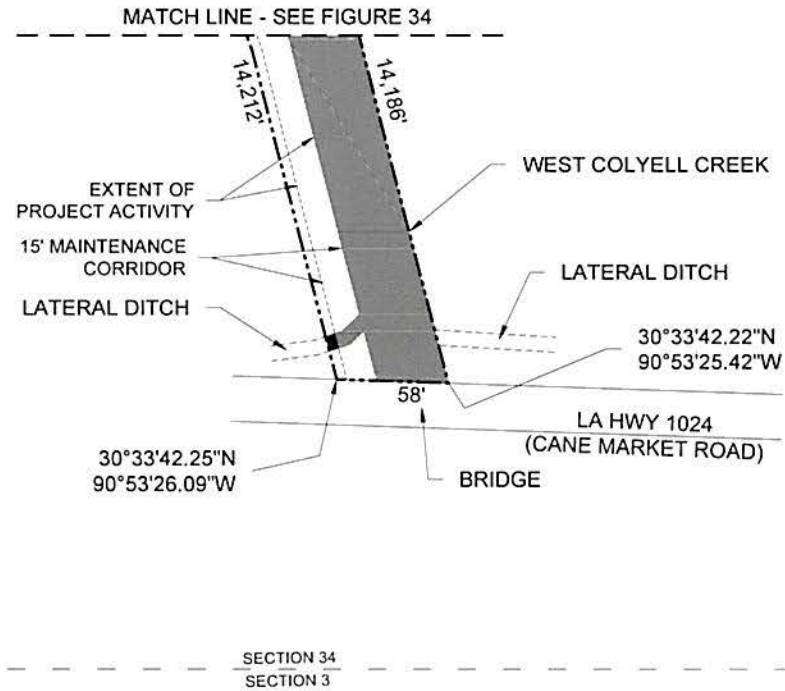
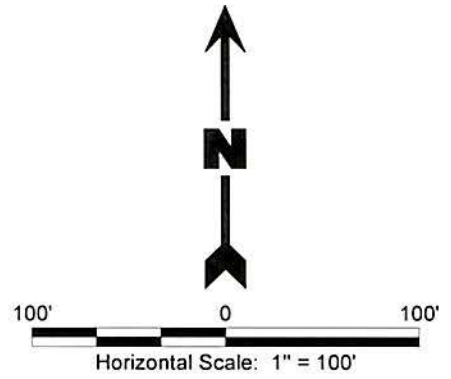

**Livingston Parish Gravity Drainage
District No. 2**

West Colyell Creek Maintenance Project

Proposed Plan View

Livingston Parish, Louisiana

**D & S
ENVIRONMENTAL SERVICES, INC.**

Legend

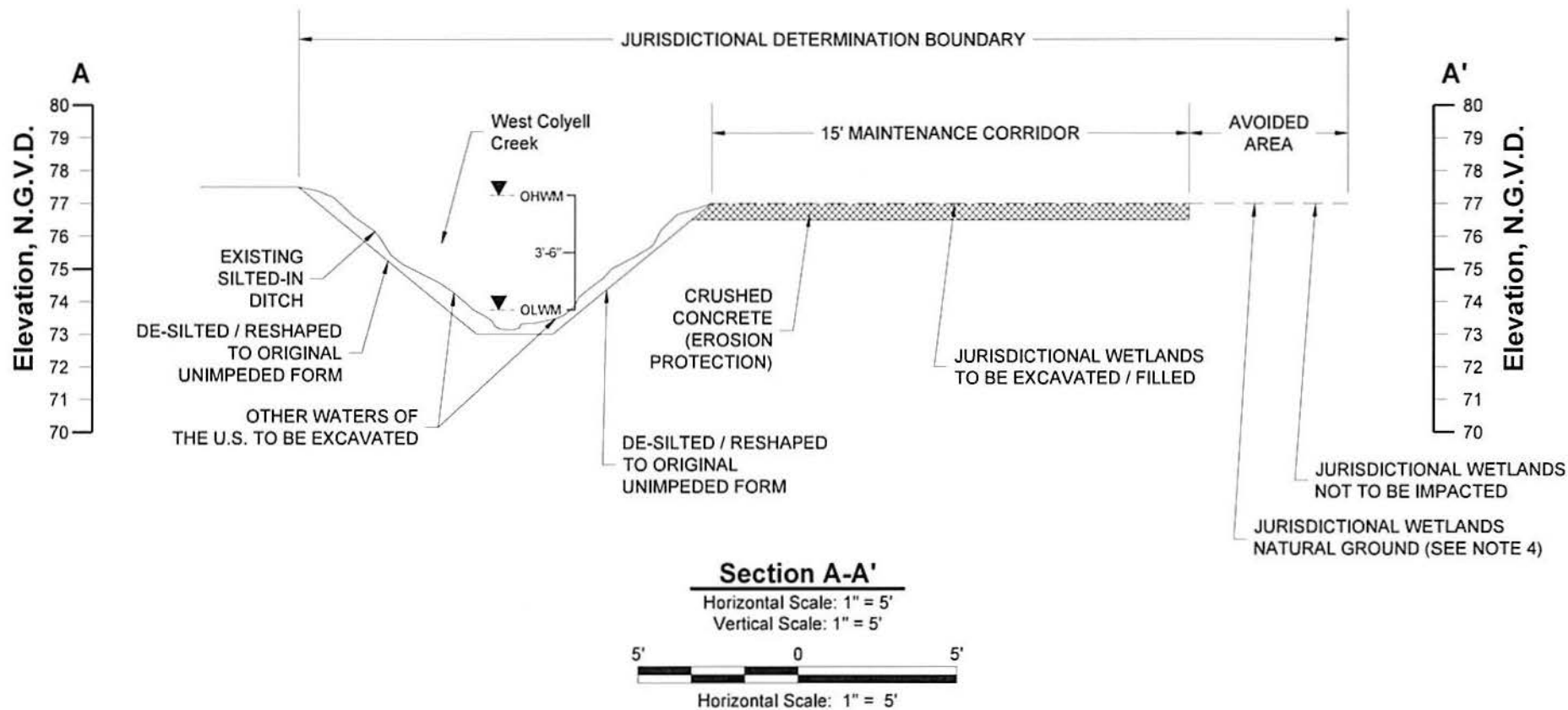

- Property Boundary (37.46 Acres)
- Non-Wetlands (12.44 Acres)
- Total Jurisdictional Wetlands (2.16 Acres)
- ▨ Jurisdictional Wetlands To Be Excavated / Filled (1.59 Acres)
- ▨ Jurisdictional Wetlands Not To Be Impacted (0.57 Acres)
- Total Other Waters Of The US (22.86 Acres)
- Other Waters Of The US To Be Excavated (22.76 Acres)
- Other Waters Of The US Not To Be Impacted (0.10 Acres)



Notes

1. The Proposed layout was provided by Livingston Parish Gravity Drainage District No. 2.
2. Jurisdictional Wetlands & Other Waters Of The U.S. obtained from U.S. Army CORPS of Engineers Jurisdictional Determination Account Number MVN-2014-00763-SY.
3. Non-wetland ground elevations vary from 86' to 63' N.G.V.D. Elevation data was obtained from USGS Quad Maps.
4. Natural ground elevations in existing Jurisdictional Wetlands are approximately 6" lower than non-wetland ground elevations.

Legend

-  Crushed Concrete
-  Ordinary High Water Mark
-  Ordinary Low Water Mark

Livingston Parish Gravity Drainage District No. 2

West Colyell Creek Maintenance Project

Section View A-A'

Livingston Parish, Louisiana



D & S ENVIRONMENTAL SERVICES, INC.



Project No.:

Date:

Figure No.: 36

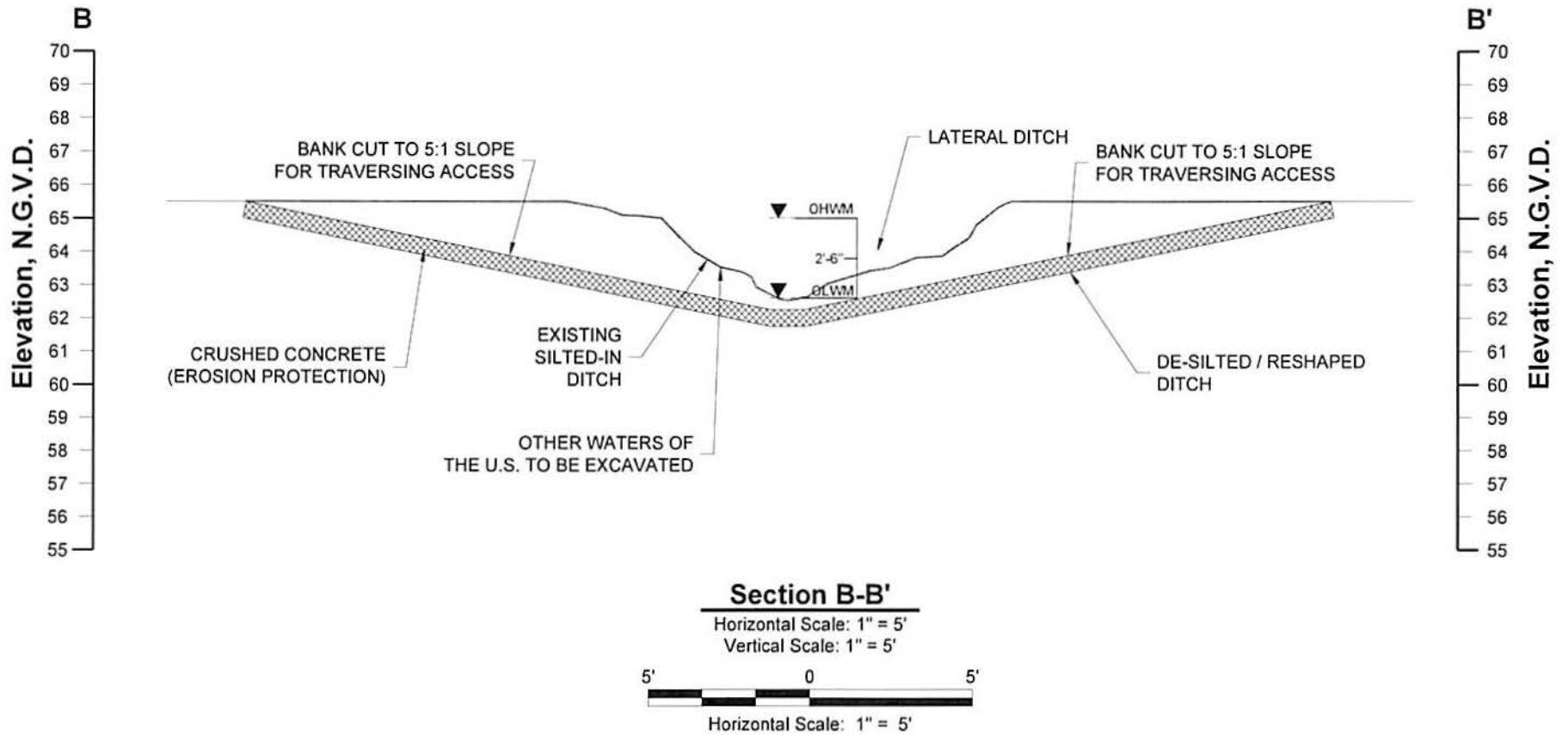

Notes

1. The Proposed layout was provided by Livingston Parish Gravity Drainage District No. 2.
2. Jurisdictional Wetlands & Other Waters Of The U.S. obtained from U.S. Army CORPS of Engineers Jurisdictional Determination Account Number MVN-2014-00763-SY.
3. Non-wetland ground elevations vary from 86' to 63' N.G.V.D. Elevation data was obtained from USGS Quad Maps.
4. Natural ground elevations in existing Jurisdictional Wetlands are approximately 6" lower than non-wetland ground elevations.

Legend

-  Crushed Concrete
- OHWM Ordinary High Water Mark
- OLWM Ordinary Low Water Mark

Livingston Parish Gravity Drainage District No. 2

West Colyell Creek Maintenance Project

Section View B-B'

Livingston Parish, Louisiana



D & S ENVIRONMENTAL SERVICES, INC.



Project No.: 26-2017-DOA

Date: 07-20-2017

Figure No.: 37

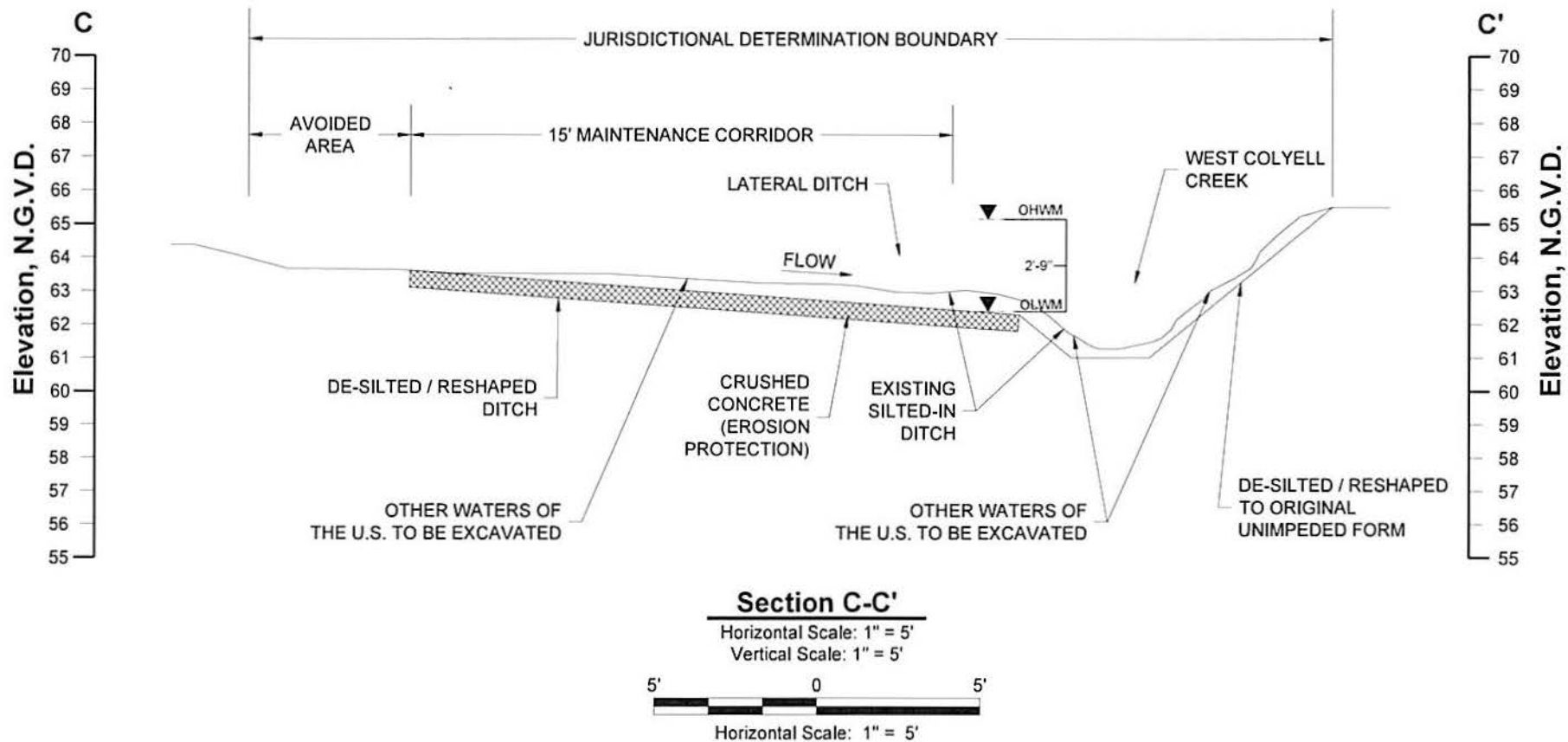

Section C-C'

Horizontal Scale: 1" = 5'
Vertical Scale: 1" = 5'

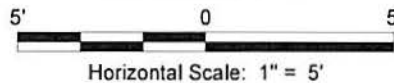

Notes

1. The Proposed layout was provided by Livingston Parish Gravity Drainage District No. 2.
2. Jurisdictional Wetlands & Other Waters Of The U.S. obtained from U.S. Army CORPS of Engineers Jurisdictional Determination Account Number MVN-2014-00763-SY.
3. Non-wetland ground elevations vary from 86' to 63' N.G.V.D. Elevation data was obtained from USGS Quad Maps.
4. Natural ground elevations in existing Jurisdictional Wetlands are approximately 6" lower than non-wetland ground elevations.

Legend

-  Crushed Concrete
- OHWM Ordinary High Water Mark
- OLWM Ordinary Low Water Mark

Livingston Parish Gravity Drainage District No. 2

West Colyell Creek Maintenance Project

Section View C-C'

Livingston Parish, Louisiana



D & S ENVIRONMENTAL SERVICES, INC.

