



DEPARTMENT OF THE ARMY
U.S. ARMY CORPS OF ENGINEERS, NEW ORLEANS DISTRICT
7400 LEAKE AVENUE
NEW ORLEANS LA 70118-3651

July 1, 2024

Regulatory Division
Central Evaluation Branch

Project Manager:
James W. Little, Jr.
(504) 862-1879
James.little@usace.army.mil

Application #: MVN 2013-01941-WII

PUBLIC NOTICE

Interested parties are hereby notified that a permit application has been received by the U.S. Army Corps of Engineers (USACE), New Orleans District (CEMVN) pursuant to: [X] Section 10 of the Rivers and Harbors Act of March 3, 1899 (30 Stat. 1151; 33 USC 403); and/or [X] Section 404 of the Clean Water Act (86 Stat. 816; 33 USC 1344).

**DREDGE A PROPOSED CANAL AND WELL SLIP TO INSTALL AND MAINTAIN A
PROPOSED BARGE MOUNTED DRILLING RIG AND APPURTENANCES TO SERVE
THE CASTEX LAFOURCHE LP 23 NO. 002 WELL IN LAFOURCHE PARISH.**

NAME OF APPLICANT: Castex Energy, Inc., c/o RCCS, LLC, Post Office Box 2183, Covington, Louisiana 70434-2182.

LOCATION OF WORK: The proposed canal and well slip to be dredged are off the Tidewater Canal, east of Bayou Lafourche, in the Lake Enfermer Field, in Sections 14 & 23, Township 20S – Range 22E, 29.333925, -90.196983, approximately 5 miles southeast of Golden Meadow, Louisiana, Lafourche Parish. In the East - Central Louisiana Coastal Basin in hydrologic unit (HUC 08090301), as shown on the attached drawings.

CHARACTER OF WORK: The applicant has requested Department of the Army authorization to dredge a new canal and well slip to install and maintain a proposed barge mounted drilling rig and appurtenances to serve the Castex Lafourche LP 23 No. 002 Well. Approximately 57,490 cubic yards of water bottom material will be dredged and stacked against the existing marsh and in open water at an elevation conducive to marsh establishment (+2.0 elevation initially prior to de-watering). Equipment mobilization will occur at a +1.5 NGVD or greater tide elevation. Upon successful completion of the canal and well slip, a 7' x 16' well structure will be installed.

A Preliminary analysis has determined that the proposed project would directly impact 22.67 acres of open water bottoms.

MITIGATION: The applicant has proposed to place the spoil material in a beneficial manner at elevations conducive to the establishment of emergent wetlands as shown in the permit drawings. At no time shall beneficial spoil placement areas include the deposition of fill in a manner which would impact existing wetlands or convert waters of the U.S. to uplands. The beneficial spoil placement of a minimum of 0.50 of an acre shall occur simultaneously and/or prior to the authorized project impacts.

The comment period for the requested Department of Army Permit will close in **20 days** from the date of this public notice. Written comments, including suggestions for modifications or objections to the proposed work, stating reasons thereof, are being solicited from anyone having interest in this permit request, and must be submitted so as to be received before or by the last day of the comment period. Letters and/or comments concerning the subject permit application must reference the Applicant's Name and the Permit Application Number and can be preferably emailed to the CEMVN project manager listed above or forwarded to the CEMVN at the address above, **ATTENTION: REGULATORY DIVISION, RGC, JAMES W. LITTLE, JR.** Individuals or parties may also request an extension of time in which to comment on the proposed work by mail or preferably by emailing the specified project manager listed above. Any request for an extension of time to comment must be specific and substantively supportive of the requested extension and received by this office prior to the end of the initial comment end of the initial comment period. The Branch Chief will review the request and the requester will be promptly notified of the decision to grant or deny the request. If granted, the time extension will be continuous and inclusive of the initial comment period and will not exceed a total of 30 calendar days. This public notice is also available for review online at <https://go.usa.gov/xennJ>

USACE Permit Criteria

The decision whether to issue a permit will be based on an evaluation of the probable impacts, including cumulative impacts of the proposed activity on the public interest. That decision will reflect the national concern for both protection and utilization of important resources. The benefit which reasonably may be expected to accrue from the proposal must be balanced against its reasonably foreseeable detriments. All factors which may be relevant to the proposal will be considered including the cumulative effects thereof; among those are conservation, economics, aesthetics, general environmental concerns, wetlands, historic properties, fish and wildlife values, flood hazards, floodplain values, land use, navigation, shoreline erosion and accretion, recreation, water supply and conservation, water quality, energy needs, safety, food and fiber production, mineral needs, considerations of property ownership and, in general, the needs and welfare of the people.

CEMVN is soliciting comments from area residents, the public, federal, state, and local agencies and officials, Indian Tribes, and other interested parties in order to consider and evaluate the impacts of this proposed activity. Any comments received will be considered by the CEMVN to determine whether to make, modify, condition, or deny a permit for this proposal. To make this decision, comments are used to assess impacts on communities with environmental justice concerns, endangered species, historic properties, water quality, general environmental effects, and other public interest factors listed above.

Comments are used in the preparation of an Environmental Assessment and/or an Environmental Impact Statement pursuant to the National Environmental Policy Act. Comments are also used to determine the need for a public hearing and to determine the overall public interest of the proposed activity. Further, all factors that may be relevant to the proposal will be considered, including the potential cumulative effects associated with the proposed project.

CEMVN is presently unaware of properties listed on the National Register of Historic Places at or near the proposed work but is pending further review in accordance with the National Historic Preservation Act. The possibility exists that the proposed work may damage or destroy presently unknown archeological, scientific, prehistorical, historical sites, or data. As deemed necessary, copies of this public notice will be sent to the State Archeologist, State Historic Preservation Officer, and federally listed tribes regarding potential impacts to cultural resources.

Our initial finding is that the proposed work would have no effect on any species listed as endangered by the U.S. Department of Commerce, nor affect any habitat designated as critical to the survival and recovery of any endangered species. A portion of the Project area is utilized by threatened or endangered Sea Turtles. The applicant would implement the National Oceanic and Atmospheric Administration (NOAA) Fisheries' Sea Turtle and Smalltooth Sawfish Construction Conditions and Vessel Strike Avoidance Measures and Reporting for Mariners to minimize the potential impacts on sea turtles. Further, these species are highly mobile and likely to move away from areas of active equipment if disturbed. Therefore, it has been determined that the proposed project is "not likely to adversely affect" federally protected sea turtles.

Based on the Information Planning and Consultation (IPaC) tool for Endangered Species in Louisiana, as signed on January 27, 2020, between the U.S. Army Corps of Engineers, New Orleans District (CEMVN) and the U.S. Fish and Wildlife Service, it has been determined that the project is not likely to adversely affect the Eastern Black Rail (*Laterallus jamaicensis ssp. jamaicensis*), and that the project is located in waters known to be utilized by the West Indian Manatee (*Trichechus manatus*) and determined that the activity is not likely to adversely affect this species. If the DA permit is approved, the permittee will be required to follow the IPaC mitigative conditions for the West Indian Manatee (*Trichechus manatus*). The Monarch Butterfly (*Danaus plexippus*) is a candidate species and the Tricolored Bat (*Perimyotis subflavus*) Proposed Endangered, while not subject to consultation requirements, construction of the Project would not result in a trend towards federal listing. would have no effect to any species listed as endangered by the U.S. Fish and Wildlife Service, nor affect any habitat designated as critical to the survival and recovery of any such species.

This notice initiates the Essential Fish Habitat (EFH) consultation requirements of the Magnuson-Stevens Fishery Conservation and Management Act. The applicant's proposal would result in the destruction or alteration of up to **22.67** acres of EFH utilized by various life stages of red drum and penaeid shrimp. Our initial determination is that the proposed action would not have a substantial adverse impact on EFH or federally managed fisheries in the Gulf of Mexico. Our final determination relative to project impacts and the need for

mitigation measures is subject to review by and coordination with the National Marine Fisheries Service.

If the proposed work involves deposits of dredged or fill material into navigable waters, the evaluation of the probable impacts will include the application of guidelines established by the Administrator of the Environmental Protection Agency. Also, a certification that the proposed activity will not violate applicable water quality standards will be required from the Department of Environmental Quality before a permit is issued.

Any person may request, (preferably by email to the project manager, or in writing), within the comment period specified in this notice, that a public hearing be held to consider this application. Requests for public hearings shall state, with particularity, the reasons for holding a public hearing.

The applicant has certified that the proposed activity described in the application complies with and will be conducted in a manner that is consistent with the Louisiana Coastal Resources Program (Louisiana Coastal Zone Application P20230384). The Department of the Army permit will not be issued unless the applicant received approval or a waiver of the Coastal Use Permit by the Department of Energy and Natural Resources.

You are invited to communicate the information contained in this notice to any other parties whom you deem likely to have interest in the matter.

John M. Herman
Chief, Central Evaluation Branch
Regulatory Division

Enclosures

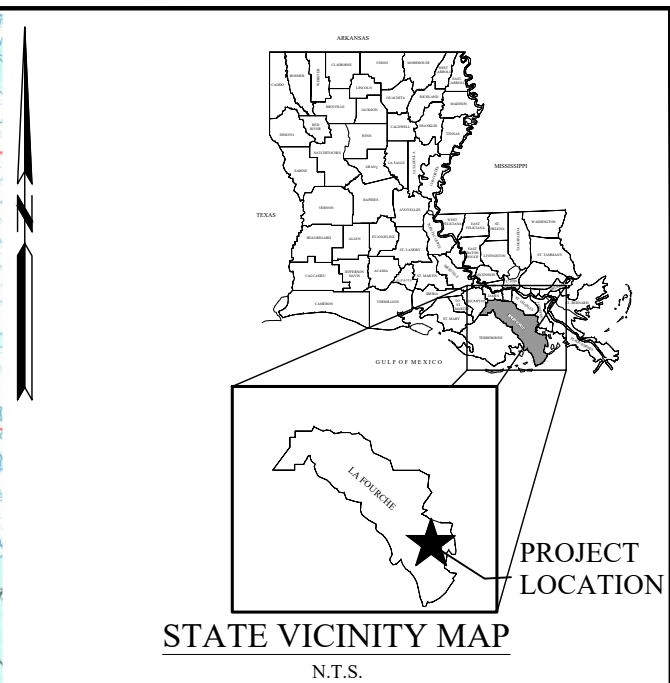
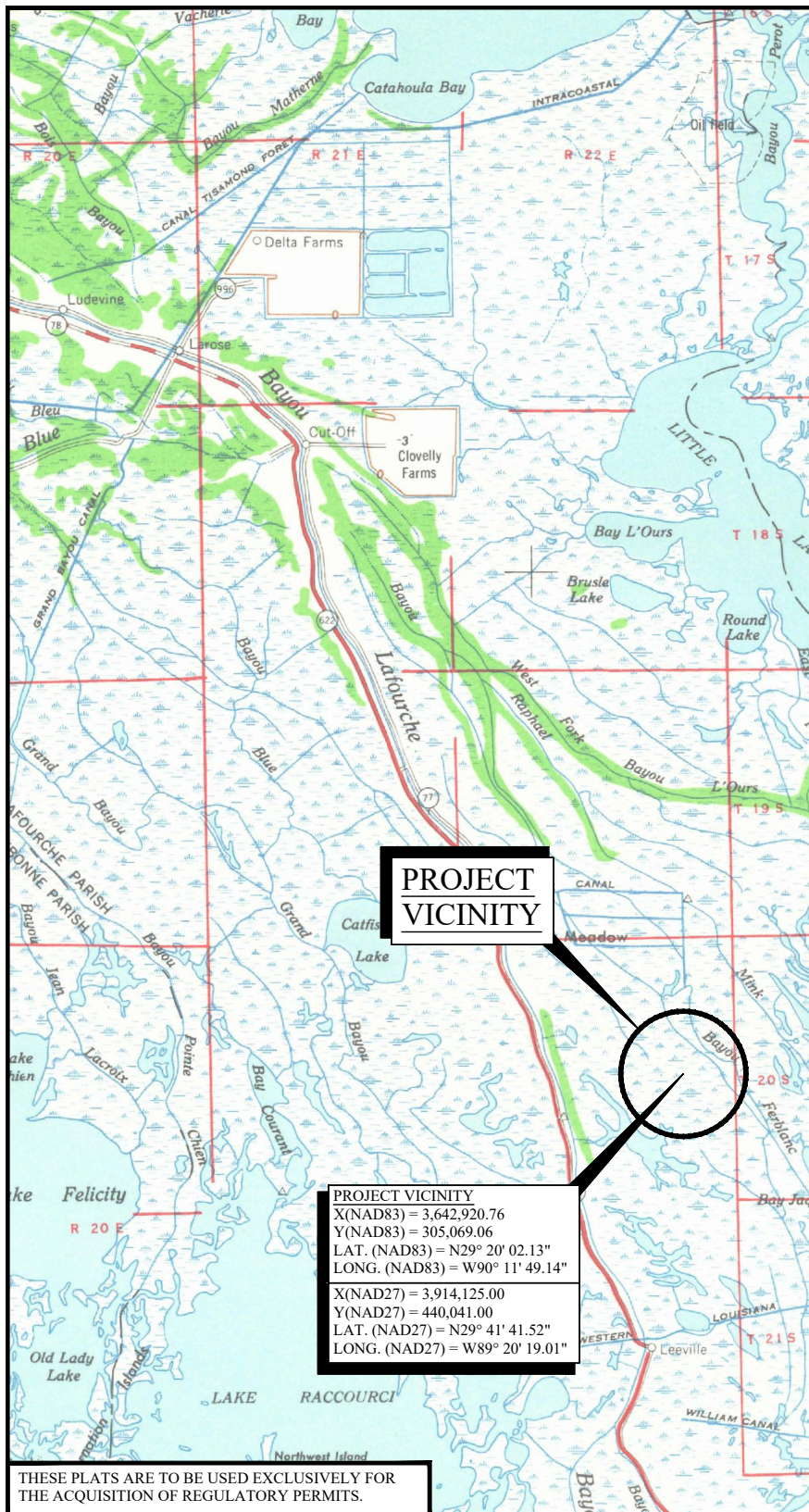

**DELTA COAST
CONSULTANTS, LLC**
 631 S. HOLLYWOOD RD.
 HOUMA, LA 70360

PHONE: 985-655-3100

www.deltacoastllc.com

SCALE: 1" = 4 MILES



VICINITY MAP

CASTEX

PROPOSED LOCATION, DREDGING & WELL STRUCTURES
 CASTEX LAFORCHE LP 23 NO. 002 WELL
 SECTIONS 014 & 023, T20S-R22E
 LAKE ENFERMER
 LAFORCHE PARISH, LOUISIANA

FILE: P:\2023\2023.016\DWG\ENVIRO\REVISION 01\01_SHT 01_VICINITY MAP.DWG

DATE
5/11/23

PROJECT
2023.016

REVISION NO.
01

DESIGNED BY

DRAWN BY
BWH

CHECKED BY
KJK

SHEET NO.
1 OF 8

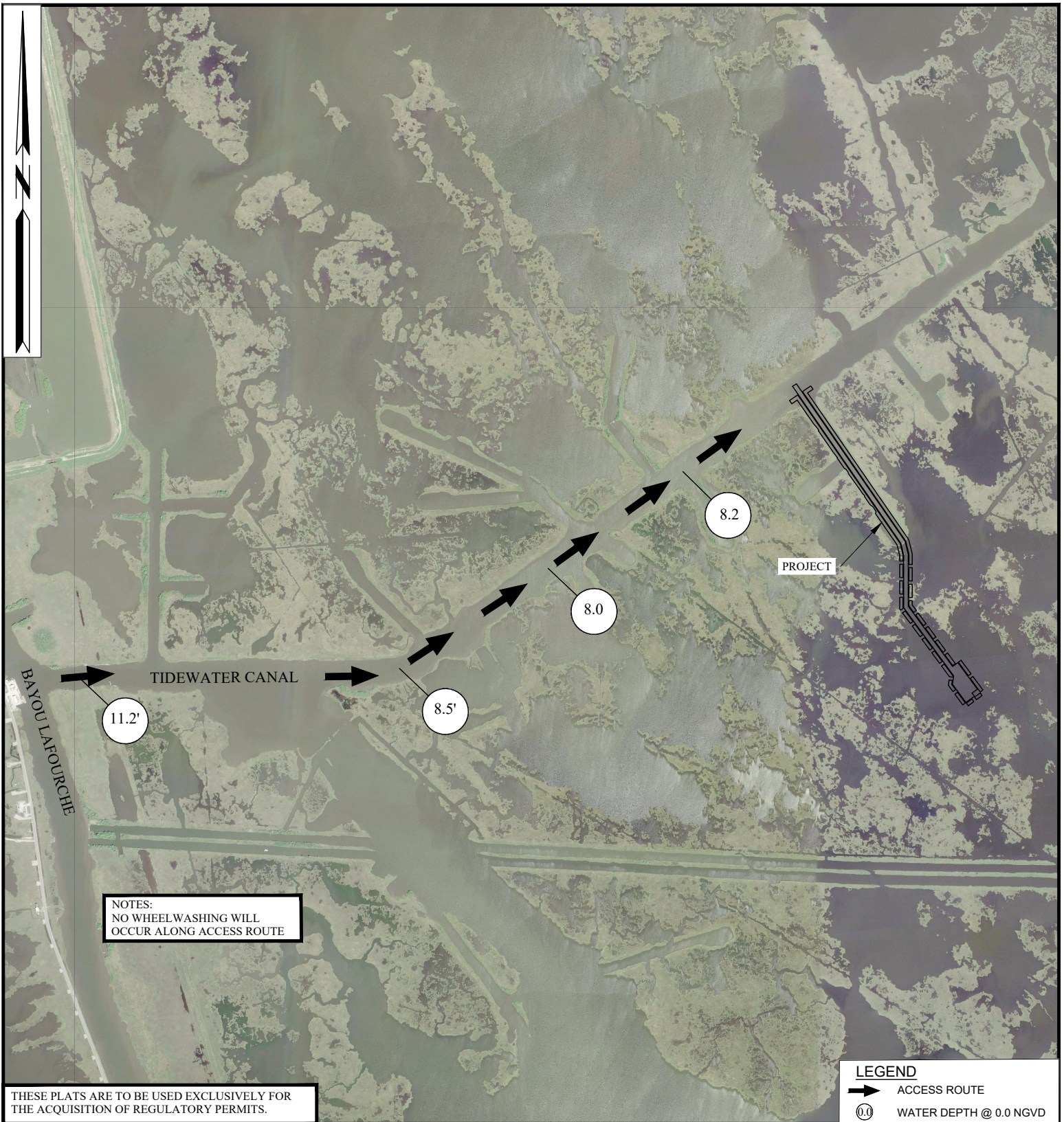

THESE PLATS ARE TO BE USED EXCLUSIVELY FOR
THE ACQUISITION OF REGULATORY PERMITS.



**DELTA COAST
CONSULTANTS, LLC**

631 S. HOLLYWOOD RD.
HOUMA, LA 70360

PHONE: 985-655-3100

www.deltacoastllc.com

SCALE: 1" = 2,000'



FILE: P:\2023\2023.016\DWG\ENVIRO\REVISION 01\01_SHT 02_ACCESS
ROUTE.DWG

DATE
5/11/23

PROJECT
2023.016

PLAN VIEW-ACCESS ROUTE

CASTEX

PROPOSED LOCATION, DREDGING & WELL STRUCTURES
CASTEX LAFOURCHE LP 23 NO. 002 WELL
SECTIONS 014 & 023, T20S-R22E
LAKE ENFERMER
LAFOURCHE PARISH, LOUISIANA

REVISION NO.
01

DESIGNED BY

DRAWN BY
BWH

CHECKED BY
KJK

SHEET NO.
2 OF 8

P.O.B DREDGING
 LAT. (NAD83) = N29° 20' 48.60"
 LONG. (NAD83) = W90° 12' 17.89"
 X(NAD83) = 3,640,329.91
 Y(NAD83) = 309,737.13

NOTE:
 1. WATER DEPTH SURVEY FEBRUARY 8, 2023
 2. IDENTITY NUMBER FOR SPOIL AND DREDGE WIDTHS
 CORRESPONDS WITH TABLE ON PAGE (8)

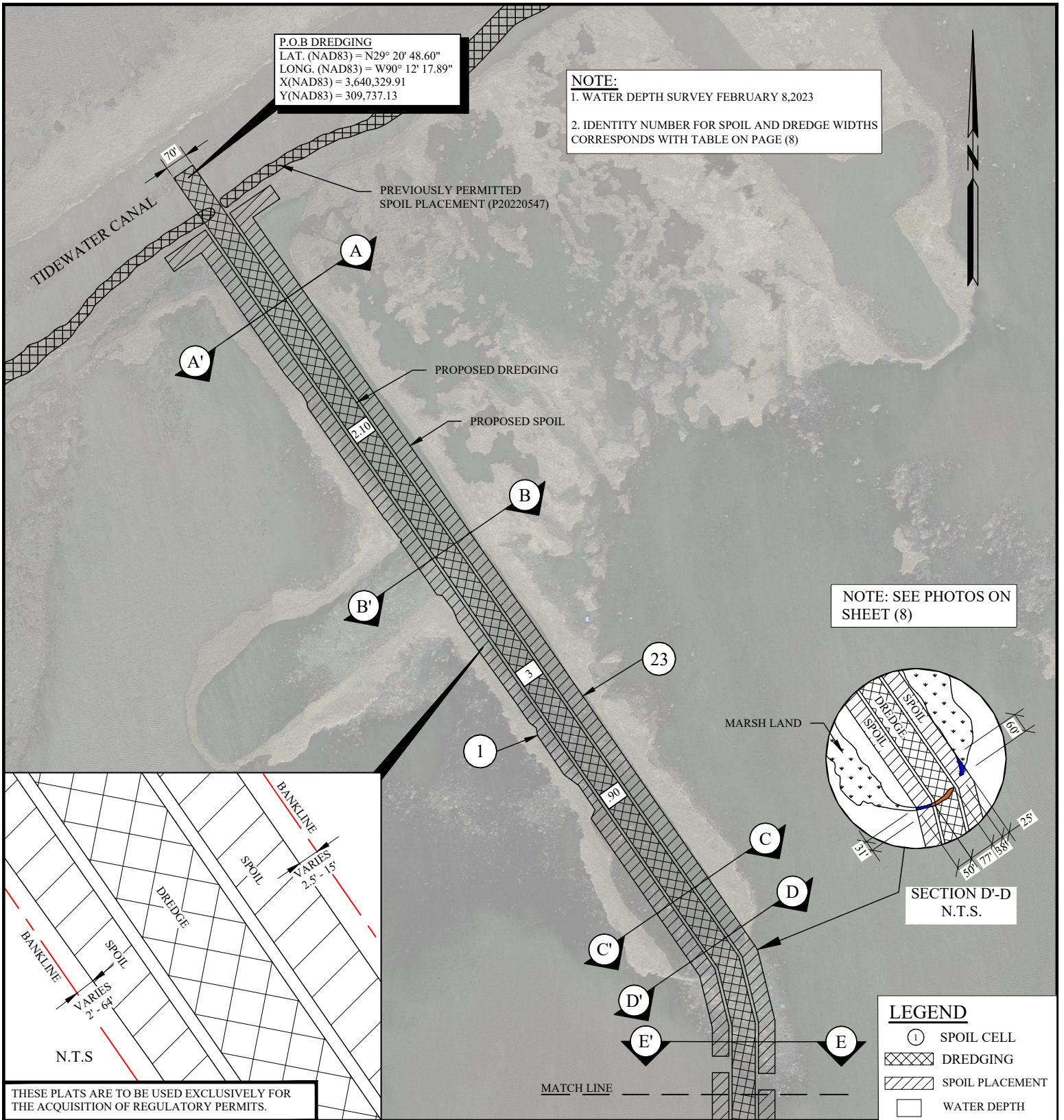

**DELTA COAST
 CONSULTANTS, LLC**
 631 S. HOLLYWOOD RD.
 HOUMA, LA 70360

PHONE: 985-655-3100

www.deltacoastllc.com

SCALE: 1" = 400'



PLAN VIEW

CASTEX

PROPOSED LOCATION, DREDGING & WELL STRUCTURES
 CASTEX LAFOURCHE LP 23 NO. 002 WELL
 SECTIONS 014 & 023, T20S-R22E
 LAKE ENFERMER
 LAFOURCHE PARISH, LOUISIANA

FILE: P:\2023\2023.016\DWG\ENVIRO\REVISION 01\01_SHT 02-08_PLAN & XSECS.DWG

DATE
 5/11/23

PROJECT
 2023.016

REVISION NO.
 01

DESIGNED BY

DRAWN BY
 BWH

CHECKED BY
 KJK

SHEET NO.
 3 OF 8

MATCH LINE

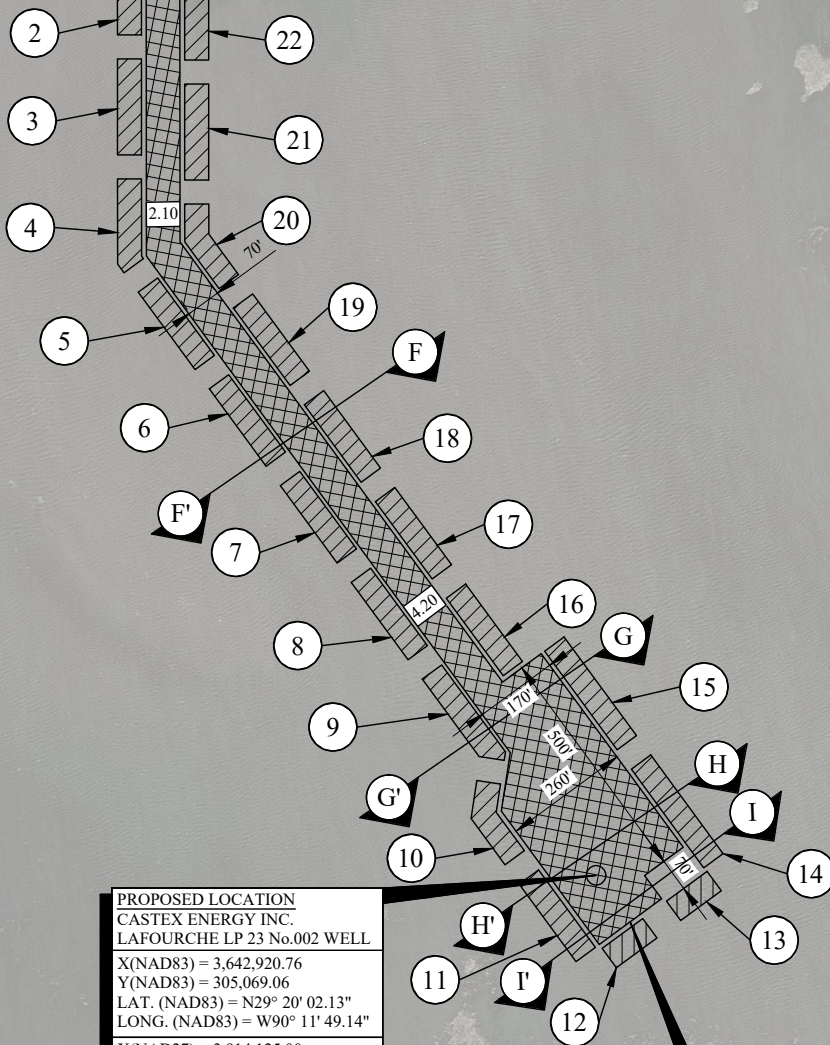

PROPOSED LOCATION
CASTEX ENERGY INC.
LAFOURCHE LP 23 No.002 WELL
X(NAD83) = 3,642,920.76
Y(NAD83) = 305,069.06
LAT. (NAD83) = N29° 20' 02.13"
LONG. (NAD83) = W90° 11' 49.14"
X(NAD27) = 3,914,125.00
Y(NAD27) = 440,041.00
LAT. (NAD27) = N29° 41' 41.52"
LONG. (NAD27) = W89° 20' 19.01"

P.O.E DREDGING
LAT. (NAD83) = N29° 20' 01.43"
LONG. (NAD83) = W90° 11' 47.93"
X(NAD83) 3,643,028.04
Y(NAD83) 304,998.95

THESE PLATS ARE TO BE USED EXCLUSIVELY FOR
THE ACQUISITION OF REGULATORY PERMITS.

LEGEND

① SPOIL CELL

XXXX DREDGING

XXXX SPOIL PLACEMENT



DELTA COAST
CONSULTANTS, LLC

631 S. HOLLYWOOD RD.
HOUMA, LA 70360

PHONE: 985-655-3100

www.deltacoastllc.com

SCALE: 1" = 400'



PLAN VIEW

CASTEX

PROPOSED LOCATION, DREDGING & WELL STRUCTURES
CASTEX LAFOURCHE LP 23 NO. 002 WELL
SECTIONS 014 & 023, T20S-R22E
LAKE ENFERMER
LAFOURCHE PARISH, LOUISIANA

FILE: P:\2023\2023.016\DWG\ENVIRO\REVISION 01\01_SHT 02-08_PLAN &
XSECS.DWG

DATE
5/11/23

PROJECT
2023.016

REVISION NO.
01

DESIGNED BY

DRAWN BY
BWH

CHECKED BY
KJK

SHEET NO.
4 OF 8



MHW:1.5' NGVD
MLW:0.0' NGVD



**DELTA COAST
CONSULTANTS, LLC**

631 S. HOLLYWOOD RD.
HOUMA, LA 70360

PHONE: 985-655-3100

www.deltacoastllc.com

HORIZ. 60' 30' 0' 60'

VERT. 20' 10' 0' 20'

SCALE IN FEET

SECTION VIEWS

CASTEX

PROPOSED LOCATION, DREDGING & WELL STRUCTURES
CASTEX LAFOURCHE LP 23 NO. 002 WELL
SECTIONS 014 & 023, T20S-R22E
LAKE ENFERMER
LAFOURCHE PARISH, LOUISIANA

FILE:P:\2023\2023.016\DWG\ENVIRO\REVISION 01\01 SHT 02-08 PLAN & XSECS.DWG

DATE _____

0/29/23

PROJECT

2023.016

REVISION NO.

01

DESIGNED BY

DRAWN BY

BWF

CHECKED BY

SHEET NO.

5 OF 8

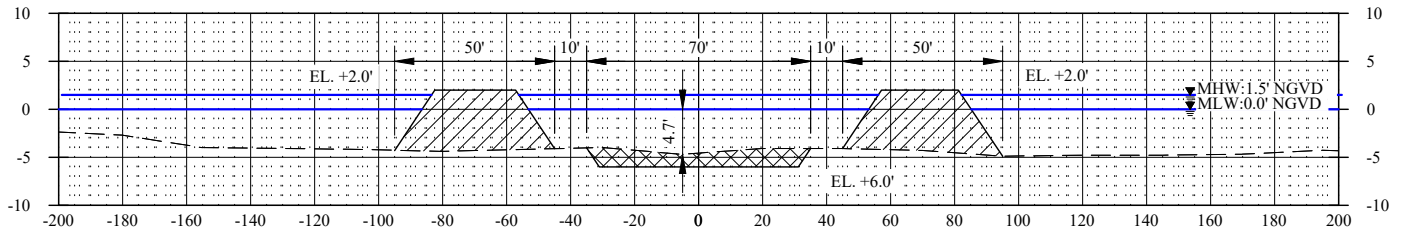

TYPICAL SECTION F-F'

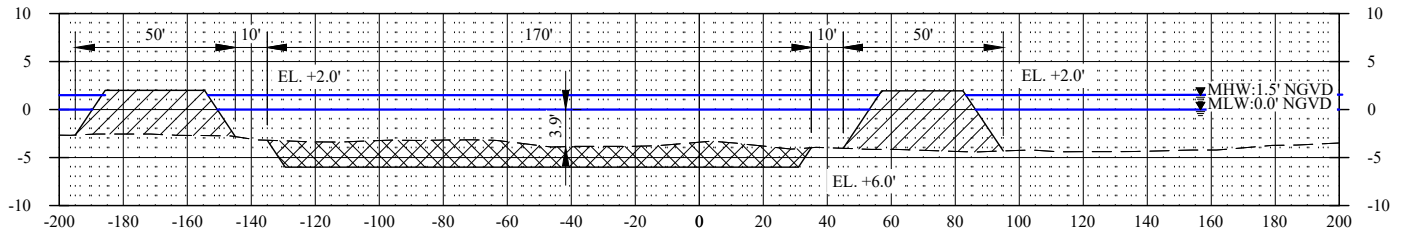

TYPICAL SECTION G-G'

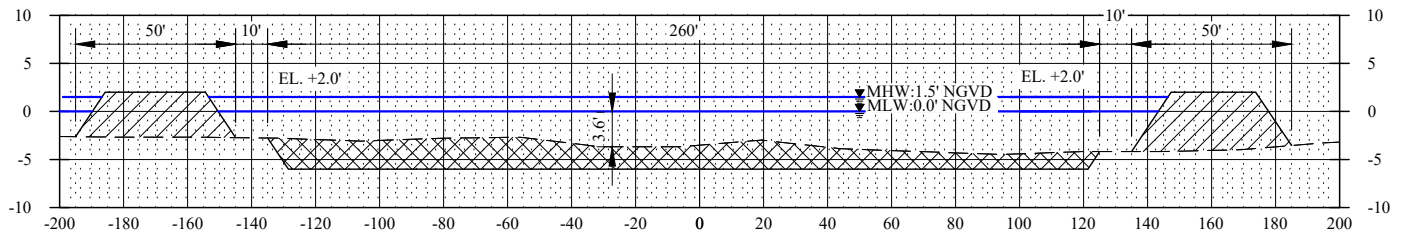

TYPICAL SECTION H-H'

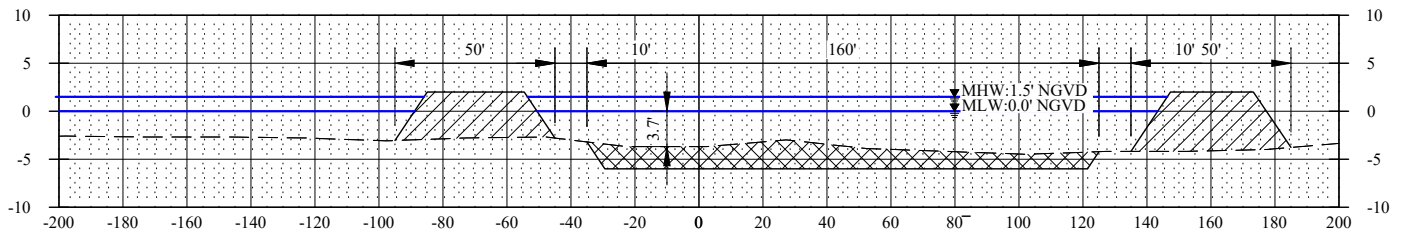

TYPICAL SECTION I-I'

THESE PLATS ARE TO BE USED EXCLUSIVELY FOR
THE ACQUISITION OF REGULATORY PERMITS.

MHW: 1.5' NGVD
MLW: 0.0' NGVD



**DELTA COAST
CONSULTANTS, LLC**
631 S. HOLLYWOOD RD.
HOUMA, LA 70360

PHONE: 985-655-3100

www.deltacoastllc.com

HORIZ. 60' 30' 0' 60'
VERT. 20' 10' 0' 20'

SCALE IN FEET

SECTION VIEWS

CASTEX

PROPOSED LOCATION, DREDGING & WELL STRUCTURES
CASTEX LAFOURCHE LP 23 NO. 002 WELL
SECTIONS 014 & 023, T20S-R22E
LAKE ENFERMER
LAFOURCHE PARISH, LOUISIANA

NOTE:

8 TEMPORARY 3 PILE CLUSTER TO BE
DRIVEN TO ASSIST IN MOORING DRILL BARGE.
TEMPORARY CLUSTERS TO BE PULLED
WHEN PERMANENT WELL GUARD
IS INSTALLED.

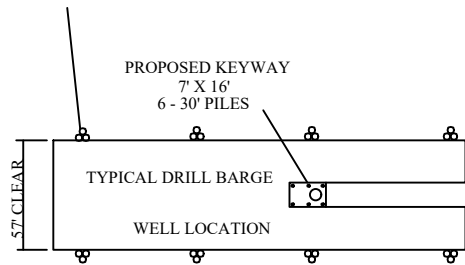

PLAN

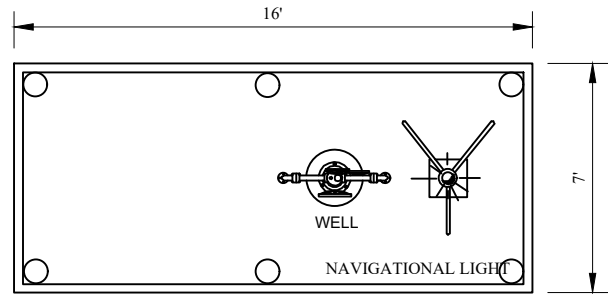

TOP VIEW

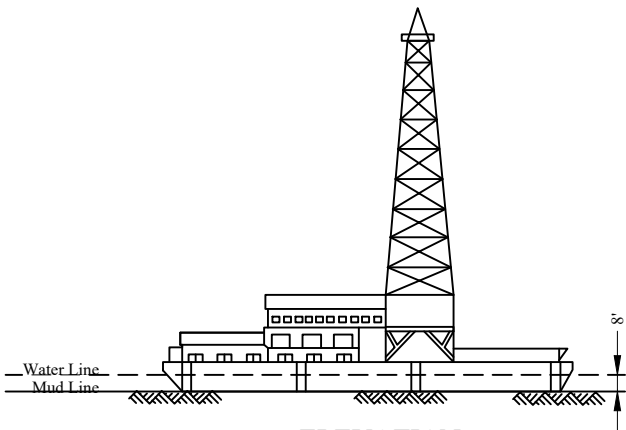

ELEVATION

TYPICAL DIESEL POWER DRILL BARGE

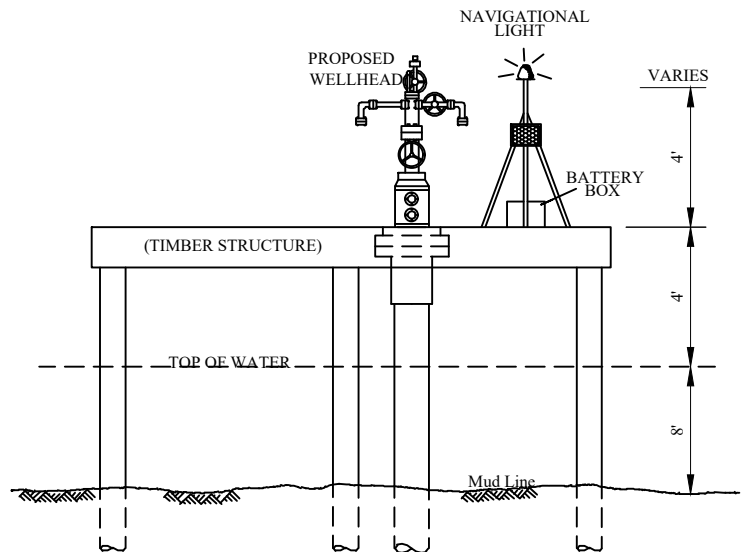

SIDE VIEW

**PROPOSED
WELL HEAD PROTECTOR**

THESE PLATS ARE TO BE USED EXCLUSIVELY FOR
THE ACQUISITION OF REGULATORY PERMITS.

MHW:1.5' NGVD
MLW:0.0' NGVD



**DELTA COAST
CONSULTANTS, LLC**

631 S. HOLLYWOOD RD.
HOUMA, LA 70360

PHONE: 985-655-3100

www.deltacoastllc.com

N.T.S



WELL VIEW

CASTEX

PROPOSED LOCATION, DREDGING & WELL STRUCTURES
CASTEX LAFOURCHE LP 23 NO. 002 WELL
SECTIONS 014 & 023, T20S-R22E
LAKE ENFERMER
LAFOURCHE PARISH, LOUISIANA

FILE: P:\2023\2023.016\DWG\ENVIRO\REVISION 01\01_SHT 02-08_PLAN &
XSECS.DWG

DATE
5/11/23

PROJECT
2023.016

REVISION NO.
01

DESIGNED BY

DRAWN BY
BWH

CHECKED BY
KJK

SHEET NO.
7 OF 8

NOTES:

1. AS-BUILT DRAWINGS AND/OR PLATS SHALL HAVE WRITTEN ON THEM THE DATE OF COMPLETION OF SAID ACTIVITIES AND SHALL BE SUBMITTED TO THE LOUISIANA DEPARTMENT OF NATURAL RESOURCES, OFFICE OF COASTAL MANAGEMENT, P.O. BOX 44487, BATON ROUGE, LA 70804-4487 WITHIN 30 DAYS FOLLOWING PROJECT COMPLETION.
2. ALL STRUCTURES BUILT UNDER THE AUTHORIZATION AND CONDITIONS OF THIS PERMIT BE REMOVED FORM THE SITE WITHIN 120 DAYS OF ABANDONMENT OF THE FACILITIES FOR THE HEREIN PERMITTED USE, OR WHEN THESE STRUCTURES FALL INTO A STATE OF DISREPAIR SUCH THAT THEY CAN NO LONGER FUNCTION AS INTENDED. THIS CONDITION DOES NOT PRECLUDE THE NECESSITY FOR REVISING THE CURRENT PERMIT OR OBTAINING A SEPARATE COASTAL USE PERMIT, SHOULD ONE BE REQUIRED, FOR SUCH REMOVAL ACTIVITIES.
3. STRUCTURES MUST ALSO BE MARKED/LIGHTED IN ACCORDANCE WITH U.S. COAST GUARD REGULATIONS.
4. IN ORDER TO ENSURE THE SAFETY OF ALL PARTIES, THE PERMITTEE SHALL CONTACT THE LOUISIANA ONE CALL SYSTEM (1-800-272-3020) A MINIMUM OF 48 HOURS PRIOR TO THE COMMENCEMENT OF ANY EXCAVATION (DIGGING, DREDGING, JETTING, ETC.) OR DEMOLITION ACTIVITY.
5. EQUIPMENT MOBILIZATION TO OCCUR AT +1.5 NGVD OR GREATER TIDE ELEVATION.

CALCULATIONS:

1. APPROXIMATELY 57,490 CU.YDS / 10.92 ACRES OF MATERIAL TO BE EXCAVATED
2. APPROXIMATELY 57,490 CU. YDS / 11.75 ACRES OF SPOIL PLACEMENT
3. SPOIL TO BE PLACED AT A HEIGHT CONDUCTIVE TO MARSH DEVELOPMENT
4. SECTION D'-D VIEW SHOW APPROXIMATELY .02 ACRES OF MARSHLAND TO BE EXCAVATED FOR DREDGING
5. SECTION D'-D VIEW SHOWS APPROXIMATELY .02 ACRES OF SPOIL PLACEMENT

EQUIPMENT LIST

1. DREDGE BARGE - 6FT. DRAFT
2. DRILL BARGE - 7.5FT. DRAFT
3. TUG - 7FT. DRAFT

SPOIL CELL MEASUREMENTS		
CELL #	LENGTH(FT.)	WIDTH(FT.)
1	3086'	10' TO 50'
2	200'	50'
3	200'	50'
4	184'	50'
5	200'	50'
6	200'	50'
7	200'	50'
8	200'	50'
9	222'	50'
10	179'	50'
11	200'	50'
12	105'	50'
13	105'	50'
14	255'	50'
15	255'	50'
16	200'	50'
17	200'	50'
18	200'	50'
19	200'	50'
20	184'	50'
21	200'	50'
22	200'	50'
23	3069'	50'

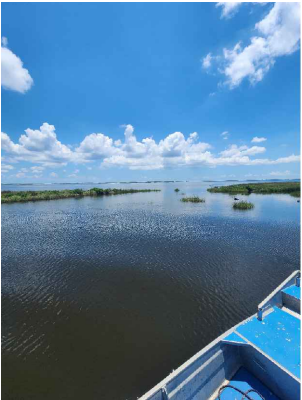

NOTES:

1. ALL SPOIL GAPS 50'
2. TOTAL SPOIL LENGTH: 10,244 L.F
3. TOTAL DREDGE LENGTH: 5,586 L.F

THESE PLATS ARE TO BE USED EXCLUSIVELY FOR THE ACQUISITION OF REGULATORY PERMITS.



DELTA COAST
CONSULTANTS, LLC

631 S. HOLLYWOOD RD.
HOUMA, LA 70360

PHONE: 985-655-3100

www.deltacoastllc.com

N.T.S



FILE: P:\2023\2023.016\DWG\ENVIRO\REVISION 01\01_SHT 02-08_PLAN & XSECS.DWG

DATE
5/11/23

PROJECT
2023.016

NOTES

CASTEX

PROPOSED LOCATION, DREDGING & WELL STRUCTURES
CASTEX LAFOURCHE LP 23 NO. 002 WELL
SECTIONS 014 & 023, T20S-R22E
LAKE ENFERMER
LAFOURCHE PARISH, LOUISIANA

REVISION NO.
01

DESIGNED BY

DRAWN BY
BWH

CHECKED BY
KJK

SHEET NO.
8 OF 8