

JOINT PUBLIC NOTICE

November 18, 2013

United States Army Corps of Engineers
New Orleans District
Regulatory Branch
Post Office Box 60267
New Orleans, Louisiana 70160-0267

(504) 862-1581
Project Manager
Christine Thibodeaux
Christine.Thibodeaux@usace.arme.mil
MVN 2013-02303-CJ

State of Louisiana
Department of Environmental Quality
Office of Environmental Services
Post Office Box 4313
Baton Rouge, Louisiana 70821-4313

(225) 219-3225
Project Managers
Jamie Phillippe, Blake Perkins
WQC Application Number
131107-02

Interested parties are hereby notified that a permit application has been received by the New Orleans District of the US Army Corps of Engineers pursuant to: [] Section 10 of the Rivers and Harbors Act of March 3, 1899 (30 Stat. 1151; 33 USC 403); and/or [X] Section 404 of the Clean Water Act (86 Stat. 816; 33 USC 1344).

Application has also been made to the Louisiana Department of Environmental Quality, Office of Environmental Services, for a Water Quality Certification (WQC) in accordance with statutory authority contained in LRS 30:2074 A(3) and provisions of Section 401 of the Clean Water Act.

AFTER THE FACT CLEAR, GRADE, AND FILL FOR A COMMERCIAL FACILITY EXPANSION IN EAST BATON ROUGE PARISH

NAME OF APPLICANT: DEEP SOUTH CRANE AND RIGGING, CAMILE LANDRY, c/o Michael Henry, Hydrik Wetlands Consultants, 604 West Charles St., Hammond, Louisiana 70401.

LOCATION OF WORK: 15324 Airline Highway, Baton Rouge, Louisiana, in East Baton Rouge Parish, within the Lake Pontchartrain Amite River Basin in hydrologic unit (HUC 08070202), as shown on the attached drawings.

The work described below was partially completed prior to obtaining a Department of the Army permit and was in violation of Section 301 of the Clean Water Act. All legal issues concerning the unauthorized work have since been deferred.

CHARACTER OF WORK: The applicant has requested Department of the Army authorization to clear, grade, excavate and deposit fill and/or aggregate material to expand and maintain an existing commercial facility (Deep South Crane and Rigging) to include parking, laydown areas, storage areas, fabrication buildings, storage buildings, repair and assembly buildings, and maintenance buildings. Approximately 4,000 cubic yards of silt from onsite grading was used as fill and approximately 1,000 cubic yards of concrete will be used for parking and slabs to be hauled in and deposited to achieve required grade

elevation requirements. The proposed project is situated on an approximately 43-acre tract that has been determined to be forested jurisdictional wetlands, waters of the U.S. and pasture. Of this, approximately 0.87 of an acre of bottomland hardwood forest and 2 acres of waters of the U.S. was impacted. As compensation for unavoidable wetland impacts, the applicant proposes to use a Corps approved mitigation bank within the watershed of impact.

The applicant may be required to fully or partially restore the site to pre-project conditions if issuance of a permit is determined to be contrary to the public interest.

The comment period for the Department of Army and the Louisiana Department of Environmental Quality will close in **20 days** from the date of this joint public notice. Written comments, including suggestions for modifications or objections to the proposed work, stating reasons thereof, are being solicited from anyone having interest in this permit and/or this WQC request and must be mailed so as to be received before or by the last day of the comment period. Letters concerning the Corps of Engineers permit application must reference the applicant's name and the Permit Application Number, and be mailed to the Corps of Engineers at the address above, **ATTENTION: REGULATORY BRANCH**. Similar letters concerning the Water Quality Certification must reference the applicant's name and the WQC application number and be mailed to the Louisiana Department of Environmental Quality at the address above. Individuals or parties may request an extension of time in which to comment on the proposed work by writing or e-mailing the Corps of Engineers Project Manager listed above. Any request must be specific and substantively supportive of the requested extension, and received by this office prior to the end of the initial comment period. The Section Chief will review the request and the requestor will be promptly notified of the decision to grant or deny the request. If granted, the time extension will be continuous to the initial comment period and, inclusive of the initial comment period, will not exceed a total of 30 calendar days.

The application for this proposed project is on file with the Louisiana Department of Environmental Quality and may be examined during weekdays between 8:00 a.m. and 4:30 p.m. Copies may be obtained upon payment of costs of reproduction.

Corps of Engineers Permit Criteria

The decision whether to issue a permit will be based on an evaluation of the probable impacts, including cumulative impacts of the proposed activity on the public interest. That decision will reflect the national concern for both protection and utilization of important resources. The benefit which reasonably may be expected to accrue from the proposal must be balanced against its reasonably foreseeable detriments. All factors which may be relevant to the proposal will be considered including the cumulative effects thereof; among those are conservation, economics, aesthetics, general environmental concerns, wetlands, historic properties, fish and wildlife values, flood hazards, floodplain values, land use, navigation, shoreline erosion and accretion, recreation, water supply and conservation, water quality, energy needs, safety, food and fiber production, mineral needs, considerations of property ownership and, in general, the needs and welfare of the people.

The US Army Corps of Engineers is soliciting comments from the public, federal, state, and local agencies and officials, Indian Tribes, and other interested parties in order to consider and evaluate the impacts of this proposed activity. Any comments received will be considered by the US Army Corps of Engineers to determine whether to make, modify, condition, or deny a permit for this proposal. To make this decision, comments are used to assess impacts on endangered species, historic properties, water quality, general environmental effects, and other public interest factors listed above. Comments are used in the preparation of an Environmental Assessment and/or an Environmental Impact Statement pursuant to the National Environmental Policy Act. Comments are also used to determine the need for a public hearing and to determine the overall public interest of the proposed activity.

The New Orleans District is unaware of properties listed on the National Register of Historic Places near the proposed work. The possibility exists that the proposed work may damage or destroy presently unknown archeological, scientific, prehistorical, historical sites, or data. Issuance of this public notice solicits input from the State Archeologist and State Historic Preservation Officer regarding potential impacts to cultural resources.

Our initial finding is that the proposed work would neither affect any species listed as endangered by the U.S. Departments of Interior or Commerce, nor affect any habitat designated as critical to the survival and recovery of any endangered species.

This notice initiates the Essential Fish Habitat (EFH) consultation requirements of the Magnuson-Stevens Fishery Conservation and Management Act. The applicant's proposal would result in the destruction or alteration of up to n/a acres of EFH utilized by various life stages of red drum and penaeid shrimp. Our initial determination is that the proposed action would not have a substantial adverse impact on EFH or federally managed fisheries in the Gulf of Mexico. Our final determination relative to project impacts and the need for mitigation measures is subject to review by and coordination with the National Marine Fisheries Service.

If the proposed work involves deposits of dredged or fill material into navigable waters, the evaluation of the probable impacts will include the application of guidelines established by the Administrator of the Environmental Protection Agency. Also, a certification that the proposed activity will not violate water quality standards will be required from the Department of Environmental Quality, Office of Environmental Services before a permit is issued.

Any person may request, in writing, within the comment period specified in this notice, that a public hearing be held to consider this application. Requests for public hearings shall state, with particularity, the reasons for holding a public hearing. You are requested to communicate the information contained in this notice to any other parties whom you deem likely to have interest in the matter.

JOHN M. HERMAN
Chief, Central Evaluation Section
Regulatory Branch

Enclosures

FIGURE 1. VIC
DEEP SOUTH CRANE
BATON ROUGE, LA
PREPARED BY:

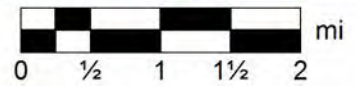

FIGURE 2. VIC ZOOM
DEEP SOUTH CRANE
BATON ROUGE, LA
PREPARED BY:

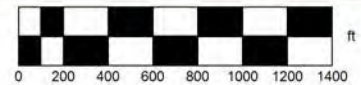

FIGURE 3. 1' DEM
 DEEP SOUTH CRANE
 BATON ROUGE, LA
 PREPARED BY:

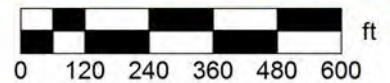
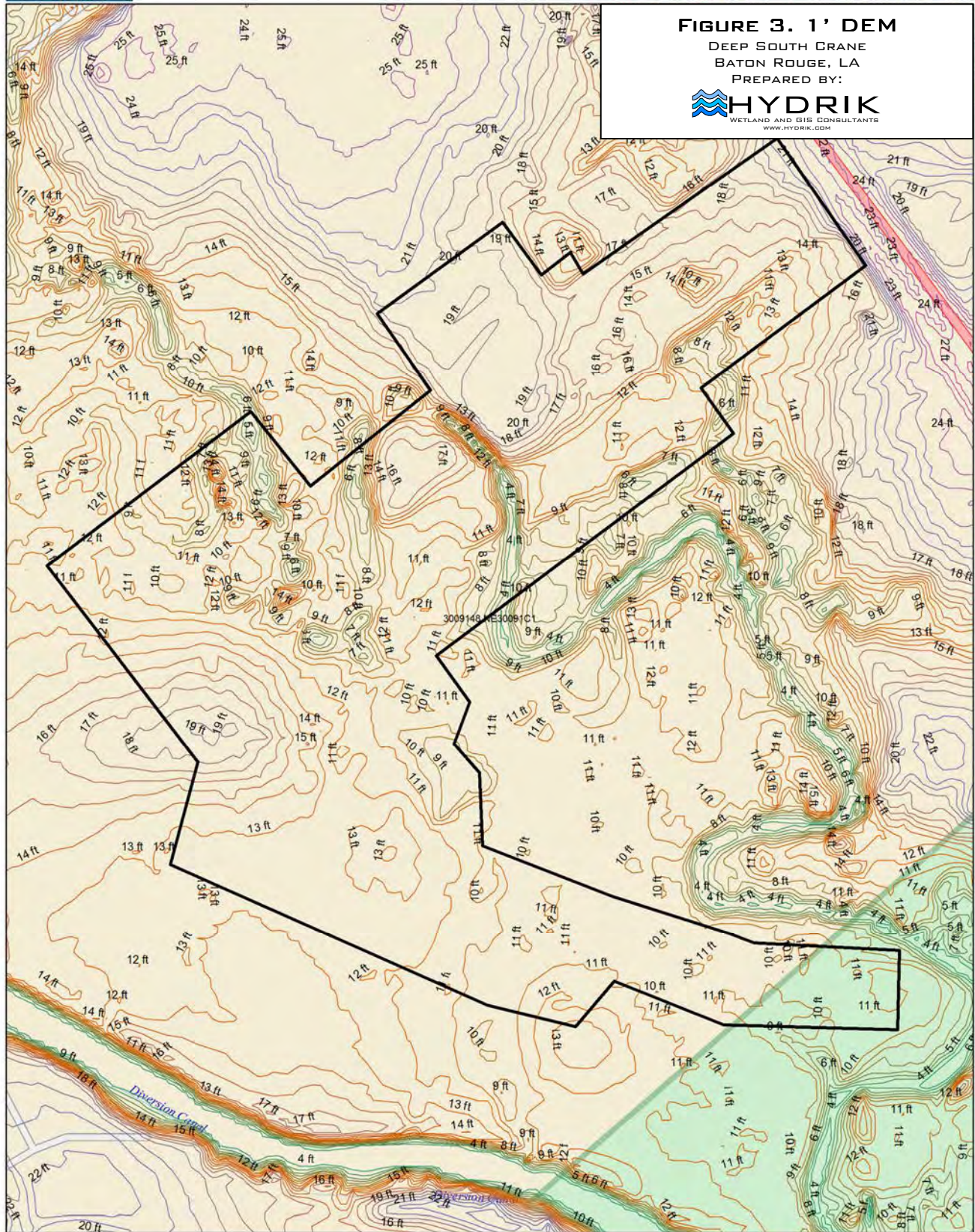

FIGURE 4. 2002 HR
DEEP SOUTH CRANE
BATON ROUGE, LA
PREPARED BY:



FIGURE 5. 2006 HR
DEEP SOUTH CRANE
BATON ROUGE, LA
PREPARED BY:



FIGURE 6. 2009 HR
DEEP SOUTH CRANE
BATON ROUGE, LA
PREPARED BY:



FIGURE 7. 2010 HR
DEEP SOUTH CRANE
BATON ROUGE, LA
PREPARED BY:



FIGURE 8. 2011 HR
DEEP SOUTH CRANE
BATON ROUGE, LA
PREPARED BY:



FIGURE 9. 2013 HR
DEEP SOUTH CRANE
BATON ROUGE, LA
PREPARED BY:



DEEP SOUTH CRANE
 ~43 ACRES, BATON ROUGE, LA.
 CRANE FACILITY EXPANSION
 MVN 2012 01584 SW



ALL CLEARING, FILL, EXCAVATION, SITE PREP AND REROUTE ACTIVITY EXISTING SINCE 2010. STRUCTURES ARE PROPOSED. AREA IS CURRENTLY USED FOR CRANE AND EQUIPMENT STORAGE.

ALL STRUCTURES EXISTING SINCE EARLY 1990'S

FIGURE 10
OVERALL PLAN
COLOR

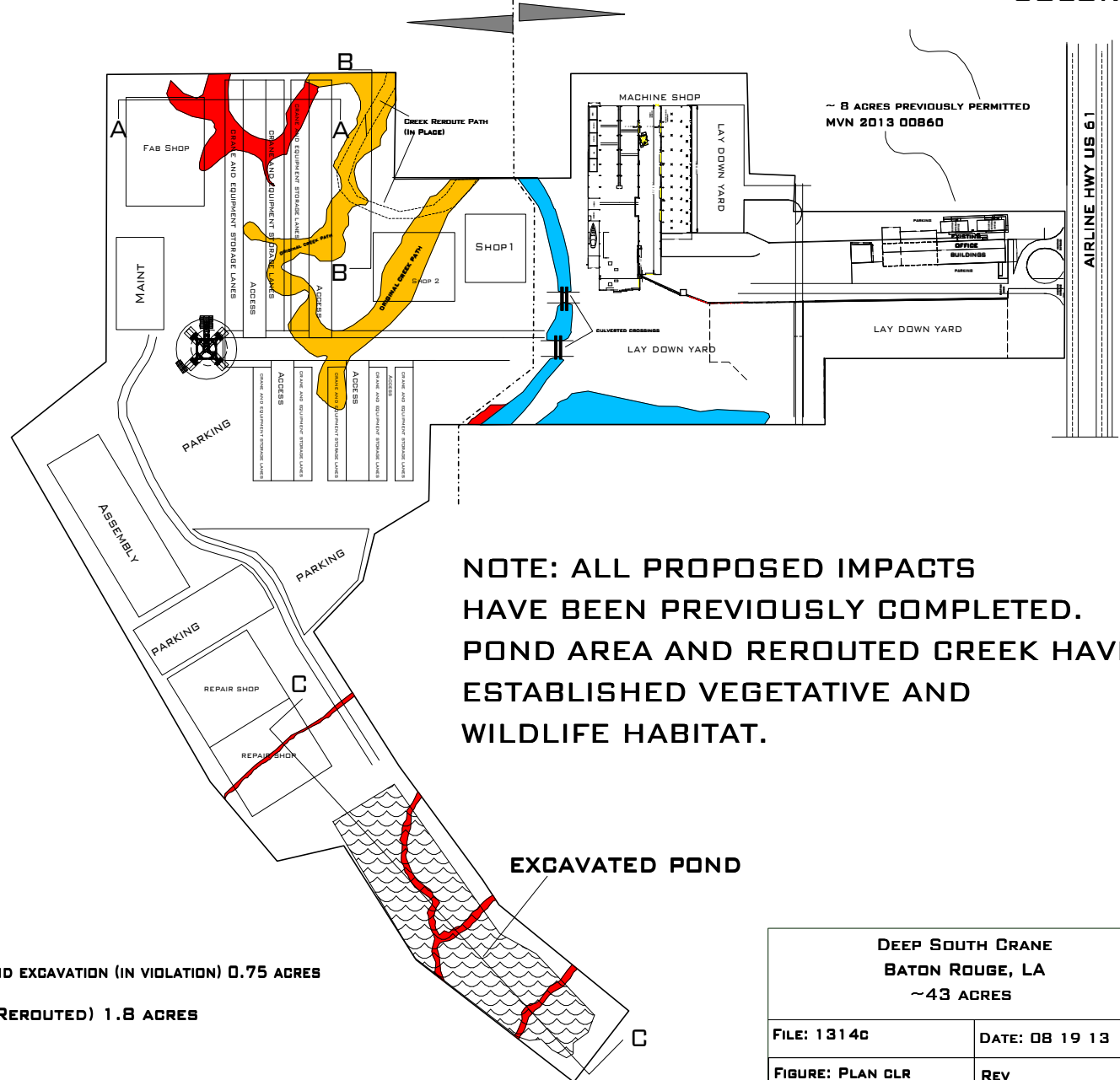

~ 8 ACRES PREVIOUSLY PERMITTED
 MVN 2013 00860

AIRLINE HWY US 61

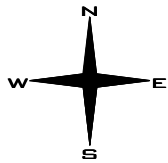

NOTE: ALL PROPOSED IMPACTS HAVE BEEN PREVIOUSLY COMPLETED. POND AREA AND REROUTED CREEK HAVE ESTABLISHED VEGETATIVE AND WILDLIFE HABITAT.

- WETLANDS IMPACTED VIA FILL, GRADING AND EXCAVATION (IN VIOLATION) 0.75 ACRES
- WATERS IMPACTED VIA FILL (CREEK REROUTED) 1.8 ACRES
- EXISTING UNIMPACTED WATERS

DEEP SOUTH CRANE BATON ROUGE, LA ~43 ACRES	
FILE: 1314C	DATE: 08 19 13
FIGURE: PLAN CLR	REV
DRAWING: PV1 CLR	APPROVED: MJH

DEEP SOUTH CRANE
 ~43 ACRES, BATON ROUGE, LA.
 CRANE FACILITY EXPANSION
 MVN 2012 01584 SW



ALL CLEARING, FILL, EXCAVATION, SITE PREP AND
 REROUTE ACTIVITY EXISTING SINCE 2010.
 STRUCTURES ARE PROPOSED. AREA IS CURRENTLY
 USED FOR CRANE AND EQUIPMENT STORAGE.

ALL STRUCTURES
 EXISTING SINCE
 EARLY 1990'S

FIGURE 11
OVERALL PLAN
HATCH

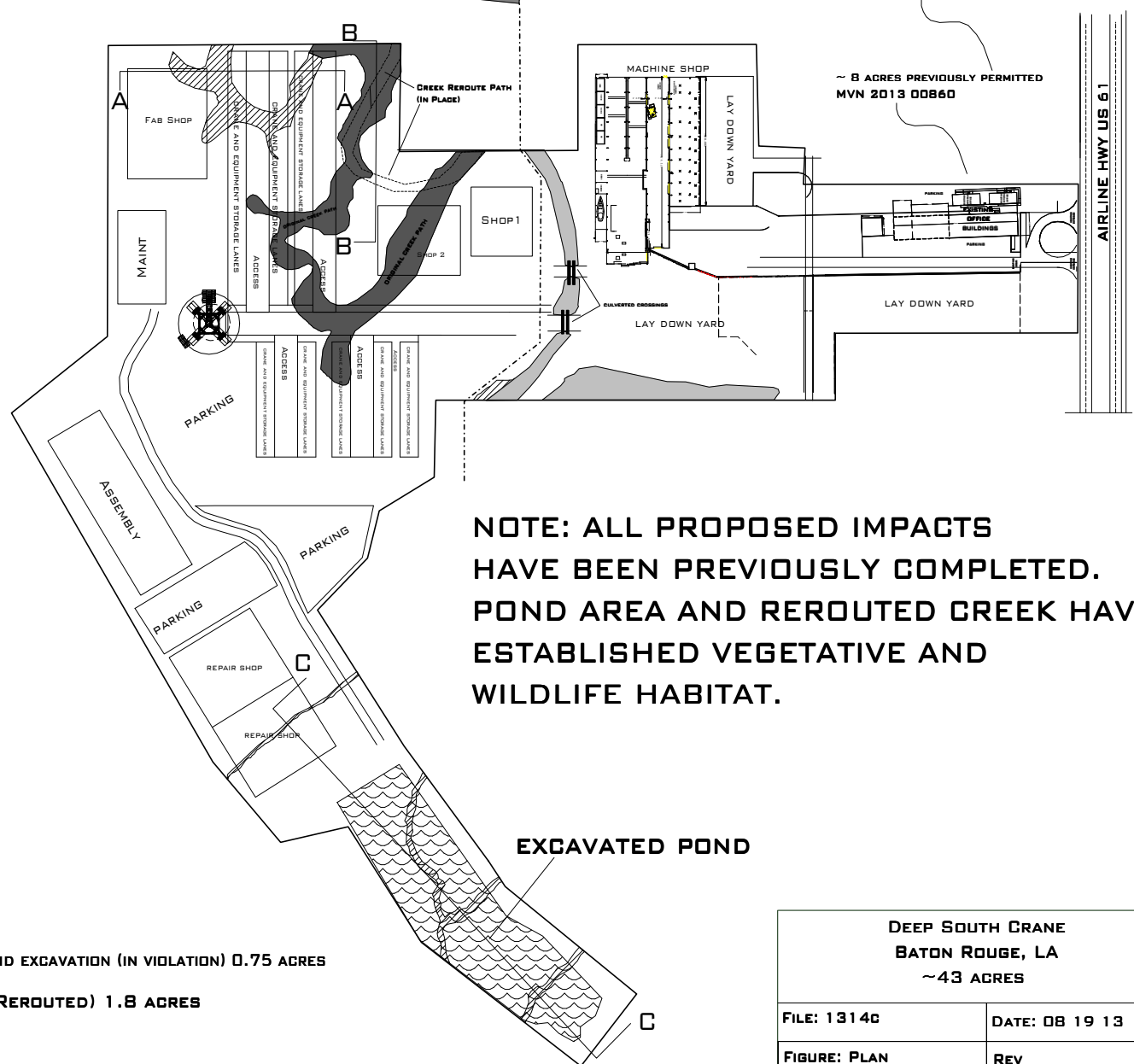

~ 8 ACRES PREVIOUSLY PERMITTED
 MVN 2013 00860

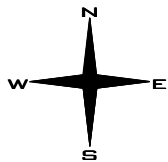

- WETLANDS IMPACTED VIA FILL, GRADING AND EXCAVATION (IN VIOLATION) 0.75 ACRES
- WATERS IMPACTED VIA FILL (CREEK REROUTED) 1.8 ACRES
- EXISTING UNIMPACTED WATERS

DEEP SOUTH CRANE BATON ROUGE, LA ~43 ACRES	
FILE: 1314C	DATE: 08 19 13
FIGURE: PLAN	REV
DRAWING: PV1	APPROVED: MJH

DEEP SOUTH CRANE
 ~43 ACRES, BATON ROUGE, LA.
 CRANE FACILITY EXPANSION
 MVN 2012 01584 SW

HORIZONTAL AND VERTICAL SCALES AS LABELED

FIGURE 12



SECTION A-A

NGVD

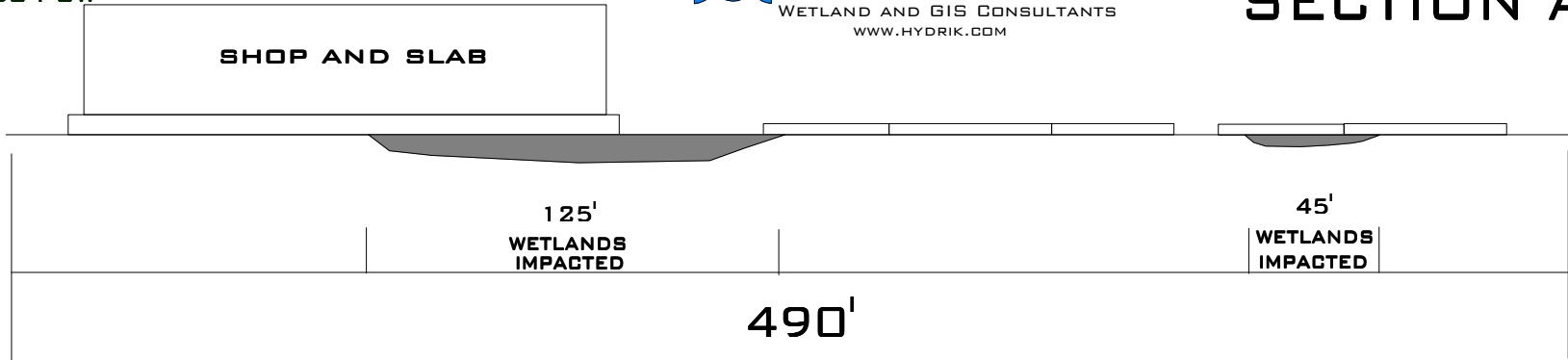
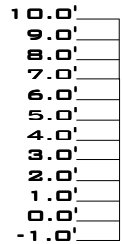

SECTION B-B

NGVD

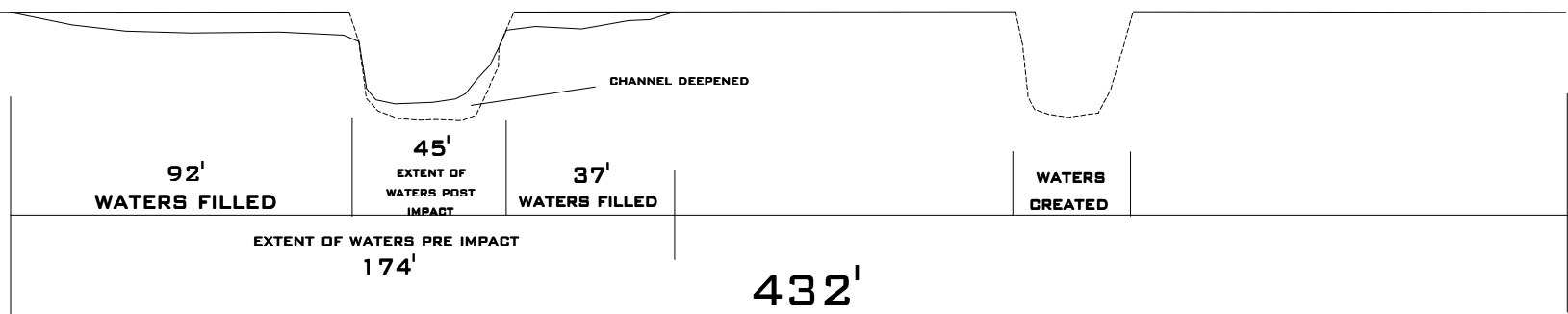
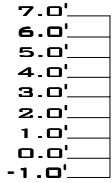

SECTION C-C

NGVD

