

# JOINT PUBLIC NOTICE

OCT 28 2013

United States Army  
Corps of Engineers  
New Orleans District  
Attn: Regulatory Branch  
Post Office Box 60267  
New Orleans, Louisiana 70160-0267

State of Louisiana  
Department of Environmental Quality  
Attn: Water Quality Certification Sec.  
Post Office Box 4313  
Baton Rouge, Louisiana 70821-4313

Project Manager: Sara Fortuna  
(504) 862-1025/ fax: (504) 862-2574  
Sara.b.fortuna@usace.army.mil  
Permit Application Number:  
MVN-2013-02146 WKK

Project Manager:  
Jamie Phillippe  
(225) 219-3225 / fax: (225) 219-3156  
WQC Application Number:  
WQC-131018-01

Interested parties are hereby notified that a permit application has been received by the New Orleans District of the U.S. Army Corps of Engineers pursuant to: [ ] Section 10 of the Rivers and Harbors Act of March 3, 1899 (30 Stat. 1151; 33 USC 403); and/or [ X ] Section 404 of the Clean Water Act (86 Stat. 816; 33 USC 1344).

The application has also been mailed to the Louisiana Department of Environmental Quality, for a Water Quality Certification (WQC) in accordance with statutory authority contained in Louisiana Revised Statute 30:2074 A(3), and provisions of Section 401 of the Clean Water Act (P.L. 95-17).

## TRACK FACILITY IN BEAUREGARD PARISH

**NAME OF APPLICANT:** Beauregard Parish School Board, c/o Arabie Environmental Solutions, Inc., Post Office Box 928, Lake Charles, Louisiana 70602.

**LOCATION OF WORK:** In Beauregard Parish, Singer High School, 153 Highway 110 E., Section 5, Township 5S, and Range 10W, located in the community of Singer, as shown on the attached vicinity map. (Hydrologic Unit Code 08080205, Calcasieu Basin)

**CHARACTER OF WORK:** Conduct clearing and grading operations and place approximately 3,000 cubic yards of earthen material, 800 cubic yards of hauled-in aggregate and soil, and 400 cubic yards of asphalt to prepare an approximately 6.0 acre site for a high school track facility. There are 0.85 acres of jurisdictional wetlands that will be impacted via project implementation. The applicant agreed to purchase appropriate mitigation credits from an approved Department of the Army mitigation bank to compensate for all project related wetland impacts.

The comment period for the Department of the Army Permit and the Louisiana Department of Environmental Quality WQC will close 20 days from the date of this joint public notice. Written comments, including suggestions for modifications or objections to the proposed work, stating reasons thereof, are being solicited from anyone having interest in this permit and/or this WQC request and must be submitted so as to be received before or by the last day of the comment period. Letters concerning the Corps of Engineers permit application must reference the applicant's name and the Permit Application Number, and be forwarded to the Corps of Engineers at the address above, **ATTENTION: REGULATORY BRANCH**. Individuals or parties may request an extension of time in which to comment on the proposed work by writing, faxing, or e-mailing the Corps of Engineers Project Manager listed above. Any request must be specific and substantively supportive of the requested extension, and received by this office prior to the end of the initial comment period. The Section Chief will review the request and the requestor will be promptly notified of the decision to grant or deny the request. If granted, the time extension will be continuous to the initial comment period and, inclusive of the initial comment period, will not exceed a total of 30 calendar days. Letters concerning the Water Quality Certification must reference the applicant's name and the WQC Application number and be mailed to the Louisiana Department of Environmental Quality at the address above.

The application for this proposed project is on file with the Louisiana Department of Environmental Quality and may be examined during weekdays between 8:00 a.m. and 4:30 p.m. Copies may be obtained upon payment of costs of reproduction.

### **Corps of Engineers Permit Criteria**

The decision whether to issue a permit will be based on an evaluation of the probable impacts, including cumulative impacts of the proposed activity on the public interest. That decision will reflect the national concern for both protection and utilization of important resources. The benefit which reasonably may be expected to accrue from the proposal must be balanced against its reasonably foreseeable detriments. All factors which may be relevant to the proposal will be considered including the cumulative effects thereof; among those are conservation, economics, aesthetics, general environmental concerns, wetlands, historic properties, fish and wildlife values, flood hazards, floodplain values, land use, navigation, shoreline erosion and accretion, recreation, water supply and conservation, water quality, energy needs, safety, food and fiber production, mineral needs, considerations of property ownership and, in general, the needs and welfare of the people.

The U.S. Army Corps of Engineers is soliciting comments from the public, federal, state, and local agencies and officials, Indian Tribes, and other interested parties in order to consider and evaluate the impacts of this proposed activity. Any comments received will be considered by the U.S. Army Corps of Engineers to determine whether to make, modify, condition, or deny a permit for this proposal. To make this decision, comments are used to assess impacts on endangered species, historic properties, water quality, general environmental effects, and other public interest factors listed above. Comments are used in the preparation of an Environmental Assessment and/or an Environmental Impact Statement pursuant to the National Environmental Policy Act. Comments are also used to determine the need for a public hearing and to determine the overall public interest of the proposed activity.

The New Orleans District is unaware of properties listed on the National Register of Historic Places near the proposed work. The possibility exists that the proposed work may damage or destroy presently unknown archeological, scientific, prehistorical, historical sites, or data. Issuance of this public notice solicits input from the State Archeologist and State Historic Preservation Officer regarding potential impacts to cultural resources.

Our initial finding is that the proposed work would neither affect any species listed as endangered by the U.S. Departments of Interior or Commerce, nor affect any habitat designated as critical to the survival and recovery of any endangered species.

This notice initiates the Essential Fish Habitat (EFH) consultation requirements of the Magnuson-Stevens Fishery Conservation and Management Act. The applicant's proposal may result in the destruction or alteration of 0 acres of EFH utilized by various life stages of red drum and penaeid shrimp. Our initial determination is that the proposed action would not have a substantial adverse impact on EFH or federally managed fisheries in the Gulf of Mexico. Our final determination relative to project impacts and the need for mitigation measures is subject to review by and coordination with the National Marine Fisheries Service.

If the proposed work involves deposits of dredged or fill material into navigable waters, the evaluation of the probable impacts will include the application of guidelines established by the Administrator of the Environmental Protection Agency. Also, a certification that the proposed activity will not violate applicable water quality standards will be required from the Department of Environmental Quality, before a permit is issued.

Any person may request, in writing, within the comment period specified in this notice, that a public hearing be held to consider this application. Requests for public hearings shall state, with particularity, the reasons for holding a public hearing.

You are requested to communicate the information contained in this notice to any other parties whom you deem likely to have interest in the matter.

Darrell S. Barbara  
Chief, Western Evaluation Section  
Regulatory Branch

Enclosure

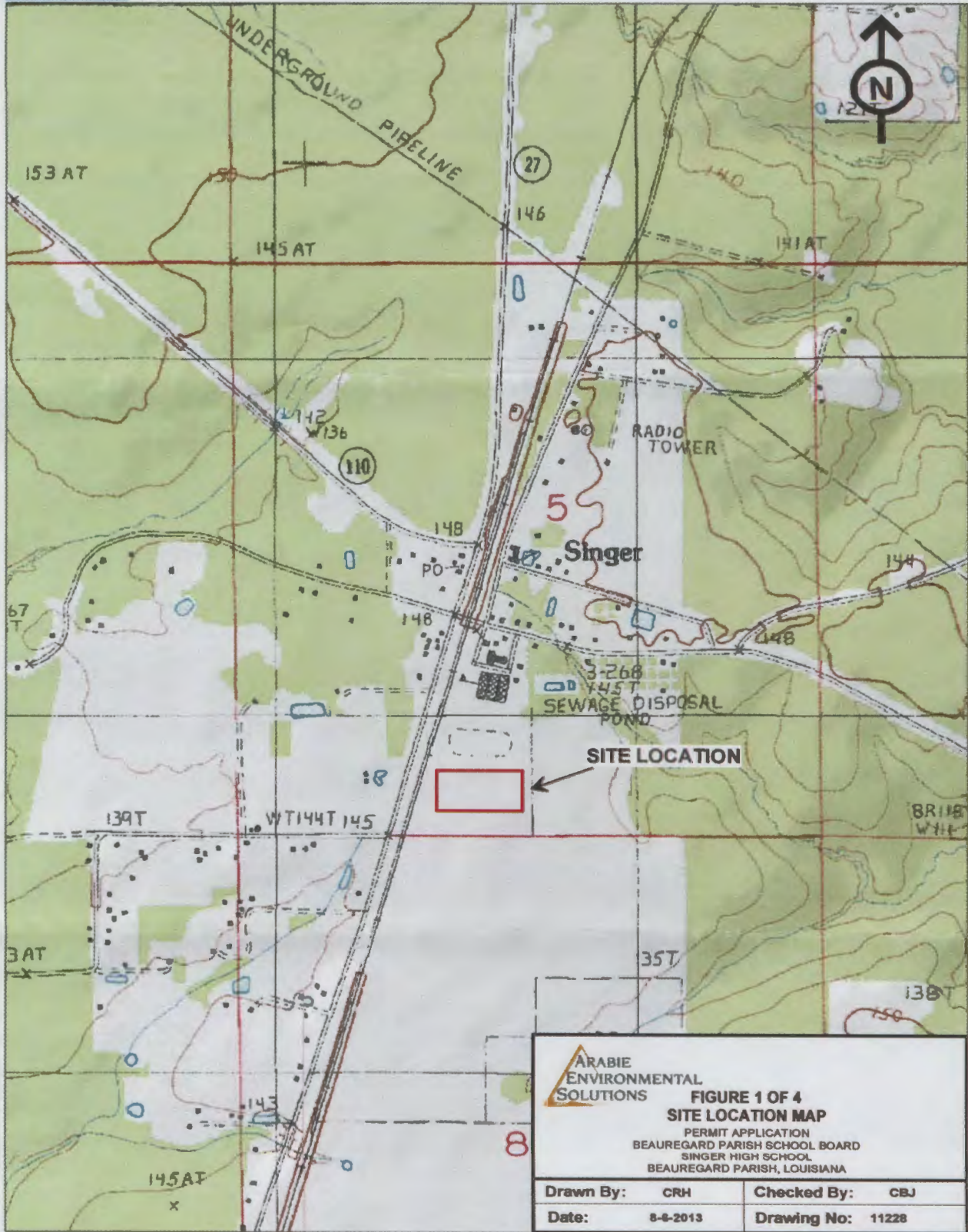

**ARABIE ENVIRONMENTAL SOLUTIONS**

**FIGURE 1 OF 4**  
**SITE LOCATION MAP**

PERMIT APPLICATION  
 BEAUREGARD PARISH SCHOOL BOARD  
 SINGER HIGH SCHOOL  
 BEAUREGARD PARISH, LOUISIANA

Drawn By:	CRH	Checked By:	CBJ
Date:	8-6-2013	Drawing No:	11228

Data use subject to license  
 © DeLorme XMap® 5.2 GIS Editor.  
 www.delorme.com

★  
 MN (1.8° E)

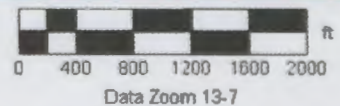

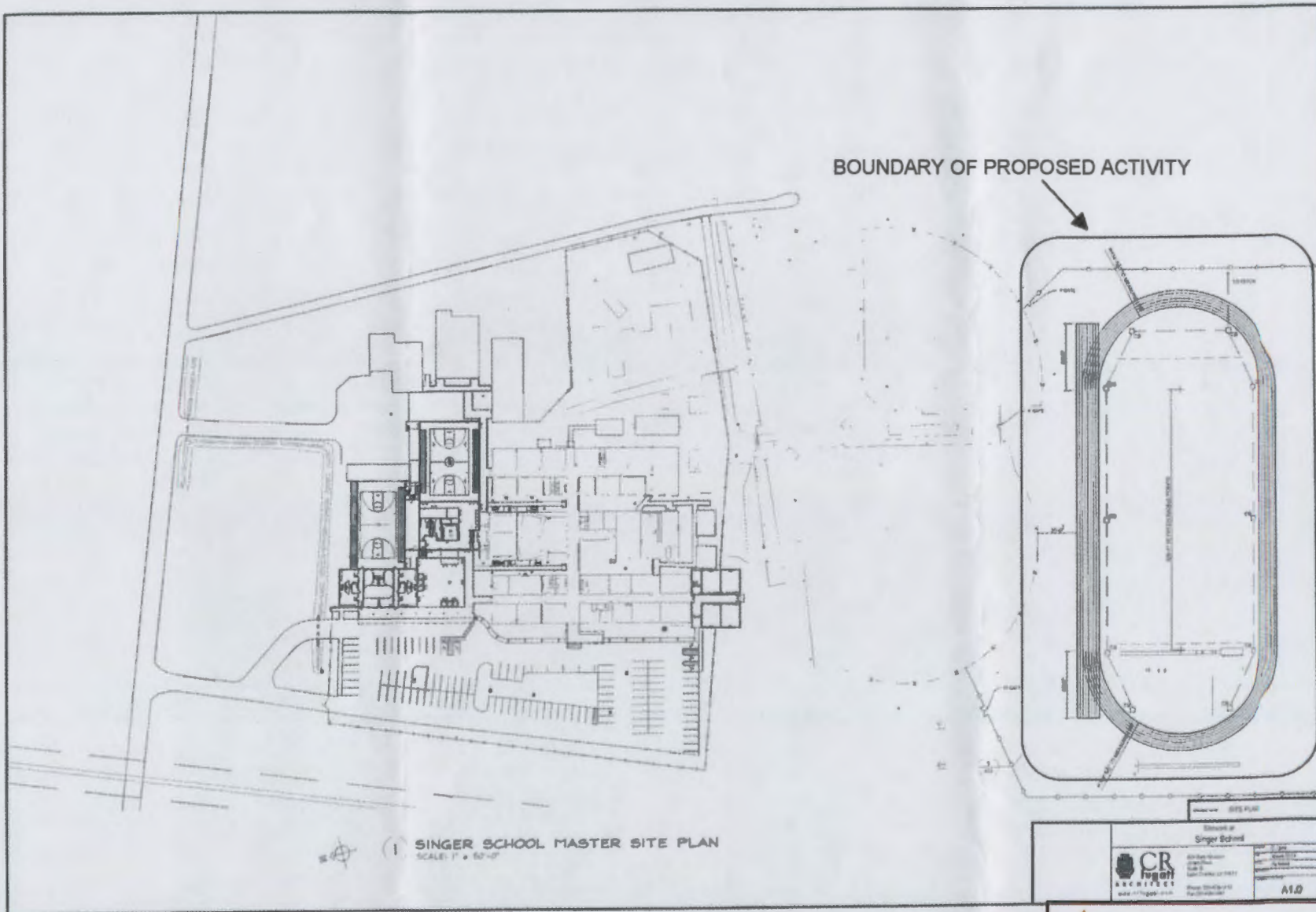



APPROXIMATELY 0.85 ACRES OF WETLANDS  
WILL BE IMPACTED AS A RESULT OF THIS PROJECT.

DRAWINGS PROVIDED BY THE BEAUREGARD PARISH SCHOOL BOARD.

SITES PLAN	
School of Singer School	
4000 Lake Road Metairie, LA 70002 Phone: (504) 885-1111 Fax: (504) 885-1112 www.crapro.com	A1.0

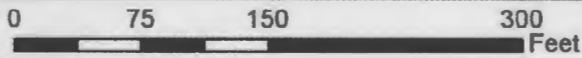
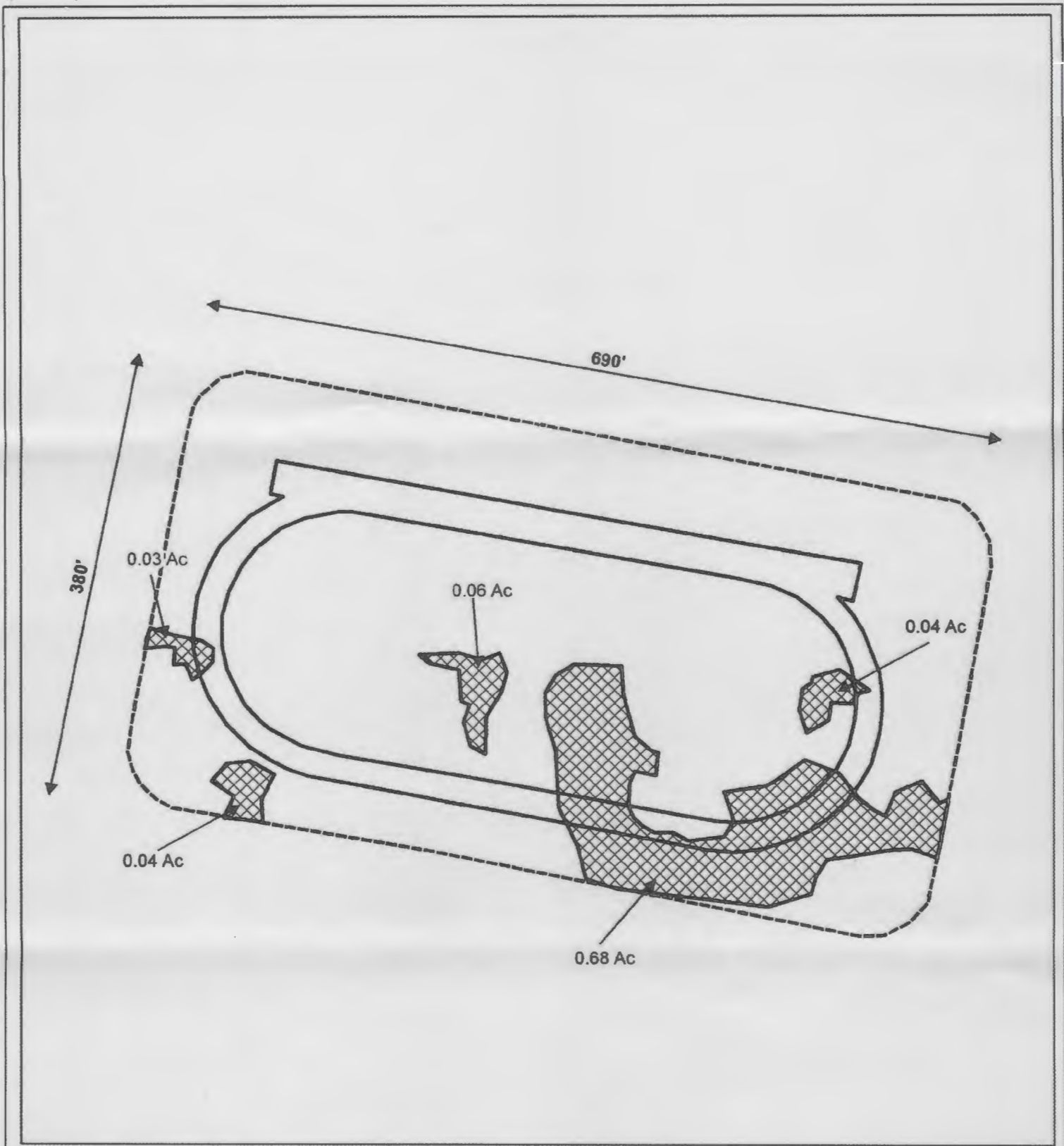
	<b>FIGURE 2 OF 4 SITE PLAN</b>
	PERMIT APPLICATION BEAUREGARD PARISH SCHOOL BOARD SINGER HIGH SCHOOL BEAUREGARD PARISH, LOUISIANA
Drawn By:	Checked By:
Date:	Drawing No.:



	<b>NON-WETLANDS (5.16 ACRES)</b>
	<b>100% WETLANDS (0.85 ACRE)</b>



**FIGURE 3 OF 4  
SITE DIAGRAM**

PERMIT APPLICATION  
BEAUREGARD PARISH SCHOOL BOARD  
SINGER HIGH SCHOOL  
BEAUREGARD PARISH, LOUISIANA

Drawn By: CRF1	Checked By: CBJ
Date: 8/6/2013	AES Project # 11225

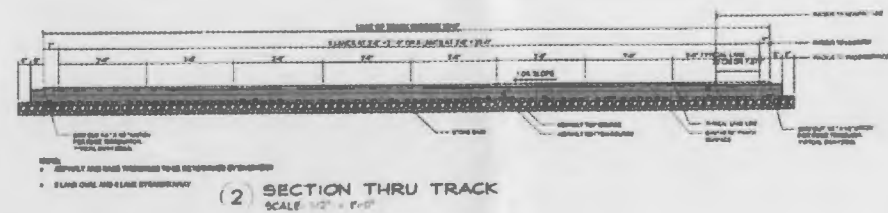
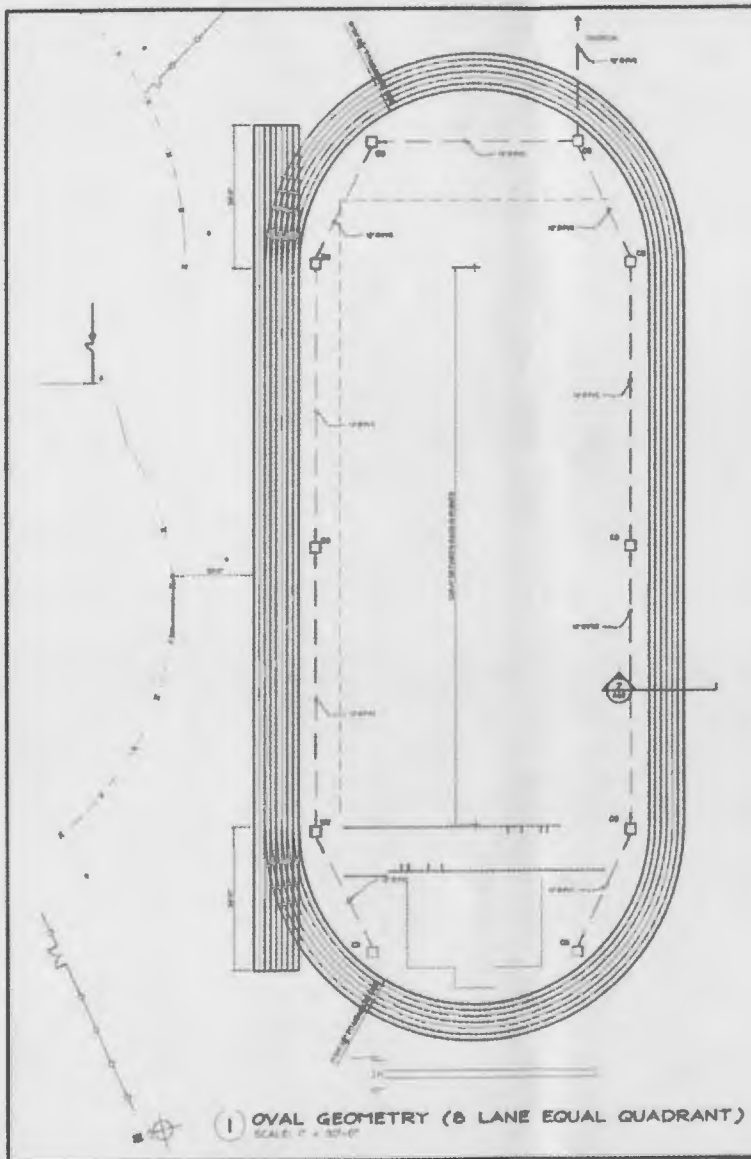

APPROXIMATELY 0.85 ACRES OF WETLANDS  
WILL BE IMPACTED AS A RESULT OF THIS PROJECT.

DRAWINGS PROVIDED BY THE BEAUREGARD PARISH SCHOOL BOARD.

SITE PLAN									
Location of Singer School									
	<table border="1"> <tr> <td>DATE</td> <td>10/1/11</td> </tr> <tr> <td>SCALE</td> <td>AS SHOWN</td> </tr> <tr> <td>PROJECT NO.</td> <td>11-001</td> </tr> <tr> <td>DATE PLOTTED</td> <td>10/1/11</td> </tr> </table>	DATE	10/1/11	SCALE	AS SHOWN	PROJECT NO.	11-001	DATE PLOTTED	10/1/11
	DATE	10/1/11							
	SCALE	AS SHOWN							
	PROJECT NO.	11-001							
DATE PLOTTED	10/1/11								
<table border="1"> <tr> <td>DATE</td> <td>10/1/11</td> </tr> <tr> <td>SCALE</td> <td>AS SHOWN</td> </tr> <tr> <td>PROJECT NO.</td> <td>11-001</td> </tr> <tr> <td>DATE PLOTTED</td> <td>10/1/11</td> </tr> </table>	DATE	10/1/11	SCALE	AS SHOWN	PROJECT NO.	11-001	DATE PLOTTED	10/1/11	A2.D
DATE	10/1/11								
SCALE	AS SHOWN								
PROJECT NO.	11-001								
DATE PLOTTED	10/1/11								

	<p>FIGURE 4 OF 4 CROSS SECTION</p> <p>PERM APPLICATION BEAUREGARD PARISH SCHOOL BOARD SINGER HIGH SCHOOL BEAUREGARD PARISH, LOUISIANA</p>			
	<table border="1"> <tr> <td>Drawn By:</td> <td>Checked By:</td> </tr> <tr> <td>Date:</td> <td>Drawing No:</td> </tr> </table>	Drawn By:	Checked By:	Date:
Drawn By:	Checked By:			
Date:	Drawing No:			

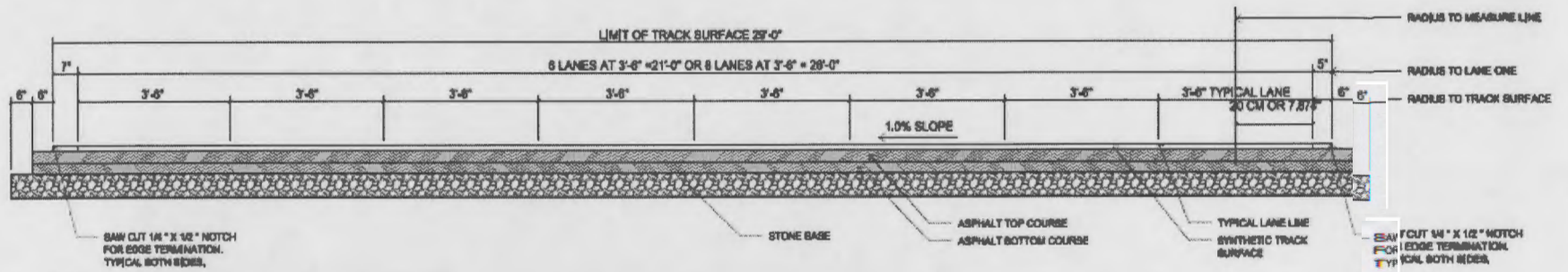

NOTE:

- ASPHALT AND BASE THICKNESS TO BE DETERMINED BY ENGINEER
- 8 LANE OVAL AND 8 LANE STRAIGHTAWAY

2 SECTION THRU TRACK  
SCALE: 1/2" = 1'-0"