

# JOINT PUBLIC NOTICE

July 15, 2013

United States Army  
Corps of Engineers  
New Orleans District  
Regulatory Branch  
Post Office Box 60267  
New Orleans, Louisiana 70160-0267

(504) 862-2259  
Project Manager  
Scott N. Kennedy  
scott.n.kennedy@usace.army.mil  
Permit Application Number  
MVN 2013-1349 EMM

State of Louisiana  
Department of Environmental Quality  
Attn: Water Quality Certifications  
Post Office Box 4313  
Baton Rouge, Louisiana 70821-4313

(225) 219-3225  
Project Manager  
Jamie Phillippe  
WQC Application Number  
WQC JP 130620-02

Interested parties are hereby notified that a permit application has been received by the New Orleans District of the U.S. Army Corps of Engineers pursuant to: [X] Section 10 of the Rivers and Harbors Act of March 3, 1899 (30 Stat. 1151; 33 USC 403); and/or [X] Section 404 of the Clean Water Act (86 Stat. 816; 33 USC 1344).

Application has also been made to the Louisiana Department of Environmental Quality, Water Quality Certifications, for a Water Quality Certification (WQC) in accordance with statutory authority contained in LRS 30:2074 A(3) and provisions of Section 401 of the Clean Water Act.

## **DREDGE TO REMOVE AND ABANDON A 10" PIPELINE IN PLAQUEMINES PARISH**

**NAME OF APPLICANT:** Chevron Pipeline Company, c/o Project Consulting Services, Inc., 302 La Rue France, Suite 200, Lafayette, Louisiana 70508.

**LOCATION OF WORK:** In the Gulf of Mexico, near Venice, Louisiana, in Plaquemines Parish, as shown on the attached drawings.

HUC: 08090203 Eastern Louisiana Coastal

**CHARACTER OF WORK:** Dredge approximately 43,298 cubic yards of native material and remove and abandon a 10" pipeline, near Venice, Louisiana. Approximately 8.95 acres of non-vegetated water bottoms would be temporarily impacted. No compensatory mitigation has been proposed.

The comment period for the Department of the Army Permit and the Louisiana Department of Environmental Quality WQC will close **20 days** from the date of this joint public notice. Written comments, including suggestions for modifications or objections to the proposed work, stating reasons thereof, are being solicited from anyone having interest in this permit and/or this WQC request and must be mailed so as to be received before or by the last day of the comment period. Letters concerning the Corps of Engineers permit application must reference the applicant's name and the Permit Application Number, and be mailed to the Corps of Engineers at the address above, **ATTENTION: REGULATORY BRANCH**. Similar letters concerning the Water Quality Certification must reference the applicant's name and the WQC Application number and be mailed to the Louisiana Department of Environmental Quality at the address above. Individuals or parties may request an extension of time in which to comment on the proposed work by writing or e-mailing the Corps of Engineers Project Manager

listed above. Any request must be specific and substantively supportive of the requested extension, and received by this office prior to the end of the initial comment period. The Section Chief will review the request and the requestor will be promptly notified of the decision to grant or deny the request. If granted, the time extension will be continuous to the initial comment period and, inclusive of the initial comment period, will not exceed a total of 30 calendar days.

The application for this proposed project is on file with the Louisiana Department of Environmental Quality and may be examined weekdays between 8:00 a.m. and 4:30 p.m. Copies may be obtained upon payment of costs of reproduction.

### **Corps of Engineers Permit Criteria**

The decision whether to issue a permit will be based on an evaluation of the probable impacts, including cumulative impacts of the proposed activity on the public interest. That decision will reflect the national concern for both protection and utilization of important resources. The benefit which reasonably may be expected to accrue from the proposal must be balanced against its reasonably foreseeable detriments. All factors which may be relevant to the proposal will be considered including the cumulative effects thereof; among those are conservation, economics, aesthetics, general environmental concerns, wetlands, historic properties, fish and wildlife values, flood hazards, floodplain values, land use, navigation, shoreline erosion and accretion, recreation, water supply and conservation, water quality, energy needs, safety, food and fiber production, mineral needs, considerations of property ownership and, in general, the needs and welfare of the people.

The U.S. Army Corps of Engineers is soliciting comments from the public, federal, state, and local agencies and officials, Indian Tribes, and other interested parties in order to consider and evaluate the impacts of this proposed activity. Any comments received will be considered by the U.S. Army Corps of Engineers to determine whether to make, modify, condition, or deny a permit for this proposal. To make this decision, comments are used to assess impacts on endangered species, historic properties, water quality, general environmental effects, and other public interest factors listed above. Comments are used in the preparation of an Environmental Assessment and/or an Environmental Impact Statement pursuant to the National Environmental Policy Act. Comments are also used to determine the need for a public hearing and to determine the overall public interest of the proposed activity.

No properties listed on the National Register of Historic Places are near the proposed work. The possibility exists that the proposed work may damage or destroy presently unknown archeological, scientific, prehistorical, historical sites, or data. Copies of this notice are being sent to the State Archeologist and the State Historic Preservation Officer.

Our initial finding is that the proposed work would neither affect any species listed as endangered by the U.S. Departments of Interior or Commerce, nor affect any habitat designated as critical to the survival and recovery of any endangered species.

This notice initiates the Essential Fish Habitat (EFH) consultation requirements of the Magnuson-Stevens Fishery Conservation and Management Act. The applicant's proposal would result in the destruction or alteration of up to 8.95 acres of EFH utilized by various life stages of red drum and penaeid shrimp. Our initial determination is that the proposed action would not have a substantial adverse impact on EFH or federally managed fisheries in the Gulf of Mexico. Our final determination relative to project impacts and the need for mitigation measures is subject to review by and coordination with the National Marine Fisheries Service.

If the proposed work involves deposits of dredged or fill material into navigable waters, the evaluation of the probable impacts will include the application of guidelines established by the Administrator of the Environmental Protection Agency. Also, a certification that the proposed activity will not violate water quality standards will be required from the Department of Environmental Quality, Water Quality Certifications, before a permit is issued.

Any person may request, in writing, within the comment period specified in this notice, that a public hearing be held to consider this application. Requests for public hearings shall state, with particularity, the reasons for holding a public hearing.

The applicant has certified that the proposed activity described in the application complies with and will be conducted in a manner that is consistent with the Louisiana Coastal Resources Program. The Department of the Army permit will not be issued unless the applicant received approval or a waiver of the Coastal Use Permit by the Department of Natural Resources.

You are requested to communicate the information contained in this notice to any other parties whom you deem likely to have interest in the matter.

Michael Farabee  
Chief, Eastern Evaluation Section

Enclosures

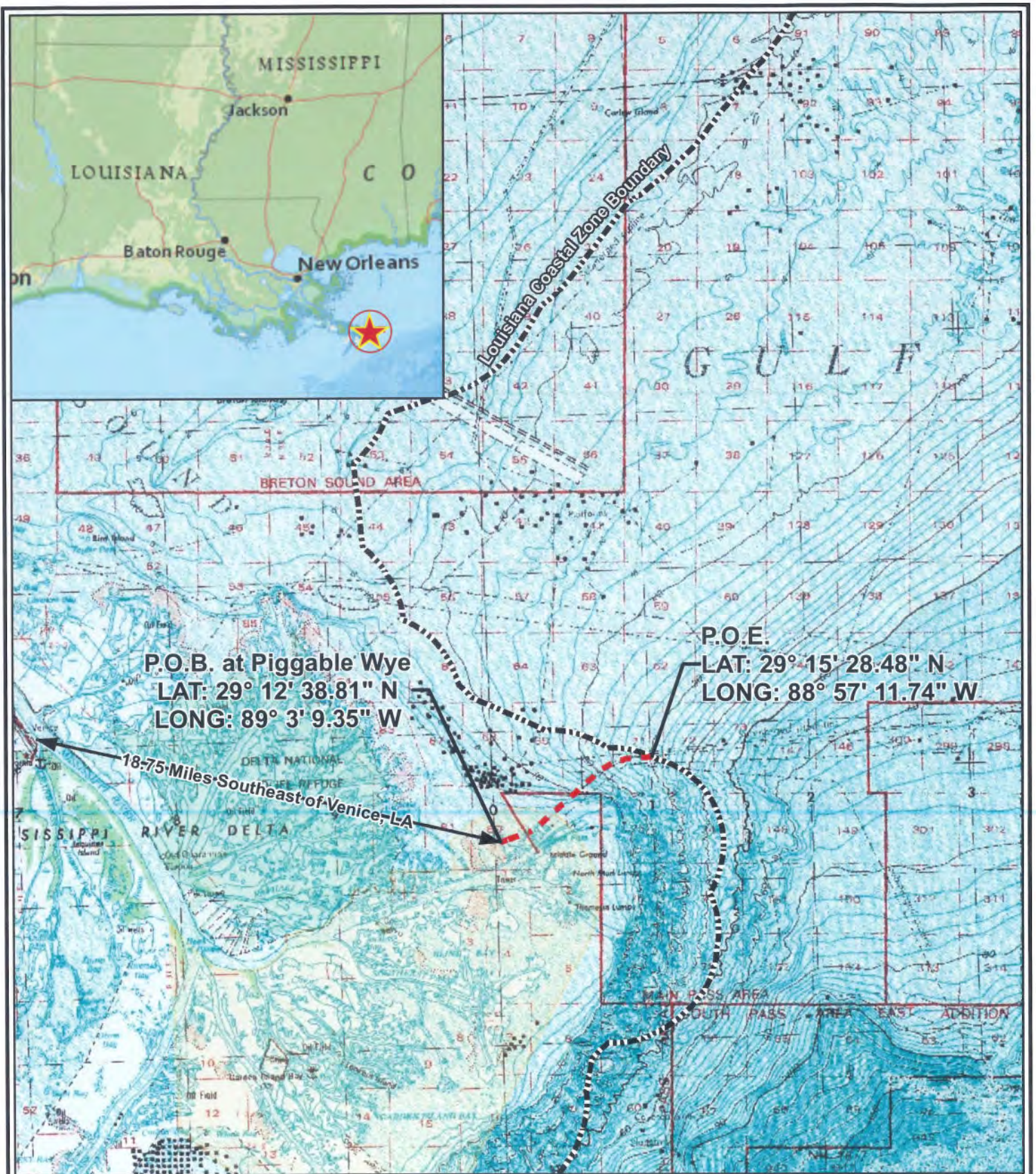



**P.O.B. at Piggable Wye**  
**LAT: 29° 12' 38.81" N**  
**LONG: 89° 3' 9.35" W**

**P.O.E.**  
**LAT: 29° 15' 28.48" N**  
**LONG: 88° 57' 11.74" W**

**18.75 Miles Southeast of Venice, LA**



 Proposed 10" Pipeline to be Abandoned ( 7.03 Miles)  
 Project Location

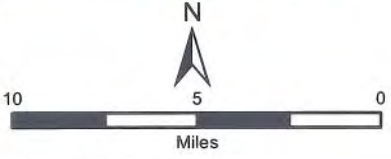

**Chevron Pipe Line Company**  
**Proposed 10" Pipeline Abandonment**  
**Plaquemines Parish, Louisiana**

Map Date: 05/14/2013  
 Map Projection NAD83 Louisiana State Plane South:  
 Page Size - 8.5" x 11"  
 Service Layer Credits:  
 National Geographic, Esri, DeLorme, NAVTEQ, UNEP-WCMC,  
 USGS, NASA, ESA, METI, NRCAN, GEBCO, NOAA, IPC  
 Copyright: © 2013 National Geographic Society

Note: The content of this drawing is designed specifically for the purpose of securing Federal, State and Local Environmental/Regulatory authorizations only.

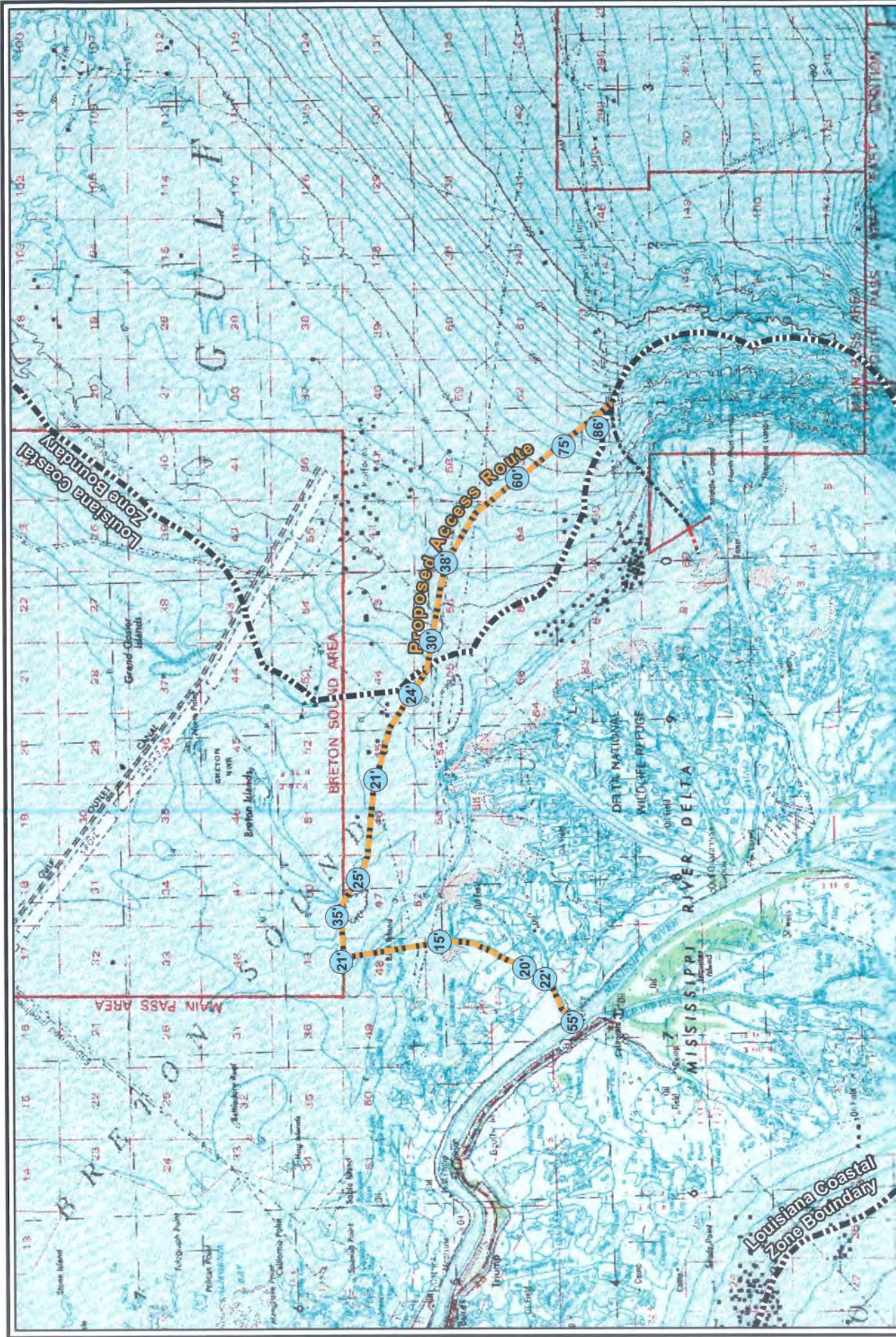

**Chevron Pipe Line Company  
Proposed 10" Pipeline Abandonment  
Plaquemines Parish, Louisiana**

Map Date: 05/14/2013  
Map Projection NAD83 Louisiana State Plane South  
Page Size - 8.5" x 11"  
Service Layer Credits:  
Copyright: © 2013 National Geographic Society

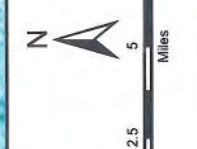

- Water Depths from Gulf Coast Electronic Navigational Charts
- Proposed 10" Pipeline to be abandoned in place (0.88 Miles)
- Proposed 10" Pipeline to be removed (6.15 Miles)

**IPS**

Note: The content of this drawing is designed specifically for the purpose of securing Federal, State and Local Environmental/Regulatory authorizations only.

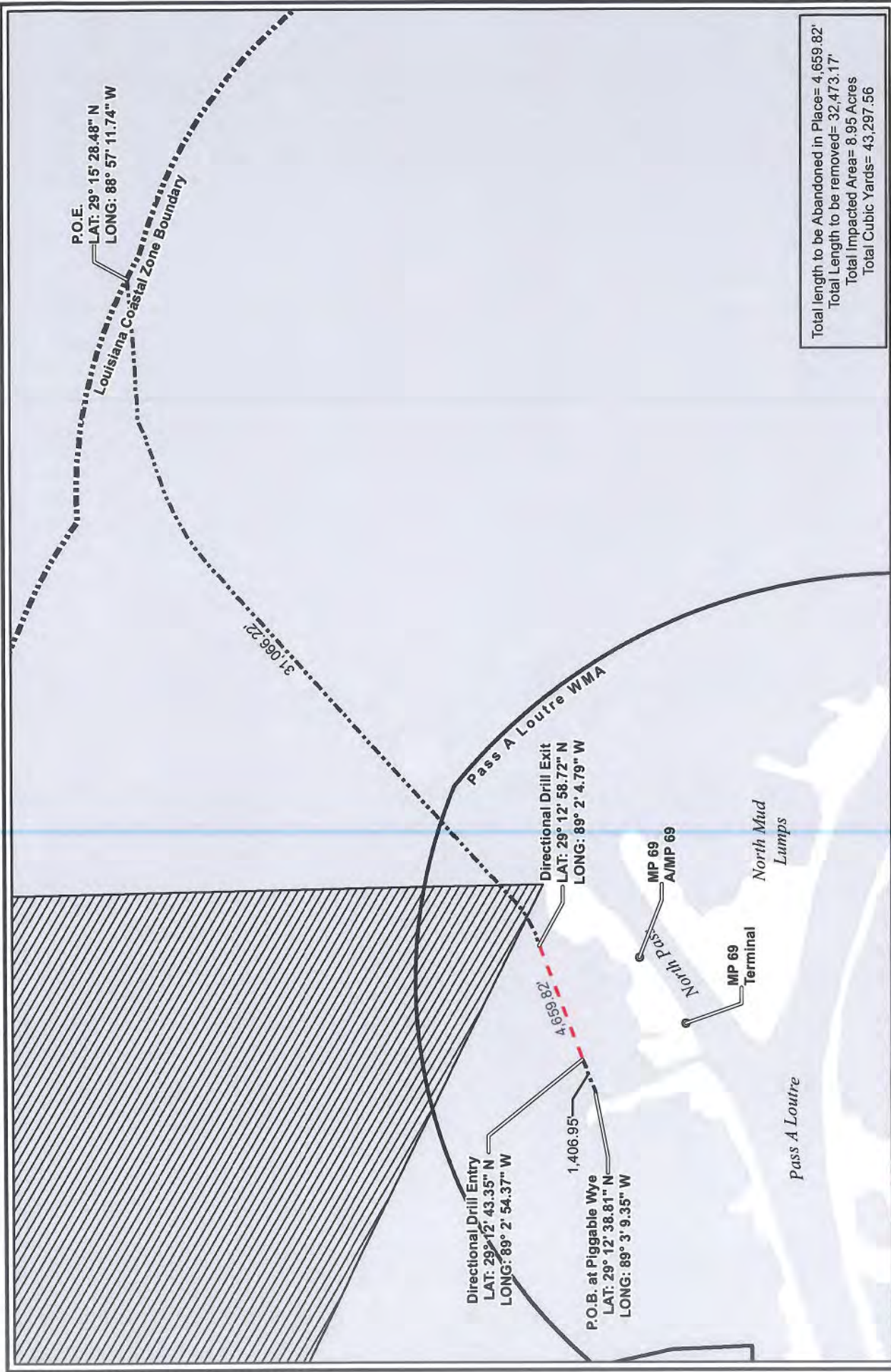

Total length to be Abandoned in Place= 4,659.82'  
 Total Length to be removed= 32,473.17'  
 Total Impacted Area= 8.95 Acres  
 Total Cubic Yards= 43,297.56

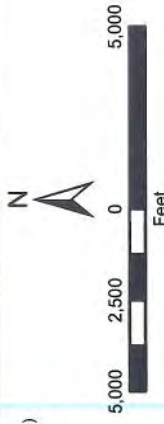

- Proposed 10" Pipeline to be abandoned in place (0.88 Miles)
- Proposed 10" Pipeline to be removed (6.15 Miles)
- Unproductive Oyster Seed Grounds



Note: The content of this drawing is designed specifically for the purpose of securing Federal, State and Local Environmental/Regulatory authorizations only.

**Chevron Pipe Line Company**  
**Proposed 10" Pipeline Abandonment**  
**Plaquemines Parish, Louisiana**

Map Date: 05/14/2013  
 Map Projection NAD83 Louisiana State Plane South:  
 Page Size - 8.5" x 11"  
 Service Layer Credits:  
 Copyright: ©2012 Esri, DeLorme, NAVTEQ

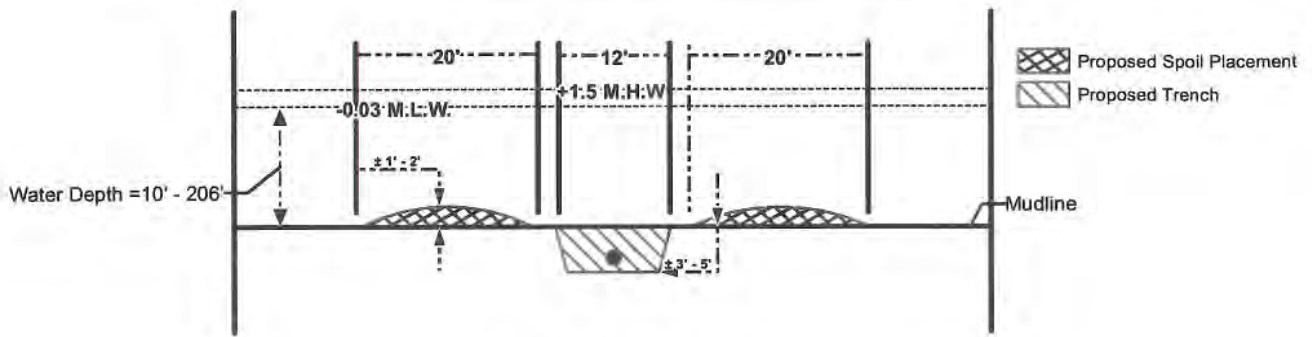

### Typical Hand Jet

Not to Scale

#### Notes:

I. As-built drawings and/or plats shall have written on them the date of completion of said activities and shall be submitted to the Louisiana Department of Natural Resources, Office of Coastal Management, P. O. Box 44487, Baton Rouge, LA 70804-4487 within 30 days following project completion.

II. All structures, facilities, well and pipelines/flowlines occurring in open water areas or in oilfield canals or slips shall be removed within 120 days of abandonment or the facilities for the herein permitted use unless prior written approval to leave such structures in place is received from the Office of Coastal Management. This condition does not preclude the necessity for revising the current permit or obtaining a separate Coastal Use Permit, should one be required.

III. In order to ensure the safety of all parties, the permittee shall contact the Louisiana One Call System (1-800-272-3020) a minimum of 48 hours prior to the commencement of any excavation (digging, dredging, jetting, etc.) or demolition activity.

IV. Applicant shall not discharge any drilling and /or workover affluent except for flocculated filtered water.

V. Applicant shall not discharge any human waste which does not meet or exceed the requirement of the Department of Health and Hospitals.

VI. Applicant shall not discharge any produced water.

VII. Applicant is subject to all applicable state laws related to damages which are demonstrated to have been caused by this proposed action.

VIII. Applicant shall obtain a special use permit for that portion of the project located within the boundaries of Pass A Loutre Wildlife Management Area.

IX. Where the pipeline is found to be covered by 10-feet or greater cover or the pipeline is covered by multiple closely spaced foreign pipelines, those segments of the pipeline shall be abandoned in place, segment locations recorded, and a liability retention agreement shall be executed with LADNR.

#### X. Equipment List

Spud Barge, 140' Boom Crane & Crew Quarters - 120' X 50' X 8' - 2.5' - 4' Draft

Tug - 60' X 23' X 7.2' - 5.0' - 7.2 Draft

Crewboat with 2 outboard motors- 22' X 10' x 2' - 4' Draft



**Chevron Pipe Line Company  
Proposed 10" Pipeline Abandonment  
Plaquemines Parish, Louisiana**

EXHIBIT A  
PLAQUEMINES PARISH, LOUISIANA

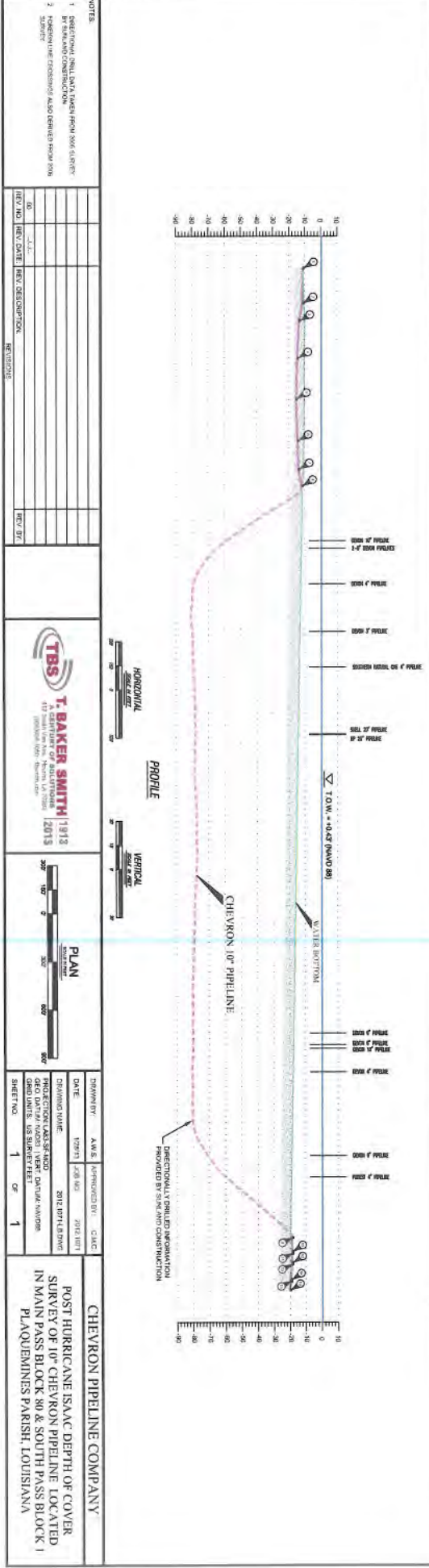
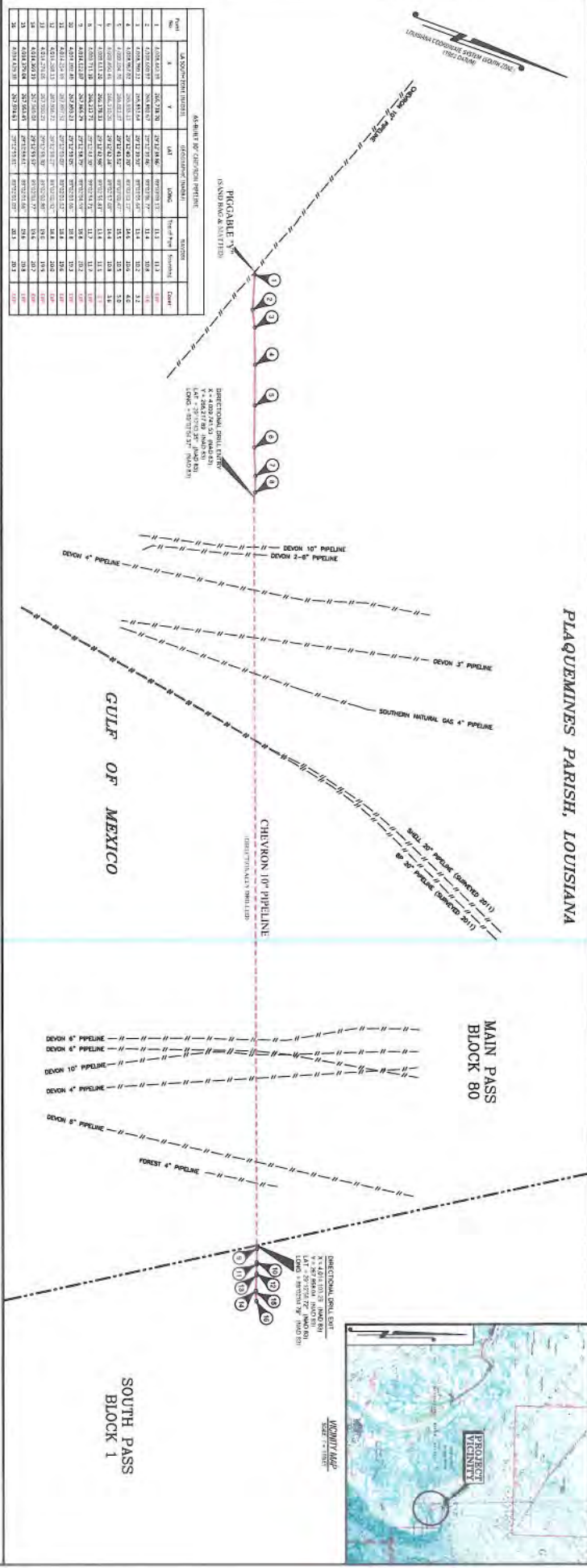

**TBS T. BAKER SMITH 1912**  
417 South Union Ave., Metairie, LA 70002  
PH: 504-885-1100 FAX: 504-885-1101  
WWW.TBSURVEYING.COM

**PLAN**  
200' 100' 0' 100' 200'

DRAWN BY: AMS  
DATE: 12/21/12  
PROJECT: CHEVRON 10" PIPELINE  
SHEET NO. 1 OF 1

**CHEVRON PIPELINE COMPANY**  
POST HIRRICANE ISAAC DEPTH OF COVER SURVEY OF 10" CHEVRON PIPELINE LOCATED IN MAIN PASS BLOCK 80 & SOUTH PASS BLOCK 1 PLAQUEMINES PARISH, LOUISIANA