

JOINT PUBLIC NOTICE

12 March 2018

United States Army
Corps of Engineers
New Orleans District
Regulatory Branch
7400 Leake Avenue
New Orleans, Louisiana 70118

(504) 862-2045
jennifer.e.burkett@usace.army.mil
Project Manager
Jennifer Burkett
Permit Application Number
MVN 2012-0371 EBB

State of Louisiana
Department of Environmental Quality
ATTN: Water Quality Certifications
Post Office Box 4313
Baton Rouge, Louisiana 70821-4313

(225) 219-3225
Project Manager
Elizabeth Hill
WQC Application Number
WQC 170713-04

Interested parties are hereby notified that a permit application has been received by the New Orleans District of the U.S. Army Corps of Engineers pursuant to: [X] Section 10 of the Rivers and Harbors Act of March 3, 1899 (30 Stat. 1151; 33 USC 403); and/or [X] Section 404 of the Clean Water Act (86 Stat. 816; 33 USC 1344).

Application has also been made to the Louisiana Department of Environmental Quality for a Water Quality Certification (WQC) in accordance with statutory authority contained in LRS30:2047 A(3), and provisions of Section 401 of the Clean Water Act (P.L.95-17).

STORM WATER TREATMENT SYSTEM ON LAKE PONTCHARTRAIN IN SAINT TAMMANY PARISH

NAME OF APPLICANT: City of Mandeville c/o Principal Engineering, Inc. at 1011 North Causeway Boulevard, Suite 19, Mandeville, Louisiana 70471.

LOCATION OF WORK: On Lake Pontchartrain, east of Sunset Point Park, on Massena Street, Mandeville, in Saint Tammany Parish, Louisiana, as shown on the attached drawings.
Hydrologic Unit Code: 08090202 - Lake Pontchartrain
Latitude: 30.36110, Longitude: -90.08419

CHARACTER OF WORK: Dredge, fill, and grade to construct a marsh habitat within a proposed storm water retention and treatment system. Upon completion of construction, the designed storm water retention/treatment system would receive storm water runoff from the City of Mandeville via the Galvez and Massena outfalls and attenuate the runoff to remove/reduce sediments and other pollutants prior to discharging into Lake Pontchartrain. The proposal consists of two redesigned outfalls discharging from an existing forested wetland area into the impoundment, a berm to attenuate the runoff for treatment, a weir for controlled release into the lake, a pedestrian-bicycle path over the berm, constructed marsh platforms, an intertidal lagoon, an outfall channel to the weir, and shoreline erosion protection features. The applicant proposes to dredge 9,930 cubic yards of material from 2.87 acres of non-vegetated tidal bottoms, to create a temporary five foot deep access channel and work area for deployment of work barges and other construction equipment to the construction site. The dredged materials would be side cast into 3.14 acres of non-vegetated tidal bottoms adjacent to the channel and placed back into the channel after completion of the project. The applicant also

proposes to dredge 8,560 cubic yards from 3.53 acres of non-vegetated tidal bottoms to construct the storm water retention impoundment, associated wetland terraces, and other associated impoundment structures. The project will also require installation of 1,300 square feet of steel sheet piling, 1,120 cubic yards of concrete, 3,860 cubic yards of bedding and armoring stone, and 260 cubic yards of riprap, and 10,120 cubic yards of other fill material to construct the impoundment berm and appurtenant structures. The completed impoundment structure would impact approximately 10.27 acres of non-vegetated tidal bottoms by conversion to marsh habitats, open water features, and permanent fill. This project was previously advertised under the same number on 18 February 2014. No permanent adverse impacts to special aquatic sites are proposed; no compensatory mitigation is anticipated at this time.

The comment period for the Department of the Army Permit and the Louisiana Department of Environmental Quality WQC will close **20 days** from the date of this joint public notice. Written comments, including suggestions for modifications or objections to the proposed work, stating reasons thereof, are being solicited from anyone having interest in this permit and/or this WQC request and must be mailed so as to be received before or by the last day of the comment period. Letters concerning the Corps of Engineers permit application must reference the applicant's name and the Permit Application Number, and be mailed to the Corps of Engineers at the address above, **ATTENTION: REGULATORY BRANCH**. Similar letters concerning the Water Quality Certification must reference the applicant's name and the WQC Application number and be mailed to the Louisiana Department of Environmental Quality at the address above. **Individuals or parties may request an extension of time in which to comment on the proposed work by writing or e-mailing the Corps of Engineers Project Manager listed above. Any request must be specific and substantively supportive of the requested extension, and received by this office prior to the end of the initial comment period. The Section Chief will review the request and the requestor will be promptly notified of the decision to grant or deny the request. If granted, the time extension will be continuous to the initial comment period and, inclusive of the initial comment period, will not exceed a total of 30 calendar days.**

The application for this proposed project is on file with the Louisiana Department of Environmental Quality and may be examined during weekdays between 8:00 a.m. and 4:30 p.m. Copies may be obtained upon payment of costs of reproduction.

Corps of Engineers Permit Criteria

The decision whether to issue a permit will be based on an evaluation of the probable impacts, including cumulative impacts of the proposed activity on the public interest. That decision will reflect the national concern for both protection and utilization of important resources. The benefit which reasonably may be expected to accrue from the proposal must be balanced against its reasonably foreseeable detriments. All factors which may be relevant to the proposal will be considered including the cumulative effects thereof; among those are conservation, economics, aesthetics, general environmental concerns, wetlands, historic properties, fish and wildlife values, flood hazards, floodplain values, land use, navigation, shoreline erosion and accretion, recreation, water supply and conservation, water quality, energy needs, safety, food and fiber production, mineral needs, considerations of property ownership and, in general, the needs and welfare of the people.

The U.S. Army Corps of Engineers is soliciting comments from the public, federal, state, and local agencies and officials, Indian Tribes, and other interested parties in order to consider and evaluate the impacts of this proposed activity. Any comments received will be considered by the U.S. Army Corps of Engineers to determine whether to make, modify, condition, or deny a permit for this proposal. To make this decision, comments are used to assess impacts on endangered species, historic properties, water quality, general environmental effects, and other public interest factors listed above. Comments are used in the preparation of an Environmental Assessment and/or an Environmental Impact Statement pursuant to the National Environmental Policy Act. Comments are also used to determine the need for a public hearing and to determine the overall public interest of the proposed activity.

The New Orleans District is unaware of properties listed on the National Register of Historic Places near the proposed work. The possibility exists that the proposed work may damage or destroy presently unknown archeological, scientific, prehistorical, historical sites, or data. Issuance of this public notice solicits input from the State Archeologist and State Historic Preservation Officer regarding potential impacts to cultural resources.

Based on the South Louisiana Standard Local Operating Procedure for Endangered Species (SLOPES), as signed on October 22, 2014, between the U.S. Army Corps of Engineers, New Orleans and the U.S. Fish and Wildlife Service, it has been determined that the proposed activity is “not likely to adversely affect” the West Indian manatee (*Trichechus manatus*). If this permit is issued, the permittee will be required to follow the “Standard Manatee Conditions for In-Water Activities”.

The project site is located in an area designated as “critical habitat”, by the National Marine Fisheries Service (NMFS) for the Gulf sturgeon (*Acipenser oxyrinchus desotoi*). The project will result in temporary adverse impacts to approximately 6.01 acres of the sturgeon’s habitat for the access channel and work area and 9.07 acres for outfall channels and marsh creation. The construction of the berm and erosion control features will permanently impact approximately 1.2 acres of sturgeon habitat. No hopper dredging is proposed and the temporary impacts for the access channel and work area will cease and be remediated upon completion of construction. The Corps’ preliminary determination under Section 7 of the Endangered Species Act (ESA) is that the project’s effects are insignificant and are “Not Likely to Adversely Affect” the Gulf sturgeon nor its critical habitat. The Corps is unaware of any other ESA listed species or of any other ESA designated critical habitat that may be affected by this project.

This notice initiates the Essential Fish Habitat (EFH) consultation requirements of the Magnuson-Stevens Fishery Conservation and Management Act. The applicant’s proposal would result in the destruction or alteration of **12.94** acres of **EFH** utilized by various life stages of red drum and penaeid shrimp. Our initial determination is that the proposed action would not have a substantial adverse impact on EFH or federally managed fisheries in the Gulf of Mexico. Our final determination relative to project impacts and the need for mitigation measures is subject to review by and coordination with the NMFS.

If the proposed work involves deposits of dredged or fill material into navigable waters, the evaluation of the probable impacts will include the application of guidelines established by the Administrator of the Environmental Protection Agency. Also, a certification that the proposed activity will not violate applicable water quality standards will be required from the Department of Environmental Quality before a permit is issued.

The applicant has certified that the proposed activity described in the application complies with and will be conducted in a manner that is consistent with the Louisiana Coastal Resources Program. The Department of the Army permit will not be issued unless the applicant received approval or a waiver of the Coastal Use Permit by the Department of Natural Resources.

Any person may request, in writing, within the comment period specified in this notice, that a public hearing be held to consider this application. Requests for public hearings shall state, with particularity, the reasons for holding a public hearing.

You are requested to communicate the information contained in this notice to any other parties whom you deem likely to have interest in the matter.

Enclosures

Michael V. Farabee
Chief, Eastern Evaluation Section

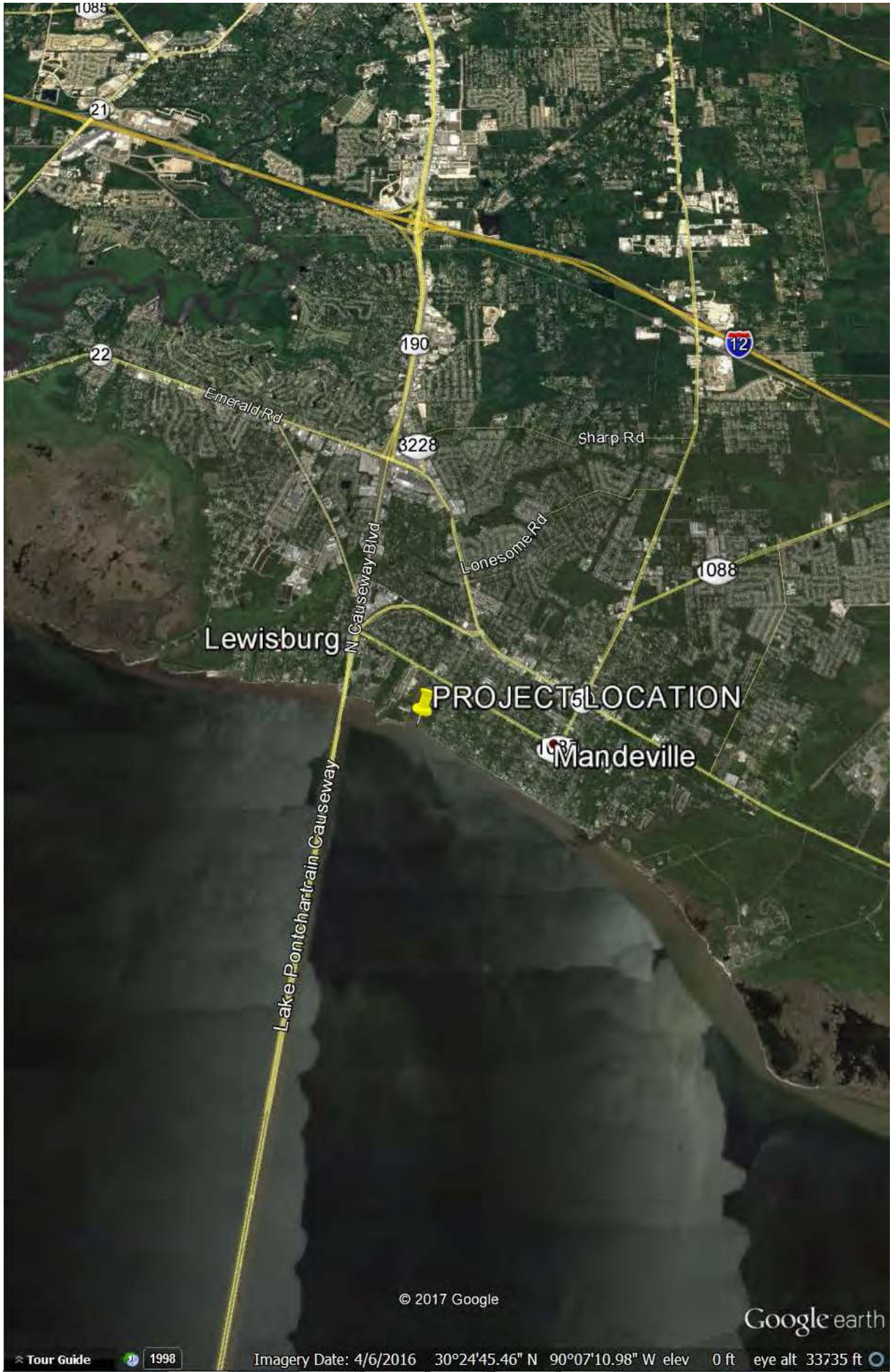

© 2017 Google

Google earth

Tour Guide 1998

Imagery Date: 4/6/2016 30°24'45.46" N 90°07'10.98" W elev 0 ft eye alt 33735 ft

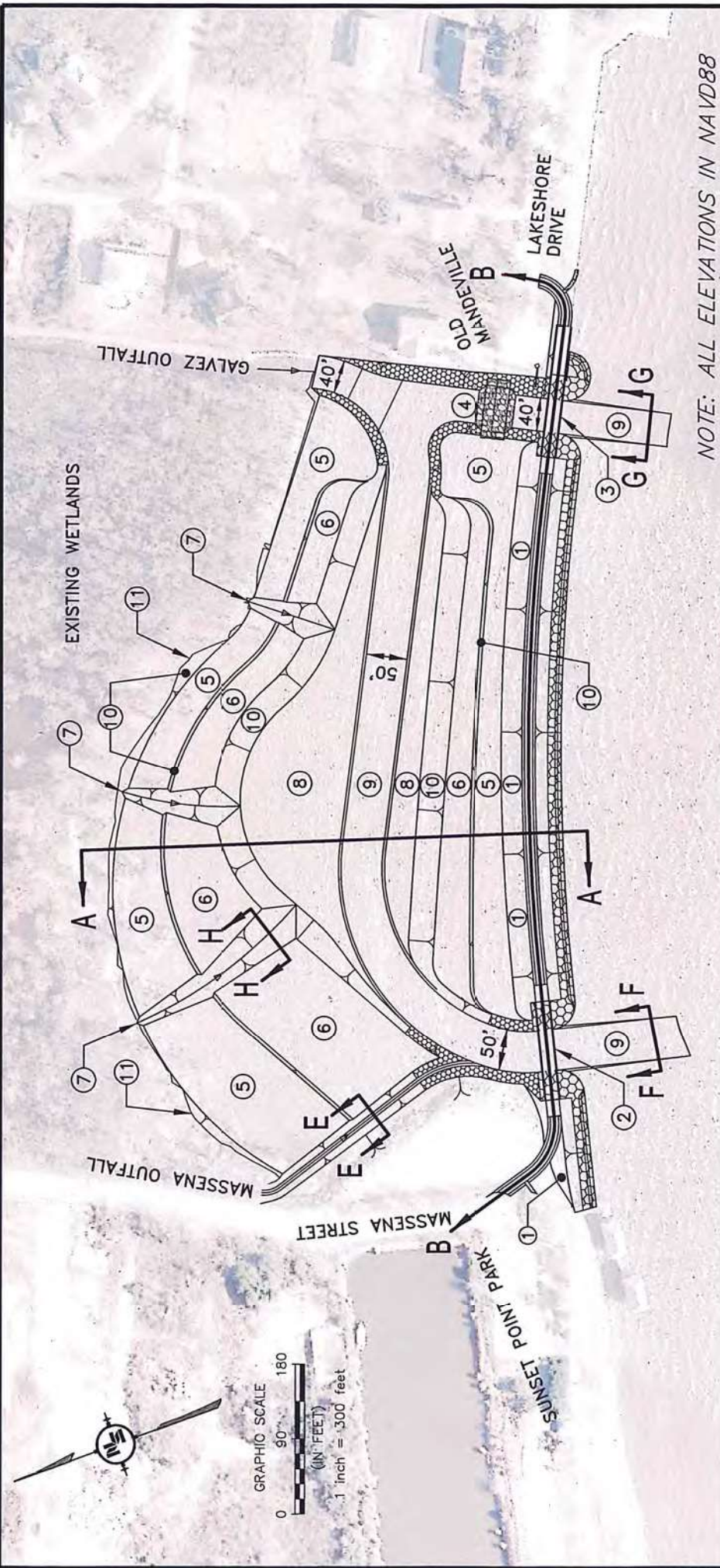

NOTE: ALL ELEVATIONS IN NAVD88

NOTE:

MHHW = +1.02
 MSL = +0.77
 MLLW = +0.52

MEASURED AT NEW
 ORLEANS NEW
 CANAL STATION

PROPOSED IMPROVEMENTS

- ① CLOSURE BERM (SEE SECTION C)
 - ② 120' SPAN BRIDGE (SEE SECTION D)
 - ③ 100' SPAN BRIDGE (SEE SECTION D)
 - ④ DIVERSION WEIR
 - ⑤ WETLAND AT ELEVATION +1.5, PLANTED WITH MARSHYAY CORDGRASS.
 - ⑥ WETLAND AT ELEVATION +1.1; PLANTED WITH SMOOTH CORDGRASS.
 - ⑦ OUTFALL FROM EXISTING WETLANDS TO INTERTIDAL LAGOON AT 1 TO 10 SLOPE, PLANTED WITH CALIFORNIA BULLWHIP.
 - ⑧ INTERTIDAL LAGOON AT ELEVATION -2.0, PLANTED WITH SMOOTH CORDGRASS.
 - ⑨ OUTFALL CHANNEL AT ELEVATION -3.0
 - ⑩ SURFACES IN TRANSITION AT 1 TO 10 SLOPE, PLANTED WITH SMOOTH CORDGRASS.
 - ⑪ APPROX. INTERFACE LOCATION BETWEEN EXISTING & NEW SHORELINE CONSTRUCTION
- AREAS OF SHORELINE EROSION PROTECTION, METHOD TO BE DETERMINED

DATE: MAY 15, 2012
 REV. DATE: MAY 13, 2013



Mandeville Lakefront Wetlands Restoration

Planned Improvements

Sheet 2 of 13

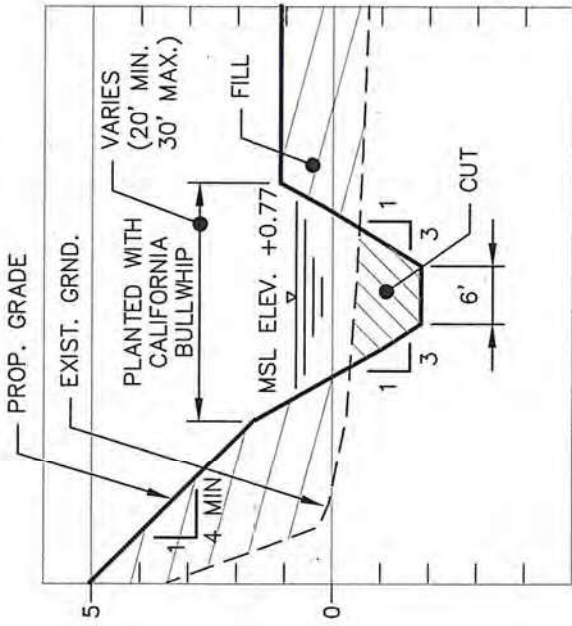

SECTION E-E

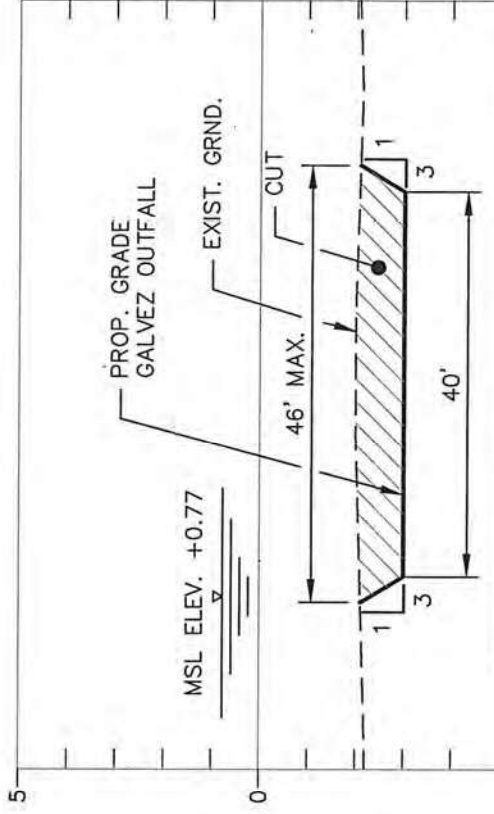

SECTION G-G

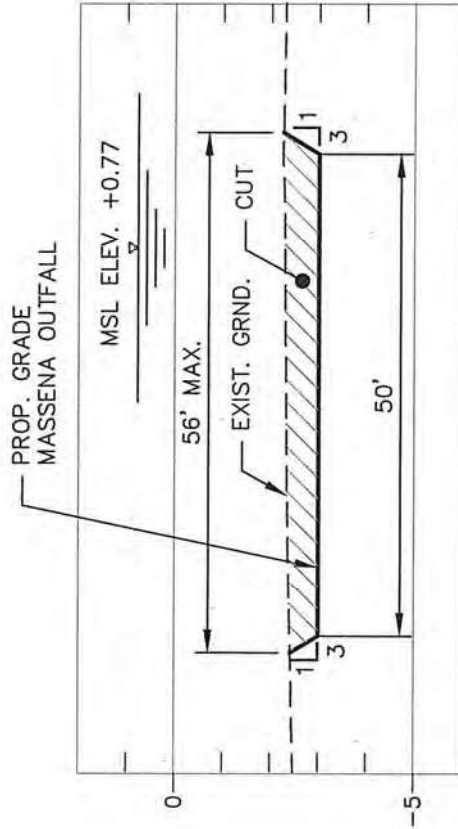

SECTION F-F

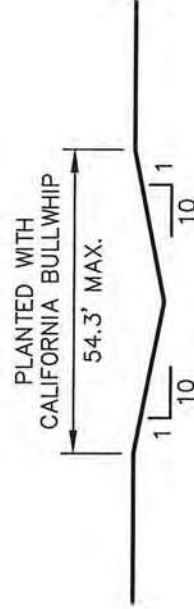

SECTION H-H

NOTE: ALL ELEVATIONS IN NAVD88

NOTE:

MHHW = +1.02
MSL = +0.77
MLLW = +0.52

MEASURED AT NEW ORLEANS NEW CANAL STATION

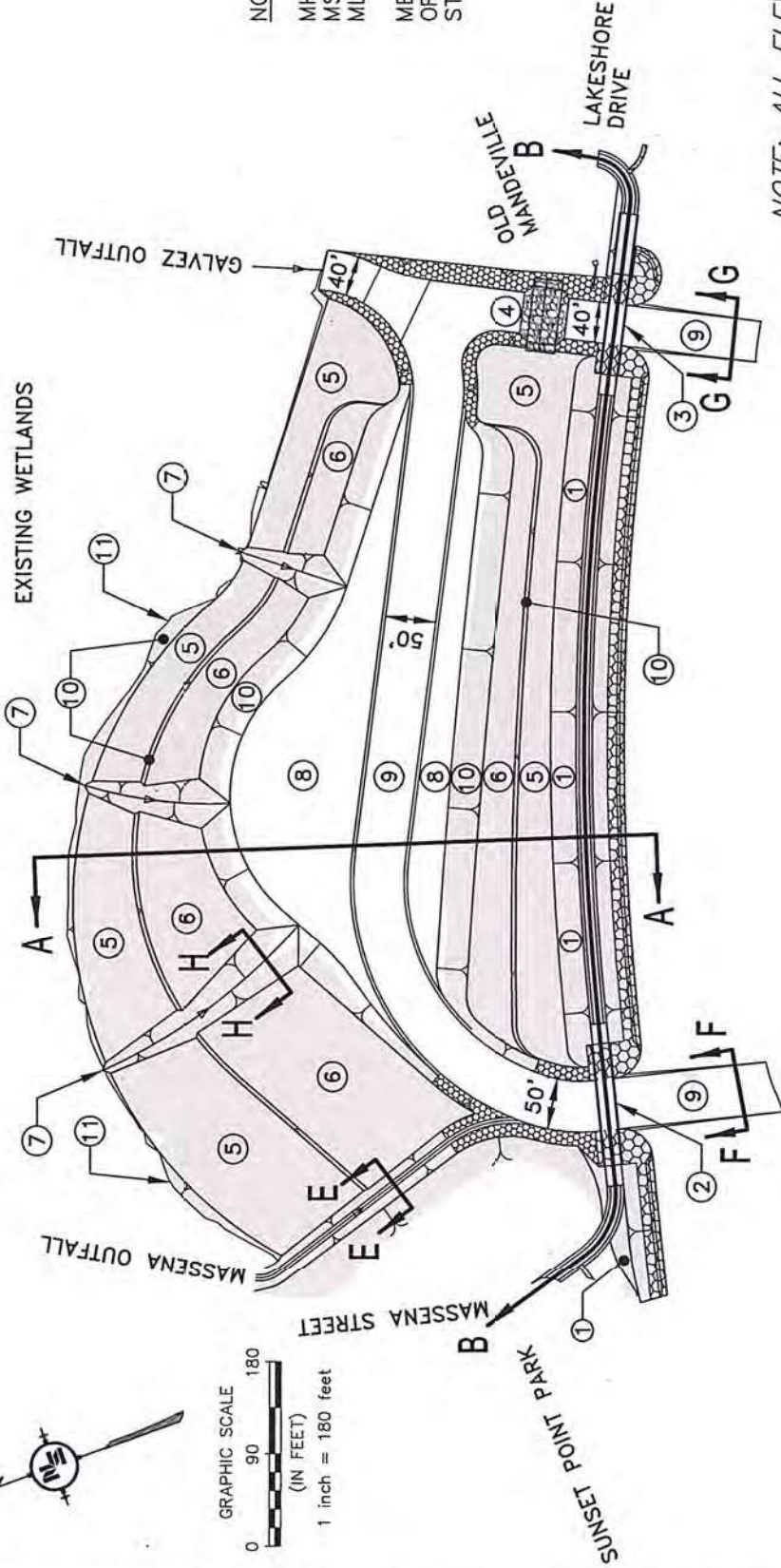
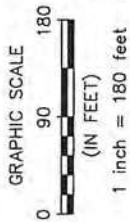
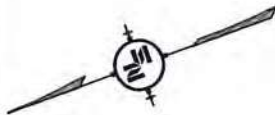

NOTE:

MHHW = +1.02
 MSL = +0.77
 MLLW = +0.52

MEASURED AT NEW
 ORLEANS NEW CANAL
 STATION

NOTE: ALL ELEVATIONS IN NAVD88

PROPOSED IMPROVEMENTS

- ① CLOSURE BERM (SEE SECTION C)
 - ② 120' SPAN BRIDGE (SEE SECTION D)
 - ③ 100' SPAN BRIDGE (SEE SECTION D)
 - ④ DIVERSION WEIR
 - ⑤ WETLAND AT ELEVATION +1.5, PLANTED WITH MARSHAY CORDGRASS.
 - ⑥ WETLAND AT ELEVATION +1.1, PLANTED WITH SMOOTH CORDGRASS.
 - ⑦ OUTFALL FROM EXISTING WETLANDS TO INTERTIDAL LAGOON AT 1 TO 10 SLOPE, PLANTED WITH CALIFORNIA BULLWHIP.
 - ⑧ INTERTIDAL LAGOON AT ELEVATION -2.0, PLANTED WITH SMOOTH CORDGRASS.
 - ⑨ OUTFALL CHANNEL AT ELEVATION -3.0'
 - ⑩ SURFACES IN TRANSITION AT 1 TO 10 SLOPE, PLANTED WITH SMOOTH CORDGRASS.
 - ⑪ APPROX. INTERFACE LOCATION BETWEEN EXISTING & NEW SHORELINE CONSTRUCTION
- AREAS OF SHORELINE EROSION PROTECTION, METHOD TO BE DETERMINED
- FILL PLACEMENT

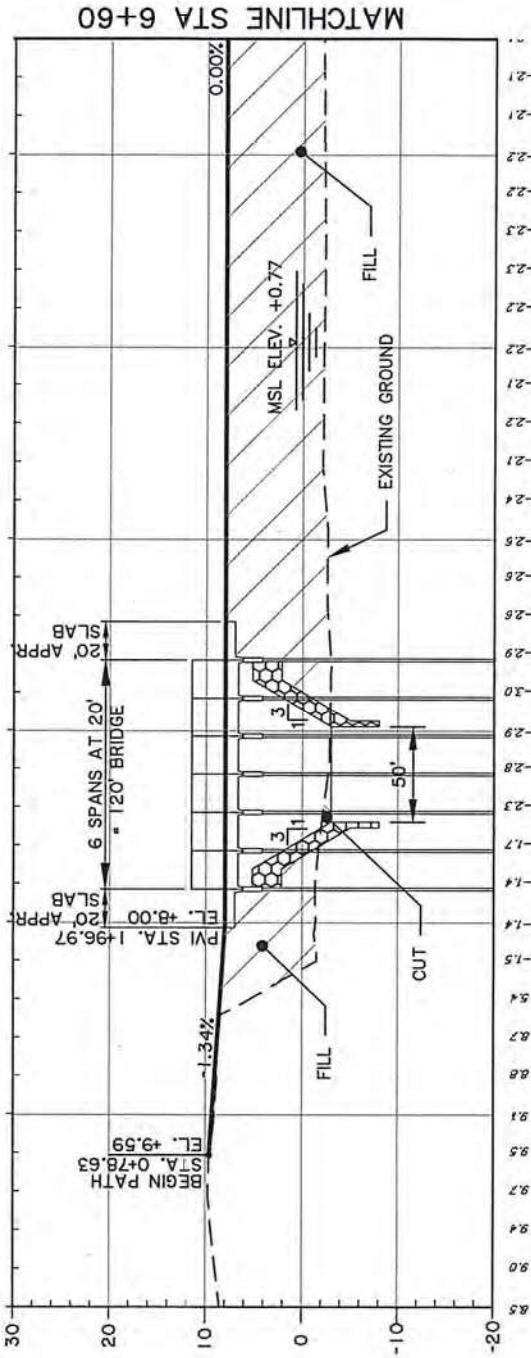

NOTE: ALL ELEVATIONS IN NAVD88

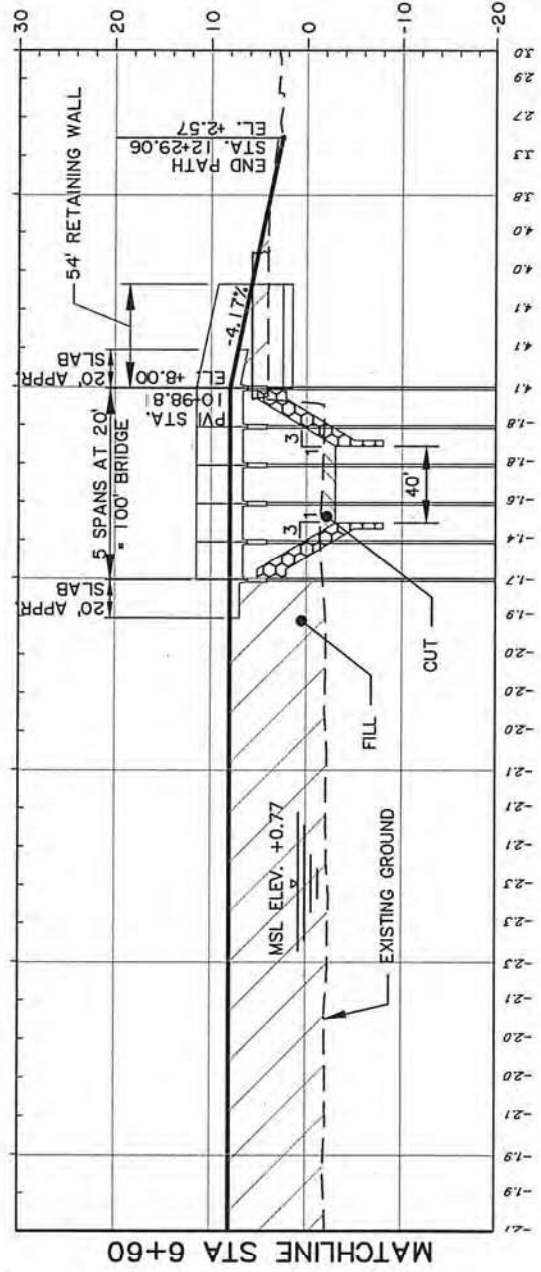

NOTE:

MHHW = +1.02
MSL = +0.77
MLLW = +0.52

MEASURED AT NEW
ORLEANS NEW CANAL
STATION

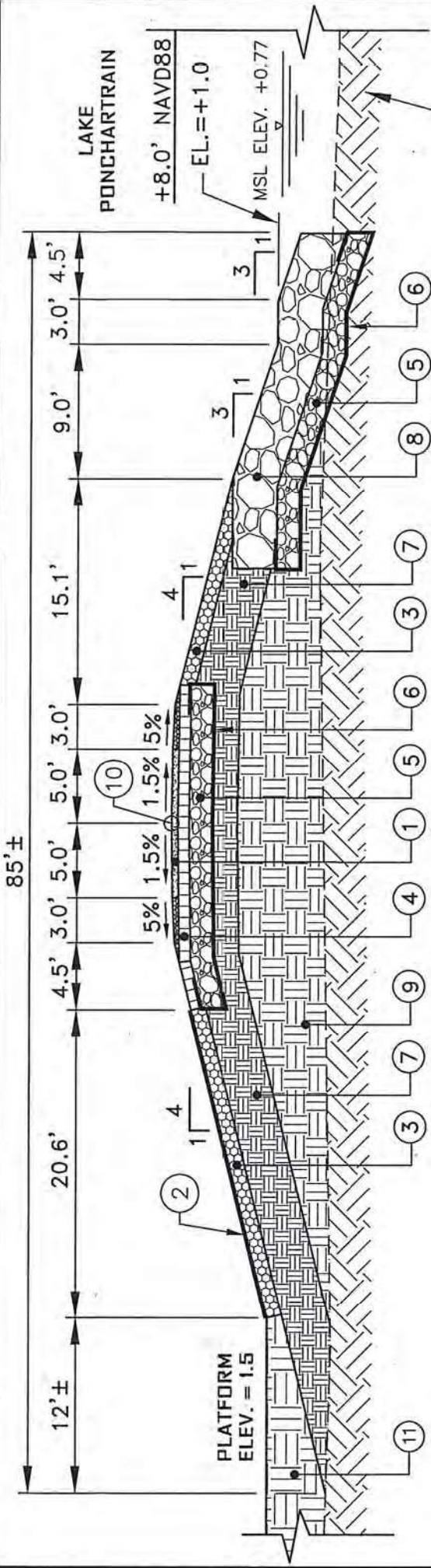

TYPICAL BERM SECTION C

SCALE: 1"=10'

NOTE: ALL ELEVATIONS IN NAVD88

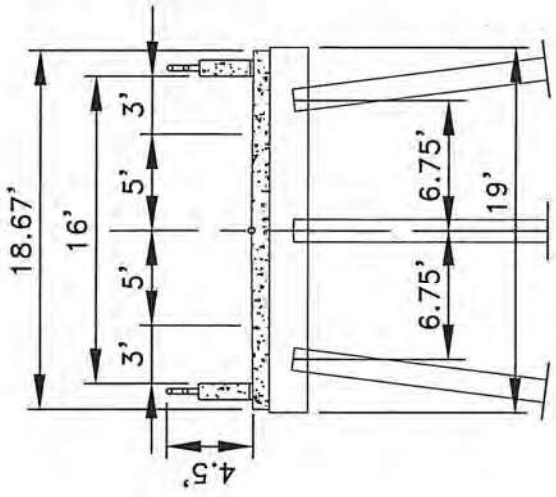

TYPICAL BRIDGE SECTION D

SCALE: 1"=10'

KEY

- ① 5" THICK CONCRETE WALKWAY
- ② OPEN MAT
- ③ 12" THICK CLAY/ SAND MIXTURE
- ④ 9" THICK ARTICULATED CONCRETE BLOCK MAT
- ⑤ 18" THICK BEDDING STONE
- ⑥ GEOTEXTILE
- ⑦ 3" THICK EROSION RESISTANT CLAY
- ⑧ 3" THICK ARMOR STONE
- ⑨ STRUCTURAL FILL MATERIAL
- ⑩ PROFILE GRADE ELEV. +8.0
- ⑪ FILL MATERIAL

NOTE:
 MHHW = +1.02
 MSL = +0.77
 MLLW = +0.52
 MEASURED AT NEW ORLEANS NEW CANAL STATION



CONSTRUCTION
STAGING SITE
2.10 Acres

STREET

MASSENA OUTFALL

MASSENA

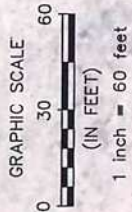

	<p>DATE: MAY 15, 2012 REV. DATE: JULY 24, 2013</p>	<p>Mandeville Lakefront Wetlands Restoration</p>	<p>Construction Staging</p>	<p>Sheet 9 of 13</p>
--	--	--	-----------------------------	--------------------------

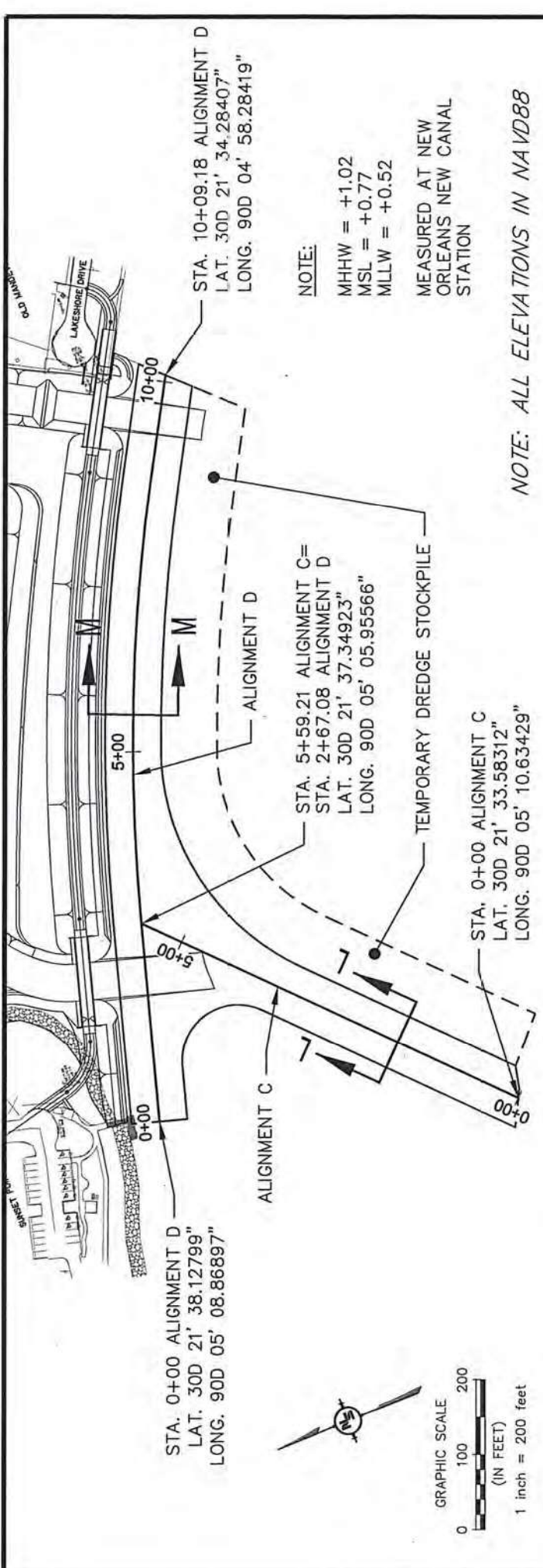

NOTE:
 MHHW = +1.02
 MSL = +0.77
 MLLW = +0.52
 MEASURED AT NEW
 ORLEANS NEW CANAL
 STATION

NOTE: ALL ELEVATIONS IN NAVD88

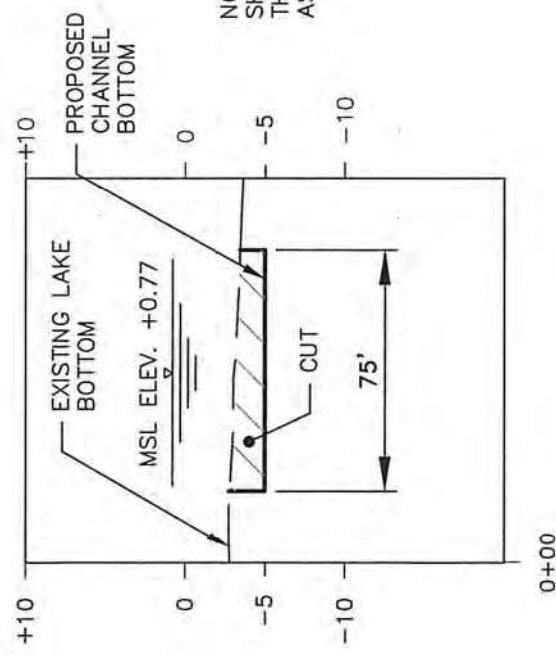
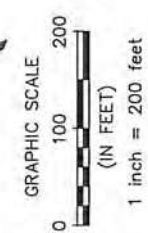

NOTE: VESSEL DRAFTS SHALL BE LIMITED TO THE CHANNEL DEPTHS AS SHOWN.

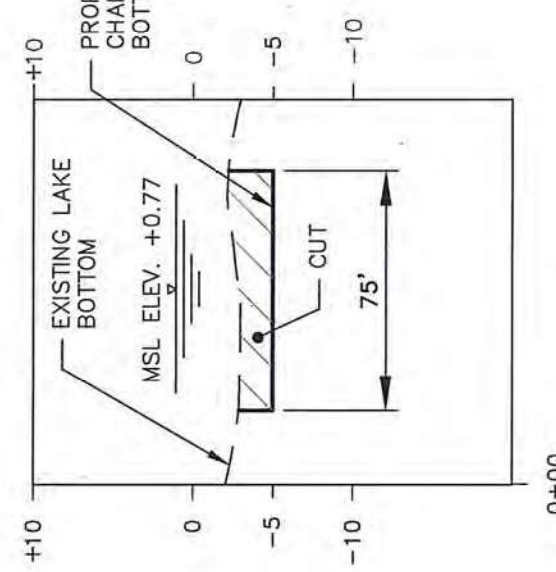

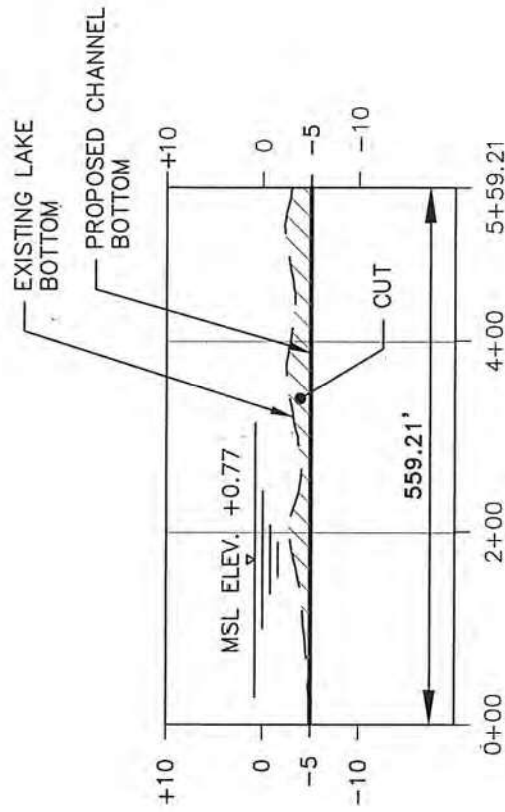

NOTE:

MHHW = +1.02
 MSL = +0.77
 MLLW = +0.52

MEASURED AT NEW
 ORLEANS NEW CANAL
 STATION

ALIGNMENT C
 N.T.S.

NOTE: ALL ELEVATIONS IN NAVD88

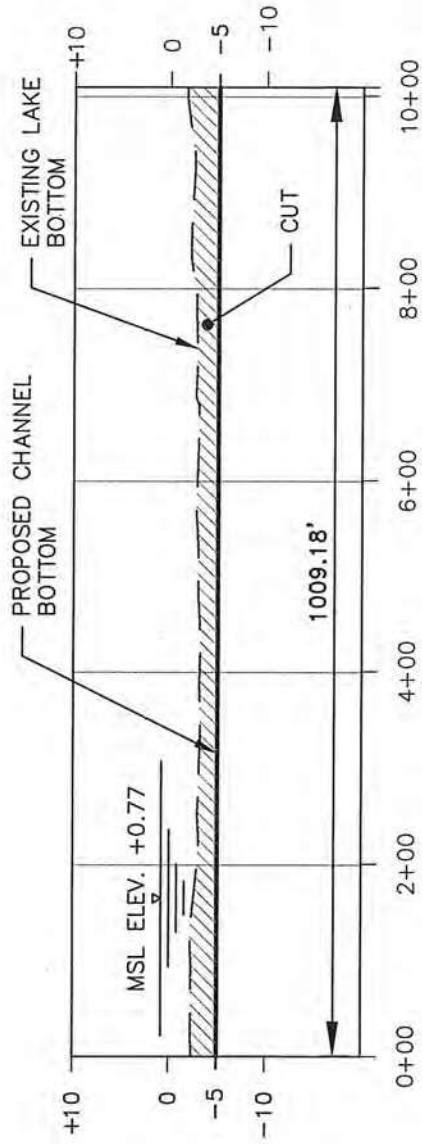

ALIGNMENT D
 N.T.S.

DATE:
 MAY 15, 2012
 REV. DATE:
 MAY 13, 2013

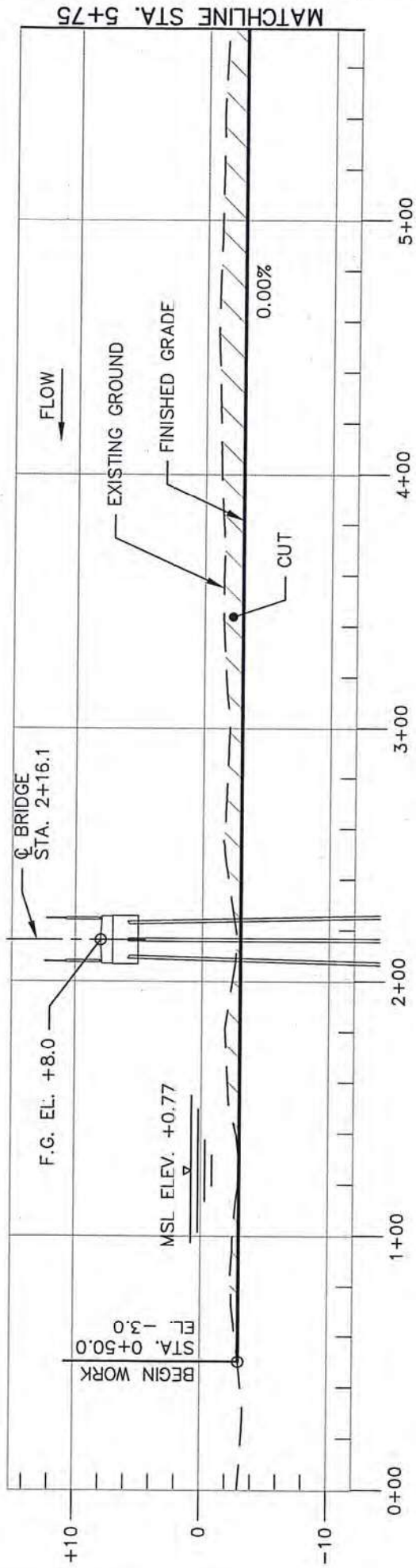

NOTE: ALL ELEVATIONS IN NAVD88

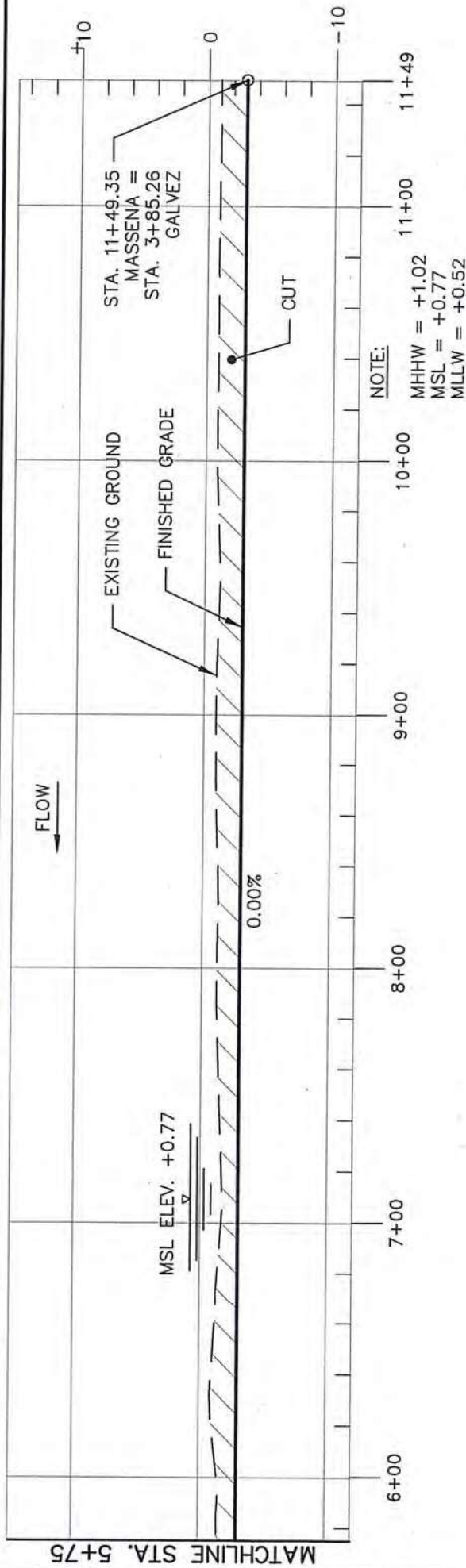

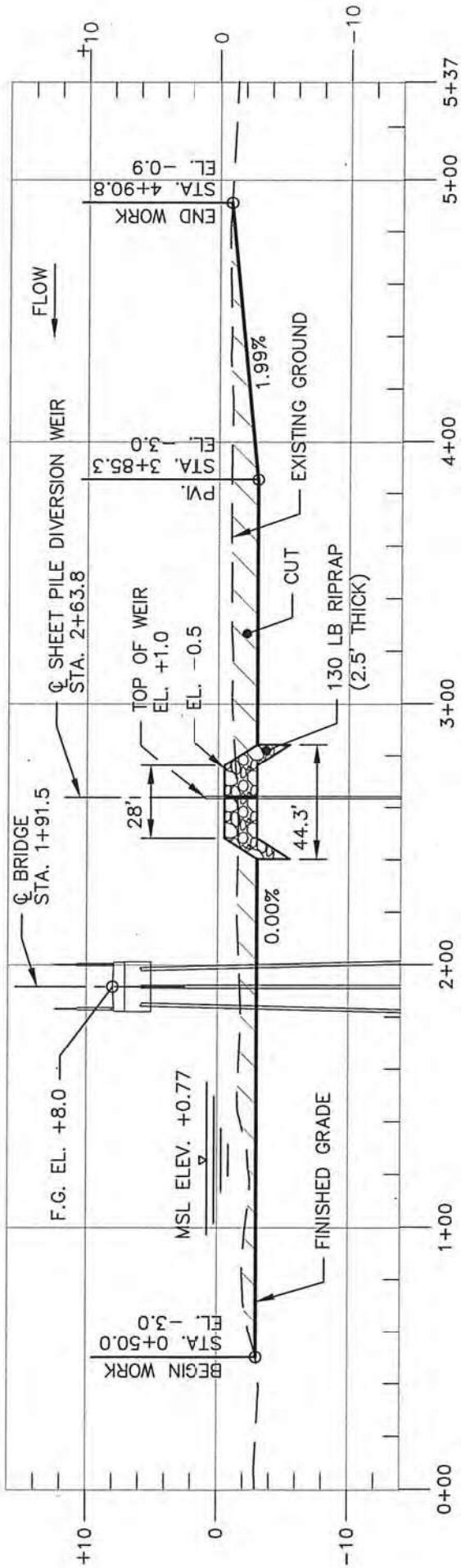

NOTE: ALL ELEVATIONS IN NAVD88

NOTE:

MHHW = +1.02
 MSL = +0.77
 MLLW = +0.52

MEASURED AT NEW
 ORLEANS NEW CANAL
 STATION