



DEPARTMENT OF THE ARMY
CORPS OF ENGINEERS, NEW ORLEANS DISTRICT
7400 LEAKE AVENUE
NEW ORLEANS, LOUISIANA 70118

February 26, 2018

REPLY TO
ATTENTION OF:

Operations Division
Western Evaluation Section
Project Manager
Darlene Herman
(504) 862-2287
Darlene.C.Herman@usace.army.mil

SUBJECT: MVN 2011-2114 WB

PUBLIC NOTICE

Interested parties are hereby notified that an application has been received by the District engineer for a Department of the Army permit to authorize the following pursuant to (X) Section 10 of the Rivers and Harbors Act of March 3, 1899 (30 Stat. 1151; 33 USC 403); and/or () Section 404 of the Clean Water Act (86 Stat. 816; 33 USC 1344).

ARTIFICIAL REEF IN THE GULF OF MEXICO

NAME OF APPLICANT: Louisiana Department of Wildlife and Fisheries, Artificial Reef Program, Post Office Box 98000, Baton Rouge, Louisiana 70808.

LOCATION OF WORK: In the Gulf of Mexico, West Cameron 587, located off the coast of Cameron Parish, Louisiana, as shown on the attached drawings.

CHARACTER OF WORK: Deploy Arena Offshore, West Cameron 564-CA jacket in the West Cameron 587 artificial reef site to provide structural habitat for the purpose of enhancing fishing opportunities in the Gulf of Mexico. Clearance from the top of the deployed platform jackets to the water surface will be approximately 157 feet. This request is pursuant to Act 100, 1986 Louisiana Legislature and the National Fishing Enhancement Act of 1984.

The comment period for the Department of the Army Permit will close **15 days** from the date of this joint public notice. Written comments, including suggestions for modifications or objections to the proposed work, stating reasons thereof, are being solicited from anyone having interest in this permit and must be submitted so as to be received before or by the last day of the comment period. Letters concerning the Corps of Engineers permit application must reference the applicant's name and the Permit Application Number, and be forwarded to the Corps of Engineers at the address above,

ATTENTION: REGULATORY BRANCH.

The decision whether to issue a permit will be based on an evaluation of the probable impact including cumulative impacts of the proposed activity on the public interest. That decision will reflect the national concern for both protection and utilization of important resources. The benefit which reasonably may be expected to accrue from the proposal must be balanced against its reasonably foreseeable detriments. All factors which may be relevant to the proposal will be considered including the cumulative effects thereof; among those are conservation, economics, aesthetics, general environmental concerns, wetlands, historic properties, fish and wildlife values, flood hazards, floodplain values, land use, navigation, shoreline erosion and accretion, recreation, water supply and conservation, water quality, energy needs, safety, food and fiber production, mineral needs, consideration of property ownership and, in general, the needs and welfare of the people.

The Corps of Engineers is soliciting comments from the public; federal, state, and local agencies and officials; Indian Tribes; and other interested parties in order to consider and evaluate the impacts of this proposed activity. Any comments received will be considered by the Corps of Engineers to determine whether to issue, modify, condition or deny a permit for this proposal. To make this decision, comments are used to assess impacts on endangered species, historic properties, water quality, general environmental effects, and the other public interest factors listed above. Comments are used in the preparation of an Environmental Assessment and/or Environmental Impact Statement pursuant to the National Environmental Policy Act. Comments are also used to determine the need for a public hearing and to determine the overall public interest of the proposed activity.

The New Orleans District is unaware of properties listed on the National Register of Historic Places near the proposed work. The possibility exists that the proposed work may damage or destroy presently unknown archeological, scientific, prehistorical, historical sites, or data. Copies of this notice is being forwarded to the State Archeologist and State Historic Preservation Officer regarding potential impacts to cultural resources.

Our initial finding is that the proposed work would neither affect any species listed as endangered by the U.S. Department of Interior nor affect any habitat designated as critical to the survival and recovery of any endangered species.

This notice initiates the Essential Fish Habitat (EFH) consultation requirements of the Magnus-Stevens Fishery Conservation and Management Act. The applicant's proposal would result in the destruction or alteration of 0 acre(s) of EFH utilized by various life stages of red drum and penaeid shrimp. Our initial determination is that the proposed action would not have a substantial adverse impact on EFH or federally managed fisheries in the Gulf of Mexico. Our final determination relative to project impacts and the need for mitigation measures is subject to review by and coordination with the National Marine Fisheries Service.

If the proposed work involves deposits of dredged or fill material into navigable waters, the evaluation of the probable impacts will include the application of guidelines established by the Administrator of the Environmental Protection Agency and certification that the proposed activity will not violate applicable water quality standards will be required from the Louisiana Department of Environmental Quality, Water Quality Certifications Section, before a permit is issued.

Any person may request, in writing, within the comment period specified in this notice, that a public hearing be held to consider this application. Requests for public hearings shall state, with particularity, the reasons for holding a public hearing.

You are requested to communicate the information contained in this notice to any other parties whom you deem likely to have interest in the matter.



Darrell S. Barbara
Chief, Western Evaluation Section
Regulatory Branch

Attachments

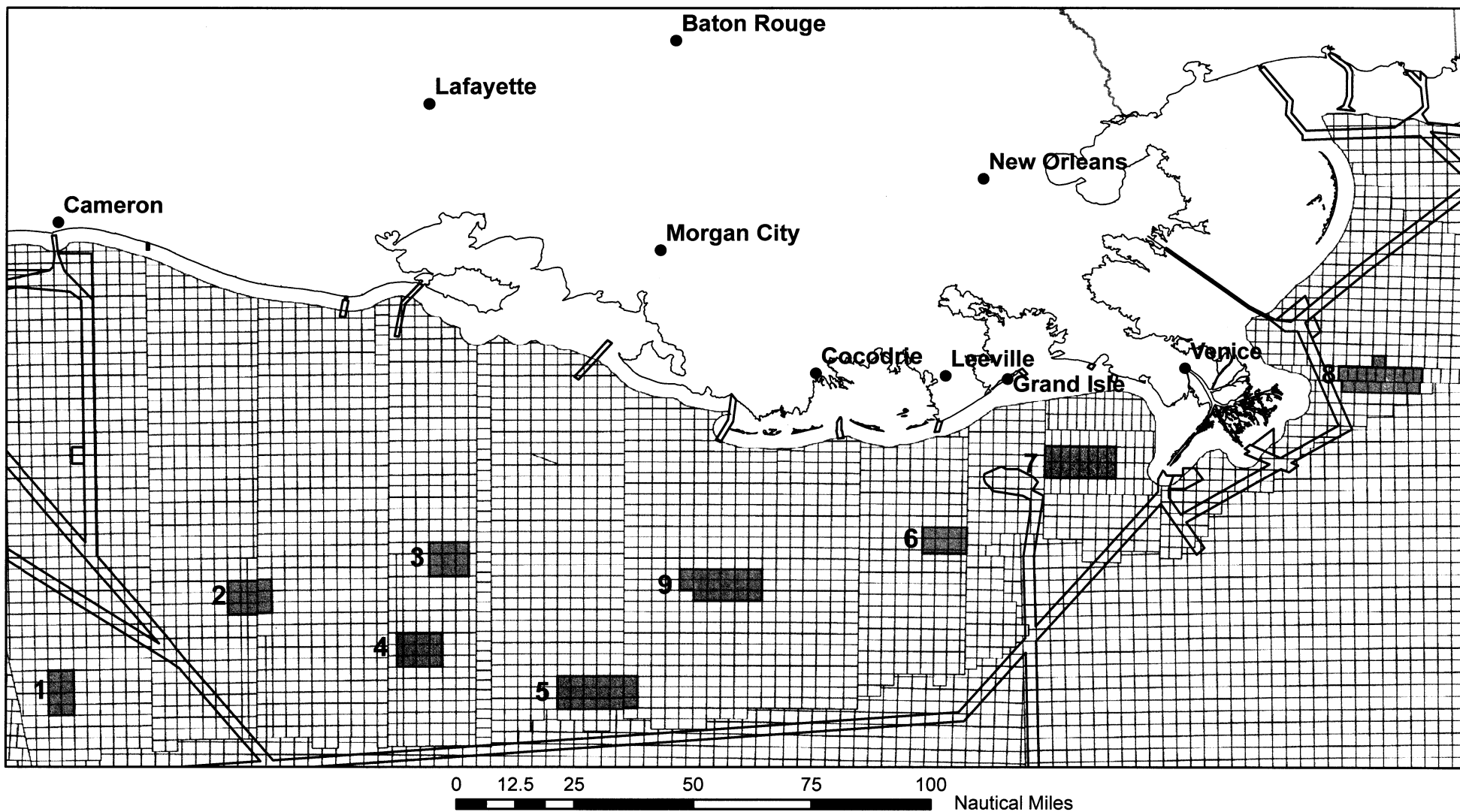
Louisiana Artificial Reef Planning Areas



Planning Areas

-  Planning Areas
-  Fairways
-  OCS Blocks

- | | |
|---|----------------------------------|
| 1. West Cameron Planning Area | 6. South Timbalier Planning Area |
| 2. East Cameron Planning Area | 7. West Delta Planning Area |
| 3. South Marsh Island (76) Planning Area | 8. Main Pass Planning Area |
| 4. South Marsh Island (146) Planning Area | 9. Ship Shoal Planning Area |
| 5. Eugene Island Planning Area | |

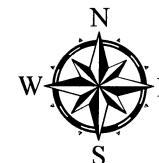

Louisiana Artificial Reef Program



-  Planning Area
-  Permitted Reef Sites
-  Fairways
-  OCS Blocks

0 5 10 20 Nautical Miles

Proposed WC-587 Reef Vicinity Map

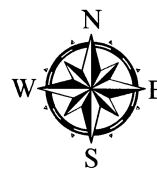

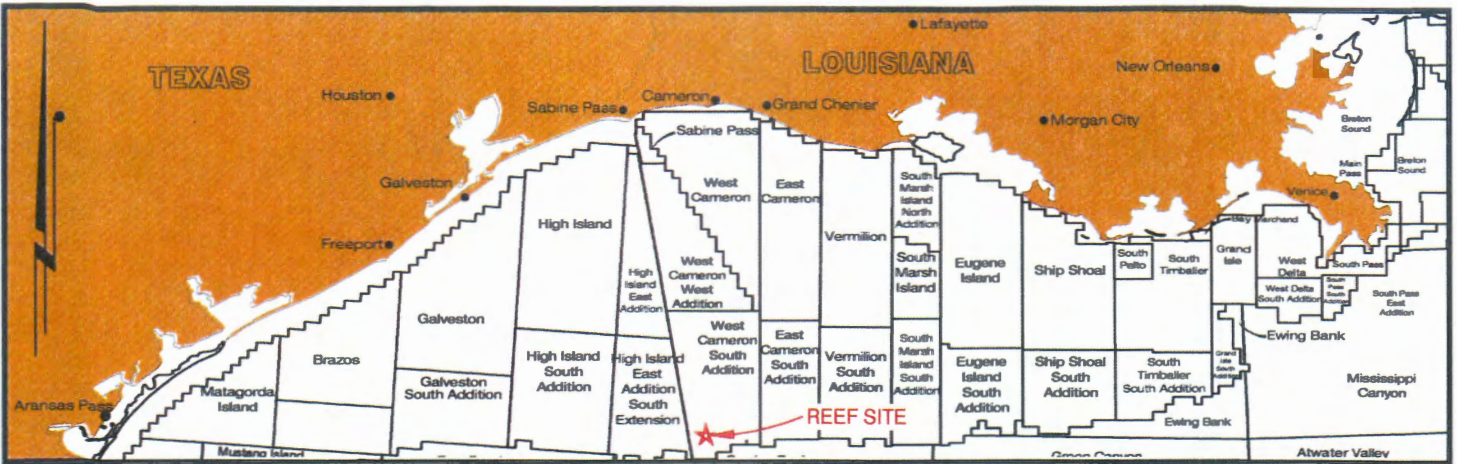

TIE	REEF BOUNDARY COORDINATES NAD27			
	X	Y	LATITUDE	LONGITUDE
1	1,347,177.57	-177,549.38	28° 09' 45.467"N	93° 21' 30.652"W
2	1,351,177.57	-177,549.38	28° 09' 46.164"N	93° 20' 45.990"W
3	1,351,177.57	-181,549.38	28° 09' 06.581"N	93° 20' 45.206"W
4	1,347,177.57	-181,549.38	28° 09' 05.884"N	93° 21' 29.863"W

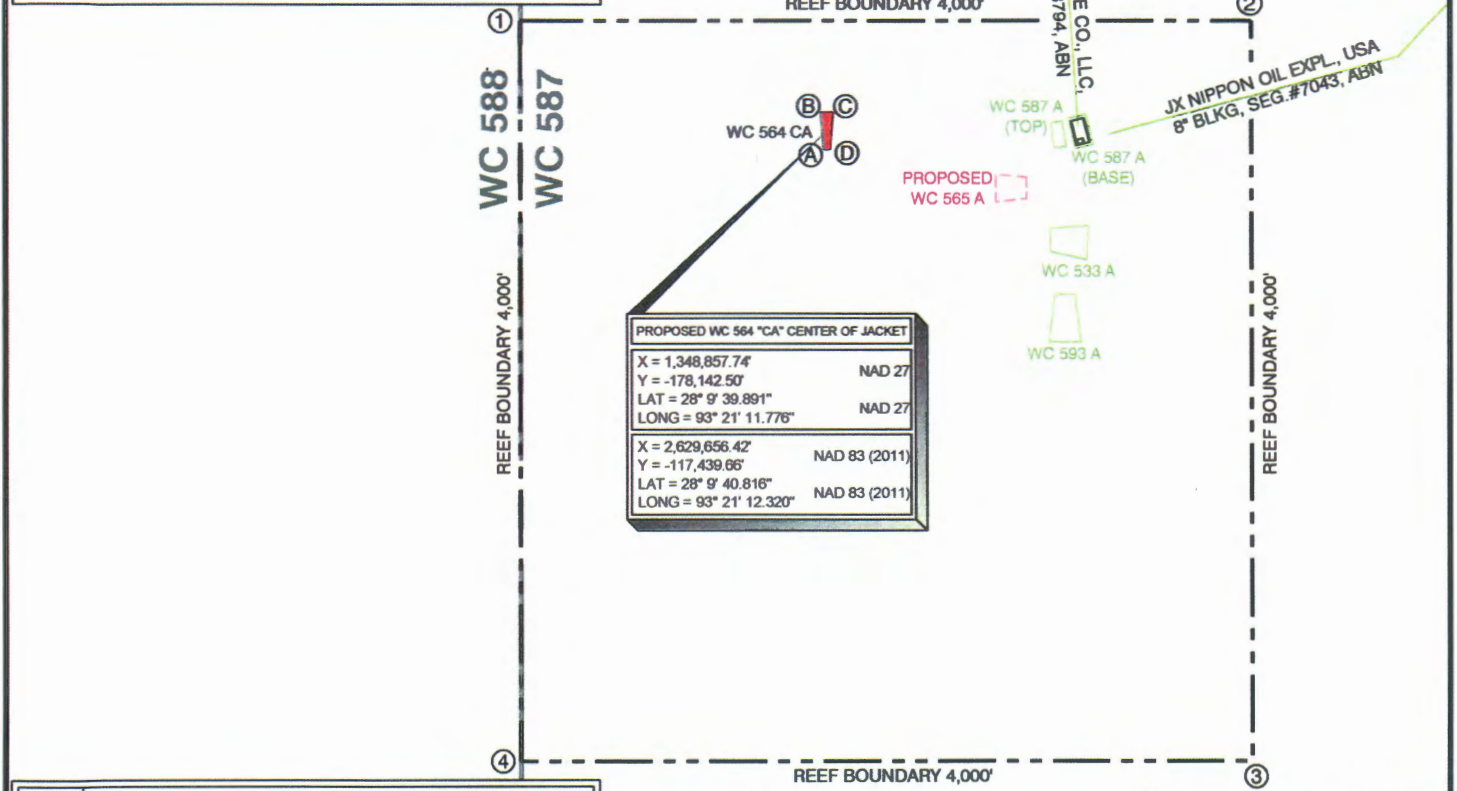

PROPOSED WC 564 "CA" CENTER OF JACKET			
X = 1,348,857.74			NAD 27
Y = -178,142.50			NAD 27
LAT = 28° 9' 39.891"			NAD 27
LONG = 93° 21' 11.776"			NAD 27
X = 2,629,656.42			NAD 83 (2011)
Y = -117,439.06			NAD 83 (2011)
LAT = 28° 9' 40.816"			NAD 83 (2011)
LONG = 93° 21' 12.320"			NAD 83 (2011)

TIE	PROPOSED WC 564 "CA" JACKET NAD27 COORDINATES			
	X	Y	LATITUDE	LONGITUDE
A	1,348,840.43	-178,246.19	28° 09' 38.862"N	93° 21' 11.948"W
B	1,348,822.49	-178,038.82	28° 09' 40.911"N	93° 21' 12.190"W
C	1,348,892.99	-178,038.82	28° 09' 40.923"N	93° 21' 11.402"W
D	1,348,875.06	-178,246.19	28° 09' 38.868"N	93° 21' 11.562"W

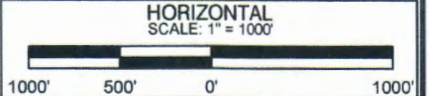

STATE OF LOUISIANA
 DAVID K. BURDEAUX
 REG. No. 4713
 REGISTERED
 LAND SURVEYOR
 1/13/2018
 DAVID K. BURDEAUX, P.L.S.
 STATE OF LOUISIANA, LICENSE NO. 4713

NOTES:
 1. Coordinates are referenced to the Louisiana Coordinate system of 1927, South Zone. Units are in U. S Survey Feet.

ARENA
 OFFSHORE, LP
WEST CAMERON 564 "CA" STRUCTURE
 PROPOSED REEF POSITION
 WEST CAMERON BLOCK 587
 GULF OF MEXICO

TBS T. BAKER SMITH
 SOLUTIONS START HERE
 107 Gimbal Circle, Lafayette, LA 70503
 (504) 733-2800

DRAWN BY: MAM
CHECKED BY: DKB
SHEET NO: 1 OF 2
DATE: JANUARY 24, 2018
DRAWING NO 180046_WC564CA-WC587_REEF_R2

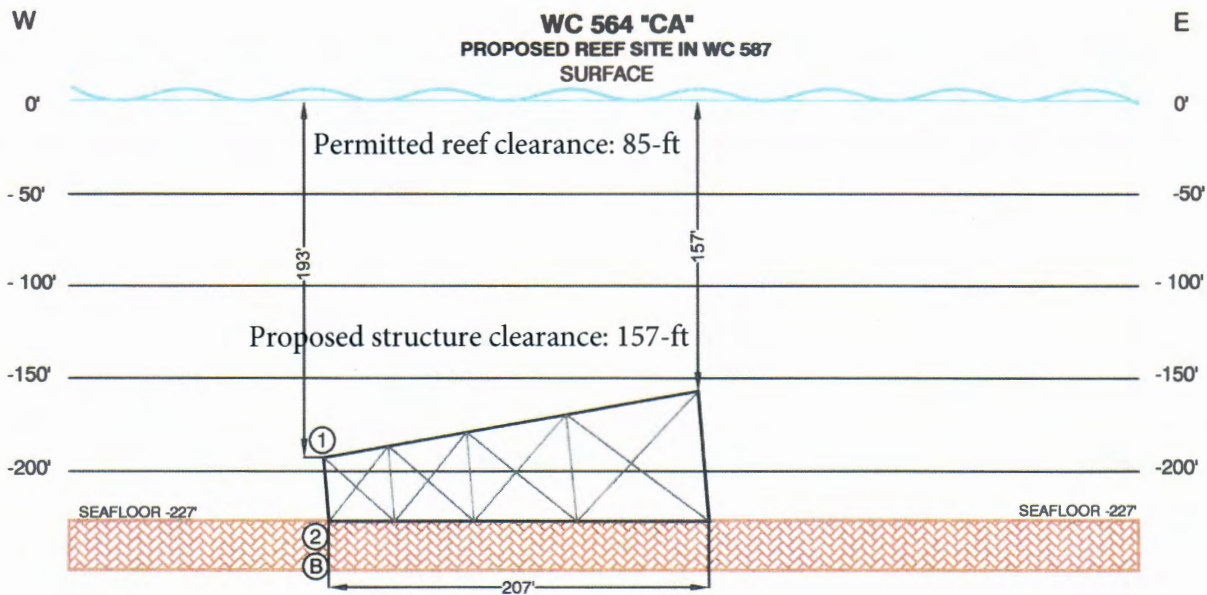
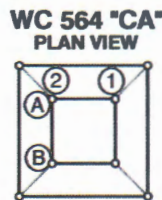
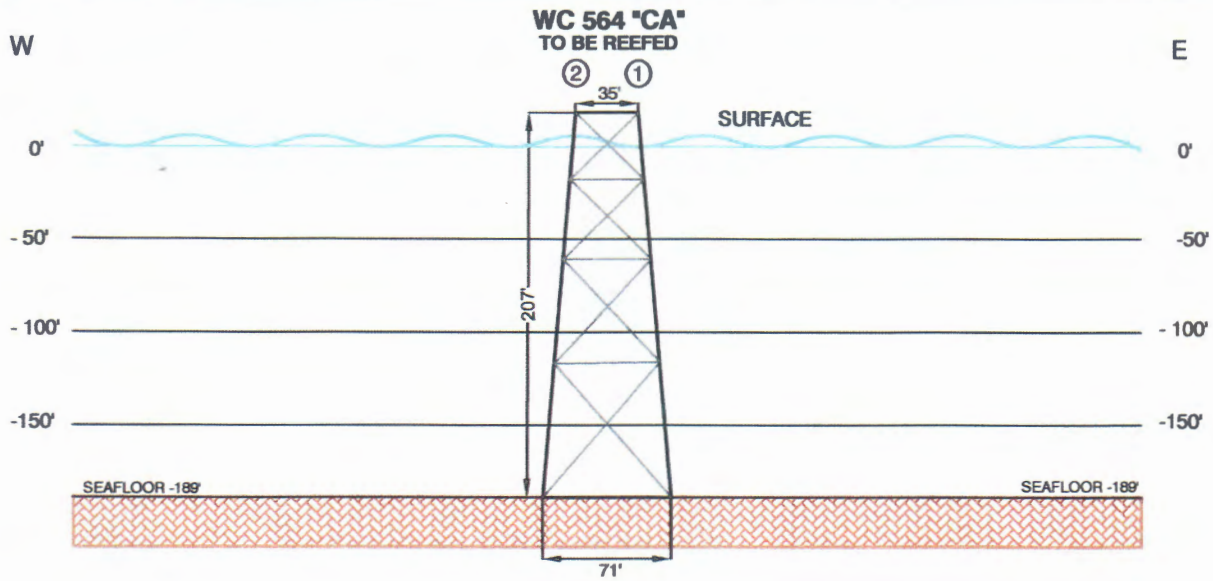

HORIZONTAL
SCALE: 1" = 100'

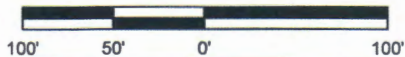

VERTICAL
SCALE: 1" = 100'

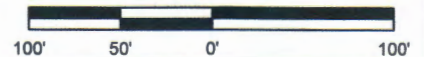

I certify this plat represents the proposed reef site.



NOTES:

1. Coordinates are referenced to the Louisiana Coordinate system of 1927, South Zone. Units are in U. S Survey Feet.
2. Jacket depths indicated on this plat were obtained by construction drawings.
3. Water depths at reef site are based on publically available information & not field verified.

ARENA
OFFSHORE, LP

WEST CAMERON 564 "CA" STRUCTURE
PROPOSED REEF POSITION
WEST CAMERON BLOCK 587
GULF OF MEXICO



DRAWN BY: MAM
CHECKED BY: DKB
SHEET: NO: 2 OF 2
DATE: JANUARY 24, 2018
DRAWING NO: 180048_WC564CA-WC587_REEF_R2