



DEPARTMENT OF THE ARMY
U.S. ARMY CORPS OF ENGINEERS, NEW ORLEANS DISTRICT
7400 LEAKE AVENUE
NEW ORLEANS, LA 70118-3651

February 27, 2023

Project Manager:
Stephanie Castaing
(504) 862-1564
Stephanie.L.Castaing@usace.army.mil

Permit Application Number: MVN-2009-02142-EPP

PUBLIC NOTICE

Interested parties are hereby notified that a permit application has been received by the New Orleans District of the U.S. Army Corps of Engineers pursuant to: [X] Section 10 of the Rivers and Harbors Act of March 3, 1899 (30 Stat. 1151; 33 USC 403); and/or [X] Section 404 of the Clean Water Act (86 Stat. 816; 33 USC 1344).

MODIFICATION FOR ADDITIONAL DREDGE AREA, STOCKPILE PIT, ACCESS ROAD, & CASING PIPE AT AND WITHIN THE MISSISSIPPI RIVER IN PLAQUEMINES PARISH

NAME OF APPLICANT: Woodlands Borrow Pits, LLC, c/o Paul Hogan, Post Office Box 250, Des Allemands, Louisiana 70030 or phinda9@aol.com

LOCATION OF WORK: At approximately Latitude: 29.582778, Longitude: -89.813056, on the right descending bank of the Mississippi River, at about 50 miles above Head of Passes, at 22442 Louisiana Highway 23, in Port Sulphur, Louisiana, in Plaquemines Parish, as shown on the enclosed drawings.

Hydrologic Unit Code: 08090100 (Lower Mississippi-New Orleans)

CHARACTER OF WORK: Additional dredge and sand stockpile area with an access road and to install and maintain a temporary dredge pipeline and a casing pipe under LA Highway 23 to facilitate the dredge pipeline from the Mississippi River to the proposed sand stockpile area. The project as proposed would directly impact approximately 166.0 acres of waterbottoms and 37.9 acres of jurisdictional wetlands. The applicant proposed to contract with an approved mitigation bank to offset the adverse impact to jurisdictional wetlands.

The comment period for the Department of the Army Permit will close **30 days** from the date of this public notice. Written comments, including suggestions for modifications or objections to the proposed work, stating reasons thereof, are being solicited from anyone having interest in this permit and must be mailed so as to be received before or by the last day of the comment period. Letters and/or comments concerning the subject permit application must reference the Applicant's Name and the Permit Application Number and can be preferably emailed to the Corps of Engineers project manager listed above or forwarded to the Corps of Engineers at the address above, ATTENTION: REGULATORY DIVISION, RGE, Stephanie Castaing. This public notice is also available for review online at <https://go.usa.gov/xennJ>.

Corps of Engineers Permit Criteria

The decision whether to issue a permit will be based on an evaluation of the probable impacts, including cumulative impacts of the proposed activity on the public interest. That decision will reflect the national concern for both protection and utilization of important resources. The benefit which reasonably may be expected to accrue from the proposal must be balanced against its reasonably foreseeable detriments. All factors which may be relevant to the proposal will be considered including the cumulative effects thereof; among those are conservation, economics, aesthetics, general environmental concerns, wetlands, historic properties, fish and wildlife values, flood hazards, floodplain values, land use, navigation, shoreline erosion and accretion, recreation, water supply and conservation, water quality, energy needs, safety, food and fiber production, mineral needs, considerations of property ownership and, in general, the needs and welfare of the people.

The U.S. Army Corps of Engineers is soliciting comments from the public, federal, state, and local agencies and officials, Indian Tribes, and other interested parties to consider and evaluate the impacts of this proposed activity. Any comments received will be considered by the U.S. Army Corps of Engineers to determine whether to make, modify, condition, or deny a permit for this proposal. To make this decision, comments are used to assess impacts on endangered species, historic properties, water quality, general environmental effects, and other public interest factors listed above. Comments are used in the preparation of an Environmental Assessment and/or an Environmental Impact Statement pursuant to the National Environmental Policy Act. Comments are also used to determine the need for a public hearing and to determine the overall public interest of the proposed activity. Further, all factors that may be relevant to the proposal will be considered, including the potential cumulative effects associated with the proposed project.

The New Orleans District is unaware of properties listed on the National Register of Historic Places near the proposed work. The possibility exists that the proposed work may damage or destroy presently unknown archeological, scientific, prehistorical, historical sites, or data. Issuance of this public notice solicits input from the State Archeologist and State Historic Preservation Officer regarding potential impacts to cultural resources.

The New Orleans District has determined that the proposed project activities are not likely to adversely affect the threatened Eastern Black Rail, endangered Pallid Sturgeon or the threatened West Indian Manatee with the inclusion of Intake Conditions and the Standard Manatee Conditions, based on the Information & Planning Consultation for Endangered Species in Louisiana (IPaC), dated January 27, 2020, between the U.S. Army Corps of Engineers, New Orleans and U.S. Fish and Wildlife Service, Ecological Services Office.

Our initial finding is that the proposed work would have no effect on any species listed as endangered by the U.S. Departments of Commerce, nor affect any habitat designated as critical to the survival and recovery of such species.

This notice initiates the Essential Fish Habitat (EFH) consultation requirements of the Magnuson-Stevens Fishery Conservation and Management Act. The applicant's proposal would result in the destruction or alteration of 37.9 acres of EFH utilized by various life stages of red drum and penaeid shrimp. Our initial determination is that the proposed action would have no adverse impact on EFH or federally managed fisheries in the Gulf of Mexico. Our final determination relative to project impacts and the need for mitigation measures is subject to review by and coordination with the National Marine Fisheries Service.

If the proposed work involves deposits of dredged or fill material into navigable waters, the evaluation of the probable impacts will include the application of guidelines established by the Administrator of the Environmental Protection Agency. Also, a certification that the proposed activity will not violate applicable water quality standards will be required from the Department of Environmental Quality, Water Quality Certifications, before a permit is issued.

Any person may request, in writing, within the comment period specified in this notice, that a public hearing be held to consider this application. Requests for public hearings shall state, with particularity, the reasons for holding a public hearing.

The applicant has certified that the proposed activity described in the application complies with and will be conducted in a manner that is consistent with the Louisiana Coastal Resources Program (Louisiana Coastal Zone Application P20220298. The Department of the Army permit will not be issued unless the applicant received approval or a waiver of the Coastal Use Permit by the Department of Natural Resources.

You are requested to communicate the information contained in this notice to any other parties whom you deem likely to have interest in the matter.

Brad P. LaBorde
Chief, Eastern Evaluation Branch
Regulatory Division

Enclosure

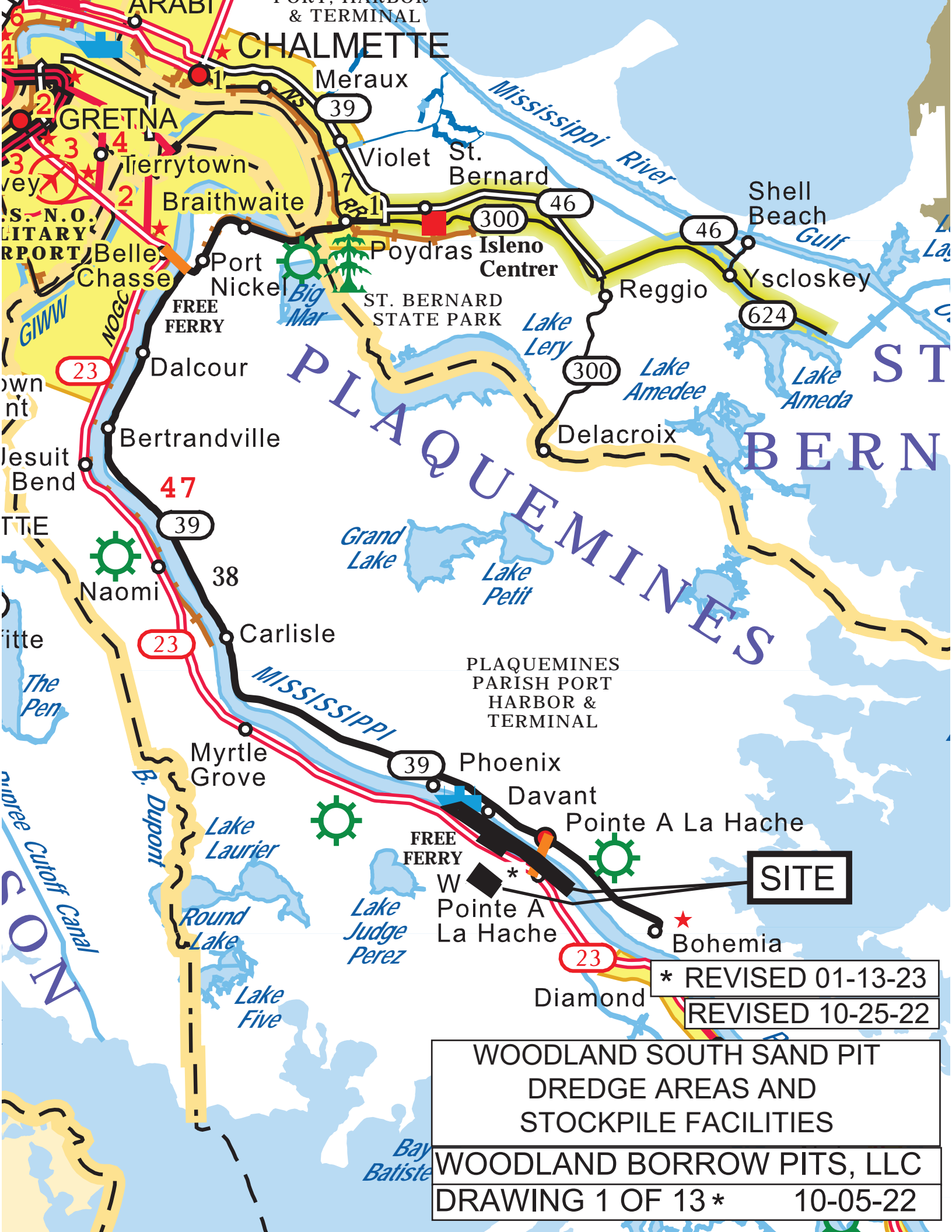

WOODLAND SOUTH SAND PIT
DREDGE AREAS AND
STOCKPILE FACILITIES

WOODLAND BORROW PITS, LLC
DRAWING 1 OF 13 * 10-05-22

* REVISED 01-13-23
REVISED 10-25-22

P20220298

EXISTING PERMITTED POINTE
CELESTE ANCHORAGE
DREDGING AREA
(SEE DRAWING 3 OF 13)

EXISTING PERMITTED
STOCKPILE AREA 1
(SEE DRAWING 4 OF 13)

STOCKPILE AREA 2 AND
ACCESS ROAD
(SEE DRAWING 6 AND 7 OF 13)

LDOTD PERMITTED HIGHWAY
CROSSING CASING

LONGITUDAL DREDGE
PIPELINE ROUTE

LIMIT OF TRANSVERSE
PIPELINE PLACEMENT
TO DREDGE AREA (TYP)

UPPER MAGNOLIA
ANCHORAGE DREDGE SITE
(SEE DRAWING 5 OF 13)

AT&T RIVER
CROSSING

SCALE

0 2000'

* REVISED 01-13-23

WOODLAND SOUTH SAND PIT
DREDGE AREAS AND
STOCKPILE FACILITIES

WOODLAND BORROW PITS. LLC
DRAWING 2 OF 13 * 10-25-22

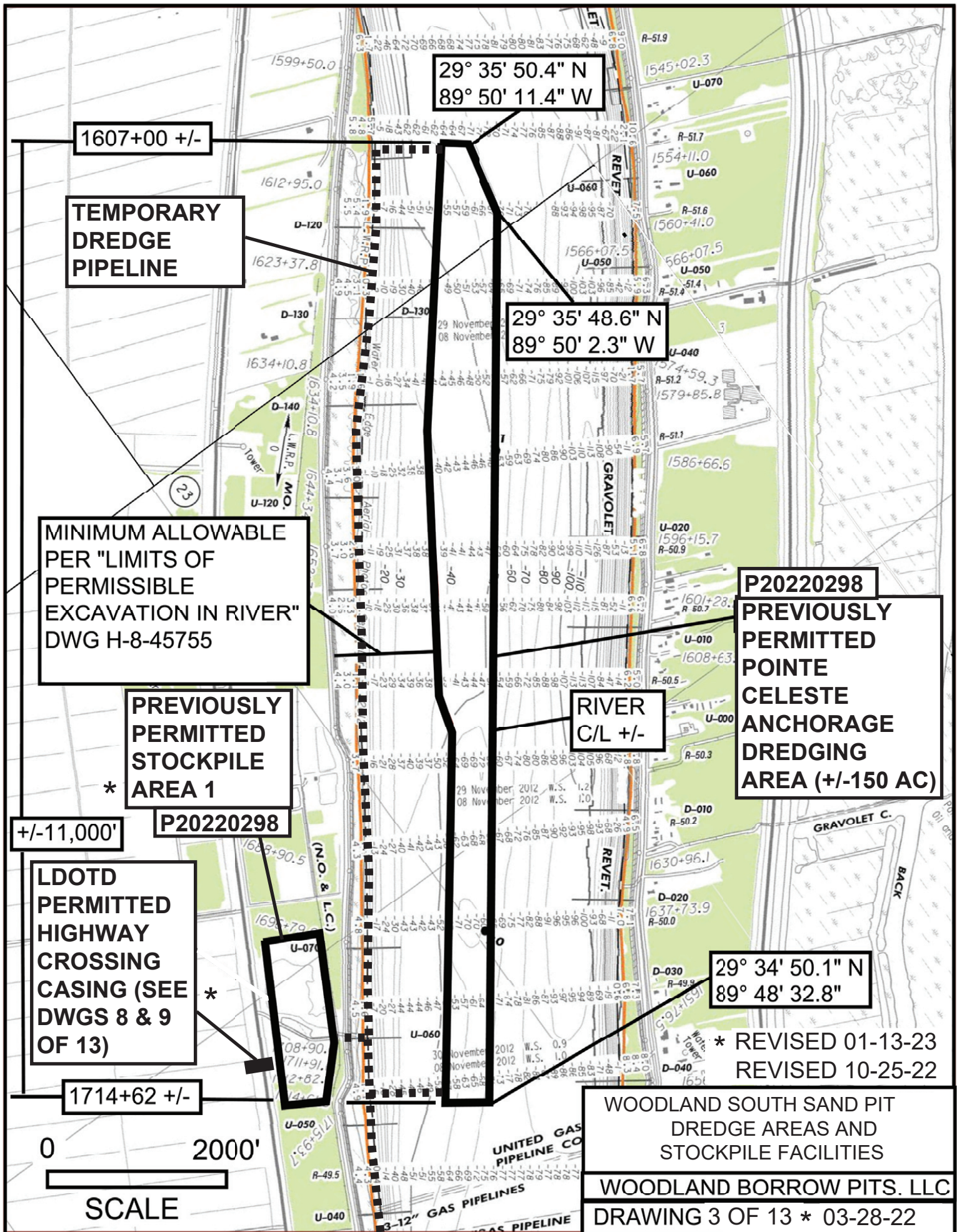

LDOTD PERMITTED HIGHWAY CROSSING CASING *
(SEE DWGS 8 & 9 OF 13)

MINIMUM ALLOWABLE PER
"LIMITS OF PERMISSIBLE
EXCAVATION IN RIVER"
DWG H-8-45755

UP-RIVER
LIMIT: STA.
1607+00 +/-



SCALE

0'

1000'

Tower
Woodland

P20220298

PREVIOUSLY
PERMITTED
STOCKPILE AREA 1

210' TO
LEVEE
TOE +/-

TEMPORARY
DREDGE
PIPELINE

720'+/-

A

1900'+/-

W

B

A

P20220298

PREVIOUSLY
PERMITTED
POINTE CELESTE
ANCHORAGE
DREDGING AREA
(+/-150 AC)
(SEE DWG 3 OF 13)

* REVISED 01-13-23
REVISED 10-25-22

500'+/-

75' TO
LEVEE
TOE +/-

WOODLAND SOUTH SAND PIT
DREDGE AREAS AND
STOCKPILE FACILITIES
WOODLAND BORROW PITS, LLC
DRAWING 4 OF 13 * 03-28-22

3-12" GAS PIPELINE

UPPER MAGNOLIA ANCHORAGE
DREDGING LIMIT

N

TEMPORARY
DREDGE
PIPELINE

* REVISED 01-13-23

POINT	NORTHING	EASTING	LATITUDE	LONGITUDE
1	389,296.4	3,774,827.7	29° 33' 40.6"	-89° 46' 46.1"
2	388,851.7	3,775,369.5	29° 33' 36.1"	-89° 46' 40.0"
3	387,778.4	3,776,382.2	29° 33' 25.3"	-89° 46' 28.7"
4	386,671.8	3,777,266.9	29° 33' 14.3"	-89° 46' 18.9"
5	385,205.8	3,778,497.8	29° 32' 59.6"	-89° 46' 05.2"
6	384,715.0	3,778,907.7	29° 32' 54.7"	-89° 46' 00.6"
7	384,464.2	3,779,135.5	29° 32' 52.2"	-89° 45' 58.1"
8	384,068.7	3,778,338.9	29° 32' 48.3"	-89° 46' 07.2"
9	384,356.3	3,778,041.8	29° 32' 51.3"	-89° 46' 10.5"
10	384,956.6	3,777,512.6	29° 32' 57.3"	-89° 46' 16.4"
11	385,566.0	3,776,994.2	29° 33' 03.3"	-89° 46' 22.2"
12	386,244.8	3,776,559.0	29° 33' 10.1"	-89° 46' 27.0"
13	386,895.9	3,776,090.8	29° 33' 16.6"	-89° 46' 32.2"
14	387,532.2	3,775,604.6	29° 33' 23.0"	-89° 46' 37.6"
15	388,131.8	3,775,074.5	29° 33' 29.0"	-89° 46' 43.5"
16	388,781.7	3,774,604.7	29° 33' 35.5"	-89° 46' 48.7"
17	388,951.6	3,774,436.6	29° 33' 37.2"	-89° 46' 50.6"

AT&T RIVER
CROSSING

WOODLAND SOUTH SAND
PIT DREDGE AREAS AND
STOCKPILE FACILITIES
WOODLAND BORROW PITS. LLC
DRAWING 5 OF 13 * 10-25-22



MISSISSIPPI RIVER

STOCKPILE AREA 2

29° 34' 06" N
89° 48' 57" W

+/-47 ACRES

RIVERBANK

LEVEE

EXISTING PERMITTED
SAND STOCKPILE AREA 1
(22442 LA 23, PORT SULPHUR, LA 70083)

LA 23

HIGHWAY CROSSING CASING
(SEE DRAWINGS 8 & 9 OF 13)

HIGHWAY DITCH

EXISTING GRAVEL ROAD
AND ROADSIDE DITCH

EXISTING PERMITTED BORROW PIT AREA
22238 HWY 23, PORT SULPHUR, LA 70083
(NOT RELATED TO THIS PERMIT)

EXISTING GRAVEL ROAD
AND ROADSIDE DITCH

TEMPORARY DREDGE PIPELINE
(LOCATION TO BE FIELD DETERMINED)

STOCKPILE AREA 2 AND
ACCESS ROAD IMPACTS:
WETLAND: 37.9 AC.
OTHER WATERS: 1.52 AC.

1600'

A

DIKES

SPILL BOXES

SEDIMENT BASIN

1300'

40' WIDE
ACCESS ROAD
(GRAVEL)

ROADSIDE
DITCH X-ING
(TYP)

FIELD
DITCH X-ING
(TYP)

B

EXIST.
FIELD
DITCH
(TYP)

WETLAND
LIMITS
(TYP)

SAND
PIT
LIMIT

EXIST.
FIELD
DITCH
(TYP)

A
DRAIN
PIPE

BASIN
DRAIN
DITCH

0' 500' 1000'

SCALE

NOTE: SEE DRAWING 7 OF 13 FOR
SECTION A-A & DETAILS

WOODLAND SOUTH SAND PIT DREDGE
AREAS AND STOCKPILE FACILITIES

WOODLAND BORROW PITS, LLC

DRAWING 6 OF 13 02-02-23

DRAWING 6 OF 13 RELATED SECTION AND DETAILS

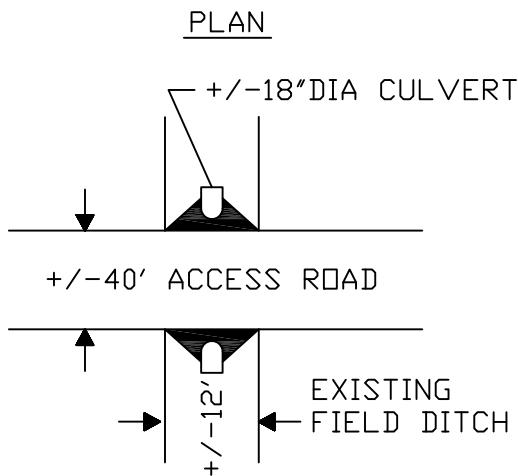
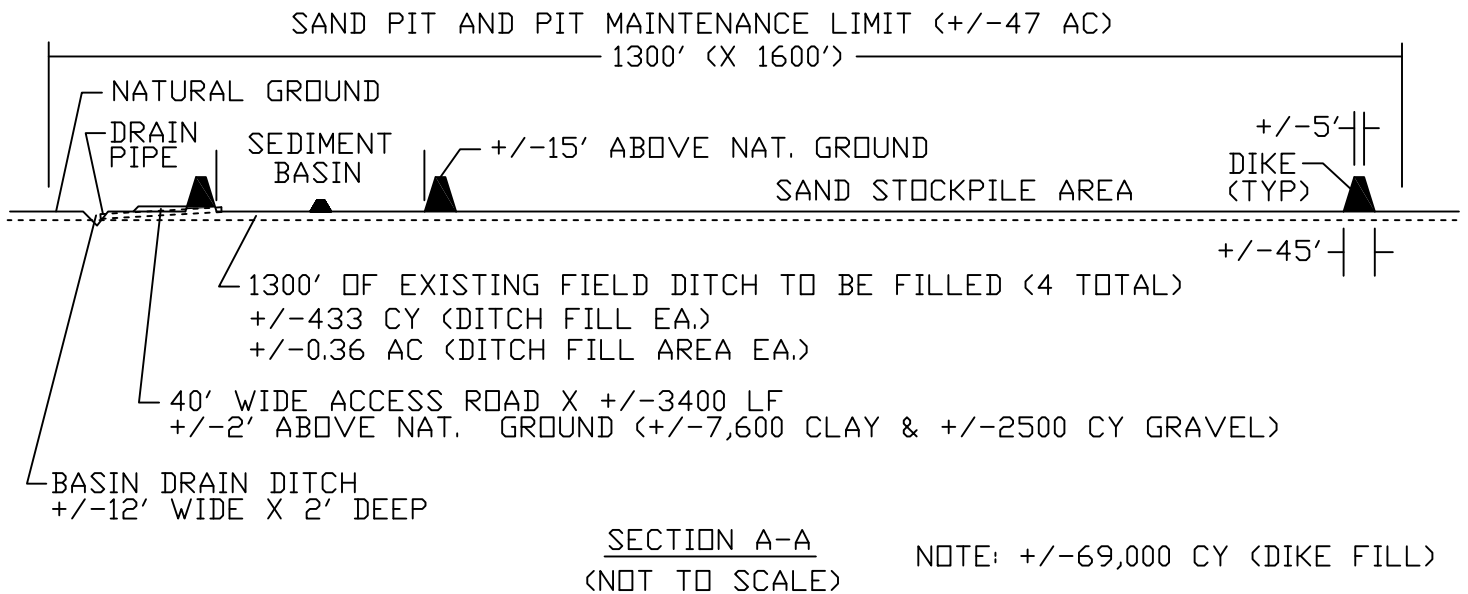

ACCESS ROAD FIELD DITCH CROSSING (4 TOTAL) (TYP)
(NOT TO SCALE)

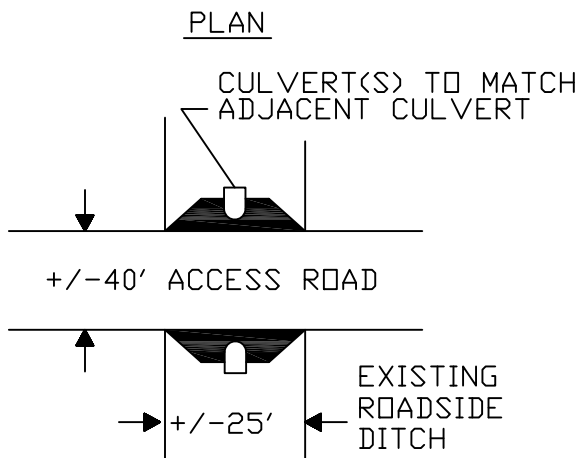
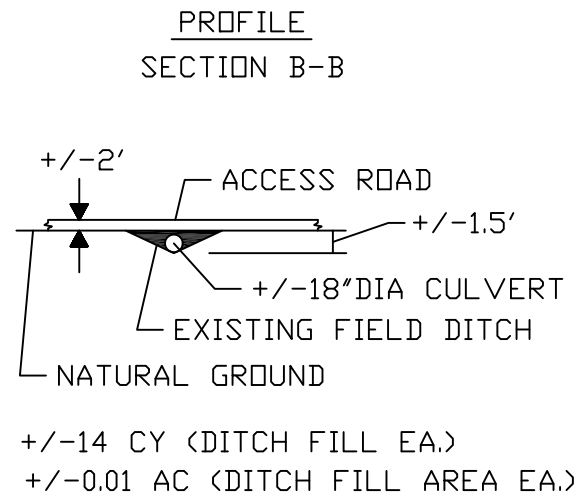

ROADSIDE DITCH CROSSING (2 TOTAL) (TYP)
(NOT TO SCALE)

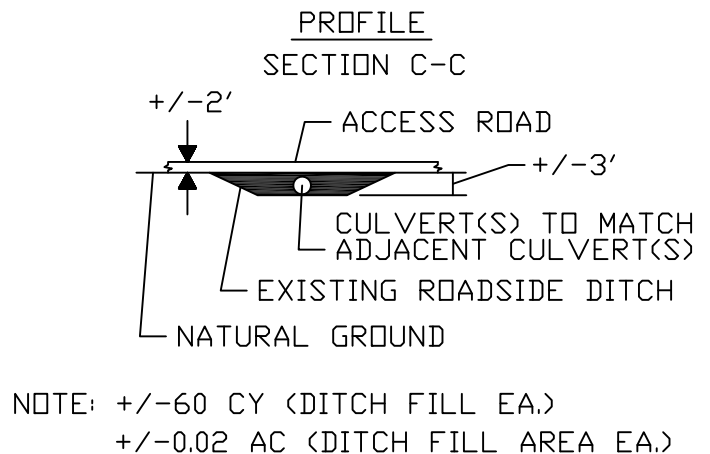

WOODLAND SOUTH SAND PIT DREDGE
AREAS AND STOCKPILE FACILITIES
WOODLAND BORROW PITS, LLC
DRAWING 7 OF 13 02-02-23

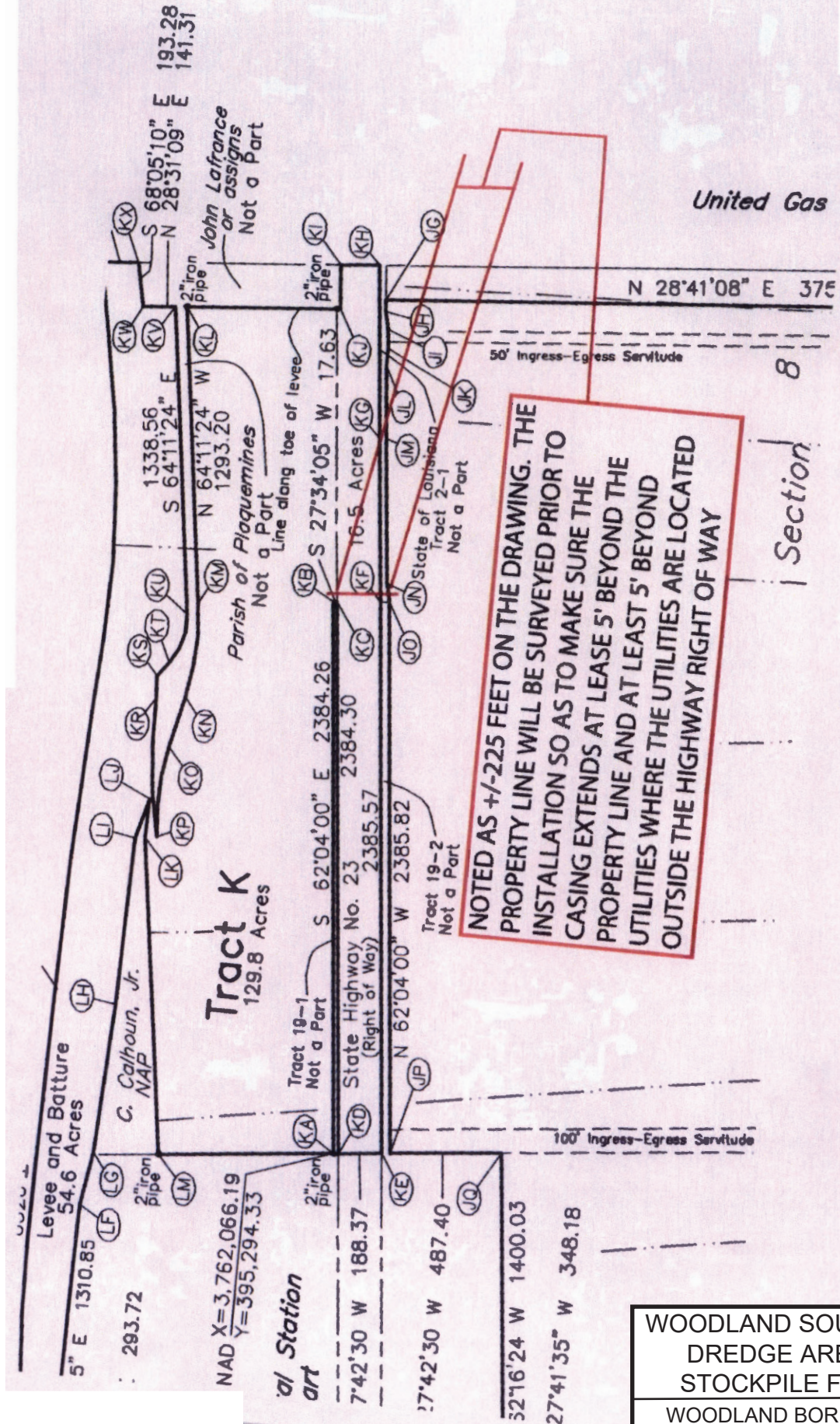

REVISED 02-23-22

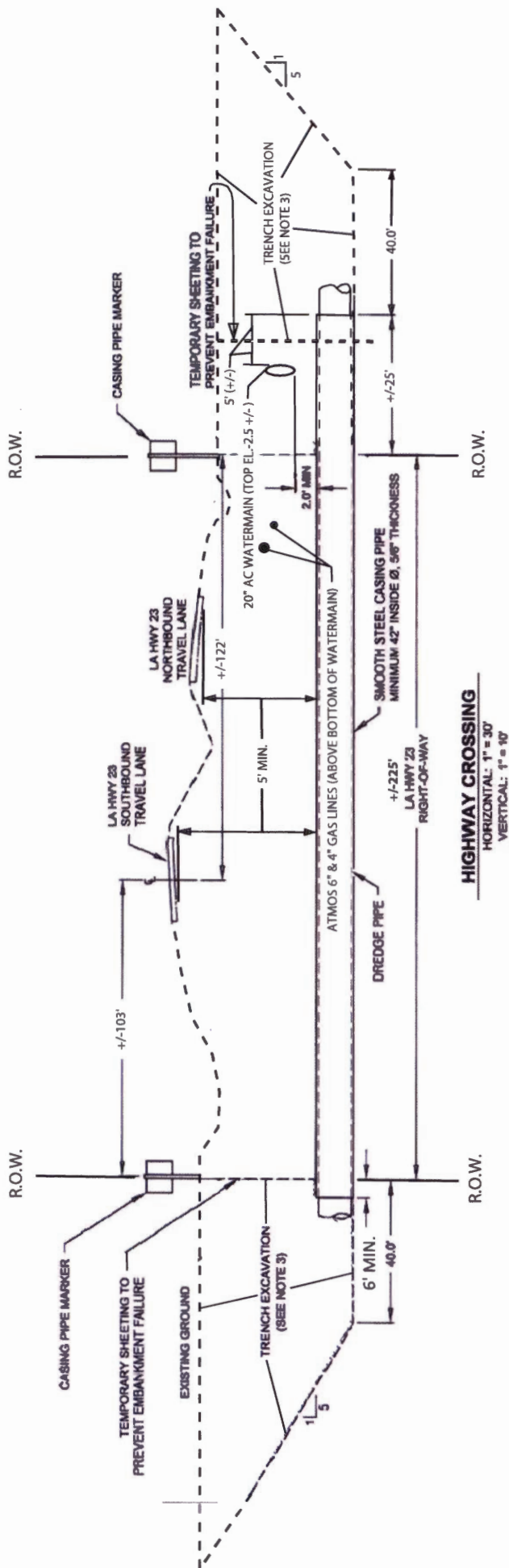

- NOTES:
1. THE CASING INSTALLATION CONTRACTOR SHALL JACK THE MINIMUM 42" STEEL CASING PIPE UNDER THE LOUISIANA RIGHT-OF-WAY IN ACCORDANCE WITH LADOTD 2016 STANDARD SPECIFICATION 728. CASING PIPE DIAMETER SHALL BE NO GREATER THAN 48".
 2. THE CASING PIPE SHALL BE MADE OF SMOOTH WALL WELDED CARBON STEEL PIPE CONFORMING TO ASTM A139, GRADE B HAVING A MINIMUM YIELD STRENGTH OF 36,000 PSI. CASING PIPE SHALL BE COATED WITH COAL TAR EPOXY-POLYAMIDE PAINT, IN ACCORDANCE WITH THE LADOTD 2016 STANDARD SPECIFICATION 1008.04.
 3. TRENCH EXCAVATION TO FACILITATE THE JACKING CONSTRUCTION PER LADOTD 2016 STANDARD SPECIFICATION 728 (EMBANKMENT MAY BE STEPPED FOR SAFETY).
 4. THE CASING IS TO UTILIZED PERIODICALLY WHEN DREDGE MATERIAL IS TO BE DEPOSITED WEST OF LA 23 (1-2 TIMES PER YEAR FOR 60 DAY PERIODS ANTICIPATED). ENDS OF CASING TO BE SEALED AND TRENCH EXCAVATION AREA BACKFILLED UPON COMPLETION OF EACH USE.

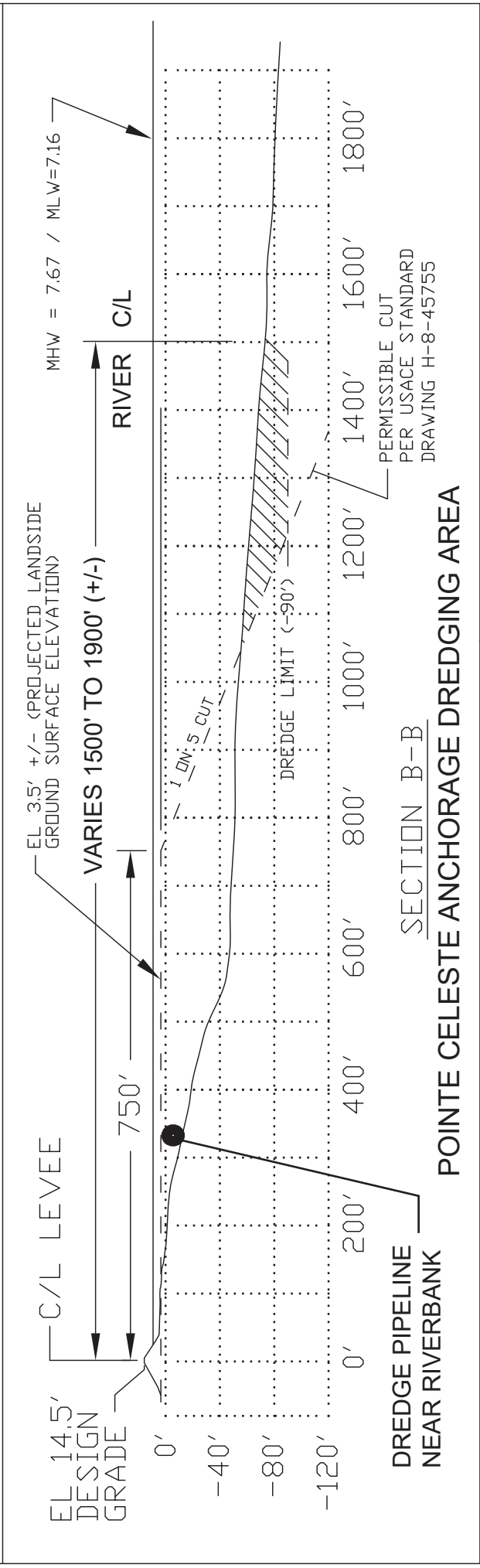
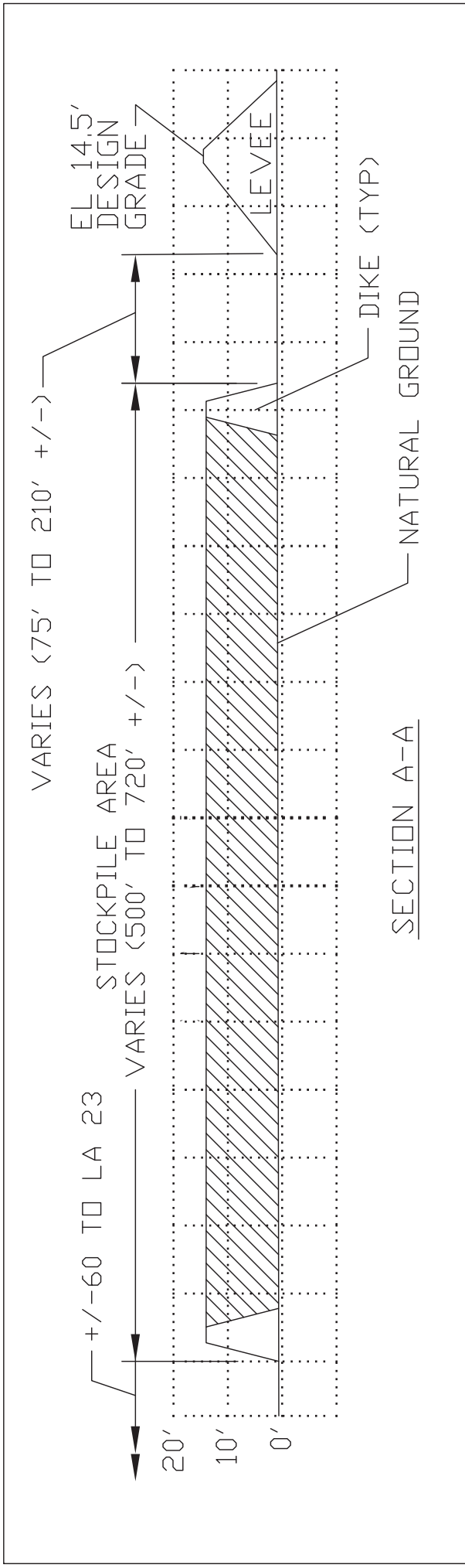

WOODLAND SOUTH SAND PIT DREDGE AREAS AND STOCKPILE FACILITIES	
* REVISED 01-13-23	WOODLAND BORROW PITS, LLC
REVISED 10-25-22	DRAWING 10 OF 13 * 05-11-17

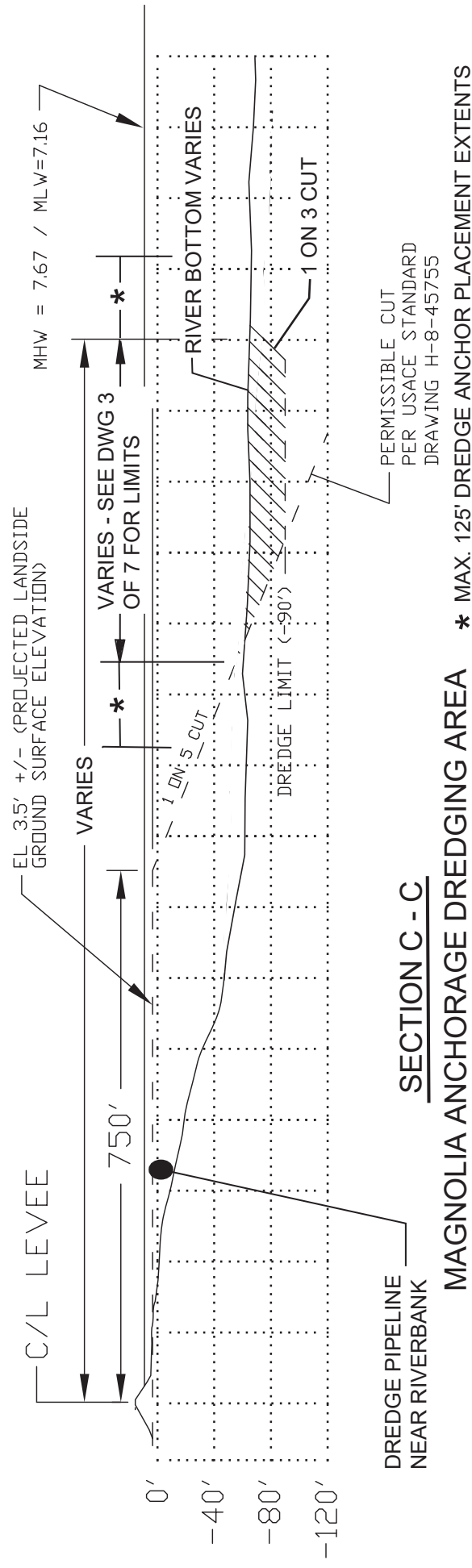

WOODLAND SOUTH SAND PIT DREDGE AREAS AND STOCKPILE FACILITIES	
WOODLAND BORROW PITS, LLC	
** REVISED 01-13-23	DRAWING 11 OF 13** 10-25-22

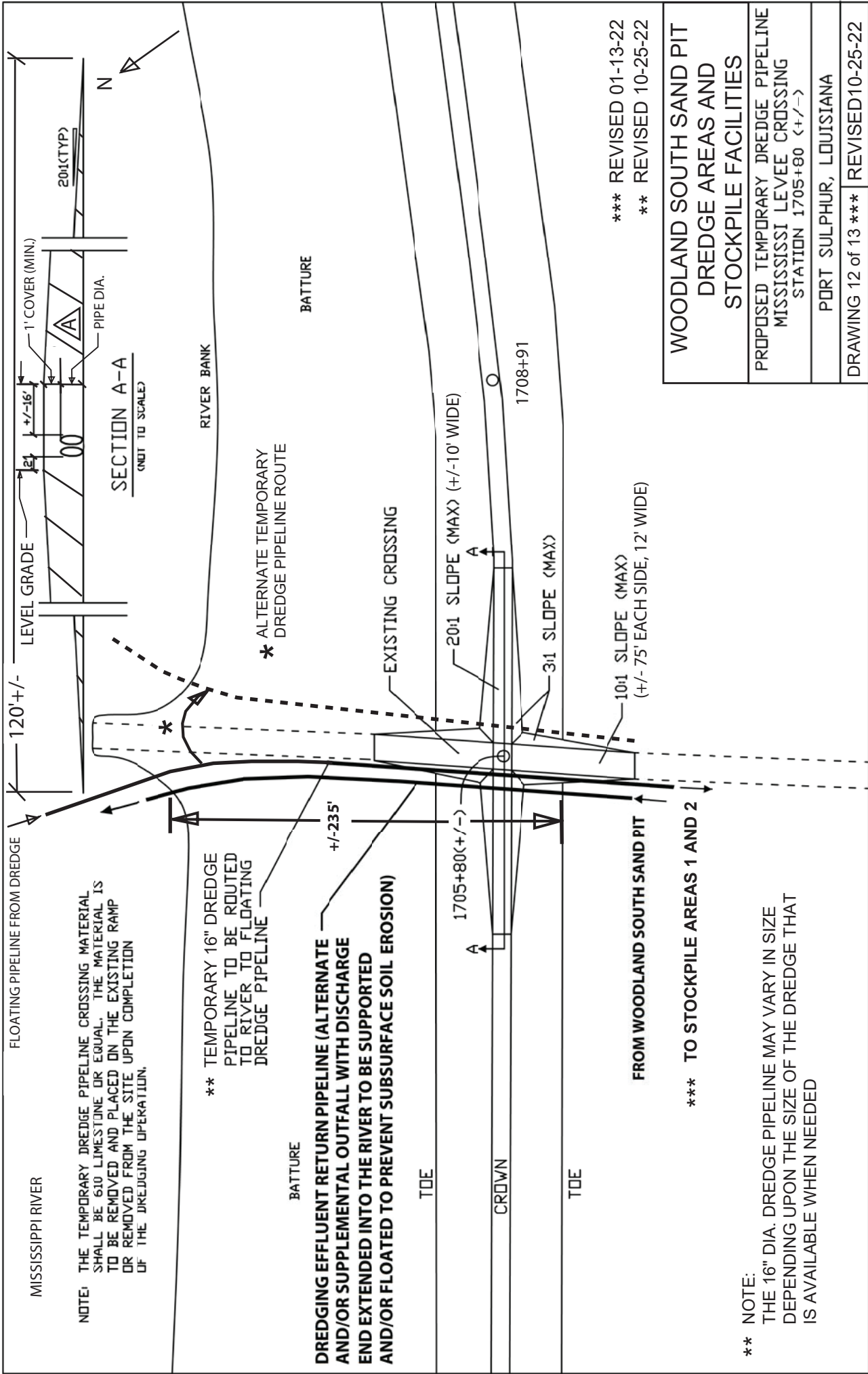

Notes:

As-Built drawings will be submitted within 10 days of completion of this project to the Louisiana Department of Natural Resources, Office of Conservation, Pipeline Division, P.O. Box 94275, Baton Rouge, LA 70804, and to the Louisiana Department of Natural Resources, Coastal Management Division, P.O. Box 44487, Baton Rouge, LA 70804-4487.

All structures, facilities, well and pipe lines / flowlines occurring in open water areas or in oilfield canal. or slips shall be removed within 120 days of abandonment or the facilities for the herein permitted use unless prior written approval to leave such structures in place is received from the Coastal Management Division. This condition does not preclude the necessity for revising the current permit or obtaining a separate Coastal Use Permit, should one be required.

Structures must also be marked / lighted in accordance with U.S. Coast Guard regulations.

In order to ensure the safety of all parties, the permitted shall contact the Louisiana One Call System (1-800-272-3020) a minimum of 48 hours prior to the commencement of any excavation (digging, dredging, jetting, etc.) or demolition activity.

The pallid sturgeon (*Scaphirhynchus albus*) may occur in water bodies near this proposed project. The pallid sturgeon is listed as endangered under the Endangered Species Act (16 U.S.C. 1531-1544) and occur in the Mississippi and Atchafalaya rivers in southern Louisiana, and the Red River. This species requires large, turbid, free-flowing riverine habitat and is adapted to living close to the bottom of large rivers with sand and gravel bars. Pallid sturgeon typically spawn from May-August, but successful reproduction has been severely reduced due to habitat modification. This includes the loss of habitat through the construction of dams that have modified flows, reduced turbidity and lowered water temperatures. It is advised that one takes the necessary measures to avoid the breeding season and any degradation of water quality in the Mississippi and Atchafalaya rivers. Contact Beau Gregory at 337-491-2576 regarding questions.

The long-tailed weasel is considered rare in La. The species is found in habitats usually near water. Habitats include brush land, open woodlands, field edges, riparian grassland, swamps & marshes. Dens are in abandoned burrows of other mammals, rock crevices, brush piles, stump hollows or spaces among tree roots. Research indicates that the weasel may be sensitive to agriculturally induced fragmentation of habitat, showing the importance of maintaining landscape connectivity for the conservation of this species.

The Louisiana Natural Heritage Program (LNHP) reports summarize the existing information known at the time of the permitting request regarding the location in question. LNHP reports should not be considered final statements on the biological elements or areas being considered, nor should they be substituted for on-site surveys required for environmental assessments. If at any time LNHP tracked species are encountered within the project area, contact a LDWF biologist at 225-765-2643.

The area where the project is located is all part of the aboriginal homelands of the Chitimacha Tribe of Louisiana. As such, large villages, burial sites, and sacred sites were in place in that entire area. If at any time during the course of the work, any traditional cultural properties are discovered, Permittee shall immediately contact Kimberly S. Walden (Cultural Director) or Melanie Aymond (Research Coordinator) at (337) 923-9923 or (337) 923-4395. Office hours are Monday through Thursday from 7:30 A.M. - 5:00 P.M. and on Friday between 7:30 A.M. -11:30 A.M. If traditional cultural properties are discovered on the weekend or after business hours, the notification shall be made the next business morning. This information is being requested pursuant to LAC, Title 43, Part I, Chapter 7, §701.

The Applicant's proposed dredging area is in the vicinity of a permitted sand resource that is utilized to construct Coastal Master Plan projects. Therefore, the Applicant shall coordinate with the Coastal Protection and Restoration Authority (CPRA) before hydraulic dredging activities begin. Additionally, information on the Applicant's dredge site (exact location), proposed equipment, and schedule shall be provided to CPRA for approval to ensure there is no impact to construction activities and sediment availability associated with potential Coastal Master Plan projects.

The applicant shall adhere to all state statutes (R.S. 56:2011 et seq.) and department regulations (LAC 76:XIII.101 et seq.) concerning dredging of fill sand and fill material from water bottoms of the state of Louisiana and severance royalties. For more information, contact Mr. Dave Butler at 504-286-4173. Wildlife Diversity Program: No impacts to rare, threatened or endangered species or critical habitats are anticipated from the proposed project. No state or federal parks, wildlife refuges, wildlife management areas or scenic rivers are known at the specified site or within ¼ mile of the proposed project. The Wildlife Diversity Program (WDP) reports summarize the existing information known at the time of the request regarding the location in question. WDP reports should not be considered final statements on the biological elements or areas being considered, nor should they be substituted for on-site surveys required for environmental assessments. If at any time WPD tracked species are encountered within the project area, please contact our biologist at 225-763-3554.

~~Dredging operations may not commence if there is another dredge operating in the area. Additionally, any dredging operations must be suspended if another dredge begins dredging in the area.~~ All dredging operations shall be for short periods of time to deposit material on the bank.

The applicant must submit for and receive a Levee Permit/Letter of No Objection from the CPRA, the United States Army Corps of Engineers and the Plaquemines Parish Government prior to commencement of the activity.

**WOODLAND SOUTH SAND PIT
DREDGE AREAS AND
STOCKPILE FACILITIES**

WOODLAND BORROW PITS, LLC

DRAWING 13 OF 13* 10-05-22

*** REVISED 01-13-23**

REVISED 10-25-22