

# JOINT PUBLIC NOTICE

June 17, 2013

United States Army  
Corps of Engineers  
Quality  
New Orleans District  
Regulatory Branch  
Post Office Box 60267  
New Orleans, Louisiana 70160-0267

(504) 862-1217  
Project Manager  
Kenny Blanke  
[Kenneth.G.Blanke@usace.army.mil](mailto:Kenneth.G.Blanke@usace.army.mil)  
MVN 2005-3266-CQ

State of Louisiana  
Department of Environmental  
Office of Environmental Services  
Post Office Box 4313  
Baton Rouge, Louisiana 70821-4313

(225) 219-3225  
Project Manager  
Jamie Phillippe  
WQC Application Number  
WQC 060111-07

Interested parties are hereby notified that a permit application has been received by the New Orleans District of the US Army Corps of Engineers pursuant to: [X] Section 10 of the Rivers and Harbors Act of March 3, 1899 (30 Stat. 1151; 33 USC 403); and/or [X] Section 404 of the Clean Water Act (86 Stat. 816; 33 USC 1344).

Application has also been made to the Louisiana Department of Environmental Quality, Office of Environmental Services, for a Water Quality Certification (WQC) in accordance with statutory authority contained in LRS 30:2074 A(3) and provisions of Section 401 of the Clean Water Act.

## **EROSION CONTROL AND BANK RECLAMATION ON THE AMITE RIVER IN ASCENSION PARISH**

**NAME OF APPLICANT:** MR. CURTIS SUTHERLAND, 18389 Ravenwood Land, Galvez, LA 70769.

**LOCATION OF WORK:** In the Amite River, right and left descending banks, at a point approximately 34 miles above the mouth of the waterway, near Port Vincent, Louisiana, in ASCENSION PARISH, 30.34273 N and -90.87459 W, as shown on the enclosed drawings. This project is located in USGS Hydrologic Unit Code (HUC) 08070202- Amite River.

**CHARACTER OF WORK:** Extension of time to for 5 years to install and maintain riprap material for erosion control, bank stabilization, and land reclamation for a land parcel along the Amite River. The project was previously authorized under MVN-2005-3266-CX on April 27, 2006, and has been expired since April 30, 2011. The proposed work on the left descending bank is to be within an area of approximately 1,200 feet long and 100 feet wide, located approximately parallel to the mean low water shoreline, the outer edge to extend approximately 45 feet channelward there from. The proposed work on the right descending bank is to be within an area of approximately 600 feet long and 55 feet wide, located approximately parallel to the mean low water shoreline, the outer edge to be approximately 50 feet channelward there from. Approximately 37,560 cubic yards of broken concrete is to be placed along the banks of the Amite River as a result of project implementation. Since the original permit authorization, no work has been performed along the left descending bank, while approximately 600 feet of the right descending bankline has been armored

with riprap material but no land reclamation has been performed. The proposed project will impact waterbottoms and no forested wetlands are proposed to be directly impacted as a result of the project. The applicant has designed the project to avoid and minimize direct and secondary adverse impacts to the maximum extent practicable.

The comment period for the Department of Army will close in **20 days** from the date of this joint public notice. Written comments, including suggestions for modifications or objections to the proposed work, stating reasons thereof, are being solicited from anyone having interest in this permit and/or this WQC request and must be mailed so as to be received before or by the last day of the comment period. Letters concerning the Corps of Engineers permit application must reference the applicant's name and the Permit Application Number, and be mailed to the Corps of Engineers at the address above, **ATTENTION: REGULATORY BRANCH**. Similar letters concerning the Water Quality Certification must reference the applicant's name and the WQC application number and be mailed to the Louisiana Department of Environmental Quality at the address above. Individuals or parties may request an extension of time in which to comment on the proposed work by writing or e-mailing the Corps of Engineers Project Manager listed above. Any request must be specific and substantively supportive of the requested extension, and received by this office prior to the end of the initial comment period. The Section Chief will review the request and the requestor will be promptly notified of the decision to grant or deny the request. If granted, the time extension will be continuous to the initial comment period and, inclusive of the initial comment period, will not exceed a total of 30 calendar days.

The application for this proposed project is on file with the Louisiana Department of Environmental Quality and may be examined during weekdays between 8:00 a.m. and 4:30 p.m. Copies may be obtained upon payment of costs of reproduction.

### **Corps of Engineers Permit Criteria**

The decision whether to issue a permit will be based on an evaluation of the probable impacts, including cumulative impacts of the proposed activity on the public interest. That decision will reflect the national concern for both protection and utilization of important resources. The benefit which reasonably may be expected to accrue from the proposal must be balanced against its reasonably foreseeable detriments. All factors which may be relevant to the proposal will be considered including the cumulative effects thereof; among those are conservation, economics, aesthetics, general environmental concerns, wetlands, historic properties, fish and wildlife values, flood hazards, floodplain values, land use, navigation, shoreline erosion and accretion, recreation, water supply and conservation, water quality, energy needs, safety, food and fiber production, mineral needs, considerations of property ownership and, in general, the needs and welfare of the people.

The US Army Corps of Engineers is soliciting comments from the public, federal, state, and local agencies and officials, Indian Tribes, and other interested parties in order to consider and evaluate the impacts of this proposed activity. Any comments received will be considered by the US Army Corps of Engineers to determine whether to make, modify, condition, or deny a permit for this proposal. To make this decision, comments are used to assess impacts on endangered species, historic properties, water quality, general environmental effects, and other public interest factors listed above. Comments are used in the preparation of an Environmental Assessment and/or an Environmental Impact Statement pursuant to the National Environmental Policy Act. Comments are also used to determine the need for a public hearing and to determine the overall public interest

of the proposed activity.

No properties listed on the National Register of Historic Places are near the proposed work. The possibility exists that the proposed work may damage or destroy presently unknown archeological, scientific, prehistorical, historical sites, or data. Copies of this notice are being sent to the State Archeologist and the State Historic Preservation Officer.

Our initial finding is that the proposed work would neither affect any species listed as endangered by the U.S. Departments of Interior or Commerce, nor affect any habitat designated as critical to the survival and recovery of any endangered species.

This notice initiates the Essential Fish Habitat (EFH) consultation requirements of the Magnuson-Stevens Fishery Conservation and Management Act. The applicant's proposal would result in the destruction or alteration of up to **n/a** acres of EFH utilized by various life stages of red drum and penaeid shrimp. Our initial determination is that the proposed action would not have a substantial adverse impact on EFH or federally managed fisheries in the Gulf of Mexico. Our final determination relative to project impacts and the need for mitigation measures is subject to review by and coordination with the National Marine Fisheries Service.

If the proposed work involves deposits of dredged or fill material into navigable waters, the evaluation of the probable impacts will include the application of guidelines established by the Administrator of the Environmental Protection Agency. Also, a certification that the proposed activity will not violate water quality standards will be required from the Department of Environmental Quality, Office of Environmental Services before a permit is issued.

Any person may request, in writing, within the comment period specified in this notice, that a public hearing be held to consider this application. Requests for public hearings shall state, with particularity, the reasons for holding a public hearing. You are requested to communicate the information contained in this notice to any other parties whom you deem likely to have interest in the matter.

JOHN M. HERMAN  
Chief, Central Evaluation Section  
Regulatory Branch

Enclosures

BATON ROUGE (CAPITOL) 25 MI.  
LITTLE PRAIRIE 3.4 MI.

Sutherland Property  
(near "Original" Mile 34)

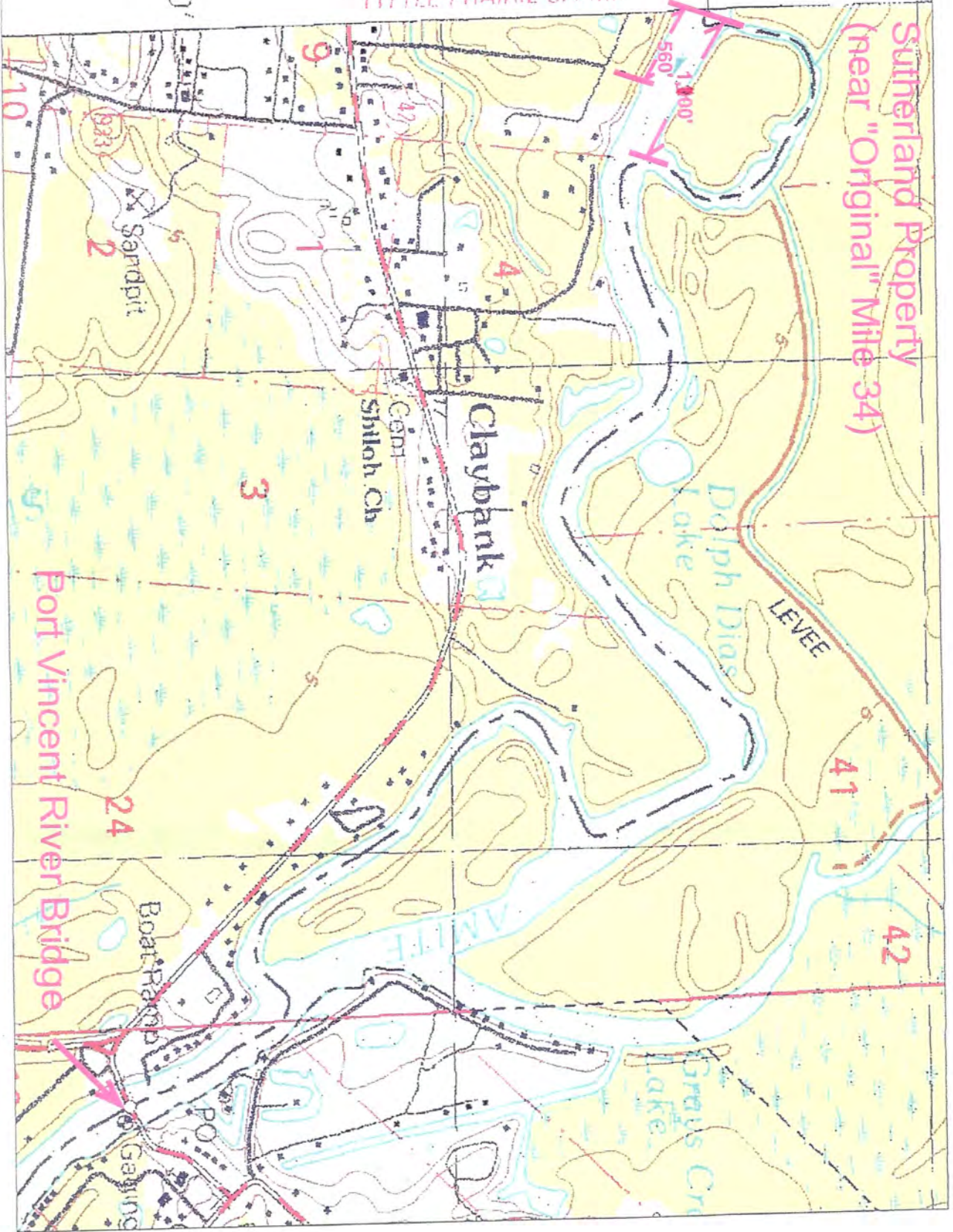

PLAN VIEW / VICINITY MAP



3359

Sutherland Property  
(near "Original" Mile 34)

BATON ROUGE (CAPITOL) 25 MI.  
LITTLE PRAIRIE 3.4 MI.

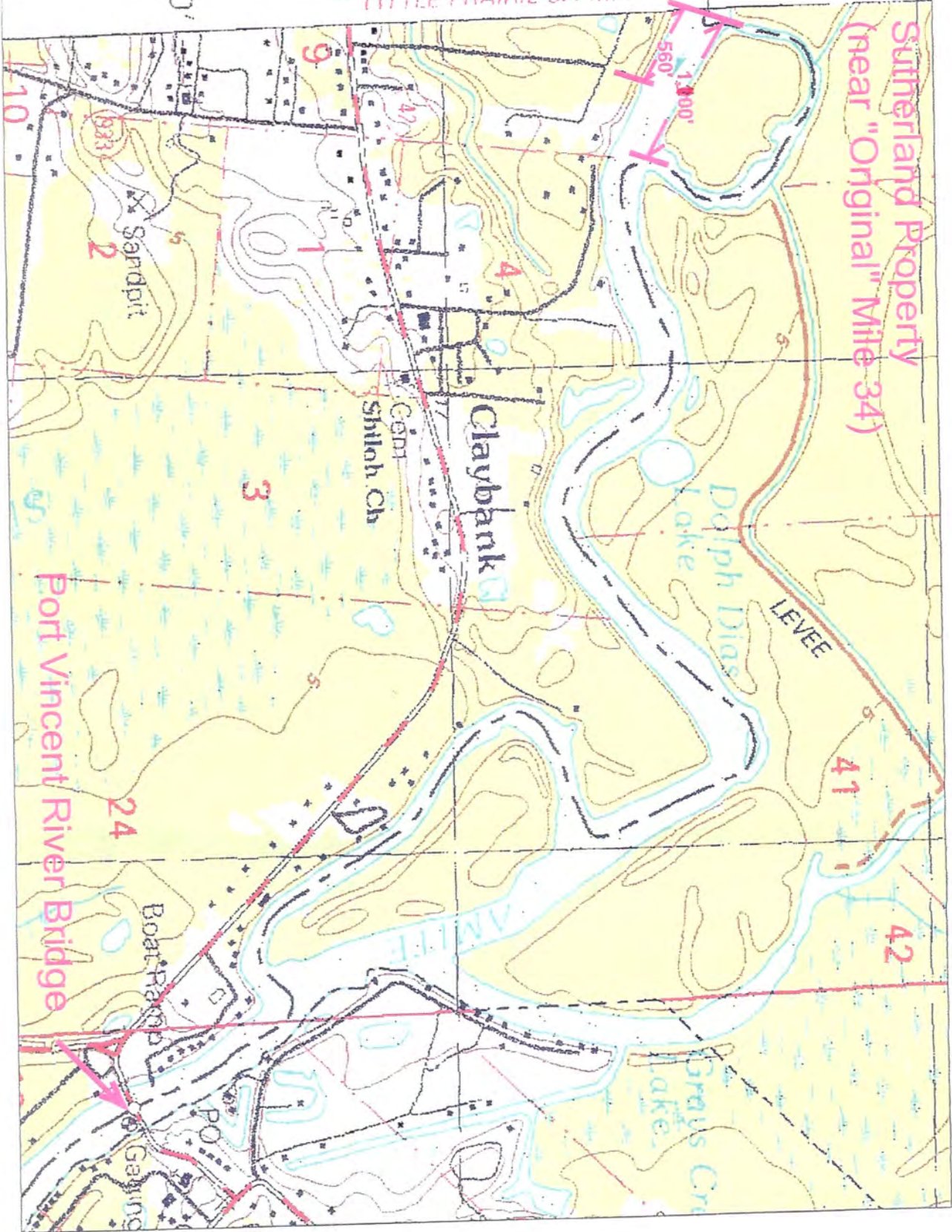

PLAN VIEW / VICINITY MAP

AMITE RIVER PROFILE AT  
 SUTHERLAND PROPERTY (MILE 34)  
 ON NOV. 5, 2012

UP TO 37,360 CU. YDS. OF BROKEN  
 CONCRETE RIP-RAP FILL AUTHORIZED  
 TO RESTORE CANAL BANKS TO  
 THEIR ORIGINAL LOCATION.

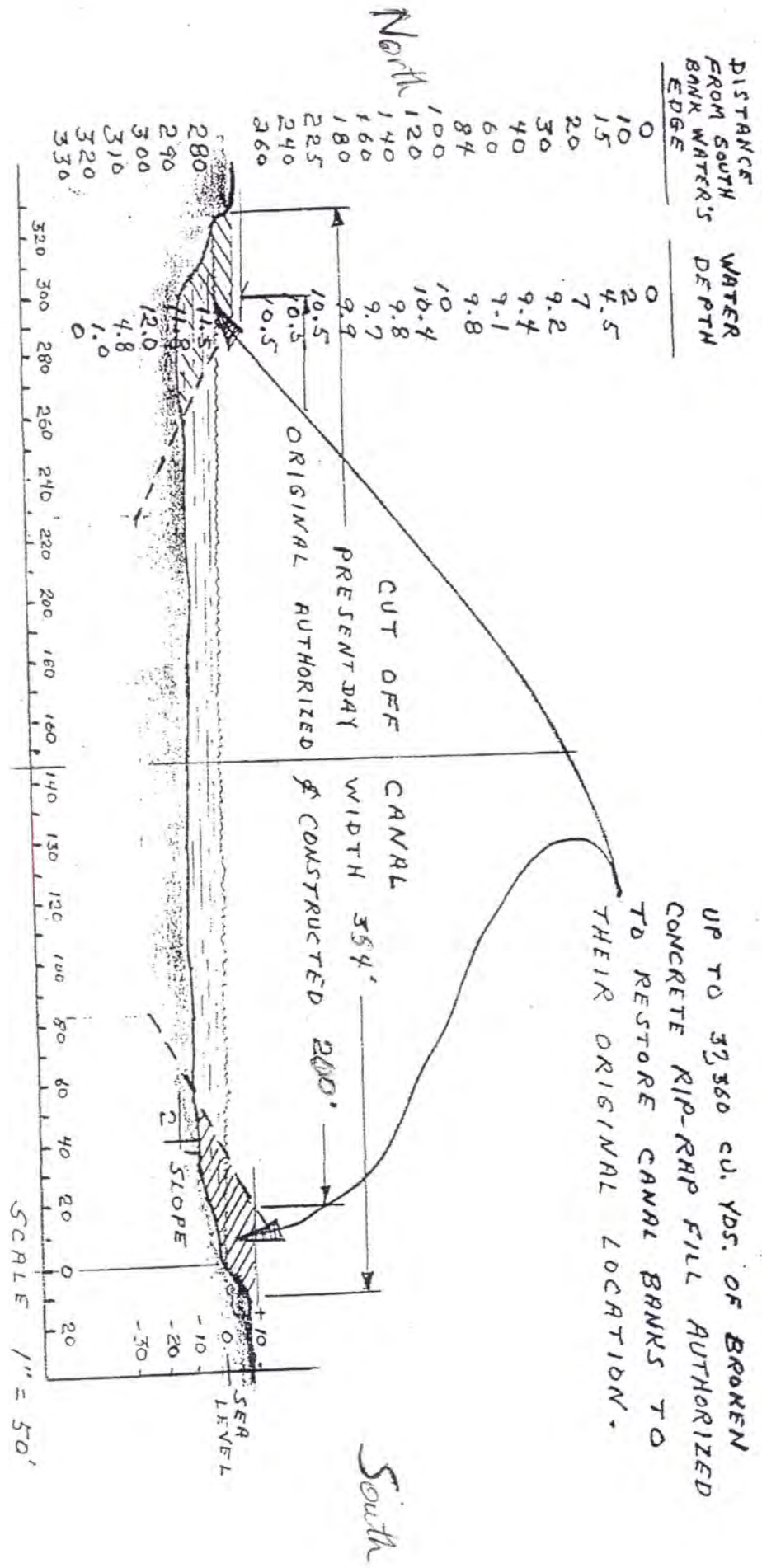

South



AMITE RIVER PROFILE AT  
 SUTHERLAND PROPERTY (MILE 34)  
 ON NOV. 5, 2012

UP TO 37,560 CU. YDS. OF BROKEN  
 CONCRETE RIP-RAP FILL AUTHORIZED  
 TO RESTORE CANAL BANKS TO  
 THEIR ORIGINAL LOCATION.

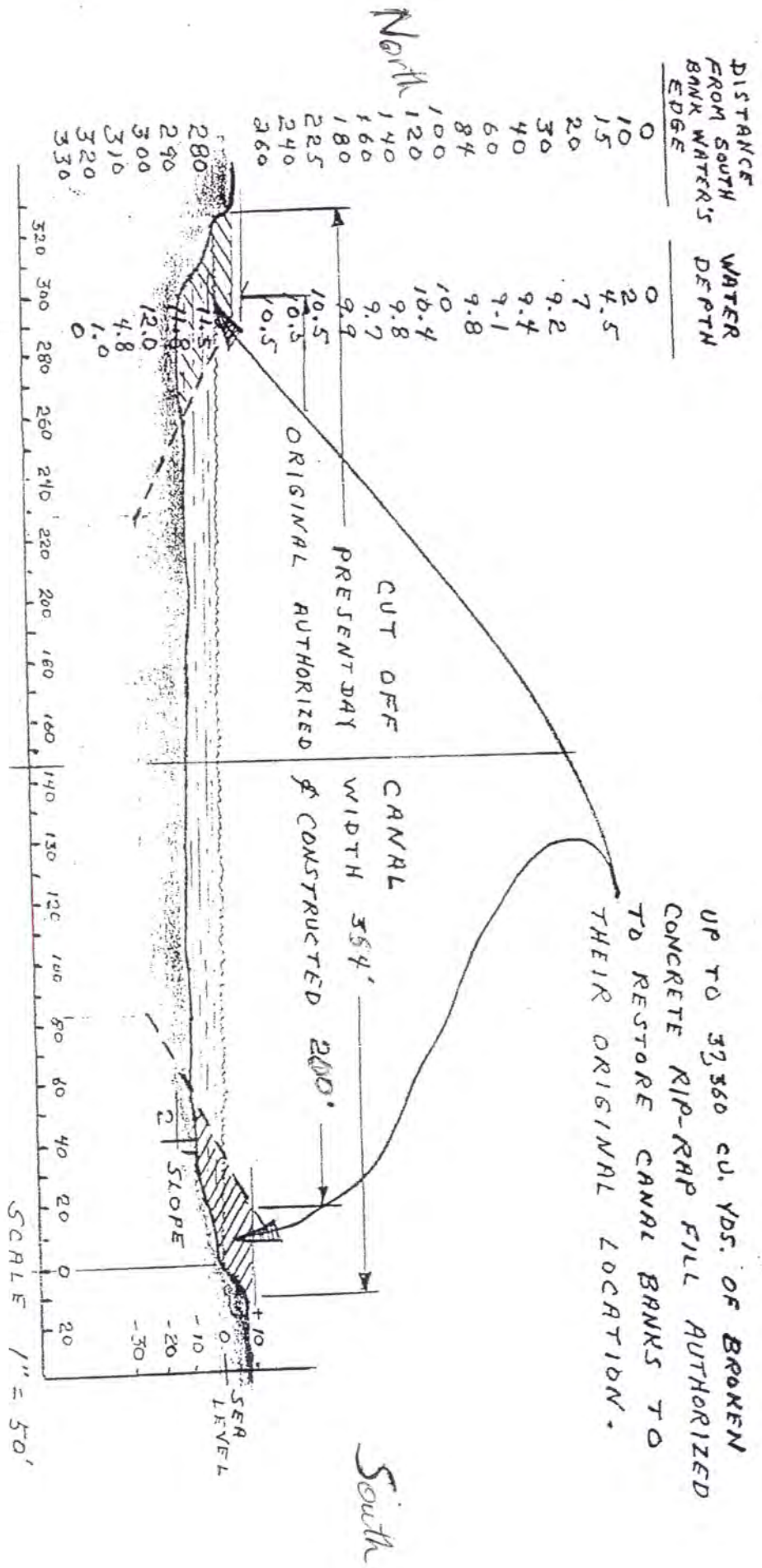

Southside Bank has been armored, No land Reclamation

3359

BATON ROUGE (CAPITOL) 25 MI.  
LITTLE PRAIRIE 3.4 MI.

Sutherland Property  
(near "Original" Mile 34)

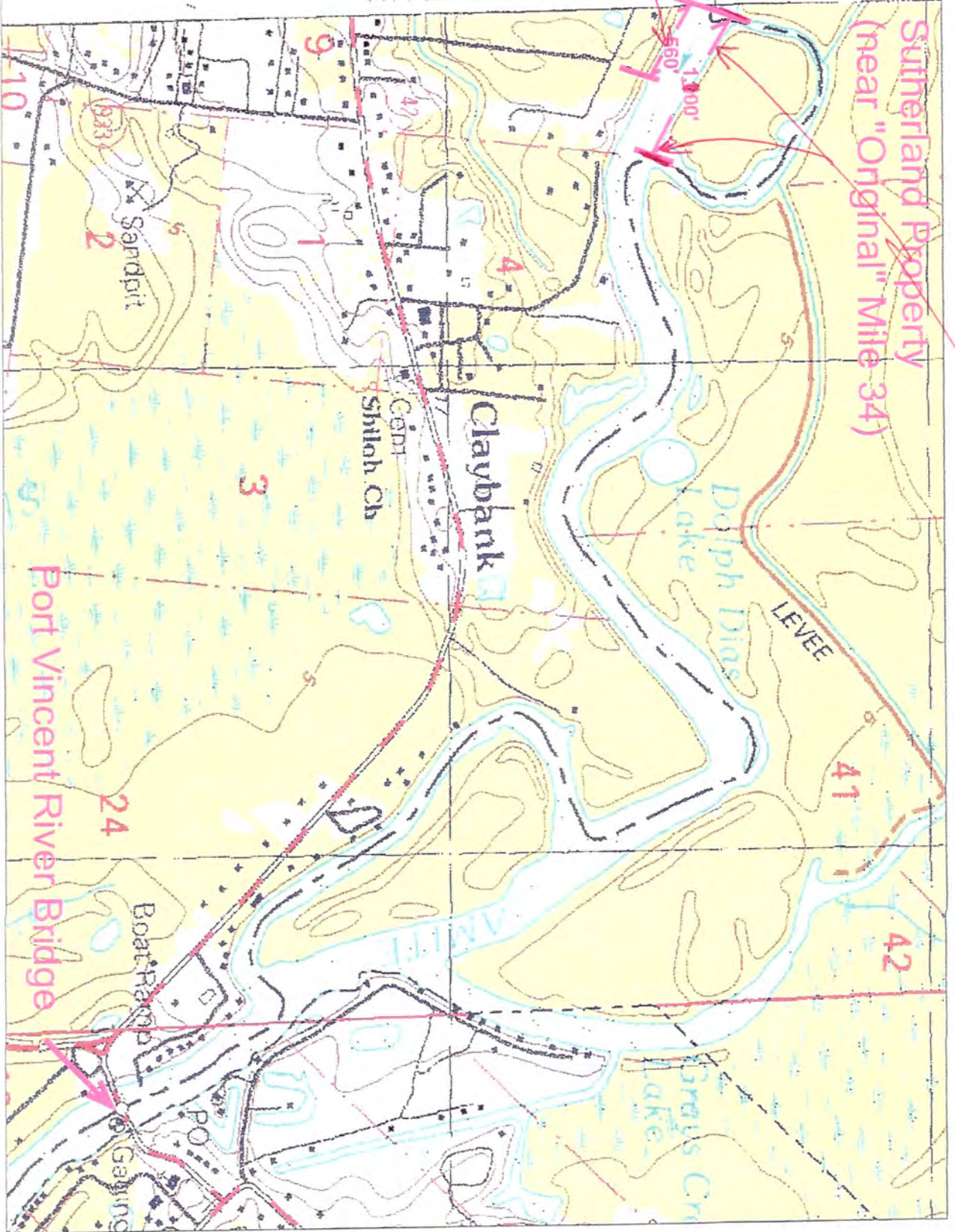

No work started on North side

PLAN VIEW / VICINITY MAP



AMITE RIVER PROFILE AT  
 SUTHERLAND PROPERTY (MILE 34)  
 ON NOV. 5, 2012

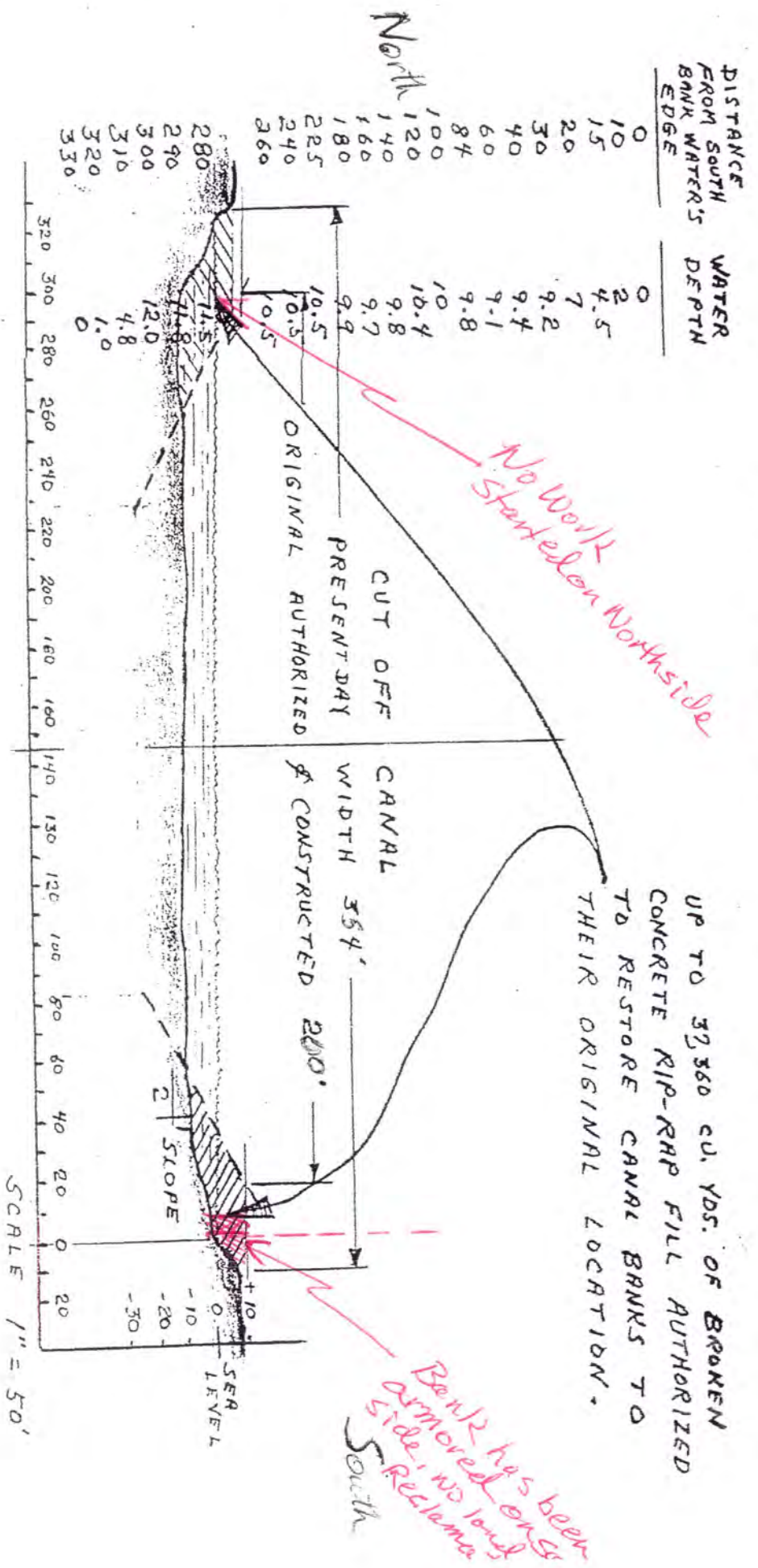

UP TO 32,560 CU. YDS. OF BROKEN  
 CONCRETE RIP-RAP FILL AUTHORIZED  
 TO RESTORE CANAL BANKS TO  
 THEIR ORIGINAL LOCATION.

*Bank has been armored on one side, no land Reclamation South*

*No work started on Northside*

SCALE 1" = 50'