

JOINT PUBLIC NOTICE

October 28, 2013

United States Army
Corps of Engineers
New Orleans District
Regulatory Branch
Post Office Box 60267
New Orleans, Louisiana 70160-0267

(504) 862-2225
Brad.LaBorde@usace.army.mil
Project Manager
Brad LaBorde
Permit Application Number
MVN 2001-0672 EOO

State of Louisiana
Department of Environmental Quality
ATTN: Water Quality Certifications
Post Office Box 4313
Baton Rouge, Louisiana 70821-4313

(225) 219-3225
Project Manager
Jamie Phillippe
WQC Application Number
WQC 001212-5

Interested parties are hereby notified that a permit application has been received by the New Orleans District of the U.S. Army Corps of Engineers pursuant to: [] Section 10 of the Rivers and Harbors Act of March 3, 1899 (30 Stat. 1151; 33 USC 403); and/or [X] Section 404 of the Clean Water Act (86 Stat. 816; 33 USC 1344).

Application has also been made to the Louisiana Department of Environmental Quality, Water Quality Certifications, for a Water Quality Certification (WQC) in accordance with statutory authority contained in LRS30:2047 A(3), and provisions of Section 401 of the Clean Water Act (P.L.95-17).

Permit Modification: Fritchie Park in Slidell, LA

NAME OF APPLICANT: City of Slidell – Recreation Department % J.V. Burkes & Associates, ATTN: Barbara Zelenka, 1805 Shortcut Highway, Slidell, Louisiana, 70458.

LOCATION OF WORK: Near the corner of Howze Beach Road and Spartan Drive at Fritchie Park in Slidell, Louisiana, Saint Tammany Parish, as shown on the enclosed drawings.

Latitude: 30.246/Longitude: -89.776; Hydrologic Unit Code: 08090201 – Liberty Bayou-Tchefuncte River

CHARACTER OF WORK: Clear, grade, excavate, and deposit fill to construct a dog park and additional recreational trails in Fritchie Park. The dog park and associated walking paths will be constructed primarily in uplands and tie into crushed limestone paths that will extend through 0.64 acres of pine flatwood wetlands. The applicant proposes a 10-foot right-of-way for the 6-foot wide limestone walking path. The remaining wooded wetlands surrounding the walking path (1.6 acres) would be selectively thinned and underbrushed to increase park safety and aesthetics. Pine saplings and herbaceous vegetation would be cut by hand and hauled off. Mature oaks and pine trees will be avoided.

The original permit authorization for Fritchie Park included a 5.43 acre walking path around the existing pond. The applicant also agreed to purchase 5.5 acres of compensatory mitigation credits to compensate for the impacts associated with the project. Of the original 5.43 acres permitted for the walking path, 0.44 acres were constructed to the east and south of the pond. The applicant proposes

to apply a portion of the remaining mitigation credits (approximately 5 acres) to offset the proposed 0.64 acres of impacts associated with this permit modification.

The comment period for the Department of the Army Permit and the Louisiana Department of Environmental Quality WQC will close **20 days** from the date of this joint public notice. Written comments, including suggestions for modifications or objections to the proposed work, stating reasons thereof, are being solicited from anyone having interest in this permit and/or this WQC request and must be mailed so as to be received before or by the last day of the comment period. Letters concerning the Corps of Engineers permit application must reference the applicant's name and the Permit Application Number, and be mailed to the Corps of Engineers at the address above, **ATTENTION: REGULATORY BRANCH. Similar letters concerning the Water Quality Certification must reference the applicant's name and the WQC Application number and be mailed to the Louisiana Department of Environmental Quality at the address above. Individuals or parties may request an extension of time in which to comment on the proposed work by writing or e-mailing the Corps of Engineers Project Manager listed above. Any request must be specific and substantively supportive of the requested extension, and received by this office prior to the end of the initial comment period. The Section Chief will review the request and the requestor will be promptly notified of the decision to grant or deny the request. If granted, the time extension will be continuous to the initial comment period and, inclusive of the initial comment period, will not exceed a total of 30 calendar days.**

The application for this proposed project is on file with the Louisiana Department of Environmental Quality and may be examined during weekdays between 8:00 a.m. and 4:30 p.m. Copies may be obtained upon payment of costs of reproduction.

Corps of Engineers Permit Criteria

The decision whether to issue a permit will be based on an evaluation of the probable impacts, including cumulative impacts of the proposed activity on the public interest. That decision will reflect the national concern for both protection and utilization of important resources. The benefit which reasonably may be expected to accrue from the proposal must be balanced against its reasonably foreseeable detriments. All factors which may be relevant to the proposal will be considered including the cumulative effects thereof; among those are conservation, economics, aesthetics, general environmental concerns, wetlands, historic properties, fish and wildlife values, flood hazards, floodplain values, land use, navigation, shoreline erosion and accretion, recreation, water supply and conservation, water quality, energy needs, safety, food and fiber production, mineral needs, considerations of property ownership and, in general, the needs and welfare of the people.

The U.S. Army Corps of Engineers is soliciting comments from the public, federal, state, and local agencies and officials, Indian Tribes, and other interested parties in order to consider and evaluate the impacts of this proposed activity. Any comments received will be considered by the U.S. Army Corps of Engineers to determine whether to make, modify, condition, or deny a permit for this proposal. To make this decision, comments are used to assess impacts on endangered species, historic properties, water quality, general environmental effects, and other public interest factors listed above. Comments are used in the preparation of an Environmental Assessment and/or an Environmental Impact Statement pursuant to the National Environmental Policy Act. Comments are also used to determine the need for a public hearing and to determine the overall public interest of the proposed activity.

The New Orleans District is unaware of properties listed on the National Register of Historic Places near the proposed work. The possibility exists that the proposed work may damage or destroy presently unknown archeological, scientific, prehistorical, historical sites, or data. Issuance of this public notice solicits input from the State Archeologist and State Historic Preservation Officer regarding potential impacts to cultural resources.

This notice initiates the Essential Fish Habitat (EFH) consultation requirements of the Magnuson-Stevens Fishery Conservation and Management Act. The applicant's proposal would result in the destruction or alteration of **N/A** acres of EFH utilized by various life stages of red drum and penaeid shrimp. Our initial determination is that the proposed action would not have a substantial adverse impact on EFH or federally managed fisheries in the Gulf of Mexico. Our final determination relative to project impacts and the need for mitigation measures is subject to review by and coordination with the National Marine Fisheries Service.

If the proposed work involves deposits of dredged or fill material into navigable waters, the evaluation of the probable impacts will include the application of guidelines established by the Administrator of the Environmental Protection Agency. Also, a certification that the proposed activity will not violate applicable water quality standards will be required from the Department of Environmental Quality, Water Quality Certifications, before a permit is issued.

Any person may request, in writing, within the comment period specified in this notice, that a public hearing be held to consider this application. Requests for public hearings shall state, with particularity, the reasons for holding a public hearing.

The applicant has certified that the proposed activity described in the application complies with and will be conducted in a manner that is consistent with the Louisiana Coastal Resources Program. The Department of the Army permit will not be issued unless the applicant received approval or a waiver of the Coastal Use Permit by the Department of Natural Resources.

You are requested to communicate the information contained in this notice to any other parties whom you deem likely to have interest in the matter.

Michael V. Farabee
Chief, Eastern Evaluation Section

Enclosure

Location Map

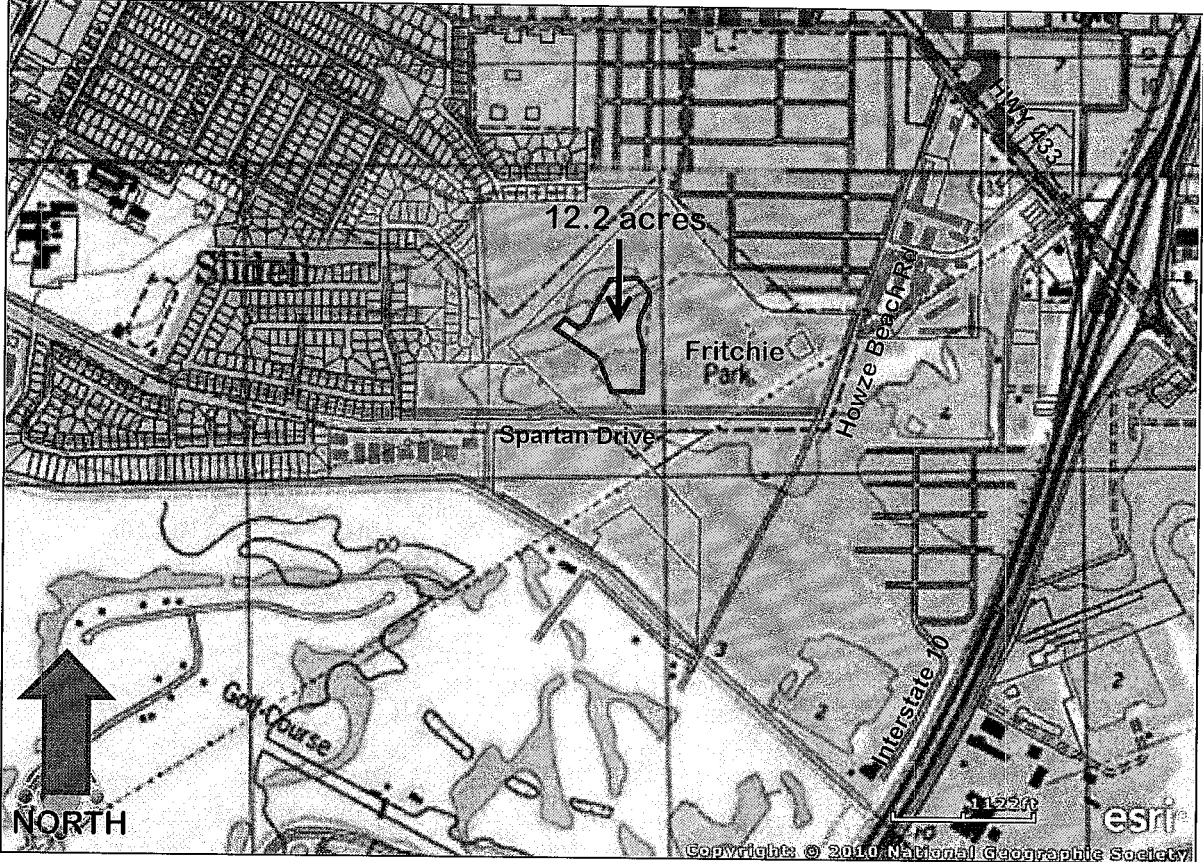

A Portion of Fritchie Park
Containing Approximately 12.2 Acres Located in
Sections 44 - T9S - R14E
City of Slidell, St. Tammany Parish, LA

30° 14' 45.85" N / 89° 46' 35.00" W

GRAPHIC SCALE



(IN FEET)
1 INCH = 150 FEET

WETLAND
1.8 acres pine flatwood

Improve habitat and provide safety in natural park area - Select cutting of wooded area, remove fallen debris, thin understory, maintain natural ground elevations.

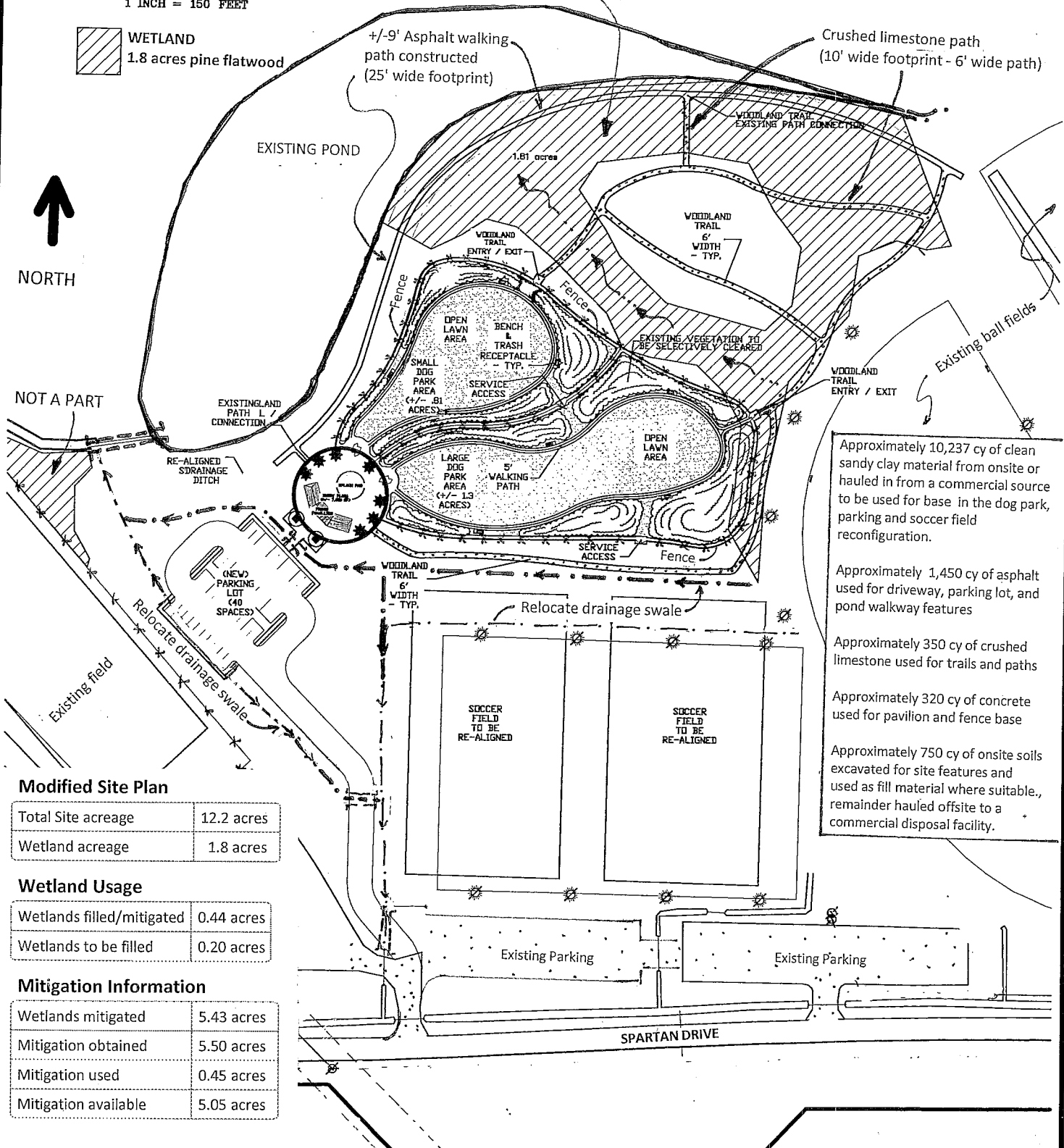

- Approximately 10,237 cy of clean sandy clay material from onsite or hauled in from a commercial source to be used for base in the dog park, parking and soccer field reconfiguration.
- Approximately 1,450 cy of asphalt used for driveway, parking lot, and pond walkway features
- Approximately 350 cy of crushed limestone used for trails and paths
- Approximately 320 cy of concrete used for pavilion and fence base
- Approximately 750 cy of onsite soils excavated for site features and used as fill material where suitable., remainder hauled offsite to a commercial disposal facility.

Modified Site Plan

Total Site acreage	12.2 acres
Wetland acreage	1.8 acres

Wetland Usage

Wetlands filled/mitigated	0.44 acres
Wetlands to be filled	0.20 acres

Mitigation Information

Wetlands mitigated	5.43 acres
Mitigation obtained	5.50 acres
Mitigation used	0.45 acres
Mitigation available	5.05 acres

SITE PLAN

Proposed dog park, recreation trails, reconfigured soccer field at Fritchie Park
 Located in Section 44 - T9S - R14E,
 City of Slidell, St. Tammany Parish, LA
 for City of Slidell Recreation Department

Scale: 1" = 150'

Date: 8-6-13

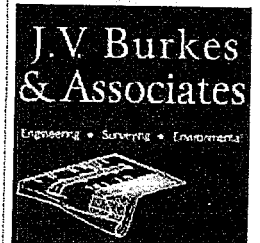

Typical Profile A-A

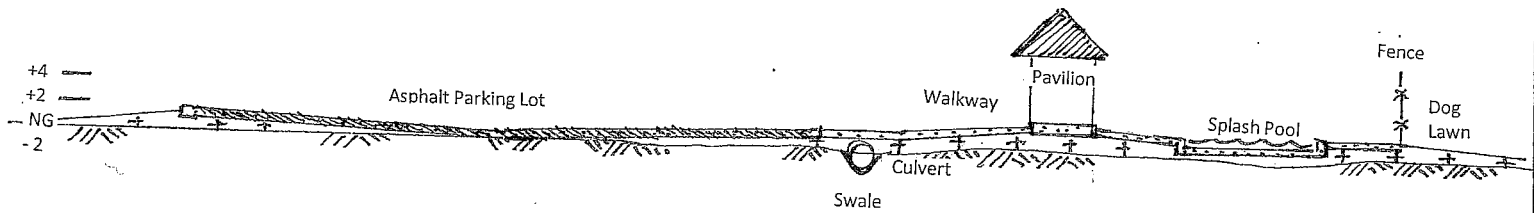

Approximately 10,237 cy of clean sandy clay material from onsite or hauled in from a commercial source to be used for base in the dog park, parking and soccer field reconfiguration.

Approximately 1,450 cy of asphalt used for driveway, parking lot, and pond walkway features

Approximately 350 cy of crushed limestone used for trails and paths

Approximately 320 cy of concrete used for pavilion and fence base

Approximately 750 cy of onsite soils excavated for site features and used as fill material where suitable., remainder hauled offsite to a commercial disposal facility.

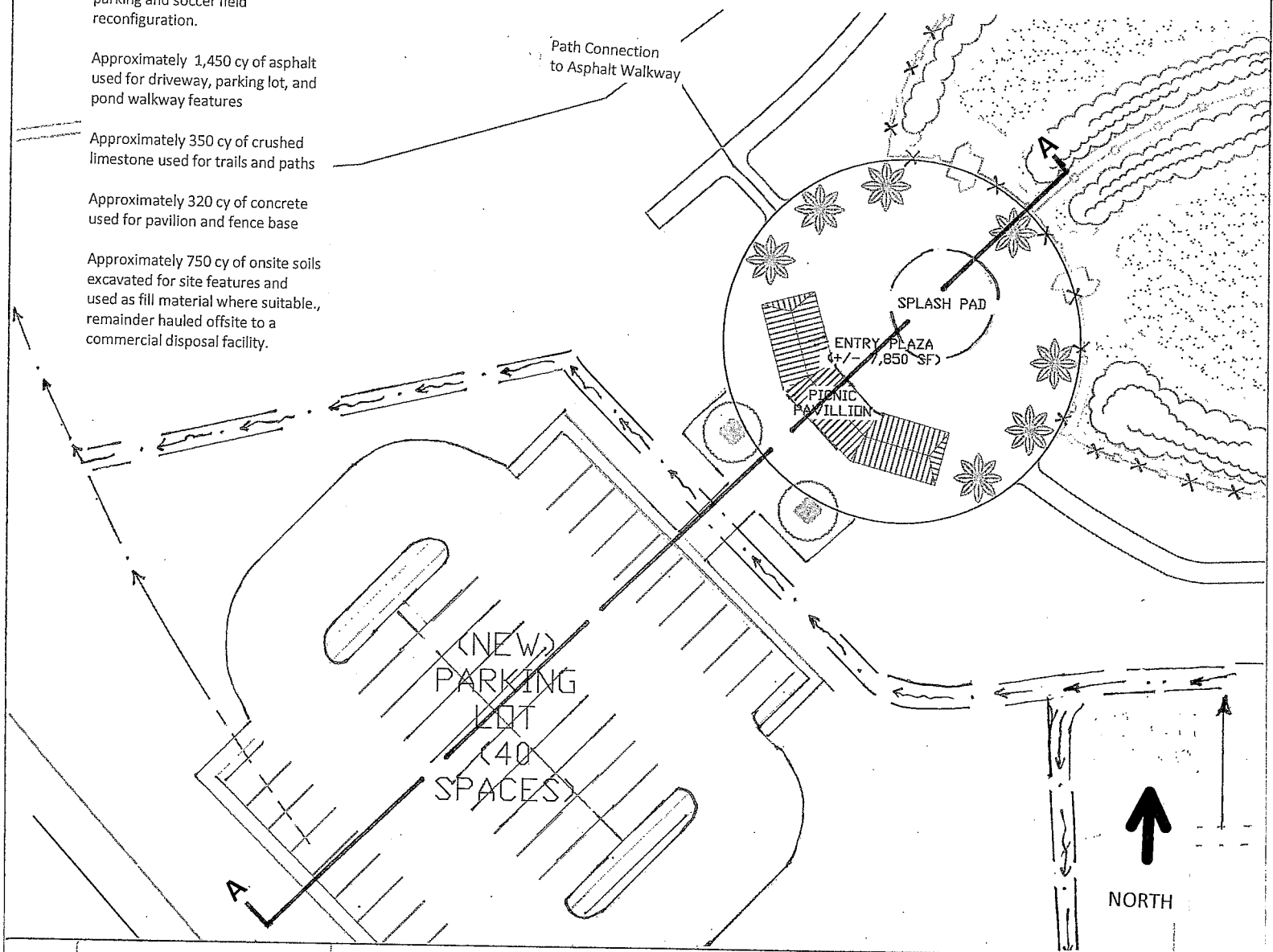

Parking & Pavilion Detail and Profile

Scale: NTS

Date: 8-6-13

Proposed dog park, recreation trails, reconfigured soccer field at Fritchie Park
 Located in Section 44 - T9S - R14E,
 City of Slidell, St. Tammany Parish, LA
 for City of Slidell Recreation Department

J.V. Burkes & Associates
 Engineering • Surveying • Environmental

Typical Crushed Limestone Path at Culvert Crossing

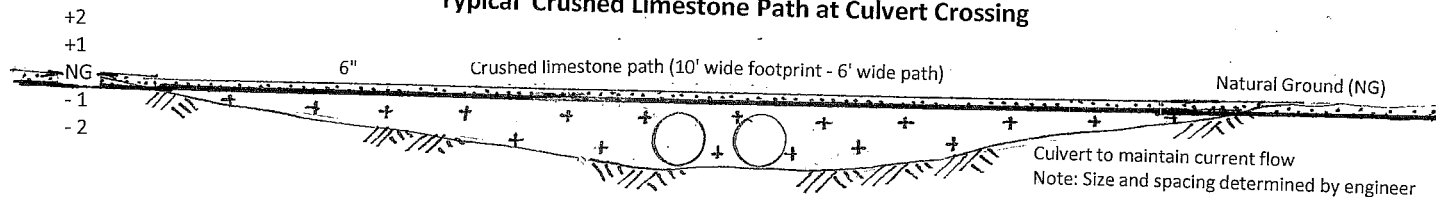

Typical Crushed Limestone Path Profile with Culvert

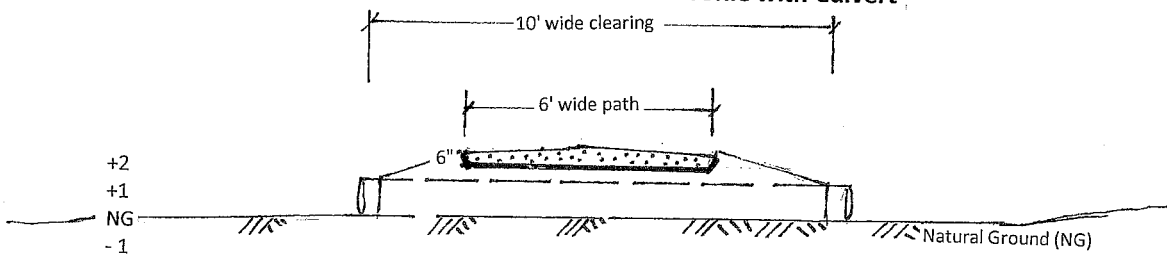

Typical Crushed Limestone Path Profile

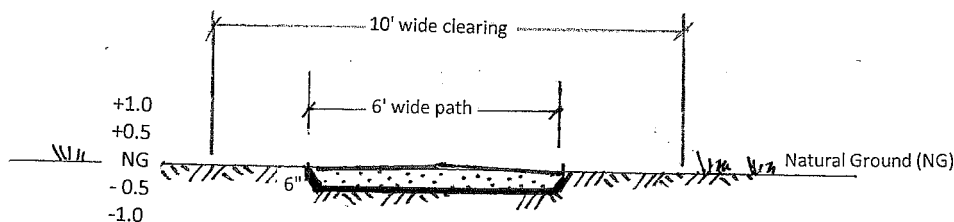

Typical Profile of Existing Asphalt Path Along Pond

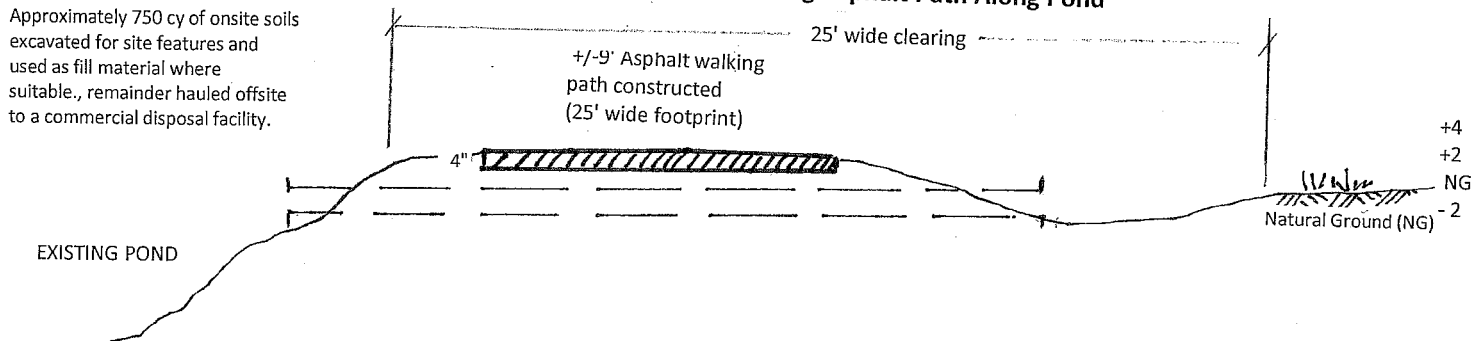

Approximately 10,237 cy of clean sandy clay material from onsite or hauled in from a commercial source to be used for base in the dog park, parking and soccer field reconfiguration.

Approximately 1,450 cy of asphalt used for driveway, parking lot, and pond walkway features

Approximately 350 cy of crushed limestone used for trails and paths

Approximately 320 cy of concrete used for pavilion and fence base

Approximately 750 cy of onsite soils excavated for site features and used as fill material where suitable., remainder hauled offsite to a commercial disposal facility.

TYPICAL PATH PROFILES

H Scale: NTS
V Scale: NTS

Date: 8-6-13

Proposed dog park, recreation trails, reconfigured soccer field at Fritchie Park
Located in Section 44 - T9S - R14E,
City of Slidell, St. Tammany Parish, LA
for City of Slidell Recreation Department

J.V. Burkes & Associates

Engineering • Surveying • Environmental



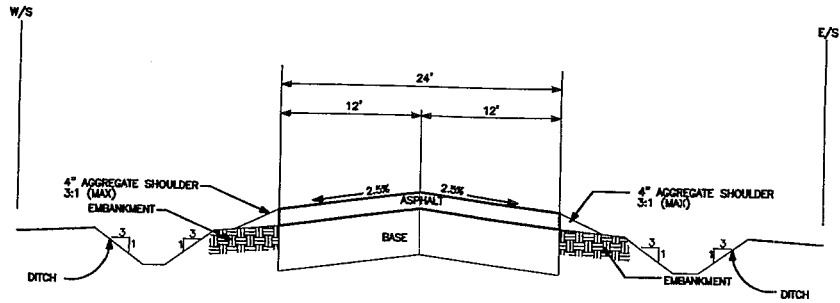

Typical Driveway Detail Profile

NTS

Approximately 10,237 cy of clean sandy clay material from onsite or hauled in from a commercial source to be used for base in the dog park, parking and soccer field reconfiguration.

Approximately 1,450 cy of asphalt used for driveway, parking lot, and pond walkway features

Approximately 350 cy of crushed limestone used for trails and paths

Approximately 320 cy of concrete used for pavilion and fence base

Approximately 750 cy of onsite soils excavated for site features and used as fill material where suitable., remainder hauled offsite to a commercial disposal facility.

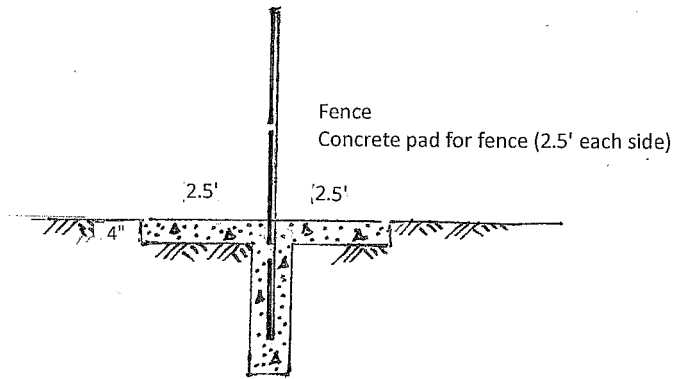

Typical Fence Profile

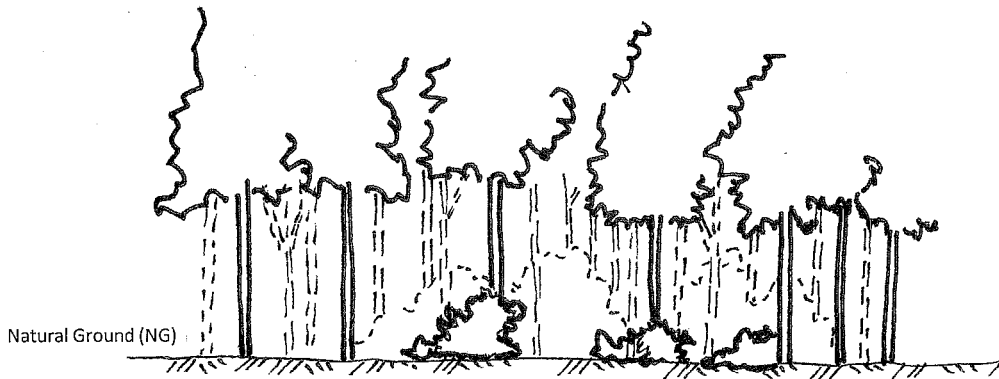

Improve habitat and provide safety in natural park area - Select cutting of wooded area, remove fallen debris, thin understory, maintain natural ground elevations.

Typical Natural Wooded Area Profile

Typical Profiles

H Scale: NTS

V Scale: NTS

Date: 8-6-13

Proposed dog park, recreation trails, reconfigured soccer field at Fritchie Park
 Located in Section 44 - T9S - R14E,
 City of Slidell, St. Tammany Parish, LA
 for City of Slidell Recreation Department

