

JOINT PUBLIC NOTICE

November 19, 2018

United States Army
Corps of Engineers
New Orleans District
Regulatory Branch
7400 Leake Avenue
New Orleans, Louisiana 70118

(504) 862-2259
Project Manager
Scott N. Kennedy
scott.n.kennedy@usace.army.mil
Permit Application Number
MVN 2000-02487 EMM

State of Louisiana
Department of Environmental Quality
Attn: Water Quality Certifications
Post Office Box 4313
Baton Rouge, Louisiana 70821-4313

(225) 219-3225
Project Manager
Elizabeth Hill
WQC Application Number
WQC 181107-03

Interested parties are hereby notified that a permit application has been received by the New Orleans District of the U.S. Army Corps of Engineers pursuant to: [X] Section 10 of the Rivers and Harbors Act of March 3, 1899 (30 Stat. 1151; 33 USC 403); and/or [X] Section 404 of the Clean Water Act (86 Stat. 816; 33 USC 1344).

Application has also been made to the Louisiana Department of Environmental Quality, Water Quality Certifications, for a Water Quality Certification (WQC) in accordance with statutory authority contained in LRS 30:2074 A(3) and provisions of Section 401 of the Clean Water Act.

INSTALL AND MAINTAIN NEW SHIP MOORING IN THE MISSISSIPPI RIVER IN JEFFERSON PARISH

NAME OF APPLICANT: Wood Resources, LLC c/o Lanier & Associates Engineers, 4101 Magazine Street, New Orleans, Louisiana 70115.

LOCATION OF WORK: Sections 31, Township 13 South, Range 22 East, in the Mississippi River, RDB, mile 109.5, in Avondale, Louisiana, in Jefferson Parish, as shown on the attached drawings.

HUC: 08090301: East Central Louisiana Coastal
Latitude: 29.932553 Longitude: -90.220461

CHARACTER OF WORK: Install and maintain an additional midstream ship mooring with five anchor piles and mooring hardware or a block fleeting operation consisting of 12 river barges (200' x 35') instead of a ship mooring when a ship is not in berth in Avondale, Louisiana. The new berth will be in line with the existing ship berths and the barges will occupy the same footprint as the potentially moored vessel. The applicant contends jurisdictional wetlands will not be impacted, as such compensatory mitigation is not anticipated at this time.

This is a modification to the previously issued permit MVN 2000-02487 EFF and Mississippi River 1169.

The comment period for the Department of the Army Permit and the Louisiana Department of Environmental Quality WQC will close **30 days** from the date of this joint public notice. Written comments, including suggestions for modifications or objections to the proposed work, stating reasons thereof, are being solicited from anyone having interest in this permit and/or this WQC request and must be mailed so as to be received before or by the last day of the comment period. Letters concerning

the Corps of Engineers permit application must reference the applicant's name and the Permit Application Number, and be mailed to the Corps of Engineers at the address above, **ATTENTION: REGULATORY BRANCH**. Similar letters concerning the Water Quality Certification must reference the applicant's name and the WQC Application number and be mailed to the Louisiana Department of Environmental Quality at the address above.

The application for this proposed project is on file with the Louisiana Department of Environmental Quality and may be examined weekdays between 8:00 a.m. and 4:30 p.m. Copies may be obtained upon payment of costs of reproduction.

Corps of Engineers Permit Criteria

The decision whether to issue a permit will be based on an evaluation of the probable impacts, including cumulative impacts of the proposed activity on the public interest. That decision will reflect the national concern for both protection and utilization of important resources. The benefit which reasonably may be expected to accrue from the proposal must be balanced against its reasonably foreseeable detriments. All factors which may be relevant to the proposal will be considered including the cumulative effects thereof; among those are conservation, economics, aesthetics, general environmental concerns, wetlands, historic properties, fish and wildlife values, flood hazards, floodplain values, land use, navigation, shoreline erosion and accretion, recreation, water supply and conservation, water quality, energy needs, safety, food and fiber production, mineral needs, considerations of property ownership and, in general, the needs and welfare of the people.

The U.S. Army Corps of Engineers is soliciting comments from the public, federal, state, and local agencies and officials, Indian Tribes, and other interested parties in order to consider and evaluate the impacts of this proposed activity. Any comments received will be considered by the U.S. Army Corps of Engineers to determine whether to make, modify, condition, or deny a permit for this proposal. To make this decision, comments are used to assess impacts on endangered species, historic properties, water quality, general environmental effects, and other public interest factors listed above. Comments are used in the preparation of an Environmental Assessment and/or an Environmental Impact Statement pursuant to the National Environmental Policy Act. Comments are also used to determine the need for a public hearing and to determine the overall public interest of the proposed activity.

The New Orleans District is unaware of properties listed on the National Register of Historic Places near the proposed work. The possibility exists that the proposed work may damage or destroy presently unknown archeological, scientific, prehistorical, historical sites, or data. Issuance of the public notice solicits input from the State Archeologist and State Historic Preservation Office regarding potential impacts to cultural resources.

The New Orleans District has determined that the proposed work would neither affect any species or critical habitat listed as endangered by the U.S. Department of Commerce.

Utilizing Standard Local Operating Procedure for Endangered Species in Louisiana (SLOPES), dated October 22, 2014, between the U.S. Army Corps of Engineers, New Orleans and U.S. Fish and Wildlife Service, Ecological Services Office, the Corps has determined that the proposed activity would have no effect on any listed species.

This notice initiates the Essential Fish Habitat (EFH) consultation requirements of the Magnuson-Stevens Fishery Conservation and Management Act. The applicant's proposal would result in the destruction or alteration of up to n/a acres of EFH utilized by various life stages of red drum and penaeid shrimp. Our initial determination is that the proposed action would not have a substantial adverse impact on EFH or federally managed fisheries in the Gulf of Mexico. Our final determination relative to project impacts and the need for mitigation measures is subject to review by and coordination with the National Marine Fisheries Service.

If the proposed work involves deposits of dredged or fill material into navigable waters, the evaluation of the probable impacts will include the application of guidelines established by the Administrator of the Environmental Protection Agency. Also, a certification that the proposed activity will not violate water quality standards will be required from the Department of Environmental Quality, Water Quality Certifications, before a permit is issued.

Any person may request, in writing, within the comment period specified in this notice, that a public hearing be held to consider this application. Requests for public hearings shall state, with particularity, the reasons for holding a public hearing.

The applicant has certified that the proposed activity described in the application complies with and will be conducted in a manner that is consistent with the Louisiana Coastal Resources Program. The Department of the Army permit will not be issued unless the applicant received approval or a waiver of the Coastal Use Permit by the Department of Natural Resources.

You are requested to communicate the information contained in this notice to any other parties whom you deem likely to have interest in the matter.

Michael Farabee
Chief, Eastern Evaluation Section

Enclosures

J:\100005\10844 WAGAMAN SHIP BERTH AND BARGE FLEETING\DRAWINGS\PERMIT\10844-P1-P2.DWG

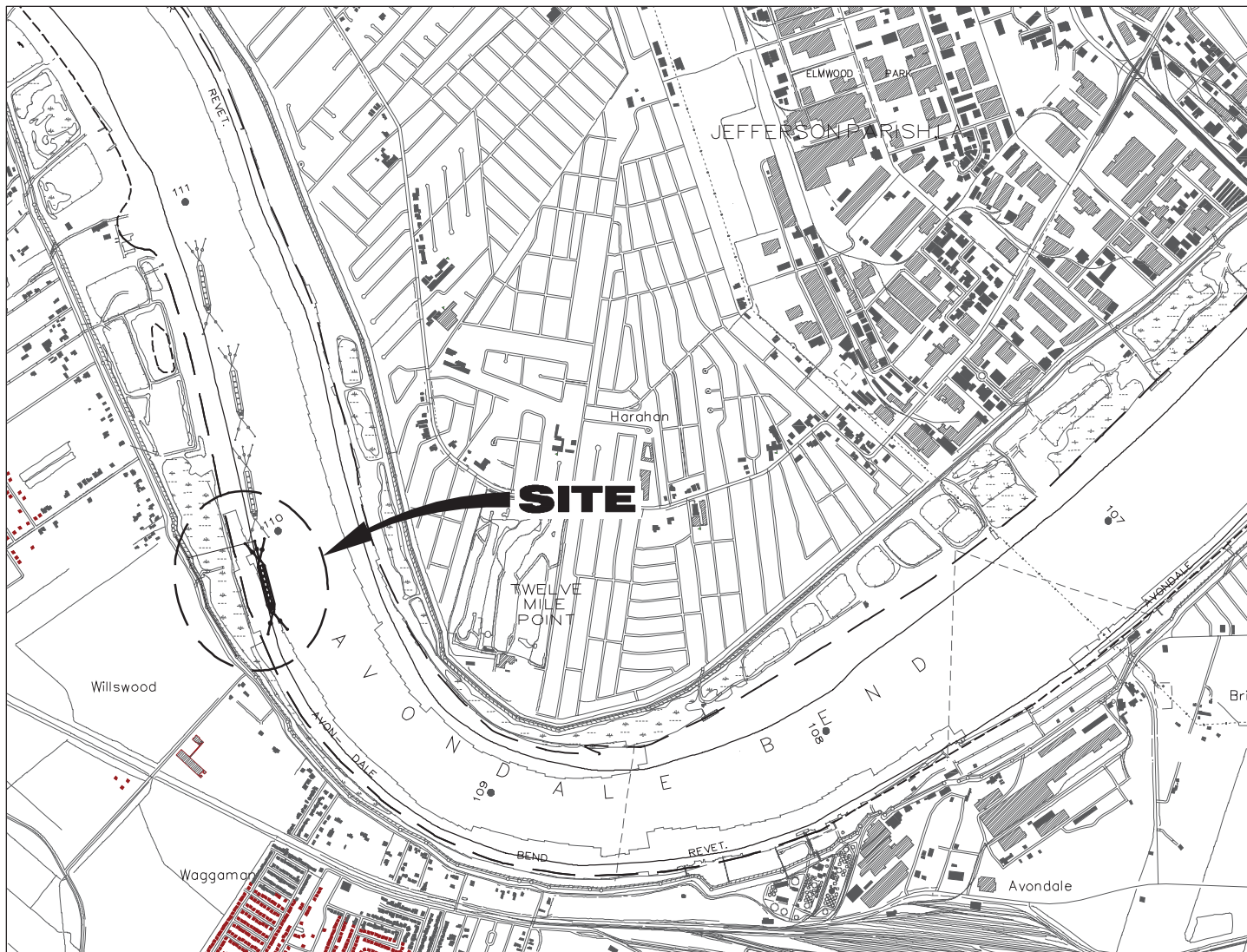

VICINITY MAP

SCALE: 1" = 2500'



LAT. 29° 55' 57.19"
LONG. 90° 13' 13.66"



GENERAL NOTES

1. AS-BUILT DRAWINGS AND/OR PLANS SHALL HAVE WRITTEN ON THEM THE DATE OF COMPLETION OF SAID ACTIVITIES AND SHALL BE SUBMITTED TO THE LOUISIANA DEPARTMENT OF NATURAL RESOURCES, OFFICE OF COASTAL MANAGEMENT, P.O. BOX 44487, BATON ROUGE, LA 70804-4487 WITHIN 30 DAYS FOLLOWING PROJECT COMPLETION.
2. ALL STRUCTURES, FACILITIES, WELL AND PIPELINES/FLOWLINES OCCURRING IN OPEN WATER AREAS OR IN OILFIELD CANALS OR SLIPS SHALL BE REMOVED WITHIN 120 DAYS OF ABANDONMENT OF THE FACILITIES FOR THE HEREIN PERMITTED USE UNLESS PRIOR WRITTEN APPROVAL TO LEAVE SUCH STRUCTURES IN PLACE IS RECEIVED FROM THE COASTAL MANAGEMENT DIVISION. THIS CONDITION DOES NOT PRECLUDE THE NECESSITY FOR REVISING THE CURRENT PERMIT OR OBTAINING A SEPARATE COASTAL USE PERMIT, SHOULD ONE BE REQUIRED.
3. STRUCTURES MUST ALSO BE MARKED/LIGHTED IN ACCORDANCE WITH U.S. COAST GUARD REGULATIONS.
4. IN ORDER TO ENSURE THE SAFETY OF ALL PARTIES, THE PERMITTEE SHALL CONTACT THE LOUISIANA ONE CALL SYSTEM (1-800-272-3020) A MINIMUM OF 48 HOURS PRIOR TO THE COMMENCEMENT OF ANY EXCAVATION (DIGGING, DREDGING, JETTING, ETC.) OR DEMOLITION ACTIVITY.

PRELIMINARY - FOR PERMIT PURPOSES ONLY

10844-P1

LANIER & ASSOCIATES
CONSULTING ENGINEERS
INCORPORATED
LA: C-1120 F-2981
NEW ORLEANS, LA BEAUMONT, TX

WOOD RESOURCES
AVONDALE LOUISIANA
PROPOSED NEW MIDSTREAM SHIP MOORING VICINITY MAP

DATE	AUG 2018
DESIGN	NPL
DRAWN	CAP
CHECK	NPL
CONTRACT	10844
SHEET No.	
	1 OF 7

J:\100005\10844 WAGAMAN SHIP BERTH AND BARGE FLEETING\DRAWINGS\PERMIT\10844-P1-P2.DWG

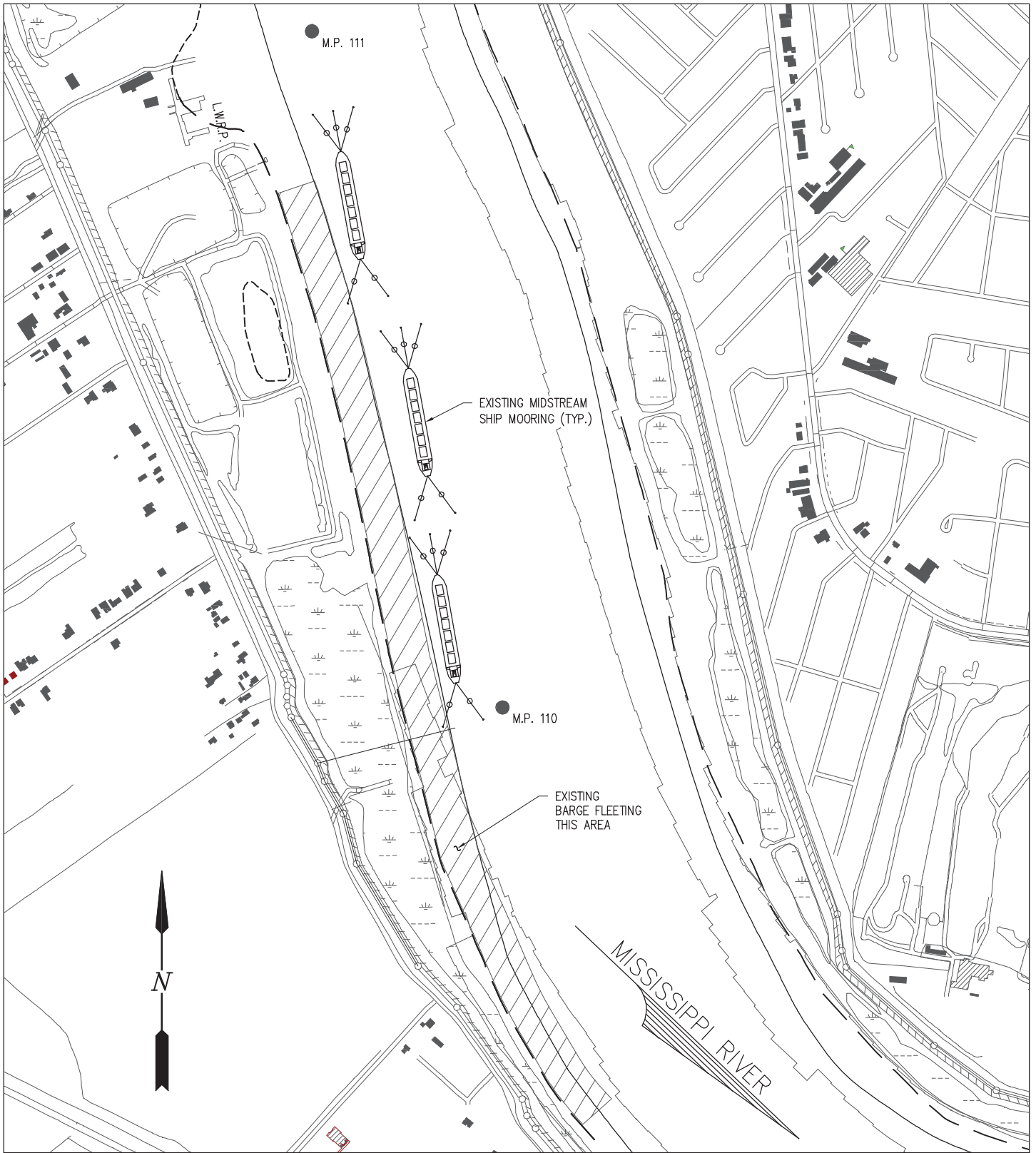

EXISTING SITE PLAN
SCALE: 1" = 1000'

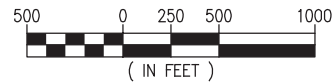

PRELIMINARY - FOR PERMIT PURPOSES ONLY

10844-P2

LANIER & ASSOCIATES
CONSULTING ENGINEERS
INCORPORATED
LA: C-1120 F-2981
NEW ORLEANS, LA BEAUMONT, TX

WOOD RESOURCES
AVONDALE LOUISIANA

**PROPOSED NEW
MID STREAM SHIP MOORING
EXISTING SITE PLAN**

DATE	AUG 2018
DESIGN	NPL
DRAWN	CAP
CHECK	NPL
CONTRACT	10844
SHEET No.	
	2 OF 7

J:\100005\10844 WAGGAMAN SHIP BERTH AND BARGE FLEETING\DRAWINGS\PERMIT\10844-P1-P2.DWG

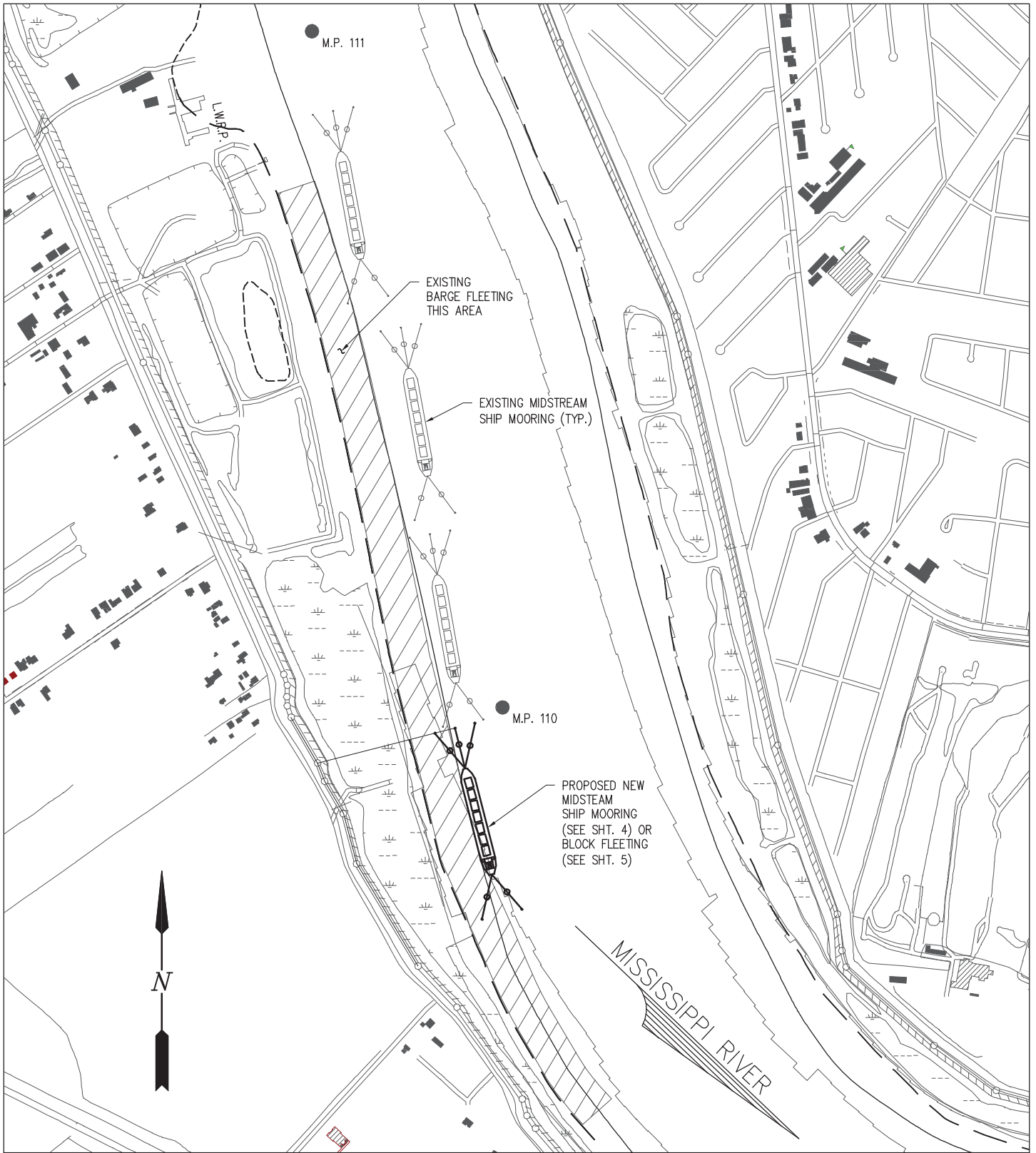

NEW SITE PLAN
SCALE: 1" = 1000'



PRELIMINARY - FOR PERMIT PURPOSES ONLY

10844-P3

LANIER & ASSOCIATES
CONSULTING ENGINEERS
INCORPORATED
LA: C-1120 F-2981
NEW ORLEANS, LA BEAUMONT, TX

WOOD RESOURCES
AVONDALE LOUISIANA

**PROPOSED NEW
MID STREAM SHIP MOORING
NEW SITE PLAN**

DATE	AUG 2018
DESIGN	NPL
DRAWN	CAP
CHECK	NPL
CONTRACT	10844
SHEET No.	
	3 OF 7

J:\100005\10844 WAGAMAN SHIP BERTH AND BARGE FLEETING\DRAWINGS\PERMIT\10844-P1-P4-P5.DWG

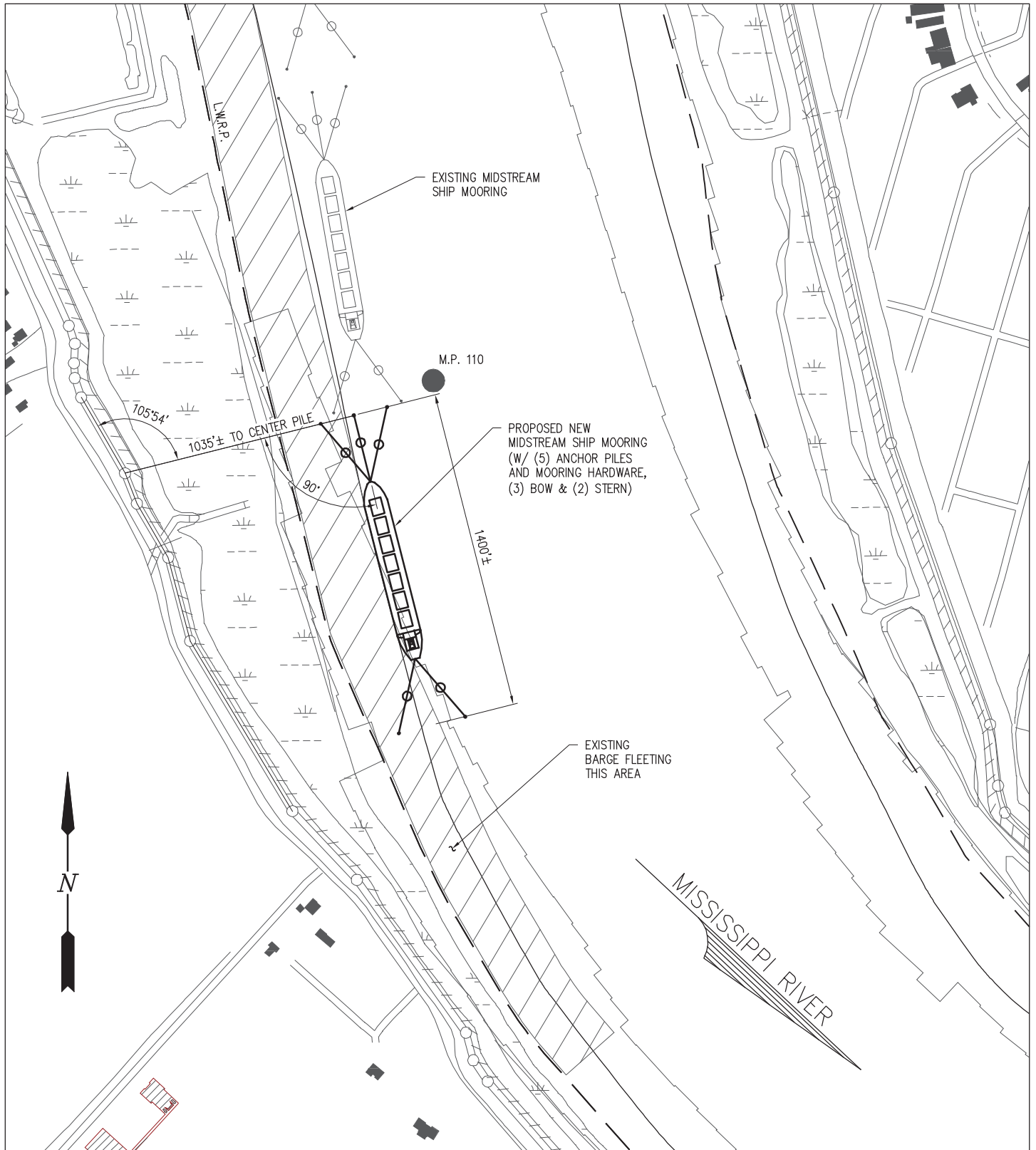

ENLARGE NEW SITE PLAN

SCALE: 1" = 600'



PRELIMINARY - FOR PERMIT PURPOSES ONLY

10844-P4

LANIER & ASSOCIATES
CONSULTING ENGINEERS
 INCORPORATED
 LA: C-1120 F-2981
 NEW ORLEANS, LA BEAUMONT, TX

WOOD RESOURCES
 AVONDALE LOUISIANA

**PROPOSED NEW
 MID STREAM SHIP MOORING
 ENLARGED NEW SITE PLAN**

DATE	AUG 2018
DESIGN	NPL
DRAWN	CAP
CHECK	NPL
CONTRACT	10844
SHEET No.	
	4 OF 7

J:\100005\10844 WAGAMAN SHIP BERTH AND BARGE FLEETING\DRAWINGS\PERMIT\10844-P1-P4-P5.DWG

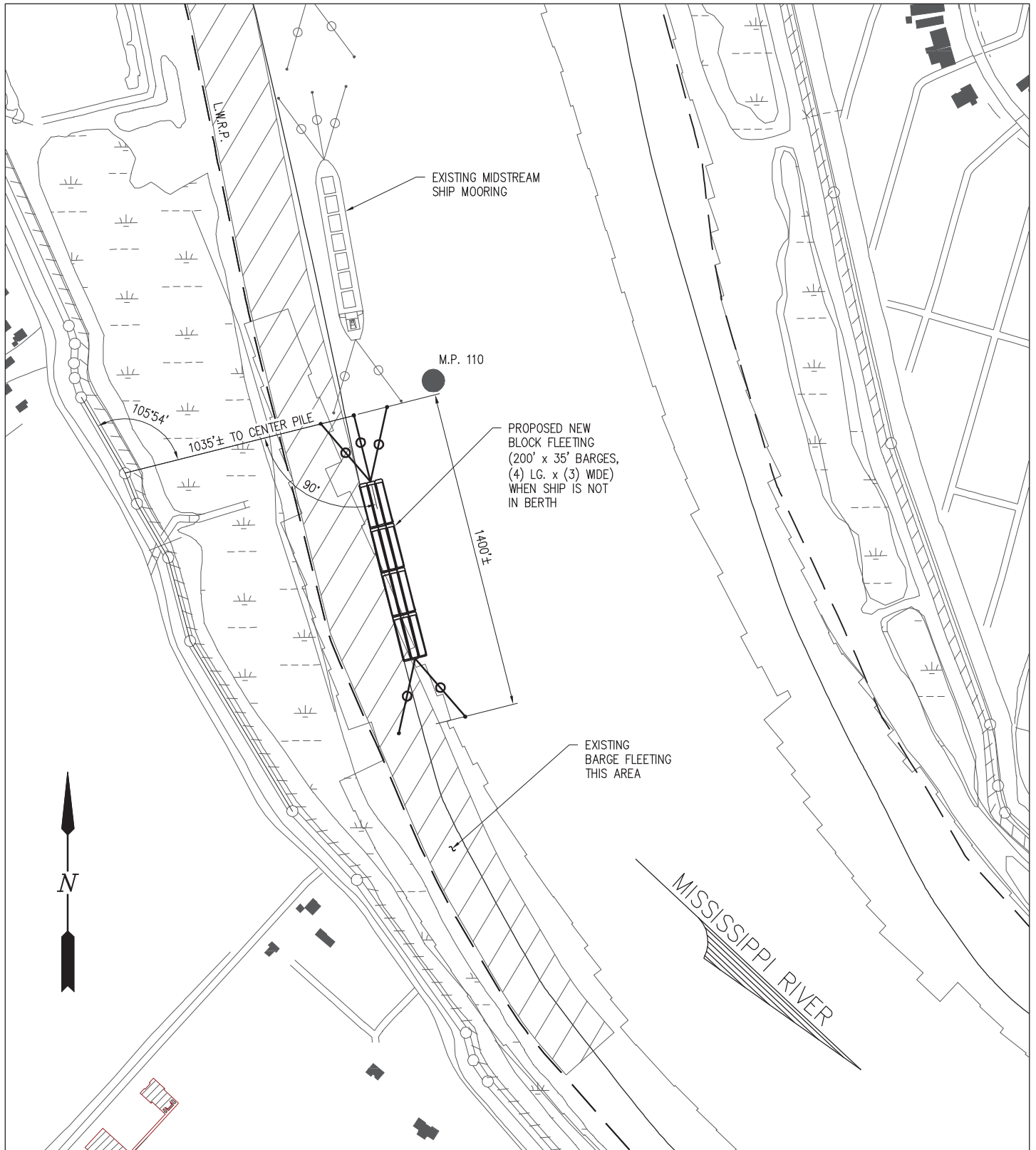

ENLARGED NEW SITE PLAN

SCALE: 1" = 600'

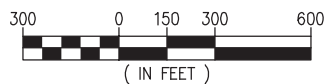

PRELIMINARY - FOR PERMIT PURPOSES ONLY

10844-P5



LANIER & ASSOCIATES
CONSULTING ENGINEERS

INCORPORATED
LA: C-1120 F-2981
NEW ORLEANS, LA BEAUMONT, TX

AVONDALE

WOOD RESOURCES

LOUISIANA

**PROPOSED NEW
MID STREAM SHIP MOORING
ENLARGED NEW SITE PLAN**

DATE AUG 2018
DESIGN NPL
DRAWN CAP
CHECK NPL
CONTRACT 10844
SHEET No.

5 OF **7**

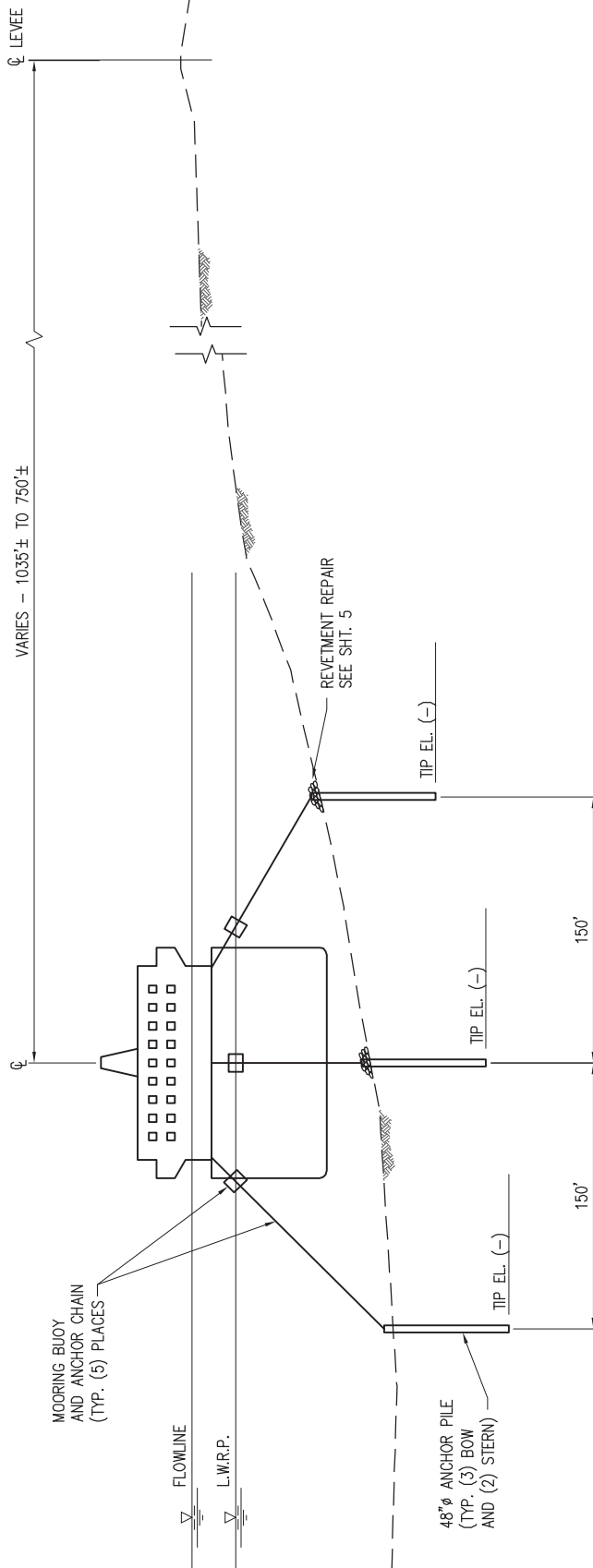

TYPICAL CROSS SECTION

SCALE: 1" = 100'



PRELIMINARY - FOR PERMIT PURPOSES ONLY

10844-P6



LANIER & ASSOCIATES
CONSULTING ENGINEERS

INCORPORATED
LA: C-1120 F-2981
NEW ORLEANS, LA BEAUMONT, TX

AVONDALE

WOOD RESOURCES

LOUISIANA

**PROPOSED NEW
MIDSTREAM SHIP MOORING
TYPICAL CROSS SECTION**

DATE AUG 2018
DESIGN NPL
DRAWN CAP
CHECK NPL
CONTRACT 10844
SHEET No.

6 OF **7**

PILE

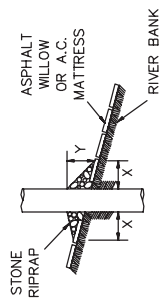

CAISSON

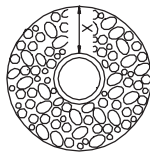
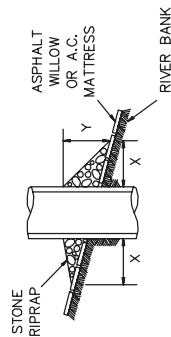

SPUD PILE
(BUOY AND ANCHOR CHAIN)

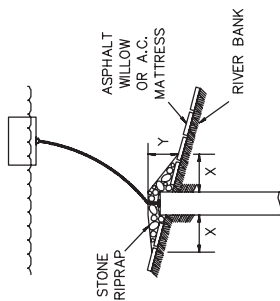

PILE CLUSTER

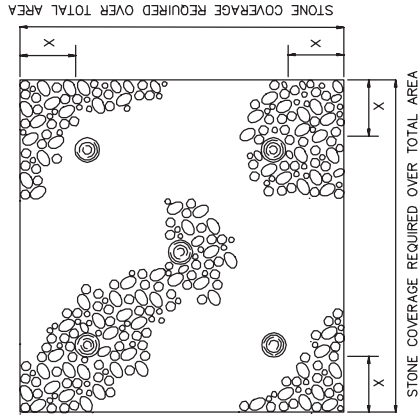
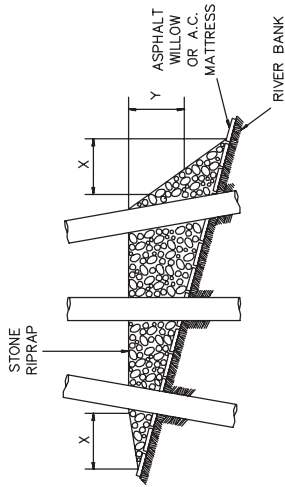

NOTES:

1. SIZE OF RIPRAP TO VARY BETWEEN 6 POUNDS AND 125 POUNDS WITH 40 PERCENT TO 60 PERCENT OF THE STONE WITHIN THE RANGE OF 25 POUNDS TO 75 POUNDS.
2. WHEN PENETRATING THE UPPER BANK PAVING IN A REVETMENT AREA WITH PILES, CAISSONS AND/OR PILE CLUSTERS, A 10 INCH THICK RIPRAP STONE LAYER SHALL BE PLACED OVER ALL AREAS WHERE THE BANK PAVING IS DISTURBED BY DRIVING OPERATIONS.
3. WHEN USING AN ANCHOR CHAIN AND BUOY SYSTEM, THE ANCHOR CHAIN MUST BE ATTACHED AT THE TOP OF THE PILE TO MINIMIZE REVETMENT DAMAGE.

DEPTH OF WATER IN FEET AT POINT OF PENETRATION AT TIME OF STONE PLACEMENT	DIMENSIONS IN FEET FOR PROTECTION AREA REQUIRED									
	PILE		CAISSON			SPUD PILE (BUOY AND ANCHOR CHAIN)			PILE CLUSTER	
	X	Y	X	Y	X	Y	X	Y	X	Y
1' - 10'	3	1.5	5	2					3	1
11' - 40'	5	2	8	3	7	3	6	2	6	2
41' - 60'	8	3	12	4	12	4	10	3	10	3

PRELIMINARY - FOR PERMIT PURPOSES ONLY

10844-P7



LANIER & ASSOCIATES
CONSULTING ENGINEERS
INCORPORATED
LA: C-1120 F-2981
NEW ORLEANS, LA BEAUMONT, TX

AVONDALE

WOOD RESOURCES

LOUISIANA

**PROPOSED NEW
MIDSTREAM SHIP MOORING
REVETMENT REPAIR**

DATE AUG 2018
DESIGN NPL
DRAWN CAP
CHECK NPL
CONTRACT 10844
SHEET No.

7 OF 7