

# JOINT PUBLIC NOTICE

December 23, 2019

United States Army  
Corps of Engineers  
New Orleans District  
Regulatory Branch  
7400 Leake Avenue  
New Orleans, Louisiana 70118

(504) 862-2259  
Project Manager  
Scott N. Kennedy  
scott.n.kennedy@usace.army.mil  
Permit Application Number  
MVN 1998-00235 EMM

State of Louisiana  
Department of Environmental Quality  
Attn: Water Quality Certifications  
Post Office Box 4313  
Baton Rouge, Louisiana 70821-4313

(225) 219-3225  
Project Manager  
Elizabeth Hill  
WQC Application Number  
WQC 190430-03

Interested parties are hereby notified that a permit application has been received by the New Orleans District of the U.S. Army Corps of Engineers pursuant to: [X] Section 10 of the Rivers and Harbors Act of March 3, 1899 (30 Stat. 1151; 33 USC 403); and/or [X] Section 404 of the Clean Water Act (86 Stat. 816; 33 USC 1344).

Application has also been made to the Louisiana Department of Environmental Quality, Water Quality Certifications, for a Water Quality Certification (WQC) in accordance with statutory authority contained in LRS 30:2074 A(3) and provisions of Section 401 of the Clean Water Act.

## **EXPAND AN EXISTING BARGE FLEET AND DREDGE UNDERNEATH THE EXISTING BARGE FLEET IN SAINT CHARLES PARISH**

**NAME OF APPLICANT:** American River Transportation Company c/o Lanier & Associates Engineers, 4101 Magazine Street, New Orleans, Louisiana 70115.

**LOCATION OF WORK:** Section 119, Township 13 South, Range 20 East, in Destrehan, Louisiana, in Saint Charles Parish, as shown on the attached drawings.

HUC: 08090100: Lower Mississippi River- New Orleans  
Latitude: 29.94861 Longitude: -90.37917

**CHARACTER OF WORK:** Expand an existing 8 barge by 9 barge fleet by adding 2 additional sets of barges to make it 10 barges by 9 barges and to dredge and deposit native material on site in the Mississippi River in Destrehan, Louisiana. Approximately 450,751 cubic yards of native material will be excavated and deposited on site below the -55' contour. These are additional plans to the original permit (EH-19-980-0235) issued in June 1998. The applicant does not propose permanent impacts to wetland resources, as such, compensatory mitigation is not anticipated.

The comment period for the Department of the Army Permit and the Louisiana Department of Environmental Quality WQC will close **30 days** from the date of this joint public notice. Written comments, including suggestions for modifications or objections to the proposed work, stating reasons thereof, are being solicited from anyone having interest in this permit and/or this WQC request and must be mailed so as to be received before or by the last day of the comment period. Letters concerning the Corps of Engineers permit application must reference the applicant's name and the Permit Application Number, and be mailed to the

Corps of Engineers at the address above, **ATTENTION: REGULATORY BRANCH**. Similar letters concerning the Water Quality Certification must reference the applicant's name and the WQC Application number and be mailed to the Louisiana Department of Environmental Quality at the address above.

The application for this proposed project is on file with the Louisiana Department of Environmental Quality and may be examined weekdays between 8:00 a.m. and 4:30 p.m. Copies may be obtained upon payment of costs of reproduction.

### **Corps of Engineers Permit Criteria**

The decision whether to issue a permit will be based on an evaluation of the probable impacts, including cumulative impacts of the proposed activity on the public interest. That decision will reflect the national concern for both protection and utilization of important resources. The benefit which reasonably may be expected to accrue from the proposal must be balanced against its reasonably foreseeable detriments. All factors which may be relevant to the proposal will be considered including the cumulative effects thereof; among those are conservation, economics, aesthetics, general environmental concerns, wetlands, historic properties, fish and wildlife values, flood hazards, floodplain values, land use, navigation, shoreline erosion and accretion, recreation, water supply and conservation, water quality, energy needs, safety, food and fiber production, mineral needs, considerations of property ownership and, in general, the needs and welfare of the people.

The U.S. Army Corps of Engineers is soliciting comments from the public, federal, state, and local agencies and officials, Indian Tribes, and other interested parties in order to consider and evaluate the impacts of this proposed activity. Any comments received will be considered by the U.S. Army Corps of Engineers to determine whether to make, modify, condition, or deny a permit for this proposal. To make this decision, comments are used to assess impacts on endangered species, historic properties, water quality, general environmental effects, and other public interest factors listed above. Comments are used in the preparation of an Environmental Assessment and/or an Environmental Impact Statement pursuant to the National Environmental Policy Act. Comments are also used to determine the need for a public hearing and to determine the overall public interest of the proposed activity.

The New Orleans District is unaware of properties listed on the National Register of Historic Places near the proposed work. The possibility exists that the proposed work may damage or destroy presently unknown archeological, scientific, prehistorical, historical sites, or data. Issuance of the public notice solicits input from the State Archeologist and State Historic Preservation Office regarding potential impacts to cultural resources.

The New Orleans District has determined that the proposed work would neither affect any species or critical habitat listed as endangered by the U.S. Department of Commerce.

Utilizing Standard Local Operating Procedure for Endangered Species in Louisiana (SLOPES), dated October 22, 2014, between the U.S. Army Corps of Engineers, New Orleans and U.S. Fish and Wildlife Service, Ecological Services Office, the Corps has determined that the proposed activity would not likely adversely affect any listed species. Cutterhead/suction dredge recommendations for pallid sturgeon shall be included as a permit condition.

This notice initiates the Essential Fish Habitat (EFH) consultation requirements of the Magnuson-Stevens Fishery Conservation and Management Act. The applicant's proposal would result in the destruction or alteration of up to n/a acres of EFH utilized by various life stages of red drum and penaeid shrimp. Our initial determination is that the proposed action would not have a substantial adverse impact on EFH or federally managed fisheries in the Gulf of Mexico. Our final determination relative to project impacts and the need for mitigation measures is subject to review by and coordination with the National Marine Fisheries Service.

If the proposed work involves deposits of dredged or fill material into navigable waters, the evaluation of the probable impacts will include the application of guidelines established by the Administrator of the Environmental Protection Agency. Also, a certification that the proposed activity will not violate water quality standards will be required from the Department of Environmental Quality, Water Quality Certifications, before a permit is issued.

Any person may request, in writing, within the comment period specified in this notice, that a public hearing be held to consider this application. Requests for public hearings shall state, with particularity, the reasons for holding a public hearing.

The applicant has certified that the proposed activity described in the application complies with and will be conducted in a manner that is consistent with the Louisiana Coastal Resources Program. The Department of the Army permit will not be issued unless the applicant received approval or a waiver of the Coastal Use Permit by the Department of Natural Resources.

You are requested to communicate the information contained in this notice to any other parties whom you deem likely to have interest in the matter.

Michael Farabee  
Chief, Eastern Evaluation Section

Enclosures

J:\100005\10831 ARTCO DREDGING\DRAWINGS\02 - MP 122 LDB - UPPER CANIZARO FLEET\PERMIT\10831-2-P1.DWG

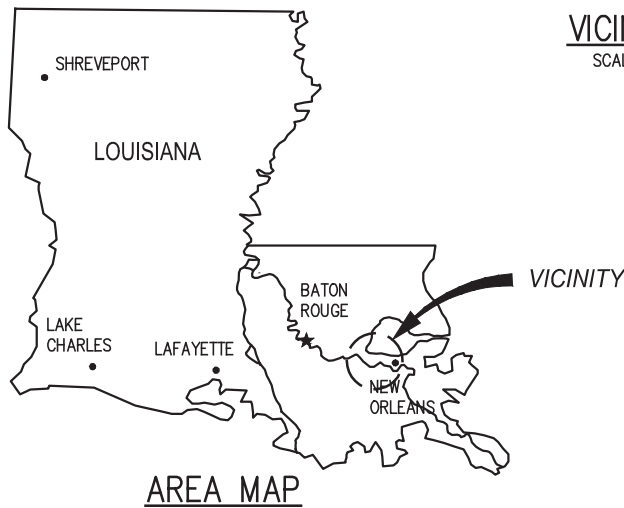
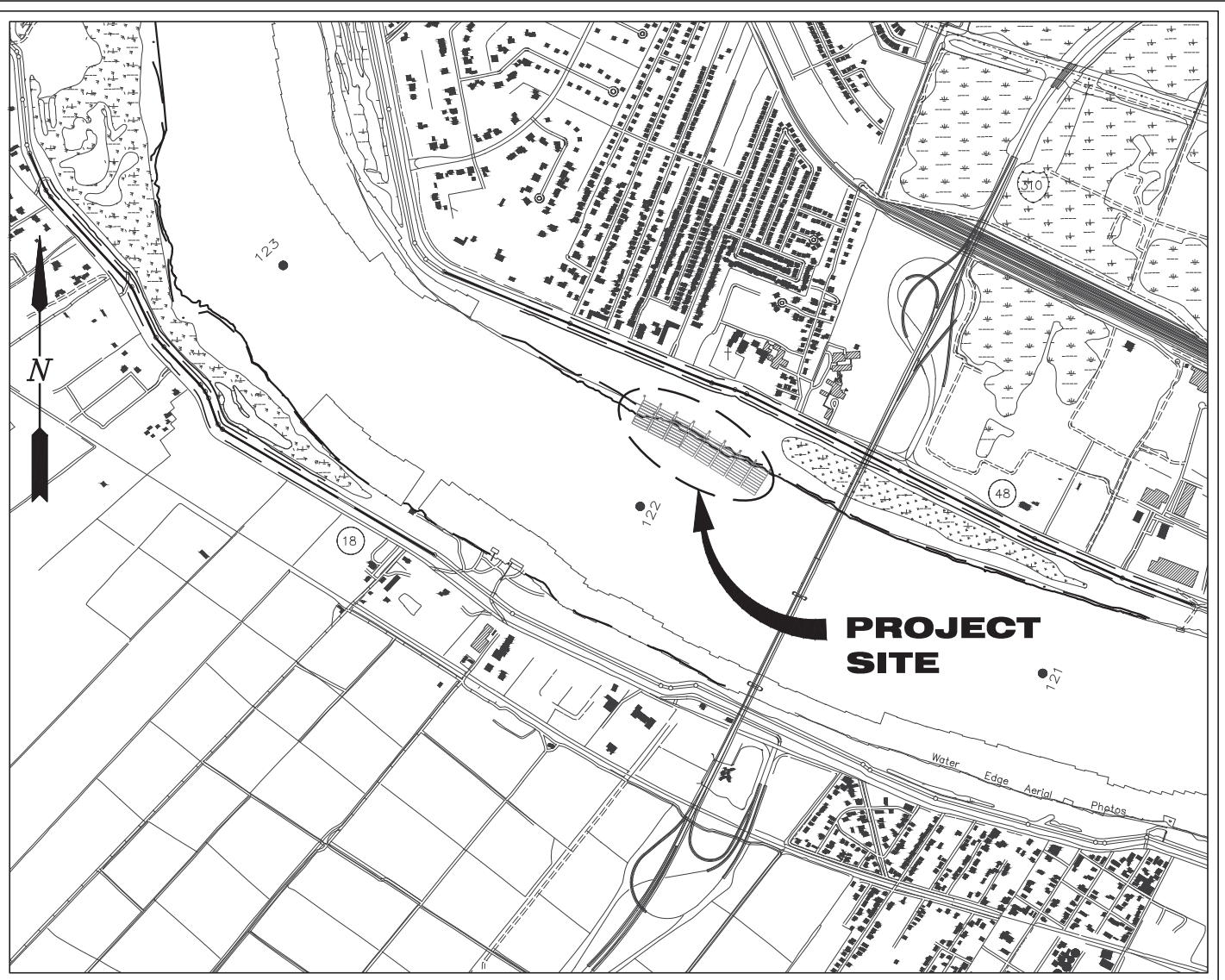

**VICINITY MAP**

SCALE: 1" = 2000'

PARISH: ST. CHARLES  
 LATITUDE: 29°56'52.6"  
 LONGITUDE: 90°22'42.1"

**GENERAL NOTES**

1. AS-BUILT DRAWINGS AND/OR PLANS SHALL HAVE WRITTEN ON THEM THE DATE OF COMPLETION OF SAID ACTIVITIES AND SHALL BE SUBMITTED TO THE LOUISIANA DEPARTMENT OF NATURAL RESOURCES, OFFICE OF COASTAL MANAGEMENT, P.O. BOX 44487, BATON ROUGE, LA 70804-4487 WITHIN 30 DAYS FOLLOWING PROJECT COMPLETION.
2. ALL STRUCTURES, FACILITIES, WELL AND PIPELINES/FLOWLINES OCCURRING IN OPEN WATER AREAS OR IN OILFIELD CANALS OR SLIPS SHALL BE REMOVED WITHIN 120 DAYS OF ABANDONMENT OF THE FACILITIES FOR THE HEREIN PERMITTED USE UNLESS PRIOR WRITTEN APPROVAL TO LEAVE SUCH STRUCTURES IN PLACE IS RECEIVED FROM THE COASTAL MANAGEMENT DIVISION. THIS CONDITION DOES NOT PRECLUDE THE NECESSITY FOR REVISING THE CURRENT PERMIT OR OBTAINING A SEPARATE COASTAL USE PERMIT, SHOULD ONE BE REQUIRED.
3. STRUCTURES MUST ALSO BE MARKED/LIGHTED IN ACCORDANCE WITH U.S. COAST GUARD REGULATIONS.
4. IN ORDER TO ENSURE THE SAFETY OF ALL PARTIES, THE PERMITEE SHALL CONTACT THE LOUISIANA ONE CALL SYSTEM (1-800-272-3020) A MINIMUM OF 48 HOURS PRIOR TO THE COMMENCEMENT OF ANY EXCAVATION (DIGGING, DREDGING, JETTING, ETC.) OR DEMOLITION ACTIVITY.
5. ALL ELEVATIONS REFER TO NAVD 88 UNLESS NOTED OTHERWISE.

**PRELIMINARY - FOR PERMIT PURPOSES ONLY**

10831-2-P1



**LANIER & ASSOCIATES**  
 CONSULTING ENGINEERS  
 INCORPORATED

LA: C-1120 F-2981  
 NEW ORLEANS, LA • BEAUMONT, TX

DESTREHAN

**ARTCO**

LOUISIANA

**M.P. 122 - LDB - UPPER CANIZARO FLEET  
 PROPOSED BARGE FLEET EXTENSION & DREDGE  
 AREA MAP, VICINITY MAP, & GENERAL NOTES**

DATE	OCT. '18
DESIGN	JPL
DRAWN	SJA
CHECK	NPL
CONTRACT	10831-2
SHEET No.	

1 OF 5

J:\10000S\10831 ARTCO DREDGING\DRAWINGS\02 - MP 122 LDB - UPPER CANIZARO FLEET\PERMIT\10831-2-P2.DWG

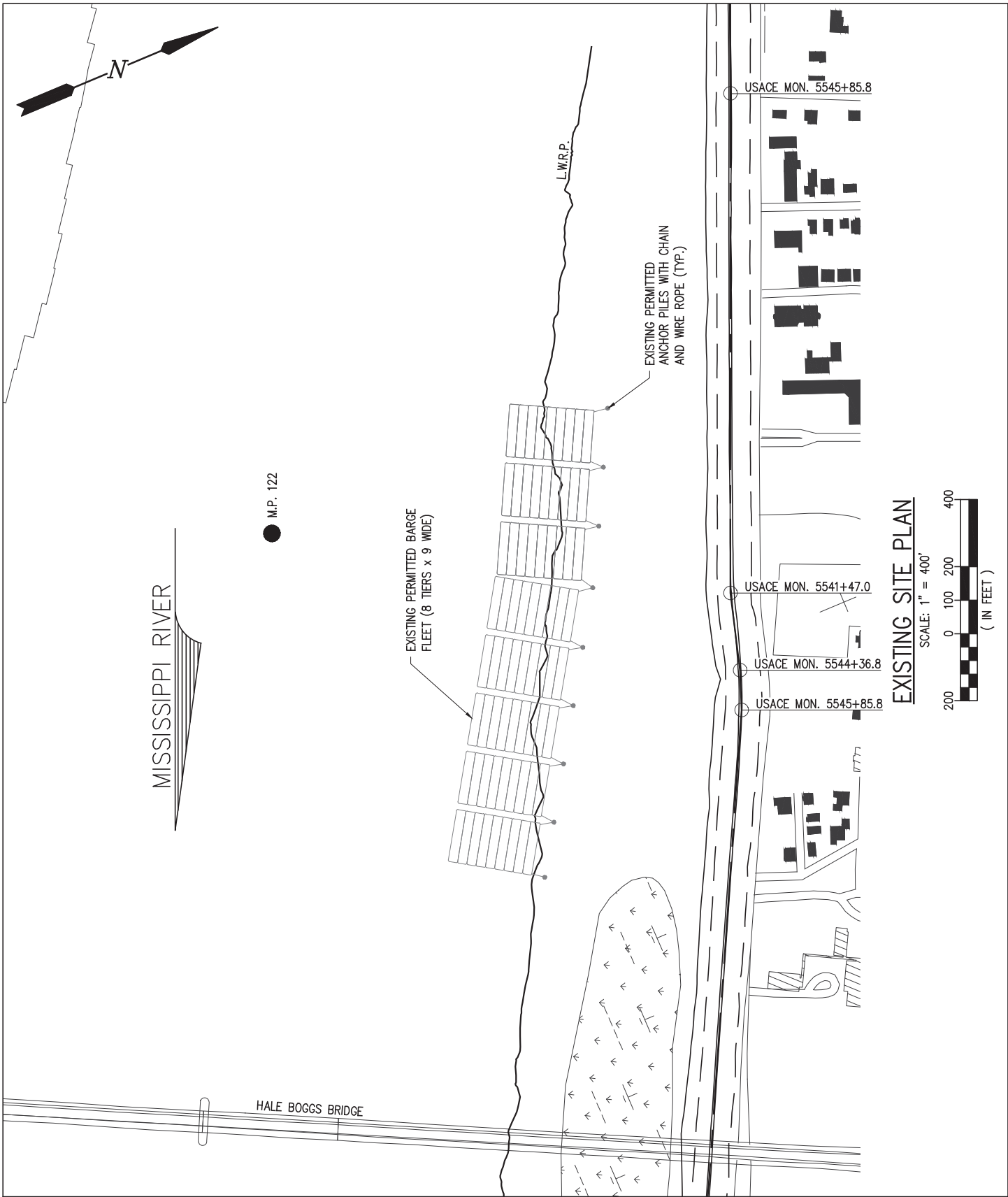

**PRELIMINARY - FOR PERMIT PURPOSES ONLY**

10831-2-P2

**LANIER & ASSOCIATES**  
 CONSULTING ENGINEERS  
 INCORPORATED  
 LA: C-1120 F-2981  
 NEW ORLEANS, LA • BEAUMONT, TX

**ARTCO**  
 DESTREHAN LOUISIANA  
**M.P. 122 - LDB - UPPER CANIZARO FLEET  
 PROPOSED BARGE FLEET EXTENSION & DREDGE  
 EXISTING SITE PLAN**

DATE	OCT. '18
DESIGN	JPL
DRAWN	SJA
CHECK	NPL
CONTRACT	10831-2
SHEET No.	2 OF 5

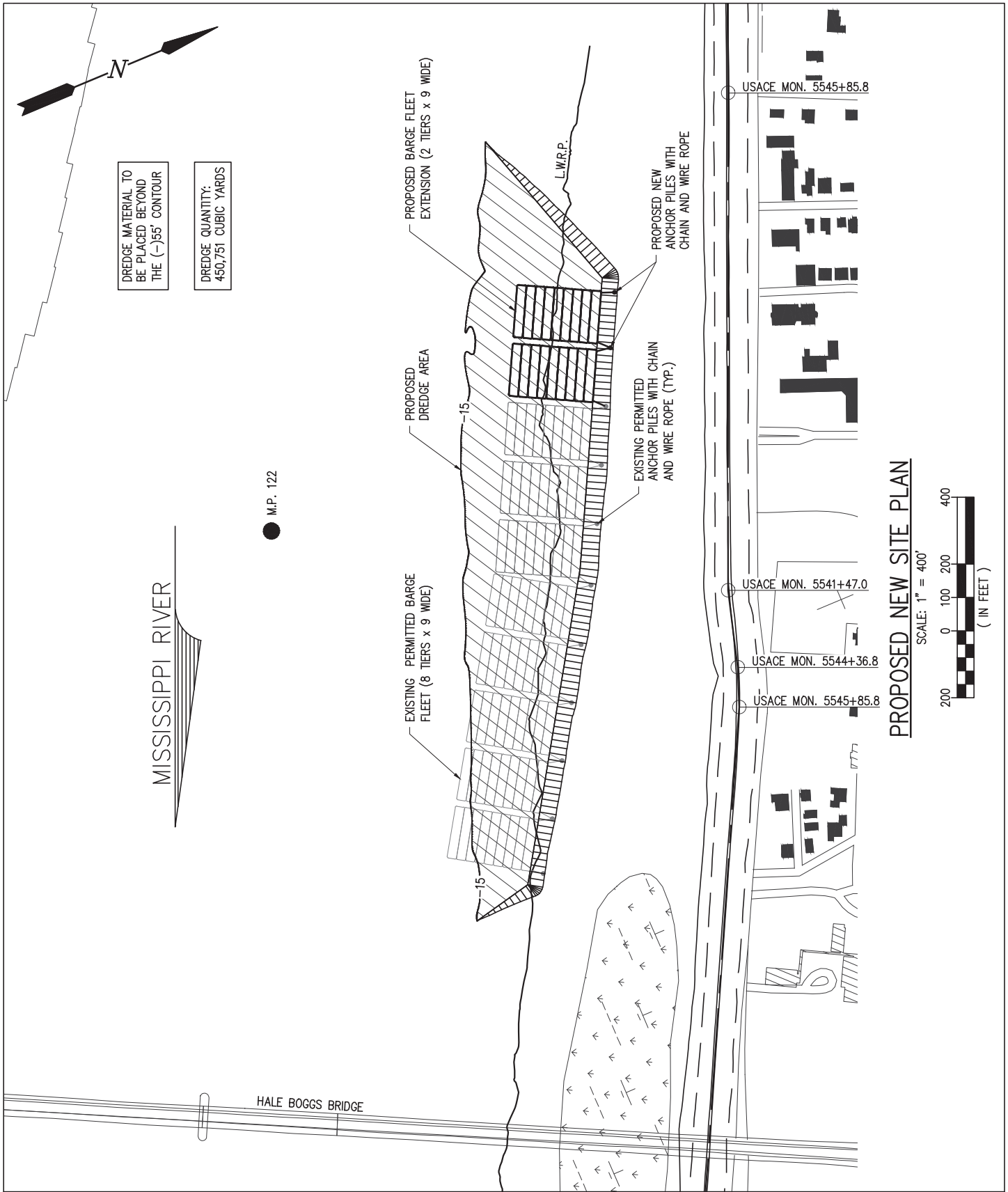

**PRELIMINARY - FOR PERMIT PURPOSES ONLY**

10831-2-P3

**LANIER & ASSOCIATES**  
 CONSULTING ENGINEERS  
 INCORPORATED  
 LA: C-1120 F-2981  
 NEW ORLEANS, LA • BEAUMONT, TX

**ARTCO**  
 DESTREHAN LOUISIANA  
**M.P. 122 - LDB - UPPER CANIZARO FLEET**  
**PROPOSED BARGE FLEET EXTENSION & DREDGE**  
**PROPOSED NEW SITE PLAN**

DATE	OCT. '18
DESIGN	JPL
DRAWN	SJA
CHECK	NPL
CONTRACT	10831-2
SHEET No.	3 OF 5

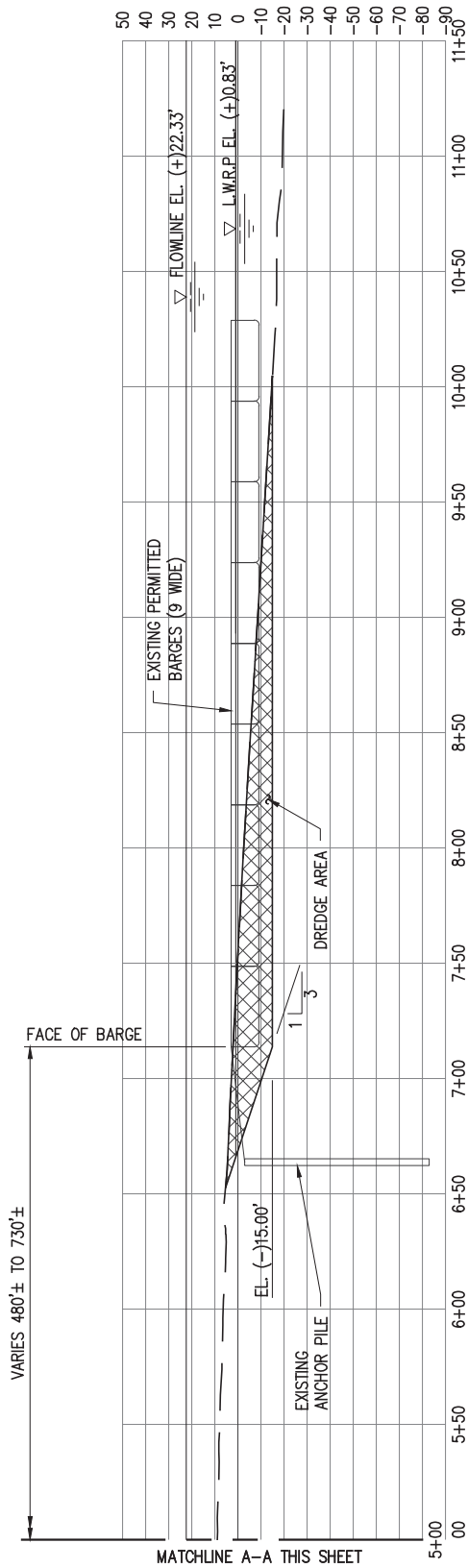
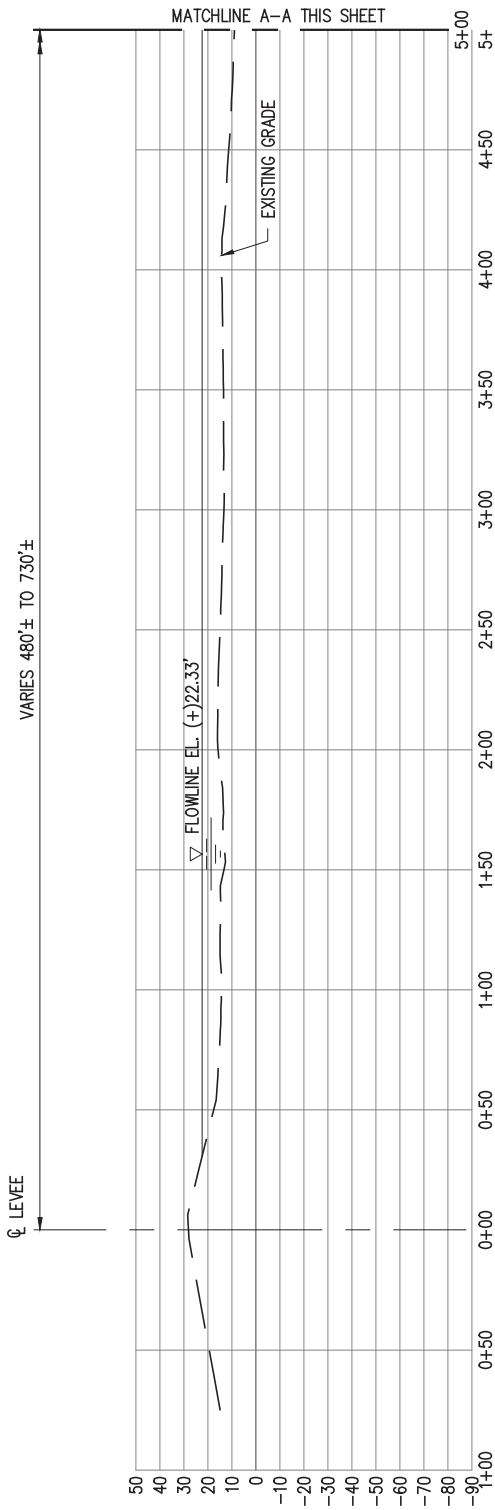

**SECTIONS AT USACE MON. 5544+36.8**

**PRELIMINARY - FOR PERMIT PURPOSES ONLY**

10831-2-P4



**LANIER & ASSOCIATES**  
**CONSULTING ENGINEERS**  
 INCORPORATED  
 LA: C-1120 F-2981  
 NEW ORLEANS, LA • BEAUMONT, TX

**ARTCO**  
 DESTREHAN LOUISIANA

**M.P. 122 - LDB - UPPER CANIZARO FLEET**  
**PROPOSED BARGE FLEET EXTENSION & DREDGE**  
**PROPOSED NEW SITE PLAN**

DATE OCT. '18  
 DESIGN JPL  
 DRAWN SJA  
 CHECK NPL  
 CONTRACT 10831-2  
 SHEET No.

J:\100005\10831 ARTCO DREDGING\DRAWINGS\02 - MP 122 LDB - UPPER CANIZARO FLEET\PERMIT\10831-2-P5.DWG

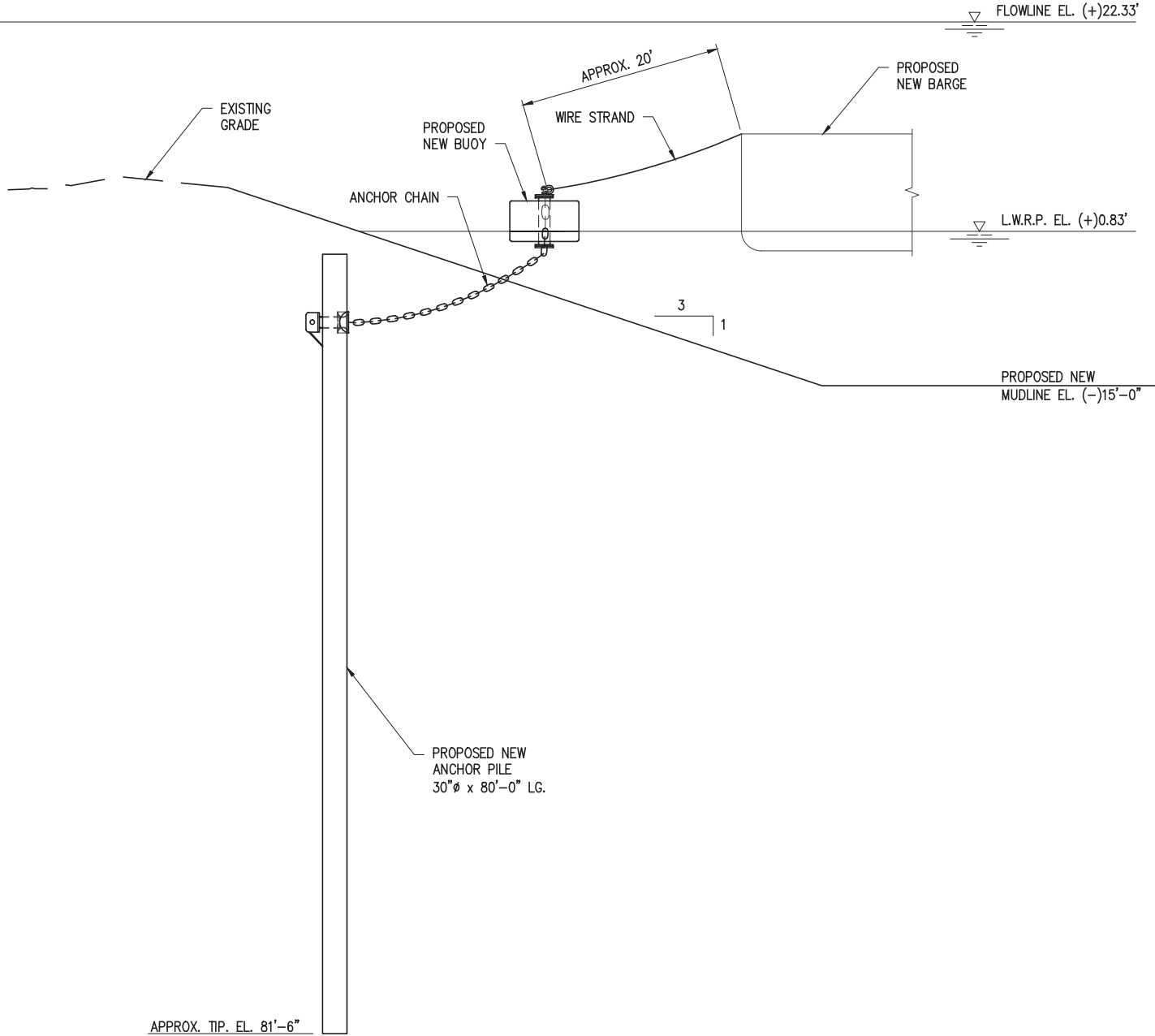

**POPOSED NEW ANCHOR PILE - ELEVATION**

SCALE: 1/16" = 1'-0"

**PRELIMINARY - FOR PERMIT PURPOSES ONLY**

10831-2-P5



**LANIER & ASSOCIATES**  
CONSULTING ENGINEERS  
INCORPORATED

LA: C-1120 F-2981  
NEW ORLEANS, LA • BEAUMONT, TX

DESTREHAN

**ARTCO**

LOUISIANA

**M.P. 122 - LDB - UPPER CANIZARO FLEET  
PROPOSED BARGE FLEET EXTENSION & DREDGE  
PROPOSED NEW ANCHOR PILE - ELEVATION**

DATE OCT. '18  
DESIGN JPL  
DRAWN SJA  
CHECK NPL  
CONTRACT 10831-2  
SHEET No.

**5 OF 5**