

JOINT PUBLIC NOTICE

24 September 2018

United States Army
Corps of Engineers
New Orleans District
Regulatory Branch
7400 Leake Avenue
New Orleans, Louisiana 70118

(504) 862-2279
kara.vick@usace.army.mil
Project Manager
Kara Vick
Permit Application Number
MVN 1997-03386-EV

State of Louisiana
Department of Environmental Quality
ATTN: Water Quality Certifications
Post Office Box 4313
Baton Rouge, Louisiana 70821-4313

(225) 219-3225
Project Manager
Elizabeth Hill
WQC Application Number
WQC 180917-01

Interested parties are hereby notified that a permit application has been received by the New Orleans District of the U.S. Army Corps of Engineers pursuant to: [X] Section 10 of the Rivers and Harbors Act of March 3, 1899 (30 Stat. 1151; 33 USC 403); and/or [X] Section 404 of the Clean Water Act (86 Stat. 816; 33 USC 1344).

Application has also been made to the Louisiana Department of Environmental Quality for a Water Quality Certification (WQC) in accordance with statutory authority contained in LRS30:2047 A(3), and provisions of Section 401 of the Clean Water Act (P.L.95-17).

DOCK at EXISTING REFINERY in the MISSISSIPPI RIVER in St. CHARLES PARISH

NAME OF APPLICANT: Valero Refining – New Orleans, LLC, ATTN: Stantec Consulting, LLC, ATTN: Ms. Lindsay Grisson, at 1615 Poydras, Suite 850, New Orleans, Louisiana 70112.

LOCATION OF WORK: Located at 14902 River Road, on the left descending bank of the Mississippi River, approximately 125 miles above the Head of Passes, in Goodhope, Louisiana, in St. Charles Parish, as shown on the attached drawings.

HUC: 08090100; Lower Mississippi River – New Orleans, 08090203; Eastern Coastal Louisiana

CHARACTER OF WORK: To install a new dock and expand an existing dock at an existing St. Charles Refinery in Goodhope, Louisiana. The work will include a piperack along the batture, modifications to an existing upstream dock and associated infrastructure. No dredging will occur. Temporary impacts to wetlands via equipment access and matting will occur to approximately 12.4 acres and a permanent conversion of forested wetland to herbaceous wetland will occur to 1.2 acres due to the elevated piperack and access road maintenance. The riprap, pilings and associated walkways and moorings, and the maintained ROW for the new road and piperack will result in a permanent impact to 0.5 acres of wetlands and 0.2 acres of other waters. The applicant proposes to purchase credits from a mitigation bank to offset any unavoidable losses to wetland functions caused by project implementation.

The comment period for the Department of the Army Permit and the Louisiana Department of Environmental Quality WQC will close 30 days from the date of this joint public notice. Written comments, including suggestions for modifications or objections to the proposed work, stating

reasons thereof, are being solicited from anyone having interest in this permit and/or this WQC request and must be mailed so as to be received before or by the last day of the comment period. Letters concerning the Corps of Engineers permit application must reference the applicant's name and the Permit Application Number, and be mailed to the Corps of Engineers at the address above, ATTENTION: REGULATORY BRANCH. Similar letters concerning the Water Quality Certification must reference the applicant's name and the WQC Application number and be mailed to the Louisiana Department of Environmental Quality at the address above.

The application for this proposed project is on file with the Louisiana Department of Environmental Quality and may be examined during weekdays between 8:00 a.m. and 4:30 p.m. Copies may be obtained upon payment of costs of reproduction.

Corps of Engineers Permit Criteria

The decision whether to issue a permit will be based on an evaluation of the probable impacts, including cumulative impacts of the proposed activity on the public interest. That decision will reflect the national concern for both protection and utilization of important resources. The benefit which reasonably may be expected to accrue from the proposal must be balanced against its reasonably foreseeable detriments. All factors which may be relevant to the proposal will be considered including the cumulative effects thereof; among those are conservation, economics, aesthetics, general environmental concerns, wetlands, historic properties, fish and wildlife values, flood hazards, floodplain values, land use, navigation, shoreline erosion and accretion, recreation, water supply and conservation, water quality, energy needs, safety, food and fiber production, mineral needs, considerations of property ownership and, in general, the needs and welfare of the people.

The U.S. Army Corps of Engineers is soliciting comments from the public, federal, state, and local agencies and officials, Indian Tribes, and other interested parties in order to consider and evaluate the impacts of this proposed activity. Any comments received will be considered by the U.S. Army Corps of Engineers to determine whether to make, modify, condition, or deny a permit for this proposal. To make this decision, comments are used to assess impacts on endangered species, historic properties, water quality, general environmental effects, and other public interest factors listed above. Comments are used in the preparation of an Environmental Assessment and/or an Environmental Impact Statement pursuant to the National Environmental Policy Act. Comments are also used to determine the need for a public hearing and to determine the overall public interest of the proposed activity.

The New Orleans District is unaware of properties listed on the National Register of Historic Places near the proposed work. The possibility exists that the proposed work may damage or destroy presently unknown archeological, scientific, prehistorical, historical sites, or data. Issuance of this public notice solicits input from the State Archeologist and State Historic Preservation Officer regarding potential impacts to cultural resources.

Our initial finding is that the proposed work would neither affect any species listed as endangered, nor habitat designated as critical to the survival and recovery of species listed as endangered by the U.S. Department of Commerce.

Utilizing Standard Local Operating Procedure for Endangered Species in Louisiana (SLOPES), dated October 22, 2014, between the U.S. Army Corps of Engineers, New Orleans and U.S. Fish and Wildlife Service, Ecological Services Office, the Corps has determined that the proposed activity would have no effect on any listed species nor affect any habitat designated as critical to the survival and recovery of any endangered species of concern to the USFW.

This notice initiates the Essential Fish Habitat (EFH) consultation requirements of the Magnuson-Stevens Fishery Conservation and Management Act. The applicant's proposal would

result in the destruction or alteration of N/A acre of EFH utilized by various life stages of red drum and penaeid shrimp. Our initial determination is that the proposed action would not have a substantial adverse impact on EFH or federally managed fisheries in the Gulf of Mexico. Our final determination relative to project impacts and the need for mitigation measures is subject to review by and coordination with the National Marine Fisheries Service.

If the proposed work involves deposits of dredged or fill material into navigable waters, the evaluation of the probable impacts will include the application of guidelines established by the Administrator of the Environmental Protection Agency. Also, a certification that the proposed activity will not violate applicable water quality standards will be required from the Department of Environmental Quality before a permit is issued.

Any person may request, in writing, within the comment period specified in this notice, that a public hearing be held to consider this application. Requests for public hearings shall state, with particularity, the reasons for holding a public hearing.

The applicant has certified that the proposed activity described in the application complies with and will be conducted in a manner that is consistent with the Louisiana Coastal Resources Program. The Department of the Army permit will not be issued unless the applicant received approval or a waiver of the Coastal Use Permit by the Department of Natural Resources.

You are requested to communicate the information contained in this notice to any other parties whom you deem likely to have interest in the matter.

Michael V. Farabee
Chief, Eastern Evaluation Section

Enclosure

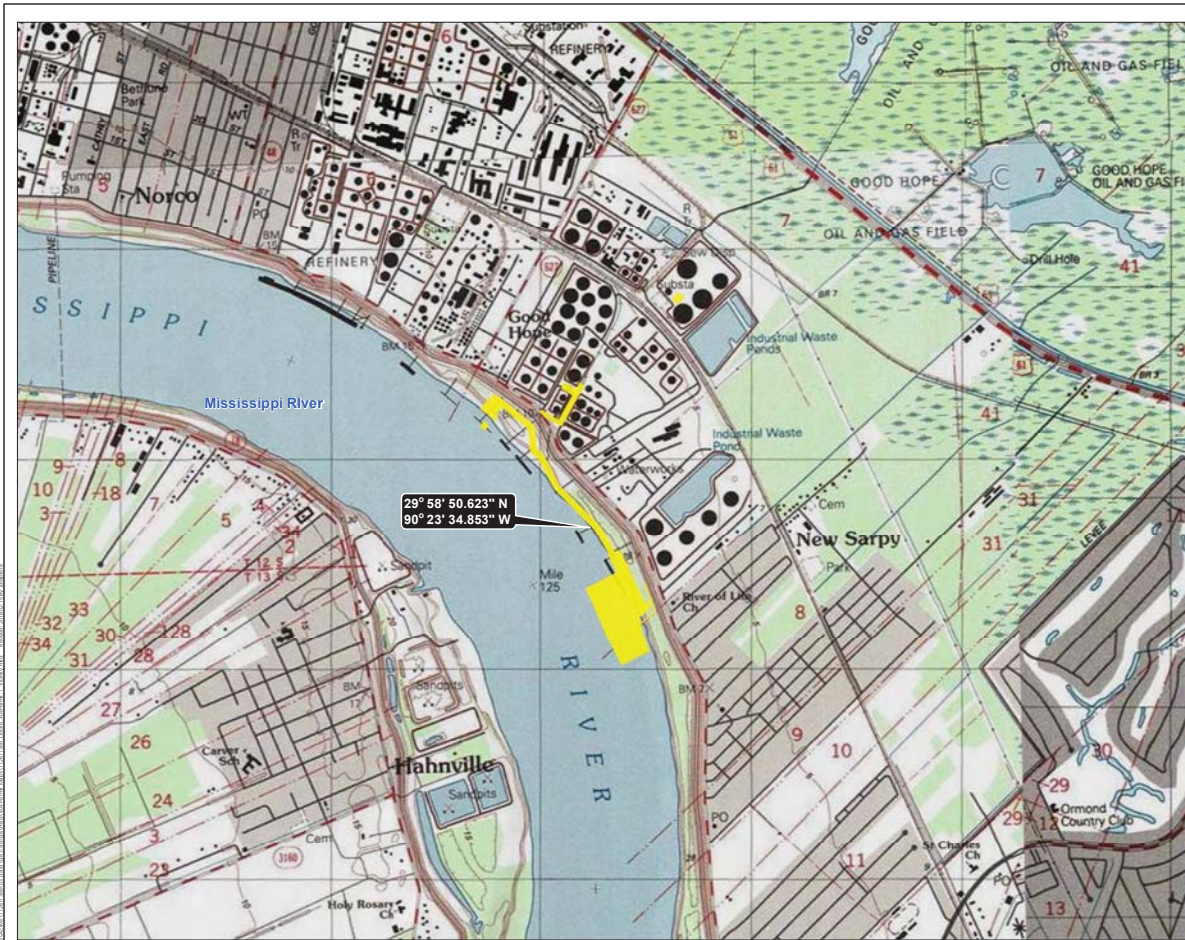

Figure No. **1**
 Title
Vicinity Map
 Client/Project
 Valero St. Charles Dock Expansion Project
 Joint Permit Application
 Project Location
 New Orleans, Louisiana
 Prepared by JD on 2018-02-08
 Technical Review by RW on 2018-02-08
 Independent Review by GS on 2018-02-15



Legend
 Project Workspace Areas

*Adjustments in certain areas may occur



Notes
 1. Coordinate System: NAD 1983 UTM Zone 15N
 2. Data Sources include: Valero
 3. Background: ESR USGS Topo



Disclaimer: Stantec assumes no responsibility for data supplied in electronic format. The recipient accepts full responsibility for verifying the accuracy and completeness of the data. The recipient releases Stantec, its officers, employees, consultants and agents, from any and all claims arising in any way from the content or provision of the data.



Figure No.
2

Title
Project Components Map

Client/Project
Valero St. Charles Dock Expansion Project
Joint Permit Application

Project Location
New Orleans, Louisiana

172677369
Prepared by JD on 2018-02-08
Technical Review by RW on 2018-02-08
Independent Review by GS on 2018-02-15

0 350 700
Feet
1:8,400 (At original document size of 11x17)



Legend

- Project Workspace Areas
- Project Components**
- Existing Ditch to be Filled
- New Dock 2 Platform Expansion
- New Dock 6
- New Dock 6 Access Walkway
- New Fenceline
- New Limestone Road
- New MVCU Platform
- New Mooring Dolphin Access Walkways
- Existing Piperack Modification
- New Piperack ROW
- New Removable Walkway
- New Transformer Platform

*Adjustments in certain areas may occur



- Notes**
1. Coordinate System: NAD 1983 UTM Zone 15N
 2. Data Sources include: Valero
 3. Background: ESRI Aerial Imagery Base Maps



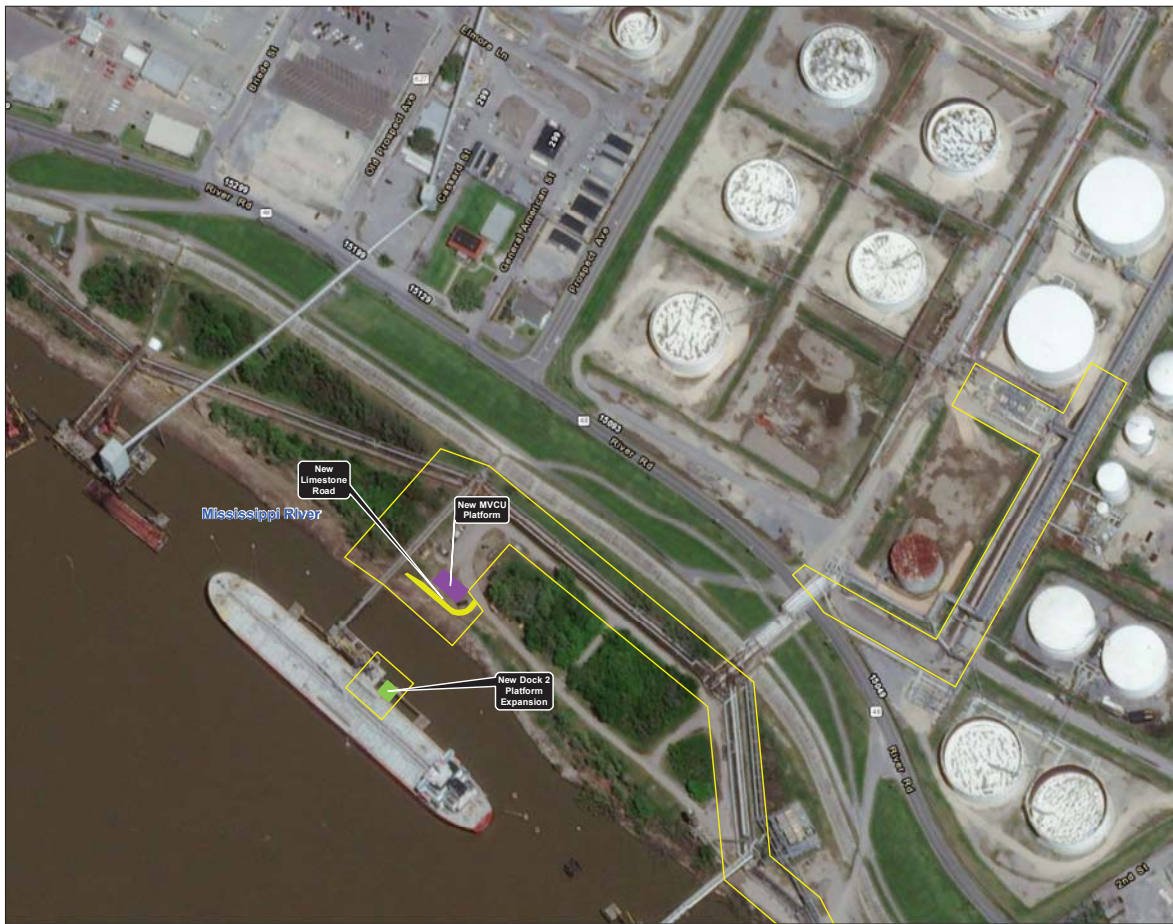
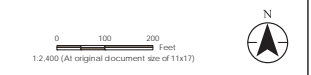

Figure No. **2A**
 Title
Project Components Map
 Client/Project
 Valero St. Charles Dock Expansion Project
 Joint Permit Application
 Project Location
 New Orleans, Louisiana
 172677369
 Prepared by JD on 2018-02-08
 Technical Review by RW on 2018-02-08
 Independent Review by GS on 2018-02-15



- Legend**
- Project Workspace Areas
 - Project Components**
 - New Dock 2 Platform Expansion
 - New Limestone Road
 - New MVCU Platform

*Adjustments in certain areas may occur



- Notes**
1. Coordinate System: NAD 1983 UTM Zone 15N
 2. Data Sources include: Valero
 3. Background: ESRI Aerial Imagery Base Maps

Disclaimer: Stantec assumes no responsibility for data supplied in electronic format. The recipient accepts full responsibility for verifying the accuracy and completeness of the data. The recipient releases Stantec, its officers, employees, consultants and agents, from any and all claims arising in any way from the content or provision of the data.

Figure No.
2B

Title
Project Components Map

Client/Project
Valero St. Charles Dock Expansion Project
Joint Permit Application

Project Location
New Orleans, Louisiana

1/26/2018
Prepared by JD on 2/18/2018
Technical Review by KRW on 2/18/2018
Independent Review by LG on 2/18/2018

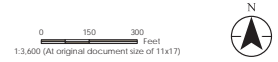

Legend

- Project Workspace Areas
- Project Components**
- Existing Ditch to be Filled
- New Dock 6
- New Dock 6 Access Walkway
- New Fenceline
- New Limestone Road
- New Mooring Dolphin Access Walkways
- Existing Piperack Modification
- New Piperack ROW
- New Removable Walkway
- New Transformer Platform

*Adjustments in certain areas may occur



- Notes**
1. Coordinate System: NAD 1983 UTM Zone 15N
 2. Data Source: Valero
 3. Background: ESRI Aerial Imagery Base Maps

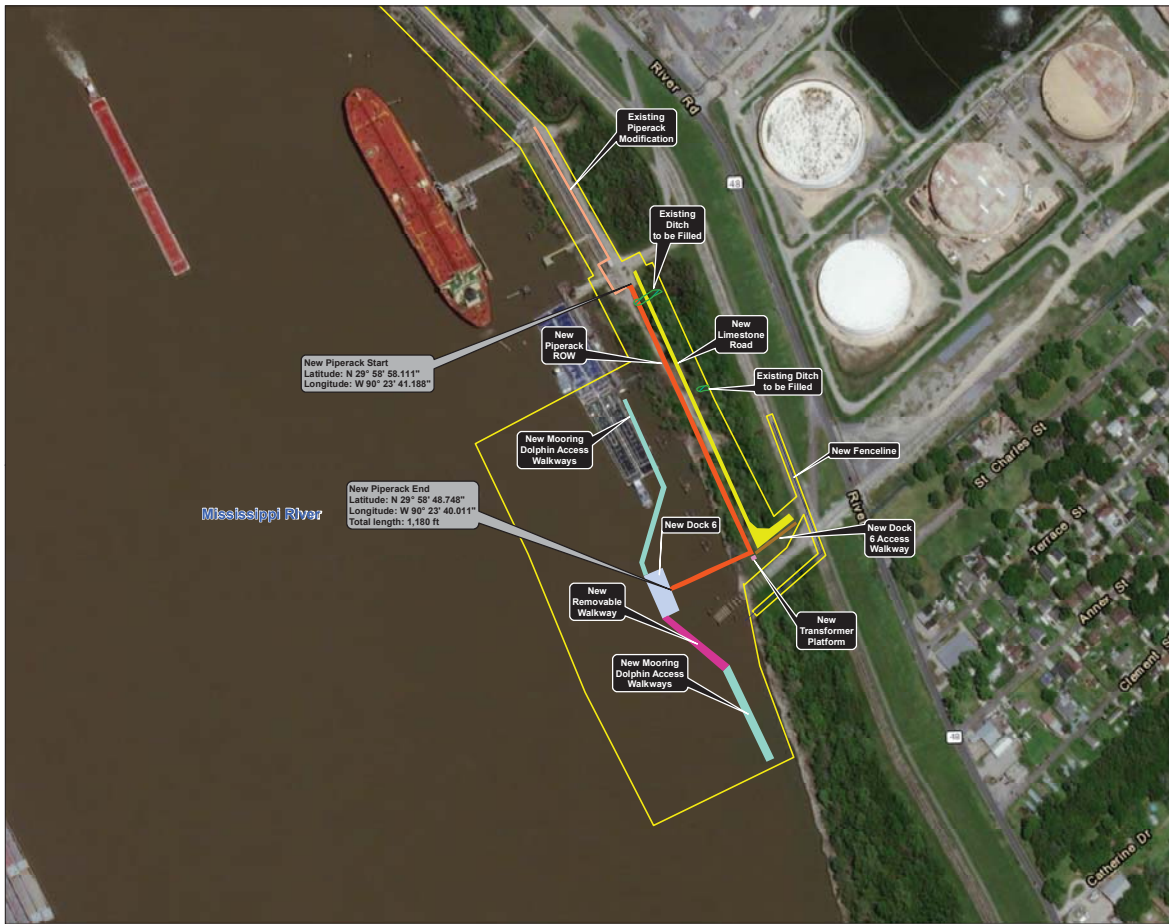

Project/Client: Valero assumes no responsibility for data supplied in electronic format. The recipient accepts full responsibility for verifying the accuracy and completeness of the data. The recipient releases Valero, its officers, employees, consultants and agents from any and all claims arising in any way from the content or provision of the data.

Project/Client: Valero assumes no responsibility for data supplied in electronic format. The recipient accepts full responsibility for verifying the accuracy and completeness of the data. The recipient releases Valero, its officers, employees, consultants and agents from any and all claims arising in any way from the content or provision of the data.

| Wetland and Waterbody Impacts | Acres | | | |
|--|--------|-------|-------|--------|
| | Total | PFO | PSS | PEM |
| Total Workspace Area | 15.234 | n/a | | |
| Total Wetland Impacts | 14.072 | 2.023 | 0.956 | 11.093 |
| Temporary Impacts to Wetlands | 12.376 | 0.541 | 0.956 | 10.879 |
| Permanent Fill in Wetlands | 0.458 | 0.244 | 0.000 | 0.215 |
| Permanent Conversion of PFO/PSS to PEM | 1.239 | n/a | | |
| Permanent Fill in Waterbodies | 0.169 | n/a | | |

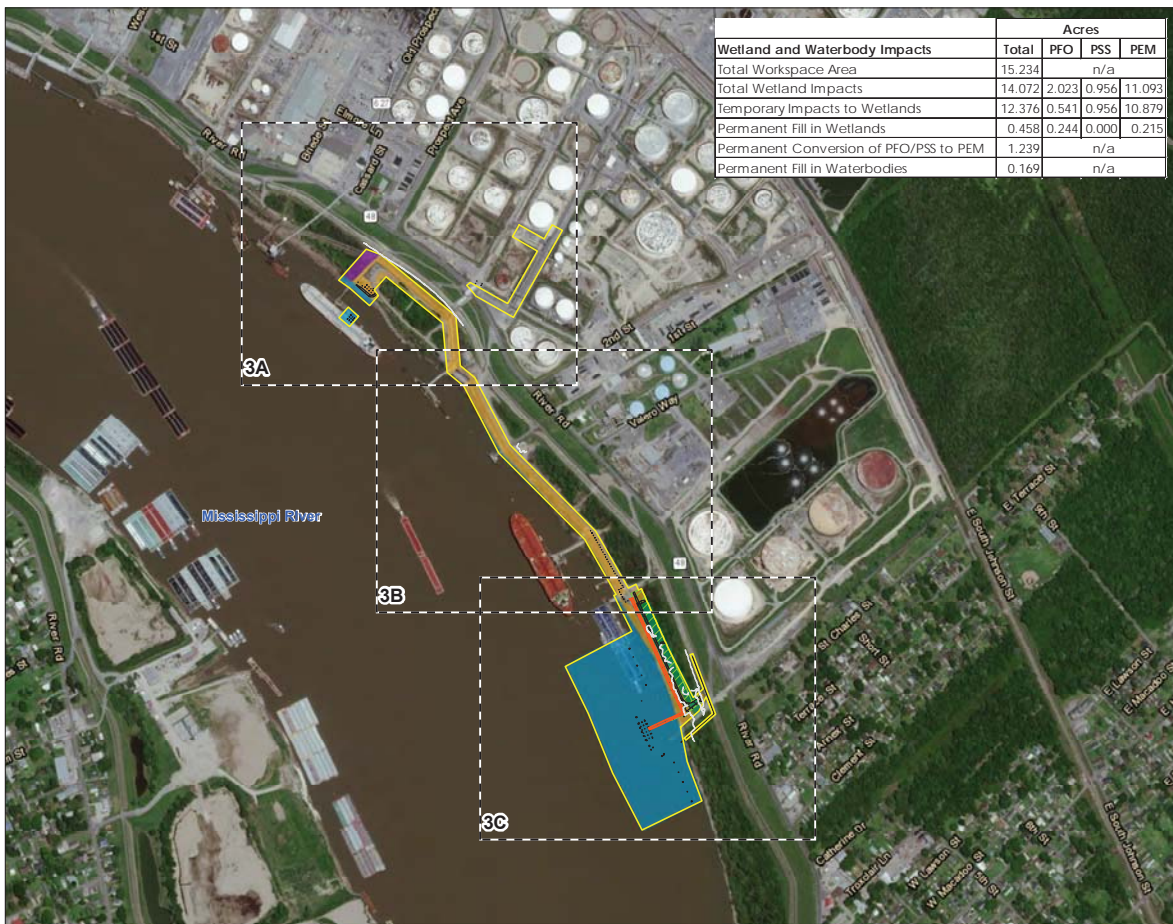
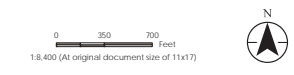

Figure No. **3**
Wetland and Waterbody Impacts Map
 Client/Project: Valero St. Charles Dock Expansion Project
 Joint Permit Application
 Project Location: New Orleans, Louisiana
 Prepared by: JD on 2018-02-08
 Technical Review by: KR on 2018-02-08
 Independent Review by: LG on 2018-02-15



- Legend**
- Wetlands**
- Herbaceous Wetlands
 - Forested Wetlands
 - Scrub/Shrub Wetlands
 - 18ft Elevation Contour
 - Section 10 Waters of the US
 - Project Workspace Areas
 - Maintained ROW
 - New Piperack ROW
 - Permanent Fill
 - New Pilings

*Adjustments in certain areas may occur



- Notes**
1. Coordinate System: NAD 1983 UTM Zone 15N
 2. Data Source: Valero
 3. Background: ESRI Aerial Imagery Base Maps

Pro-User: Valero assumes no responsibility for data supplied in electronic format. The recipient accepts full responsibility for verifying the accuracy and completeness of the data. The recipient releases Valero, its officers, employees, consultants and agents, from any and all claims arising in any way from the content or provision of the data.



Figure No. **3A**
Wetland and Waterbody Impacts Map

Client/Project
 Valero St. Charles Dock Expansion Project
 Joint Permit Application

Project Location
 New Orleans, Louisiana

172677309
 Prepared by JD on 2018-02-08
 Technical Review by RW on 2018-02-08
 Independent Review by LG on 2018-02-15



- Legend**
- Wetlands**
- Herbaceous Wetlands
 - Forested Wetlands
 - Scrub/Shrub Wetlands
 - 18ft Elevation Contour
 - Section 10 Waters of the US
 - Project Workspace Areas
 - Permanent Fill
 - New Pillings

*Adjustments in certain areas may occur

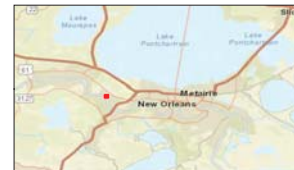

- Notes**
1. Coordinate System: NAD 1983 UTM Zone 15N
 2. Data Sources include: Valero
 3. Background: ESRI Aerial Imagery Base Maps

Valero and/or its subsidiaries assume no responsibility for data supplied in electronic format. The recipient accepts full responsibility for verifying the accuracy and completeness of the data. The recipient releases Valero, its officers, employees, consultants and agents, from any and all claims liability in any way from the content or provision of the data.

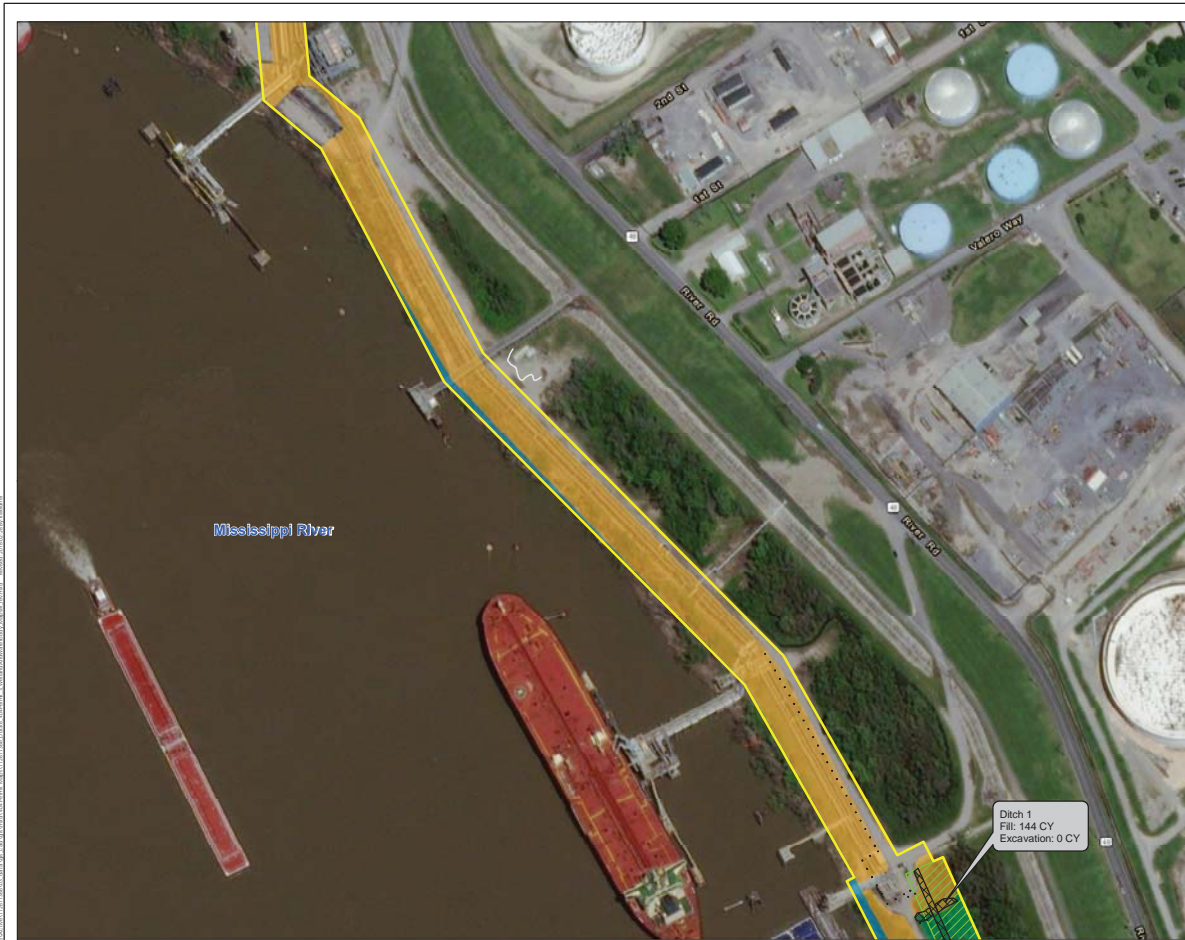

Figure No. **38**
 Title **Wetland and Waterbody Impacts Map**

Client/Project
 Valero St. Charles Dock Expansion Project
 Joint Permit Application

Project Location 172677309
 New Orleans, Louisiana Prepared by JD on 2018-02-08
 Technical Review by RW on 2018-02-08
 Independent Review by LG on 2018-02-15



- Legend**
- Wetlands**
- Herbaceous Wetlands
 - Forested Wetlands
 - 18ft Elevation Contour
 - Section 10 Waters of the US
 - Project Workspace Areas
 - Maintained ROW
 - Permanent Fill
 - New Pillings

*Adjustments in certain areas may occur

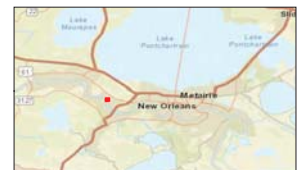

- Notes**
1. Coordinate System: NAD 1983 UTM Zone 15N
 2. Data Sources include: Valero
 3. Background: ESRI Aerial Imagery Base Maps

The sender, Valero, assumes no responsibility for data supplied in electronic format. The recipient accepts full responsibility for verifying the accuracy and completeness of the data. The recipient releases Valero, its officers, employees, consultants and agents, from any and all claims arising in any way from the content or provision of the data.



Figure No. **3C**
Wetland and Waterbody Impacts Map

Client/Project
 Valero St. Charles Dock Expansion Project
 Joint Permit Application

Project Location
 New Orleans, Louisiana

172677309
 Prepared by JD on 2018-02-08
 Technical Review by RW on 2018-02-08
 Independent Review by LG on 2018-02-15



- Legend**
- Wetlands**
- Herbaceous Wetlands
 - Forested Wetlands
 - 18ft Elevation Contour
 - Section 10 Waters of the US
 - Project Workspace Areas
 - Maintained ROW
 - Permanent Fill
 - New Pillings

*Adjustments in certain areas may occur



- Notes**
1. Coordinate System: NAD 1983 UTM Zone 15N
 2. Data Sources include: Valero
 3. Background: ESRI Aerial Imagery Base Maps

Valero Energy Services, Inc. assumes no responsibility for data supplied in electronic format. The recipient accepts full responsibility for verifying the accuracy and completeness of the data. The recipient releases Valero, its officers, employees, consultants and agents, from any and all claims arising in any way from the content or provision of the data.

Notice: This drawing and all information herein contained are the property of VALERO DESIGN CORPORATION and its licensor. It is to be used only for the project and site for which it was prepared. It is to be used only for the project and site for which it was prepared. It is to be used only for the project and site for which it was prepared. It is to be used only for the project and site for which it was prepared.

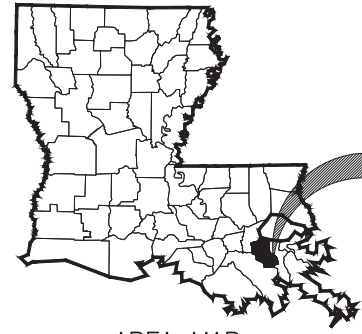
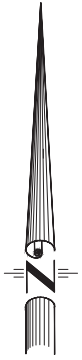

ST. CHARLES PARISH

AREA MAP



PROJECT SITE
(SEE P-2)

AECOM AECOM JOB NO. 31668-102

| REV | DATE | ENG. | DESIGN | DRAWN | CHECK | COMPANY/ENG | MOC# | AFE#/WO# | DESCRIPTION |
|-----|----------|------|--------|-------|-------|-------------|------|-----------|-----------------------|
| A | 12/14/17 | GMF | GMF | JRG | GMF | AECOM | -- | SC17-0200 | ISSUED FOR 404 PERMIT |

VALERO ST. CHARLES REFINERY
 UNIT 98 - DOCKS
 DOCK NO. 2 EXPANSION & NEW DOCK NO. 6
 PROJECT VICINITY MAP
 A-SIZE (8.5X11) DWG. NO. P-1

| |
|------------------|
| PLANT AREA DOCKS |
| DATE: 12/14/2017 |
| SCALE: N.T.S. |
| COMPANY: AECOM |
| AFE: SC17-0200 |
| SHEET 1 of 21 |
| REV A |

Note: This drawing and all information herein contained are the property of VALERO ENERGY CORPORATION and its subsidiaries. It is to be used only for the project and location specifically identified in the title block. No part of this drawing may be reproduced, stored in a retrieval system, or transmitted in any form or by any means, electronic, mechanical, photocopying, recording, or by any information storage and retrieval system, without the prior written permission of VALERO ENERGY CORPORATION.

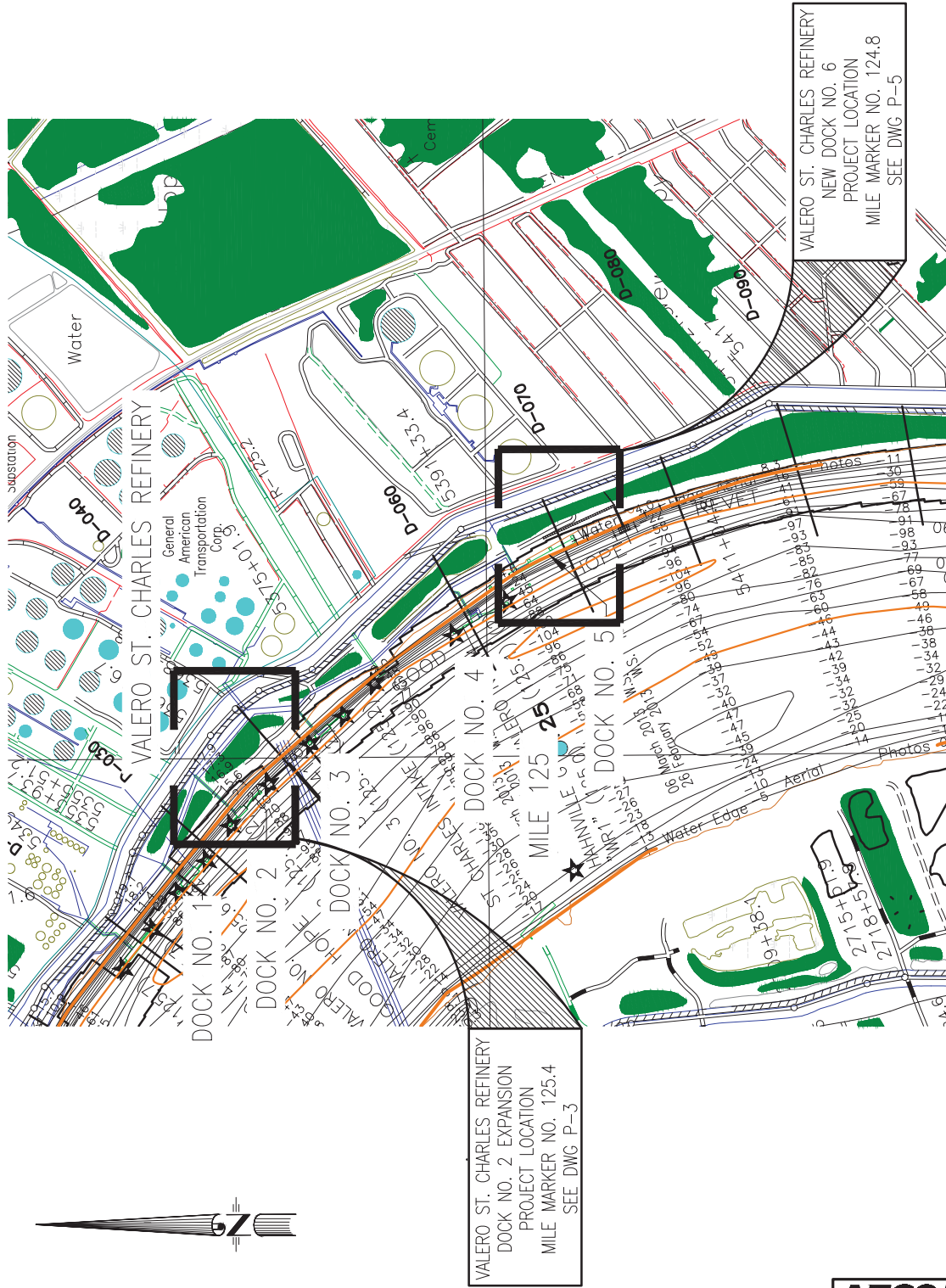

NOTE:
 REFERENCE USCOE HYDROGRAPHIC
 SURVEY, 2013, INDEX MAP

AECOM AECOM JOB NO. 31668-102

| | | | | | | | | | | | | | |
|-----|----------|------|--------|-------|-------|-------------|------|-----------|-----------------------|--|--|---|----------|
| | | | | | | | | | | VALERO ST. CHARLES REFINERY UNIT 98 - DOCKS DOCK NO. 2 EXPANSION & NEW DOCK NO. 6 PROJECT AREA MAP | | PLANT AREA DOCKS | |
| | | | | | | | | | | A-SIZE (8.5X11) | | DATE: 12/14/2017 SCALE: N.T.S. COMPANY: AECOM AFE: SC17-0200 | |
| A | 12/14/17 | GMF | GMF | JRG | GMF | AECOM | -- | SC17-0200 | ISSUED FOR 404 PERMIT | | | SHEET 2 of 21 | REV A |
| REV | DATE | ENG. | DESIGN | DRAWN | CHECK | COMPANY/ENG | MOC# | AFE#/WO# | DESCRIPTION | | | | |

Notice: This drawing and all data and information herein contained are the property of VALERO DESIGN CORPORATION. No part of this drawing, in whole or in part, may be reproduced, stored in a retrieval system, or transmitted in any form, or by any means, electronic, mechanical, photocopying, recording, or otherwise, without the prior written permission of VALERO DESIGN CORPORATION. Borrower to not be construed as a warranty or representation. Borrower to not be construed as a warranty or representation. Borrower to not be construed as a warranty or representation.

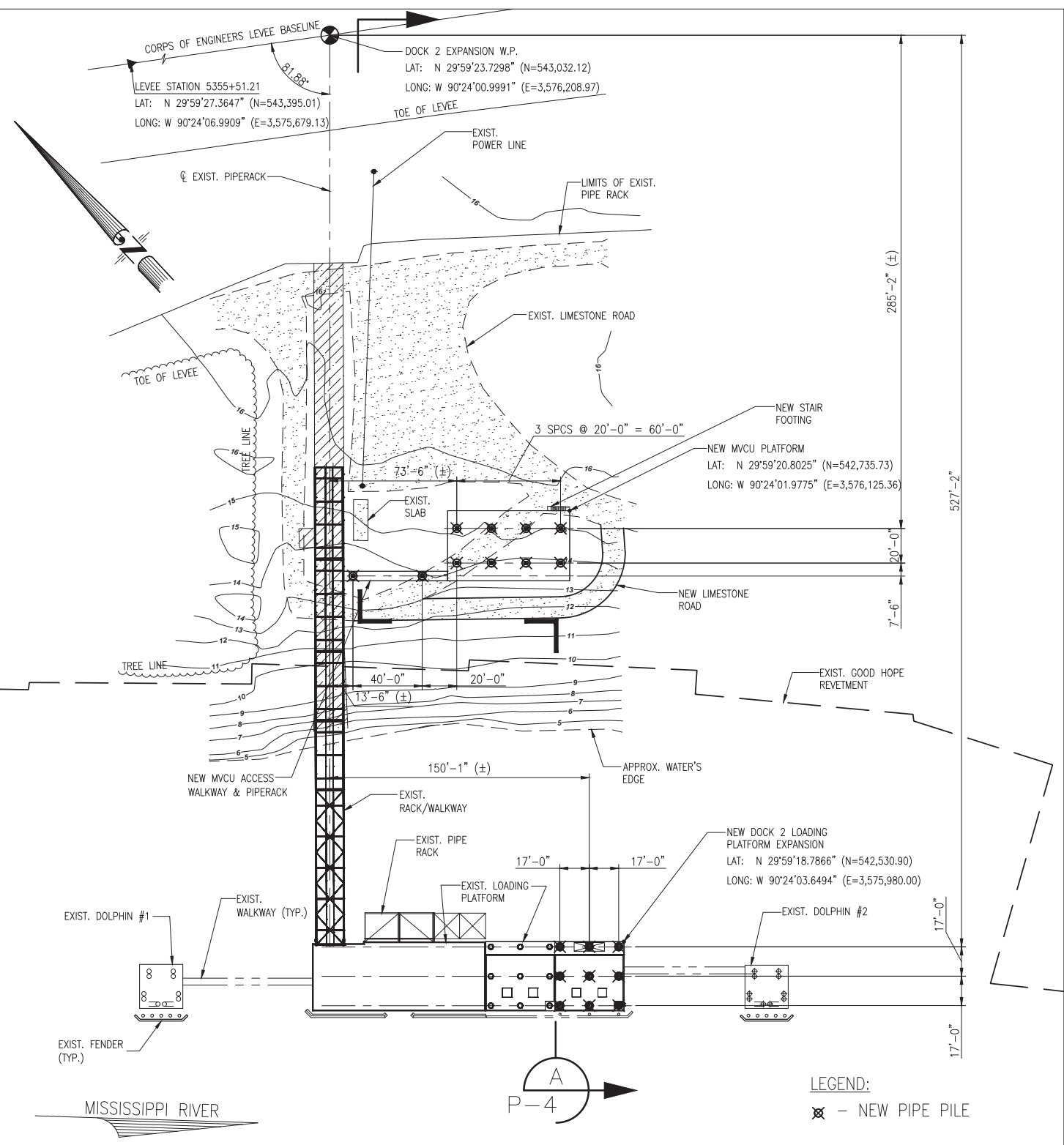

GENERAL ARRANGEMENT PLAN - DOCK NO. 2 EXPANSION
 1"=75'-0"

| | |
|--|-------------------------|
| | AECOM JOB NO. 31668-102 |
|--|-------------------------|

| REV | DATE | ENG. | DESIGN | DRAWN | CHECK | COMPANY/ENG | MOC# | AFE#/WO# | DESCRIPTION | PLANT AREA | DOCKS |
|-----|----------|------|--------|-------|-------|-------------|------|-----------|-----------------------|--|---|
| A | 12/14/17 | GMF | GMF | JRG | GMF | AECOM | -- | SC17-0200 | ISSUED FOR 404 PERMIT | VALERO ST. CHARLES REFINERY UNIT 98 - DOCKS DOCK NO. 2 EXPANSION GENERAL ARRANGEMENT | DATE: 12/14/2017 SCALE: AS NOTED COMPANY: AECOM AFE: SC17-0200 |
| | | | | | | | | | | SHEET 3 of 21 REV A | |

A-SIZE (8.5X11) DWG. NO. P-3

Note: This drawing and all data and information herein contained are the property of VALERO DESIGN CONSULTANTS, INC. and its licensor. It is provided to you in confidence and with the understanding and condition that all persons and/or legal entities receiving this drawing shall be deemed to have agreed not to copy, duplicate or reproduce it in any manner and to not disclose or use whatsoever, all or any part thereof except as expressly authorized in writing by VALERO DESIGN CONSULTANTS, INC. or its licensor. Any use of, alteration or reproduction of this drawing in any form, without the written consent of VALERO DESIGN CONSULTANTS, INC. or its licensor, is prohibited. Valero agrees to obtain the necessary permits for this project.

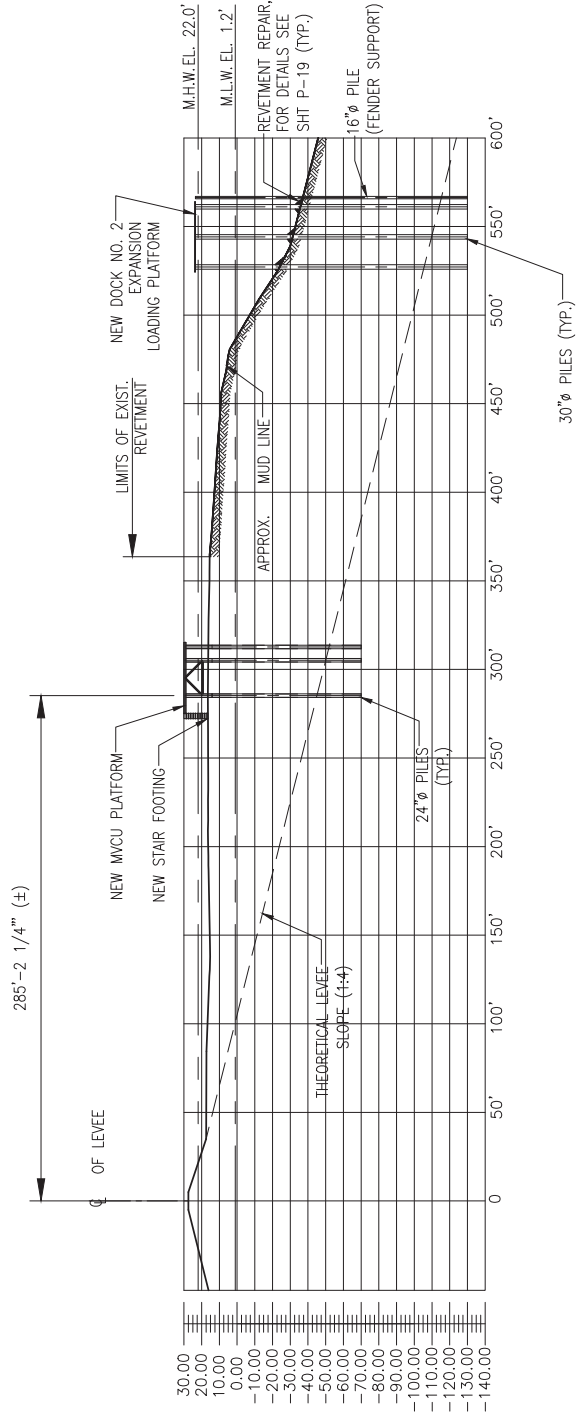

SECTION A
 1" = 100'-0"

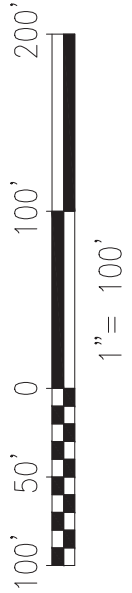

| REV | DATE | ENG. | DESIGN | DRAWN | CHECK | COMPANY/ENG | MOC# | AFE#/WO# | DESCRIPTION |
|-----|----------|------|--------|-------|-------|-------------|------|-----------|-----------------------|
| A | 12/14/17 | GMF | GMF | JRG | GMF | AECOM | -- | SC17-0200 | ISSUED FOR 404 PERMIT |

| | |
|---|---|
| VALERO ST. CHARLES REFINERY UNIT 98 - DOCKS DOCK NO. 2 EXPANSION SECTION @ DOCK NO. 2 EXPANSION | PLANT AREA DOCKS |
| | DATE: 12/14/2017 SCALE: AS NOTED COMPANY: AECOM AFE: SC17-0200 |
| A-SIZE (8.5X11) DWG. NO. P-4 | SHEET 4 of 21 REV A |



Note: This drawing and all information herein contained are the property of VALERO DESIGN CORPORATION and its licensor. In confidence and with the understanding and condition that all persons and/or legal entities receiving this drawing shall be deemed to have agreed not to copy, duplicate or reproduce it in any manner and to not disclose or use whatsoever, all or any part thereof except as expressly authorized in writing by VALERO DESIGN CORPORATION. Borrower to not, in any way, use or otherwise dispose of this drawing in any form, directly or indirectly for any use other than that for which it was intended. Borrower agrees to return this drawing promptly upon request.

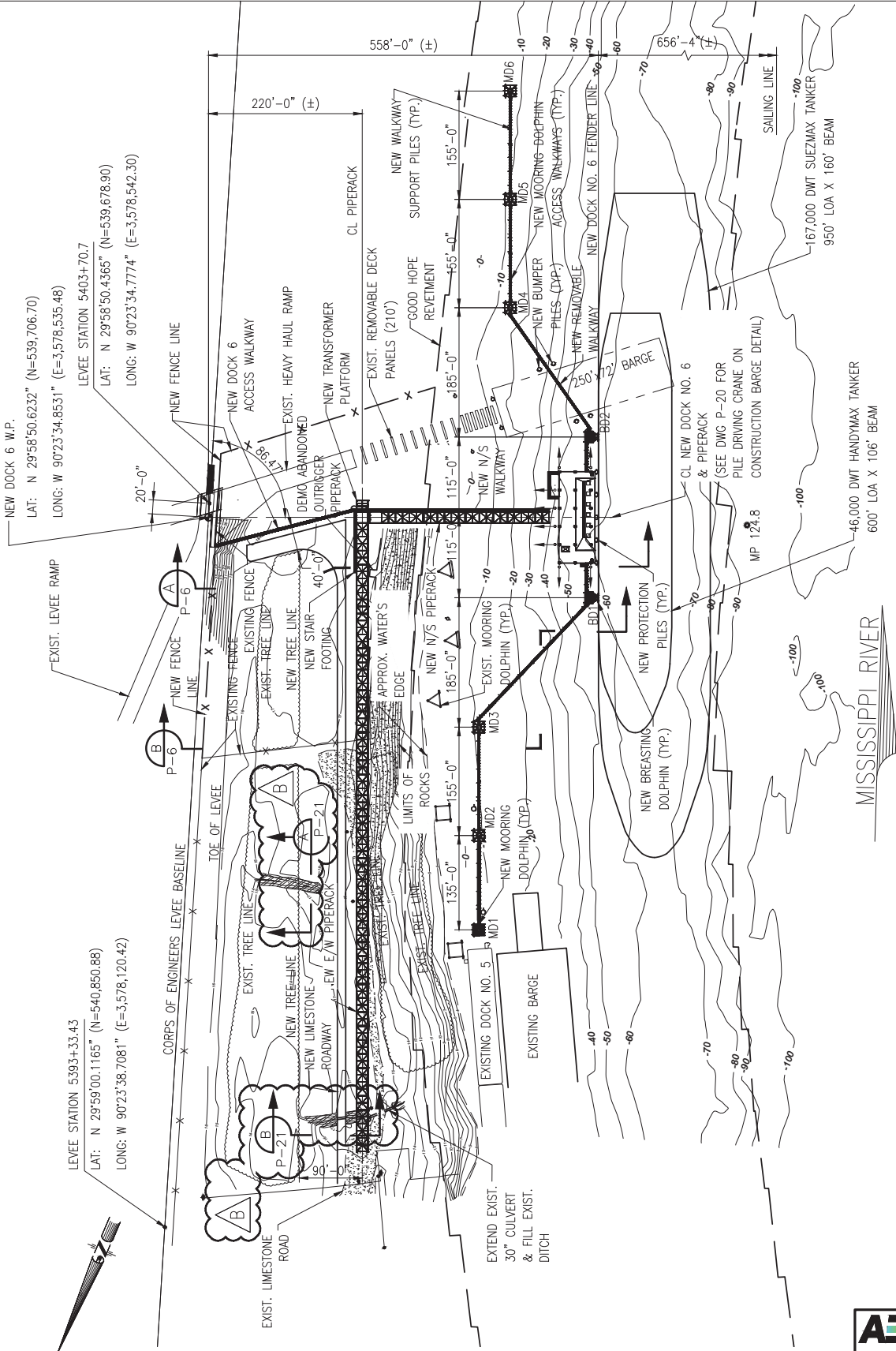

GENERAL ARRANGEMENT PLAN — NEW DOCK NO. 6

1"=200'-0"

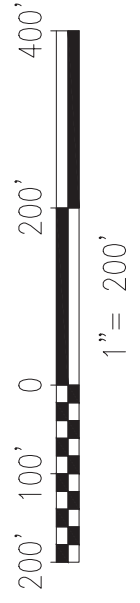

AECOM AECOM JOB NO. 31668-102

| REV | DATE | ENG. | DESIGN | DRAWN | CHECK | COMPANY/ENG | MOC# | AFE#/WO# | DESCRIPTION |
|-----|----------|------|--------|-------|-------|-------------|------|-----------|-----------------------|
| B | 03/01/18 | GMF | GMF | JRG | GMF | AECOM | -- | SC17-0200 | ISSUED FOR 404 PERMIT |
| A | 12/14/17 | GMF | GMF | JRG | GMF | AECOM | -- | SC17-0200 | ISSUED FOR 404 PERMIT |

VALERO ST. CHARLES REFINERY
 UNIT 98 — DOCKS
 NEW DOCK NO. 6
 GENERAL ARRANGEMENT

A-SIZE (8.5X11) DWG. NO. P-5

| PLANT AREA DOCKS | |
|------------------|------------|
| DATE: | 03/01/2018 |
| SCALE: | AS NOTED |
| COMPANY: | AECOM |
| AFE: | SC17-0200 |
| SHEET | 5 of 21 |
| REV | B |

Notice: This drawing and all information herein contained are the property of VALERO DESIGN CONSULTANTS, INC. and shall be borrower in confidence and with the understanding and condition that all persons and/or legal entities receiving this drawing shall be deemed to have agreed not to copy, duplicate or reproduce it in any manner and to not disclose or use whatsoever, all or any part thereof except as expressly authorized in writing by VALERO DESIGN CONSULTANTS, INC. Borrower is not to print, use or otherwise dispose of this drawing in any form, directly or indirectly, other than that to which it was submitted. Borrower agrees to return this drawing promptly upon request.

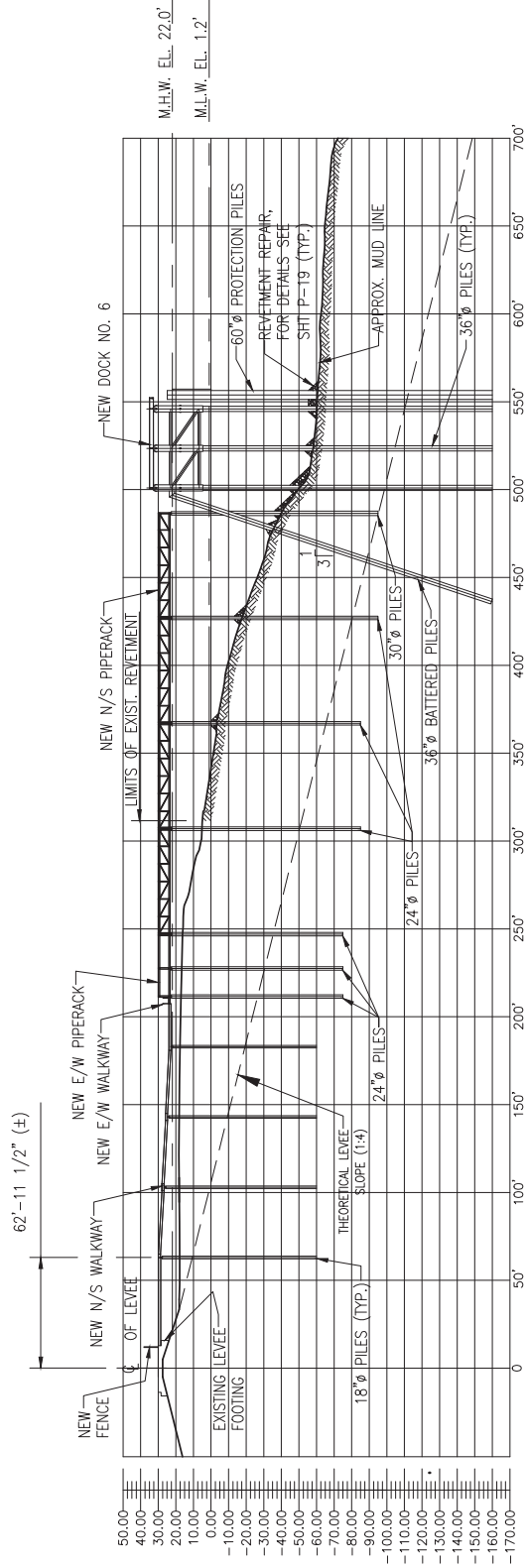

SECTION A
1"=100'-0"

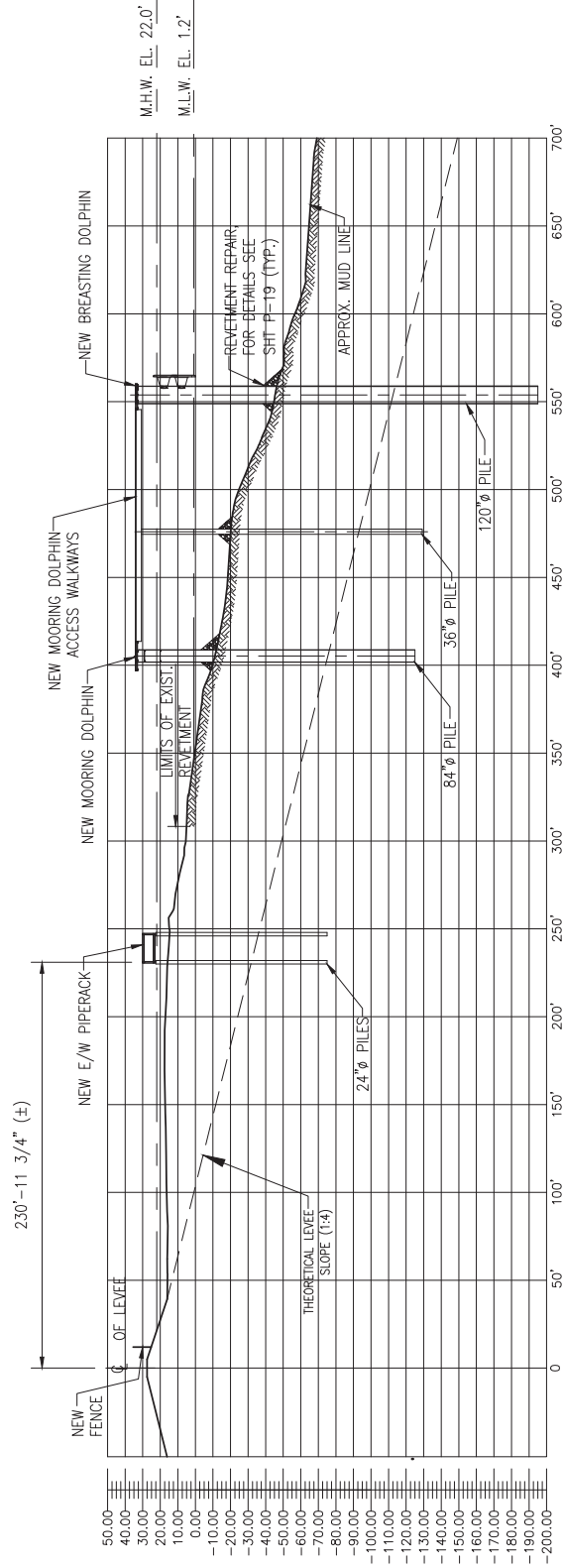

SECTION B
1"=100'-0"

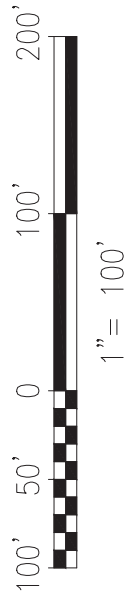

AECOM AECOM JOB NO. 31668-102

| REV | DATE | ENG. | DESIGN | DRAWN | CHECK | COMPANY/ENG | MOC# | AFE# / WO# | DESCRIPTION |
|-----|----------|------|--------|-------|-------|-------------|------|------------|-----------------------|
| A | 12/14/17 | GMF | GMF | JRG | GMF | AECOM | -- | SC17-0200 | ISSUED FOR 404 PERMIT |

VALERO ST. CHARLES REFINERY
UNIT 98 - DOCKS
NEW DOCK NO. 6
SECTIONS @ NEW DOCK NO. 6
A-SIZE (8.5X11) DWG. NO. P-6

| |
|------------------|
| PLANT AREA DOCKS |
| DATE: 12/14/2017 |
| SCALE: AS NOTED |
| COMPANY: AECOM |
| AFE: SC17-0200 |
| SHEET 6 of 21 |
| REV A |

Note: This drawing and all data and information herein contained are the property of VALERO ENERGY CORPORATION and its subsidiaries. No part of this drawing may be reproduced or transmitted in any form or by any means, electronic, mechanical, photocopying, recording, or by any information storage and retrieval system, without the prior written permission of VALERO ENERGY CORPORATION. The user of this drawing agrees to indemnify and hold harmless VALERO ENERGY CORPORATION and its subsidiaries from and against all claims, damages, losses, and expenses, including reasonable attorneys' fees, that may be incurred by VALERO ENERGY CORPORATION or its subsidiaries in connection with the use of this drawing.

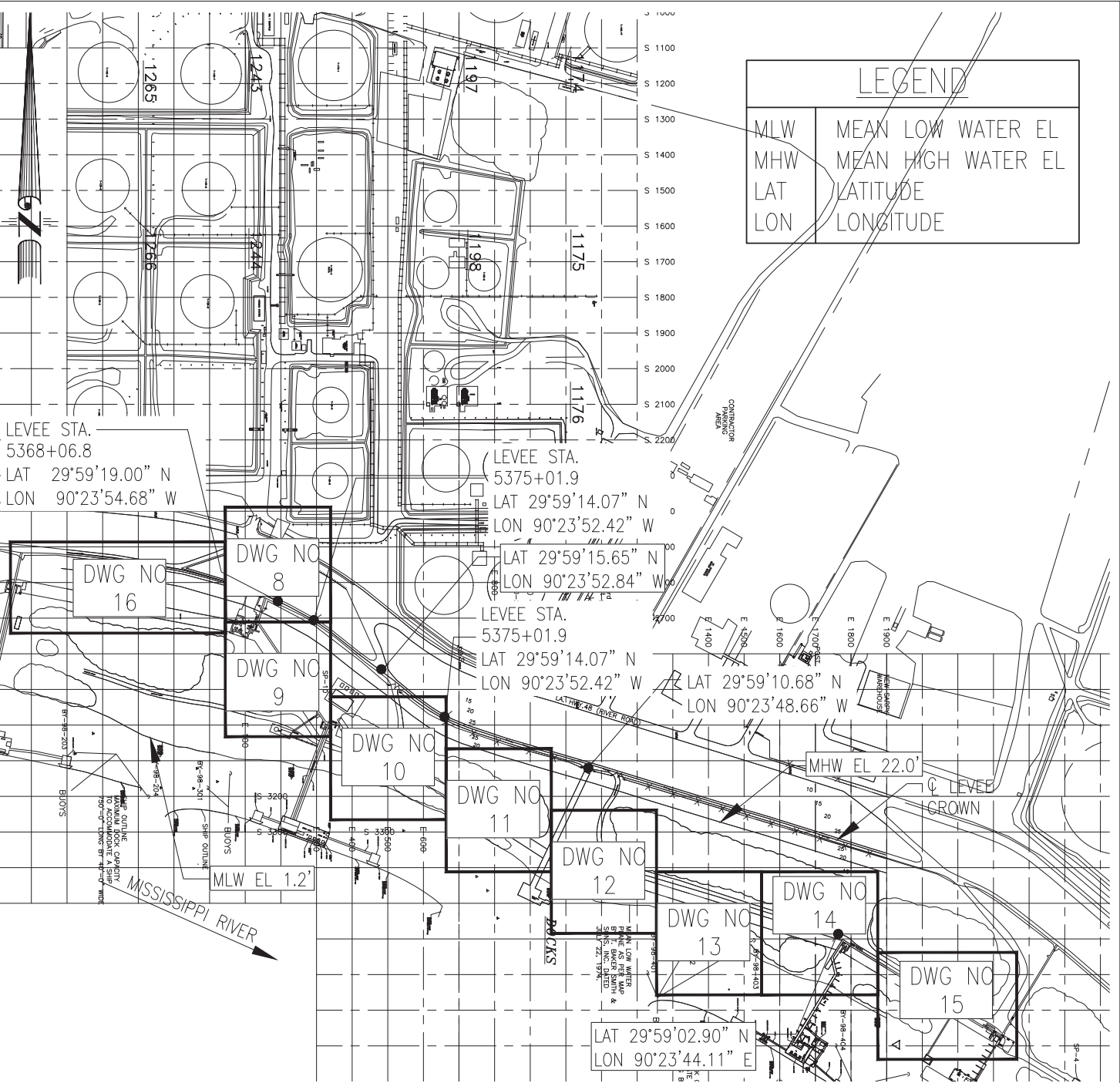

OVERALL KEY PLAN

N.T.S.

NOTE:
 FFL AT RIVER MILE MARKER
 125.4 IS 22.8 FT NAVD88 AS
 PER EMAIL KYLE GORDON
 (USACE).

AECOM JOB NO. 31668-102

| | | | | | | | | | | | |
|---|----------|------|--------|-------|-------|-------------|------|-----------|-----------------------|---------------------|--------------|
| VALERO ST. CHARLES REFINERY UNIT 98 - DOCKS PIPERACK MODIFICATIONS OVERALL KEY PLAN | | | | | | | | | | PLANT AREA DOCKS | |
| | | | | | | | | | | DATE: 12/14/2017 | |
| | | | | | | | | | | SCALE: N.T.S. | |
| | | | | | | | | | | COMPANY: AECOM | |
| | | | | | | | | | | AFE: SC17-0200 | |
| | | | | | | | | | | SHEET 7 of 21 | |
| | | | | | | | | | | REV A | |
| A | 12/14/17 | GMF | GMF | JRG | GMF | AECOM | -- | SC17-0200 | ISSUED FOR 404 PERMIT | A-SIZE (8.5X11) | DWG. NO. P-7 |
| REV | DATE | ENG. | DESIGN | DRAWN | CHECK | COMPANY/ENG | MOC# | AFE#/WO# | DESCRIPTION | | |

Notice: This drawing and all information herein contained are the property of VALERO DESIGN CORPORATION and shall be borrower in confidence and with the understanding and condition that all persons and/or legal entities receiving this drawing shall be deemed to have agreed not to copy, duplicate or reproduce it in any manner and to not disclose or use whatsoever all or any part thereof except as expressly authorized in writing by VALERO DESIGN CORPORATION. Borrower is not to provide any warranty or liability for any use of this drawing in any form, directly or indirectly for any purpose other than that to which it was intended. Borrower agrees to return this drawing promptly upon request.

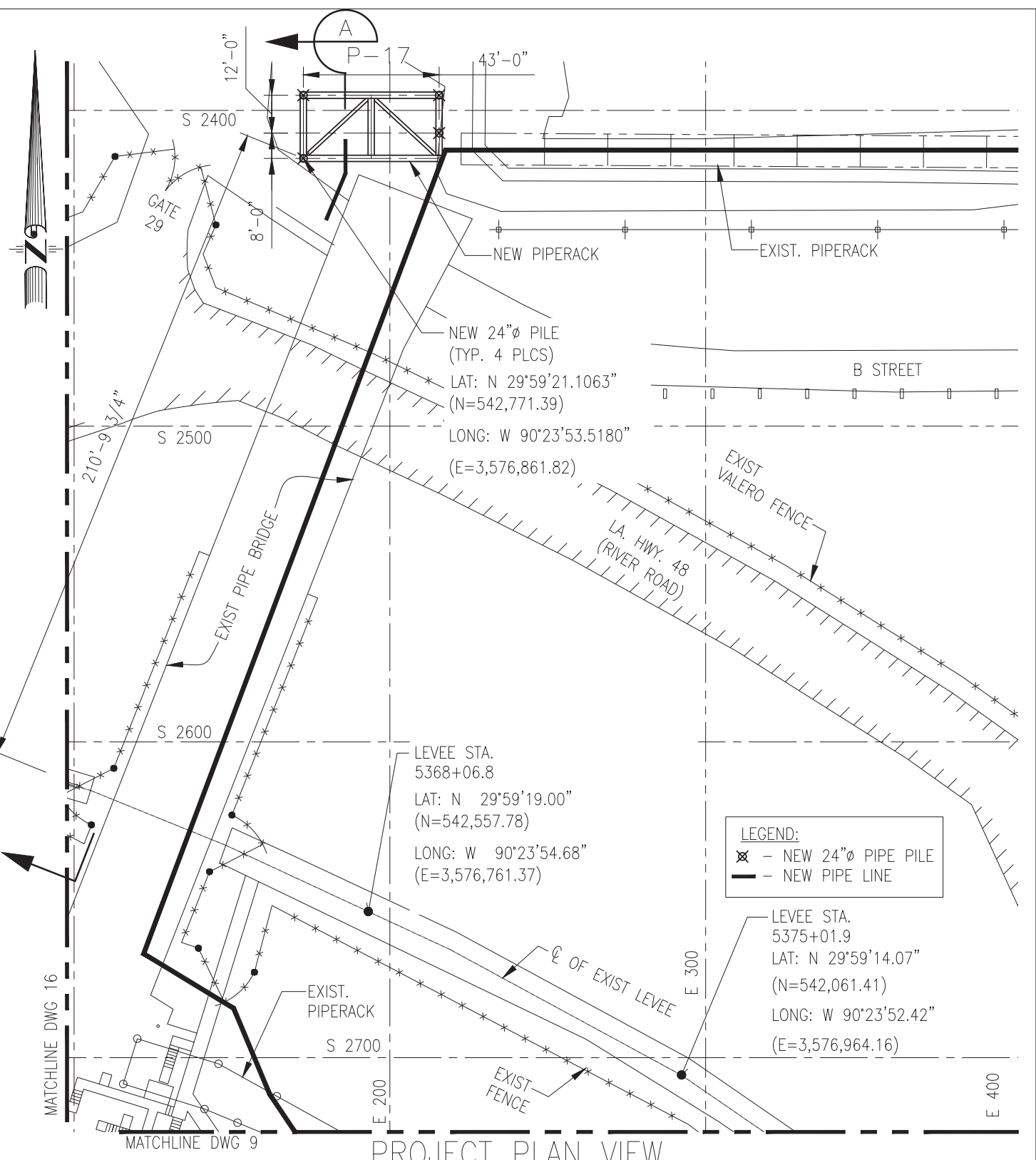

NOTE:
 ALL WORK CONTAINED ON
 THIS PAGE IS WITHIN 1500'
 OF THE LEVEE CENTERLINE

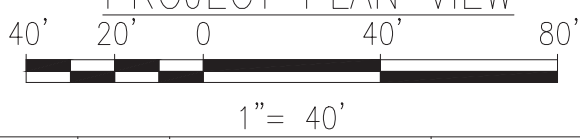

AECOM AECOM JOB NO. 31668-102
 VALERO ST. CHARLES REFINERY
 UNIT 98 - DOCKS
 PIPERACK MODIFICATIONS
 PARTIAL PLAN VIEW MISSISSIPPI RIVER 125 MILE

| REV | DATE | ENG. | DESIGN | DRAWN | CHECK | COMPANY/ENG | MOC# | AFE#/WO# | DESCRIPTION | A-SIZE (8.5X11) | DWG. NO. | REV | PLANT AREA | DOCKS | DATE: | SCALE: | COMPANY: | AFE: | SHEET | REV |
|-----|----------|------|--------|-------|-------|-------------|------|-----------|-----------------------|-----------------|----------|-----|------------|-------|------------|----------|----------|-----------|---------|-----|
| A | 12/14/17 | GMF | GMF | JRG | GMF | AECOM | -- | SC17-0200 | ISSUED FOR 404 PERMIT | | P-8 | | | | 12/14/2017 | AS NOTED | AECOM | SC17-0200 | 8 of 21 | A |

Note: This drawing and all data and information herein contained are the property of VALERO DESIGN CORPORATION, and is not to be, nor is it to be, reproduced, in confidence and with the understanding and condition that all persons and/or legal entities receiving this drawing shall be deemed to have agreed not to copy, duplicate or reproduce it in any manner and to not disclose or use whatsoever, all or any part thereof except as expressly authorized in writing by VALERO DESIGN CORPORATION. Borrower is not to print, use or otherwise dispose of this drawing in any form, directly or indirectly, for any purpose other than that to which it was intended. Borrower agrees to return this drawing promptly upon request.

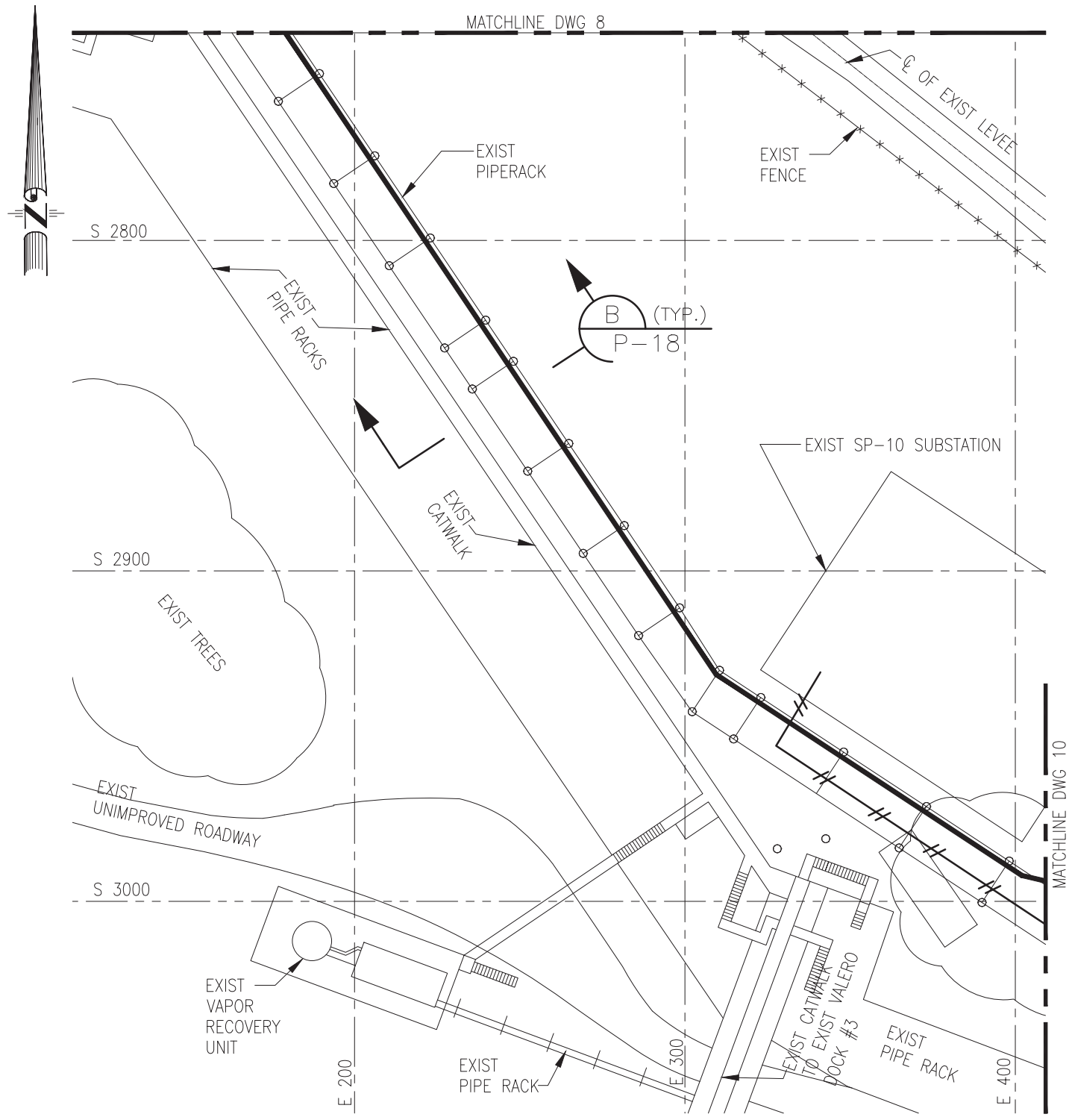

PROJECT PLAN VIEW

NOTE:
 ALL WORK CONTAINED ON
 THIS PAGE IS WITHIN 1500'
 OF THE LEVEE CENTERLINE

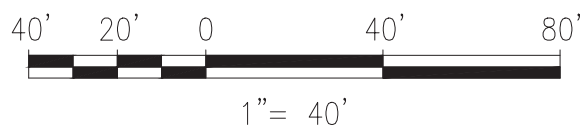

- LEGEND:
- NEW PIPE LINE
 - NEW CABLE TRAY

AECOM AECOM JOB NO. 31668-102

| | | | | | | | | | | | | | | |
|-----|----------|------|--------|-------|-------|-------------|------|-----------|-----------------------|---|-----------------|--|---------|-----|
| | | | | | | | | | | VALERO ST. CHARLES REFINERY UNIT 98 - DOCKS PIPERACK MODIFICATIONS PARTIAL PLAN VIEW MISSISSIPPI RIVER 125 MILE | | PLANT AREA DOCKS DATE: 12/14/2017 SCALE: AS NOTED COMPANY: AECOM AFE: SC17-0200 | | |
| A | 12/14/17 | GMF | GMF | JRG | GMF | AECOM | -- | SC17-0200 | ISSUED FOR 404 PERMIT | | A-SIZE (8.5X11) | DWG. No. P-9 | SHEET | REV |
| REV | DATE | ENG. | DESIGN | DRAWN | CHECK | COMPANY/ENG | MOC# | AFE#/WO# | DESCRIPTION | | | | 9 of 21 | A |

Notice: This drawing and all information herein contained are the property of VALERO DESIGN COMPANY (VDC) and is not to be reproduced, modified, or used in any manner without the written consent of VALERO DESIGN COMPANY. Valero Design Company is not responsible for any errors or omissions in this drawing. Valero Design Company is not responsible for any damage or injury to any person or property caused by the use of this drawing. Valero Design Company is not responsible for any damage or injury to any person or property caused by the use of this drawing. Valero Design Company is not responsible for any damage or injury to any person or property caused by the use of this drawing.

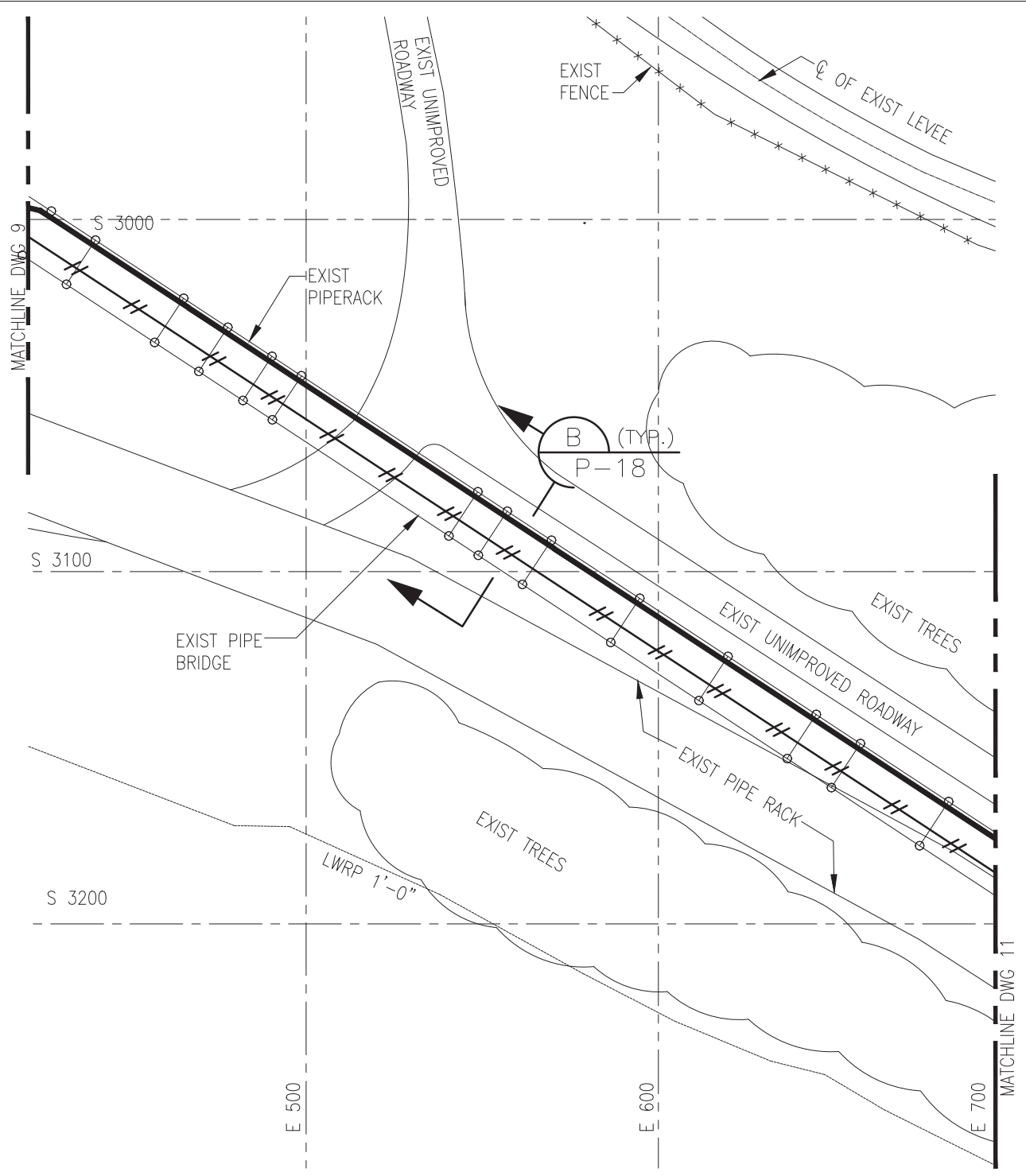
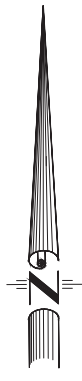

NOTE:
 ALL WORK CONTAINED ON
 THIS PAGE IS WITHIN 1500'
 OF THE LEVEE CENTERLINE

PROJECT PLAN VIEW

LEGEND:
 ——— NEW PIPE LINE
 // NEW CABLE TRAY

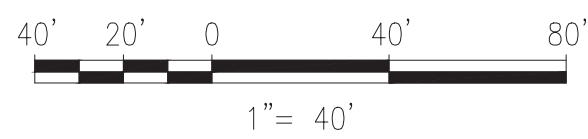

AECOM AECOM JOB NO. 31668-102

| | | | | | | | | | | VALERO ST. CHARLES REFINERY UNIT 98 - DOCKS PIPERACK MODIFICATIONS PARTIAL PLAN VIEW MISSISSIPPI RIVER 125 MILE | | PLANT AREA DOCKS DATE: 12/14/2017 SCALE: AS NOTED COMPANY: AECOM AFE: SC17-0200 | |
|-----|----------|------|--------|-------|-------|-------------|------|-----------|-----------------------|---|---------------|--|----------|
| A | 12/14/17 | GMF | GMF | JRG | GMF | AECOM | -- | SC17-0200 | ISSUED FOR 404 PERMIT | A-SIZE (8.5X11) | DWG. NO. P-10 | SHEET 10 of 21 | REV A |
| REV | DATE | ENG. | DESIGN | DRAWN | CHECK | COMPANY/ENG | MOC# | AFE#/WO# | DESCRIPTION | | | | |

Notice: This drawing and all data and information herein contained are the property of VALERO DESIGN CONSULTING, INC. and its licensor. It is to be used only for the project and site for which it was prepared. It is not to be used for any other project or site without the written consent of VALERO DESIGN CONSULTING, INC. and its licensor. The licensor shall not be held responsible for any errors or omissions in this drawing. The licensor shall not be held responsible for any errors or omissions in this drawing. The licensor shall not be held responsible for any errors or omissions in this drawing.

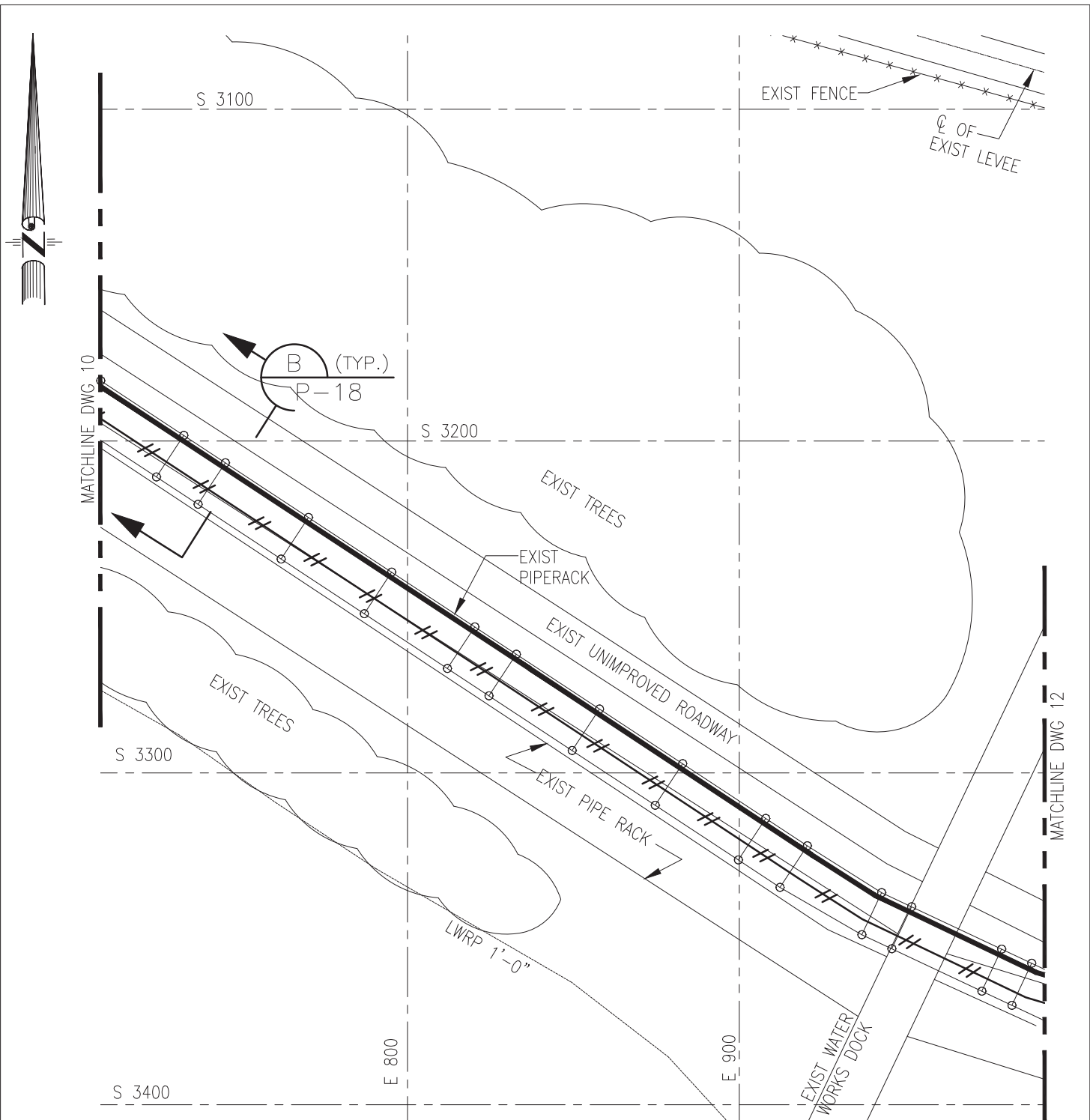

NOTE:
 ALL WORK CONTAINED ON
 THIS PAGE IS WITHIN 1500'
 OF THE LEVEE CENTERLINE

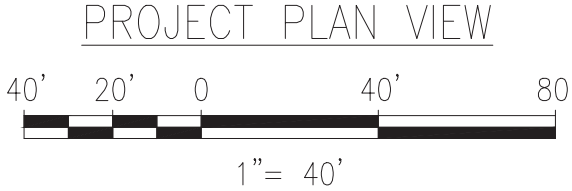

LEGEND:
 ——— NEW PIPE LINE
 // NEW CABLE TRAY

AECOM AECOM JOB NO. 31668-102

| | | | | | | | | | | | | | | | |
|-----|----------|------|--------|-------|-------|-------------|------|-----------|-----------------------|---|-----------------|---|-------|----------|-----|
| | | | | | | | | | | VALERO ST. CHARLES REFINERY UNIT 98 - DOCKS PIPERACK MODIFICATIONS PARTIAL PLAN VIEW MISSISSIPPI RIVER 125 MILE | | PLANT AREA DOCKS | | | |
| | | | | | | | | | | | | DATE: 12/14/2017 SCALE: AS NOTED COMPANY: AECOM AFE: SC17-0200 | | | |
| A | 12/14/17 | GMF | GMF | JRG | GMF | AECOM | -- | SC17-0200 | ISSUED FOR 404 PERMIT | | A-SIZE (8.5X11) | DWG. NO. | P-11 | REV | A |
| REV | DATE | ENG. | DESIGN | DRAWN | CHECK | COMPANY/ENG | MOC# | AFE#/WO# | DESCRIPTION | | | | SHEET | 11 of 21 | REV |

Notice: This drawing and all information herein contained are the property of VALERO DESIGN CONSULTANTS, INC. and is loaned to you for your use only. It is to be used only for the project and purpose for which it was prepared. No part of this drawing is to be reproduced or transmitted in any form or by any means, electronic, mechanical, photocopying, recording, or by any information storage and retrieval system, without the prior written permission of VALERO DESIGN CONSULTANTS, INC.

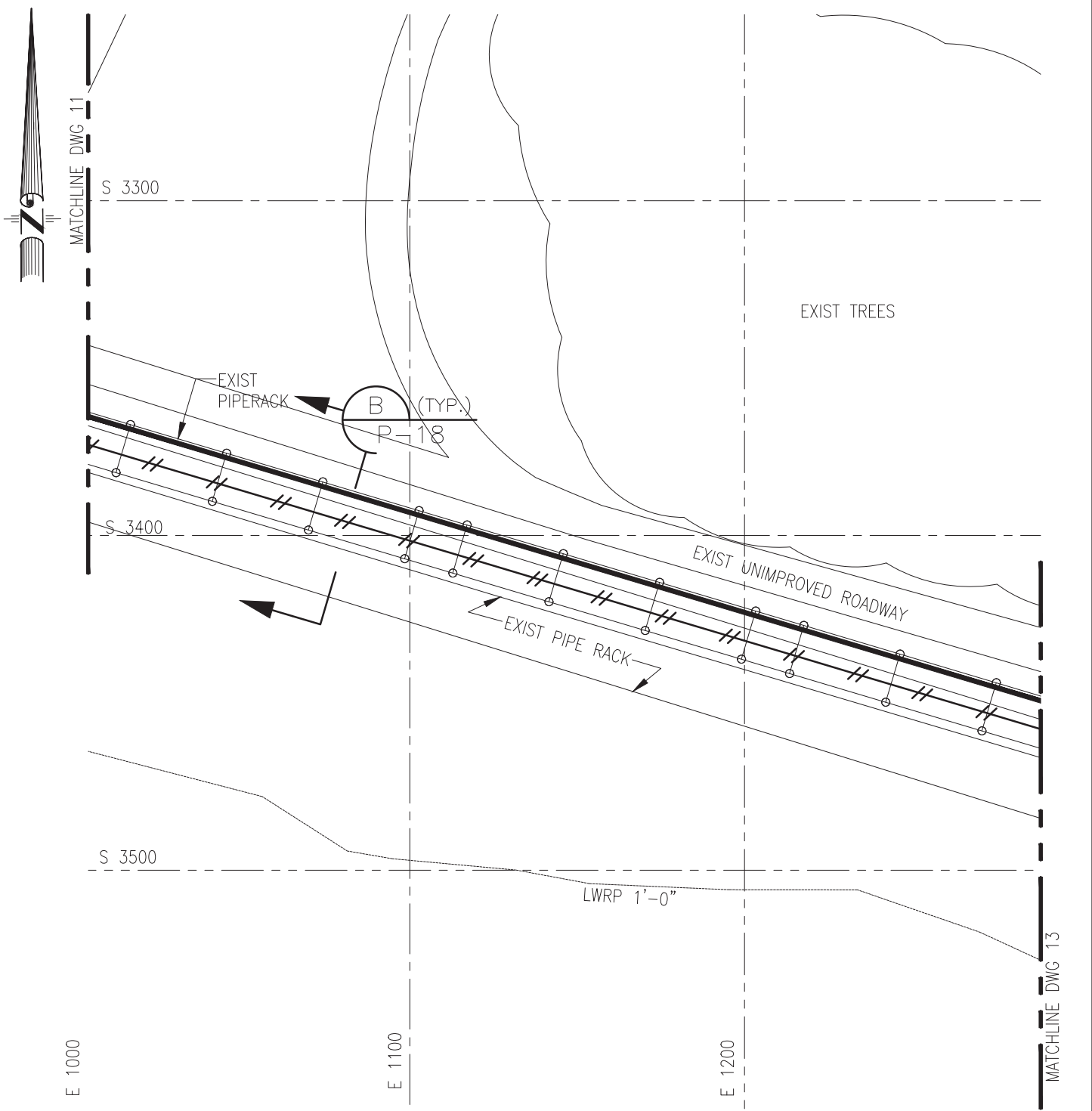

NOTE:
 ALL WORK CONTAINED ON
 THIS PAGE IS WITHIN 1500'
 OF THE LEVEE CENTERLINE

PROJECT PLAN VIEW

- LEGEND:**
- NEW PIPE LINE
 - NEW CABLE TRAY

AECOM JOB NO. 31668-102

| | | | | | | | | | | | | | | | |
|-----|----------|------|--------|-------|-------|-------------|------|-----------|-----------------------|---|--|---------------------|--|---|--|
| | | | | | | | | | | VALERO ST. CHARLES REFINERY UNIT 98 - DOCKS PIPERACK MODIFICATIONS PARTIAL PLAN VIEW MISSISSIPPI RIVER 125 MILE | | PLANT AREA DOCKS | | | |
| | | | | | | | | | | A-SIZE (8.5X11) | | DWG. NO. P-12 | | DATE: 12/14/2017 SCALE: AS NOTED COMPANY: AECOM AFE: SC17-0200 | |
| REV | DATE | ENG. | DESIGN | DRAWN | CHECK | COMPANY/ENG | MOC# | AFE#/WO# | DESCRIPTION | | | SHEET 12 of 21 | | REV A | |
| A | 12/14/17 | GMF | GMF | JRG | GMF | AECOM | -- | SC17-0200 | ISSUED FOR 404 PERMIT | | | | | | |

Note: This drawing and all information herein contained are the property of VALERO DESIGN CONSULTANTS, INC. and is loaned to the borrower in confidence and with the understanding and condition that all persons and/or legal entities receiving this drawing shall by the act of receiving it be deemed to have agreed not to copy, duplicate or reproduce it in any manner and to not disclose or use information contained herein in any way without the prior written consent of VALERO DESIGN CONSULTANTS, INC. Borrower is not to print, use or otherwise dispose of this drawing in any form, directly or indirectly for use in any project or other project without the prior written consent of VALERO DESIGN CONSULTANTS, INC.

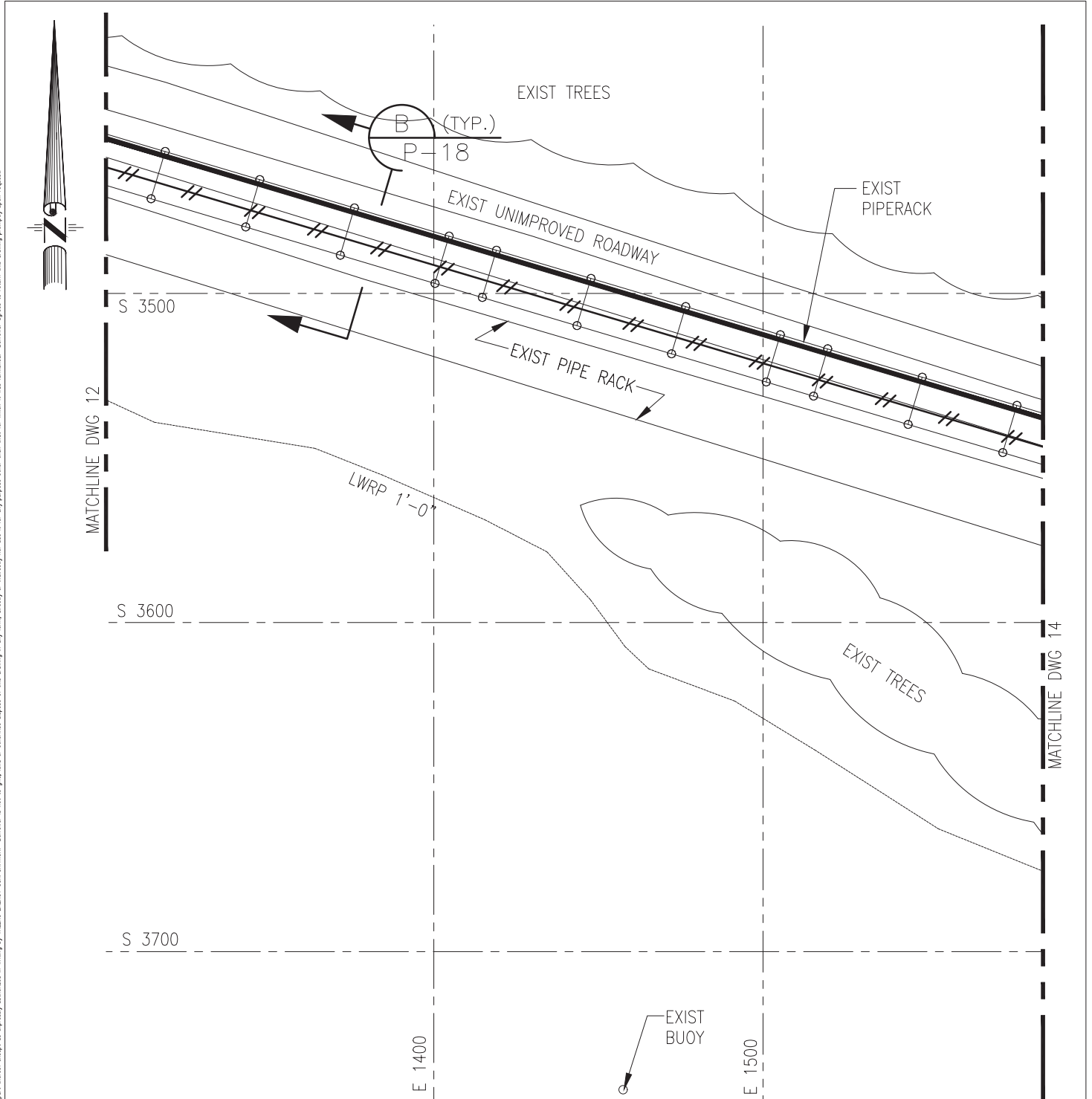

NOTE:
 ALL WORK CONTAINED ON
 THIS PAGE IS WITHIN 1500'
 OF THE LEVEE CENTERLINE

PROJECT PLAN VIEW

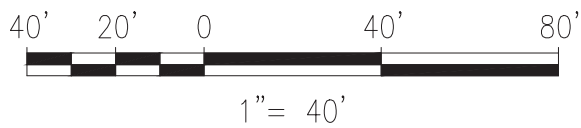

LEGEND:

- NEW PIPE LINE
- // NEW CABLE TRAY

AECOM AECOM JOB NO. 31668-102

| | | | | | | | | | | VALERO ST. CHARLES REFINERY UNIT 98 - DOCKS PIPERACK MODIFICATIONS PARTIAL PLAN VIEW MISSISSIPPI RIVER 125 MILE | | PLANT AREA DOCKS DATE: 12/14/2017 SCALE: AS NOTED COMPANY: AECOM AFE: SC17-0200 | |
|-----|----------|------|--------|-------|-------|-------------|------|-----------|-----------------------|---|---------------|--|----------|
| A | 12/14/17 | GMF | GMF | JRG | GMF | AECOM | -- | SC17-0200 | ISSUED FOR 404 PERMIT | A-SIZE (8.5X11) | DWG. NO. P-13 | SHEET 13 of 21 | REV A |
| REV | DATE | ENG. | DESIGN | DRAWN | CHECK | COMPANY/ENG | MOC# | AFE#/WO# | DESCRIPTION | | | | |

Note: This drawing and all information herein contained are the property of VALERO DESIGN CORPORATION and its subsidiaries. No part of this drawing shall be reproduced or transmitted in any form or by any means, electronic, mechanical, photocopying, recording, or by any information storage and retrieval system, without the prior written permission of VALERO DESIGN CORPORATION.

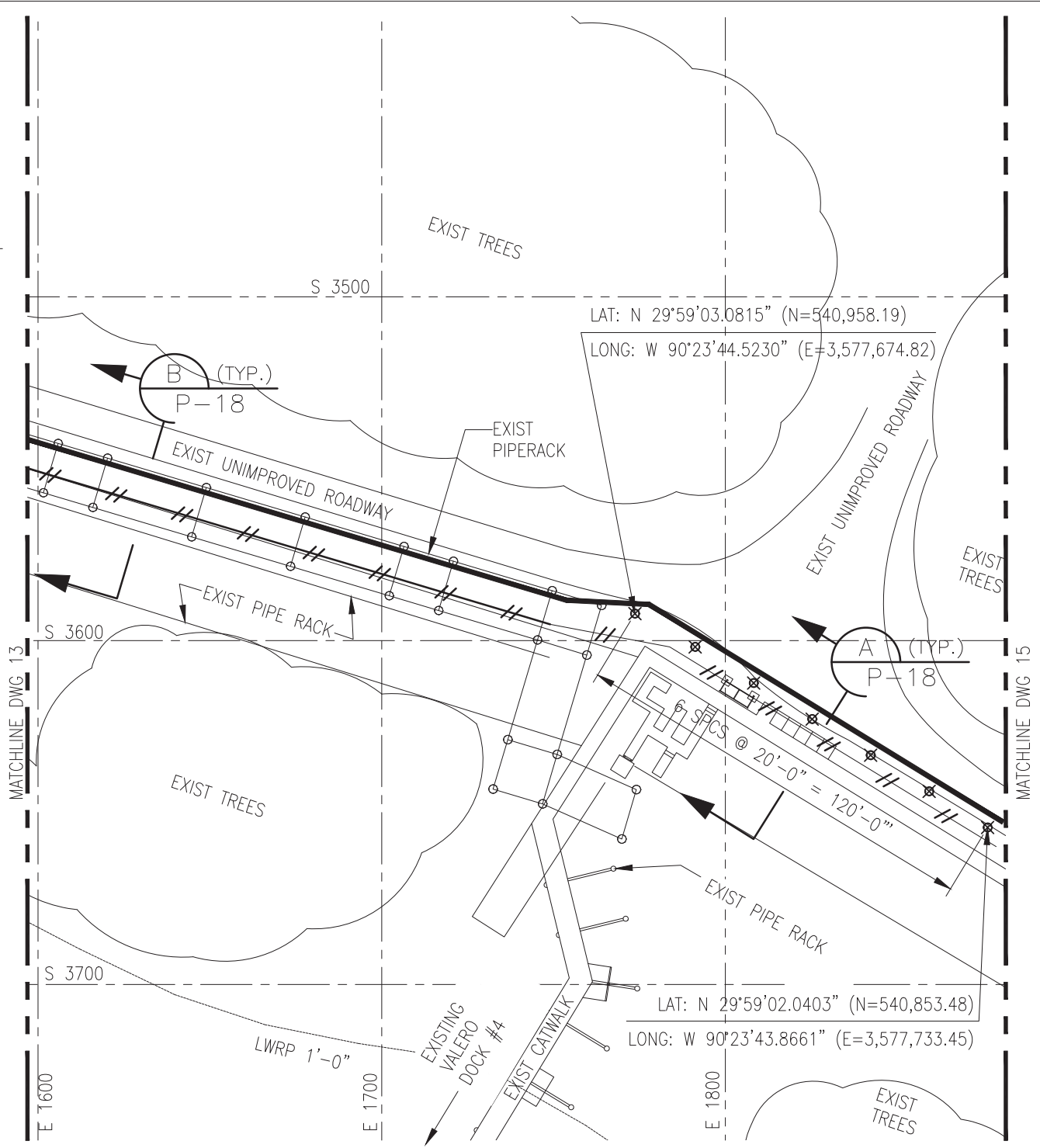
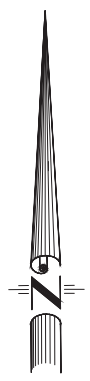

PROJECT PLAN VIEW

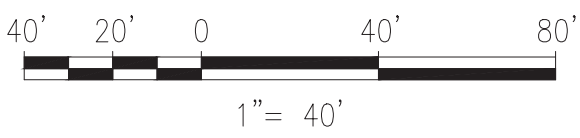

LEGEND:

- NEW PIPE LINE
- NEW CABLE TRAY
- NEW 18"Ø PIPE PILE

AECOM JOB NO. 31668-102

| | | | | | | | | | | VALERO ST. CHARLES REFINERY UNIT 98 - DOCKS PIPERACK MODIFICATIONS PARTIAL PLAN VIEW MISSISSIPPI RIVER 125 MILE | | PLANT AREA DOCKS DATE: 12/14/2017 SCALE: AS NOTED COMPANY: AECOM AFE: SC17-0200 | | |
|-----|----------|------|--------|-------|-------|-------------|------|-----------|-----------------------|---|----------|--|-------------------|----------|
| A | 12/14/17 | GMF | GMF | JRG | GMF | AECOM | -- | SC17-0200 | ISSUED FOR 404 PERMIT | A-SIZE (8.5X11) | DWG. NO. | P-14 | SHEET 14 of 21 | REV A |
| REV | DATE | ENG. | DESIGN | DRAWN | CHECK | COMPANY/ENG | MOC# | AFE#/WO# | DESCRIPTION | | | | | |

Note: This drawing and all information herein contained are the property of VALERO DESIGN CORPORATION, and is not to be retransmitted, reproduced, or otherwise disseminated without the written consent of VALERO DESIGN CORPORATION. Borrower is not to put, use or otherwise dispose of this drawing in any form, directly or indirectly, for any purpose other than that for which it was intended. Borrower agrees to indemnify and hold harmless the Designer from any and all claims, damages, costs, expenses and attorney's fees, in any manner and to the extent of the maximum allowed by applicable law, arising out of or in connection with the use of this drawing.

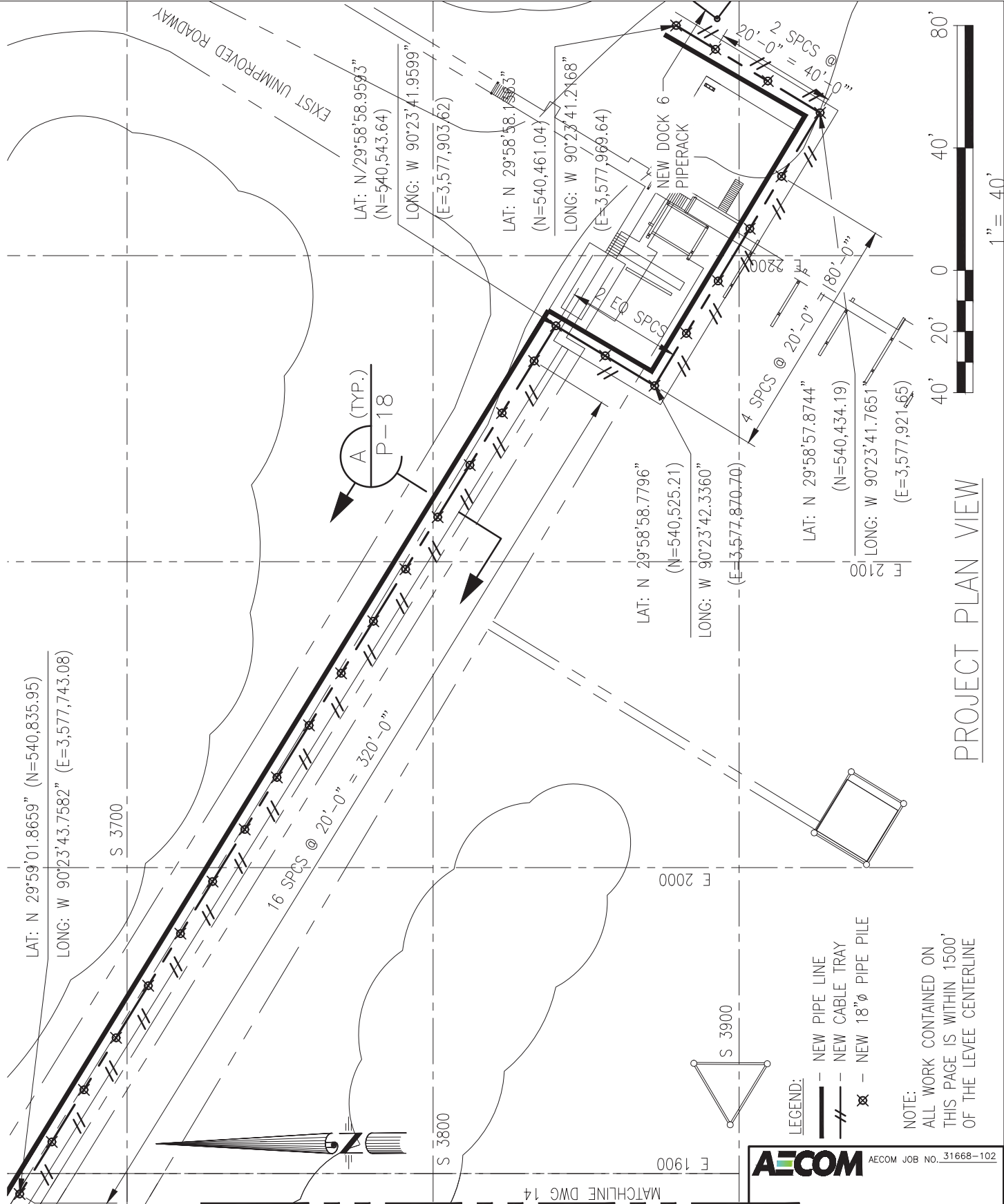

PROJECT PLAN VIEW

AECOM AECOM JOB NO. 31668-102

- LEGEND:**
- NEW PIPE LINE
 - NEW CABLE TRAY
 - ⊗ NEW 18"Ø PIPE PILE

NOTE:
 ALL WORK CONTAINED ON
 THIS PAGE IS WITHIN 1500'
 OF THE LEVEE CENTERLINE

| REV | DATE | ENG. | DESIGN | DRAWN | CHECK | COMPANY/ENG | MOC# | AFE#/WO# | DESCRIPTION |
|-----|----------|------|--------|-------|-------|-------------|------|-----------|-----------------------|
| A | 12/14/17 | GMF | GMF | JRG | GMF | AECOM | -- | SC17-0200 | ISSUED FOR 404 PERMIT |

VALERO ST. CHARLES REFINERY

UNIT 98 - DOCKS
 BATTURE PIPERACK
 PLAN VIEW MISSISSIPPI RIVER 125 MILE

A-SIZE (8.5X11) DWG. NO. P-15

| | |
|---------------------|------------------|
| PLANT AREA DOCKS | DATE: 12/14/2017 |
| SCALE: AS NOTED | COMPANY: AECOM |
| AFE: SC17-0200 | SHEET REV |
| SHEET 15 of 21 | 15 of 21 |

Note: This drawing and all information herein contained are the property of VALERO DESIGN CORPORATION and its subsidiaries. No part of this drawing is to be reproduced or transmitted in any form or by any means, electronic, mechanical, photocopying, recording, or by any information storage and retrieval system, without the prior written permission of VALERO DESIGN CORPORATION.

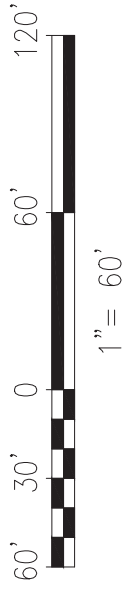
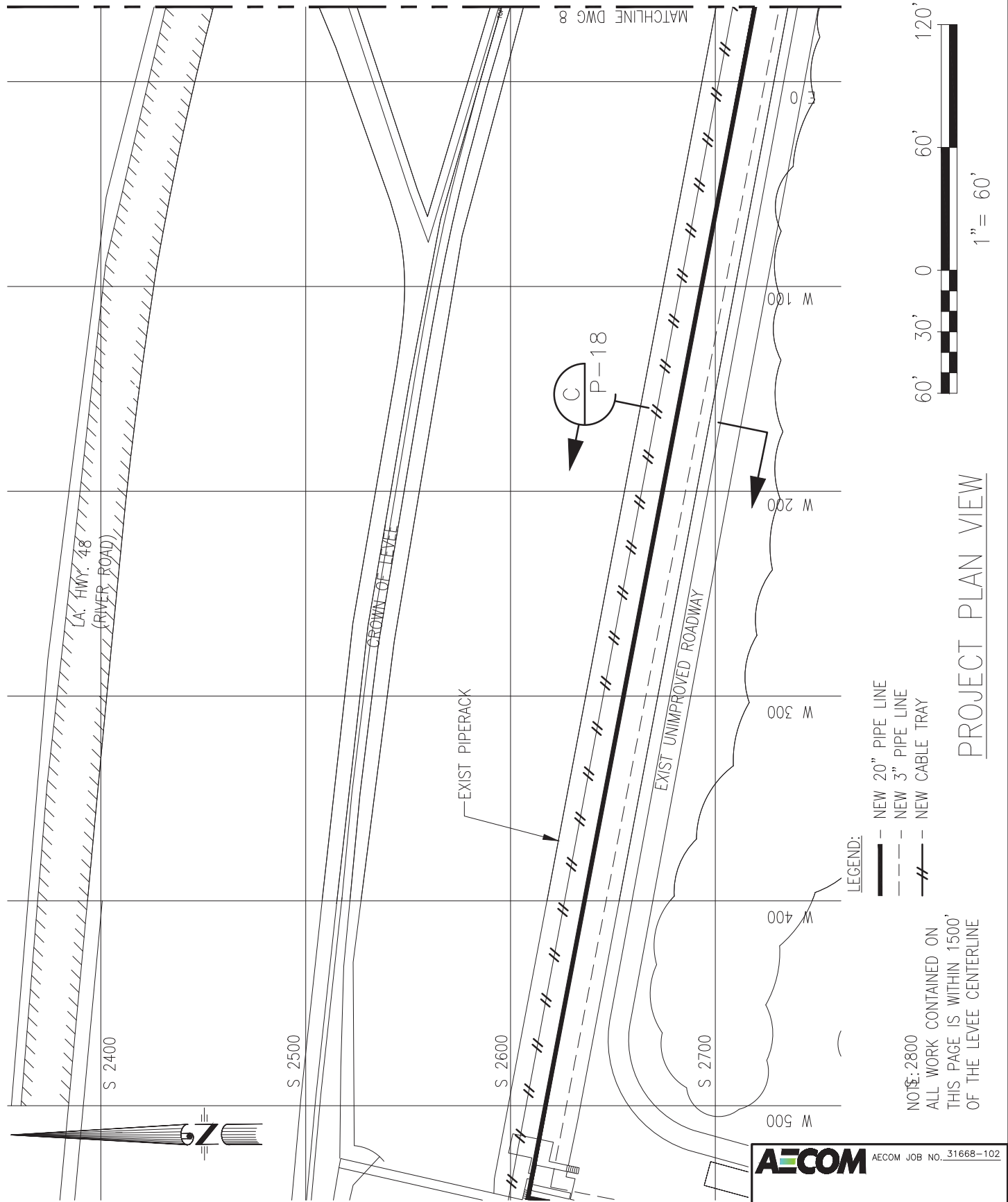

PROJECT PLAN VIEW

NOTE: 2800
 ALL WORK CONTAINED ON
 THIS PAGE IS WITHIN 1500'
 OF THE LEVEE CENTERLINE

AECOM AECOM JOB NO. 31668-102

| REV | DATE | ENG. | DESIGN | DRAWN | CHECK | COMPANY/ENG | MOC# | AFE#/WO# | DESCRIPTION |
|-----|----------|------|--------|-------|-------|-------------|------|-----------|-----------------------|
| A | 12/14/17 | GMF | GMF | JRG | GMF | AECOM | -- | SC17-0200 | ISSUED FOR 404 PERMIT |

VALERO ST. CHARLES REFINERY
 UNIT 98 - DOCKS
 BATTURE PIPERACK
 PLAN VIEW MISSISSIPPI RIVER 125 MILE

 A-SIZE (8.5X11) DWG. NO. P-16

| | |
|------------|------------|
| PLANT AREA | DOCKS |
| DATE: | 12/14/2017 |
| SCALE: | AS NOTED |
| COMPANY: | AECOM |
| AFE: | SC17-0200 |
| SHEET | 16 of 21 |
| REV | A |

Notice: This drawing and all data and information herein contained are the property of VALERO DESIGN CONSULTING, and is not to be retransmitted, copied, duplicated or reproduced in any manner and to the fullest extent possible, without the written consent of VALERO DESIGN CONSULTING. Borrower is not to print, use or otherwise dispose of this drawing in any form, directly or indirectly for use in any project other than that for which it was prepared. Borrower agrees to indemnify and hold harmless the design firm from any and all claims, damages or expenses, including reasonable attorneys' fees, that may be incurred by the design firm as a result of the use of this drawing for any purpose other than that for which it was prepared.

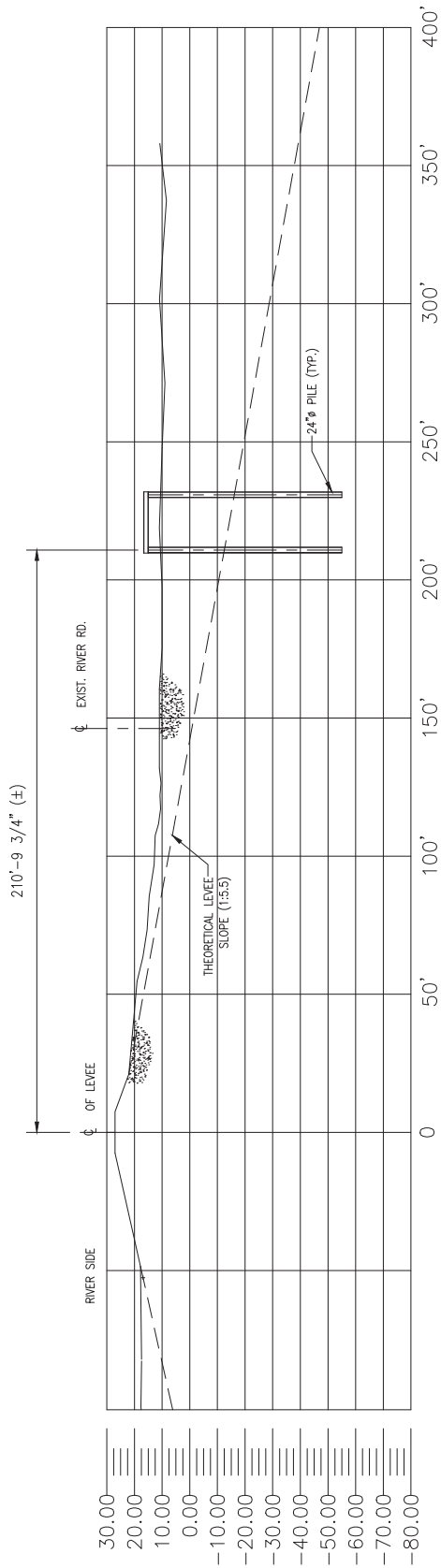

SECTION A / P-5
 1"=60'-0"

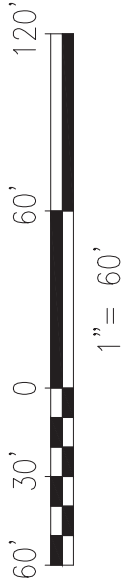

| | |
|--------------|-------------------------|
| AECOM | AECOM JOB NO. 31668-102 |
|--------------|-------------------------|

| REV | DATE | ENG. | DESIGN | DRAWN | CHECK | COMPANY/ENG | MOC# | AFE#/WO# | DESCRIPTION |
|-----|----------|------|--------|-------|-------|-------------|------|-----------|-----------------------|
| A | 12/14/17 | GMF | GMF | JRG | GMF | AECOM | -- | SC17-0200 | ISSUED FOR 404 PERMIT |

| | |
|--|---|
| VALERO ST. CHARLES REFINERY UNIT 98 - DOCKS BATTURE PIPERACK SECTION | PLANT AREA DOCKS |
| | DATE: 12/14/2017 SCALE: AS NOTED COMPANY: AECOM AFE: SC17-0200 |
| A-SIZE (8.5X11) DWG. NO. P-17 | SHEET 17 of 21 REV A |

Note: This drawing and all information herein contained are the property of VALERO DESIGN COMPANY (VDC) and its subsidiaries. It is to be used only for the project and site for which it was prepared. No part of this drawing is to be reproduced or transmitted in any form or by any means, electronic or mechanical, including photocopying, recording, or by any information storage and retrieval system, without the prior written permission of VALERO DESIGN COMPANY.

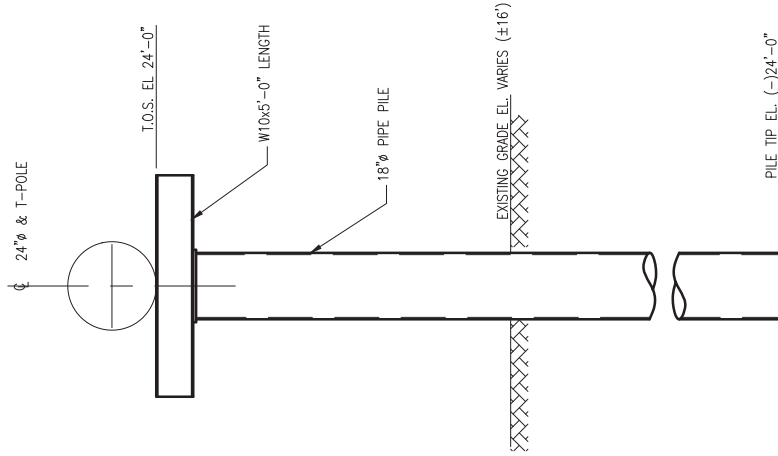

SECTION A
1/4" = 1' - 0"

NEW T-POLES FROM DOCK 4 TO NEW DOCK 6 PIPE RACK

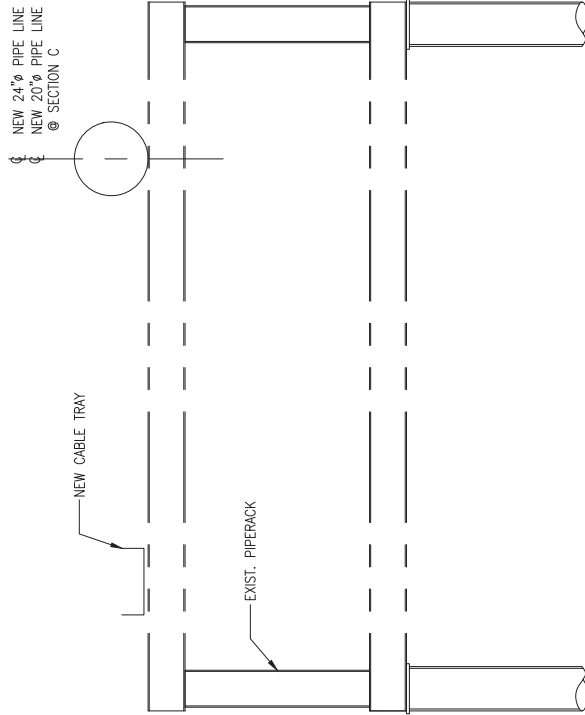

NOTE:
EXIST. PIPE RACK PIPING NOT SHOWN FOR CLARITY.

SECTION B
1/4" = 1' - 0" P9-P14

SECTION C (AS NOTED)
1/4" = 1' - 0" P16

EXISTING PIPERACK FROM RIVER ROAD PIPERACK BRIDGE TO DOCK 4

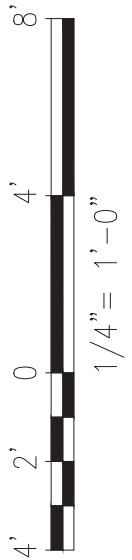

AECOM AECOM JOB NO. 31668-102

| REV | DATE | ENG. | DESIGN | DRAWN | CHECK | COMPANY/ENG | MOC# | AFE#/WO# | DESCRIPTION |
|-----|----------|------|--------|-------|-------|-------------|------|-----------|-----------------------|
| A | 12/14/17 | GMF | GMF | JRG | GMF | AECOM | -- | SC17-0200 | ISSUED FOR 404 PERMIT |

VALERO ST. CHARLES REFINERY
 UNIT 98 - DOCKS
 TYPICAL T-POLE SECTION

A-SIZE (8.5X11) DWG. NO. P-18

| |
|------------------|
| PLANT AREA DOCKS |
| DATE: 12/14/2017 |
| SCALE: AS NOTED |
| COMPANY: AECOM |
| AFE: SC17-0200 |
| SHEET 18 of 21 |
| REV A |

Notice: This drawing and all data and information herein contained are the property of VALERO DESIGN CONSULTANTS, INC. and shall be borrower in confidence and with the understanding and condition that all persons and/or legal entities receiving this drawing shall be deemed to have agreed not to copy, duplicate or reproduce it in any manner and to not disclose or use measurements or any part thereof except as expressly authorized in writing by VALERO DESIGN CONSULTANTS, INC. Borrower is not to print, use or otherwise dispose of this drawing in any form, directly or indirectly for use in any project other than that to which it was submitted. Borrower agrees to return this drawing promptly upon request.

PILE

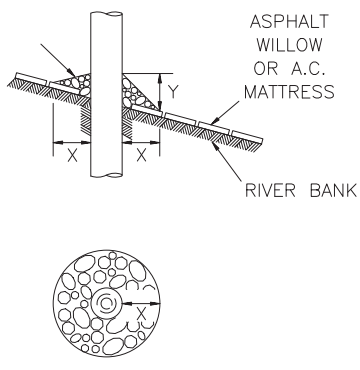

CAISSON

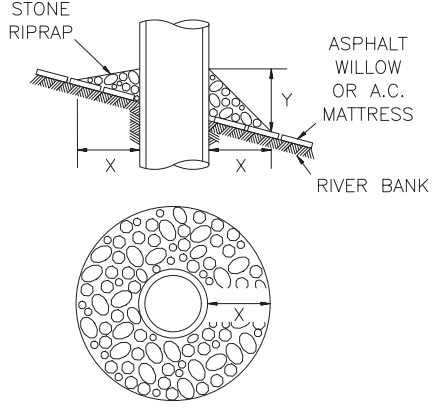

REVETMENT REPAIR NOTES:

1. SIZE OF RIPRAP TO VARY BETWEEN 6 POUNDS AND 125 POUNDS WITH 40 PERCENT TO 60 PERCENT OF THE STONE WITHIN THE RANGE OF 25 POUNDS TO 75 POUNDS.
2. WHEN PENETRATING THE UPPER BANK PAVING IN A REVETMENT AREA WITH PILES, CAISSONS AND/OR PILE CLUSTERS, A 10 INCH THICK RIPRAP STONE LAYER SHALL BE PLACED OVER ALL AREAS WHERE THE BANK PAVING IS DISTURBED BY DRIVING OPERATIONS.
3. REPAIR DETAILS PER USACE STANDARD DWG H-18-45204.

| DEPTH OF WATER IN FEET AT POINT OF PENETRATION AT TIME OF STONE PLACEMENT | DIMENSIONS IN FEET FOR PROTECTION AREA REQUIRED | | | | | | | |
|---|---|-----|---------|---|-----------------------------------|---|--------------|---|
| | PILE | | CAISSON | | SPUD PILE (BUOY AND ANCHOR CHAIN) | | PILE CLUSTER | |
| | X | Y | X | Y | X | Y | X | Y |
| 1' - 10' | 3 | 1.5 | 5 | 2 | | | 3 | 1 |
| 11' - 40' | 5 | 2 | 8 | 3 | 7 | 3 | 6 | 2 |
| 41' - 60' | 8 | 3 | 12 | 4 | 12 | 4 | 10 | 3 |

GENERAL NOTES:

1. AS-BUILT DRAWINGS WILL BE SUBMITTED WITHIN 30 DAYS OF COMPLETION OF THIS PROJECT TO THE LOUISIANA DEPARTMENT OF NATURAL RESOURCES, OFFICE OF CONSERVATION, PIPELINE DIVISION, P.O. BOX 94275 BATON ROUGE, LA 70804, AND TO THE LOUISIANA DEPARTMENT OF NATURAL RESOURCES, COASTAL MANAGEMENT DIVISION, P.O. BOX 44487, BATON ROUGE, LA 70804-4487.
2. ALL STRUCTURES, FACILITIES, WELL AND PIPELINES/FLOWLINES OCCURRING IN OPEN WATER AREAS OR IN OILFIELD CANALS OR SLIPS SHALL BE REMOVED WITHIN 120 DAYS OF ABANDONMENT OR THE FACILITIES FOR THE HEREIN PERMITTED USE UNLESS PRIOR WRITTEN APPROVAL TO LEAVE SUCH STRUCTURES IN PLACE IS RECEIVED FROM THE COASTAL MANAGEMENT DIVISION. THIS CONDITION DOES NOT PRECLUDE THE NECESSITY FOR REVISING THE CURRENT PERMIT OR OBTAINING A SEPARATE COASTAL USE PERMIT, SHOULD ONE BE REQUIRED.
3. STRUCTURES MUST ALSO BE MARKED/LIGHTED IN ACCORDANCE WITH U.S. COAST GUARD REGULATIONS.
4. IN ORDER TO ENSURE THE SAFETY OF ALL PARTIES, THE PERMITTEE SHALL CONTACT THE LOUISIANA ONE CALL SYSTEM (1-800-272-3020) A MINIMUM OF 48 HOURS PRIOR TO THE COMMENCEMENT OF ANY EXCAVATION (DIGGING, DREDGING, JETTING, ETC.) OR DEMOLITION ACTIVITY.

 AECOM JOB NO. 31668-102

| | | | | | | | | | | | | |
|-----|----------|------|--------|-------|-------|-------------|------|-----------|-----------------------|---|---------------|------------------|
| | | | | | | | | | |  VALERO ST. CHARLES REFINERY | | PLANT AREA DOCKS |
| | | | | | | | | | | UNIT 98 - DOCKS | | DATE: 12/14/2017 |
| | | | | | | | | | | NEW DOCK NO. 2 & DOCK NO. 6 | | SCALE: N.T.S. |
| | | | | | | | | | | REVETMENT PENETRATION REPAIR DETAILS AND GENERAL NOTES | | COMPANY: AECOM |
| | | | | | | | | | | | | AFE: SC17-0200 |
| A | 12/14/17 | GMF | GMF | JRG | GMF | AECOM | -- | SC17-0200 | ISSUED FOR 404 PERMIT | | | SHEET 19 of 21 |
| REV | DATE | ENG. | DESIGN | DRAWN | CHECK | COMPANY/ENG | MOC# | AFE#/WO# | DESCRIPTION | A-SIZE (8.5X11) | DWG. NO. P-19 | REV A |

Notice: This drawing and all information herein contained are the property of VALERO DESIGN CONSULTANTS, INC. and is not to be reprinted, reproduced, or otherwise disseminated without the prior written consent of VALERO DESIGN CONSULTANTS, INC. in any form or by any means, electronic or mechanical, including photocopying, recording, or by any information storage and retrieval system. Valero Design Consultants, Inc. is not responsible for any errors or omissions in this drawing. Valero Design Consultants, Inc. is not responsible for any damage or injury to any person or property caused by the use of this drawing. Valero Design Consultants, Inc. is not responsible for any damage or injury to any person or property caused by the use of this drawing. Valero Design Consultants, Inc. is not responsible for any damage or injury to any person or property caused by the use of this drawing.

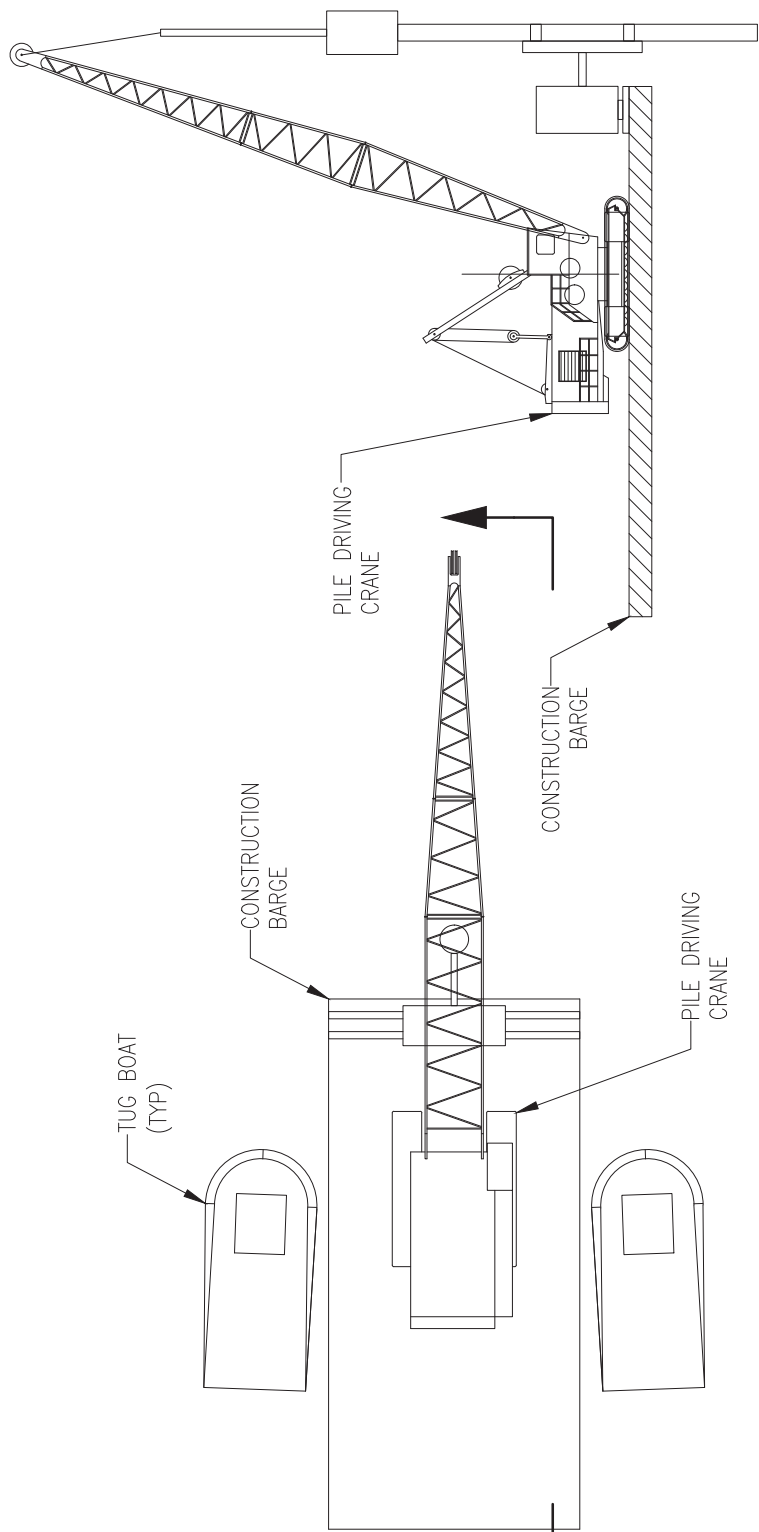
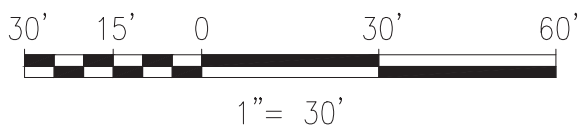

PLAN VIEW
1" = 30'

SECTION A
1" = 30' - 0"

TYPICAL PLAN & SECTION @ PILE DRIVING CRANE ON CONSTRUCTION BARGE

AECOM AECOM JOB NO. 31668-102

| REV | DATE | ENG. | DESIGN | DRAWN | CHECK | COMPANY/ENG | MOC# | AFE#/WO# | DESCRIPTION |
|-----|----------|------|--------|-------|-------|-------------|------|-----------|-----------------------|
| A | 12/14/17 | GMF | GMF | JRG | GMF | AECOM | -- | SC17-0200 | ISSUED FOR 404 PERMIT |

VALERO ST. CHARLES REFINERY
 UNIT 98 - DOCKS
 NEW DOCK NO. 6
 PILE DRIVING CRANE ON CONSTRUCTION BARGE

A-SIZE (8.5X11) DWG. NO. P-20

| | |
|------------|------------|
| PLANT AREA | DOCKS |
| DATE: | 12/14/2017 |
| SCALE: | AS NOTED |
| COMPANY: | AECOM |
| AFE: | SC17-0200 |
| SHEET | 20 of 21 |
| REV | A |

Note: This drawing and all information herein contained are the property of VALERO ENERGY CORPORATION and its subsidiaries. It is to be used only for the project and site for which it was prepared. No part of this drawing may be reproduced or transmitted in any form or by any means, electronic or mechanical, including photocopying, recording, or by any information storage and retrieval system, without the prior written permission of VALERO ENERGY CORPORATION.

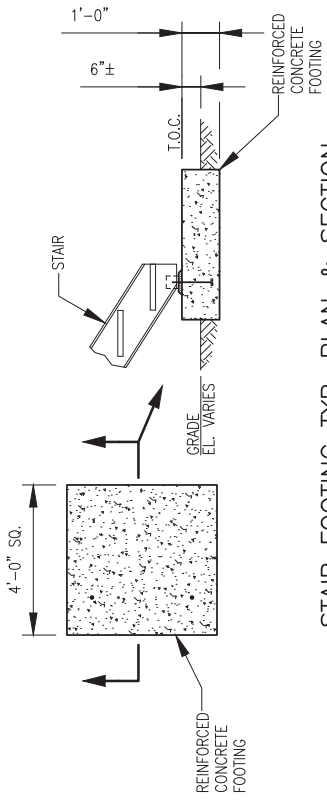

STAIR FOOTING TYP. PLAN & SECTION
N.T.S.

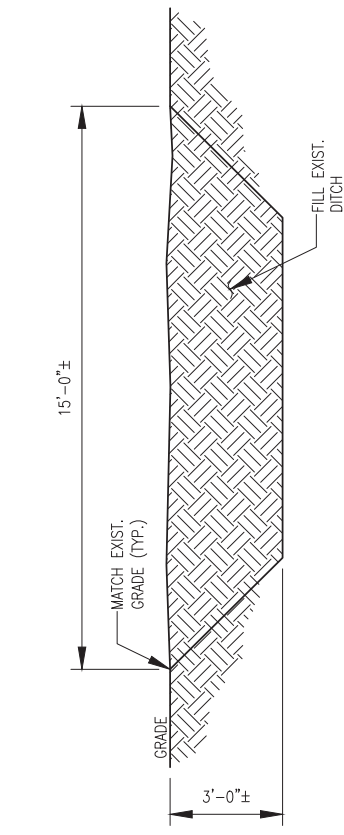

LIMESTONE ROADWAY TYP. SECTION
N.T.S.

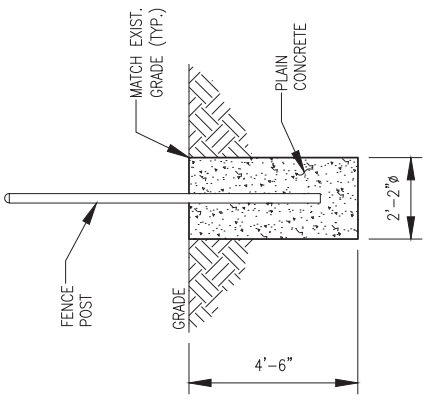

FENCE POST FOOTING TYP. SECTION
N.T.S.

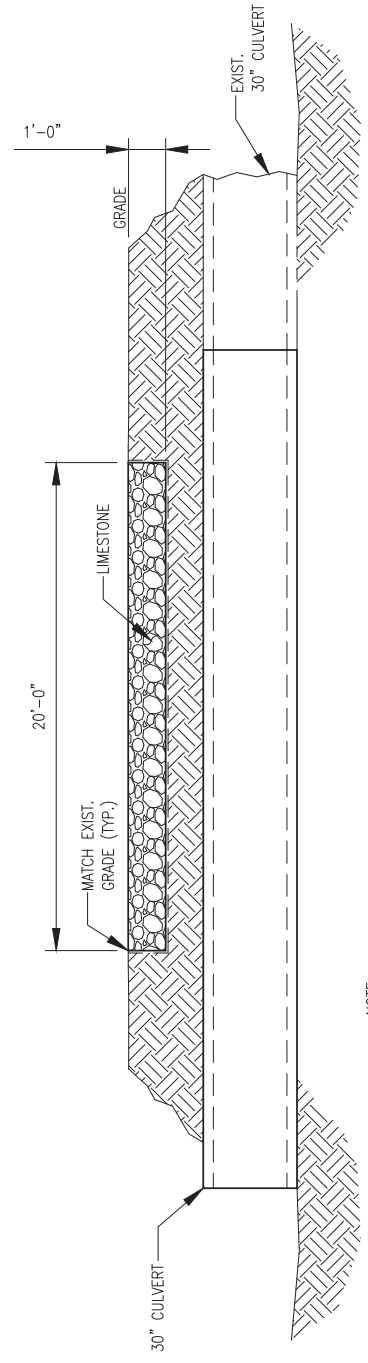

SECTION A-B
P-5
N.T.S.

SECTION B-P
P-5
N.T.S.

NOTE:
PIPERACK NOT SHOWN
FOR CLARITY.

AECOM AECOM JOB NO. 31668-102

| REV | DATE | ENG. | DESIGN | DRAWN | CHECK | COMPANY/ENG | MOC# | AFE#/WO# | DESCRIPTION |
|-----|----------|------|--------|-------|-------|-------------|------|-----------|-----------------------|
| A | 03/01/18 | GMF | GMF | JRG | GMF | AECOM | -- | SC17-0200 | ISSUED FOR 404 PERMIT |

VALERO ST. CHARLES REFINERY
 UNIT 98 - DOCKS
 NEW DOCK NO. 6
 TYPICAL EXCAVATION/FILL CROSS SECTIONS
 A-SIZE (8.5X11) DWG. NO. P-21

| | |
|------------|------------|
| PLANT AREA | DOCKS |
| DATE: | 03/01/2018 |
| SCALE: | AS NOTED |
| COMPANY: | AECOM |
| AFE: | SC17-0200 |
| SHEET | 21 of 21 |
| REV | A |