



DEPARTMENT OF THE ARMY
NEW ORLEANS DISTRICT, CORPS OF ENGINEERS
P. O. BOX 60267
NEW ORLEANS, LOUISIANA 70160-0267

REPLY TO
ATTENTION OF:

March 16, 2015

Operations Division
Eastern Evaluation Section
Project Manager
Ed Wrubluski
(504) 862-2822
Edward.F.Wrubluski@usace.army.mil

SUBJECT: MVN-2015-0487-EII

PUBLIC NOTICE

Interested parties are hereby notified that an application has been received by the District engineer for a Department of the Army permit to authorize the following pursuant to (X) Section 10 of the Rivers and Harbors Act of March 3, 1899 (30 Stat. 1151; 33 USC 403); and/or () Section 404 of the Clean Water Act (86 Stat. 816; 33 USC 1344).

ARTIFICIAL REEF IN THE GULF OF MEXICO

NAME OF APPLICANT: Louisiana Department of Wildlife and Fisheries, Artificial Reef Program, Post Office Box 98000, Baton Rouge, Louisiana 70808.

LOCATION OF WORK: In the Gulf of Mexico, West Delta Area, Block 117, 28 nautical miles southwest from Venice, Louisiana off the coast of Plaquemines Parish, as shown on the attached drawings.

CHARACTER OF WORK: Deploy Grand Isle 78 "A" jacket in the West Delta 117 artificial reef site to provide structural habitat for the purpose of enhancing fishing opportunities in the Gulf of Mexico. Clearance from the top of the deployed platform jacket to the water surface will be approximately 131 feet. This Request is pursuant to Act 100, 1986 Louisiana Legislature and the National Fishing Enhancement Act of 1984.

The comment period will close **15 days** from the date of this public notice advertisement. Written comments, including suggestions for modifications or objections to the proposed work, stating reasons therefore, are being solicited from anyone having interest in this permit request. Letters must reference the applicant's name and the subject number, be addressed and mailed to the address above, **ATTENTION: REGULATORY BRANCH**. Individuals or parties may request an extension of time in which to comment on the proposed work by writing or e-mailing the Corps of Engineers Project Manager listed above. Any request must be specific and substantively supportive of the requested extension, and received by this office prior to the end of the initial comment period. The Section Chief will review the request and the requestor will be promptly notified of the decision to grant or deny the request. If granted, the time extension will be continuous to the initial comment period and, inclusive of the initial comment period, will not exceed a total of 30 calendar days.

The decision whether to issue a permit will be based on an evaluation of the probable impact including cumulative impacts of the proposed activity on the public interest. That decision will reflect the national concern for both protection and utilization of important resources. The benefit which reasonably may be expected to accrue from the proposal must be balanced against its reasonably foreseeable detriments. All factors which may be relevant to the proposal will be considered including the cumulative effects thereof; among those are conservation, economics, aesthetics, general environmental concerns, wetlands, historic properties, fish and wildlife values, flood hazards, floodplain values, land use, navigation, shoreline erosion and accretion, recreation, water supply and conservation, water quality, energy needs, safety, food and fiber production, mineral needs, consideration of property ownership and, in general, the needs and welfare of the people.

The Corps of Engineers is soliciting comments from the public; federal, state, and local agencies and officials; Indian Tribes; and other interested parties in order to consider and evaluate the impacts of this proposed activity. Any comments received will be considered by the Corps of Engineers to determine whether to issue, modify, condition or deny a permit for this proposal. To make this decision, comments are used to assess impacts on endangered species, historic properties, water quality, general environmental effects, and the other public interest factors listed above. Comments are used in the preparation of an Environmental Assessment and/or Environmental Impact Statement pursuant to the National Environmental Policy Act. Comments are also used to determine the need for a public hearing and to determine the overall public interest of the proposed activity.

The New Orleans District is unaware of properties listed on the National Register of Historic Places near the proposed work. The possibility exists that the proposed work may damage or destroy presently unknown archeological, scientific, rehistorical, historical sites, or data. Issuance of this public notice solicits input from State Archeologist and State Historic Preservation Officer regarding potential impacts to cultural resources.

Our initial finding is that the proposed work would neither affect any species listed as endangered by the U.S. Department of Interior nor affect any habitat designated as critical to the survival and recovery of any endangered species.

This notice initiates the Essential Fish Habitat (EFH) consultation requirements of the Magnus-Stevens Fishery Conservation and Management Act. The applicant's proposal would result in the destruction or alteration of 0 acre(s) of EFH utilized by various life stages of red drum and penaeid shrimp. Our initial determination is that the proposed action would not have a substantial adverse impact on EFH or federally managed fisheries in the Gulf of Mexico. Our final determination relative to project impacts and the need for mitigation measures is subject to review by and coordination with the National Marine Fisheries Service.

If the proposed work involves deposits of dredged or fill material into navigable waters, the evaluation of the probable impacts will include the application of guidelines established by the Administrator of the Environmental Protection Agency and certification that the proposed activity will not violate applicable water quality standards will be required from the Louisiana Department of Environmental Quality, Office of Environmental Services, before a permit is issued.

Any person may request, in writing, within the comment period specified in this notice, that a public hearing be held to consider this application. Requests for public hearings shall state, with particularity, the reasons for holding a public hearing. You are requested to communicate the information contained in this notice to any other parties whom you deem likely to have interest in the matter.



The applicant has certified that the proposed activity described in the application complies with and will be conducted in a manner that is consistent with the Louisiana Coastal Resources Program. The Department of the Army permit will not be issued unless the applicant received approval or a waiver of the Coastal Use Permit by the Department of Natural Resources.

Michael V. Farabee
Chief, Eastern Evaluation Section
Regulatory Branch

Attachments

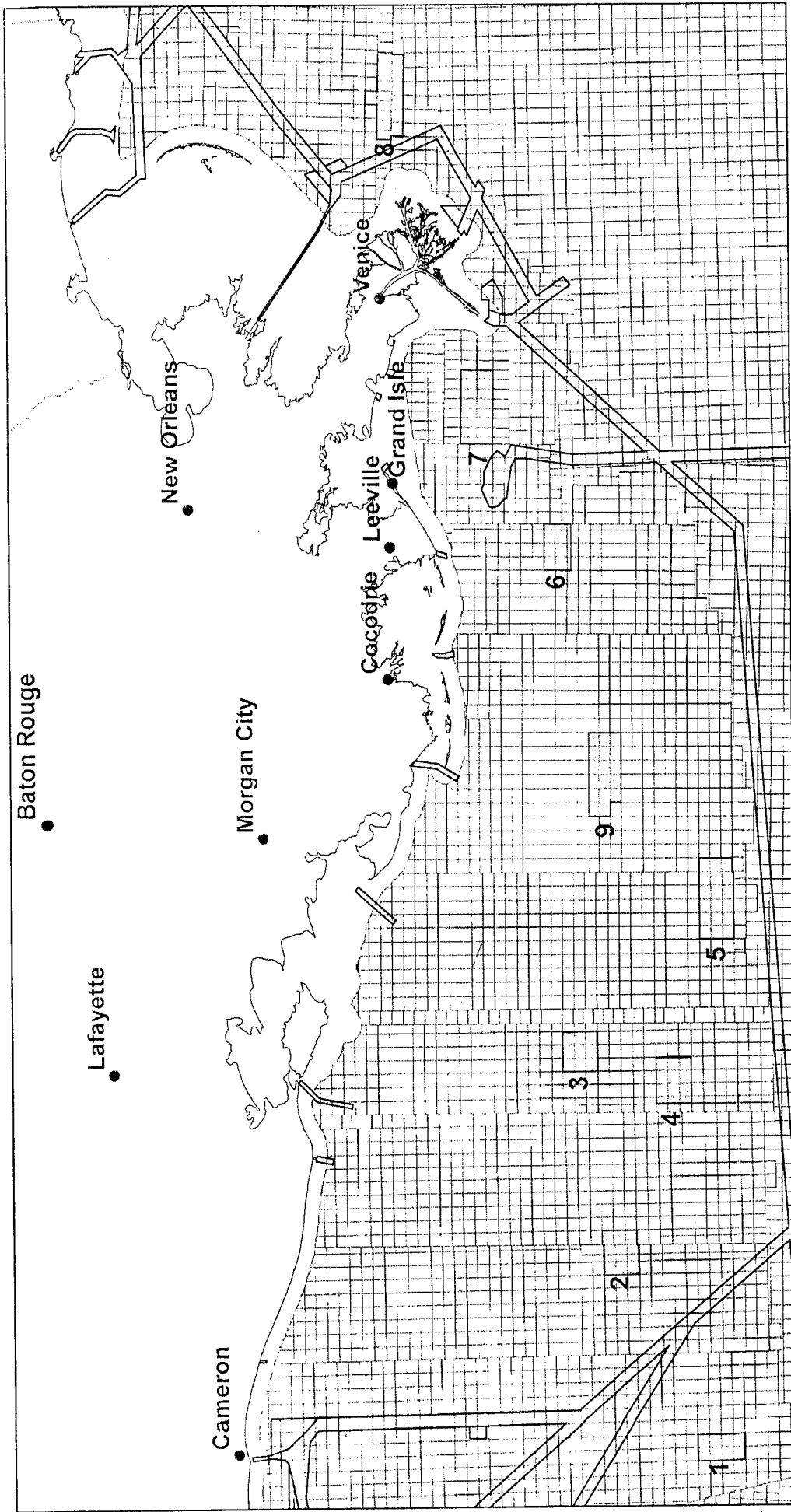
Louisiana Artificial Reef Planning Areas



-  Planning Areas
-  Fairways
-  OCS Blocks

Planning Areas

- 1. West Cameron Planning Area
- 2. East Cameron Planning Area
- 3. South Marsh Island (76) Planning Area
- 4. South Marsh Island (146) Planning Area
- 5. Eugene Island Planning Area
- 6. South Timbalier Planning Area
- 7. West Delta Planning Area
- 8. Main Pass Planning Area
- 9. Ship Shoal Planning Area

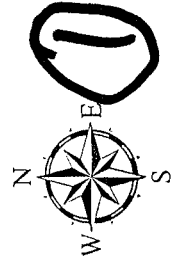

Louisiana Artificial Reef Program

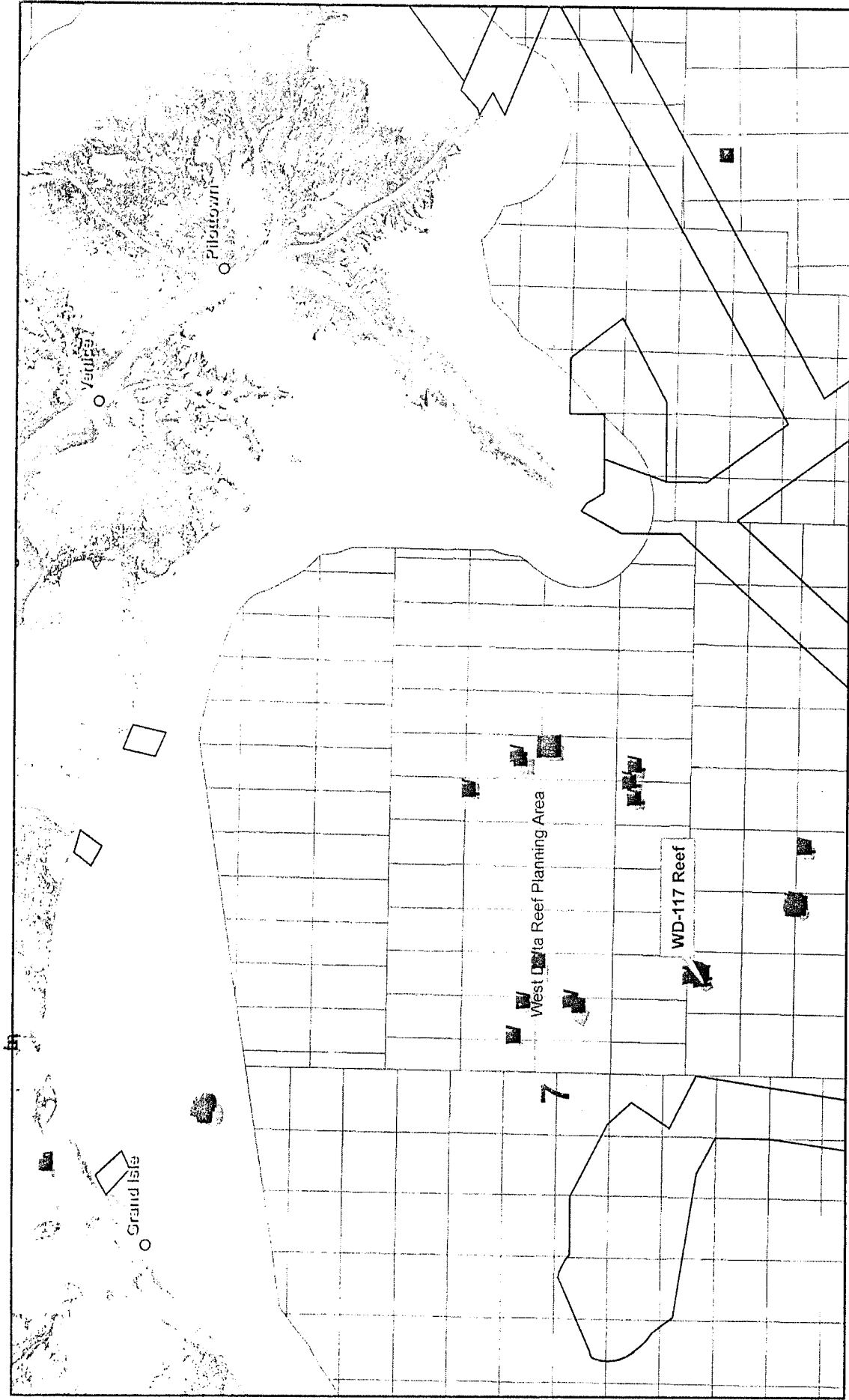

- Reef Planning Area
- Permitted Reef Sites
- Fairways
- OCS Blocks



WD-117 Reef Vicinity Map

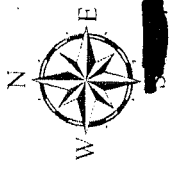

ARTIFICIAL REEF BOUNDARIES

LOCATION	X COORDINATE	Y COORDINATE	LATITUDE	LONGITUDE
1A	2,493,618.96'	58,991.97'	28° 49' 11.111"N	89° 47' 31.539"W
1B	2,494,351.58'	59,364.63'	28° 49' 14.702"N	89° 47' 23.249"W
2	2,496,093.09'	57,760.29'	28° 48' 58.589"N	89° 47' 03.919"W
3	2,497,126.88'	55,675.73'	28° 48' 37.817"N	89° 46' 52.618"W
4	2,495,582.40'	53,917.93'	28° 48' 20.891"N	89° 47' 32.717"W
5	2,492,548.61'	56,002.48'	28° 48' 41.662"N	89° 47' 44.020"W

Anglo-Suisse 10" S-15474

G178-A Jacket in Prop Reefed Position (Orientation to be field determined)	
NAD27-LA SOUTH	
X=	2,494,579.07'
Y=	58,061.94'
Lat.	28° 49' 01.777"N
Lon.	89° 47' 20.889"W
NAD83-LA SOUTH	
X=	3,775,382.41'
Y=	118,767.33'
Lat.	28° 49' 02.647"N
Lon.	89° 47' 21.105"W

WD117

OCS-G-01101

Anglo-Suisse

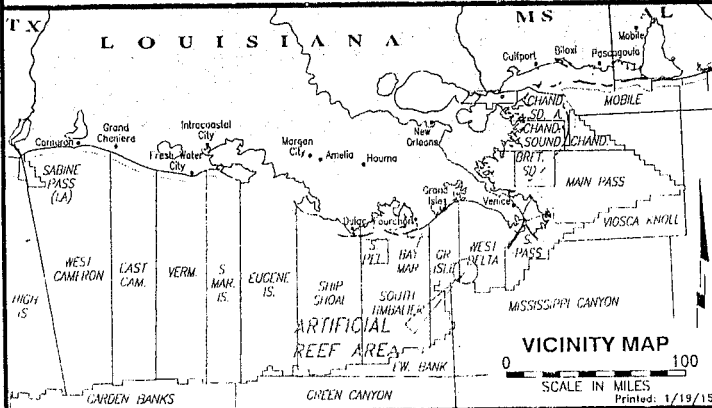
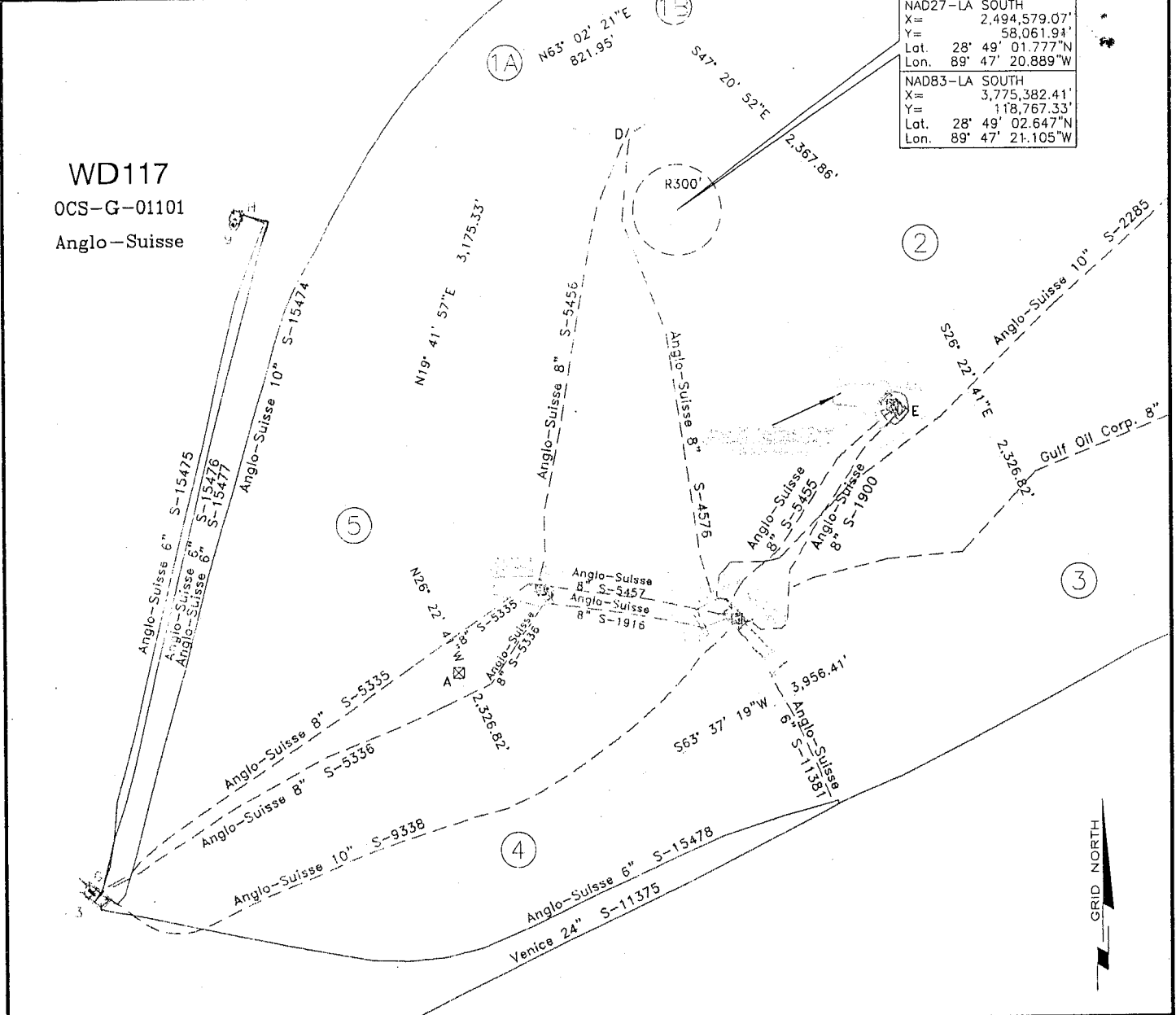

GRAND ISLE 78 - "A"
PROPOSED REEF POSITION

BLOCK 117
 WEST DELTA AREA
 GULF OF MEXICO

FUGRO CHANCE INC.

200 Dulles Dr., Lafayette, Louisiana 70506-5001 (337) 237-1300

GEODETIC DATUM: NAD27 PROJECTION: LOUISIANA SOUTH GRID UNITS: US SURVEY FEET	SCALE IN FEET 	Job No.: 1500052 Dwn: SJL Chart: Of:
--	----------------------	--

Dwgfile: H:\2015\1500052\CAD\1500052A

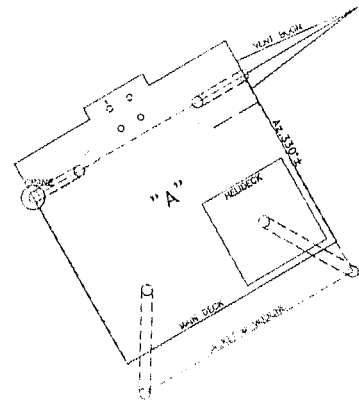

PLAN

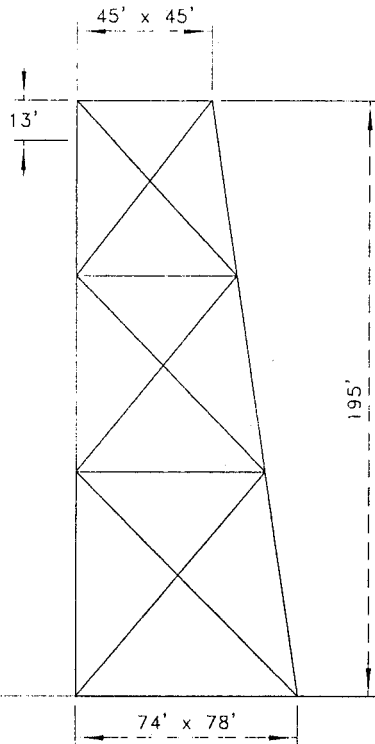

PROFILE



ARENA
OFFSHORE

GRAND ISLE 78 - "A"
TO BE REEFED
BLOCK 117
WEST DELTA AREA
GULF OF MEXICO



FUGRO CHANCE INC.

200 Dulles Dr. Lafayette, Louisiana 70506-3001 (337) 237-1300

GEODEIC DATUM: NAD27
PROJECTION: LOUISIANA SOUTH
GRID UNITS: US SURVEY FEET

SCALE
IN FEET

Job No.: 1500052

Drwn: SJL

Chart: Of:

Printed: 1/19/15

Dwgfile: H:\2015\1500052\CAD\1500052B

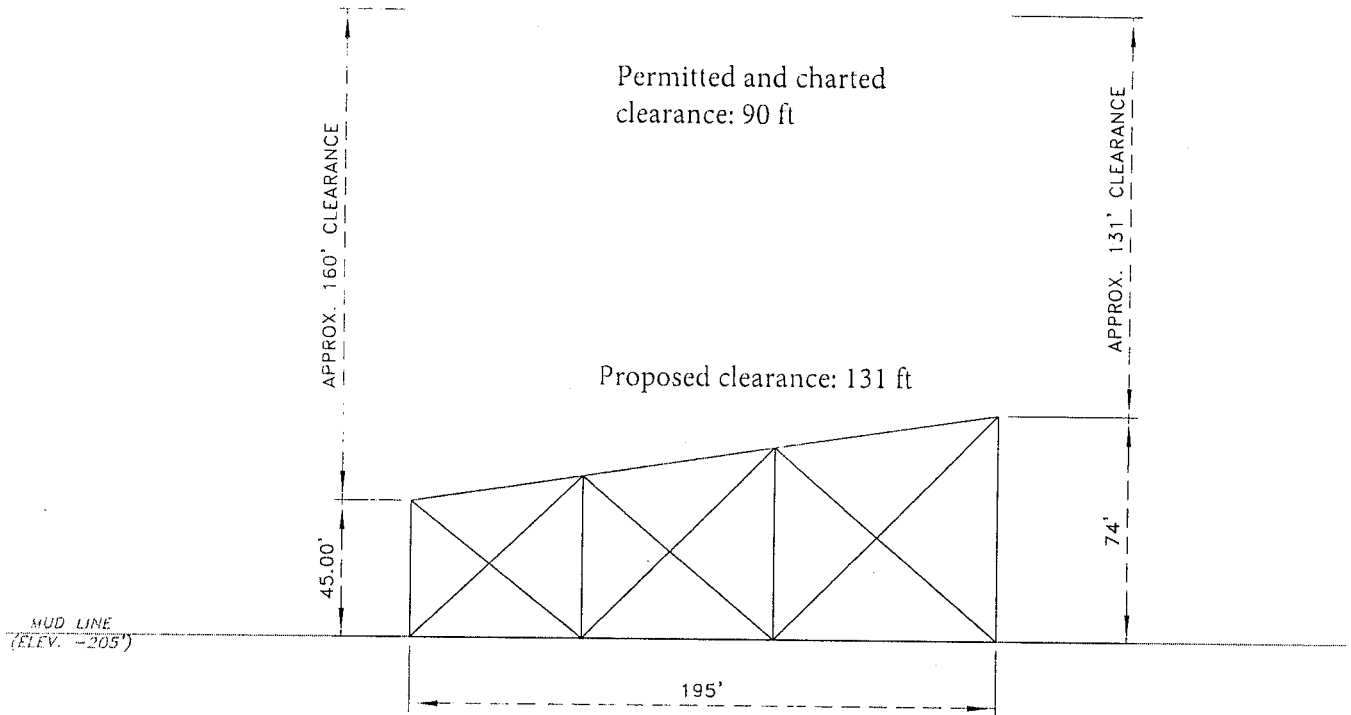

NOTES:
 1) 4.12 MILES TO NEAREST SHIPPING FAIRWAY.
 2) CLEARANCES BASED ON CONSTRUCTION DRAWINGS.



GRAND ISLE 78 - "A"
IN PROPOSED REEF POSITION
 BLOCK 117
 WEST DELTA AREA
 GULF OF MEXICO

5

FUGRO CHANCE INC.
200 Dulles Dr. Lafayette, Louisiana 70506-3001 (337) 237-1500

GEODETIC DATUM: NAD27
 PROJECTION: LOUISIANA SOUTH
 GRID UNITS: US SURVEY FEET

SCALE
 IN FEET 0 60'

Job No.: 1500052 [REDACTED] Drwn: SJL Chart: Of: [REDACTED]

Printed: 1/19/15

Dwgfile: H:\2015\1500052\CAD\1500052B