

APPROVED JURISDICTIONAL DETERMINATION FORM

U.S. Army Corps of Engineers

To view the unedited version of the form go to: <http://www.mvn.usace.army.mil/regulatory/finalform.htm>.

This form should be completed by following the instructions provided in Section IV of the JD Form Instructional Guidebook.

SECTION I: BACKGROUND INFORMATION

A. REPORT COMPLETION DATE FOR APPROVED JURISDICTIONAL DETERMINATION (JD): **OCT 29 2015**

B. DISTRICT OFFICE, FILE NAME, AND NUMBER: MVN-2015-02091-SJ

C. PROJECT LOCATION AND BACKGROUND INFORMATION:

State: Louisiana County/parish/borough: East Baton Rouge City: Baton Rouge

Center coordinates of site (lat/long in degree decimal format): Lat. 30.43670° N, Long. -91.18100° W.

Universal Transverse Mercator:

Name of nearest waterbody: Mississippi River

Name of nearest Traditional Navigable Water (TNW) into which the aquatic resource flows: Bayou Duplanier

Name of watershed or Hydrologic Unit Code (HUC): 08070202 Amite

☒ Check if map/diagram of review area and/or potential jurisdictional areas is/are available upon request.

☐ Check if other sites (e.g., offsite mitigation sites, disposal sites, etc...) are associated with this action and are recorded on a different JD form.

D. REVIEW PERFORMED FOR SITE EVALUATION (CHECK ALL THAT APPLY):

☒ Office (Desk) Determination. Date: 10/16/2015

☐ Field Determination. Date(s):

SECTION II: SUMMARY OF FINDINGS

A. RHA SECTION 10 DETERMINATION OF JURISDICTION.

There are no "navigable waters of the U.S." within Rivers and Harbors Act (RHA) jurisdiction (as defined by 33 CFR part 329) in the review area. [Required]

B. CWA SECTION 404 DETERMINATION OF JURISDICTION.

There are no "waters of the U.S." within Clean Water Act (CWA) jurisdiction (as defined by 33 CFR part 328) in the review area. [Required]

SECTION III THRU V. Not Applicable

SECTION IV: DATA SOURCES.

A. SUPPORTING DATA. Data reviewed for JD (check all that apply - checked items shall be included in case file and, where checked and requested, appropriately reference sources below):

☒ Maps, plans, plots or plat submitted by or on behalf of the applicant/consultant: 9/24/2015.

☐ Data sheets prepared/submitted by or on behalf of the applicant/consultant.

☐ Office concurs with data sheets/delineation report.

☐ Office does not concur with data sheets/delineation report.

☐ Data sheets prepared by the Corps:

☐ Corps navigable waters' study:

☒ U.S. Geological Survey Hydrologic Atlas:

☐ USGS NHD data.

☒ USGS 8 and 12 digit HUC maps.

☒ U.S. Geological Survey map(s). Cite scale & quad name: Baton Rouge West 1:24000.

☒ USDA Natural Resources Conservation Service Soil Survey. Citation: <http://websoilsurvey.sc.egov.usda.gov/default.aspx>.

☒ National wetlands inventory map(s). Cite name: <http://www.fws.gov/wetlands/Data/Mapper.html>.

☐ State/Local wetland inventory map(s):

☐ FEMA/FIRM maps:

☐ 100-year Floodplain Elevation is: (National Geodetic Vertical Datum of 1929)

☒ Photographs: ☒ Aerial (Name & Date): 1998, 2008, 2013.

or ☐ Other (Name & Date):

☐ Previous determination(s). File no. and date of response letter:

☐ Applicable/supporting case law:

☐ Applicable/supporting scientific literature:

☒ Other information (please specify): Louisiana LiDAR.

B. ADDITIONAL COMMENTS TO SUPPORT JD: The entire project site consist of uplands.

APPROVED

JURISDICTIONAL DETERMINATION

USACE

IH, 16 OCTOBER 2015

ANDREW BENNETT

FOR JESSICA KEASLER, TERRACON

ACCOUNT # MVN-2015-02091-SJ

 NON-WETLAND

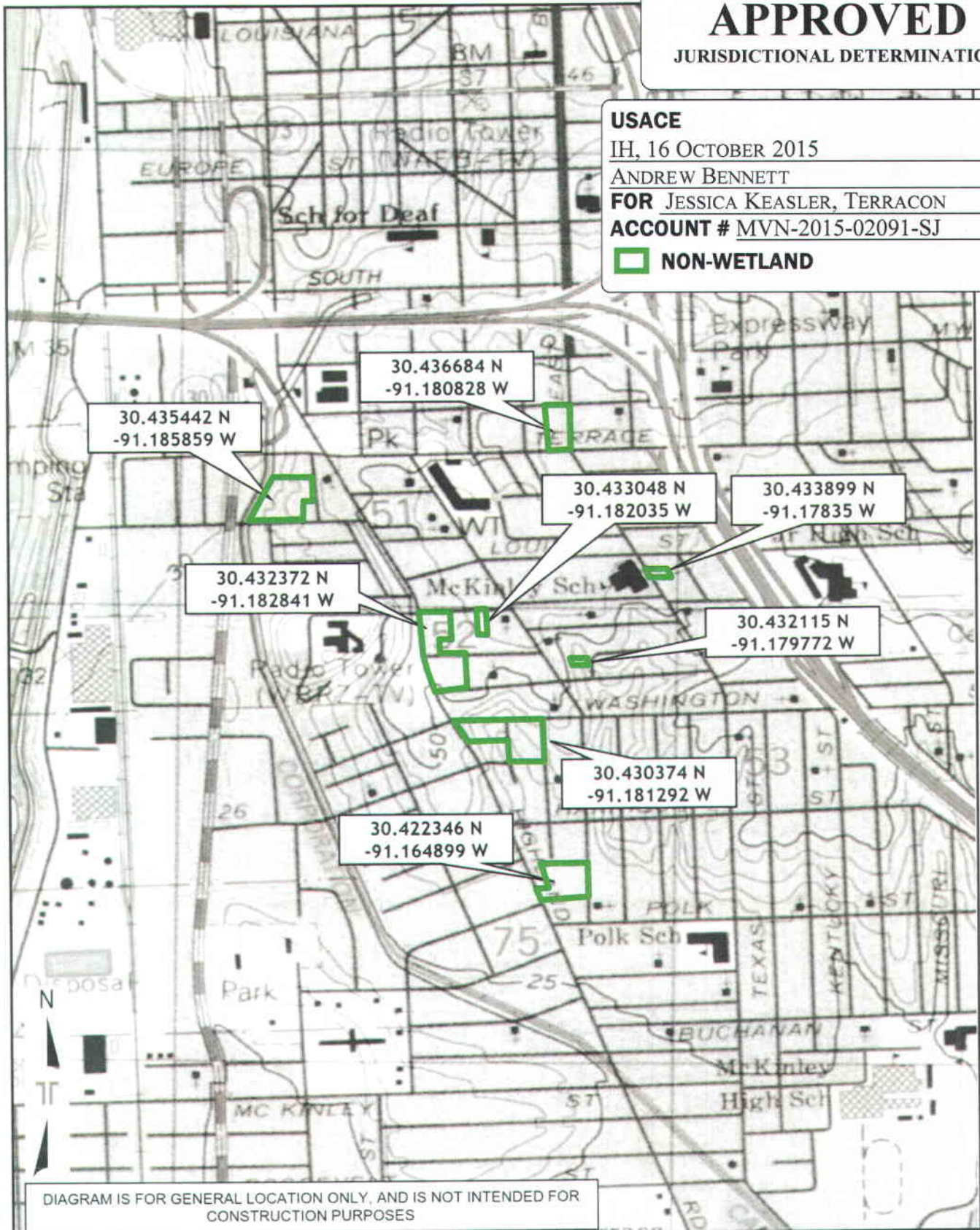

Project No. EH147059	 2822-B O'Neal Lane Baton Rouge, Louisiana 70816 PH (225) 344-6052 FAX (225) 344-6348	TOPOGRAPHIC MAP	EXHIBIT
Scale: AS SHOWN		Baton Rouge Single Family Housing Various Locations, Baton Rouge, Louisiana	1
Quad Name: 7.5 Minute Topographic Map Baton Rouge West, LA			
Date: 9/21/2015			