



REPLY TO  
ATTENTION OF:

DEPARTMENT OF THE ARMY  
NEW ORLEANS DISTRICT, CORPS OF ENGINEERS  
P.O. BOX 60267  
NEW ORLEANS, LOUISIANA 70160-0267

January 13, 2009

Planning, Programs, and  
Project Management Division  
Environmental Planning  
and Compliance Branch  
Attn: CEMVN-PM-RN

Mr. Scott Hutcheson  
State Historic Preservation Officer  
Office of Cultural Development  
Department of Culture, Recreation, and Tourism  
P.O. Box 44247  
Baton Rouge, Louisiana 70804

We concur that the proposed undertaking will have no adverse effect on historic properties. This effect determination could change should new information come to our attention.

 1/26/09  
Date  
Scott Hutcheson  
State Historic Preservation Officer

**RE: Request to Continue Consultation Under Section 106 of the National Historic Preservation Act for the Lake Pontchartrain and Vicinity Hurricane Protection Project, Orleans East Bank, Individual Environmental Report #4, Orleans Parish, Louisiana.**

Dear Mr. Hutcheson:

The U.S. Army Corps of Engineers, Mississippi Valley Division, New Orleans District (CEMVN), is proposing to construct flood reduction improvements within the Lake Pontchartrain and Vicinity Hurricane Protection Project, Orleans East Bank, Orleans Parish, Louisiana. This improvement project is currently being studied under the emergency alternative arrangements approved by the Council on Environmental Quality for the Lake Pontchartrain and Vicinity Hurricane Protection Project, Individual Environmental Report (IER) #4. Additional information on the Emergency Alternative Arrangements and IER's can be found on web page [HTTP://www.nolaenvironmental.gov](http://www.nolaenvironmental.gov).

In our letter to your office dated October 23, 2008, the CEMVN provided project documentation in support of a "no adverse effect" finding for construction activities proposed within the project's area of potential effect (APE). Your office responded in a letter dated December 5, 2008 and requested additional maps showing the project APE in relationship to the boundaries of the Spanish Fort Site (16OR19) and Locus 04-02 (16OR448). Definitive recommendations concerning the National Register of Historic Places (NRHP) eligibility of the Milneburg Lighthouse was also requested. Copies of these letters are attached herein.

The CEMVN asked Nathanael Heller (R. Christopher Goodwin & Associates, Inc.) to prepare a map showing the project APE boundary and the boundaries for the Spanish Fort Site (16OR19) and Locus 04-02 (16OR448). Heller conducted the recent Phase 1 testing that delineated the boundaries for both sites (Heller et al. 2008). He prepared the enclosed map (see Enclosure #1) and confirmed that the northern boundary of the Spanish Fort Site (16OR19) does not extend into the project APE. In order to ensure avoidance of Locus 04-02 (16OR448), Heller recommended that the southern boundary of the APE bordering the northern boundary of Locus 04-02 (16OR448) be moved slightly to the north along an alignment shown as a dashed red line (see Enclosure #1). The District has revised the project plans in accordance with Heller's recommendation (see Enclosure #2).

In order to further ensure that project impacts will be avoided, project plans have also been revised to clearly delineate a 75 foot radius "no work zone" around the Milneburg Lighthouse (see Enclosure #3). The Milneburg Lighthouse is located outside of the APE and will not be impacted by proposed construction. It is our view that preparation of definitive recommendations concerning NRHP eligibility is not required.

The District will include information concerning the Camp Leroy Johnson Site (16OR219) in the summary discussion of the pending draft Phase 1 report, as requested.

Based on the information summarized above, it is our view that the proposed project will have no adverse impacts on significant cultural resources. Please review this additional documentation and provide our office with your opinion regarding our "no adverse effect" finding within 30 days of receipt of this letter. If you have any questions and/or concerns, please contact Mr. Michael Swanda at (504) 862-2036.

Sincerely,

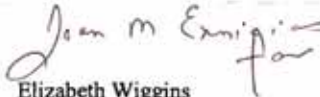

Elizabeth Wiggins  
Chief, Environmental Planning  
and Compliance Branch

Enclosures

CF: Jones, SHPO  
Galouse, SHPO  
Rivet, SHPO  
Varnado, SHPO

**References Cited**

Heller, Nathanael, Troy Nowack, Kathryn A. Ryberg, Katy Coyle, Lindsay Hannah, Ginny Jones, and Lauren Bair

2008 *Management Summary: Phase 1 Cultural Resources Survey and Inventory, and Marine Remote Sensing Survey Performed for Lake Pontchartrain and Vicinity Project, Individual Environmental Report Area 4 (IER #4): Orleans Parish, Louisiana*. R. Christopher Goodwin & Associates, Inc., New Orleans. Prepared for the U.S. Army Corps of Engineers, New Orleans District under Contract W91P8-07-D-0042, Delivery Orders 002/003.

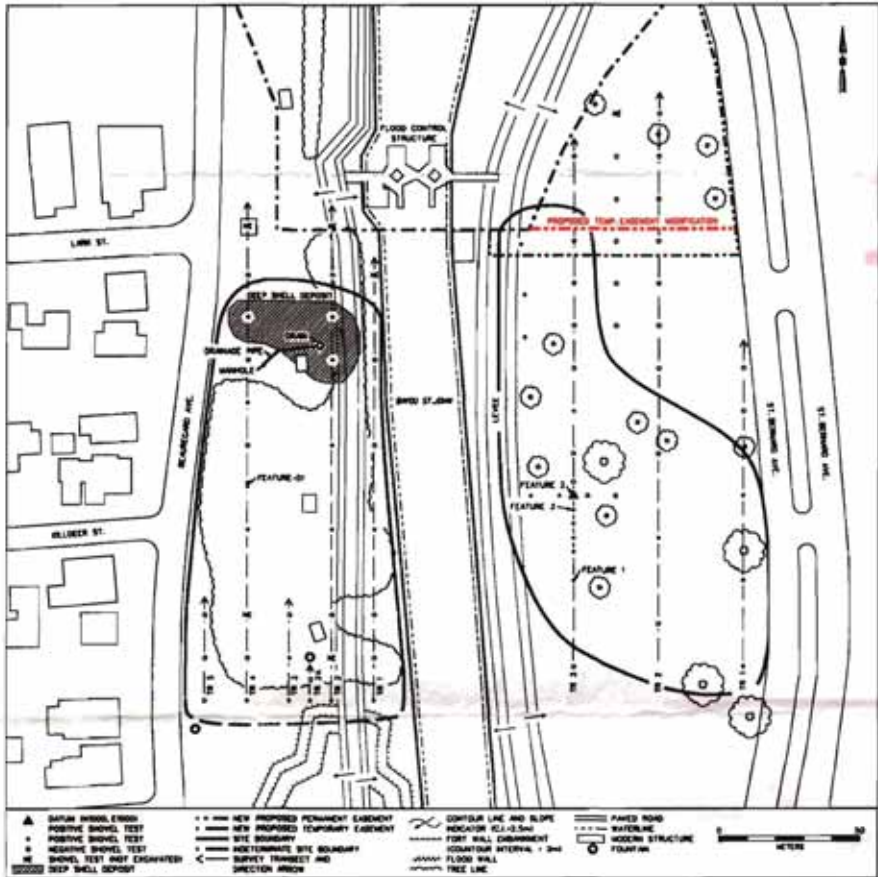



ENCLOSURE #2

	SHEET NO. TOTAL SHEETS DATE	PROJECT NO. PROJECT NAME	DRAWN BY CHECKED BY
	ALL WORK ON THIS DRAWING IS TO BE ACCORDING TO THE LATEST REVISIONS OF THE SPECIFICATIONS.		ALL WORK SHALL BE ACCORDING TO THE LATEST REVISIONS OF THE SPECIFICATIONS.

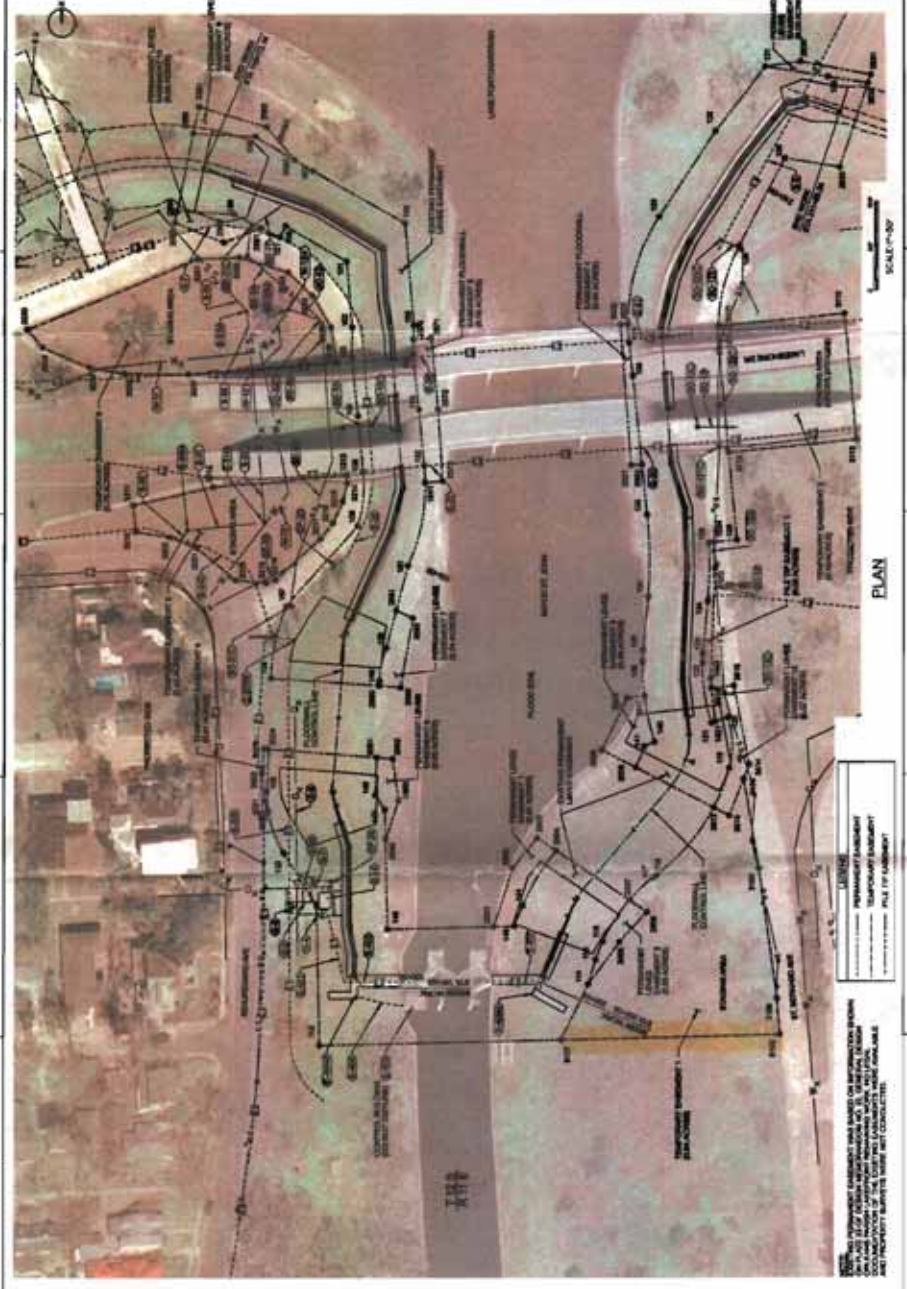

	EXISTING UTILITY
	PROPOSED UTILITY
	PROPOSED UTILITY
	FIELD OF LAYOUT

THIS IS A PRELIMINARY DRAWING AND SHOULD NOT BE USED FOR CONSTRUCTION WITHOUT THE APPROVAL OF THE ENGINEER. ALL DIMENSIONS SHALL BE AS SHOWN UNLESS OTHERWISE NOTED. THE CONTRACTOR SHALL BE RESPONSIBLE FOR VERIFYING THE EXISTING CONDITIONS AND FOR OBTAINING ALL NECESSARY PERMITS AND APPROVALS.

PLAN

SCALE 1" = 40'

ENCLOSURE # 3

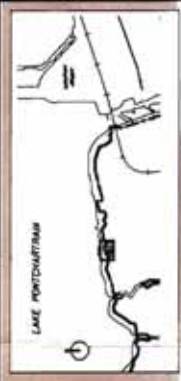
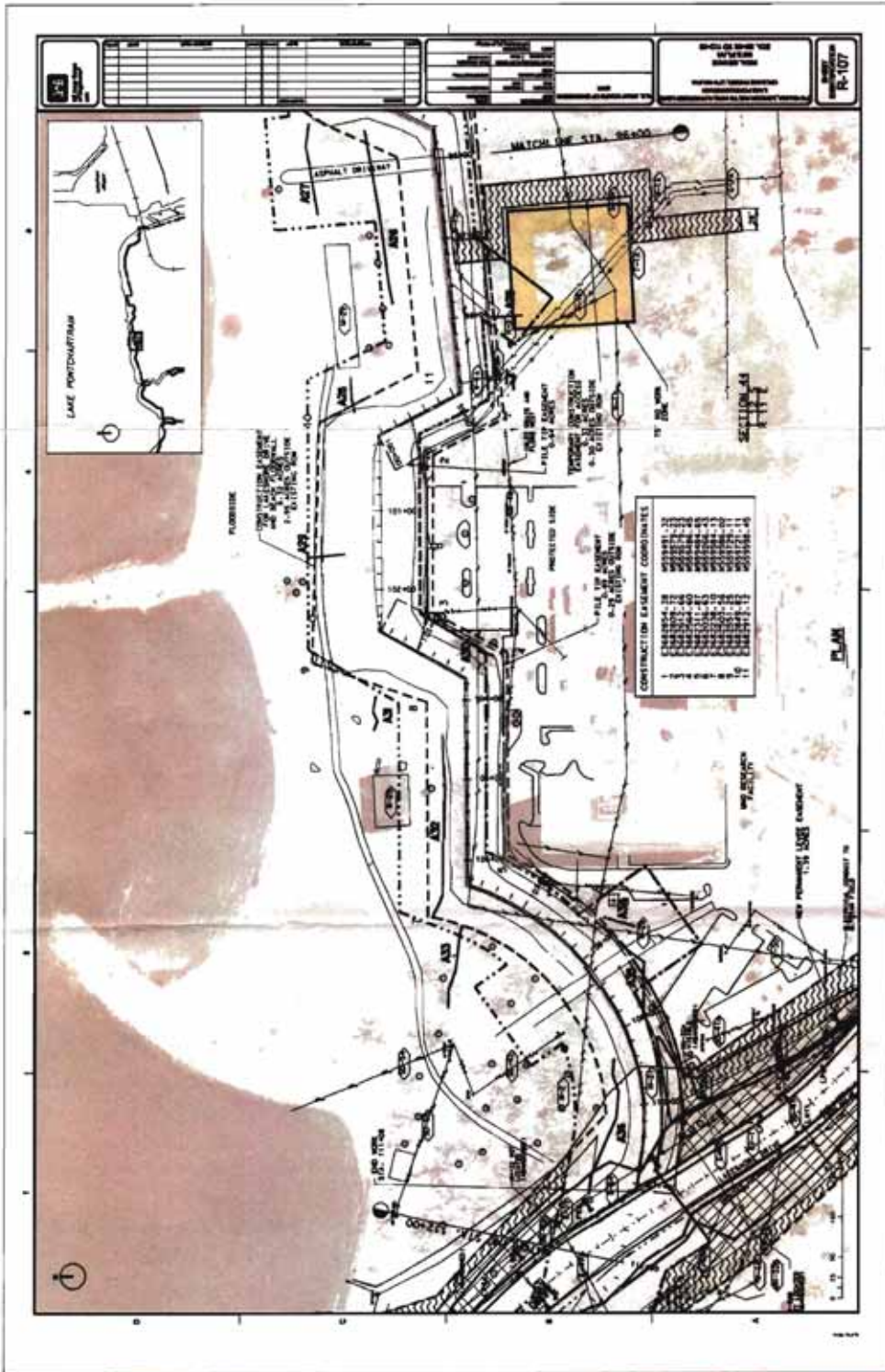

CONSTRUCTION EQUIPMENT COORDINATES

NO.	EQUIPMENT	Easting	Northing
1	Excavator	1000.00	1000.00
2	Excavator	1000.00	1000.00
3	Excavator	1000.00	1000.00
4	Excavator	1000.00	1000.00
5	Excavator	1000.00	1000.00
6	Excavator	1000.00	1000.00
7	Excavator	1000.00	1000.00
8	Excavator	1000.00	1000.00
9	Excavator	1000.00	1000.00
10	Excavator	1000.00	1000.00
11	Excavator	1000.00	1000.00
12	Excavator	1000.00	1000.00
13	Excavator	1000.00	1000.00
14	Excavator	1000.00	1000.00
15	Excavator	1000.00	1000.00
16	Excavator	1000.00	1000.00
17	Excavator	1000.00	1000.00
18	Excavator	1000.00	1000.00
19	Excavator	1000.00	1000.00
20	Excavator	1000.00	1000.00
21	Excavator	1000.00	1000.00
22	Excavator	1000.00	1000.00
23	Excavator	1000.00	1000.00
24	Excavator	1000.00	1000.00
25	Excavator	1000.00	1000.00
26	Excavator	1000.00	1000.00
27	Excavator	1000.00	1000.00
28	Excavator	1000.00	1000.00
29	Excavator	1000.00	1000.00
30	Excavator	1000.00	1000.00
31	Excavator	1000.00	1000.00
32	Excavator	1000.00	1000.00
33	Excavator	1000.00	1000.00
34	Excavator	1000.00	1000.00
35	Excavator	1000.00	1000.00
36	Excavator	1000.00	1000.00
37	Excavator	1000.00	1000.00
38	Excavator	1000.00	1000.00
39	Excavator	1000.00	1000.00
40	Excavator	1000.00	1000.00
41	Excavator	1000.00	1000.00
42	Excavator	1000.00	1000.00
43	Excavator	1000.00	1000.00
44	Excavator	1000.00	1000.00
45	Excavator	1000.00	1000.00
46	Excavator	1000.00	1000.00
47	Excavator	1000.00	1000.00
48	Excavator	1000.00	1000.00
49	Excavator	1000.00	1000.00
50	Excavator	1000.00	1000.00

PLAN