

NO FIELD WORK DONE IN PREPARATION FOR THESE PLATS.

VICINITY MAP

REPRODUCED FROM USGS "LAFAYETTE", LA 7.5" QUADRANGLE.

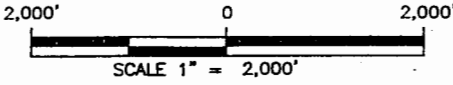

PREPARED BY:
 C. L. JACK STELLY & ASSOCIATES, INC.
 LAFAYETTE, LOUISIANA
 FILE NO. 19763-C1.DWG

PROPOSED BULKHEAD & BOAT SLIP WATERFRONT COVE AREA

VERMILION PARISH, LOUISIANA
 APPLICATION BY:
 OCTOBER 1, 2003
 RONALD HOOVER
 MAURICE, LOUISIANA

REVISIONS:

HOMER ROAD

NOTES:

1.) Approximately 336 cubic yards of dredged materials to be placed behind bulkhead.

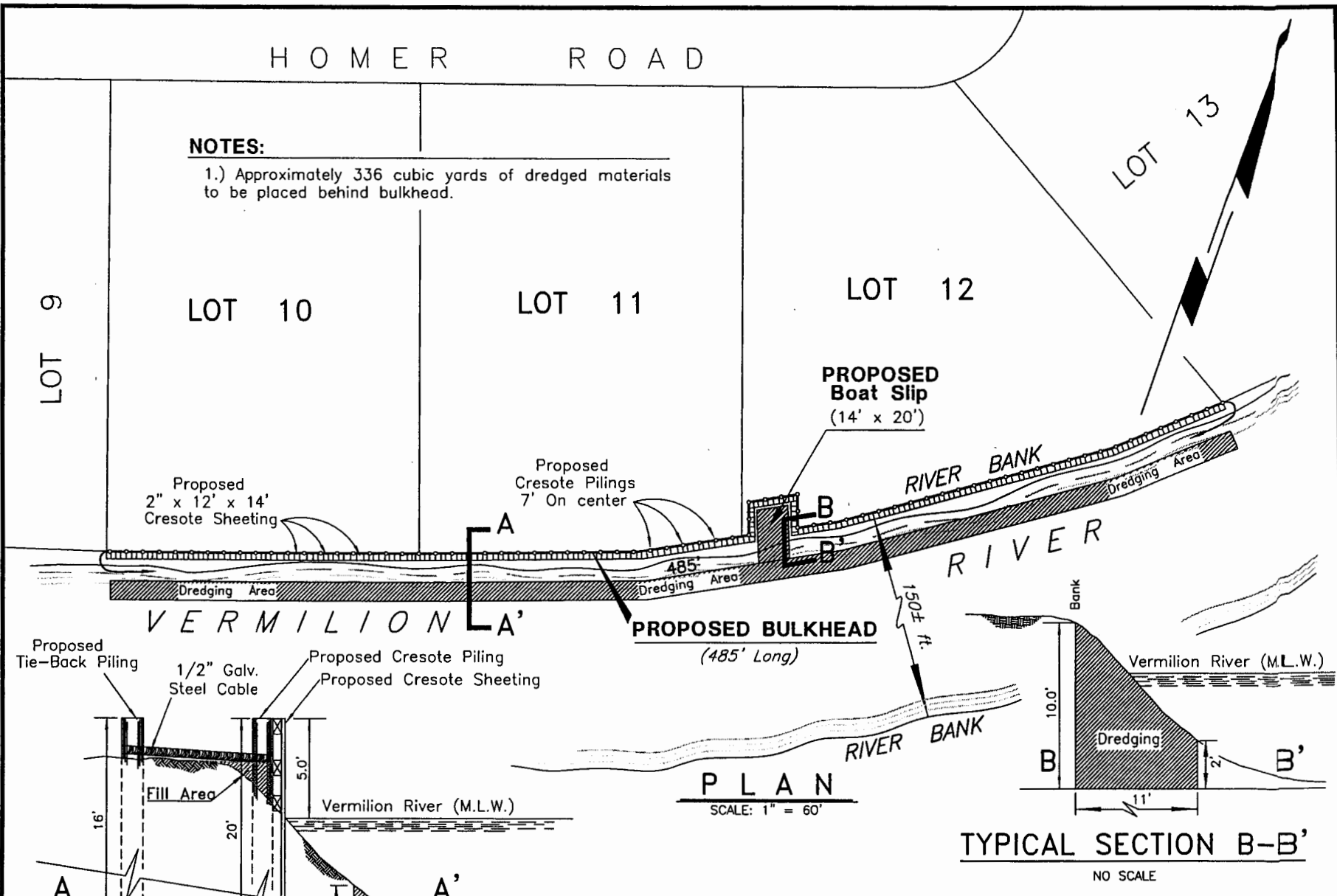

PLAN

SCALE: 1" = 60'

TYPICAL SECTION B-B'

NO SCALE

TYPICAL SECTION A-A'

NO SCALE

PROPOSED BULKHEAD & BOAT SLIP WATERFRONT COVE AREA

VERMILION

PARISH,

LOUISIANA

APPLICATION BY:
OCTOBER 1, 2003

RONALD HOOVER
MAURICE, LOUISIANA

REVISIONS:

SHEET 2 OF 2

PREPARED BY:
C. L. JACK STELLY & ASSOCIATES, INC.
LAFAYETTE, LOUISIANA
FILE NO. 19763-C1.DWG

M.H.W. = 6.3' N.G.V.D.
M.L.W. = 2.0' N.G.V.D.