

FIGURE 1. VICINITY MAP

RIECKE AND ASSOCIATES
 ~18 ACRES
 COVINGTON, LA
 PREPARED BY:

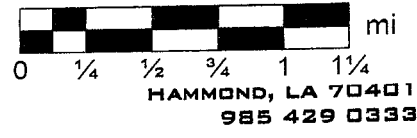
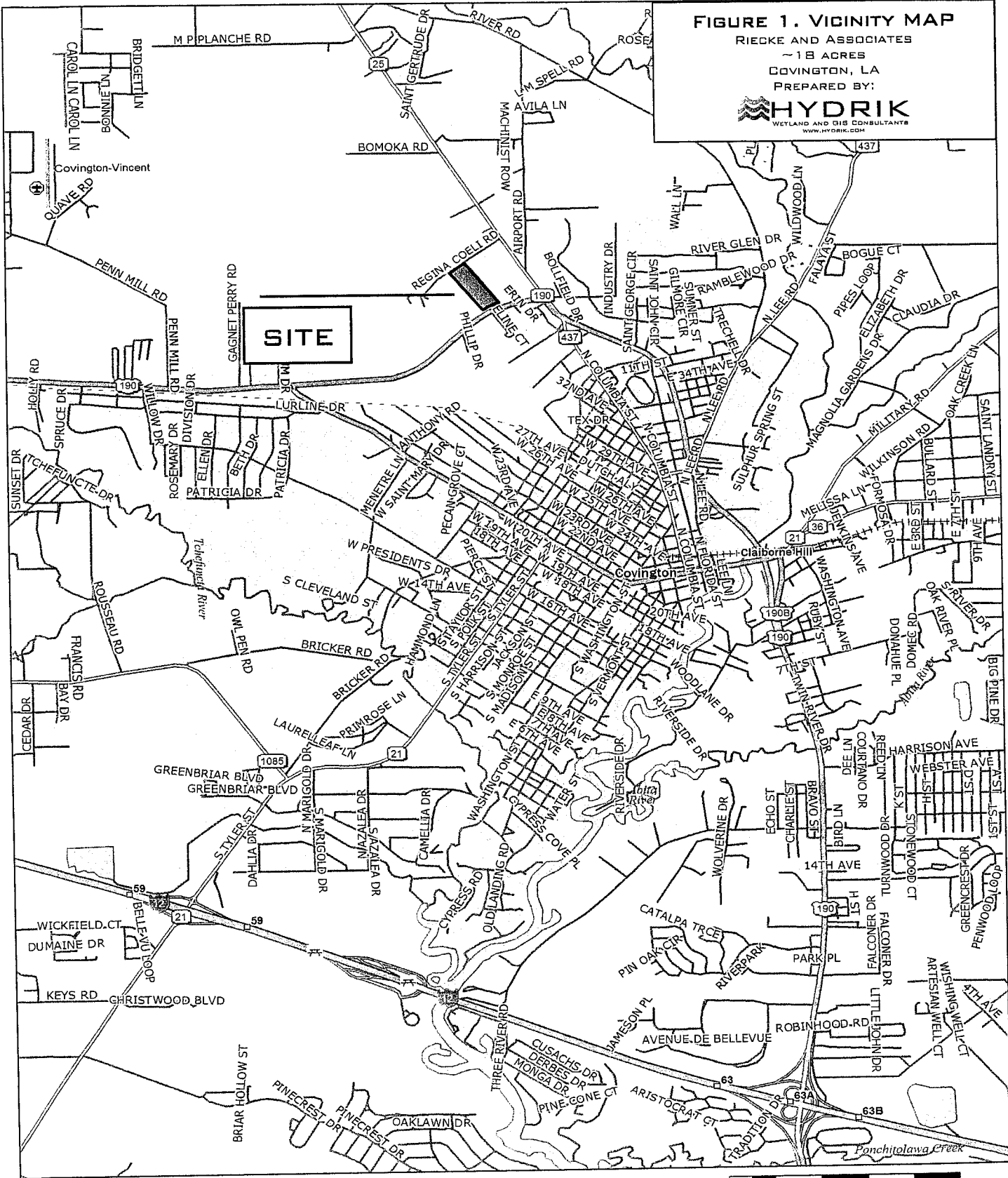
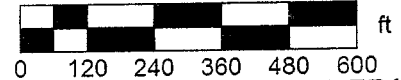
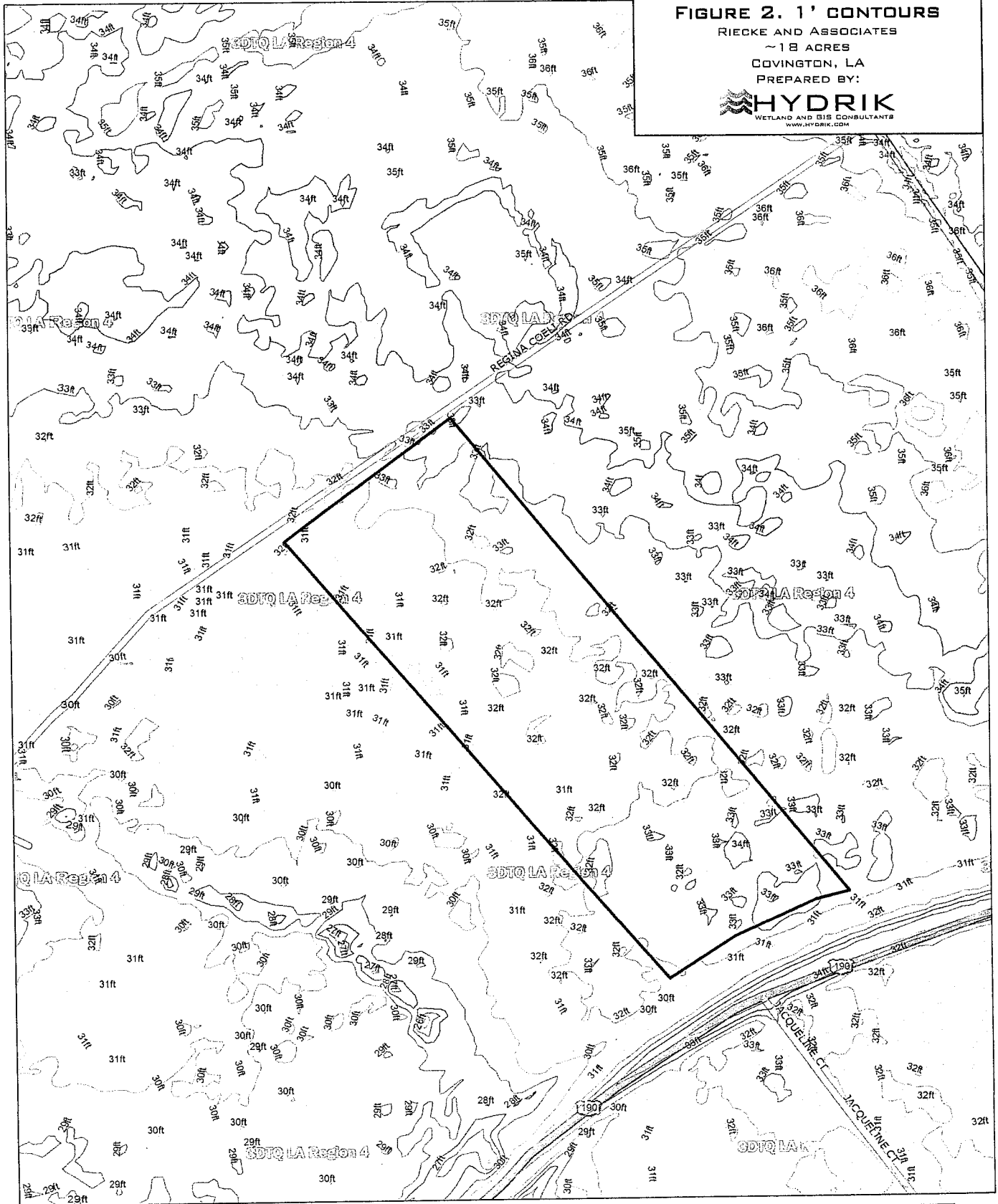

FIGURE 2. 1' CONTOURS

RIECKE AND ASSOCIATES
 ~ 18 ACRES
 COVINGTON, LA
 PREPARED BY:



0 120 240 360 480 600
 HAMMOND, LA 70401
 985 429 0333

FIGURE 3. 2004 IR

RIECKE AND ASSOCIATES

~18 ACRES

COVINGTON, LA

PREPARED BY:

 **HYDRIK**
WETLAND AND GIS CONSULTANTS
WWW.HYDRIK.COM

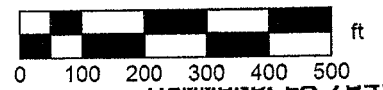
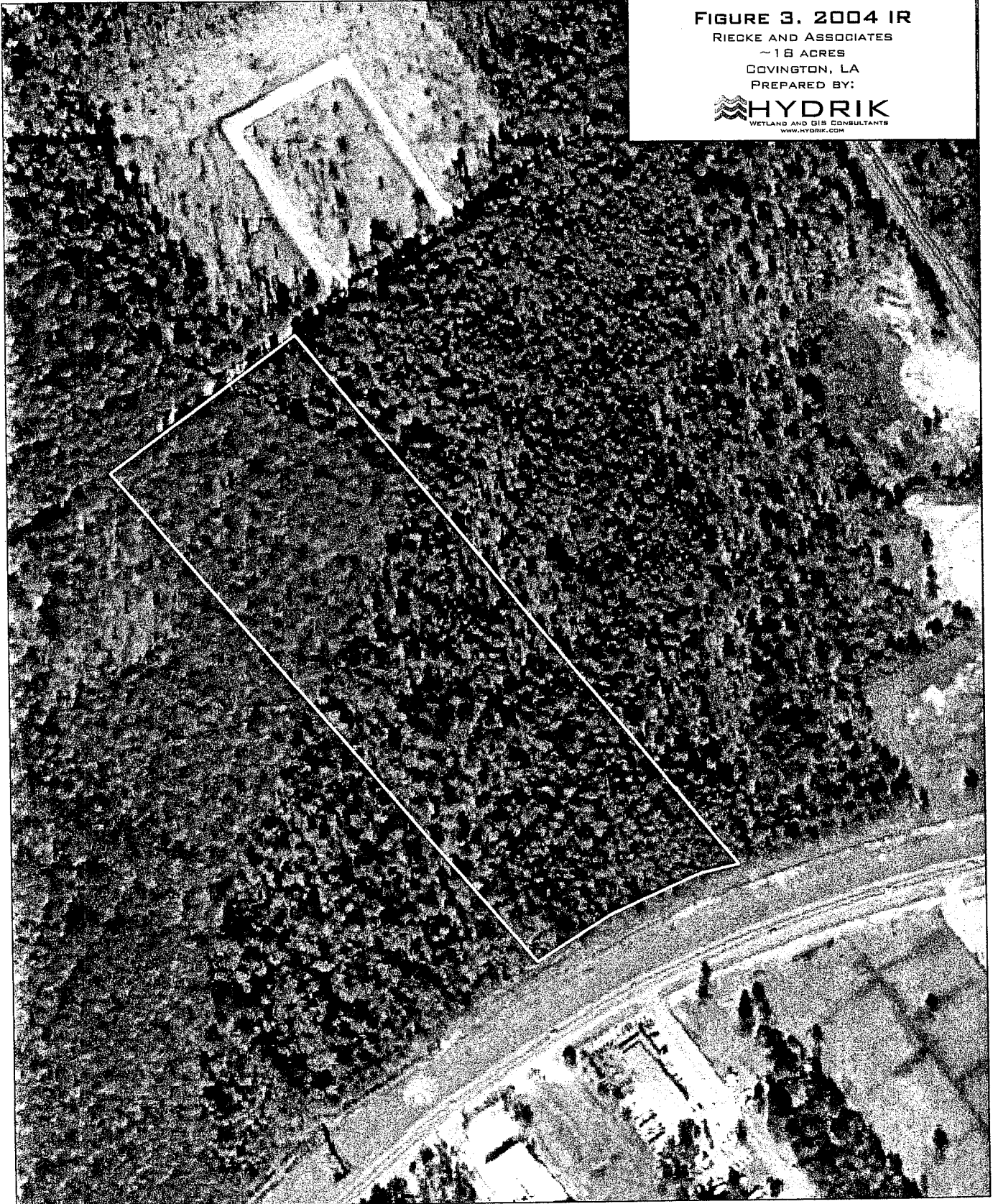

FIGURE 4. USDA SOILS

RIECKE AND ASSOCIATES

~18 ACRES

COVINGTON, LA

PREPARED BY:

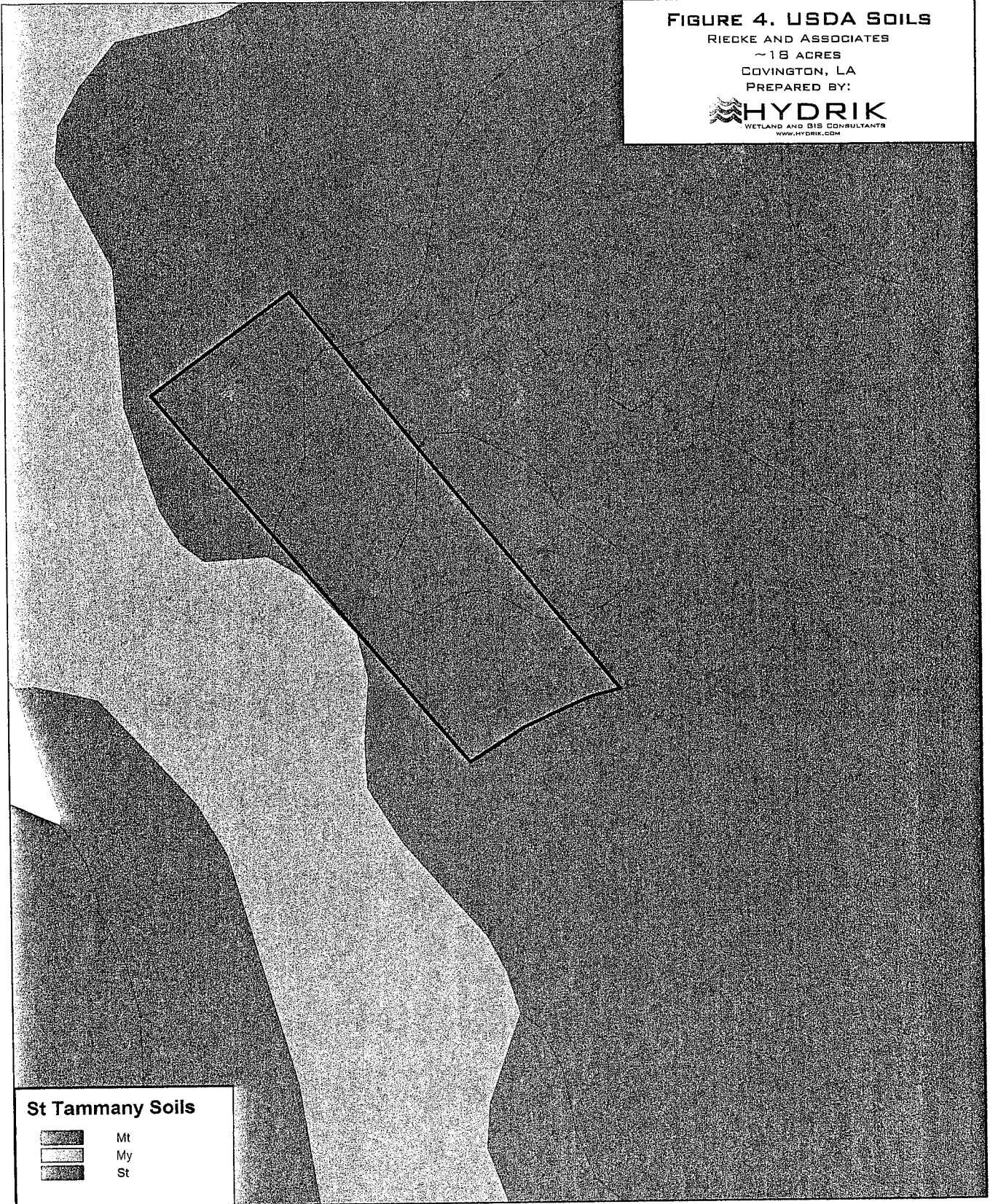

St Tammany Soils

-  Mt
-  My
-  St

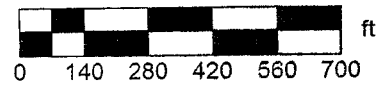

604 W.CHARLES ST.
HAMMOND, LA 70401
985 429 0333

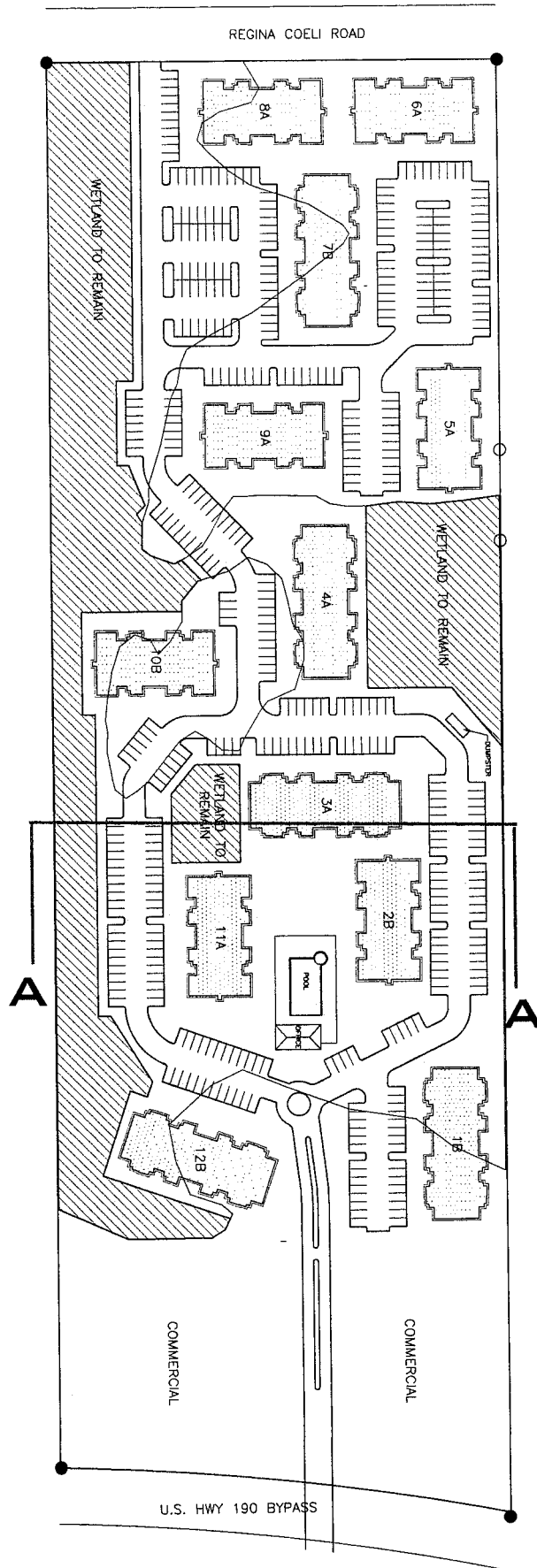

UNIT COUNT:
 BUILDING A (3-STORY) - (2) 180R PER F.L.R. - 360R - 144 TOTAL
 BUILDING B (3-STORY) - (2) 288R PER F.L.R. - 576R - 288 TOTAL
 BUILDING C (3-STORY) - (2) 288R PER F.L.R. - 576R - 288 TOTAL
432 PARKING SPACE REQUIRED - 432 PARKING SPACE PROVIDED

[Hatched Box] IMPACTED WETLANDS - 6.03 ACRES
 [White Box] WETLANDS TO REMAIN - 3.22 ACRES
 TOTAL OF ACRES - 1.8 ACRES
 TOTAL OF WETLANDS - 9.25 ACRES

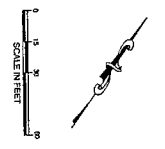

	Kyle Associates, LLC Planning, Engineering, and Landscape Architecture 5000 Metairie Square Pl., Metairie, LA 70001 • 504.737.8377 2018 Poydras Street • New Orleans, LA 70112 • 504.586.5991	STAMP: _____ DATE: _____ REMARKS: _____	REVISIONS <table border="1" style="width:100%; border-collapse: collapse;"> <thead> <tr> <th>NO.</th> <th>DATE</th> <th>REMARKS</th> <th>APP'D</th> </tr> </thead> <tbody> <tr><td> </td><td> </td><td> </td><td> </td></tr> <tr><td> </td><td> </td><td> </td><td> </td></tr> <tr><td> </td><td> </td><td> </td><td> </td></tr> </tbody> </table>	NO.	DATE	REMARKS	APP'D													WISTERIA ESTATES U.S. HIGHWAY 190 COVINGTON, LA SITE PLAN	SCALE: (24x36) 1"=60'-0" SCALE: (11x17) 1"=120'-0" DATE: 18.OCT.12	DESIGNED BY: FMK DRAWN BY: NBZ CHECKED BY: FMK JOB NO. 12015	12015-PL-Site.dwg 10/22/2012 3:06:39 PM kpassow
NO.	DATE	REMARKS	APP'D																				

JARED REICKE
 WISTERIA ESTATES APT. COMPLEX
 ~ 18 ACRES
 COVINGTON, LA
 SECTION 404 PERMIT

SECTION A-A

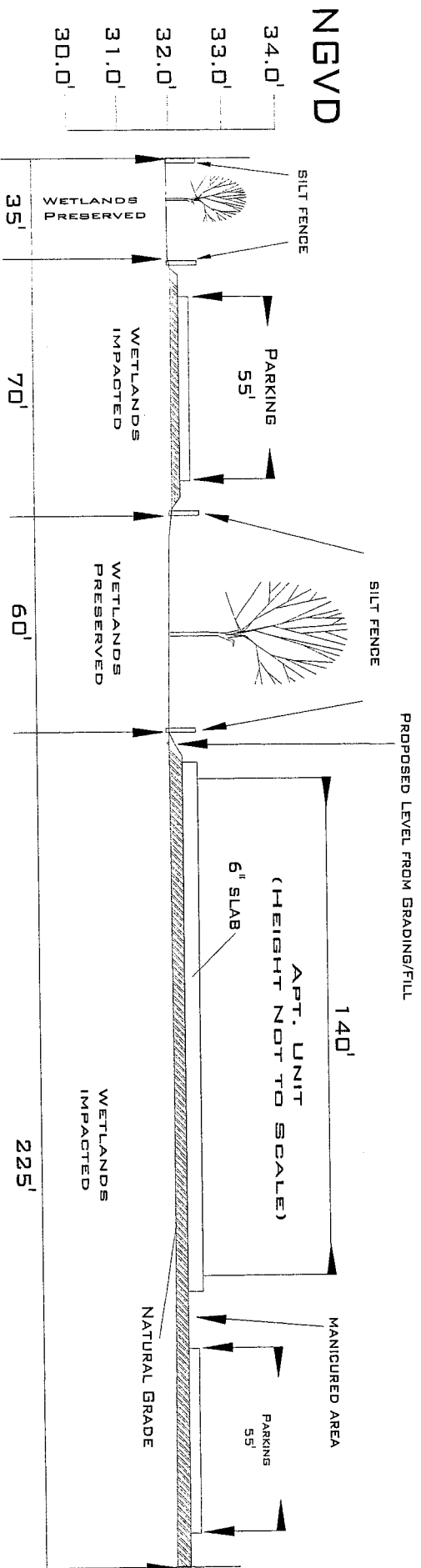

JARED REICKE COVINGTON, LA ~ 18 ACRES	
FILE: 1120C	DATE:
FIGURE: CS	REV :
DRAWING: CS	APPROVED:



6