

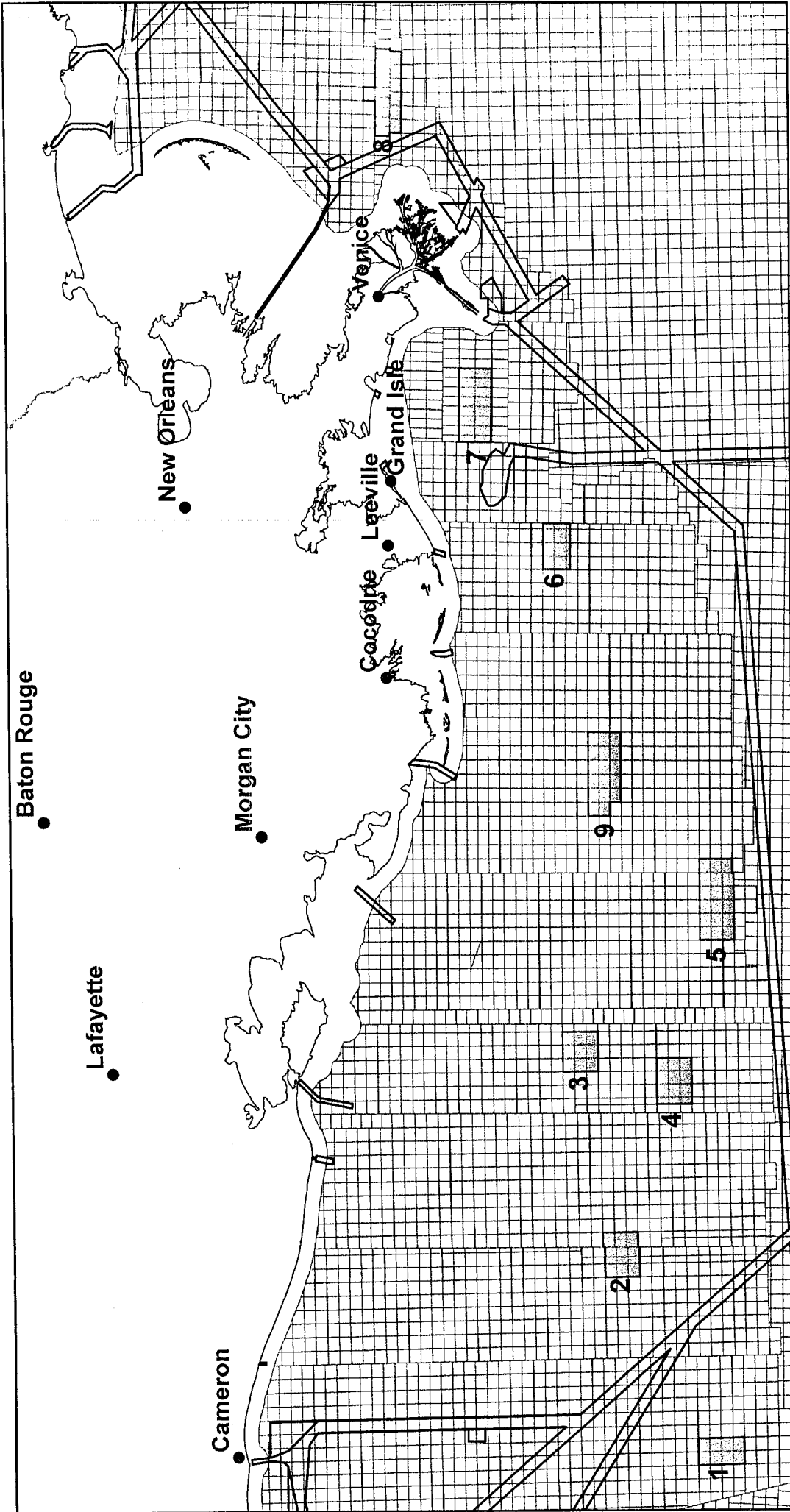

Louisiana Artificial Reef Planning Areas







-  Planning Areas
-  Fairways
-  OCS Blocks

Planning Areas

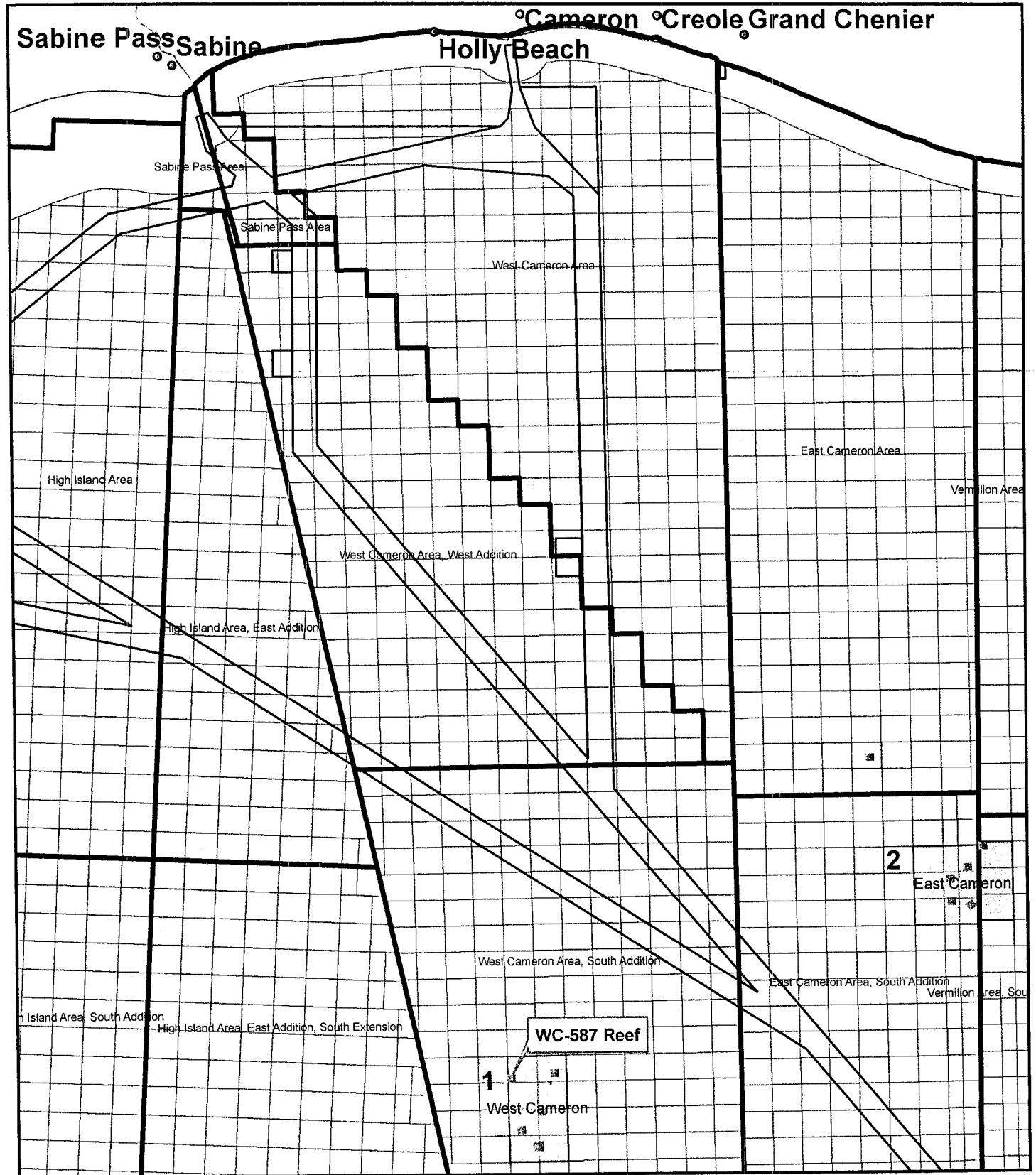
1. West Cameron Planning Area
2. East Cameron Planning Area
3. South Marsh Island (76) Planning Area
4. South Marsh Island (146) Planning Area
5. Eugene Island Planning Area
6. South Timbalier Planning Area
7. West Delta Planning Area
8. Main Pass Planning Area
9. Ship Shoal Planning Area

Louisiana Artificial Reef Program



-  Planning Area
-  Permitted Reef Sites
-  Fairways
-  OCS Blocks

0 5 10 20 Nautical Miles

WC-587 Reef Vicinity Map



WC588

WC587

EAST 4,000.00'

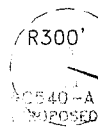

WC540-A Jacket in Prop. Reefed Position (Orientation to be field determined)	
NAD27-LA SOUTH	
X=	1,349,880.54'
Y=	-178,446.03'
Lat.	28° 09' 37.065"N
Lon.	93° 21' 00.296"W
NAD83-LA SOUTH	
X=	2,630,681.36'
Y=	-117,741.48'
Lat.	28° 09' 38.008"N
Lon.	93° 21' 00.817"W

NORTH 4,000.00'

SOUTH 4,000.00'

WEST 4,000.00'

WC593

WC594

ARTIFICIAL REEF BOUNDARIES

LOCATION	X COORDINATE	Y COORDINATE	LATITUDE	LONGITUDE
1	1,347,177.57'	-177,549.38'	28° 09' 45.467"N	93° 21' 30.652"W
2	1,351,177.57'	-177,549.38'	28° 09' 46.164"N	93° 20' 45.990"W
3	1,351,177.57'	-181,549.38'	28° 09' 06.581"N	93° 20' 45.206"W
4	1,347,177.57'	-181,549.38'	28° 09' 05.883"N	93° 21' 29.863"W

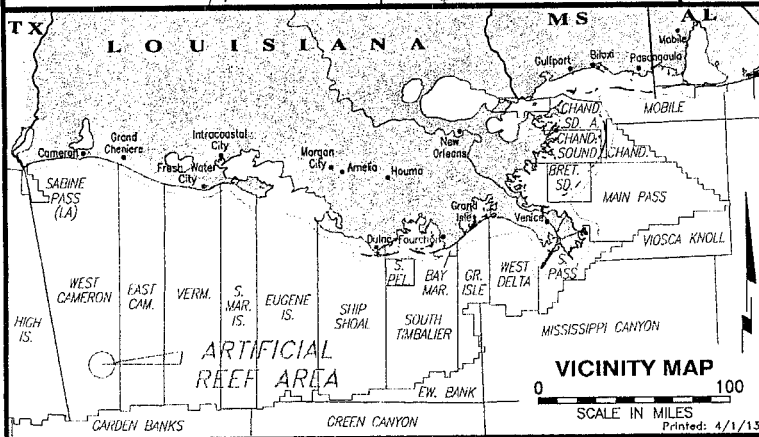

WEST CAMERON 540 - "A" PROPOSED REEF POSITION

BLOCK 587 WEST CAMERON AREA GULF OF MEXICO

FUGRO CHANCE INC.

230 Dulles Dr. Lafayette, Louisiana 70506-3901 (537) 237-1300

GEODETTIC DATUM: NAD27 PROJECTION: LOUISIANA SOUTH GRID UNITS: US SURVEY FEET	SCALE IN FEET 0 1,000'	Chart: Of:
Job No.: 1300652 Date: 4/01/13 Drwn: SJL	1 3	
Dwgfile: H:\2013\1300652\CAD\1300652A		

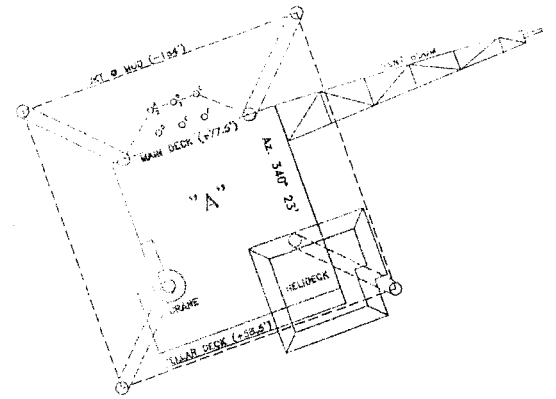

PLAN

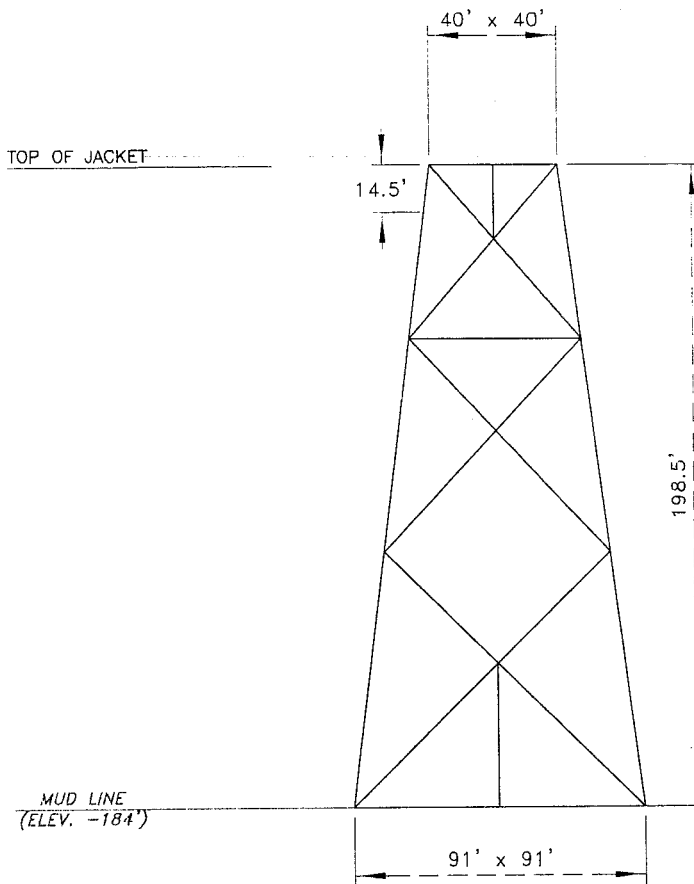

PROFILE



WEST CAMERON 540 - "A"
TO BE REEFED
 BLOCK 587
 WEST CAMERON AREA
 GULF OF MEXICO

FUGRO CHANCE INC.
 200 Duques Dr. Lafayette, Louisiana 70508-5001 (337) 237-1300



GEODETTIC DATUM: NAD27
 PROJECTION: LOUISIANA SOUTH
 GRID UNITS: US SURVEY FEET

SCALE 0 60'
 IN FEET

Job No.: 1300652 Date: 4/01/13

Drwn: SJL

Chart: Of:

Dwgfile: H:\2013\1300652\CAD\1300652B

2 3

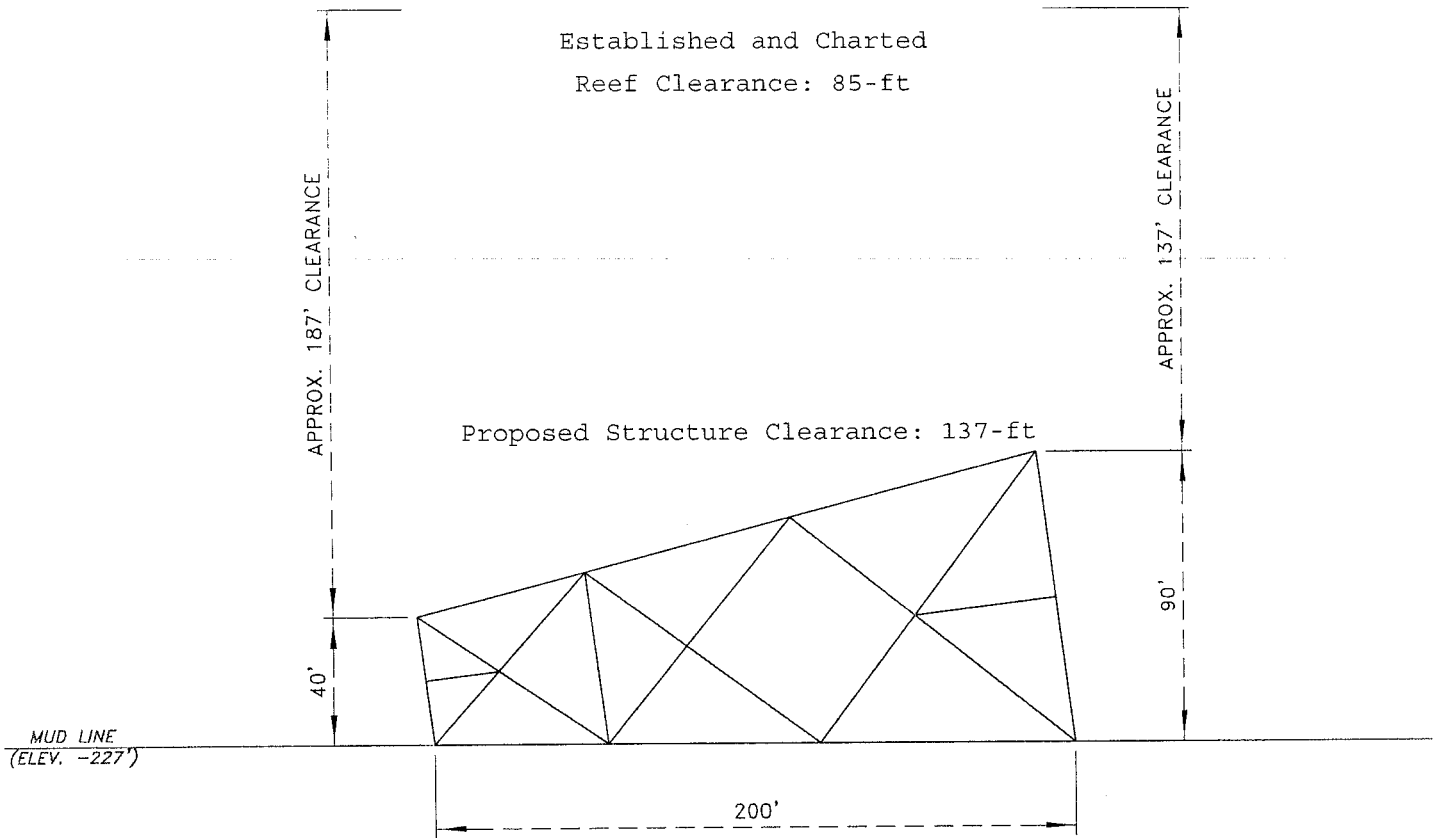

NOTES:

- 1) 18 MILES TO NEAREST SHIPPING FAIRWAY.
- 2) CLEARANCES BASED ON CONSTRUCTION DRAWINGS.



**WEST CAMERON 540 - "A"
IN PROPOSED REEF POSITION**

BLOCK 587
WEST CAMERON AREA
GULF OF MEXICO

FUGRO CHANCE INC.

200 Dulles Dr. Lafayette, Louisiana 70506-3001 (337) 237-1500



GEODEIC DATUM: NAD27
PROJECTION: LOUISIANA SOUTH
GRID UNITS: US SURVEY FEET

SCALE IN FEET 60'

Job No.: 1300652	Date: 4/01/13	Drwn: SJL	Chart: Of:
Dwgfile: H:\2013\1300652\CAD\1300652B			3 3

WC588

WC587

EAST 4,000.00'

①

②

Stingray 24" S-3794
Stingray 24" S-9691
Stingray 8" S-7043

WC593-A
(PROPOSED)

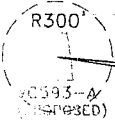

WC593-A Jacket in Prop. Reefed Position (Orientation to be field determined)	
NAD27-LA SOUTH	
X=	1,350,181.76'
Y=	-179,131.07'
Lat.	28° 09' 30.339"N
Lon.	93° 20' 56.798"W
NAD83-LA SOUTH	
X=	2,630,982.59'
Y=	-118,426.53'
Lat.	28° 09' 31.282"N
Lon.	93° 20' 57.319"W

4,000.00'
SOUTH

NORTH 4,000.00'

WEST 4,000.00'

④

③

GRID NORTH

WC593

WC594

Stingray 24" S-9691

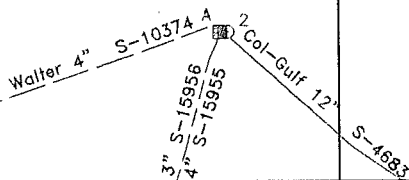

ARTIFICIAL REEF BOUNDARIES

LOCATION	X COORDINATE	Y COORDINATE	LATITUDE	LONGITUDE
1	1,347,177.57'	-177,549.38'	28° 09' 45.467"N	93° 21' 30.652"W
2	1,351,177.57'	-177,549.38'	28° 09' 46.164"N	93° 20' 45.990"W
3	1,351,177.57'	-181,549.38'	28° 09' 06.581"N	93° 20' 45.206"W
4	1,347,177.57'	-181,549.38'	28° 09' 05.883"N	93° 21' 29.863"W

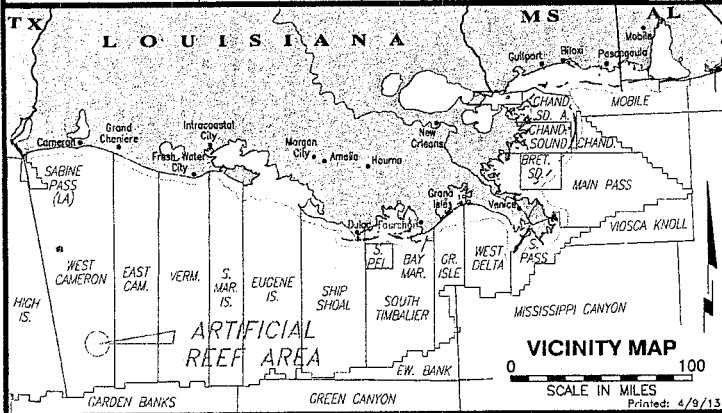

VICINITY MAP

SCALE IN MILES 0 100

Printed: 4/9/13



WEST CAMERON 593 - "A" PROPOSED REEF POSITION

BLOCK 587
WEST CAMERON AREA
GULF OF MEXICO

FUGRO CHANCE INC.

200 Dulles Dr., Lafayette, Louisiana 70506-3001 (337) 237-1300

GEODETIC DATUM: NAD27 PROJECTION: LOUISIANA SOUTH GRID UNITS: US SURVEY FEET	SCALE IN FEET
Job No.: 1300731 Date: 4/09/13 Dwgfile: H:\2013\1300731\CAD\1300731A	Drwn: SJL Chart: Of: 1 3

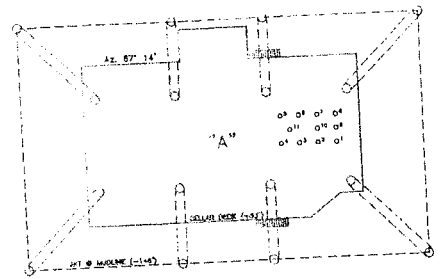

PLAN
PROFILE

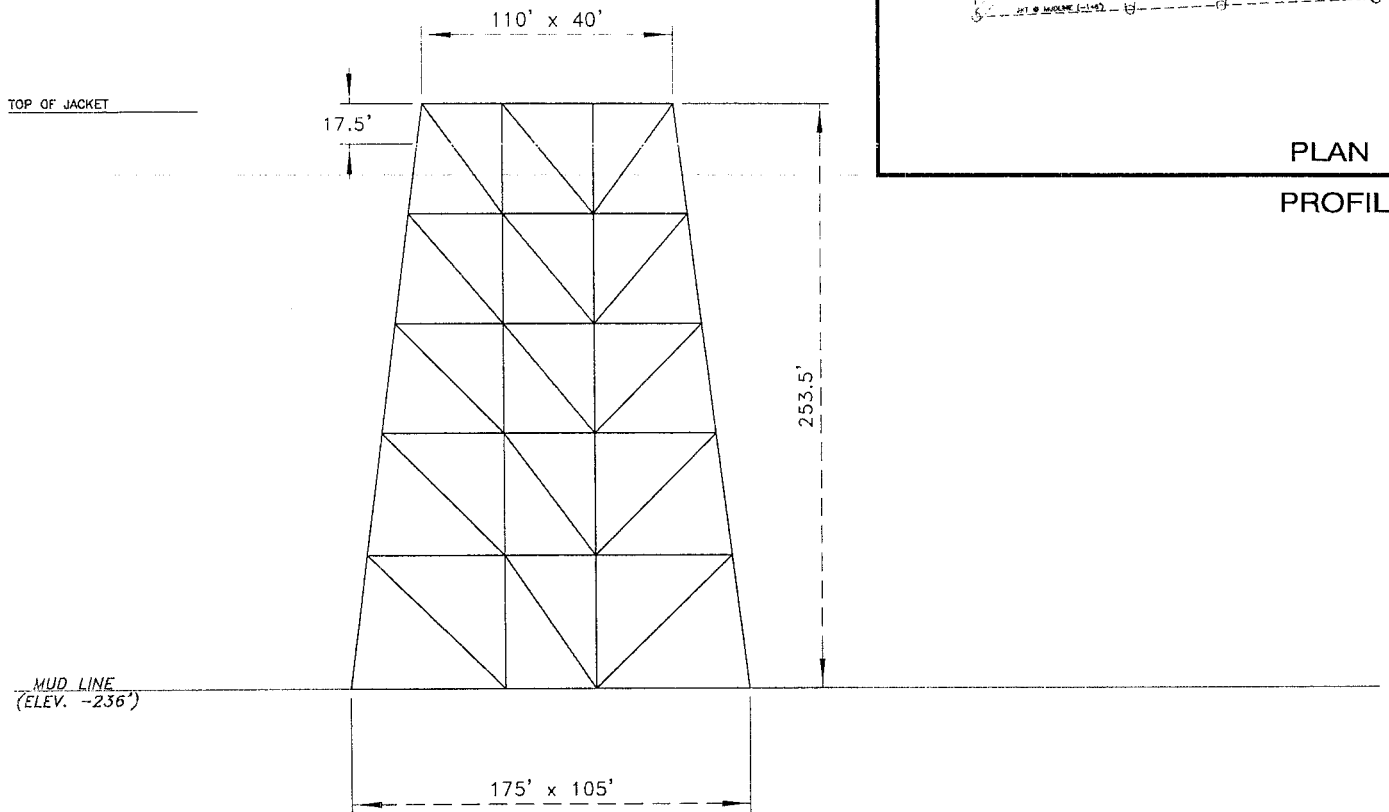

WEST CAMERON 593 - "A"
TO BE REEFED
 BLOCK 587
 WEST CAMERON AREA
 GULF OF MEXICO

FUGRO CHANCE INC.

200 Dulles Dr. Lafayette, Louisiana 70506-3001 (337) 237-1300



GEODETIC DATUM: NAD27
 PROJECTION: LOUISIANA SOUTH
 GRID UNITS: US SURVEY FEET

Job No.: 1300731

Date: 4/09/13

Drwn: SJL

Chart: Of:

Dwgfile: H:\2013\1300731\CAD\1300731B

2 3

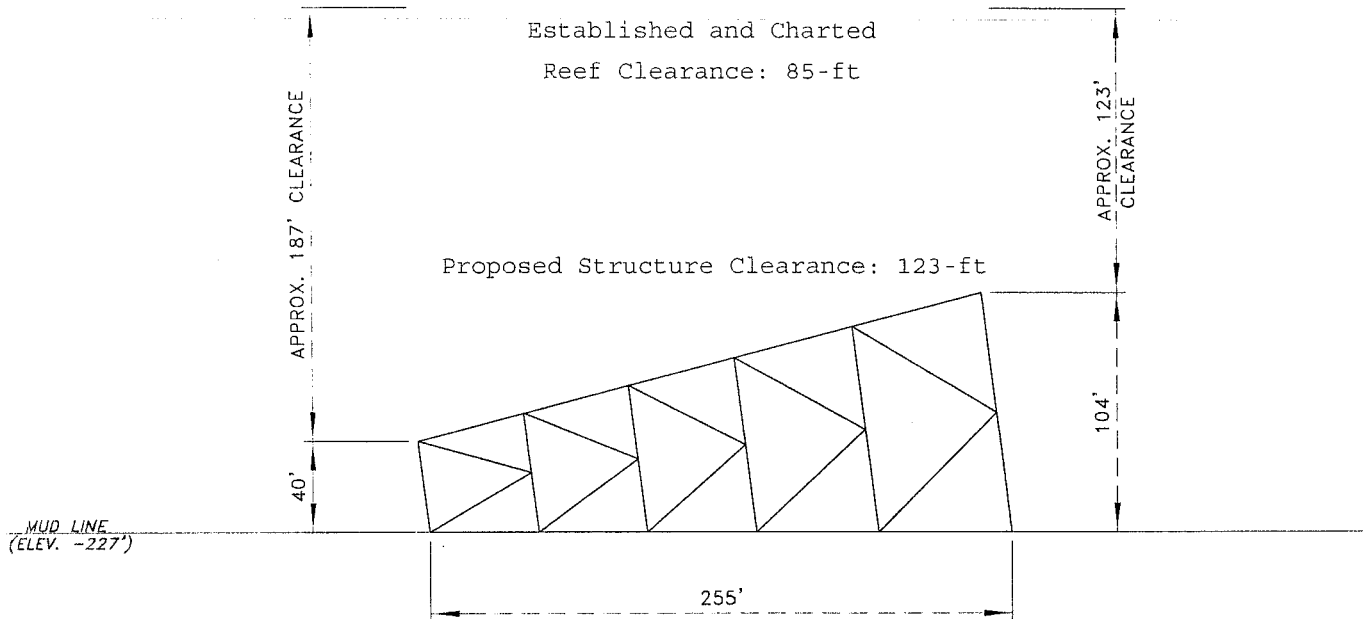

NOTES:

- 1) 18 MILES TO NEAREST SHIPPING FAIRWAY.
- 2) CLEARANCES BASED ON CONSTRUCTION DRAWINGS.



**WEST CAMERON 593 - "A"
IN PROPOSED REEF POSITION**

BLOCK 587
WEST CAMERON AREA
GULF OF MEXICO

FUGRO CHANCE INC.

200 Dulles Dr. Lafayette, Louisiana 70508-3001 (337) 237-1300



GEODETTIC DATUM: NAD27
PROJECTION: LOUISIANA SOUTH
GRID UNITS: US SURVEY FEET

Job No.: 1300731	Date: 4/09713	Drwn: SJL	Chart: Of:
Dwgfile: H:\2013\1300731\CAD\1300731B			3 3