

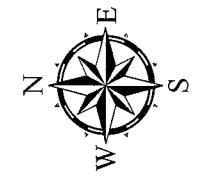

Louisiana Artificial Reef Planning Areas

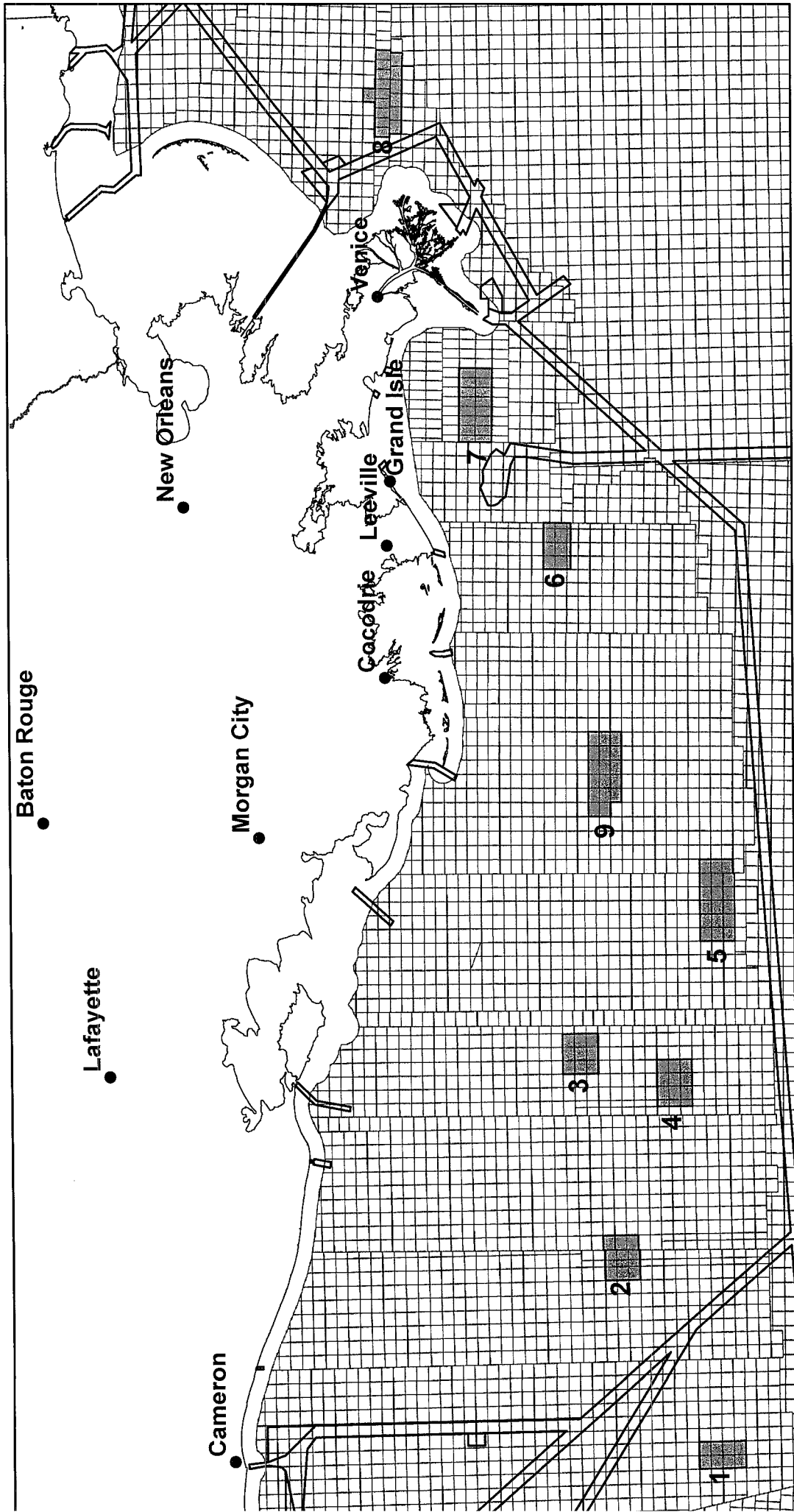

0 12.5 25 50 75 100
Nautical Miles



Planning Areas

- | | |
|---|----------------------------------|
| 1. West Cameron Planning Area | 6. South Timbalier Planning Area |
| 2. East Cameron Planning Area | 7. West Delta Planning Area |
| 3. South Marsh Island (76) Planning Area | 8. Main Pass Planning Area |
| 4. South Marsh Island (146) Planning Area | 9. Ship Shoal Planning Area |
| 5. Eugene Island Planning Area | |

-  Planning Areas
-  Fairways
-  OCS Blocks

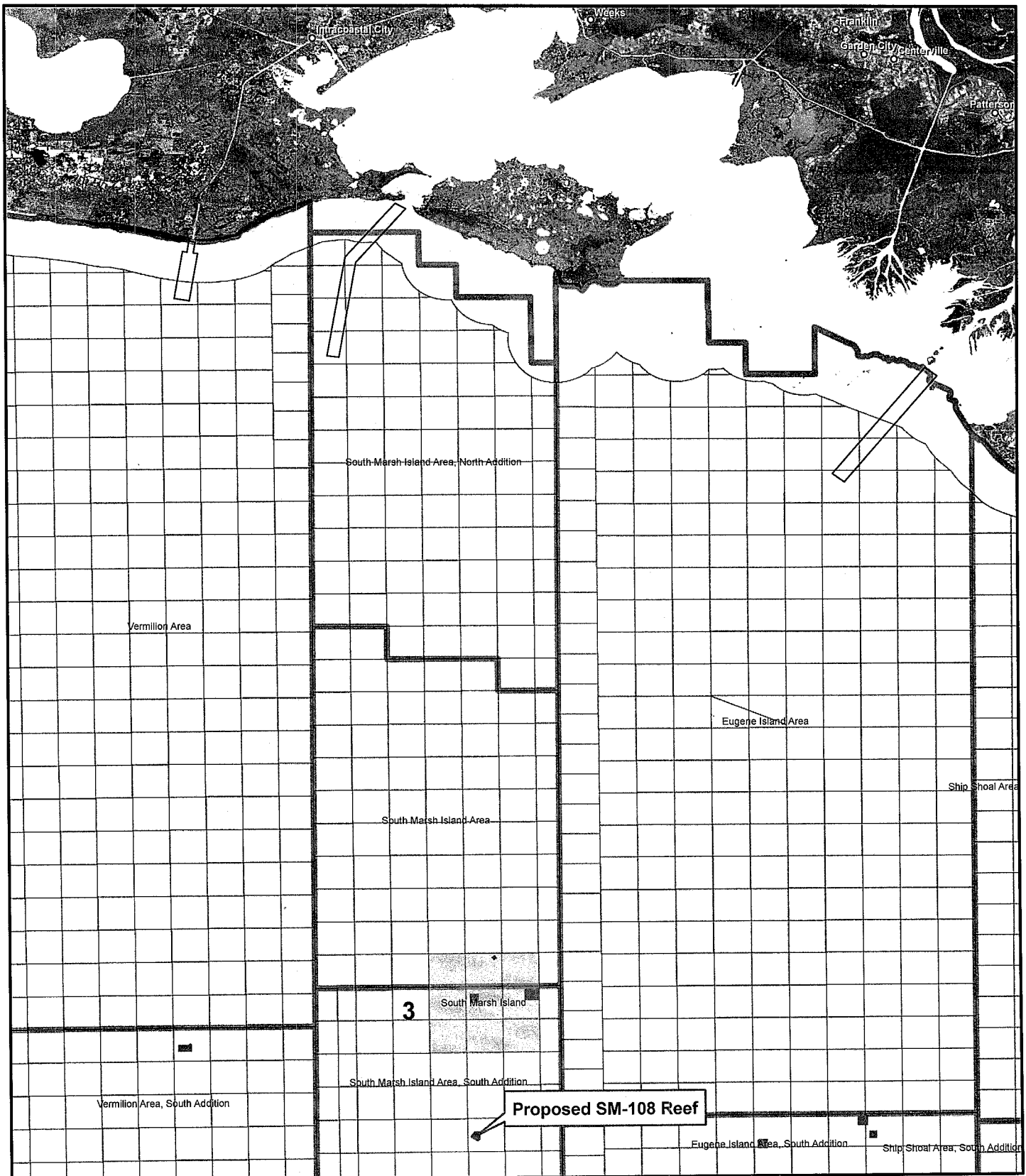
Louisiana Artificial Reef Program



-  Planning Area
-  Permitted Reef Sites
-  Fairways
-  OCS Blocks

0 5 10 20 Nautical Miles

SM-108 Reef Vicinity Map



SM108
OCS-00792
Stone

EAST 2,218.0'

GRID NORTH

SM108-J Jacket in Prop.
Reefed Position (Orientation
to be field determined)

NAD27-LA SOUTH
X= 1,798,676.00'
Y= -87,624.00'
Lat. 28° 25' 27.193"N
Lon. 91° 57' 34.065"W

NAD83-LA SOUTH
X= 3,079,476.25'
Y= -26,922.59'
Lat. 28° 25' 28.072"N
Lon. 91° 57' 34.484"W

SM108-G Jacket in Prop.
Reefed Position (Orientation
to be field determined)

NAD27-LA SOUTH
X= 1,799,440.00'
Y= -87,090.00'
Lat. 28° 25' 32.520"N
Lon. 91° 57' 25.544"W

NAD83-LA SOUTH
X= 3,080,240.24'
Y= -26,388.59'
Lat. 28° 25' 33.399"N
Lon. 91° 57' 25.963"W

Highest Point of
SM108-"D" Jacket
Reefed in Place

X= 1,799,392.00'
Y= -87,704.69'
Lat. 28° 25' 26.433"N
Lon. 91° 57' 26.044"W

Highest Point of
SM108-"D" Conductor
Area Reefed in Place

X= 1,799,499.46'
Y= -87,855.14'
Lat. 28° 25' 24.949"N
Lon. 91° 57' 24.832"W

Center of SM108 - "D"
Jacket Reefed in Place

NAD27-LA SOUTH
X= 1,799,453.09'
Y= -87,775.07'
Lat. 28° 25' 25.739"N
Lon. 91° 57' 25.356"W

NAD83-LA SOUTH
X= 3,080,253.35'
Y= -27,073.67'
Lat. 28° 25' 26.619"N
Lon. 91° 57' 25.775"W

ARTIFICIAL REEF BOUNDARY				
LOCATION	X COORDINATE	Y COORDINATE	LATITUDE	LONGITUDE
1	1,797,861.92'	-84,400.00'	28° 25' 59.060"N	91° 57' 43.378"W
2	1,800,080.00'	-84,400.00'	28° 25' 59.180"N	91° 57' 18.542"W
3	1,800,080.00'	-88,017.15'	28° 25' 23.377"N	91° 57' 18.322"W
4	1,799,123.76'	-88,728.14'	28° 25' 16.288"N	91° 57' 28.985"W
5	1,796,272.77'	-86,725.89'	28° 25' 35.952"N	91° 58' 01.027"W

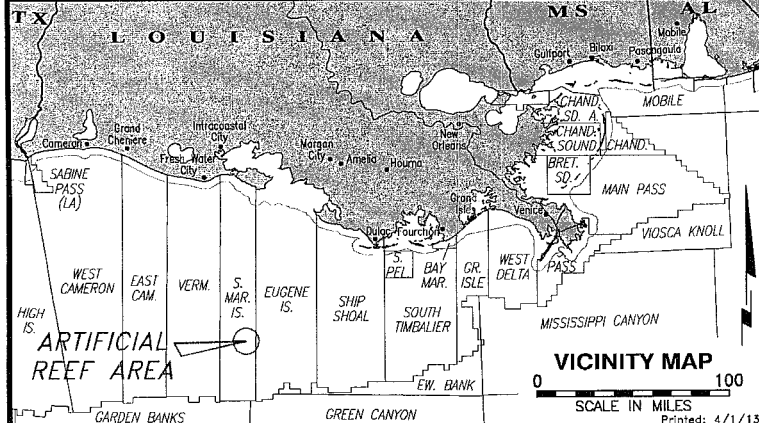
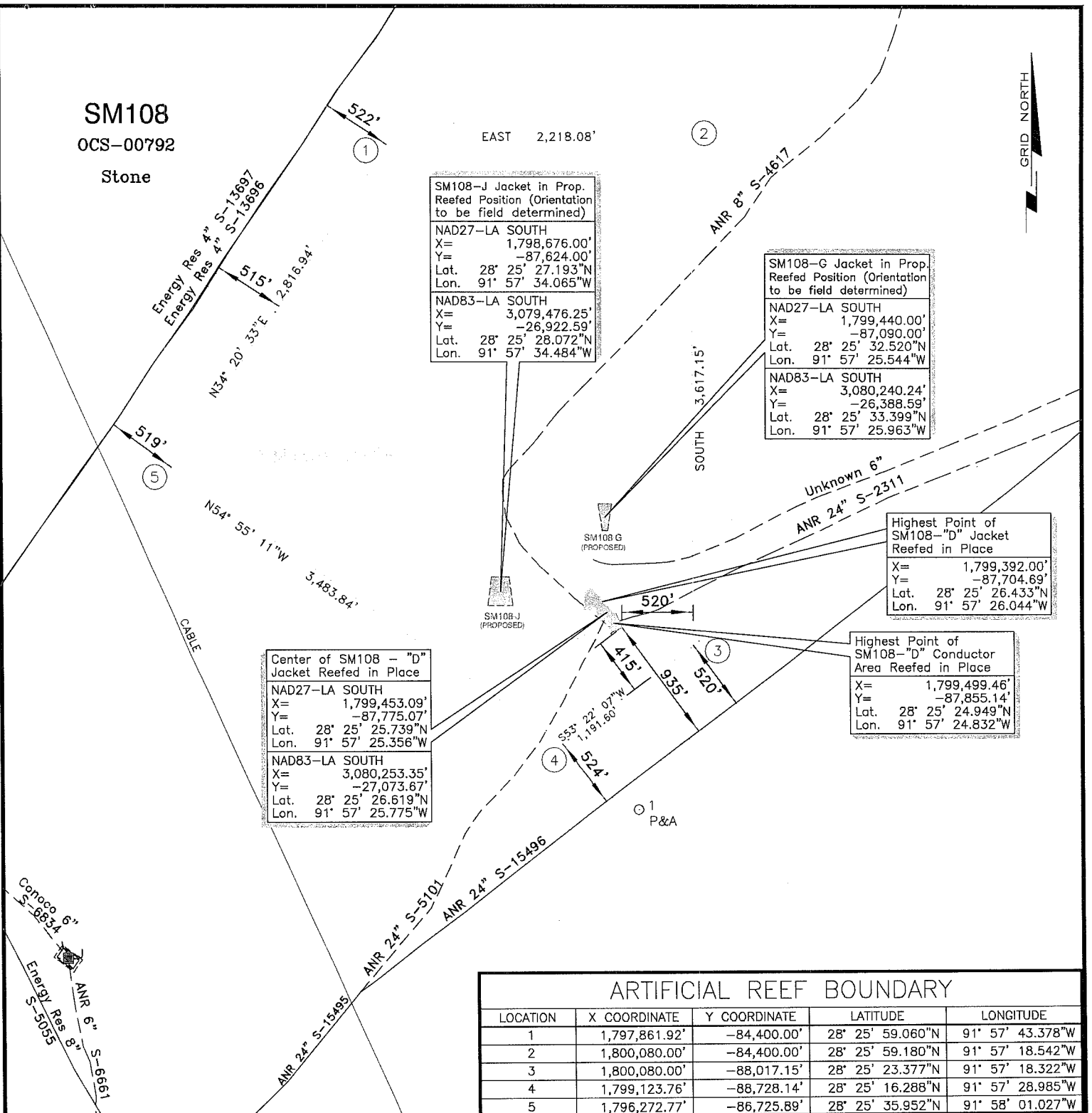

STONE
ENERGY

**SOUTH MARSH 108 - "D", "G", & "J"
IN PROPOSED REEF POSITIONS**

BLOCK 108
SOUTH MARSH ISLAND AREA
GULF OF MEXICO

FUGRO CHANCE INC.
200 Dulles Dr. Lafayette, Louisiana 70506-3001 (337) 237-1300

GEODETIC DATUM: NAD27
PROJECTION: LOUISIANA SOUTH
GRID UNITS: US SURVEY FEET

SCALE IN FEET 0 1,000'

Job No.: 1300640 Date: 4/01/13 Drwn: SJL Chart: Of: 1 7
Dwgfile: H:\2013\1300640\CAD\1300640A

TOP OF JACKET

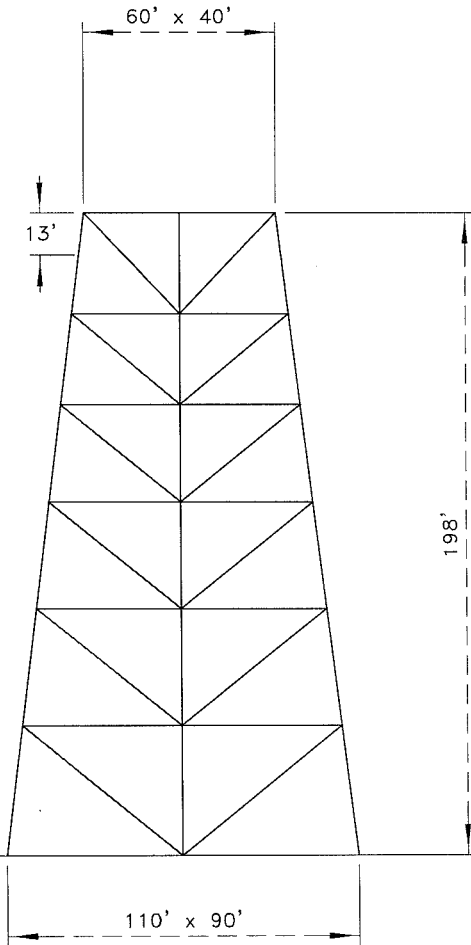

MUD LINE
(ELEV. -185')

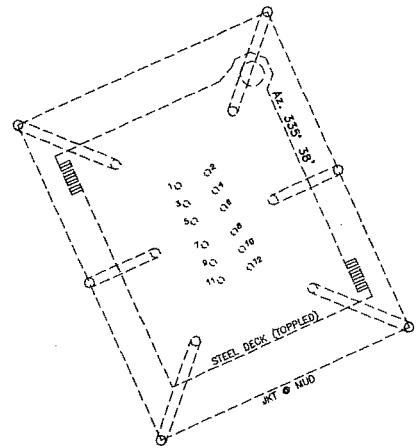

PLAN

PROFILE



SOUTH MARSH ISLAND - "D"
TO BE REEFED

BLOCK 108
SOUTH MARSH ISLAND AREA
GULF OF MEXICO

FUGRO CHANCE INC.

200 Dulles Dr. Lafayette, Louisiana 70506-3001 (337) 237-1500



GEODEIC DATUM: NAD27
PROJECTION: LOUISIANA SOUTH
GRID UNITS: US SURVEY FEET

SCALE 0 60'
IN FEET

Job No.: 1300640 Date: 3/27/13

Drwn: SJL

Chart: Of:
2 7

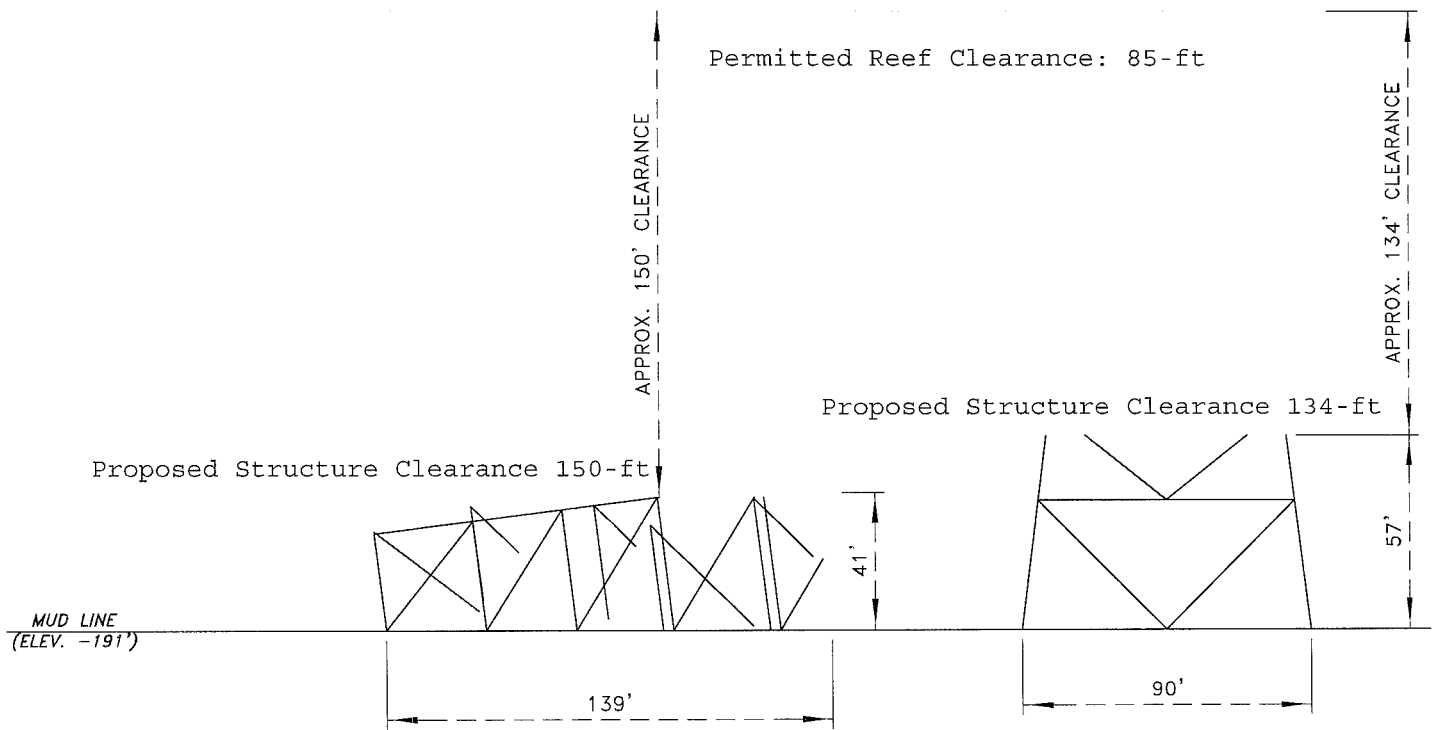

NOTES:

- 1) 35 MILES TO NEAREST SHIPPING FAIRWAY.
- 2) CLEARANCES BASED ON CONSTRUCTION DRAWINGS.



**SOUTH MARSH ISLAND 108 - "D"
IN PROPOSED REEF POSITION**

BLOCK 108
SOUTH MARSH ISLAND AREA
GULF OF MEXICO

FUGRO CHANCE INC.

200 Dulles Dr. Lafayette, Louisiana 70506-3001 (337) 237-1500



GEODEIC DATUM: NAD27
PROJECTION: LOUISIANA SOUTH
GRID UNITS: US SURVEY FEET

SCALE 0 60'
IN FEET

Job No.: 1300640 Date: 4/01/13

Drwn: SJL

Chart: Of:
3 7

TOP OF JACKET

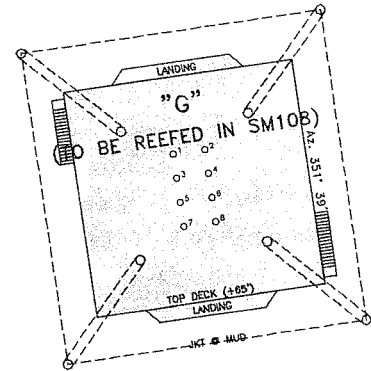
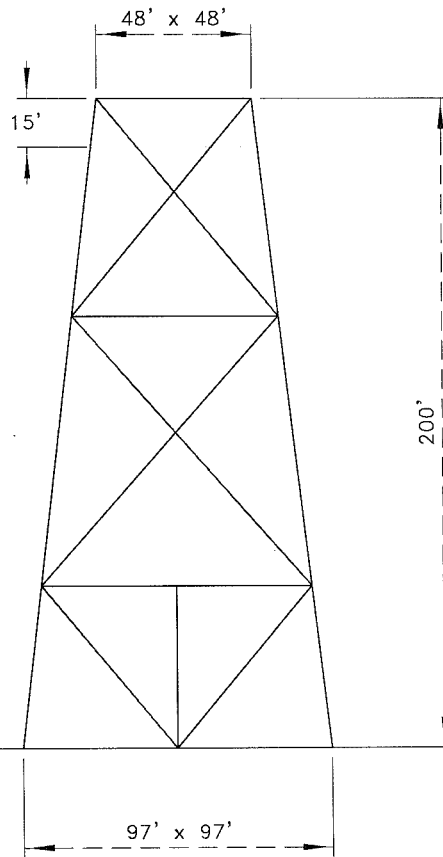

PLAN

PROFILE

MUD LINE
(ELEV. -185')



SOUTH MARSH ISLAND 108 - "G"
TO BE REEFED

BLOCK 108
 SOUTH MARSH ISLAND AREA
 GULF OF MEXICO

FUGRO CHANCE INC.
 200 Dulles Dr. Lafayette, Louisiana 70506-3001 (337) 237-1300



GEODETTIC DATUM: NAD27
 PROJECTION: LOUISIANA SOUTH
 GRID UNITS: US SURVEY FEET

SCALE 0 60'
 IN FEET

Job No.: 1300640 Date: 3/27/13

Drwn: SJL

Chart: Of:
 4 7

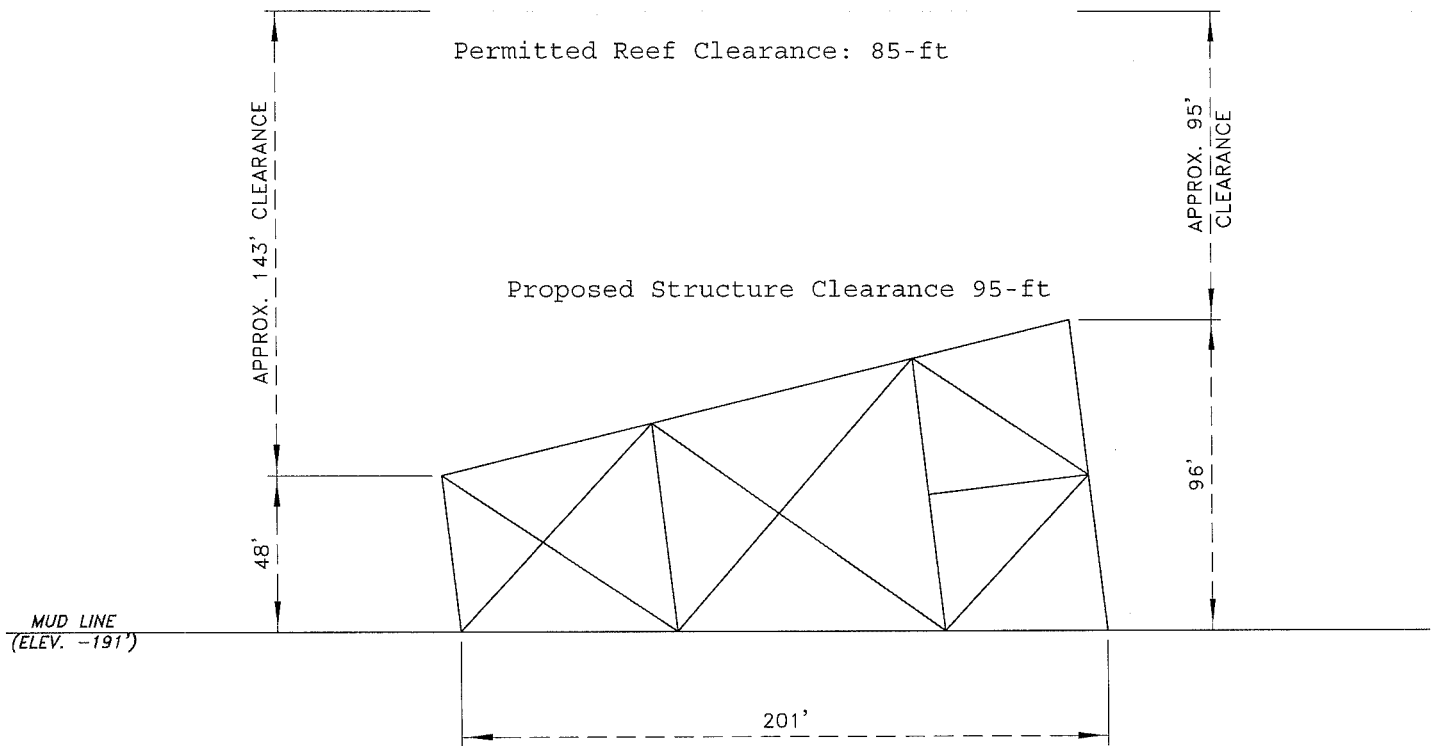

NOTES:

- 1) 35 MILES TO NEAREST SHIPPING FAIRWAY.
- 2) CLEARANCES BASED ON CONSTRUCTION DRAWINGS.



**SOUTH MARSH ISLAND 108 - "G"
IN PROPOSED REEF POSITION**

BLOCK 108
SOUTH MARSH ISLAND AREA
GULF OF MEXICO

FUGRO CHANCE INC.

200 Dulles Dr. Lafayette, Louisiana 70506-3001 (337) 237-1500



GEODEIC DATUM: NAD27
PROJECTION: LOUISIANA SOUTH
GRID UNITS: US SURVEY FEET

SCALE
IN FEET



Job No.: 1300640

Date: 3/27/13

Drwn: SJL

Chart: Of:

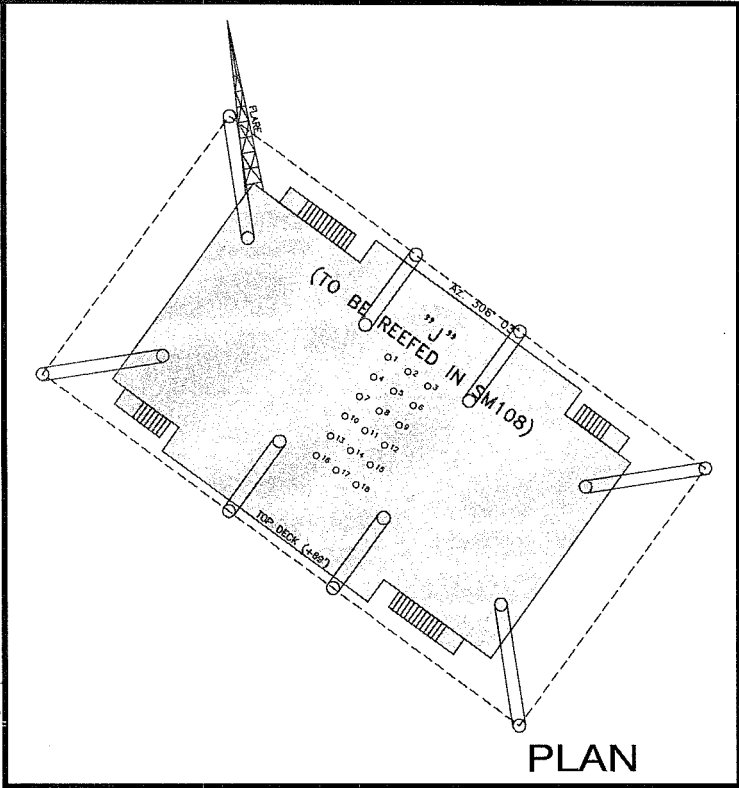

PLAN

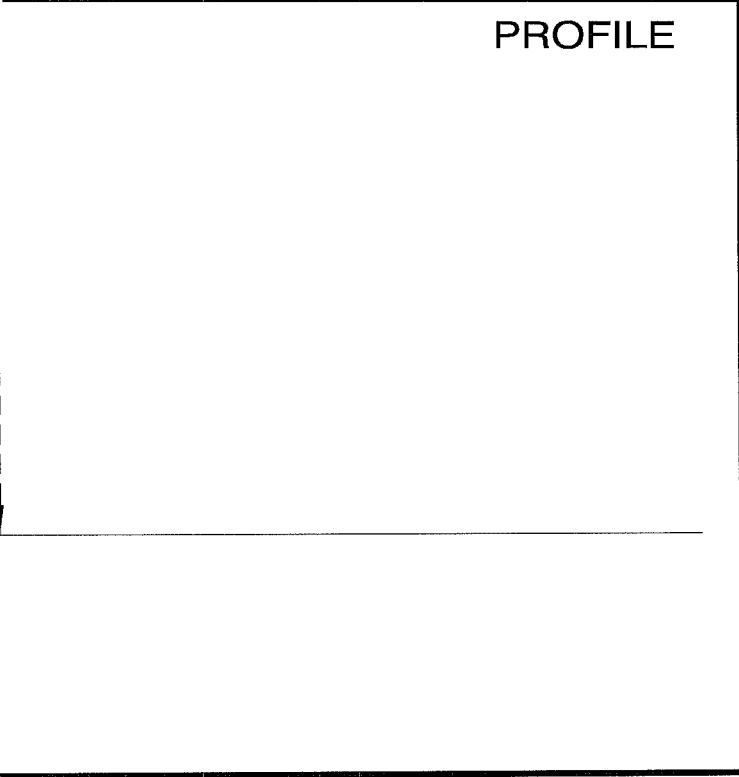

PROFILE



SOUTH MARSH ISLAND 108 - "J"
TO BE REEFED
 BLOCK 108
 SOUTH MARSH ISLAND AREA
 GULF OF MEXICO

FUGRO CHANCE INC.
 200 Dulles Dr. Lafayette, Louisiana 70508-3001 (337) 237-1300



GEODETC DATUM: NAD27
 PROJECTION: LOUISIANA SOUTH
 GRID UNITS: US SURVEY FEET

SCALE
 IN FEET

Job No.: 1300640 Date: 3/27/13

Drwn: SJL Chart: Of:

Dwgfile: H:\2013\1300640\CAD\1300640C

6 7

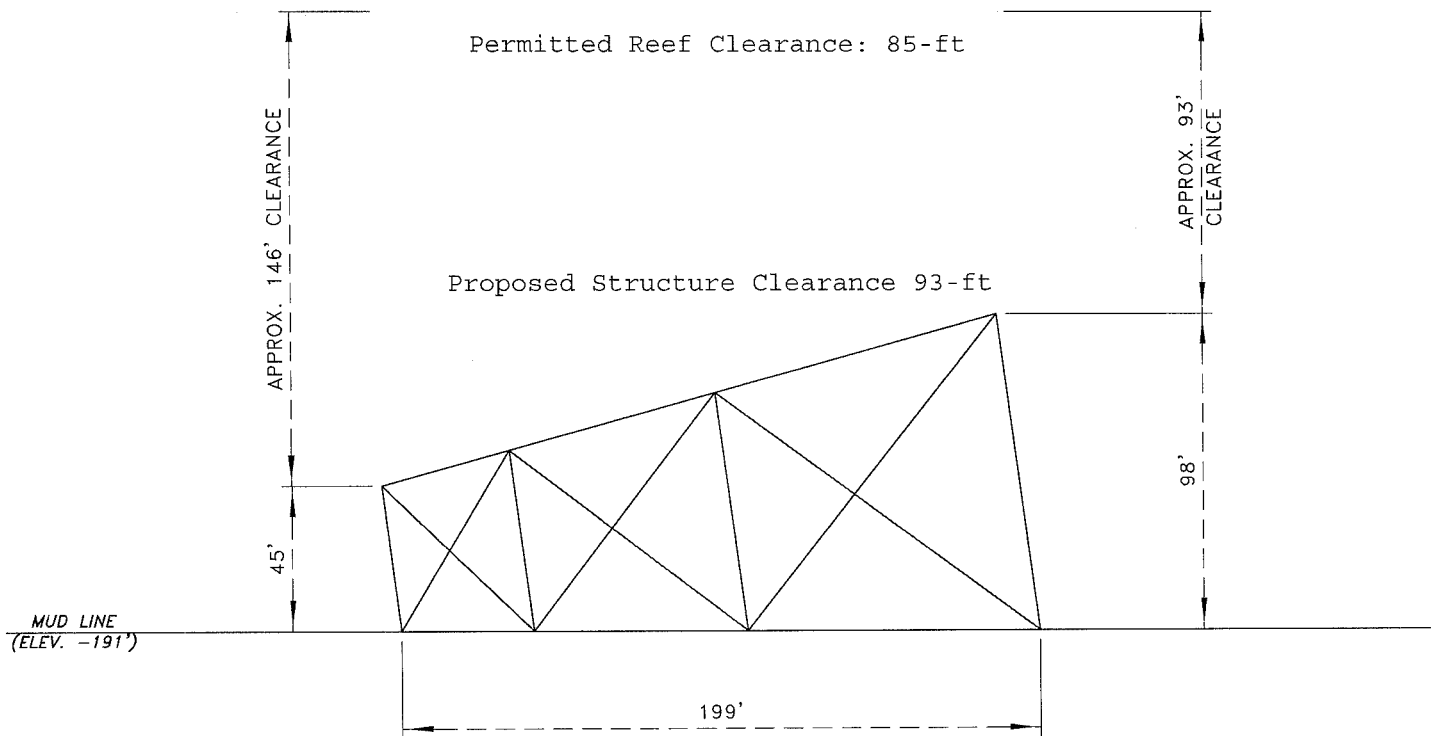

NOTES:

- 1) 35 MILES TO NEAREST SHIPPING FAIRWAY.
- 2) CLEARANCES BASED ON CONSTRUCTION DRAWINGS.



**SOUTH MARSH ISLAND 108 - "J"
IN PROPOSED REEF POSITION**

BLOCK 108
SOUTH MARSH ISLAND AREA
GULF OF MEXICO

FUGRO CHANCE INC.

200 Dulles Dr. Lafayette, Louisiana 70506-3001 (337) 237-1500



GEODETTIC DATUM: NAD27
PROJECTION: LOUISIANA SOUTH
GRID UNITS: US SURVEY FEET

SCALE 0 60'
IN FEET

Job No.: 1300640 Date: 3/27/13

Drwn: SJL

Chart: Of:
7 7