

**PROPOSED ACCESS
DREDGING IN
BAYOU CASSMER**
LAT. 29°50'46.69"N
LONG. 91°53'31.33"W

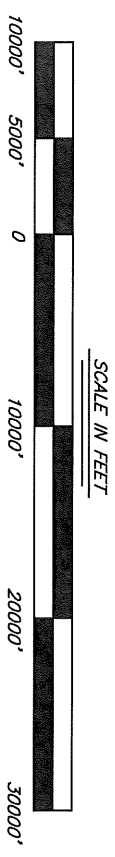

VICINITY MAP

PROJECT IS LOCATED APPROXIMATELY
 3 MILES SOUTHERLY FROM
 AVERY ISLAND, LA

**PURPOSE: PROPOSED ACCESS DREDGING
 FOR SHORELINE MAINTENANCE**



LEONARD CHAUVIN P.E., P.L.S., INC.
CIVIL ENGINEER - LAND SURVEYOR
 627 JACKSON ST. THIBODAUX, LA.

PERMIT PLAT

**PROPOSED MAINTENANCE DREDGING
 SECTIONS 6 AND 7
 LOCATED T14S - R6E
 IBERIA PARISH, LOUISIANA**

APPLICATION BY: MCLHENNY RESOURCES
 DATE: JANUARY 26, 2012

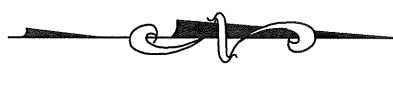

LEGEND:

- EXISTING MARSH
- BANKLINE
- LIMITS OF ACCESS DREDGING
- SPOIL PLACEMENT

LIMITS OF 50' ACCESS CHANNEL
±75' FROM BANKLINE
SEE TYPICAL SECTION
SHEET 3 OF 3

LIMITS OF 50' ACCESS CHANNEL
±75' FROM BANKLINE
SEE TYPICAL SECTION
SHEET 3 OF 3

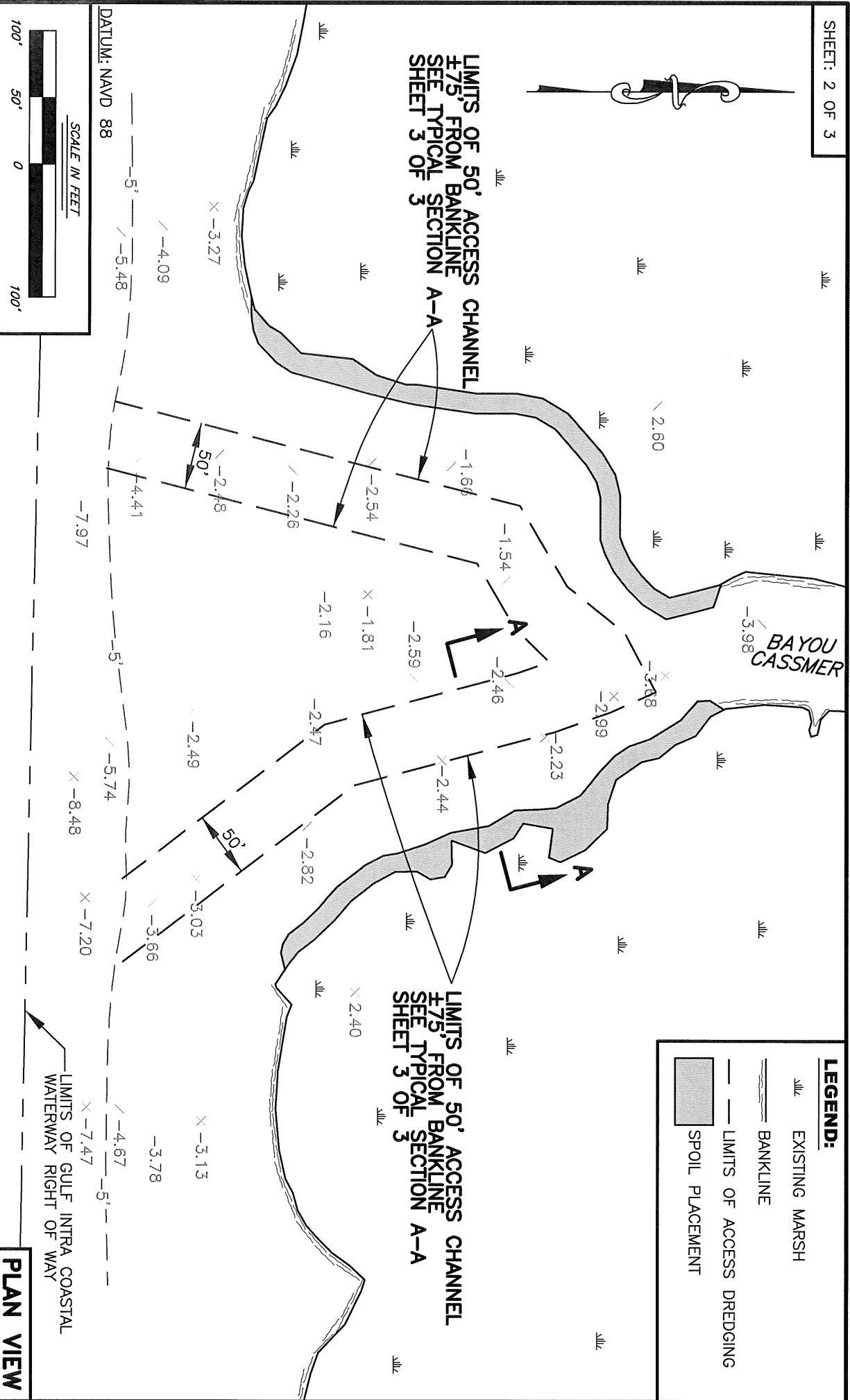

DATUM: NAVD 88

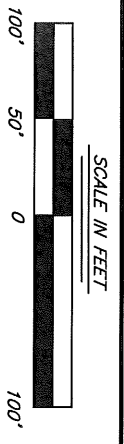

PURPOSE: PROPOSED ACCESS DREDGING
FOR SHORELINE MAINTENANCE

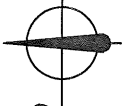

LEONARD CHAUVIN P.E., P.L.S., INC.
CIVIL ENGINEER - LAND SURVEYOR
627 JACKSON ST. THIBODAUX, LA.

PERMIT PLAT

PROPOSED MAINTENANCE DREDGING
SECTIONS 6 AND 7
LOCATED T14S - R6E
IBERIA PARISH, LOUISIANA

APPLICATION BY: MCLHENNY RESOURCES
DATE: JANUARY 26, 2012

PLAN VIEW

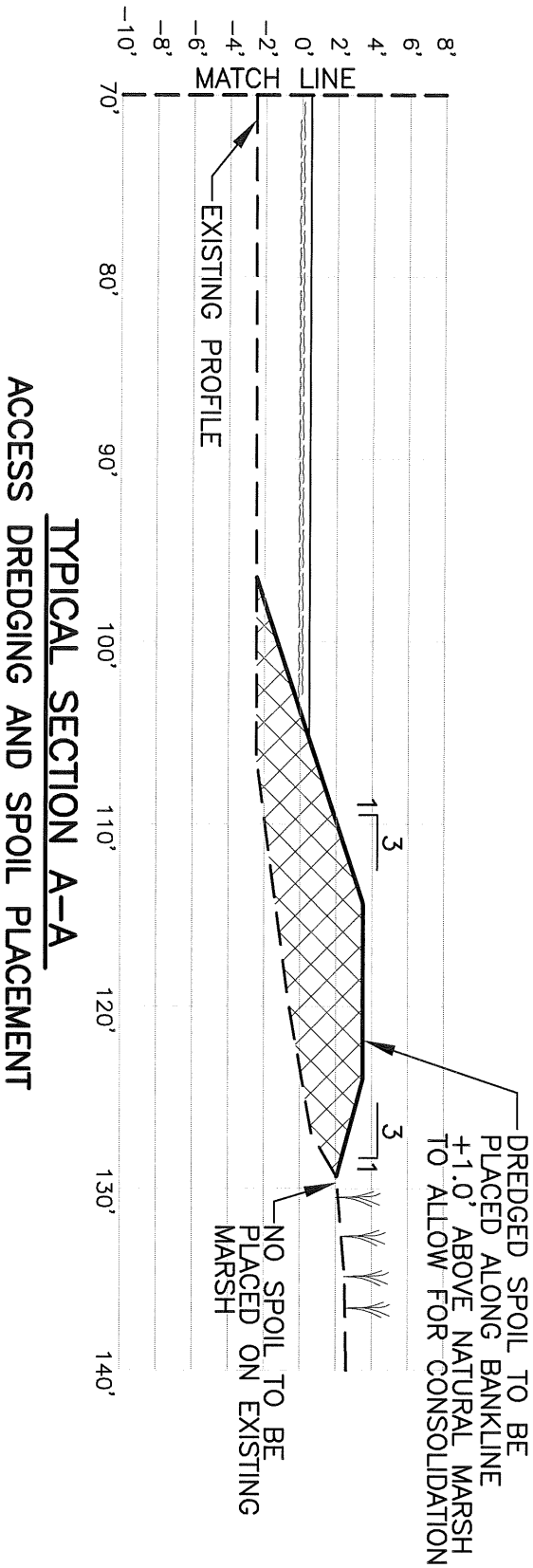
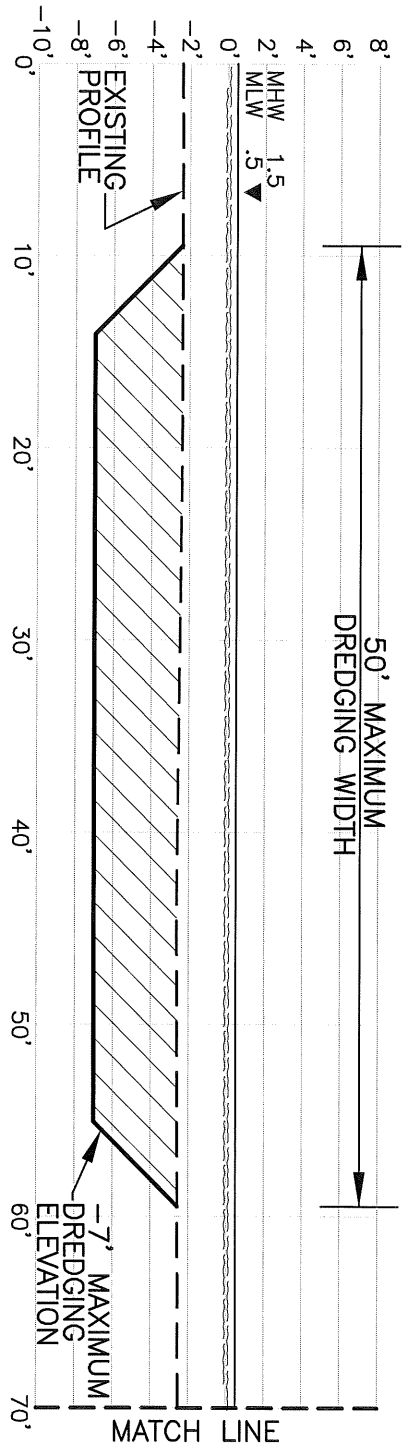

DATUM: NAVD 88
 SCALE: HORIZONTAL SCALE 1" = 10'
 VERTICAL SCALE 1" = 10'

QUANTITIES:
 ACCESS DREDGING VOLUME: 6,385 CUBIC YARDS
 AREA OF WATER BOTTOMS TO BE MAINTAINED: 1.0 ACRES
 SPOIL PLACEMENT ON NON VEGETATED WATER BOTTOMS: .33 ACRES

PURPOSE: PROPOSED ACCESS DREDGING FOR SHORELINE MAINTENANCE

TYPICAL SECTION A-A

PERMIT PLAT

PROPOSED MAINTENANCE DREDGING SECTIONS 6 AND 7 LOCATED T14S - R6E IBERIA PARISH, LOUISIANA



LEONARD CHAUVIN P.E., P.L.S., INC.
 CIVIL ENGINEER - LAND SURVEYOR
 627 JACKSON ST. THIBODAUX, LA.

APPLICATION BY: MCLHENNY RESOURCES
 DATE: JANUARY 26, 2012