

JOINT PUBLIC NOTICE

United States Army
Corps of Engineers
New Orleans District
Regulatory Branch
Post Office Box 60267
New Orleans, Louisiana 70160-0267

January 21, 2014

State of Louisiana
Department of Environmental Quality
ATTN: Water Quality Certifications
Post Office Box 4313
Baton Rouge, Louisiana 70821-4313

(504) 862-1577
Project Manager
Amy Oestringer
Amy.L.Oestringer@usace.army.mil
Permit Application Number
MVN 2013-2864-CL

(225) 219-3225
Project Manager
Jaime Phillippe
WQC Application Number
140116-01

Interested parties are hereby notified that a permit application has been received by the New Orleans District of the U.S. Army Corps of Engineers pursuant to:
[] Section 10 of the Rivers and Harbors Act of March 3, 1899 (30 Stat. 1151; 33 USC 403); and/or
[X] Section 404 of the Clean Water Act (86 Stat. 816; 33 USC 1344).

Application has also been made to the Louisiana Department of Environmental Quality, for a Water Quality Certification (WQC) in accordance with statutory authority contained in LRS30:2047 A(3), and provisions of Section 401 of the Clean Water Act (P.L.95-17).

CLEAR, GRADE AND FILL FOR WALKER APARTMENTS IN LIVINGSTON PARISH

NAME OF APPLICANT: Buzzell & Bryson, LLC, D&S Environmental Services, Inc., Attn: David Temple, Post Office Box 510, French Settlement, Louisiana 70733.

LOCATION OF WORK: 30100 Walker North Road, in Walker, Louisiana, in Livingston Parish, Lake Pontchartrain Basin, Hydrologic Unit Code 08070202, as shown on the enclosed drawings.

CHARACTER OF WORK: Clear, grade, install and maintain fill for the construction of Walker Apartments. The apartment complex will consist of 7 buildings with 168 units, and appurtenant structures. Construction will require the placement of approximately 4,110 cubic yards of fill material to prepare the site for development. This fill placement will impact approximately 1.5 acres of jurisdictional herbaceous wetland habitat, as shown on the attached drawings. The applicant proposes to purchase compensatory mitigation from an approved mitigation bank for all wetland impacts.

The comment period for the Department of the Army Permit and the Louisiana Department of Environmental Quality WQC will close **20 days** from the date of this joint public notice. Written comments, including suggestions for modifications or objections to the proposed work, stating reasons thereof, are being solicited from anyone having interest in this permit and/or this WQC request and must be mailed so as to be received before or by the last day of the comment period. Letters concerning the Corps of Engineers permit application must reference the applicant's name

and the Permit Application Number, and be mailed to the Corps of Engineers at the address above, **ATTENTION: REGULATORY BRANCH**. Individuals or parties may request an extension of time in which to comment on the proposed work by writing or e-mailing the Corps of Engineers Project Manager listed above. Any request must be specific and substantively supportive of the requested extension, and received by this office prior to the end of the initial comment period. The Section Chief will review the request and the requestor will be promptly notified of the decision to grant or deny the request. If granted, the time extension will be continuous to the initial comment period and, inclusive of the initial comment period, will not exceed a total of 30 calendar days. Letters concerning the Water Quality Certification must reference the applicant's name and the WQC Application number and be mailed to the Louisiana Department of Environmental Quality at the address above.

The application for this proposed project is on file with the Louisiana Department of Environmental Quality and may be examined during weekdays between 8:00 a.m. and 4:30 p.m. Copies may be obtained upon payment of costs of reproduction.

Corps of Engineers Permit Criteria

The decision whether to issue a permit will be based on an evaluation of the probable impacts, including cumulative impacts of the proposed activity on the public interest. That decision will reflect the national concern for both protection and utilization of important resources. The benefit which reasonably may be expected to accrue from the proposal must be balanced against its reasonably foreseeable detriments. All factors which may be relevant to the proposal will be considered including the cumulative effects thereof; among those are conservation, economics, aesthetics, general environmental concerns, wetlands, historic properties, fish and wildlife values, flood hazards, floodplain values, land use, navigation, shoreline erosion and accretion, recreation, water supply and conservation, water quality, energy needs, safety, food and fiber production, mineral needs, considerations of property ownership and, in general, the needs and welfare of the people.

The U.S. Army Corps of Engineers is soliciting comments from the public, federal, state, and local agencies and officials, Indian Tribes, and other interested parties in order to consider and evaluate the impacts of this proposed activity. Any comments received will be considered by the U.S. Army Corps of Engineers to determine whether to make, modify, condition, or deny a permit for this proposal. To make this decision, comments are used to assess impacts on endangered species, historic properties, water quality, general environmental effects, and other public interest factors listed above. Comments are used in the preparation of an Environmental Assessment and/or an Environmental Impact Statement pursuant to the National Environmental Policy Act. Comments are also used to determine the need for a public hearing and to determine the overall public interest of the proposed activity.

No properties listed on the National Register of Historic Places are near the proposed work. The possibility exists that the proposed work may damage or destroy presently unknown archeological, scientific, prehistorical, historical sites, or data. Copies of this notice are being sent to the State Archeologist and the State Historic Preservation Officer.

Our initial finding is that the proposed work would neither affect any species listed as endangered by the U.S. Departments of Interior or Commerce, nor affect any habitat designated as critical to the survival and recovery of any endangered species.

This notice initiates the Essential Fish Habitat (EFH) consultation requirements of the Magnuson-Stevens Fishery Conservation and Management Act. The applicant's proposal would result in the destruction or alteration of n/a acres of EFH utilized by various life stages of red drum and penaeid shrimp. Our initial determination is that the proposed action would not have a substantial adverse impact on EFH or federally managed fisheries in the Gulf of Mexico. Our final determination relative to project impacts and the need for mitigation measures is subject to review by and coordination with the National Marine Fisheries Service.

If the proposed work involves deposits of dredged or fill material into navigable waters, the evaluation of the probable impacts will include the application of guidelines established by the Administrator of the Environmental Protection Agency. Also, a certification that the proposed activity will not violate applicable water quality standards will be required from the Department of Environmental Quality, before a permit is issued.

Any person may request, in writing, within the comment period specified in this notice, that a public hearing be held to consider this application. Requests for public hearings shall state, with particularity, the reasons for holding a public hearing.

You are requested to communicate the information contained in this notice to any other parties whom you deem likely to have interest in the matter.

John M. Herman
Chief, Central Evaluation Section

Enclosure

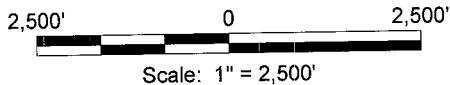
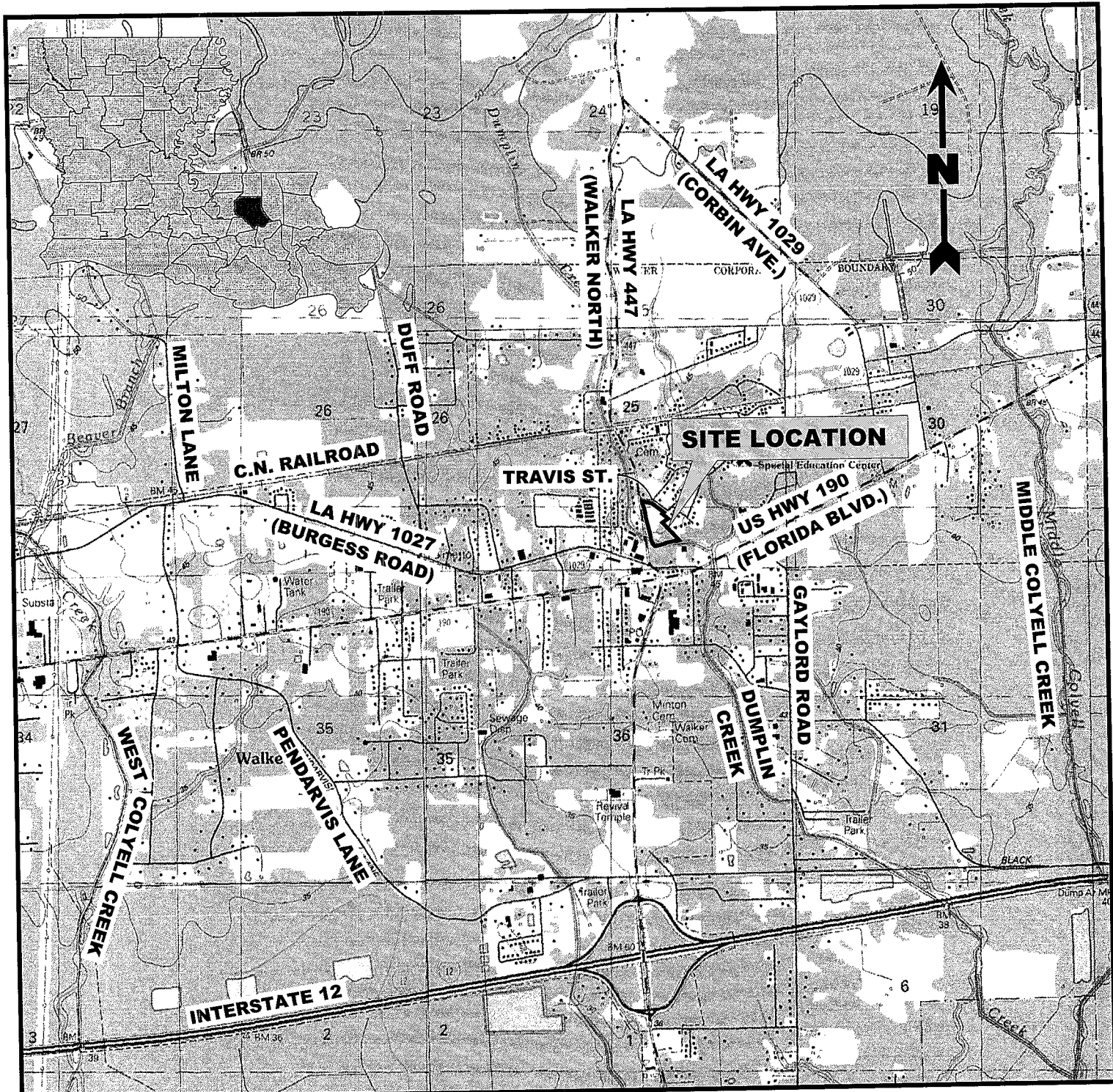

Notes

Property is located in Section 25, T-6-S, R-3-E

Latitude: 30°29'26.75"N · Longitude: 90°51'42.01"W

Reference

Base map comprised of U.S.G.S. 7.5 minute topographic maps "Denham Springs, LA", "Satsuma, LA", "Watson, LA" and "Walker, LA".

Buzzell & Bryson, L.L.C.

Walker Apartments

Vicinity Map

Livingston Parish, Louisiana



**D & S
ENVIRONMENTAL SERVICES, INC.**



Project No.: 30-2013-DOA

Date: 11-09-13

Figure No.: 1

Total Proposed Fill

Approximately 1,193.87 Cubic Yards of Earthen Material.
 Approximately 1,162.65 Cubic Yards of Lime Treated Base.
 Approximately 1,755.30 Cubic Yards of Concrete.

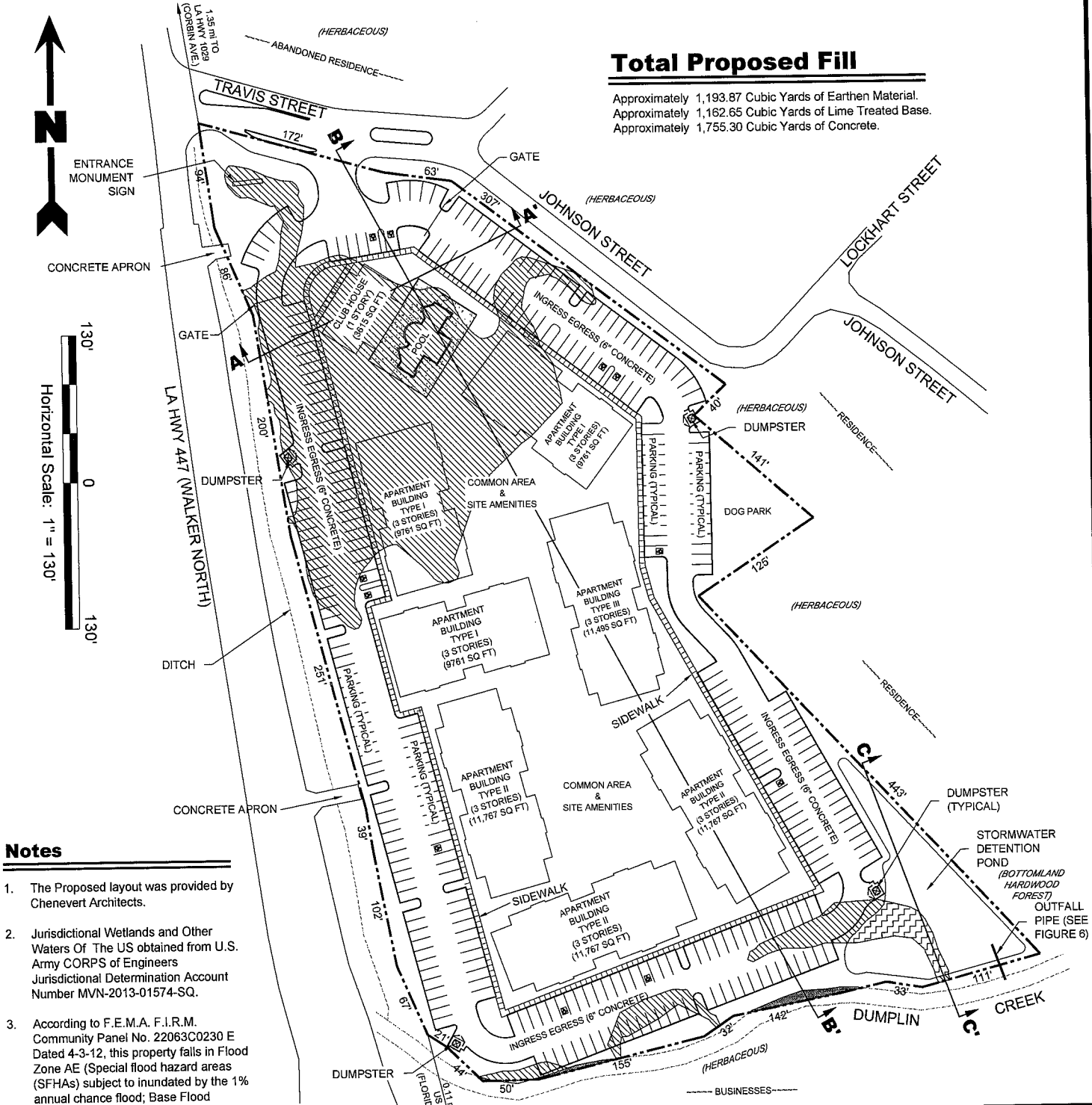

Notes

1. The Proposed layout was provided by Chenevert Architects.
2. Jurisdictional Wetlands and Other Waters Of The US obtained from U.S. Army CORPS of Engineers Jurisdictional Determination Account Number MVN-2013-01574-SQ.
3. According to F.E.M.A. F.I.R.M. Community Panel No. 22063C0230 E Dated 4-3-12, this property falls in Flood Zone AE (Special flood hazard areas (SFHAs) subject to inundated by the 1% annual chance flood; Base Flood Elevations Determined) & Zone X (Areas determined to be outside the 0.2% annual chance floodplain). Base Flood Elevation = 44'.

Legend

- Property Boundary (7.47 Acres)
- Non-Wetlands (5.92 Acres)
- Jurisdictional Wetlands to be Filled (1.48 Acres)
- Jurisdictional Wetlands To Be Excavated (0.05 Acres)
- Other Waters Of The US (0.02 Acres)
- Other Waters Of The US Not To Be Impacted (0.02 Acres)

Buzzell & Bryson, L.L.C.

Walker Apartments

Jurisdictional Wetlands Map



Livingston Parish, Louisiana

D & S
ENVIRONMENTAL SERVICES, INC.

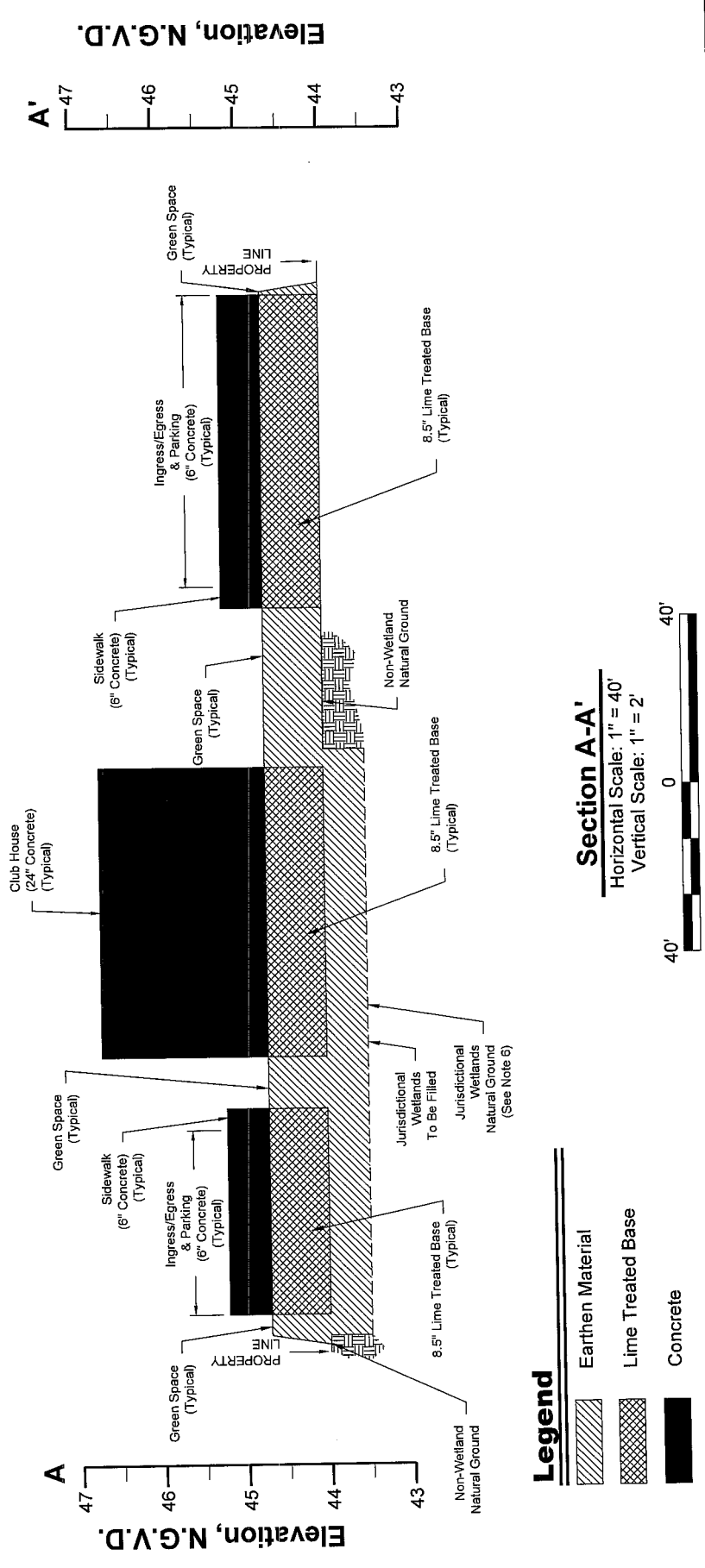
Project. No.: 30-2013-DOA	Date: 11-09-13	Figure No.: 2
---------------------------	----------------	---------------



Legend

-  Earthen Material
-  Lime Treated Base
-  Concrete

Section A-A'

Horizontal Scale: 1" = 40'
 Vertical Scale: 1" = 2'



Notes

1. The proposed layout was provided by Chenevert Architects.
2. Excavated material to be distributed as on-site fill.
3. Jurisdictional Wetlands and Other Waters Of The U.S. obtained from U.S. Army CORPS of Engineers Jurisdictional Determination Account Number MVN-2013-01574-SQ.
4. According to F.E.M.A. F.I.R.M. Community Panel No. 22063C0230 E Dated 4-3-12, this property falls in Flood Zone AE (Special flood hazard areas (SFHAs) subject to inundation by the 1% annual chance flood; Base Flood Elevations Determined) & Zone X (Areas determined to be outside the 0.2% annual chance floodplain). Base Flood Elevation = 44'.
5. Non-wetland natural ground elevations averages 44' N.G.V.D. Elevation data was obtained from topographic data provided by MR Engineering & Surveying, L.L.C..
6. Natural ground in existing jurisdictional wetlands are approximately 6" lower than non-wetland natural ground elevations.

Buzzell & Bryson, L.L.C.

Walker Apartments

Section View A-A'

Livingston Parish, Louisiana

D & S ENVIRONMENTAL SERVICES, INC.



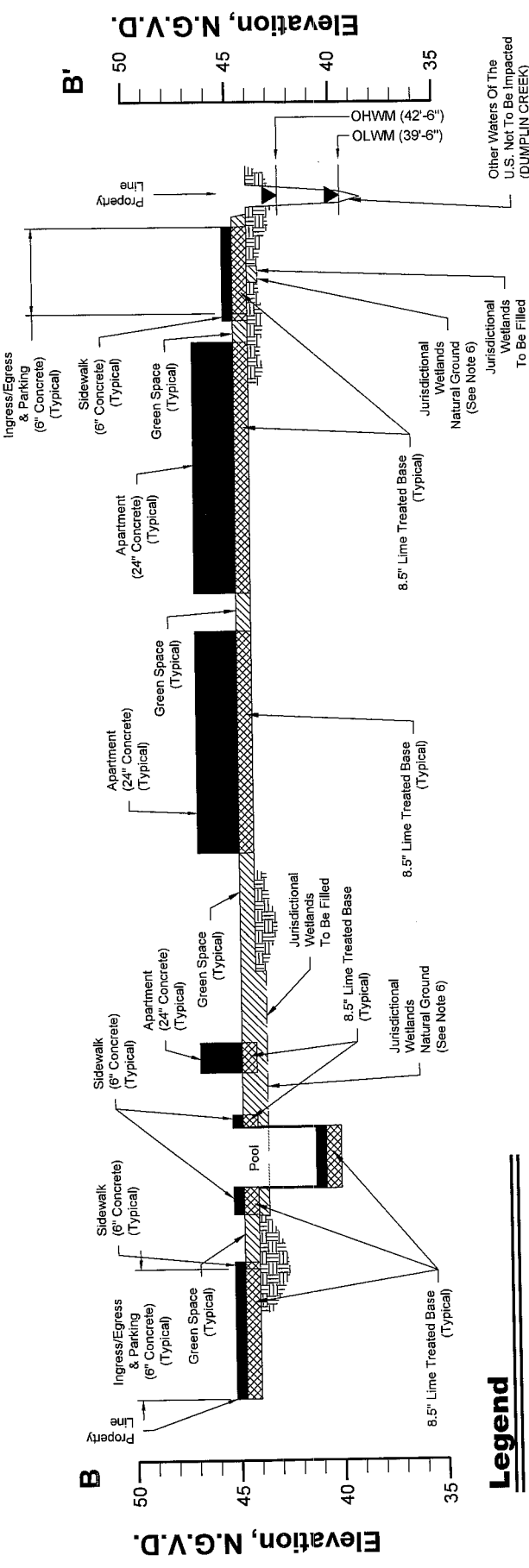

Section B-B'
 Horizontal Scale: 1" = 120'
 Vertical Scale: 1" = 8'

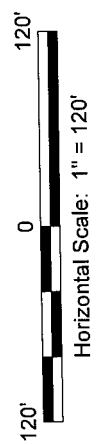

Legend

- Earthen Material
- Lime Treated Base
- Concrete
- Ordinary High Water Mark
- Ordinary Low Water Mark

Notes

1. The proposed layout was provided by Chenevert Architects.
2. Excavated material to be distributed as on-site fill.
3. Jurisdictional Wetlands and Other Waters Of The U.S. obtained from U.S. Army CORPUS of Engineers Jurisdictional Determination Account Number MVN-2013-01574-SQ.
4. According to F.E.M.A. F.I.R.M. Community Panel No. 22063C0230 E Dated 4-3-12, this property falls in Flood Zone AE (Special flood hazard areas (SFHAs) subject to inundation by the 1% annual chance flood; Base Flood Elevations = Determined) & Zone X (Areas determined to be outside the 0.2% annual chance floodplain). Base Flood Elevation = 44'.
5. Non-wetland natural ground elevations averages 44' N.G.V.D. Elevation data was obtained from topographic data provided by MR Engineering & Surveying, L.L.C..
6. Natural ground in existing jurisdictional wetlands are approximately 6" lower than non-wetland natural ground elevations.

Buzzell & Bryson, L.L.C.

Walker Apartments

Section View B-B'

Livingston Parish, Louisiana



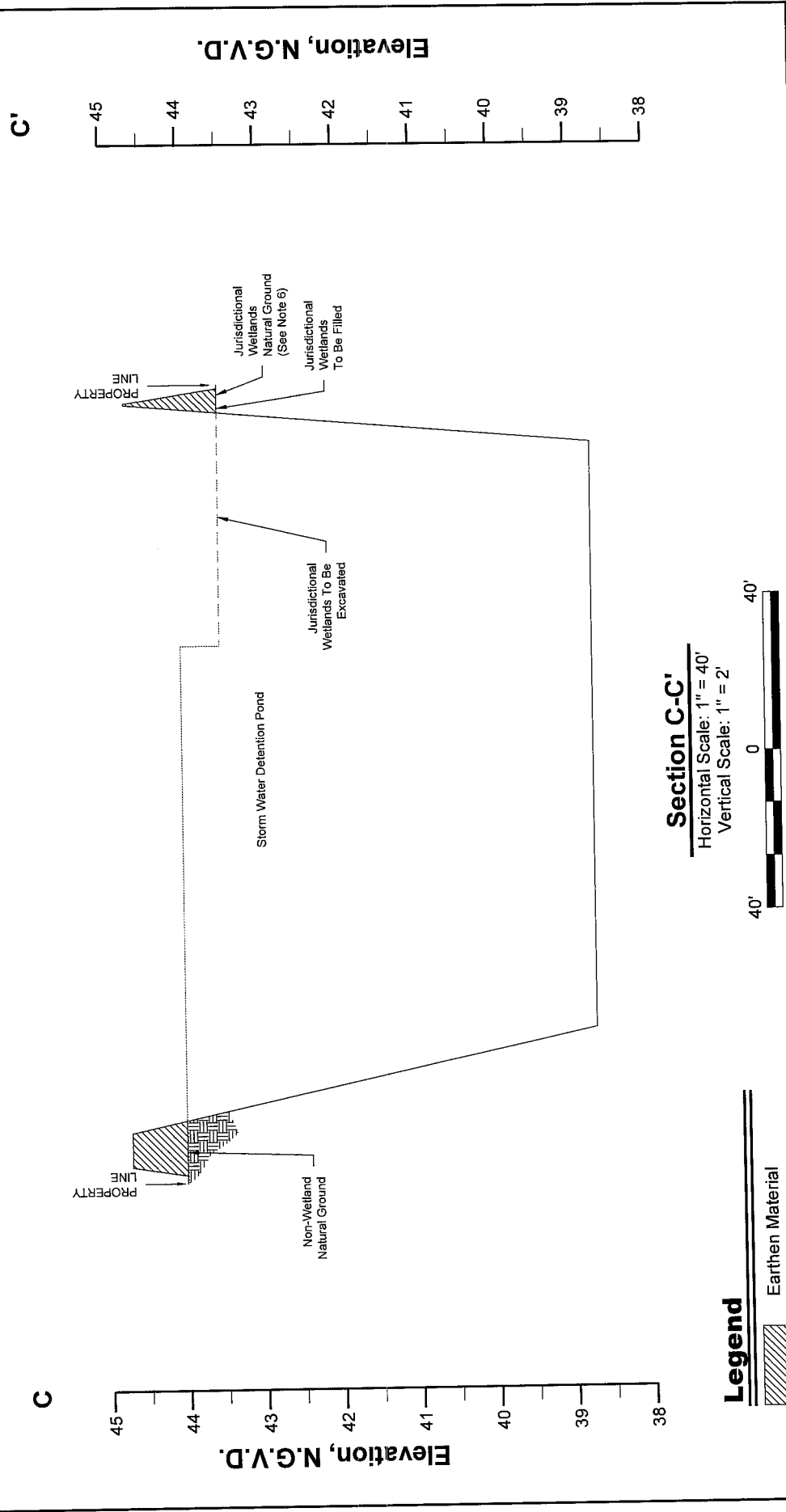

Buzzell & Bryson, L.L.C.

Walker Apartments

Section View C-C'

Livingston Parish, Louisiana

D & S ENVIRONMENTAL SERVICES, INC.

Project No.: 30-2013-DOA Date: 11-09-13 Figure No.: 5

- Legend**
- Earthen Material
- Notes**
1. The proposed layout was provided by Chenevert Architects.
 2. Excavated material to be distributed as on-site fill.
 3. Jurisdictional Wetlands and Other Waters Of The U.S. obtained from U.S. Army CORPS of Engineers Jurisdictional Determination Account Number MVN-2013-01574-SQ.
 4. According to F.E.M.A. F.I.R.M. Community Panel No. 22063C0230 E Dated 4-3-12, this property falls in Flood Zone AE (Special flood hazard areas (SFHAs) subject to inundation by the 1% annual chance flood; Base Flood Elevations Determined) & Zone X (Areas determined to be outside the 0.2% annual chance floodplain). Base Flood Elevation = 44'.
 5. Non-wetland natural ground elevations averages 44' N.G.V.D. Elevation data was obtained from topographic data provided by MR Engineering & Surveying, L.L.C..
 6. Natural ground in existing jurisdictional wetlands are approximately 6" lower than non-wetland natural ground elevations.

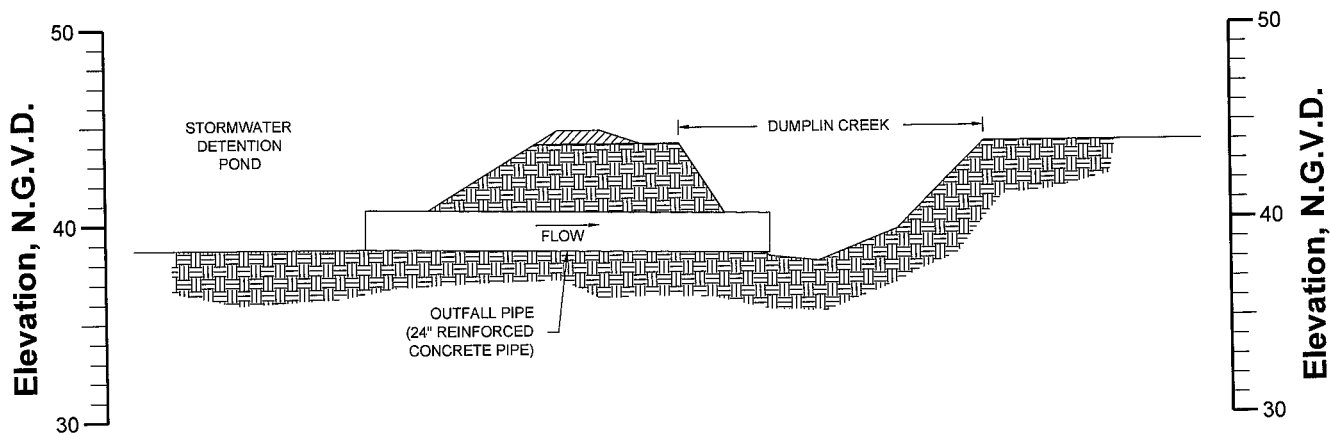
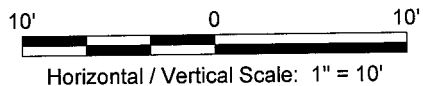

Legend

 Earthen Material

Notes

1. The Proposed layout was provided by Chenevert Architects.
2. Jurisdictional Wetlands and Other Waters Of The US obtained from U.S. Army CORPS of Engineers Jurisdictional Determination Account Number MVN-2013-01574-SQ.
3. According to F.E.M.A. F.I.R.M. Community Panel No. 22063C0230 E Dated 4-3-12, this property falls in Flood Zone AE (Special flood hazard areas (SFHAs) subject to inundated by the 1% annual chance flood; Base Flood Elevations Determined) & Zone X (Areas determined to be outside the 0.2% annual chance floodplain). Base Flood Elevation = 44'.

Buzzell & Bryson, L.L.C.

Walker Apartments

**Stormwater Detention Pond
Outfall Detail**

Livingston Parish, Louisiana

**D & S
ENVIRONMENTAL SERVICES, INC.**

Project No.: 30-2013-DOA

Date: 11-09-13

Figure No.: 6

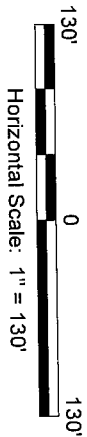

Total Proposed Fill

Approximately 1,193.87 Cubic Yards of Earthen Material.
 Approximately 1,162.65 Cubic Yards of Lime Treated Base.
 Approximately 1,755.30 Cubic Yards of Concrete.

Notes

- The Proposed layout was provided by Chenevert Architects.
- Jurisdictional Wetlands and Other Waters Of The US obtained from U.S. Army CORPS of Engineers Jurisdictional Determination Account Number MVN-2013-01574-SQ.
- According to F.E.M.A. F.I.R.M. Community Panel No. 22063C0230 E Dated 4-3-12, this property falls in Flood Zone AE (Special flood hazard areas (SFHAs) subject to inundation by the 1% annual chance flood; Base Flood Elevations Determined) & Zone X (Areas determined to be outside the 0.2% annual chance floodplain). Base Flood Elevation = 44'.

Legend

- Property Boundary (7.47 Acres)
- Non-Wetlands (5.92 Acres)
- Total Jurisdictional Wetlands (1.53 Acres)
- Jurisdictional Wetlands to be Filled (1.48 Acres)
- Jurisdictional Wetlands To Be Excavated (0.05 Acres)
- Total Other Waters Of The US (0.02 Acres)
- Other Waters Of The US Not To Be Impacted (0.02 Acres)
- Pre-Development Drainage Flow
- Post-Development Drainage Flow

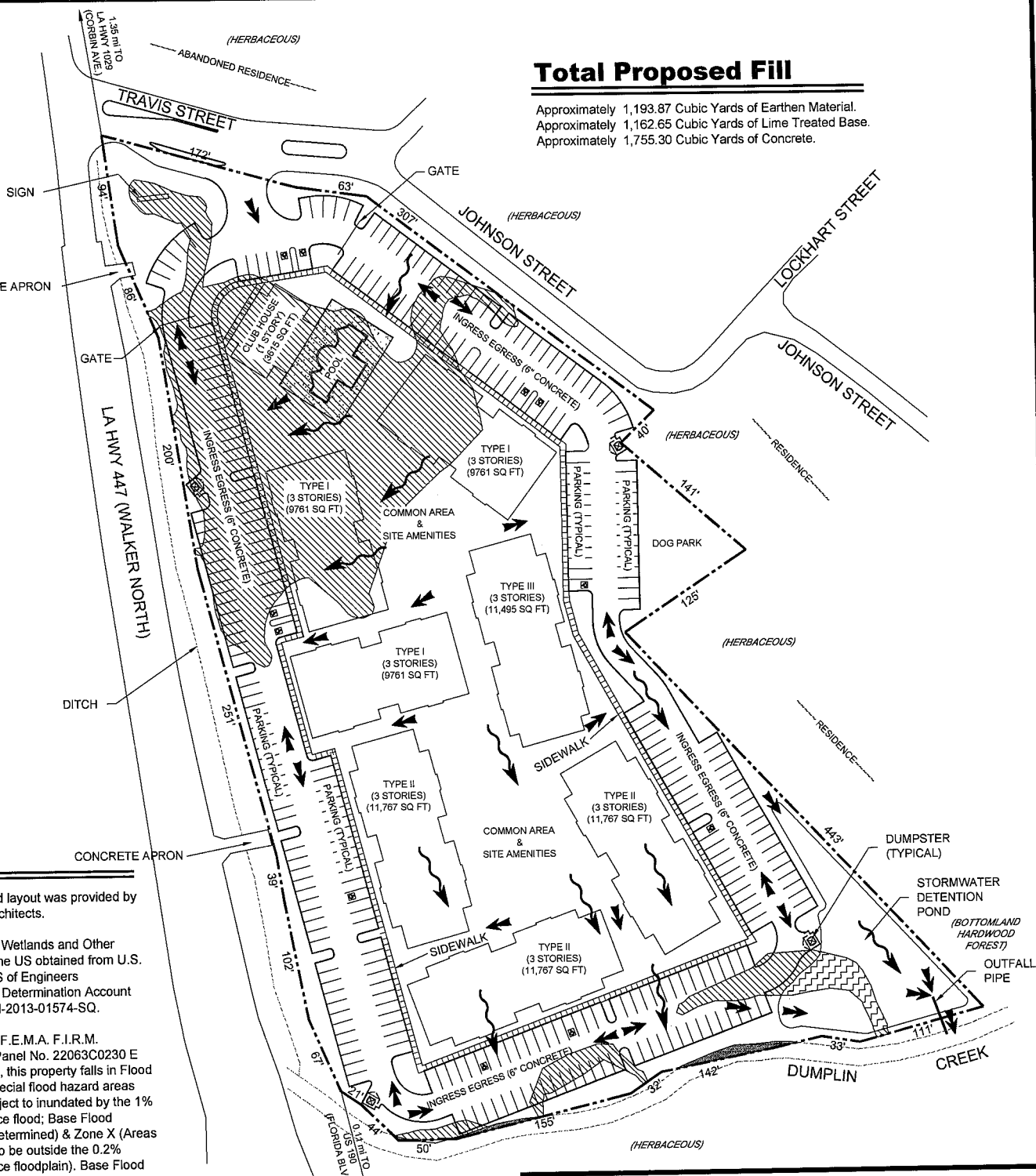

Buzzell & Bryson, L.L.C.

Walker Apartments

Pre-Development / Post Development Drainage Implementation Plan

Livingston Parish, Louisiana

**D & S
ENVIRONMENTAL SERVICES, INC.**

Project No.: 30-2013-DOA

Date: 11-09-13

Figure No.: 7