

# JOINT PUBLIC NOTICE

October 31, 2016

United States Army  
Corps of Engineers  
New Orleans District  
Regulatory Branch  
7400 Leake Avenue  
New Orleans, La. 70118-3651

State of Louisiana  
Department of Environmental Quality  
Post Office Box 4313  
Baton Rouge, La. 70821-4313  
Attn: Water Quality Certifications

(504) 862-2548/ FAX (504) 862-2574  
Project Manager  
Johnny Duplantis  
Permit Application Number  
MVN-2013-02344-WPP

(225) 219-3225/FAX (225) 325-8125  
Project Manager  
Elizabeth Hill  
WQC Application Number  
WQC # 161026-03

Interested parties are hereby notified that a permit application has been received by the New Orleans District of the U.S. Army Corps of Engineers pursuant to: [X] Section 10 of the Rivers and Harbors Act of March 3, 1899 (30 Stat. 1151; 33 USC 403); and/or [X] Section 404 of the Clean Water Act (86 Stat. 816; 33 USC 1344).

Application has also been made to the Louisiana Department of Environmental Quality, for a Water Quality Certification (WQC) in accordance with statutory authority contained in Louisiana Revised Statutes of 1950, Title 30, Chapter 11, Part IV, Section 2074 A(3) and provisions of Section 401 of the Clean Water Act (P.L.95-17).

## **PROPOSED KING'S BAYOU DRAINAGE IMPROVEMENT CAMERON PARISH**

**NAME OF APPLICANT:** Cameron Parish Gravity Drainage District No. 4, LLC, c/o Lonnie G. Harper & Associates, Inc., 2746 Highway 384, Bell City, Louisiana 70630.

**LOCATION:** Centered at Latitude 29.77681, Longitude -93.00851, ending point at Latitude 30.154319, Longitude -93.22354, located near Bell City, in Cameron Parish, Louisiana.

**DESCRIPTION:** Proposed maintenance dredging of existing drainage laterals along Kings Bayou, in order to restore drainage areas that were silted in by previous hurricanes; Rita and Ike. All dredge material would come from existing open water areas, with disposal areas naturally revegetating within one full growing season after completion of work. To minimize impacts to wetlands, disposal material would be placed at no greater than six inches of settled depth. All land based disposal is expected to naturally revegetate within one growing season after completion of work. Permanent negative impacts to wetlands are not expected as part of this project. Approximately 351 acres of wetlands and waters of the US would be temporarily affected by the proposal.

A detailed description of the project is attached to this Public Notice. The applicant proposes to purchase any required mitigation from an approved mitigation bank, to offset any unavoidable losses to wetland functions caused by project implementation.

The comment period for the Department of the Army Permit and the Louisiana Department of Environmental Quality WQC will close **20 days** from the date of this joint public notice. Written comments, including suggestions for modifications or objections to the proposed work, stating reasons thereof, are being solicited from anyone having interest in this permit and/or this WQC request and must be mailed so as to be received before or by the last day of the comment period. Letters concerning the Corps of Engineers permit application must reference the applicant's name and the Permit Application Number, and be mailed to the Corps of Engineers at the address above, **ATTENTION: REGULATORY BRANCH**. Similar letters concerning the Water Quality Certification must reference the applicant's name and the WQC Application number and be mailed to the Louisiana Department of Environmental Quality at the address above.

The application for this proposed project is on file with the Louisiana Department of Environmental Quality and may be examined during weekdays between 8:00 a.m. and 5:00 p.m. Copies may be obtained upon payment of costs of reproduction.

### **Corps of Engineers Permit Criteria**

The decision whether to issue a permit will be based on an evaluation of the probable impacts, including cumulative impacts of the proposed activity on the public interest. That decision will reflect the national concern for both protection and utilization of important resources. The benefit which reasonably may be expected to accrue from the proposal must be balanced against its reasonably foreseeable detriments. All factors which may be relevant to the proposal will be considered including the cumulative effects thereof; among those are conservation, economics, aesthetics, general environmental concerns, wetlands, historic properties, fish and wildlife values, flood hazards, floodplain values, land use, navigation, shoreline erosion and accretion, recreation, water supply and conservation, water quality, energy needs, safety, food and fiber production, mineral needs, considerations of property ownership and, in general, the needs and welfare of the people.

The U.S. Army Corps of Engineers is soliciting comments from the public, federal, state, and local agencies and officials, Indian Tribes, and other interested parties in order to consider and evaluate the impacts of this proposed activity. Any comments received will be considered by the U.S. Army Corps of Engineers to determine whether to make, modify, condition, or deny a permit for this proposal. To make this decision, comments are used to assess impacts on endangered species, historic properties, water quality, general environmental effects, and other public interest factors listed above. Comments are used in the preparation of an Environmental Assessment and/or an Environmental Impact Statement pursuant to the National Environmental Policy Act. Comments are also used to determine the need for a public hearing and to determine the overall public interest of the proposed activity.

The New Orleans District is unaware of properties listed on the National Register of Historic Places near the proposed work. The possibility exists that the proposed work may damage or destroy presently unknown archeological, scientific, prehistorical, historical sites, or data. Issuance of this public notice solicits input from the State Archeologist and State Historic Preservation Officer regarding potential impacts to cultural resources.

Our initial finding is that the proposed work would neither affect any species listed as endangered by the U.S. Departments of Interior or Commerce, nor affect any habitat designated as critical to the survival and recovery of any endangered species. Utilizing Standard Local

Operating Procedure for Endangered Species in Louisiana (SLOPES), dated October 22, 2014, between the U.S. Army Corps of Engineers, New Orleans and U.S. Fish and Wildlife Service, Ecological Services Office, the Corps has determined that the proposed activity would have no effect on any listed species.

This notice initiates the Essential Fish Habitat (EFH) consultation requirements of the Magnuson-Stevens Fishery Conservation and Management Act. The applicant's proposal would result in the destruction or alteration of 351 acre(s) of EFH utilized by various life stages of red drum and penaeid shrimp. Our initial determination is that the proposed action would not have a substantial adverse impact on EFH or federally managed fisheries in the Gulf of Mexico. Our final determination relative to project impacts and the need for mitigation measures is subject to review by and coordination with the National Marine Fisheries Service.

If the proposed work involves deposits of dredged or fill material into navigable waters, the evaluation of the probable impacts will include the application of guidelines established by the Administrator of the Environmental Protection Agency. Also, a certification that the proposed activity will not violate applicable water quality standards will be required from the Department of Environmental Quality, before a permit is issued.

Any person may request, in writing, within the comment period specified in this notice, that a public hearing be held to consider this application. Requests for public hearings shall state, with particularity, the reasons for holding a public hearing.

You are requested to communicate the information contained in this notice to any other parties whom you deem likely to have interest in the matter.

Darrell S. Barbara  
Chief, Western Evaluation Section  
Regulatory Branch

Attachments

NOTE: THESE DRAWINGS ARE TO BE USED EXCLUSIVELY FOR ACQUISITION OF REGULATORY PERMITS.

REVISED: 06/10/2013

**CAMERON PARISH, LOUISIANA**  
SECTIONS 9,16,19,20,21,30,31, T.14S., R.6W.  
SECTIONS 5,6, T.15S., R.6W.

SHEET 01 OF 12

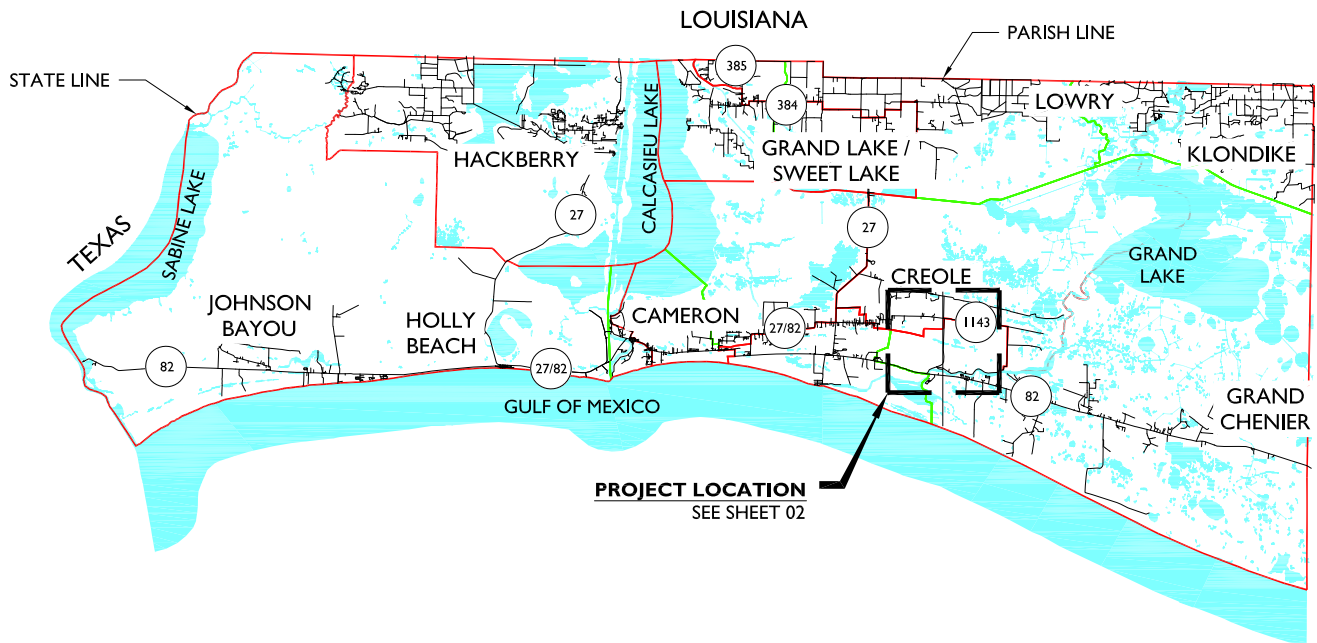
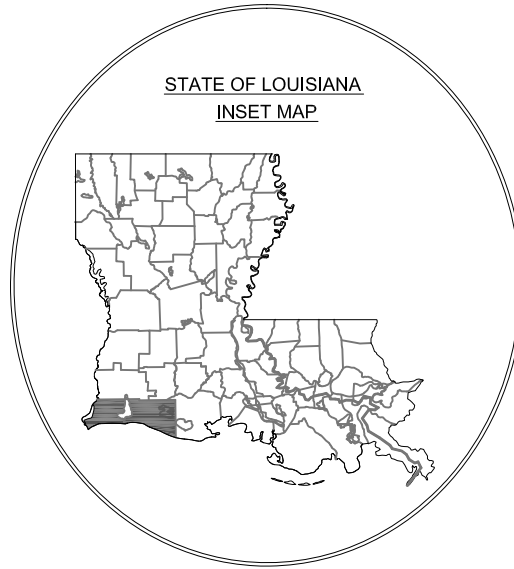

PREPARED BY:



**LONNIE G. HARPER  
& ASSOCIATES, INC.**

2746 HWY. NO. 384 BELL CITY, LOUISIANA 70643  
PHONE: (337) 905-1079 FAX: (337) 905-1076

**CP GRAVITY DISTRICT NO.4**  
**KING'S BAYOU DRAINAGE MAINTENANCE**  
**CAMERON PARISH, LOUISIANA**

APPLICATION BY:  
DATE: 3/22/2013

CAMERON PARISH GRAVITY DISTRICT NO. 4  
CAMERON, CAMERON PARISH, LA

**VICINITY MAP**

DATE: 03/22/2013

SCALE: 1" = 60,000'

NOTE: THESE DRAWINGS ARE TO BE USED EXCLUSIVELY FOR ACQUISITION OF REGULATORY PERMITS.

REVISED: 06/10/2013

**CAMERON PARISH, LOUISIANA**  
**SECTIONS 9,16,19,20,21,30,31, T.14S., R.6W.**  
**SECTIONS 5,6, T.15S., R.6W.**

SHEET 02 OF 12

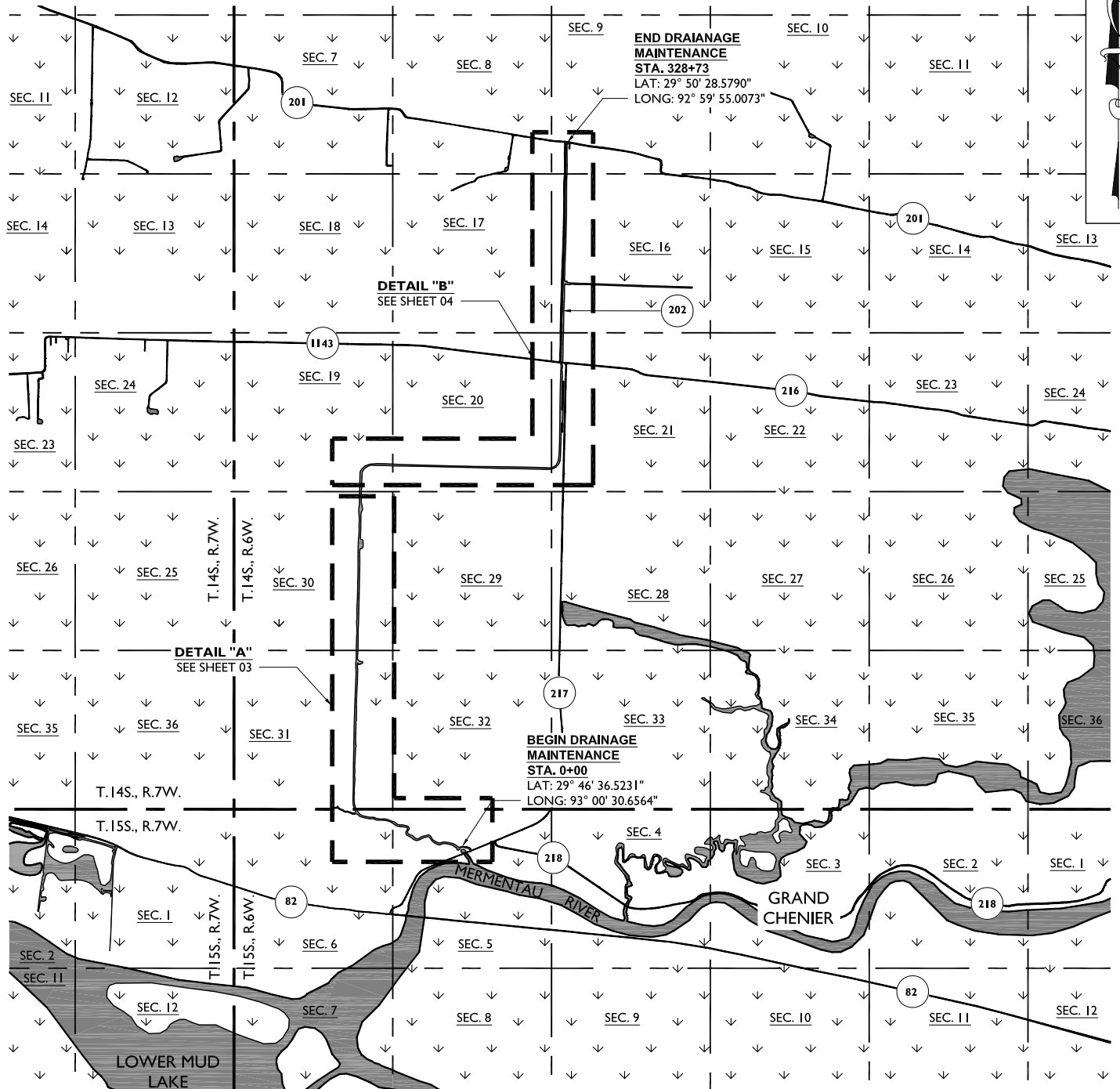

PREPARED BY:



**LONNIE G. HARPER  
& ASSOCIATES, INC.**

2746 HWY. NO. 384 BELL CITY, LOUISIANA 70643  
PHONE: (337) 905-1079 FAX: (337) 905-1076

APPLICATION BY:  
DATE: 3/22/2013

**CP GRAVITY DISTRICT NO.4**  
**KING'S BAYOU DRAINAGE MAINTENANCE**  
**CAMERON PARISH, LOUISIANA**

CAMERON PARISH GRAVITY DISTRICT NO. 4  
CAMERON, CAMERON PARISH, LA

**PROJECT LOCATION**

DATE: 03/19/2013

SCALE: 1" = 5,000'

NOTE: THESE DRAWINGS ARE TO BE USED EXCLUSIVELY FOR ACQUISITION OF REGULATORY PERMITS.

REVISED: 06/10/2013

**CAMERON PARISH, LOUISIANA**  
**SECTIONS 9,16,19,20,21,30,31, T.14S., R.6W.**  
**SECTIONS 5,6, T.15S., R.6W.**

SHEET 03 OF 12

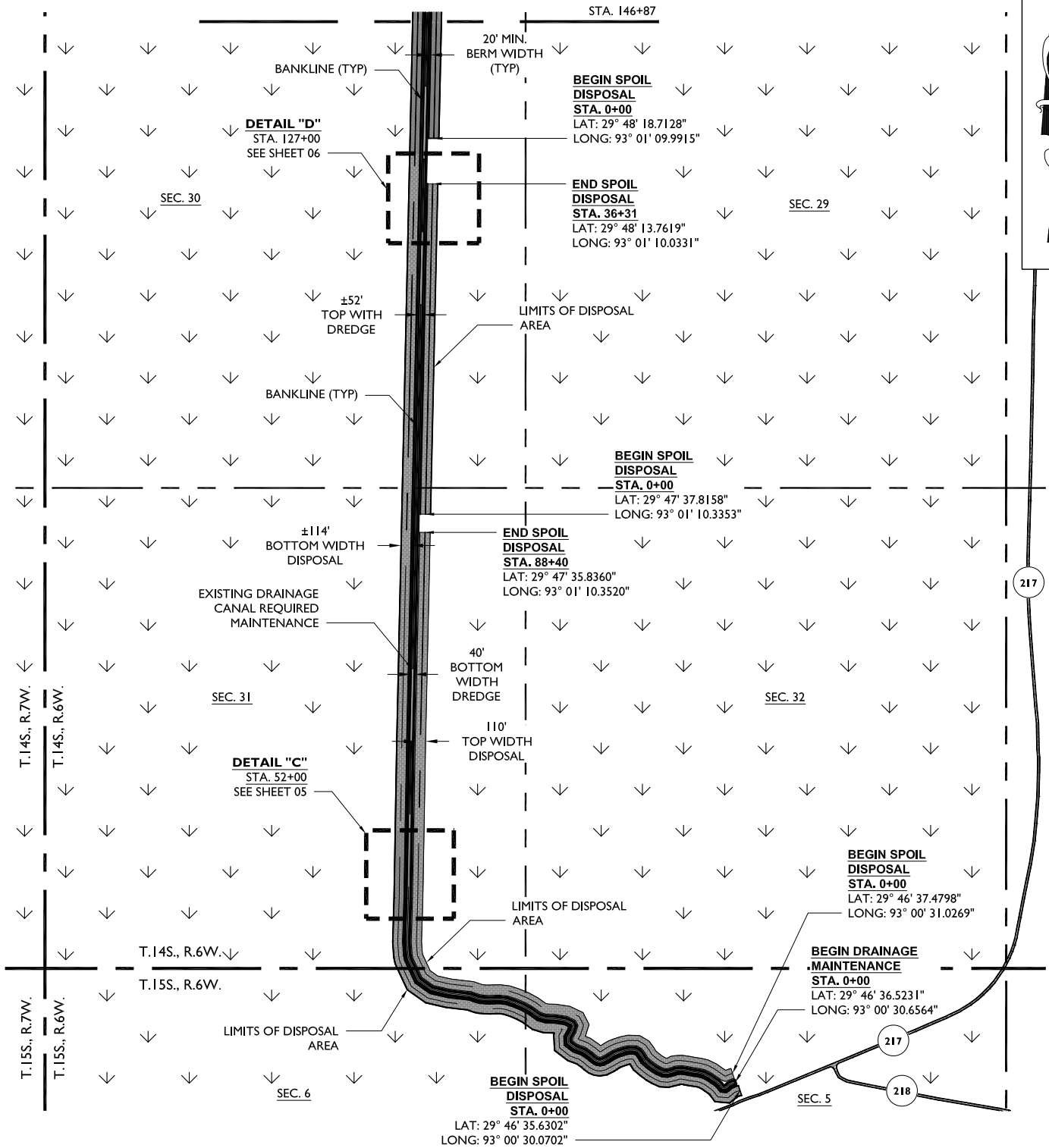

PREPARED BY:



**LONNIE G. HARPER  
& ASSOCIATES, INC.**

2746 HWY. NO. 384 BELL CITY, LOUISIANA 70643  
PHONE: (337) 905-1079 FAX: (337) 905-1076

APPLICATION BY:  
DATE: 3/22/2013

**CP GRAVITY DISTRICT NO.4**  
**KING'S BAYOU DRAINAGE MAINTENANCE**  
**CAMERON PARISH, LOUISIANA**

CAMERON PARISH GRAVITY DISTRICT NO. 4  
CAMERON, CAMERON PARISH, LA

**DETAIL "A"**

DATE: 03/19/2013

SCALE: 1" = 130'

NOTE: THESE DRAWINGS ARE TO BE USED EXCLUSIVELY FOR ACQUISITION OF REGULATORY PERMITS.

REVISED: 06/10/2013

**CAMERON PARISH, LOUISIANA**  
SECTIONS 9,16,19,20,21,30,31, T.14S., R.6W.  
SECTIONS 5,6, T.15S., R.6W.

SHEET 04 OF 12

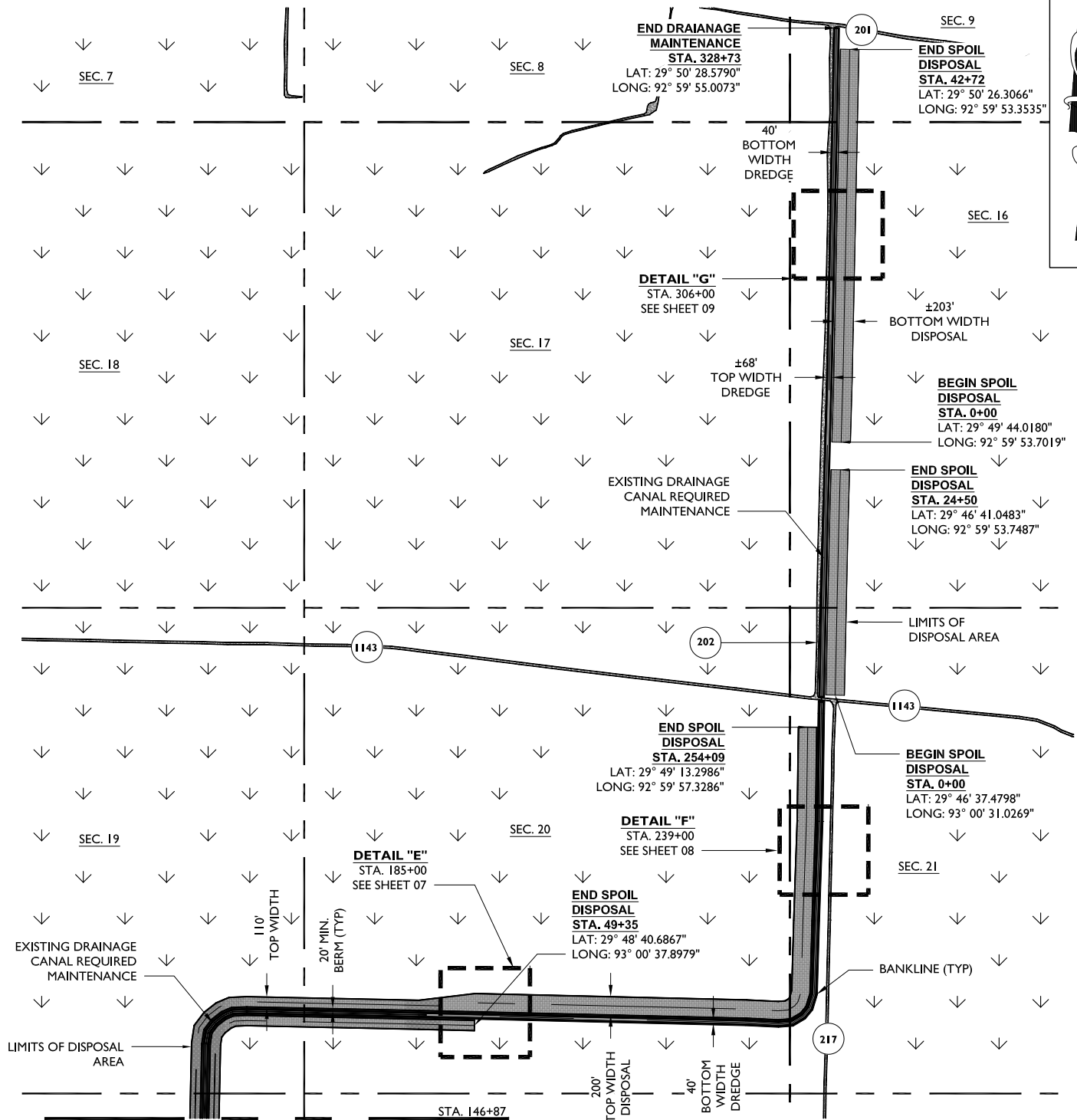

PREPARED BY:



**LONNIE G. HARPER  
& ASSOCIATES, INC.**

2746 HWY. NO. 384 BELL CITY, LOUISIANA 70643  
PHONE: (337) 905-1079 FAX: (337) 905-1076

APPLICATION BY:  
DATE: 3/22/2013

**CP GRAVITY DISTRICT NO.4**  
**KING'S BAYOU DRAINAGE MAINTENANCE**  
**CAMERON PARISH, LOUISIANA**

CAMERON PARISH GRAVITY DISTRICT NO. 4  
CAMERON, CAMERON PARISH, LA

**DETAIL "B"**

DATE: 03/19/2013

SCALE: 1" = 130'

NOTE: THESE DRAWINGS ARE TO BE USED EXCLUSIVELY FOR ACQUISITION OF REGULATORY PERMITS.

REVISED: 06/10/2013

**CAMERON PARISH, LOUISIANA**  
**SECTIONS 9,16,19,20,21,30,31, T.14S., R.6W.**  
**SECTIONS 5,6, T.15S., R.6W.**

SHEET 05 OF 12

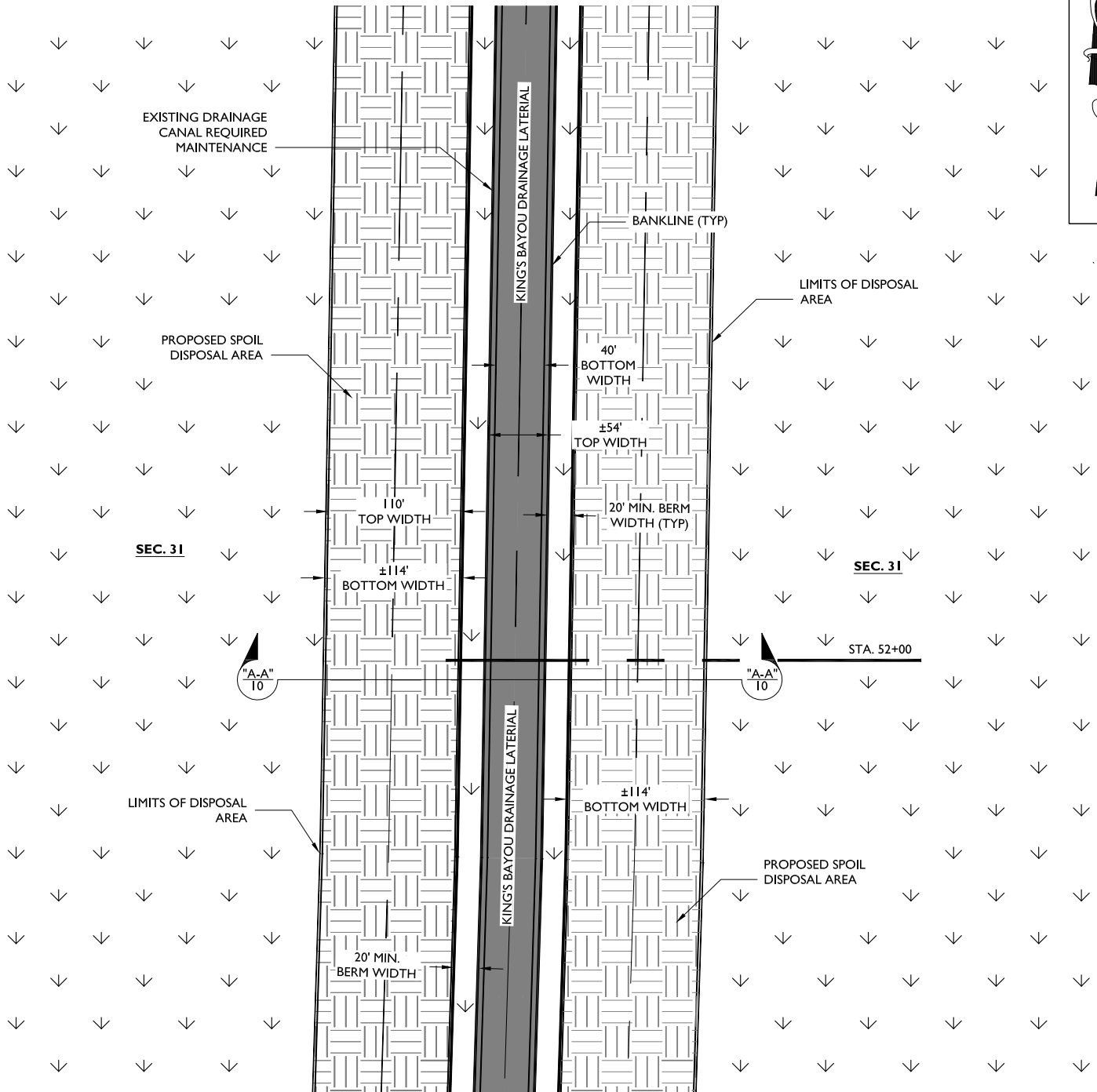

PREPARED BY:



**LONNIE G. HARPER  
& ASSOCIATES, INC.**

2746 HWY. NO. 384 BELL CITY, LOUISIANA 70643  
PHONE: (337) 905-1079 FAX: (337) 905-1076

APPLICATION BY:  
DATE: 3/22/2013

**CP GRAVITY DISTRICT NO.4**  
**KING'S BAYOU DRAINAGE MAINTENANCE**  
**CAMERON PARISH, LOUISIANA**

CAMERON PARISH GRAVITY DISTRICT NO. 4  
CAMERON, CAMERON PARISH, LA

**DETAIL "C"**

DATE: 03/19/2013

SCALE: 1" = 130'



NOTE: THESE DRAWINGS ARE TO BE USED EXCLUSIVELY FOR ACQUISITION OF REGULATORY PERMITS.

REVISED: 06/10/2013

**CAMERON PARISH, LOUISIANA**  
**SECTIONS 9,16,19,20,21,30,31, T.14S., R.6W.**  
**SECTIONS 5,6, T.15S., R.6W.**

SHEET 06 OF 12

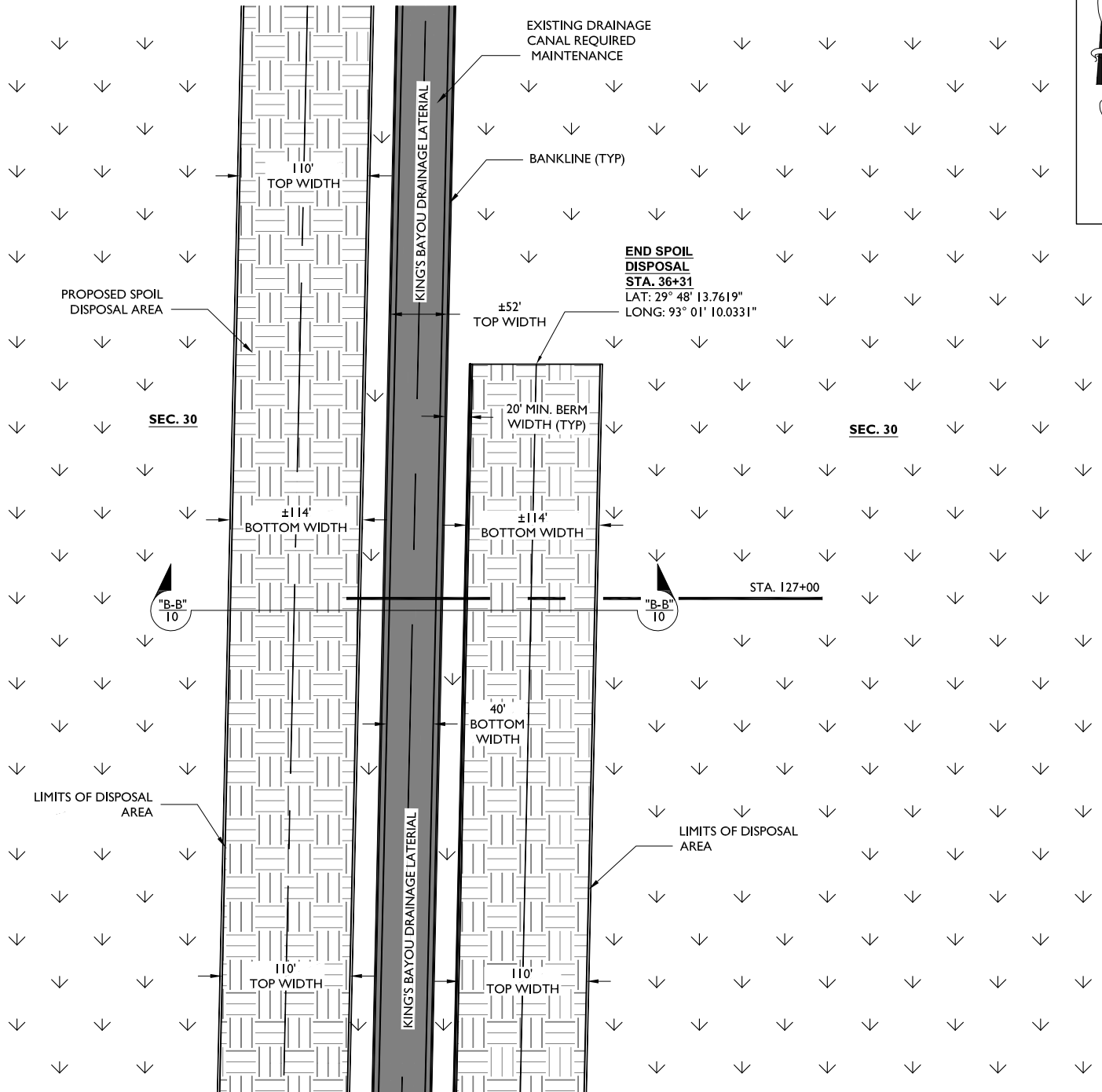

PREPARED BY:



**LONNIE G. HARPER  
& ASSOCIATES, INC.**

2746 HWY. NO. 384 BELL CITY, LOUISIANA 70643  
PHONE: (337) 905-1079 FAX: (337) 905-1076

**CP GRAVITY DISTRICT NO.4**  
**KING'S BAYOU DRAINAGE MAINTENANCE**  
**CAMERON PARISH, LOUISIANA**

APPLICATION BY:  
DATE: 3/22/2013

CAMERON PARISH GRAVITY DISTRICT NO. 4  
CAMERON, CAMERON PARISH, LA

**DETAIL "D"**

DATE: 03/19/2013

SCALE: 1" = 130'

NOTE: THESE DRAWINGS ARE TO BE USED EXCLUSIVELY FOR ACQUISITION OF REGULATORY PERMITS.

REVISED: 06/10/2013

**CAMERON PARISH, LOUISIANA**  
**SECTIONS 9,16,19,20,21,30,31, T.14S., R.6W.**  
**SECTIONS 5,6, T.15S., R.6W.**

SHEET 07 OF 12

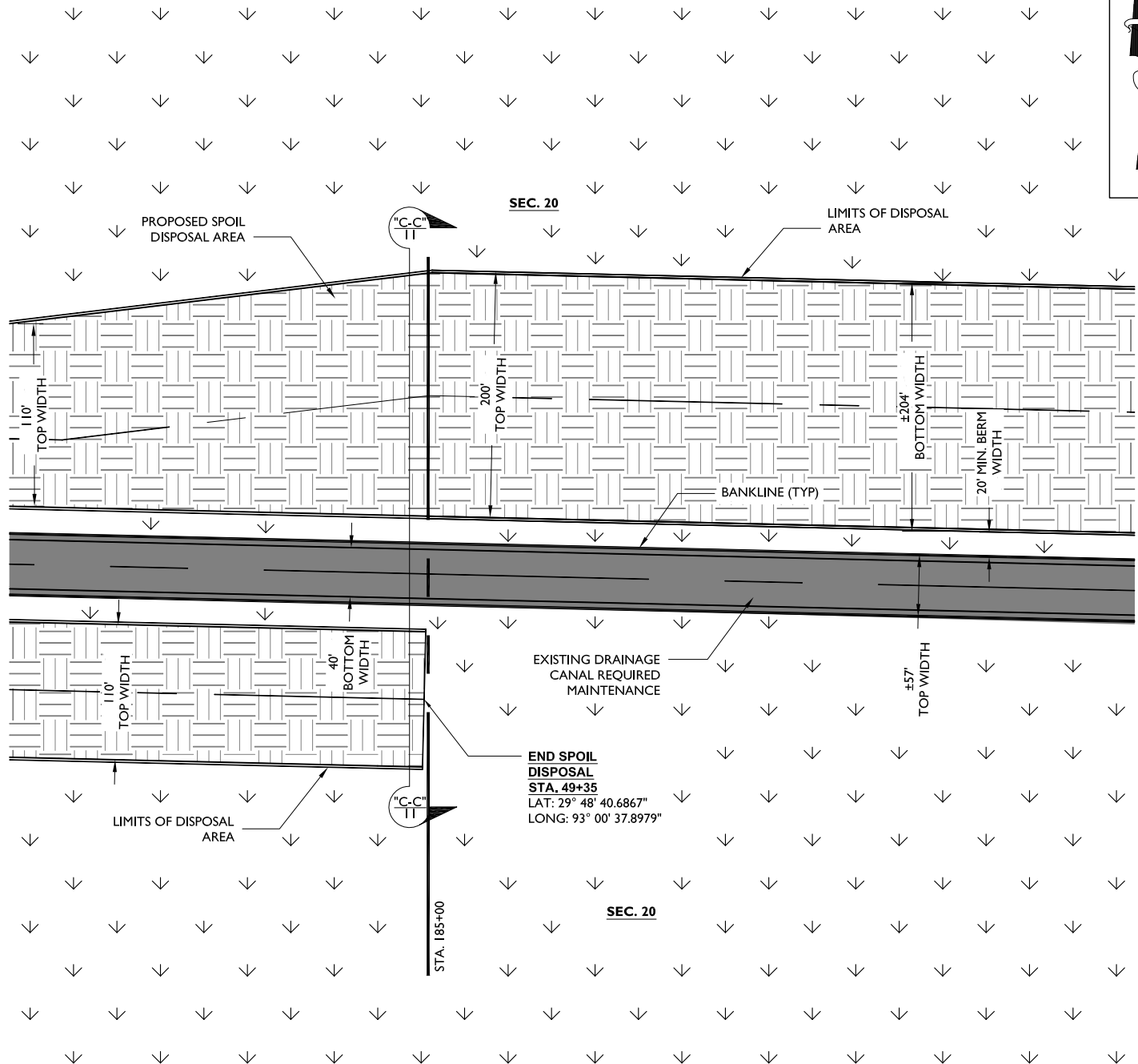

PREPARED BY:



**LONNIE G. HARPER  
& ASSOCIATES, INC.**

2746 HWY. NO. 384 BELL CITY, LOUISIANA 70643  
PHONE: (337) 905-1079 FAX: (337) 905-1076

**CP GRAVITY DISTRICT NO.4**  
**KING'S BAYOU DRAINAGE MAINTENANCE**  
**CAMERON PARISH, LOUISIANA**

APPLICATION BY:  
DATE: 3/22/2013

CAMERON PARISH GRAVITY DISTRICT NO. 4  
CAMERON, CAMERON PARISH, LA

**DETAIL "E"**

DATE: 03/19/2013

SCALE: 1" = 130'

SCALE: 1" = 130'

NOTE: THESE DRAWINGS ARE TO BE USED EXCLUSIVELY FOR ACQUISITION OF REGULATORY PERMITS.

REVISED: 06/10/2013

**CAMERON PARISH, LOUISIANA**  
**SECTIONS 9,16,19,20,21,30,31, T.14S., R.6W.**  
**SECTIONS 5,6, T.15S., R.6W.**

SHEET 09 OF 12

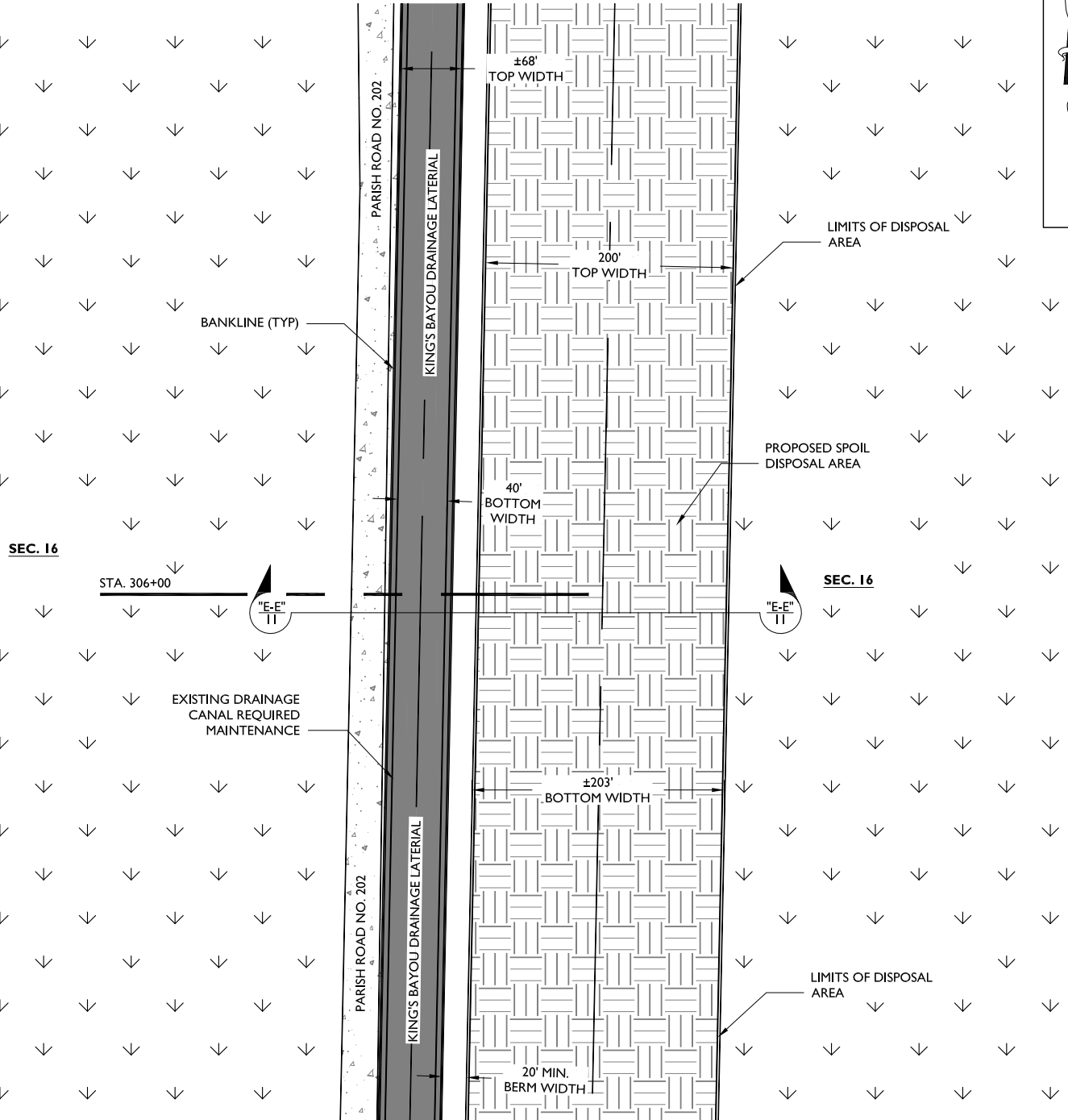

PREPARED BY:



**LONNIE G. HARPER  
& ASSOCIATES, INC.**

2746 HWY. NO. 384 BELL CITY, LOUISIANA 70643  
PHONE: (337) 905-1079 FAX: (337) 905-1076

**CP GRAVITY DISTRICT NO.4**  
**KING'S BAYOU DRAINAGE MAINTENANCE**  
**CAMERON PARISH, LOUISIANA**

APPLICATION BY:  
DATE: 3/22/2013

CAMERON PARISH GRAVITY DISTRICT NO. 4  
CAMERON, CAMERON PARISH, LA

**DETAIL "G"**

DATE: 03/19/2013

SCALE: 1" = 130'

NOTE: THESE DRAWINGS ARE TO BE USED EXCLUSIVELY FOR ACQUISITION OF REGULATORY PERMITS.

REVISED: 06/10/2013

**CAMERON PARISH, LOUISIANA**  
**SECTIONS 9,16,19,20,21,30,31, T.14S., R.6W.**  
**SECTIONS 5,6, T.15S., R.6W.**

SHEET 10 OF 12

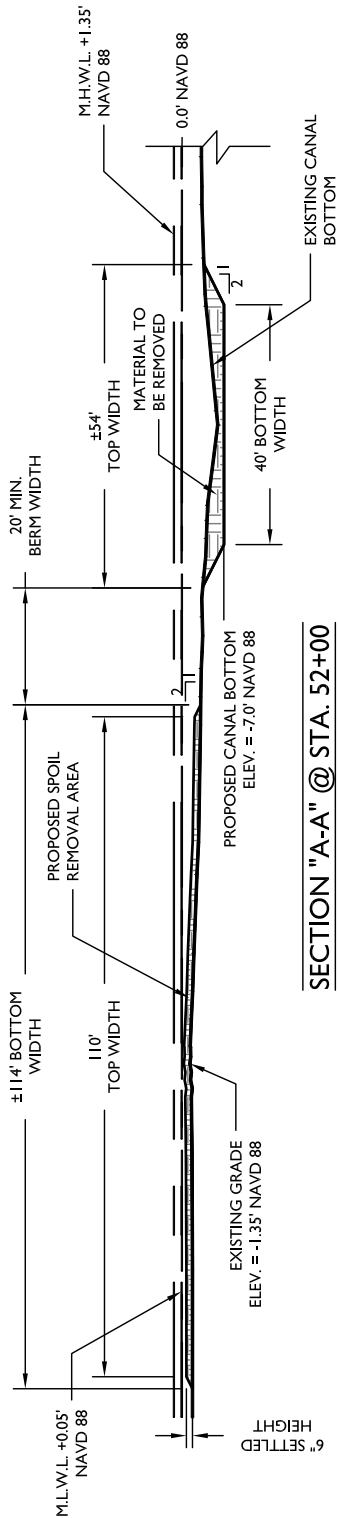

**SECTION "A-A" @ STA. 52+00**

SCALE: 3/8" = 1'-0"

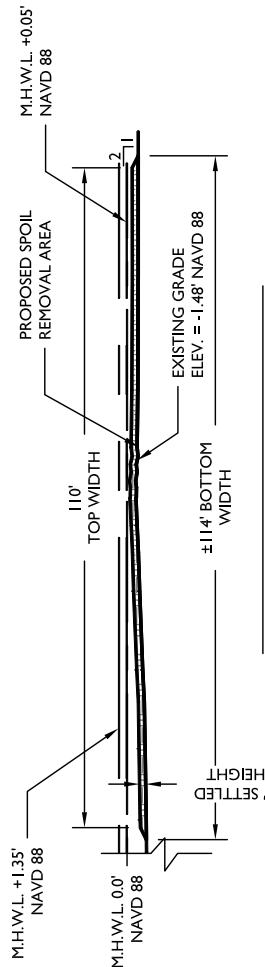

**SECTION "A-A" @ STA. 52+00**

(CONT'D)

SCALE: 3/8" = 1'-0"

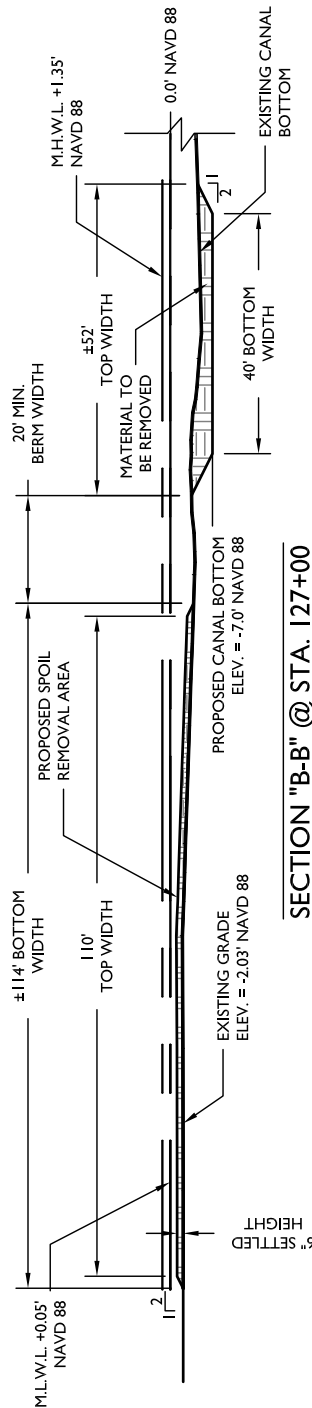

**SECTION "B-B" @ STA. 127+00**

SCALE: 3/8" = 1'-0"

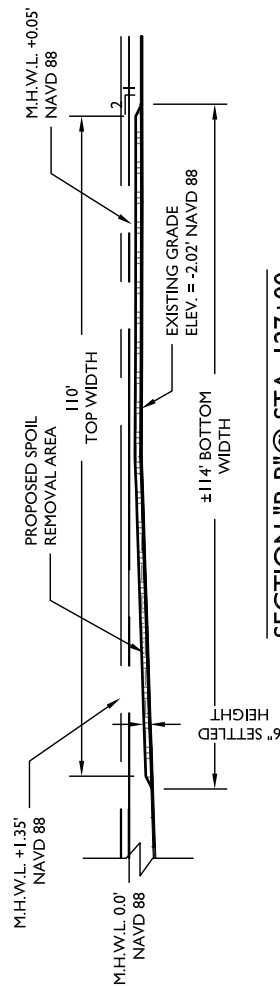

**SECTION "B-B" @ STA. 127+00**

(CONT'D)

SCALE: 3/8" = 1'-0"

PREPARED BY:



**LONNIE G. HARPER  
& ASSOCIATES, INC.**

2746 HWY. NO. 384 BELL CITY, LOUISIANA 70643  
PHONE: (337) 905-1079 FAX: (337) 905-1076

**CP GRAVITY DISTRICT NO.4**  
**KING'S BAYOU DRAINAGE MAINTENANCE**  
**CAMERON PARISH, LOUISIANA**

APPLICATION BY:  
DATE: 3/22/2013

CAMERON PARISH GRAVITY DISTRICT NO. 4  
CAMERON, CAMERON PARISH, LA

**TYPICAL SECTIONS**

DATE: 03/19/2013

SCALE: 3/8" = 1'-0"

NOTE: THESE DRAWINGS ARE TO BE USED EXCLUSIVELY FOR ACQUISITION OF REGULATORY PERMITS.

REVISED: 06/10/2013

**CAMERON PARISH, LOUISIANA**  
SECTIONS 9,16,19,20,21,30,31, T.14S., R.6W.  
SECTIONS 5,6, T.15S., R.6W.

SHEET 11 OF 12

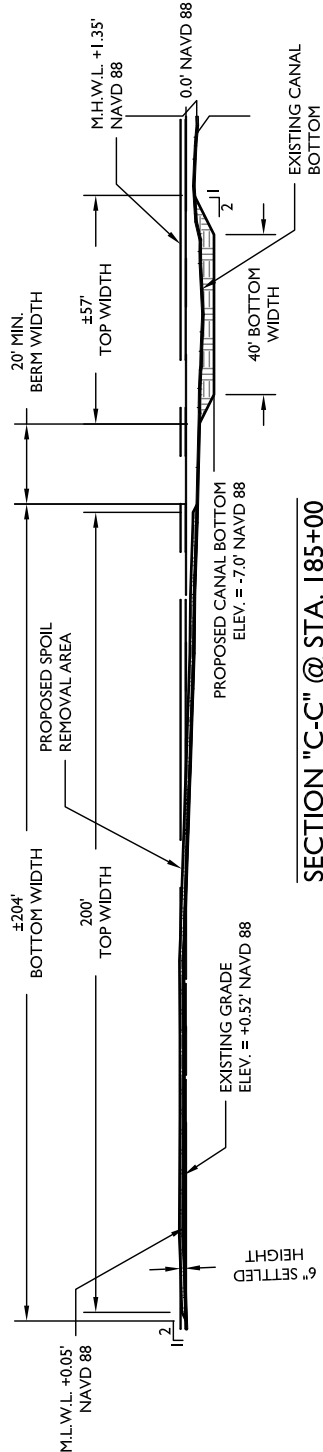

**SECTION "C-C" @ STA. 185+00**

SCALE: 1/4" = 1'-0"

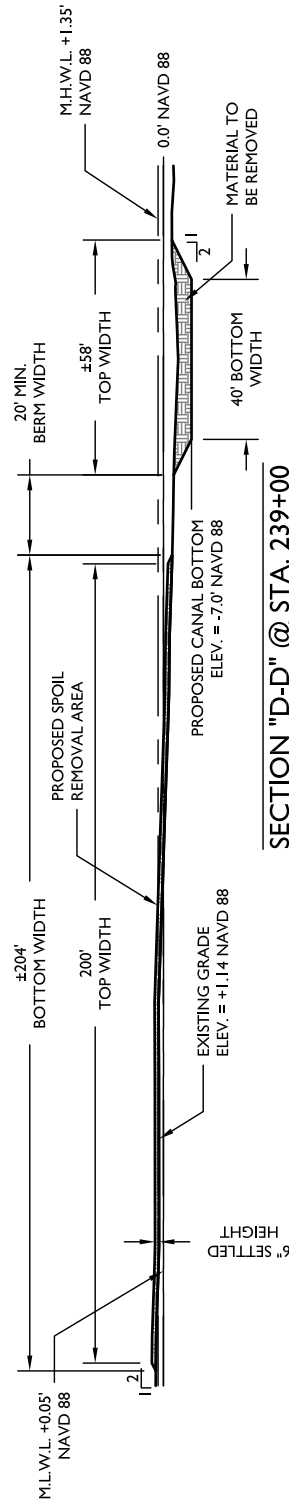

**SECTION "D-D" @ STA. 239+00**

SCALE: 1/4" = 1'-0"

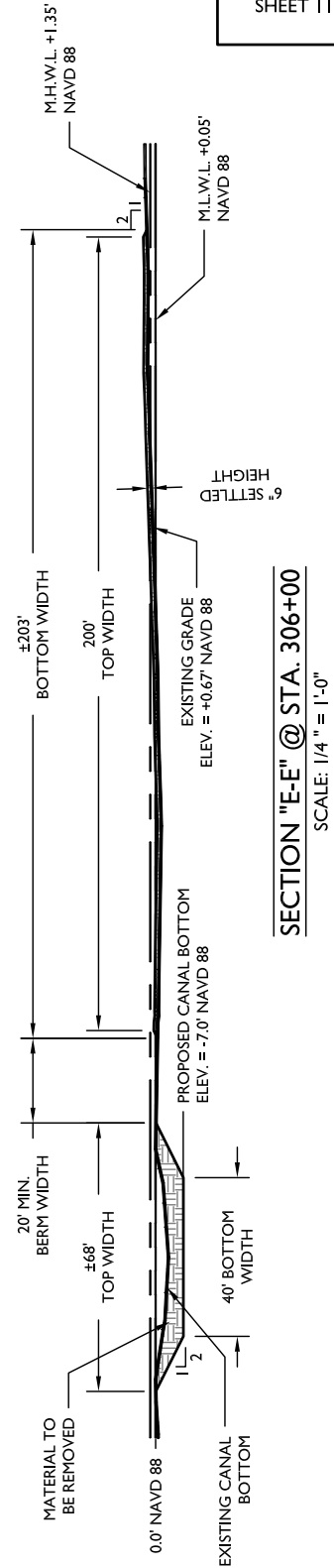

**SECTION "E-E" @ STA. 306+00**

SCALE: 1/4" = 1'-0"

PREPARED BY:



**LONNIE G. HARPER  
& ASSOCIATES, INC.**

2746 HWY. NO. 384 BELL CITY, LOUISIANA 70643  
PHONE: (337) 905-1079 FAX: (337) 905-1076

**CP GRAVITY DISTRICT NO.4**  
KING'S BAYOU DRAINAGE MAINTENANCE  
CAMERON PARISH, LOUISIANA

APPLICATION BY:  
DATE: 3/22/2013

CAMERON PARISH GRAVITY DISTRICT NO. 4  
CAMERON, CAMERON PARISH, LA

**TYPICAL SECTIONS**

DATE: 03/19/2013

SCALE: 1/4" = 1'-0"

NOTE: THESE DRAWINGS ARE TO BE USED EXCLUSIVELY FOR ACQUISITION OF REGULATORY PERMITS.

REVISED: 06/10/2013  
12/04/2013

**CAMERON PARISH, LOUISIANA**  
**SECTIONS 9,16,19,20,21,30,31, T.14S., R.6W.**  
**SECTIONS 5,6, T.15S., R.6W.**

SHEET 12 OF 12

**GENERAL NOTES:**

1. THE APPLICANT REQUESTS AUTHORIZATION TO PERFORM MAINTENANCE DRAINAGE CLEANOUT OF THE KING'S BAYOU DRAINAGE LATERAL AS SHOWN IN THE PERMIT DRAWINGS.
2. APPROXIMATELY 250,000 CUBIC YARDS OF NATIVE MATERIAL WILL BE REMOVED FROM THE EXISTING CHANNELS BY DRAGLINE/LONG STICK HOE AND DEPOSITED IMMEDIATELY INTO THE SPECIFIC DISPOSAL AREAS SHOWN IN THESE PERMIT DRAWINGS.
3. IN ORDER TO INSURE THE SAFETY OF ALL PARTIES, THE PERMITEE WILL CONTACT THE LOUISIANA DOTTIE SYSTEM(1-800-272-3020), A MINIMUM OF 48 HOURS PRIOR TO THE COMMENCEMENT OF ANY ACTIVITY.
4. LAND OWNER LIST ATTACHED.
5. APPLICATION WAS PREVIOUSLY AUTHORIZED UNDER CMS PERMIT NO. P20010122 (MODIFIED) AND COE NO. WO-20-010-1529.
6. ALL MATERIAL WILL BE PLACED NO THICKER THAN SIX INCHES (6") SETTLED THICKNESS ABOVE EXISTING GRADE.

PREPARED BY:



**LONNIE G. HARPER  
& ASSOCIATES, INC.**

2746 HWY. NO. 384 BELL CITY, LOUISIANA 70643  
PHONE: (337) 905-1079 FAX: (337) 905-1076

**CP GRAVITY DISTRICT NO.4**  
**KING'S BAYOU DRAINAGE MAINTENANCE**  
**CAMERON PARISH, LOUISIANA**

APPLICATION BY: CAMERON PARISH GRAVITY DISTRICT NO. 4  
DATE: 3/22/2013 CAMERON, CAMERON PARISH, LA

**NOTES**

DATE: 03/19/2013

SCALE: AS NOTED