

JOINT PUBLIC NOTICE

November 20, 2017

United States Army
Corps of Engineers
New Orleans District
Regulatory Branch
7400 Leake Avenue
New Orleans, Louisiana 70118

State of Louisiana
Department of Environmental Quality
Office of Environmental Services
Post Office Box 4313
Baton Rouge, Louisiana 70821-4313

(504) 862-1217
Project Manager
Kenny Blanke
Kenneth.G.Blanke@usace.army.mil
MVN 2017-0963-CQ

(225) 219-3225
Project Manager
Ms. Elizabeth Hill
WQC Application Number
WQC 171115-03

Interested parties are hereby notified that a permit application has been received by the New Orleans District of the U.S. Army Corps of Engineers pursuant to: [] Section 10 of the Rivers and Harbors Act of March 3, 1899 (30 Stat. 1151; 33 USC 403); and/or [X] Section 404 of the Clean Water Act (86 Stat. 816; 33 USC 1344).

Application has also been made to the Louisiana Department of Environmental Quality, Office of Environmental Services, for a Water Quality Certification (WQC) in accordance with statutory authority contained in LRS30:2074 A(3), and provisions of Section 401 of the Clean Water Act (P.L.95-17).

ASSISTED LIVING FACILITY IN LIVINGSTON PARISH

NAME OF APPLICANT: Plantation Management, LLC, c/o Hydrik Wetlands Consultants, Attn: Michael Henry, 2323 LA Highway 190 East, Suite 2, Hammond, Louisiana 70401.

LOCATION OF WORK: Located on an approximate 18-acre site, in Section 25, Township 6 South, Range 2 East, along North Range Avenue (LA Highway 16), north of Centerville Street (LA Highway 1032), near Denham Springs, Louisiana, located in Livingston Parish, as shown on the enclosed drawings (Latitude 30.494271 N Longitude -90.958035 W). This project is located in the Pontchartrain Basin (Amite River HUC 08070202).

CHARACTER OF WORK: The applicant is requesting a Department of the Army permit authorization to clear, grade, excavate, place and maintain fill material for the construction of an assisted living facility (Harvest Manor Assisted Living Facility), near Denham Springs, Louisiana, within Livingston Parish. The proposed development would include an approximate 171-bed assisted living facility, a maintenance facility, parking areas, roadways, drainage and utilities, the construction of four onsite detention ponds, and other appurtenances. Approximately 25,000 cubic yards of native material would be excavated as a result of pond construction and placed as fill in jurisdictional areas during project construction. Approximately 1.15 acres of jurisdictional wetlands would be directly impacted as a result of project implementation. Approximately 0.04 acre of jurisdictional Other Waters of the United States (OWOUS) would be excavated and 0.087 acre OWOUS would be filled and rerouted. Approximately 0.17 acre of OWOUS will be avoided and not directly impacted. The applicant has claimed that the project has been designed to avoid and minimize direct and secondary adverse wetland impacts to the maximum extent practicable. The applicant is proposing to utilize best management practices during and after the construction phase of the project. The applicant is proposing to

compensate for the unavoidable impact by purchasing mitigation credits from an approved mitigation bank.

The comment period for the Department of Army Permit and the Louisiana Department of Environmental Quality will close in **20 days** from the date of this joint public notice. Written comments, including suggestions for modifications or objections to the proposed work, stating reasons thereof, are being solicited from anyone having interest in this permit and/or this WQC request and must be mailed so as to be received before or by the last day of the comment period. Letters concerning the Corps of Engineers permit application must reference the applicant's name and the Permit Application Number, and be mailed to the Corps of Engineers at the address above, **ATTENTION: REGULATORY BRANCH**. Similar letters concerning the Water Quality Certification must reference the applicant's name and the WQC application number and be mailed to the Louisiana Department of Environmental Quality at the address above. Individuals or parties may request an extension of time in which to comment on the proposed work by writing or e-mailing the Corps of Engineers Project Manager listed above. Any request must be specific and substantively supportive of the requested extension, and received by this office prior to the end of the initial comment period. The Section Chief will review the request and the requestor will be promptly notified of the decision to grant or deny the request. If granted, the time extension will be continuous to the initial comment period and, inclusive of the initial comment period, will not exceed a total of 30 calendar days.

The application for this proposed project is on file with the Louisiana Department of Environmental Quality and may be examined during weekdays between 8:00 a.m. and 4:30 p.m. Copies may be obtained upon payment of costs of reproduction.

Corps of Engineers Permit Criteria

The decision whether to issue a permit will be based on an evaluation of the probable impacts, including cumulative impacts of the proposed activity on the public interest. That decision will reflect the national concern for both protection and utilization of important resources. The benefit which reasonably may be expected to accrue from the proposal must be balanced against its reasonably foreseeable detriments. All factors which may be relevant to the proposal will be considered including the cumulative effects thereof; among those are conservation, economics, aesthetics, general environmental concerns, wetlands, historic properties, fish and wildlife values, flood hazards, floodplain values, land use, navigation, shoreline erosion and accretion, recreation, water supply and conservation, water quality, energy needs, safety, food and fiber production, mineral needs, considerations of property ownership and, in general, the needs and welfare of the people.

The US Army Corps of Engineers is soliciting comments from the public, federal, state, and local agencies and officials, Indian Tribes, and other interested parties in order to consider and evaluate the impacts of this proposed activity. Any comments received will be considered by the US Army Corps of Engineers to determine whether to make, modify, condition, or deny a permit for this proposal. To make this decision, comments are used to assess impacts on endangered species, historic properties, water quality, general environmental effects, and other public interest factors listed above. Comments are used in the preparation of an Environmental Assessment and/or an Environmental Impact Statement pursuant to the National Environmental Policy Act. Comments are also used to determine the need for a public hearing and to determine the overall public interest of the proposed activity.

The New Orleans District is unaware of properties listed on the National Register of Historic Places near the proposed work. The possibility exists that the proposed work may damage or destroy presently unknown archeological, scientific, prehistorical, historical sites, or data. Copies of this notice are being sent to the State Archeologist and State Historic Preservation Officer.

Our initial finding is that the proposed work would neither affect any species listed as endangered by the U.S. Departments of Interior or Commerce, nor affect any habitat designated as critical to the survival and recovery of any endangered species. Utilizing Standard Local Operating Procedure for Endangered Species in Louisiana (SLOPES), dated October 22, 2014, between the U.S. Army Corps of Engineers, New Orleans and U.S. Fish and Wildlife Service, Ecological Services Office, the Corps has determined that the proposed activity would have no effect on any listed species.

This notice initiates the Essential Fish Habitat (EFH) consultation requirements of the Magnuson-Stevens Fishery Conservation and Management Act. The applicant's proposal would result in the destruction or alteration of 0 acres of EFH utilized by various life stages of red drum and penaeid shrimp. Our initial determination is that the proposed action would not have a substantial adverse impact on EFH or federally managed fisheries in the Gulf of Mexico. Our final determination relative to project impacts and the need for mitigation measures is subject to review by and coordination with the National Marine Fisheries Service.

If the proposed work involves deposits of dredged or fill material into navigable waters, the evaluation of the probable impacts will include the application of guidelines established by the Administrator of the Environmental Protection Agency. Also, a certification that the proposed activity will not violate applicable water quality standards will be required from the Department of Environmental Quality, Office of Environmental Services, before a permit is issued.

Any person may request, in writing, within the comment period specified in this notice, that a public hearing be held to consider this application. Requests for public hearings shall state, with particularity, the reasons for holding a public hearing. You are requested to communicate the information contained in this notice to any other parties whom you deem likely to have interest in the matter.

for JOHN M. HERMAN
Chief, Central Evaluation Section
Regulatory Branch

Enclosure

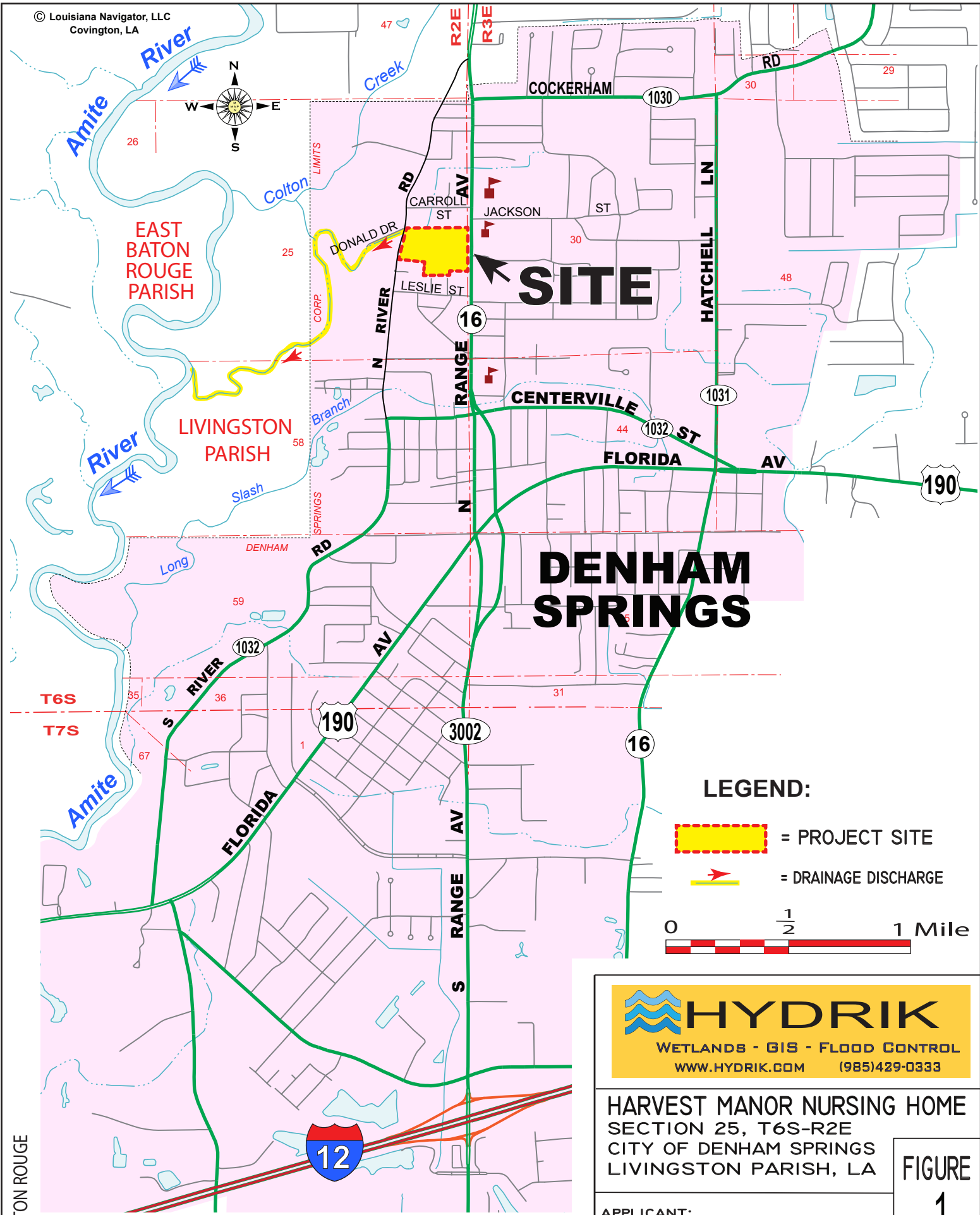

TO BATON ROUGE

SITE COORDINATES
30.494271 N, 90.958035 W

 **HYDRIK**
WETLANDS - GIS - FLOOD CONTROL
WWW.HYDRIK.COM (985)429-0333

HARVEST MANOR NURSING HOME
SECTION 25, T6S-R2E
CITY OF DENHAM SPRINGS
LIVINGSTON PARISH, LA

FIGURE
1

APPLICANT:
PLANTATION MANAGEMENT
HF: 1781BC | DATE: 8-20-2017 | APPROVED:

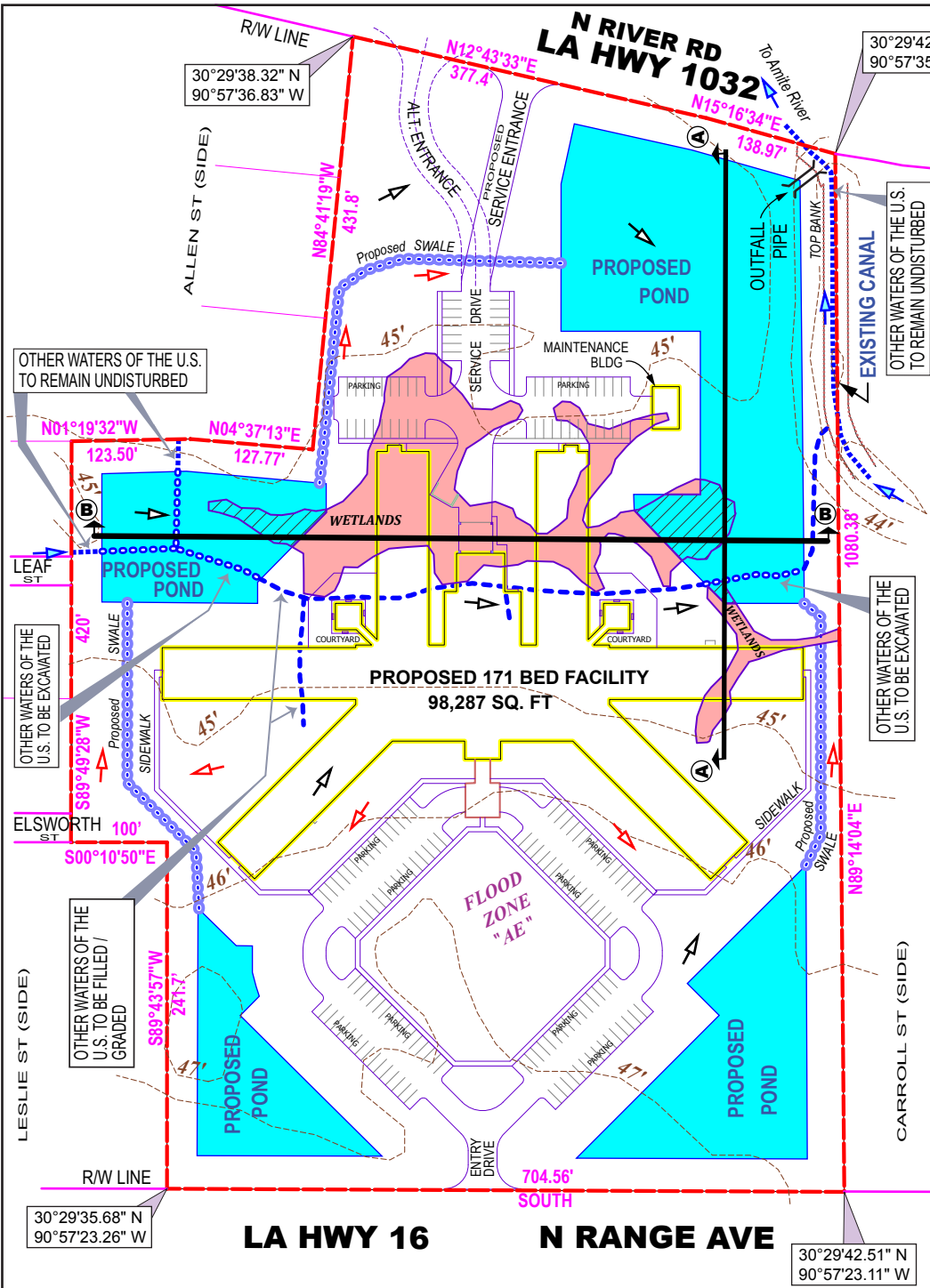

LEGEND:

- 56' --- ELEVATION / LINE
- - - - - DEVELOPMENT BOUNDARY
- ZONE --- FLOOD ZONE / TRANSITION LINE
- DRAINAGE FLOW - PRE DEVELOPMENT
- DRAINAGE FLOW - POST DEVELOPMENT
- ||| OUTFALL PIPE: 24" x 20FT
- TOP BANK OF CANAL
- ▭ PROPOSED STRUCTURE

OTHER WATERS OF THE U.S.

- TO REMAIN - UNDISTURBED = 354 LIN. FT / 0.17 AC
- - - - - TO BE FILLED / RELOCATED = 761 LIN. FT / 0.087 AC
- TO BE EXCAVATED = 356 LIN. FT / 0.04 AC
- NEW O.W.U.S. (REROUTED) = 1073 LIN. FT / 0.12 AC

POND AREAS = 3.79 ACRES
 VOLUME OF MATERIAL TO BE EXCAVATED: 57,300 CU. YDS.

TOTAL WETLANDS = 1.15 ACRES

- WETLANDS TO BE IMPACTED VIA FILLING & GRADING = 0.97 AC
- WETLANDS TO BE IMPACTED VIA EXCAVATION = 0.18 AC

PROJECT DATA

PROJECT AREA = 17.89 ACRES
 BUILDING AREA = 98,287 SQ. FT.

THIS SITE IS LOCATED IN FLOOD ZONE "AE" PER FEMA FLOOD INSURANCE RATE MAP NUMBER: 22063C 0205E, DATED 4-03-2012. BASE FLOOD ELEV. = 48.5'

FIGURE 2

HARVEST MANOR NURSING HOME
 SECTION 25, T6S-R2E
 CITY OF DENHAM SPRINGS
 LIVINGSTON PARISH, LA

HYDRIK
 WETLANDS - GIS - FLOOD CONTROL
 WWW.HYDRIK.COM (985)429-0333

APPLICANT:
PLANTATION MANAGEMENT

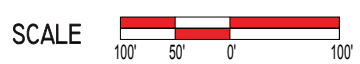

PLEASE NOTE: MAP DATA IS FOR REFERENCE ONLY. THIS IS NOT A LEGAL SURVEY AND SHOULD NOT BE USED AS SUCH.

HF: 1781BC | DATE: 8-20-2017 | APPROVED:

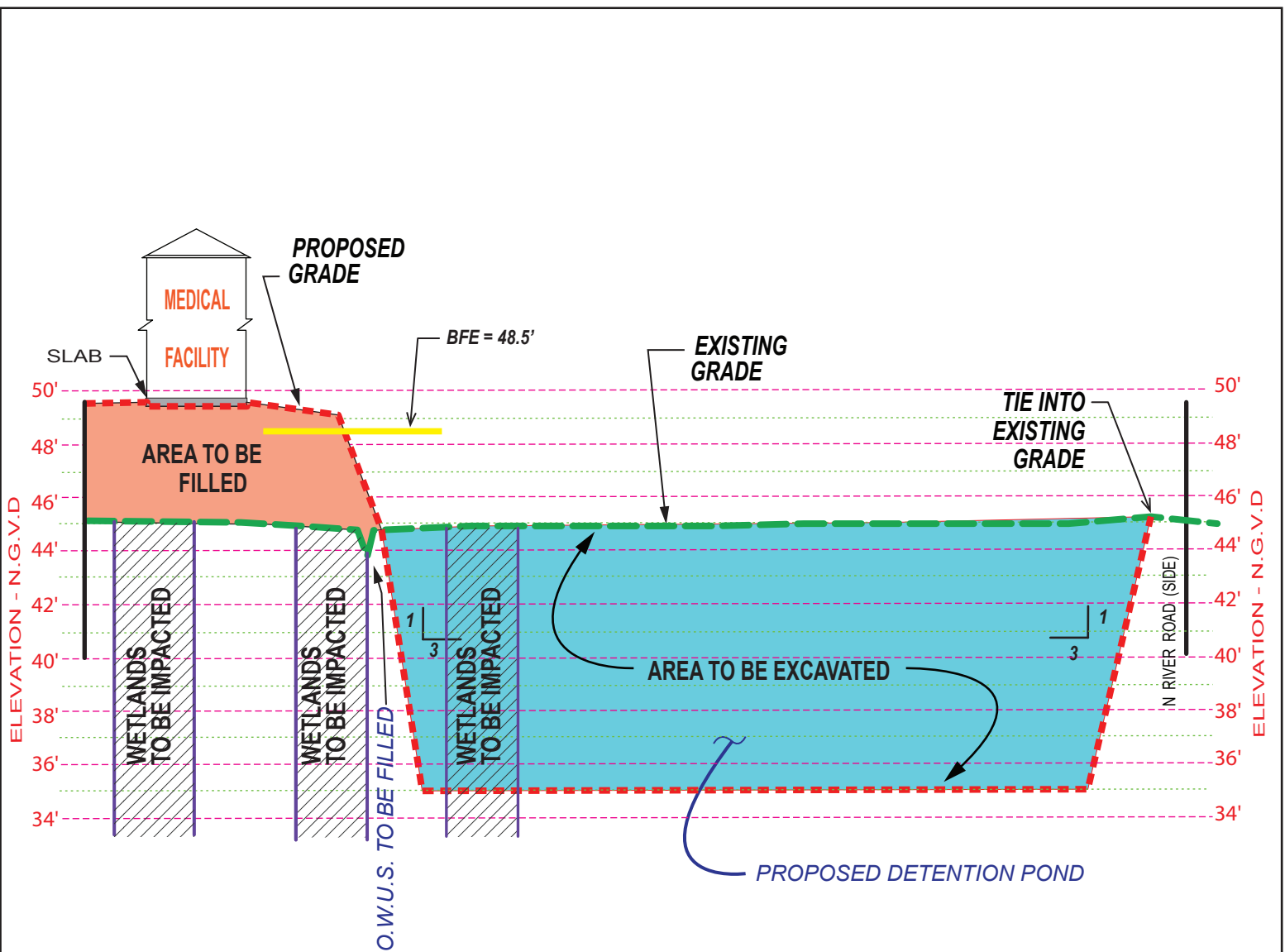

SECTION A-A
PROFILE VIEW

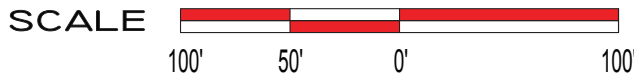

- LEGEND:**
- EXISTING GRADE
 - PROPOSED GRADE
 - AREA TO BE FILLED / GRADED
 - PROPOSED CONCRETE
 - WETLANDS IMPACTED
 - AREA TO BE EXCAVATED

APPLICANT:
PLANTATION MANAGEMENT

FIGURE 3

HARVEST MANOR NURSING HOME
SECTION 25, T6S-R2E
CITY OF DENHAM SPRINGS
LIVINGSTON PARISH, LA



HYDRIK
WETLANDS - GIS - FLOOD CONTROL
WWW.HYDRIK.COM (985)429-0333

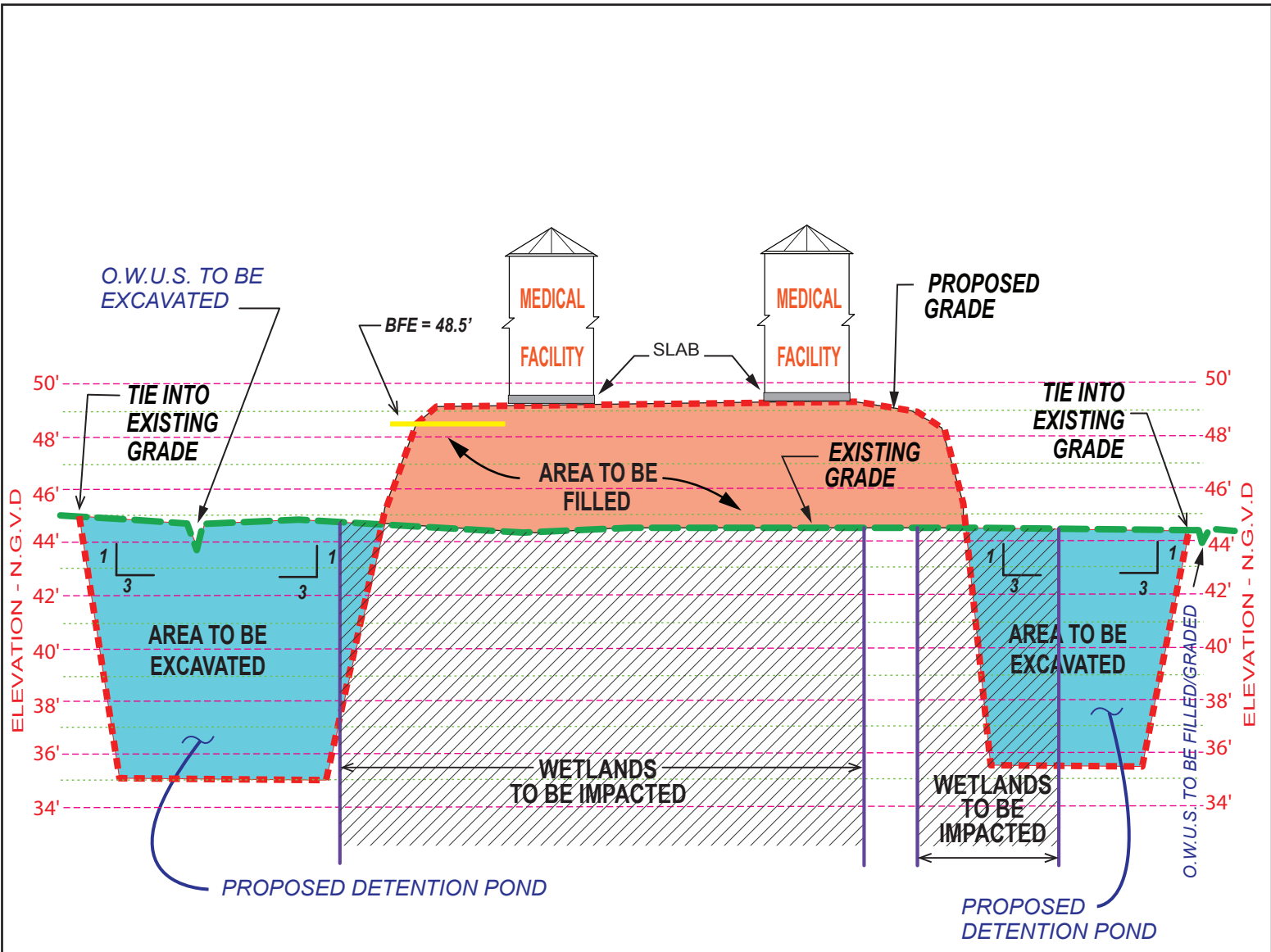

SECTION B-B
PROFILE VIEW

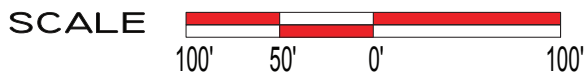

- LEGEND:**
- EXISTING GRADE
 - PROPOSED GRADE
 - AREA TO BE FILLED / GRADED
 - PROPOSED CONCRETE
 - WETLANDS IMPACTED
 - AREA TO BE EXCAVATED

FIGURE 4

HARVEST MANOR NURSING HOME
SECTION 25, T6S-R2E
CITY OF DENHAM SPRINGS
LIVINGSTON PARISH, LA



WETLANDS - GIS - FLOOD CONTROL
WWW.HYDRIK.COM (985)429-0333

APPLICANT:
PLANTATION MANAGEMENT

HF: 1781BC | DATE: 8-20-2017 | APPROVED: