

# JOINT PUBLIC NOTICE

November 13, 2017

U.S. Army Corps of Engineers  
New Orleans District  
Attn: Regulatory Branch  
7400 Leake Avenue  
New Orleans, LA 70118

State of Louisiana  
Department of Environmental Quality  
Attn: Water Quality Certifications  
Post Office Box 4313  
Baton Rouge, LA 70821-4313

Project Manager:  
Michael H. Herrmann  
(504) 862-1954/ (504) 862-2574 fax  
michael.h.herrmann@usace.army.mil  
Application # MVN-2016-00584-WLL

Project Manager:  
Elizabeth Hill  
(225) 219-3225  
WQC Application Number:  
WQC 171106-02

Interested parties are hereby notified that a permit application has been received by the New Orleans District of the U.S. Army Corps of Engineers pursuant to: [X] Section 10 of the Rivers and Harbors Act of March 3, 1899 (30 Stat. 1151; 33 U.S.C. 403); and/or [X] Section 404 of the Clean Water Act (86 Stat. 816; 33 U.S.C. 1344).

Application has also been made to the Louisiana Department of Environmental Quality for a Water Quality Certification (WQC) in accordance with statutory authority contained in La. R.S. 30:2074(A)(3) and provisions of Section 401 of the Clean Water Act (P.L. 95-217; 33 U.S.C. 1341).

## **SHIPPING DOCKS AND BULK MATERIALS FACILITY IN CAMERON PARISH, LOUISIANA**

**Name of Applicant:** Bell Tech Group, INC, 3309 Kaliste Saloom Rd., Lafayette, LA 70508, ATTN: Michael Bellard

**Location of Work:** The project is located at the mouth of the Calcasieu River Shipping Channel and the Gulf of Mexico, within Cameron Parish, Louisiana, as shown on the attached drawings. (Lat 29.7576, Long -93.3454) within the Calcasieu Watershed.

**Character of Work:** Excavate 505,908 cubic yards of waterbottoms, and place spoil to create land, build the Bell Tech A,B,C & D Docks with bulkheads and a 13,329 linear foot access road, all to construct a loading and off-loading facility for bulk materials, aggregate, etc., to supply for other local ventures and facilities. In addition, 404,118 cubic yards of aggregate material and 5,700 cubic yards of asphalt will be placed on site to construct the proposed project.

A Corps of Engineers jurisdictional determination (JD) is presently pending; and a preliminary wetland delineation by the applicant indicates that the project will impact approximately 47.5 acres of vegetated wetlands and approximately 90 acres of non-vegetated waterbottoms. Following a final JD by the USACE, should variations and additional wetlands and/or waterbottoms show to exist and/or be impacted, a secondary Public Notice and/or resource agency notification will be issued, subject the extent of differences in jurisdiction and impacts.

The comment period for the Department of the Army (DA) permit application and the Louisiana Department of Environmental Quality WQC will close **20 days** from the date of this joint public notice. Written comments, including suggestions for modifications or objections to the proposed work, stating reasons thereof, are being solicited from anyone having interest in this DA permit and WQC request and must be mailed, so as to be received before or by the last day of the comment period. Letters concerning the DA permit application must reference the applicant's name and the DA Permit Number, and be mailed to the U.S. Army Corps of Engineers at the address above. Similar letters concerning the WQC must reference the applicant's name and the WQC Number and be mailed to the Louisiana Department of Environmental Quality at the address above. Individuals or parties may request an extension of time in which to comment on the proposed work by writing or e-mailing the Project Manager listed above. Any request must be specific and substantively supportive of the requested extension, and received by this office prior to the end of the initial comment period. The Section Chief will review the request and the requestor will be promptly notified of the decision to grant or deny the request. If granted, the time extension will be continuous to the initial comment period and, inclusive of the initial comment period, will not exceed a total of 30 calendar days.

The application for this proposed project is on file with the Louisiana Department of Environmental Quality and may be examined weekdays between 8:00 a.m. and 4:30 p.m. Copies may be obtained upon payment of costs of reproduction.

### **Corps of Engineers Permit Criteria**

The decision whether to issue a permit will be based on an evaluation of the probable impacts, including cumulative impacts of the proposed activity on the public interest. That decision will reflect the national concern for both protection and utilization of important resources. The benefit which reasonably may be expected to accrue from the proposal must be balanced against its reasonably foreseeable detriments. All factors which may be relevant to the proposal will be considered, including the cumulative effects thereof; among these being: conservation, economics, aesthetics, general environmental concerns, wetlands, historic properties, fish and wildlife values, flood hazards, floodplain values, land use, navigation, shoreline erosion and accretion, recreation, water supply and conservation, water quality, energy needs, safety, food and fiber production, mineral needs, considerations of property ownership and, in general, the needs and welfare of the people.

The U.S. Army Corps of Engineers is soliciting comments from the public, federal, state, and local agencies and officials, Indian Tribes, and other interested parties in order to consider and evaluate the impacts of this proposed activity. Any comments received will be considered by the U.S. Army Corps of Engineers to determine whether to make, modify, condition, or deny a permit for this proposal. To make this decision, comments are used to assess impacts on endangered species, historic properties, water quality, general environmental effects, and other public interest factors listed above. Comments are used in the preparation of an Environmental Assessment and/or an Environmental Impact Statement pursuant to the National Environmental Policy Act. Comments are also used to determine the need for a public hearing and to determine the overall public interest of the proposed activity.

The New Orleans District is unaware of properties listed on the National Register of Historic Places near the proposed work. The possibility exists that the proposed work may damage or destroy presently unknown archeological, scientific, prehistorical, historical sites, or data. Issuance of this public notice solicits input from the State Archeologist and State Historic Preservation Officer regarding potential impacts to cultural resources.

Our initial finding is that the proposed work may effect species listed as endangered, and may effect habitat designated as critical to the survival and recovery of endangered species listed by the U.S. Department of Commerce. Based on the South Louisiana **Standard Local Operating Procedure for Endangered Species (SLOPES)**, as signed on October 22, 2014, between the U.S. Army Corps of Engineers, New Orleans and U.S. Fish and Wildlife Service, it has been determined that the proposed activity may affect the Piping Plover (*Charadrius melodus*) and the Red Knot (*Calidris canutus rufa*) and their Critical Habitat due to project construction. It has been determined that the 90 acre dredge footprint is located in waters known to be utilized by the West Indian Manatee (*Trichechus manatus*) and determined that the activity is not likely to adversely affect this species. If the subject permit is issued, the permittee will be required to follow the SLOPES Manatee Conditions for In-Water Use.

This notice initiates the Essential Fish Habitat (EFH) consultation requirements of the Magnuson-Stevens Fishery Conservation and Management Act. The applicant's proposal would result in the destruction or alteration of approximately 137 acres of possible EFH utilized by various life stages of red drum and penaeid shrimp. Our initial determination is that the proposed action would not have a substantial adverse impact on EFH or federally managed fisheries in the Gulf of Mexico. Our final determination relative to project impacts and the need for mitigation measures is subject to review by and coordination with the National Marine Fisheries Service.

If the proposed work involves deposits of dredged or fill material into navigable waters, the evaluation of the probable impacts will include the application of guidelines established by the Administrator of the U.S. Environmental Protection Agency. Also, a certification that the proposed activity will not violate applicable water quality standards will be required from the Louisiana Department of Environmental Quality before a permit is issued.

Any person may request, in writing, within the comment period specified in this notice, that a public hearing be held to consider this application. Requests for public hearings shall state, with particularity, the reasons for holding a public hearing.

The applicant has certified that the proposed activity described in the application complies with and will be conducted in a manner that is consistent with the Louisiana Coastal Resources Program. The Department of the Army permit will not be issued unless the applicant received approval or a waiver of the Coastal Use Permit by the Department of Natural Resources.

You are invited to communicate the information contained in this notice to any other parties whom you deem likely to have interest in the matter.

Darrell S. Barbara  
Chief, Western Evaluation Section  
Regulatory Branch

Enclosure





MAP LOCATION PLAN  
DOCKS A, B, C, D  
SCALE: N.T.S.

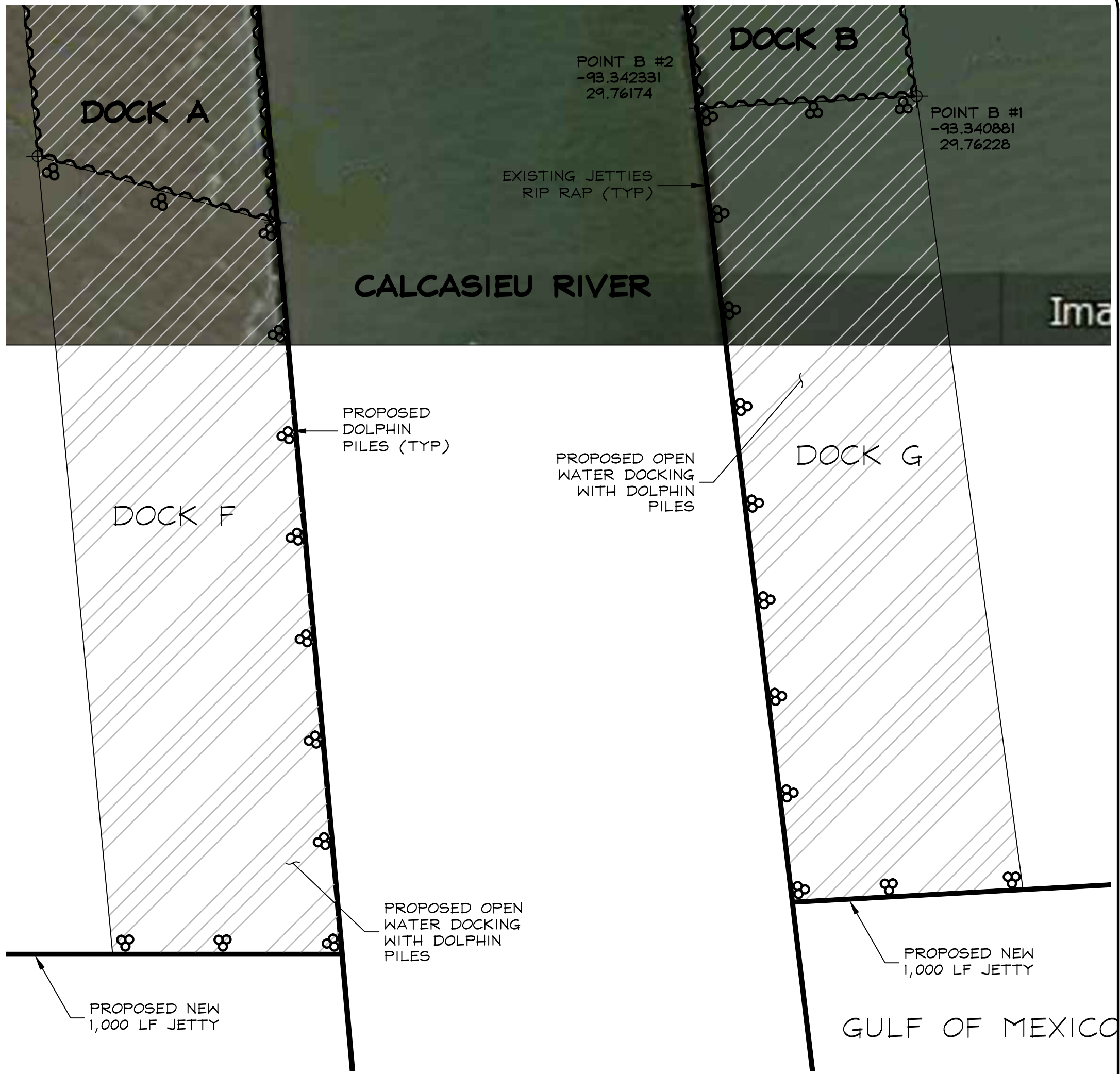

MAP LOCATION PLAN  
DOCKS F&G  
SCALE: N.T.S.

NOTES:

1. TEMPORARY ROAD (DOCK C) SHALL HAVE A GEOTEX FABRIC AND COVERED WITH 8" OF 610 LIMESTONE. EXISTING CULVERTS SHALL HAVE BOARD ROAD FOR CROSSING, WITH GEOTEX AND LIMESTONE COVER. THIS EXISTING ROAD TIES INTO THE PROJECT FROM THE NORTH SIDE AS SHOWN ON ARIEL VIEW.
2. PERMANENT ROAD (DOCK D) SHALL BE CONSTRUCTED OF ASPHALT WITH DOTD STANDARDS FOR A TWO LANE ACCESS AND USE ROAD. CULVERTS WILL BE 24" DIAMETER POLYVINYL PVC EQUALIZER PIPES INSTALLED EVERY 250 YARDS.
3. OFFICE AND RESTROOMS WILL BE USED AND MAINTAINED AT EXISTING CAMERON PARISH CAMPGROUND SITE (DOCK D) WHICH IS PART OF THIS PERMIT. TRUCKS - 18 WHEELER END DUMP TRUCK PARKING IS LOCATED AT THIS SITE WITH 50 - 70 EACH, PARKED HERE ON EXISTING LIMESTONE PARKING AREA. THE PROPOSED NEW ROAD FROM EXISTING CAMERON PARISH CAMPGROUND SITE WILL TIE INTO STATE ROAD HWY 1142. THE PROPOSED NEW ROAD WILL MATCH STATE ROAD HWY 1142, DOTD CONSTRUCTION STANDARDS.
4. EARTH, LIMESTONE AND EQUIPMENT WILL ALSO BE DELIVERED TO DOCK SITES VIA BARGE. BARGES WILL BE DOCKED ALONGSIDE DOLPHIN PILES, LOADED AND OFFLOADED ONTO SITE LOCATIONS AT DOCKS A, B, C & D. SEE COE DRAWING WITH TYPICAL BARGE DOCKING.
5. DOCKS SHALL BE GRADED TO ELEVATION WITH GEOTEX FABRIC AND LIMESTONE TOPPING TO A PLUS 4'-0" +/- ELEVATION.
6. REFER TO PHOTOGRAPHS ON DRAWINGS OF EXISTING SITE CONDITIONS AND ONE EXAMPLE PICTURE #3 OF SUCH ACTIVITIES.



PHOTO #2



PHOTO #1



PHOTO #3

BELLTECH DOCKS  
CAMERON PARISH  
Louisiana

BELLARD & ASSOCIATES, INC.  
CONSULTING ENGINEERS  
LOUISIANA  
LAFAYETTE

PROJECT No. 28-17-01  
DATE July 19, 2017  
REVISED  
DESIGNED BY RJB  
DRAWN BY KWH  
CHECKED BY

SHEET NO.  
1

1 OF 4 SHEETS



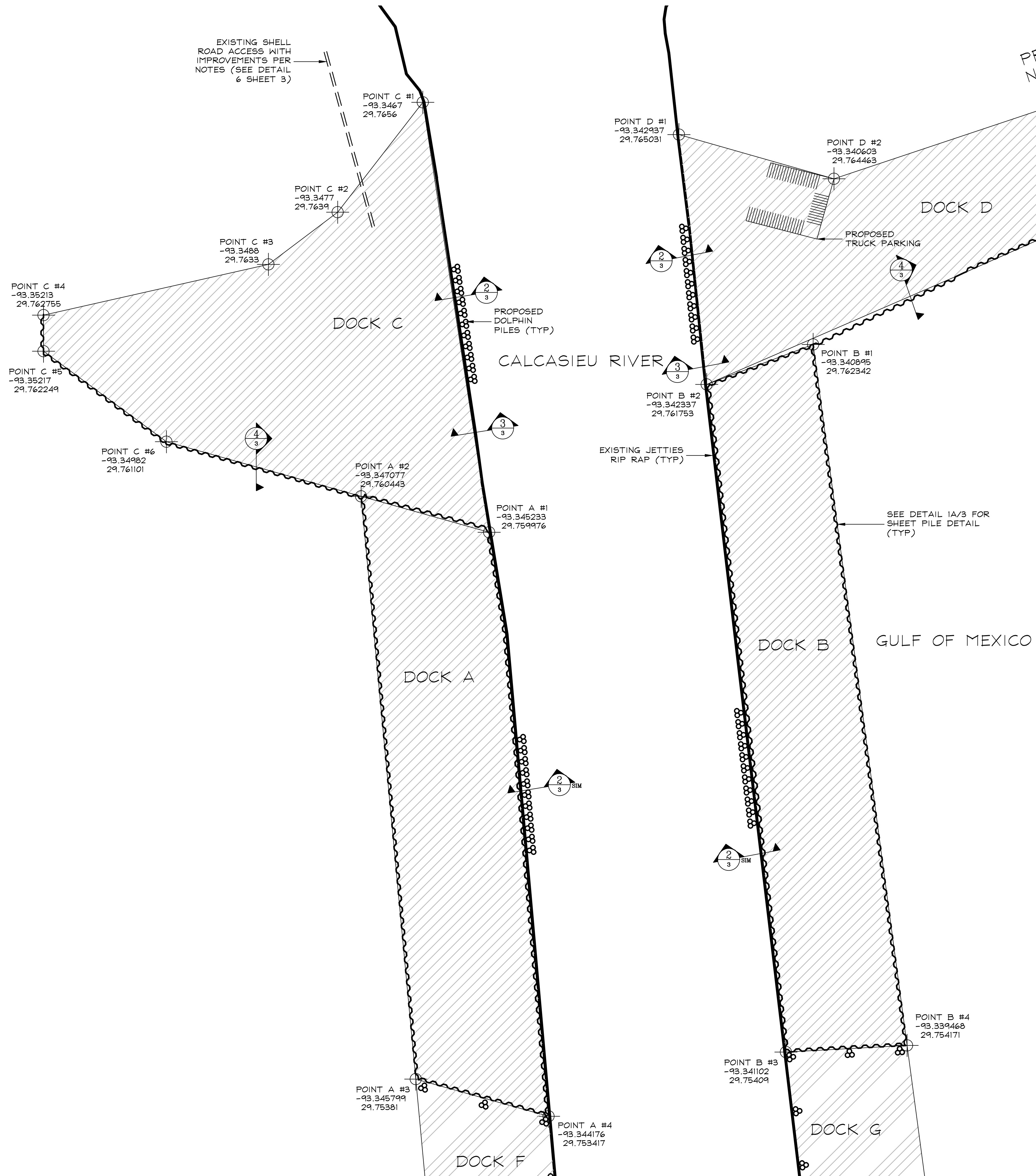

**DOCK PLAN  
DOCKS A, B, C, D**  
SCALE: N.T.S.

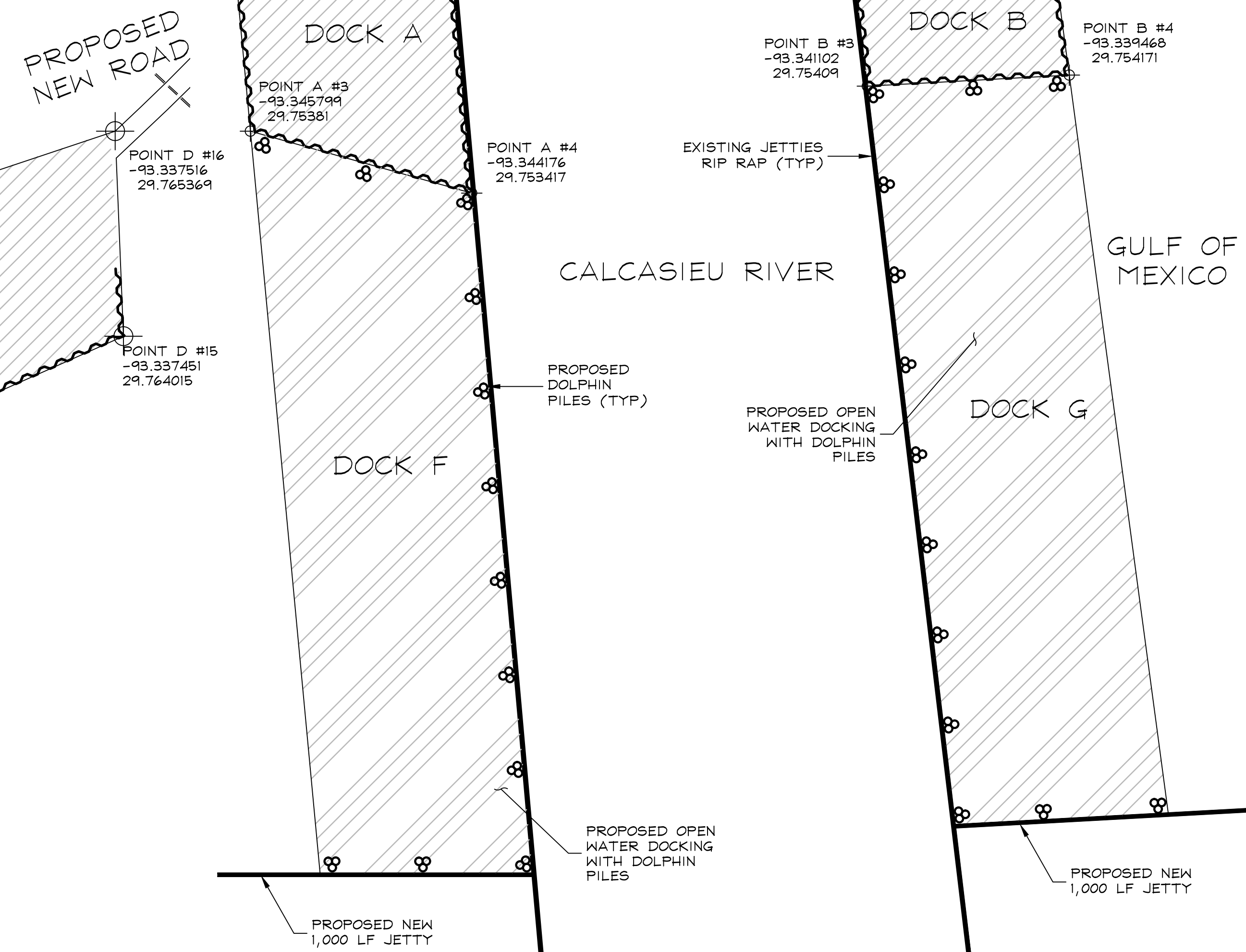

**DOCK PLAN  
DOCKS F & G**  
SCALE: N.T.S.

**BELLTECH DOCKS  
CAMERON PARISH  
Louisiana**

**BELLARD & ASSOCIATES, INC.  
CONSULTING ENGINEERS  
LOUISIANA  
LAFAYETTE**

PROJECT No. 28-17-01  
DATE July 19, 2017  
REVISED \_\_\_\_\_  
DESIGNED BY RJB  
DRAWN BY KWH  
CHECKED BY \_\_\_\_\_



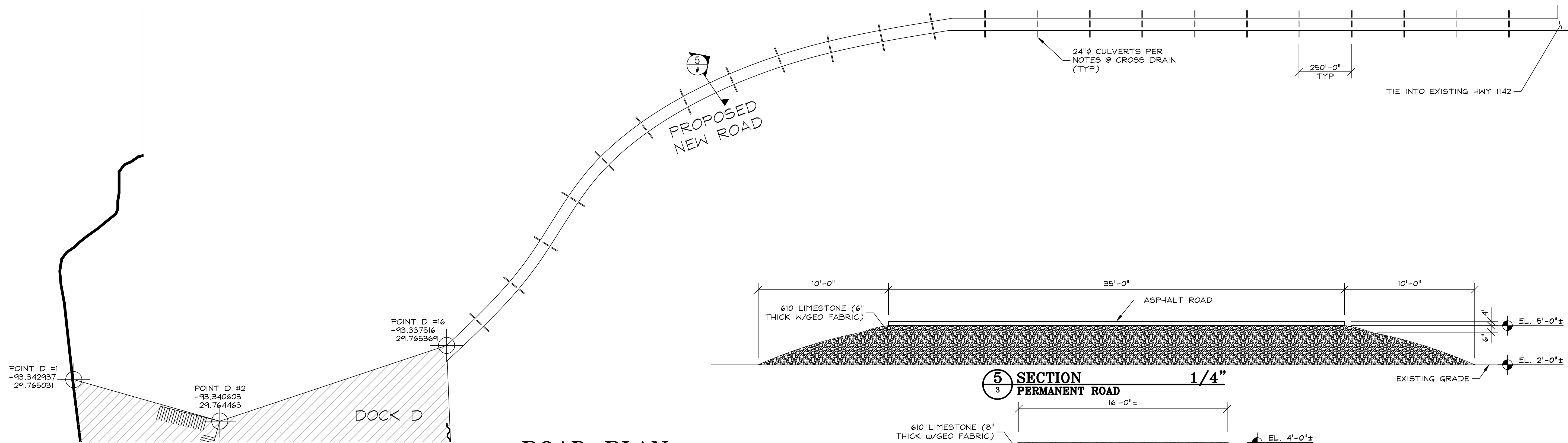

**ROAD PLAN**  
SCALE: N.T.S.

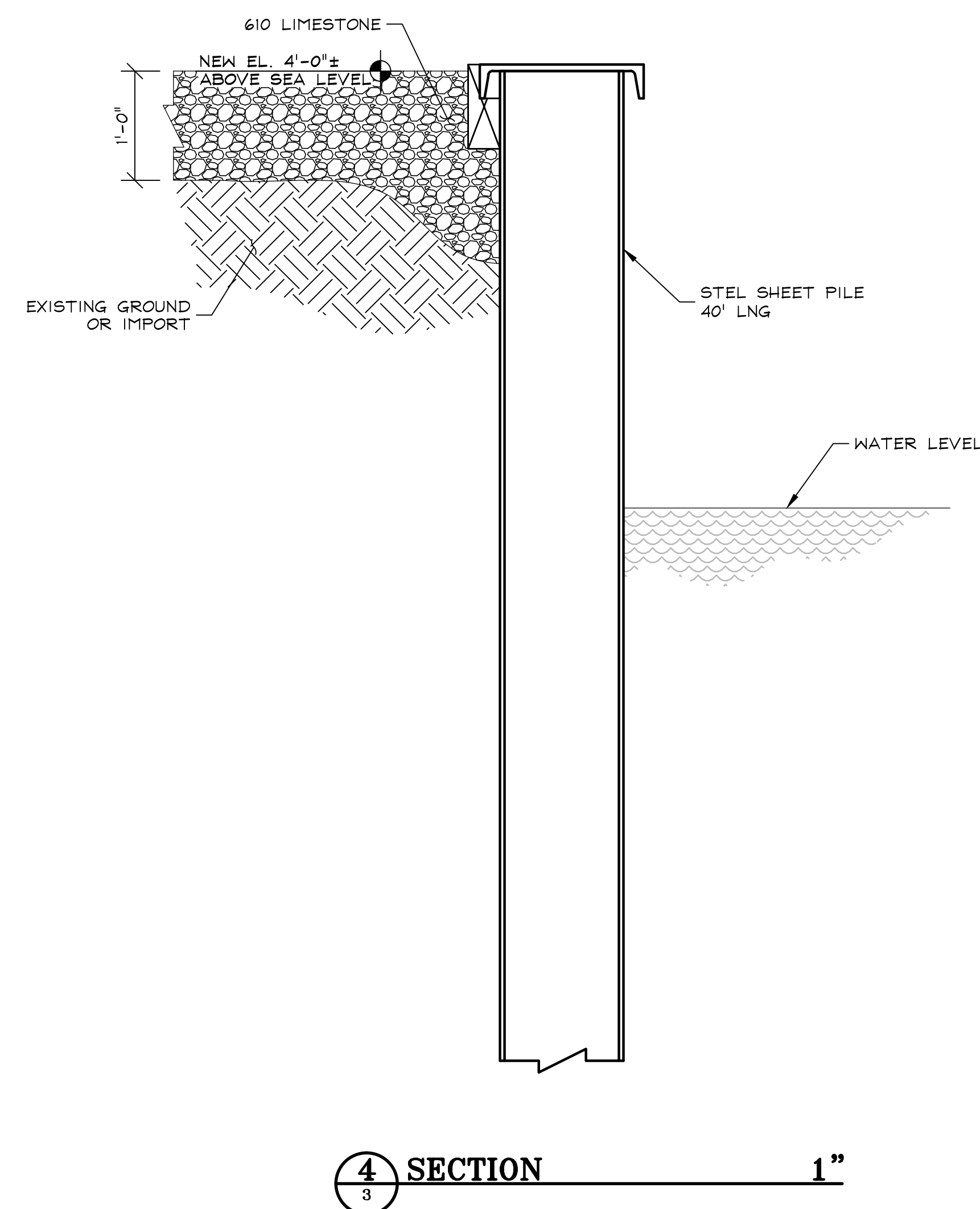
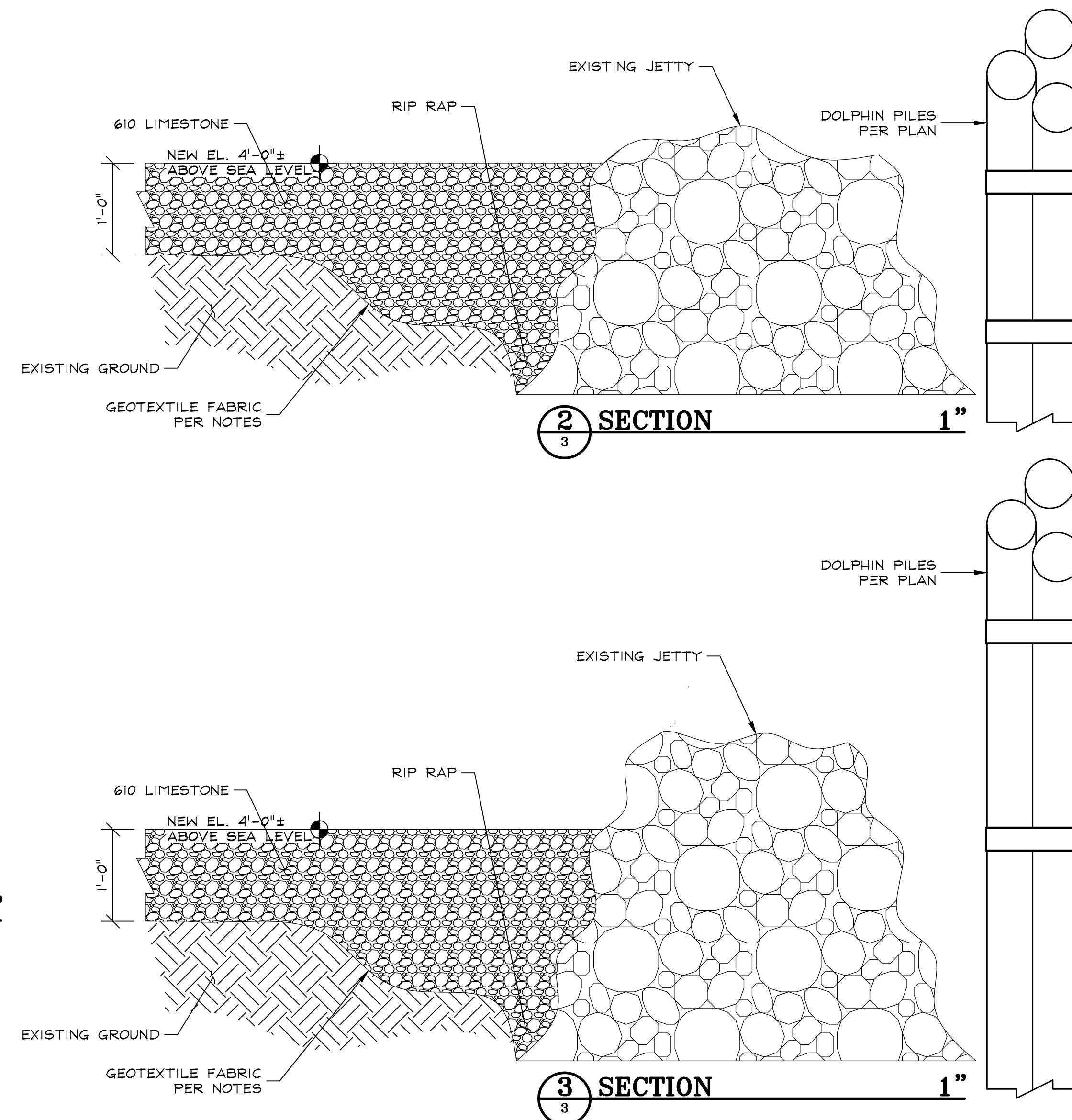
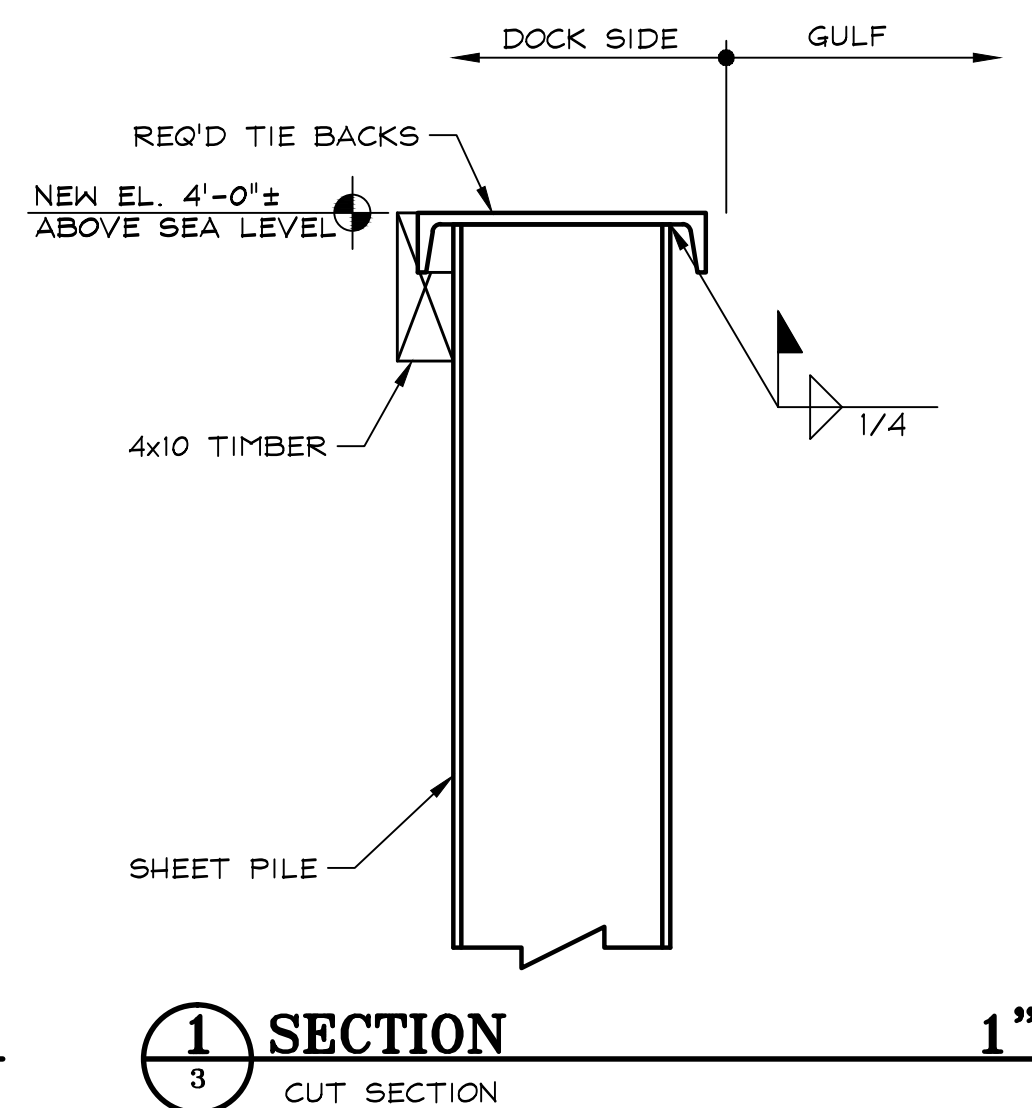
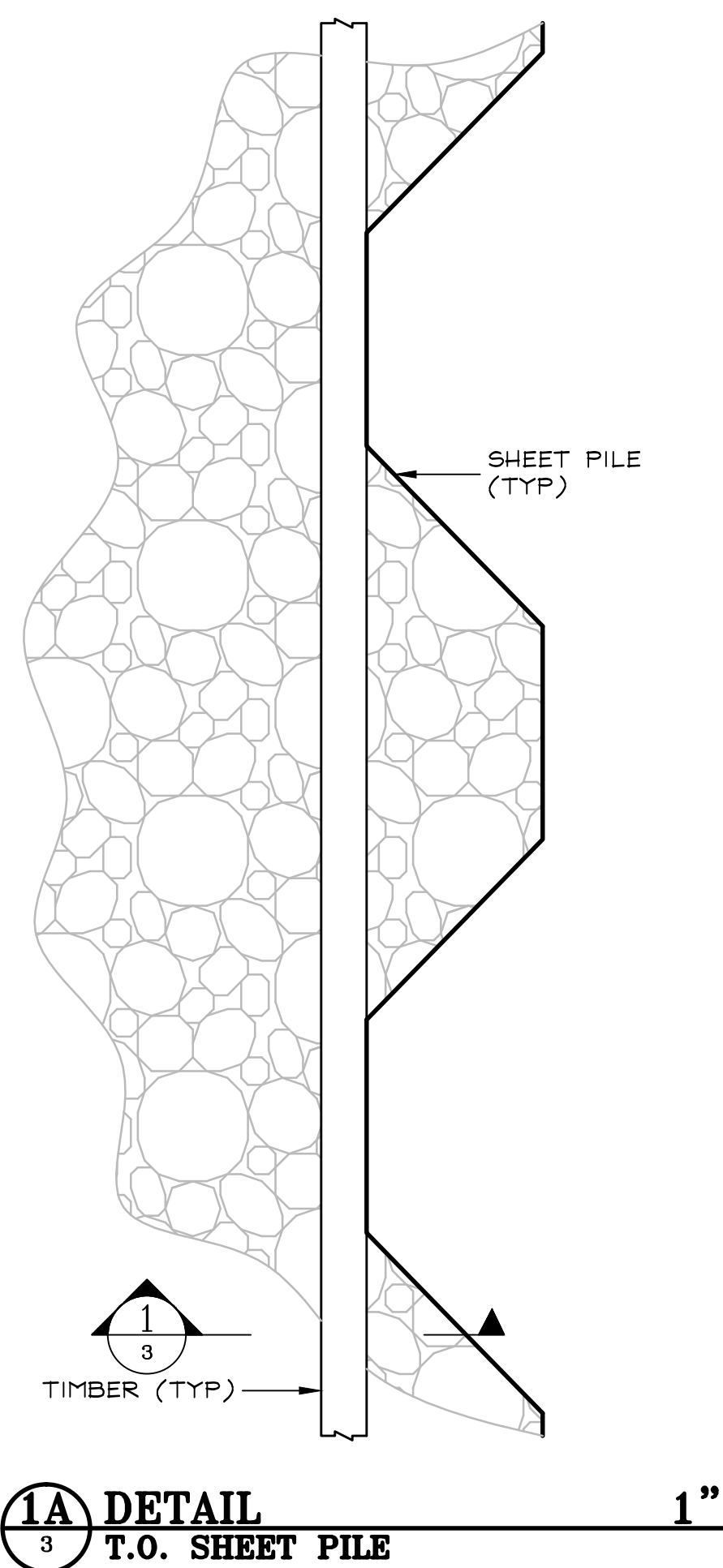
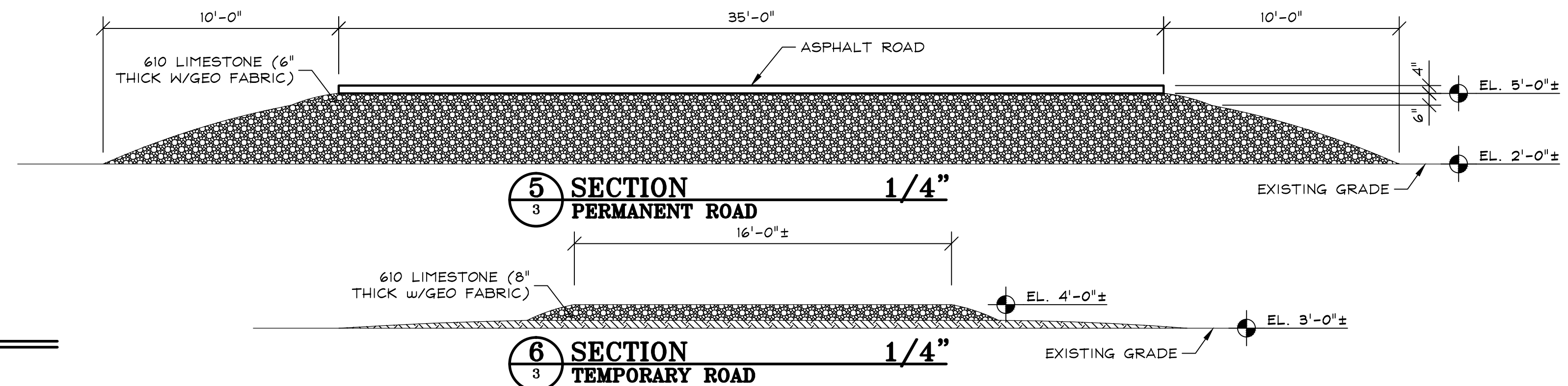

**BELLTECH DOCKS**  
**CAMERON PARISH**  
Louisiana

**BELLARD & ASSOCIATES, INC.**  
**CONSULTING ENGINEERS**  
**LOUISIANA**  
**LAFAYETTE**

PROJECT No. 28-17-01  
DATE March 30, 2017  
REVISED  
DESIGNED BY RJB  
DRAWN BY KWH  
CHECKED BY

SHEET NO.  
**3**

3 OF 4 SHEETS





**THE BELLTECH GROUP, INC.**

Developers - Construction Managers - Constructors

P#20160249

Revision (4/4/17)

POINT A #2  
-93.347077  
29.760443

POINT A #1  
-93.345233  
29.759976

DOCK A



POINT A #3  
-93.345799  
29.75381

POINT A #4  
-93.344176  
29.753417





**THE BELLTECH GROUP, INC.**

Developers - Construction Managers - Constructors

P#20160249  
Revision (4/4/17)

## BellTech Dock A (REV. )

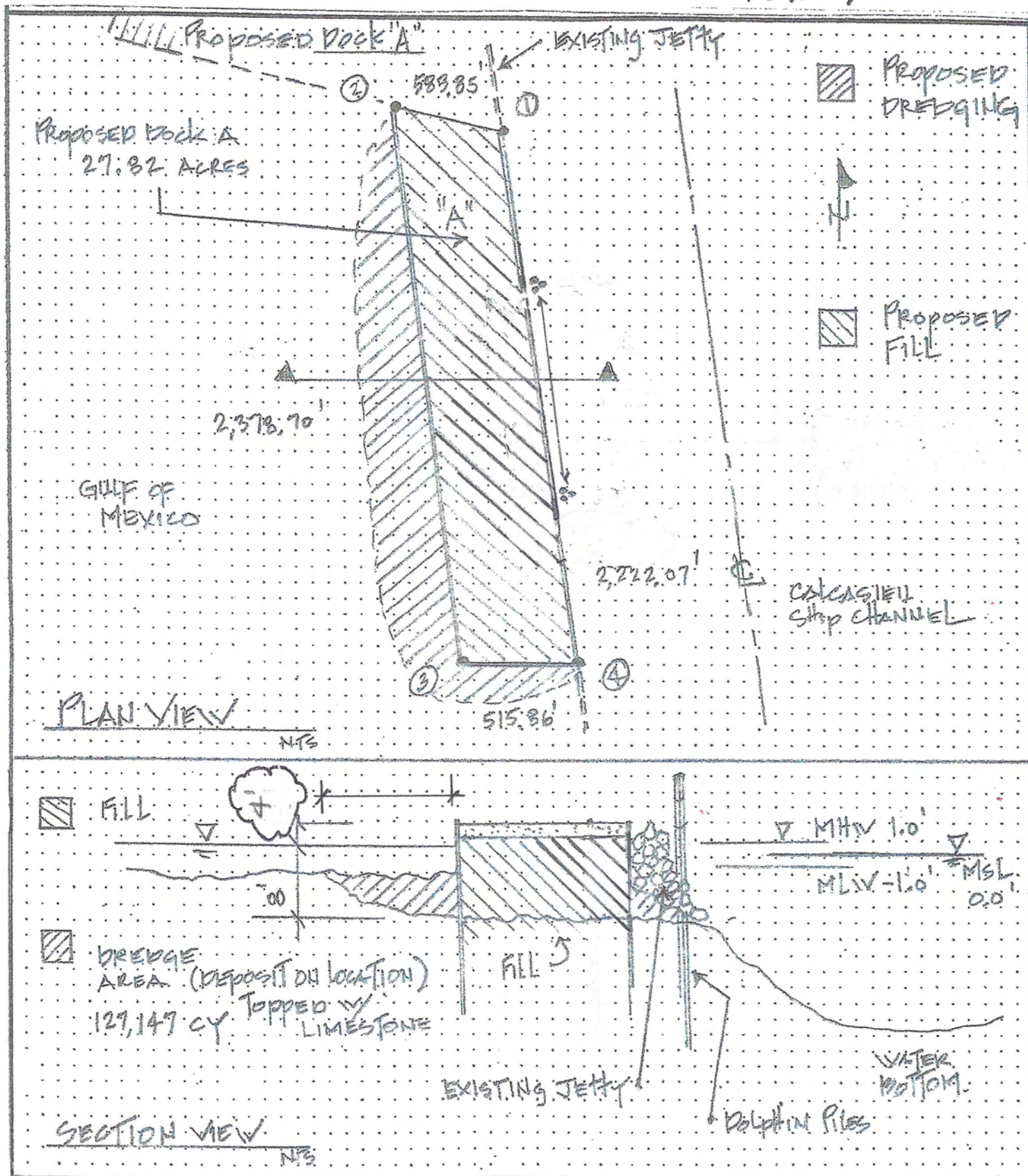



RIVER



POINT B #2  
-93.342331  
29.76174

POINT B #1  
-93.340881  
29.76228

EXISTING JETTIES  
RIP RAP (TYP)

SEE DETAIL 1A/3 FOR  
SHEET PILE DETAIL  
(TYP)

DOCK B

GULF OF MEXICO



POINT B #4  
-93.339468  
29.754171

POINT B #3  
-93.341102  
29.75409



THE BELLTECH GROUP, INC.

Developers - Construction Managers - Constructors

P#20160249

Revision (4/4/17)



**THE BELLTECH GROUP, INC.**

Developers - Construction Managers - Constructors

P#20160249  
Revision (4/4/17)

## BellTech Dock B (REV. )

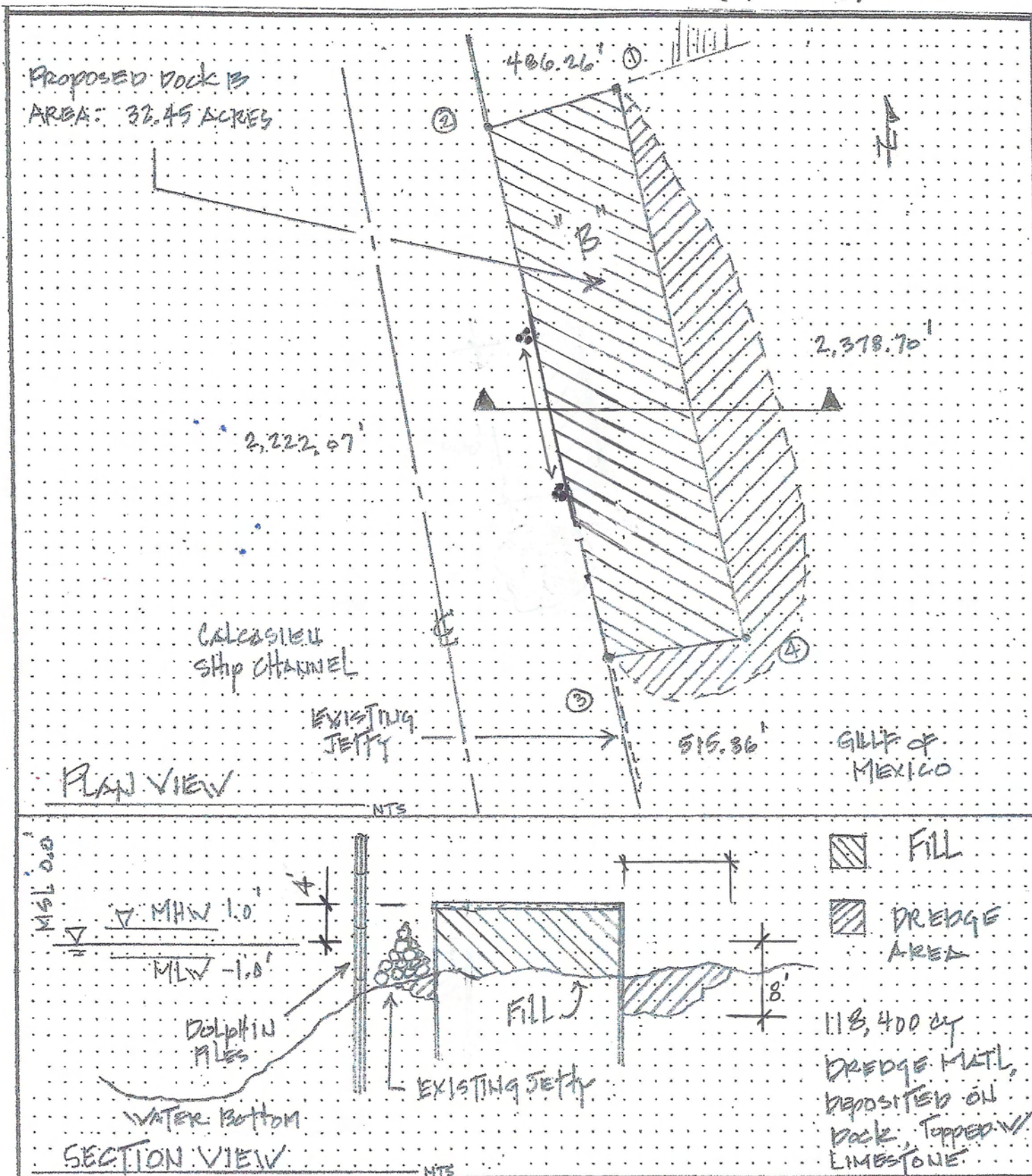



P#20160249

Revision (6/19/17)

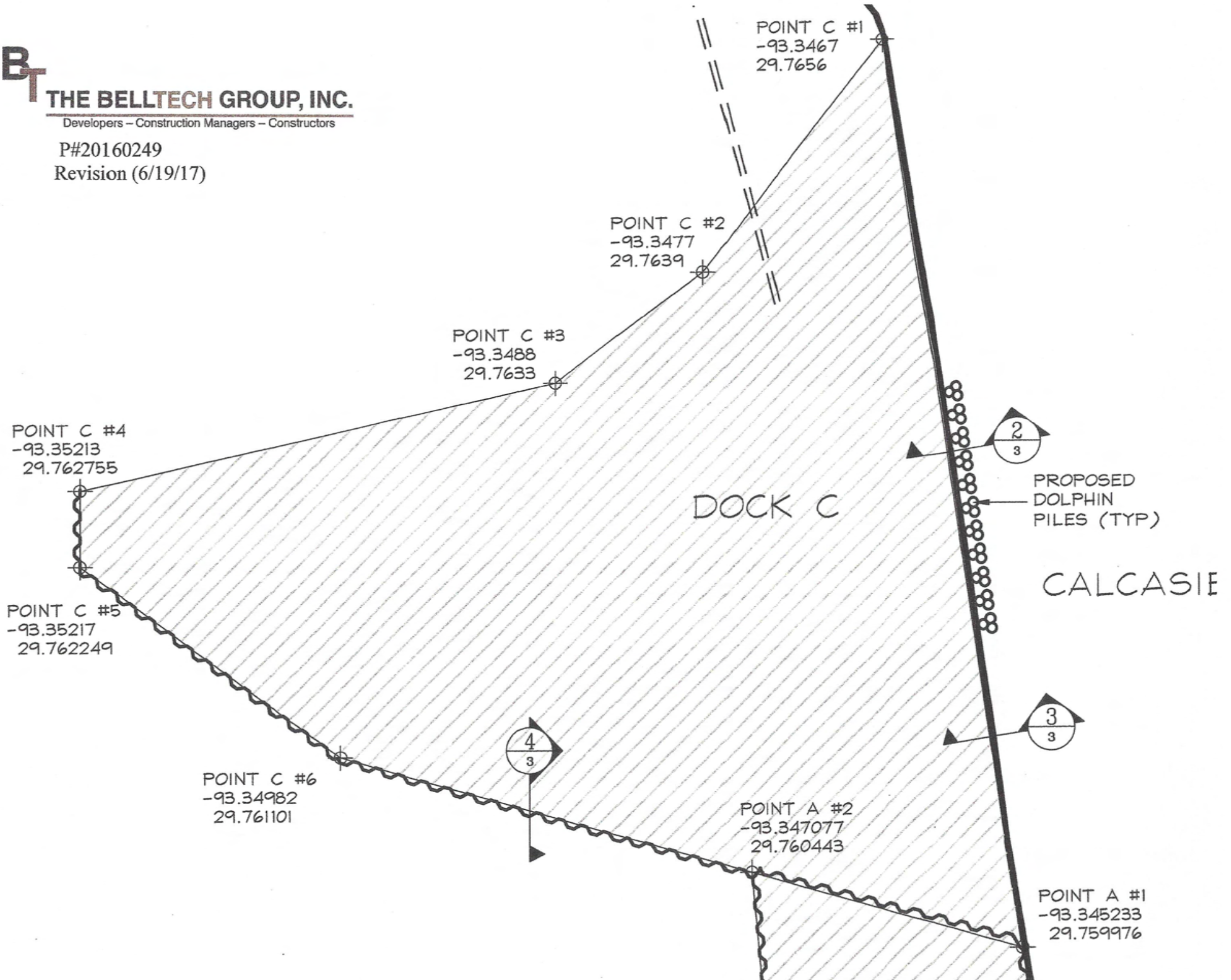



# THE BELLTECH GROUP, INC.

Developers - Construction Managers - Constructors

## BELLTECH DOCK C

(REV. )

ADJUSTED AREA, 44 ACRES

 DREDGE PROPOSED 1.26 ACRES

 FILL 6,100 CY

EXISTING JETTY

PROPOSED DOLPHIN PILES  
4' Ø

44 ACRES

EXISTING BEACH

GULF OF MEXICO

PLAN VIEW

NTS

CALESHIEL SHIP CHANNEL

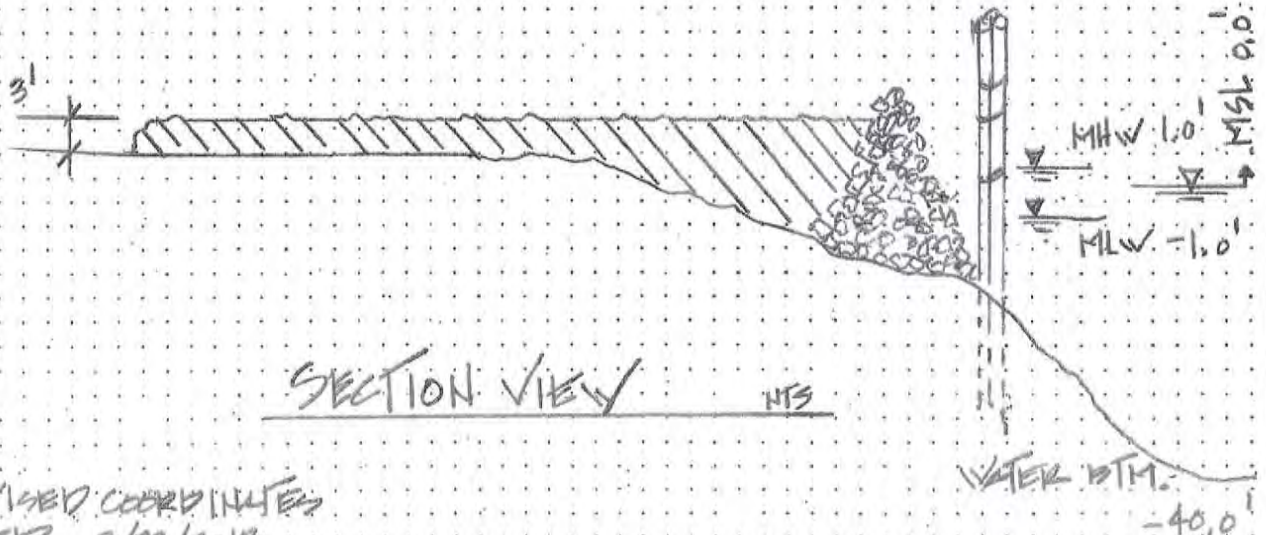

• SEE REVISED COORDINATES  
ATTACHED 3/29/2017



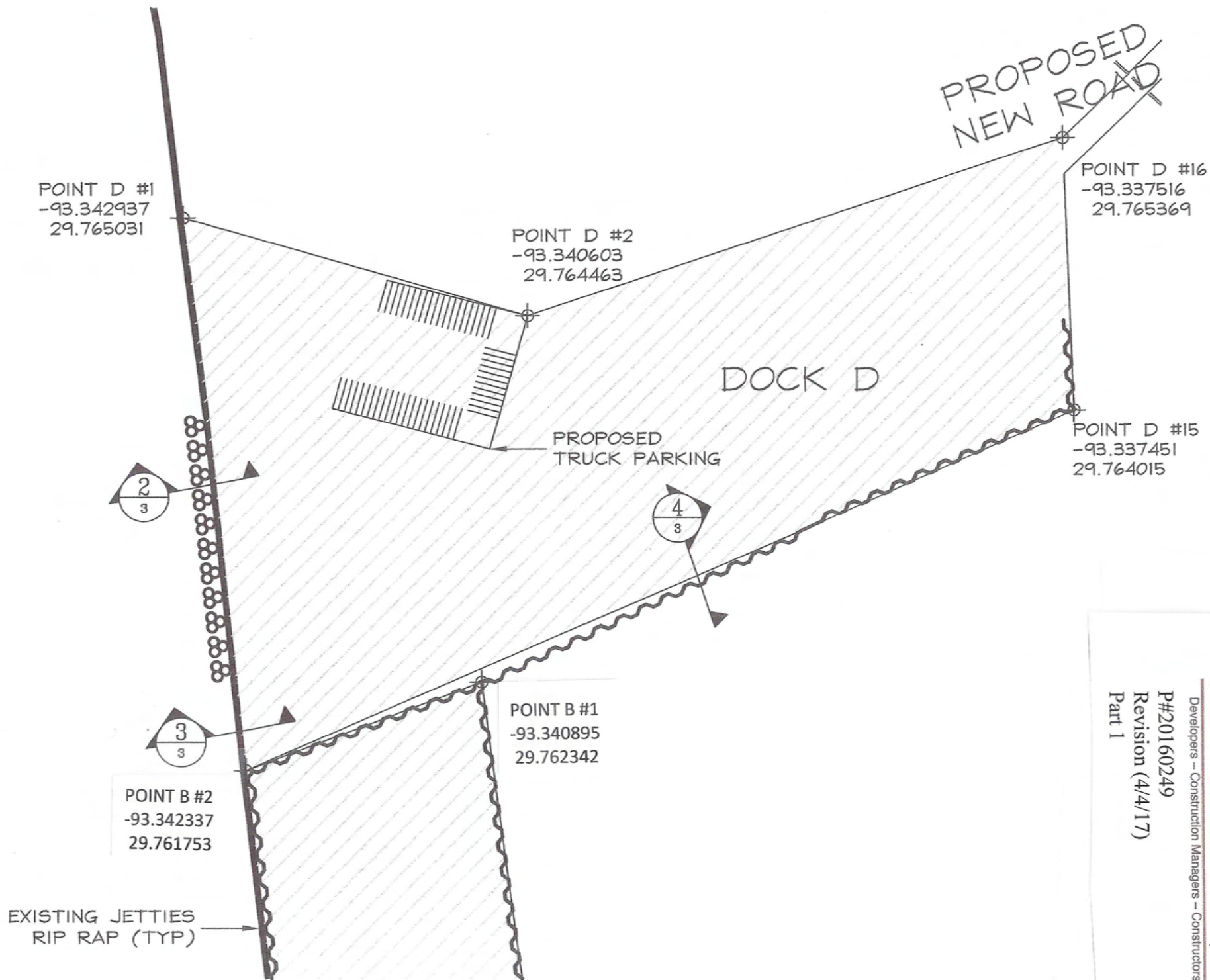



**THE BELLTECH GROUP, INC.**  
Developers – Construction Managers – Constructors

P#20160249

Revision (4/4/17)

Part 2

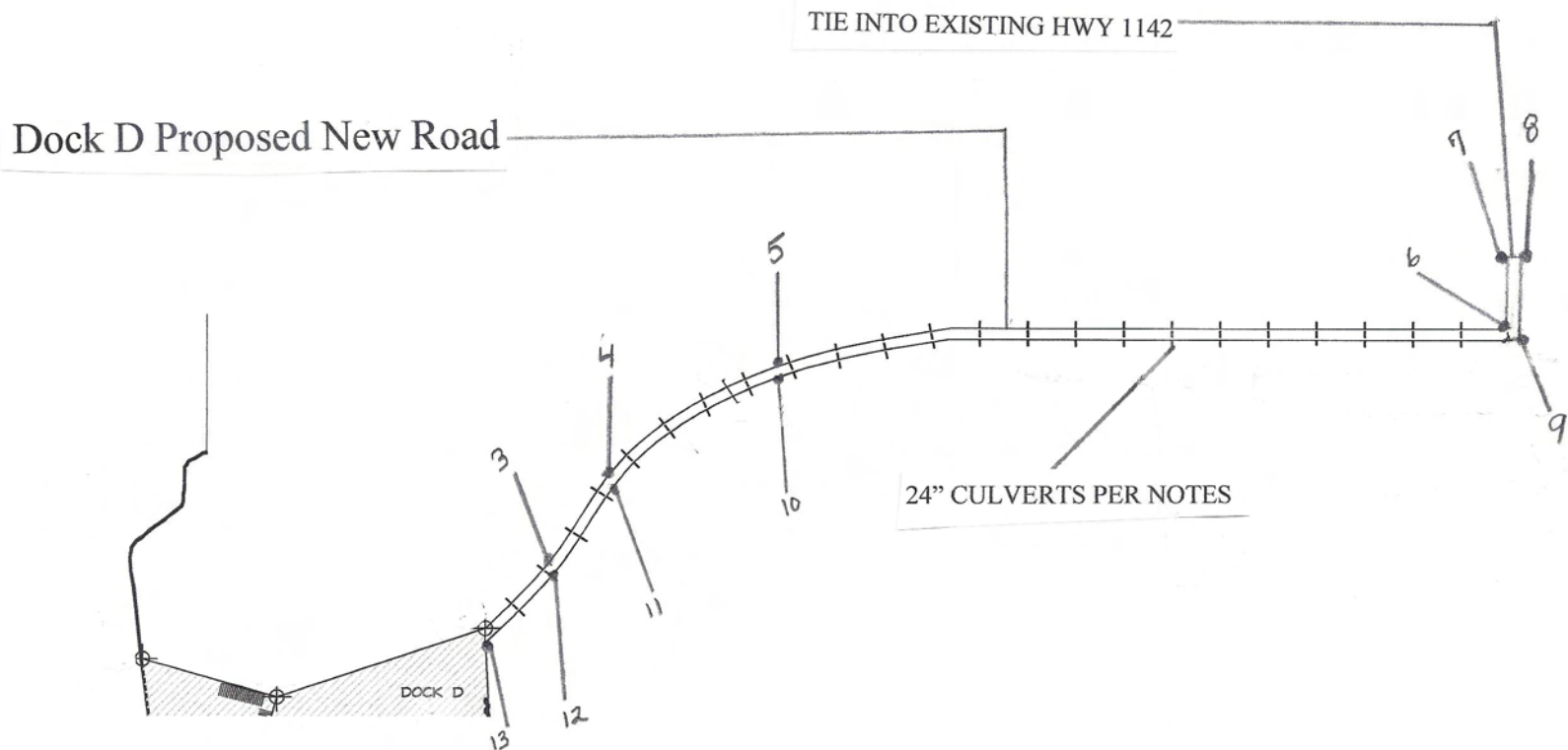





THE BELLTECH GROUP, INC.

Developers - Construction Managers - Constructors

P#20160249  
Revision (4/4/17)  
Part 1

BELLTECH DOCK D

(REV.)

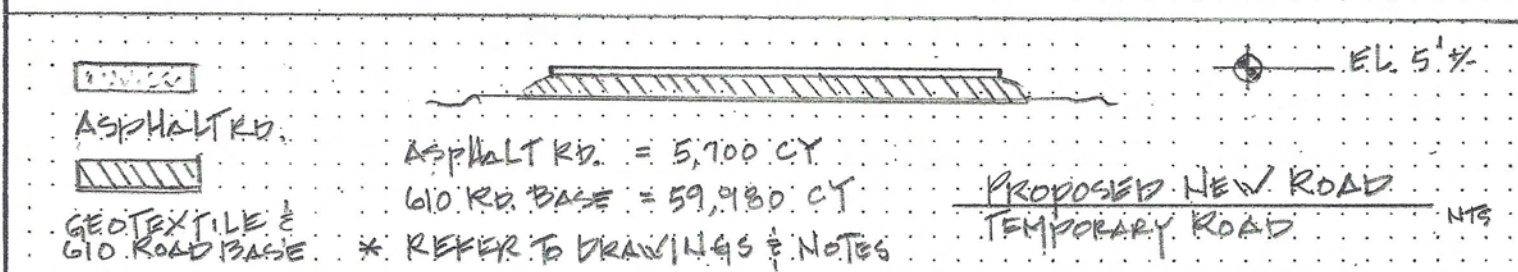
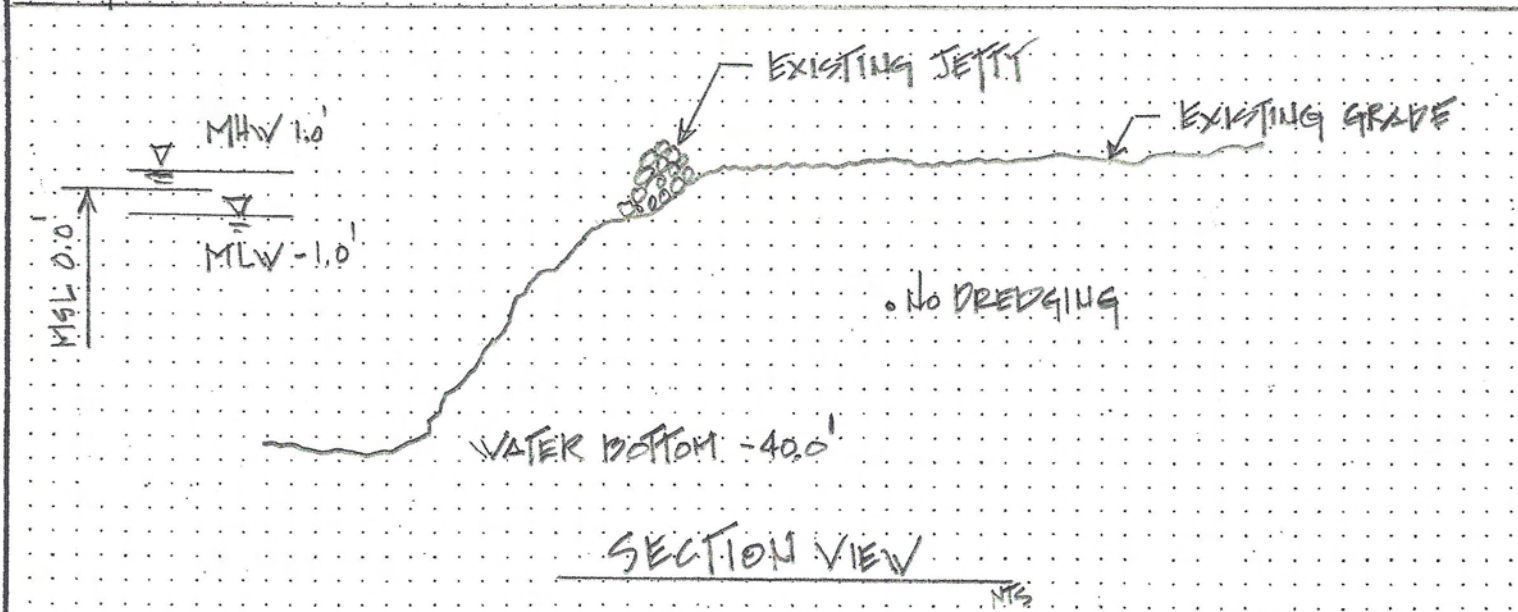
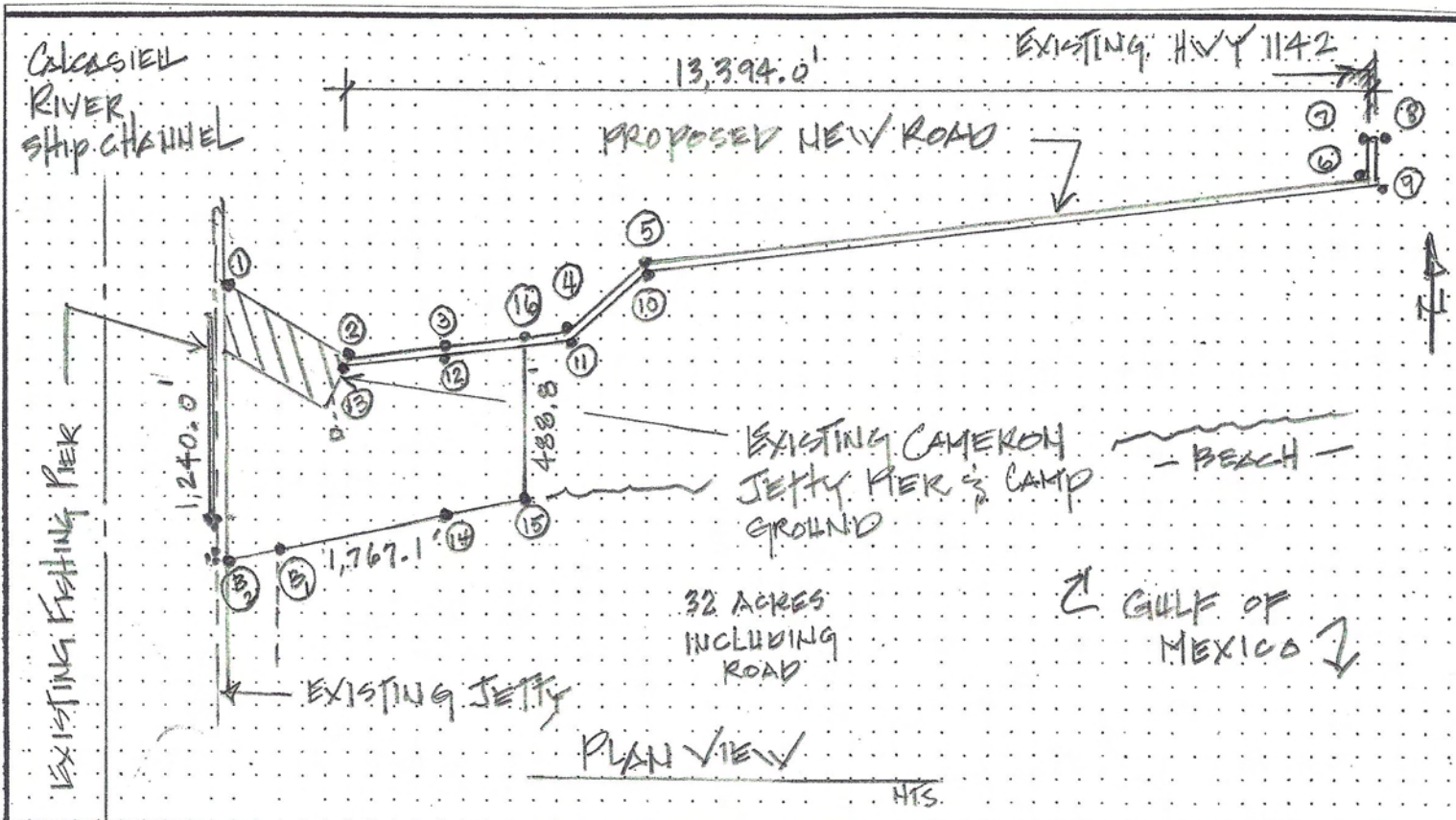



**THE BELLTECH GROUP, INC.**

Developers – Construction Managers – Constructors

P#20160249

Revision (4/4/17)

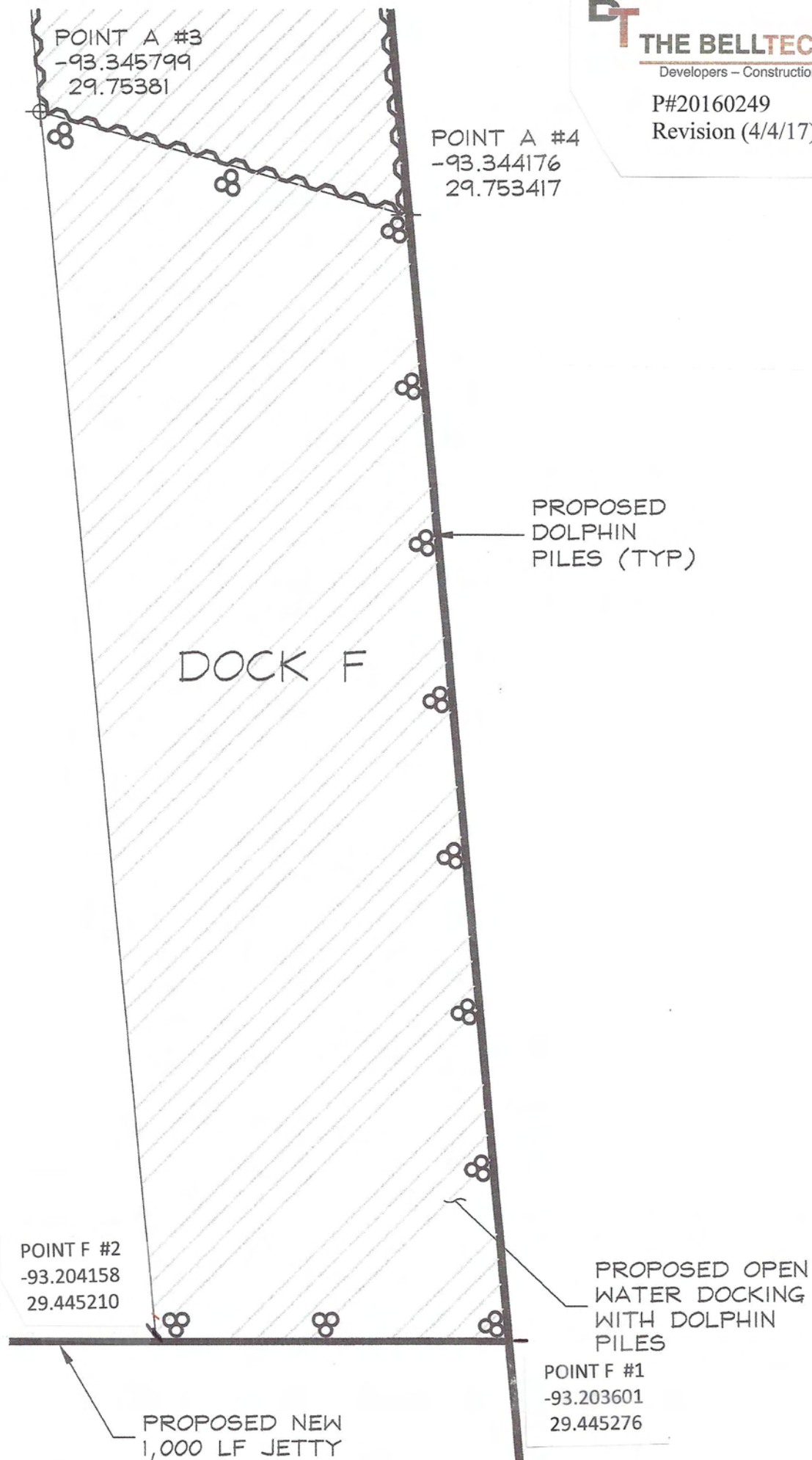



# BELLTECH DOCK F

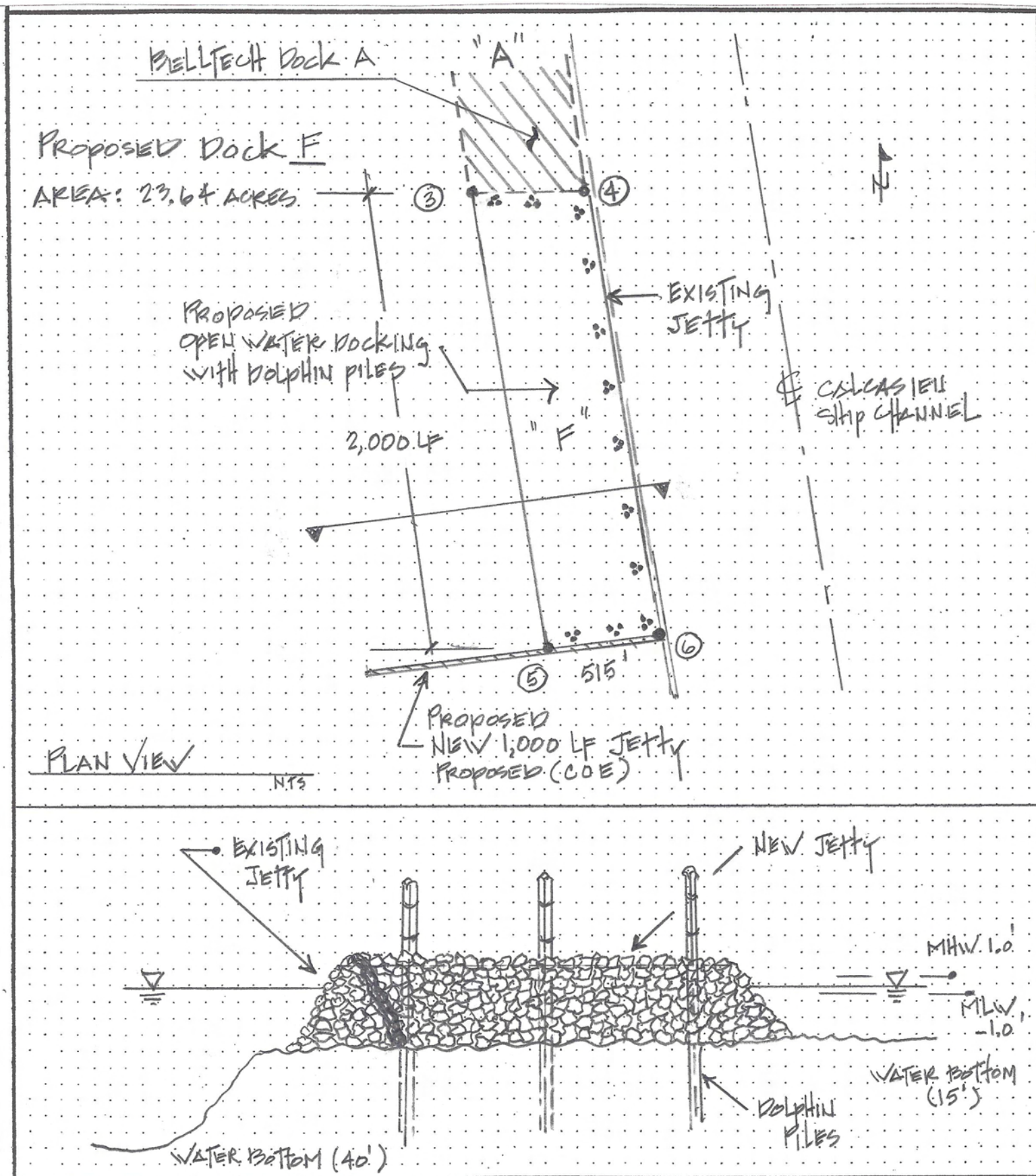

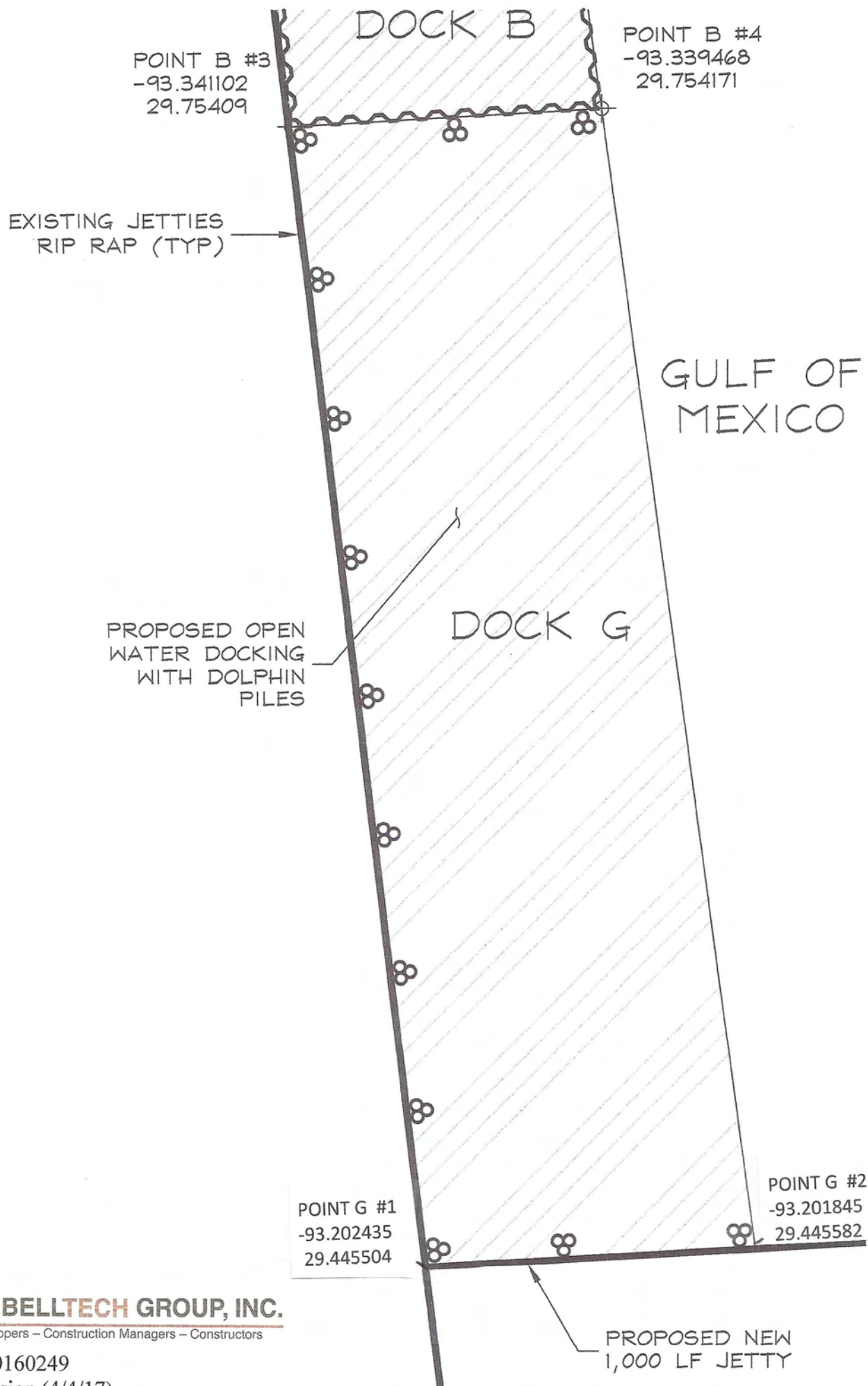

**THE BELLTECH GROUP, INC.**

Developers – Construction Managers – Constructors

P#20160249

Revision (4/4/17)



**BELLTECH DOCK G**

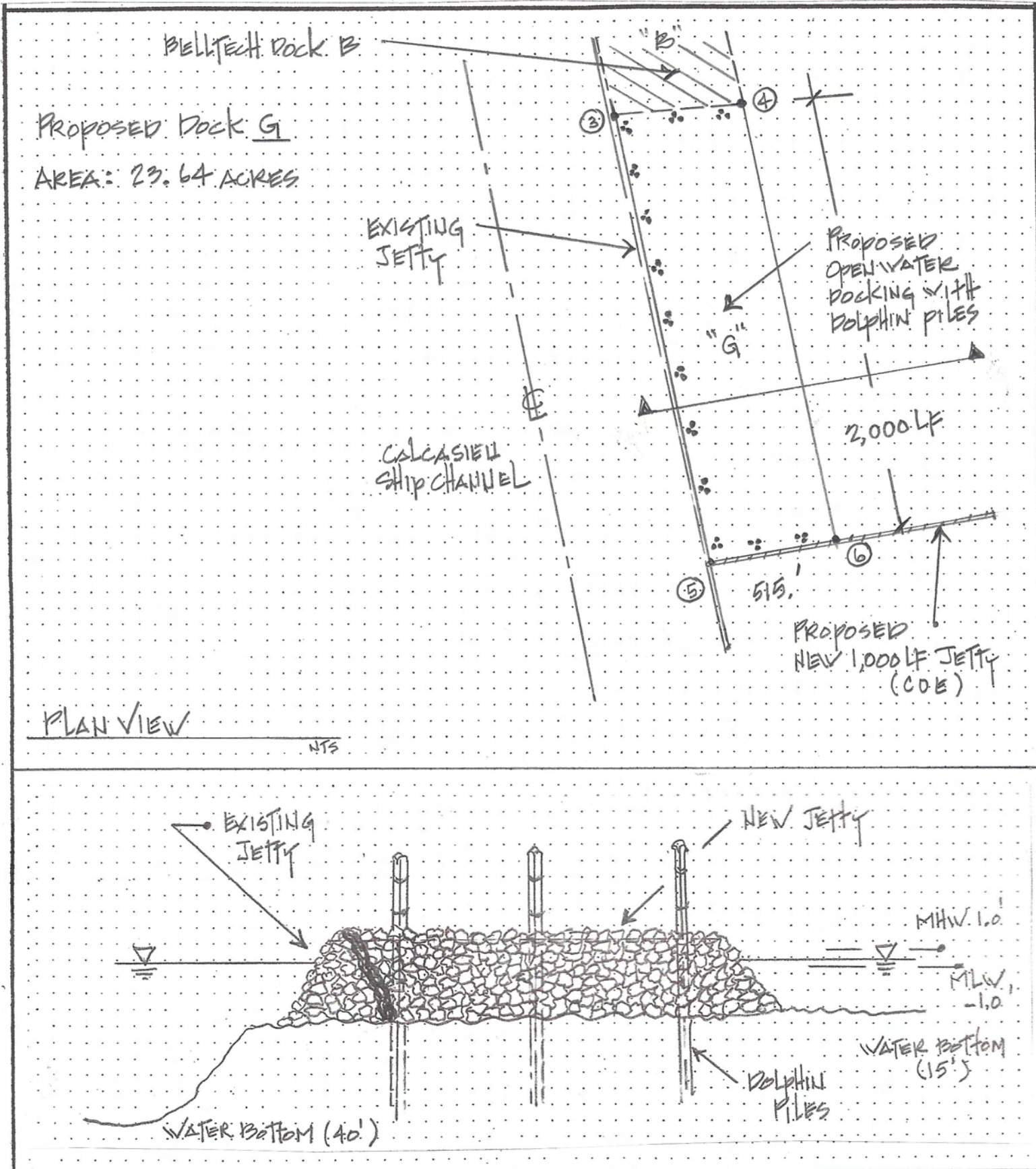

# BELLTECH DOCK COORDINATES (as revised) 06-19-17

DOCK A	DOCK B	DOCK C	DOCK D	DOCK F	DOCK G
A #1) -93.345233	B #1) -93.340881	A #1) -93.345233	B #1) -93.340895	A #3) -93.345799	B #3) -93.341102
29.759976	29.76228	29.759976	29.762342	29.75381	29.75409
A #2) -93.347077	B #2) -93.342331	A #2) -93.347077	B #2) -93.342337	A #4) -93.344176	B #4) -93.339468
29.760443	29.76174	29.760443	29.761753	29.753417	29.754171
A #3) -93.345799	B #3) -93.341102	C #1) -93.3467	D #1) -93.342937	F #1) -93.203601	G #1) -93.202435
29.75381	29.75409	29.7656	29.765031	29.445276	29.445504
A #4) -93.344176	B #4) -93.339468	C #2) -93.3477	D #2) -93.340603	F #2) -93.204158	G #2) -93.201845
29.753417	29.754171	29.7639	29.764463	29.445210	29.445582
		C #3) -93.3488	D #3) -93.338872		
		29.7633	29.764955		
		C #4) -93.35213	D #4) -93.332403		
		29.762755	29.766546		
		C #5) -93.35217	D #5) -93.327805		
		29.762249	29.769837		
		C #6) -93.34982	D #6) -93.301946		
		29.761101	29.773965		
			D #7) -93.301946		
			29.775385		
			D #8) -93.301858		
			29.775385		
			D #9) -93.301848		
			29.773926		
			D #10) -93.327739		
			29.769766		
			D #11) -93.332378		
			29.766498		
			D #12) -93.338865		
			29.764915		
			D #13) -93.340614		
			29.764416		
			D #14) -93.338804		
			29.763207		
			D #15) -93.337451		
			29.764015		
			D #16) -93.337516		
			29.765369		