

JOINT PUBLIC NOTICE

February 17, 2020

United States Army
Corps of Engineers
New Orleans District
Attn: Regulatory Branch
7400 Leake Ave.
New Orleans, Louisiana 70118-3651

State of Louisiana
Department of Environmental Quality
Attn: Water Quality Certifications
Post Office Box 4313
Baton Rouge, Louisiana 70821-4313

Project Manager:
Sara Fortuna
(504) 862-2284
Sara.b.fortuna@usace.army.mil
Application #: MVN-2016-00405 WKK

Project Manager:
Elizabeth Hill
(225) 219-3225
WQC Application Number:
WQC-200203-01

Interested parties are hereby notified that a permit application has been received by the New Orleans District of the U.S. Army Corps of Engineers pursuant to: [X] Section 10 of the Rivers and Harbors Act of March 3, 1899 (30 Stat. 1151; 33 USC 403); and/or [X] Section 404 of the Clean Water Act (86 Stat. 816; 33 USC 1344).

The application has also been mailed to the Louisiana Department of Environmental Quality, for a Water Quality Certification (WQC) in accordance with statutory authority contained in Louisiana Revised Statute 30:2074 A(3), and provisions of Section 401 of the Clean Water Act (P.L. 95-17).

DREDGING AND WELL STRUCTURES IN TERREBONNE PARISH

NAME OF APPLICANT: Castex Energy, Inc., c/o RCCS, L.L.C., Post Office Box 2182, Covington, Louisiana 70434-2182.

LOCATION OF WORK: Fourleague Bay, located approximately 30.5 miles south of Morgan City, in Terrebonne Parish, Louisiana, as shown on the enclosed drawings.

Location: Latitude: 29.282033° N / Longitude: -91.140347° W, Hydrologic Unit Code: 08090302 – Terrebonne Basin.

CHARACTER OF WORK: Conduct dredging and hand jetting operations, install four 8-inch diameter pipelines, a 40-foot wide by 40-foot long pile supported platform, a 3-foot wide by 130-foot long walkway, a 7-foot wide by 30-foot long platform, a 70-foot wide by 250-foot long rock pad, and place a drilling barge on location, all to access and drill the Oyster Bayou South Prospects Nos. 1 and 2 in Fourleague Bay. Approximately 133,127.98 cubic yards of earthen material via dredging operations, 21,112 cubic yards of earthen material via hand jetting operations, and 1,296 cubic yards of rock via rock pad construction would be temporarily placed during project implementation. Approximately 93.41 acres of non-wetland waters would be temporarily impacted via project implementation.

The comment period for the Department of the Army Permit and the Louisiana Department of Environmental Quality WQC will close **20 days** from the date of this joint public notice. Written comments, including suggestions for modifications or objections to the proposed work, stating reasons thereof, are being solicited from anyone having interest in this permit and/or this WQC request and must be submitted so as to be received before or by the last day of the comment period. Letters concerning the Corps of Engineers permit application must reference the applicant's name and the Permit Application Number, and be forwarded to the Corps of Engineers at the address above, **ATTENTION: REGULATORY BRANCH**. Individuals or parties may request an extension of time in which to comment on the proposed work by writing or e-mailing the Corps of Engineers Project Manager listed above. Any request must be specific and substantively supportive of the requested extension, and received by this office prior to the end of the initial comment period. The Section Chief will review the request and the requestor will be promptly notified of the decision to grant or deny the request. If granted, the time extension will be continuous to the initial comment period and, inclusive of the initial comment period, will not exceed a total of 30 calendar days. Letters concerning the Water Quality Certification must reference the applicant's name and the WQC Application number and be mailed to the Louisiana Department of Environmental Quality at the address above.

The application for this proposed project is on file with the Louisiana Department of Environmental Quality and may be examined during weekdays between 8:00 a.m. and 4:30 p.m. Copies may be obtained upon payment of costs of reproduction.

Corps of Engineers Permit Criteria

The decision whether to issue a permit will be based on an evaluation of the probable impacts, including cumulative impacts of the proposed activity on the public interest. That decision will reflect the national concern for both protection and utilization of important resources. The benefit which reasonably may be expected to accrue from the proposal must be balanced against its reasonably foreseeable detriments. All factors which may be relevant to the proposal will be considered including the cumulative effects thereof; among those are conservation, economics, aesthetics, general environmental concerns, wetlands, historic properties, fish and wildlife values, flood hazards, floodplain values, land use, navigation, shoreline erosion and accretion, recreation, water supply and conservation, water quality, energy needs, safety, food and fiber production, mineral needs, considerations of property ownership and, in general, the needs and welfare of the people.

The U.S. Army Corps of Engineers is soliciting comments from the public, federal, state, and local agencies and officials, Indian Tribes, and other interested parties in order to consider and evaluate the impacts of this proposed activity. Any comments received will be considered by the U.S. Army Corps of Engineers to determine whether to make, modify, condition, or deny a permit for this proposal. To make this decision, comments are used to assess impacts on endangered species, historic properties, water quality, general environmental effects, and other public interest factors listed above. Comments are used in the preparation of an Environmental Assessment and/or an Environmental Impact Statement pursuant to the National Environmental Policy Act. Comments are also used to determine the need for a public hearing and to determine the overall public interest of the proposed activity.

The possibility exists that the proposed work may damage or destroy presently unknown archeological, scientific, prehistorical, historical sites, or data. Copies of this public notice are being sent to the State Archeologist and State Historic Preservation Officer regarding potential impacts to cultural resources.

Our initial finding is that the proposed work would neither affect any species listed as endangered by the U.S. Departments of Interior or Commerce, nor affect any habitat designated as critical to the survival and recovery of any endangered species. Based on the South Louisiana **Standard Local Operating Procedure for Endangered Species (SLOPES)**, as signed on October 22, 2014, between the U.S. Army Corps of Engineers, New Orleans and the U.S. Fish and Wildlife Service, it has been determined that the project is located in waters known to be utilized by the West Indian Manatee (*Trichechus manatus*) and determined that the activity is not likely to adversely affect this species. If this permit modification/time extension is issued, the permittee will be required to follow the SLOPES conditions.

This notice initiates the Essential Fish Habitat (EFH) consultation requirements of the Magnuson-Stevens Fishery Conservation and Management Act. The applicant's proposal may result in the destruction, alteration, and/or disturbance of **93.41** acres of EFH utilized by various life stages of red drum and penaeid shrimp. Our initial determination is that the proposed action would not have a substantial adverse impact on EFH or federally managed fisheries in the Gulf of Mexico. Our final determination relative to project impacts and the need for mitigation measures is subject to review by and coordination with the National Marine Fisheries Service.

If the proposed work involves deposits of dredged or fill material into navigable waters, the evaluation of the probable impacts will include the application of guidelines established by the Administrator of the Environmental Protection Agency. Also, a certification that the proposed activity will not violate applicable water quality standards will be required from the Department of Environmental Quality, before a Department of the Army permit is issued.

Any person may request, in writing, within the comment period specified in this notice, that a public hearing be held to consider this application. Requests for public hearings shall state, with particularity, the reasons for holding a public hearing.

The applicant has certified that the proposed activity described in the application complies with and will be conducted in a manner that is consistent with the Louisiana Coastal Resources Program. The Department of the Army permit will not be issued unless the applicant received approval or a waiver of the Coastal Use Permit by the Department of Natural Resources.

You are invited to communicate the information contained in this notice to any other parties whom you deem likely to have interest in the matter.

Darrell S. Barbara
Chief, Western Evaluation Section
Regulatory Branch

Enclosure

Approximately 30.5 miles south of Morgan City

ARKANSAS

TEXAS

VICINITY MAP

MISSISSIPPI

Terrebonne Parish, LA.

GULF OF MEXICO

LOUISIANA COORDINATE SYSTEM (SOUTH ZONE)
(1983 DATUM)

OYSTER BAYOU PRODUCTION FACILITY

PROPOSED
4 x 8" FLOWLINES

PREVIOUSLY PERMIT
ACCESS ROUTE
PERMIT # P20050772

PROPOSED
ACCESS ROUTE

PROJECT
VICINITY

PREVIOUSLY PERMITTED
ACCESS ROUTE
PERMIT # P20160191

Lighthouse

Big Hellhole Lake

LEGEND:

- DENOTES PROPOSED ACCESS ROUTE
- DENOTES PREVIOUSLY PERMITTED ACCESS ROUTE (P20050772)
- DENOTES PREVIOUSLY PERMITTED ACCESS ROUTE (P20160191)
- 7.7 DENOTES WATER DEPTH

DRAWN BY:	L.J.B.	APPROVED BY:	R.J.H.
DATE:	8/7/2019	JOB NO:	2019.0404
DRAWING NAME:	2019.0404_P01-08.DWG		
SHEET NO:	1	OF	11
PROJECTION:	LOUISIANA SOUTH		
GEO. DATUM:	NAD83 VERT. DATUM: NAVD88		
GRID UNITS:	US SURVEY FEET		

VICINITY MAP

CASTEX ENERGY, INC.
 PROPOSED DREDGING TO ACCESS
 OYSTER BAYOU SOUTH PROSPECTS 001 & 002
 IN FOURLEAGUE BAY
 LOCATED IN T20S - R13E
 TERREBONNE PARISH, LOUISIANA

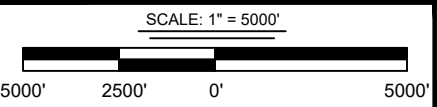

T. BAKER SMITH
 A CENTURY OF SOLUTIONS
 412 South Van Ave, Houma, LA 70363
 (855) 666-1656 - tbsmith.com

REV. NO:	01	REV. DATE:	10/18/2019	REV. BY:	BLC
REVISION DESCRIPTION: VARIOUS REVISIONS					

10/18/2019 - P:\Y-2019\2019.0404\DWG\PERMIT\2019.0404_P01-10_REV01B.DWG

10/18/2019 - P:\Y-2019\2019.0404\DWG\PERMIT2019.0404_P01-10_REV01B.DWG

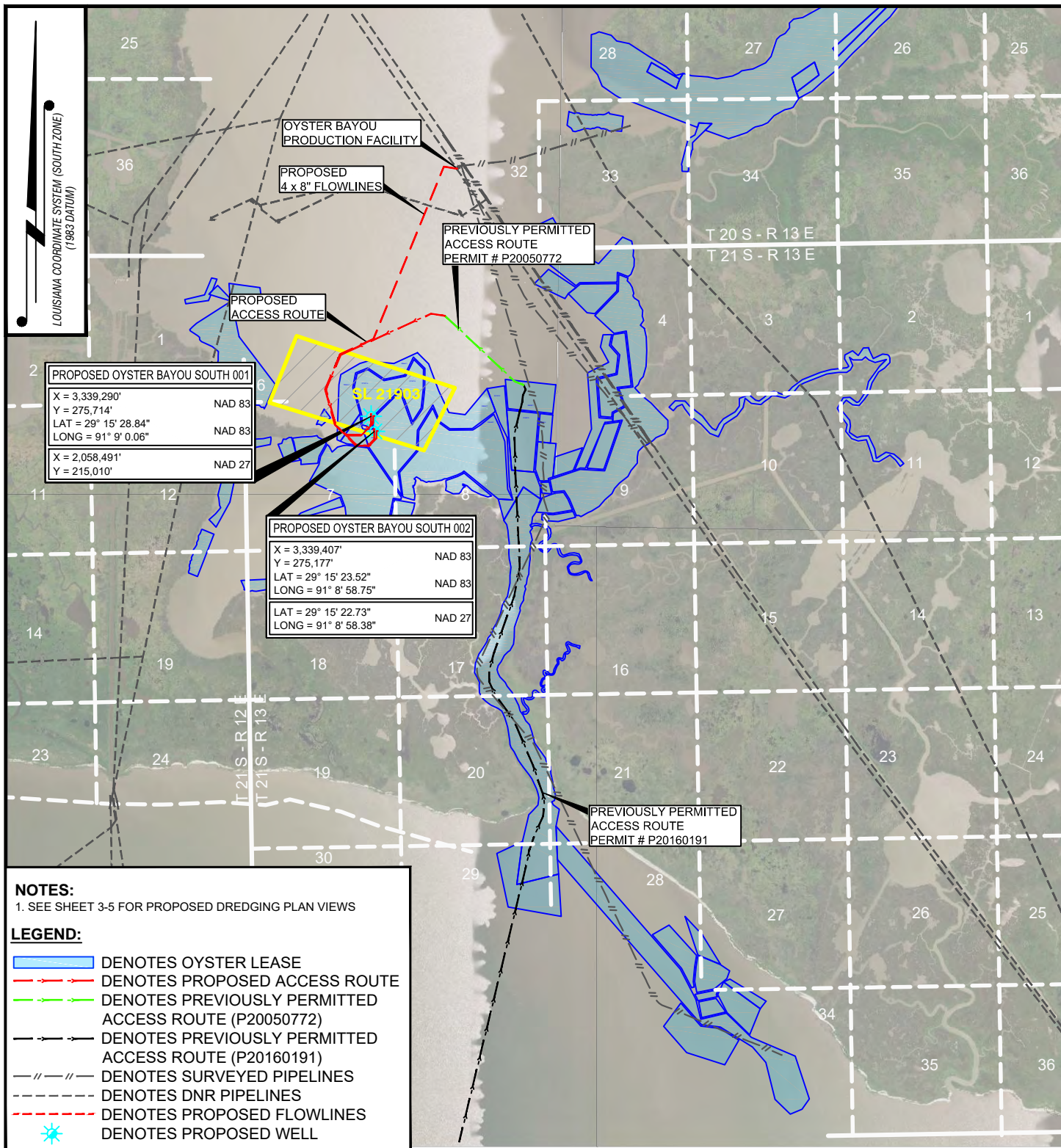

DRAWN BY:	L.J.B.	APPROVED BY:	R.J.H.
DATE:	8/7/2019	JOB NO:	2019.0404
DRAWING NAME:	2019.0404_P01-08.DWG		
SHEET NO:	2	OF	11
PROJECTION:	LOUISIANA SOUTH		
GEO. DATUM:	NAD83 VERT. DATUM: NAVD88		
GRID UNITS:	US SURVEY FEET		

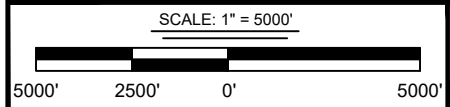

ACCESS ROUTE

CASTEX ENERGY, INC.
 PROPOSED DREDGING TO ACCESS
 OYSTER BAYOU SOUTH PROSPECTS 001 & 002
 IN FOURLEAGUE BAY
 LOCATED IN T20S - R13E
 TERREBONNE PARISH, LOUISIANA

<p>T. BAKER SMITH A CENTURY OF SOLUTIONS 412 South Van Ave., Houma, LA 70363 (865) 968-1650 - tbsmith.com</p>	REV. NO: 01	REV. DATE: 10/18/2019	REV. BY: BLC
	REVISION DESCRIPTION: VARIOUS REVISIONS		

10/18/2019 - P:\Y-2019\2019.0404\DWG\PERMIT\2019.0404_P01-10_REV01B.DWG

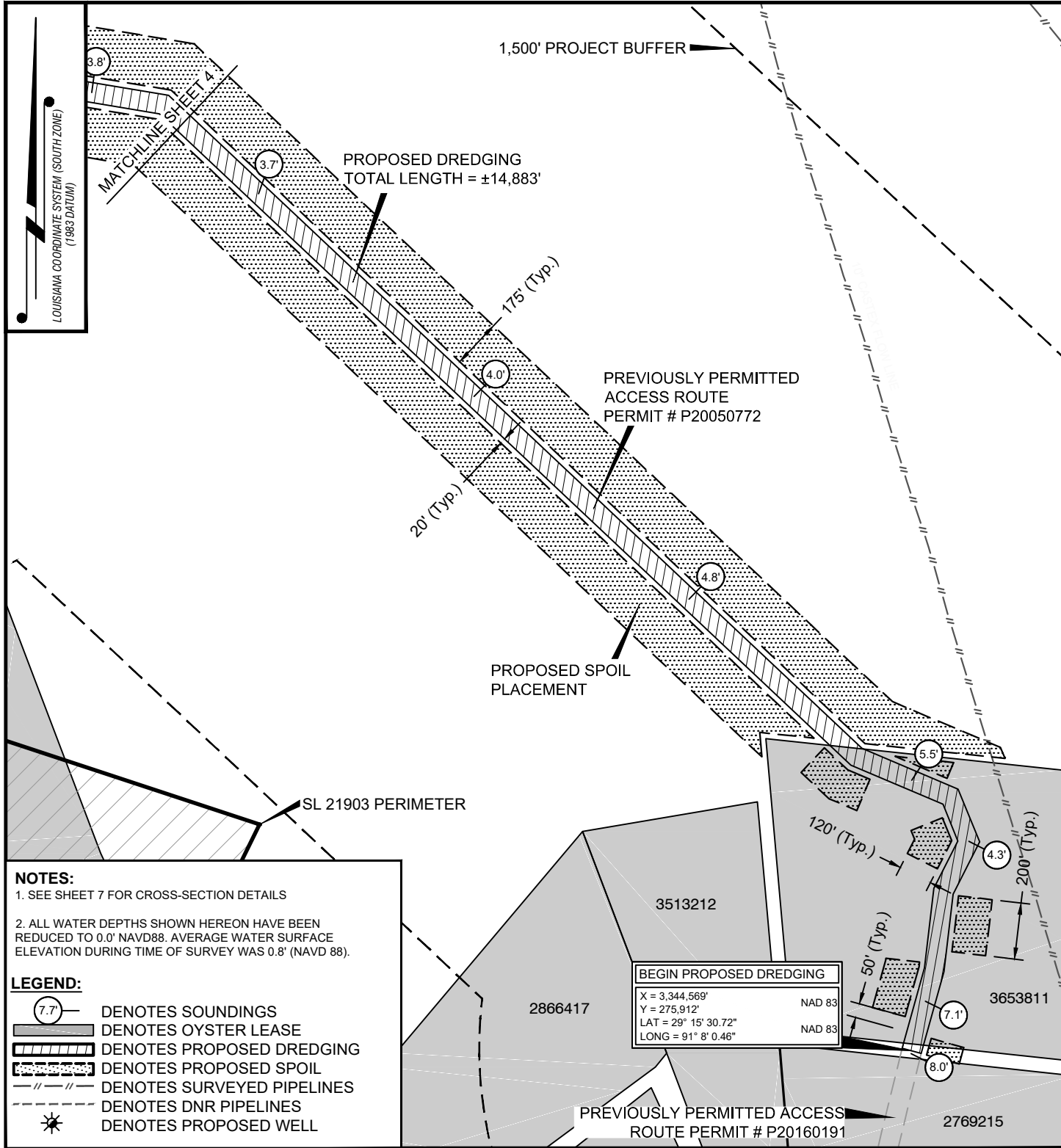

NOTES:
 1. SEE SHEET 7 FOR CROSS-SECTION DETAILS
 2. ALL WATER DEPTHS SHOWN HEREON HAVE BEEN REDUCED TO 0.0' NAVD88. AVERAGE WATER SURFACE ELEVATION DURING TIME OF SURVEY WAS 0.8' (NAVD 88).

LEGEND:

- 7.7 DENOTES SOUNDINGS
- DENOTES OYSTER LEASE
- DENOTES PROPOSED DREDGING
- DENOTES PROPOSED SPOIL
- DENOTES SURVEYED PIPELINES
- DENOTES DNR PIPELINES
- DENOTES PROPOSED WELL

DRAWN BY: L.J.B.	APPROVED BY: R.J.H.
DATE: 8/7/2019	JOB NO: 2019.0404
DRAWING NAME: 2019.0404_P01-08.DWG	
SHEET NO: 3 OF 11	
PROJECTION: LOUISIANA SOUTH GEO. DATUM: NAD83 VERT. DATUM: NAVD88 GRID UNITS: US SURVEY FEET	

PLAN VIEW

CASTEX ENERGY, INC.
 PROPOSED DREDGING TO ACCESS
 OYSTER BAYOU SOUTH PROSPECTS 001 & 002
 IN FOURLEAGUE BAY
 LOCATED IN T20S - R13E
 TERREBONNE PARISH, LOUISIANA

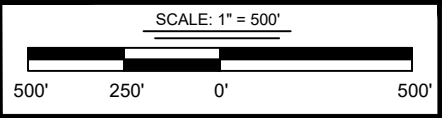

T. BAKER SMITH
 A CENTURY OF SOLUTIONS
 412 South Van Ave. Houma, LA 70363
 (865) 968-1650 - tbsmith.com

REV. NO: 01	REV. DATE: 10/18/2019	REV. BY: BLC
REVISION DESCRIPTION: VARIOUS REVISIONS		

10/18/2019 - P:\Y-2019\2019.0404\DWG\PERMIT\2019.0404_P01-10_REV01B.DWG

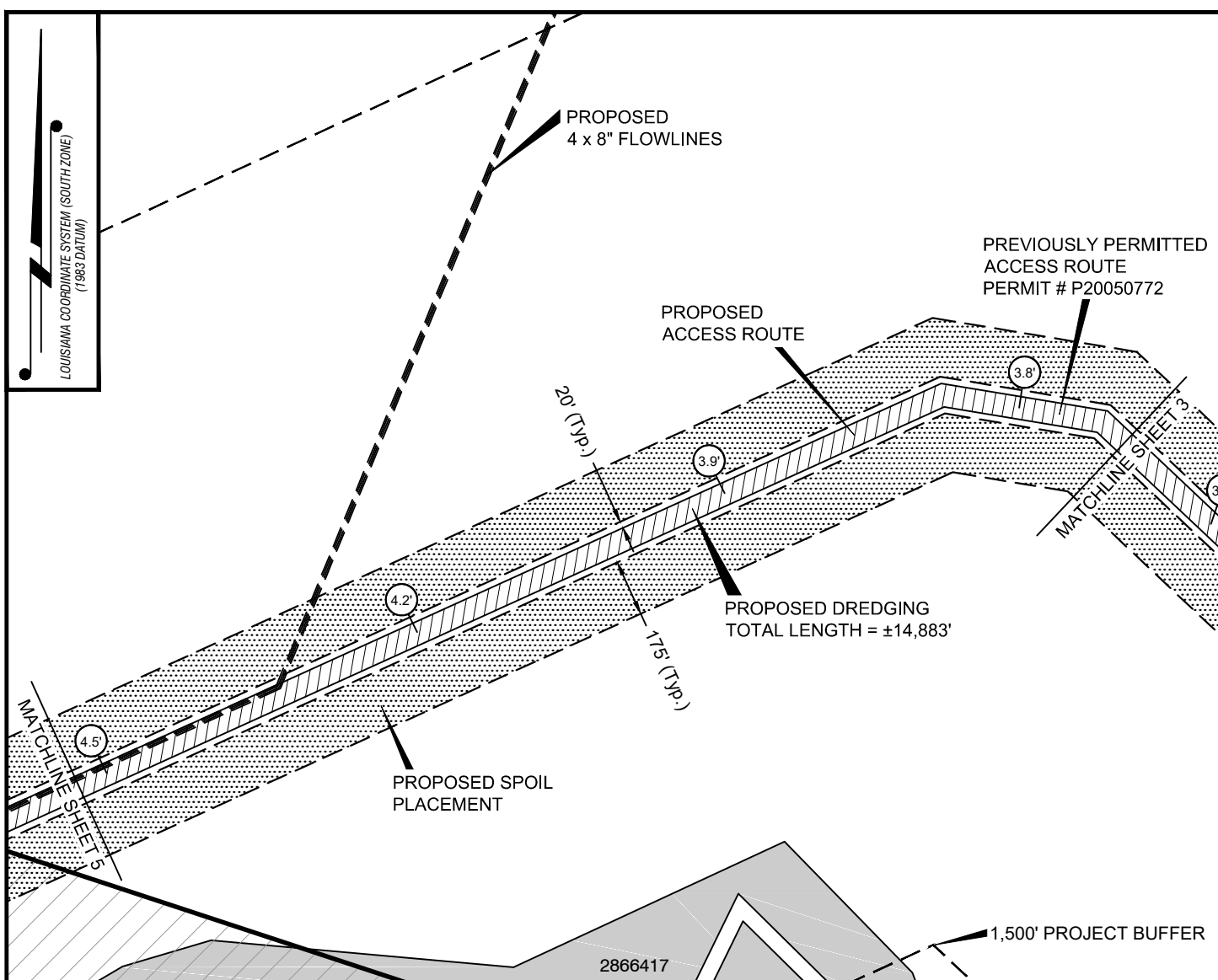

NOTES:
 1. SEE SHEET 7 FOR CROSS-SECTION DETAILS
 2. ALL WATER DEPTHS SHOWN HEREON HAVE BEEN REDUCED TO 0.0' NAVD88. AVERAGE WATER SURFACE ELEVATION DURING TIME OF SURVEY WAS 0.8' (NAVD 88).

LEGEND:
 (7.7) DENOTES SOUNDINGS
 [Hatched pattern] DENOTES OYSTER LEASE
 [Diagonal hatching] DENOTES PROPOSED DREDGING
 [Dotted pattern] DENOTES PROPOSED SPOIL
 [Double line] DENOTES SURVEYED PIPELINES
 [Dashed line] DENOTES DNR PIPELINES
 [Dash-dot line] DENOTES PROPOSED FLOWLINES
 [Star symbol] DENOTES PROPOSED WELL

DRAWN BY: L.J.B.	APPROVED BY: R.J.H.
DATE: 8/7/2019	JOB NO: 2019.0404
DRAWING NAME: 2019.0404_P01-08.DWG	
SHEET NO: 4 OF 11	
PROJECTION: LOUISIANA SOUTH GEO. DATUM: NAD83 VERT. DATUM: NAVD88 GRID UNITS: US SURVEY FEET	

PLAN VIEW

CASTEX ENERGY, INC.
 PROPOSED DREDGING TO ACCESS
 OYSTER BAYOU SOUTH PROSPECTS 001 & 002
 IN FOURLEAGUE BAY
 LOCATED IN T20S - R13E
 TERREBONNE PARISH, LOUISIANA

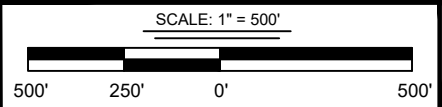

REV. NO: 01	REV. DATE: 10/18/2019	REV. BY: BLC
REVISION DESCRIPTION: VARIOUS REVISIONS		

10/18/2019 - P:\Y-2019\2019.0404\DWG\PERMIT\2019.0404_P01-10_REV01B.DWG

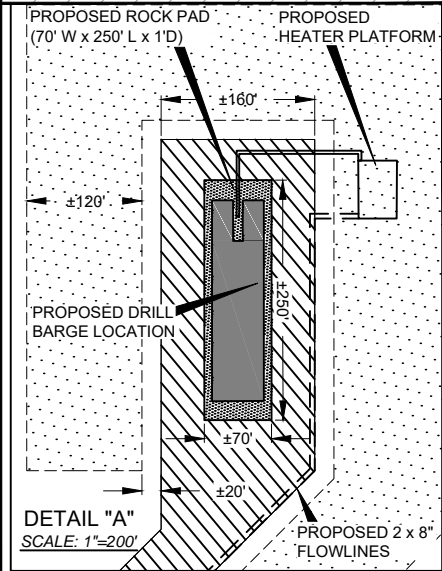
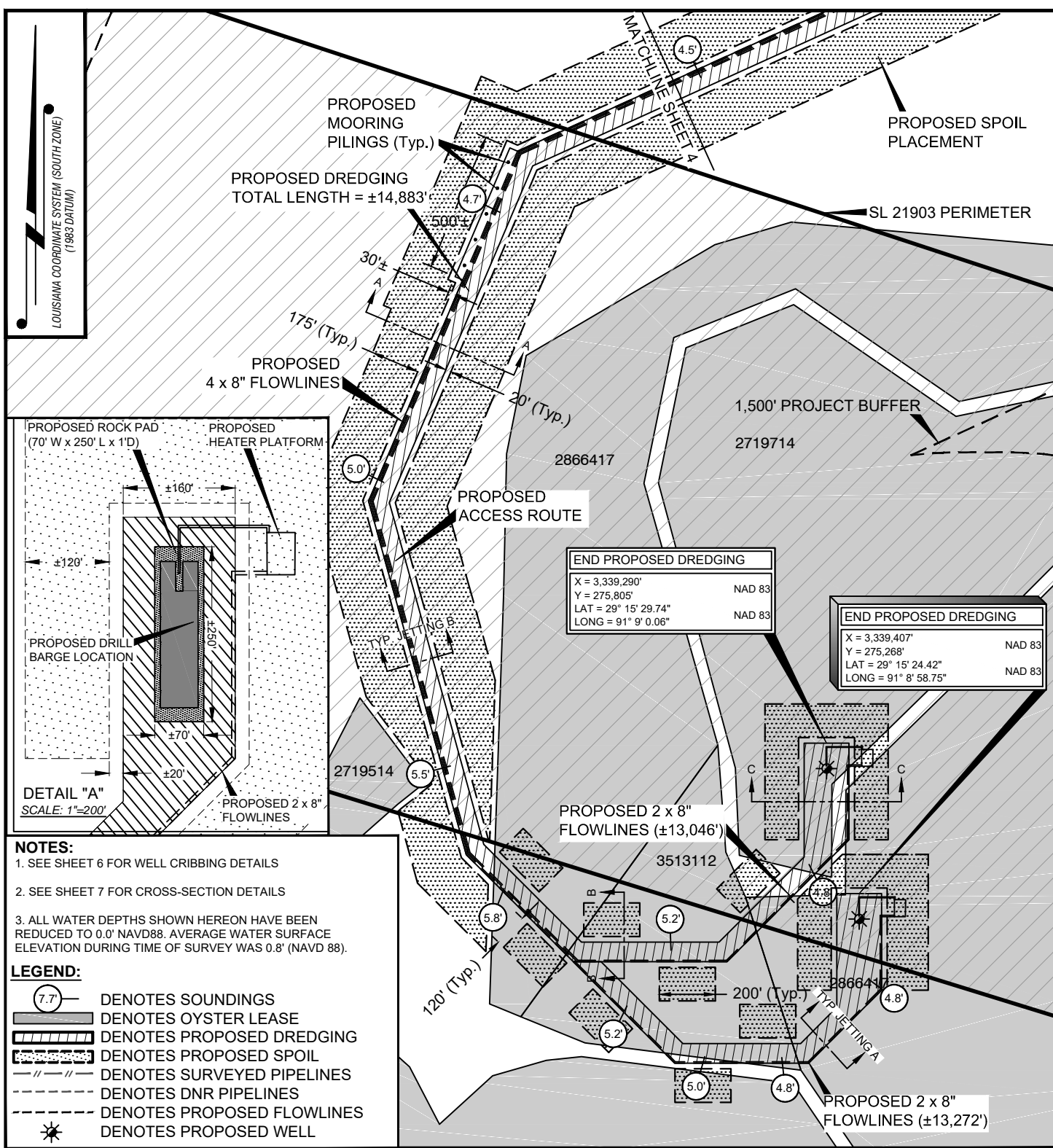

NOTES:

1. SEE SHEET 6 FOR WELL CRIBBING DETAILS
2. SEE SHEET 7 FOR CROSS-SECTION DETAILS
3. ALL WATER DEPTHS SHOWN HEREON HAVE BEEN REDUCED TO 0.0' NAVD88. AVERAGE WATER SURFACE ELEVATION DURING TIME OF SURVEY WAS 0.8' (NAVD 88).

LEGEND:

- (7.7) DENOTES SOUNDINGS
- ▨ DENOTES OYSTER LEASE
- ▨ DENOTES PROPOSED DREDGING
- ▨ DENOTES PROPOSED SPOIL
- DENOTES SURVEYED PIPELINES
- - - DENOTES DNR PIPELINES
- - - DENOTES PROPOSED FLOWLINES
- ⊗ DENOTES PROPOSED WELL

END PROPOSED DREDGING
 X = 3,339,290' NAD 83
 Y = 275,805' NAD 83
 LAT = 29° 15' 29.74" NAD 83
 LONG = 91° 9' 0.06" NAD 83

END PROPOSED DREDGING
 X = 3,339,407' NAD 83
 Y = 275,268' NAD 83
 LAT = 29° 15' 24.42" NAD 83
 LONG = 91° 8' 58.75" NAD 83

DRAWN BY: L.J.B.	APPROVED BY: R.J.H.
DATE: 8/7/2019	JOB NO: 2019.0404
DRAWING NAME: 2019.0404_P01-08.DWG	
SHEET NO: 5 OF 11	
PROJECTION: LOUISIANA SOUTH GEO. DATUM: NAD83 VERT. DATUM: NAVD88 GRID UNITS: US SURVEY FEET	

PLAN VIEW

CASTEX ENERGY, INC.
 PROPOSED DREDGING TO ACCESS
 OYSTER BAYOU SOUTH PROSPECTS 001 & 002
 IN FOURLEAGUE BAY
 LOCATED IN T20S - R13E
 TERREBONNE PARISH, LOUISIANA

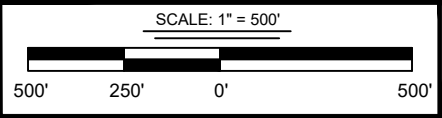

REV. NO: 01	REV. DATE: 10/18/2019	REV. BY: BLC
REVISION DESCRIPTION: VARIOUS REVISIONS		

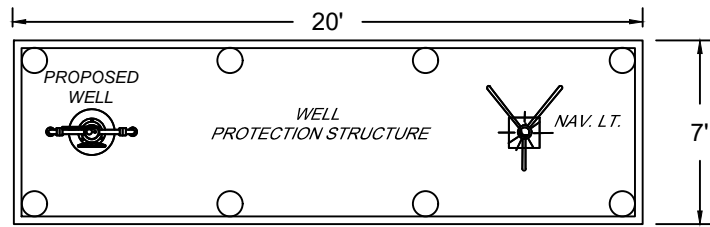

TOP VIEW

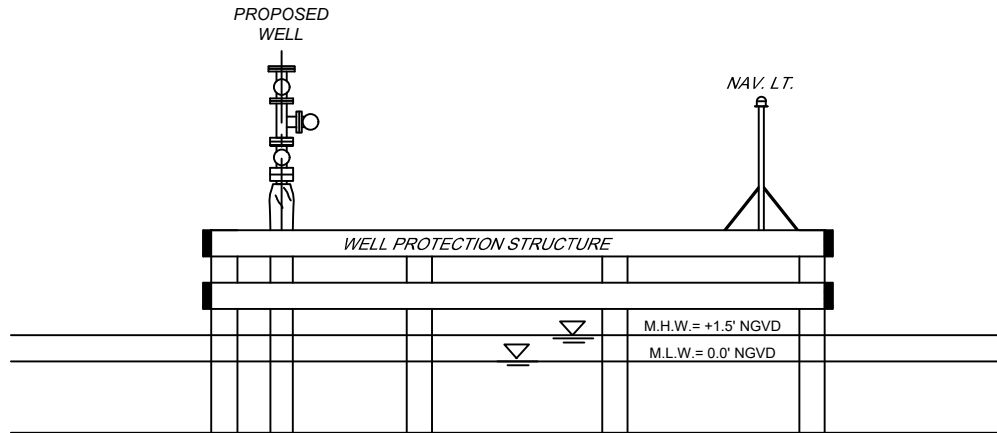

PLAN VIEW

TYPICAL PROTECTION STRUCTURE DETAIL

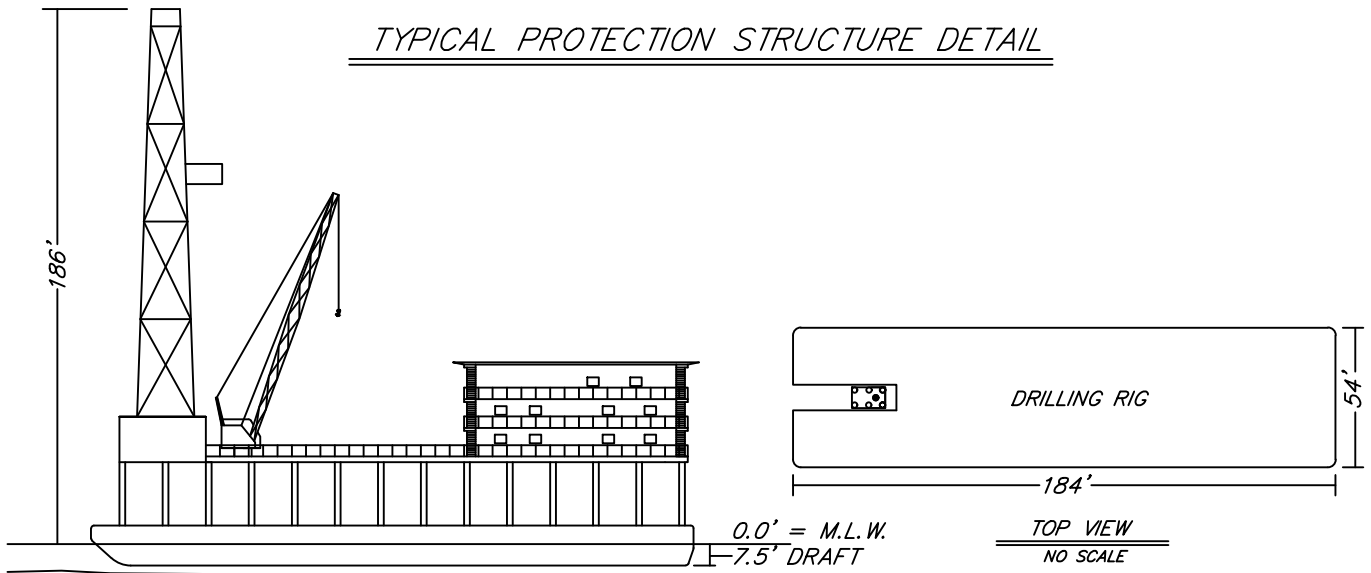

PROFILE VIEW
NO SCALE

TOP VIEW
NO SCALE

TYPICAL DRILLING RIG & PROTECTION STRUCTURE

DRAWN BY:	L.J.B.	APPROVED BY:	R.J.H.
DATE:	8/7/2019	JOB NO:	2019.0404
DRAWING NAME:	2019.0404_P01-08.DWG		
SHEET NO:	6	OF	11
PROJECTION: LOUISIANA SOUTH GEO. DATUM: NAD83 VERT. DATUM: NAVD88 GRID UNITS: US SURVEY FEET			

DETAILS

CASTEX ENERGY, INC.
 PROPOSED DREDGING TO ACCESS
 OYSTER BAYOU SOUTH PROSPECTS 001 & 002
 IN FOURLEAGUE BAY
 LOCATED IN T20S - R13E
 TERREBONNE PARISH, LOUISIANA

NOT TO SCALE



REV. NO: 01 REV. DATE: 10/18/2019 REV. BY: BLC

REVISION DESCRIPTION:
VARIOUS REVISIONS

TYPICAL PLATFORM
NOT TO SCALE

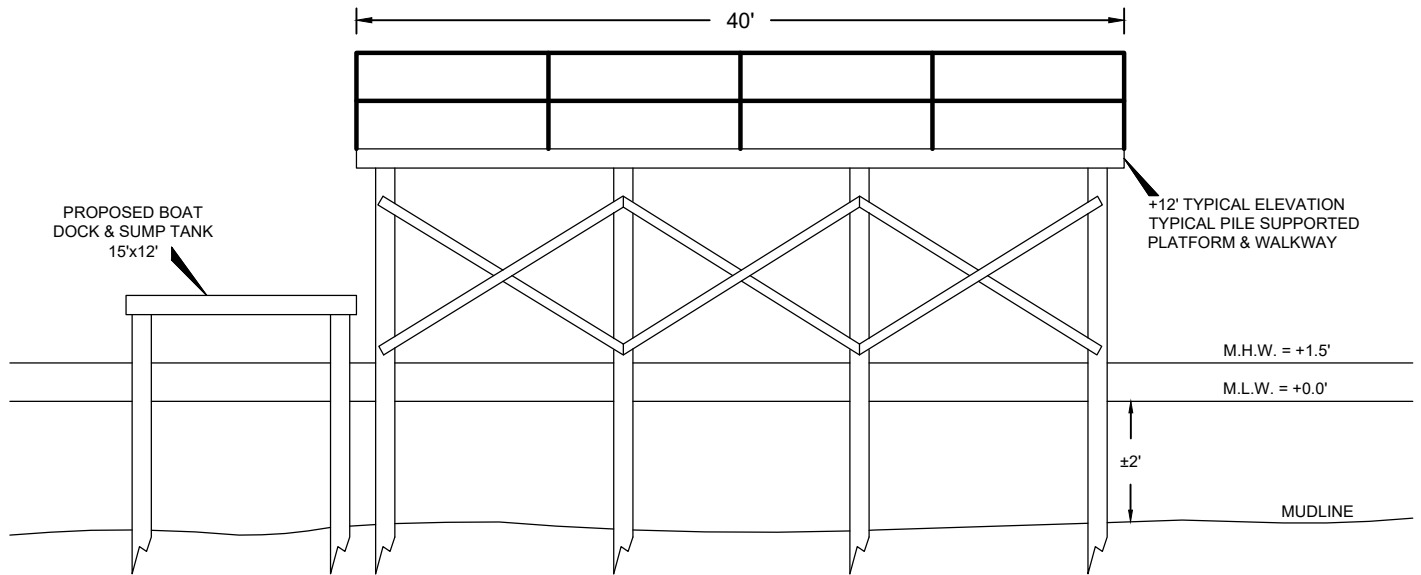
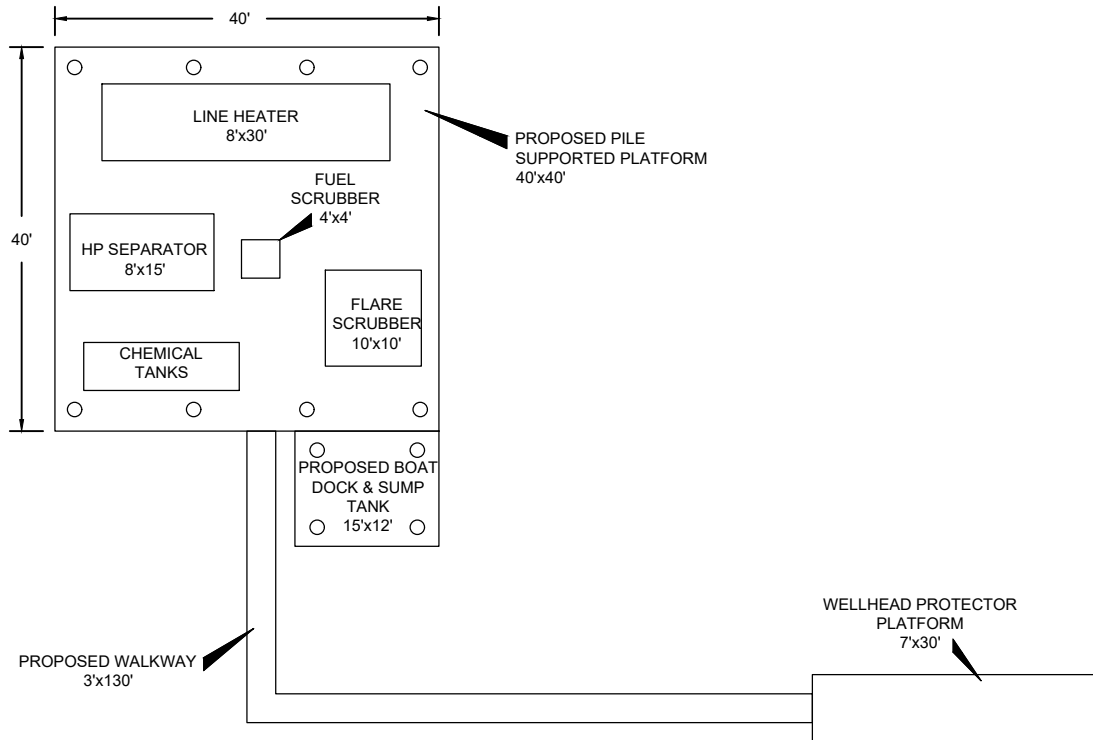

TYPICAL PLATFORM
NOT TO SCALE

DRAWN BY:	L.J.B.	APPROVED BY:	R.J.H.
DATE:	8/7/2019	JOB NO:	2019.0404
DRAWING NAME:	2019.0404_P01-08.DWG		
SHEET NO:	7	OF	11
PROJECTION: LOUISIANA SOUTH GEO. DATUM: NAD83 VERT. DATUM: NAVD88 GRID UNITS: US SURVEY FEET			

TYPICAL
CASTEX ENERGY, INC.
PROPOSED DREDGING TO ACCESS
OYSTER BAYOU SOUTH PROSPECTS 001 & 002
IN FOURLEAGUE BAY
LOCATED IN T20S - R13E
TERREBONNE PARISH, LOUISIANA

NOT TO SCALE



T. BAKER SMITH
A CENTURY OF SOLUTIONS
412 South Van Ave. Houma, LA 70363
(985) 866-1650 - tbsmith.com

REV. NO:	01	REV. DATE:	10/18/2015	REV. BY:	BLC
REVISION DESCRIPTION: VARIOUS REVISIONS					

10/18/2019 - P:\Y-2019\2019.0404\DWG\PERMIT\2019.0404_P01-10_REV01B.DWG

POB @ PROPOSED WALKWAY

POE @ EXISTING OYSTER BAYOU PRODUCTION FACILITY

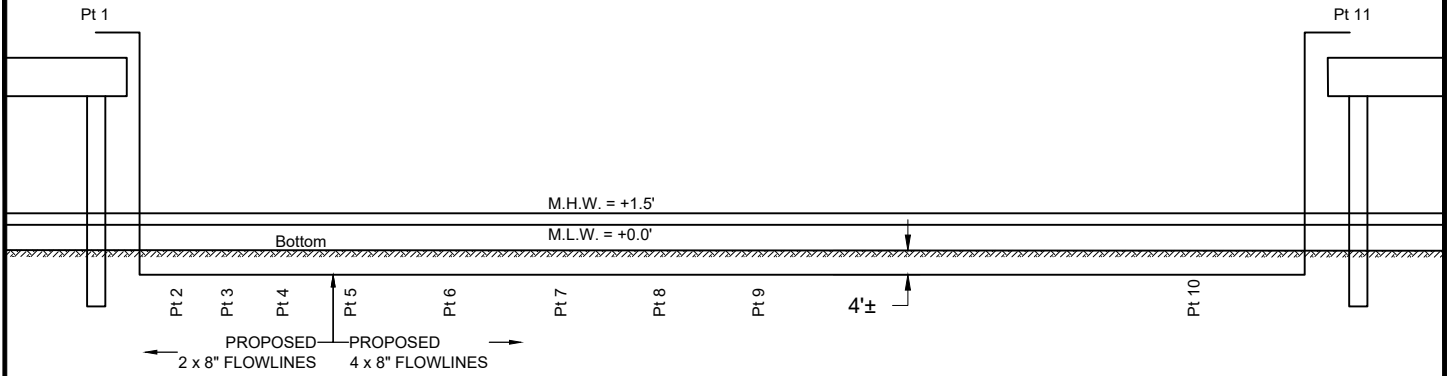

Point No.	Coordinates (NAD 27)		Coordinates (NAD 83)		Coordinates (NAD 83)		Description
	Easting	Northing	Easting	Northing	Latitude	Longitude	
1	2,058,617	215,018	3,339,416	275,722	29° 15' 28.92"	91° 08' 58.65"	POB
2	2,058,571	215,018	3,339,370	275,722	29° 15' 28.92"	91° 08' 59.16"	PI
3	2,058,571	214,756	3,339,370	275,460	29° 15' 26.32"	91° 08' 59.17"	PI
4	2,058,136	214,320	3,338,935	275,024	29° 15' 22.01"	91° 09' 04.09"	PI
5	2,057,601	214,320	3,338,400	275,024	29° 15' 22.02"	91° 09' 10.13"	PI
6	2,057,213	214,708	3,338,012	275,412	29° 15' 25.87"	91° 09' 14.50"	PI
7	2,056,865	215,965	3,337,664	276,669	29° 15' 38.32"	91° 09' 18.40"	PI
8	2,057,395	217,208	3,338,194	277,912	29° 15' 50.62"	91° 09' 12.40"	PI
9	2,058,575	217,744	3,339,375	278,448	29° 15' 55.91"	91° 08' 59.06"	PI
10	2,061,073	223,861	3,341,872	284,565	29° 16' 56.42"	91° 08' 30.75"	PI
11	2,061,546	223,798	3,342,346	284,502	29° 16' 55.79"	91° 08' 25.40"	POE

COORDINATES ARE FOR PERMITTING PURPOSES ONLY

TYPICAL A HAND JETTING
NOT TO SCALE

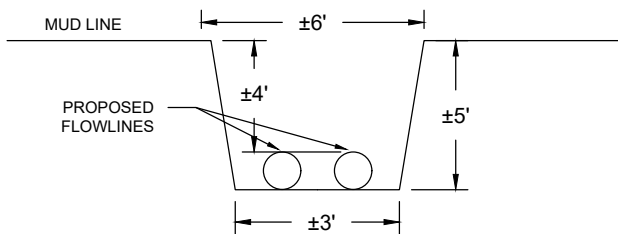

TYPICAL B HAND JETTING
NOT TO SCALE

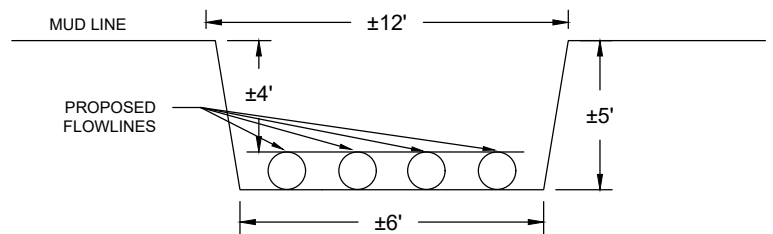

HAND JETTED TRENCH TO BE BACKFILLED BY NATURALLY OCCURRING SEDIMENTATION

DRAWN BY: L.J.B.	APPROVED BY: R.J.H.	<p>TYPICAL</p> <p>CASTEX ENERGY, INC.</p> <p>PROPOSED DREDGING TO ACCESS</p> <p>OYSTER BAYOU SOUTH PROSPECTS 001 & 002</p> <p>IN FOURLEAGUE BAY</p> <p>LOCATED IN T20S - R13E</p> <p>TERREBONNE PARISH, LOUISIANA</p>
DATE: 8/7/2019	JOB NO: 2019.0404	
DRAWING NAME: 2019.0404_P01-08.DWG		
SHEET NO: 8 OF 11		
PROJECTION: LOUISIANA SOUTH GEO. DATUM: NAD83 VERT. DATUM: NAVD88 GRID UNITS: US SURVEY FEET		
NOT TO SCALE		 <p>T. BAKER SMITH A CENTURY OF SOLUTIONS 412 South Van Ave. Houma, LA 70363 (985) 866-1650 - tbsmith.com</p>
REV. NO: 01	REV. DATE: 10/18/2019	REV. BY: BLC
REVISION DESCRIPTION: VARIOUS REVISIONS		

10/18/2019 - P:\Y-2019\2019.0404\DWG\PERMIT\2019.0404_P01-10_REV01B.DWG

POB @ PROPOSED WALKWAY

POE @ EXISTING OYSTER BAYOU PRODUCTION FACILITY

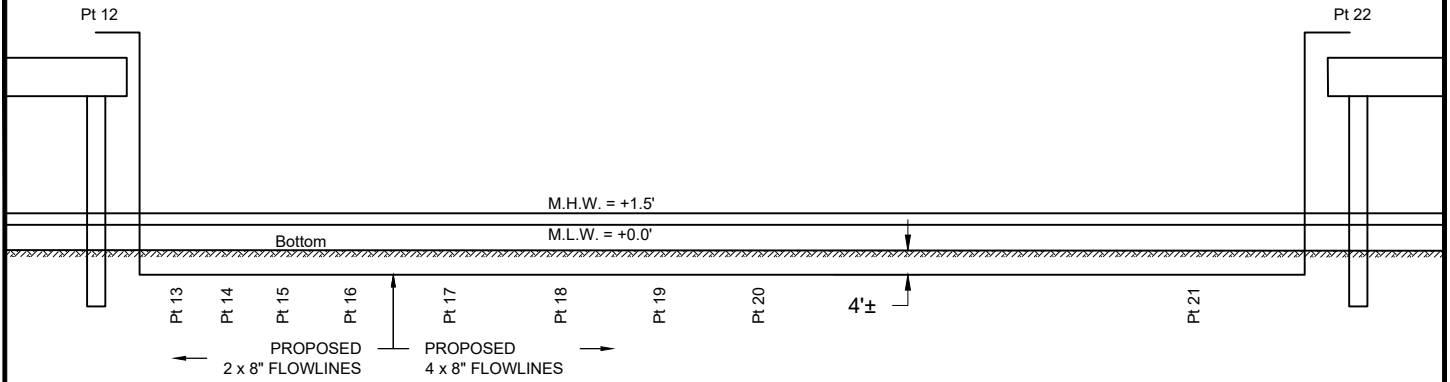

Proposed 2 x 8" Flowlines (13,825'±)							Description
Point No.	Coordinates (NAD 27)		Coordinates (NAD 83)		Coordinates (NAD 83)		
	Easting	Northing	Easting	Northing	Latitude	Longitude	
12	2,058,734	214,481	3,339,533	275,185	29° 15' 23.60"	91° 08' 57.34"	POB
13	2,058,688	214,481	3,339,487	275,185	29° 15' 23.60"	91° 08' 57.85"	PI
14	2,058,688	214,219	3,339,487	274,923	29° 15' 21.00"	91° 08' 57.86"	PI
15	2,058,427	213,958	3,339,226	274,662	29° 15' 18.43"	91° 09' 00.80"	PI
16	2,057,949	213,958	3,338,748	274,662	29° 15' 18.43"	91° 09' 06.21"	PI
17	2,057,204	214,703	3,338,003	275,406	29° 15' 25.82"	91° 09' 14.60"	PI
18	2,056,855	215,966	3,337,654	276,670	29° 15' 38.33"	91° 09' 18.52"	PI
19	2,057,387	217,216	3,338,186	277,920	29° 15' 50.69"	91° 09' 12.49"	PI
20	2,058,568	217,752	3,339,367	278,456	29° 15' 55.98"	91° 08' 59.15"	PI
21	2,061,067	223,872	3,341,866	284,576	29° 16' 56.53"	91° 08' 30.82"	PI
22	2,061,548	223,798	3,342,347	284,502	29° 16' 55.79"	91° 08' 25.39"	POE

COORDINATES ARE FOR PERMITTING PURPOSES ONLY

TYPICAL A HAND JETTING
NOT TO SCALE

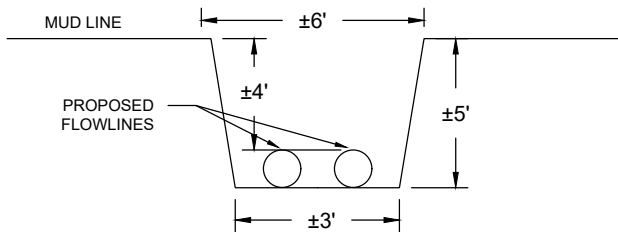

TYPICAL B HAND JETTING
NOT TO SCALE

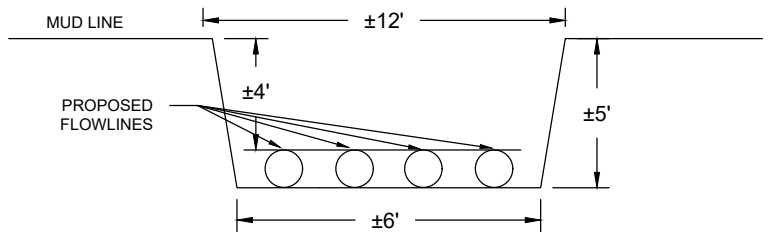

HAND JETTED TRENCH TO BE BACKFILLED BY NATURALLY OCCURRING SEDIMENTATION

DRAWN BY: L.J.B.	APPROVED BY: R.J.H.	<p>TYPICAL</p> <p>CASTEX ENERGY, INC.</p> <p>PROPOSED DREDGING TO ACCESS</p> <p>OYSTER BAYOU SOUTH PROSPECTS 001 & 002</p> <p>IN FOURLEAGUE BAY</p> <p>LOCATED IN T20S - R13E</p> <p>TERREBONNE PARISH, LOUISIANA</p>
DATE: 8/7/2019	JOB NO: 2019.0404	
DRAWING NAME: 2019.0404_P01-08.DWG		
SHEET NO: 9 OF 11		
PROJECTION: LOUISIANA SOUTH GEO. DATUM: NAD83 VERT. DATUM: NAVD88 GRID UNITS: US SURVEY FEET		
NOT TO SCALE		 <p>T. BAKER SMITH A CENTURY OF SOLUTIONS 412 South Van Ave. Houma, LA 70363 (866)666-1650 - tbsmith.com</p>
REV. NO: 01	REV. DATE: 10/18/2019	REV. BY: BLC
REVISION DESCRIPTION: VARIOUS REVISIONS		

10/18/2019 - P:\Y-2019\2019.0404\DWG\PERMIT\2019.0404_P01-10_REV01B.DWG

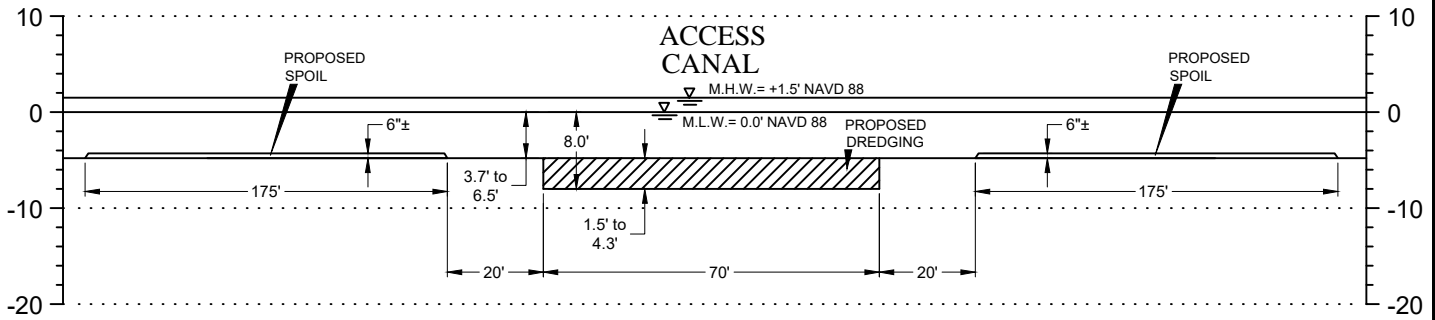

CROSS-SECTION A-A

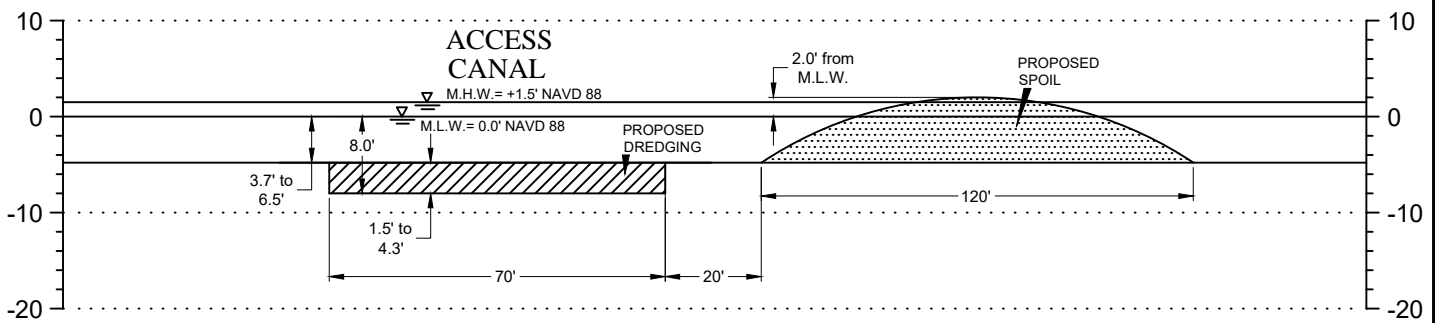

CROSS-SECTION B-B

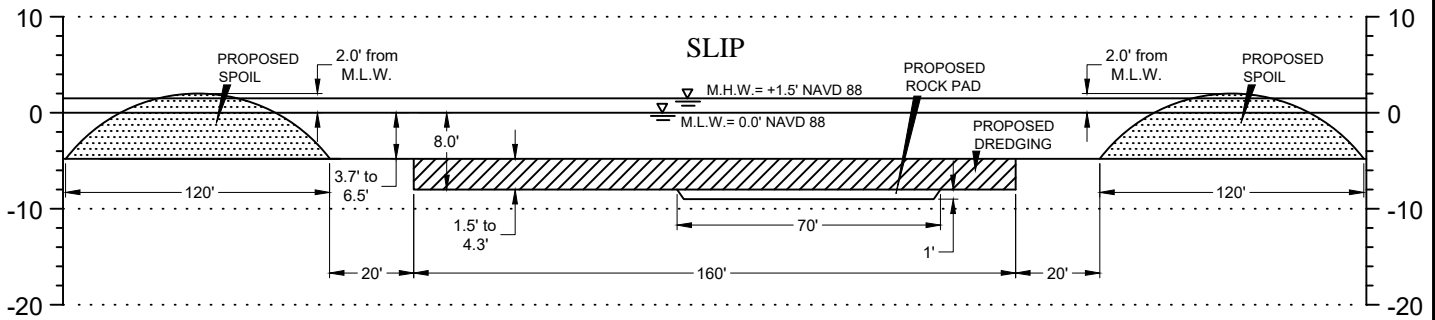

CROSS-SECTION C-C

DRAWN BY:	L.J.B.	APPROVED BY:	R.J.H.
DATE:	8/7/2019	JOB NO:	2019.0404
DRAWING NAME:	2019.0404_P01-08.DWG		
SHEET NO:	10	OF	11
PROJECTION: LOUISIANA SOUTH GEO. DATUM: NAD83 VERT. DATUM: NAVD88 GRID UNITS: US SURVEY FEET			

CROSS SECTIONS & NOTES

CASTEX ENERGY, INC.
PROPOSED DREDGING TO ACCESS
OYSTER BAYOU SOUTH PROSPECTS 001 & 002
IN FOURLEAGUE BAY
LOCATED IN T20S - R13E
TERREBONNE PARISH, LOUISIANA

NOT TO SCALE



REV. NO:	01	REV. DATE:	10/18/2019	REV. BY:	BLC
REVISION DESCRIPTION: VARIOUS REVISIONS					

NOTES

1. As-built drawings and/or plats shall have written on them the date of completion of said activities and shall be submitted to the Louisiana Department of Natural Resources, Office of Coastal Management, P. O. Box 44487, Baton Rouge, LA 70804-4487 within 30 days following project completion.
2. All structures built under the authorization and conditions of this permit shall be removed from the site within 120 days of abandonment of the facilities for the herein permitted use, or when these structures fall into a state of disrepair such that they can no longer function as intended. This condition does not preclude the necessity for revising the current permit or obtaining a separate Coastal Use Permit, should one be required, for such removal activities.
3. Structures must also be marked/lighted in accordance with U. S. Coast Guard regulations.
4. In order to ensure the safety of all parties, the permittee shall contact the Louisiana One Call System (1-800-272-3020) a minimum of 48 hours prior to the commencement of any excavation (digging, dredging, jetting, etc.) or demolition activity.

TOTAL IMPACTS

DREDGING

NON-VEGETATED 133,127.98 CU. YDS.
 WATER BOTTOMS: 23.92 ACS.

FILL MATERIALS

NATIVE MATERIAL: 133,127.98 CU. YDS.
 93.40 ACS.
 ROCKS: 1,296 CU. YD.

HAND JETTING

TRENCH: 3.49 ACS.

MATERIAL VOLUME: 21,112 CU. YD.

DRAWN BY: L.J.B.	APPROVED BY: R.J.H.	<h3 style="margin: 0;">CROSS SECTIONS & NOTES</h3> <p style="margin: 0;">CASTEX ENERGY, INC. PROPOSED DREDGING TO ACCESS OYSTER BAYOU SOUTH PROSPECTS 001 & 002 IN FOURLEAGUE BAY LOCATED IN T20S - R13E TERREBONNE PARISH, LOUISIANA</p>
DATE: 8/7/2019	JOB NO: 2019.0404	
DRAWING NAME: 2019.0404_P01-08.DWG		
SHEET NO: 11 OF 11		
PROJECTION: LOUISIANA SOUTH GEO. DATUM: NAD83 VERT. DATUM: NAVD88 GRID UNITS: US SURVEY FEET		
NOT TO SCALE		 <p>T. BAKER SMITH A CENTURY OF SOLUTIONS 412 South Van Ave. Houma, LA 70363 (865)666-1656 - tbsmith.com</p>
		REV. NO: 01 REV. DATE: 10/18/2019 REV. BY: BLC REVISION DESCRIPTION: VARIOUS REVISIONS