

# JOINT PUBLIC NOTICE

March 7, 2016

United States Army Corps of Engineers  
New Orleans District  
Regulatory Branch  
Post Office Box 60267  
New Orleans, Louisiana 70160-0267

State of Louisiana  
Department of Environmental Quality  
Office of Environmental Services  
Post Office Box 4313  
Baton Rouge, Louisiana 70821-4313

(504) 862-1545  
Project Manager  
S. Gail Gainey  
[Sandra.G.Gainey@usace.army.mil](mailto:Sandra.G.Gainey@usace.army.mil)  
MVN 2016-00142-CG

(225) 219-3225  
Project Manager  
Elizabeth Hill  
WQC Application Number  
WQC # 160224-02

Interested parties are hereby notified that a permit application has been received by the New Orleans District of the US Army Corps of Engineers pursuant to: [ ] Section 10 of the Rivers and Harbors Act of March 3, 1899 (30 Stat. 1151; 33 USC 403); and/or [X] Section 404 of the Clean Water Act (86 Stat. 816; 33 USC 1344).

Application has also been made to the Louisiana Department of Environmental Quality, Office of Environmental Services, for a Water Quality Certification (WQC) in accordance with statutory authority contained in LRS 30:2074 A(3) and provisions of Section 401 of the Clean Water Act.

## **CONSTRUCTION OF A RESIDENTIAL SUBDIVISION IN ASCENSION PARISH**

**NAME OF APPLICANT:** Engquist-Level Development, LLC. , c/o ELOS Environmental, LLC, 43177 East Pleasant Ridge Road, Hammond, LA 70403.

**LOCATION OF WORK:** Just east of Louisiana Highway 44 at the southwest intersection of Panama Canal and Hackett Canal, Section 7, T10S-R3E, in Gonzales, Louisiana, in Ascension Parish, within the Lake Pontchartrain-Lake Maurepas Basin hydrologic unit (HUC 08070204), (Latitude 30.167323 N, Longitude -90.911422 W) as shown on the attached drawings.

**CHARACTER OF WORK:** The applicant has requested Department of the Army authorization to grade, excavate and deposit fill and/or aggregate material to expand a residential subdivision (Pelican Crossing Subdivision, 4<sup>th</sup>, 5<sup>th</sup> and 6<sup>th</sup> Filings) to include 343 lots with houses, driveways and green spaces to accommodate each residence, walking trails, ponds, associated roadways, utilities and drainage infrastructure. Approximately 353,339 cubic yards of fill material would be hauled in and deposited and approximately 375,344 cubic yards of excavated material would be redistributed to achieve required grade elevation requirements. The proposed project is situated on approximately 138 acres and includes approximately 6.12 acres of jurisdictional Waters of the U.S. Of this, approximately 5.24 acres would be filled and 0.88 acre would be excavated by the construction of the subdivision. A preliminary analysis has determined no wetlands to be present at the project site.

It is presumed that the applicant has designed the project to avoid and minimize direct and secondary adverse impacts to the maximum extent practicable. Any further reduction in the proposed development would be cost prohibitive and therefore, deem the project impracticable. To compensate for unavoidable impacts to jurisdictional waters, the applicant proposes to construct a drainage infrastructure within the subdivision to replace the impacted conveyances and ensure sufficient drainage is maintained on the site as well as for adjacent properties.

The comment period for the Department of Army will close in **20 days** from the date of this joint public notice. Written comments, including suggestions for modifications or objections to the proposed work, stating reasons thereof, are being solicited from anyone having interest in this permit and/or this WQC request and must be mailed so as to be received before or by the last day of the comment period. Letters concerning the Corps of Engineers permit application must reference the applicant's name and the Permit Application Number, and be mailed to the Corps of Engineers at the address above, **ATTENTION: REGULATORY BRANCH**. Similar letters concerning the Water Quality Certification must reference the applicant's name and the WQC application number and be mailed to the Louisiana Department of Environmental Quality at the address above. Individuals or parties may request an extension of time in which to comment on the proposed work by writing or e-mailing the Corps of Engineers Project Manager listed above. Any request must be specific and substantively supportive of the requested extension, and received by this office prior to the end of the initial comment period. The Section Chief will review the request and the requestor will be promptly notified of the decision to grant or deny the request. If granted, the time extension will be continuous to the initial comment period and, inclusive of the initial comment period, will not exceed a total of 30 calendar days.

The application for this proposed project is on file with the Louisiana Department of Environmental Quality and may be examined during weekdays between 8:00 a.m. and 4:30 p.m. Copies may be obtained upon payment of costs of reproduction.

### **Corps of Engineers Permit Criteria**

The decision whether to issue a permit will be based on an evaluation of the probable impacts, including cumulative impacts of the proposed activity on the public interest. That decision will reflect the national concern for both protection and utilization of important resources. The benefit which reasonably may be expected to accrue from the proposal must be balanced against its reasonably foreseeable detriments. All factors which may be relevant to the proposal will be considered including the cumulative effects thereof; among those are conservation, economics, aesthetics, general environmental concerns, wetlands, historic properties, fish and wildlife values, flood hazards, floodplain values, land use, navigation, shoreline erosion and accretion, recreation, water supply and conservation, water quality, energy needs, safety, food and fiber production, mineral needs, considerations of property ownership and, in general, the needs and welfare of the people.

The US Army Corps of Engineers is soliciting comments from the public, federal, state, and local agencies and officials, Indian Tribes, and other interested parties in order to consider and evaluate the impacts of this proposed activity. Any comments received will be considered by the US Army Corps of Engineers to determine whether to make, modify, condition, or deny a permit for this proposal. To make this decision, comments are used to assess impacts on endangered species, historic properties, water quality, general environmental effects, and other public interest factors listed above. Comments are used in the preparation of an Environmental Assessment and/or an Environmental Impact Statement pursuant to the National

Environmental Policy Act. Comments are also used to determine the need for a public hearing and to determine the overall public interest of the proposed activity.

The New Orleans District is unaware of properties listed on the National Register of Historic Places near the proposed work. The possibility exists that the proposed work may damage or destroy presently unknown archeological, scientific, prehistorical, historical sites, or data. Copies of this notice are being sent to the State Archeologist and the State Historic Preservation Officer.

Our initial finding is that the proposed work would neither affect any species listed as endangered by the U.S. Departments of Interior or Commerce, nor affect any habitat designated as critical to the survival and recovery of any endangered species. Utilizing Standard Local Operating Procedure for Endangered Species in Louisiana (SLOPES), dated October 22, 2014, between the U.S. Army Corps of Engineers, New Orleans and U.S. Fish and Wildlife Service, Ecological Services Office, the Corps has determined that the proposed activity would have no effect on any listed species.

This notice initiates the Essential Fish Habitat (EFH) consultation requirements of the Magnuson-Stevens Fishery Conservation and Management Act. The applicant's proposal would result in the destruction or alteration of up to n/a acres of EFH utilized by various life stages of red drum and penaeid shrimp. Our initial determination is that the proposed action would not have a substantial adverse impact on EFH or federally managed fisheries in the Gulf of Mexico. Our final determination relative to project impacts and the need for mitigation measures is subject to review by and coordination with the National Marine Fisheries Service.

If the proposed work involves deposits of dredged or fill material into navigable waters, the evaluation of the probable impacts will include the application of guidelines established by the Administrator of the Environmental Protection Agency. Also, a certification that the proposed activity will not violate water quality standards will be required from the Department of Environmental Quality, Office of Environmental Services before a permit is issued.

Any person may request, in writing, within the comment period specified in this notice, that a public hearing be held to consider this application. Requests for public hearings shall state, with particularity, the reasons for holding a public hearing. You are requested to communicate the information contained in this notice to any other parties whom you deem likely to have interest in the matter.

JOHN M. HERMAN  
Chief, Central Evaluation Section  
Regulatory Branch

Enclosures

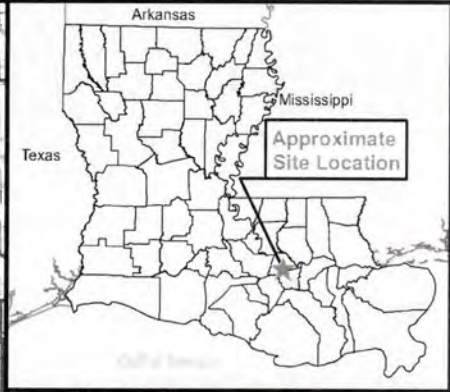
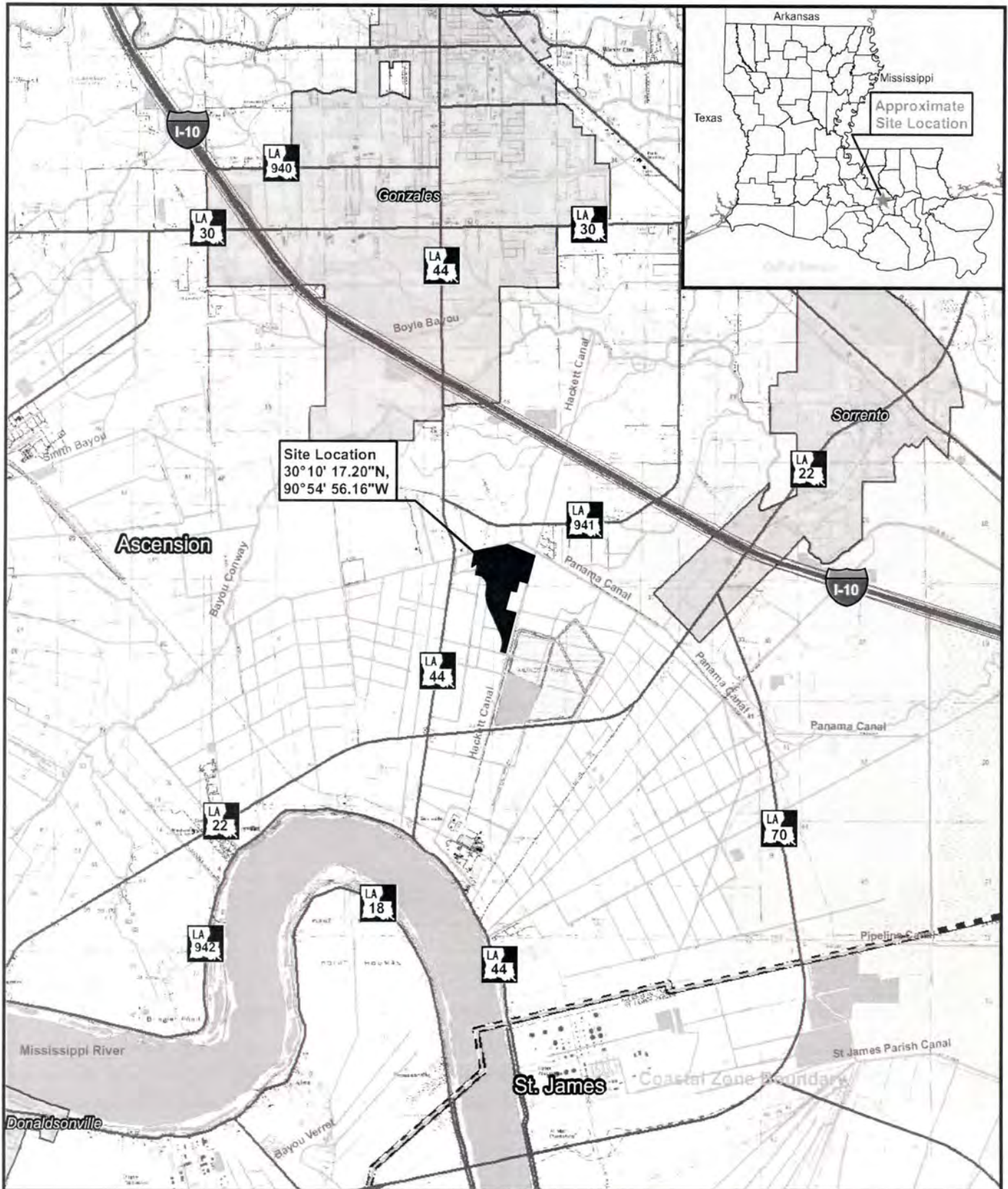

Site Location  
 30°10' 17.20"N,  
 90°54' 56.16"W

**ELOS**  
 environmental  
<http://elosenv.com/>  
 43177 East Pleasant Ridge Road  
 Hammond, Louisiana 70403  
 P. 985-662-5501, F. 985-662-5504

0 0.5 1 Miles

**Figure 1: TopoVicinity Map**

**Pelican Crossing**  
 (4th, 5th, and 6th Filings)

**Legend:**

- Site Outline
- Interstates
- Primary and Secondary Roads
- Cities & Towns
- Coastal Zone Boundary
- Parish Boundary
- Waters
- Stream/River

Map prepared from public and proprietary spatial data. ELOS Environmental, LLC does not warrant its accuracy or completeness. This map should not be used to establish legal boundaries or specific locations.



  
**ELOS**  
 environmental  
<http://elosenv.com/>  
 43177 East Pleasant Ridge Road  
 Hammond, Louisiana 70403  
 P. 985-662-5501, F. 985-662-5504

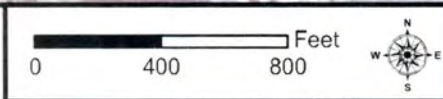

Figure 2: Existing Conditions

**Pelican Crossing**  
(4th, 5th, and 6th Filings)

**Legend:**

-  Site Outline

Map prepared from public and proprietary spatial data. ELOS Environmental, LLC does not warrant its accuracy or completeness. This map should not be used to establish legal boundaries or specific locations.

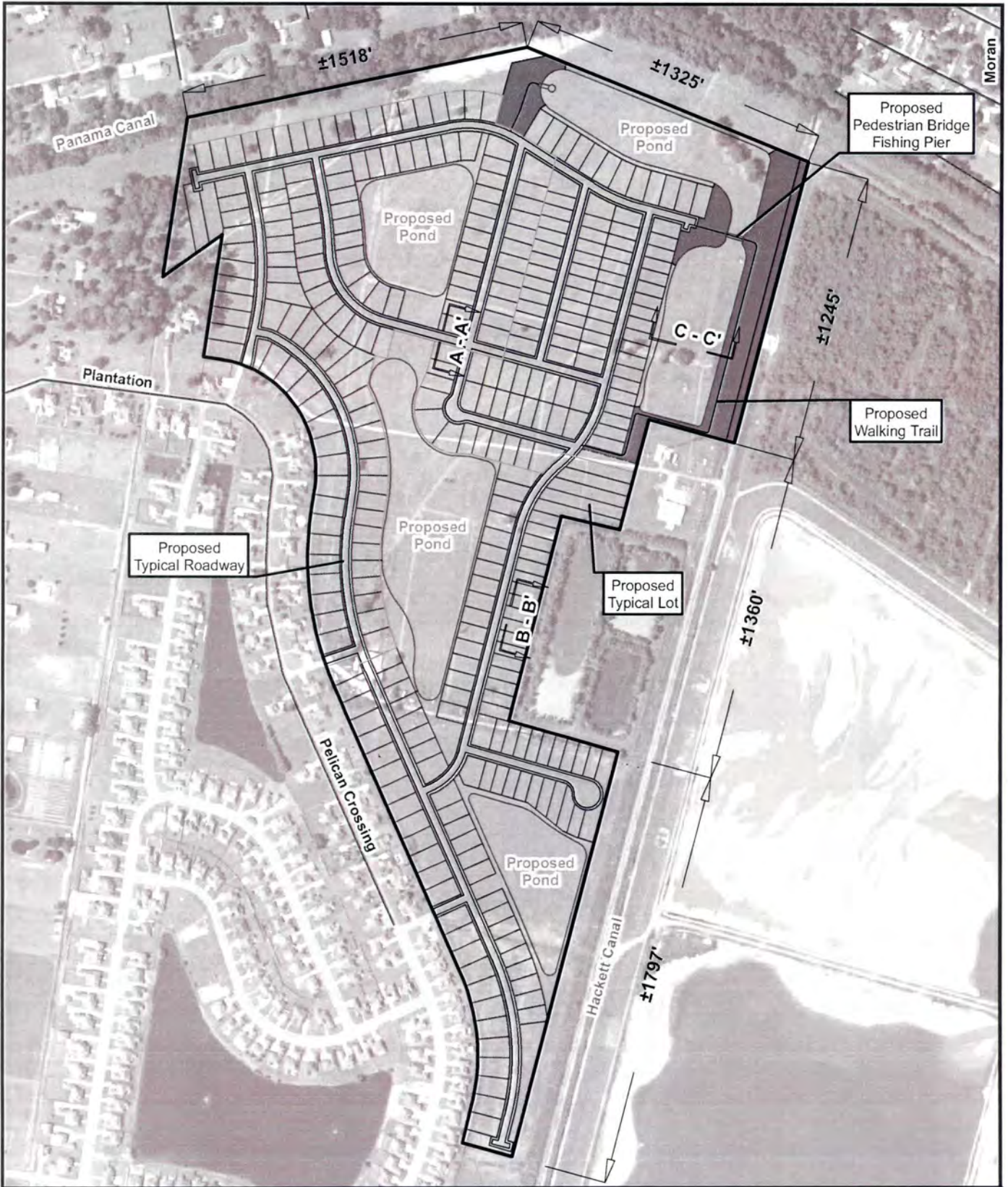

43177 East Pleasant Ridge Road  
Hammond, Louisiana 70403  
P. 985-662-5501, F. 985-662-5504

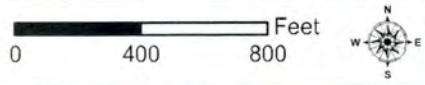
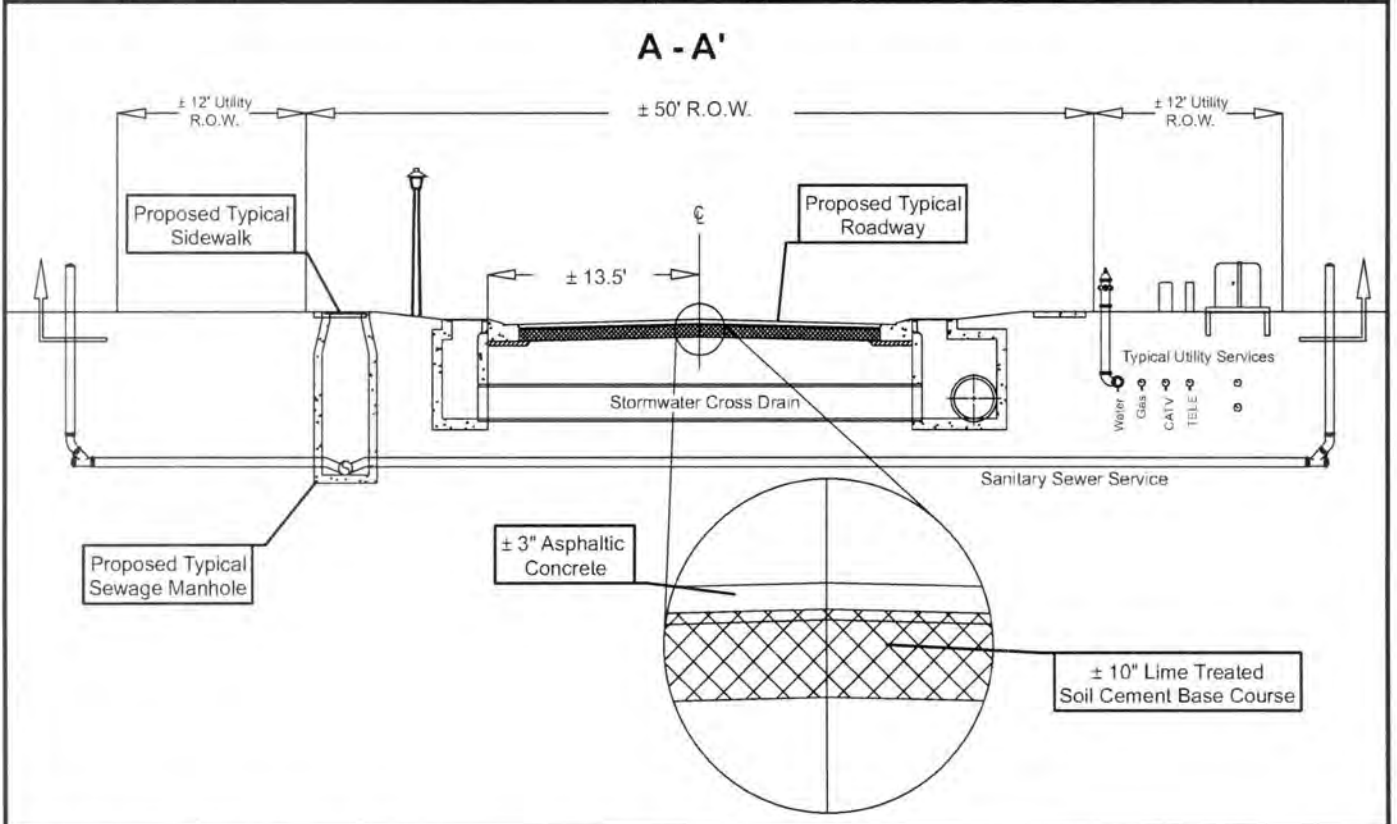
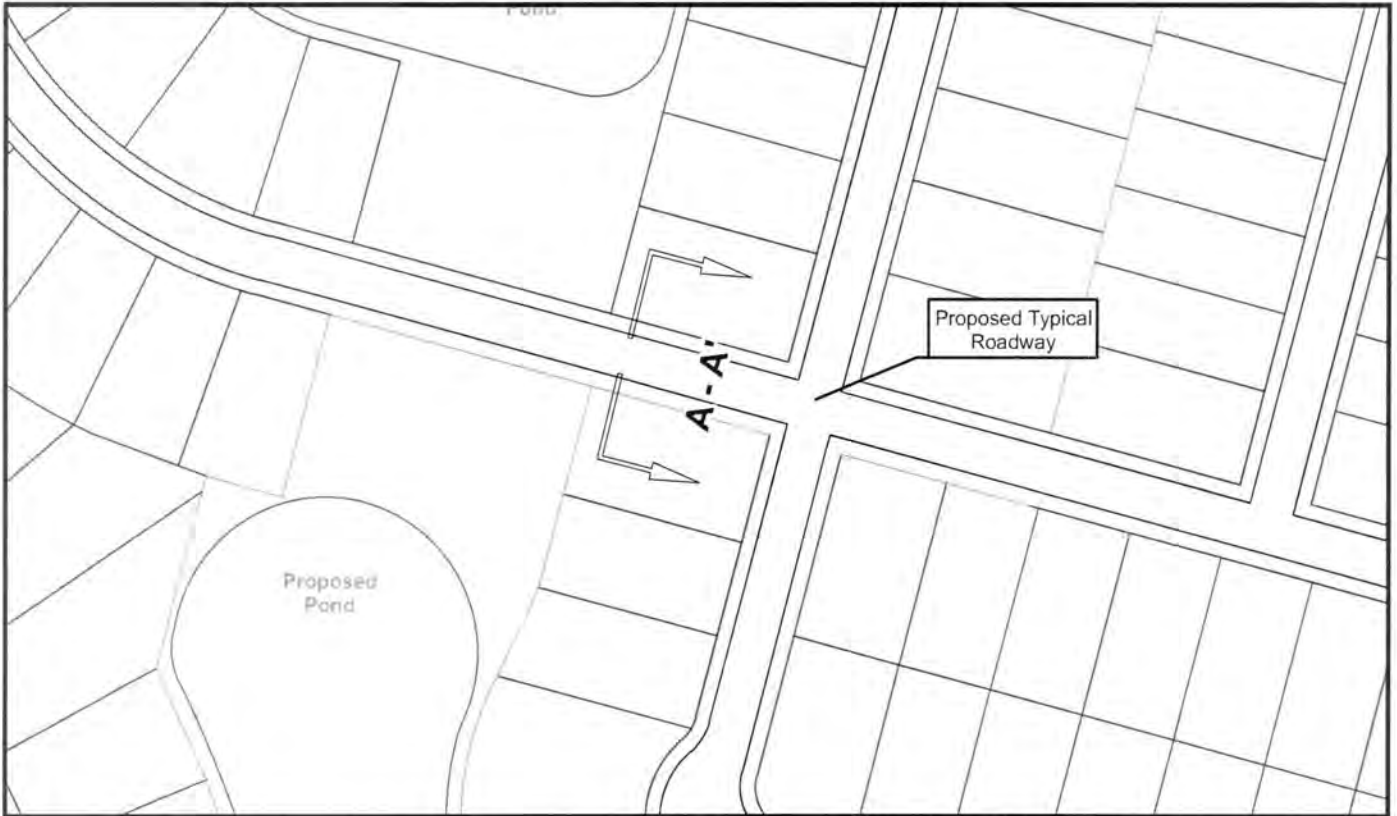



Figure 3: Plan View

**Pelican Crossing**  
(4th, 5th, and 6th Filings)

- Legend:**
- Site Outline
  - Park Area

Map prepared from public and proprietary spatial data. ELOS Environmental, LLC does not warrant its accuracy or completeness. This map should not be used to establish legal boundaries or specific locations.



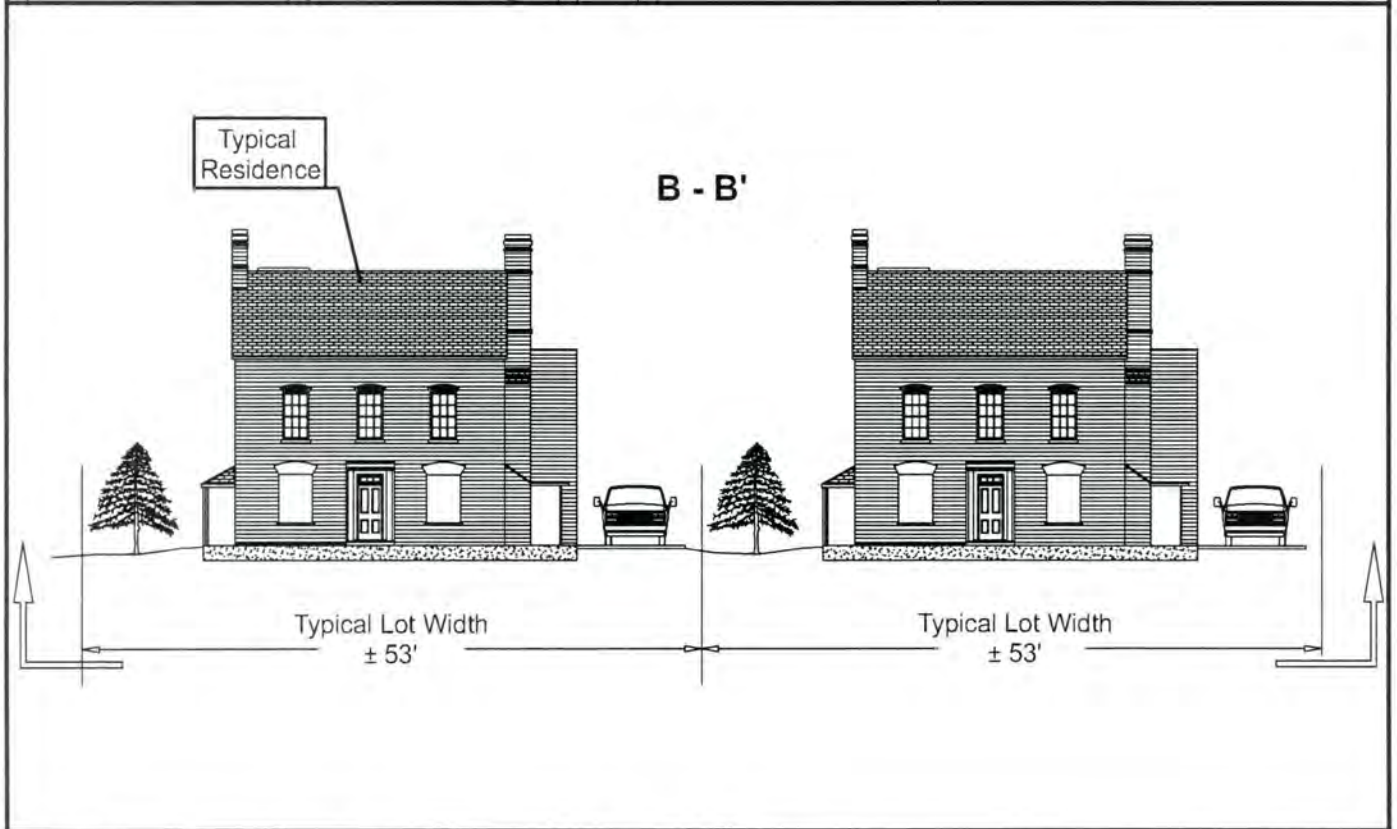
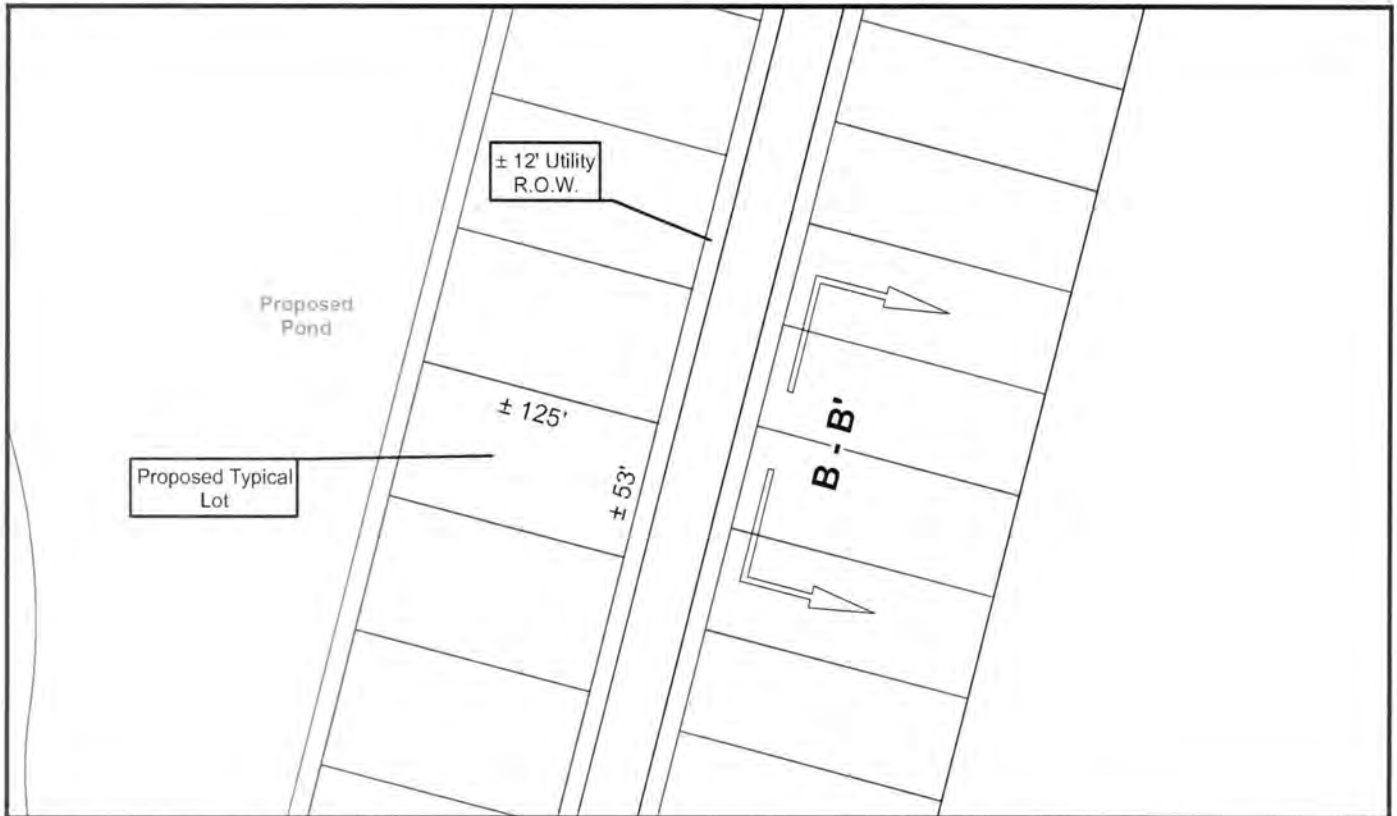

 <p>43177 East Pleasant Ridge Road Hammond, Louisiana 70403 P. 985-662-5501, F. 985-662-5504</p>	<p><b>Scale = Not To Scale</b></p>	<p>Map prepared from public and proprietary spatial data. ELOS Environmental, LLC does not warrant its accuracy or completeness. This map should not be used to establish legal boundaries or specific locations.</p>
	<p>Figure 4: Typical Roadway Cross Section</p>	
	<p><b>Pelican Crossing</b> (4th, 5th, and 6th Filings)</p>	



 <p><b>ELOS</b> environmental <a href="http://elosenv.com/">http://elosenv.com/</a> 43177 East Pleasant Ridge Road Hammond, Louisiana 70403 P. 985-662-5501, F. 985-662-5504</p>	<p><b>Scale = Not To Scale</b></p>	
	<p>Figure 5: Typical Lot Cross Section</p>	
	<p><b>Pelican Crossing</b> (4th, 5th, and 6th Filings)</p>	<p>Map prepared from public and proprietary spatial data. ELOS Environmental, LLC does not warrant its accuracy or completeness. This map should not be used to establish legal boundaries or specific locations.</p>

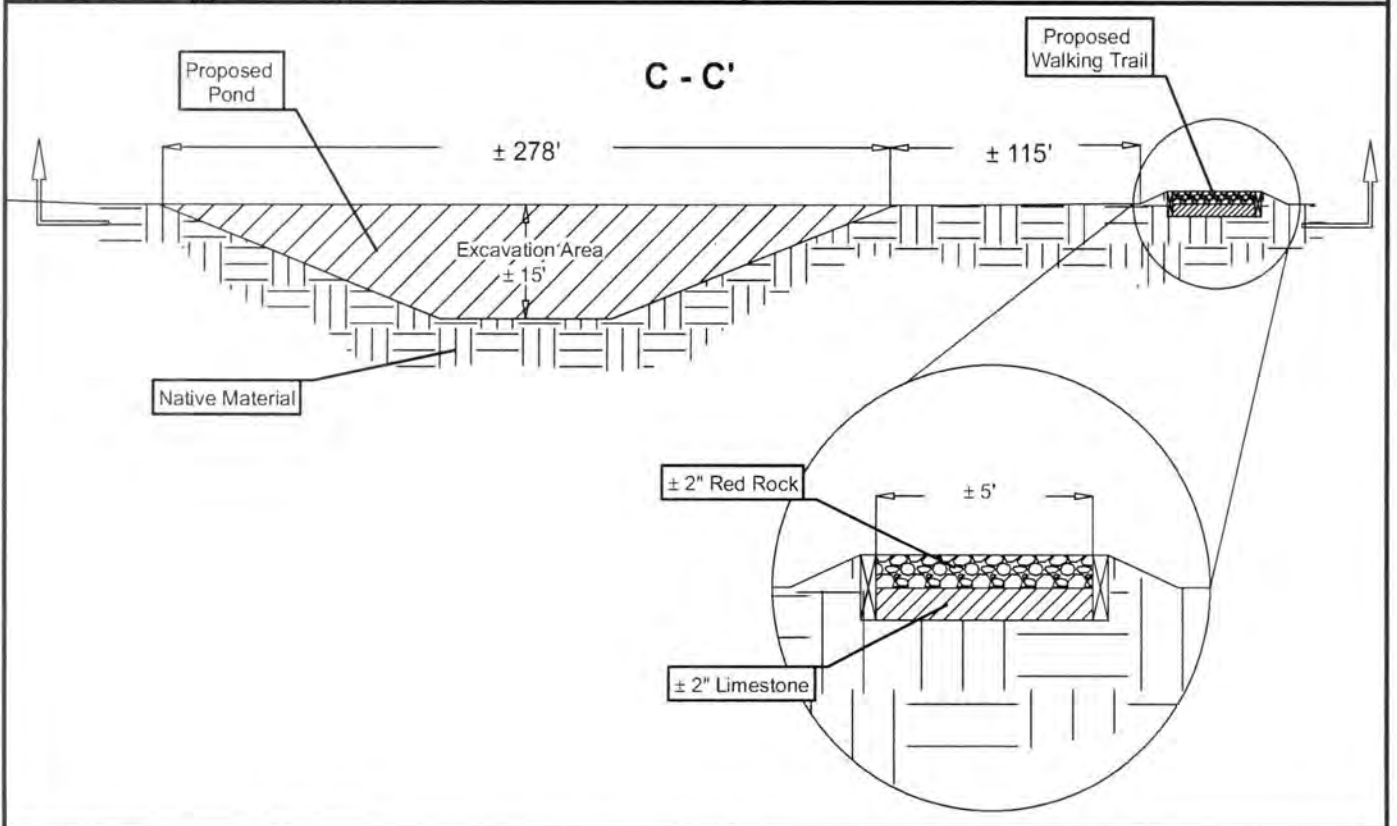
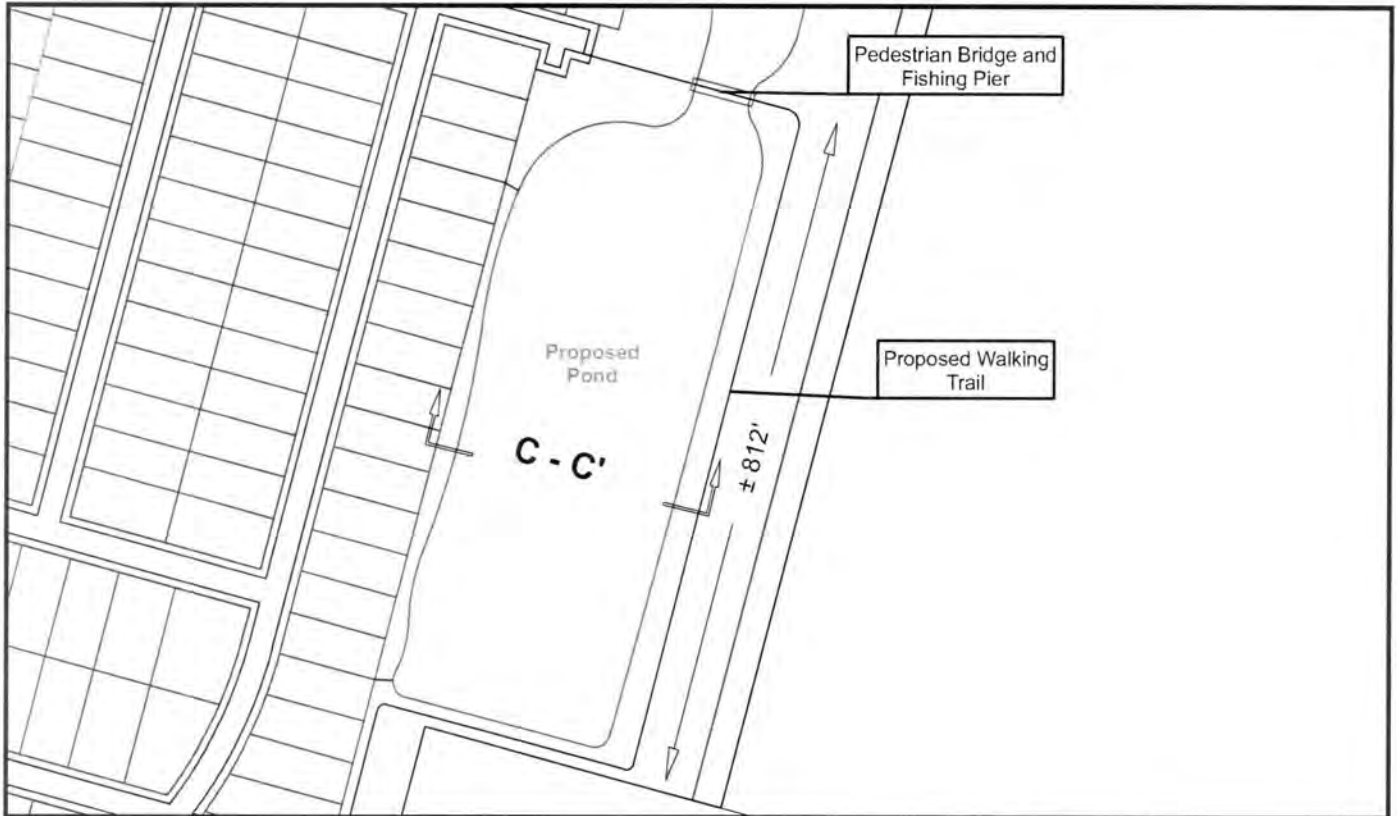



 <p>environmental  <a href="http://elosenv.com/">http://elosenv.com/</a>          43177 East Pleasant Ridge Road          Hammond, Louisiana 70403          P. 985-662-5501, F. 985-662-5504</p>	<p><b>Scale = Not To Scale</b></p>	<p>Map prepared from public and proprietary spatial data. ELOS Environmental, LLC does not warrant its accuracy or completeness. This map should not be used to establish legal boundaries or specific locations.</p>
	<p>Figure 6: Typical Pond Cross Section</p>	
	<p><b>Pelican Crossing</b> (4th, 5th, and 6th Filings)</p>	

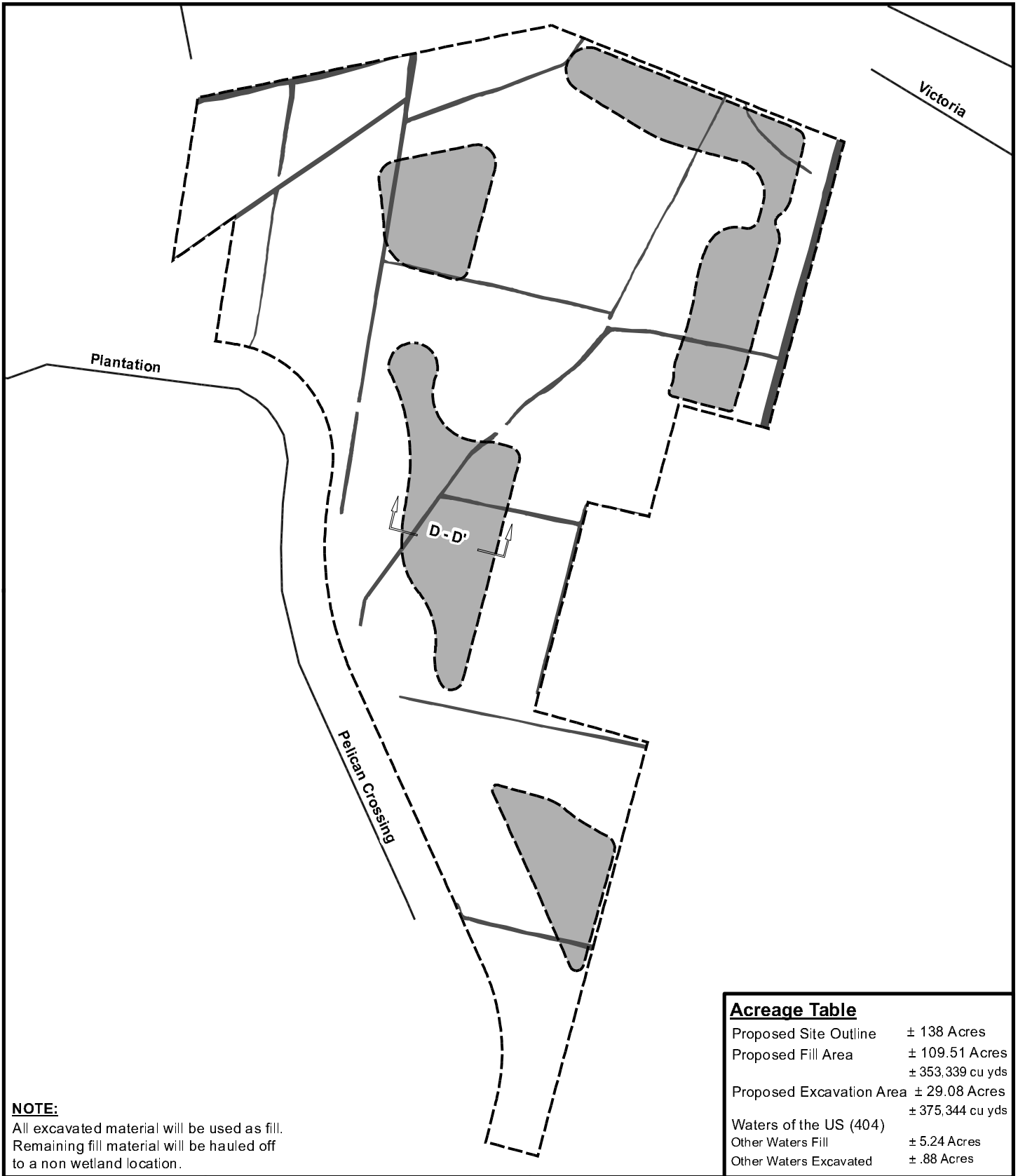

<b>Acreeage Table</b>	
Proposed Site Outline	± 138 Acres
Proposed Fill Area	± 109.51 Acres ± 353,339 cu yds
Proposed Excavation Area	± 29.08 Acres ± 375,344 cu yds
Waters of the US (404)	± 5.24 Acres
Other Waters Excavated	± .88 Acres

**NOTE:**  
 All excavated material will be used as fill.  
 Remaining fill material will be hauled off  
 to a non wetland location.

**ELOS**  
 environmental  
<http://elosenv.com/>  
 43177 East Pleasant Ridge Road  
 Hammond, Louisiana 70403  
 P. 985-662-5501, F. 985-662-5504

0 400 800 Feet

**Figure 7: Proposed Findings**

**Pelican Crossing**  
 (4th, 5th, and 6th Filings)

**Legend:**

- Proposed Fill Area
- Waters of the US 404
- Proposed Excavation Area

**Refer to MVN-2015-00161-SQ**

Map prepared from public and proprietary spatial data. ELOS Environmental, LLC does not warrant its accuracy or completeness. This map should not be used to establish legal boundaries or specific locations.

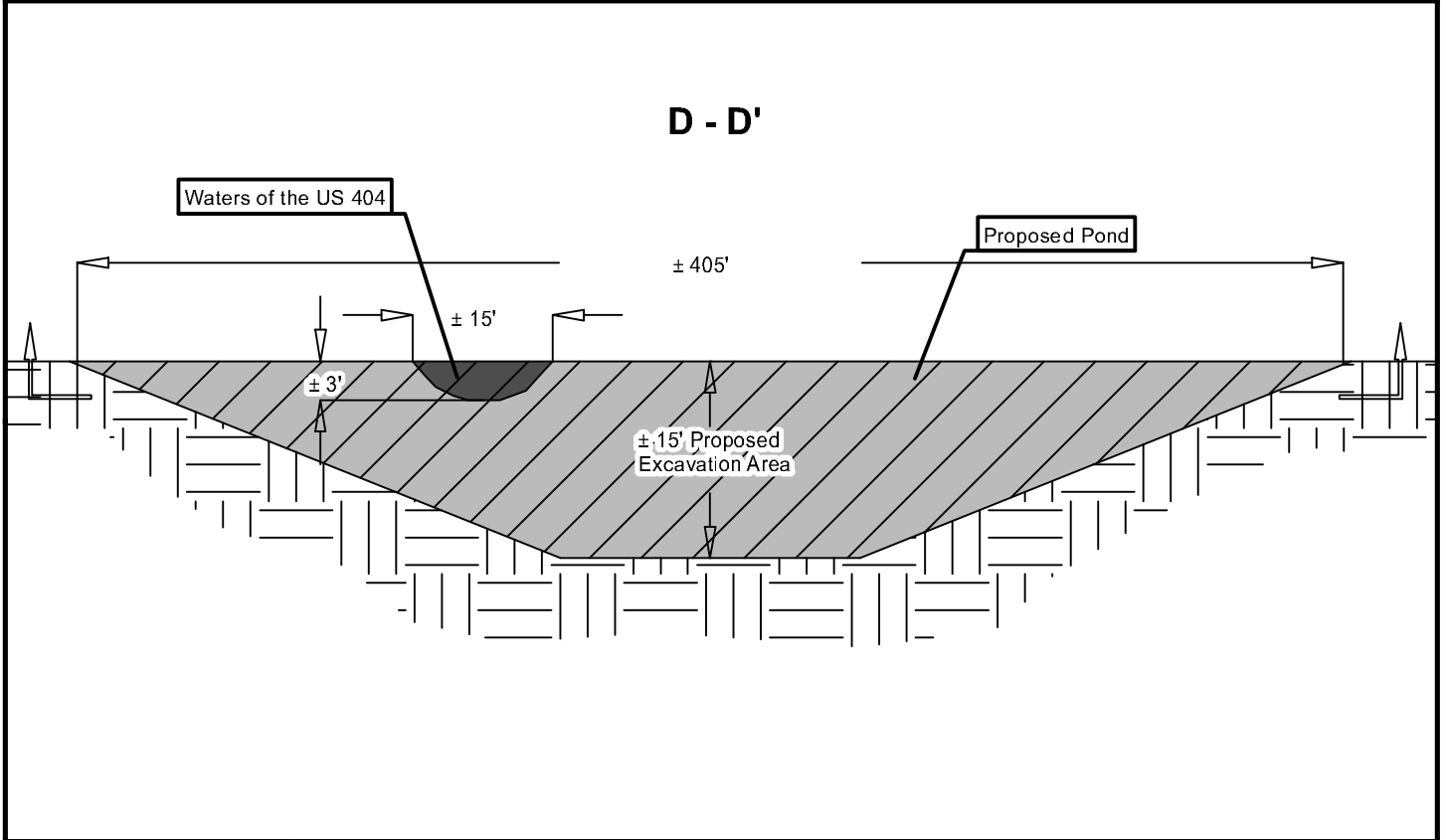
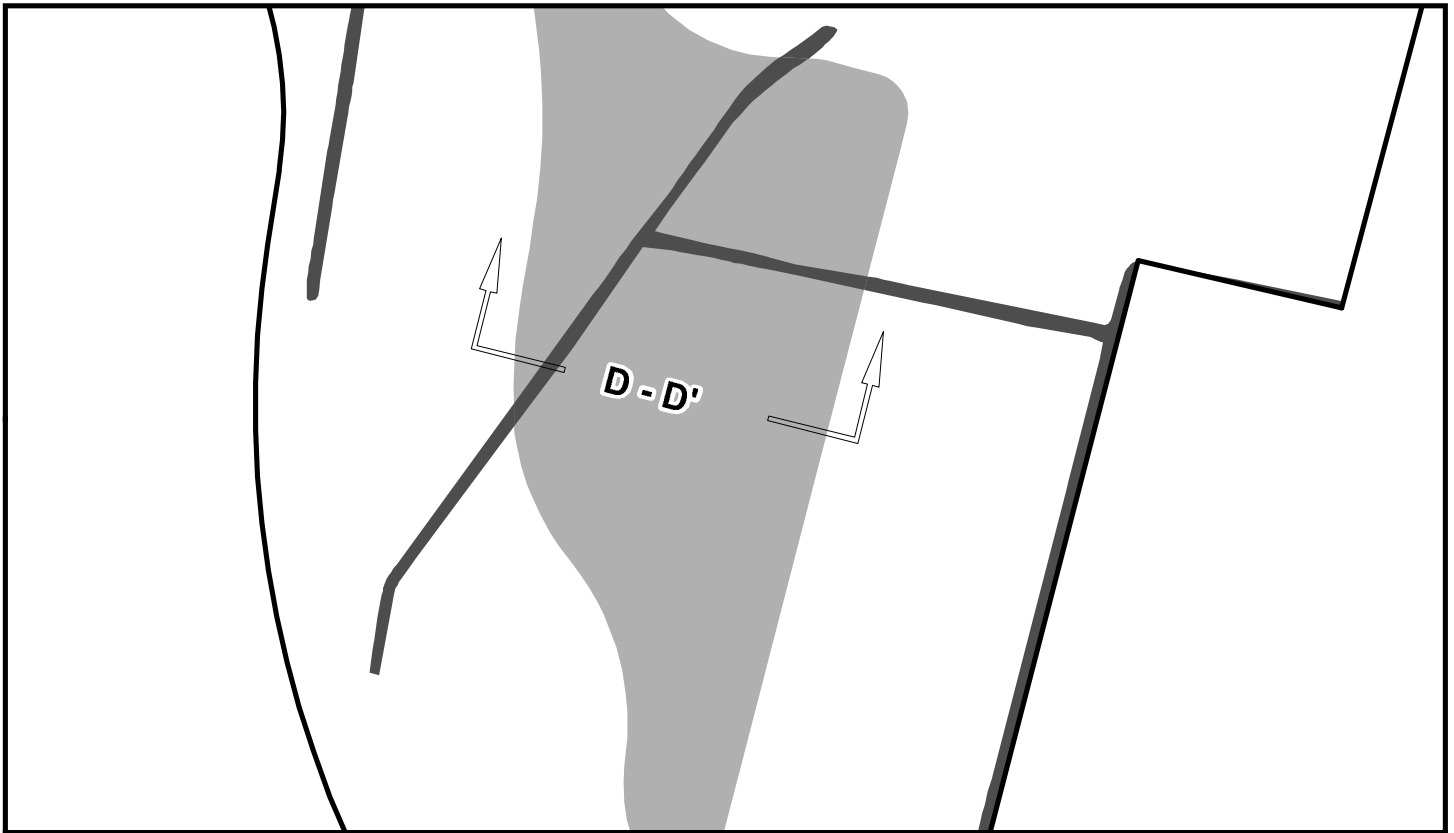

**Scale = Not To Scale**

Figure 8: Typical Ditch  
Cross Section

**Pelican Crossing**  
(4th, 5th, and 6th Filings)

**Legend:**

- Site Outline
- Waters of the US 404
- Proposed Excavation Area

**Refer to MVN-2015-00161-SQ**

Map prepared from public and proprietary spatial data. ELOS Environmental, LLC does not warrant its accuracy or completeness. This map should not be used to establish legal boundaries or specific locations.